



**ASSESSMENT WORK REPORT
CROXALL-VUKSANOVICH PROPERTY
SHAW TOWNSHIP, PORCUPINE MINING DIVISION**

Sept. 26, 1998

The Croxall-Vuksanovich property consists of 10 unpatented mining claims (24 units)in the north-east part of Shaw Township (see portion of Sept. 22,1998 claim map attached). The claims were acquired by staking during the period Oct. 25,1997 to Sept.19, 1998 to cover two previously mapped (by others) cherty iron formations. Where observed in the field these units were found to contain little or no mineralization other than sugary textured white chert. The property was staked as a silica prospect.

Two grab samples taken from a chert outcrop on claim no. 1228836 were sent for whole rock analysis and a multi-element scan. A copy of the May 8,1998 Swastika Lab assay report no. 8W1076 is attached and shows a high free silica content and negligible contaminants. The visual uniformity of the deposits makes additional grab sampling at this time of little significance. Where future changes are noted additional grab sampling will be performed or deferred in favour of channel or drill core sampling.

The attached sketch map shows the initial prospecting traverses and manual stripping performed by the recorded holder and his partner on claims no. 1228836 and 1229264 on Sept.23,24,25/98 to begin delineation of the two zones in the field.

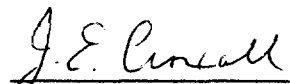

J.E. Croxall
Recorded Holder



Eli Vuksanovich
Partner

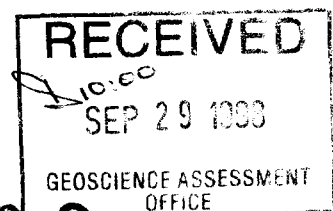

2.18902

ASSESSMENT WORK - PROSPECTING & MANUAL STRIPPING

CROXALL-VUKSANDUHLH PROPERTY

SHAW TOWNSHIP

SCALE 1:5000

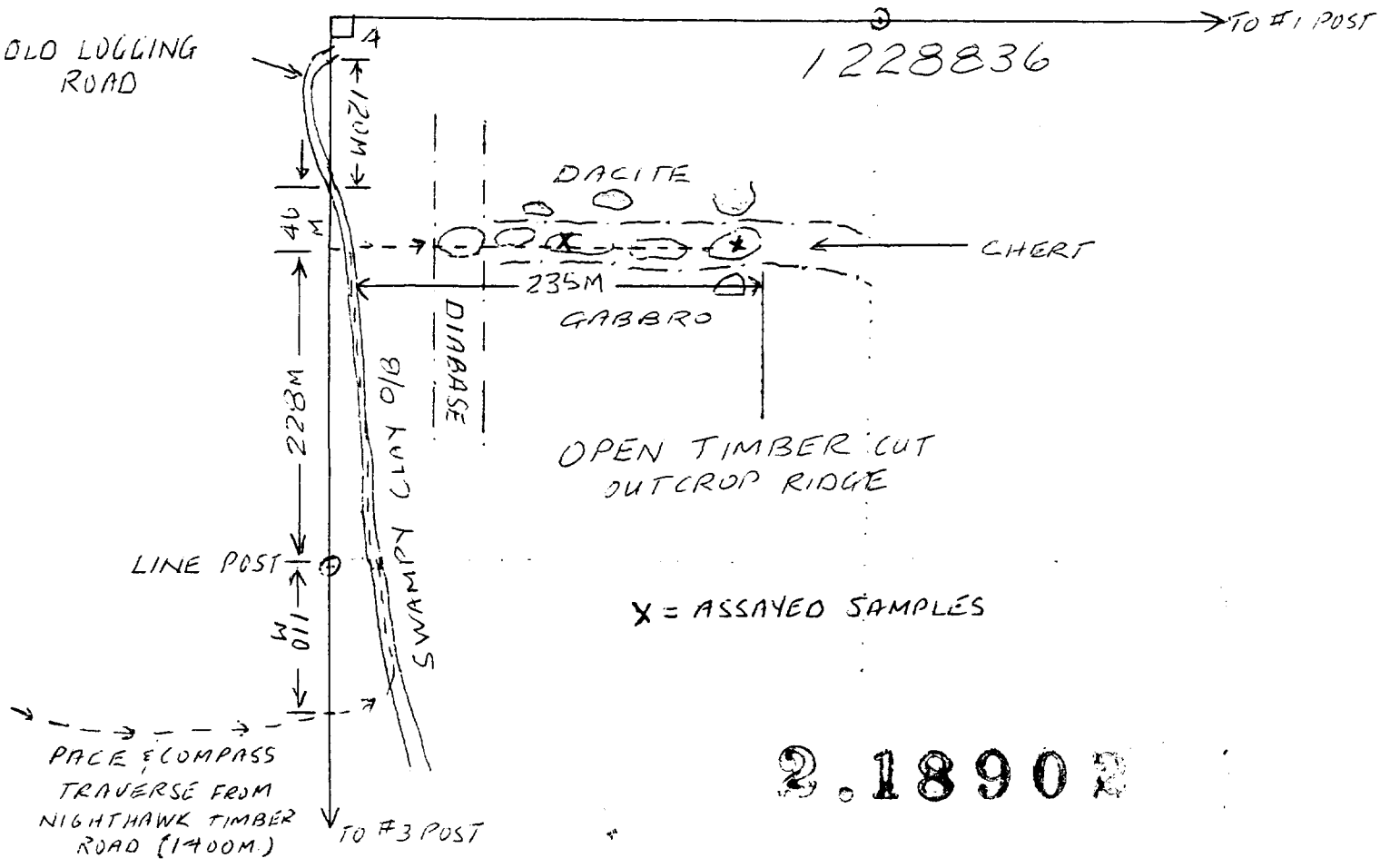
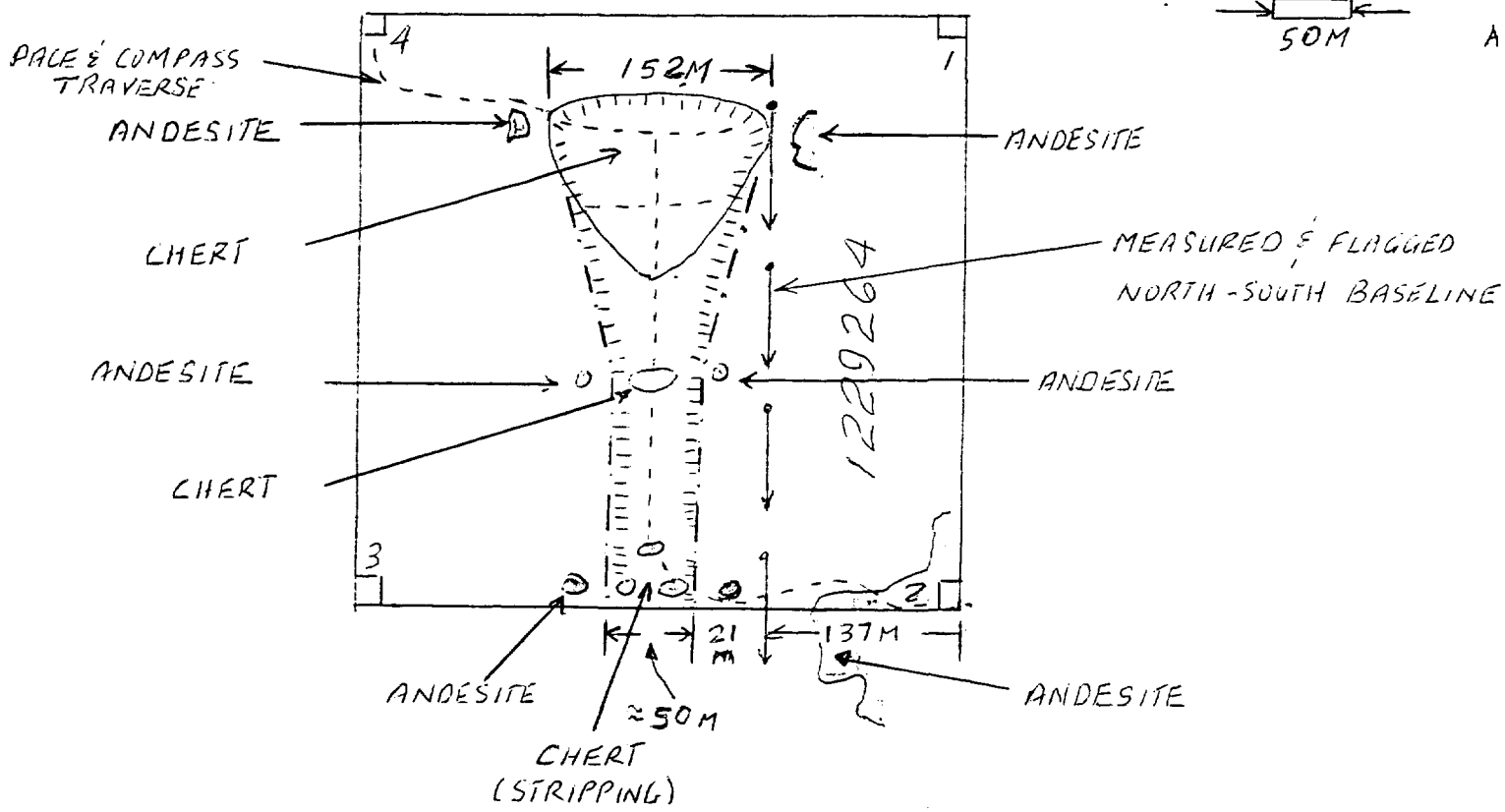
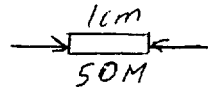

2.18902

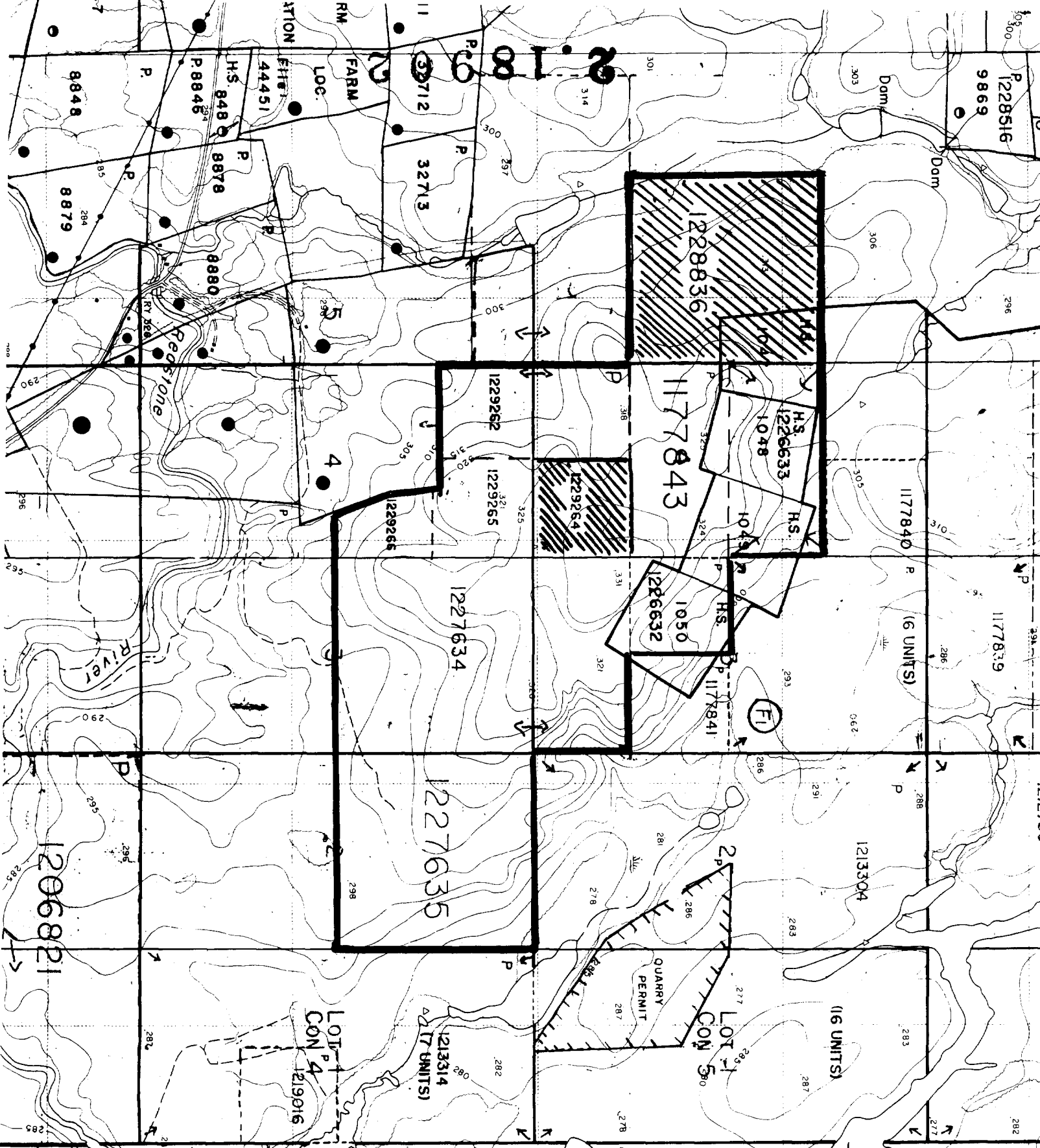

CROXALL-VUKSINOVICH PRPTY.

CLAIMS WHERE WORK PERFORMED

CARMAN TWP

IV

V

10

20

30

40

50

48° 26'

NOV 19 '98 14:25

7052674314

PAGE.03

11/19/1998 14:22

7052674314

CROXALL

PAGE 03

J.E. CROXALL

Attention: J.E. Croxall

Project:

Sample: Rock

Swastika Laboratories

1 Cameron Ave., Swastika, Ontario

PHONE (705) 642-3244 FAX (705) 642-3300

Report No : BW1076,

Date : May-08-98

MULTI-ELEMENT ICP ANALYSIS

Aqua Regia Digestion

Sample Number	Ag ppm	Al %	As ppm	Ba ppm	Be ppm	Bi ppm	Ca %	Cd ppm	Co ppm	Cr ppm	Cu ppm	Fe %	K %	Mg %	Mn ppm	Mo ppm	Na %	Ni ppm	P ppm	Pb ppm	Sb ppm	Sc ppm	Sn ppm	Sr ppm	Ti %	V ppm	W ppm	Y ppm	Zn ppm	Zr ppm
SH #1	<0.2	0.01	<5	<10	<0.5	<5	0.01	<1	5	538	5	0.36	<0.01	0.01	45	2	0.01	16	10	<2	5	<1	<10	1	<0.01	10	<10	<1	3	<1
SH #2	<0.2	<0.01	<5	<10	<0.5	<5	<0.01	<1	2	274	4	0.25	<0.01	<0.01	20	<2	0.01	7	10	<2	<5	<1	<10	<1	<0.01	5	<10	<1	1	<1

2 189 02

A .5 gm sample is digested with 10 ml 3:1 HCl/HNO3 at 95c for 2 hours and diluted to 25ml with D.I.H2O.

ASSAY REPORT-Page 2 of 2

Signed



42A06NE2006 2.18902 SHAW

900

Sections 65(2) and 66(3) of the Mining Act. Under section 8 of the Mining Act, this work and correspond with the mining land holder. Questions about this collection and Mines, 3rd Floor, 933 Ramsey Lake Road, Sudbury, Ontario, P3E 6B5.

Instructions: - For work performed on Crown Lands before recording a claim, use form 0240.
 - Please type or print in ink.

1. Recorded holder(s) (Attach a list if necessary)

Name	JAMES E. CROXALL	Client Number	122685
Address	152 BROCK AVE TIMMINS, ONTARIO, P4N7P1	Telephone Number	(705)-267-4314
		Fax Number	(705)-267-4314
Name		Client Number	
Address		Telephone Number	
		Fax Number	

2. Type of work performed: Check (✓) and report on only ONE of the following groups for this declaration.

Geotechnical: prospecting, surveys, assays and work under section 18 (regs)
 Physical: drilling stripping, trenching and associated assays
 Rehabilitation

Work Type	PROSPECTING TRAVERSES & MANUAL STRIPPING	Office Use
		Commodity
		Total \$ Value of Work Claimed \$ 1106
Dates Work Performed	From Day 23 Month 9 Year 98 To Day 25 Month 9 Year 98	NTS Reference
Global Positioning System Data (if available)	Township/Area SHAW TWP.	Mining Division
	M or G-Plan Number G-3999	Resident Geologist District

Please remember to: - obtain a work permit from the Ministry of Natural Resources as required;
 - provide proper notice to surface rights holders before starting work;
 - complete and attach a Statement of Costs, form 0212;
 - provide a map showing contiguous mining lands that are linked for assigning work;
 - include two copies of your technical report.

3. Person or companies who prepared the technical report (Attach a list if necessary)

Name	JAMES E. CROXALL	Telephone Number	(705)-267-4314
Address	152 BROCK AVE., TIMMINS, ONT., P4N7P1	Fax Number	(705)-267-4314
Name		Telephone Number	
Address		Fax Number	
Name		Telephone Number	
Address		Fax Number	

4. Certification by Recorded Holder or Agent

I, JAMES E. CROXALL (Print Name), do hereby certify that I have personal knowledge of the facts set forth in this Declaration of Assessment Work having caused the work to be performed or witnessed the same during or after its completion and, to the best of my knowledge, the annexed report is true.

Signature of Recorded Holder or Agent	J. E. Croxall	Date	SEPT. 26/98
Agent's Address	152 BROCK AVE., TIMMINS, ONT., P4N7P1	Telephone Number	(705)-267-4314
		Fax Number	(705)-267-4314

0241 (03/97)

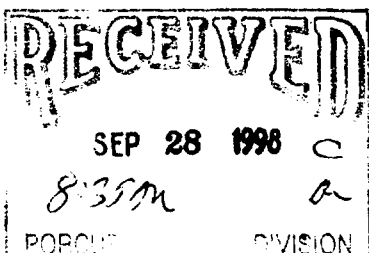

2.18902

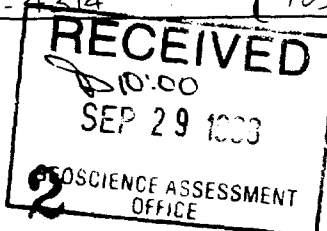

De... 22/98

5. Work to be recorded and distributed. Work can only be assigned to claims that are contiguous (adjoining) to the mining land where work was performed, at the time work was performed. A map showing the contiguous link must accompany this form.

12286.00790

Mining Claim Number. Or if work was done on other eligible mining land, show in this column the location number indicated on the claim map.	Number of Claim Units. For other mining land, list hectares.	Value of work performed on this claim or other mining land.	Value of work applied to this claim.	Value of work assigned to other mining claims.	Bank. Value of work to be distributed at a future date
eg TB 7827	16 ha	\$26,825	N/A	\$24,000	\$2,825
eg 1234567	12	0	\$24,000	0	0
eg 1234568	2	\$ 8,892	\$ 4,000	0	\$4,892
1 1229264	1	\$ 737.00	\$ 400.00 /	\$ 337.00	
2 1228836	4	\$ 368.50	Ø	\$ 368.50 /	
3 1229266	1	Ø	\$ 400.00 /		
4 1229265	1	Ø	305.50 /		
5					
6					
7					
8					
9					
10					
11					
12					
13					
14					
15					
Column Totals		\$ 1105.50	\$ 1105.50	\$ 705.50	Ø

I, JAMES E. CROXALL (Print Full Name), do hereby certify that the above work credits are eligible under subsection 7 (1) of the Assessment Work Regulation 6/96 for assignment to contiguous claims or for application to the claim where the work was done.

Signature of Recorded Holder or Agent Authorized in Writing: J.E. Croxall Date: SEPT 26/98

6. Instructions for cutting back credits that are not approved.

Some of the credits claimed in this declaration may be cut back. Please check (✓) in the boxes below to show how you wish to prioritize the deletion of credits:

- 1. Credits are to be cut back from the Bank first, followed by option 2 or 3 or 4 as indicated.
- 2. Credits are to be cut back starting with the claims listed last, working backwards; or
- 3. Credits are to be cut back equally over all claims listed in this declaration; or
- 4. Credits are to be cut back as prioritized on the attached appendix or as follows (describe):

1229265 FIRST, 1229264 SECOND, 1229266 LAST.

Note: If you have not indicated how your credits are to be deleted, credits will be cut back from the Bank first, followed by option number 2 if necessary.

For Office Use Only

Received Stamp	Deemed Approved Date	Date Notification Sent
	Date Approved	Total Value of Credit Approved
Approved for Recording by Mining Recorder (Signature)		

0241 (03/97)

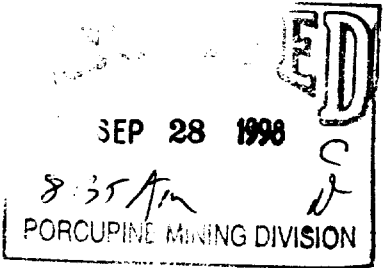



W 4860.05790

Personal information collected on this form is obtained under the authority of subsection 6 (1) of the Assessment Work Regulation 6/96. Under section 8 of the Mining Act, this information is a public record. This information will be used to review the assessment work and correspond with the mining land holder. Questions about this collection should be directed to a Provincial Mining Recorder, Ministry of Northern Development and Mines, 3rd Floor, 933 Ramsey Lake Road, Sudbury, Ontario, P3E 6B5.

Work Type	Units of work Depending on the type of work, list the number of hours/days worked, metres of drilling, kilometres of grid line, number of samples, etc.	Cost Per Unit of work	Total Cost
PROSPECTING & MANUAL STRIPPING	6 MANDAYS @ 8 HR/DAY	\$150 / MANDAY	\$ 900
	WORK PERFORMED BY:		
	J. CROXALL - 3 DAYS (K-18327)		
	E. VUKSANOVICH - 3 DAYS (M-25346)		
Associated Costs (e.g. supplies, mobilization and demobilization).			
4 WHEEL ALL-TERRAIN VEHICLE USED FOR			
MOBE & DEMOBE ACCESS FROM TRUCK PARKING AREA			
TO PROPERTY (OWNED BY J. CROXALL)			
CLAIM EQUIVALENT RENTAL RATE @ \$55/DAY (VERBAL			
QUOTE FROM TILDEN) FOR 3 CALENDAR DAYS			
		\$ 55/DAY	\$ 165
Transportation Costs			
TRAVEL - TRUCK			
45 km (return) / DAY x 3 DAYS x \$0.30/km			
		\$ 13.50 / DAY	\$ 40.50
Food and Lodging Costs			
N/A			
Total Value of Assessment Work			\$ 1105.50

Calculations of Filing Discounts:

1. Work filed within two years of performance is claimed at 100% of the above Total Value of Assessment Work.
2. If work is filed after two years and up to five years after performance, it can only be claimed at 50% of the Total Value of Assessment Work. If this situation applies to your claims, use the calculation below:

TOTAL VALUE OF ASSESSMENT WORK x 0.50 = Total \$ value of worked claimed.

Note:

- Work older than 5 years is not eligible for credit.
- A recorded holder may be required to verify expenditures claimed in this statement of costs within 45 days of a request for verification and/or correction/clarification. If verification and/or correction/clarification is not made, the Minister may reject all or part of the assessment work submitted.

Certification verifying costs:

I, JAMES E. CROXALL, do hereby certify, that the amounts shown are as accurate as may reasonably be determined and the costs were incurred while conducting assessment work on the lands indicated on the accompanying

Declaration of Work form as RECORDED HOLDER I am authorized to make this certification. (recorded holder, agent, or state company position with signing authority)

RECEIVED SEP 28 1998 8:57 AM

Signature: J. E. Croxall Date: SEPT 26/98

RECEIVED 10:00 SEP 28 1998 GEOSCIENCE ASSESSMENT OFFICE

Geoscience Assessment Office
933 Ramsey Lake Road
6th Floor
Sudbury, Ontario
P3E 6B5

Telephone: (888) 415-9846
Fax: (877) 670-1555

November 20, 1998

JAMES ERNEST CROXALL
152 BROCK AVENUE
TIMMINS, ONTARIO
P4N-7P1

Visit our website at:
www.gov.on.ca/MNDM/MINES/LANDS/mlsmnpge.htm

Dear Sir or Madam:

Submission Number: 2.18902

Status

Subject: Transaction Number(s): W9860.00790 Approval

We have reviewed your Assessment Work submission with the above noted Transaction Number(s). The attached summary page(s) indicate the results of the review. WE RECOMMEND YOU READ THIS SUMMARY FOR THE DETAILS PERTAINING TO YOUR ASSESSMENT WORK.

If the status for a transaction is a 45 Day Notice, the summary will outline the reasons for the notice, and any steps you can take to remedy deficiencies. The 90-day deemed approval provision, subsection 6(7) of the Assessment Work Regulation, will no longer be in effect for assessment work which has received a 45 Day Notice. Allowable changes to your credit distribution can be made by contacting the Geoscience Assessment Office within this 45 Day period, otherwise assessment credit will be cut back and distributed as outlined in Section #6 of the Declaration of Assessment work form.

Please note any revisions must be submitted in DUPLICATE to the Geoscience Assessment Office, by the response date on the summary.

If you have any questions regarding this correspondence, please contact Steve Beneteau by e-mail at benetest@epo.gov.on.ca or by telephone at (705) 670-5855.

Yours sincerely,



ORIGINAL SIGNED BY
Blair Kite
Supervisor, Geoscience Assessment Office
Mining Lands Section

Work Report Assessment Results

Submission Number: 2.18902

Date Correspondence Sent: November 20, 1998

Assessor: Steve Beneteau

Transaction Number	First Claim Number	Township(s) / Area(s)	Status	Approval Date
W9860.00790	1229264	SHAW	Approval	November 19, 1998

Section:
10 Physical PSTRIP
9 Prospecting PROSP

Correspondence to:
Resident Geologist
South Porcupine, ON

Recorded Holder(s) and/or Agent(s):
JAMES ERNEST CROXALL
TIMMINS, ONTARIO

Assessment Files Library
Sudbury, ON

MAP SYMBOLOLOGY

Aerial Cableway	Pipeline
Boundary	Railroad
International	Single Track
District, Township	Abandoned
Indian Reserve	Turbidite
Approximate	Road
Lot, Subdivision	Highway, County
Approximate	Township
Park Boundary	Access (road of doubtful
Bridge	importance)
Roat, Railroad	Trail, Bush Road
Building	(various, utility)
Chimney	Rapids
Cliff, Pit, Pile	Double line river
Contours	with multiple rapids
Interpretation	Reservoir
Approximate	River, Stream, Canal
Depression	Approximate
Control Points	Direction of flow
Horizontal	Rock
Vertical	Significant
Culvert	Spot Elevation
Falls	(with elevation)
Dam, Dammed	Tower
Fence, Hedge, Wall	Transmission Line
Feature Outline	Pylon
(contour lines, etc.)	Tunnel
Flooded Land	Utility Poles
Lock	Wharf, Dock, Pier
Marsh or Swamp	Wooded Area
Moat	
Mine Head Frame	
Outcrop	

AREAS WITHDRAWN FROM DISPOSITION

M.R.O. - MINING RIGHTS ONLY
S.R.O. - SURFACE RIGHTS ONLY
M+S - MINING AND SURFACE RIGHTS

Description	Order No.	Date	Disposition	File
REC. PURP.	SEC'S PLA.			18845
W. 97/77	18/12/77	S.R.O.		80088

SAND AND GRAVEL

BRANZEL	55688
BRANZEL	68780

THE INFORMATION THAT APPEARS ON THIS MAP HAS BEEN COMPILED FROM VARIOUS SOURCES, AND ACCURACY IS NOT GUARANTEED. THOSE WISHING TO STAKE MINING CLAIMS SHOULD CONSULT WITH THE MINING RECORDER, MINISTRY OF NORTHERN DEVELOPMENT

WHITNEY TWP.

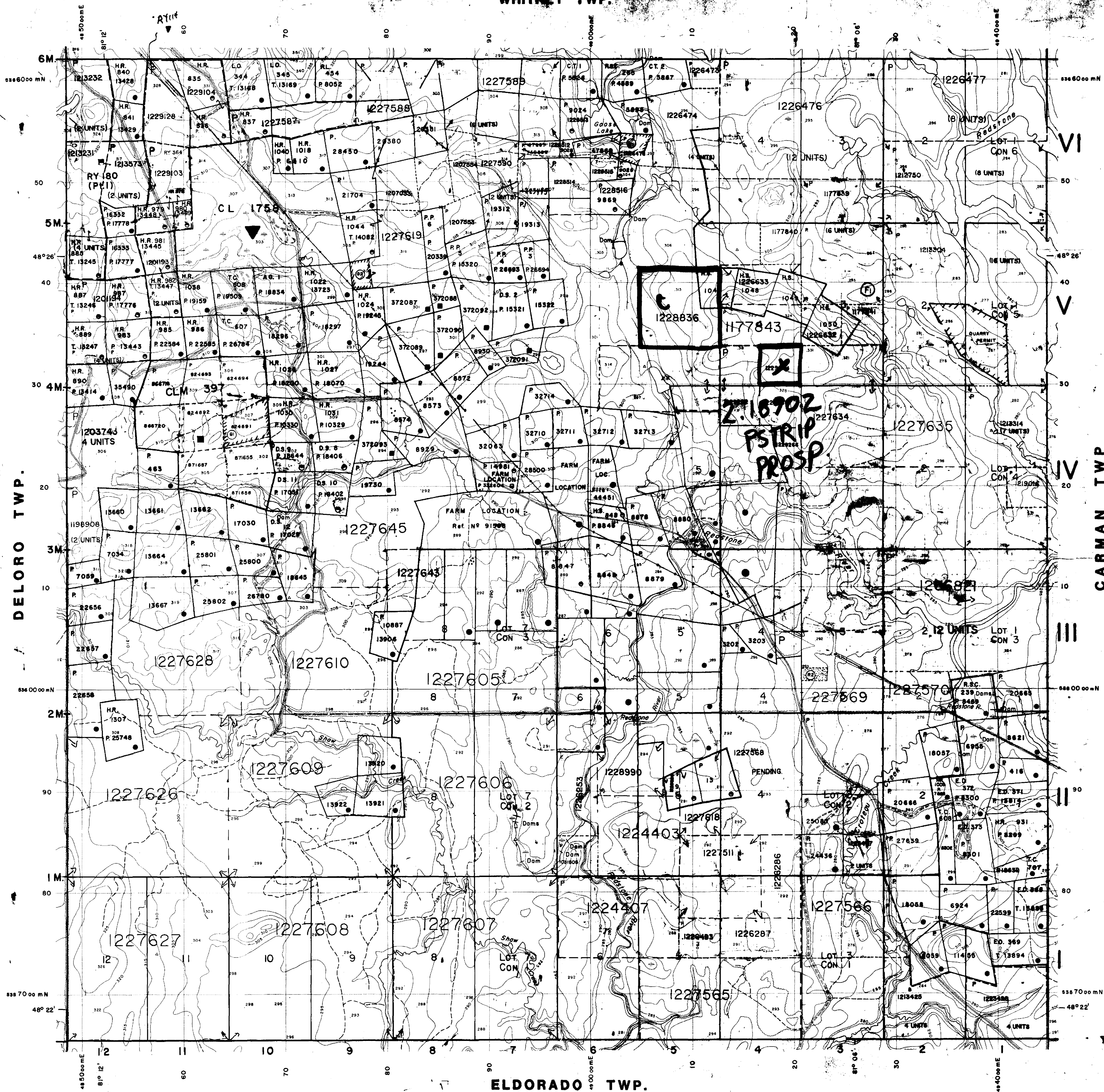

LEGEND

HIGHWAY AND ROUTE No.	
OTHER ROADS	
TRAILS	
SURVEYED LINES:	
TOWNSHIPS, BASE LINES, ETC.	
LOTS, MINING CLAIMS, PARCELS, ETC.	
UNSURVEYED LINES:	
LOT LINES	
PARCEL BOUNDARY	
MINING CLAIMS ETC.	
RAILWAY AND RIGHT OF WAY	
UTILITY LINES	
NON-PERENNIAL STREAM	
FLOODING OR FLOODING RIGHTS	
SUBDIVISION OR COMPOSITE PLAN	
RESERVATIONS	
ORIGINAL SHORELINE	
MARSH OR MUSKEG	
MINES	
TRAVERSE MONUMENT	

DISPOSITION OF CROWN LANDS

TYPE OF DOCUMENT	SYMBOL
PATENT, SURFACE & MINING RIGHTS	●
" SURFACE RIGHTS ONLY	○
" MINING RIGHTS ONLY	◐
LEASE, SURFACE & MINING RIGHTS	◑
" SURFACE RIGHTS ONLY	◒
" MINING RIGHTS ONLY	◓
LICENCE OF OCCUPATION	◔
ORDER-IN-COUNCIL	OC
RESERVATION	○
CANCELLED	○
SAND & GRAVEL	○

NOTE: MINING RIGHTS IN PARCELS PATENTED PRIOR TO MAY 6, 1913, VESTED IN ORIGINAL PATENTEES BY THE PUBLIC LANDS ACT, R.S.O. 1970, CHAP. 300, SEC. 63, SUBSEC. 1.

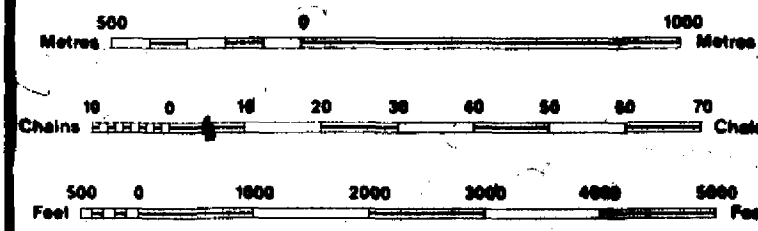

SCALE 1:20 000
GRID ZONE 17

DATE OF ISSUE
NOV 20 1998
PROVINCIAL RECORDING
OFFICE - SUDBURY

TOWNSHIP
SHAW
M.N.R. ADMINISTRATIVE DISTRICT
TIMMINS
MINING DIVISION
PORCUPINE
LAND TITLES / REGISTRY DIVISION
COCHRANE

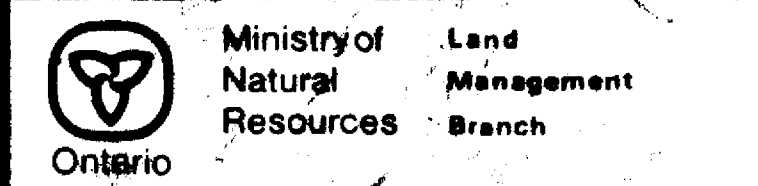

ORIGINAL COMPILATION JULY 1984
REVISED IN SERVICE 2004, 2011
G-3999