



42A06NE8906 2.4208 DELORO

010

McGill Exploration Limited
Report of Geophysical Work
Deloro Township
Porcupine Mining Division

RECEIVED

OCT 21 1981

MINING LANDS SECTION

INTRODUCTION:

From July 29 to August 25, 1981 a program of linecutting and ground geophysical surveying was carried out on the Big Dyke gold prospect in Deloro Township.

The work was performed by McGill Exploration Limited on behalf of Thomas Skimming & Associates Limited acting for Vatco Exploration, Inc. of Mississauga, Ontario.

PROPERTY:

The property consists of six unpatented mining claims situated in Deloro Township about 10 miles southeast of Timmins (see Plan 1).

The claims are numbered as follows:

P.529005
P.529006
P.567521
P.567522
P.530598
P.530599

ACCESS:

The property is accessible by a logging road leading off the Langmuir Road from South Porcupine a distance of approximately 2 miles to the south-west. The turn-off is about $\frac{1}{4}$ mile past the pumphouse on the Langmuir Road.

LINECUTTING:

A baseline bearing N.60°E. was cut for 900 meters across claims P.530599, P.529005 and P.529006. Approximately 15 kilometers of picket line runs perpendicular to baseline at 100 meter and 50 meter spacings.

L.D

...2

Parallel to baseline, line 5+00N is 900 meters in length and ties-in the picket lines on claims P.567522, P.530598 and P.567521. Offset 6+50N from 9+00W provides the required extension for picket lines 10+00W and 11+00W to cover the southwest portion of claim P.567521. The offset runs 325 meters beyond 9+00W. In total, 16.8 kilometers of control line was cut and picketed at 25 meter intervals.

ELECTROMAGNETIC SURVEY:

A VLF electromagnetic survey was performed on the control lines using the Geonics EM-16 receiver tuned to transmitter NAA (17.8 kHz) in Cutler, Maine. The inphase and quadrature components of the secondary field were measured in percentages as a function of the tilt of the instrument relative to the horizontal (primary) field. Readings were taken facing northerly along the lines and recorded at 25 meter intervals. The data is plotted in profile and is presented as Plan 2.

MAGNETIC SURVEY:

The Scintrex MP-2 Proton Precession magnetometer was used to gauge the magnetic susceptibility of the bedrock. Base stations were established at each baseline/picket line intersection for diurnal correction and all measurements were calculated relative to the base station readings. The magnetic field was measured to an accuracy of ± 5 gammas at 25 meter intervals (see Plan 3).

CONCLUSION:

Geological survey work must be performed to evaluate the significance of the geophysical data.

October 16, 1981
Timmins, Ontario

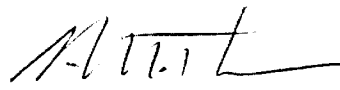
G. M. Thomas
Geologist



42A06NE8906 2.4208 DELORO

900

October 19, 1981

McGill Exploration Limited,
33 Young Road, Kanata,
Ontario. K2L 1V9

Mr. Fred Matthews,
Lands Administration Branch,
Mining Lands Section,
Ministry of Natural Resources,
Room 1617, Whitney Block,
Queen's Park, Toronto.

Dear Sir:

Attached please find copies of Mining Act Report of Work documents received by the Recorder of the Porcupine Mining Division, August 31, 1981. Enclosed are the required reports and maps in duplicate for the work performed on these claims.

Yours truly,

McGill Exploration Limited

G. M. Thomas
Geologist

Attach.
Encl.

RECEIVED

OCT 21 1981

MINING LANDS SECTION



A separate form is required for each type of work to be recorded.

THE MINING ACT REPORT OF WORK

To the Recorder of Porcupine Mining Division

I, B. Vatri name of Recorded Holder M-21337 Prospector's Licence

5500 Tonkka Road, Mississauga, Ontario Post Office Address 240

do hereby report the performance of Geophysical days of type of work

not before reported to be applied on the following contiguous claims

Table with 6 columns: Claim No., Days, Claim No., Days, Claim No., Days. Rows include P.529005, P.529006, P.567521, P.587522, P.53059A.

All the work was performed on Mining Claim (s) As listed above (In the case of geological and/or geophysical survey (s) where more than 18 claims are involved attach a schedule)

READ CAREFULLY: THE FOLLOWING INFORMATION IS REQUIRED BY THE MINING RECORDER.

- For Manual Work, Stripping or Opening up of Mines, Sinking Shafts or Other Actual Mining Operations - Names and addresses of the men who performed the work and the dates and hours of their employment. For Diamond and other Core Drilling - Footage, No. and angle of holes and diameter of core. Name and address of owner or operator of drill. Dates when drilling was done. Signed core log and sketch in duplicate. For Compressed Air or Other Power Driven or Mechanical Equipment Type of drill or equipment. Names and addresses of men engaged in operating equipment and the dates and hours of their employment. For Power Stripping - Type of equipment. Name and address of owner or operator. Amount expended. Dates on which work was done. Proof of actual cost must be submitted within 30 days of recording. With each of the above types of work sketches are required to show the location and extent of the work in relation to the nearest claim post. In the case of diamond or other core drilling the sketch must be submitted in duplicate. For Geophysical, Geological, Geochemical Surveys and Expenditure Credits - the name of author of report. Covering dates of survey (linecutting & office). Type of instrument used. Total amount of expenditure. Technical reports, maps, expenditure breakdown, receipts must be filed in duplicate with the Minister within 60 days of recording. For Land Survey - the name and address of Ontario Land surveyor.

The Required Information is as Follows: (Attach a list if this space is insufficient)

Geophysical - Proton Precession Magnetometer - Scintrex MP-2 Author of report - McGill Exploration Limited

Date August 28, 1991

Signature of Recorded Holder or Agent

The Mining Act Certificate Verifying Report of Work

I, George McGill Thomas McGill Exploration Limited, 33 Young Road, Kanata, Ontario (Post Office Address)

hereby certify:

- 1. That I have a personal and intimate knowledge of the facts set forth in the report of work annexed hereto, having performed the work or witnessed same during and/or after its completion. 2. That the annexed report is true.

Dated August 28 19 91

Signature

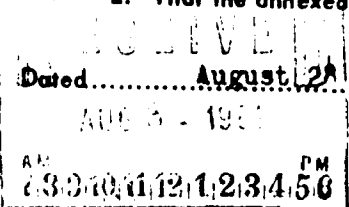

THE PENALTY FOR MAKING A FALSE STATEMENT IN THIS REPORT AND/OR CERTIFICATE IS \$500. OR SIX MONTHS IMPRISONMENT OR BOTH



THE MINING ACT REPORT OF WORK

A separate form is required for each type of work to be recorded.

To the Recorder of Porcupine Mining Division

I, D. Vatri name of Recorded Holder M-21337 Prospector's Licence

5520 Louisa Road, Mississauga, Ontario 120 Post Office Address

do hereby report the performance of Geophysical days of type of work

not before reported to be applied on the following contiguous claims

Table with 6 columns: Claim No., Days, Claim No., Days, Claim No., Days. Contains entries for P. 529005, P. 529006, P. 567521, P. 567522, P. 530599.

All the work was performed on Mining Claim (s) As listed above (In the case of geological and/or geophysical survey (s) where more than 18 claims are involved attach a schedule)

READ CAREFULLY: THE FOLLOWING INFORMATION IS REQUIRED BY THE MINING RECORDER.

- For Manual Work, Stripping or Opening up of Mines, Sinking Shafts or Other Actual Mining Operations - Names and addresses of the men who performed the work and the dates and hours of their employment.
For Diamond and other Core Drilling - Footage, No. and angle of holes and diameter of core. Name and address of owner or operator of drill. Dates when drilling was done. Signed core log and sketch in duplicate.
For Compressed Air or Other Power Driven or Mechanical Equipment Type of drill or equipment. Names and addresses of men engaged in operating equipment and the dates and hours of their employment.
For Power Stripping - Type of equipment. Name and address of owner or operator. Amount expended. Dates on which work was done. Proof of actual cost must be submitted within 30 days of recording.
With each of the above types of work sketches are required to show the location and extent of the work in relation to the nearest claim post. In the case of diamond or other core drilling the sketch must be submitted in duplicate.
For Geophysical, Geological, Geochemical Surveys and Expenditure Credits - the name of author of report. Covering dates of survey (linecutting & office). Type of instrument used. Total amount of expenditure. Technical reports, maps, expenditure breakdown, receipts must be filed in duplicate with the Minister within 60 days of recording.
For Land Survey - the name and address of Ontario Land surveyor.

The Required Information is as Follows: (Attach a list if this space is insufficient)

Geophysical - VLF Survey - Geonics EM-16
Author of report - McGill Exploration Limited

Date August 28, 1991

Signature of Recorded Holder or Agent

The Mining Act Certificate Verifying Report of Work

I, George McGill-Thomas McGill Exploration Limited, 33 Young Road, Kanata, Ontario (Post Office Address)

hereby certify:

- 1. That I have a personal and intimate knowledge of the facts set forth in the report of work annexed hereto, having performed the work or witnessed same during and/or after its completion.
2. That the annexed report is true.

Dated August 28, 1991

Signature

Stamp: AUG 28 1991

THE PENALTY FOR MAKING A FALSE STATEMENT IN THIS REPORT AND/OR CERTIFICATE IS \$500. OR SIX MONTHS IMPRISONMENT OR BOTH

2.4208

1983 06 13

2.4208

Mr. William L. Good
Mining Recorder
Ministry of Natural Resources
60 Wilson Avenue
Timmins, Ontario
P4N 2S7

Dear Sir:

RE: Geophysical (Electromagnetic & Magnetometer) Survey
on Mining Claims P529005 in the Township of Deloro

The Geophysical (Electromagnetic & Magnetometer) Survey
assessment work credits as shown on the attached statement
have been approved as of the above date.

Please inform the recorded holder of these mining claims
and so indicate on your records.

Yours very truly,

E.F. Anderson
Director
Land Management Branch

Whitney Block, Room 6450
Queen's Park
Toronto, Ontario
M7A 1W3
Phone: (416) 965-1380

D. Kinvig:mc

Attach:

cc: B. Vatri
Etobicoke, Ontario

cc: Resident Geologist
Timmins, Ontario

1983 06 13

Recorded Holder B. VATRI
Township or Area DELORO TOWNSHIP

Type of survey and number of Assessment days credit per claim	Mining Claims Assessed
Geophysical	P 529005 - 06 567521 - 22 530598 - 99
Electromagnetic _____ 20 days	
Magnetometer _____ 40 days	
Radiometric _____ days	
Induced polarization _____ days	
Section 86 (18) _____ days	
Geological _____ days	
Geochemical _____ days	
Man days <input type="checkbox"/> Airborne <input type="checkbox"/>	
Special provision <input checked="" type="checkbox"/> Ground <input checked="" type="checkbox"/>	
<input type="checkbox"/> Credits have been reduced because of partial coverage of claims.	
<input type="checkbox"/> Credits have been reduced because of corrections to work dates and figures of applicant.	

Special credits under section 86 (15a) for the following mining claims

No credits have been allowed for the following mining claims

not sufficiently covered by the survey Insufficient technical data filed

The Mining Recorder may reduce the above credits if necessary in order that the total number of approved assessment days recorded on each claim does not exceed the maximum allowed as follows: Geophysical — 80; Geological — 40; Geochemical — 40; Section 86(18)-60:



P-529005

2.4208

Ministry of Natural Resources

Notification of recording of assessment work credits

Lands Administration Branch Mining Lands Section Ministry of Natural Resources Room 1617, Whitney Block Queen's Park, Toronto M7A 1W3

RECEIVED

SEP 30 1981

MINING LANDS SECTION

Date of recording of work: September 8, 1981
Recorded holder: B. Vatri
Address: 5500 Tomken Road, Mississauga, Ontario
Township or Area: Deloro Township

Table with 2 columns: Type of survey and number of Assessment days credit per claim, Mining claims. Rows include Geophysical (Electromagnetic, Magnetometer, Radiometric, Induced polarization, Section 72 19), Geological, Geochemical, Man days, Airborne, Special provision, Ground.

Notice to recorded holder:

- Survey reports and maps in duplicate be submitted to the Lands Administration Branch, Toronto within 60 days from the date of recording of this work.
Reports and maps are being forwarded to the Lands Administration Branch with this letter.

Signature: J. Pennington for Mining recorder
c.c. B. Vatri



Mining Lands Comments

<i>2/1/83</i>	<i>Barlow</i>

To: Geophysics *Mr. Barlow*

Comments

Approved Wish to see again with corrections

Date *Sept 12/83* Signature *[Signature]*

To: Geology - Expenditures

Comments

Approved Wish to see again with corrections

Date Signature

To: Geochemistry

Comments

L.D.

Approved Wish to see again with corrections

Date Signature

To: Mining Lands Section, Room 6462, Whitney Block. (Tel: 5-1380)



Ministry of
Natural
Resources

Ontario

1983 03 03

Your file:

Our file: 2.4150
2.4208 ✓
2.4241
2.4224

Mr. Christian Von Hessert
49 Wellington Street East
Toronto, Ontario
M5E 1C9

Dear Sir:

I understand that you are endeavouring to provide the required data for geophysical surveys of Mining Claims P 529005 et al held by Mr. B. Vatri. As you requested, I have extended the time for submitting the missing maps from March 7 to March 31, 1983.

Yours very truly,

A handwritten signature in cursive script, appearing to read "E.F. Anderson".

E.F. Anderson
Director
Land Management Branch

Whitney Block, Room 6450
Queen's Park
Toronto, Ontario
M7A 1W3
Phone: 416/965-1380

FW F.W. Matthews:sc

1983 02 21

2.4208

Mr. B. Vatri
11 Cherry Post Crescent
Etobicoke, Ontario
M9C 2T5

Dear Sir:

RE: Geophysical (Electromagnetic & Magnetometer) Survey
submitted on Mining Claims P 529005 et al in the
Township of Delores.

Enclosed is a copy of our letter dated March 26, 1982 requesting
additional information for the above mentioned survey.

Unless you can provide the required data by March 7, 1983 the
Mining Recorder will be directed to cancel the work credits
recorded on September 8, 1981.

For further information, please contact Mr. F.W. Matthews at
416/965-1380.

Yours very truly,

E.F. Anderson
Director
Land Management Branch

Whitney Block, Room 6450
Queen's Park
Toronto, Ontario
M7A 1W3
Phone: 416/965-1380

Diane Wice:sc

cc: McGill Exploration Limited
Kanata, Ontario
Attn: Mr. G.M. Thomas.

cc: MR. Thomas Skimming
Islington, Ontario

cc: Mining Recorder
Timmins, Ontario

1982 03 26

2.4208

Mr. G.M. Thomas
c/o McGill Exploration Limited
33 Yonge Road
Kanata, Ontario
K2L 1V9

Dear Sir:

Re: Geophysical (Electromagnetic and Magnetometer) Survey
submitted on mining claims P. 529005 et al in the
Township of Delora

Enclosed are the plans (in duplicate) for the above-mentioned survey. In order to complete your submission please forward to this office the following information:

- (a) V.L.F. maps need values of the readings at each station.
- (b) Magnetometer map needs contouring.
- O.K. ✓ (c) A brief resume of your qualifications for our records.

For further information please contact Mr. F.W. Matthews at 416/965-1380.

Yours truly,

E.F. Anderson
Director
Land Management Branch

Whitney Block, Room 6450
Queen's Park
Toronto, Ontario
M7A 1W3
Phone: 416/965-1316

A. Barr/amc

Encl.

cc: Mining Recorder
Timmins, Ontario

2.4208

Tom

April 8, 1982

McGill Exploration Limited,
33 Young Road, Kanata,
Ontario. K2L 1V9

Mr. Thomas Skimming,
Thomas Skimming & Associates Limited,
Suite 306, 5233 Dundas St. W.,
Islington, Ontario. MB9 1A9

RECEIVED

APR 15 1982

Dear Mr. Skimming:

MINING LANDS SECTION

Re: Vatri Project - Assessment
MNR File No.'s 2.4208, 2.4224

Regarding assessment requirements on the Deloro (Big Dyke) and Macklem claims, please find enclosed copies of correspondence from Mr. Anderson of the Land Management Branch.

I telephoned Mr. Matthews, and as he was absent, spoke with Mr. Smith. In view of the fact that the VLF data is plotted accurately to scale, the Ministry has requested that we provide in duplicate, the drafted VLF and contoured magnetic maps for the above referenced properties.

Along with copy of this letter to you, I am forwarding to Mr. Anderson a signed statement of my qualifications.

Yours very truly,

McGill Exploration Limited

G. M. Thomas
Geologist

Attach.

cc: E. F. Anderson ✓

RECEIVED	
Land Management Branch	
CIRCULATE	<input type="checkbox"/>
COMMENTS p. 1	<input type="checkbox"/>
BY	
APR 8 1982	
E. F. ANDERSON	
J. R. MORTON	
J. C. SMITH	
W. GOOD	
V. LEONARD	
J. W. SMALL	
RETURN TO BRANCH	

CERTIFICATE

I, George McGill Thomas, certify that:

1. I am a professional geologist residing at 33 Young Road, Kanata, Ontario.
2. I graduated from Carleton University, Ottawa, in 1974 with a Bachelor of Science degree in Geology.
3. I have been employed with the Geological Survey of Canada, Urangesellschaft Canada Limited, Western Mines Limited and Eldorado Nuclear Limited between the years 1969 and 1979.
4. I presently head McGill Exploration Limited, a private Ontario corporation, carrying on the business of mining exploration in Canada.

April, 1982

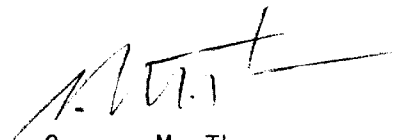

George M. Thomas

GEOTECHNICAL REPORT APPROVAL

MINING LANDS COMMENTS:

US-11 maps have no advantage
no fault LD

GEOPHYSICS Mr. Barlow

- US-11 maps need readings
- May maps need contouring

DATE: March 2/82

APPROVED

SIGNATURE: Ryan DeL...

WISH TO SEE AGAIN WITH CORRECTIONS

GEOLOGY - EXPENDITURES

DATE:

APPROVED

SIGNATURE:

WISH TO SEE AGAIN WITH CORRECTIONS

GEOCHEMISTRY

DATE:

APPROVED

SIGNATURE:

WISH TO SEE AGAIN WITH CORRECTIONS

1981 10 22

2.4206

Mining Recorder's Office
Ministry of Natural Resources
60 Wilson Avenue
Timmins, Ontario
P4N 2S7

Dear Sir;

We have received reports and maps for a Geophysical (Electromagnetic and Magnetometer) survey submitted under Special Provisions (credit for Performance and Coverage) on mining claims P 529005 et al in the Township 66 Deloro.

This material will be examined and assessed and a statement of assessment work credits will be issued.

Yours very truly

E.F. Anderson
Director
Land Management Branch

Whitney Block, Room 6450
Queen's Park
Toronto, Ontario
M7A 1W3
Phone 416/965-1380

Joan Skura

cc: Mr. Matri
Mississauga, Ontario

2.4208

P. - 529005

V.L.F. Mag.

✓

06

1/4^h accounted

530598

as prep

✓

99

✓

567521

✓

22

1/4^h accounted

P.K.

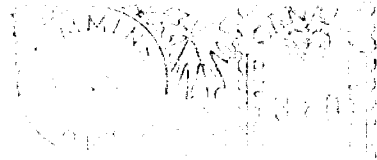

REPORT: 088-52403.0

PROJECT: 630 N & NE PAGE 3

SAMPLE NUMBER	ELEMENT UNITS	AU PPB	SAMPLE NUMBER	ELEMENT UNITS	AU PPB
CSR-256		9	CSR-296		4
CSR-257		5	CSR-297		2
CSR-258		7	CSR-298		2
CSR-259		10	CSR-299		2
CSR-260		4	CSR-300		8
CSR-261		25	CSR-301		6
CSR-262		11	CSR-302		6
CSR-263		9	CSR-303		6
CSR-264		8	CSR-304		5
CSR-265		7	CSR-305		5
CSR-266		12	CSR-306		8
CSR-267		7	CSR-307		6
CSR-268		9	CSR-308		7
CSR-269		9	CSR-309		3
CSR-270		9	CSR-310		2
CSR-271		7	CSR-311		7
CSR-272		4	CSR-312		5
CSR-273		5	CSR-313		4
CSR-274		7	CSR-314		5
CSR-275		6	CSR-315		6
CSR-276		6	CSR-316		6
CSR-277		9	CSR-317		12
CSR-278		6	CSR-318		9
CSR-279		9	CSR-319		5
CSR-280		7	CSR-320		5
CSR-281		11			
CSR-282		11			
CSR-283		6			
CSR-284		7			
CSR-285		11			
CSR-286		12			
CSR-287		11			
CSR-288		9			
CSR-289		10			
CSR-290		7			
CSR-291		2			
CSR-292		6			
CSR-293		7			
CSR-294		8			
CSR-295		6			

TISDALE TWP. M-315

THE TOWNSHIP OF
DELORO

DISTRICT OF
COCHRANE

PORCUPINE
MINING DIVISION

SCALE: 1-INCH = 20 CHAINS

LEGEND

- PATENTED LAND (P)
- CROWN LAND SALE (CS)
- LEASES (L)
- LOCATED LAND (Loc.)
- LICENSE OF OCCUPATION (L.O.)
- MINING RIGHTS ONLY (M.R.O.)
- SURFACE RIGHTS ONLY (S.R.O.)
- ROADS
- IMPROVED ROADS
- KING'S HIGHWAYS
- RAILWAYS
- POWER LINES
- MARSH OR MUSKEG
- MINES
- CANCELLED
- PATENTED S.R.O. (S.R.O.)

NOTES

400' Surface Rights reservation along the shores of all lakes and rivers.

For status of fraction situated between Mg. Claims: H.R.1132, H.R.947 & M.E.42 see File No.119653

Mining claims within the area shown thus are subject to rights & privileges granted under an Easement Order dated May 10, 1937 to Delnite Mines Ltd.

This township lies within the Municipality of CITY OF TIMMINS.

DATE OF ISSUE
OCT 23 1981
Ministry of Natural Resources
TORONTO

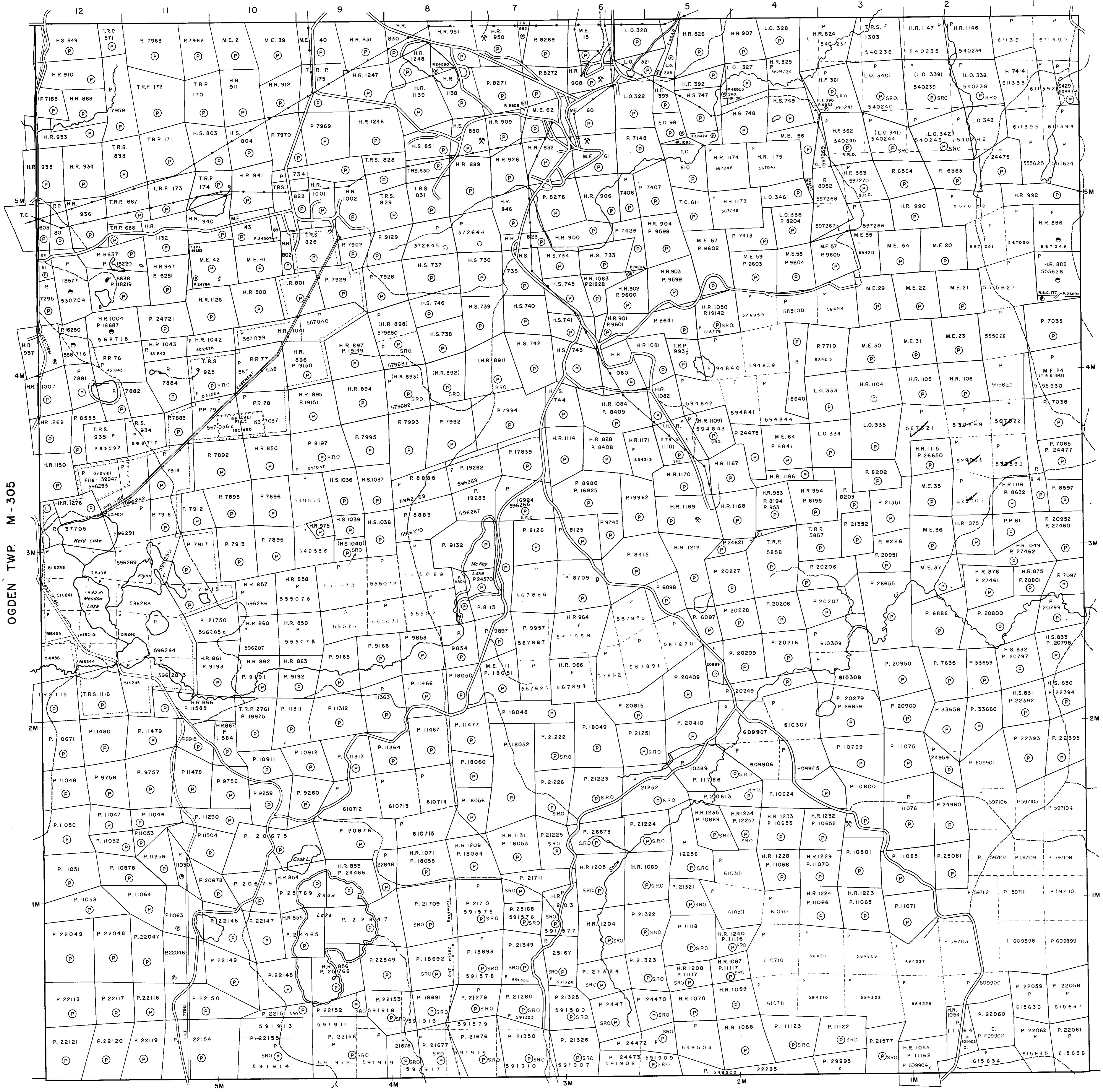

OGDEN TWP. M-305

SHAW TWP. M-311

ADAMS TWP. M-261

PLAN No. - M-272

ONTARIO
MINISTRY OF NATURAL RESOURCES
SURVEYS AND MAPPING BRANCH



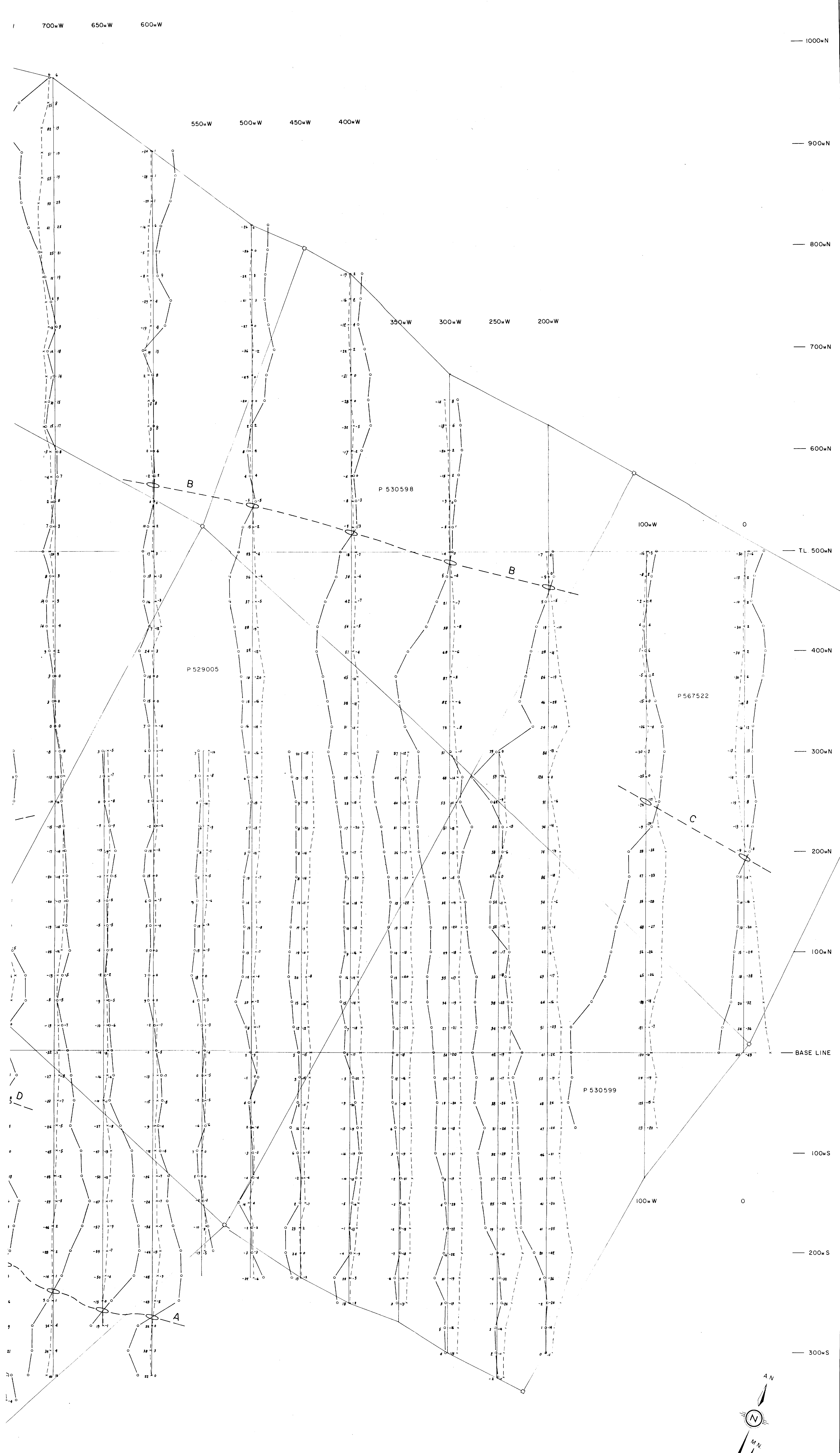

700W 650W 600W 550W 500W 450W 400W 350W 300W 250W 200W

1000N
900N
800N
700N
600N
TL 500N
400N
300N
200N
100N
BASE LINE
100S
200S
300S

100W 0

LEGEND

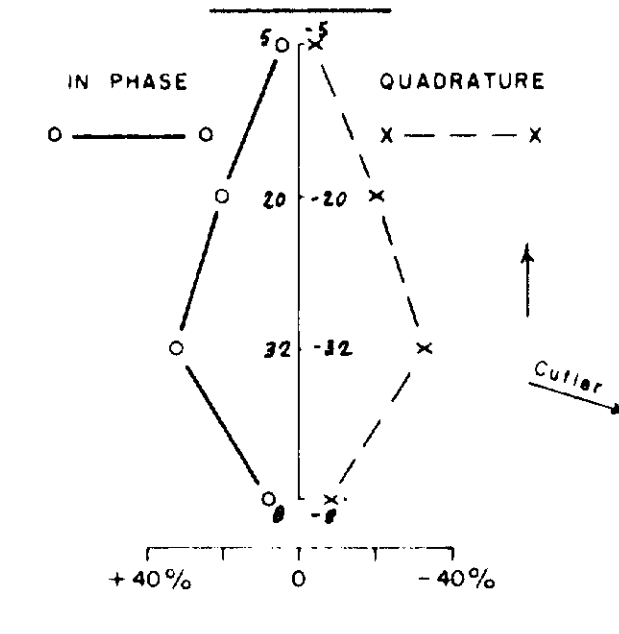

INSTRUMENT: GEONICS EM-16
STATION: CUTLER, MAINE
FREQUENCY: 17.8 kHz, COORDINATES: 67°17'W 44°39'N

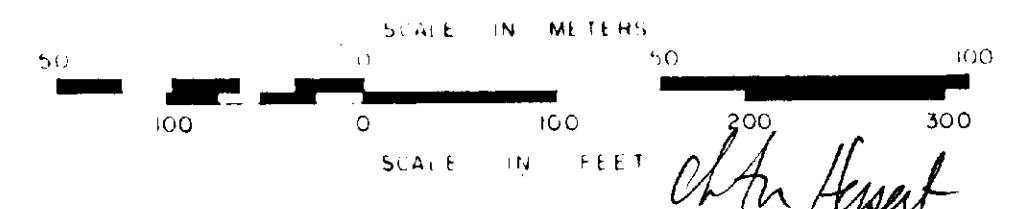

VATCO EXPLORATION INCORPORATED	
VATRI PROJECT — BIG DYKE PROPERTY	
DELOORO TOWNSHIP, ONTARIO PORCUPINE MINING DIVISION	
VLF EM-16 SURVEY	
24208	
WORK CARRIED OUT BY MCGILL EXPLORATION LIMITED	
SCALE: 1:12500	PRINTED BY: OMA
CHECKED BY: G. M. THOMAS	MAP NO: 2

750mW 700mW 650mW 600mW 550mW 500mW 450mW 400mW 350mW 300mW 250mW 200mW 100mW 0m

1000mN

900mN

800mN

700mN

600mN

500mN

400mN

300mN

200mN

100mN

BASE LINE

100mS

200mS

300mS

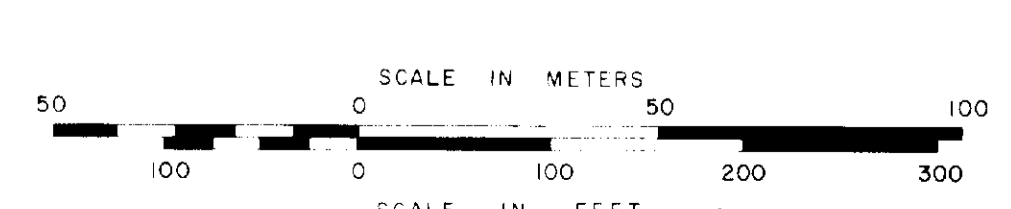
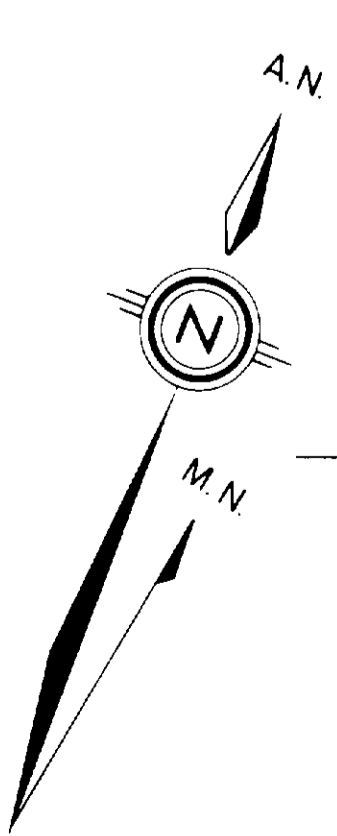
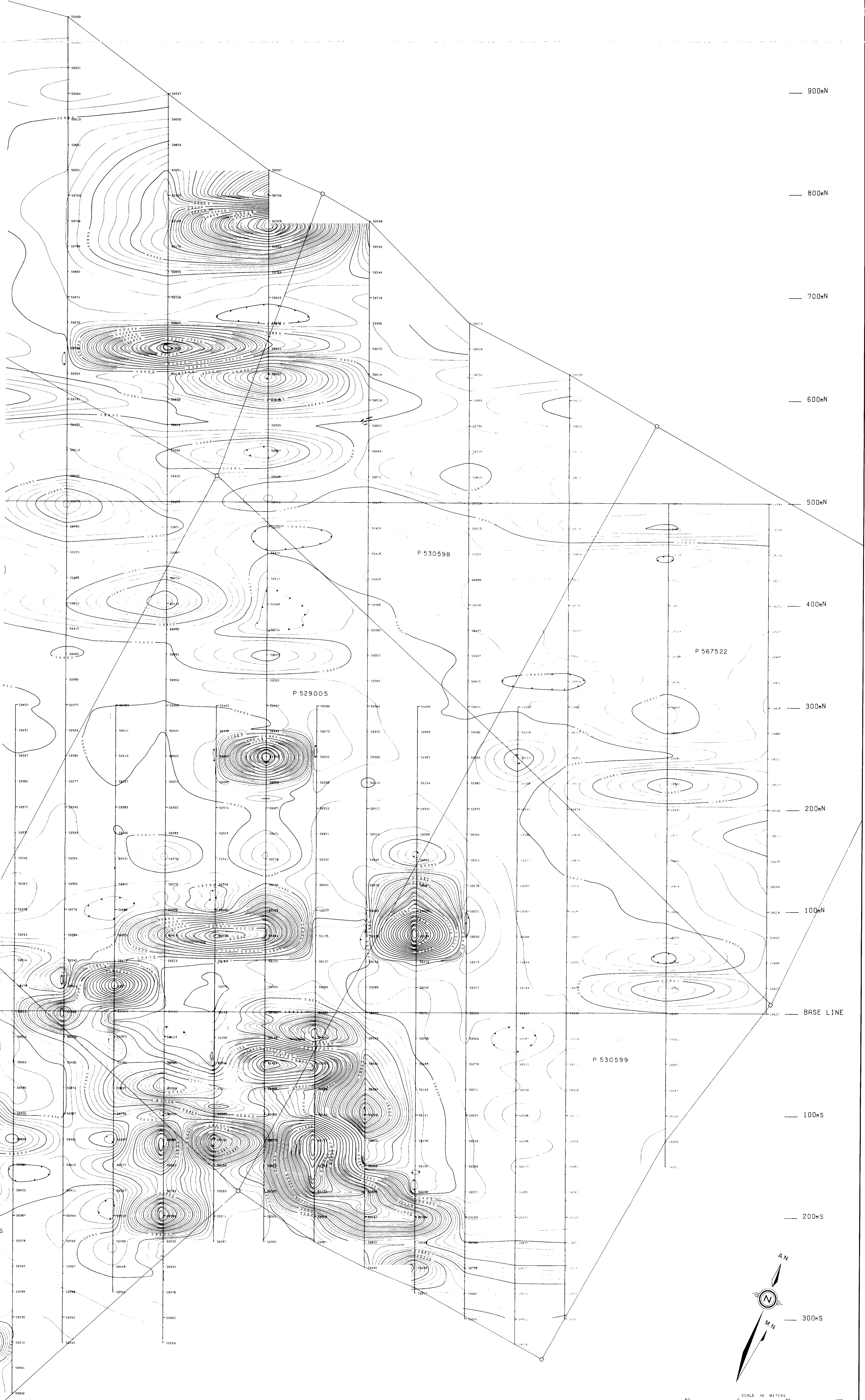

Alvin Hunt

LEGEND

UNITS OF GAMMAS
(Earth's total field accuracy of ± 1 gamma)

53300

CONTOUR INTERVAL 50 GAMMAS

53400

INSTRUMENT: SINTREX MP-2 PROTON PRECESSION MAGNETOMETER

VATCO EXPLORATION INCORPORATED

VATRI PROJECT — BIG DYKE PROPERTY

DELORO TOWNSHIP, ONTARIO
PORCUPINE MINING DIVISION

MAGNETIC SURVEY

WORK CARRIED OUT BY MCGILL EXPLORATION LIMITED

SCALE: 1:5000

DRAFTED BY: gmes

CHECKED BY: G. M. THOMAS

MAP NO. 3

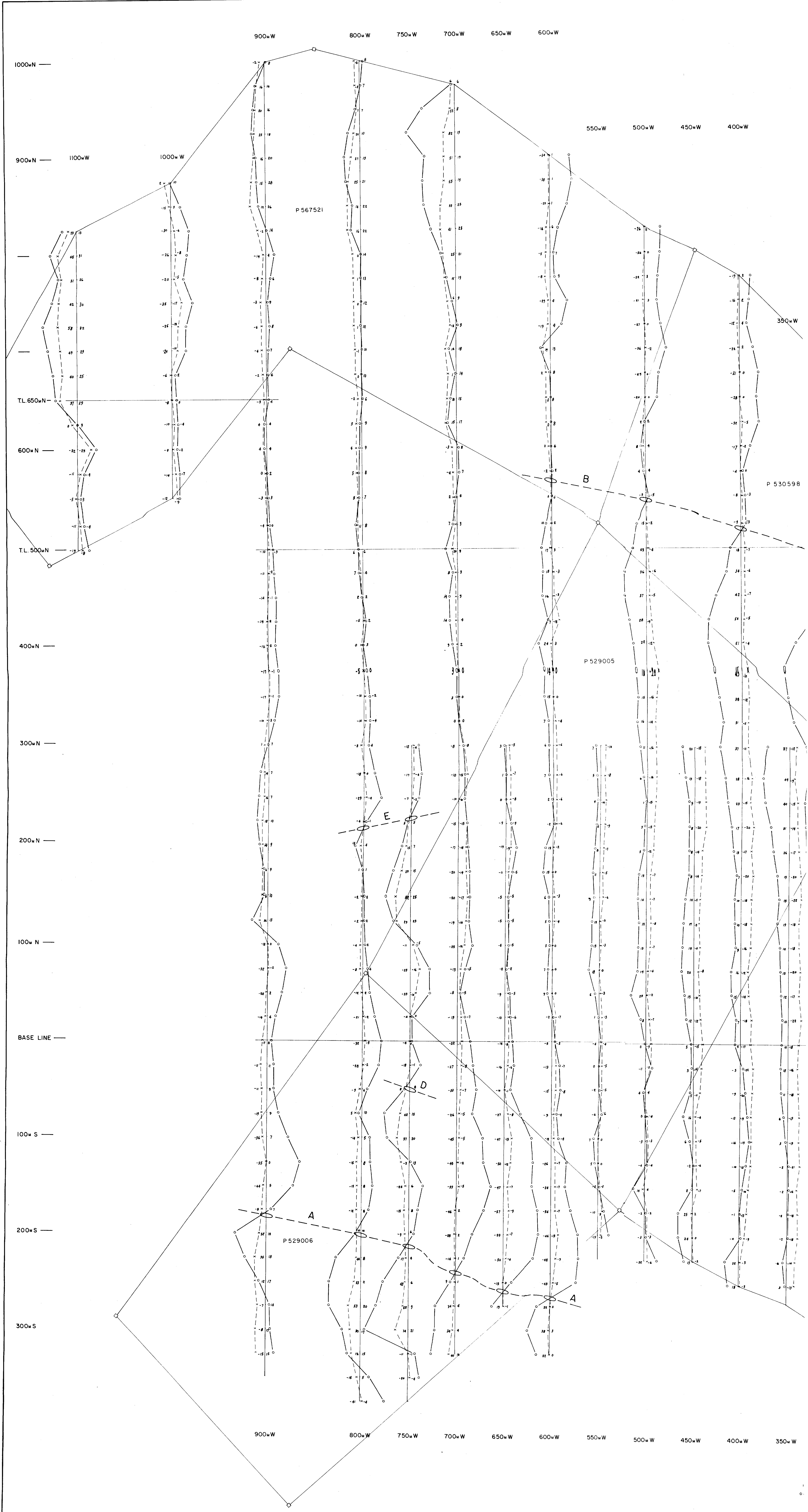

1100hW 1000hW 900hW 800hW 750hW 700hW 650hW 600hW 550hW 500hW 450hW 400hW 350hW

1000hN

900hN

800hN

700hN

600hN

T.L. 500hN

400hN

300hN

200hN

100hN

BASE LINE

100hs

200hs

300hs

P 567521

P 529005

P 529006

P 53059

