

DIAMOND DRILLING



42A06NW0131 24 DELORO

010

TOWNSHIP: Deloro

REPORT No.: 24

WORK PERFORMED BY: L. Letourneau

<u>CLAIM No.</u>	<u>HOLE No.</u>	<u>FOOTAGE</u>	<u>DATE</u>	<u>NOTE</u>
P 516244	10	115	July/83	(1)
	11	112	July/83	(1)
	12	125	July/83	(1)

NOTES: (1) #238-83

OGDEN TWP.

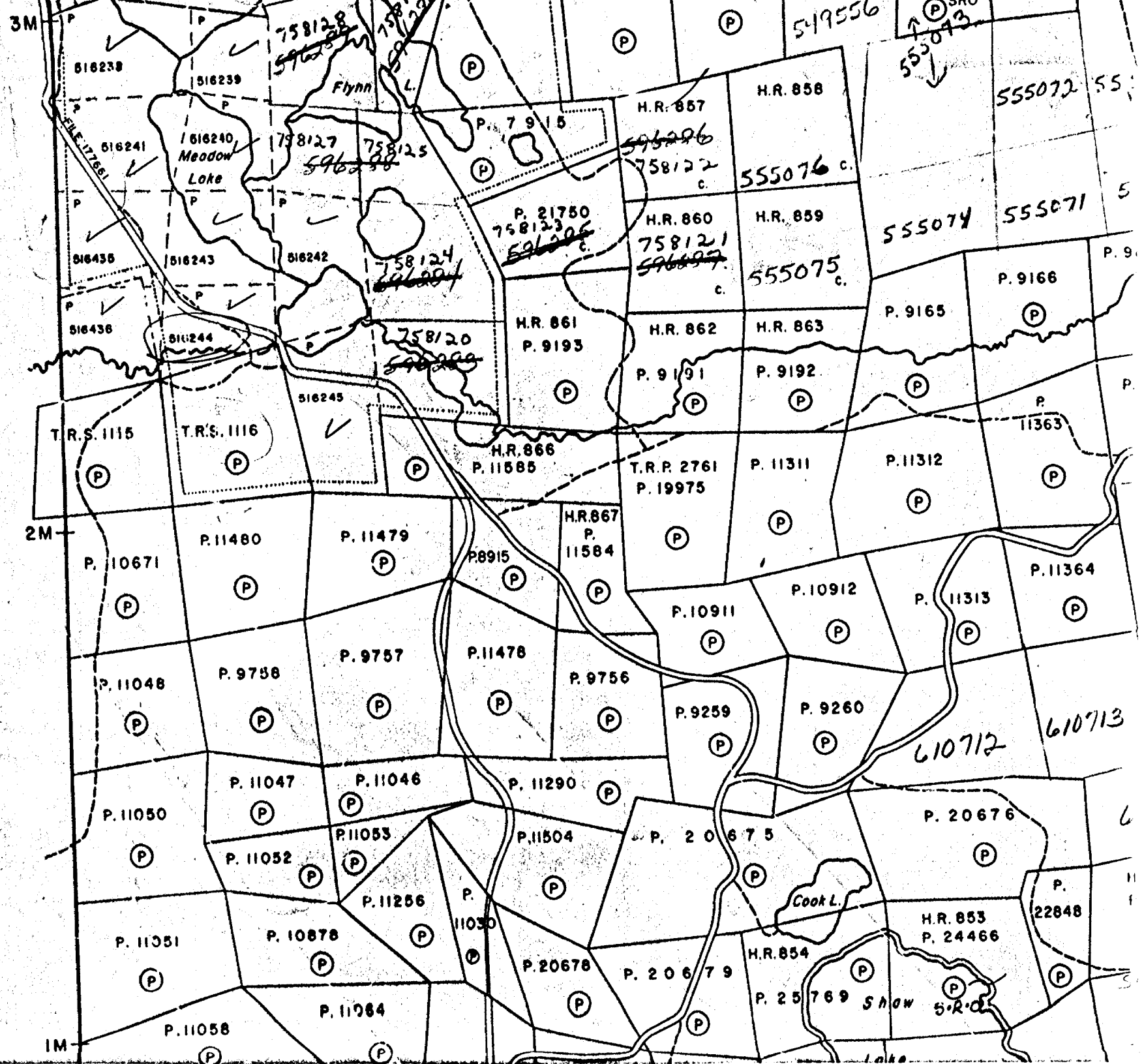

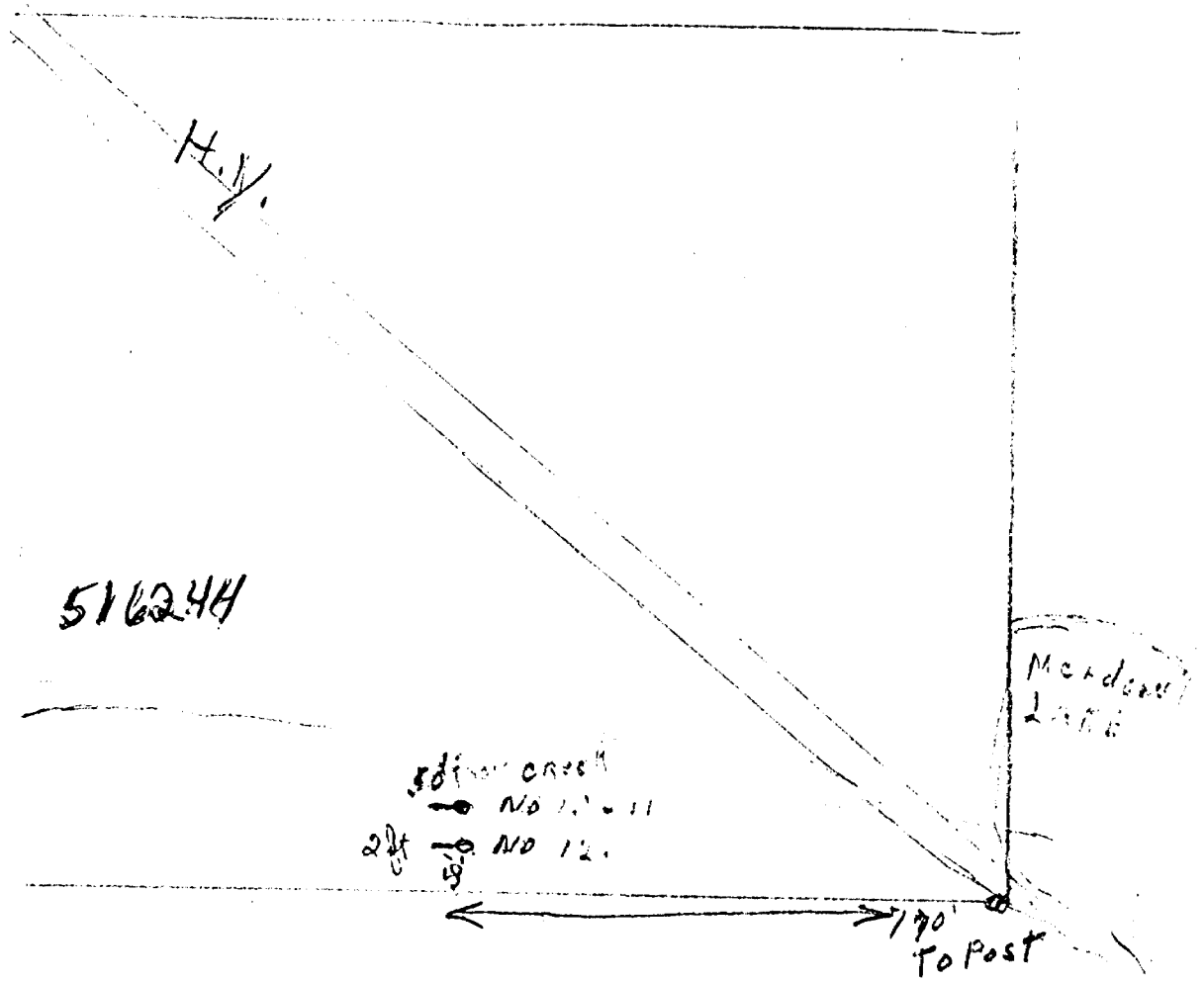

H.V.

516244

Mendocino  
Lake

50 ft creek

NO 11

28 NO 12

170'  
TO POST



# DIAMOND DRILL RECORD

SHEET 1 OF 2PROPERTY: Delard Twp. Ont.HOLE NO. 10

Latitude		Departure		Elevation		Section	
Datum		Bearing		Dip <u>45°</u>		From: To:	
				Started (date) <u>July 29/83</u>		Completed (date) <u>August 3/83</u>	
						Ultimate Depth Proposed Depth	

Depth in Feet	Formation	Sample Number	Width of Sample	Assay Values			
0 - 5.5	GREY-GREEN TO TAN CHLORITE CARBONATE SCHIST POSSIBLE CARBONATED BASALT 1.2-2.5 m. SLIGHT PYRITE 4-5 CARBONATE STRINGERS WITH UNDER 1% PY. GROUND CORE 5.0-5.5	8					
5.5 - 8.8	LOST CORE						
8.8 - 11.0	BLOCKY CARBONATE BASALT AS ABOVE. UNDER 1% PYRITE. TWO 1/2 INCH QUARTZ VEINS AND 6% CARBONATE PATCHES. SOME RUSTY SLIPS.	3	2.0'				
11.0 - 13.5	LOST CORE						
13.5 - 20.0	SAME AS FROM 8.8-11.0, 15'-17' 1/4" CARBONATE STRINGER RUNS DOWN THE CORE SLIGHTLY MORE PYRITE THAN IN REST OF SECTION. 19'-20' SMALL CARBONATE STRINGER, SLIGHT PYRITE AND SERICITE.	4	2.0'				
20.0 - 21.0	QUARTZ VEIN WITH FINE GRAINED BLACK TOURMALINE AND <del>RA</del> FRAGMENTS OF WALL ROCK NOW ALTERED TO CHLORITE AND SERICITE NO MINERALIZATION NOTED.	5	1.0'				
21.0 - 22.4	LOST CORE	6	1.0'				

Drilling Performed By

Chloé Pétournan  
Agency

Signature P. Lalonde  
Geologist



# DIAMOND DRILL RECORD

PROPERTY: Delard Twp. Ont.HOLE NO. 10

Latitude		Departure		Elevation		Section	
Datum		Bearing		Dip <u>45°</u>		Started (date) <u>July 29/83</u>	
						Completed (date) <u>August 31/83</u>	
						Ultimate Depth	
						Proposed Depth	

Depth in Feet	Formation	Sample Number	Width of Sample	Assay Values			
<u>23.4 - 40.0</u>	<u>CARBONATED VOLCANIC BASALT AS BEFORE WITH SOME CHLORITE AND SERICITIC ALTERATION</u>						
	<u>FROM 23.4 - 24.0 10% CARBONATE STRINGERS TO 25'</u>	<u>7</u>	<u>0.6'</u>				
	<u>35.5 - 38.2 BRECCIA LIGHT QUARTZ - CARBONATE MATRIX, TRAIL PYRITE</u>	<u>8</u>	<u>1.8'</u>				
<u>40.0 - 115'</u>	<u>LIGHT GREY ALTERED FELSIC TO INTERMEDIATE VOLCANIC, MORE SILICEOUS AND SERICITIC THAN PREVIOUS UNIT. STRINGERS OF CARBONATE THROUGHOUT UP TO 1/2% PYRITE LOCALLY. 42' - 45' GROUND CORE 30-40% QUARTZ CARBONATE STRINGERS AT LOW ANGLE TO CORE, SLIGHT PYRITE</u>						
	<u>45.2 - 46.5 CARBONATE AND SERICITE ALT'N.</u>	<u>10</u>	<u>1.2'</u>	<u>SAMPLE NOT TAKEN</u>			
	<u>47.2 - 48.5 LOST CORE</u>						
	<u>CORE ANGLE AT 50' = 35°, 75' = 30°, 115' = 35°</u>						
	<u>LOST CORE 52.0 - 54.5, 58.5 - 59.5, 61.0 - 64.2</u>						
	<u>83.0 - 84.6, 86.2 - 89.0, 92.0 - 94.5, 86.2 - 89.2,</u>						
	<u>101.5 - 107.0 BLOCKY GROUND FROM 40 TO END</u>						
	<u>90.0 - 92.0 SLIGHT PY, 1" QZ CARB VEIN</u>	<u>10</u>	<u>2.0'</u>				
	<u>AT 15° TO CORE, 108 - 112 SLIGHT CHALCOPYRITE</u>	<u>11</u>	<u>4.0'</u>				
	<u>10% MnO - H2 AND PYRITE</u>	<u>12</u>					

Drilling Performed By

P. L. Pitouneau  
Agency

Signature P. L. Pitouneau  
Geologist



# DIAMOND DRILL RECORD

SHEET 1 OF 1PROPERTY: DE LA RD TWP. ONT.HOLE NO. 11

Latitude		Departure		Elevation		Section	
Datum		Bearing		Dip <u>55°</u>		From: To:	
				Started (date) <u>July 29/83</u>		Completed (date) <u>August 31/83</u>	
				Ultimate Depth		Proposed Depth	

Depth in Feet	Formation	Sample Number	Width of Sample	Assay Values			
0 - 112'	LIGHT GREY TO GREEN FELSIC TO INTERMEDIATE VOLCANICS, HIGHLY DEFORMED NOW A CARBONATED SERICITE CHLORITE SCHIST SLIGHT PYRITE UNDER 1% THROUGHOUT, MINOR QUARTZ CARBONATE AND CARBONATE STRINGERS AND VEINS THROUGHOUT. BLOCKY WITH SOME SURFACE LEACHING TO 18'						
	LOST CORE - 10.2', 15.5 - 18.5, 31 - 32, 37 - 37.5						
	25 - 26.6 1' QUARTZ VEIN TRACE PYRITE, AT 35° TO CORE, CHLORITE AND TOURMALINE.	1	1.6'				
	<del>55-56</del> GROUND CORE AND MUD, GROUND CORE 70 - 71.5						
	LOST CORE 71.5 - 74.5, 75 - 78 (MUD), 81 - 84.8						
	84.8 - 90 10% QUARTZ AND CARBONATE AND CARBONATE STRINGERS, TRACE PYRITE AND CHALCOPYRITE						
	GROUND CORE AT 93', 98 - 98.7 CARBONATE STRINGERS WITH SLIGHT PYRITE,						
	LOST CORE 105.2 - 106.2.						
	110 - 112 FAIRLY SILICEOUS - WHOLE UNIT HAS FRAGMENTAL TEXTURES IN PLACES -						
	CORE ANGLE AT 25' = 35°, 50 = 30°, 75 = 15°, 100 = 40°						

Drilling Performed By

Rilianne Pitourman  
Agency

Signature P. Wolff  
Geologist



# DIAMOND DRILL RECORD

SHEET 1 OF 1

PROPERTY: Delara Twp. Ont

HOLE NO. 12

Latitude		Departure		Elevation		Section	
Datum		Bearing		Dip <u>50°</u>		Started (date) <u>July 29/83</u>	
						Completed (date) <u>August 31/83</u>	
						Ultimate Depth	
						Proposed Depth	

Depth in Feet	Formation	Sample Number	Width of Sample	Assay Values			
0-125'	ALTERED FELSIC TO INTERMEDIATE VOLCANIC AS IN HOLES 10 AND 11, NOW A SEMICRIST, CHLORITE CARBONATE SCHIST FOR THE MOST PART. BLOCKY <del>AND</del> WITH RUSTY SLIPS TO 25. LOST CORE <del>15-17</del> , 20.5-24.0, 26-28 QUARTZ CARBONATE VEIN 18'-19' TRACE PYRITE BLOCKY GROUND AND GROUND CORE 28'-30.4' LOST CORE 30.4-31.4, GROUND CORE AT 45'-45.5' AND 52-53, LOST CORE 53.0-54.0, 56-57, 71-72 72-73.5 QUARTZ STRINGERS WITH CALCITE. 75.3-78 LOST CORE, 81.5-84 LOST CORE, BLOCKY GROUND IN RE FROM 75-93 LOST CORES. 85.8-89.3 AT 84.8 1" QUARTZ VEIN WITH CHALCOPYRITE BLEBS. GROUND CORE 102-103, LOST CORE 105-105.6 109-110.5 118-120 STRONG SEMICRISTIC ALTERATION <del>AND</del> ASSOCIATED WITH PINK QUARTZ CARBONATE ZONE TRACE CHALCOPYRITE AND PYRITE. THIN QUARTZ AND CARBONATE STRINGERS GAIN THIN UNIT. CORE ANGLE 25' = 40°, 50' = 25°, 75' = 35°, 125' = 36°						

Drilling Performed By

Blissanne Pitouman  
Agency

Signature P. Walcott  
Geologist



Ministry of Natural Resources

Ontario

*Dobow Twp #238 p.*



42A06NW0131 24 DELORO

900

THE MINING ACT REPORT OF WORK

type of work to be recorded.

To the Recorder of *Paraspine* Mining Division

I, *Liliane Letourneau* name of Recorded Holder *M-M-20347* Prospector's Licence

*R.R.# 3; Tillsonburg, Ont* Post Office Address *N4G-4G8*

do hereby report the performance of *352* days of *Diamond Drilling* type of work

not before reported to be applied on the following contiguous claims

Claim No.	Days	Claim No.	Days	Claim No.	Days
<i>P-516245</i>	<i>36</i>	<i>P-516239</i>	<i>36</i>		
<i>P-516244</i>	<i>35</i>	<i>P-516238</i>	<i>34</i>		
<i>P-516243</i>	<i>35</i>	<i>P-516436</i>	<i>36</i>		
<i>P-516242</i>	<i>36</i>	<i>P-516435</i>	<i>32</i>		
<i>P-516241</i>	<i>36</i>				
<i>P-516240</i>	<i>36</i>				

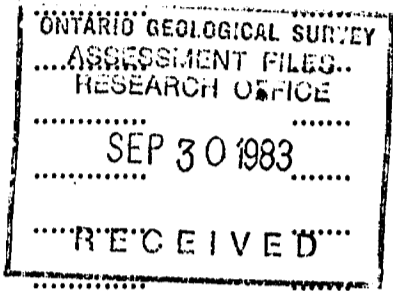

All the work was performed on Mining Claim (s) (In the case of geological and/or geophysical survey (s) where more than 18 claims are involved attach a schedule)

READ CAREFULLY: THE FOLLOWING INFORMATION IS REQUIRED BY THE MINING RECORDER.

- For Manual Work, Stripping or Opening up of Mines, Sinking Shafts or Other Actual Mining Operations - Names and addresses of the men who performed the work and the dates and hours of their employment.
- For Diamond and other Core Drilling - Footage, No. and angle of holes and diameter of core. Name and address of owner or operator of drill. Dates when drilling was done. Signed core log and sketch in duplicate.
- For Compressed Air or Other Power Driven or Mechanical Equipment Type of drill or equipment. Names and addresses of men engaged in operating equipment and the dates and hours of their employment.
- For Power Stripping - Type of equipment. Name and address of owner or operator. Amount expended. Dates on which work was done. Proof of actual cost must be submitted within 30 days of recording.
- With each of the above types of work sketches are required to show the location and extent of the work in relation to the nearest claim post. In the case of diamond or other core drilling the sketch must be submitted in duplicate.
- For Geophysical, Geological, Geochemical Surveys and Expenditure Credits - the name of author of report. Covering dates of survey (linecutting & office). Type of instrument used. Total amount of expenditure. Technical reports, maps, expenditure breakdown, receipts must be filed in duplicate with the Minister within 60 days of recording.
- For Land Survey - the name and address of Ontario Land surveyor.

The Required Information is as Follows: (Attach a list if this space is insufficient)

*Sept 6/83*  
Date .....

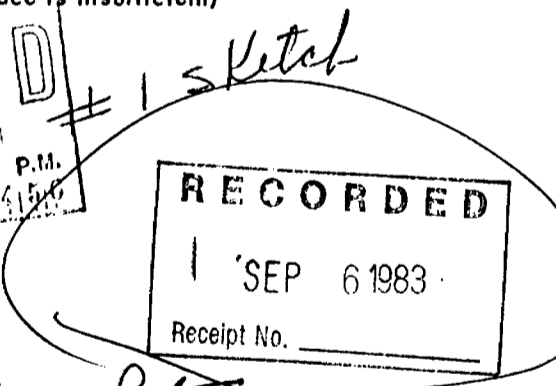
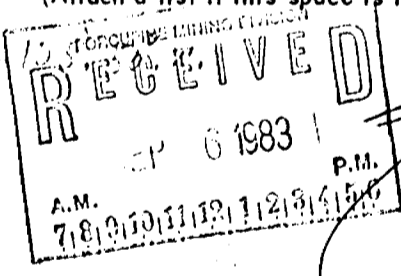

*Liliane Letourneau*  
Signature of Recorded Holder or Agent

The Mining Act Certificate Verifying Report of Work

I, *Liliane Letourneau*  
*R.R.# 3 Tillsonburg, Ont N4G-4G8*  
(Post Office Address)

hereby certify:

- That I have a personal and intimate knowledge of the facts set forth in the report of work annexed here-to, having performed the work or witnessed same during and/or after its completion.
- That the annexed report is true.

Dated *Sept 6* 19 *83* *Liliane Letourneau*  
Signature

THE PENALTY FOR MAKING A FALSE STATEMENT IN THIS REPORT AND/OR CERTIFICATE IS \$500. OR SIX MONTHS IMPRISONMENT OR BOTH