

42A06NW0210 2.4326 OGDEN

010

REPORT ON A GEOLOGICAL SURVEY

RECEIVED

NOV 27 1981

MINING LANDS SECTION

OGDEN-7

PROJECT 1043-20

NTS: 42-A-6

AMAX MINERALS EXPLORATION

Timmins, Ontario
October, 1981

J. MacPherson
Geologist

SUMMARY

During July, 1981, a detailed geological survey was carried out on fourteen (14) claims located in north western Ogden township, District of Cochrane, Ontario.

There is one weak electromagnetic feature on the property. Ground geophysics did not pick up this feature.

There is no outcrop present on the property.

The weak airborne conductor could be re-examined by using a different grid orientation, if deemed necessary. If this does not outline the conductor, it is recommended that the property be dropped.

INTRODUCTION

During July, 1981, a detailed geological survey was carried out on a group of fourteen (14) claims located in north western Ogden township. The claim numbers are P-596973 to P-595986 inclusive and are recorded in the name of Amax of Canada Limited.

The property is located on a weak airborne electromagnetic anomaly uncovered during a helicopter-borne survey carried out by Amax during the fall of 1979.

Detail ground geophysics consisting of magnetometer and horizontal loop (high and low frequency) were carried out during the summer of 1981.

LOCATION AND ACCESS

This group of fourteen (14) claims is located in the north-

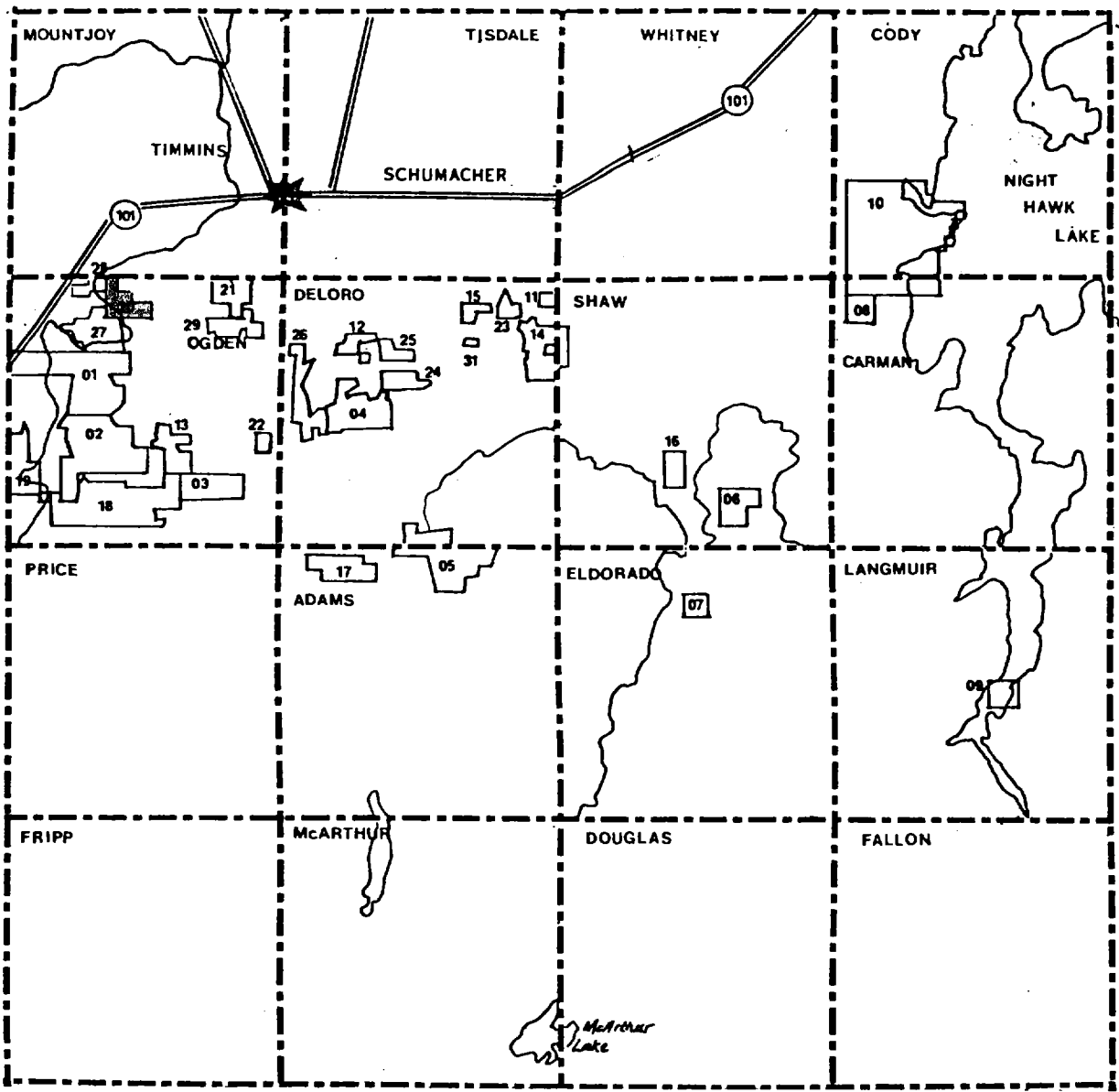

LOCATION MAP
 Project 1043-20

OGDEN-7
 1" = 4 miles

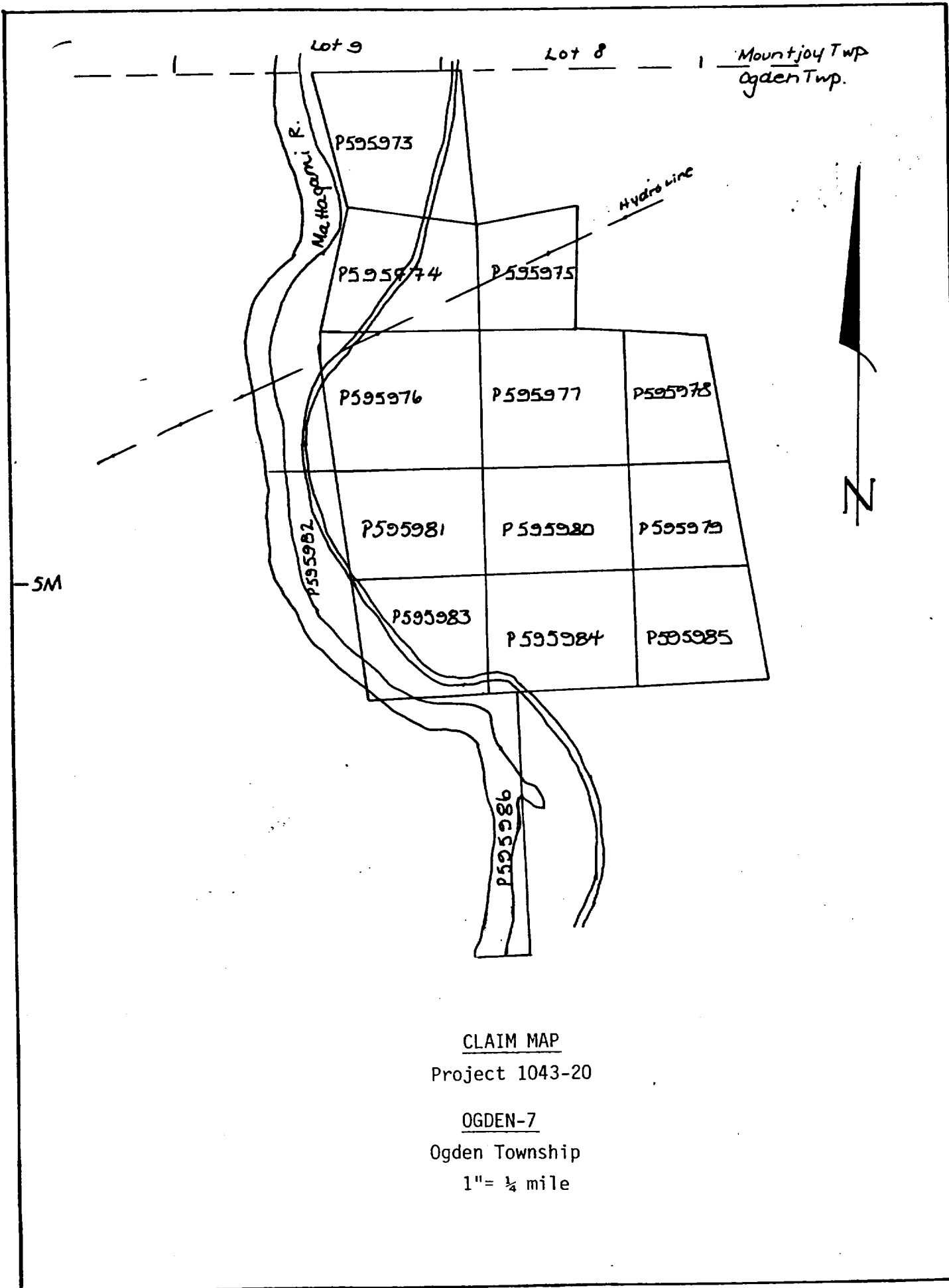

CLAIM MAP

Project 1043-20

OGDEN-7

Ogden Township

1" = 1/4 mile

western corner of Ogden township in the District of Cochrane, Ontario.

A major gravel road cuts the property, which lies about three miles south of the city of Timmins. Thus the property is easily accessible.

TOPOGRAPHY AND RESOURCES

The relief is low. As a result, no outcrop was located on the property. Generally, low sand ridges separate areas of clay and sand which are covered by swamps.

Vegetation consists of good stands of spruce and poplar on the sand ridges (some of which has been harvested) and scattered spruce and birch with alders in the lower areas.

The western edge of the property is defined by the Mattagami River, which is the only substantial source of water in the area for a diamond drill program.

PREVIOUS WORK

No evidence of previous work was found in the assessment files or in the field itself.

SURVEY METHOD

The survey was carried out by P. Lickley and assistants during early August, 1981. Air photos at a scale of 1:30,000 and air

TABLE OF FORMATIONS

CENZOIC

Quaternary

Recent

Swamp and stream deposits

Pleistocene

Till, clay, sand, gravel

Unconformity

PRECAMBRIAN

Mafic Intrusive Rocks

Olivine diabase, quartz diabase

Intrusive Contact

Huronian Supergroup

Gowganda Formation, Cobalt Group

Arkose, wacke, argillite, conglomerate

Unconformity

ARCHEAN

Mafic Intrusive Rocks

Diabase

Intrusive Contact

Felsic Intrusive Rocks

Quartz feldspar porphyry, granite, diorite, granodiorite

Metamorphosed Mafic Intrusive Rocks

Gabbro, quartz gabbro

Intrusive and Gradational Contact

Metamorphosed Ultramafic Intrusive Rocks
Serpentinized diorite, peridotite

Intrusive Contact

METAVOLCANICS AND METASEDIMENTS

Metasediments

Conglomerate, lithic wacke, iron formation

Metavolcanics

Felsic Calc Alkalic metavolcanics

Massive, fine-grained flows, tuff, lapilli tuff, breccia

Mafic Calc-alkalic metavolcanics

Massive, fine-grained flows, pillowed flows, tuff, lapilli
tuff and breccia, sheared, carbonated pyroclastics

Tholeiitic Metavolcanics

Massive to medium grained flows, pillowed flows and flow
breccia, minor tuff, lapilli tuff and breccia

Komatiitic Metavolcanics

Peridotite, olivine spinifex, carbonate and talc alteration

photo blow-ups of 1:5,000 were used as control for the geology survey.

Where topography allowed, pace and compass traverse lines at 125 metre intervals were run across the claim group to provide complete coverage.

REGIONAL GEOLOGY

The volcanic rocks of the Timmins area consist of the older Deloro Group and the younger overlying Tisdale Group.

The Deloro Group is confined to a large domal structure centred in Shaw township. It grades from andesite and basalt flows in the lower portion to dacite and rhyolite pyroclastics near the top. Oxide iron formation is a good marker horizon which may be used to separate the two groups of rocks. A major change in volcanism marks the base of the Tisdale Group, the Lower Volcanic Formation of which is marked by serpentized ultramafic flows.

The Destor-Porcupine Fault is the major structural feature of the area, along with the Porcupine Syncline to the north and the Shaw Dome to the south.

PROPERTY GEOLOGY.

No outcrop was found on the property. However, the area is interpreted to be underlain by volcanic rocks of the Tisdale Group or time equivalent sediments. The airborne conductor gave only an extremely weak response on the ground which could be due to overburden effects.

From the airborne and ground magnetic response, it appears that the property is underlain by sediments which would be unlikely hosts for gold mineralization.



MOUNTJOY TWP.
OGDEN TWP.

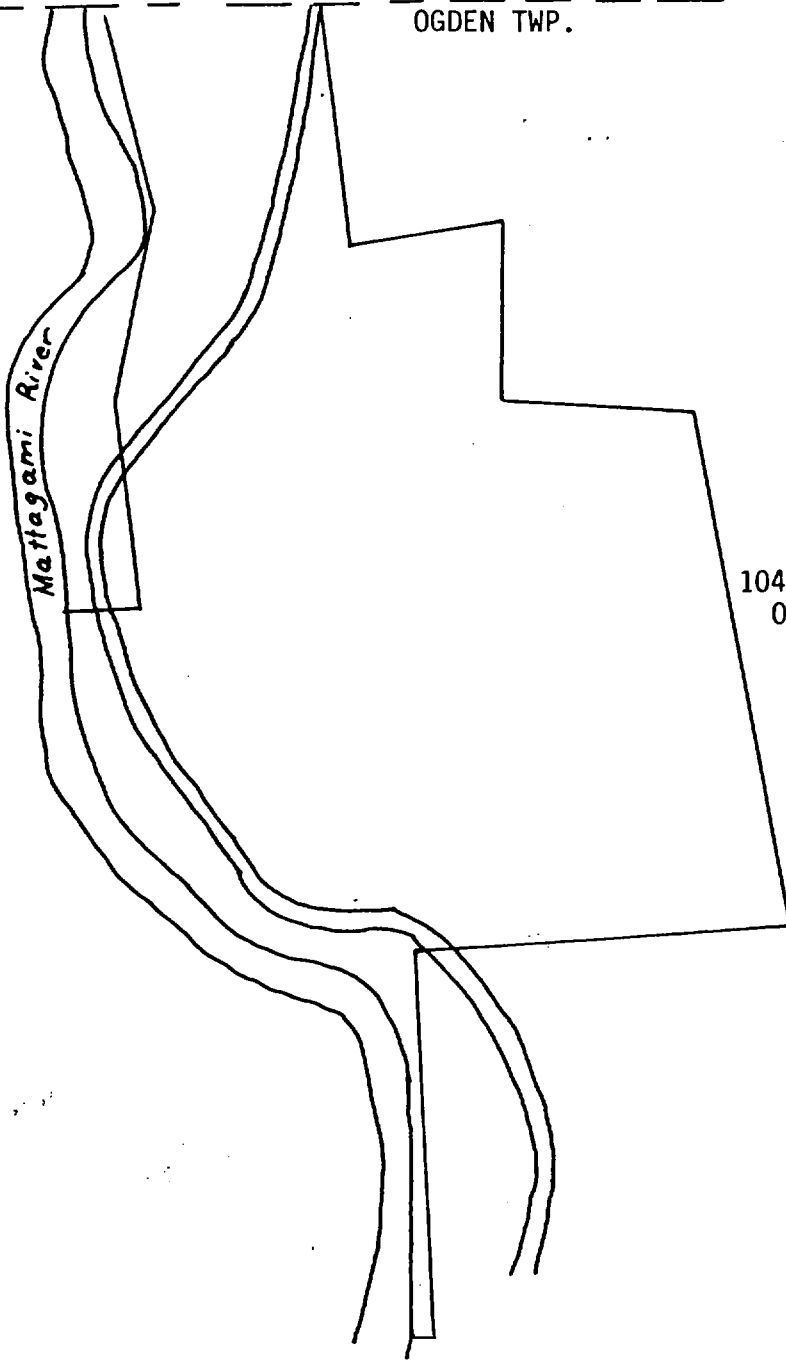

1043-20
Ogden-7

NOTE: No evidence of previous work
was located in the field or
Ministry assessment file.

Area interpreted to be underlain
by metasediments.

AMAX MINERALS EXPLORATION

PROJECT : DELORO (1043)
GROUP : 1043-20, Ogden-7
TWP : Ogden
Survey : Compilation
Date : August, 1981
SCALE : 1" $\frac{1}{4}$ mile

CONCLUSIONS AND RECOMMENDATIONS

An interpretation of the available geophysical data suggests that the property is underlain by sediments.

It is recommended that the airborne conductor be re-examined by geophysics on a differently oriented grid. If this does not produce results the property should be dropped.

Timmins, Ontario
October, 1981



J. MacPherson
Geologist

APPENDIX A

SCHEDULE OF CLAIMS

OGDEN-7

PROJECT 1043-20

Claim Group	Township	Number	Claim Numbers	Recording Date
1043-20 Ogden	Ogden	14	P-595973	January 19, 1981
			P-595974	January 19, 1981
			P-595975	January 19, 1981
			P-595976	January 19, 1981
			P-595977	January 19, 1981
			P-595978	January 19, 1981
			P-595979	January 19, 1981
			P-595980	January 19, 1981
			P-595981	January 19, 1981
			P-595982	January 19, 1981
			P-595983	January 19, 1981
			P-595984	January 19, 1981
			P-595985	January 19, 1981
			P-595986	January 19, 1981



Ministry of
Natural
Resources

Report of Work
(Geophysical, Geological,
Geochemical and Expenditures)

Ogden



42A06NW0210 2.4326 OGDEN

1043-20

#487

The Min

900

Type of Survey(s) Geological Survey		Township or Area Ogden	
Claim Holder(s) Amax of Canada Limited		Prospector's Licence No. A-38495	
Survey Company Amax Minerals Exploration		Survey Dates (linecutting to office) Day 07 Mo. 81 Yr.	Total Miles of line Cut
Name and Address of Author (of Geo-Technical report) J. MacPherson, 255 Algonquin Blvd. West, Timmins, Ontario. P4N 2R8			

Special Provisions Credits Requested

Instructions	Geophysical	Days per Claim
For first survey: Enter 40 days. (This includes line cutting)	- Electromagnetic	
	- Magnetometer	
For each additional survey: using the same grid: Enter 20 days (for each)	- Radiometric	
	- Other	
	Geological	20
	Geochemical	

Mining Claims Traversed (List in numerical sequence)

Mining Claim			Mining Claim		
Prefix	Number	Expend. Days Cr.	Prefix	Number	Expend. Days Cr.
P	595973	20			
	595974	20			
	595975	20			
	595976	20			
	595977	20			
	595978	20			
	595979	20			
	595980	20			
	595981	20			
	595982	20			
	595983	20			
	595984	20			
	595985	20			
	<u>595986</u>	20			

RECEIVED
 NOV 3 01981
 MINING LANDS SECTION

RECORDED
 NOV 25 1981
 Receipt No.

Man Days

Instructions	Geophysical	Days per Claim
Complete reverse side and enter total(s) here	- Electromagnetic	
	- Magnetometer	
	- Radiometric	
	- Other	
	Geological	
	Geochemical	

Airborne Credits

Note: Special provisions credits do not apply to Airborne Surveys.		Days per Claim
	Electromagnetic	
	Magnetometer	
	Radiometric	

Expenditures (excludes power stripping)

Type of Work Performed

Performed on Claim(s)

Calculation of Expenditure Days Credits

Total Expenditures \$ ÷ **15** = Total Days Credits

Instructions
Total Days Credits may be apportioned at the claim holder's choice. Enter number of days credits per claim selected in columns at right.

Report Completed

Date of Report **Nov. 23, 1981**

Recorded Holder or Agent (Signature) *Rosemary Hickey*

For Office Use Only

Total Days Cr. Recorded **280**

Date Recorded **Nov. 25/81**

Date Approved as Recorded

Total number of mining claims covered by this report of work. **14**

Mining Recorder *[Signature]*

Regional/Branch Director

Certification Verifying Report of Work

I hereby certify that I have a personal and intimate knowledge of the facts set forth in the Report of Work annexed hereto, having performed the work or witnessed same during and/or after its completion and the annexed report is true.

Name and Postal Address of Person Certifying



Ministry of
Natural
Resources

SEPT 28, 1982

Your file:

Our file: 2.4326

September 7, 1982

Mr. William L. Good
Mining Recorder
Ministry of Natural Resources
60 Wilson Avenue
Timmins, Ontario
P4N 2S7

Dear Mr. Good:

Enclosed are two copies of a Notice of Intent with statements listing a reduced rate of assessment work credits to be allowed for a technical survey. Please forward one copy to the recorded holder of the claims and retain the other. In approximately fifteen days from the above date, a final letter of approval of these credits will be sent to you. On receipt of the approval letter, you may then change the work entries on the claim record sheets.

Yours very truly,

E.F. Anderson
Director
Lands Administration Branch
Whitney Block, Room 6450
Queen's Park
Toronto, Ontario
M7A 1W3
Phone: 416/965-1316

/las

Encl.

cc Amax of Canada Limited
Timmins, Ontario

cc Mr. G. H. Ferguson, Q.C.
Mining & Lands Commissioner
Toronto, Ontario



Ministry of
Natural
Resources

Notice of Intent
for Technical Reports

File 2.4326

September 7, 1982

An examination of your survey report indicates that the requirements of The Ontario Mining Act have not been fully met to warrant maximum assessment work credits. This notice is merely a warning that you will not be allowed the number of assessment work days credits that you expected and also that in approximately 15 days from the above date, the mining recorder will be authorized to change the entries on his record sheets to agree with the enclosed statement. Please note that until such time as the recorder actually changes the entry on the record sheet, the status of the claim remains unchanged.

If you are of the opinion that these changes by the mining recorder will jeopardize your claims, you may during the next fifteen days apply to the Mining and Lands Commissioner for an extension of time. Abstracts should be sent with your application.

If the reduced rate of credits does not jeopardize the status of the claims then you need not seek relief from the Mining and Lands Commissioner and this Notice of Intent may be disregarded.

If your survey was submitted and assessed under the "Special Provision-Performance and Coverage" method and you are of the opinion that a re-appraisal under the "Man-days" method would result in the approval of a greater number of days credit per claim, you may, within the said fifteen day period, submit assessment work breakdowns listing the employees names, addresses and the dates and hours they worked. The new work breakdowns should be submitted direct to the Lands Management Branch, Toronto. The report will be re-assessed and a new statement of credits based on actual days worked will be issued.



Recorded Holder	Amax of Canada Limited
Township or Area	Ogden Township

Type of survey and number of Assessment days credit per claim	Mining Claims Assessed
Geophysical Electromagnetic _____ days Magnetometer _____ days Radiometric _____ days Induced polarization _____ days Section 86 (18) _____ days Geological <u>20</u> days Geochemical _____ days Man days <input type="checkbox"/> Airborne <input type="checkbox"/> Special provision <input checked="" type="checkbox"/> Ground <input checked="" type="checkbox"/> <input type="checkbox"/> Credits have been reduced because of partial coverage of claims. <input type="checkbox"/> Credits have been reduced because of corrections to work dates and figures of applicant.	P 595973 to 85, inclusive

Special credits under section 86 (15a) for the following mining claims

No credits have been allowed for the following mining claims

not sufficiently covered by the survey Insufficient technical data filed

P 595986

2.4326

1982 11 05

2.4326

Mining Recorder
Ministry of Natural Resources
60 Wilson Avenue
Timmins, Ontario
P4N 2S7

Dear Sir:

RE: Geological Survey on Mining Claims P 595973
et al in the Township of Ogden.

The Geological Survey assessment work credits as listed with my Notice of Intent dated September 7, 1982 have been approved as of the above date.

Please inform the recorded holder of these mining claims and so indicate on your records.

Yours very truly,

E.F. Anderson
Director
Land Management Branch

Whitney Block, Room 6450
Queen's Park
Toronto, Ontario
M7A 1W3
Phone: 416/965-1380

A. Barr:sc

cc: Kmax Minerals Exploration
Timmins, Ontario
Attn: Joseph MacPherson,
Rosemary Tittley.

cc: Resident Geologist
Timmins, Ontario

December 22, 1981

2.4326

Office of the Mining Recorder
Ministry of Natural Resources
60 Wilson Avenue
Timmins, Ontario
P4N 2S7

Dear Sir:

We have received reports and maps for a Geological Survey submitted under Special Provisions (credit for Performance and Coverage) on Mining Claims P.595973 et al, in the Township of Ogden.

This material will be examined and assessed and a statement of assessment work credits will be issued.

Yours very truly,

E.F. Anderson
Director
Land Management Branch

Whitney Block, Room 6450
Queen's Park
Toronto, Ontario
M7A 1W3
Phone: 416/965-1380

J. Skura/bk

cc: AMAX Minerals Exploration
Timmins, Ontario
Attention: Joseph MacPherson/Rosemary Tittley



MINERALS EXPLORATION
(A Division of AMAX OF CANADA LIMITED)

255 Algonquin Blvd. West
Timmins, Ontario
P4N 2R8

Telephone: (705) 264-5247

Our File: 1043-20

November 24, 1981

RECEIVED

NOV 27 1981

MINING LANDS SECTION

Mr. F. W. Matthews,
Ontario Ministry of Natural Resources,
W 1617 Whitney Block,
Queen's Park,
Toronto, Ontario.
M7A 1W3

Dear Sir:

Enclosed herewith please find two (2) copies of a report on a geological survey which was carried out over the below listed contiguous mining claims located in Ogden township, along with their respective survey plans.

P-595973	P-595974	P-595975	P-595976
P-595977	P-595978	P-595979	P-595980
P-595981	P-595982	P-595983	P-595984
P-595985	P-595986		

A "Report of Work" has been filed with Mr. William Good, Mining Recorder for the Porcupine Mining Division.

Thank you.

Yours truly,
AMAX OF CANADA LIMITED

Rosemary Tittley
Rosemary Tittley (Mrs.)
Land Recorder

equal on file no: 63.2513

Encs. 2

c.c. K. Clemiss/E. Barclay, Toronto

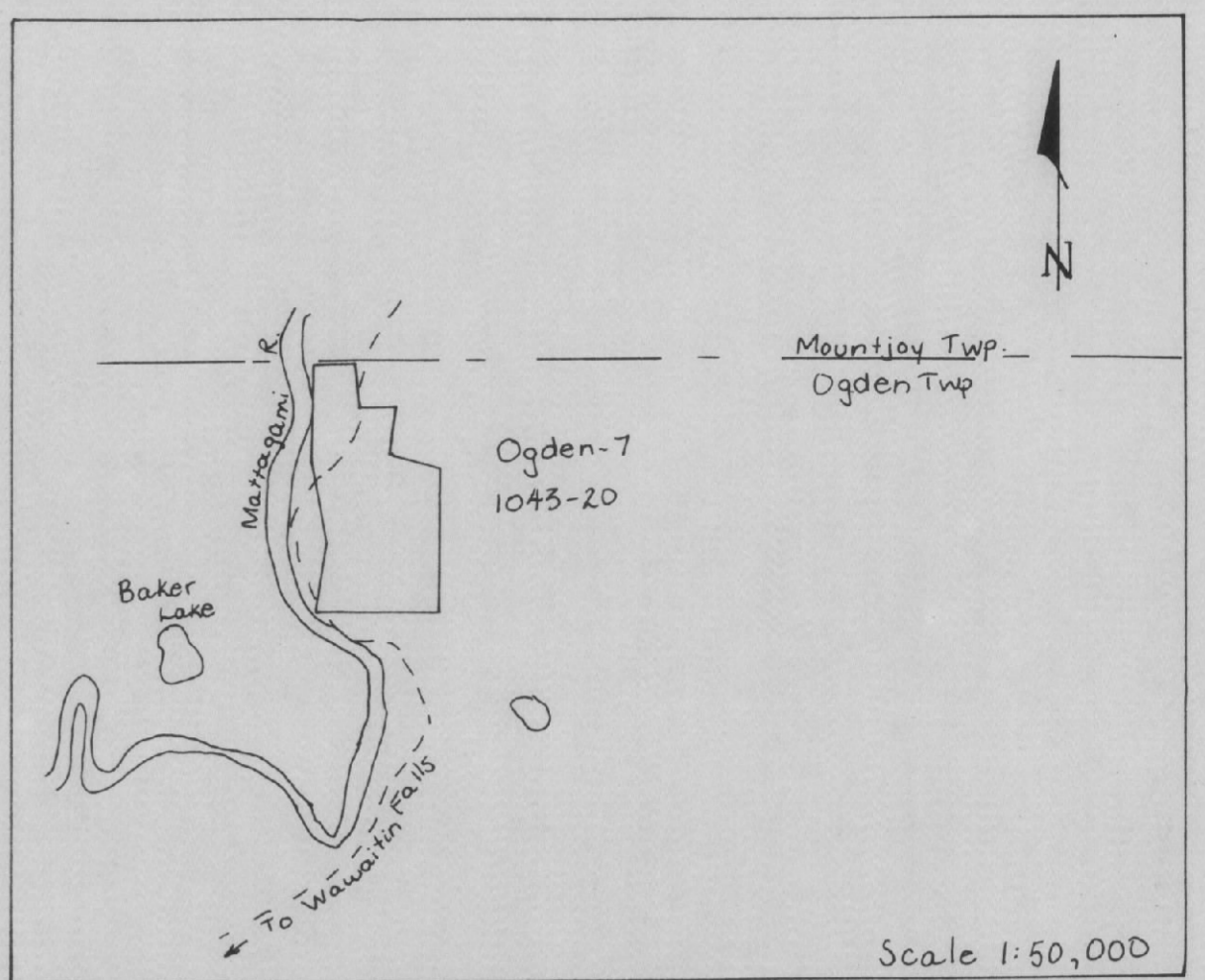

INDEX MAP

Note: No outcrop found on property

SYMBOLS

- Claim post located
- Grid Line
- Traverse Line (pace and compass)
- Stream
- ≡≡≡ Gravel Road
- - - Bush Road

AMAX MINERALS EXPLORATION

GEOLOGICAL SURVEY

OGDEN-7, 1043-20

Ogden Township
District of Cochrane

Scale: 1:5,000

NTS 42/A/6 July 1981
To Accompany Report by *J. Macdonald* Timmins Office
24326

