

Prospecting Report

L.B.L. Richgold Mines Inc.

Deloro Township

2.23683

B.J. McKay

Timmins, Ontario

31 May 2002

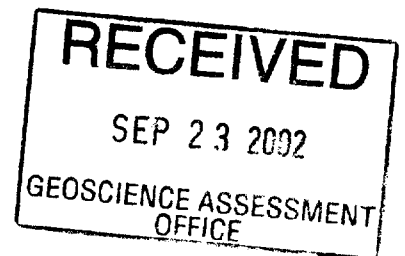

Table of Contents

Introduction	1
Property Location, Access and Claims	1
Previous Work	1
Current Work	1
Regional Geology.....	1
Property Geology	2
Results.....	3
References	3
Certificate.....	4

List of maps

Figure 1: Geology	rear pocket
-------------------------	-------------

Introduction

This report was prepared at the request of the owner, L.B.L. Richgold Mines Inc. with information provided to the author. Detailed prospecting was conducted in two areas to further determine the extent of gold mineralization on the property.

The author has visited the property.

Property Location, Access and Claims

The property straddles the Deloro and Ogden Township boundary. The property is located approximately 6 km south of Timmins and is accessible via Pine Street South.

The property consists of 12 leased claims in Deloro Township and 8 units in 3 claims in Ogden Township. The Ogden claims, 1238662, 1238663 and 1238664, were acquired by staking in August, 2000.

The current work was conducted to meet assessment requirements.

Previous Work

Work has been intermittently conducted on and near the property since 1909. Assessment file T-444 reports on some test pits sunk by Bill and John Mitchell on claim 1116 at the south boundary of the current property. Ridgegold Mines Ltd conducted stripping and trenching from 1923 to 1930. In 1975 Goshawk Mines Ltd. completed ground magnetics and diamond drilling. J. St. Gelais and L. Letourneau completed stripping, trenching and drilling from 1979 to 1983. Amax subjected the area to an airborne MAG and EM survey in 1980. L.B.L. Richgold Mines conducted additional stripping, trenching and drilling in 1986, 1991 and 2000.

Current Work

The prospecting was conducted during the period, 3-21 August 2001, under the supervision of the owner, Lilianne Letourneau. Ray and Sue St. Gelais, Tillsonburg, Val Toner, Timmins and Kent Caron, Timmins provided assistance.

The work was conducted from a camp established on the property.

Regional Geology

The L.B.L. Richgold claim group "lies in the western extremity of the Abitibi Greenstone Belt which is famous for its gold and base-metal deposits. All rocks found in the immediate area, except for Proterozoic diabase dykes, are of Archean Age." (Boisvert, 1986.)

The Richgold property "is underlain by rocks of the Deloro Group. The mafic to intermediate volcanic rocks which dominate this area are characteristic of the Middle Metavolcanic Formation (Pyke, D.R., 1982). The claim group is situated on the western limb of the Shaw Dome, which forms the dominant structural feature of the area. The property lies approximately 1 kilometre to

the south of the Destor-Porcupine Fault which is believed to control the distribution of major gold deposits in the Timing Mining District." (Boisvert, 1986).

Property Geology

"Much of the property is underlain by fine-grained tuffs and lapilli-tuffs of basaltic to andesitic composition. Bedding measurements are uncommon and these strike east and dip steeply to the north. On occasions, andesitic feldspar crystal tuffs, comprising 20% to 35% white plagioclase phenocrysts (1-2mm) occur as 0.3 to 1 metre thick interbeds."

"A few outcrops of andesitic to dacitic tuffs are dispersed throughout the property; the dacites are intercalated with their more mafic counterparts and do not appear to form any laterally "persistent" horizons."

"Two banded iron formations (BIF) were identified on the property. One occurs on the east shore of Meadow Lake (author's note: one of the locations of the current phase of work) and the other, just beyond the southwestern extremity of the claim group (author's note: on the Deloro side of the township line). "...the iron-formation found east of Meadow Lake has apparently been the subject of intense structural deformation."

"The BIF strike roughly east and dip steeply to the north. They are well banded and comprise of rhythmic alterations of aphanitic black magnetite-shale, white-pink-orange chert and pyrite-pyrrhotite-limonite-carbonate layers. The thickness of individual layers varies considerably, ranging from 1 cm to over 1 metre. Pyrite stringers, blebs and pseudo-nodules occur located adjacent to the sulfide ironstone...."

"Numerous fracture cleavages as well as white and cherty quartz veins cross-cut the local stratigraphy, especially in the iron-formation found east of Meadow Lake: this attest to the intense brittle structural deformation which may have occurred locally. The occurrence of convoluted banding, boudin structures and pseudo-fluidization structures in the magnetite-chert iron-formation is indicative of a soft-sediment mode of deformation. Locally, the BIF has been intensely folded, squeezed and mixed, thus losing its banded appearance and taking on a rather "irregular" appearance. A breccia-type texture results, with rounded fragments of magnetite-shale being enclosed in a groundmass of chert and vice-versa."

"The regional foliation (S1?) is generally consistent throughout the property: its strike ranges from 80° to 120° and the dip varies between 70° South to 90°.

"At least a dozen of large quartz veins have been identified on the property. The veins consist of milky white quartz and often contain sericitized, silicified and/or chloritized wallrock xenoliths (1mm-30cm). All veins visited contained at best but a few specks of pyrite (i.e., less than 1% sulfides). The vein thicknesses ranged from 1cm to over 1 metre and their outcrop exposure could be followed on strike for distances varying between 1 metre and 10 metres."

"All major veins found in the northern sector of the property are apparently confined to a zone of siliceous (altered) sericitic and carbonatized volcanics. The alteration zone strikes 100° to 120° and cross-cuts the local stratigraphy 980° to 100°). The vein system, along with its alteration envelope can be followed from the southwest shore of Reid Lake to its southeast shore and possibly beyond. An outcrop displaying carbonatized and sheared volcanics in the northwestern part of the property could conceivably represent the western extension of this zone." (Boisvert, 1986.)

Results

A total of seven samples were obtained from two areas of interest. Refer to enclosed map, Figure 1.

Samples were submitted to Swastika Laboratories for conventional precious and base metal analysis.

The results are included in the legend of the enclosed map.

Encouraging results were obtained.

References

Boisvert, G.J., 1986, L.B.L. Richgold Mines Inc., Report on Geological Survey on the Meadow Lake Property, Deloro Township, Province of Ontario. Val d'Or, Quebec, August 20th, 1986. Timmins Assessment File T-2981. 20pp.

Certificate of Qualifications

I, Bryan Joseph McKay, do certify that:

- 1) I am a resident of Porcupine, Ontario
- 2) I graduated from St. Francis Xavier University, B.Sc. (Major in Geology) in 1974 and from McGill University, M.Sc.(A.) (Mineral Exploration) in 1982.
- 3) I am a member of the Association of Professional Engineers & Geoscientists of Saskatchewan.
- 4) I have been continuously active in the exploration and mining industry since graduation in 1974.
- 5) I have visited the L.B.L. Richgold Mines Inc. property in Deloro Township discussed in this report.
- 6) I do not own, directly or indirectly, any interest in the property discussed in this report nor do I intent to receive, either directly or indirectly, any interest in the property discussed herein.

Signed,

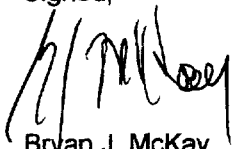

Bryan J. McKay,
M.Sc. (A.), P. Geol.

Porcupine, Ontario
31 May 2002

Date: 2002-OCT-07

GEOSCIENCE ASSESSMENT OFFICE
933 RAMSEY LAKE ROAD, 6th FLOOR
SUDBURY, ONTARIO
P3E 6B5

L.B.L. RICHGOLD MINES INC.
R.R. #3
TILLSONBURG, ONTARIO
N4G 4G8 CANADA

Tel: (888) 415-9845
Fax: (877) 670-1555

Submission Number: 2.23683
Transaction Number(s): W0260.00959

Dear Sir or Madam

Subject: Approval of Assessment Work

We have approved your Assessment Work Submission with the above noted Transaction Number(s). The attached Work Report Summary indicates the results of the approval.

At the discretion of the Ministry, the assessment work performed on the mining lands noted in this work report may be subject to inspection and/or investigation at any time.

A total of \$3200.00 was approved for this submission. The information provided to Mr. Bryan McKay in order for him to write a technical report and provide an adequate prospecting map was minimal. Please review the requirements for filing a prospecting program so that you can collect the required information while you are in the field doing the work. An example of a prospecting submission is provided at our Internet Site @ www.mndm.gov.on.ca/MNDM/MINES/LANDS/asgao/reptexamp/prospect/prospexe.htm.

If you have any question regarding this correspondence, please contact LUCILLE JEROME by email at lucille.jerome@ndm.gov.on.ca or by phone at (705) 670-5858.

Yours Sincerely,

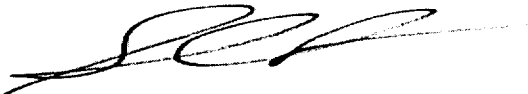

Sheila Lessard
Acting Senior Manager, Mining Lands Section

Cc: Resident Geologist

L.B.L. Richgold Mines Inc.
(Claim Holder)

Bryan Joseph Mckay
(Agent)

Assessment File Library

L.B.L. Richgold Mines Inc.
(Assessment Office)



MINISTRY OF
NATURAL RESOURCES AND FORESTRY
PROVINCE OF ONTARIO

MINING LAND TENURE MAP

Date / Time of Issue Feb 5 2002 13:33h Eastern

TOWNSHIP / AREA PLAN
DELORO G-3993

ADMINISTRATIVE DISTRICTS / DIVISIONS
Mining Division Porcupine
Land Titles/Registry Division COCHRANE
Ministry of Natural Resources District TIMMINS

TOPOGRAPHIC

- Administrative Boundaries
- Contour
- Concession Lot
- Private Lst
- Indian Reserve
- City/Township
- Canal
- Canal - Supply / Sewer / Drainage
- Spot
- Mill Location
- Railway
- Road
- Fence
- Natural Gas Pipeline
- Hydro Line
- Communication Line
- Watercourse
- Mineral / Cultural Resource / Historic District

LAND TENURE

Freehold Patent

- Surface And Mining Rights
- Surface Rights Only
- Mining Rights Only

Landed Patent

- Surface And Mining Rights
- Surface Rights Only
- Mining Rights Only

License of Occupation

- License of Surface
- Surface And Mining Rights
- Surface Rights Only
- Mining Rights Only

LAND TENURE WITHDRAWALS

- Area Withdrawn From Disposition Mining Act (where applicable)
- Area Withdrawn From Disposition Mining Act (where applicable) - Mining Rights Only
- Area Withdrawn From Disposition Mining Act (where applicable) - Surface Rights Only
- Area Withdrawn From Disposition Mining Act (where applicable) - Mining Rights Only
- Area Withdrawn From Disposition Mining Act (where applicable) - Surface Rights Only

IMPORTANT NOTICES

LAND TENURE WITHDRAWAL DESCRIPTIONS

Identifier	Type	Date	Description
3451	With	Jan 1 2001	COME MINES LIMITED SURFACE RIGHTS LEASE #185926
3452	With	Jan 1 2001	COME MINES LIMITED SURFACE RIGHTS LEASE #185926
3453	With	Jan 1 2001	COME MINES LIMITED SURFACE RIGHTS LEASE #185926
3454	With	Jan 1 2001	COME MINES LIMITED SURFACE RIGHTS LEASE #185926
3455	With	Jan 1 2001	MINING CLAIMS WITHIN THIS AREA ARE SUBJECT TO THE RIGHTS AND PRIVILEGES GRANTED TO DELINTE MINES LTD UNDER AN EASEMENT CONTRACT DATED MAY 16, 1977
W1-1292	With	Jan 1 2002	WP-1292 AND RELATED 25% P.O. APPLICATION UNDER THE MINING ACT FOR A WASTE DISPOSAL SITE

IMPORTANT NOTICES

This map is not to be used as a legal document. It is for informational purposes only. It does not constitute a legal document. It is not a guarantee of any kind. It is not a warranty of any kind. It is not a representation of any kind. It is not a statement of any kind. It is not a declaration of any kind. It is not a promise of any kind. It is not a contract of any kind. It is not a deed of any kind. It is not a will of any kind. It is not a power of attorney of any kind. It is not a letter of intent of any kind. It is not a letter of understanding of any kind. It is not a letter of agreement of any kind. It is not a letter of consent of any kind. It is not a letter of approval of any kind. It is not a letter of objection of any kind. It is not a letter of protest of any kind. It is not a letter of appeal of any kind. It is not a letter of request of any kind. It is not a letter of demand of any kind. It is not a letter of notice of any kind. It is not a letter of summons of any kind. It is not a letter of subpoena of any kind. It is not a letter of writ of any kind. It is not a letter of injunction of any kind. It is not a letter of restraining order of any kind. It is not a letter of protective order of any kind. It is not a letter of temporary restraining order of any kind. It is not a letter of temporary protective order of any kind. It is not a letter of permanent restraining order of any kind. It is not a letter of permanent protective order of any kind. It is not a letter of permanent injunction of any kind. It is not a letter of permanent protective injunction of any kind. It is not a letter of permanent restraining injunction of any kind. It is not a letter of permanent protective injunction of any kind. It is not a letter of permanent restraining order of any kind. It is not a letter of permanent protective order of any kind. It is not a letter of permanent restraining injunction of any kind. It is not a letter of permanent protective injunction of any kind.

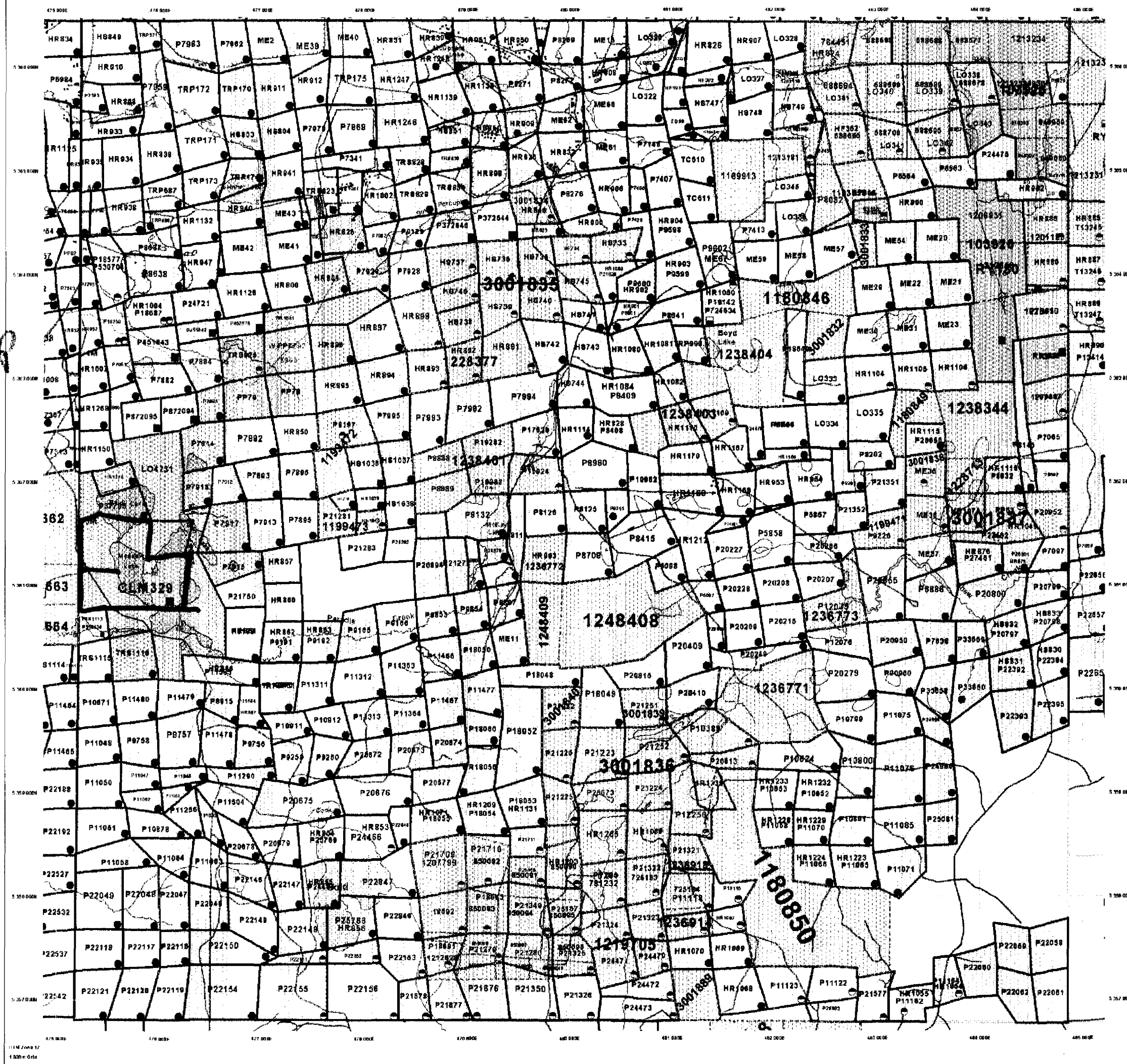

2-23683
PROSP

3001836

1180846

1238404

1238403

1238402

3001837

1238401

1248408

1236771

1236773

1236772

1236774

1236775

1236776

1236777

1236778

1236779

1236780

General Information and Limitations
This map is not to be used as a legal document. It is for informational purposes only. It does not constitute a legal document. It is not a guarantee of any kind. It is not a warranty of any kind. It is not a representation of any kind. It is not a statement of any kind. It is not a declaration of any kind. It is not a promise of any kind. It is not a contract of any kind. It is not a deed of any kind. It is not a will of any kind. It is not a power of attorney of any kind. It is not a letter of intent of any kind. It is not a letter of understanding of any kind. It is not a letter of agreement of any kind. It is not a letter of consent of any kind. It is not a letter of approval of any kind. It is not a letter of objection of any kind. It is not a letter of protest of any kind. It is not a letter of appeal of any kind. It is not a letter of request of any kind. It is not a letter of demand of any kind. It is not a letter of notice of any kind. It is not a letter of summons of any kind. It is not a letter of subpoena of any kind. It is not a letter of writ of any kind. It is not a letter of injunction of any kind. It is not a letter of restraining order of any kind. It is not a letter of protective order of any kind. It is not a letter of temporary restraining order of any kind. It is not a letter of temporary protective order of any kind. It is not a letter of permanent restraining order of any kind. It is not a letter of permanent protective order of any kind. It is not a letter of permanent restraining injunction of any kind. It is not a letter of permanent protective injunction of any kind. It is not a letter of permanent restraining order of any kind. It is not a letter of permanent protective order of any kind. It is not a letter of permanent restraining injunction of any kind. It is not a letter of permanent protective injunction of any kind.

42A06W2032 2.23683 DELORO
200

ODGEN TWP
DELORO TWP

P37705

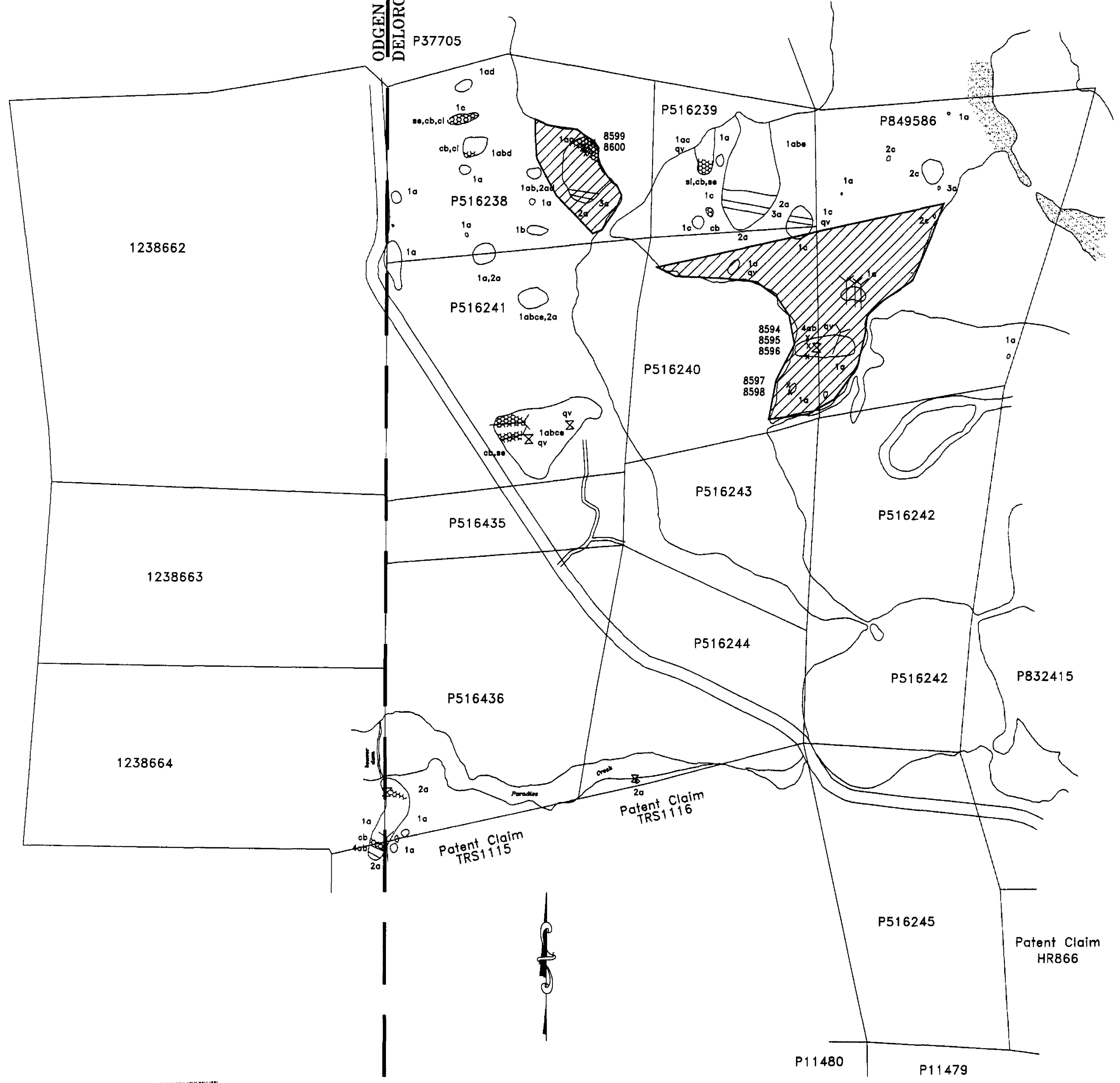

LEGEND

- 1 Mafic to Intermediate Volcanics
 - a fine-grained tuff
 - b lapilli tuff
 - c lapilli tuff breccia
 - d feldspar porphyry dyke
 - e feldspar crystal tuff
- 2 Intermediate to Felsic Volcanics
 - a fine-grained tuff
 - b lapilli tuff
 - c lapilli tuff breccia
 - d feldspar crystal tuff
- 3 Mafic Intrusive
 - a melano-gabbro
- 4 Ironstone
 - a oxide facies ironstone
 - b sulfide

ALTERATION

- stippled alteration zone
- st silicification
- cb carbonate
- se sericite
- cc calcite
- cl chlorite

SYMBOLS

- esker
- outcrop
- trench
- 2001 prospecting sample site and Number

Sam. #	Au-1	Au-2	Ag	Cu	Zn
8594	3		0.1		
8595	1337	1284	0.6	27	59
8596	636		0.4	58	42
8597	9		0.2		
8598	5		0.2	13	63
8599	9		0.1	7	19
8600	206	243	0.3	24	27

Results: reported in ppm

L.B.L. RICHGOLD MINES INC.
Meadow Lake Property

Plan Map		List of Revisions		
Survey by:	Date:	No.	By:	Date:
GJB	July 1986	1	BJM	Nov 95
AutoCAD by:	Date:	2	BJM	Aug 02
BJM	Aug. 2002	3		

