

**Geology Survey and  
Prospecting Report**

2. 26090

**L.B.L. Richgold Mines Inc.**

**Deloro Township**

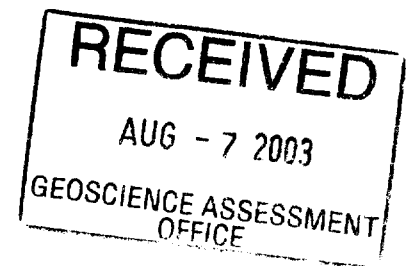

**B.J. McKay**

**Marathon, Ontario**

**4 August 2003**



## Table of Contents

Introduction .....	1
Property Location, Access and Claims.....	1
Previous Work.....	1
Current Work.....	1
Regional Geology.....	1
Property Geology .....	2
Results .....	3
References.....	3
Certificate .....	4

### *List of maps*

Figure 1: Claim Map .....	after page 1
Figure 2: Geological Map .....	after page 3

## **Introduction**

This report was prepared at the request of the owner, L.B.L. Richgold Mines Inc. with information provided to and collected by the author. Prospecting was conducted in two areas to further determine the extent of economic mineralization on the property. The most northern area was surveyed by boat and a single sample was taken from shallow water. Geological mapping was conducted by the author on recently staked claims in the western portion of the property

## **Property Location, Access and Claims**

The property straddles the Deloro and Ogden Township boundary. The property is located approximately 6 km south of Timmins and is accessible via Pine Street South.

The property consists of 11 leased claims in Deloro Township and 8 units in 3 staked claims in Ogden Township. The Ogden claims, 1238662, 1238663 and 1238664, were acquired by staking in August, 2000. Refer to Figure 1.

The current work was conducted to meet assessment requirements.

## **Previous Work**

Work has been intermittently conducted on and near the property since 1909. Assessment file T-444 reports on some test pits sunk by Bill and John Mitchell on claim 1116 at the south boundary of the current property. Ridggold Mines Ltd conducted stripping and trenching from 1923 to 1930. In 1975 Goshawk Mines Ltd. completed ground magnetics and diamond drilling. J. St. Gelais and L. Letourneau completed stripping, trenching and drilling from 1979 to 1983. Amax subjected the area to an airborne MAG and EM survey in 1980. L.B.L. Richgold Mines conducted additional stripping, trenching and drilling in 1986, 1991 and 2000.

## **Current Work**

The prospecting was conducted during the period, 26 July to 4 August 2003, under the supervision of the owner, Lilianne Letourneau. Maurice Letourneau and Rene St. Gelais, from Tillsonburg and Peter Courville, from Timmins provided assistance.

Prospecting was conducted in two areas in Deloro Township. Two samples were obtained from the southern area in claim 516240. A third samples was taken from shallow water in claim 516238. This samples was obtained in an attempt to trace mineralization on the nearby shore. Samples consisted of quartz veins and pyretic iron formation.

Geological mapping was conducted on 31 Aug by the author. The western portion of claim 1238662 and a small section of 1238663 were mapped using existing historical gridlines. The claims are underlain by sheared and rusted mafic to intermediate tuffs. A total of eight quartz vein samples were obtained from historical trenches, rock piles and outcrops.

All samples, from both phases of work, have been submitted for analysis and will be filed in a subsequent report.

Refer to Figure 1 for location of the work completed. Figure 2 shows the geological mapping and sampling.

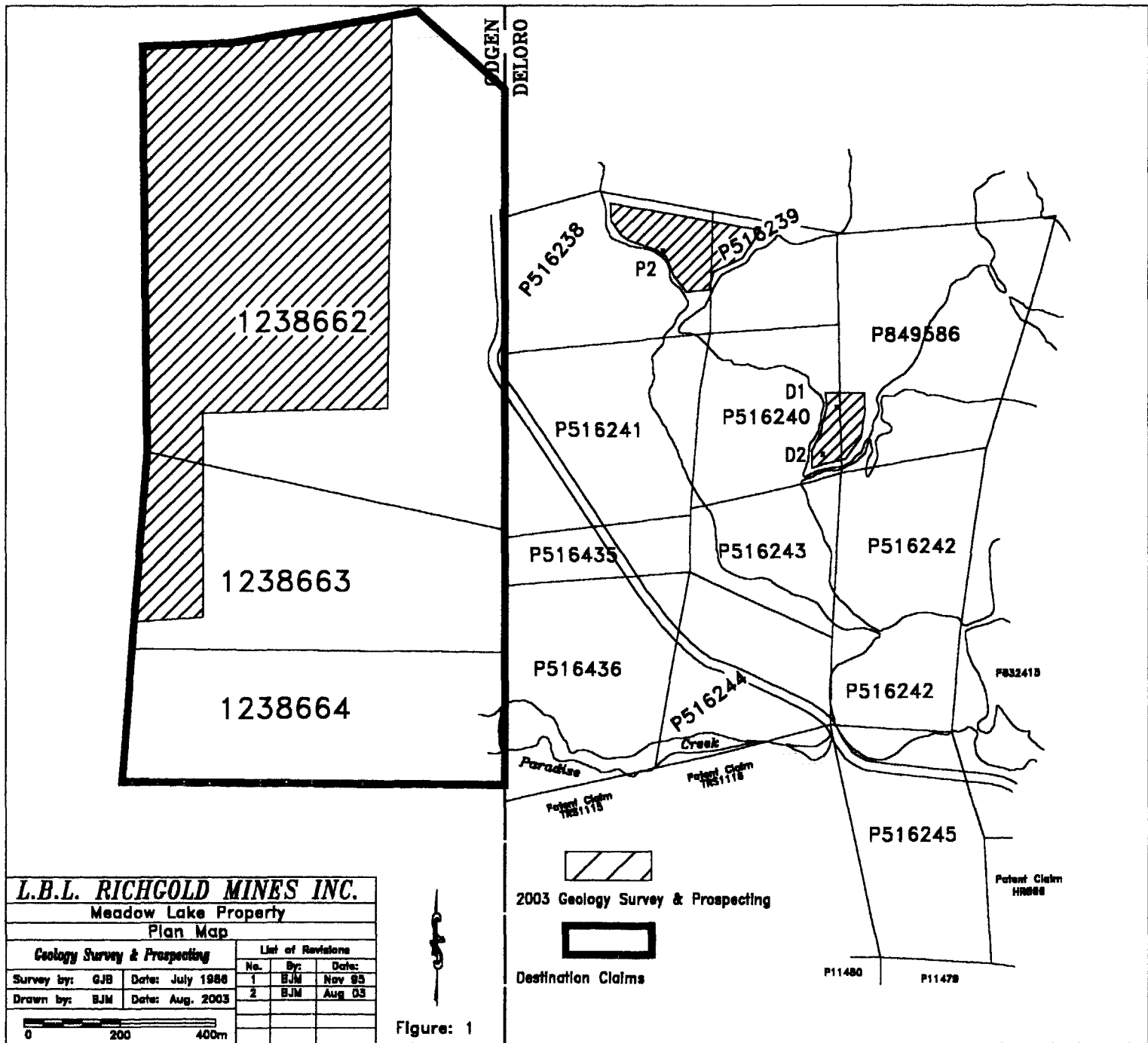

## Regional Geology

The L.B.L. Richgold claim group "lies in the western extremity of the Abitibi Greenstone Belt which is famous for its gold and base-metal deposits. All rocks found in the immediate area, except for Proterozoic diabase dykes, are of Archean Age." (Boisvert, 1986.)

The Richgold property "is underlain by rocks of the Deloro Group. The mafic to intermediate volcanic rocks which dominate this area are characteristic of the Middle Metavolcanic Formation (Pyke, D.R., 1982). The claim group is situated on the western limb of the Shaw Dome, which forms the dominant structural feature of the area. The property lies approximately 1 kilometre to the south of the Destor-Porcupine Fault which is believed to control the distribution of major gold deposits in the Timing Mining District." (Boisvert, 1986).

## Property Geology

"Much of the property is underlain by fine-grained tuffs and lapilli-tuffs of basaltic to andesitic composition. Bedding measurements are uncommon and these strike east and dip steeply to the north. On occasions, andesitic feldspar crystal tuffs, comprising 20% to 35% white plagioclase phenocrysts (1-2mm) occur as 0.3 to 1 metre thick interbeds."

"A few outcrops of andesitic to dacitic tuffs are dispersed throughout the property; the dacites are intercalated with their more mafic counterparts and do not appear to form any laterally "persistent" horizons."

"Two banded iron formations (BIF) were identified on the property. One occurs on the east shore of Meadow Lake (author's note: one of the locations of the current phase of work) and the other, just beyond the southwestern extremity of the claim group (author's note: on the Deloro side of the township line). "...the iron-formation found east of Meadow Lake has apparently been the subject of intense structural deformation."

"The BIF strike roughly east and dip steeply to the north. They are well banded and comprise of rhythmic alterations of aphanitic black magnetite-shale, white-pink-orange chert and pyrite-pyrrhotite-limonite-carbonate layers. The thickness of individual layers varies considerably, ranging from 1 cm to over 1 metre. Pyrite stringers, blebs and pseudo-nodules occur located adjacent to the sulfide ironstone...."

"Numerous fracture cleavages as well as white and cherty quartz veins cross-cut the local stratigraphy, especially in the iron-formation found east of Meadow Lake: this attest to the intense brittle structural deformation which may have occurred locally. The occurrence of convoluted banding, boudin structures and pseudo-fluidization structures in the magnetite-chert iron-formation is indicative of a soft-sediment mode of deformation. Locally, the BIF has been intensely folded, squeezed and mixed, thus losing its banded appearance and taking on a rather "irregular" appearance. A breccia-type texture results, with rounded fragments of magnetite-shale being enclosed in a groundmass of chert and vice-versa."

"The regional foliation (S1?) is generally consistent throughout the property: its strike ranges from 80° to 120° and the dip varies between 70° South to 90°.

"At least a dozen of large quartz veins have been identified on the property. The veins consist of milky white quartz and often contain sericitized, silicified and/or chloritized wallrock xenoliths (1mm-30cm). All veins visited contained at best but a few specks of pyrite (i.e., less than 1% sulfides). The vein thicknesses ranged from 1cm to over 1 metre and their outcrop exposure could be followed on strike for distances varying between 1 metre and 10 metres."

"All major veins found in the northern sector of the property are apparently confined to a zone of siliceous (altered) sericitic and carbonatized volcanics. The alteration zone strikes 100° to 120°

and cross-cuts the local stratigraphy 980° to 100°). The vein system, along with its alteration envelope can be followed from the southwest shore of Reid Lake to its southeast shore and possibly beyond. An outcrop displaying carbonatized and sheared volcanics in the northwestern part of the property could conceivably represent the western extension of this zone." (Boisvert, 1986.)

## **Results**

Figure 1 shows the areas surveyed. Eleven rock samples were obtained during the survey and submitted for analysis. Results are pending at the time of writing and will be filed in a later report.

Rock samples were submitted to Swastika Laboratories for precious and base metal analysis.

## **References**

Boisvert, G.J., 1986, L.B.L. Richgold Mines Inc., Report on Geological Survey on the Meadow Lake Property, Deloro Township, Province of Ontario. Val d'Or, Quebec, August 20<sup>th</sup>, 1986. Timmins Assessment File T-2981. 20pp.

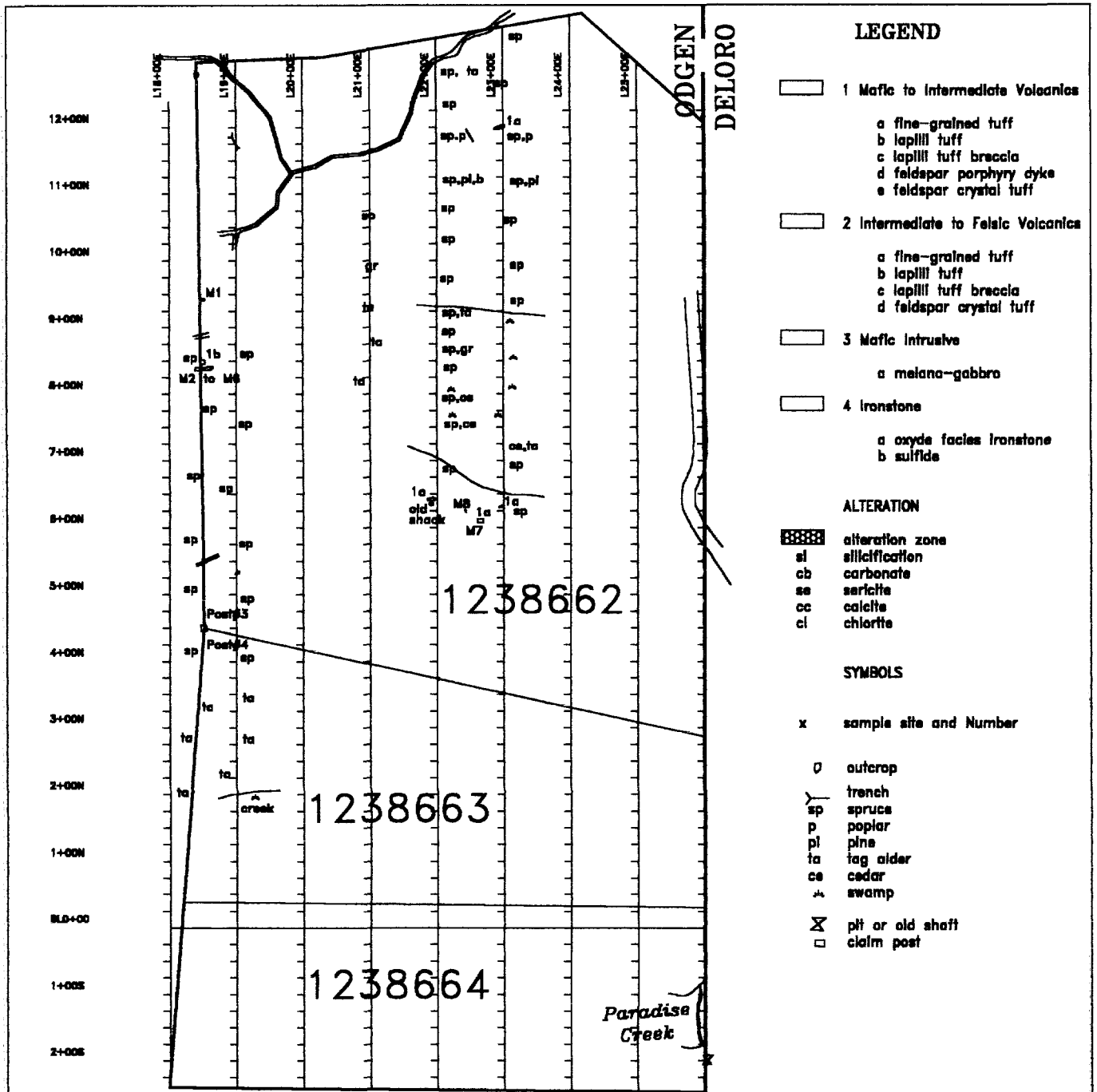

**LEGEND**

- 1 Mafic to Intermediate Volcanics
  - a fine-grained tuff
  - b lapilli tuff
  - c lapilli tuff breccia
  - d feldspar porphyry dyke
  - e feldspar crystal tuff
- 2 Intermediate to Felsic Volcanics
  - a fine-grained tuff
  - b lapilli tuff
  - c lapilli tuff breccia
  - d feldspar crystal tuff
- 3 Mafic Intrusive
  - a melano-gabbro
- 4 Ironstone
  - a oxide facies ironstone
  - b sulfide

**ALTERATION**

- alteration zone
- sil silicification
- cb carbonate
- se sericite
- cc calcite
- cl chlorite

**SYMBOLS**

- x sample site and Number
- o outcrop
- Y trench
- sp spruce
- p poplar
- pl pine
- ta tag alder
- ce cedar
- sw swamp
- X pit or old shaft
- claim post

**L.B.L. RICHGOLD MINES INC.**  
 Meadow Lake Property  
 Plan Map

*Geological Survey*

List of Revisions	
No.	By: Date:
1	BJM Nov 95
2	BJM Aug 03

Survey by: GJB Date: July 1986  
 Drawn by: BJM Date: Aug. 2003

0 200 400m



Figure: 2

## Certificate of Qualifications

I, Bryan Joseph McKay, do certify that:

- 1) I am a resident of Porcupine, Ontario
- 2) I graduated from St. Francis Xavier University, B.Sc. (Major in Geology) in 1974 and from McGill University, M.Sc.(A.) (Mineral Exploration) in 1982.
- 3) I am a member of the Association of Professional Engineers & Geoscientists of Saskatchewan.
- 4) I have been continuously active in the exploration and mining industry since graduation in 1974.
- 5) I have visited the L.B.L. Richgold Mines Inc. property in Deloro and Ogden Townships discussed in this report.
- 6) I do not own, directly or indirectly, any interest in the property discussed in this report nor do I intent to receive, either directly or indirectly, any interest in the property discussed herein.

Signed,

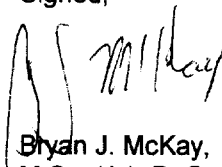

Bryan J. McKay,  
M.Sc. (A.), P. Geol.

Marathon, Ontario  
4 August 2003.





Date: 2003-OCT-16

GEOSCIENCE ASSESSMENT OFFICE  
933 RAMSEY LAKE ROAD, 6th FLOOR  
SUDBURY, ONTARIO  
P3E 6B5

L.B.L. RICHGOLD MINES INC.  
R.R. #3  
TILLSONBURG, ONTARIO  
N4G 4G8 CANADA

Tel: (888) 415-9845  
Fax: (877) 670-1555

**Submission Number:** 2.26090  
**Transaction Number(s):** W0360.01266

Dear Sir or Madam

**Subject: Approval of Assessment Work**

We have approved your Assessment Work Submission with the above noted Transaction Number(s). The attached Work Report Summary indicates the results of the approval.

At the discretion of the Ministry, the assessment work performed on the mining lands noted in this work report may be subject to inspection and/or investigation at any time.

NOTE: Documents submitted on October 10 in Timmins appear to be for submission 2.25943 which reported on prospecting in May and June 2003. The important technical data associated with a prospecting submission remains undocumented. This information was requested in the notice and referred to in an approval letter in 2002. Major additions are required to the technical data and as currently submitted only a minimal amount of assessment credit is available. The response date is November 7, 2003.

The 45 days outlined in the Notice dated August 26, 2003 have passed. None of the deficiencies were addressed. The only eligible work is one day of geology and report writing. The report contains only minor changes from that previously submitted and approved.

The assessment credit is being reduced by \$7,606. The TOTAL VALUE of assessment credit that will be allowed, based on the information provided in this submission, is \$800. Allowable changes to your credit distribution can be made by contacting the Geoscience Assessment Office by October 30, 2003 otherwise assessment credit will be cut-back and distributed as outlined in Section #6 of the Declaration of Assessment Work form.

If you have any question regarding this correspondence, please contact BRUCE GATES by email at [bruce.gates@ndm.gov.on.ca](mailto:bruce.gates@ndm.gov.on.ca) or by phone at (705) 670-5856.

Yours Sincerely,



Ron C. Gashinski  
Senior Manager, Mining Lands Section

**Cc:** Resident Geologist

L.B.L. Richgold Mines Inc.  
(Claim Holder)

Assessment File Library

L.B.L. Richgold Mines Inc.  
(Assessment Office)

Ministry of  
Northern Development  
and Mines

Ministère du  
Développement du Nord  
et des Mines



Bryan Joseph Mckay  
(Agent)

Date / Time of Issue: Wed Oct 15 14:43:27 EDT 2003

TOWNSHIP / AREA  
OGDEN

PLAN  
G-3979

ADMINISTRATIVE DISTRICTS / DIVISIONS

Mining Division Porcupine  
Land Titles/Registry Division COCHRANE  
Ministry of Natural Resources District TIMMINS

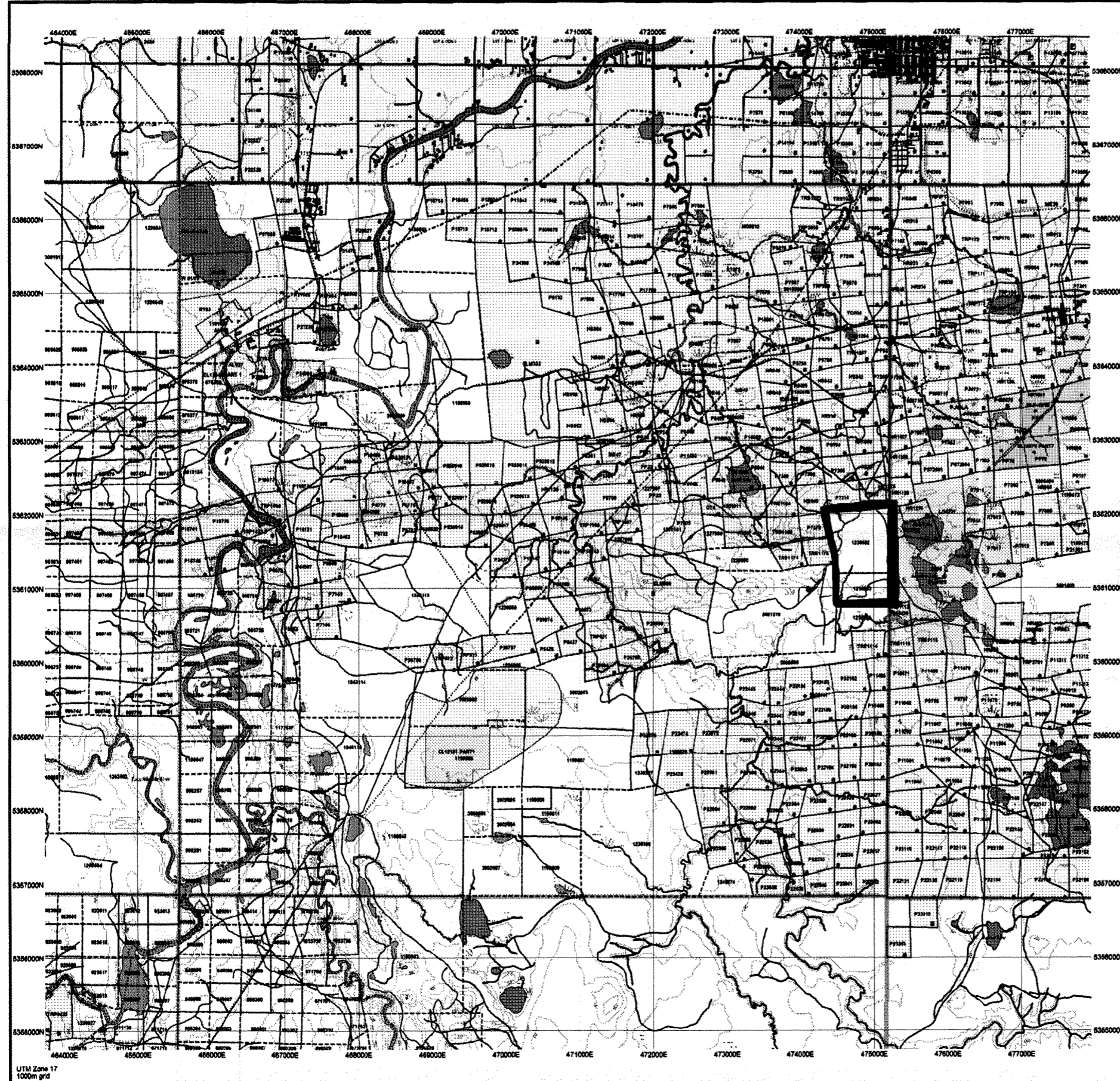

TOPOGRAPHIC

- Administrative Boundaries
- Township
- Concession Lot
- Provincial Park
- Indian Reserve
- CHE, PL & PSL
- Chert
- Wild Shore
- Blue Heartline
- Railway
- Road
- Tier
- Natural Gas Pipeline
- Utilities
- Stream

Land Tenure

- Registered Patent
- Surface Area Mining Right
- Surface Rights Only
- Mining Rights Only
- Location Patent
- Surface Area Mining Right
- Surface Rights Only
- Mining Rights Only
- License of Occupation
- Under Not Specified
- Surface Area Mining Right
- Surface Rights Only
- Mining Rights Only
- Lease Use Permit
- Order in Council (Not open for debate)
- Water Power Lease Agreement
- Mining Claim
- Filed City Mining Claims

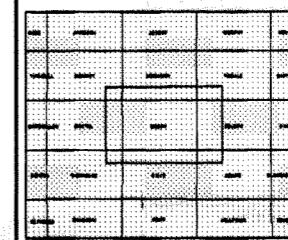

LAND TENURE WITHDRAWALS

- Area Withdrawn from Disposition
- Mining Right Withdrawal Types
- Surface Area Mining Right Withdrawal
- Surface Rights Only Withdrawal
- Mining Rights Only Withdrawal
- Order in Council (Withdrawal Types)
- Surface Area Mining Right Withdrawal
- Surface Rights Only Withdrawal
- Mining Rights Only Withdrawal

LAND TENURE WITHDRAWAL DESCRIPTIONS

Identifier	Type	Date	Description
3373	Withdrawal	Jan 1, 2001	RESERVED FOR RECREATIONAL PURPOSES UNDER P.L.A. FILE 18643
3375	Withdrawal	Jan 1, 2001	RESERVED FOR RECREATIONAL PURPOSES UNDER P.L.A. FILE 18643
3430	Withdrawal	Jan 1, 2001	PENDING APPLICATION UNDER THE PUBLIC LANDS ACT NOTICE RECEIVED BY
3431	Withdrawal	Jan 1, 2001	S.I.C. UNDER APPLICATION THE APPLICABLE LOCAL PRACTICES
3432	Withdrawal	Jan 1, 2001	SRM PDS APPLICATION
3433	Withdrawal	Jan 1, 2001	400 FEET SURFACE RIGHTS PRESENTATION AROUND ALL LAYERS A REVERSE
3434	Withdrawal	Jan 1, 2001	S.I.C. 2470 (1979) & S.I.C. 2470
3435	Withdrawal	Jan 1, 2001	400 FEET SURFACE RIGHTS PRESENTATION AROUND ALL LAYERS A REVERSE
3436	Withdrawal	Aug 19, 1999	Mining Claims shown within this area are subject to the Rights and Privileges granted to
3437	Withdrawal	Jul 26, 2003	Public application for Crown Land
3438	Withdrawal	Aug 12, 2003	Public application under the Public Land, Surface Rights Only
3439	Withdrawal	Nov 2, 1989	Miner 0176, 0177 & 0178
3440	Withdrawal	Feb 24, 1992	Miner 0176, 0177 & 0178
3441	Withdrawal	Nov 1, 2002	Mining Rights withdrawn from Mining, November 1, 2002

2.26090  
GEOL



Those wishing to make mining claims should consult with the Provincial Mining Recorder's Office of the Ministry of Northern Development and Mines for additional information on the status of the areas shown herein. This map is not intended for navigation, survey, or other use where accuracy is essential. The information shown on this map is compiled from various sources. Completeness and accuracy are not guaranteed. Approval/revision may also be obtained through the Land Titles/Registry Office, or the Ministry of Natural Resources.

General Information and Limitations  
Correct Information  
Provincial Mining Recorder's Office  
Tel: 705-941-1111  
Fax: 705-941-1112  
Web: www.mnr.gov.on.ca

This map may not show unregistered third-party claims and it does not constitute a warranty, express or implied, of any kind. The Province of Ontario does not assume any liability for any loss or damage, including consequential, arising from the use of this map. Also, the Province of Ontario does not assume any liability for any loss or damage, including consequential, arising from the use of this map.