



42A06NW8453 39 BRISTOL

010

DIAMOND DRILLING

TOWNSHIP: BRISTOL TWP.

REPORT NO: 39

WORK PERFORMED FOR: Placer Dome Inc.

RECORDED HOLDER: SAME AS ABOVE (xx)

: OTHER ()

<u>CLAIM NO.</u>	<u>HOLE NO.</u>	<u>FOOTAGE</u>	<u>DATE</u>	<u>NOTE</u>
P 997466	246-051	250.0m	May/88	(1)
	246-052	266.0m	May/88	(1)
	246-053	271.0m	May/88	(1)
	246-054	227.0m	May/88	(1)
	246-056	226.0m	May/88	(1)
P 985631	246-058	242.0m	May-June/88	(1)
	246-061	238.0m	June/88	(1)
	246-063	368.0m	June/88	(1)

NOTES: (1) W9006.60238, filed Apr/90

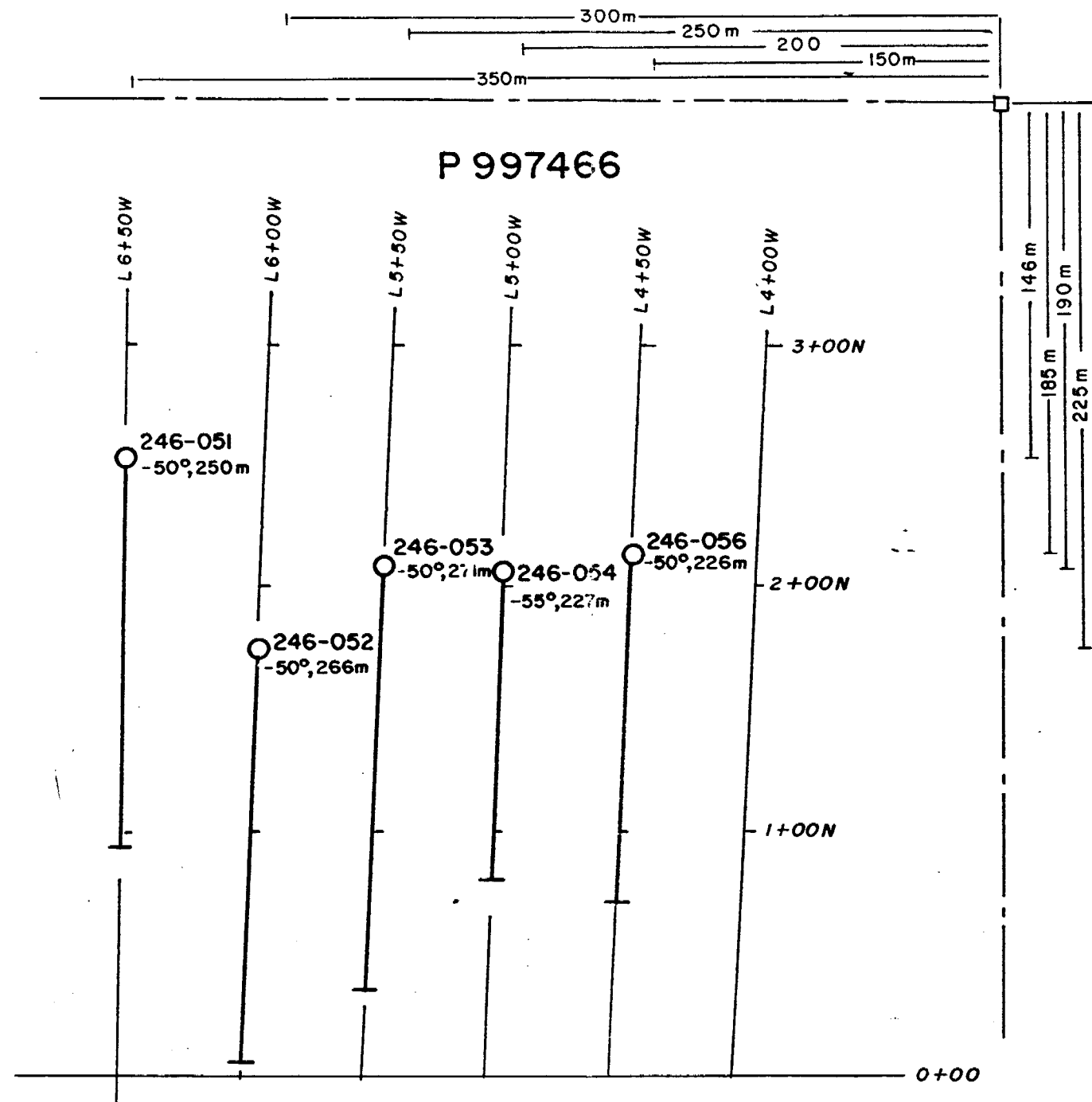

PLACER DOME INC.		
Proj. No. 246, BRISTOL TWP., ONT.		
DDH LOCATIONS		
Scale 1: 2500	Drawn F.C.	Dwg No.
Date Jan. 1990	NTS Ref 42A/6	246-76

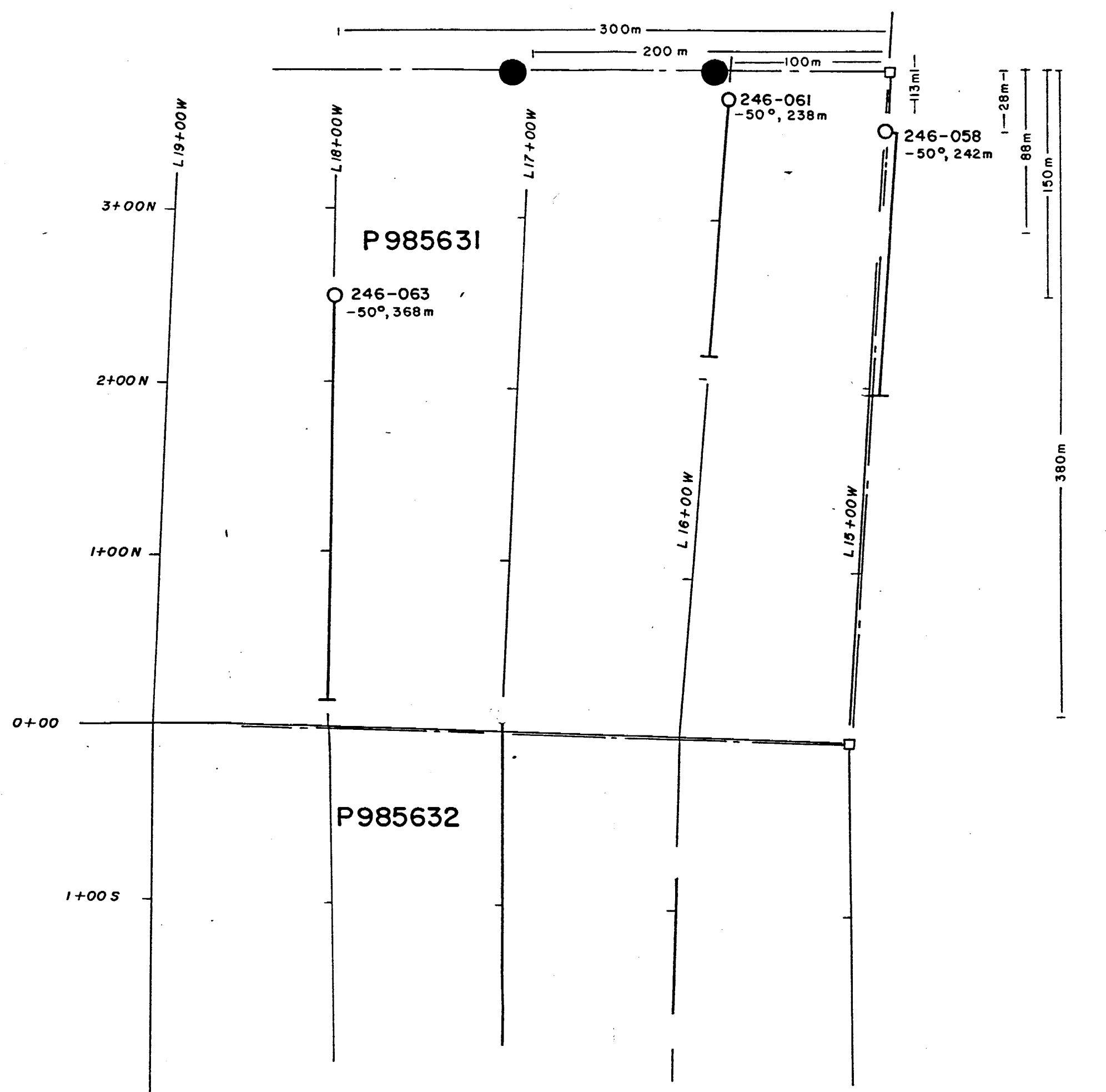

PLACER DOME INC.		
Proj. No. 246, BRISTOL TWP, ONT.		
DDH LOCATIONS		
Scale 1: 2500	Drawn F.C.	Dwg. No. 246-77
Date Jan. 1990	NTS Ref 42A/6	

PLACER DOME INC.

REF CORD: 10254.0 9350.0 SURVEYED: NO

DIAMOND DRILL RECORD

LOCATION: 2+54N 6+50W GRID: SOUTH

HOLE NO: 246-051

PROPERTY: PROJECT 246
BRISTOL TWP, ONTARIO

POST LOCATION: 146m N & 350m W to POST 1, CLAIM P997466

SECTION:

AZIMUTH: 180.0

LENGTH: 250.0

ELEVATION: .0

LOGGED BY: B. COLE

DIP: -50.0

CORE SIZE: BQ

SYSTEM OF MEASURE: METRIC

DATE LOGGED: MAY 4-7, 1988

STARTED: MAY 3, 1988

COMPLETED: MAY 6, 1988

CLAIM NO: P 997466

DIP TESTS (corrected)

DEPTH	AZIMUTH	DIP	DEPTH	AZIMUTH	DIP
35.00		-48.0	242.00		-42.5
122.00		-47.5			

FROM	TO	-----DESCRIPTION-----	SAMPLE	FROM	TO	LENGTH	Au g/t	RERUN	REJECT	AVERAGE
.00	26.00	CASING AND OVERBURDEN								
26.00	40.83	FELSPAR PORPHYRY Light grey. Highly sheared at 60 degrees to the core axis. Predominantly quartz, feldspar, and sericite. Very slightly chloritic. Minor finely disseminated pyrite.								
	26.00	28.00 From BQ Casing.								
	39.89	40.83 90% massive quartz-carbonate vein. Several coarse blebs of chalcopyrite. Contacts at 20 and 55 degrees	D29429	39.89	40.83		.94			
40.83	94.57	PROPYLITIZED FELDSPAR PORPHYRY Green grey. Highly sheared at 60 degrees. Primarily quartz								

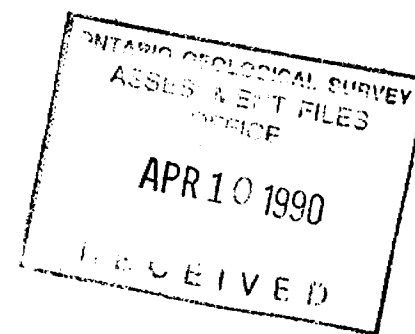

PLACER DOME INC.
DIAMOND DRILL RECORD

HOLE NO: 246-051
PAGE NO: 2

FROM	TO	-----DESCRIPTION-----	SAMPLE	FROM	TO	LENGTH	Au g/t	RERUN	REJECT	AVERAGE
		and feldspar, some sericite. Moderately chloritic. 5 to 10% epidote blebs. Minor finely disseminated pyrite. Minor quartz-carbonate veining.								
40.83	42.50	Minor finely disseminated pyrite.	D29430	40.83	42.50	1.67				
42.50	44.00	Minor finely disseminated pyrite.	D29431	42.50	44.00	1.50				
44.00	45.50	Minor finely disseminated pyrite.	D29432	44.00	45.50	1.50				
45.50	47.00	Minor finely disseminated pyrite.	D29433	45.50	47.00	1.50				
47.00	48.50	Minor finely disseminated pyrite.	D29434	47.00	48.50	1.50				
48.50	50.00	Minor finely disseminated pyrite.	D29435	48.50	50.00	1.50				
50.00	51.50	Minor finely disseminated pyrite.	D29436	50.00	51.50	1.50				
51.50	53.00	Minor finely disseminated pyrite.	D29437	51.50	53.00	1.50				
53.00	54.50	Minor finely disseminated pyrite.	D29438	53.00	54.50	1.50				
54.50	56.00	Minor finely disseminated pyrite.	D29439	54.50	56.00	1.50				
56.00	57.50	Minor finely disseminated pyrite.	D29440	56.00	57.50	1.50				
57.50	59.00	Minor finely disseminated pyrite.	D29441	57.50	59.00	1.50				
59.00	60.50	Minor finely disseminated pyrite.	D29442	59.00	60.50	1.50				
60.50	62.00	Minor finely disseminated pyrite.	D29443	60.50	62.00	1.50				
62.00	63.50	Minor finely disseminated pyrite.	D29444	62.00	63.50	1.50				
63.50	65.00	Minor finely disseminated pyrite.	D29445	63.50	65.00	1.50				
65.00	66.50	Minor finely disseminated pyrite.	D29446	65.00	66.50	1.50				
66.50	68.00	Minor finely disseminated pyrite.	D29447	66.50	68.00	1.50				
68.00	69.50	Minor finely disseminated pyrite.	D29448	68.00	69.50	1.50				
69.50	71.00	Minor finely disseminated pyrite.	D29449	69.50	71.00	1.50				
71.00	72.11	Minor finely disseminated pyrite.	D29450	71.00	72.11	1.11				
72.11	72.93	1% fine to blebby pyrite.	D29451	72.11	72.93	.82				
72.93	73.47	QUARTZ - CARBONATE VEIN: massive pink orange carbonate with minor pyrite. 30% clasts of grey highly fractured quartz with 15% fine pyrite, minor tourmaline.	D29452	72.93	73.47	.54				
73.47	74.53	1 to 5% pyrite.	D29453	73.47	74.53	1.06				
74.53	75.66	1 to 5% pyrite.	D29454	74.53	75.66	1.13				
75.66	77.00	1 to 5% pyrite.	D29455	75.66	77.00	1.34				
77.00	78.50	Minor finely disseminated pyrite. slightly vuggy.	D29456	77.00	78.50	1.50				
78.50	80.00	Minor finely disseminated pyrite. slightly vuggy.	D29457	78.50	80.00	1.50				
80.00	81.50	Minor finely disseminated pyrite.	D29458	80.00	81.50	1.50				
81.50	83.00	Minor finely disseminated pyrite. 10% localized vuggy quartz-carbonate veins.	D29459	81.50	83.00	1.50				

PLACER DOME INC.
DIAMOND DRILL RECORD

HOLE NO: 246-051
PAGE NO: 3

FROM	TO	-----DESCRIPTION-----	SAMPLE	FROM	TO	LENGTH	Au g/t	RERUN	REJECT	AVERAGE
83.00	84.50	Minor finely disseminated pyrite. Slightly silicified locally.	D29460	83.00	84.50	1.50				
84.50	86.00	Minor finely disseminated pyrite. Slightly silicified locally.	D29461	84.50	86.00	1.50				
86.00	87.12	Minor finely disseminated pyrite.	D29462	86.00	87.12	1.12				
87.12	88.39	Minor finely disseminated pyrite.	D29463	87.12	88.39	1.27				
88.39	94.57	Transition to bleached zone.								
88.39	89.58	Slightly bleached. Sericitic with quartz and carbonate. Slightly chloritic. Highly sheared at 60 degrees. 5% coarse disseminated pyrite.	D29464	88.39	89.58	1.19				
89.58	91.06	Similar to 88 to 89.	D29465	89.58	91.06	1.48				
91.06	92.00	Similar to 88 to 89. 15% quartz veinlets. Quite blocky. 10% coarse pyrite.	D29466	91.06	92.00	.94				
92.00	93.33	Similar to 88 to 89. 1 to 5% coarsely disseminated pyrite.	D29467	92.00	93.33	1.33				
93.33	94.57	Similar to 88 to 89. 1% pyrite.	D29468	93.33	94.57	1.24				
94.57	97.65	BLEACHED FELDSPAR PORPHYRY Orange buff. Highly sheared. Very highly sericitic with chloritic portions. 15% quartz eyes. Possibly some albitization. Minor pyrite.								
94.57	95.78	Minor pyrite.	D29469	94.57	95.78	1.21				
95.78	96.53	Minor pyrite.	D29470	95.78	96.53	.75				
96.53	97.65	Minor pyrite.	D29471	96.53	97.65	1.12				
97.65	152.00	PROPYLITIZED FELDSPAR PORPHYRY Transition between bleached and propylitic zones. Grey green. Highly sheared at 65 degrees. Alternating chloritic and sericitic zones. 1 to 5% disseminated pyrite.								
97.65	98.63	Minor disseminated pyrite.	D29472	97.65	98.63	.98				

PLACER DOME INC.
DIAMOND DRILL RECORD

HOLE NO: 246-051

PAGE NO: 4

FROM	TO	-----DESCRIPTION-----	SAMPLE	FROM	TO	LENGTH	Au g/t	RERUN	REJECT	AVERAGE
98.63	99.82	Minor disseminated pyrite. Slightly silicified.	D29473	98.63	99.82	1.19				
99.82	101.00	1% disseminated pyrite.	D29474	99.82	101.00	1.18				
101.00	102.50	1% disseminated pyrite.	D29475	101.00	102.50	1.50				
102.50	104.00	1% disseminated pyrite.	D29476	102.50	104.00	1.50				
104.00	105.50	1% disseminated pyrite. Chloritic sections. Tuffaceous appearance locally.	D29477	104.00	105.50	1.50				
105.50	107.00	5% disseminated pyrite.	D29478	105.50	107.00	1.50				
107.00	108.58	1% disseminated pyrite.	D29479	107.00	108.58	1.58				
108.58	110.24	1% finely disseminated pyrite. Quartz lapilli-tuff appearance. Lenticular clasts at 70 degrees.	D29480	108.58	110.24	1.66				
110.24	111.47	1 to 5% disseminated pyrite, patches of 10% locally. Slightly silicified locally.	D29481	110.24	111.47	1.23				
111.47	113.00	Similar to 110 to 111.	D29482	111.47	113.00	1.53				
113.00	114.50	Similar to 110 to 111.	D29483	113.00	114.50	1.50				
114.50	116.00	Similar to 110 to 111.	D29484	114.50	116.00	1.50				
116.00	117.50	Similar to 110 to 111.	D29485	116.00	117.50	1.50				
117.50	119.00	Similar to 110 to 111.	D29486	117.50	119.00	1.50				
119.00	120.50	1 to 5% disseminated pyrite.	D29487	119.00	120.50	1.50				
120.50	122.00	1 to 5% disseminated pyrite.	D29488	120.50	122.00	1.50				
122.00	123.50	1 to 5% disseminated pyrite.	D29489	122.00	123.50	1.50				
123.50	125.00	1 to 5% disseminated pyrite.	D29490	123.50	125.00	1.50				
125.00	126.50	1 to 5% disseminated pyrite.	D29491	125.00	126.50	1.50				
126.50	128.00	1 to 5% disseminated pyrite.	D29492	126.50	128.00	1.50				
128.00	129.50	1 to 5% disseminated pyrite.	D29493	128.00	129.50	1.50				
129.50	131.00	1 to 5% disseminated pyrite.	D29494	129.50	131.00	1.50				
131.00	132.50	1 to 5% disseminated pyrite.	D29495	131.00	132.50	1.50				
132.50	134.00	1 to 5% disseminated pyrite.	D29496	132.50	134.00	1.50				
134.00	135.50	1 to 5% disseminated pyrite.	D29497	134.00	135.50	1.50				
135.50	137.00	1 to 5% disseminated pyrite.	D29498	135.50	137.00	1.50				
137.00	138.50	1 to 5% disseminated pyrite.	D29499	137.00	138.50	1.50				
138.50	140.00	1 to 5% disseminated pyrite.	D29500	138.50	140.00	1.50				
140.00	141.50	1 to 5% disseminated pyrite.	D29601	140.00	141.50	1.50				
141.50	143.00	1 to 5% disseminated pyrite.	D29602	141.50	143.00	1.50				
143.00	144.50	Tuffaceous: grey. Highly sheared at 65 degrees. 1% pyrite.	D29603	143.00	144.50	1.50				
144.50	146.00	Similar to 143 to 144.	D29604	144.50	146.00	1.50				
146.00	147.50	Similar to 143 to 144.	D29605	146.00	147.50	1.50				
147.50	149.13	Similar to 143 to 144. Localized quartz-carbonate vein with tourmaline at 15%.	D29606	147.50	149.13	1.63				

PLACER DOME INC.
DIAMOND DRILL RECORD

HOLE NO: 246-051
PAGE NO: 5

FROM	TO	-----DESCRIPTION-----	SAMPLE	FROM	TO	LENGTH	Au g/t	RERUN	REJECT	AVERAGE
	149.13	150.50	Similar to 143 to 144.	D29607	149.13	150.50	1.37			
	150.50	152.00	Similar to 143 to 144.	D29608	150.50	152.00	1.50			
152.00	164.31	BLEACHED FELDSPAR PORPHYRY Pink buff. Very highly sheared at 75 degrees. Primarily sericite and carbonate with 5% quartz eyes. Minor to 5% disseminated pyrite.								
	152.00	153.50	1 to 5% disseminated pyrite.	D29609	152.00	153.50	1.50			
	153.50	155.00	1 to 5% disseminated pyrite, 10% locally. Some carbonate-quartz veining.	D29610	153.50	155.00	1.50			
	155.00	156.00	5% disseminated pyrite.	D29611	155.00	156.00	1.00			
	156.00	156.74	5 to 10% disseminated pyrite.	D29612	156.00	156.74	.74			
	156.74	164.31	Quartz lapilli-tuff appearance. Sericitic matrix. 1 to 10% coarse pyrite, 20% locally.							
	156.74	158.00	Quartz lapilli-tuff appearance. 5 to 10% pyrite, very crudely aligned parallel with plane of shear.	D29613	156.74	158.00	1.26			
	158.00	159.50	Similar to 156 to 158.	D29614	158.00	159.50	1.50			
	159.50	161.00	Similar to 156 to 158.	D29615	159.50	161.00	1.50			
	161.00	162.36	Similar to 156 to 158.	D29616	161.00	162.36	1.36			
	162.36	163.43	Similar to 156 to 158. 20% coarse pyrite crudely aligned parallel with plane of shear.	D29617	162.36	163.43	1.07			
	163.43	164.31	Similar to 156 to 158.	D29618	163.43	164.31	.88			
164.31	182.00	PROPYLITIZED FELDSPAR PORPHYRY Similar to 97 to 152. Abundant carbonate. 5% quartz eyes generally. Minor to 5% disseminated pyrite.								
	164.31	165.50	1% disseminated pyrite.	D29619	164.31	165.50	1.19			
	165.50	167.00	1% disseminated pyrite.	D29620	165.50	167.00	1.50			
	167.00	168.50	1% disseminated pyrite.	D29621	167.00	168.50	1.50			
	168.50	170.00	1% disseminated pyrite.	D29622	168.50	170.00	1.50			
	170.00	171.50	1% disseminated pyrite.	D29623	170.00	171.50	1.50			
	171.50	173.00	1% disseminated pyrite.	D29624	171.50	173.00	1.50			
	173.00	174.50	1% disseminated pyrite.	D29625	173.00	174.50	1.50			

PLACER DOME INC.
DIAMOND DRILL RECORD

HOLE NO: 246-051
PAGE NO: 6

FROM	TO	-----DESCRIPTION-----	SAMPLE	FROM	TO	LENGTH	Au g/t	RERUN	REJECT	AVERAGE
174.50	176.00	1% disseminated pyrite.	D29626	174.50	176.00	1.50				
176.00	177.50	1% disseminated pyrite.	D29627	176.00	177.50	1.50				
177.50	179.00	1% disseminated pyrite.	D29628	177.50	179.00	1.50				
179.00	180.50	1% disseminated pyrite.	D29629	179.00	180.50	1.50				
180.50	182.00	1% disseminated pyrite.	D29630	180.50	182.00	1.50				
182.00	200.00	BLEACHED FELDSPAR PORPHYRY Grey. Very abundant carbonate, sericitic, slightly siliceous. Very highly sheared at 70 degrees. Brecciated appearance locally. 1 to 5% pyrite, 20% locally. Some chalcopyrite locally.								
182.00	183.00	1 to 5% disseminated pyrite.	D29631	182.00	183.00	1.00				
183.00	184.00	1 to 5% disseminated pyrite.	D29632	183.00	184.00	1.00				
184.00	185.00	1 to 5% disseminated pyrite.	D29633	184.00	185.00	1.00				
185.00	186.00	1 to 5% disseminated pyrite.	D29634	185.00	186.00	1.00				
186.00	187.00	1 to 5% disseminated pyrite.	D29635	186.00	187.00	1.00				
187.00	188.00	1 to 5% disseminated pyrite.	D29636	187.00	188.00	1.00				
188.00	189.00	5% disseminated and coarse blebby pyrite aligned parallel with plane of shear. Several localized blebs of chalcopyrite.	D29637	188.00	189.00	1.00				
189.00	190.22	5% disseminated and coarse blebby pyrite.	D29638	189.00	190.22	1.22				
190.22	191.00	15% coarse pyrite crudely aligned parallel with plane of shear at 70 degrees.	D29639	190.22	191.00	.78				
191.00	191.89	Similar to 190 to 191.	D29640	191.00	191.89	.89				
191.89	192.15	Similar to 190 to 191, with 2 pyrite, chalcopyrite bands 1 and 2 cms wide.	D29641	191.89	192.15	.26				
192.15	193.15	5 to 10% coarse pyrite.	D29642	192.15	193.15	1.00				
193.15	194.30	5 to 15% disseminated and blebby pyrite in siliceous, breccia (?).	D29643	193.15	194.30	1.15				
194.30	195.30	5% finely disseminated pyrite.	D29644	194.30	195.30	1.00				
195.30	195.62	Quartz-carbonate vein with 15% coarse tourmaline stringers and 5% finely disseminated, localized pyrite.	D29645	195.30	195.62	.32				
195.62	196.49	Silicified quartz breccia. 10 to 15% finely disseminated and blebby pyrite.	D29646	195.62	196.49	.87				
196.49	197.78	Slightly silicified. 15% fine blebby pyrite	D29647	196.49	197.78	1.29				

PLACER DOME INC.
DIAMOND DRILL RECORD

HOLE NO: 246-051
PAGE NO: 7

FROM	TO	-----DESCRIPTION-----	SAMPLE	FROM	TO	LENGTH	Au g/t	RERUN	REJECT	AVERAGE
		aligned parallel with shear.								
	197.78	198.90 Similar to 196 to 197.	D29648	197.78	198.90	1.12				
	198.90	200.00 2% very finely disseminated pyrite.	D29649	198.90	200.00	1.10				
200.00	216.24	SILICIFIED FELDSPAR PORPHYRY Light grey. Generally moderately silicified. Moderately to highly sheared at 55 degrees. Highly sericitic with carbonate along shear planes. Minor to 5% pyrite.								
	200.00	201.50 1% finely disseminated pyrite.	D29650	200.00	201.50	1.50				
	201.50	203.00 1% finely disseminated pyrite.	D29651	201.50	203.00	1.50				
	203.00	204.50 1% finely disseminated pyrite.	D29652	203.00	204.50	1.50				
	204.50	206.00 1% finely disseminated pyrite.	D29653	204.50	206.00	1.50				
	206.00	206.86 3% finely disseminated pyrite.	D29654	206.00	206.86	.86				
	206.86	208.03 10% finely disseminated with blebby pyrite.	D29655	206.86	208.03	1.17				
	208.03	209.00 Medium grey. Extremely silicified. Quite hard. 10 to 15% fine, blebby pyrite.	D29656	208.03	209.00	.97				
	209.00	210.00 Similar to 208 to 209.	D29657	209.00	210.00	1.00				
	210.00	212.00 Grind.								
	212.00	212.94 Similar to 208 to 209.	D29658	212.00	212.94	.94				
	212.94	214.22 5% fine, blebby pyrite. Chalcopyrite, pyrite, quartz stringer.	D29659	212.94	214.22	1.28				
	214.22	215.00 1 to 5% pyrite.	D29660	214.22	215.00	.78				
	215.00	216.24 1 to 5% pyrite.	D29661	215.00	216.24	1.24				
216.24	250.00	PROPYLITIZED FELDSPAR PORPHYRY Similar to 97 to 152. Highly sheared at 65 degrees. 1% disseminated pyrite, occasional chalcopyrite stringer.								
	216.24	217.28 1% disseminated pyrite.	D29662	216.24	217.28	1.04				
	217.28	218.00 1% disseminated pyrite.	D29663	217.28	218.00	.72				
	218.00	219.50 1% disseminated pyrite. Blocky.	D29664	218.00	219.50	1.50				
	219.50	221.00 1% disseminated pyrite.	D29665	219.50	221.00	1.50				
	221.00	222.50 1% disseminated pyrite.	D29666	221.00	222.50	1.50				
	222.50	224.00 1% disseminated pyrite.	D29667	222.50	224.00	1.50				
	224.00	225.20 1% disseminated pyrite.	D29668	224.00	225.20	1.20				

PLACER DOME INC.
DIAMOND DRILL RECORD

HOLE NO: 246-051
PAGE NO: 8

FROM	TO	-----DESCRIPTION-----	SAMPLE	FROM	TO	LENGTH	Au g/t	RERUN	REJECT	AVERAGE
225.20	226.37	1% disseminated pyrite.	D29669	225.20	226.37	1.17				
226.37	227.32	1% disseminated pyrite.	D29670	226.37	227.32	.95				
227.32	227.59	1% disseminated pyrite. Several thin chalcopyrite stringers.	D29671	227.32	227.59	.27				
227.59	228.83	1% disseminated pyrite.	D29672	227.59	228.83	1.24				
228.83	230.00	1% disseminated pyrite.	D29673	228.83	230.00	1.17				
230.00	231.50	1% disseminated pyrite.	D29674	230.00	231.50	1.50				
231.50	233.00	1% disseminated pyrite.	D29675	231.50	233.00	1.50				
233.00	250.00	Slightly to moderately chloritic. Generally darker in colour.								
233.00	234.50	1 to 5% pyrite.	D29676	233.00	234.50	1.50				
234.50	236.00	1 to 5% pyrite.	D29677	234.50	236.00	1.50				
236.00	237.50	1 to 5% pyrite.	D29678	236.00	237.50	1.50				
237.50	239.00	1 to 5% pyrite.	D29679	237.50	239.00	1.50				
239.00	240.02	1 to 5% pyrite.	D29680	239.00	240.02	1.02				
240.02	241.19	1 to 5% pyrite.	D29681	240.02	241.19	1.17				
241.19	241.48	15% localized, reticulate chalcopyrite. Minor pyrite.	D29682	241.19	241.48	.29				
241.48	242.77	1 to 5% disseminated pyrite.	D29683	241.48	242.77	1.29				
242.77	244.00	1 to 5% disseminated pyrite.	D29684	242.77	244.00	1.23				
244.00	245.00	1% fine disseminated pyrite.	D29685	244.00	245.00	1.00				
245.00	246.50	1% fine disseminated pyrite.	D29686	245.00	246.50	1.50				
246.50	248.00	1% fine disseminated pyrite.	D29687	246.50	248.00	1.50				
248.00	249.19	1% fine disseminated pyrite.	D29688	248.00	249.19	1.19				
249.19	250.00	1% fine disseminated pyrite. 50 cm wide quartz-carbonate vein with 5% tourmaline, minor pyrite. Slightly vuggy.	D29689	249.19	250.00	.81				

250.00 END OF HOLE

CORE STORED AT DOME MINES, SOUTH PORCUPINE, ONTARIO.

N CASING DRIVEN TO BEDROCK AND LEFT IN HOLE. B CASING PULLED.

PLACER DOME INC.
DIAMOND DRILL RECORD

HOLE NO: 246-051
PAGE NO: 9

FROM TO -----DESCRIPTION----- SAMPLE FROM TO LENGTH Au g/t RERUN REJECT AVERAGE

HOLE CAPPED.

DRILLING BY BRADLEY BROS. DRILLING, TIMMINS, ONTARIO.

Zuan Cole

PLACER DOME INC.

REF CORD: 175.0 -600.0 SURVEYED: NO

DIAMOND DRILL RECORD

HOLE NO: 246-052

LOCATION: 1+75N 6+00W GRID: SOUTH

PROPERTY: PROJECT 246
BRISTOL TWP, ONTARIO

POST LOCATION: 225m N & 300m W to POST 1, CLAIM P997466

SECTION:

AZIMUTH: 180.0

LENGTH: 266.0

ELEVATION: .0

LOGGED BY: B. COLE

DIP: -50.0

CORE SIZE: BQ

SYSTEM OF MEASURE: METRIC

DATE LOGGED: MAY 7-11, 1988

STARTED: MAY 6, 1988

COMPLETED: MAY 10, 1988

CLAIM NO: P 997466

DIP TESTS (corrected)

DEPTH	AZIMUTH	DIP	DEPTH	AZIMUTH	DIP
42.00		-53.0	264.00	171	-39.5
150.00	175	-42.0			

FROM	TO	-----DESCRIPTION-----	SAMPLE	FROM	TO	LENGTH	Au g/t	RERUN	REJECT	AVERAGE
------	----	-----------------------	--------	------	----	--------	--------	-------	--------	---------

.00	35.93	CASING AND OVERBURDEN								
-----	-------	-----------------------	--	--	--	--	--	--	--	--

35.93	66.76	FELSPAR PORPHYRY Buff to light green portions. Highly sheared at 60 degrees to the core axis. Quite sericitic with slightly chloritic sections. Large quartz eyes occur commonly. Minor to 1% disseminated pyrite. Occasional thin brecciated portion.								
-------	-------	---	--	--	--	--	--	--	--	--

66.76	76.23	PROPYLITIZED FELDSPAR PORPHYRY Green grey. Slightly chloritic. Abundant carbonate. Possibly lapilli-tuff. Highly sheared at 55 degrees. 1 to 5% disseminated pyrite.								
-------	-------	---	--	--	--	--	--	--	--	--

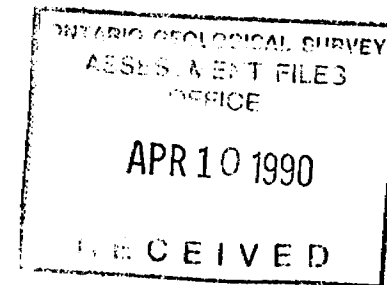

PLACER DOME INC.
DIAMOND DRILL RECORD

HOLE NO: 246-052
PAGE NO: 3

FROM	TO	-----DESCRIPTION-----	SAMPLE	FROM	TO	LENGTH	Au g/t	RERUN	REJECT	AVERAGE
		disseminated and blebby pyrite.								
107.70	108.90	1 to 5% pyrite.	D73005	107.70	108.90	1.20				
108.90	110.00	1 to 5% pyrite.	D73006	108.90	110.00	1.10				
110.00	111.30	5 to 10% fine blebby pyrite, 15% locally.	D73007	110.00	111.30	1.30				
111.30	112.30	5% fine blebby pyrite.	D73008	111.30	112.30	1.00				
112.30	113.00	1 to 5% pyrite.	D73009	112.30	113.00	.70				
113.00	114.50	1 to 5% pyrite.	D73010	113.00	114.50	1.50				
114.50	116.00	1% disseminated pyrite.	D73011	114.50	116.00	1.50				
116.00	117.00	1 to 5% pyrite.	D73012	116.00	117.00	1.00				
117.00	120.25	PROPYLITIZED MAFIC - INTERMEDIATE LAPILLI-TUFF Similar to 97 to 107.								
117.00	117.85	10 to 15% fine blebby pyrite. Several large blebs.	D73013	117.00	117.85	.85				
117.85	119.00	1% disseminated pyrite.	D73014	117.85	119.00	1.15				
119.00	120.25	5 to 10% fine blebby pyrite.	D73015	119.00	120.25	1.25				
120.25	266.00	PROPYLITIZED FELDSPAR PORPHYRY								
120.25	146.00	Grey green. Slightly chloritic. Abundant carbonate. 5% quartz eyes. Highly sheared at 65 to 70 degrees. Minor to 1% disseminated pyrite.								
120.25	122.00	Minor to 1% disseminated pyrite.	D73016	120.25	122.00	1.75				
122.00	123.50	Minor to 1% disseminated pyrite.	D73017	122.00	123.50	1.50				
123.50	125.00	Minor to 1% disseminated pyrite.	D73018	123.50	125.00	1.50				
125.00	126.50	Minor to 1% disseminated pyrite.	D73019	125.00	126.50	1.50				
126.50	128.00	Minor to 1% disseminated pyrite.	D73020	126.50	128.00	1.50				
128.00	129.50	Minor to 1% disseminated pyrite.	D73021	128.00	129.50	1.50				
129.50	131.00	Minor to 1% disseminated pyrite.	D73022	129.50	131.00	1.50				
131.00	132.50	Minor to 1% disseminated pyrite.	D73023	131.00	132.50	1.50				
132.50	134.00	Minor to 1% disseminated pyrite.	D73024	132.50	134.00	1.50				

PLACER DOME INC.
DIAMOND DRILL RECORD

HOLE NO: 246-052
PAGE NO: 4

FROM	TO	-----DESCRIPTION-----	SAMPLE	FROM	TO	LENGTH	Au g/t	RERUN	REJECT	AVERAGE
134.00	135.50	Minor to 1% disseminated pyrite.	D73025	134.00	135.50	1.50				
135.50	137.00	Minor to 1% disseminated pyrite.	D73026	135.50	137.00	1.50				
137.00	138.50	Minor to 1% disseminated pyrite.	D73027	137.00	138.50	1.50				
138.50	140.00	Minor to 1% disseminated pyrite.	D73028	138.50	140.00	1.50				
140.00	141.50	Minor to 1% disseminated pyrite.	D73029	140.00	141.50	1.50				
141.50	143.00	Minor to 1% disseminated pyrite.	D73030	141.50	143.00	1.50				
143.00	144.50	Minor to 1% disseminated pyrite.	D73031	143.00	144.50	1.50				
144.50	146.00	Minor to 1% disseminated pyrite.	D73032	144.50	146.00	1.50				
146.00	200.00	Moderately chloritic. Darker in colour. Generally with 5 to 10% dark quartz eyes.								
146.00	147.50	Minor to 1% disseminated pyrite.	D73033	146.00	147.50	1.50				
147.50	149.00	1% disseminated pyrite.	D73034	147.50	149.00	1.50				
149.00	150.50	1% disseminated pyrite.	D73035	149.00	150.50	1.50				
150.50	152.00	1% disseminated pyrite.	D73036	150.50	152.00	1.50				
152.00	153.50	1% disseminated pyrite.	D73037	152.00	153.50	1.50				
153.50	155.00	1% disseminated pyrite.	D73038	153.50	155.00	1.50				
155.00	156.50	1% disseminated pyrite.	D73039	155.00	156.50	1.50				
156.50	158.00	1% disseminated pyrite.	D73040	156.50	158.00	1.50				
158.00	159.50	1% disseminated pyrite.	D73041	158.00	159.50	1.50				
159.50	161.00	1% disseminated pyrite.	D73042	159.50	161.00	1.50				
161.00	162.50	1% disseminated pyrite.	D73043	161.00	162.50	1.50				
162.50	164.00	1% disseminated pyrite.	D73044	162.50	164.00	1.50				
164.00	165.50	1% disseminated pyrite.	D73045	164.00	165.50	1.50				
165.50	167.00	1% disseminated pyrite.	D73046	165.50	167.00	1.50				
167.00	168.50	1% disseminated pyrite.	D73047	167.00	168.50	1.50				
168.50	170.00	1% disseminated pyrite.	D73048	168.50	170.00	1.50				
170.00	171.50	1% disseminated pyrite.	D73049	170.00	171.50	1.50				
171.50	173.00	1% disseminated pyrite.	D73050	171.50	173.00	1.50				
173.00	174.50	1% disseminated pyrite.	D73051	173.00	174.50	1.50				
174.50	176.00	1% disseminated pyrite.	D73052	174.50	176.00	1.50				
176.00	177.50	1% disseminated pyrite.	D73053	176.00	177.50	1.50				
177.50	179.00	1% disseminated pyrite.	D73054	177.50	179.00	1.50				
179.00	180.50	1% disseminated pyrite.	D73055	179.00	180.50	1.50				
180.50	182.00	1% disseminated pyrite.	D73056	180.50	182.00	1.50				
182.00	183.50	1% disseminated pyrite.	D73057	182.00	183.50	1.50				
183.50	185.00	1% disseminated pyrite.	D73058	183.50	185.00	1.50				
185.00	186.50	1% disseminated pyrite.	D73059	185.00	186.50	1.50				
186.50	188.00	1% disseminated pyrite.	D73060	186.50	188.00	1.50				

PLACER DOME INC.
DIAMOND DRILL RECORD

HOLE NO: 246-052
PAGE NO: 5

FROM	TO	-----DESCRIPTION-----	SAMPLE	FROM	TO	LENGTH	Au g/t	RERUN	REJECT	AVERAGE
188.00	189.50	1% disseminated pyrite.	D73061	188.00	189.50	1.50				
189.50	191.00	1% disseminated pyrite.	D73062	189.50	191.00	1.50				
191.00	192.50	1% disseminated pyrite.	D73063	191.00	192.50	1.50				
192.50	194.00	1% disseminated pyrite.	D73064	192.50	194.00	1.50				
194.00	195.50	1% disseminated pyrite.	D73065	194.00	195.50	1.50				
195.50	197.00	1% disseminated pyrite.	D73066	195.50	197.00	1.50				
197.00	198.50	1% disseminated pyrite.	D73067	197.00	198.50	1.50				
198.50	200.00	1 to 5% pyrite.	D73068	198.50	200.00	1.50				
200.00	209.60	Highly sericitic, slightly chloritic, highly sheared zone with 5 to 10% fine to blebby pyrite, minor chalcopyrite. 10% small quartz eyes.								
200.00	201.00	5 to 10% fine blebby pyrite. Chalcopyrite, pyrite, carbonate-quartz stringer.	D73069	200.00	201.00	1.00				
201.00	202.00	5 to 10% blebby pyrite.	D73070	201.00	202.00	1.00				
202.00	203.00	10% blebby pyrite crudely aligned parallel with plane of shear.	D73071	202.00	203.00	1.00				
203.00	204.00	5 to 10% blebby pyrite.	D73072	203.00	204.00	1.00				
204.00	205.00	5% blebby pyrite.	D73073	204.00	205.00	1.00				
205.00	206.00	5 to 10% blebby pyrite.	D73074	205.00	206.00	1.00				
206.00	207.00	5% blebby pyrite.	D73075	206.00	207.00	1.00				
207.00	208.00	5% blebby pyrite.	D73076	207.00	208.00	1.00				
208.00	209.00	5 to 10% blebby pyrite.	D73077	208.00	209.00	1.00				
209.00	209.60	5 to 10% blebby pyrite.	D73078	209.00	209.60	.60				
209.60	251.00	Similar to 146 to 200. 5% epidote blebs from 227 to 266. Tuffaceous sections.								
209.60	210.82	1 to 5% pyrite.	D73079	209.60	210.82	1.22				
210.82	212.00	1 to 5% pyrite.	D73080	210.82	212.00	1.18				
212.00	213.50	Highly chloritic. 1% pyrite. Tuff (?).	D73081	212.00	213.50	1.50				
213.50	215.00	Highly chloritic. 1% pyrite. Thin chalcopyrite, pyrite, quartz-carbonate stringer. Tuff (?).	D73082	213.50	215.00	1.50				
215.00	216.50	1% disseminated pyrite.	D73083	215.00	216.50	1.50				
216.50	218.00	1% disseminated pyrite.	D73084	216.50	218.00	1.50				
218.00	219.50	1% disseminated pyrite.	D73085	218.00	219.50	1.50				
219.50	221.00	1% disseminated pyrite.	D73086	219.50	221.00	1.50				
221.00	222.50	1% disseminated pyrite.	D73087	221.00	222.50	1.50				
222.50	224.00	1% disseminated pyrite.	D73088	222.50	224.00	1.50				

PLACER DOME INC.
DIAMOND DRILL RECORD

HOLE NO: 246-052
PAGE NO: 6

FROM	TO	-----DESCRIPTION-----	SAMPLE	FROM	TO	LENGTH	Au g/t	RERUN	REJECT	AVERAGE
224.00	225.50	1% disseminated pyrite.	D73089	224.00	225.50	1.50				
225.50	227.00	1% disseminated pyrite.	D73090	225.50	227.00	1.50				
227.00	228.50	1% disseminated pyrite.	D73091	227.00	228.50	1.50				
228.50	230.00	1% disseminated pyrite.	D73092	228.50	230.00	1.50				
230.00	231.50	1% disseminated pyrite.	D73093	230.00	231.50	1.50				
231.50	233.00	1% disseminated pyrite.	D73094	231.50	233.00	1.50				
233.00	234.50	1% disseminated pyrite.	D73095	233.00	234.50	1.50				
234.50	236.00	1% disseminated pyrite.	D73096	234.50	236.00	1.50				
236.00	237.50	1% disseminated pyrite.	D73097	236.00	237.50	1.50				
237.50	239.00	1% disseminated pyrite.	D73098	237.50	239.00	1.50				
239.00	240.50	1% disseminated pyrite.	D73099	239.00	240.50	1.50				
240.50	242.00	1% disseminated pyrite.	D73100	240.50	242.00	1.50				
242.00	243.50	1% disseminated pyrite.	D73101	242.00	243.50	1.50				
243.50	245.00	1% disseminated pyrite.	D73102	243.50	245.00	1.50				
245.00	246.50	1% disseminated pyrite.	D73103	245.00	246.50	1.50				
246.50	248.00	1% disseminated pyrite.	D73104	246.50	248.00	1.50				
248.00	249.13	1% disseminated pyrite.	D73105	248.00	249.13	1.13				
249.13	249.48	60% dark grey irregular quartz. Minor pyrite.	D73106	249.13	249.48	.35				
249.48	251.00	1% disseminated pyrite.	D73107	249.48	251.00	1.52				
251.00	266.00	Intercalations of sediment.								
264.12	264.58	30% massive quartz-carbonate veining.	D73108	264.12	264.58	.46				

266.00 END OF HOLE

CORE STORED AT DOME MINES, SOUTH PORCUPINE, ONTARIO.

ALL CASING LEFT IN HOLE.

HOLE CAPPED.

DRILLING BY BRADLEY BROS. DRILLING, TIMMINS, ONTARIO.

Brian Cole

PLACER DOME INC.

REF COR: 210.0 -550.0 SURVEYED: NO

DIAMOND DRILL RECORD

HOLE NO: 246-053

LOCATION: 2+10N 5+50W GRID: SOUTH

PROPERTY: PROJECT 246
BRISTOL TWP, ONTARIO

POST LOCATION: 190m N & 250m E to POST 1, CLAIM P997466

SECTION:

AZIMUTH: 180.0

LENGTH: 271.0

ELEVATION: .0

LOGGED BY: B. COLE

DIP: -50.0

CORE SIZE: BQ

SYSTEM OF MEASURE: METRIC

DATE LOGGED: MAY 12-14, 1988

STARTED: MAY 10, 1988

COMPLETED: MAY 13, 1988

CLAIM NO: P 997466

DIP TESTS (corrected)

DEPTH	AZIMUTH	DIP	DEPTH	AZIMUTH	DIP
42.00	178	-51.0	269.00	169	-38.5
152.00	169	-44.0			

FROM TO -----DESCRIPTION----- SAMPLE FROM TO LENGTH Au g/t RERUN REJECT AVERAGE

.00 36.20 CASING AND OVERBURDEN

36.20 104.70 PROPYLITIZED FELDSPAR PORPHYRY

Grey green. Highly sheared at 55 degrees to the core axis.
Slightly to moderately chloritic. Some albitic (?)
alteration. Abundant carbonate. Minor to 1% pyrite.

36.20 37.36 From BW casing.

Some light orange, highly sericitic sections.

37.36 38.72 1% pyrite.
38.72 40.00 1% pyrite.
40.00 41.50 1% pyrite.
41.50 43.00 1% pyrite.
43.00 44.50 1% pyrite.

D73109	37.36	38.72	1.36
D73110	38.72	40.00	1.28
D73111	40.00	41.50	1.50
D73112	41.50	43.00	1.50
D73113	43.00	44.50	1.50

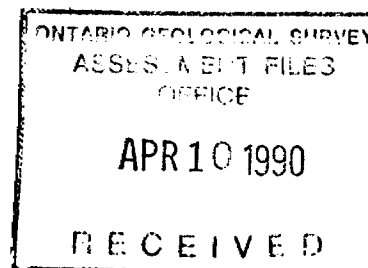

PLACER DOME INC.
DIAMOND DRILL RECORD

HOLE NO: 246-053

PAGE NO: 2

FROM	TO	-----DESCRIPTION-----	SAMPLE	FROM	TO	LENGTH	AU g/t	RERUN	REJECT	AVERAGE
44.50	46.00	1% pyrite.	D73114	44.50	46.00	1.50				
46.00	47.50	1% pyrite.	D73115	46.00	47.50	1.50				
47.50	49.00	1% pyrite.	D73116	47.50	49.00	1.50				
49.00	50.50	1% pyrite.	D73117	49.00	50.50	1.50				
50.50	52.00	1% pyrite.	D73118	50.50	52.00	1.50				
52.00	53.50	1% pyrite.	D73119	52.00	53.50	1.50				
53.50	55.00	1% pyrite.	D73120	53.50	55.00	1.50				
55.00	56.50	1% pyrite.	D73121	55.00	56.50	1.50				
56.50	58.00	1% pyrite.	D73122	56.50	58.00	1.50				
58.00	59.49	1% pyrite.	D73123	58.00	59.49	1.49				
59.49	61.00	1% pyrite.	D73124	59.49	61.00	1.51				
61.00	62.50	1 to 5% pyrite.	D73125	61.00	62.50	1.50				
62.50	64.00	1% pyrite.	D73126	62.50	64.00	1.50				
64.00	65.50	1% pyrite.	D73127	64.00	65.50	1.50				
65.50	67.00	1% pyrite.	D73128	65.50	67.00	1.50				
67.00	68.50	1% pyrite.	D73129	67.00	68.50	1.50				
68.50	70.00	1% pyrite.	D73130	68.50	70.00	1.50				
70.00	71.50	1% pyrite.	D73131	70.00	71.50	1.50				
71.50	73.00	1% pyrite.	D73132	71.50	73.00	1.50				
73.00	74.50	1% pyrite.	D73133	73.00	74.50	1.50				
74.50	76.00	1% pyrite.	D73134	74.50	76.00	1.50				
76.00	104.70	Transition between propylitic and bleached zones. Some hematite - gypsum alteration.								
76.00	77.50	1% pyrite.	D73135	76.00	77.50	1.50				
77.50	79.00	1% pyrite.	D73136	77.50	79.00	1.50				
79.00	80.50	1% pyrite.	D73137	79.00	80.50	1.50				
80.50	82.00	1% pyrite.	D73138	80.50	82.00	1.50				
82.00	83.50	1% pyrite.	D73139	82.00	83.50	1.50				
83.50	85.00	1% pyrite.	D73140	83.50	85.00	1.50				
85.00	86.50	1% pyrite.	D73141	85.00	86.50	1.50				
86.50	88.00	1% pyrite.	D73142	86.50	88.00	1.50				
88.00	89.50	1% pyrite.	D73143	88.00	89.50	1.50				
89.50	91.00	1% pyrite.	D73144	89.50	91.00	1.50				
91.00	92.50	1% pyrite.	D73145	91.00	92.50	1.50				
92.50	94.00	1% pyrite.	D73146	92.50	94.00	1.50				
94.00	95.50	1% pyrite.	D73147	94.00	95.50	1.50				
95.50	97.00	1% pyrite. Slightly silicified locally.	D73148	95.50	97.00	1.50				

PLACER DOME INC.
DIAMOND DRILL RECORD

HOLE NO: 246-053
PAGE NO: 3

FROM	TO	-----DESCRIPTION-----	SAMPLE	FROM	TO	LENGTH	Au g/t	RERUN	REJECT	AVERAGE
97.00	98.50	1% pyrite. Slightly silicified locally.	D73149	97.00	98.50	1.50				
98.50	100.00	1% pyrite. Slightly silicified locally.	D73150	98.50	100.00	1.50				
100.00	101.50	1% pyrite. Slightly silicified locally.	D73151	100.00	101.50	1.50				
101.50	103.00	1 to 5% pyrite. Slightly silicified locally.	D73152	101.50	103.00	1.50				
103.00	104.70	1 to 5% pyrite. Slightly silicified locally. Blocky. Some grind.	D73153	103.00	104.70	1.70				
104.70	113.69	PROPYLITIZED MAFIC - INTERMEDIATE LAPILLI-TUFF Green grey. Highly sheared at 50 to 65 degrees. Chloritic. Abundant carbonate. 20% lapilli-tuff sized clasts altered to carbonate and quartz. 1 to 5% pyrite.								
104.70	105.81	1% pyrite. Blocky.	D73154	104.70	105.81	1.11				
105.81	106.58	5% blebby pyrite. Blocky.	D73155	105.81	106.58	.77				
106.58	108.10	1 to 5% pyrite. Quite blocky.	D73156	106.58	108.10	1.52				
108.10	109.00	5% blebby pyrite.	D73157	108.10	109.00	.90				
109.00	110.50	1% pyrite.	D73158	109.00	110.50	1.50				
110.50	112.00	1% pyrite.	D73159	110.50	112.00	1.50				
112.00	113.69	1% pyrite.	D73160	112.00	113.69	1.69				
113.69	127.00	PROPYLITIZED FELDSPAR PORPHYRY Green green. Transition between propylitic and bleached zones. Slightly chloritic with sericitic portions. Highly sheared at 70 degrees.								
113.69	115.00	1% pyrite.	D73161	113.69	115.00	1.31				
115.00	116.50	1% pyrite.	D73162	115.00	116.50	1.50				
116.50	118.00	1% pyrite.	D73163	116.50	118.00	1.50				
118.00	119.50	1% pyrite.	D73164	118.00	119.50	1.50				
119.50	121.00	1% pyrite.	D73165	119.50	121.00	1.50				
121.00	122.50	1% pyrite.	D73166	121.00	122.50	1.50				
122.50	124.00	1% pyrite.	D73167	122.50	124.00	1.50				
124.00	125.50	1% pyrite.	D73168	124.00	125.50	1.50				
125.50	127.00	1% pyrite.	D73169	125.50	127.00	1.50				

PLACER DOME INC.
DIAMOND DRILL RECORD

HOLE NO: 246-053
PAGE NO: 5

FROM	TO	-----DESCRIPTION-----	SAMPLE	FROM	TO	LENGTH	Au g/t	RERUN	REJECT	AVERAGE
	143.65	144.50	1% pyrite.	D73182	143.65	144.50	.85			
	144.50	145.42	1% pyrite.	D73183	144.50	145.42	.92			
145.42	154.47	PROPYLITIZED MAFIC - INTERMEDIATE LAPILLI-TUFF Similar to 127 to 138. Grey green. Generally chloritic and sericitic with light bleached portions. Highly to extremely sheared. Some portions highly schistose. 1 to 5% pyrite, trace chalcopyrite.								
	145.42	146.67	1% finely disseminated pyrite.	D73184	145.42	146.67	1.25			
	146.67	148.00	2% finely disseminated pyrite.	D73185	146.67	148.00	1.33			
	148.00	149.50	1% finely disseminated pyrite.	D73186	148.00	149.50	1.50			
	149.50	151.00	1% finely disseminated pyrite. Highly schistose.	D73187	149.50	151.00	1.50			
	151.00	152.30	1% finely disseminated pyrite. Highly schistose.	D73188	151.00	152.30	1.30			
	152.30	153.57	1 to 5% fine pyrite, trace chalcopyrite. Highly schistose.	D73189	152.30	153.57	1.27			
	153.57	154.47	1 to 5% fine pyrite. Extremely schistose.	D73190	153.57	154.47	.90			
154.47	170.22	BLEACHED MAFIC - INTERMEDIATE LAPILLI-TUFF Grey. Highly to extremely sheared at 75 degrees. Moderately to highly schistose. Primarily of sericite and carbonate with interstitial quartz. 20% lapilli-tuff - sized clasts altered to quartz and carbonate. 1% fine disseminated pyrite.								
	154.57	155.36	1% pyrite.	D73191	154.57	155.36	.79			
	155.36	157.00	1% finely disseminated pyrite. Slightly hematized.	D73192	155.36	157.00	1.64			
	157.00	158.04	1% finely disseminated pyrite.	D73193	157.00	158.04	1.04			
	158.04	159.23	1% finely disseminated pyrite.	D73194	158.04	159.23	1.19			
	159.23	160.34	1% finely disseminated pyrite.	D73195	159.23	160.34	1.11			
	160.34	161.66	Moderately to highly chloritic, propylitic							

PLACER DOME INC.
DIAMOND DRILL RECORD

HOLE NO: 246-053
PAGE NO: 6

FROM	TO	-----DESCRIPTION-----	SAMPLE	FROM	TO	LENGTH	Au g/t	RERUN	REJECT	AVERAGE
		zone. 1% pyrite.								
160.34	161.66	Propylitic zone. 1% pyrite.	D73196	160.34	161.66	1.32				
161.66	162.42	1% finely disseminated pyrite.	D73197	161.66	162.42	.76				
162.42	163.28	SERICITE CARBONATE QUARTZ ZONE; 10 to 15% pyrite, minor chalcopyrite.								
162.42	163.28	Predominantly grey quartz ramified by fine carbonate stringers. Some sericite. 10 to 15% fine to blebby and stringer pyrite, some chalcopyrite stringers locally.	D73198	162.42	163.28	.86				
163.28	170.22	Wholesale alteration to carbonate and quartz.								
163.28	164.30	5 to 10% finely disseminated, blebby, and stringer pyrite. Quartz tourmaline veinlet.	D73199	163.28	164.30	1.02				
164.30	166.00	Extremely carbonatized. 1% finely disseminated pyrite. 20 cm wide highly sheared felsic dike.	D73200	164.30	166.00	1.70				
166.00	167.50	Extremely carbonatized. 1% finely disseminated pyrite.	D73201	166.00	167.50	1.50				
167.50	168.70	Extremely carbonatized. 1% finely disseminated pyrite.	D73202	167.50	168.70	1.20				
168.70	170.22	Extremely carbonatized. 1% finely disseminated pyrite.	D73203	168.70	170.22	1.52				
170.22	226.00	SILICIFIED FELDSPAR PORPHYRY Grey to green grey. Slightly to moderately silicified. Highly sheared at 65 degrees. Sericitic along shear planes. Weakly chloritic locally. Some epidote blebs locally. 1% disseminated pyrite generally, some small blebs and thin discontinuous stringers locally.								
170.22	171.39	1% pyrite.	D73204	170.22	171.39	1.17				
171.39	172.00	1% pyrite.	D73205	171.39	172.00	.61				
172.00	173.50	1% pyrite.	D73206	172.00	173.50	1.50				
173.50	175.00	1% pyrite.	D73207	173.50	175.00	1.50				
175.00	176.50	1% pyrite.	D73208	175.00	176.50	1.50				
176.50	178.00	1% pyrite.	D73209	176.50	178.00	1.50				

PLACER DOME INC.
DIAMOND DRILL RECORD

HOLE NO: 246-053
PAGE NO: 7

FROM	TO	-----DESCRIPTION-----	SAMPLE	FROM	TO	LENGTH	Au g/t	RERUN	REJECT	AVERAGE
178.00	179.50	1% pyrite.	D73210	178.00	179.50	1.50				
179.50	181.00	1% pyrite.	D73211	179.50	181.00	1.50				
181.00	182.50	1% pyrite.	D73212	181.00	182.50	1.50				
182.50	184.00	1% pyrite.	D73213	182.50	184.00	1.50				
184.00	185.50	1% pyrite.	D73214	184.00	185.50	1.50				
185.50	187.00	1% pyrite.	D73215	185.50	187.00	1.50				
187.00	188.50	1% pyrite.	D73216	187.00	188.50	1.50				
188.50	190.00	1% pyrite.	D73217	188.50	190.00	1.50				
190.00	191.50	1% pyrite.	D73218	190.00	191.50	1.50				
191.50	193.00	1% pyrite.	D73219	191.50	193.00	1.50				
193.00	194.50	1% pyrite.	D73220	193.00	194.50	1.50				
194.50	196.00	1% pyrite.	D73221	194.50	196.00	1.50				
196.00	197.50	1% pyrite.	D73222	196.00	197.50	1.50				
197.50	199.00	1% pyrite.	D73223	197.50	199.00	1.50				
199.00	200.50	1% pyrite.	D73224	199.00	200.50	1.50				
200.50	202.00	1% pyrite.	D73225	200.50	202.00	1.50				
202.00	203.50	1% pyrite.	D73226	202.00	203.50	1.50				
203.50	205.00	1% pyrite.	D73227	203.50	205.00	1.50				
205.00	206.50	1% pyrite.	D73228	205.00	206.50	1.50				
206.50	208.00	1% pyrite.	D73229	206.50	208.00	1.50				
208.00	209.50	1% pyrite.	D73230	208.00	209.50	1.50				
209.50	211.00	1% pyrite. 15% blebby pyrite portions locally	D73231	209.50	211.00	1.50				
211.00	212.50	1% pyrite.	D73232	211.00	212.50	1.50				
212.50	214.00	1% pyrite.	D73233	212.50	214.00	1.50				
214.00	215.50	1 to 5% pyrite.	D73234	214.00	215.50	1.50				
215.50	217.00	1 to 5% fine blebby pyrite.	D73235	215.50	217.00	1.50				
217.00	218.50	1 to 5% pyrite.	D73236	217.00	218.50	1.50				
218.50	220.00	1 to 5% pyrite.	D73237	218.50	220.00	1.50				
220.00	224.50	5 to 10% fine to coarse blebby pyrite crudely aligned parallel with plane of shear. Minor chalcopyrite. In highly sheared, silicified porphyry.								
220.00	221.50	5 to 10% fine to coarse blebby pyrite crudely aligned parallel with plane of shear. Minor chalcopyrite.	D73238	220.00	221.50	1.50				
221.50	223.00	Similar to 220 to 221.	D73239	221.50	223.00	1.50				
223.00	224.50	Similar to 220 to 221.	D73240	223.00	224.50	1.50				

PLACER DOME INC.
DIAMOND DRILL RECORD

HOLE NO: 246-053
PAGE NO: 8

FROM	TO	-----DESCRIPTION-----	SAMPLE	FROM	TO	LENGTH	Au g/t	RERUN	REJECT	AVERAGE
224.50	226.00	1 to 5% blebby pyrite.	D73241	224.50	226.00	1.50				
226.00	263.50	PROPYLITIZED QUARTZ FELDSPAR PORPHYRY Grey green. Slightly silicified. Gradual transition from silicified zone above. Highly sheared at 75 degrees. 5% small black quartz eyes, possibly phenocrysts. Slightly chloritic. Moderately sericitic. 1 to 5% fine pyrite generally.								
226.00	227.50	1 to 5% fine pyrite.	D73242	226.00	227.50	1.50				
227.50	229.00	1 to 5% fine pyrite.	D73243	227.50	229.00	1.50				
229.00	235.00	Highly carbonatized. 5 to 10% fine to coarse blebby pyrite crudely aligned parallel with the plane of shear.								
229.00	230.50	Highly carbonatized. 5 to 10% fine to coarse blebby pyrite crudely aligned parallel with plane of shearing.	D73244	229.00	230.50	1.50				
230.50	232.00	Similar to 229 to 230.	D73245	230.50	232.00	1.50				
232.00	233.50	Similar to 229 to 230.	D73246	232.00	233.50	1.50				
233.50	235.00	Similar to 229 to 230.	D73247	233.50	235.00	1.50				
235.00	236.50	1 to 5% blebby pyrite.	D73248	235.00	236.50	1.50				
236.50	238.00	1 to 5% blebby pyrite.	D73249	236.50	238.00	1.50				
238.00	239.50	1% pyrite.	D73250	238.00	239.50	1.50				
239.50	241.00	1% pyrite.	D73251	239.50	241.00	1.50				
241.00	242.50	1% pyrite.	D73252	241.00	242.50	1.50				
242.50	244.00	1% pyrite.	D73253	242.50	244.00	1.50				
244.00	245.50	1 to 5% pyrite.	D73254	244.00	245.50	1.50				
245.50	247.00	1 to 5% pyrite.	D73255	245.50	247.00	1.50				
247.00	248.50	1% pyrite.	D73256	247.00	248.50	1.50				
248.50	250.00	1% pyrite.	D73257	248.50	250.00	1.50				
250.00	251.50	1 to 5% pyrite.	D73258	250.00	251.50	1.50				
251.50	253.00	1% pyrite.	D73259	251.50	253.00	1.50				
253.00	254.50	1% pyrite.	D73260	253.00	254.50	1.50				
254.50	256.00	1% pyrite.	D73261	254.50	256.00	1.50				
256.00	257.50	1 to 5% pyrite. Chalcopyrite stringer.	D73262	256.00	257.50	1.50				
257.50	259.00	1% pyrite.	D73263	257.50	259.00	1.50				

PLACER DOME INC.
DIAMOND DRILL RECORD

HOLE NO: 246-053

PAGE NO: 9

FROM	TO	-----DESCRIPTION-----	SAMPLE	FROM	TO	LENGTH	Au g/t	RERUN	REJECT	AVERAGE
259.00	260.50	1% pyrite.	D73264	259.00	260.50	1.50				
260.50	262.00	1% pyrite.	D73265	260.50	262.00	1.50				
262.00	263.50	1% pyrite.	D73266	262.00	263.50	1.50				

263.50 271.00 QUARTZ FELDSPAR PORPHYRY
Light orange grey. Highly sheared at 70 degrees. Primarily
of feldspar, sericite, and 5% small quartz phenocrysts.
Minor to 1% finely disseminated pyrite.

264.13 267.10 Brecciated. Slightly hematized. Some
carbonate veins. Blocky.

271.00 END OF HOLE

CORE STORED AT DOME MINES, SOUTH PORCUPINE, ONTARIO.

NW CASING DRIVEN TO BEDROCK AND LEFT IN HOLE. BW CASING
PULLED.

HOLE CAPPED.

DRILLING BY BRADLEY BROS. DRILLING, TIMMINS, ONTARIO.



PLACER DOME INC.

REF CORD: 210.0 -500.0 SURVEYED: NO

DIAMOND DRILL RECORD

HOLE NO: 246-054

LOCATION: 2+10N 5+00W GRID: SOUTH

PROPERTY: PROJECT 246
BRISTOL TWP, ONTARIO

POST LOCATION: 190m N & 200m E to POST 1, CLAIM P997466

SECTION:

AZIMUTH: 180.0

LENGTH: 227.0

ELEVATION: .0

LOGGED BY: B. COLE

DIP: -55.0

CORE SIZE: BQ

SYSTEM OF MEASURE: METRIC

DATE LOGGED: MAY 17-18, 1988

STARTED: MAY 13, 1988

COMPLETED: MAY 17, 1988

CLAIM NO: P 997466

DIP TESTS (corrected)

DEPTH	AZIMUTH	DIP	DEPTH	AZIMUTH	DIP
42.00	188	-56.0	225.00	170	-43.5
126.00	173	-48.5			

FROM TO -----DESCRIPTION----- SAMPLE FROM TO LENGTH Au g/t RERUN REJECT AVERAGE

.00 37.00 CASING AND OVERBURDEN

37.00 107.40 QUARTZ FELDSPAR PORPHYRY

Light orange. Moderately sheared at 50 degrees to the core axis. Quite feldspathic. Sericitic along shear planes. 5% quartz, 15% feldspar phenocrysts in fine grained, sheared groundmass. Weak albitic alteration (?). Some weakly propylitic sections. Blocky portions locally. Minor disseminated pyrite.

60.40 65.06 Weakly propylitic. 5% fine disseminated pyrite. Generally blocky.

60.40 61.24 Weakly propylitic. 5% fine disseminated pyrite. Generally blocky. D73267 60.40 61.24 .84

61.24 62.67 Similar to 60 to 61. D73268 61.24 62.67 1.43

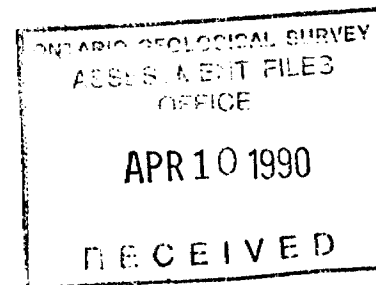

PLACER DOME INC.
DIAMOND DRILL RECORD

HOLE NO: 246-054
PAGE NO: 2

FROM	TO	-----DESCRIPTION-----	SAMPLE	FROM	TO	LENGTH	Au g/t	RERUN	REJECT	AVERAGE
62.67	64.20	Similar to 60 to 61. 20 cm wide massive quartz vein.	D73269	62.67	64.20	1.53				
64.20	65.06	Similar to 60 to 61.	D73270	64.20	65.06	.86				
70.30	75.88	Weakly propylitic. 1% disseminated pyrite. Generally blocky.								
70.30	71.60	Weakly propylitic. 1% disseminated pyrite. Generally blocky.	D73271	70.30	71.60	1.30				
71.60	72.50	Similar to 70 to 71.	D73272	71.60	72.50	.90				
72.50	74.00	Similar to 70 to 71.	D73273	72.50	74.00	1.50				
74.00	75.88	Similar to 70 to 71.	D73274	74.00	75.88	1.88				
107.40	144.50	SILICIFIED QUARTZ FELDSPAR PORPHYRY Light grey to very light orange. Moderately to highly silicified sheared porphyry. Minor pyrite. Sericitic along shear planes.								
107.40	108.50	Minor pyrite.	D73275	107.40	108.50	1.10				
108.50	110.00	Minor pyrite.	D73276	108.50	110.00	1.50				
110.00	111.50	Minor pyrite.	D73277	110.00	111.50	1.50				
111.50	113.00	Minor pyrite.	D73278	111.50	113.00	1.50				
113.00	114.50	Minor pyrite.	D73279	113.00	114.50	1.50				
114.50	116.00	Minor pyrite.	D73280	114.50	116.00	1.50				
116.00	117.50	Minor pyrite.	D73281	116.00	117.50	1.50				
117.50	119.00	Minor pyrite.	D73282	117.50	119.00	1.50				
119.00	120.50	Minor pyrite.	D73283	119.00	120.50	1.50				
120.50	122.00	Minor pyrite.	D73284	120.50	122.00	1.50				
122.00	123.50	Minor pyrite.	D73285	122.00	123.50	1.50				
123.50	125.00	Minor pyrite.	D73286	123.50	125.00	1.50				
125.00	126.50	Minor pyrite.	D73287	125.00	126.50	1.50				
126.50	128.00	Minor pyrite.	D73288	126.50	128.00	1.50				
128.00	129.50	Minor pyrite.	D73289	128.00	129.50	1.50				
129.50	131.00	Minor pyrite. Very thin stringer of chalcopyrite.	D73290	129.50	131.00	1.50				
131.00	132.50	Minor pyrite.	D73291	131.00	132.50	1.50				
132.50	134.00	1% finely disseminated pyrite.	D73292	132.50	134.00	1.50				

PLACER DOME INC.
DIAMOND DRILL RECORD

HOLE NO: 246-054

PAGE NO: 3

FROM	TO	-----DESCRIPTION-----	SAMPLE	FROM	TO	LENGTH	AU g/t	RERUN	REJECT	AVERAGE
	134.00	135.50	Minor pyrite.	D73293	134.00	135.50	1.50			
	135.50	137.00	1 to 5% fine disseminated pyrite.	D73294	135.50	137.00	1.50			
	137.00	138.50	1% disseminated pyrite.	D73295	137.00	138.50	1.50			
	138.50	140.00	1% disseminated pyrite.	D73296	138.50	140.00	1.50			
	140.00	141.50	1% disseminated pyrite.	D73297	140.00	141.50	1.50			
	141.50	143.00	1% disseminated pyrite. Very thin stringer of chalcopyrite. Very weakly silicified.	D73298	141.50	143.00	1.50			
	143.00	144.50	1% disseminated pyrite. Very weakly silicified.	D73299	143.00	144.50	1.50			
144.50	156.26	PROPYLITIZED MAFIC - INTERMEDIATE LAPILLI-TUFF Green. Moderately to highly chloritic. Highly sheared at 70 degrees. Rare quartz-carbonate clast ?. Very weakly silicified. 1% disseminated pyrite. Minor chalcopyrite stringer.								
	144.50	146.00	1% disseminated pyrite.	D73300	144.50	146.00	1.50			
	146.00	147.50	1% disseminated pyrite.	D73301	146.00	147.50	1.50			
	147.50	149.00	1% disseminated pyrite.	D73302	147.50	149.00	1.50			
	149.00	150.50	1% disseminated pyrite.	D73303	149.00	150.50	1.50			
	150.50	152.00	1% disseminated pyrite.	D73304	150.50	152.00	1.50			
	152.00	153.50	1% disseminated pyrite. Very thin stringer of chalcopyrite.	D73305	152.00	153.50	1.50			
	153.50	155.00	1% disseminated pyrite.	D73306	153.50	155.00	1.50			
	155.00	156.26	1% disseminated pyrite.	D73307	155.00	156.26	1.26			
156.26	192.64	BLEACHED MAFIC - INTERMEDIATE LAPILLI-TUFF Light green grey. Moderately to highly silicified in part. Highly sheared at 75 degrees. 15% lapilli-tuff - sized clasts altered to carbonate and quartz. Sericitic along shear planes. 1 to 5% disseminated pyrite.								
	156.26	157.00	Highly silicified. 1% finely disseminated pyrite.	D73308	156.26	157.00	.74			
	157.00	158.00	Moderately silicified. 1% disseminated pyrite. Some carbonate-quartz veining with tourmaline.	D73309	157.00	158.00	1.00			

PLACER DOME INC.
DIAMOND DRILL RECORD

HOLE NO: 246-054
PAGE NO: 4

FROM	TO	-----DESCRIPTION-----	SAMPLE	FROM	TO	LENGTH	Au g/t	RERUN	REJECT	AVERAGE
158.00	159.00	Highly silicified. 5% finely disseminated pyrite.	D73310	158.00	159.00	1.00				
159.00	160.00	Highly silicified. 5 to 10% fine to blebby pyrite.	D73311	159.00	160.00	1.00				
160.00	161.00	Highly silicified 5% fine blebby pyrite.	D73312	160.00	161.00	1.00				
161.00	162.00	1 to 5% disseminated pyrite.	D73313	161.00	162.00	1.00				
162.00	163.00	1 to 5% disseminated pyrite.	D73314	162.00	163.00	1.00				
163.00	164.00	1 to 5% disseminated pyrite.	D73315	163.00	164.00	1.00				
164.00	165.50	1 to 5% disseminated pyrite.	D73316	164.00	165.50	1.50				
165.50	167.00	1 to 5% disseminated pyrite.	D73317	165.50	167.00	1.50				
167.00	168.50	1 to 5% disseminated pyrite.	D73318	167.00	168.50	1.50				
168.50	170.00	1 to 5% disseminated pyrite.	D73319	168.50	170.00	1.50				
170.00	170.88	1 to 5% disseminated pyrite.	D73320	170.00	170.88	.88				
170.88	177.00	SERICITE QUARTZ CARBONATE ZONE; extremely altered to blebby blue quartz and carbonate, with sericite along shear planes. 1 to 5% fine blebby pyrite.								
170.88	171.95	Sericite carbonate quartz zone. 1 to 5% fine blebby pyrite.	D73321	170.88	171.95	1.07				
171.95	173.00	Similar to 170 to 171.	D73322	171.95	173.00	1.05				
173.00	174.00	Similar to 170 to 171.	D73323	173.00	174.00	1.00				
174.00	175.00	Similar to 170 to 171.	D73324	174.00	175.00	1.00				
175.00	176.00	Similar to 170 to 171.	D73325	175.00	176.00	1.00				
176.00	177.00	Similar to 170 to 171.	D73326	176.00	177.00	1.00				
177.00	178.00	1 to 5% fine pyrite.	D73327	177.00	178.00	1.00				
178.00	179.00	1 to 5% fine pyrite.	D73328	178.00	179.00	1.00				
179.00	180.50	1 to 5% fine pyrite.	D73329	179.00	180.50	1.50				
180.50	182.00	1 to 5% fine pyrite.	D73330	180.50	182.00	1.50				
182.00	183.50	1 to 5% fine pyrite.	D73331	182.00	183.50	1.50				
183.50	185.00	1 to 5% fine pyrite.	D73332	183.50	185.00	1.50				
185.00	186.50	1 to 5% fine pyrite.	D73333	185.00	186.50	1.50				
186.50	188.00	1 to 5% fine pyrite.	D73334	186.50	188.00	1.50				
188.00	189.50	Slightly propylitic. 1 to 5% pyrite. Several small localized blebs of chalcopyrite.	D73335	188.00	189.50	1.50				
189.50	191.00	Slightly propylitic. 1 to 5% pyrite.	D73336	189.50	191.00	1.50				
191.00	191.92	Slightly propylitic. 1 to 5% pyrite. 2 cm wide quartz-carbonate pyrite veinlet.	D73337	191.00	191.92	.92				
191.92	192.64	Slightly propylitic. 1 to 5% pyrite.	D73338	191.92	192.64	.72				

PLACER DOME INC.
DIAMOND DRILL RECORD

HOLE NO: 246-054
PAGE NO: 5

FROM	TO	-----DESCRIPTION-----	SAMPLE	FROM	TO	LENGTH	Au g/t	RERUN	REJECT	AVERAGE
192.64	227.00	PROPYLITIZED MAFIC - INTERMEDIATE LAPILLI-TUFF Green to light green. Highly to slightly chloritic. Silicified locally. Abundant carbonate. 1 to 5% pyrite. Some kinking in foliation.								
192.64	201.50	Highly chloritic at upper contact, gradually diminishing chlorite content with depth.								
192.64	194.00	Highly chloritic. 1 to 5% pyrite.	D73339	192.64	194.00	1.36				
194.00	195.50	Highly chloritic. 1 to 5% pyrite.	D73340	194.00	195.50	1.50				
195.50	197.00	Moderately chloritic. 1% pyrite.	D73341	195.50	197.00	1.50				
197.00	198.50	Slightly chloritic. 1% pyrite.	D73342	197.00	198.50	1.50				
198.50	200.00	Slightly chloritic. 1% pyrite.	D73343	198.50	200.00	1.50				
200.00	201.50	slightly chloritic. 1% pyrite. Localized stringer of pyrite, chalcopyrite.	D73344	200.00	201.50	1.50				
201.50	227.00	Slightly chloritic. Slightly to moderately carbonatized.								
201.50	203.00	1% pyrite.	D73345	201.50	203.00	1.50				
203.00	204.50	1% pyrite.	D73346	203.00	204.50	1.50				
204.50	206.00	1% pyrite.	D73347	204.50	206.00	1.50				
206.00	207.50	1% pyrite.	D73348	206.00	207.50	1.50				
207.50	209.00	1% pyrite.	D73349	207.50	209.00	1.50				
209.00	210.50	1% pyrite.	D73350	209.00	210.50	1.50				
210.50	212.00	1% pyrite.	D73351	210.50	212.00	1.50				
212.00	213.50	1% pyrite.	D73352	212.00	213.50	1.50				
213.50	215.00	1% pyrite.	D73353	213.50	215.00	1.50				
215.00	216.50	1% pyrite.	D73354	215.00	216.50	1.50				
216.50	218.00	1% pyrite.	D73355	216.50	218.00	1.50				
218.00	219.50	1% pyrite.	D73356	218.00	219.50	1.50				
219.50	221.00	1% pyrite.	D73357	219.50	221.00	1.50				
221.00	222.50	1% pyrite. Silicified locally.	D73358	221.00	222.50	1.50				
222.50	224.00	1% pyrite. Silicified locally.	D73359	222.50	224.00	1.50				
224.00	225.50	1% pyrite. Silicified locally.	D73360	224.00	225.50	1.50				
225.50	227.00	1% pyrite. Silicified locally.	D73361	225.50	227.00	1.50				

PLACER DOME INC.
DIAMOND DRILL RECORD

HOLE NO: 246-054
PAGE NO: 6

FROM	TO	-----DESCRIPTION-----	SAMPLE	FROM	TO	LENGTH	Au g/t	RERUN	REJECT	AVERAGE
227.00		END OF HOLE								

CORE STORED AT DOME MINES, SOUTH PORCUPINE, ONTARIO.

NW CASING DRIVEN TO BEDROCK AND LEFT IN HOLE. BW CASING
PULLED.

HOLE CAPPED.

DRILLING BY BRADLEY BROS. DRILLING, TIMMINS, ONTARIO.

Bradley Bros

PLACER DOME INC.

REF CORD: 215.0 -450.0 SURVEYED: NO

DIAMOND DRILL RECORD

HOLE NO: 246-056

LOCATION: 2+15N 4+50W GRID: SOUTH

PROPERTY: PROJECT 246
BRISTOL TWP, ONTARIO

POST LOCATION: 185m N & 150m E to POST 1, CLAIM P997466

SECTION:

AZIMUTH: 180.0

LENGTH: 226.0

ELEVATION: .0

LOGGED BY: B. COLE

DIP: -50.0

CORE SIZE: BQ

SYSTEM OF MEASURE: METRIC

DATE LOGGED: MAY 24-27, 1988

STARTED: MAY 19, 1988

COMPLETED: MAY 26, 1988

CLAIM NO: P 997466

DIP TESTS (corrected)

DEPTH	AZIMUTH	DIP	DEPTH	AZIMUTH	DIP
44.00	180	-50.0	224.00	171	-41.5
131.00	178	-45.0			

FROM	TO	-----DESCRIPTION-----	SAMPLE	FROM	TO	LENGTH	Au g/t	RERUN	REJECT	AVERAGE
------	----	-----------------------	--------	------	----	--------	--------	-------	--------	---------

.00	42.29	CASING AND OVERBURDEN								
-----	-------	-----------------------	--	--	--	--	--	--	--	--

42.29	74.06	QUARTZ FELDSPAR PORPHYRY								
-------	-------	--------------------------	--	--	--	--	--	--	--	--

Light orange to light grey. Moderately to highly sheared at 55 degrees to the core axis. Quite feldspathic, sericitic, with 5% small quartz phenocrysts or eyes. Weakly propylitic locally. Minor disseminated pyrite.

55.40 59.23 Weakly propylitic lapilli-tuff unit. 1 to 5% pyrite.

55.40 56.55 Weakly propylitic. Minor disseminated pyrite.

D73420	55.40	56.55	1.15
--------	-------	-------	------

56.55 57.79 Weakly propylitic. 5% disseminated pyrite.

D73421	56.55	57.79	1.24
--------	-------	-------	------

57.79 59.23 Weakly propylitic. 1% disseminated pyrite.

D73422	57.79	59.23	1.44
--------	-------	-------	------

70.00 74.06 Moderate to strong silicification caused by intruding dike.

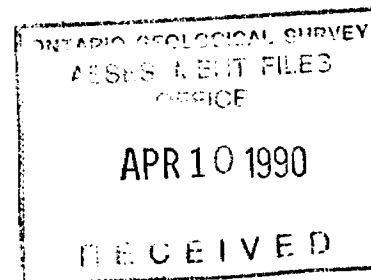

PLACER DOME INC.
DIAMOND DRILL RECORD

HOLE NO: 246-056
PAGE NO: 5

FROM	TO	-----DESCRIPTION-----	SAMPLE	FROM	TO	LENGTH	Au g/t	RERUN	REJECT	AVERAGE
195.56	196.73	1% pyrite.	D73465	195.56	196.73	1.17				
196.73	198.07	1% pyrite.	D73466	196.73	198.07	1.34				
198.07	199.00	1% pyrite.	D73467	198.07	199.00	.93				
199.00	200.50	1% pyrite.	D73468	199.00	200.50	1.50				
200.50	202.00	1% pyrite.	D73469	200.50	202.00	1.50				
202.00	203.50	1% pyrite.	D73470	202.00	203.50	1.50				
203.50	205.00	5% pyrite.	D73471	203.50	205.00	1.50				
205.00	206.60	1% pyrite.	D73472	205.00	206.60	1.60				
206.60	226.00	GREYWACKE Similar to 188 to 195.								
206.60	208.00	1% pyrite.	D73473	206.60	208.00	1.40				
208.00	209.50	1 to 5% pyrite.	D73474	208.00	209.50	1.50				
209.50	211.00	1% pyrite.	D73475	209.50	211.00	1.50				
211.00	212.50	10% pyrite, trace chalcopryrite.	D73476	211.00	212.50	1.50				
226.00		END OF HOLE								

CORE STORED AT DOME MINES, SOUTH PORCUPINE, ONTARIO.

NW CASING DRIVEN TO BEDROCK AND LEFT IN HOLE. BW CASING PULLED.

HOLE CAPPED.

DRILLING BY BRADLEY BROS. DRILLING, TIMMINS, ONTARIO.

Brian Cole

PLACER DOME INC.

REF CORD: 360.0 -1500.0 SURVEYED: NO

DIAMOND DRILL RECORD

HOLE NO: 246-058

LOCATION: 3+60N 15+00W GRID: SOUTH

PROPERTY: PROJECT 246
BRISTOL TWP, ONTARIO

POST LOCATION: 28m N & 0m E to POST 1, CLAIM P 985631

SECTION:

AZIMUTH: 180.0

LENGTH: 242.0

ELEVATION: .0

LOGGED BY: B. COLE

DIP: -50.0

CORE SIZE: 8Q

SYSTEM OF MEASURE: METRIC

DATE LOGGED: MAY 31 - JUNE 3, 1988

STARTED: MAY 30, 1988

COMPLETED: JUNE 2, 1988

CLAIM NO: P 985631

DIP TESTS (corrected)

DEPTH	AZIMUTH	DIP	DEPTH	AZIMUTH	DIP
42.00	185	-51.0	240.00	171	-41.5
138.00	175	-46.5			

FROM	TO	-----DESCRIPTION-----	SAMPLE	FROM	TO	LENGTH	Au g/t	RERUN	REJECT	AVERAGE
------	----	-----------------------	--------	------	----	--------	--------	-------	--------	---------

.00	37.00	CASING AND OVERBURDEN								
-----	-------	-----------------------	--	--	--	--	--	--	--	--

37.00	102.00	QUARTZ FELDSPAR PORPHYRY								
-------	--------	--------------------------	--	--	--	--	--	--	--	--

Light greenish grey. Very highly sheared at 65 degrees to the core axis. Extensively altered and deformed to quartz, carbonate, sericite. Slightly siliceous. Minor pyrite. Some quartz eyes locally.

47.00	50.00	One metre grind.								
-------	-------	------------------	--	--	--	--	--	--	--	--

51.79	52.10	15% quartz veining. Minor blebby chalcopyrite.	D73522	51.79	52.10	.31				
55.87	55.97	10 cms fault gouge.								

71.56	73.60	Streched breccia clasts or lapilli-tuff horizon. Slightly carbonatized.								
-------	-------	---	--	--	--	--	--	--	--	--

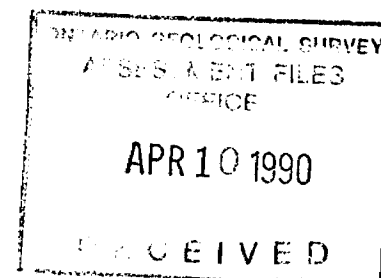

FROM	TO	-----DESCRIPTION-----	SAMPLE	FROM	TO	LENGTH	Au g/t	RERUN	REJECT	AVERAGE
102.00	106.44	CARBONATIZED QUARTZ FELDSPAR PORPHYRY Light grey. Gradual transition from medium grey. Moderately carbonatized. Very highly sheared at 70 degrees. 1% blebby pyrite.								
	102.00	103.43 1% blebby pyrite.	D73523	102.00	103.43	1.43				
	103.43	104.88 1% blebby pyrite.	D73524	103.43	104.88	1.45				
	104.88	106.44 1% blebby pyrite. Slightly silicified.	D73525	104.88	106.44	1.56				
106.44	110.00	SILICIFIED QUARTZ FELDSPAR PORPHYRY Medium grey. Highly sheared before strong silicification. Numerous quartz eyes. 1 to 5% fine blebby pyrite to thin stringers. Numerous quartz-carbonate stringers.								
	106.44	107.35 75% carbonate-quartz veining with 5 to 10% fine blebby pyrite.	D73526	106.44	107.35	.91				
	107.35	108.35 5% fine blebby pyrite. 15% carbonate-quartz stringers.	D73527	107.35	108.35	1.00				
	108.35	109.03 10% fine blebby pyrite. 5% carbonate-quartz stringers.	D73528	108.35	109.03	.68				
	109.03	110.00 10% fine blebby pyrite/ Trace chalcopyrite.	D73529	109.03	110.00	.97				
110.00	119.00	CARBONATIZED QUARTZ FELDSPAR PORPHYRY Similar to 102 to 106. 1 to 5% fine pyrite. Trace chalcopyrite.								
	110.00	111.50 1 to 5% fine pyrite.	D73530	110.00	111.50	1.50				
	111.50	113.00 1 to 5% fine pyrite.	D73531	111.50	113.00	1.50				
	113.00	114.50 1 to 5% fine pyrite.	D73532	113.00	114.50	1.50				
	114.50	116.00 1 to 5% fine pyrite.	D73533	114.50	116.00	1.50				
	116.00	117.50 1 to 5% fine pyrite.	D73534	116.00	117.50	1.50				

FROM	TO	-----DESCRIPTION-----	SAMPLE	FROM	TO	LENGTH	Au g/t	RERUN	REJECT	AVERAGE
	117.50	119.00	1 to 5% fine pyrite.	D73535	117.50	119.00	1.50			
119.00	123.00	SILICIFIED QUARTZ FELDSPAR PORPHYRY Similar to 106 to 110. Slightly to moderately silicified with some carbonatization. 1 to 5% fine blebby pyrite, locally 15%. Occasional thin chalcopyrite stringer.								
	119.00	120.00	10% fine blebby pyrite, crudely aligned parallel with plane of shear.	D73536	119.00	120.00	1.00			
	120.00	121.00	5% fine blebby pyrite. 35 cm wide carbonate-quartz vein with 5% pyrite.	D73537	120.00	121.00	1.00			
	121.00	122.00	5 to 10% blebby pyrite. Some carbonate-quartz veining.	D73538	121.00	122.00	1.00			
	122.00	123.00	5 to 10% blebby pyrite.	D73539	122.00	123.00	1.00			
123.00	141.50	CARBONATIZED INTERMEDIATE - FELSIC LAPILLI-TUFF Light greenish grey. Very slightly silicified with slightly to moderate carbonatization. 15% faint quartz and carbonate lapilli-tuff - sized clasts in highly sheared, sericitic matrix.								
	123.00	124.00	5 to 10% fine blebby pyrite.	D73540	123.00	124.00	1.00			
	124.00	125.00	5% fine blebby pyrite.	D73541	124.00	125.00	1.00			
	125.00	126.00	5% fine blebby pyrite, several blebs and thin stringer of chalcopyrite.	D73542	125.00	126.00	1.00			
	126.00	127.00	1% pyrite.	D73543	126.00	127.00	1.00			
	127.00	128.00	1% pyrite.	D73544	127.00	128.00	1.00			
	128.00	129.00	1% pyrite.	D73545	128.00	129.00	1.00			
	129.00	130.00	1% pyrite.	D73546	129.00	130.00	1.00			
	130.00	131.00	5% fine pyrite. 5 mm wide chalcopyrite stringer.	D73547	130.00	131.00	1.00			
	131.00	132.50	1% fine pyrite.	D73548	131.00	132.50	1.50			
	132.50	134.00	1% fine pyrite.	D73549	132.50	134.00	1.50			
	134.00	135.50	1% fine pyrite.	D73550	134.00	135.50	1.50			
	135.50	137.00	1% fine pyrite.	D73551	135.50	137.00	1.50			

PLACER DOME INC.
DIAMOND DRILL RECORD

HOLE NO: 246-058

PAGE NO: 4

FROM	TO	-----DESCRIPTION-----	SAMPLE	FROM	TO	LENGTH	Au g/t	RERUN	REJECT	AVERAGE
137.00	138.50	1% fine pyrite.	D73552	137.00	138.50	1.50				
138.50	140.00	1% fine pyrite.	D73553	138.50	140.00	1.50				
140.00	141.50	1% fine pyrite.	D73554	140.00	141.50	1.50				
141.50	177.50	CARBONATIZED QUARTZ FELDSPAR PORPHYRY Indistinct contact. Light grey. Slightly to moderately carbonatized. Highly sheared but no distinct foliation. 1% fine pyrite.								
141.50	143.00	1% pyrite.	D73555	141.50	143.00	1.50				
143.00	144.50	1% pyrite.	D73556	143.00	144.50	1.50				
144.50	145.39	1% pyrite.	D73557	144.50	145.39	.89				
145.39	146.24	50% massive white carbonate-quartz vein parallel with core axis.	D73558	145.39	146.24	.85				
146.24	147.07	80% massive white quartz-carbonate vein parallel with core axis.	D73559	146.24	147.07	.83				
147.07	148.17	1% pyrite.	D73560	147.07	148.17	1.10				
148.17	149.00	1% pyrite. 20 cm wide massive white carbonate-quartz vein at 15 degrees.	D73561	148.17	149.00	.83				
149.00	150.50	1% finely disseminated pyrite.	D73562	149.00	150.50	1.50				
150.50	152.00	1% finely disseminated pyrite.	D73563	150.50	152.00	1.50				
152.00	153.50	1% finely disseminated pyrite.	D73564	152.00	153.50	1.50				
153.50	155.00	1% finely disseminated pyrite.	D73565	153.50	155.00	1.50				
155.00	156.50	1% finely disseminated pyrite.	D73566	155.00	156.50	1.50				
156.50	158.00	1% finely disseminated pyrite.	D73567	156.50	158.00	1.50				
158.00	159.50	1% finely disseminated pyrite.	D73568	158.00	159.50	1.50				
159.50	160.25	1 to 5% disseminated to fine blebby pyrite with 2% chalcopyrite : fine blebs to crude stringers at 65 degrees.	D73569	159.50	160.25	.75				
160.25	161.00	Similar to 159 to 160.	D73570	160.25	161.00	.75				
161.00	162.00	Similar to 159 to 160. 5% chalcopyrite, usually as fine blebs.	D73571	161.00	162.00	1.00				
162.00	163.00	Similar to 159 to 160. 5% chalcopyrite, 15% locally as fine blebs.	D73572	162.00	163.00	1.00				
163.00	164.00	Similar to 159 to 160. 1% chalcopyrite.	D73573	163.00	164.00	1.00				
164.00	165.50	1% finely disseminated pyrite.	D73574	164.00	165.50	1.50				
165.50	167.00	1% finely disseminated pyrite.	D73575	165.50	167.00	1.50				

PLACER DOME INC.
DIAMOND DRILL RECORD

HOLE NO: 246-058
PAGE NO: 5

FROM	TO	-----DESCRIPTION-----	SAMPLE	FROM	TO	LENGTH	Au g/t	RERUN	REJECT	AVERAGE
167.00	168.50	1% finely disseminated pyrite.	D73576	167.00	168.50	1.50				
168.50	170.00	1% finely disseminated pyrite.	D73577	168.50	170.00	1.50				
170.00	171.50	1% finely disseminated pyrite.	D73578	170.00	171.50	1.50				
171.50	173.00	1% finely disseminated pyrite.	D73579	171.50	173.00	1.50				
173.00	174.50	1% finely disseminated pyrite.	D73580	173.00	174.50	1.50				
174.50	176.00	1% finely disseminated pyrite.	D73581	174.50	176.00	1.50				
176.00	177.50	1% finely disseminated pyrite.	D73582	176.00	177.50	1.50				
177.50	209.00	QUARTZ FELDSPAR PORPHYRY Similar to 37 to 102. 1% disseminated pyrite. Slightly siliceous. Massive. Occasional quartz eyes. Slightly carbonatized, moderately so locally.								
209.00	242.00	EPIDOTIZED QUARTZ FELDSPAR PORPHYRY Medium grey. 5% quartz and 15% feldspar phenocrysts are distinguishable. Siliceous. Massive. 1% fine blebby epidote								
		227.00 228.50 Moderately carbonatized. 1% pyrite. Thin stringer of chalcopyrite.	D73583	227.00	228.50	1.50				
242.00		END OF HOLE								

CORE STORED AT DOME MINES, SOUTH PORCUPINE, ONTARIO.

NW CASING DRIVEN TO BEDROCK AND LEFT IN HOLE. BW CASING PULLED.

HOLE CAPPED.

DRILLING BY BRADLEY BROS. DRILLING, TIMMINS, ONTARIO.

Brian Ash

PLACER DOME INC.

REF CORD: 375.0 -1600.0 SURVEYED: NO

DIAMOND DRILL RECORD

HOLE NO: 246-061

LOCATION: 3+75N 16+00W GRID: SOUTH

PROPERTY: PROJECT 246
BRISTOL TWP, ONTARIO

POST LOCATION: 13m N & 100m E to POST 1, CLAIM P 985631

SECTION:

AZIMUTH: 180.0

LENGTH: 238.0

ELEVATION: .0

LOGGED BY: B. COLE

DIP: -50.0

CORE SIZE: BQ

SYSTEM OF MEASURE: METRIC

DATE LOGGED: JUNE 10, 1988

STARTED: JUNE 7, 1988

COMPLETED: JUNE 9, 1988

CLAIM NO: P 985631

DIP TESTS (corrected)

DEPTH	AZIMUTH	DIP	DEPTH	AZIMUTH	DIP
41.00	188	-52.0	236.00	178	-46.5
131.00	180	-49.0			

FROM	TO	DESCRIPTION	SAMPLE	FROM	TO	LENGTH	Au g/t	RERUN	REJECT	AVERAGE
------	----	-------------	--------	------	----	--------	--------	-------	--------	---------

.00	36.04	CASING AND OVERBURDEN								
-----	-------	-----------------------	--	--	--	--	--	--	--	--

36.04	58.00	CARBONATIZED QUARTZ FELDSPAR PORPHYRY Light grey. Slightly carbonatized. Slightly sheared at 45 to 50 degrees to the core axis. Small phenocrysts. 1 to 5% disseminated to blebby pyrite, minor chalcopyrite.								
-------	-------	--	--	--	--	--	--	--	--	--

Lapilli-tuff horizons locally.

36.04	37.00	5% disseminated pyrite.	D73777	36.04	37.00		.96			
37.00	38.04	5% disseminated pyrite.	D73778	37.00	38.04		1.04			
38.04	38.34	4 cm vein of chalcopyrite plus coarse stringer of chalcopyrite.	D73779	38.04	38.34		.30			
38.34	39.00	1% finely disseminated pyrite.	D73780	38.34	39.00		.66			
39.00	40.00	1 to 5% finely disseminated pyrite.	D73781	39.00	40.00		1.00			

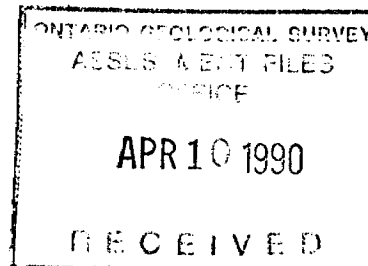

FROM	TO	-----DESCRIPTION-----	SAMPLE	FROM	TO	LENGTH	Au g/t	RERUN	REJECT	AVERAGE
67.00	68.00	Extremely silicified. Pinkish. 1% disseminated pyrite.	D73803	67.00	68.00	1.00				
68.00	69.00	Extremely silicified. Pinkish. 1% finely disseminated pyrite.	D73804	68.00	69.00	1.00				
69.00	70.00	Grind.								
70.00	78.45	CARBONATIZED QUARTZ FELDSPAR PORPHYRY Buff. Very highly sheared and schistose at 60 degrees. Predominantly carbonate and sericite. 1 to 5% finely disseminated to blebby pyrite.								
70.00	71.00	1% pyrite. Some grind.	D73805	70.00	71.00	1.00				
71.00	72.00	1% finely disseminated pyrite. Some grind.	D73806	71.00	72.00	1.00				
72.00	73.00	1% pyrite.	D73807	72.00	73.00	1.00				
73.00	74.00	1 to 5% pyrite.	D73808	73.00	74.00	1.00				
74.00	75.00	1% fine to coarse blebby pyrite.	D73809	74.00	75.00	1.00				
75.00	76.00	5% blebby pyrite.	D73810	75.00	76.00	1.00				
76.00	77.20	1% fine pyrite.	D73811	76.00	77.20	1.20				
77.20	78.45	1% pyrite.	D73812	77.20	78.45	1.25				
78.45	100.00	QUARTZ FELDSPAR PORPHYRY Gradational contact. Orange grey. Moderately sheared at 65 degrees. Fine to medium grained granular texture. Slightly carbonatized. Possibly some albitic alteration near contact. 1% pyrite, occasional chalcopyrite bleb or stringer.								
78.45	79.00	Minor to 1% disseminated pyrite. Thin stringer of chalcopyrite.	E3201	78.45	79.00	.55				
79.00	80.50	Minor to 1% pyrite.	E3202	79.00	80.50	1.50				
80.50	82.00	Minor to 1% pyrite.	E3203	80.50	82.00	1.50				
82.00	83.50	Minor to 1% pyrite.	E3204	82.00	83.50	1.50				
83.50	85.00	Minor to 1% pyrite.	E3205	83.50	85.00	1.50				
85.00	86.50	Minor to 1% pyrite.	E3206	85.00	86.50	1.50				

PLACER DOME INC.
DIAMOND DRILL RECORD

HOLE NO: 246-061
PAGE NO: 4

FROM	TO	-----DESCRIPTION-----	SAMPLE	FROM	TO	LENGTH	Au g/t	RERUN	REJECT	AVERAGE
86.50	88.00	Minor to 1% pyrite.	E3207	86.50	88.00	1.50				
88.00	89.50	Minor to 1% pyrite.	E3208	88.00	89.50	1.50				
89.50	91.00	Minor to 1% pyrite.	E3209	89.50	91.00	1.50				
91.00	92.50	Minor to 1% pyrite.	E3210	91.00	92.50	1.50				
92.50	94.00	Minor to 1% pyrite.	E3211	92.50	94.00	1.50				
94.00	95.67	Minor to 1% pyrite.	E3212	94.00	95.67	1.67				
95.67	96.66	Lapilli-tuff horizon. 1 to 10% disseminated pyrite.	D73813	95.67	96.66	.99				
100.00	112.95	INTERMEDIATE - FELSIC LAPILLI-TUFF Indistinct contacts. Light green. 20% lapilli-tuff - sized quartz clasts in fine grained, slightly chloritic matrix. Carbonatized. Numerous dikes of porphyry. 1% pyrite. Minor quartz stringers.								
112.95	139.00	QUARTZ FELDSPAR PORPHYRY Medium grey. Generally massive. Medium grained to porphyritic in part. Siliceous. Indistinct crystal boundaries. Minor pyrite.								
112.95	113.23	1% finely disseminated pyrite.	E3213	112.95	113.23	.28				
113.23	115.00	1% finely disseminated pyrite.	E3214	113.23	115.00	1.77				
115.00	116.50	1% finely disseminated pyrite.	E3215	115.00	116.50	1.50				
116.50	118.00	1% disseminated pyrite.	E3216	116.50	118.00	1.50				
118.00	119.50	1% disseminated pyrite.	E3217	118.00	119.50	1.50				
119.50	121.00	1% disseminated pyrite.	E3218	119.50	121.00	1.50				
121.00	122.50	1% disseminated pyrite.	E3219	121.00	122.50	1.50				
122.50	124.00	1% disseminated pyrite.	E3220	122.50	124.00	1.50				
124.00	125.50	1% disseminated pyrite.	E3221	124.00	125.50	1.50				
125.50	127.00	1% disseminated pyrite.	E3222	125.50	127.00	1.50				
127.00	128.50	1% disseminated pyrite.	E3223	127.00	128.50	1.50				
128.50	130.00	1% disseminated pyrite.	E3224	128.50	130.00	1.50				
130.00	131.50	1% disseminated pyrite.	E3225	130.00	131.50	1.50				
131.50	133.00	1% disseminated pyrite.	E3226	131.50	133.00	1.50				

PLACER DOME INC.
DIAMOND DRILL RECORD

HOLE NO: 246-061
PAGE NO: 5

FROM	TO	-----DESCRIPTION-----	SAMPLE	FROM	TO	LENGTH	Au g/t	RERUN	REJECT	AVERAGE
133.00	134.50	1% disseminated pyrite.	E3227	133.00	134.50	1.50				
134.50	136.00	1% disseminated pyrite.	E3228	134.50	136.00	1.50				
136.00	137.50	1% disseminated pyrite.	E3229	136.00	137.50	1.50				
137.50	139.00	1% disseminated pyrite.	E3230	137.50	139.00	1.50				
139.00	195.70	INTERMEDIATE - FELSIC LAPILLI-TUFF Indistinct contact. 20% lapilli-tuff - sized lenticular quartz clasts at 65 degrees in fine to medium grained, slightly siliceous and chloritic matrix. No other foliation. 1% pyrite. Some porphyry diking. Off and on appearance of minor to 5% small epidote blebs. Sharp lower contact at 60 degrees.								
187.00	188.50	1% disseminated pyrite.	E3231	187.00	188.50	1.50				
188.50	190.00	1% disseminated pyrite.	E3232	188.50	190.00	1.50				
190.00	191.50	1% disseminated pyrite.	E3233	190.00	191.50	1.50				
191.50	193.00	1% disseminated pyrite.	E3234	191.50	193.00	1.50				
193.00	194.37	Silicified. 1 to 5% pyrite.	D73814	193.00	194.37	1.37				
194.37	195.70	Silicified. 1 to 5% pyrite.	D73815	194.37	195.70	1.33				
195.70	232.00	QUARTZ FELDSPAR PORPHYRY Medium grey. Fine to medium grained. Massive with very small phenocrysts over short portions. Minor pyrite, trace chalcopyrite bleb or stringer.								
195.70	196.70	Silicified. 1 to 5% pyrite.	E3235	195.70	196.70	1.00				
196.70	197.90	1% disseminated pyrite.	E3236	196.70	197.90	1.20				
197.90	199.00	1% disseminated pyrite.	E3237	197.90	199.00	1.10				
199.00	200.50	1% disseminated pyrite.	E3238	199.00	200.50	1.50				
200.50	202.00	1% disseminated pyrite.	E3239	200.50	202.00	1.50				
202.00	203.50	Minor to 1% pyrite.	E3240	202.00	203.50	1.50				
203.50	205.00	Minor to 1% pyrite.	E3241	203.50	205.00	1.50				
205.00	206.50	Minor to 1% pyrite.	E3242	205.00	206.50	1.50				
206.50	208.00	Minor to 1% pyrite.	E3243	206.50	208.00	1.50				

PLACER DOME INC.
DIAMOND DRILL RECORD

HOLE NO: 246-061
PAGE NO: 7

FROM TO -----DESCRIPTION----- SAMPLE FROM TO LENGTH Au g/t RERUN REJECT AVERAGE

CORE STORED AT DOME MINES, SOUTH PORCUPINE, ONTARIO.

NW CASING DRIVEN TO BEDROCK AND LEFT IN HOLE. BW CASING
PULLED.

HOLE CAPPED.

DRILLING BY BRADLEY BROS. DRILLING, TIMMINS, ONTARIO.

Brain Cole

PLACER DOME INC.

REF CORD: 250.0 -1800.0 SURVEYED: NO

DIAMOND DRILL RECORD

HOLE NO: 246-063

LOCATION: 2+50N 18+00W GRID: SOUTH

PROPERTY: PROJECT 246
BRISTOL TWP, ONTARIO

POST LOCATION: 150m N & 300m E to POST 1, CLAIM P 985631

SECTION:

AZIMUTH: 180.0

LENGTH: 368.0

ELEVATION: .0

LOGGED BY: B. COLE

DIP: -50.0

CORE SIZE: BQ

SYSTEM OF MEASURE: METRIC

DATE LOGGED: JUNE 15-23, 1988

STARTED: JUNE 14, 1988

COMPLETED: JUNE 21, 1988

CLAIM NO: P 985631

DIP TESTS (corrected)

DEPTH	AZIMUTH	DIP	DEPTH	AZIMUTH	DIP
45.00	179	-50.5	273.00	171	-41.5
174.00	178	-45.5	366.00	170	-40.0

FROM	TO	-----DESCRIPTION-----	SAMPLE	FROM	TO	LENGTH	Au g/t	RERUN	REJECT	AVERAGE
------	----	-----------------------	--------	------	----	--------	--------	-------	--------	---------

.00	37.00	CASING AND OVERBURDEN								
-----	-------	-----------------------	--	--	--	--	--	--	--	--

37.00	55.63	GREYWACKE								
-------	-------	-----------	--	--	--	--	--	--	--	--

Medium grey. Fine to medium grained. Massive to weakly foliated at 70 degrees to the core axis. Occasional lapilli-tuff horizon. Occasional porphyry dike. Generally blocky. Minor pyrite and carbonate-quartz veinlets.

42.23	42.90	Quartz lapilli-tuff horizon with 10% fine blebby pyrite.	D73842	42.23	42.90	.67				
-------	-------	--	--------	-------	-------	-----	--	--	--	--

49.63	50.25	Quartz lapilli-tuff horizon with 10% fine blebby pyrite adjacent porphyry dike.	D73843	49.63	50.25	.62				
-------	-------	---	--------	-------	-------	-----	--	--	--	--

50.25	51.89	Quartz feldspar porphyry dike. Sharp contact at 65 degrees.								
-------	-------	---	--	--	--	--	--	--	--	--

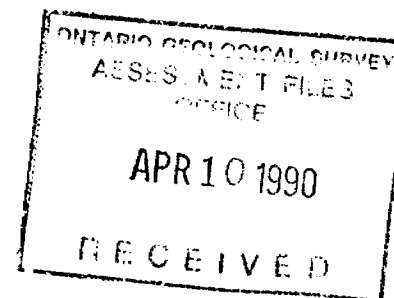

PLACER DOME INC.
DIAMOND DRILL RECORD

HOLE NO: 246-063
PAGE NO: 2

FROM	TO	-----DESCRIPTION-----	SAMPLE	FROM	TO	LENGTH	Au g/t	RERUN	REJECT	AVERAGE
55.63	62.95	QUARTZ FELDSPAR PORPHYRY Light grey. Abundant quartz and feldspar phenocrysts in fine grained, siliceous groundmass. Slightly fractured. 1 to 5% finely disseminated pyrite.								
55.63	56.79	10% carbonate-quartz veining in fractured porphyry. 1% finely disseminated pyrite.	D73844	55.63	56.79	1.16				
56.79	57.85	80% massive carbonate-quartz veining with 5% tourmaline stringers.	D73845	56.79	57.85	1.06				
57.85	59.00	1% fine pyrite. Blocky.	D73872	57.85	59.00	1.15				
59.00	60.50	1% fine pyrite.	D73873	59.00	60.50	1.50				
62.95	68.92	GREYWACKE Similar to 37 to 55.								
68.92	83.90	QUARTZ FELDSPAR PORPHYRY Similar to 55 to 62.								
76.29	77.51	1% finely disseminated pyrite.	D73846	76.29	77.51	1.22				
77.51	78.42	Massive grey white carbonate-quartz vein with 5% tourmaline stringers and 5% fine to coarse chalcopyrite stringers. Contacts at 10 and 35 degrees.	D73847	77.51	78.42	.91				
78.42	79.08	8 cm wide zone of coarse blebby pyrite at vein contact. 5% finely disseminated pyrite otherwise.	D73848	78.42	79.08	.66				
79.08	80.00	Grey white massive carbonate-quartz vein with minor tourmaline and 10% carbonate stringers. Generally parallel with core axis.	D73849	79.08	80.00	.92				
80.00	81.00	Slightly carbonatized. 1% very finely disseminated pyrite.	D73850	80.00	81.00	1.00				
81.00	82.00	Similar to 80 to 81.	D73851	81.00	82.00	1.00				
82.00	83.00	Similar to 80 to 81.	D73852	82.00	83.00	1.00				

FROM	TO	-----DESCRIPTION-----	SAMPLE	FROM	TO	LENGTH	Au g/t	RERUN	REJECT	AVERAGE
219.73	242.42	CARBONATIZED QUARTZ FELDSPAR PORPHYRY Questionable origin. Sharp contacts at 85 to 90 degrees. Light grey. Medium grained. Extremely carbonatized. Effervesces profusely with HCl. Some sericite slips. Shear (?) at 60 degrees. Minor to 2% disseminated pyrite.								
219.73	221.00	Minor to 1% pyrite.	D73855	219.73	221.00	1.27				
221.00	222.50	Minor to 1% pyrite.	D73856	221.00	222.50	1.50				
222.50	224.00	Minor to 1% pyrite.	D73857	222.50	224.00	1.50				
224.00	225.50	Minor to 1% pyrite.	D73858	224.00	225.50	1.50				
225.50	227.00	Minor to 1% pyrite.	D73859	225.50	227.00	1.50				
227.00	228.50	Minor to 1% pyrite.	D73860	227.00	228.50	1.50				
228.50	230.00	Minor to 1% pyrite.	D73861	228.50	230.00	1.50				
230.00	231.50	Minor to 1% pyrite.	D73862	230.00	231.50	1.50				
231.50	233.00	Minor to 1% pyrite. Large grey quartz bleb.	D73863	231.50	233.00	1.50				
233.00	233.66	Minor to 1% pyrite.	D73864	233.00	233.66	.66				
233.66	233.96	White grey mottled carbonate-quartz vein. Contacts at 83 and 43 degrees. 10% fine blebby pyrite. Several sericite slips.	D73865	233.66	233.96	.30				
233.96	234.50	Minor to 1% pyrite.	D73866	233.96	234.50	.54				
234.50	236.00	Minor to 1% pyrite.	D73867	234.50	236.00	1.50				
236.00	237.50	Minor to 1% pyrite.	D73868	236.00	237.50	1.50				
237.50	239.00	Minor to 1% pyrite.	D73869	237.50	239.00	1.50				
239.00	240.50	Minor to 1% pyrite.	D73870	239.00	240.50	1.50				
240.50	242.00	Minor to 1% pyrite.	D73871	240.50	242.00	1.50				
242.00	242.42	Minor to 1% pyrite.	D73874	242.00	242.42	.42				
242.42	368.00	GREYWACKE Mottled grey. Fine to medium grained. Massive to weakly laminated at 65 degrees. Weakly carbonatized. Some quartz-carbonate veining. Rare stringer of pyrite, red sphalerite.								
245.14	245.44	Ten cm wide carbonate-quartz vein at 70	D73875	245.14	245.44	.30				

PLACER DOME INC.
DIAMOND DRILL RECORD

HOLE NO: 246-063
PAGE NO: 5

FROM	TO	-----DESCRIPTION-----	SAMPLE	FROM	TO	LENGTH	Au g/t	RERUN	REJECT	AVERAGE
		degrees.								
251.94	252.52	50% grey white carbonate-quartz veining at 40 to 50 degrees. Some yellow green sericite stringers (?).	D73876	251.94	252.52	.58				
265.94	267.27	20% blebs and veins of carbonate-quartz. Veins at 50 to 70 degrees. Minor pyrite locally.	D73877	265.94	267.27	1.33				
269.83	270.30	Blue white and white carbonate-quartz veins at 45 degrees. Minor pyrite at contacts.	D73878	269.83	270.30	.47				
307.34	307.93	One cm wide blue grey quartz vein with minor blebby pyrite at 50 degrees.	D73879	307.34	307.93	.59				
307.93	308.71	Carbonate-quartz vein. Mottled white grey. Variable contact angles but generally at 45 degrees. 1 to 5% locally disseminated, blebby, and stringer pyrite, usually parallel with core axis. Minor tourmaline.	D73880	307.93	308.71	.78				
308.71	309.32	Carbonate-quartz vein. Similar to 307 to 308. Host rock biotitic a few cms from contact.	D73881	308.71	309.32	.61				
309.32	310.22	Several grey white pyroclast carbonate-quartz veinlets at 40 to 50 degrees.	D73882	309.32	310.22	.90				
314.89	315.19	10 cm wide white grey carbonate-quartz vein at 55 and 80 degrees.	D73883	314.89	315.19	.30				
317.82	318.12	Pyrite carbonate-quartz veinlet.	D73884	317.82	318.12	.30				
318.12	368.00	5 to 10% buff, sub- anhedral porphyroblasts of andalusite (?). Appearance of blue quartz eyes from 338.00 to 368.00.								

368.00

END OF HOLE

CORE STORED AT DOME MINES, SOUTH PORCUPINE, ONTARIO.

NW CASING DRIVEN TO BEDROCK AND LEFT IN HOLE. BW CASING PULLED.

HOLE CAPPED.

DRILLING BY BRADLEY BROS. DRILLING, TIMMINS, ONTARIO.

Bracewell

W9006.60238



42A06NW8453 39 BRISTOL

900

Project 246

Mining Act

Report of Work

Name and Address of Recorded Holder Placer Dome Inc.	Prospector's Licence No. T 837
P.O. Box 350, Suite 3500, IBM Tower, TD Centre, Toronto, Ont.	Telephone No. 416 868-6060

Summary of Distribution of Credits and Work Performance		M5K 1N3							
Mining Division Timmins	Mining Claim		Work Days Cr.	Mining Claim		Work Days Cr.	Mining Claim		Work Days Cr.
	Prefix	Number		Prefix	Number		Prefix	Number	
Township or Area Bristol / <i>COGden</i>	P	985601	(See Schedule "A")						
Total Assessment Credits Claimed 6,850									
Type of Work Performed (Check one only)									
<input type="checkbox"/> Manual Work									
<input type="checkbox"/> Shaft Sinking Drifting or other Lateral Work									
<input type="checkbox"/> Mechanical equipment									
<input type="checkbox"/> Power Stripping other than Manual (maximum credit allowed - 100 days per claim)									
<input checked="" type="checkbox"/> Diamond or other Core drilling									
<input type="checkbox"/> Core Specimens									

Dates when work was performed From: May 3/88 To: June 21/88	Total No. of Days Performed 6,850	Total No. of Days Claimed 6,850	Total No. of Days to be Claimed at a Future Date 0
--	--------------------------------------	------------------------------------	---

All the work was performed on Mining Claim(s): Indicate no. of days performed on each claim. * (See note No. 1 on reverse side)	Mining Claim P997466	No. of Days 4,068	Mining Claim P985631	No. of Days 2,782	Mining Claim	No. of Days	Mining Claim	No. of Days
Mining Claim	No. of Days	Mining Claim	No. of Days	Mining Claim	No. of Days	Mining Claim	No. of Days	Mining Claim

Required Information eg. type of equipment, Names, Addresses, etc. (See Table on reverse side)
If space below is insufficient, attach schedules with required information and location sketches

Drilling by: Bradley Bros. Drilling
P.O. Box 485
Highway 101 West
Timmins, Ontario P4N 7E7

Core Size: BQ

DDH No. 246-051 to 246-054
246-056
246-058
246-061
246-063

ONTARIO GEOLOGICAL SURVEY
ASSESSMENT FILES
OFFICE
APR 10 1990
RECEIVED

Certification of Beneficial Interest * (See Note No. 2 on reverse side)

I hereby certify that, at the time the work was performed, the claims covered in this report of work were recorded in the current recorded holder's name or held under a beneficial interest by the current recorded holder.	Date Feb. 5/90	Recorded Holder or Agent (Signature) <i>[Signature]</i>
--	-------------------	--

Certification Verifying Report of Work

I hereby certify that I have a personal and intimate knowledge of the facts set forth in the Report of Work annexed hereto, having performed the work or witnessed same during and/or after its completion and the annexed report is true.

Name and Address of Person Certifying Brian Cole	Telephone No. 705 235-8022	Date Feb 7/90	Certified By (Signature) <i>[Signature]</i>
---	-------------------------------	------------------	--

For Office Use Only

Work Assignments	<div style="border: 1px solid black; padding: 10px; text-align: center;"> <p>RECORDED</p> <p>FEB - 8 1990</p> </div>	<div style="border: 1px solid black; padding: 10px;"> <p>Received Stamp</p> <p>ONTARIO GEOLOGICAL SURVEY MINE DIVISION RECEIVED FEB 8 1990 <i>[Signature]</i></p> </div>
------------------	---	---

SCHEDULE "A"

CLAIM PREFIX	CLAIM NUMBER	DAYS WORK
P	985601	100
P	985602	100
P	985603	100
P	985604	100
P	985605	100
P	985608	100
P	985609	100
P	985610	100
P	985611	100
P	985612	100
P	985613	100
P	985614	100
P	985615	100
P	985616	100
P	985617	90
P	985618	80
P	985619	80
P	985622	80
P	985623	80
P	985624	80
P	985625	80
P	985626	80
P	985627	80
P	985628	80
P	985629	80
P	985630	80
P	985631	80
P	985632	80
P	985633	80
P	985634	80
P	985635	80
P	985636	80
P	985637	80
P	985638	80
P	985639	80
P	985640	80
P	985641	40
P	985642	40
P	985643	40
P	985644	40
P	985645	40
P	985646	40
P	985647	80
P	985720	80
P	985721	80
P	985722	80
P	985723	80
P	985724	85

RECEIVED
FEB 8 1990
@ 10:20 AM

HW

SCHEDULE "A"

CLAIM PREFIX	CLAIM NUMBER	DAYS WORK
P	985725	90
P	985726	90
P	985727	50
P	985728	50
P	985729	50
P	985730	50
P	985731	50
P	985732	50
P	985733	50
P	985734	50
P	985735	50
P	985736	50
P	985737	50
P	985738	50
P	985739	50
P	985740	50
P	985741	50
P	985742	50
P	985743	50
P	985744	50
P	985745	50
P	985746	50
P	985747	50
P	985748	50
P	985749	50
P	985750	50
P	985751	50
P	985752	50
P	985753	50
P	985754	50
P	997457	50
P	997458	50
P	997459	50
P	997460	50
P	997461	90
P	997462	50
P	997463	50
P	997464	90
P	997465	90
P	997466	68
P	997468	90
P	997469	90
P	997470	50
P	997471	50
P	997472	90
P	997473	90
P	997474	90
P	997475	90

MLV

Page No.
02/02/90

3

SCHEDULE "A"

CLAIM PREFIX	CLAIM NUMBER	DAYS WORK
P	997476	97
*** Total ***		6850

MLV

