

**MESPI MINES LIMITED****COVERING AN ELECTROMAGNETIC SURVEY****OVER THEIR CARMAN - LANGMUIR TOWNSHIP CLAIM GROUP**

Porcupine Mining Division, Ontario
September 1970

CLAIMS: P 76033 to 76044
Total of 12 claims

SURVEY: Electromagnetic - RADEN - VLF - EM

MAPS: 1

LOCATION AND ACCESS:

The 12 claim group is located at the Carman - Langmuir township line 1/2 mile west of Carman Bay of Nighthawk Lake. Access is via Nighthawk Lake.

PREVIOUS REPORTS AND WORK:**Maps**

Ontario Department of Mines	P 444
Ontario Department of Mines	P 356

The claim group area has been actively explored for many years. It is underlain primarily by peridotite with some diorite. Numerous pits have been placed in an outcrop area in the centre of the claim group to sample several small showings of asbestos. A Magnetometer and a JEM-EM survey were completed by Mespi Mines Limited in March 1966.

This survey detected a wide conductive zone that was strongly magnetic. Three drill holes put down in 1966 by Maspi all intersected conductive filament type magnetite.

EQUIPMENT USED AND OPERATORS:

A Crone RADEN-VLF-EM unit was used measuring both the dip angle of the resultant field in degrees and the Field Strength of the horizontal component of the VLF field as a percent of normal field strength. Accuracies are $\pm 1^\circ$ and $\pm 2\%$. Instrument brochure enclosed. VLF station read was Seattle, Washington 18.6 K Hz. Instrument operator was Roger Denomme of 387 Brasseur Avenue, Timmins. Total number of readings 400. Period of survey July 20 - 25, 1970.

LINECUTTING:

A grid totalling 18 miles of line was cut by W. Wilson of 143 Cedar Street North, Timmins, during the period May 22 to June 3, 1970.

INTERPRETATION:

The earlier JEM survey detected an oval conductive zone of 800' across and 1200' long located between lines 4+00W and 8+00E, and the base line and 8+00 north. This area is mapped as being a zone of strongly carbonatized peridotite.

The RADEM survey being more sensitive to lower order conductors extended the conductive area from the creek at line 10+00E to line 9+00N line 20W. It also detected another zone across the southern boundary of the property. The 140% field strength contour of the RADEM survey would appear to outline the boundary of the conductive magnetite zone.

A large zone of low order conductivity has been outlined that is a highly carbonitized portion of a peridotite intrusive. The conductivity is apparently due to fine filaments of magnetite laced throughout the altered zone.

Respectfully submitted,

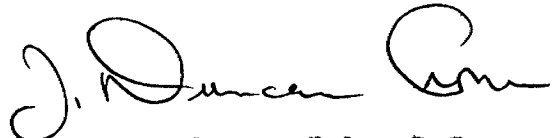

J. Duncan Crane, B.A., P.Eng.
Geophysicist.

**NEPTI MINES LIMITED****COVERING A SOIL SAMPLING GEOCHEMICAL SURVEY****OVER THEIR CARMAN - LANGSHIR TOWNSHIP CLAIM GROUP**

Porcupine Mining Division, Ontario
September 1970

CLAIMS: P 78033 to 78044
Total 12 claims

SURVEY: Soil Sampling
Cu - Ni hot nitric extraction

MAPS: 1

LOCATION AND ACCESS:

The 12 claim group is located at the Carman - Langshir township line 1/2 mile west of Carman Bay of Nighthawk Lake. Access is via Nighthawk Lake.

PREVIOUS REPORTS AND WORK:**Maps**

Ontario Department of Mines	P 444
Ontario Department of Mines	P 356

The claim group area has been actively explored for many years. It is underlain primarily by peridotite with some diorite. Numerous pits have been placed in an outcrop area in the centre of the claim group to sample several small showings of asbestos. A Magnetometer and a JEM-EM survey were completed by Nepti Mines Limited in March 1966.

This survey detected a wide conductive zone that was strongly magnetic. Three drill holes put down in 1966 by Meepi all intersected conductive filament type magnetite.

LINECUTTING:

A grid totalling 18 miles of line was cut by W. Wilson of 143 Cedar Street North, Timmins, during the period May 22 to June 3, 1970.

METHOD USED AND OPERATOR:

The survey was carried out by Eugene Rae of Box 887, Timmins, Ontario during the period July 20 to 25th, 1970.

The claim group covers an area of high ground with numerous outcrops and shallow, generally sandy overburden. When the soil was deep enough the samples were taken from the "C" horizon with a steel auger. The samples were assayed for Cu and Ni by X-Ray Assay Laboratories, Don Mills, Ontario using the hot nitric extraction method. A total of 266 soils were assayed (copy enclosed). Thirty-five rock core samples were also assayed for nickel.

SURVEY RESULTS:

The altered peridotite zone produced several high geochemical anomalies with over 1000 ppm nickel. This area has

been tested by either drill hole or trenching. Core from the three drill holes was split and assayed. These assays over wide sections averaged .28 Ni which adequately explains the soil anomalies. No further work is recommended.

Respectfully submitted,

A handwritten signature in cursive script, appearing to read "J. Duncan Grome".

J. Duncan Grome, B.A., P. Eng.
Geophysicist.

X-RAY ASSAY LABORATORIES

LIMITED

45 LESMILL ROAD

DON MILLS ONTARIO

445-5755

Certificate of Analysis

NO. 5106

TO. Mespi Mines Limited,
80 Richmond St. W. Suite 401,
TORONTO 1, Ontario.

RECEIVED July 31, 1970

INVOICE NO. 6066

SAMPLE(S) OF 266 soils

SUBMITTED TO US SHOW RESULTS AS FOLLOWS:

Sample	Cu ppm	Ni ppm	Sample	Cu ppm	Ni ppm
500	4	23	528	1	70
501	8	30	529	3	115
502	12	28	530	1	135
503	4	57	531	4	710
504	12	64	540	6	40
505	3	33	541	12	115
506	2	25	542	14	145
507	3	15	543	9	115
508	2	14	544	10	105
509	2	135	545	30	100
510	6	60	546	1	95
511	6	81	547	1	53
512	11	47	548	18	290
513	10	53	549	6	900
514	1	11	550	3	930
515	6	135	551	2	64
516	10	600	552	6	120
517	x	195	553	9	115
518	23	92	554	6	150
519	30	88	555	9	100
520	3	16	556	14	100
521	2	30	557	9	92
522	1	145	558	14	230
523	2	205	559	5	320
524	1	14	560	4	250
525	6	155	561	9	210
526	7	530	563	15	43
527	2	230	564	5	255

X-RAY ASSAY LABORATORIES LIMITED

DATE August 20, 1970

CERTIFIED BY

X-RAY ASSAY LABORATORIES

LIMITED

45 LESMILL ROAD

DON MILLS ONTARIO

445-5755

Certificate of Analysis

NO. 5106

TO. Mespi Mines Limited,
80 Richmond St. W. Suite 401,
TORONTO 1, Ontario.

RECEIVED July 31, 1970

INVOICE NO. 6066

SAMPLE(S) OF soils			SUBMITTED TO US SHOW RESULTS AS FOLLOWS:		
Sample	Cu ppm	Ni ppm	Sample	Cu ppm	Ni ppm
565	23	80	594	14	270
66	23	90	95	8	460
67	19	73	96	8	300
68	26	120	97	5	210
69	6	155	98	36	1600
70	3	83	99	7	200
71	5	300	600	17	1500
72	5	460	01	8	490
73	12	255	02	5	230
74	3	370	03	8	790
75	8	800	04	21	160
76	3	150	05	3	210
77	4	74	06	9	700
78	10	84	07	3	130
79	10	85	08	2	130
80	8	370	09	12	730
81	8	260	10	10	780
82	5	460	11	20	90
83	5	500	12	20	250
84	8	230	13	13	390
85	2	270	14	10	64
86	13	150	15	14	61
87	44	300	16	16	69
88	12	73	17	11	58
90	12	63	18	11	67
91	21	94	19	10	92
92	23	110	20	8	73
93	16	310	21	11	130

X-RAY ASSAY LABORATORIES LIMITED

DATE

August 20, 1970

CERTIFIED BY

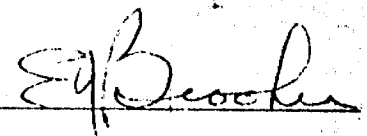

X-RAY ASSAY LABORATORIES

LIMITED

45 LESMILL ROAD

DON MILLS ONTARIO

445-5755

Certificate of Analysis

NO. 5106

TO. Mespi Mines Limited,
80 Richmond St. W. Suite 401,
TORONTO 1, Ontario.

RECEIVED July 31, 1970

INVOICE NO. 6066

SAMPLE(S) OF soils

SUBMITTED TO US SHOW RESULTS AS FOLLOWS:

Sample	Cu ppm	Ni ppm	Sample	Cu ppm	Ni ppm
622	12	410	650	24	96
23	7	620	51	4	16
24	3	280	52	2	10
25	6	1520	53	2	8
26	8	1210	54	9	86
27	3	420	55	3	28
28	9	1570	56	16	55
29	6	520	57	8	73
30	6	430	58	17	73
31	10	420	59	21	140
32	6	190	60	9	77
33	8	810	61	10	53
34	33	570	62	12	51
35	7	310	63	22	43
36	11	460	64	24	38
37	31	750	65	4	38
38	18	420	66	18	53
39	22	1100	67	6	77
40	20	95	68	8	32
41	22	105	69	4	15
42	13	105	70	3	10
43	12	87	71	4	13
44	20	83	72	23	37
45	24	80	73	20	320
46	7	45	74	10	520
47	30	270	75	16	50
48	22	670	76	6	650
49	14	530	77	5	33

X-RAY ASSAY LABORATORIES LIMITED

DATE August 20, 1970

CERTIFIED BY

X-RAY ASSAY LABORATORIES

LIMITED

45 LESMILL ROAD

DON MILLS ONTARIO

445-5755

Certificate of Analysis

NO. 5106

TO. Mespi Mines Limited,
80 Richmond St. W. Suite 401,
TORONTO, 1, Ontario.

RECEIVED July 31, 1970

INVOICE NO. 6066

SAMPLE(S) OF soils

SUBMITTED TO US SHOW RESULTS AS FOLLOWS:

Sample	Cu ppm	Ni ppm
737	7	680
38	16	160
39	12	290
40	7	220
41	7	2300
42	9	110
743-5S-8E	15	830
743-8S-12E	16	79
744	6	290
45	8	130
46	7	230
47	16	83
48	6	77
49	6	290
50	9	230
51	8	540
52	9	490
53	9	300
54	8	350
55	6	2200
56	4	2400
57	12	18
58	6	500
59	4	52
80	15	63
81	16	43
82	12	49
83	18	66

Sample	Cu ppm	Ni ppm
784	14	250
85	14	260
86	9	290
87	8	760
88	1	73
89	4	140
90	14	76
91	20	67
92	18	63
93	15	270
94	3	180
95	48	590
96	62	180
97	15	210

x - less than 1 ppm Cu

X-RAY ASSAY LABORATORIES LIMITED

DATE

August 20, 1970

CERTIFIED BY

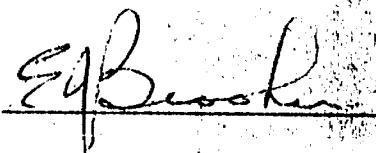

X-RAY ASSAY LABORATORIES

LIMITED

45 LESMILL ROAD

DON MILLS ONTARIO

445-5755

Certificate of Analysis

NO. 5106

TO. Mespi Mines Limited,
80 Richmond St. W. Suite 401,
TORONTO, 1 Ontario.

RECEIVED July 31, 1970

INVOICE NO. 6066

SAMPLE(S) OF soils

SUBMITTED TO US SHOW RESULTS AS FOLLOWS:

Sample	Cu ppm	Ni ppm	Sample	Cu ppm	Ni ppm
678	10	460	709	7	59
79	10	150	10	8	67
80	4	62	11	9	73
81	4	86	12	17	115
82	9	470	13	11	105
83	6	59	14	12	105
84	4	130	15	14	115
85	7	1100	16	10	88
86	12	46	17	18	150
87	6	560	18	5	330
88	18	46	19	3	67
89	13	73	20	6	350
90	7	125	21	16	160
91	6	29	22	6	450
92	3	195	23	12	58
95	3	850	24	12	62
97	2	33	25	4	140
98	14	120	26	10	200
99	13	105	27	11	220
700	18	79	28	4	460
01	15	78	29	8	53
02	12	63	30	9	50
03	14	15	31	16	74
705-8N-16E	16	120	32	19	83
705-9N-16E	11	105	33	2	65
706	8	43	34	10	50
07	6	41	35	14	33
08	6	54	36	14	48

X-RAY ASSAY LABORATORIES LIMITED

DATE August 20, 1970

CERTIFIED BY

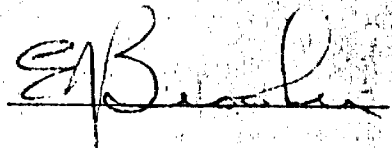

X-RAY ASSAY LABORATORIES

LIMITED

45 LESMILL ROAD

DON MILLS ONTARIO

445-5755

Certificate of Analysis

NO. 5199

TO. Mespi Mines Limited,
80 Richmond Street West, Suite 401,
TORONTO, Ontario.

RECEIVED August 31, 1970

INVOICE NO. 6156

SAMPLE(S) OF S. Core

SUBMITTED TO US SHOW RESULTS AS FOLLOWS:

Sample No.	% Ni	Sample No.	% Ni	Pt oz./ton*
<i>L-2</i> B-312 10-35	0.27	<i>CL-1</i> B-340 219-244	0.28	
313 35-60	0.28	341 145-170	0.31	
314 60-80	0.28	342 50-74	0.31	
315 80-105	0.29	343 344-369	0.30	
316 105-130	0.29	344 444-469	0.31	
317 130-154	0.28	345		Nil
318 154-179	0.29	346		Nil
319 179-204	0.27			
320 204-229	0.28			
321 229-253	0.27			
322 253-277	0.28			
323 277-302	0.27			
324 302-326	0.20			
325 326-350	0.15			
326 350-374	0.18			
327 374-399	0.02			
<i>L-3</i> 328 6-31	0.30			
329 31-51	0.31			
330 51-74	0.29			
331 74-99	0.28			
332 99-125	0.28			
333 125-150	0.29			
334 150-175	0.29			
335 175-200	0.28			
336 200-225	0.25			
337 225-250	0.27			
338 250-275	0.29			
339 275-300	0.23			

* - Semi-quantitative analysis only.

X-RAY ASSAY LABORATORIES LIMITED

DATE Sept. 2, 1970

CERTIFIED BY

CODY TWP. M-270











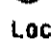

THE TOWNSHIP
CLAIM OF MAP
CARMAN

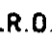
DISTRICT OF
COCHRANE

PORCUPINE
MINING DIVISION

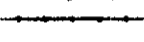
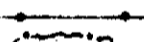
SCALE: 1-INCH 40 CHAINS

LEGEND

- PATENTED LAND 
- CROWN LAND SALE 
- LEASES 
- LOCATED LAND 
- LICENSE OF OCCUPATION 
- MINING RIGHTS ONLY 
- SURFACE RIGHTS ONLY 
- ROADS 
- IMPROVED ROADS 
- KING'S HIGHWAYS 
- RAILWAYS 
- POWER LINES 
- MARSH OR MUSKEG 
- MINES 
- CANCELLED 

NOTES

400' Surface Rights Reservation around all lakes and rivers.

Flooding Rights on Nighthawk Lake to the contour elevation 903.5' reserved to H.E.P.C.

DATE OF ISSUE

DEC 18 1970

ONT. DEPT. OF MINES
AND NORTHERN AFFAIRS

PLAN NO. M-266

ONTARIO
DEPARTMENT OF MINES
AND NORTHERN AFFAIRS

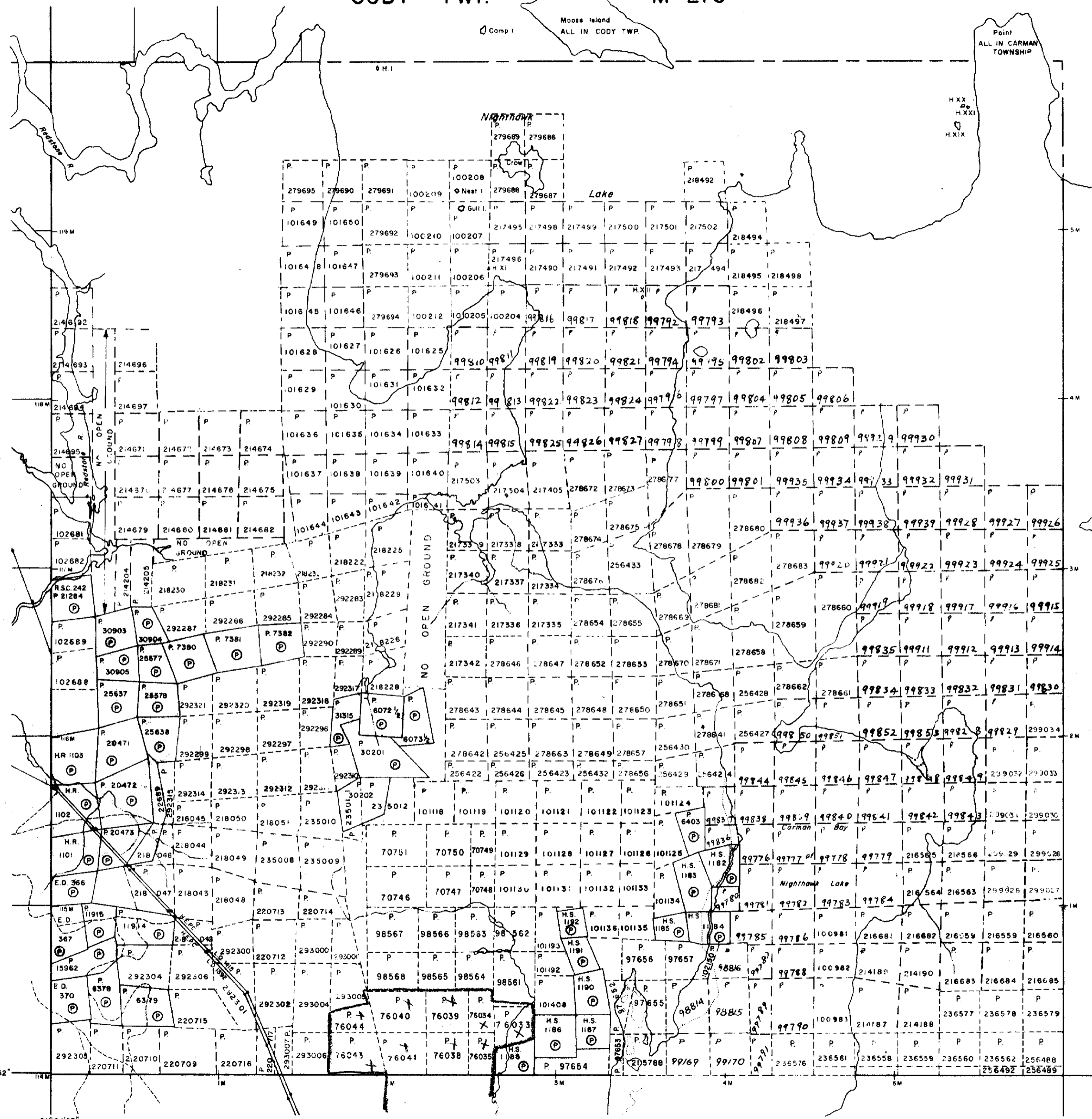

SHAW TWP. M-311

THOMAS TWP. M-312

LANGMUIR TWP. M-292



42A965E0010 2.126 CARMAN

Carman Twp. - M.266

THE TOWNSHIP OF

LANGMUIR

DISTRICT OF
TIMISKAMING

PORCUPINE
MINING DIVISION

SCALE: 1-INCH = 40 CHAINS

LEGEND

- PATENTED LAND Ⓟ
- CROWN LAND SALE Ⓢ
- LEASES Ⓛ
- LOCATED LAND Ⓛ
- LICENSE OF OCCUPATION Ⓛ
- MINING RIGHTS ONLY M.R.O.
- SURFACE RIGHTS ONLY S.R.O.
- ROADS —
- IMPROVED ROADS —
- KING'S HIGHWAYS —
- RAILWAYS —
- POWER LINES —
- MARSH OR MUSKES —
- MINES —
- CANCELLED —

NOTES

400' Surface Rights Reservation around all
mines and prospects.

Filing of plans on highways to be
at correct elevation unless reserved.

DATE OF ISSUE
FEB 5 1971
ONT. DEPT. OF MINES
AND NORTHERN AFFAIRS

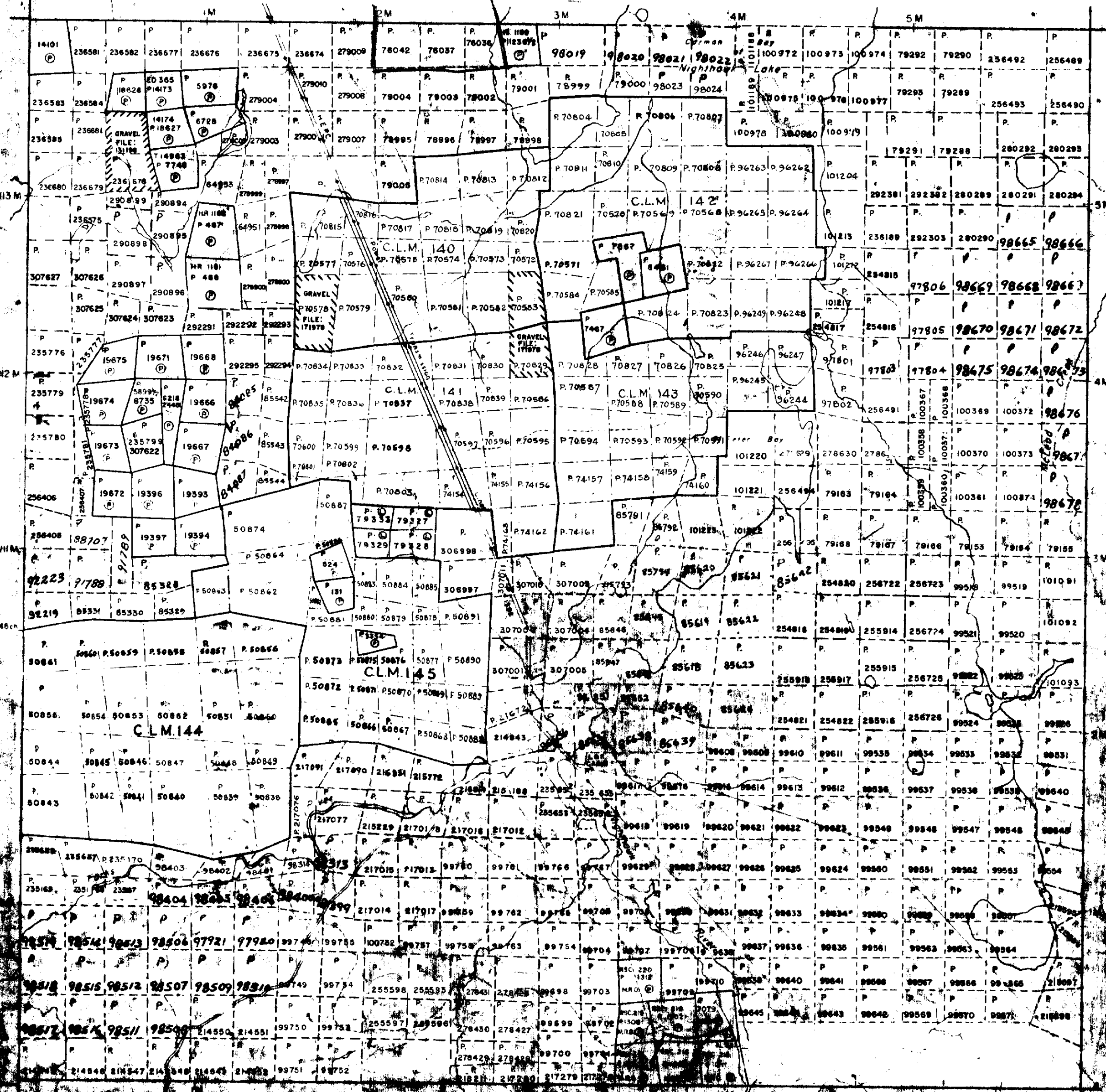

Eldorado Twp. - M.276

Blackstock Twp. - M.263

Franco Twp. - M.278



PLAN NO. M.266
ONTARIO
DEPARTMENT OF MINES
AND NORTHERN AFFAIRS

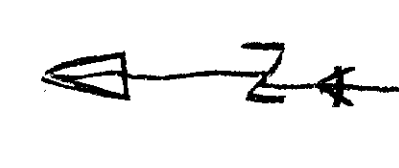
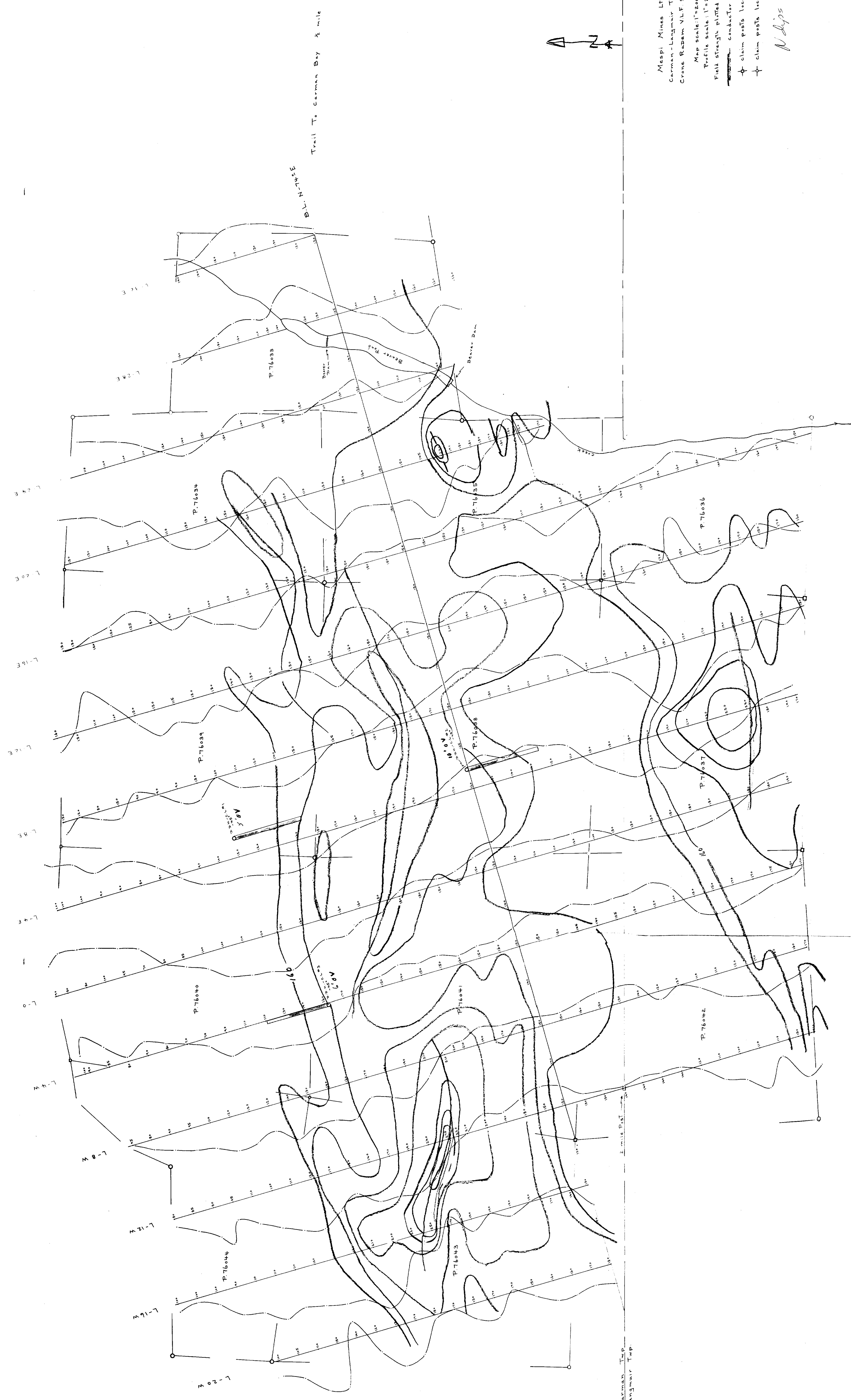

Meppi Mines Ltd.
 Carmen-Lagmar Tops.
 Crossed Radom VLF Survey
 Map scale: 1"=200'
 Profile scale: 1"=20'
 Field strength plotted at station
 --- conductor axis
 + claim posts located
 + claim posts location assumed
 N. Lips F./A.

J. Duncan Carr

July 1976



E20

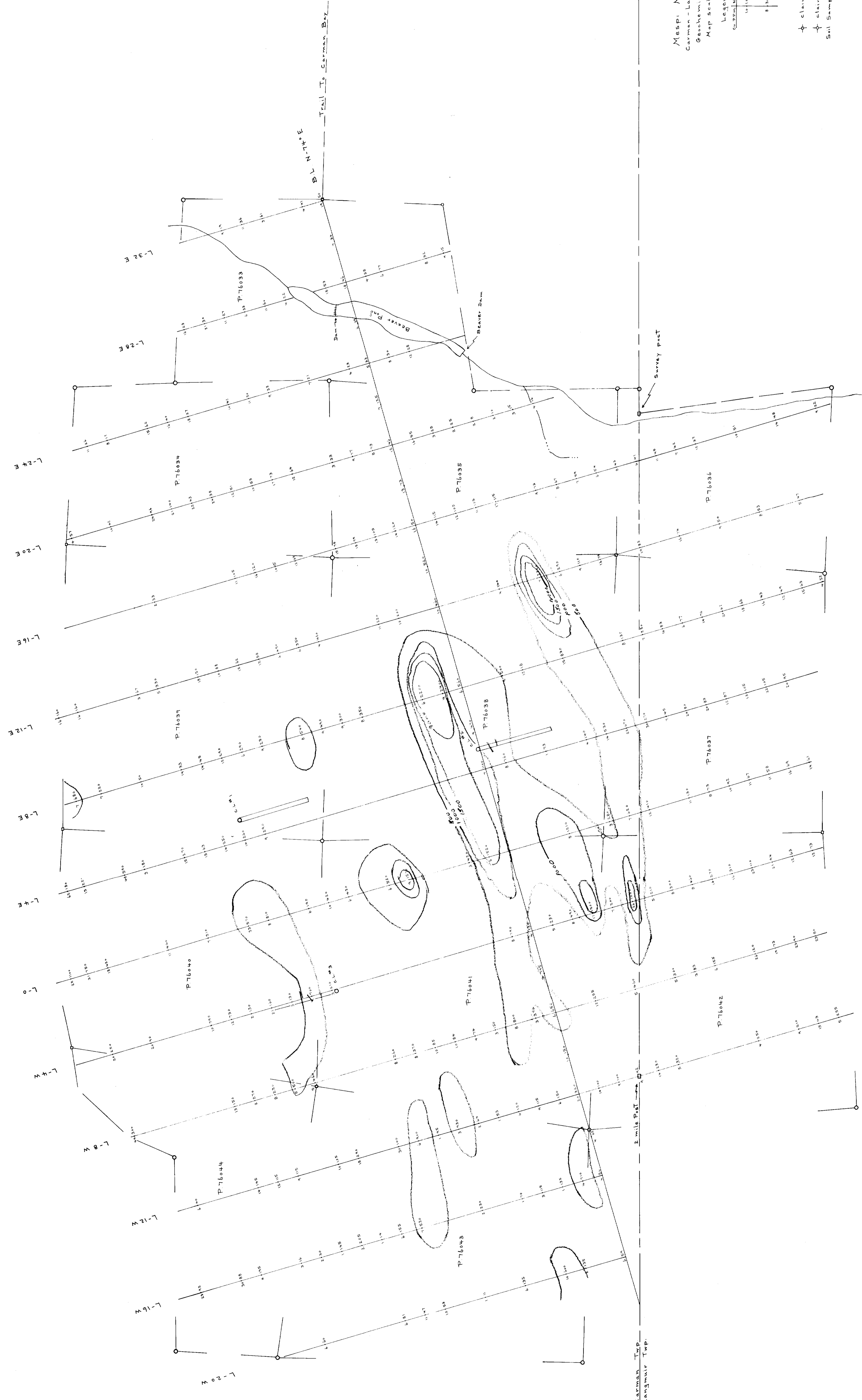

Mespi Mines Ltd.
 Carman-Langmuir Tops
 Geochemical Survey
 Map scale: 1:5000

Legend
 Claim posts located
 Claim posts assumed location
 Soil samples assayed by X-Ray Assay Lab

Don Mills, Ontario

Donna Cameron

Survey Date: July, 1970
 Drawn by: T.R.C.D.