

W9460.00210

2.15682

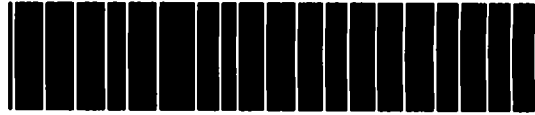

42A06SE0012 2.15682 LANGMUIR

010

**REPORT ON
STRIPPING AND EXCAVATING
OF
ELDORADO-LANGMUIR PROPERTY
IN
LANGMUIR TOWNSHIP
FOR
OUTOKUMPU MINES LTD.**

N.T.S.: 42-A/6

October 1994

Paul Davis,
Outokumpu Mines Ltd.

Introduction:

A trenching and stripping program was completed during August and September 1994, on an area in claims 1181894 and 1198994. The result of the stripping program was the uncovering of approximately 2000 m² of rocks that were previously covered by <1 to 2 metres of glacial overburden.

The property consists of 4 contiguous mining claims that represent 28 units, in Eldorado and Langmuir Townships, Porcupine Mining Division and are recorded as follows:

<u>Claim Number</u>	<u>Units</u>
1181894	16
1198994	3
1204410	6
1204506	3

Location and Access:

The property is located approximately 30 kilometres southeast of the City of Timmins, west of Nighthawk Lake and east of the Redstone River (Figures 1 and 2). Access is by all-weather road from South Porcupine and by winter bush roads and trails off of the main road.

Previous Work:

- 1959: Abacus Mines Limited completed geological, magnetometer and vertical loop electromagnetic surveys. Three diamond drill holes were drilled to test VLEM anomalies.
- 1965: Terrex Mines Limited completed a magnetometer survey and drilled seven diamond drill holes to test anomalies.
- 1966: Mining Corporation of Canada Ltd. completed magnetometer and vertical loop electromagnetic surveys and drilled three diamond drill holes in 1966 and 1967.
- 1967: Pyrotec Mining and Exploration Company Ltd. completed magnetometer and slingram electromagnetic surveys and drilled five diamond drill holes to test conductors.
- 1968: Urban Quebec Mines Limited completed magnetometer and McPhar horizontal loop electromagnetic surveys and drilled four diamond drill holes to test the HLEM anomalies.
- 1969: Falconbridge Nickel Mines Ltd. drilled seven diamond drill holes.
- 1969-1973: Canico completed a magnetometer survey over 73 claims and drilled seven diamond drill holes.
- 1973:
- 1978: Hudson Bay Exploration and Development Ltd. completed a Max Min survey and drilled one diamond drill hole.
- 1989: Granges Inc. completed a geological, magnetometer, horizontal loop electromagnetic, and geochemical assay surveys in conjunction with a trenching program that stripped a total of five trenches.

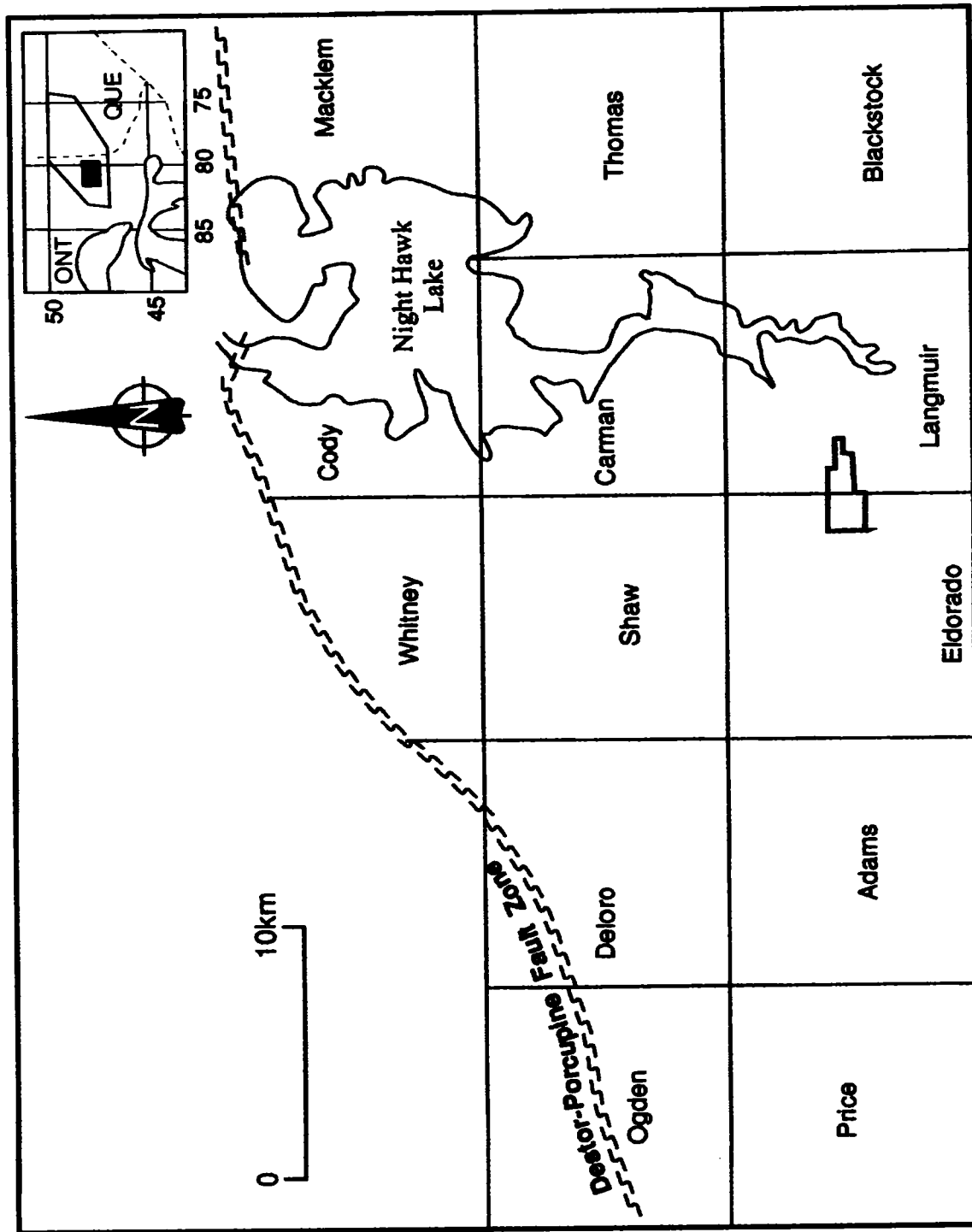
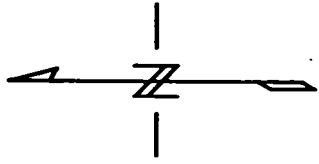

Figure 1: Location Map



Outokumpu Mines Ltd.
Eldorado-Langmuir Property

Claims Map
Trench Location

Langmuir and Eldorado Townships
scale 1:20,000
October, 1994

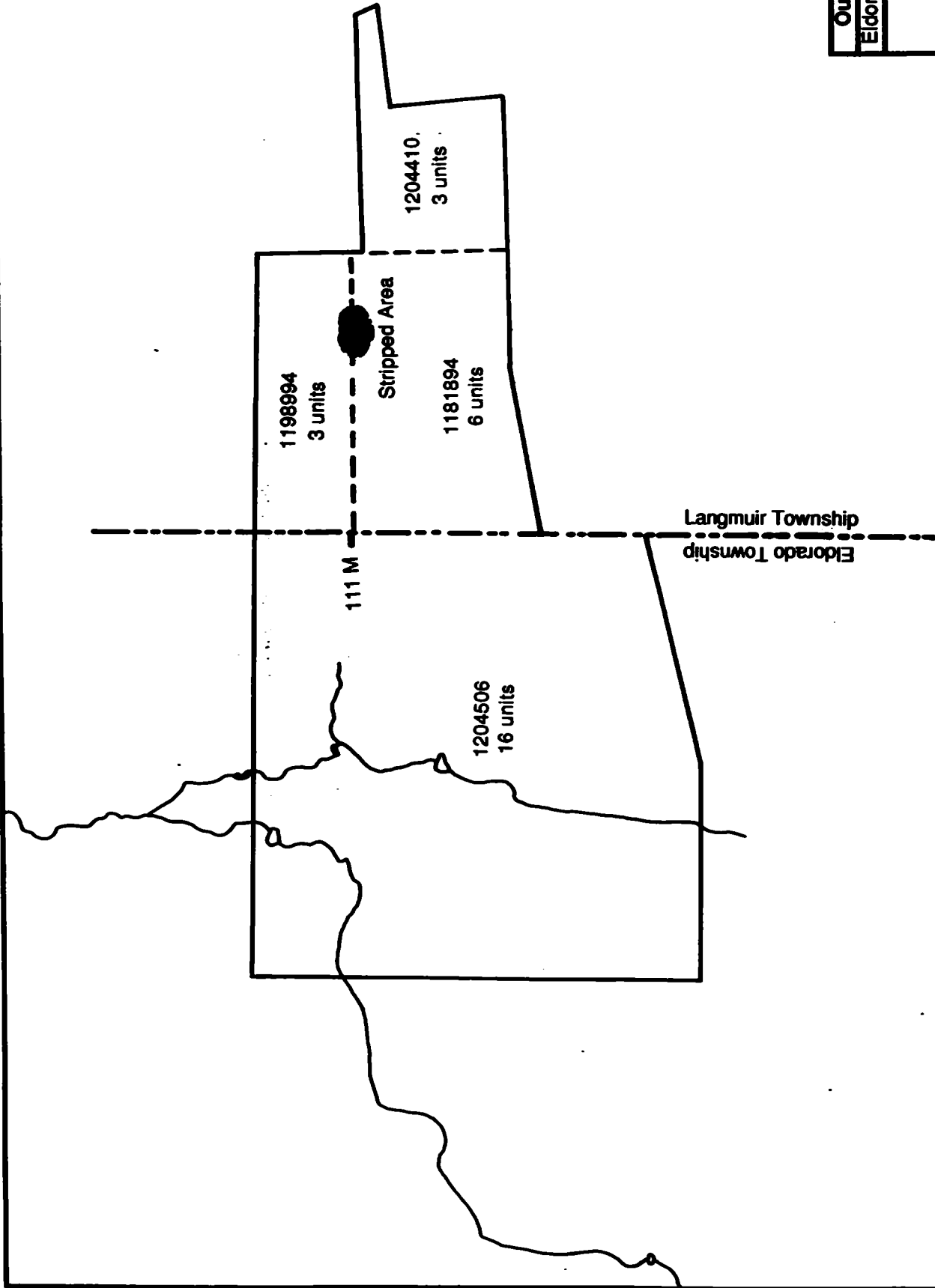

Figure 2:

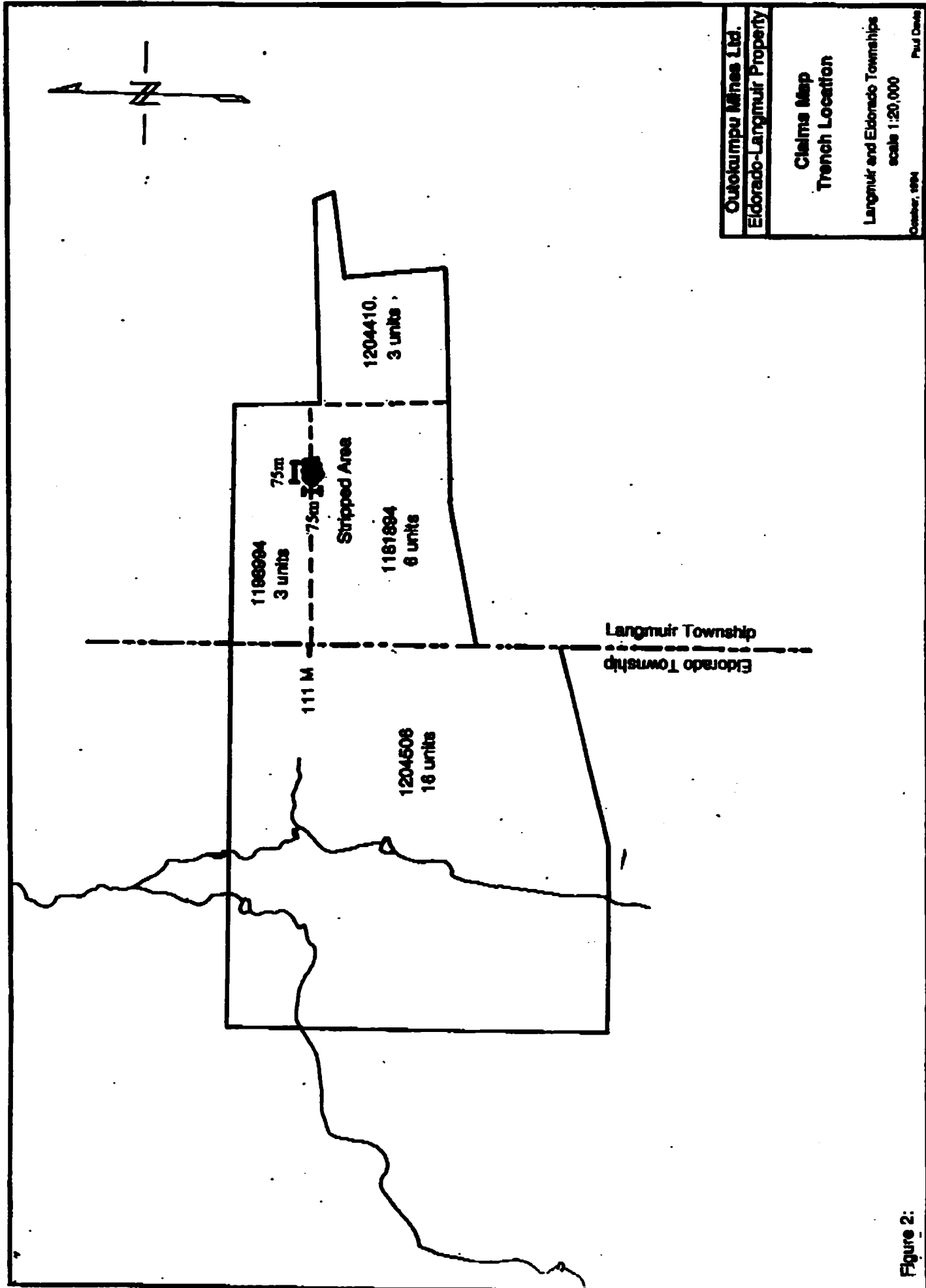



Figure 2:

Stripping and Excavating:

A large area was stripped and excavated to expose the geological contacts associated with the Galata nickel showing in Langmuir Township (Figure 2). A total area of approximately 2000 m² of overburden was stripped, to expose the bedrock, and mapped from August 30th to September 22nd, 1994. The stripping was successful in exposing a large percentage of the bedrock in the vicinity of the showing and resulted in a better understanding of the volcanic relationships in the area.

Excavating of the area was completed by Larchex Inc. of Timmins with a 690 John Deer excavator, a Muskeg Mounted Backhoe, and Wajax mark 3 and Honda high pressure pumps. Mapping of the bedrock exposures was completed by Thomas Schuster and Phil Vicker (Figure 3) at a scale of 1:500 and includes the geological contacts and a preliminary structural analysis. Note that sulfide mineralization occurs at the contact of a peridotite cumulate and a pillowed dacite.

October 4, 1994
Date

Paul Davis,
Exploration Geologist,
Outokumpu Mines Ltd.

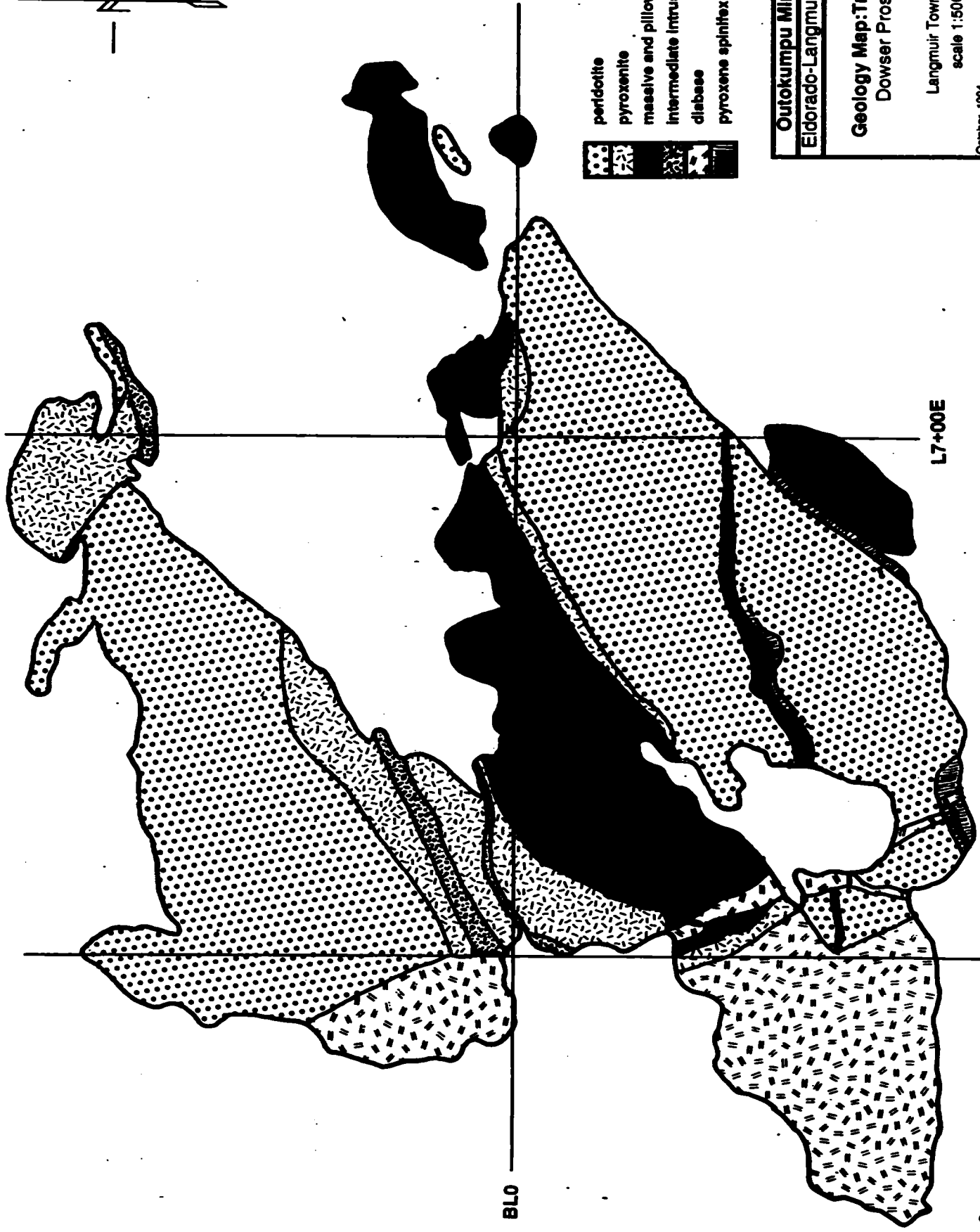
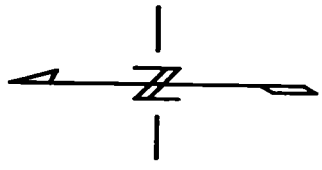

- peridotite
- pyroxenite
- massive and pillowed dacites
- intermediate intrusions
- diabase
- pyroxene spinifex

Outokumpu Mines Ltd.
Eldorado-Langmuir Property

Geology Map: Trenching
Dowser Prospect

Langmuir Township
scale 1:500

October, 1994 Paul Davis

Figure 3:



LARCHEX Inc.
MINING EXPLORATION
 PHONE 268-7793 FAX 268-6225

Office: 74 Roblin Ave.
 Mailing: P.O. Box 1394
 Timmins, Ontario P4N 7N2

2.15681⁴⁰

.....Outokumpu Mines Ltd.....

DATE OF INVOICE:September 27 1994.....

.....Paul Davis manager Timmins.....

CUSTOMER NO.:

.....Suite 12 637 Algonquin East Timmins.....

INVOICE RE: STRIPPING PROJECT in Langquire TWP			
Equipment used job duration			
690 John Deer EXCAVATOR 1 Yard incl. Fuels \$63 Per	104 5hr		\$6583.50
Wiax mark3 and 1000 hose incl. fuels \$90. Day	5days		\$ 450.00
Operators \$27. per Hr	550hrs		\$14850.00
Chain saw all incl.	19 days		\$475.00
List Operators	Sub		\$29943.50
Aagi Nissen	Total		\$32039.55
Jack Robert			
Erric Sears			
Thank You			
David E. Larche President			
LarcheX Inc.			

RECEIVED
 NOV 8 1994
 TIMMINS BRANCH

Terms: Net 15 days - 2% interest per month (24% per anum) charged on overdue accounts.



Report of Work Conducted After Recording Claim

Mining Act

Transaction Number
W9460. 0010

2.15681

Personal information collected on this form is obtained under the authority of the Mining Act. This information will be used for correspondence. Questions about this collection should be directed to the Provincial Manager, Mining Lands, Ministry of Northern Development and Mines, Fourth Floor, 159 Cedar Street, Sudbury, Ontario, P3E 8A5, telephone (705) 670-7284.

- Instructions:
- Please type or print and submit in duplicate.
 - Refer to the Mining Act and Regulations for re Recorder.
 - A separate copy of this form must be complete
 - Technical reports and maps must accompany
 - A sketch, showing the claims the work is assg



42A06SE0012 2.15682 LANGMUIR

900

Recorded Holder(s) Outokumpu Mines Ltd.		Client No. 178525
Address Box 360, Suite 4650, 1 First Canadian Place, Toronto, Ont M5X 1E1		Telephone No.
Mining Division Porcupine	Township/Area Langmuir	M or G Plan No. G-3226
Date Work Performed From: August 30, 1994		To: September 22, 1994

Work Performed (Check One Work Group Only)

Work Group	Type
Geotechnical Survey	
Physical Work, including Drilling	Excavating and Stripping of Bedrock Exposures
Rehabilitation	
Other Authorized Work	
Assays	
Assignment from Reserve	

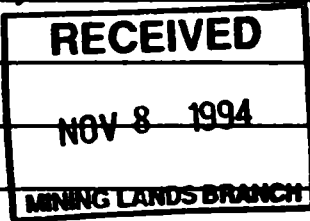

Total Assessment Work Claimed on the Attached Statement of Costs \$ **29,475⁰⁰**

Note: The Minister may reject for assessment work credit all or part of the assessment work submitted if the recorded holder cannot verify expenditures claimed in the statement of costs within 30 days of a request for verification.

Persons and Survey Company Who Performed the Work (Give Name and Address of Author of Report)

Name	Address
Paul Davis (Author of Report)	Outokumpu Mines Ltd., P.O. Box 1123, Timmins, Ont. P4N 7H9
Doc Locke, Locher Inc.	P.O. Box 1394, Timmins, Ont. P4N 7N2
See attached invoice for list of operators	

(attach a schedule if necessary)

Certification of Beneficial Interest * See Note No. 1 on reverse side

I certify that at the time the work was performed, the claims covered in this work report were recorded in the current holder's name or held under a beneficial interest by the current recorded holder.	Date	Recorded Holder or Agent (Signature)
--	------	--------------------------------------

Certification of Work Report

I certify that I have a personal knowledge of the facts set forth in this Work report, having performed the work or witnessed same during and/or after its completion and annexed report is true.		
Name and Address of Person Certifying Paul Davis, Outokumpu Mines Ltd., P.O. Box 1123, Timmins, Ont., P4N 7H9		
Telephone No. (705) 264-5024	Date October 4, 1994	Certified By (Signature) Paul

For Office Use Only

Total Value Cr. Recorded \$29,475.	Date Recorded	Mining Recorder	
	Deemed Approval Date JAN. 2, 1995	Date Approved	
	Date Notice for Amendments Sent		



Ministry of
Northern Development
and Mines

Ministère du
Développement du Nord
et des mines

**Statement of Costs
for Assessment Credit**

**État des coûts aux fins
du crédit d'évaluation**

Mining Act/Loi sur les mines

Transaction No / N° de transaction
W9460.0010

2. 15681

Personal information collected on this form is obtained under the authority of the Mining Act. This information will be used to maintain a record and ongoing status of the mining claim(s). Questions about this collection should be directed to the Provincial Manager, Minings Lands, Ministry of Northern Development and Mines, 4th Floor, 159 Cedar Street, Sudbury, Ontario P3E 6A5, telephone (705) 670-7284.

Les renseignements personnels contenus dans la présente formule sont recueillis en vertu de la Loi sur les mines et serviront à tenir à jour un registre des concessions minières. Adresser toute question sur la collecte de ces renseignements au chef provincial des terrains miniers, ministère du Développement du Nord et des Mines, 159, rue Cedar, 4^e étage, Sudbury (Ontario) P3E 6A5, téléphone (705) 670-7284.

1. Direct Costs/Coûts directs

Type	Description	Amount Montant	Totals Total global
Wages Salaires	Labour Main-d'oeuvre	14,850 ⁰⁰	
	Field Supervision Supervision sur le terrain		11,150 ⁰⁰
Contractor's and Consultant's Fees Droits de l'entrepreneur et de l'expert- conseil	Type		
Supplies Used Fournitures utilisées	Type		
Equipment Rental Location de matériel	Type		
	See Attached Invoice for Specific equipment.	14,508 ⁰⁰	
Total Direct Costs Total des coûts directs			29,508⁰⁰

2. Indirect Costs/Coûts indirects

** Note: When claiming Rehabilitation work indirect costs are not allowable as assessment work. Pour le remboursement des travaux de réhabilitation, les coûts indirects ne sont pas admissibles en tant que travaux d'évaluation.

Type	Description	Amount Montant	Totals Total global
Transportation Transport	Type		
Food and Lodging Nourriture et hébergement			
Mobilization and Demobilization Mobilisation et démobilisation	Float mob and Demob	955 ⁰⁰	
Sub Total of Indirect Costs Total partiel des coûts indirects			955⁰⁰
Amount Allowable (not greater than 20% of Direct Costs) Montant admissible (n'excedant pas 20 % des coûts directs)			
Total Value of Assessment Credit (Total of Direct and Allowable indirect costs)			30,463⁰⁰

Note: The recorded holder will be required to verify expenditures claimed in this statement of costs within 30 days of a request for verification. If verification is not made, the Minister may reject for assessment work all or part of the assessment work submitted.

Note: Le titulaire enregistré sera tenu de vérifier les dépenses demandées dans le présent état des coûts dans les 30 jours suivant une demande à cet effet. Si la vérification n'est pas effectuée, le ministre peut rejeter tout ou une partie des travaux d'évaluation présentés.

Filing Discounts

1. Work filed within two years of completion is claimed at 100% of the above Total Value of Assessment Credit.
2. Work filed three, four or five years after completion is claimed at 50% of the above Total Value of Assessment Credit. See calculations below:

Total Value of Assessment Credit	Total Assessment Claimed
	x 0.50 =

Remises pour dépôt

1. Les travaux déposés dans les deux ans suivant leur achèvement sont remboursés à 100 % de la valeur totale susmentionnée du crédit d'évaluation.
2. Les travaux déposés trois, quatre ou cinq ans après leur achèvement sont remboursés à 50 % de la valeur totale du crédit d'évaluation susmentionné. Voir les calculs ci-dessous.

Valeur totale du crédit d'évaluation	Évaluation totale demandée
	x 0,50 =

Certification Verifying Statement of Costs

I hereby certify:
that the amounts shown are as accurate as possible and these costs were incurred while conducting assessment work on the lands shown on the accompanying Report of Work form.

that as Exploration Geologist I am authorized
(Recorded Holder, Agent, Position in Company)

to make this certification

Attestation de l'état des coûts

J'atteste par la présente :
que les montants indiqués sont le plus exact possible et que ces dépenses ont été engagées pour effectuer les travaux d'évaluation sur les terrains indiqués dans la formule de rapport de travail ci-joint.

Et qu'à titre de _____ je suis autorisé
(titulaire enregistré, représentant, poste occupé dans la compagnie)

à faire cette attestation.

Signature _____ Date
Paul L. October 4, 1994



Ontario

Ministry of
Northern Development
and Mines

Ministère du
Développement du Nord
et des Mines

Geoscience Approvals Office
933 Ramsey Lake Road
6th Floor
Sudbury, Ontario
P3E 6B5

Telephone: (705) 670-5853
Fax: (705) 670-5863

November 15, 1994

Our File: 2.15682
Transaction #: W9460.00210

Mining Recorder
Ministry of Northern Development
and Mines
60 Wilson Avenue,
1st Floor
Timmins, Ontario
P4N 2S7

Dear Sir/Madam:

**Subject: APPROVAL OF ASSESSMENT WORK CREDITS ON MINING CLAIMS
P.1181894 & 1198994 IN LANGUIR TOWNSHIP**

Assessment work credits have been approved as outlined on the report of work form for the submission. The credits have been approved under Section 10, Physical, Mining Act Regulations.

The approval date is November 15, 1994.

If you have any questions regarding this correspondence, please contact Lucille Jerome at (705) 670-5861.

ORIGINAL SIGNED BY:

Ron C. Gashinski
Senior Manager, Mining Lands Section
Mining and Land Management Branch
Mines and Minerals Division

LJ/jl
Enclosures:

cc: Resident Geologist
Timmins, Ontario

Assessment Files Library
Sudbury, Ontario

REFERENCES

AREAS WITHDRAWN FROM DISPOSITION

- M.R.O. - MINING RIGHTS ONLY
- S.R.O. - SURFACE RIGHTS ONLY
- M.+S. - MINING AND SURFACE RIGHTS

Description Order No. Date Disposition File

Re Application pending under
PLA - surface rights withdrawn
Re-opened NRO 34 85

NOTES

THIS TOWNSHIP LIES WITHIN THE MUNICIPALITY OF THE CITY OF TIMMINS

FLOODING RIGHTS ON NIGHTHAWK LAKE TO THE CONTOUR
ELEVATION 950.0' ADJUSTED TO 941.14 Meters.

THE INFORMATION THAT APPEARS ON THIS MAP HAS BEEN COMPILED FROM VARIOUS SOURCES, AND ACCURACY IS NOT GUARANTEED. THOSE WISHING TO STAKE MINING CLAIMS SHOULD CONSULT WITH THE MINING RECORDS, MINISTRY OF NORTHERN DEVELOPMENT AND MINES, FOR ADDITIONAL INFORMATION ON THE STATUS OF THE LANDS SHOWN HEREON.

CARMAN TP.

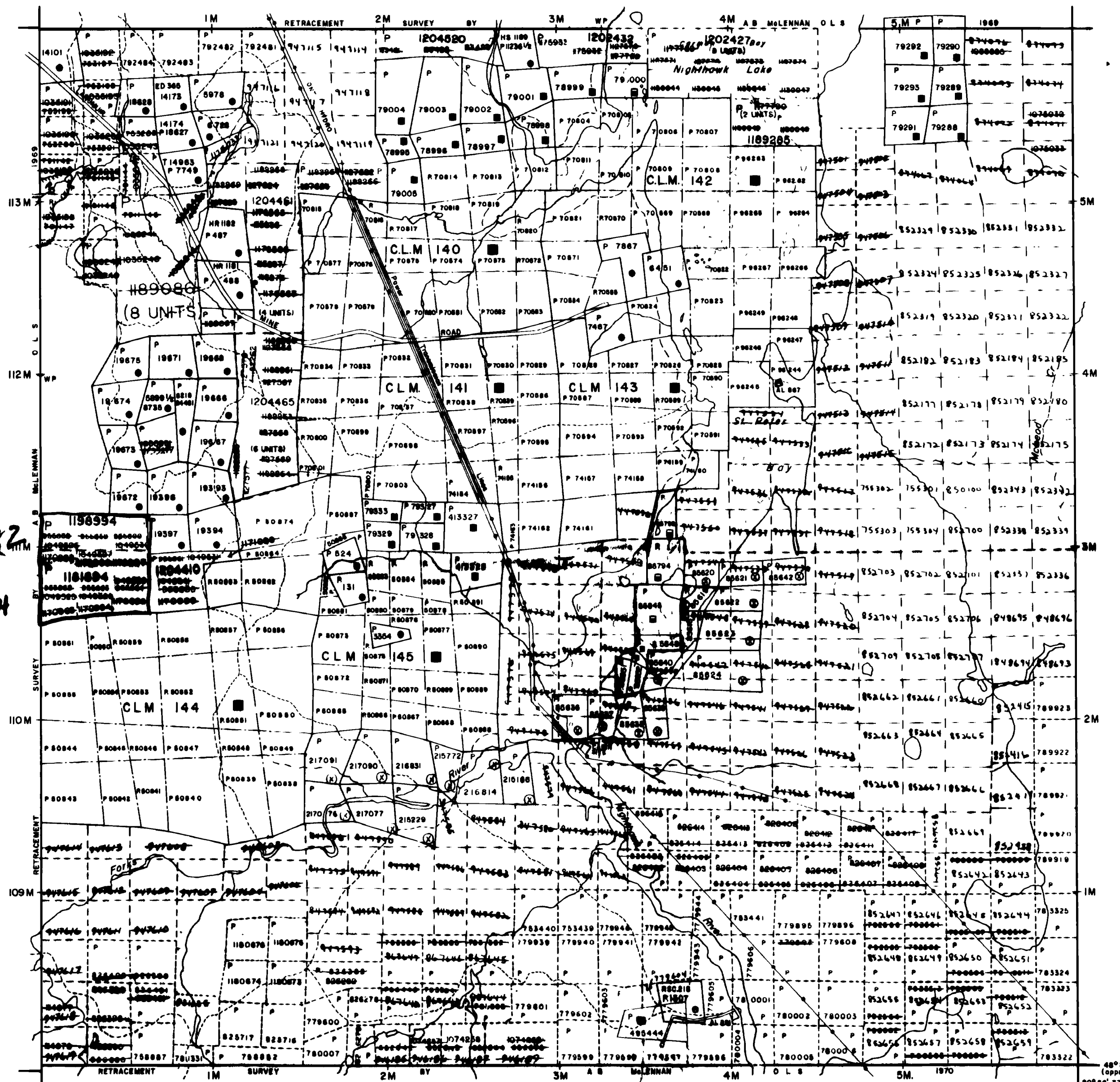

FALLON TP.

LEGEND

- HIGHWAY AND ROUTE No.
- OTHER ROADS
- TRAILS
- SURVEYED LINES
- TOWNSHIPS, BASE LINES, ETC.
- LOTS, MINING CLAIMS, PARCELS, ETC.
- UNSURVEYED LINES
- LOT LINES
- PARCEL BOUNDARY
- MINING CLAIMS ETC.
- RAILWAY AND RIGHT OF WAY
- UTILITY LINES
- NON-PERENNIAL STREAM
- FLOODING OR FLOODING RIGHTS
- SUBDIVISION OR COMPOSITE PLAN
- RESERVATIONS
- ORIGINAL SHORELINE
- MARSH OR MUSKEG
- MINES
- TRAVERSE MONUMENT

DISPOSITION OF CROWN LANDS

TYPE OF DOCUMENT	SYMBOL
PATENT, SURFACE & MINING RIGHTS	●
" SURFACE RIGHTS ONLY	○
" MINING RIGHTS ONLY	◐
LEASE, SURFACE & MINING RIGHTS	■
" SURFACE RIGHTS ONLY	◼
" MINING RIGHTS ONLY	◻
LICENCE OF OCCUPATION	▼
ORDER-IN-COUNCIL	OC
RESERVATION	⊙
CANCELLED	⊖
SAND & GRAVEL	⊗

NOTE: MINING RIGHTS IN PARCELS PATENTED PRIOR TO MAY 6 1912, VESTED IN ORIGINAL PATENTEE BY THE PUBLIC LANDS ACT, R.S.O. 1970, CHAP. 300, SEC. 63, SUBSEC. 1

SCALE 1 INCH = 40 CHAINS

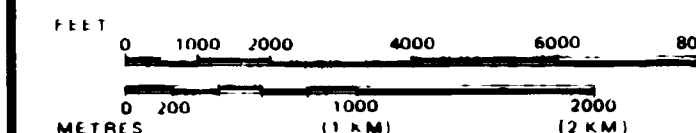

TOWNSHIP

LANGMUIR

M.N.R. ADMINISTRATOR
TIMMINS
MINING DIVISION
PORCUPINE
LAND TITLES / REGISTRY DIVISION
COCHRANE

RECEIVED
NOV 8 1994
MINING LANDS BRANCH

Ontario Ministry of Natural Resources Land Management Branch

Date MARCH, 1985

Number
G-3226

