



42A06SE0027 33 LANGMUIR

010

Diamond Drilling

Township OF LANGMUIR

Report NO: 33

Work performed by: A. Comisson in Trust

Claim NO	Hole NO	Footage	Date	Note
P 217077	1	1,297'	Aug/70	(1)
	2	835'	Aug/70	(1)
	3	500'	Aug/70	(1)

Notes:

(1) #174/70



THE MINING ACT - DEPARTMENT OF MINES
DIAMOND DRILLING LOG

Start a new page for every new hole, but fill in top portion of form only on first page for each hole.

FILL IN ON EVERY PAGE

HOLE NO. 1 PAGE NO. 1

DRILLING COMPANY BRADLEY BROS. DIAMOND DRILLING		COLLAR ELEVATION ---	BEARING OF HOLE FROM TRUE NORTH N 15° E.	TOTAL FOOTAGE 1297.0	DIP OF HOLE AT collar 45°	LOCATION OF HOLE IN RELATION TO A FIXED POINT ON THE CLAIM 80° East) 140° North) Post #3 Claim No. P-217077	MAP REFERENCE NO.	CLAIM NO. P-217077
DATE HOLE STARTED August 13, 1970	DATE COMPLETED August 24, 1970	DATE LOGGED August 24/70	LOGGED BY Hugh Carlson				LOCATION (Tp., Lot, Con. OR Lat. and Long.) Langmuir Township	
EXPLORATION CO., OWNER OR OPTIONEE Yellow Knife Base Metals Co. Ltd.		DATE SUBMITTED Oct. 25, 1970	SUBMITTED BY (Signature) Jim Zimmerman				PROPERTY NAME Yellow Knife Base Metals Co. Ltd.	

FOOTAGE		ROCK TYPE	DESCRIPTION Colour, grain size, texture, minerals, alteration, etc.	PLANAR FEATURE ANGLE *	CORE SPECIMEN FOOTAGE †	YOUR SAMPLE NUMBER	SAMPLE FOOTAGE		SAMPLE LENGTH	ASSAYS ‡	
FROM	TO						FROM	TO			
0.0	20.0	Casing									
20.0	326.0	Serpentinite	Fine-grained, grey-green, some carbonate stringers, minor sulphides								
326.0	337.8	Graphite-shist	Black, highly contacted, some carbonate stringers, minor sulphides								
336.8	345.5	Tryo-dike	Black, massive, micaceous, 5% sulphides (pyrite and pyrrhotite)								
345.5	372.1	Serpentinite	Fine-grained, massive, light green								
372.1	373.0	Graphite-shist	Black, shistose	35°							
373.0	584.0	Serpentinite	Fine-grained, grey-green, locally chloritized and serpentized								
584.0	638.0	Volcanic Tuff	Fine-grained, grey, locally chloritized								
638.0	652.5	Serpentinite	Fine-grained, grey-green								
652.5	659.0	Volcanic tuff	Similar to 584.0 - 638.0								
659.0	667.5	Serpentinite	Similar to 540.5 - 584.0								
667.5	700.0	Volcanic tuff	Similar to 584.0 - 638.0								
700.0	1176.5	Serpentinite	Fine-grained, grey-green, massive								
1176.5	1228.0	Porphyry	Grey, massive, feldspar phenocrysts								
1228.0	1252.5	Serpentinite	Similar to 540.5 - 584.0								
1252.5	1297.0	Volcanic tuff	Grey, variably chloritized and serpentized, indefinite banding	75°							
	1297.0		End of Hole								

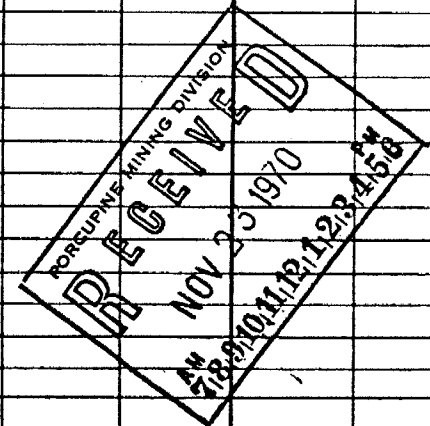

James R. Zimmerman

* For features such as foliation, bedding, schistosity, measured from the long axis of the core.



DIAMOND DRILLING LOG

Start a new page for every new hole, but fill in top portion of form only on first page for each hole.

FILL IN ON EVERY PAGE

HOLE NO. 2 PAGE NO. 1

DRILLING COMPANY Bradley Bros. Diamond Drilling Ltd.		COLLAR ELEVATION --	BEARING OF HOLE FROM TRUE NORTH N 15° E	TOTAL FOOTAGE 835'	DIP OF HOLE AT collar - 60	LOCATION OF HOLE IN RELATION TO A FIXED POINT ON THE CLAIM 80' East) 140' North) Post #3 Claim No. P-217077	MAP REFERENCE NO.	CLAIM NO. P-217077	
DATE HOLE STARTED August 27, 1970	DATE COMPLETED August 27, 1970	DATE LOGGED August 27	LOGGED BY E. Bozinet		200 ft - 63		LOCATION (Tp., Lot, Con. OR Lat. and Long.) Langmuir Township	PROPERTY NAME Yellow Knife Base Metals Co. Ltd.	
EXPLORATION CO., OWNER OR OPTIONEE Yellow Knife Base Metals Co. Ltd.		DATE SUBMITTED Oct. 25	SUBMITTED BY (Signature) Jim Zimmerman		400 ft - 64				
					500 ft - 64				

FOOTAGE FROM	TO	ROCK TYPE	DESCRIPTION Colour, grain size, texture, minerals, alteration, etc.	PLANAR FEATURE ANGLE *	CORE SPECIMEN FOOTAGE †	YOUR SAMPLE NUMBER	SAMPLE FOOTAGE		SAMPLE LENGTH	ASSAYS †		
							FROM	TO				
0.0	10.0	Casing										
10.0	554.5	Serpentinite	Dark grey to dark green, minor fine-sulphides									
554.5	558.5	Lamprophyre dike	Brown, fine-grained									
558.5	562.0	Serpentinite	Same as 10.0 - 554.5									
563.0	566.5	Lamprophyre dike	As above									
566.5	568.0	Serpentinite	As above									
568.0	569.8	Lamprophyre dike	As above									
569.8	578.0	Serpentinite	As above									
578.0	578.5	Lamprophyre dike	As above									
578.5	586.5	Serpentinite	As above									
586.5	587.5	Lamprophyre dike	As above									
587.5	590.3	Serpentinite	As above									
590.3	591.0	Lamprophyre dike	As above									
591.0	612.5	Serpentinite	Light grey-green, some graphitic slips at 603.5 - 604.5	30°								
612.5	624.0	Tuff	Grey, some bands of graphitic shist									
624.0	775.0	Serpentinite	Similar to 10.0 - 554.5									
775.0	778.5	Diabase dike	Fine-grained, brown									
778.5	794.5	Serpentinite	Grey-green									
794.5	799.0	Diabase dike	Brown, fine-grained									
799.0	807.0	Serpentinite	Fine grained, locally brecciated, minor sulphides									
807.0	815.5	Dike	Feldspathic	15°								
815.5	835.0	Serpentinite	Similar to 10.0 - 554.5, fairly massive									
	835.0	End of Hole										

Jim R. Zimmerman

* For features such as foliation, lineation, schistosity, measured from the long axis of the core.

† Additional credit available. See Assessment Work Regulations.



THE MINING ACT - DEPARTMENT OF MINES
DIAMOND DRILLING LOG

Start a new page for every new hole, but fill in top portion of form only on first page for each hole.

FILL IN ON EVERY PAGE

HOLE NO. **3** PAGE NO. **1**

DRILLING COMPANY Bradley Bros. Diamond Drilling Ltd.		COLLAR ELEVATION --	BEARING OF HOLE FROM TRUE NORTH S 15° W	TOTAL FOOTAGE 500'	DIP OF HOLE AT collar - 70	LOCATION OF HOLE IN RELATION TO A FIXED POINT ON THE CLAIM 95' South) 120' West) Post #1 Claim P-217077	MAP REFERENCE NO.	CLAIM NO. P-217077
DATE HOLE STARTED August 29, 1970	DATE COMPLETED August 31, 1970	DATE LOGGED Aug. 31, 1970	LOGGED BY H. D. Carlson		100 ft - 72		LOCATION (Tp., Lot, Con. OR Lat. and Long.) Langmuir Township	PROPERTY NAME Yellow Knife Base Metals Co. Ltd.
EXPLORATION CO., OWNER OR OPTIONEE Yellow Knife Base Metals Co. Ltd.		DATE SUBMITTED Oct. 25, 1970	SUBMITTED BY (Signature) Jim Zimmerman		200 ft - 73			
					300 ft - 73			
					400 ft - 73			

FOOTAGE		ROCK TYPE	DESCRIPTION Colour, grain size, texture, minerals, alteration, etc.	PLANAR FEATURE ANGLE *	CORE SPECIMEN FOOTAGE †	YOUR SAMPLE NUMBER	SAMPLE FOOTAGE		SAMPLE LENGTH	ASSAYS †	
FROM	TO						FROM	TO			
0.0	22.0	Casing									
22.0	187.5	Diabase	Dark grey, medium to fine-grained, dense, massive								
187.5	287.5	Serpentinite	Dark greenish-grey, massive, some talc - carbonate alteration								
287.5	294.8	Lamprophyre	Medium, grey, fine-grained, dense, massive, some small white feldspar phenocrysts.								
294.8	324.0	Serpentinite	As above								
324.0	329.0	Diabase dike	Brown, fine-grained, massive								
329.0	342.5	Serpentinite	As above								
342.5	353.5	Diabase	As above								
353.5	410.5	Serpentinite	As above								
410.5	461.5	Diabase	As above								
461.5	483.5	Serpentinite	As above								
483.5	489.0	Diabase	As above								
489.0	500.0	Serpentinite	As above								
	500.0	End of Hole									

Jim R. Zimmerman

* For features such as foliation, bedding, schistosity, measured from the long axis of the core.

† Additional credit available. See Assessment Work Regulations.

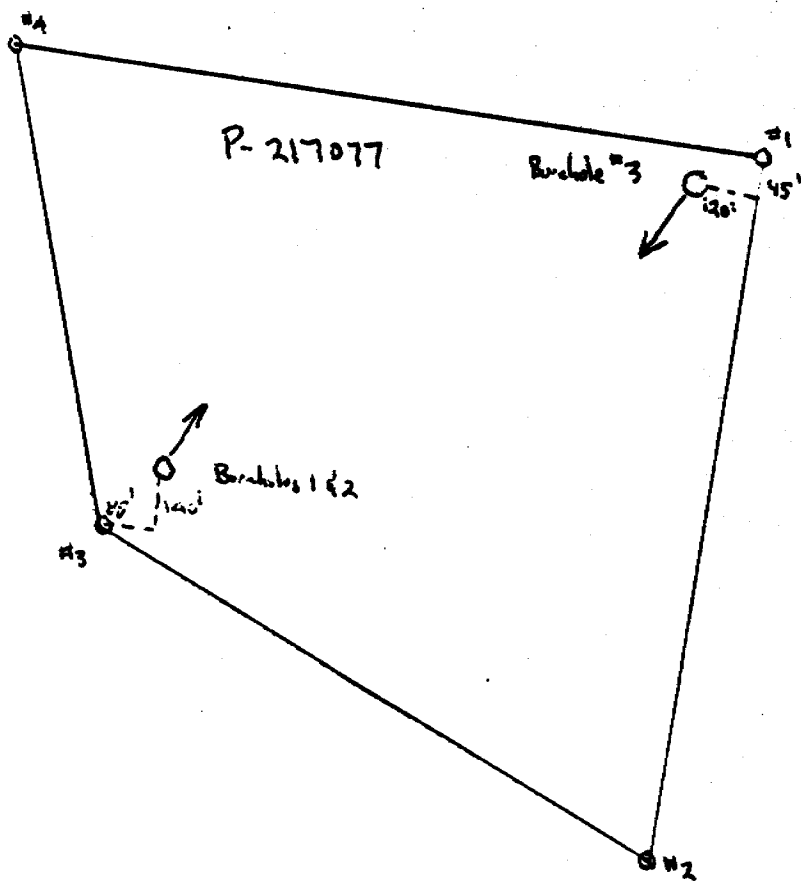

Langmuir Township
 Yellowknife Base Metals Ltd.
 Claim no P-217077



Scale 1"=400'

#174/70 Langmuir Tp
 A. Caminos in Trust