



42A06SE0049 2.8936 LANGMUIR

010

T.K. Filo
804-246 Roslyn Rd.
Winnipeg Man.
477-6166

Miss Susan Hurst.
Whitney Block, 6th Floor
Queens Park
Toronto Ont.
M7A 1W3

DEAR SUSAN,

Enclosed with this letter are copies of the cancelled cheques for assay done for claim # ~~792475~~ # 792475 in Carman Twp (File # 2.8936). The maps for the location of samples is enclosed in the geology report submitted and approved earlier. The approval of the geology report was in question last time I was speaking with you, but I was in Timmins last week and noted that you must have the geology report as it is marked approved in Timmins.

I trust that upon receipt of this material I will have 7 extra geology days and 6 assay days credited to claim # 792475. If this assumption is not correct please inform me as soon as possible

RECEIVED

APR 16 1986

MINING LANDS SECTION

Regards
T.K. Filo

M. KEAN RESOURCES INC.
BOX 2120,
TIMMINS, ONTARIO P4N 7X8

0621

Oct 10 1985

PAY TO THE ORDER OF MIN - EN Labeonitomer Ltd \$ 63.00

SUM OF sixty - three 00 / 100 DOLLARS

M. KEAN RESOURCES INC.

THE BANK OF NOVA SCOTIA
1 PINE ST.S.,
TIMMINS, ONTARIO
P4N 2J9

PER J. K. L.

⑈000621⑈ ⑆1072002⑆ 017840011⑈

⑈0000006300⑈

4776166

FOR DEPOSIT ONLY
TO THE CREDIT OF
WARNOCK HERSEY PROFESSIONAL SERVICES LTD

1985-01-01	02091-003
UNIVERSITY - U.S.	
SUCORSALE TRADE NEWMAN	
BANK OF CANADA	
02091-003	

117171329 126071244 15730465

J.K. FILO or S. MARSHALL
804 - 246 Roslyn Rd.
Winnipeg, Man. R3L 0H2

209

Nov 1 19 85

PAY TO THE ORDER OF

Warnock Hersey

\$33.00

thirty-three

~~100~~ DOLLARS

CANADIAN IMPERIAL BANK OF COMMERCE
55 Nassau Street
Winnipeg, Manitoba

DICA

Sheila Maudslap

2209 101017010 03 47930

0000003300

Warnock Hersey

HEAD OFFICE
SIEGE SOCIAL ... 128 Elmslie, LaSalle, Qué. H8R 1V8 — Tel. (514) 366-3100

ISSUING OFFICE ADDRESS:
ADRESSE DU BUREAU D'ÉMISSION:

1154 Sanford Street
Winnipeg, Manitoba

DATE October 8, 1985	CLIENT NO. 38680	OUR ORDER NO. - NOTRE NO. DE COMM. E 7541-7543	CODE 710-09	CLIENT'S ORDER NO. - NO. COMMANDE DU CLIENT
--------------------------------	----------------------------	----------------------------------------------------------	-----------------------	---------------------------------------------

INVOICED TO/FACTURÉ À

REPORTED TO/RAPPORT TRANSMIS À

Kevin Fild
804-246 Roslyn Road
Winnipeg, Manitoba

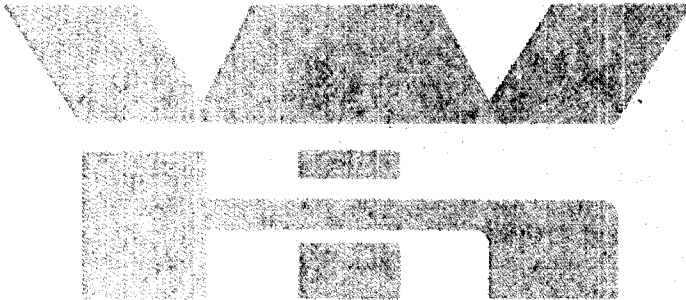
REPORT DATE DATE DU RAPPORT	REPORT NO. NO. DU RAPPORT	
		<p>3 Au. dets @ 9.00 27.00 3 preparations @ 2.00 6.00 TOTAL \$ 33.00</p>
		

REMIT PAYMENT TO: **WARNOCK HERSEY PROFESSIONAL SERVICES Ltd.**
FAIRE REMISE À: **LES SERVICES PROFESSIONNELS WARNOCK HERSEY Ltée**

PLEASE ATTACH COPY OF INVOICE TO YOUR REMITTANCE
VEUILLEZ INCLURE COPIE DE FACTURE AVEC VOTRE REMISE

**128 Elmslie Street
LA SALLE P.Q. H8R 1V8**

INVOICE NO. / FACTURE NO.
DEPT. **710 71486**

THIS ACCOUNT FOR PROFESSIONAL SERVICES IS DUE ON PRESENTATION • COMPTE DE SERVICES PROFESSIONNELS, EXIGIBLE SUR PRÉSENTATION
ALL OVERDUE ACCOUNTS SHALL BEAR INTEREST AT THE RATE OF 2% PER MONTH. (24% PER ANNUM)
UN INTÉRÊT DE 2% PAR MOIS, SERA CALCULÉ SUR LES COMPTES EN ARRÉRAGES. (24% PAR ANNÉE)

INVOICE

MIN-EN LABORATORIES LTD.
705 WEST 15TH STREET
NORTH VANCOUVER, B.C.
CANADA V7M 1T2

INVOICE No 0381B

DATE: SEPT 25/85

PHONE: (604) 980-5814 DR 988-4524
TELEX: 04-352828

TO : M. KEAN RESOURCE

TIMMINS, ONT.
P4N 2P4

FILE No: 52-043
PROJECT:

ATTENTION M. KEAN

QTY	DESCRIPTION	UNIT PRICE	AMOUNT
6	ASSAYS - AU	7.50	45.00
6	ASSAYS SAMPLE PREP	3.00	18.00
* TOTAL *			63.00

THESE ARE PROFESSIONAL SERVICES AND ARE PAYABLE WHEN RENDERED.
OVER 30 DAYS 2% INTEREST PER MONTH WILL BE CHARGED.

0621
Oct 10/85

MIN-EN Laboratories Ltd.

Specialists in Mineral Environments

705 WEST 1516 STREET NORTH VANCOUVER, B.C. CANADA V7W 1T2

PHONE: (604) 980-5814 OR (604) 988-4524

TELEX: 04-352828

CERTIFICATE OF ASSAY

COMPANY: M. KEAN RESOURCE INC.

FILE: 52-043

PROJECT:

DATE: SEPT. 24/85.

ATTENTION: MR. MARK KEAN

TYPE: ROCK ASSAY

We hereby certify that the following are assay results for samples submitted.

SAMPLE NUMBER	AU G/TONNE	AU OZ/TON
KF-1	.01	0.001
KF-2	.01	0.001
KF-6	.01	0.001
KF-7	.01	0.001
KF-8	.01	0.001
KF-9	.01	0.001

Certified by



MIN-EN LABORATORIES LTD.



42A06SE0049 2.8936 LANGMUIR

900

Mining Lands Section

File No 2.8936

Control Sheet

TYPE OF SURVEY _____ GEOPHYSICAL

_____ GEOLOGICAL

_____ GEOCHEMICAL

EXPENDITURE

MINING LANDS COMMENTS:

See file 2.8810 for plans.

S. Hurst

Signature of Assessor

April 21/86

Date

god

W.R. # 067/86 28936

Instructions: - Please type or print. - If number of mining claims traversed exceeds space on this form, attach a list. Note: - Only days credits calculated in the "Expenditures" section may be entered in the "Expend. Days Cr." columns. - Do not use shaded areas below.

Mining Act

Type of Survey(s) **PROSPECTING - ASSAYING** Township or Area **Laanmanan Carman Township**

Claim Holder(s) **MR. M. KEAN** Prospector's Licence No. **M-21054**

Address **P.O. Box 2120 Timmins Ont**

Survey Company **J.K. FILO** Date of Survey (from & to) **28 09 85** to **24 09 85** Total Miles of line Cut **N.A.**

Name and Address of Author (of Geo-Technical report) **J.K. FILO 804-246 Roslyn Rd. Winnipeg Man.**

Credits Requested per Each Claim in Columns at right

Mining Claims Traversed (List in numerical sequence)

Special Provisions	Geophysical	Days per Claim
For first survey: Enter 40 days. (This includes line cutting)	- Electromagnetic	
	- Magnetometer	
	- Radiometric	
For each additional survey: using the same grid: Enter 20 days (for each)	- Other	
	Geological	
	Geochemical	
Man Days	Geophysical	Days per Claim
Complete reverse side and enter total(s) here	- Electromagnetic	
	- Magnetometer	
	- Radiometric	
	- Other (PROSPECTING)	7
	Geological	7
	Geochemical	
Airborne Credits	Electromagnetic	Days per Claim
Note: Special provisions credits do not apply to Airborne Surveys.	Magnetometer	
	Radiometric	

Mining Claim			Mining Claim		
Prefix	Number	Expend. Days Cr.	Prefix	Number	Expend. Days Cr.
P	792475	6			
	792475	7			
act	792476	-			
	792477	-			
	792481	-			
	792482	-			
	792483	-			
	792484	-			

RECORDED
FEB 24 1986

RECEIVED
MAR 0 1985
MINING LANDS SECTION

RECEIVED
FEB 24 1986
PROSPECTING DIVISION

Expenditures (excludes power stripping)

Type of Work Performed **Assaying** (sect. 77-19)

Performed on Claim(s) **792483 & 792482**

Calculation of Expenditure Days Credits

Total Expenditures **\$ 99** ÷ **15** = **6** Total Days Credits

Instructions: Total Days Credits may be apportioned at the claim holder's choice. Enter number of days credits per claim selected in columns at right.

For Office Use Only

Total Days Cr. Recorded **13** Date Recorded **Feb. 24/86** Mining Recorder **[Signature]**

Date Approved as Recorded **Feb. 4/83** Branch Director **[Signature]**

Date **Jan 20/86** Recorder/Holder or Agent (Signature) **J.K. Filo**

Certification Verifying Report of Work

I hereby certify that I have a personal and intimate knowledge of the facts set forth in the Report of Work annexed hereto, having performed the work or witnessed same during and/or after its completion and the annexed report is true.

Name and Postal Address of Person Certifying **J.K. FILO 804-246 Roslyn Rd. Winnipeg Man.**

Date Certified **Jan 20/86** Certified by (Signature) **J.K. Filo**

Assessment Work Breakdown

Man Days are based on eight (8) hour Technical or Line-cutting days. Technical days include work performed by consultants, draftsmen, etc.

Type of Survey <i>Prospecting</i>												
Technical Days	X	7	=	Technical Days Credits	+	Line-cutting Days	=	Total Credits	+	No. of Claims	=	Days per Claim
1				7		0		7		1		7

Type of Survey												
Technical Days	X	7	=	Technical Days Credits	+	Line-cutting Days	=	Total Credits	+	No. of Claims	=	Days per Claim

Type of Survey												
Technical Days	X	7	=	Technical Days Credits	+	Line-cutting Days	=	Total Credits	+	No. of Claims	=	Days per Claim

Type of Survey												
Technical Days	X	7	=	Technical Days Credits	+	Line-cutting Days	=	Total Credits	+	No. of Claims	=	Days per Claim

March 7, 1986

File: 2.8936

Mr. M. Kean
P.O. Box 2120
Timmins, Ontario
P4N 7X8

Dear Sir:

RE: Geological Survey and Data for Assaying
submitted on Mining Claim P 792475 in
Carman Township

In order to complete the above-described submission the following information is required (in duplicate):

- 1) cancelled cheques or receipts as proof of payment for the \$99.00 expenditure credits claimed.
- 2) sample location plan showing sample numbers or assay results.
- 3) geology report and map.
(guidelines enclosed)

When submitting this material, please quote file 2.8936.

For further information, please contact Susan Hurst at
(416) 965-4888.

Yours sincerely,

J.C. Smith, Supervisor
Mining Lands Section

Whitney Block, 6th Floor
Queen's Park
Toronto, Ontario
M7A 1W3

Telephone: (416) 965-4888

SH/mc
cc: Mining Recorder
Timmins, Ontario
#67

Kevin Filo
Suite 804
246 Roslyn Road
Winnipeg, Manitoba R3L 0H2

Encl.

REFERENCES

AREAS WITHDRAWN FROM DISPOSITION

- M.R.O. - MINING RIGHTS ONLY
- S.R.O. - SURFACE RIGHTS ONLY
- M.+S. - MINING AND SURFACE RIGHTS

Description	Order No.	Date	Disposition	File
55C 26/90	W 37/84	12/1/83	M+S	1086
Re-opened NRO 36 85				

NOTES

THIS TOWNSHIP LIES WITHIN THE MUNICIPALITY OF THE CITY OF TIMMINS.

FLOODING RIGHTS ON NIGHTHAWK LAKE TO THE CONTOUR ELEVATION 903.5' RESERVED TO ONT. HYDRO

CARMAN TP.

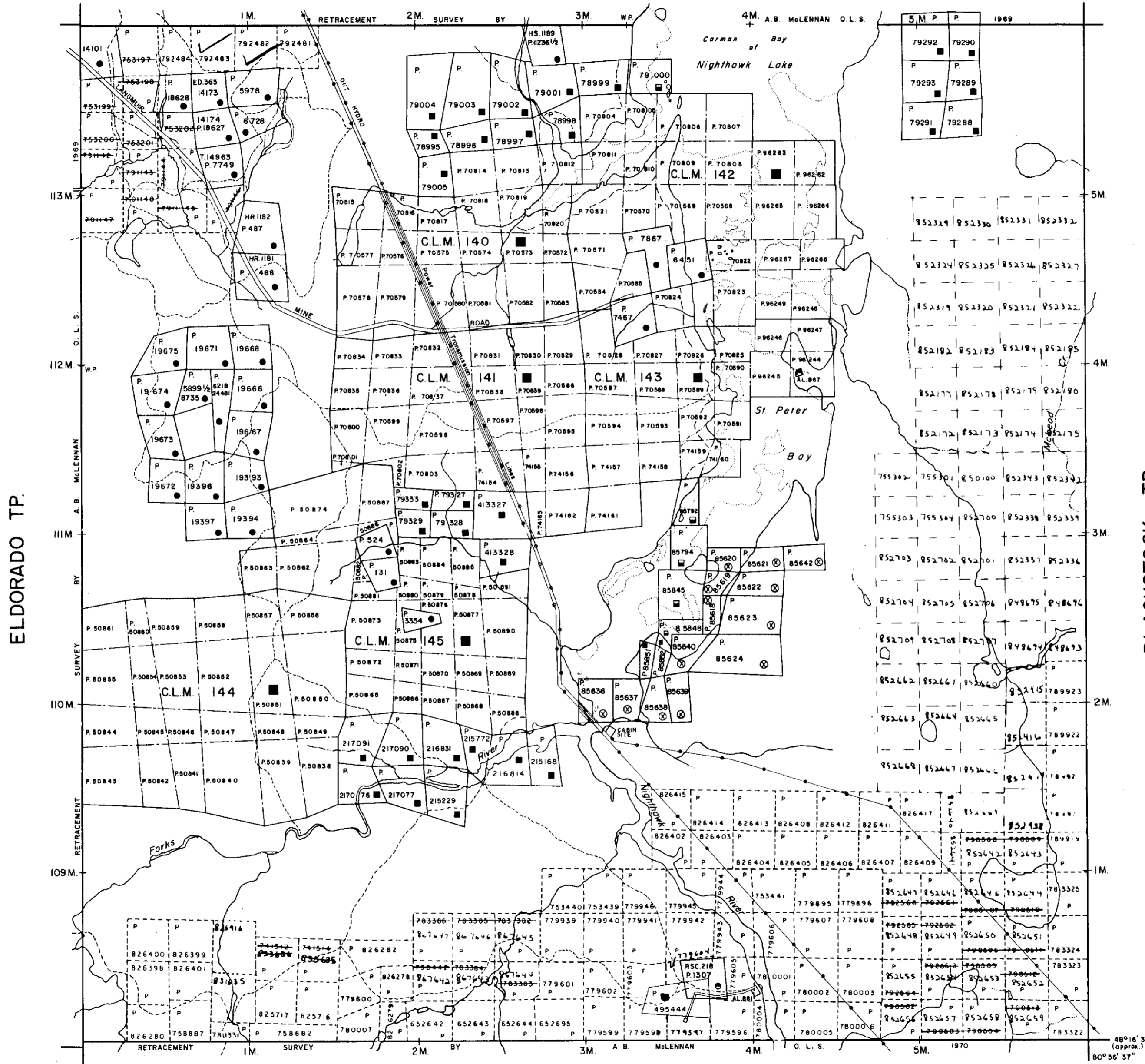

FALLON TP.

LEGEND

- HIGHWAY AND ROUTE No.
- OTHER ROADS
- TRAILS
- SURVEYED LINES:
 - TOWNSHIPS, BASE LINES, ETC.
 - LOTS, MINING CLAIMS, PARCELS, ETC.
- UNSURVEYED LINES:
 - LOT LINES
 - PARCEL BOUNDARY
 - MINING CLAIMS ETC.
- RAILWAY AND RIGHT OF WAY
- UTILITY LINES
- NON-PERENNIAL STREAM
- FLOODING OR FLOODING RIGHTS
- SUBDIVISION OR COMPOSITE PLAN
- RESERVATIONS
- ORIGINAL SHORELINE
- MARSH OR MUSKEG
- MINES
- TRAVERSE MONUMENT

DISPOSITION OF CROWN LANDS

TYPE OF DOCUMENT	SYMBOL
PATENT, SURFACE & MINING RIGHTS	●
" SURFACE RIGHTS ONLY	○
" MINING RIGHTS ONLY	◐
LEASE, SURFACE & MINING RIGHTS	■
" SURFACE RIGHTS ONLY	◼
" MINING RIGHTS ONLY	◑
LICENCE OF OCCUPATION	▼
ORDER-IN-COUNCIL	OC
RESERVATION	⊙
CANCELLED	⊘
SAND & GRAVEL	⊙

NOTE: MINING RIGHTS IN PARCELS PATENTED PRIOR TO MAY 8, 1913, VESTED IN ORIGINAL PATENTEE BY THE PUBLIC LANDS ACT, R.S.O. 1970, CHAP. 380, SEC. 63, SUBSEC. 1

SCALE: 1 INCH = 40 CHAINS

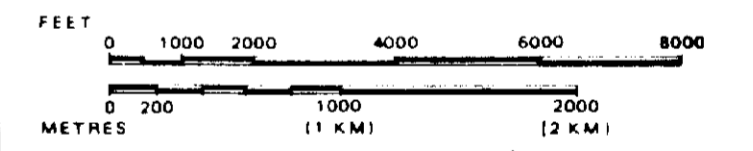

up to date as of Dec 19/85

TOWNSHIP
LANGMUIR
 M.N.R. ADMINISTRATIVE DISTRICT
TIMMINS
 MINING DIVISION
PORCUPINE
 LAND TITLES / REGISTRY DIVISION
COCHRANE

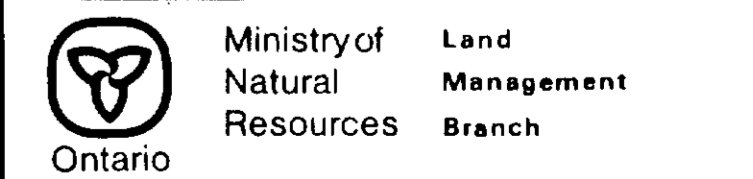

Date MARCH, 1985
 Number **G-3226**

