

42A06SE0127 23 ELDORADO

010

## Diamond Drilling

Township OF ELDORADO

Report N<sup>o</sup>: 23

Work performed by: Pyrotex Mining

| Claim N <sup>o</sup> | Hole N <sup>o</sup> | Footage | Date    | Note |
|----------------------|---------------------|---------|---------|------|
| P 67334              | 2                   | 385'    | Sept/67 |      |
| P 67333              | 1                   | 395'    | Sept/67 |      |
|                      | 4                   | 735'    | Dec/67  |      |
|                      | 5                   | 339'    | Dec/67  |      |
| P 67362              | 3                   | 305     | Sept/67 |      |

Notes:

# DIAMOND DRILL RECORD

Hole No. # 1 Sheet No. 1 of 1

Property PROTEX Mining & Expl. Co. LTD.  
 Location EL DORADO TWP.  
 Latitude \_\_\_\_\_  
 Departure \_\_\_\_\_  
 Bearing \_\_\_\_\_

Dip 60°

Total Footage 395'

Elev. Collar \_\_\_\_\_  
 Datum \_\_\_\_\_  
 Date Started Sep. 15/67  
 Date Completed Sep. 18/67  
 Drilled by CONTINENTAL DIAMOND DRILLING CO.  
 Logged by J. CANIR.

| Footage |     | Formation   | Sample Number | Sample Footage | Sample Width | Gold Sample | Gold Sludge | Remarks |
|---------|-----|---|---------------|----------------|--------------|-------------|-------------|---------|
| From    | To  |   |               |                |              |             |             |         |
| 0       | 40  | CASING  |               |                |              |             |             |         |
| 40      | 120 | fine grained diorite with minor pyroxenite                            |               |                |              |             |             |         |
| 120     | 135 | banded serpentine with minor pyroxenite                               |               |                |              |             |             |         |
| 135     | 148 | megacrystic fine grained massive to disseminated                      |               |                |              |             |             |         |
| 148     | 203 | fine grained rhyolite   |               |                |              |             |             |         |
| 203     | 298 | medium to fine grained diorite<br>250-255 minor stringers of graphite |               |                |              |             |             |         |
| 298     | 362 | Stained medium grained talc chlorite<br>carbonate part                |               |                |              |             |             |         |
| 362     | 395 | Coarse grained diorite  |               |                |              |             |             |         |
| 395     |     | end of hole.  |               |                |              |             |             |         |

Date of Examination \_\_\_\_\_

PORCUPINE  
MINING DIV.

RECEIVED

SEP 29 1967

AM 7:30 PM 12:15

*[Handwritten Signature]*

# DIAMOND DRILL RECORD

Hole No. #2 Sheet No. 1 of 1

Property Location Pyrotec Mining Expl. Co. Ltd.  
ELDOORAD TWP.

Dip 60°

Elev. Collar \_\_\_\_\_  
Datum \_\_\_\_\_  
Date Started Sept. 15/67  
Date Completed Sept. 18/67  
Drilled by Continental Diamond Drilling Co.  
Logged by J. C. Anis

Latitude \_\_\_\_\_  
Departure \_\_\_\_\_  
Bearing \_\_\_\_\_

Total Footage 385

| Footage |       | Formation   | Sample Number | Sample Footage | Sample Width | Gold Sample | Gold Sludge | Remarks |
|---------|-------|---|---------------|----------------|--------------|-------------|-------------|---------|
| From    | To    |   |               |                |              |             |             |         |
| 0       | 4     | CRASING   |               |                |              |             |             |         |
| 4       | 44'   | variably stained mafic volcanics with<br>epidote veins  |               |                |              |             |             |         |
| 44      | 61.5  | Coarse to medium grained diorite  |               |                |              |             |             |         |
| 61.5    | 67'   | non mineralized blue quartz vein  |               |                |              |             |             |         |
| 67      | 128   | Coarse to medium grained diorite  |               |                |              |             |             |         |
| 128     | 142   | massive to disseminated fine grained magnetite  |               |                |              |             |             |         |
| 142     | 199.5 | medium fine to intermediate to mafic<br>meta-volcanics  |               |                |              |             |             |         |
| 199.5   | 275   | Magnetite bearing non formation massive to dissemi-<br>nated fine grained magnetite (50% of section) Bands of<br>massive magnetite up to 2 feet wide. |               |                |              |             |             |         |
| 275     | 326   | Sheared fine to medium grained calcic<br>carbonate and probably highly altered mafic<br>meta-volcanics  |               |                |              |             |             |         |
| 326     | 385   | Coarse to medium grained <del>metavolcanics</del><br>quartz veins<br>end of hole.   |               |                |              |             |             |         |

RECEIVED  
SEP 29 1967  
AM 7:00 PM 12:1

J. C. Anis

Date of Examination \_\_\_\_\_

P-67362  
Adwards

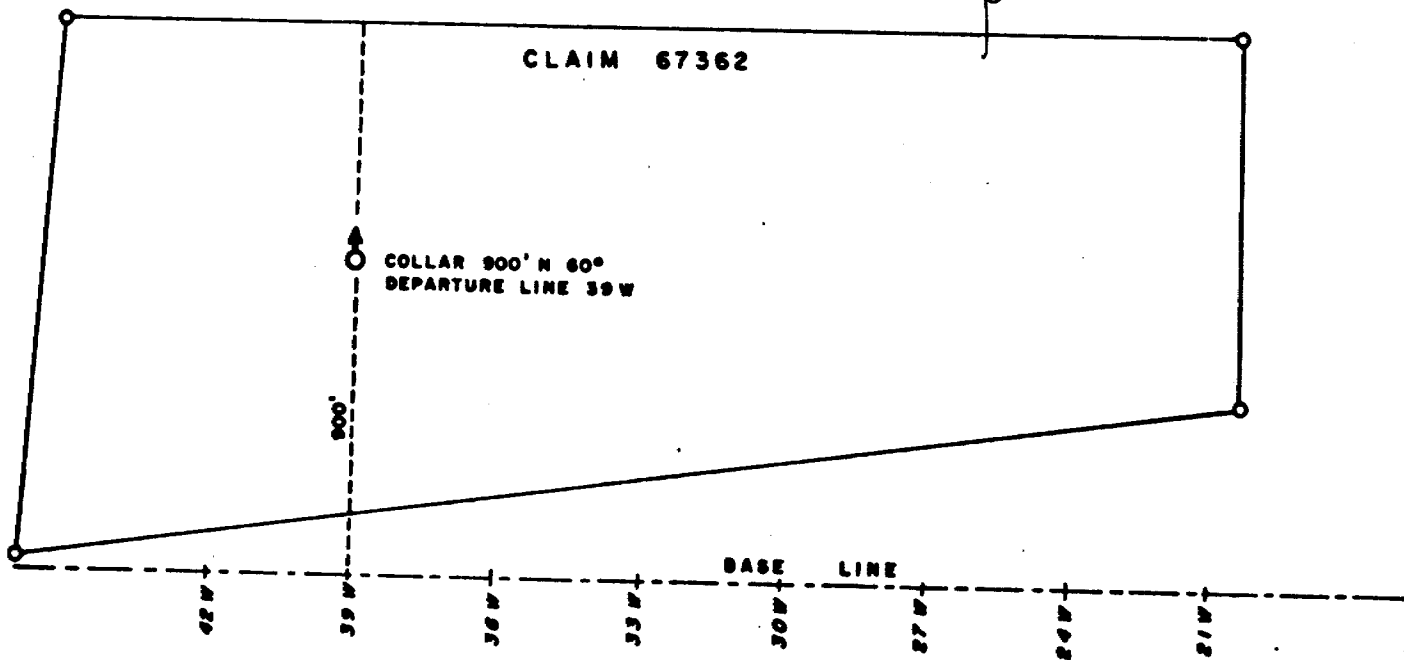

CONTINENTAL DIAMOND DRILLING CO. LTD. ROUYN QUE.  
Axl 1 1/4" Core Dia.      Date started Sept. 20/67  
Hole No. 3                      Date completed Sept. 22/67  
Depth 305'  
Angle 60°

# DIAMOND DRILL RECORD

Hole No. No 3 Sheet No. 1/2

Property Pyrates Mining and Exploration  
 Location Eldorado Tn

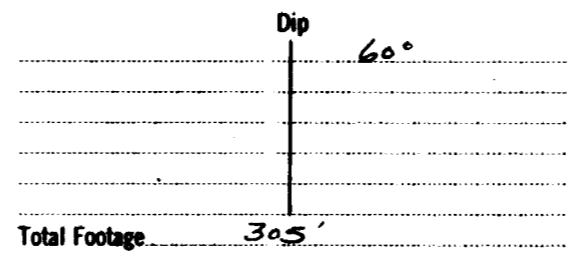

Elev. Collar \_\_\_\_\_  
 Datum \_\_\_\_\_  
 Date Started SEP 20/67  
 Date Completed SEPT 22, 1967  
 Drilled by CONTINENTAL DIAMOND DRILLING  
 Logged by J. CANIR

Latitude \_\_\_\_\_  
 Departure \_\_\_\_\_  
 Bearing \_\_\_\_\_

| Footage |      | Formation   | Sample Number | Sample Footage | Sample Width | Gold Sample | Gold Sludge | Remarks |
|---------|------|---|---------------|----------------|--------------|-------------|-------------|---------|
| From    | To   |   |               |                |              |             |             |         |
| 0       | 5    | <u>Casing</u>   |               |                |              |             |             |         |
| 5       | 53   | <u>Variably sheared and altered mafic volcanic. Cut by epidote veins and quartz-feldspar stringers.</u>                             |               |                |              |             |             |         |
| 53      | 56.5 | <u>Diorite to dioritic gabbro. Medium to coarse grained, grey-green.</u>  |               |                |              |             |             |         |
| 56.5    | 91.5 | <u>Sheared mafic metavolcanics.</u>   |               |                |              |             |             |         |
| 91.5    | 106  | <u>Porphyritic intrusion. Orthoclase phenocrysts in a fine grained, sheared, dark grey chloritic matrix.</u>                        |               |                |              |             |             |         |
| 106     | 131  | <u>Dark green, sheared mafic metavolcanics.</u>   |               |                |              |             |             |         |
| 131     | 156  | <u>Intermediate zone. Medium grade, intermediate to mafic metavolcanics.</u>  |               |                |              |             |             |         |
| 156     | 196  | <u>Banded, <del>intermediate</del> chloritic to feldspathic rock. Probably tuff but may be sheared intermediate mafic volcanic.</u> |               |                |              |             |             |         |

**FORGUPINE**  
**RECEIVED**  
 SEP 23 1967  
 AM 7:30:40 PM

Date of Examination SEPT. 22, 1967

*J. Canir*

# DIAMOND DRILL RECORD

Hole No. 305 Sheet No. 2 of 2

Property Lynden  
 Location \_\_\_\_\_  
 \_\_\_\_\_  
 \_\_\_\_\_  
 Latitude \_\_\_\_\_  
 Departure \_\_\_\_\_  
 Bearing \_\_\_\_\_

Dip  
 \_\_\_\_\_  
 \_\_\_\_\_  
 \_\_\_\_\_  
 \_\_\_\_\_  
 \_\_\_\_\_  
 Total Footage 305

Elev. Collar \_\_\_\_\_  
 Datum \_\_\_\_\_  
 Date Started \_\_\_\_\_  
 Date Completed \_\_\_\_\_  
 Drilled by \_\_\_\_\_  
 Logged by \_\_\_\_\_

| Footage |         | Formation  | Sample Number | Sample Footage | Sample Width | Gold Sample | Gold Sludge | Remarks     |
|---------|---------|--|---------------|----------------|--------------|-------------|-------------|-------------|
| From    | To      |  |               |                |              |             |             |             |
| 196     | 243     | Iron Formation. Both oxide and sulfidic facies present in green chloritic matrix   |               |                |              |             |             |             |
|         | 196-203 | Magnetite-bearing iron formation. Massive to disseminated, fine grained magnetite (50% of section). Bands of massive magnetite up to 1 foot wide |               |                |              |             |             |             |
|         | 203-217 | Pyrochlore rich; massive to disseminated. Massive bands 1/4" to 6" in green chloritic matrix. Minor Chalkopyrite 215-217.                        |               | 215-217        | 2'           |             |             | Cu-Ni assay |
|         | 217-243 | Magnetite in finely banded chloritic material.   |               |                |              |             |             |             |
| 243     | 299     | Highly shaly, fine to medium grained talc-chlorite schist, probably highly altered mafic metavolcanics.  |               |                |              |             |             |             |
| 299     | 305     | Shaly to brecciated leucocratic quartz; medium grained quartz and feldspar with chloritic matrix, altered breccia fragments.                     |               |                |              |             |             |             |
| 305     |         | End of hole.   |               |                |              |             |             |             |

**PORCUPINE**  
 MINING DEPT.  
**RECEIVED**  
 SEP 29 1967  
 AM 7 00 13 1967

J. P. [Signature]

Date of Examination \_\_\_\_\_







CONTINENTAL DIAMOND DRILLING CO. LTD. ROUYN QUE  
 AXI 1 1/4" Core Dia.  
 Hole No. 2  
 Depth 385'  
 Angle 60°

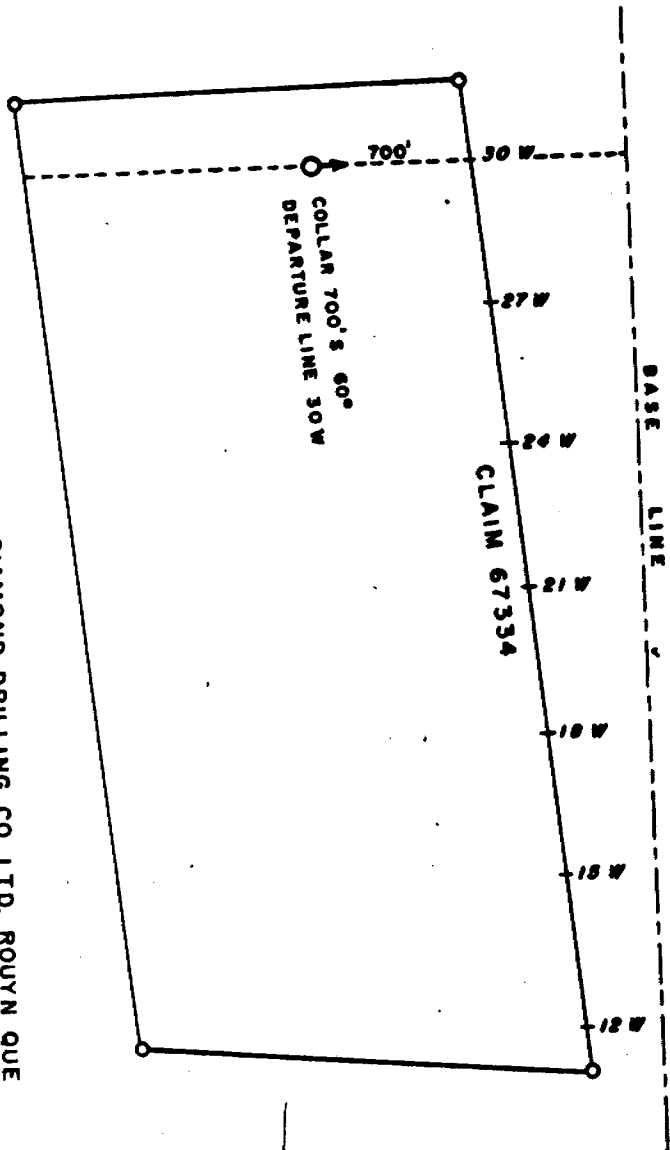

R-67334

*Eldorado*

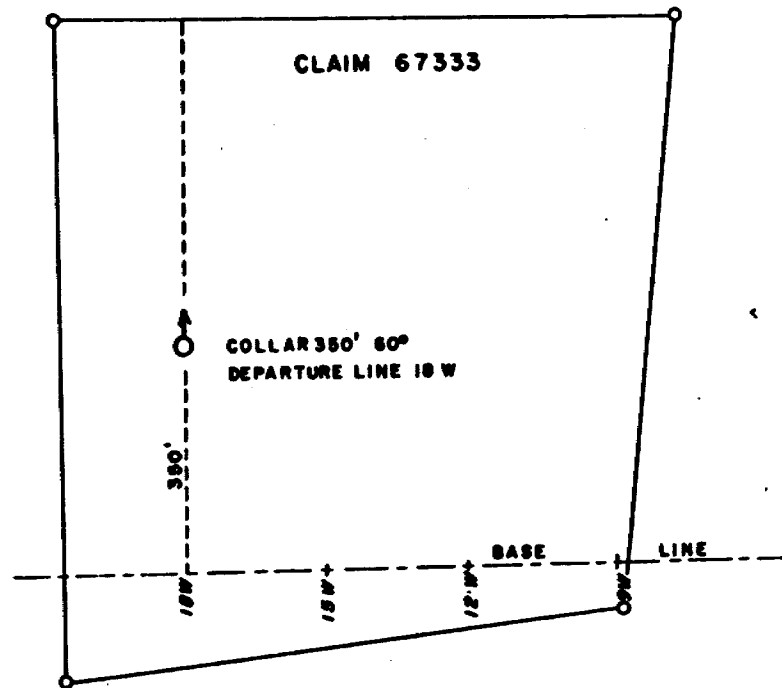

*Journal*  
*D. 67333*  
*Journal*

CONTINENTAL DIAMOND DRILLING CO. LTD. ROUYN QUE.

Azt 1 1/4" Core Dia.

Date started Sept. 10/67

Hole No. 1

Date completed Sept. 13/67

Depth 395'

Angl 60°

Eldorado Twp. property of  
Pyrotex Mining and Exploration Co. Ltd.

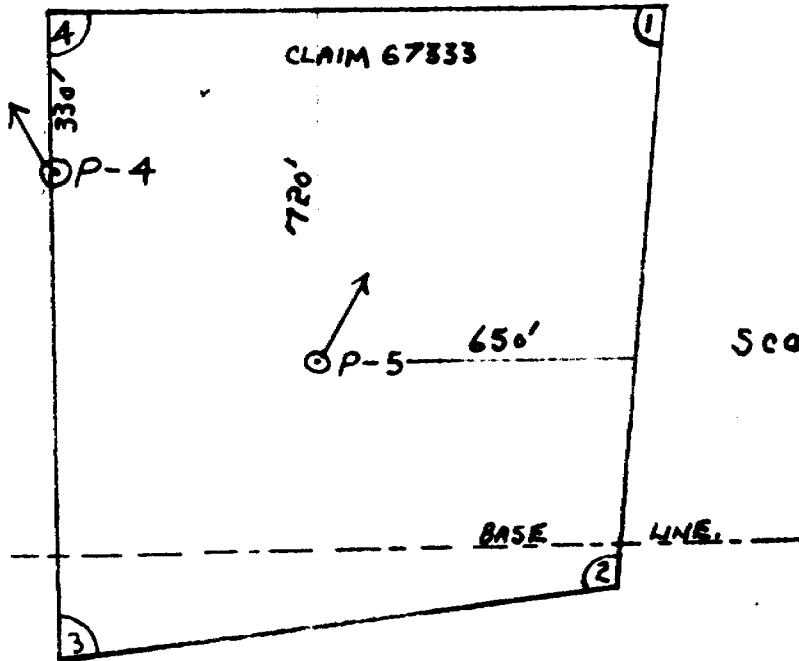

Locations of D.D.M. #P-4 and #P-5, Claim no. 67333.

P. 67333