



42A06SE0135 26 ELDORADO

010

Diamond Drilling

Township OF ELDORADO

Report NO: #26

Work performed by: Canadian Nickel

Claim NO	Hole NO	Footage	Date	Note
P 99735	BH43277	800'	May-June/70	(1)

Notes:

(1) #145/70

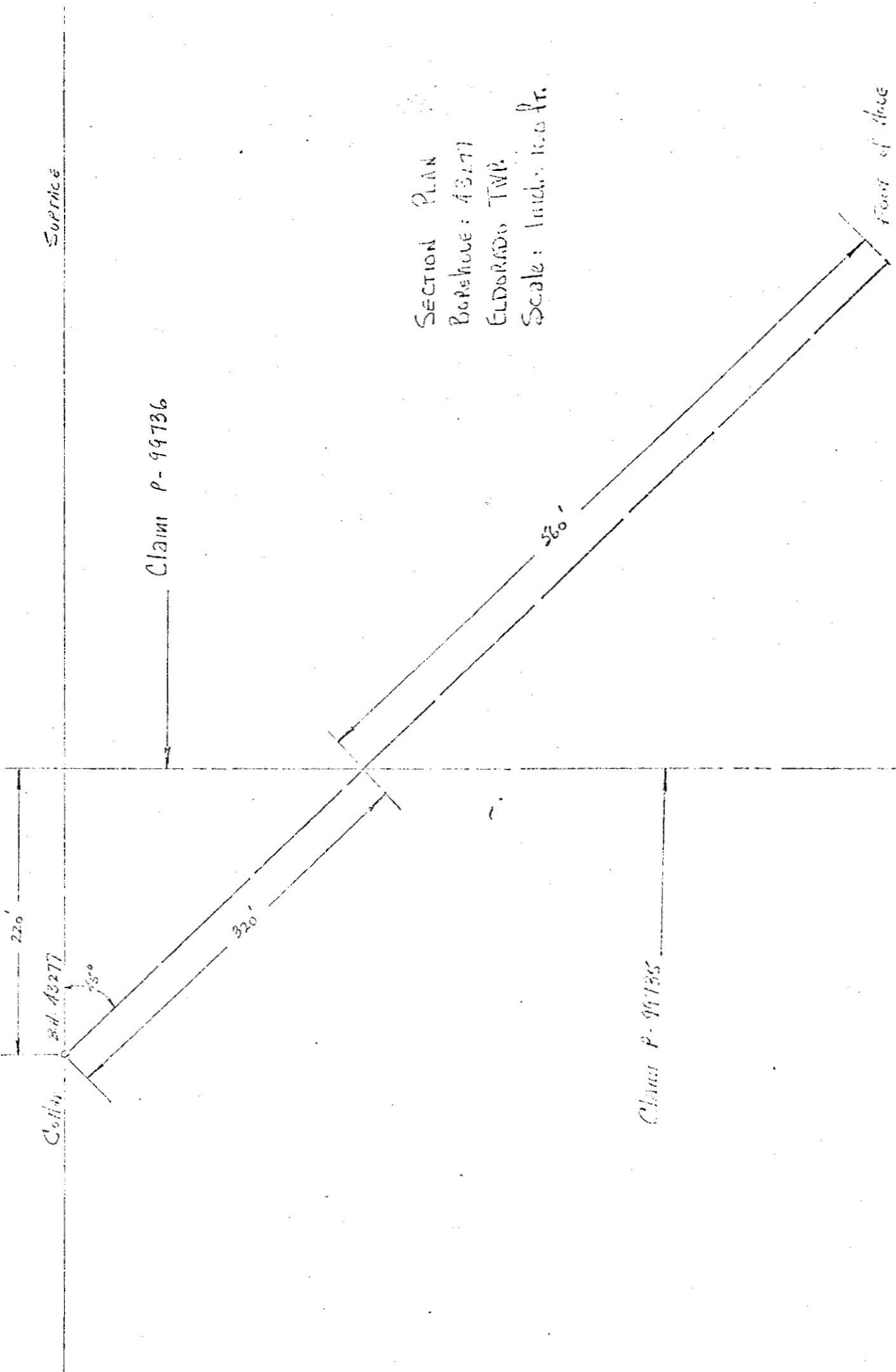

SECTION PLAN
 BOREHOLE: 43277
 ELDERADO TWP.
 Scale: 1 inch = 100 ft.

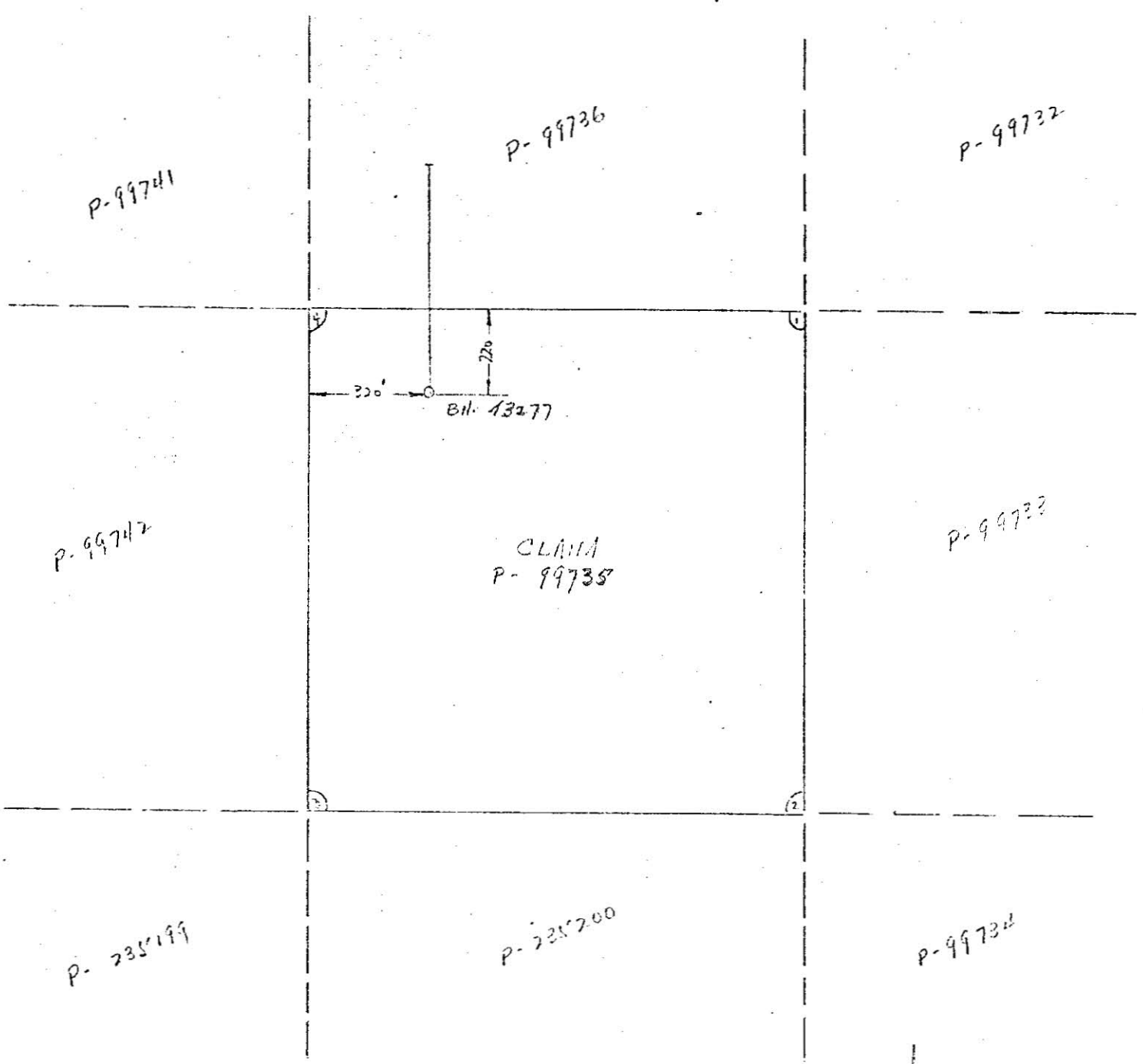

LOCATION SKETCH
 of Warehouse: 13277.
 Located on CL. P-99735
 E11-13277 TRP.
 Potomac Marsh Division
 Scale: 1 inch = 100 ft.



Supplementary List 'A'

<u>Claim No.</u>	<u>Days</u>	<u>Claim No.</u>	<u>Days</u>	<u>Claim No.</u>	<u>Days</u>
P 99711	50	P 99740	20	P 235186	20
P 99712	20	P 99741	20	P 235187	20
P 99713	20	P 99742	20	P 235188	20
P 99714	20	P 99743	20	P 235189	20
P 99715	20	P 99744	20	P 235190	20
P 99716	20	P 99745	20	P 235191	20
P 99717	20	P 99746	20	P 235192	20
P 99718	20	P 99747	20	P 235193	20
P 99719	20	P 99756	20	P 235194	20
P 99720	20	P 100168	20	P 235195	20
P 99721	20	P 100169	20	P 235196	20
P 99722	20	P 100170	20	P 235197	20
P 99723	20	P 100171	20	P 235198	20
P 99724	20	P 100172	20	P 235199	20
P 99725	20	P 100173	20	P 235200	20
P 99726	20	P 100174	20	P 235272	20
P 99727	20	P 100175	20	P 235274	20
P 99728	20	P 100176	20	P 235275	20
P 99729	20	P 100177	20	P 255041	20
P 99730	20	P 100178	20	P 255042	20
P 99731	20	P 100179	20	P 255043	20
P 99732	20	P 217497	20	P 255044	20
P 99733	20	P 218173	20	P 255045	20
P 99734	20	P 218174	20	P 255046	20
P 99735	20	P 218175	20	P 255047	20
P 99736	20	P 218176	20	P 255048	20
P 99737	20	P 218234	20	P 255049	20
P 99738	20	P 235185	20	P 255050	20
P 99739	20				

Total No. of Claims = 84
 Total No. of days filed = 1,730

September 28, 1970

E. W. ...

W. V. Roehrig

*...
 ...
 ...*

Supplementary List 'A'

AQ d.d. hole 43277, Angle -45°N, 320 feet drilled on P 99735
and 560 feet on P 99736, Total 880 ft. - 880 days
AQ d.d.hole 43289, located on Cl. P 99718, Angle -45°N, 850 ft. - 850 days
Total work available - 1,730 days
Work recorded as per Supplementary List 'A' - 1,730 days
Credits remaining - Nil

Drilling dates for the above 2 boreholes =

B.H. 43277 = May 27 - June 10, 1970
B.H. 43289 = July 8-15, 1970

by: Bradley Bros. Drilling Limited
Noranda, Quebec

September 28, 1970.

W.V. Rodney

BOREHOLE RECORD

DATE PROCESSED SEPT 28, 1970

BOREHOLE# 43277-0 PROPERTY ELDORADO 1 NTS# 42A SH# 6E ANOM# ANOM# DEPTH 880 AZIMUTH 0 00 DIP -45 00 LATITUDE S DEPARTURE 600 E ELEVATION 6000 LEVEL
 CHK'D.....
 DATE.....

INCLINATION AND TROPARI TESTS

DEPTH AZIMUTH DIP DEPTH AZIMUTH DIP DEPTH AZIMUTH DIP DEPTH AZIMUTH DIP DEPTH AZIMUTH DIP
 200 -46 00 400 -46 00 600 -46 00 800 -45 30

TOPS OF WEDGES

COMMENTS

LOGGED BY..GC PELLETIER STARTED..MAY 27, 1970 COMPLETED..JUNE 10, 1970 DRLD BRADLEY BROS ON CL P-99735 320 E & 220 S POST 4
 26 N 70 B 26 A CAS & SHOES LEFT IN HOLE CEMENT AT 132
 AQ CORE

SAMPLE ENTRIES

DEPTH	LENGTH	MNZN	ROCK	DESCRIPTION	ANG
0.0	0.0			COLLAR	
26.0	26.0			NX CASING	
70.0	44.0			BX CAS AX CAS TO 72 SOC OB BLDS & GRAVEL	
71.0	1.0	MVVW	FDPR	PINK CG PY SPKS	
72.3	1.3	MVVW	PRDT	MASS SLLY MTC	
73.8	1.5	MVVW	FDPR	SOME IRON STNG SHARP CT	
76.7	2.9	MVVW	PRDT	AS AT 72.3 TALC-CARB SHARP CT	
78.2	1.5	MVVW	FELS	MASS SHARP CT IRON STNG	
87.8	9.6	MVVW	GAB	BLUE CG TO MG PY SPKS	
93.4	5.6	MVVW	VOLC	BAS TO INT GY TO GRN BXTD PO SPKS	
100.0	6.6		DIA	GY FG PY SPKS	
130.0	30.0		VOLC	AS AT 93.4 GY BXTD 119	
180.0	50.0		VOLC	AC TO INT GY TO GRN SLLY CRBD OCC PY SPKS	
185.0	5.0		FDPR	GY BLUE CG OCC PY SPKS	
200.0	15.0		VOLC	AS AT 180	
206.0	6.0	MVVW	VOLC	AS AT 180	
215.0	9.0	MVVW	PRDT	DK BLUE MTC MG PY CUBES	
220.0	5.0	MVVW	VOLC	AS AT 180	
231.0	11.0		VOLC	AS AT 180	
257.7	26.7		FDPR	CG GY BLUE SHARP CT OCC PY CUBES	
274.0	16.3		VOLC	AS AT 180	
280.0	6.0		SYNT	BRWN FG TO MASS SOME VOLCS FGMS	
291.0	11.0		VOLC	AS AT 180	
293.8	2.8		FDPR	GY CG IRON STNG	
298.4	4.6		VOLC	AS AT 180	
306.0	7.6		FDPR	AS AT 293.8 SHARP CT	
317.0	11.0		VOLC	AS AT 180 SOME FDPR FGMS	
322.0	5.0	MVVW	DIA	BK MASS NON MTC	
335.0	13.0	MVVW	PRDT	BLUE MTC CRBD GRN AT CT TALC PY SPKS	
346.3	11.3	MVVW	PRDT	AS PREV ENTRY	
353.0	6.7	MVVW	SYNT	BROWN MTC MG IRON STNG	
365.0	12.0	MVVW	PRDT	AS AT 335	
380.0	15.0	MVVW	PRDT	AS AT 335	
395.0	15.0	MVVW	PRDT	AS AT 335	
410.0	15.0	MVVW	PRDT	AS AT 335	

DEPTH	LENGTH	MNZN	ROCK	DESCRIPTION	ANG
425.0	15.0	MVVW	VOLC	BASIC GRN BROAD CT NON MTC PY SPKS	
440.0	15.0	MVVW	VOLC	AS PREV ENTRY	
465.0	25.0		VOLC	AS PREV ENTRY	
497.3	32.3		VOLC	AC TO INT LT GRN FG TO MASS PY SPKS	
500.8	3.5		QZPR	WHITE SPKS OF CHLC	
516.3	15.5		VOLC	AS AT 497.3	
523.0	6.7		FDPR	GY CG OCC PY SPKS	
596.9	73.9		VOLC	AS AT 497.3 LOCL AGLM	
605.0	8.1		FDPR	AS AT 523	
630.0	25.0		VOLC	AS AT 497.3	
635.0	5.0	MVVW	VOLC	AS AT 497.3	
640.0	5.0	MVVW	FDPR	AS AT 523	
645.0	5.0	MVVW	VOLC	AS AT 497.3	
651.6	6.6		VOLC	AS AT 497.3	
657.2	5.6		FDPR	AS AT 523	
699.9	42.7		VOLC	AS AT 497.3 SOME FDPR FGMS	
716.0	16.1		FDPR	AS AT 523 SHARP CT	
733.6	17.6		VOLC	AS AT 699.9	
740.0	6.4		FDPR	AS AT 716	
793.4	53.4		VOLC	AS AT 596.9	
801.5	8.1		FDPR	AS AT 523	
826.8	25.3		VOLC	AS AT 497.3 SOME BAS VOLC FGMS	
830.0	3.2		FDPR	AS AT 523	
880.0	50.0		VOLC	AS AT 596.9 FOOT OF HOLE	