



42A065W0050 63.5905 PRICE

010

ROW and Geotechnical
Analysis for Power-
Stripped Areas

Price Twp.

1991

KANGAS-CROXALL PROPERTY (90 CLAIMS)

BRISTOL TWP
OGDEN TWP

PROPERTY OUTLINE

 AREA WHERE
WORK APPLIED (22 CLS.)

 CLAIM WORKED
(4)

TRUE NORTH

BRISTOL TWP.
THORNELOE TWP.

OGDEN TWP
PRICE TWP.

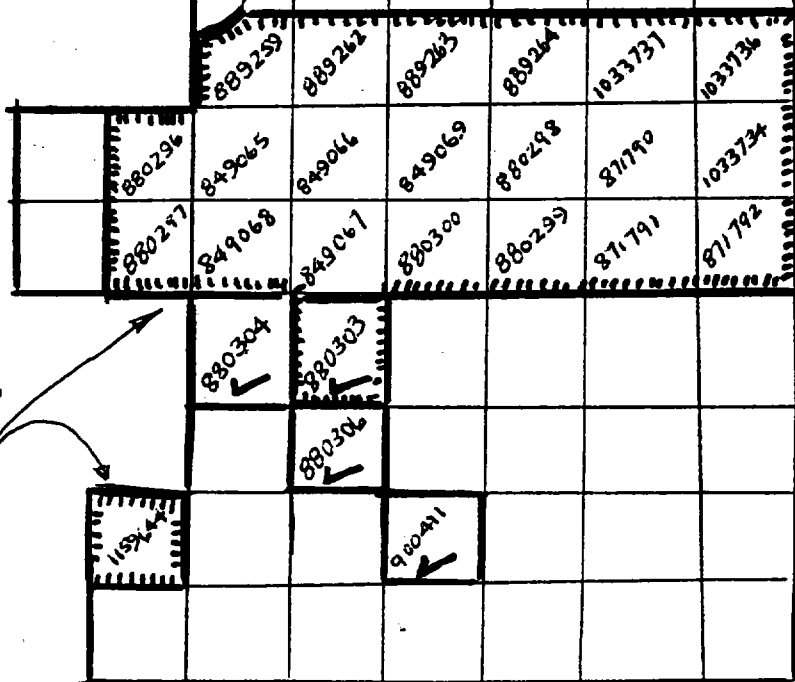

WORK APPLIED
TO 22 CLS.

BR. TH.

mk.

KEY SKETCH OF WORK LOCATIONS - PRICE TWP. 1991 (SCALE: N.T.S.)

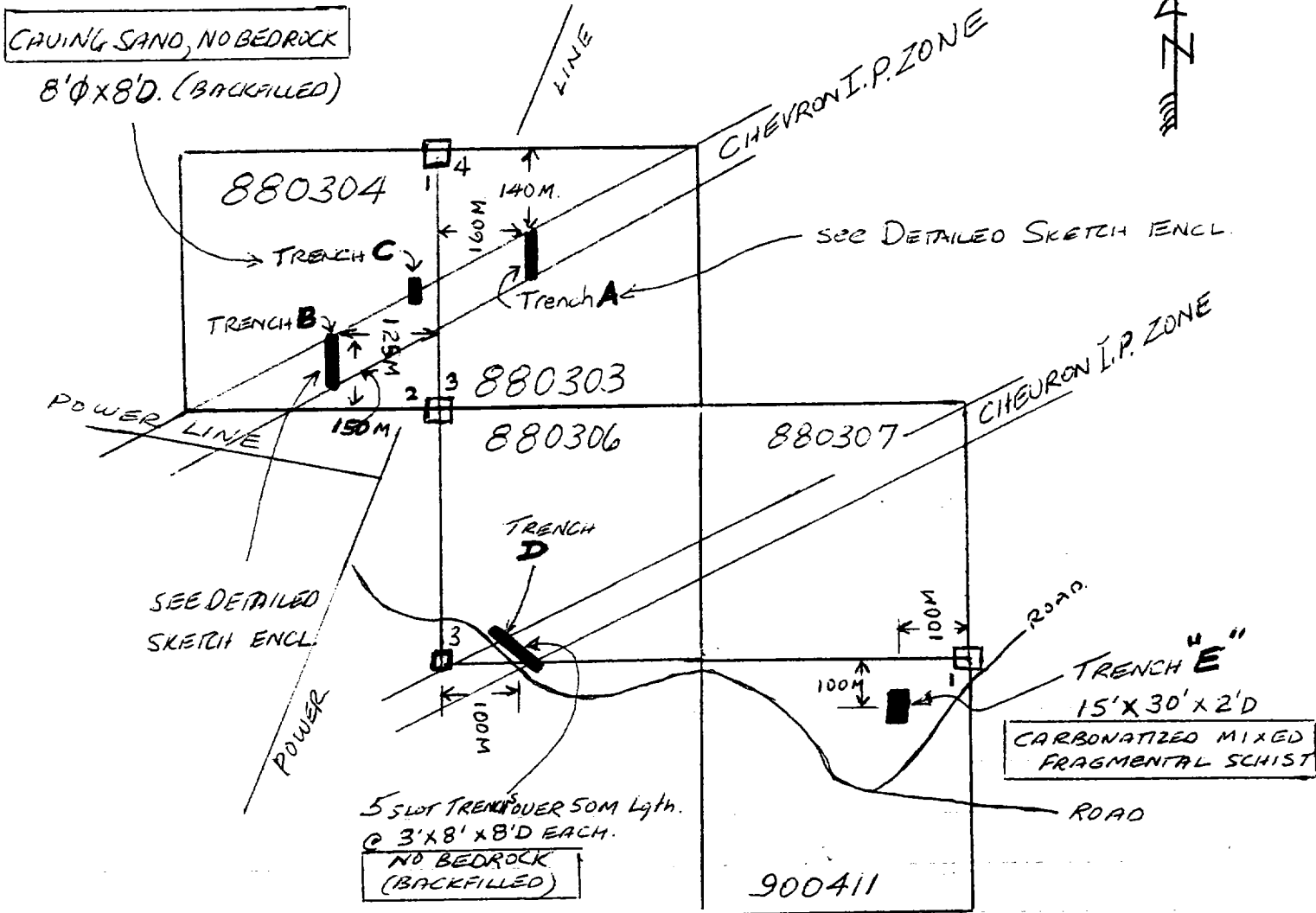

5 AREAS OF POWERSTRIPPING WITH BACKHOE
DETAILED SKETCHES OF TRENCHES A & B NEXT PAGE.

TRENCHES A, B, C MAY 11 → JUNE 8 /91 (9.2 CREW DAYS) — 3.6 on A and 5.6 on B & C

TRENCHES D, E JUNE 22 /91 (0.8 CREW DAYS)

MOBE/MOUE/DEMOBE @ 1 CREW-DAY - APPLY EVENLY OVER 4 CLAIMS AT 0.25 CREW DAYS EACH.

mk

DETAILED SKETCHES OF TRENCHES A & B - PRICE TWP. 1991

SCALE: 1 CM = 20 FT

TRENCH "B"

TRENCH "A"

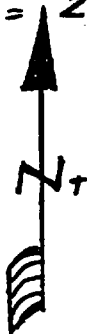
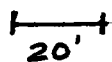

5+00N. *
11' Ø x 8'D
QUICKSAND ON
BEDROCK
(NO SAMPLES)

15' Ø x 8'D

4' x 9' x 8'D

3' x 12' x 8'D

CAVING SAND
(NO BEDROCK)

XL 22 W

NOT ASSAYED YET
SAMPLE #279
MAFIC
CHERT
TUFF
TUFF
12' x 57' x 7'D
CAVING SAND
SPARSE BEDROCK
SAMPLE #278

10' Ø x 8'D

5' x 9' x 8'D

5' x 11' x 8'D

8' x 24' x 8'D

10' x 15' x 3'D
BLACK MUCK
NO BEDROCK

3+75N. *

XL 19 W.

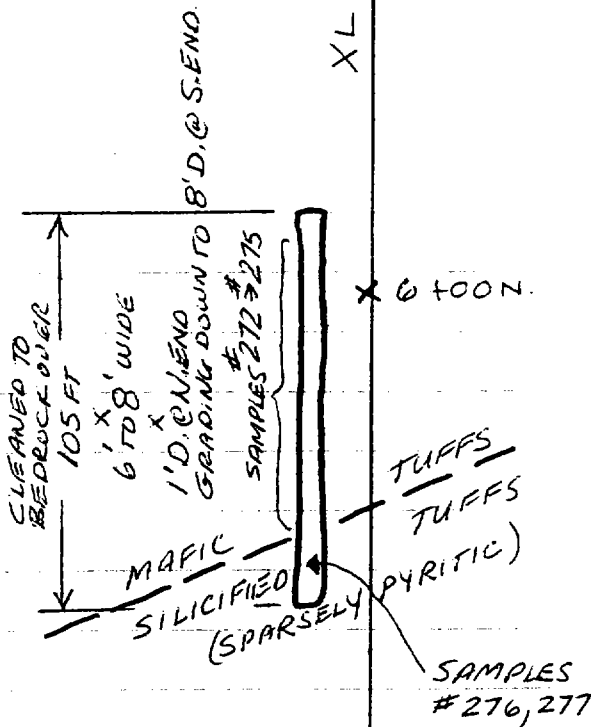

NOTE: TRENCH "A"

SAMPLES ASSAYED
BY ACCURASSY LTD.

FOR PLACER DOME

(see Attached Analysis
Certificate #40007)

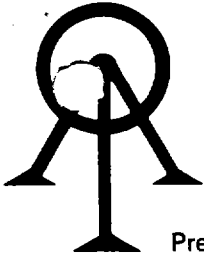

ACCURASSAY LABORATORIES

A DIVISION OF BARRINGER LABORATORIES LIMITED, REXDALE, ONTARIO

BOX 426

KIRKLAND LAKE, ONTARIO, CANADA P2N 3J1

TEL.: (705) 567-3361

President: Dr. GEORGE DUNCAN, M.Sc., Ph. D., C. Chem (Ont.), C. Chem (U.K.), M.C.I.C., M.R.S.C., A.R.C.S.T.

40007

Certificate of Analysis

Page #1

May 29

1991

Mr. John Gardiner
Placer Dome Inc.
P.O. Box 670
South Porcupine, Ontario
POW 1H0

Work Order # 910608
Project # 295

SAMPLE NUMBER		Gold
Accurassay	Customer	ppb
243232	272	5
243233	273	<5
243234	274	<5
243235	275	<5
243236	276	5
243237	277	<5

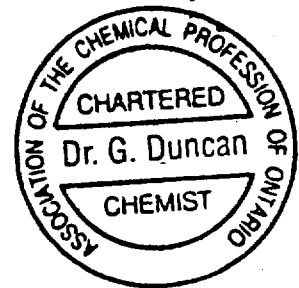

G. Duncan



Report of Work Conducted After Recording Claim

Mining Act

Transaction Number
150666
W9160.00261

Personal information collected on this form is obtained under the authority of the M this collection should be directed to the Provincial Manager, Mining Lands, Min Sudbury, Ontario, P3E 6A5, telephone (705) 670-7264.



42A065W0050 63.5905 PRICE

900

- Instructions:**
- Please type or print and submit in duplicate.
 - Refer to the Mining Act and Regulations for requirements of filing assessment work or consult the Mining Recorder.
 - A separate copy of this form must be completed for each Work Group.
 - Technical reports and maps must accompany this form in duplicate.
 - A sketch, showing the claims the work is assigned to, must accompany this form.

Recorded Holder(s) MATTI KANGAS		Client No. 150666 M-20585
Address 128 QUEEN AVE., TIMMINS, ONTARIO, P4N4L6		Telephone No. (705)-267-6175
Mining Division PORCUPINE	Township/Area PRICE TWP	M or G Plan No.
Dates Work Performed From: MAY 11/91		To: JUNE 22/91

Work Performed (Check One Work Group Only)

Work Group	Type
<input type="checkbox"/> Geotechnical Survey	
<input checked="" type="checkbox"/> Physical Work, Including Drilling	MECHANICAL OVERBURDEN STRIPPING
<input type="checkbox"/> Rehabilitation	
<input type="checkbox"/> Other Authorized Work	
<input type="checkbox"/> Assays	
<input type="checkbox"/> Assignment from Reserve	

ONTARIO GEOLOGICAL SURVEY
GIS-ASSESSMENT FILES
FEB 12 1992
RECEIVED

RECORDED
SEP 25 1991
Receipt _____

Total Assessment Work Claimed on the Attached Statement of Costs \$ **8,800**

Note: The Minister may reject for assessment work credit all or part of the assessment work submitted if the recorded holder cannot verify expenditures claimed in the statement of costs within 30 days of a request for verification.

Persons and Survey Company Who Performed the Work (Give Name and Address of Author of Report)

Name	Address
MATTI KANGAS	128 QUEEN AVE., TIMMINS, ONT., P4N4L6
JAMES CROXALL	152 BROCK AVE., TIMMINS, ONT., P4N7P1
<i>(see work schedule on reverse side of STATEMENT OF COSTS)</i>	

(attach a schedule if necessary)

Certification of Beneficial Interest * See Note No. 1 on reverse side

I certify that at the time the work was performed, the claims covered in this work report were recorded in the current holder's name or held under a beneficial interest by the current recorded holder.	Date SEP 23/91	Recorded Holder or Agent (Signature) Matti Kangas
--	--------------------------	---

Certification of Work Report

I certify that I have a personal knowledge of the facts set forth in this Work report, having performed the work or witnessed same during and/or after its completion and annexed report is true.		
Name and Address of Person Certifying MATTI KANGAS, 128 QUEEN AVE., TIMMINS, ONT., P4N4L6		
Telephone No. (705)-267-6175	Date SEP 23/91	Certified By (Signature) Matti Kangas

For Office Use Only

\$ 8,800	Date Recorded SEP 25/91	Mining Recorder <i>[Signature]</i>	
	Deemed Approval Date DEC 23/91	Date Approved	
	Date Notice for Amendments Sent		



**Statement of Costs
for Assessment Credit**

**État des coûts aux fins
du crédit d'évaluation**

Transaction No./N° de transaction

W9160.00261

Mining Act/Loi sur les mines

Personal information collected on this form is obtained under the authority of the Mining Act. This information will be used to maintain a record and ongoing status of the mining claim(s). Questions about this collection should be directed to the Provincial Manager, Minings Lands, Ministry of Northern Development and Mines, 4th Floor, 159 Cedar Street, Sudbury, Ontario P3E 6A5, telephone (705) 670-7264.

Les renseignements personnels contenus dans la présente formule sont recueillis en vertu de la Loi sur les mines et serviront à tenir à jour un registre des concessions minières. Adresser toute question sur la collecte de ces renseignements au chef provincial des terrains miniers, ministère du Développement du Nord et des Mines, 159, rue Cedar, 4^e étage, Sudbury (Ontario) P3E 6A5, téléphone (705) 670-7264.

1. Direct Costs/Coûts directs

Type	Description	Amount Montant	Totals Total global
Wages Salaires	Labour Main-d'oeuvre		
	Field Supervision Supervision sur le terrain		
Contractor's and Consultant's Fees Droits de l'entrepreneur et de l'expert- conseil	Type EQUIVALENT CONTRACTOR'S POWER STRIPPING FEES		
		\$8000	
Supplies Used Fournitures utilisées	Type		
Equipment Rental Location de matériel	Type		
Total Direct Costs Total des coûts directs		\$8000	

2. Indirect Costs/Coûts indirects

** Note: When claiming Rehabilitation work Indirect costs are not allowable as assessment work.
Pour le remboursement des travaux de réhabilitation, les coûts indirects ne sont pas admissibles en tant que travaux d'évaluation.

Type	Description	Amount Montant	Totals Total global
Transportation Transport	Type		
Food and Lodging Nourriture et hébergement			
Mobilization and Demobilization Mobilisation et démobilisation	EQUIV. CONTRACTOR'S MOBE/MOVE/DEMOBE FEES		\$800
Sub Total of Indirect Costs Total partiel des coûts indirects			\$800
Amount Allowable (not greater than 20% of Direct Costs) Montant admissible (n'excédant pas 20 % des coûts directs)			\$800
Total Value of Assessment Credit (Total of Direct and Allowable Indirect costs)		Valeur totale du crédit d'évaluation (Total des coûts directs et Indirects admissibles)	\$8,800

Note: The recorded holder will be required to verify expenditures claimed in this statement of costs within 30 days of a request for verification. If verification is not made, the Minister may reject for assessment work all or part of the assessment work submitted.

Note : Le titulaire enregistré sera tenu de vérifier les dépenses demandées dans le présent état des coûts dans les 30 jours suivant une demande à cet effet. Si la vérification n'est pas effectuée, le ministre peut rejeter tout ou une partie des travaux d'évaluation présentés.

Filing Discounts

1. Work filed within two years of completion is claimed at 100% of the above Total Value of Assessment Credit.
2. Work filed three, four or five years after completion is claimed at 50% of the above Total Value of Assessment Credit. See calculations below:

Total Value of Assessment Credit	Total Assessment Claimed
	× 0.50 =

Remises pour dépôt

1. Les travaux déposés dans les deux ans suivant leur achèvement sont remboursés à 100 % de la valeur totale susmentionnée du crédit d'évaluation.
2. Les travaux déposés trois, quatre ou cinq ans après leur achèvement sont remboursés à 50 % de la valeur totale du crédit d'évaluation susmentionné. Voir les calculs ci-dessous.

Valeur totale du crédit d'évaluation	Evaluation totale demandée
	× 0,50 =

Certification Verifying Statement of Costs

I hereby certify:
that the amounts shown are as accurate as possible and these costs were incurred while conducting assessment work on the lands shown on the accompanying Report of Work form.

that as RECORDED HOLDER I am authorized
(Recorded Holder, Agent, Position in Company)

to make this certification

Attestation de l'état des coûts

J'atteste par la présente :
que les montants indiqués sont le plus exact possible et que ces dépenses ont été engagées pour effectuer les travaux d'évaluation sur les terrains indiqués dans la formule de rapport de travail ci-joint.

Et qu'à titre de _____ je suis autorisé
(titulaire enregistré, représentant, poste occupé dans la compagnie)

à faire cette attestation.

Signature Mark Kangas Date SEP 23/91 *

PHYSICAL WORK REPORT

WORK WAS PERFORMED BY RECORDED HOLDER J. CROXALL (HIS PARTNER IN THE PROPERTY) USING A JOHN-DEERE 400 BACKHOE-LOADER OWNED BY J. CROXALL.

ASSESSMENT CREDIT IS CLAIMED ON THE BASIS OF WHAT ARE BELIEVED TO BE CURRENT INDUSTRY-STANDARD CHARGING RATES FOR EQUIVALENT EQUIPMENT & OPERATING CREW AT \$800 PER 10 HOUR DAY USING 2 MAN CREW.

WORK PERFORMANCE SCHEDULE

DIRECT EXPENSE

<u>DATE</u>	<u>CREW HRS</u>	<u>DATE</u>	<u>CREW HRS</u>
MAY 11/91	12	MAY 28/91	4
MAY 12/91	12	JUNE 2/91	12
MAY 19/91	12	JUNE 4/91	4
MAY 25/91	12	JUNE 8/91	12
MAY 26/91	12	JUNE 22/91	8

TOTAL 100 CREW HRS OR 10 CREW DAYS

EXPENDITURE CLAIMED = $10 \times \$800 = \underline{\underline{\$8000}}$

INDIRECT EXPENSE

MOBE / MOVE / DEMOBE BACKHOE

CLAIM - 10 CREW HRS OR 1 CREW DAY

EXPENDITURE CLAIMED = $1 \times \$800 = \underline{\underline{\$800}}$

TOTAL EXPENDITURE CLAIMED = $8000 + 800 = \underline{\underline{\$8800}}$

Ogden Twp (M 305)

THE TOWNSHIP OF

PRICE

DISTRICT OF COCHRANE

PORCUPINE MINING DIVISION

SCALE 1 INCH 40 CHAINS

DISPOSITION OF CROWN LANDS

- PATENT SURFACE AND MINING RIGHTS ●
- SURFACE RIGHTS ONLY ○
- MINING RIGHTS ONLY ◐
- LEASE, SURFACE AND MINING RIGHTS ■
- SURFACE RIGHTS ONLY ▨
- MINING RIGHTS ONLY ▩
- LICENCE OF OCCUPATION ▼

- ROADS
- IMPROVED ROADS
- KINGS HIGHWAYS
- RAILWAYS
- POWER LINES
- MARSH OR MUSKEG
- MINES

NOTES

10 surface rights reservation along the shores of all lakes and rivers

Areas withdrawn from staking under Section 33 of the Mining Act (R.S.O. 1970)
Order No File Date Disposition

PLANNED RE FORESTATION
THIS TWP SUBJECT TO FOREST ACTIVITY IN 1991/92
FURTHER INFORMATION AVAILABLE ON FILE

SAND AND GRAVEL

The township lies within the Municipality of the CITY of TIMMINS

PLAN NO M-307

ONTARIO
MINISTRY OF NATURAL RESOURCES

SURVEY AND MAPPING BRANCH

Thorneloe Twp (M 313)

Adams Twp (M 261)

Fripp Twp (M 281)

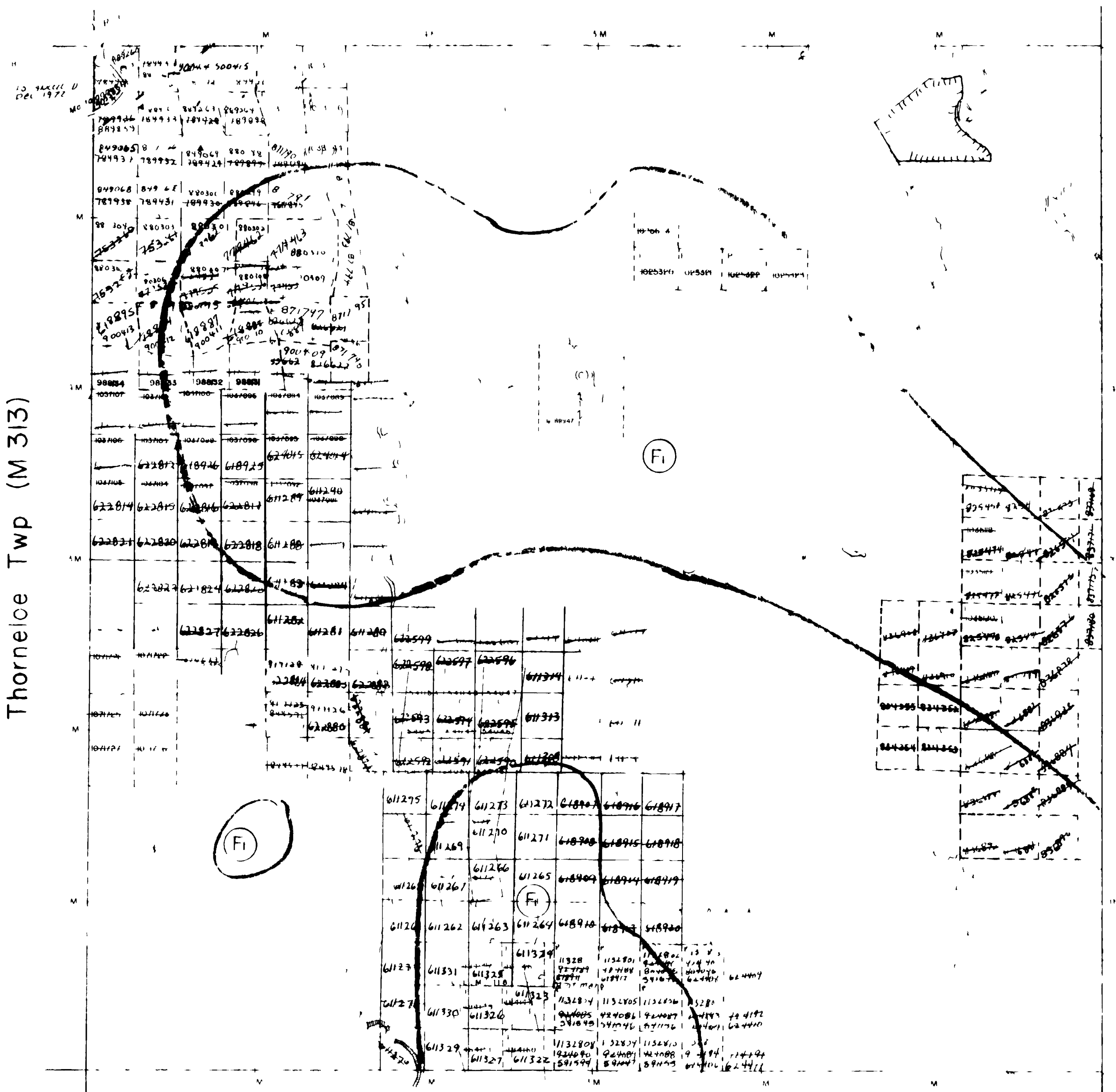

503

PRICE TWP

503

THE INFORMATION THAT APPEARS ON THIS MAP HAS BEEN COMPILED FROM VARIOUS SOURCES AND ACCURACY IS NOT GUARANTEED. THOSE WISHING TO TAKE MINING CLAIMS SHOULD CONSULT WITH THE MINING RECORDER, MINISTRY OF NORTHERN DEVELOPMENT AND MINES FOR ADDITIONAL INFORMATION ON THE STATUS OF LAND SHOWN HEREON.



REFERENCES

AREAS WITHDRAWN FROM DISPOSITION

- M R O MINING RIGHTS ONLY
- S R O SURFACE RIGHTS ONLY
- M + S MINING AND SURFACE RIGHTS

Description	Order No	Date	Disposition	File

SAND AND GRAVEL

NOTES

Reservation for Deputy Chief Ranger's Headquarters site shown thus [Symbol] File 110657

Flooding Rights on Kenogamissi Lk & Mattagami R are reserved to Ont Hydro — LO 7598 File 1163 vol 3

1291/J2

THE INFORMATION ON THIS MAP HAS BEEN COMPILED FROM VARIOUS SOURCES AND IS NOT GUARANTEED TO BE COMPLETELY ACCURATE. THE USER SHALL TAKE RESPONSIBILITY FOR OBTAINING NECESSARY INFORMATION FROM THE APPROPRIATE AGENCIES.

Bristol Twp

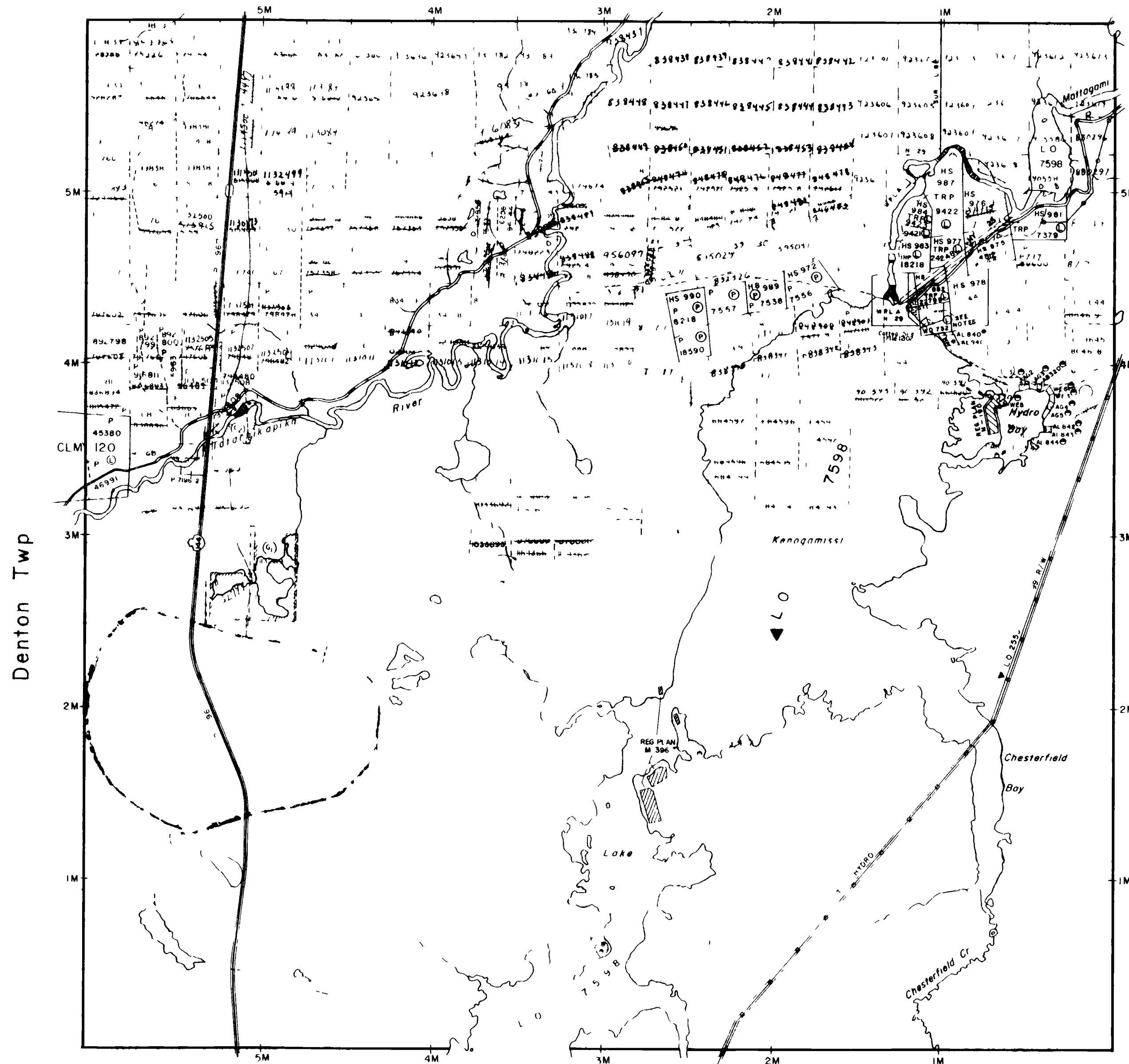

Mc Keown Twp

LEGEND

- HIGHWAY AND ROUTE No. [Symbol]
- OTHER ROAD [Symbol]
- TRAILS [Symbol]
- SURVEYED LINES [Symbol]
- TOWNSHIP BAL LINES ETC [Symbol]
- LOTS, MINING CLAIMS, PARCELS ETC [Symbol]
- UNSURVEYED LINE [Symbol]
- LOT LINES [Symbol]
- PARCEL BOUNDARY [Symbol]
- MINING CLAIM, ETC [Symbol]
- RAILWAY AND RIGHT OF WAY [Symbol]
- UTILITY LINES [Symbol]
- NON PERENNIAL STREAM [Symbol]
- FLOODING OR FLOODING RIGHTS [Symbol]
- SUBDIVISION (COMPOSITE PLAN) [Symbol]
- RESERVATION [Symbol]
- ORIGINAL SHORE LINE [Symbol]
- MARSH OR MUSKELGONIA [Symbol]
- MINES [Symbol]
- TRAVERSE MONUMENT [Symbol]

DISPOSITION OF CROWN LANDS

TYPE OF DOCUMENT	SYMBOL
PATENT SURFACE & MINING RIGHTS	P or ●
SURFACE RIGHTS ONLY	○
MINING RIGHTS ONLY	○ or ◻
LEASE SURFACE & MINING RIGHTS	○ or ◻
SURFACE RIGHTS ONLY	◻
MINING RIGHTS ONLY	◻
LICENCE OF OCCUPATION	LO or ▼
ORDER IN COUNCIL	OC
RESERVATION	⊙
CANCELLED	⊗
"AND" & "OR"	()

NOTE MINING RIGHTS IN PARCELS PATENTED PRIOR TO MAY 6 1913 VESTED IN ORIGINAL PATENTEE BY THE PUBLIC LANDS ACT R.S.O. 1970 CHAP. 380 SEC. 63 SUBSEC. 1

SCALE 1 INCH = 40 CHAINS

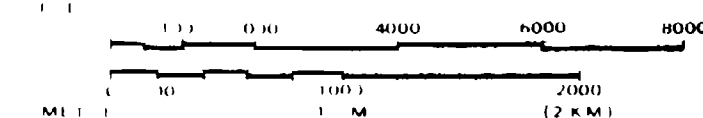

TOWNSHIP **63.5905**

THORNELOE

MNR ADMINISTRATIVE DISTRICT

TIMMINS

MINING DIVISION

PORCUPINE

LAND TITLES / REGISTRY DIVISION

COCHRANE

Ministry of Land
Natural Resources Management
Ontario Branch

Date MARCH 1985

Number

Apr 4 85

G-3229

