



42A06SW0083 63.1301 PRICE

010

March 3, 1964

O'Leary Malartic Mines Limited
654 Murdoch Ave.
Koranda, Que.

SELF POTENTIAL SURVEY
PRICE TOWNSHIP

Gentlemen:

A self potential survey has been completed over all portions of your option covering claims 39855 to 872 inclusive and 52391 to 408 inclusive which are east of the Grassy River. As the claims are actually located about a half mile southeast of the position indicated on the township map very little ground remains west of the river.

The work indicated one strong and several weakly anomalous zones trending about north-south and two strongly anomalous areas trending east-west.

The strong north-south zone coincides with a band of iron formation which forms a rather obvious structure in outcrop and on which considerable work was done years ago, apparently without much success. This is designated anomaly "E".

One of the weak north-south zones is on the northerly extension of the North Showing where excellent character samples of copper ore were obtained in trenching last Fall. This has been designated anomaly "C" and extends for some 2000 feet.

Two other weakly anomalous north-south zones occur in the south part of the property which are believed to coincide with zones shearing and merit prospecting. These are designated "F" and "G".

Of greatest interest are two strongly anomalous areas trending east-west which have been designated anomalies "A" and "B". Their source is unknown. However, they strike across the trend of the bedded rocks parallel to the South Showing where interesting copper mineralization occurs over a length of several hundred feet. Zone "A" is largely along line 36 north and extends for over 1000 feet. Similarly Zone "B" extends along lines 69 and 72 north for over 1000 feet.

A weak to moderately anomalous zone trends north into Anomaly "B" just west of the base line. This has been designated Anomaly "D"

Limited electromagnetic work was done over swampy ground in the east central part of the property. This gave little useful evidence. This type of survey was also tested over the South Showing without success.

Two days of detail work were done over the North and South Showings, results of which are shown on a separate plan of 50 feet to the inch. Readings were not very strong over either zone although the South Showing gave more definite results. Apparently the mineralization is not very continuous and its extension to depth is doubtful.

If anomaly "C" marks the northerly extension of the North Showing it would indicate a great length for this structure and, in view of the values obtained in the showing, this could be important.

Anomalies "A" and "B" probably indicate extensive areas of fracturing and sulphide replacement. If this contains appreciable copper it could prove very important. However, it is quite possible that it contains only iron sulphides without sufficient copper to make ore. The copper content could, of course, vary from place to place.

I would recommend that anomalies "A" and "B" be detailed to determine their limits and local irregularities and that some geochemical sampling be done over these areas to determine whether they contain appreciable copper. While they definitely warrant drilling they are so extensive that any program to eliminate the possibility of any parts of them containing copper by drilling alone would be quite expensive.

Respectfully submitted,

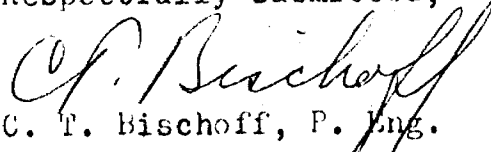
C. T. Bischoff, P. Eng.



30
17.
4W
KE
N

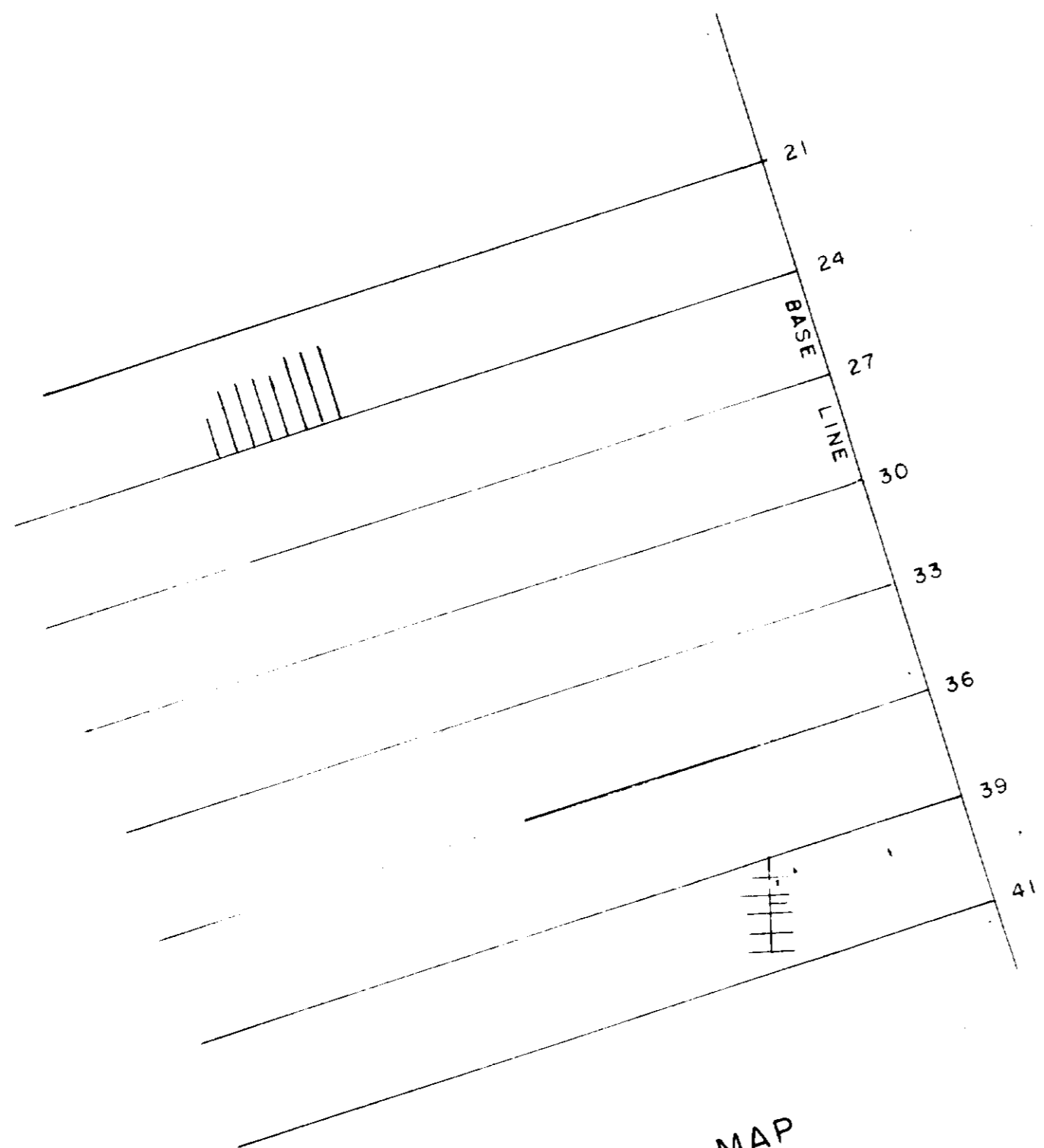

LOCATION MAP
SCALE 1" = 400'

O'LEARY MALARTIC MINES LIMITED
SELF-POTENTIAL DETAIL
AROUND SHOWINGS

SCALE 1" = 50' FEBRUARY 1964 C T BISCHOFF, P Eng

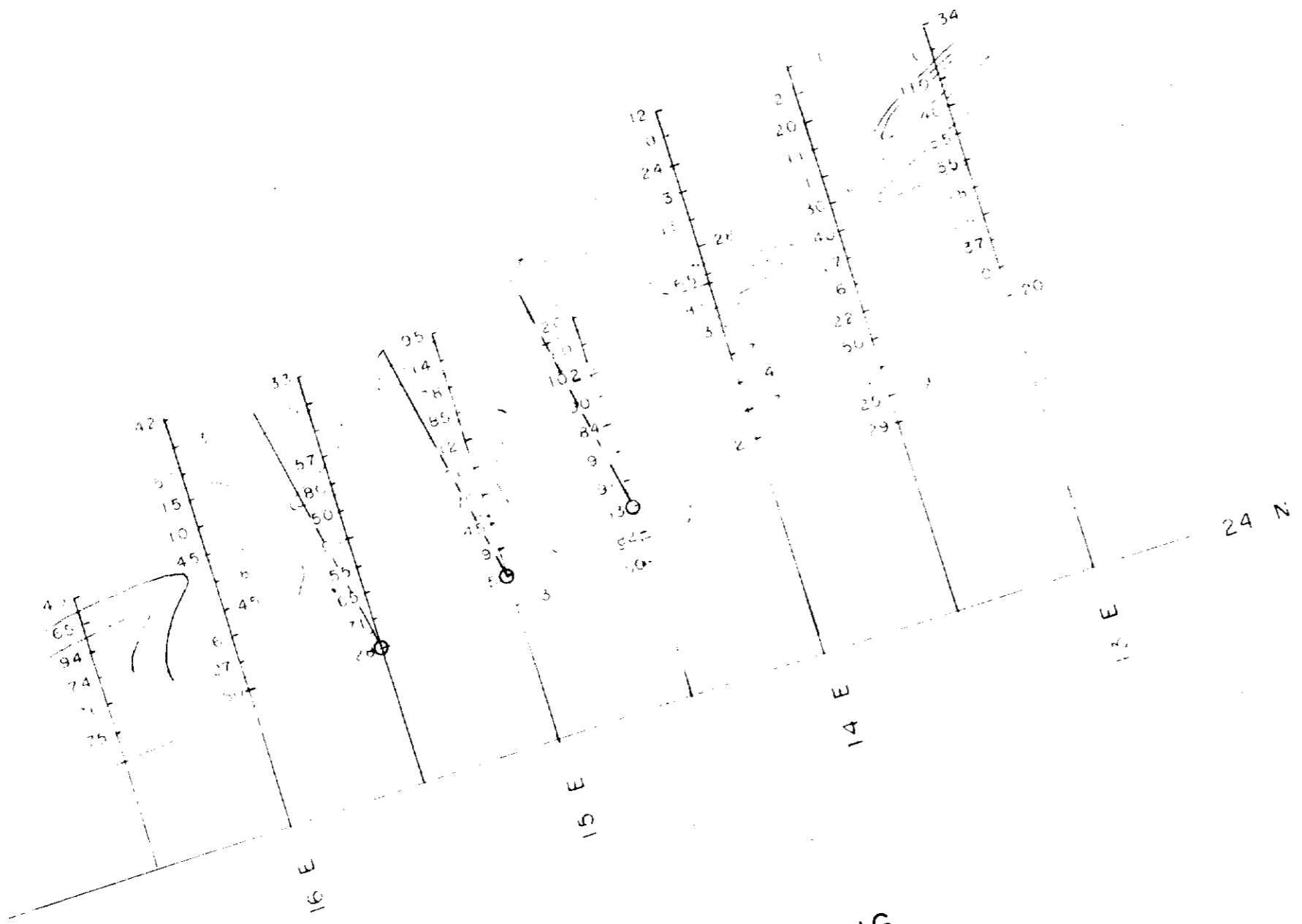

SOUTH SHOWING

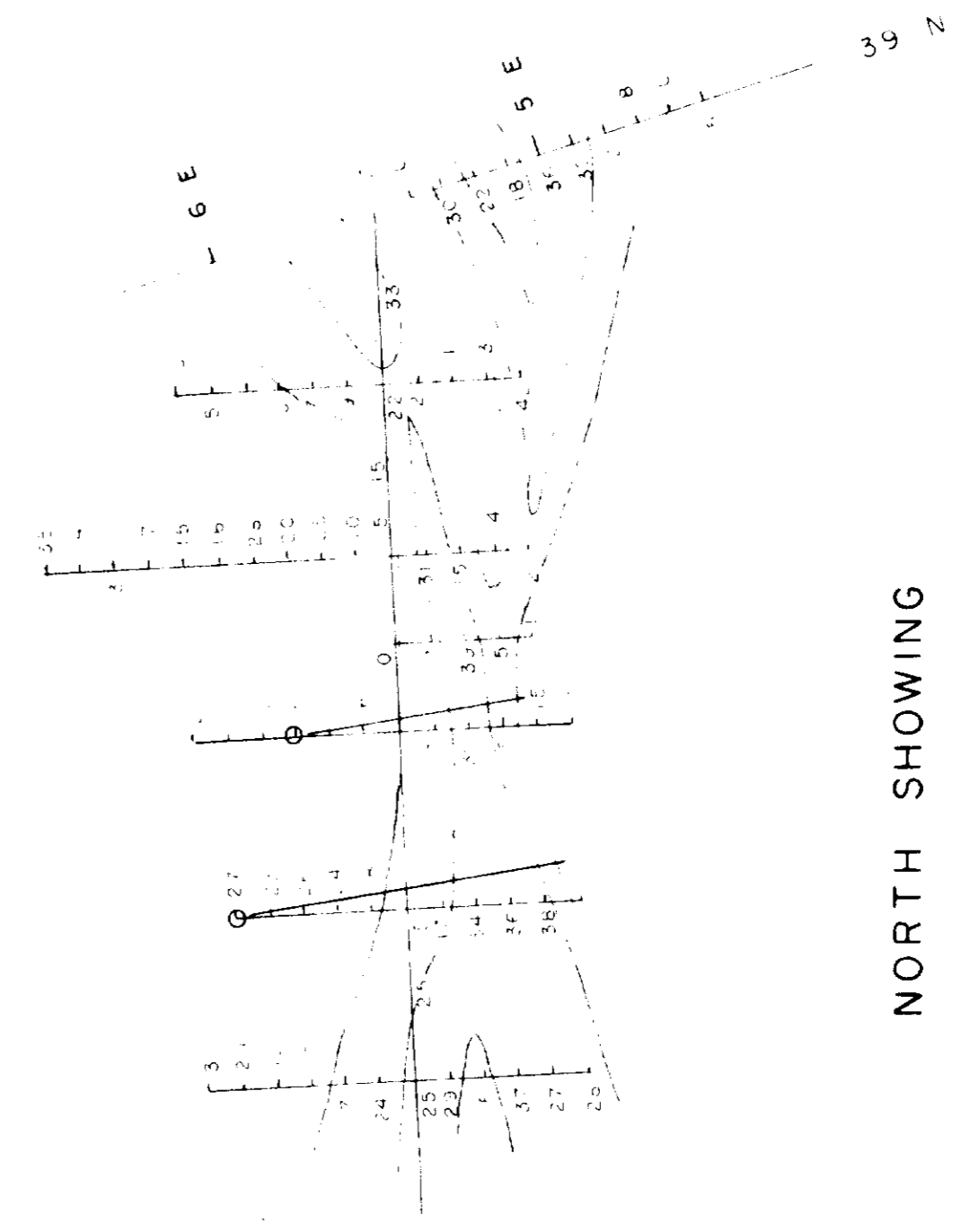

NORTH SHOWING



O'LEARY MALARTIC MINES LIMITED

PRICE TOWNSHIP, ONT.

SELF - POTENTIAL SURVEY

SCALE 1" = 200' FEBRUARY 29, 1964 C.T. BISCHOFF, P. Eng.

C.T. Bischoff

- NOTE: 1 - Relative potentials are shown in millivolts - negative left & positive right of line
2 - Electromagnetic profiles scale 1" = 10° - solid line with transmitting coil 90° with line, E dips plotted to right, W dips to left - broken line with transmitting coil 0° line, N dips plotted to right, S dips to left

