

42A06SW0098 2.7250 THORNELOE

010

COMSTATE RESOURCES LTD.

Geological Survey

Thorneloe Property

Thorneloe Township

Porcupine Mining Division, Ontario

RECEIVED

OCT 01 1984

MINING LANDS SECTION

September, 1984

Timmins, Ontario

D.R. Pyke, Ph.D.

PORCUPINE MINING DIVISION

RECEIVED

SEP 27 1984

A.M. P.M.

7 8 9 10 11 12 1 2 3 4 5 6



42A06SW0098 2.7250 THORNELOE

010C

TABLE OF CONTENTS

Introduction

Access

Previous Work

Property Geology

Conclusions and Recommendations

References

Figure 1: Location of Comstate Resources Property,
Thorneloe Twp.

Enclosed Map: Geology of Comstate Resources Property,
Thorneloe Twp.

Introduction

The property consists of 16 claims situated in northeast Thorneloe Township near the north end of Kenogamissi Lake on the Mattagami River (Figure 1). North trending cut-lines, spaced at 100 metre intervals and picketed every 25 metres provided mapping control.

The property, currently held by Comstate Resources Ltd., consists of the following claims:

P. 568441	P. 595997
P. 568443	P. 595998
P. 568444	P. 595999
P. 568445	P. 596000
P. 595029	P. 596001
P. 595030	P. 661519
P. 595031	P. 831661
P. 595032	P. 661520

Access

An all weather gravel road from the City of Timmins to the north end of Kenogamissi Lake provides easy access to the property.

Previous Work

The north Thorneloe area was first mapped by A.G. Burrows (1911,1912), as part of a geological inves-

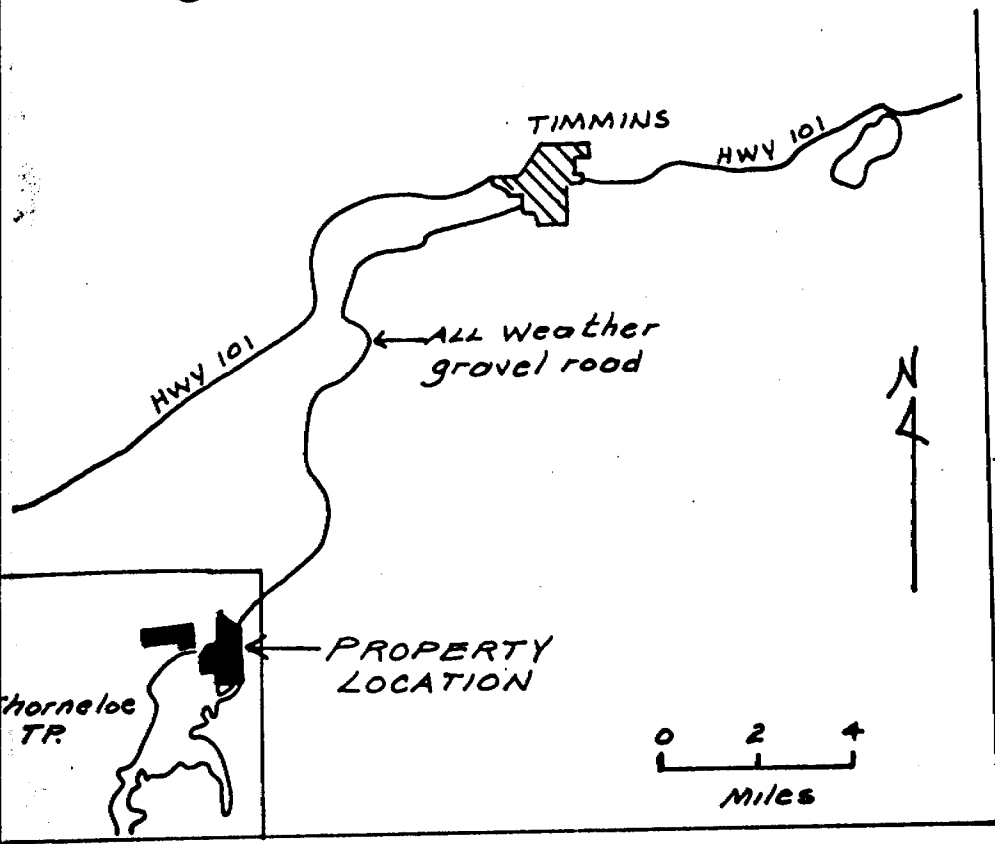
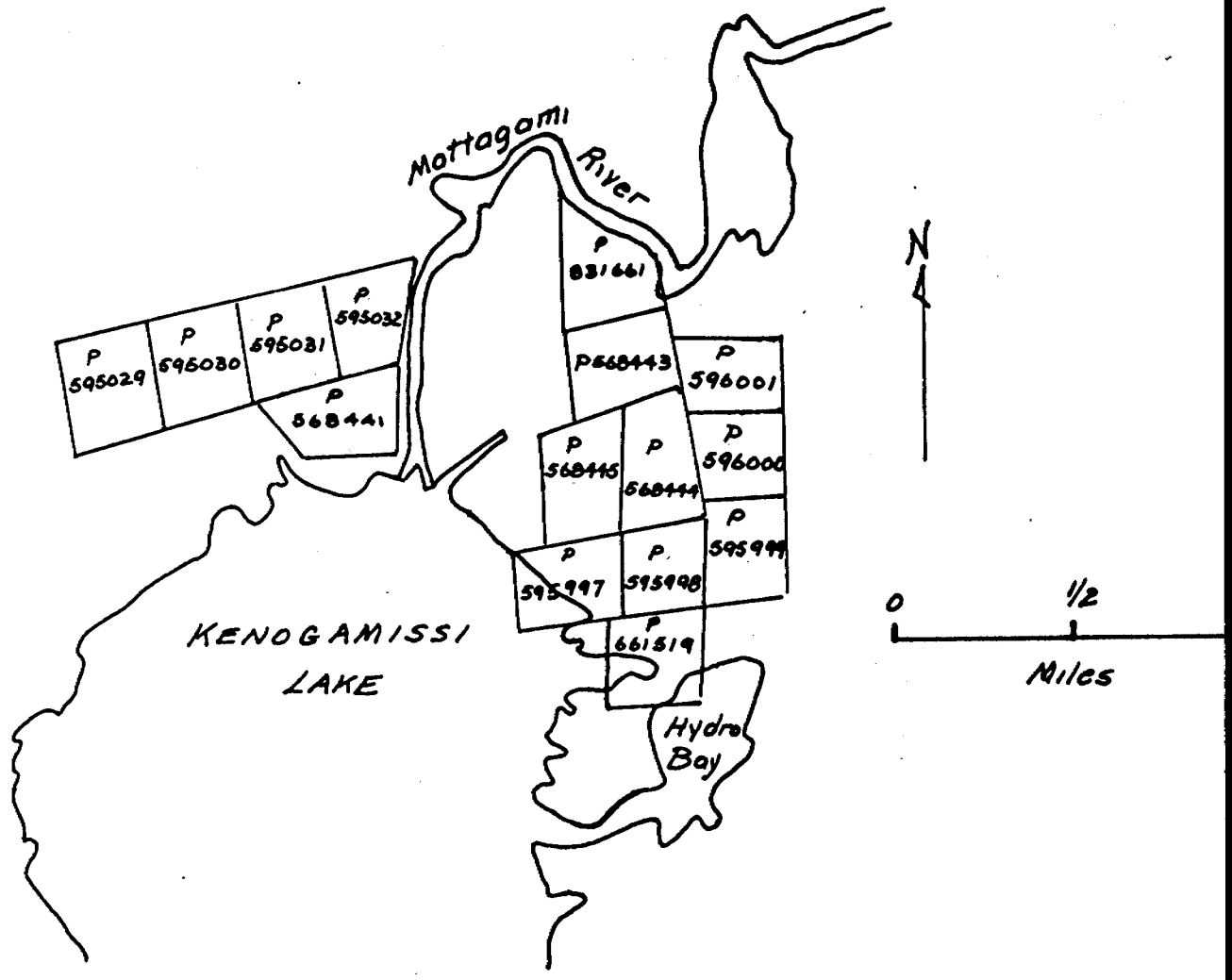

Figure 1 - Location of ComSTATE Resource Property, Thorneloe T.P.



tigation of the general Porcupine gold area. In 1937, the area was remapped by Harding and Berry(1939) at a scale of 1 inch to 1 mile, as part of a reconnaissance survey of the Keefer - Eldorado area.

Previous exploration work in the area has largely been confined to a group of ten claims(including five patented claims) which lie immediately west of the Mattagami River. The ten claims were originally acquired by Mr. J. Thibeault and his associates of Timmins, and were held by them for a period of 20 years up to 1937. During this period, the property was worked intermittently. Two shallow shafts (114 feet and 28 feet respectively) were sunk, a small mining plant and a five-ton test mill were erected, and a small amount of gold was reported to have been produced (Harding and Berry, 1939).

In 1980, Comstate Resources Ltd. conducted a geochemical (humus) survey over the Thorneloe property. On claim P. 568441, humus samples were collected at 100 foot intervals, and 174 of these samples were analyzed for gold and arsenic. Four areas of weakly anomalous gold concentrations were outlined in the humus horizon; maximum gold content was 29 parts per billion. Two of the gold anomalies showed corresponding arsenic anomalies. Seventy-one humus samples obtained from the north half of claims P 568444, P 568445 and P 596000 were analyzed for gold and arsenic; no anomalous values were detected.

In 1981, Comstate Resources Ltd. drilled 16 per-

cussion overburden drill holes on claim P 568441, and 54 holes across claims P 568445, P 568444, P 596000 and P 596001. Lodgement till suitable for sampling was found to be extremely scarce. Only eleven samples were analyzed, and none contained detectable gold.

In 1983, Kerr Addison Mines Ltd., under option from Comstate Resources, completed magnetic and electromagnetic (VLF) surveys over the claim group. Two diamond drill holes, totalling 1,002 feet, were subsequently sunk and no significant gold values were encountered.

Property Geology

The property appears to be largely underlain by sedimentary rocks, of which four mappable units were distinguished in the present survey:

4. Sandstone (Tuff?)
3. Graphitic argillite, interbedded siltstone and minor sandstone,
2. Mariposite-bearing carbonate zone; in part fragmental,
1. Graphitic chert, siltstone and felsic tuff.

Some of the rocks, especially in the sandstone unit, may be tuffaceous; however, no consistent mappable criteria could be established for a tuff-sediment differentiation.

Sandstone (Tuff?)

The sandstone is light brown to buff weathering, fine grained, light grey-green fresh surface and weakly carbonatized. Sericitization is locally pronounced, and

less than one percent pyrite is common. Rarely is bedding discernable, rather the rock is massive in appearance and possesses a moderate to well developed foliation. Bedding is best observed in the river channel below the Ontario Hydro dams. Exposures of the sandstone are confined to the northern part of the claim group.

Interbedded Graphitic Argillite - Siltstone-Sandstone

Fine grained interbedded buff weathering siltstone and minor sandstone and black argillite- graphitic argillite form a mappable unit immediately south of the sandstone. The sandstone-siltstone layers vary from 2 mm. to 10 cm. in thickness and tend to be somewhat lensoidal and discontinuous as a result of boudinaging parallel to bedding. The argillite is black on fresh and weathered surface and forms layers commonly 3 to 5 mms. in thickness. Broken surfaces of the argillite display a graphitic sheen. A conglomeratic unit with buff to white weathering fragments up to one inch in size and forming 15 percent of the rock occurs near Line 9W, 875 N.

Mariposite - bearing Carbonate Zone

A mariposite - bearing carbonate zone, approximately 200 feet thick, outcrops in the southern part of claims P 568441 and P 568445. The rocks weather rusty brown, have a pitted, hackly appearance and are strongly schistose, composed largely of light brown to grey carbonate, quartz, minor sericite and traces to ten percent mariposite.

Mariposite is especially common in and adjacent to areas of quartz veining. Patchy silicification is locally pronounced. Up to 1 - 2 percent fine disseminated pyrite occurs in those areas where silicification, mariposite and quartz veining are prominent. Narrow, discontinuous quartz veinlets, 2-3 mm wide and 1-2 cm in length, locally form up to 15-20% of the carbonate rock.

In a few exposures, fragments of carbonatized volcanic rock form 5 to 10 percent of the rock. The fragments range in size from 0.25 to six inches and are strongly elongated parallel to foliation. A fragmental texture is especially well developed in the outcrop west of Line 8W, 700 N.

In the writer's opinion, the mariposite-bearing carbonate zone is best interpreted as a carbonatized volcanoclastic or tuffaceous rock with a significant ultramafic component.

Graphitic Chert, Siltstone and Felsic Tuff

Finely interbedded graphitic chert and siltstone are found in the southern portion of a large outcrop west of the number three post of claim P 568445. The chert layers are aphanitic, black, range from 2 to 10 mm in thickness and form differentially weathered ridges on the outcrop surface. The siltstone layers are very fine grained, buff-brown weathering, 5 - 20 mm in thickness, and form approximately 60 percent of the exposed unit. The northern portion of the above outcrop consists of fine grained, schistose, light grey-green felsic tuff.

Structure

All the rocks are moderately to strongly foliated, and some of the mariposite - carbonate rocks are extremely schistose. Foliations dip steeply north and trend in an east - east-southeast direction. In the few outcrops where layering was observed, foliation and layering were parallel to sub-parallel.

Two prominent fracture cleavages were observed - one trending 070° - 85° , the other 035° - 40° ; both cleavages dip steeply north. The latter cleavage commonly produces steep north plunging crenulations within the foliation plane.

Quartz veining on the property strikes easterly and appears to largely parallel the east striking fracture cleavage. Quartz veins are commonly 12 to 18 inches wide. A few quartz veins or lenses were observed to have a cigar-like shape with a sub-horizontal to shallow eastward plunge.

Conclusions and Recommendations

The property is underlain by an east striking, steeply north dipping, strongly foliated to schistose sedimentary - volcanoclastic sequence. A prominent mariposite-bearing carbonate zone, of possible volcanoclastic derivation, contains numerous quartz veins which have been extensively trenched on the west portion of the property. The westerly extension of this unit passes

through the Thibeault shafts where gold mineralization was previously reported. Very limited exploration work has been performed on the Comstate property east of the Mattagami River where exposure of the mariposite-carbonate unit is sparse. As minor disseminated sulphide is associated with this unit within zones of quartz veining and silicification, an I.P. survey would be warranted to delineate such zones for possible gold mineralization.

Further work on the property would be contingent on the results of the I P survey.

W R Lyke

REFERENCES

Burrows, A.G.

1911: The Porcupine gold area; Ont. Bureau of Mines,
Vol. 20, pt. 2

1912: The Porcupine gold area, Second Report;
Ontario Bureau of Mines, Vol. 21, pt. 1,
p. 205 - 249.

Harding, W.D. and Berry, L.G.

1938: Geology of the Keefer - Eldorado area;
Ont. Dept. Mines, Vol. 47, pt 4., p. 1-26.

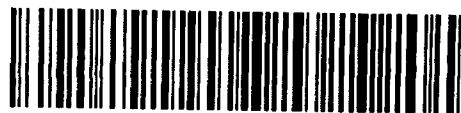

TO BE ATTACHED AS AN APPENDIX TO TECHNICAL REPORT
FACTS SHOWN HERE NEED NOT BE REPEATED IN REPORT
TECHNICAL REPORT MUST CONTAIN INTERPRETATION, CONCLUSIONS ETC.

Type of Survey(s) Geological
Township or Area THORNELOE
Claim Holder(s) COMSTATE RESOURCES LTD
Survey Company D.R. PYKE ASSOCIATES INC.
Author of Report D. R. PYKE
Address of Author 31 DELAIR CRES THORNHILL ONT
Covering Dates of Survey JAN 83 - SEPT 84
(linecutting to office)
Total Miles of Line Cut 16.4

MINING CLAIMS TRAVERSED	
List numerically	
P	568441
(prefix)	(number)
P	568443
P	568444
P	568445
P	595029
P	595030
P	595031
P	595032
P	595997
P	595998
P	595999
P	596000
P	596001
P	661519
P	831661
P	661520
TOTAL CLAIMS <u>15</u>	

If space insufficient, attach list

SPECIAL PROVISIONS CREDITS REQUESTED	DAYS per claim
Geophysical	
-Electromagnetic	
-Magnetometer	
-Radiometric	
-Other	
Geological	<u>20</u>
Geochemical	

AIRBORNE CREDITS (Special provision credits do not apply to airborne surveys)

Magnetometer _____ Electromagnetic _____ Radiometric _____
(enter days per claim)

DATE: Sept 26/84 SIGNATURE: D.R. Pyke
Author of Report or Agent

Res. Geol. _____ Qualifications 23877

Previous Surveys			
File No.	Type	Date	Claim Holder

OFFICE USE ONLY

GEOPHYSICAL TECHNICAL DATA

GROUND SURVEYS -- If more than one survey, specify data for each type of survey

Number of Stations _____ Number of Readings _____
Station interval _____ Line spacing _____
Profile scale _____
Contour interval _____

MAGNETIC

Instrument _____
Accuracy -- Scale constant _____
Diurnal correction method _____
Base Station check-in interval (hours) _____
Base Station location and value _____

ELECTROMAGNETIC

Instrument _____
Coil configuration _____
Coil separation _____
Accuracy _____
Method: Fixed transmitter Shoot back In line Parallel line
Frequency _____
(specify V.L.F. station)
Parameters measured _____

GRAVITY

Instrument _____
Scale constant _____
Corrections made _____

Base station value and location _____

Elevation accuracy _____

**INDUCED POLARIZATION
RESISTIVITY**

Instrument _____
Method Time Domain Frequency Domain
Parameters -- On time _____ Frequency _____
-- Off time _____ Range _____
-- Delay time _____
-- Integration time _____
Power _____
Electrode array _____
Electrode spacing _____
Type of electrode _____

SELF POTENTIAL

Instrument _____ Range _____

Survey Method _____

Corrections made _____

RADIOMETRIC

Instrument _____

Values measured _____

Energy windows (levels) _____

Height of instrument _____ Background Count _____

Size of detector _____

Overburden _____

(type, depth - include outcrop map)

OTHERS (SEISMIC, DRILL WELL, LOGGING ETC.)

Type of survey Geological

Instrument _____

Accuracy _____

Parameters measured _____

Additional information (for understanding results) N-S lines, cut @ 100 metre intervals and picketed every 25 meters provided mapping control.

AIRBORNE SURVEYS

Type of survey(s) _____

Instrument(s) _____

(specify for each type of survey)

Accuracy _____

(specify for each type of survey)

Aircraft used _____

Sensor altitude _____

Navigation and flight path recovery method _____

Aircraft altitude _____ Line Spacing _____

Miles flown over total area _____ Over claims only _____

GEOCHEMICAL SURVEY – PROCEDURE RECORD

Numbers of claims from which samples taken _____

Total Number of Samples _____

Type of Sample _____
(Nature of Material)

Average Sample Weight _____

Method of Collection _____

Soil Horizon Sampled _____

Horizon Development _____

Sample Depth _____

Terrain _____

Drainage Development _____

Estimated Range of Overburden Thickness _____

SAMPLE PREPARATION
(Includes drying, screening, crushing, ashing)

Mesh size of fraction used for analysis _____

General _____

ANALYTICAL METHODS

Values expressed in: per cent
p. p. m.
p. p. b.

Cu, Pb, Zn, Ni, Co, Ag, Mo, As, -(circle)

Others _____

Field Analysis (_____ tests)

Extraction Method _____

Analytical Method _____

Reagents Used _____

Field Laboratory Analysis

No. (_____ tests)

Extraction Method _____

Analytical Method _____

Reagents Used _____

Commercial Laboratory (_____ tests)

Name of Laboratory _____

Extraction Method _____

Analytical Method _____

Reagents Used _____

General _____

W.R.

#306/84

The Mining Act

27250

- Instructions: - Please type or print.
 - If number of mining claims traversed exceeds space on this form, attach a list.
 Note: - Only days credits calculated in the "Expenditures" section may be entered in the "Expend. Days Cr." columns.
 - Do not use shaded areas below.

Sept 28th

Type of Survey(s) **GEOLOGICAL** Township or Area **THORNELOE**

Claim Holder(s) **D. R. PYKE** Prospector's Licence No. **K19126**

Address **31 DELAIR CRES THORNHILL ONT. L3T 2M3**

Survey Company **D. R. PYKE & ASSOCIATES INC** Date of Survey (from & to) **6 07 84 27 07 84** Total Miles of line Cut **16.4**

Name and Address of Author (of Geo-Technical report) **D. R. PYKE 31 DELAIR CRES THORNHILL ONT L3T 2M3**

Credits Requested per Each Claim in Columns at right		
Special Provisions	Geophysical	Days per Claim
For first survey: Enter 40 days. (This includes line cutting)	- Electromagnetic	
	- Magnetometer	
For each additional survey: using the same grid: Enter 20 days (for each)	- Radiometric	
	- Other	
	Geological	20
	Geochemical	
Man Days	Geophysical	Days per Claim
Complete reverse side and enter total(s) here	- Electromagnetic	
	- Magnetometer	
	- Radiometric	
	- Other	
	Geological	
	Geochemical	
Airborne Credits	Geophysical	Days per Claim
Note: Special provisions credits do not apply to Airborne Surveys.	- Electromagnetic	
	- Magnetometer	
	- Radiometric	

Mining Claims Traversed (List in numerical sequence)		
Mining Claim Prefix	Mining Claim Number	Expend. Days Cr.
P	568441	
	568442	
	568443	
	568444	
	568445	
	595028	
	595029	
	595030	
	595031	
	595032	
	595997	
	595998	
	595999	
	596000	
	596001	
	661519	

RECEIVED
AUG 13 1984
MINING LANDS SECTION

RECORDED
JUL 30 1984
Receipt No. **JD**

RECEIVED
JUL 30 1984
A.M. P.M.
7 8 9 10 11 12 1 2 3 4 5 6

Expenditures (excludes power stripping)

Type of Work Performed

Performed on Claim(s)

Calculation of Expenditure Days Credits

Total Expenditures **\$** ÷ **15** = Total Days Credits

Instructions
Total Days Credits may be apportioned at the claim holder's choice. Enter number of days credits per claim selected in columns at right.

Total number of mining claims covered by this report of work. **16**

Date **July 30/84** Recorded Holder or Agent (Signature) **D.R. Pyke**

For Office Use Only

Total Days Cr. Recorded **320** Date Recorded **July 30, 1984** Mining Recorder **[Signature]**

Date Approved as Recorded **See Revised Statement** Mining Recorder **[Signature]**

Certification Verifying Report of Work

I hereby certify that I have a personal and intimate knowledge of the facts set forth in the Report of Work annexed hereto, having performed the work or witnessed same during and/or after its completion and the annexed report is true.

Name and Postal Address of Person Certifying **D. R. PYKE, P.O. Box 1142 Timmins Ont P4N 7H9**

Date Certified **July 30/84** Certified by (Signature) **D.R. Pyke**

404/84

Nov. 26th
Instructions: - Please type or print.
- If number of mining claims traversed exceeds space on this form, attach a list.
Note: - Only days credits calculated in the "Expenditures" section may be entered in the "Expend. Days Cr." columns.
- Do not use shaded areas below.

The Mining Act

Type of Survey(s) Geological, Township or Area THORNELOE, Claim Holder(s) D. McVittie, Prospector's Licence No. M21375, Address Box 370 HUNTSVILLE ONTARIO, Survey Company D.R. Pyke & Assocs. Inc, Date of Survey (from & to) 25 09 84 to 26 09 84, Total Miles of line Cut, Name and Address of Author (of Geo-Technical report) D.R. PYKE 31 DELAIR CRES THORNHILL ONT

Credits Requested per Each Claim in Columns at right. Special Provisions: For first survey: Enter 40 days. For each additional survey: Enter 20 days. Man Days: Complete reverse side and enter total(s) here. Airborne Credits: Note: Special provisions credits do not apply to Airborne Surveys.

Mining Claims Traversed (List in numerical sequence). Table with columns: Mining Claim Prefix, Mining Claim Number, Expend. Days Cr.

RECEIVED OCT 18 1984 MINING DIVISION

Expenditures (excludes power stripping). Type of Work Performed, Performed on Claim(s), Calculator of Expenditure Days Credits, Total Expenditures \$25, Total Days Credits 20. Instructions: Total Days Credits may be apportioned at the claim holder's choice.

Total number of mining claims covered by this report of work. 1

For Office Use Only. Total Days Cr. Recorded 20, Date Recorded Sept 27/84, Mining Recorder, Date Approved as Recorded 54.10.76, Blasting Recorder.

Date Sept 27/84, Recorded Holder of Agency (Signature) D.R. Pyke

Certification Verifying Report of Work. I hereby certify that I have a personal and intimate knowledge of the facts set forth in the Report of Work annexed hereto, having performed the work or witnessed same during and/or after its completion and the annexed report is true. Name and Postal Address of Person Certifying: D.R. PYKE P.O. Box 1142 TIMMINS ONTARIO P4N 7H9. Date Certified: SEPT 27/84, Certified by (Signature) D.R. Pyke.

27250 # 407/84

Instructions: - Please type or print.
 - If number of mining claims traversed exceeds space on this form, attach a list.
 Note: - Only days credits calculated in the "Expenditures" section may be entered in the "Expend. Days Cr." columns.
 - Do not use shaded areas below.

Nov. 26th

The Mining Act

Type of Survey(s) Geological	Township or Area THORNELDE
Claim Holder(s) COMSTATE Resources LTD	Prospector's Licence No. T-1127
Address #901-1015 4th St. S.W. CALGARY Alberta T2R 1J4	
Survey Company D.R. PYKE & ASSOC. INC	Date of Survey (from & to) Day Mo. Yr. 6 07 84 Day Mo. Yr. 27 07 84
Name and Address of Author (of Geo-Technical report) D. R. PYKE 31 DELAIR CRES THORNHILL ONT. L3T 2M3	

Special Provisions	Geophysical		Days per Claim	Mining Claims Traversed (List in numerical sequence)		
	- Electromagnetic	- Magnetometer		Prefix	Number	Expend. Days Cr.
For first survey: Enter 40 days. (This includes line cutting)				P	661520	
For each additional survey using the same grid: Enter 20 days (for each)	- Radiometric	- Other				
Man Days Complete reverse side and enter total(s) here	Geological	Geochemical				
Airborne Credits Note: Special provisions credits do not apply to Airborne Surveys.	Geophysical	Days per Claim	20			
	- Electromagnetic					
	- Magnetometer					
	- Radiometric					
	- Other					
	Geological					
	Geochemical					
	Electromagnetic					
	Magnetometer					
	Radiometric					

RECORDED
 SEP 27 1984
 [Signature]

See aerial work statement.

Expenditures (excludes power stripping)

Type of Work Performed

Performed on Claim(s)

Calculation of Expenditure Days Credits

Total Expenditures \$ [] A.M. [] P.M.

Instructions
 Total Days Credits may be apportioned at the claim holder's choice. Enter number of days credits per claim selected in columns at right.

PORCUPINE MINING DIVISION
 RECEIVED
 SEP 27 1984

For Office Use Only		Mining Recorder
Total Days Cr. Recorded	Date Recorded	
20	Sept 27/84	
Date Approved as Recorded		

Date **Sept 27/84** | Recorder/Holder of Agent (Signature) **D.R. Pyke**

Certification Verifying Report of Work

I hereby certify that I have a personal and intimate knowledge of the facts set forth in the Report of Work annexed hereto, having performed the work or witnessed same during and/or after its completion and the annexed report is true.

Name and Postal Address of Person Certifying
D. R. Pyke P.O. Box 1142 Timmins Ont

Date Certified **Sept 27/84** | Certified by (Signature) **D.R. Pyke**



Ministry of
Natural
Resources

Jan 7/85

1984 12 21

Your File: 407/84
Our File: 2.7250

Mining Recorder
Ministry of Natural Resources
60 Wilson Avenue
Timmins, Ontario
P4N 2S7

Dear Sir:

Enclosed are two copies of a Notice of Intent with statements listing a reduced rate of assessment work credits to be allowed for a technical survey. Please forward one copy to the recorded holder of the claims and retain the other. In approximately fifteen days from the above date, a final letter of approval of these credits will be sent to you. On receipt of the approval letter, you may then change the work entries on the claim record sheets.

For further information, if required, please contact Mr. R.J. Pichette at 416/965-4888.

Yours sincerely,

S.E. Yundt
Director
Land Management Branch

Whitney Block, Room 6643
Queen's Park
Toronto, Ontario
M7A 1W3

R.W.K. D. Kinvig:mc

Encls.

cc: Comstate Resources Ltd
Suite 901
1015 4th Street SW
Calgary, Alberta
T2R 1J4

cc: Mr. G.H. Ferguson
Mining & Lands Commissioner
Toronto, Ontario

cc: D.R. Pyke
31 Delair Crescent
Thornhill, Ontario
L3T 2M3



Ministry of
Natural
Resources

Notice of Intent
for Technical Reports

1984 12 21

2.7250/407/84

An examination of your survey report indicates that the requirements of The Ontario Mining Act have not been fully met to warrant maximum assessment work credits. This notice is merely a warning that you will not be allowed the number of assessment work days credits that you expected and also that in approximately 15 days from the above date, the mining recorder will be authorized to change the entries on his record sheets to agree with the enclosed statement. Please note that until such time as the recorder actually changes the entry on the record sheet, the status of the claim remains unchanged.

If you are of the opinion that these changes by the mining recorder will jeopardize your claims, you may during the next fifteen days apply to the Mining and Lands Commissioner for an extension of time. Abstracts should be sent with your application.

If the reduced rate of credits does not jeopardize the status of the claims then you need not seek relief from the Mining and Lands Commissioner and this Notice of Intent may be disregarded.

If your survey was submitted and assessed under the "Special Provision-Performance and Coverage" method and you are of the opinion that a re-appraisal under the "Man-days" method would result in the approval of a greater number of days credit per claim, you may, within the said fifteen day period, submit assessment work breakdowns listing the employees names, addresses and the dates and hours they worked. The new work breakdowns should be submitted direct to the Land Management Branch, Toronto. The report will be re-assessed and a new statement of credits based on actual days worked will be issued.

1984 11 08

Your File: 306/84
Our File: 2.7250

Mining Recorder
Ministry of Natural Resources
60 Wilson Avenue
Timmins, Ontario
P4N 2S7

Dear Sir:

RE: Notice of Intent dated October 22, 1984.
Geological Survey on Mining Claims P 568441
et al in the Township of Thorneloe.

The assessment work credits, as listed with the
above-mentioned Notice of Intent, have been approved
as of the above date.

Please inform the recorded holder of these mining
claims and so indicate on your records.

Yours sincerely,

S.E. Yundt
Director
Land Management Branch

Whitney Block, Room 6643
Queen's Park
Toronto, Ontario
M7A 1K3
Phone:(416)965-6918

S. Hurst:sc

cc: D.R. Pyke
31 Delair Crescent
Thornhill, Ontario
L3T 2M3

cc: Mr. G.H. Ferguson
Mining & Lands Commissioner
Toronto, Ontario

cc: Resident Geologist
Timmins, Ontario

**Technical Assessment
Work Credits**

File
2.7250

Date
1984 10 22

Mining Recorder's Report of
Work No. 306/84

Recorded Holder	D.R. PYKE
Township or Area	THORNELOE TOWNSHIP

Type of survey and number of Assessment days credit per claim	Mining Claims Assessed
Geophysical Electromagnetic _____ days Magnetometer _____ days Radiometric _____ days Induced polarization _____ days Other _____ days Section 77 (19) See "Mining Claims Assessed" column Geological _____ 20 _____ days Geochemical _____ days Man days <input type="checkbox"/> Airborne <input type="checkbox"/> Special provision <input checked="" type="checkbox"/> Ground <input checked="" type="checkbox"/> <input type="checkbox"/> Credits have been reduced because of partial coverage of claims. <input type="checkbox"/> Credits have been reduced because of corrections to work dates and figures of applicant.	P 568441-43-44-45 595029 to 032 inclusive 595997 to 6001 inclusive 661519

Special credits under section 77 (16) for the following mining claims

No credits have been allowed for the following mining claims

not sufficiently covered by the survey Insufficient technical data filed

P 568442
595028

The Mining Recorder may reduce the above credits if necessary in order that the total number of approved assessment days recorded on each claim does not exceed the maximum allowed as follows: Geophysical — 80; Geological — 40; Geochemical — 40; Section 77 (19)—60:



Ministry of
Natural
Resources

NOV
~~NOV~~ 6/84

1984 10 22

Your File: 306/84
Our File: 2.7250

Mining Recorder
Ministry of Natural Resources
60 Wilson Avenue
Timmins, Ontario
P4N 2S7

Dear Sir:

Enclosed are two copies of a Notice of Intent with statements listing a reduced rate of assessment work credits to be allowed for a technical survey. Please forward one copy to the recorded holder of the claims and retain the other. In approximately fifteen days from the above date, a final letter of approval of these credits will be sent to you. On receipt of the approval letter, you may then change the work entries on the claim record sheets.

For further information, if required, please contact Mr. R.J. Pichette at 416/965-4888.

Yours sincerely,

S.E. Yundt
Director
Land Management Branch

Whitney Block, Room 6643
Queen's Park
Toronto, Ontario
M7A 1W3

RJ S. Hurst:mc

Encls.

cc: D.R. Pyke
31 Delair Crescent
Thornhill, Ontario
L3T 2M3

cc: Mr. G.H. Ferguson
Mining & Lands Commissioner
Toronto, Ontario



Ministry of
Natural
Resources

Ontario

Notice of Intent
for Technical Reports

1984 10 22

2.7250/306/84

An examination of your survey report indicates that the requirements of The Ontario Mining Act have not been fully met to warrant maximum assessment work credits. This notice is merely a warning that you will not be allowed the number of assessment work days credits that you expected and also that in approximately 15 days from the above date, the mining recorder will be authorized to change the entries on his record sheets to agree with the enclosed statement. Please note that until such time as the recorder actually changes the entry on the record sheet, the status of the claim remains unchanged.

If you are of the opinion that these changes by the mining recorder will jeopardize your claims, you may during the next fifteen days apply to the Mining and Lands Commissioner for an extension of time. Abstracts should be sent with your application.

If the reduced rate of credits does not jeopardize the status of the claims then you need not seek relief from the Mining and Lands Commissioner and this Notice of Intent may be disregarded.

If your survey was submitted and assessed under the "Special Provision-Performance and Coverage" method and you are of the opinion that a re-appraisal under the "Man-days" method would result in the approval of a greater number of days credit per claim, you may, within the said fifteen day period, submit assessment work breakdowns listing the employees names, addresses and the dates and hours they worked. The new work breakdowns should be submitted direct to the Land Management Branch, Toronto. The report will be re-assessed and a new statement of credits based on actual days worked will be issued.

Mining Lands Section

File No 2. ⁷²~~87~~50

Control Sheet

TYPE OF SURVEY GEOPHYSICAL
 GEOLOGICAL
 GEOCHEMICAL
 EXPENDITURE

MINING LANDS COMMENTS:

Leg. LB.

S. Hurst D. Kinzig.
Signature of Assessor

84-10-20 Dec. 11/84
Date

1985 01 14

Your File: 407/84
Our File: 2.7250

Mining Recorder
Ministry of Natural Resources
60 Wilson Avenue
Timmins, Ontario
P4N 2S7

Dear Sir:

RE: Notice of Intent dated December 21, 1984
Geological Survey on Mining Claim P 661520
in Thorneloe Township

The assessment work credits, as listed with the
above-mentioned Notice of Intent, have been approved
as of the above date.

Please inform the recorded holder of these mining
claims and so indicate on your records.

Yours sincerely,

S.E. Yundt
Director
Land Management Branch

Whitney Block, Room 6643
Queen's Park
Toronto, Ontario
M7A 1W3
Phone: (416) 965-4888

D. Kinvig:mc

cc: Comstate Resources Ltd
Suite 901
1015 4th Street SW
Calgary, Alberta
T2R 1J4
cc: D.R. Pyke
31 Delair Crescent
Thornhill, Ontario
L3T 2M3

cc: Mr. G.H. Ferguson
Mining & Lands Commissioner
Toronto, Ontario

cc: Resident Geologist
Timmins, Ontario

Encl.

**Technical Assessment
Work Credits**

File
2.7250

Date
1984 12 21

Mining Recorder's Report of
Work No. 407/84

Recorded Holder
COMSTATE RESOURCES LTD

Township or Area
THORNELOE TOWNSHIP

Type of survey and number of Assessment days credit per claim	Mining Claims Assessed
Geophysical Electromagnetic _____ days Magnetometer _____ days Radiometric _____ days Induced polarization _____ days Other _____ days	
Section 77 (19) See "Mining Claims Assessed" column	
Geological _____ 10 _____ days	P 661520
Geochemical _____ days	
Man days <input type="checkbox"/> Airborne <input type="checkbox"/>	
Special provision <input checked="" type="checkbox"/> Ground <input checked="" type="checkbox"/>	
<input checked="" type="checkbox"/> Credits have been reduced because of partial coverage of claims.	
<input type="checkbox"/> Credits have been reduced because of corrections to work dates and figures of applicant.	

Special credits under section 77 (16) for the following mining claims

No credits have been allowed for the following mining claims

not sufficiently covered by the survey Insufficient technical data filed

The Mining Recorder may reduce the above credits if necessary in order that the total number of approved assessment days recorded on each claim does not exceed the maximum allowed as follows: Geophysical — 80; Geological — 40; Geochemical — 40; Section 77 (19)—60:

Bristol Twp. M.264

THE TOWNSHIP OF
OF
THORNELOE

DISTRICT OF
COCHRANE

PORCUPINE
MINING DIVISION

SCALE: 1-INCH 40 CHAINS

Denton Twp. M.273

Price Twp M.307

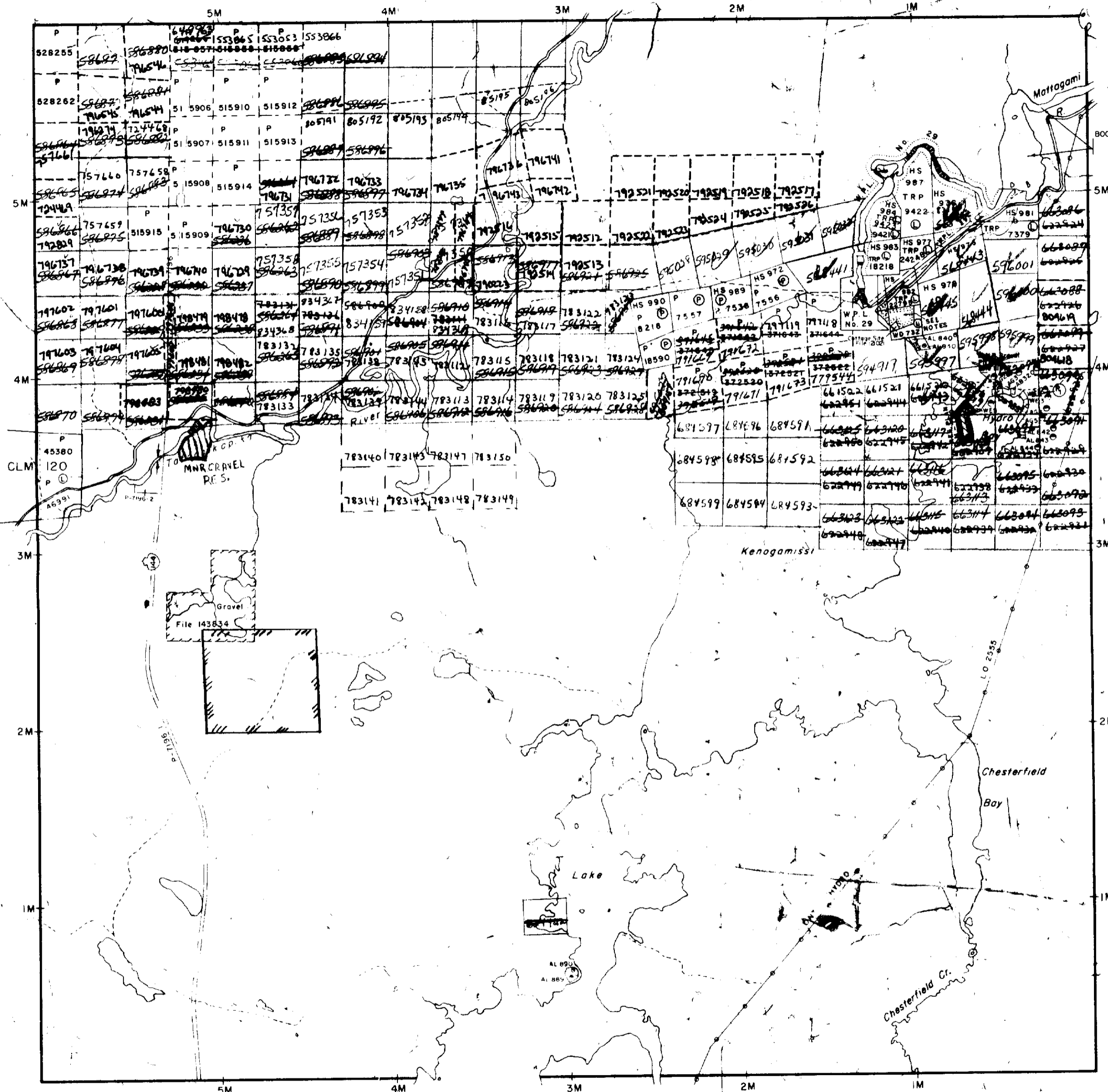

BOOMING GROUNDS
L.O 6613
FILE 73543

LEGEND

REGISTERED PLAN OF SUBDIVISION	⊖
PATENTED LAND	⊕
CROWN LAND SALE	C.S.
LEASES	⊙
LOCATED LAND	Loc.
LICENSE OF OCCUPATION	L.O.
MINING RIGHTS ONLY	M.R.O.
SURFACE RIGHTS ONLY	S.R.O.
ROADS	—
IMPROVED ROADS	—
KING'S HIGHWAYS	—
RAILWAYS	—
POWER LINES	—
MARSH OR MUSKEG	—
MINES	—
CANCELLED PATENTED S.R.O.	—
L.U.P.	—

NOTES

400' Surface Rights reservation along the shores of all lakes and rivers.

Reservation for Deputy Chief Ranger's Headquarters site shown thus: File 110657

Flooding rights on Mattagami River & Kenogamissi Lake are reserved to Ont. Hydro - L.O. 7598 File 1163 vol.3

Areas withdrawn from staking under Section 43 of the Mining Act (R.S.O. 1970.)

Order No	File	Date	Disposition
①	164584	17/5/72	R.O.

PLANNED REFORESTATION

This township lies within the Municipality of the CITY of TIMMINS

PLAN NO. **M.313**

ONTARIO
MINISTRY OF NATURAL RESOURCES
SURVEYS AND MAPPING BRANCH

Mc Keown Twp. M.299



LINE 25+00 W
 LINE 24+00 W
 LINE 23+00 W
 LINE 22+00 W
 LINE 21+00 W
 LINE 20+00 W
 LINE 19+00 W
 LINE 18+00 W
 LINE 17+00 W
 LINE 16+00 W
 LINE 15+00 W
 LINE 14+00 W
 LINE 13+00 W
 LINE 12+00 W
 LINE 11+00 W
 LINE 10+00 W
 LINE 9+00 W
 LINE 8+00 W

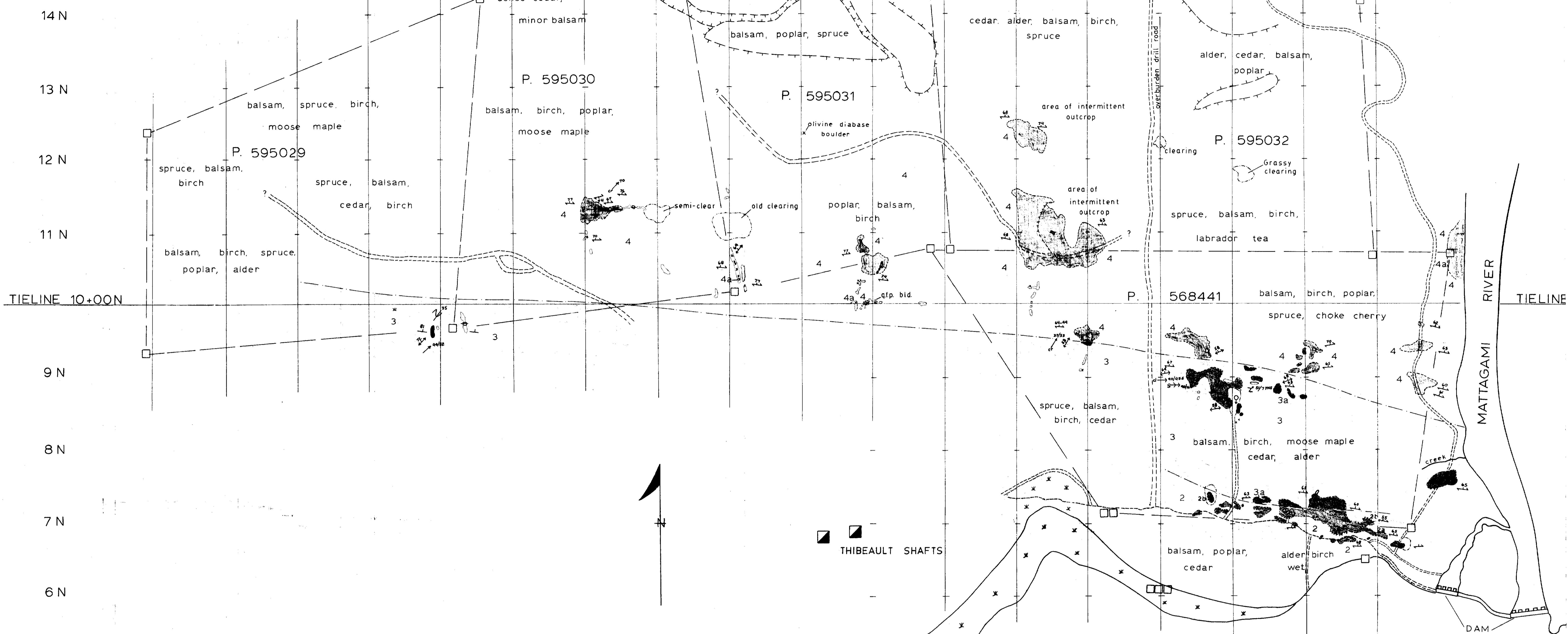

LEGEND

Archean

- 4 Sandstone (Tuff?)
4a Graphitic interbeds
- 3 Interbedded siltstone, graphitic argillite, minor sandstone
3a conglomeratic
- 2 Mariposite-bearing carbonate zone
2a well preserved fragments
2b strongly silicified, mariposite-bearing
- 1 Felsic tuff; interbedded graphitic chert/siltstone
1 graphitic chert and siltstone
1a schistose felsic tuff

SYMBOLS

- area of outcrop
- small outcrop
- pit/trench in rock
- pit/trench in overburden
- quartz vein
- strike and dip of bedding
- strike and dip of foliation
- slickensiding lineation
- crenulation lineation
- strike and dip of fracture cleavage
- trace of fracture cleavage in foliation plane
- drag fold
- diamond drill hole
- claim post
- claim line
- major road
- secondary road
- trail
- power line
- swampy area
- rise/hill

KENOGAMISSI LAKE

2.7250

SURVEY BY: COMSTATE RESOURCES LTD.	
SURVEY TYPE: GEOLOGICAL	
LOCATION: THORNELOE TOWNSHIP	DATE: SEPTEMBER, 1984
DRAWN BY: KMC	
SCALE : 1 2500	

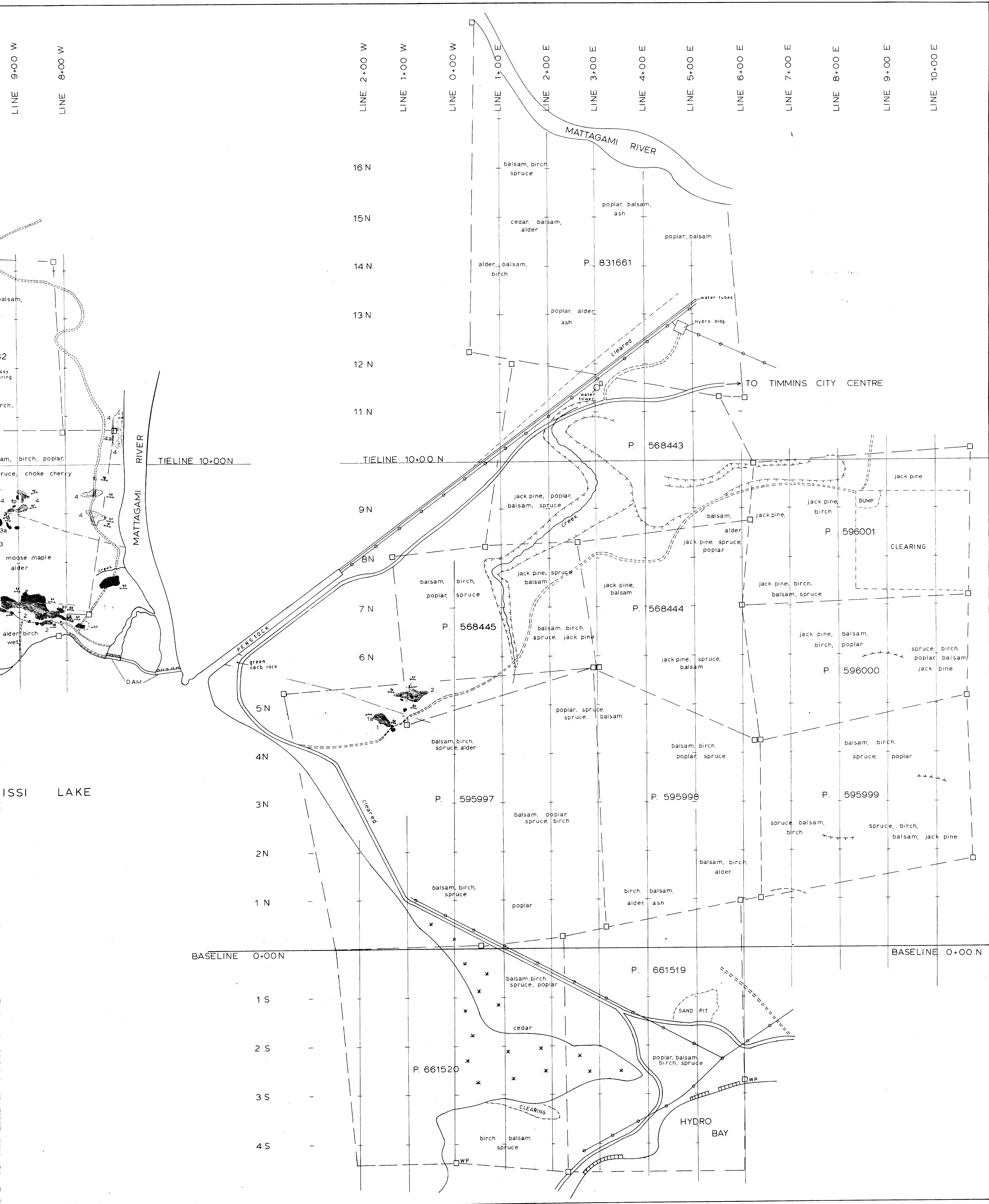

LINE 9+00 W

LINE 8+00 W

LINE 2+00 W

LINE 1+00 W

LINE 0+00 W

LINE 1+00 E

LINE 2+00 E

LINE 3+00 E

LINE 4+00 E

LINE 5+00 E

LINE 6+00 E

LINE 7+00 E

LINE 8+00 E

LINE 9+00 E

LINE 10+00 E

16 N

15 N

14 N

13 N

12 N

11 N

9 N

8 N

7 N

6 N

5 N

4 N

3 N

2 N

1 N

BASELINE 0+00 N

BASELINE 0+00 N

1 S

2 S

3 S

4 S

MATTAGAMI RIVER

MATTAGAMI RIVER

TIELINE 10+00 N

TIELINE 10+00 N

PENNSYLVANIA CREEK

balsam,

ssy spring

rch,

am, birch, poplar,

pruce, choke cherry

moose maple alder

alder, birch, wet

ISSI LAKE

DAM

green carb. rock

cleared

CLEARING

HYDRO BAY

SAND PIT

CLEARING

DUMP

TO TIMMINS CITY CENTRE

P. 831661

P. 568443

P. 596001

P. 568445

P. 568444

P. 596000

P. 595997

P. 595998

P. 595999

P. 661519

P. 661520

WP

WP

balsam, birch, spruce

poplar, balsam, ash

cedar, balsam, alder

poplar, balsam

alder, balsam, birch

poplar, alder, ash

water tubes

Hydro bldg

cleared

water tower

jack pine, poplar, balsam, spruce

balsam, jack pine, alder

jack pine, birch

balsam, birch, spruce, poplar

jack pine, spruce, balsam

jack pine, birch, balsam, spruce

balsam, birch, spruce, jack pine

jack pine, spruce, balsam

jack pine, balsam, birch, poplar

spruce, birch, poplar, balsam, jack pine

poplar, spruce, spruce, balsam

balsam, birch, poplar, spruce

balsam, birch, spruce, poplar

balsam, birch, spruce, alder

balsam, poplar, spruce, birch

balsam, birch, alder

spruce, balsam, birch

spruce, birch, balsam, jack pine

balsam, birch, spruce

poplar

birch, balsam, alder, ash

balsam, birch, spruce, poplar

poplar, balsam, birch, spruce

birch, balsam, spruce