



42A06670101 2.4240 THORNELOE

010

RECEIVED

OCT 29 1981

MINING LANDS SECTION

Report on Overburden Drilling

East Thorneloe Twp. Claim Group

Porcupine Mining Division, Ontario

October 1, 1981
Timmins, Ontario

D.R. Pyke, Ph.D.

D.R. Pyke

quest on file 2.3899

L.D.

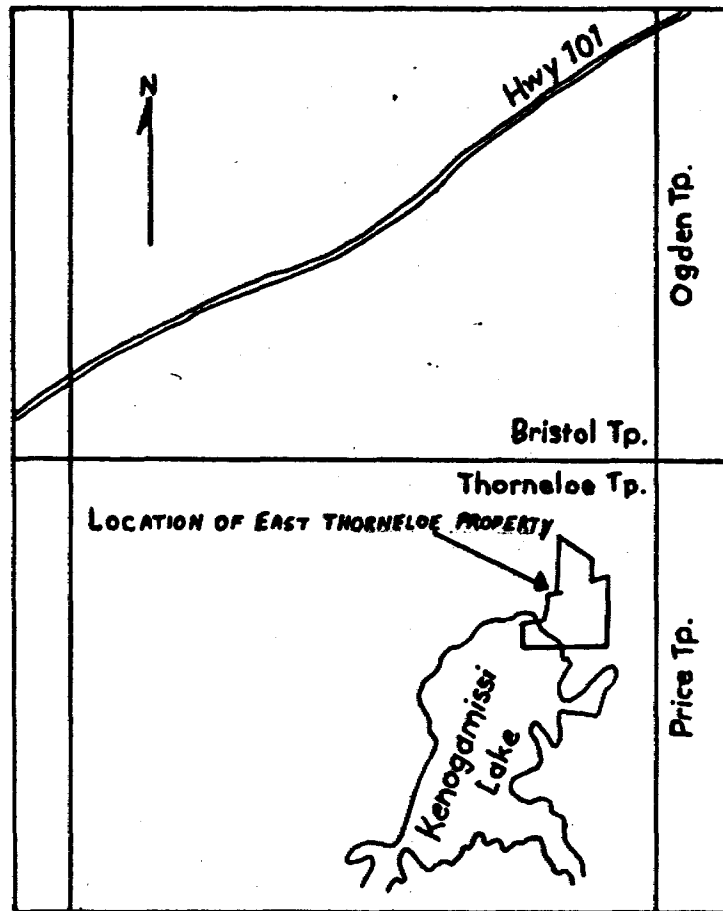

Figure 1 - LOCATION OF EAST-THORNELOE PROPERTY

Report on Overburden Drilling

Introduction

During the periods August 24-25, 1981, September 15-18, 1981, September 21, 1981 and September 28, 1981, W.O. Karvinen and Associates Limited, was contracted to carry out portable percussion overburden drilling on the East Thorneloe Claim Group, about 12 miles southwest of the City of Timmins (Figure 1). During the contract period, they drilled the 54 holes included in this report, for a total of 1,422 feet.

Location and Access

The property is located immediately east of the Wawiatin Falls power dam on the Mattagami River at the outlet from Kenogamissi Lake. It is located in the northeast corner of Thorneloe Township, approximately 12 miles southwest of Timmins. Access is via a gravel road which leads to the dam facilities and summer cottages at Hydro Bay.

Equipment and Methodology

The equipment used consists of a portable gasoline Cobra plugger, 25 mm thick rods, a mechanical two-lever jack for pulling rods, and a flow-through type sampler with a serrated cutting edge. A terrajet all terrain vehicle is used as a carrier.

In a new area, normal procedure by the 2-man crew is to put down a few test holes to determine if suitable lodgement till is present and if the overburden can be penetrated. If these tests are positive, normal drilling along lines across ice direction is carried out.

The main objective is to hit bedrock and to sample both it and the glacial sediment immediately overlying bedrock.

From past experience in the Timmins area, there is a widespread distribution of lodgement and modified tills overlying bedrock, although in places it is completely eroded and replaced by glaciofluvial (sand, silt) or glaciolacustrine (clays, silts) deposits. Very little is known about the detailed glacial history of northeastern Ontario and therefore other till sheets higher in the section may exist or till deposits overlying bedrock may vary in age and origins from area to area. Because of these uncertainties, some of the interpretations of results may be difficult, but from past experience, a relatively simple geochemical picture usually emerges, provided the tills are properly identified during sampling and separated from other glacial sediments.

Lodgement till in the general Timmins area consists of very compact light to dark gray rock debris which is "pasted" onto the bedrock surface. It comprises a wide spectrum of clast sizes, most of which are locally derived. Armoured clasts and mold and cast features are common. Lodgement till best reflects the chemical composition of bedrock in the immediate area up-ice.

Modified till is compositionally similar to lodgement till but is not compact. Mold and cast features are absent and armoured clasts are few. It appears to be till that has been slightly modified by frost action and/or fluidization. Although modified, it still reflects accurately the chemical make-up of its nearby source up-ice.

Sands, silts or clays, where sampled over bedrock do not represent in any way the chemistry of the nearby bedrock. Their chemical composition has been greatly modified and some of the components have been derived from distant sources. Therefore, these sediments cannot be used effectively in evaluating the bedrock potential of a small area such as a normal group of claims.

Glacial Sediments - East Thorneloe Property Area

The property is situated in an ancient glacial river valley now occupied by the Mattagami River. Because of its long history as a waterway, any tills which may have been deposited during glaciation were mostly reworked and destroyed by later melt waters. The sequence of sediments now consists predominantly of layered strata of sands, gravels and silts lying directly on bedrock. Good lodgement and modified tills suitable for geochemical sampling are scarce. Because of the relatively shallow overburden depths, most of the drilling was concentrated on obtaining samples of bedrock.

Summary of Work

East Thorneloe Claim Group

Total overburden footage drilled on the East Thorneloe property during the periods August 24-25, 1981, September 15-18, 1981, September 21, 1981, and September 28, 1981 1,422 feet

Cost per foot for drilling during these periods \$3.00/foot

Total cost of drilling on East Thorneloe property during these periods \$4,266.00

Total Expenditure claim \$4,266.00

Expenditure Credits

Total days claimed at \$15.00 per day 284.4 days

Total number of claims to which assessment credits are applied 10

Total number of days accumulated per claim 28.44 day

Submitted by D.R. Pyke on October 10, 1981 for purposes of obtaining assessment work credits for mining claims P 568442, P 568443, P 568444, P 568445, P 596000, P 596001, P 594919, P 595997, P 595998, P 595999, Thorneloe Township, Porcupine Mining Division.

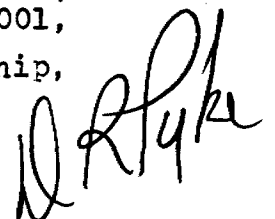

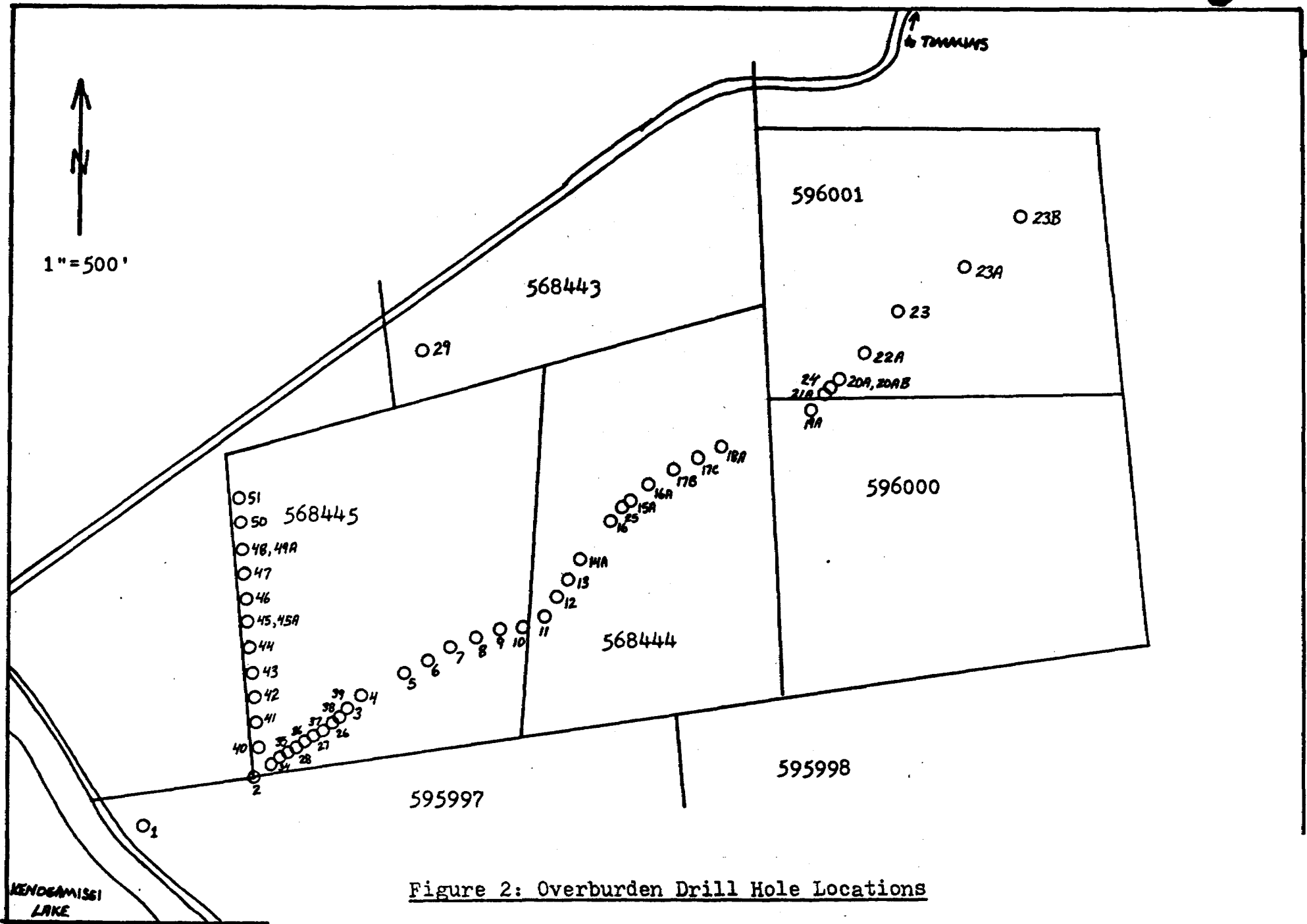

Figure 2: Overburden Drill Hole Locations

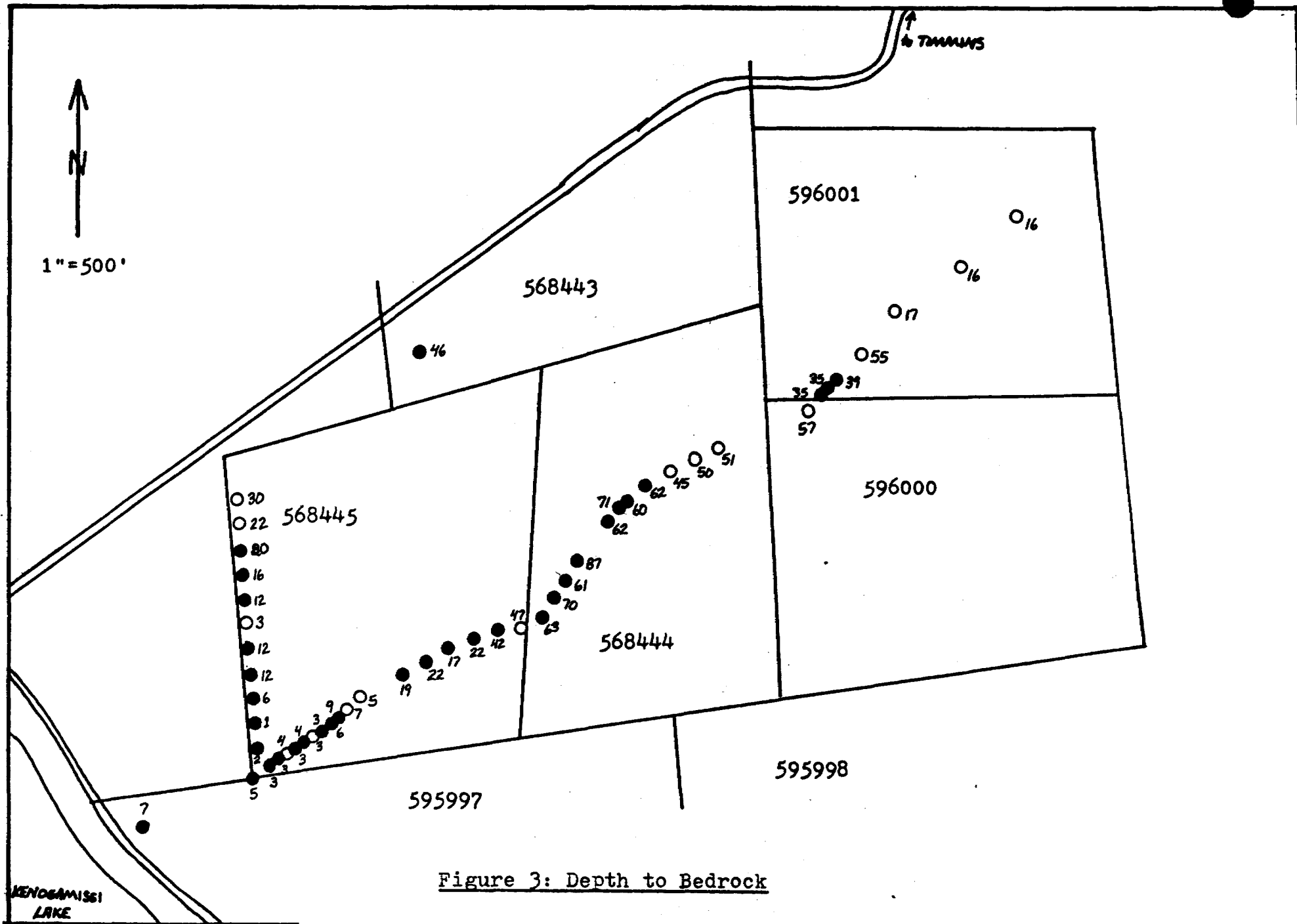

Figure 3: Depth to Bedrock

Table I - Drilling Statistics

| Sample No. | Coordinates | Depth of hole (ft) | Bedrock reached | Bedrock Description | Till Description | | | | Notes |
|------------|-------------|--------------------|-----------------|------------------------|------------------|--------|-----------|---------|-----------------------|
| | | | | | Color | Type | Thickness | Quality | |
| WF-1 | L-A 000NE | 7 | yes | Gray volcanic | brown | sand | | poor | boulder on surface |
| WF-2 | L-A 500NE | 5 | yes | dark volcanic | brown | sand | | poor | |
| WF-3 | L-A 900NE | 7 | no | -- | gray | sand | | poor | Couldn't penet. |
| WF-4 | L-A 1000NE | 5 | no | -- | brown | sand | | poor | |
| WF-5 | L-A 1200NE | 19 | yes | brown volcanic | brown | sand | | | |
| WF-6 | L-A 1300NE | 22 | yes | Carb. Volc? | gray | modif | | fair | |
| WF-7 | L-A 1400NE | 17 | yes | gray volcanic | gray | sand | | poor | |
| WF-8 | L-A 1500NE | 22 | yes | -- | gray | modif. | | good | |
| WF-9 | L-A 1600NE | 42 | yes | soft, altered volcanic | gray | modif. | | good. | |
| WF-10 | L-A 1700NE | 47 | no | -- | gray | modif. | | good | |
| WF-11 | L-A 1800NE | 63 | yes | gray volcanic | gray | modif. | | good | |
| WF-12 | L-A 1900NE | 70 | yes | -- | gray | modif. | | good | |
| WF-13 | L-A 2000NE | 61 | yes | gray volcanic | gray | modif. | | good | |
| WF-14A | L-A 2100NE | 87 | yes | soft, blackrock | - | - | | -- | sampler full of rock. |
| WF-15A | L-A 2400NE | 60 | yes | soft rock | gray | sand | | poor | |
| WF-16 | L-A 2300NE | 63 | yes | -- | - | - | | - | lost sample |
| WF-16A | L-A 2500NE | 55 | no | -- | gray | sand | | poor | |
| WF-17B | L-A 2600NE | 45 | no | -- | gray | modif. | | good | |
| WF-17C | L-A 2700NE | 50 | no | -- | - | - | | - | lost sample |

| Sample No. | Coordinates | Depth of hole (ft) | Bedrock reached | Bedrock description | Till Description | | | | |
|------------|-------------|--------------------|-----------------|-------------------------|------------------|-----------|-----------|---------|--------------|
| | | | | | Color | Type | Thickness | Quality | Notes |
| WF-18A | L-A 2800NE | 51 | no | -- | gray | sand | | poor | wet |
| WF-19A | L-A 3200NE | 57 | no | -- | gray | sand | | poor | |
| WF-20A | L-A 3400NE | 39 | yes | -- | gray | silt | | poor | |
| WF-20AB | L-A 3400NE | 39 | yes | black volcanic | gray | silt | | poor | wet |
| WF-21A | L-A 3300NE | 35 | yes | soft volcanic | gray | silt | | poor | wet |
| WF-22A | L-A 3500NE | 55 | no | -- | gray | sand | | poor | can't penet. |
| WF-23 | L-A 3700NE | 17 | no | -- | gray | sand | | poor | " " |
| WF-23A | L-A 4000NE | 16 | no | -- | gray | sand | | poor | " " |
| WF-23B | L-A 4300NE | 16 | no | -- | gray | sand | | poor | " " |
| WF-24 | L-A 3350NE | 35 | yes | soft volcanic | gray | silt | | poor | wet |
| WF-25 | L-A 2350NE | 71 | yes | -- | gray | sand | | poor | |
| WF-26 | L-A 850NE | 6 | yes | brown, altered volcanic | gray | sand | | poor | |
| WF-27 | L-A 750NE | 3 | no | -- | brown | sand | | poor | |
| WF-28 | L-A 640NE | 3 | yes | gray volcanic | brown | sand | | poor | |
| WF-29 | gravel pit | 46 | yes | black volcanic | brown | lodgement | 6" | good | |
| WF-34 | L-A 625NE | 3 | yes | gray volcanic | brown | sand | | poor | |
| WF-35 | L-A 675NE | 4 | no | -- | brown | sand | | poor | |
| WF-35A | L-A 675NE | 4 | no | -- | gray | sand | | poor | hit boulder |
| WF-36 | L-A 725NE | 4 | yes | soft, brown rock | - | - | | -- | |
| WF-37 | L-A 774NE | 3 | yes | soft, green volcanic | brown | sand | | poor | |

| Sample No. | Coordinates | Depth of hole (ft) | Bedrock reached | Bedrock description | Till Description | | | | Notes |
|------------|-------------|--------------------|-----------------|---------------------------------|------------------|-----------|-----------|---------|-----------------------|
| | | | | | Color | Type | Thickness | Quality | |
| WF-38 | L-A 825NE | 9 | yes | soft, green volcanic | brown | sand | | poor | |
| WF-39 | L-A 875NE | 6 | yes | brown volcanic | -- | -- | | -- | |
| WF-40 | L-D 100N | 2 | yes | soft, brown rock | - | -- | | -- | sampler full of rock. |
| WF-41 | L-D 200N | 1 | yes | gray-brown vole. with qtz. & py | brown | sand | | poor | |
| WF-42 | L-D 300N | 6 | yes | gray-orange rock | brown | sand | | poor | |
| WF-43 | L-D 400N | 12 | yes | brown volcanic | gray | sand | | poor | |
| WF-44 | L-D 500N | 12 | yes | brown volcanic | gray | lodgement | | good | |
| WF-45 | L-D 600N | 3 | no | -- | brown | sand | | poor | hit boulder |
| WF-46 | L-D 700N | 12 | yes | soft, brown volcanic | -- | -- | | -- | sampler full of rock |
| WF-47 | L-D 800N | 16 | yes | soft, gray vole. | -- | -- | | -- | " " |
| WF-48 | L-D 900N | 3 | no | -- | brown | sand | | poor | |
| WF-49A | L-D 900N | 20 | yes | gray-brwn volc. | gray | sand | | poor | |
| WF-50 | L-D 1000N | 22 | no | -- | gray | sand | | poor | |
| WF-51 | L-d 1100N | 30 | no | -- | gray | silt | | poor | |
| WF-45A | L-D 600N | 15 | yes | green-gray volcanic | brown | sand | | poor | |

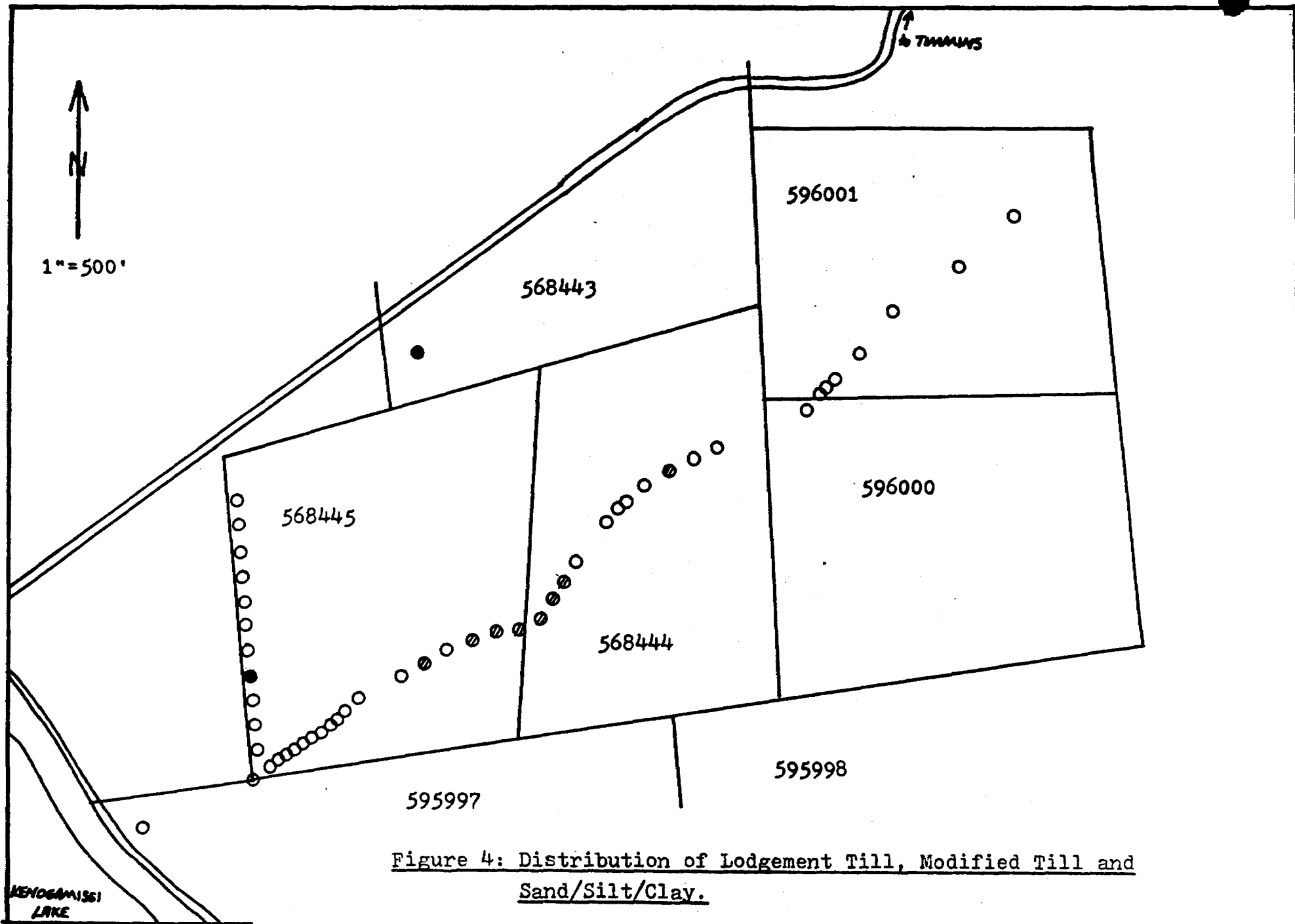

Figure 4: Distribution of Lodgement Till, Modified Till and Sand/Silt/Clay.

OVERBURDEN DRILL LOG

Log No: WF-1
 Project: East Thorneloe
 Township: Thorneloe Twp.
 Date: August 24, 1981

Location: L-A 000NE

Log No: WF-2
 Project: East Thorneloe
 Township: Thorneloe
 Date: August 24, 1981

Location: L-A 500NE

| Depth | Sample No. | REMARKS |
|-------|------------|---------------|
| 2.1 | WF-1 | brown sand |
| m. | WF-1* | gray volcanic |

| Depth | Sample No. | REMARKS |
|-------|------------|------------------------|
| 1.5 | WF-2 | brown sand |
| m. | WF-2* | Bedrock- dark volcanic |

Scale 1 : 200

OVERBURDEN DRILL LOG

Log NO: WF-3
 Project: East Thorneloe
 Township: Thorneloe Twp.
 Date: August 24, 1981
 Location: L-A 900NE

Log NO: WF-4
 Project: East Thorneloe
 Township: Thorneloe Twp.
 Date: August 24, 1981
 Location: L-A 1000NE

| Depth | Sample No. | REMARKS |
|-------|------------|---------------------|
| 2.1 | WF-3 | Gray sand |
| m. | --- | Bedrock-not reached |

| Depth | Sample No. | REMARKS |
|-------|------------|---------------------|
| 1.5 | WF-4 | brown sand |
| m. | --- | Bedrock-not reached |

Scale 1 : 200

OVERBURDEN DRILL LOG

Log NO: WF-5
 Project: East Thorneloe
 Township: Thorneloe Twp.
 Date: August 24, 1981
 Location: L-A 1200NE

Log NO: WF-6
 Project: East Thorneloe
 Township: Thorneloe Twp.
 Date: August 24, 1981
 Location: L-A 1300NE

| Depth | Sample No. | REMARKS |
|-------|------------|------------------------|
| 5.8 | WF-5 | Brown sand |
| m. | WF-5* | Bedrock-brown volcanic |

| Depth | Sample No. | REMARKS |
|-------|------------|------------------------------|
| 6.7 | WF-6 | Modified till, gray |
| m. | WF-6* | Bedrock-carbonated volcanic? |

Scale 1 : 200

OVERBURDEN DRILL LOG

Log NO.: WF-7
 Project: East Thorneloe
 Township: Thorneloe Twp.
 Date: August 24, 1981
 Location: L-A 1400NE

Log NO.: WF-8
 Project: East Thorneloe
 Township: Thorneloe Twp.
 Date: August 24, 1981
 Location: L-A 1500NE

| Depth | Sample No. | REMARKS |
|-------|------------|-----------------------|
| 5.2 | WF-7 | Gray sand |
| m. | WF-7 | Bedrock-gray volcanic |

| Depth | Sample No. | REMARKS |
|-------|------------|--------------------------------------|
| 6.7 | WF-8 | Modified till, gray |
| m. | --- | Bedrock-sample lost during retrieval |

OVERBURDEN DRILL LOG

Log NO: WF-9
 Project: East Thorneloe
 Township: Thorneloe Twp.
 Date: August 24, 1981
 Location: L-A 1600NE

Log NO: WF-10
 Project: East Thorneloe
 Township: Thorneloe Twp.
 Date: August 25, 1981
 Location: L-A 1700NE

| Depth | Sample No. | REMARKS |
|-------------|------------|------------------------------------|
| 12.8- m. | WF-9 | Modified till, gray |
| | WF-9* | Bedrock- soft, altered volcanic |

| Depth | Sample No. | REMARKS |
|------------|------------|---------------------|
| 14.3 m. | WF-10 | Modified till, gray |
| | --- | Bedrock-not reached |

OVERBURDEN DRILL LOG

Log NO: WF-11
 Project: East Thorneloe
 Township: Thorneloe Twp.
 Date: August 25, 1981
 Location: L-A 1800NE

Log NO: WF-12
 Project: East Thorneloe
 Township: Thorneloe Twp.
 Date: August 25, 1981
 Location: L-A 1900NE

| Depth | Sample No. | REMARKS |
|------------|------------|-----------------------|
| 19.2 m. | WF-11 | Modified till, gray |
| | WF-11* | Bedrock-gray volcanic |

| Depth | Sample No. | REMARKS |
|------------|------------|---------------------------------------|
| 21.3 m. | WF-12 | Modified till, gray |
| | --- | Bedrock-sample lost during retrieval. |

OVERBURDEN DRILL LOG

Log NO: WF-13
 Project: East Thorneloe
 Township: Thorneloe Twp.
 Date: August 25, 1981
 Location: L-A 2000NE

Log NO: WF-14A
 Project: East Thorneloe
 Township: Thorneloe Twp.
 Date: September 15, 1981
 Location: L-A 2100NE

| Depth | Sample No. | REMARKS |
|-------|------------|-----------------------|
| 18.6 | WF-13 | Modified till, gray |
| m. | WF-13* | Bedrock-gray volcanic |

| Depth | Sample No. | REMARKS |
|-------|------------|---------------------------|
| 26.5 | --- | Sampler full of rock. |
| m. | WF-14A | Bedrock-soft, black rock. |

Scale 1 : 200

OVERBURDEN DRILL LOG

Log NO: WF-15A
 Project: East Thorneloe
 Township: Thorneloe Twp.
 Date: September 15, 1981
 Location: L-A 2400NE

Log NO: WF-16
 Project: East Thorneloe
 Township: Thorneloe Twp.
 Date: September 15, 1981
 Location: L-A 2300NE

| Depth | Sample No. | REMARKS |
|-------|------------|--------------------|
| 18.3 | WF-15A | Gray sand. |
| m. | WF-15A* | Bedrock-soft rock. |

| Depth | Sample No. | REMARKS |
|-------|------------|---------------------------------------|
| 18.9 | ---- | Sample lost during retrieval. |
| m. | ---- | Bedrock-sample lost during retrieval. |

OVERBURDEN DRILL LOG

Log NO: WF-16A
 Project: East Thorneloe
 Township: Thorneloe Twp.
 Date: September 15, 1981
 Location: L-A 2500NE

Log NO: WF-17B
 Project: East Thorneloe
 Township: Thorneloe Twp.
 Date: September 15, 1981
 Location: L-A 2600NE

| Depth | Sample No. | REMARKS |
|------------|---------------|----------------------------------|
| 16.8 m. | WF-16A --- | Gray sand Bedrock-not reached |

| Depth | Sample No. | REMARKS |
|------------|---------------|---------------------------------------------|
| 13.7 m. | WF-17B --- | Modified till, gray Bedrock-not reached. |

OVERBURDEN DRILL LOG

Log NO: WF-17C
 Project: East Thorneloe
 Township: Thorneloe Twp.
 Date: September 16, 1981
 Location: L-A 2700NE

Log NO: WF-18A
 Project: East Thorneloe
 Township: Thorneloe Twp.
 Date: September 16, 1981
 Location: L-A 2800NE

| Depth | Sample No. | REMARKS |
|------------|------------|-------------------------------|
| 15.2 m. | WF-17C | Sample lost during retrieval. |
| | --- | Bedrock-not reached. |

| Depth | Sample No. | REMARKS |
|------------|------------|----------------------|
| 15.5 m. | WF-18A | Gray sand. |
| | --- | Bedrock-not reached. |

OVERBURDEN DRILL LOG

Log NO: WF-19A
 Project: East Thorneloe
 Township: Thorneloe Twp.
 Date: September 16, 1981
 Location: L-A 3200NE

Log NO: WF-20A
 Project: East Thorneloe
 Township: Thorneloe Twp.
 Date: September 17, 1981
 Location: L-A 3400NE

| Depth | Sample No. | REMARKS |
|------------|------------|----------------------|
| 17.3 m. | WF-19A | Gray sand. |
| | --- | Bedrock-not reached. |

| Depth | Sample No. | REMARKS |
|------------|------------|---------------------------------------|
| 11.9 m. | WF-20A | Gray silt. |
| | --- | Bedrock-sample lost during retrieval. |

OVERBURDEN DRILL LOG

Log No: WF-20AB
 Project: East Thorneloe
 Township: Thorneloe Twp.
 Date: September 17, 1981
 Location: L-A 3400NE

Log No: WF-21A
 Project: East Thorneloe
 Township: Thorneloe Twp.
 Date: September 17, 1981
 Location: L-A 3300NE

| Depth | Sample No. | REMARKS |
|-------|------------|------------------------|
| 11.9 | WF-20AB | Gray silt |
| m. | WF-20AB* | Bedrock-black volcanic |

| Depth | Sample No. | REMARKS |
|-------|------------|------------------------|
| 10.7 | WF-21A | Gray silt |
| m. | WF-21A* | Bedrock-soft volcanic. |

Scale 1 : 200

OVERBURDEN DRILL LOG

Log NO: WF-22A
 Project: East Thorneloe
 Township: Thorneloe Twp.
 Date: September 17, 1981
 Location: L-A 3500NE

Log NO: WF-23
 Project: East Thorneloe
 Township: Thorneloe Twp.
 Date: September 17, 1981
 Location: L-A 3700NE

| Depth | Sample No. | REMARKS |
|------------|----------------|------------------------------------|
| 16.8 m. | WF-22A ---- | Gray sand. Bedrock-not reached. |

| Depth | Sample No. | REMARKS |
|-----------|--------------|-----------------------------------|
| 5.2 m. | WF-23 --- | Gray sand Bedrock-not reached. |

OVERBURDEN DRILL LOG

Log NO: WF-23A
 Project: East Thorneloe
 Township: Thorneloe Twp.
 Date: September 17, 1981
 Location: L-A 4000NE

Log NO: WF-23B
 Project: East Thorneloe
 Township: Thorneloe Twp.
 Date: September 17, 1981
 Location: L-A 4300NE

| Depth | Sample No. | REMARKS |
|-----------|------------|----------------------|
| 4.9 m. | WF-23A | Gray sand |
| | ---- | Bedrock-not reached. |

| Depth | Sample No. | REMARKS |
|-----------|------------|---------------------|
| 4.9 m. | WF-23B | Gray sand. |
| | --- | Bedrock-not reached |

OVERBURDEN DRILL LOG

Log NO: WF-24
 Project: East Thorneloe
 Township: Thorneloe Twp.
 Date: September 17, 1981
 Location: L-A 3350NE

Log NO: WF-25
 Project: East Thorneloe
 Township: Thorneloe Twp.
 Date: September 18, 1981
 Location: L-A 2350NE

| Depth | Sample No. | REMARKS |
|-------|------------|-----------------------|
| 10.7 | WF-24 | Gray silt |
| m. | WF-24* | Bedrock-soft volcanic |

| Depth | Sample No. | REMARKS |
|-------|------------|---------------------------------------|
| 21.6 | WF-25 | Gray sand |
| m. | --- | Bedrock-sample lost during retrieval. |

OVERBURDEN DRILL LOG

Log NO: WF-26
 Project: East Thorneloe
 Township: Thorneloe Twp.
 Date: September 18, 1981
 Location: L-A 850NE

Log NO: WF-27
 Project: East Thorneloe
 Township: Thorneloe Twp.
 Date: September 18, 1981
 Location: L-A 750NE

| Depth | Sample No. | REMARKS |
|-------|------------|---------------------------------|
| 1.8 | WF-26 | Gray sand |
| m. | WF-26* | Bedrock-brown, altered volcanic |

| Depth | Sample No. | REMARKS |
|-------|------------|----------------------|
| 0.9 | WF-27 | Brown sand |
| m. | --- | Bedrock-not reached. |

OVERBURDEN DRILL LOG

Log NO: WF-28
 Project: East Thorneloe
 Township: Thorneloe Twp.
 Date: September 18, 1981
 Location: L-A 640NE

Log NO: WF-29
 Project: East Thorneloe
 Township: Thorneloe Twp.
 Date: September 18, 1981
 Location: gravel pit

| Depth | Sample No. | REMARKS |
|-------|------------|-----------------------|
| 0.9 | WF-28 | Brown sand |
| m. | WF-28* | Bedrock-gray volcanic |

| Depth | Sample No. | REMARKS |
|-------|------------|------------------------|
| 14.0 | WF-29 | Lodgement till, brown |
| m. | WF-29* | Bedrock-black volcanic |

Scale: 1 : 200

OVERBURDEN DRILL LOG

Log No.: WF-34
 Project: East Thorneloe
 Township: Thorneloe Twp.
 Date: September 21, 1981
 Location: L-A 625 NE

Log No.: WF-35
 Project: East Thorneloe
 Township: Thorneloe Twp.
 Date: September 21, 1981
 Location: L-A 675NE

| Depth | Sample No. | REMARKS |
|-----------|------------|-----------------------|
| 0.9 m. | WF-34 | Brown sand |
| | WF-34* | Bedrock-gray volcanic |

| Depth | Sample No. | REMARKS |
|-----------|------------|---------------------|
| 1.2 m. | WF-35 | Brown sand |
| | --- | Bedrock-not reached |

OVERBURDEN DRILL LOG

Log NO: WF-36
 Project: East Thorneloe
 Township: Thorneloe Twp.
 Date: September 21, 1981
 Location: L-A 725NE

Log NO: WF-35A
 Project: East Thorneloe
 Township: Thorneloe Twp.
 Date: September 21, 1981
 Location: L-A 675NE

| Depth | Sample No. | REMARKS |
|-------|------------|---------------------------|
| 1.2 | --- | Sampler full of rock |
| m. | WF-36* | Bedrock-soft, brown rock. |

| Depth | Sample No. | REMARKS |
|-------|------------|----------------------|
| 1.2 | WF-35A | Gray sand |
| m. | --- | Bedrock-not reached. |

OVERBURDEN DRILL LOG

Log NO: WF-37
 Project: East Thoreneloe
 Township: Thorneloe Twp.
 Date: September 21, 1981
 Location: L-A 775NE

Log NO: WF-38
 Project: East Thorneloe
 Township: Thorneloe Twp.
 Date: September 21, 1981
 Location: L-A 825NE

| Depth | Sample No. | REMARKS |
|-------|------------|------------------------------|
| 0.9 | WF-37 | Brown sand |
| m. | WF-37* | Bedrock-soft, green volcanic |

| Depth | Sample No. | REMARKS |
|-------|------------|-------------------------------|
| 2.7 | WF-38 | Brown sand |
| m. | WF-38* | Bedrock-soft, green volcanic. |

OVERBURDEN DRILL LOG

Log NO: WF-39
 Project: Thorneloe East
 Township: Thorneloe Twp.
 Date: September 21, 1981
 Location: L-A 875NE

Log NO: WF-40
 Project: East Thorneloe
 Township: Thorneloe Twp.
 Date: September 21, 1981
 Location: L-D 100N

| Depth | Sample No. | REMARKS |
|-----------|------------|------------------------|
| 1.8 m. | --- | Sampler full of rock. |
| | WF-39* | Bedrock-brown volcanic |

| Depth | Sample No. | REMARKS |
|-----------|------------|---------------------------|
| 0.6 m. | ---- | Sampler full of rock |
| | WF-40* | Bedrock-soft, brown rock. |

Scale 1 : 200

OVERBURDEN DRILL LOG

Log No: WF-41
 Project: East Thorneloe
 Township: Thorneloe Twp.
 Date: September 21, 1981
 Location: L-D 200N

Log No: WF-42
 Project: East Thorneloe
 Township: Thorneloe Twp.
 Date: September 21, 1981
 Location: L-D 300N

| Depth | Sample No. | REMARKS |
|-----------|-----------------|--------------------------------------------------------------------|
| 0.3 m. | WF-41 WF-41* | Brown sand Bedrock- gray-brown volcanic with quartz and pyrite. |

| Depth | Sample No. | REMARKS |
|-----------|-----------------|-----------------------------------------|
| 1.8 m. | WF-42 WF-42* | Brown sand Bedrock-gray-orange rock. |

OVERBURDEN DRILL LOG

Log No.: WF-43
 Project: Thorneloe East
 Township: Thorneloe Twp.
 Date: September 28, 1981

Log No.: WF-44
 Project: East Thorneloe
 Township: Thorneloe Twp.
 Date: September 28, 1981

Location: L-D 400N

Location: L-D500N

| Depth | Sample No. | REMARKS |
|-------|------------|------------------------|
| 3.7 | WF-43 | Gray sand |
| m. | WF-43* | Bedrock-brown volcanic |

| Depth | Sample No. | REMARKS |
|-------|------------|-------------------------|
| 3.7 | WF-44 | Lodgement till, gray |
| m. | WF-44* | Bedrock-brown volcanic. |

OVERBURDEN DRILL LOG

Log No: WF-45
 Project: East Thorneloe
 Township: Thorneloe Twp.
 Date: September 28, 1981
 Location: L-D 600N

Log No: WF-46
 Project: East Thorneloe
 Township: Thorneloe Twp.
 Date: September 28, 1981
 Location: L-D 700N

| Depth | Sample No. | REMARKS |
|-----------|------------|----------------------|
| 0.9 m. | WF-45 | Brown sand |
| | --- | Bedrock-not reached. |

| Depth | Sample No. | REMARKS |
|-----------|------------|-------------------------------|
| 3.7 m. | --- | Sampler full of rock |
| | WF-46* | Bedrock-soft, brown volcanic. |

OVERBURDEN DRILL LOG

Log NO: WF-47
 Project: East Thorneloe
 Township: Thorneloe Twp.
 Date: September 28, 1981
 Location: L-D 800N

Log NO: WF-48
 Project: East Thorneloe
 Township: Thorneloe Twp.
 Date: September 28, 1981
 Location: L-D 900N

| Depth | Sample No. | REMARKS |
|-----------|------------|------------------------------|
| 4.9 m. | --- | sampler full of rock |
| | WF-47* | Bedrock-soft, gray volcanic. |

| Depth | Sample No. | REMARKS |
|-----------|------------|----------------------|
| 0.9 m. | WF-48 | Brown sand |
| | --- | Bedrock-not reached. |

OVERBURDEN DRILL LOG

Log NO: WF-49A
 Project: East Thorneloe
 Township: Thorneloe Twp.
 Date: September 28, 1981
 Location: L-D 900N

Log NO: WF-50
 Project: East Thorneloe
 Township: Thorneloe Twp.
 Date: September 28, 1981
 Location: L-D 1000N

| Depth | Sample No. | REMARKS |
|-------|------------|------------------------------|
| 6.1 | WF-49A | Gray sand |
| m. | WF-49A* | Bedrock-gray-brown volcanic. |

| Depth | Sample No. | REMARKS |
|-------|------------|----------------------|
| 6.7 | WF-50 | Gray sand |
| m. | --- | Bedrock-not reached. |

OVERBURDEN DRILL LOG

Log NO: WF-51
 Project: East Thorneloe
 Township: Thorneloe Twp.
 Date: September 28, 1981
 Location: L-D 1100N

Log NO: WF-45A
 Project: East Thorneloe
 Township: Thorneloe Twp.
 Date: September 28, 1981
 Location: L-D 600N

| Depth | Sample No. | REMARKS |
|-----------|------------|----------------------|
| 9.1 m. | WF-51 | Gray silt |
| | --- | Bedrock-not reached. |

| Depth | Sample No. | REMARKS |
|-----------|------------|-----------------------------|
| 4.6 m. | WF-45A | Brown sand |
| | WF-45A* | Bedrock-green-gray volcanic |

Bristol Twp. M.264

THE TOWNSHIP OF
OF
THORNELOE

DISTRICT OF
COCHRANE

PORCUPINE
MINING DIVISION

SCALE: 1-INCH = 40 CHAINS

LEGEND

- PATENTED LAND Ⓟ
- CROWN LAND SALE C.S.
- LEASES Ⓛ
- LOCATED LAND Loc.
- LICENSE OF OCCUPATION L.O.
- MINING RIGHTS ONLY M.R.O.
- SURFACE RIGHTS ONLY S.R.O.
- ROADS —
- IMPROVED ROADS —
- KING'S HIGHWAYS —
- RAILWAYS —
- POWER LINES —
- MARSH OR MUSKEG —
- MINES ⚡
- CANCELLED C.
- PATENTED S.R.O. ⊙

NOTES

400' Surface Rights reservation along the shores of all lakes and rivers.

Reservation for Deputy Chief Ranger's Headquarters site shown thus File 110657

Flooding rights on Mattagami River & Kenogamissi Lake are reserved to Ont. Hydro - L.O. 7598 File 1163 vol.3

Areas withdrawn from staking under Section 43 of the Mining Act (R.S.O. 1970.)

| Order# | File | Date | Disposition |
|--------|--------|---------|-------------|
| Ⓟ | 164584 | 1976/72 | Ont. O. |

DATE OF ISSUE

DEC - 2 1981

Ministry of Natural Resources
TORONTO

SAND and GRAVEL

- Ⓟ M.N.R. GRAVEL PIT 258, FILE 111467
- Ⓟ GRAVEL FILE 143834
- Ⓟ M.N.R. GRAVEL RESERVE

24240

This township lies within the Municipality of the CITY of TIMMINS.

PLAN NO. **M.313**

ONTARIO
MINISTRY OF NATURAL RESOURCES
SURVEYS AND MAPPING BRANCH

Denton Twp. M.273;

Price Twp. M.307

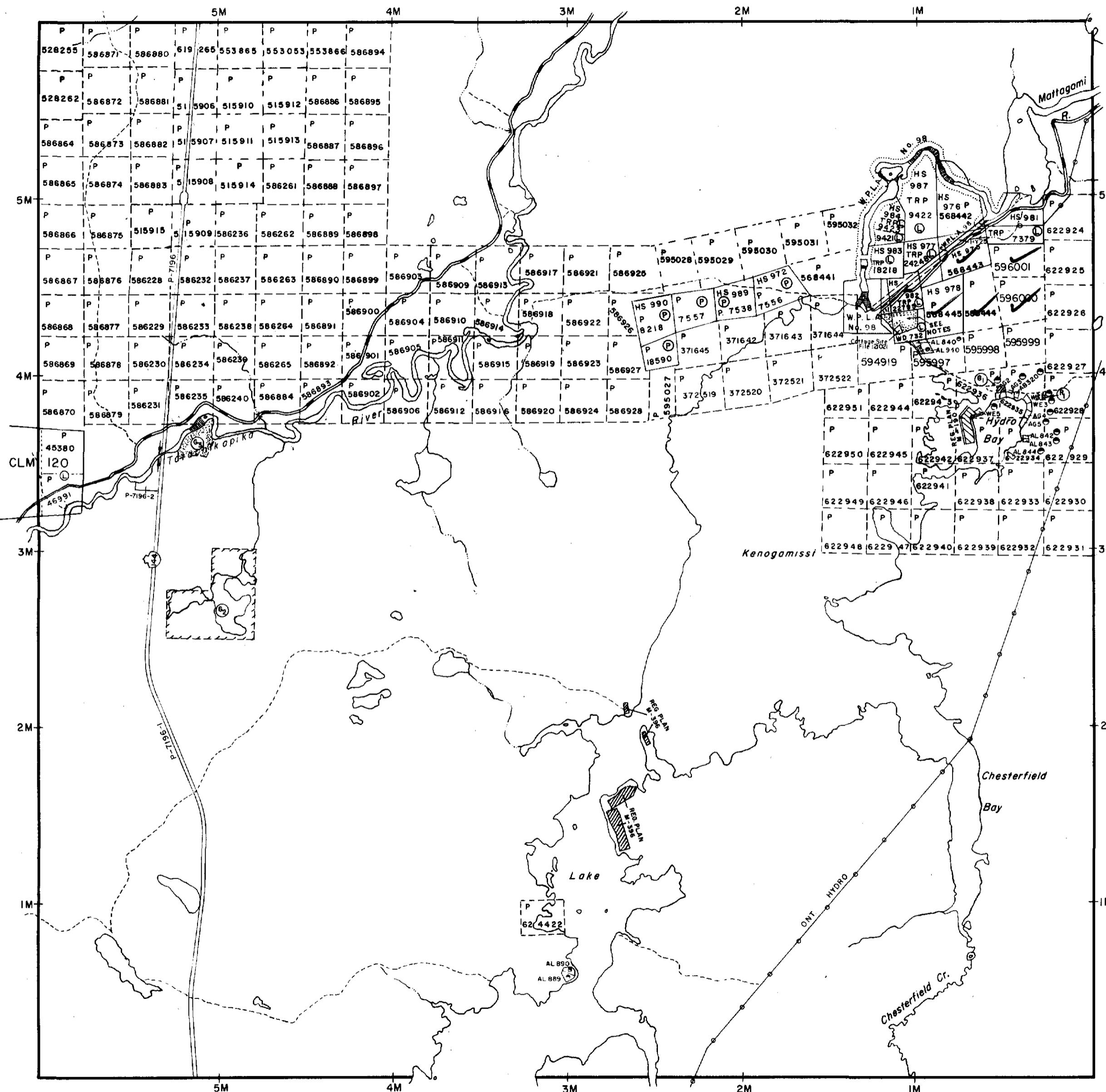

Mc Keown Twp. M.299



42A055W0101 2.4240 THORNELOE