



42A06SW2011 2.20791 DELORO

010

**Timmins Magnesite Project  
Globex Mining Enterprises Inc.**

**Fall 2000  
Diamond Drilling**

**Diamond Drill Holes  
TM-01 and TM-02**

2.20791

**Deloro Township, Ontario  
NTS: 42A/6**

R. V. Zalnieriunas P. Geol  
December 14, 2000  
Rouyn-Noranda, QC

file: C:\DELORO\dd2000.rpt

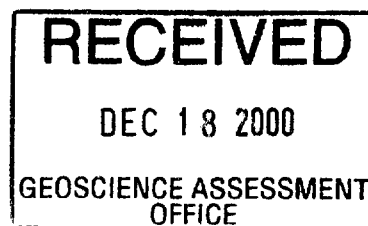

## **Introduction**

Diamond drilling on the Timmins Magnesite project was carried out by Globex Mining Enterprises Inc. during October, 2000. The purpose of this work was to continue the delineation of the main magnesite alteration zone, west of drilling carried out in 1999.

## **Property; Description and Location**

The project is located in south-central Deloro Township, approximately 11 kilometres southeast of Timmins, Ontario. The property consists of 19 unsurveyed mining claims, totalling 24 claim units of 16 hectares (more or less) which covers an approximate area of 384 hectares and an approximately equally sized area of severed, 'surface-rights-only' mining patents that cover the same area. (see Appendix A for claim data)

The claim group is approximately centred 1.5 kilometres east of Gold Lake and 1.5 kilometres north of the Deloro-Adams township line. The property lies within the Porcupine Mining Division and Timmins RGO of MNDM, Timmins MNR Administrative District and Cochrane Land Titles/Registry Division. Claim outlines are illustrated on claim map G-3993 and are within NTS 42A/6.

## **Access**

Vehicular access to the claim group is provided by a road via Pine Street South from the City of Timmins, south for 12 kilometres to the McArthur Forestry Access road, east for 3 kilometres to the 'Wishbone' powerline and then northwards for 3 kilometres by a series of seasonal trails to the centre of the claims.

## **Previous Work**

The current claim group was originally staked by Pamourex and re-staked by Royal Oak Mines Ltd. during 1984-85. The property had been originally worked by Canadian Magnesite Mines in 1962.

Diamond drilling by Canadian Magnesite Mines and Pamourex during the 1960's and 1980's outlined a reported proven reserve of 20 million tonnes of material containing 52% magnesite and 28% talc.

The project was optioned by Magnesium Refractories Ltd during 1989-1994. This company completed a positive feasibility study, but, was unable to raise funds for further work.

---

### **Globex Mining Enterprises Inc.**

146, 14e rue, Rouyn-Noranda, QC J9X 2J3  
Tel.: (819)797-5242 Fax.: (819)797-1470 Email: globex@lino.com

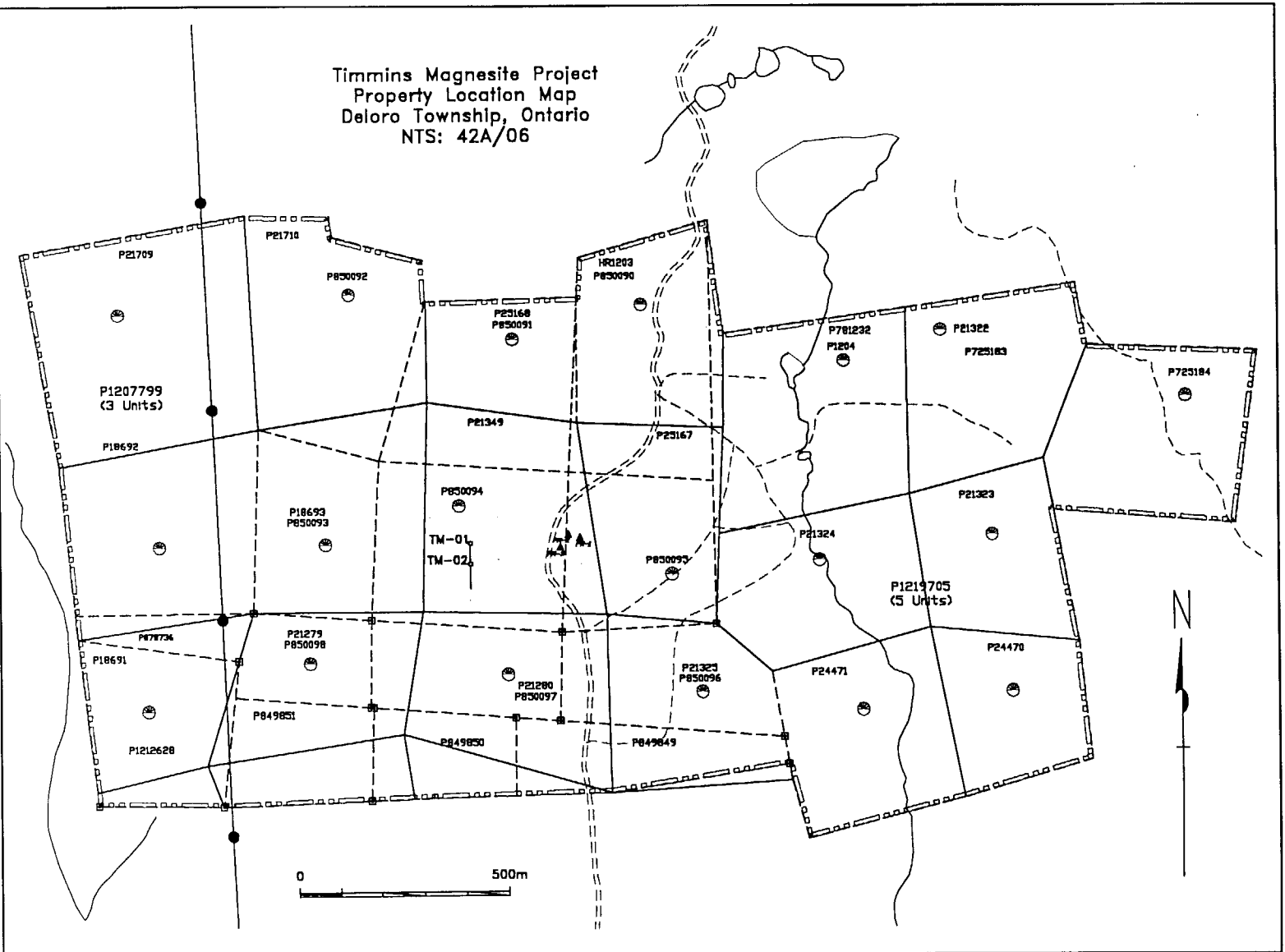

Figure 1

**Timmins Magnesite - 2000 Drilling Program**

---

During 1997, Royal Oak re-staked some claims and completed some additional studies in 1997-98. Two drill holes were completed by Pentland Firth Ventures Ltd. for Kinross in 1999 on section 5+00E. (DDH's KDE99-1 & 2). These holes were subsequently analysed by Globex Mining Enterprises Inc. early in the year 2000. Two additional holes were completed by Globex in 2000 (logs with this report).

**2000 Drill Program**

Two drill holes totalling 163.07m (TM-01 and TM-02) were completed on section 6+00E at the western end of the Timmins magnesite deposit. Drilling was carried out by crews from Bradley Bro.'s Ltd.

Drill collars were established on the 1998 Royal Oak metric grid in early October. A Longyear 17A rig was mobilized in on October 11. Diamond drilling was completed on the 13th, and all equipment was de-mobed out on October 14.

All work was carried out on claim P 850094.

Core was transported to the offices and core shack of Globex Mining Enterprises Inc. in Rouyn-Noranda, QC, where it was logged. Visual estimates of mineralization were completed as part of the logging process, but, no samples have been cut as yet. Drill logs and sections are appended.

**2000 Diamond Drill Program**

<i>Hole No.</i>	<i>Easting (m)</i>	<i>Northing (m)</i>	<i>Azm/Dip (deg.)</i>	<i>EOH (m)</i>	<i>OVB (vert m)</i>	<i>Zone (m)</i>
TM-01	6+00E	1+60S	180 / -45	83.07	7.8	11.1 - 34.4 & 45.3 - 83.07
TM-02	6+00E	2+10S	180 / -45	80.0	2.9	none

Drill hole locations are illustrated in Figure 2 (below)

---

**Globex Mining Enterprises Inc.**

146, 14e rue, Rouyn-Noranda, QC J9X 2J3  
Tel.: (819) 797-5242 Fax.: (819) 797-1470 Email: globex@lino.com

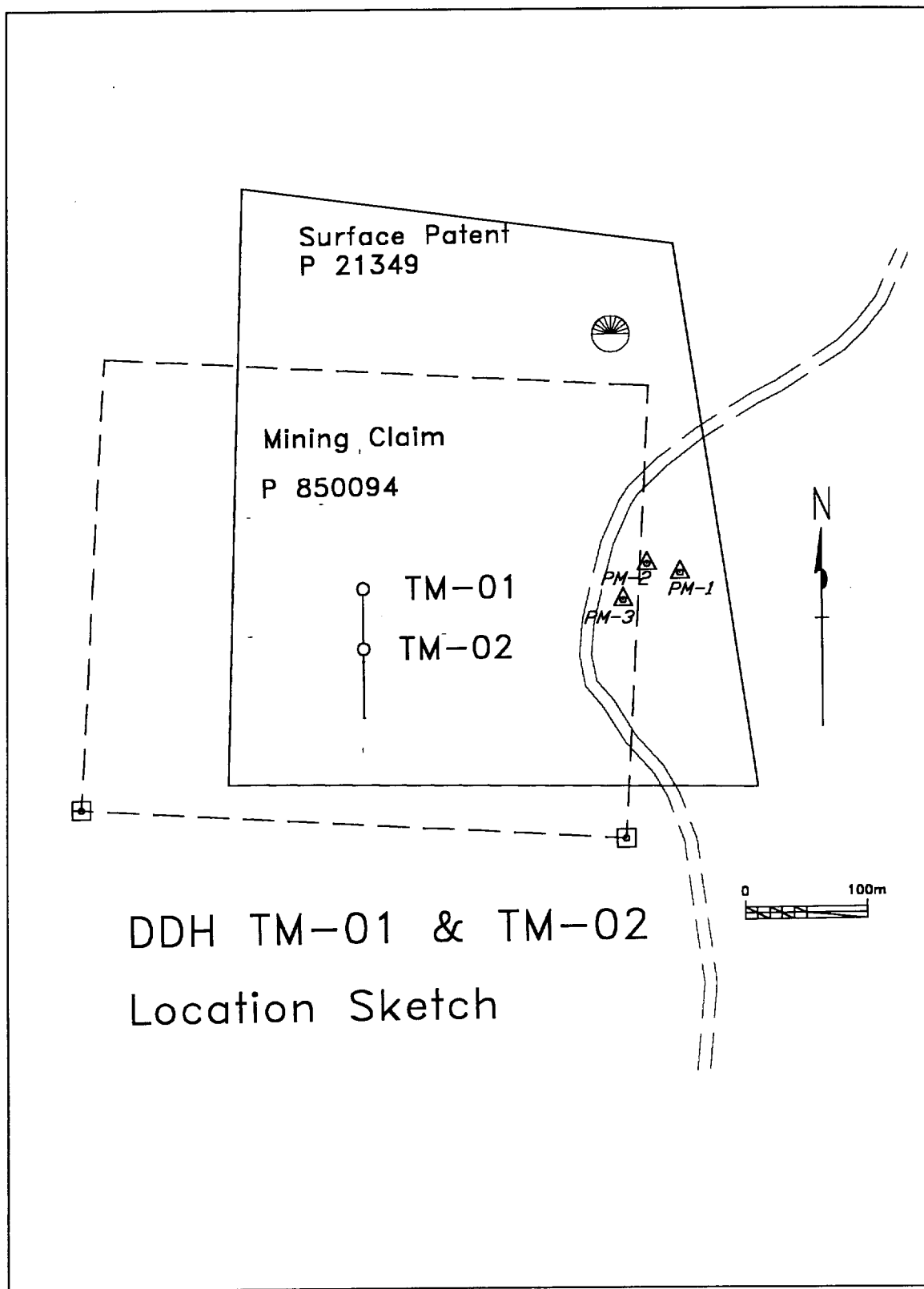

**Globex Mining Enterprises Inc.**

146, 14e rue, Rouyn-Noranda, QC J9X 2J3  
Tel.: (819)797-5242 Fax.: (819)797-1470 Email: globex@lino.com

**Results**

Two drill holes for a total of 163.07m were completed on the project during the fall drilling project. The holes were targeted to extend magnesite mineralization 100 metres west of the 1999 Kinross drilling. The first hole collared and ended in magnesite ore. The southern hole failed to intersect magnesite to any significant degree. The zone remains open to the north on this section.

Core will be analysed at a later date.

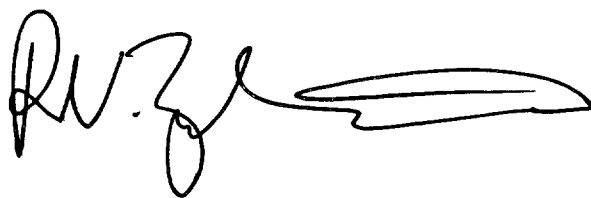

R.V. Zalnieriunas P.Geol.  
Chief Geologist  
Globex Mining Enterprises Inc.  
December 14, 2000  
Rouyn-Noranda, QC

**APPENDIX 'A'**

**Claim Data**

**TIMMINS MAGNESITE PROJECT, Deloro Township, Porcupine Division**

<u>Claim Number</u>	<u>Recording Date</u>	<u>Claim Units</u>	<u>Work Required</u>	<u>Total Reserve</u>	<u>Claim Bank</u>
P 725183	1984-FEB-28	1	400	0	0
P 725184	1984-FEB-28	1	400	34	0
P 781232	1984-FEB-28	1	400	0	0
P 849849	1985-JUN-04	1	400	0	0
P 849850	1985-JUN-04	1	400	0	0
P 849851	1985-JUN-04	1	400	0	0
P 850090	1985-MAY-07	1	400	40	0
P 850091	1985-MAY-07	1	400	53	0
P 850092	1985-MAY-07	1	400	33	0
P 850093	1985-MAY-07	1	400	0	0
P 850094	1985-MAY-07	1	400	200	0
P 850095	1985-MAY-07	1	400	11	0
P 850096	1985-MAY-07	1	400	0	0
P 850097	1985-MAY-07	1	400	0	0
P 850098	1985-MAY-07	1	400	0	0
P 878736	1987-FEB-02	1	400	0	0
P 1207799	1997-AUG-28	3	1200	14	0
P 1212628	1996-FEB-12	1	400	0	0
P 1219705	1999-MAY-05	4	1600	0	0
19 claims =		24	\$9,600	\$385	0



**APPENDIX 'B'**

**Diamond Drill Logs**

**TM-01  
and  
TM-02**





GLOBEX

# GLOBEX MINING ENTERPRISES INC. DIAMOND DRILL HOLE RECORD

HOLE NO. TM-01

From	To	LITHOLOGY	ALTERATION	MINERALISATION
0	7.38m	Casing (OB)		
7.38	11.11	- Boulders orange-yellow stained to grey, magnesite altered ultra mafic volc's - moderately blocky CORE.	- limonite	
		10.64- 11.11: black, patchy Fe-oxide stained UM. cobble		
11.11	34.37	Magnesite-talc altered Ultra mafic volc. (MZ)	- 2-3% fg spec. hematite	
		med. purplish-grey, m. eg, massive to locally banded & foliated.	- strong magnesite - minor talc	
		- re-crystallized with no original textures remaining	- variable free glz vltz, str's & thds 10-3%	
		- banding undulating & rotating along length of core	- wk lim. Fe-oxide stains on joints & fracture planes as broad bands to depth of ~ 23m	
		- occ. x-cutting wuggy carb str's & fg. bull white qstr's sets at 95-105 dca & 65 dca		
		grades / 3cm @ 105 dca into:		



GLOBEX

# GLOBEX MINING ENTERPRISES INC. DIAMOND DRILL HOLE RECORD

HOLE NO. TM-01

From	To	LITHOLOGY	ALTERATION	MINERALISATION
34.37	35.33	Talcosed & Bleached Volcanics (vi) mottled pale olive green, green-grey and occ. grey, mg, massive bleached & carb & volc.	30% pale grey talc-carb str's dev. @ 120 dca	
		grades into:		
35.33	39.27	Carb & chloritic Volcanics med. green, f-mg, massive mod. fractured & sealed with pale creamy to white carb str's & th's - occ. vuggy, shape = irreg.	- wk-mod bleached - mod Fe-carb grd mass - leucoxene - minor Fe-oxide stains /20cm on jts.	
		-tr snowflake leucoxene?		
		-probably altered ultramafic? (V13carb)		
39.27	45.30	Altered Ultramafic Volcanics mottled & banded, pale green, cream, grey to hematitic grey, f-mg, strongly re-crystallised massive to banded volc.	-wk chlorite wk spec. hematite strong carb & bleaching mod. serp. wk talc	
		44.39-44.86: mod fractured low altered UM. volc. banded.	tr. fuchsite / mari posite	(spotty)
		BC-grades @ 60 dca into:		



GLOBEX

# GLOBEX MINING ENTERPRISES INC. DIAMOND DRILL HOLE RECORD

HOLE NO. TM-01

From	To	LITHOLOGY	ALTERATION	MINERALISATION
45.30	55.25	Ultra mafic volc. (U13) dark green to grey/black, fg, massive to thinly lam., locally variolitic (?)	- variable p. grey carb as f-mg WAC ("white alteration carb spots") to fine lam. spaced <1mm apart @ 65-70dca	
		- volc. locally bleached & card <sup>d</sup> to pale grey as bands &/ bx bands. 2/3 metres thick (interflow breccias?)	- non-magnetic - <u>Fe-carb</u> stains - mod.	
		- grades into:		
55.25	83.07	Magnesite-talc alt <sup>d</sup> u.m. volc. (as 11.11 - 34.37) (M2)		
		highly re-crystallized, mg. < 1% csts 1-2cm thick & only minor qstns.		
		83.07 EOH (Drillers rpt 80.0m - mistake on blocks in boxes 8-9)		

*[Signature]*  
 Nov 3/00  
 Rayn - Natman QC



GLOBEX

**GLOBEX MINING ENTERPRISES INC.  
DIAMOND DRILL HOLE SAMPLING RECORD**

HOLE NO. TM-01

metres		Sample No.	Length	Visual Qtz %	Visual Fe-oxid	Visual Other Matrix %	Visual Talc %	Visual MgCO <sub>3</sub> %	Visual Serp. %				Code	note:
From	To													
11.11	14.0		2.89	10	1	TR	<5	82	<2				MZ	
	17.0		3.0	10	2	TR	<5	93	TR					
	20.0		↓	3	2	TR	2	92	1					
	23.0		↓	7	2-3	1	3	85	2					
	26.0		↓	3	<2	TR	3	91	<1					
	29.0		↓	2	2	TR	2	94	TR					
	32.0		3.0	5	2-3	TR	2	90	TR					↓
	34.37		2.37	5	2	TR	2	91	TR?				MZ	
34.37	35.33		0.96	+10	TR	TR	+15	75	TR?				TZ	
35.33	39.27	-	3.94	7	TR	35	<2	30?	-				V13 carb, chl.	
39.27	39.82		0.55	12	-	+20	<10	+30	10?				SZ	
	41.0		1.18	5	-	+10	+10	30	<20				SZ	spinelifer?
	44.39		3.39	5	1	+5	4	40	<5				SZ	fuchsite
	44.88		0.49	10	-	+35	5	10	5				V13 carb	
	45.3		0.43	<10	-	20	+15	30	5				V13 carb, fuch.	
45.3	50.0	-	4.69	4	TR	60-50	-	-	-			mod Fe-carbed	V13	gthds
50.0	51.0		1.0	2	TR	+50	-	-	-			mod Fe-carb	V13	shd?
51.0	55.25		4.25	2-1	TR	+60	-	-	-			mod Fe-carb	V13	gthds.









GLOBEX

# GLOBEX MINING ENTERPRISES INC. DIAMOND DRILL HOLE RECORD

HOLE NO. TM-02

From	To	LITHOLOGY	ALTERATION	MINERALISATION
0	4.15m	Casing		
4.15	17.95	Feldspar Porphyry (syenite) and 1/2 ultramafic volc. Xenoliths (IFPEU13J) - med - dk grey, fg matrix, massive inter. intrusive with +10% med porphyritic feldspar laths occ. showing flow banding textures & chilled contacts. minor fracturing showing sil <sup>2</sup> &/ bleaching at margins - variable 1/2 ultramafic bands & xeno's thro as follows:  4.15-4.53: grey IFP, Bc ≈ 90 dca - 5.26: green chl <sup>c</sup> volc flow top bx (?) / hynochstite Bc=20 ptf. - 6.5: grey IFP, fg, flow bands @ 55 dca, Bc=72 dca - 8.0: carb <sup>d</sup> UM volc, fuch thro, Bc irreg. - 14.7: grey IFP - top 2 1/2 meters fmc. & sealed w 1% gstr. - 17.95: carb <sup>d</sup> UM volc flow, fg, massive - minor thermal fines thro - grades into:	- mod. Fe-carb grd mass thro.  - occ Fe-oxide staining on jt planes / fractures	



**GLOBEX MINING ENTERPRISES INC.  
DIAMOND DRILL HOLE RECORD**

HOLE NO. TM-02

From	To	LITHOLOGY	ALTERATION	MINERALISATION
17.95	27.52	Serp - Carb - Talc altered UM Volc (SZ) p. green & grey banded, f. eg, massive to thickly laminated, re-crystallized & altered volc - minor i/c thick bands of fg, thickly laminated grey carbonate bands - possibly magnesite rich?	tr spec. hem. thro WK Fe-carb grd mass - serp. - talc zone.	
		17.96 - 18.23: Fe-oxide stained carb band. - 19.28: serp-talc eg bx - 22.94: grey carb, fol <sup>n</sup> 70dca avg (55-155° range) - 27.14: serp-talc ± Fe-oxide stains bands @ 30-20dca, fol <sup>n</sup> 30-80 & occ. undulating along core length (avg 45) - 27.52: grey carb-talc band, bc @ 65dca.		
27.52	31.0	Carb <sup>g</sup> UM. Volc (V13 carb) grey, fg, massive ultramafic volc, locally bxd & / strongly foliated; m-eg WAC (white alt <sup>n</sup> carb spots) thro; fol <sup>n</sup> @ 50-75dca trace serp, mod. carb thds bc=72°	mod. Fe-carb grd mass	



**GLOBEX MINING ENTERPRISES INC.  
DIAMOND DRILL HOLE RECORD**

HOLE NO. TM-02

From	To	LITHOLOGY	ALTERATION	MINERALISATION
31.0	37.30	Serp - talc alt U.M. Volc (SZ) (similar to 17.95-27.52)		
		31.0-31.61: p. green serp-carb, wk fol <sup>d</sup> @ 57 dca, BC=40		
		- 34.00: grey carb U.M.V, mod WAC, occ pale grey blech zones - mod carb str & d hds ptf @ 60 dca		
		- 37.30: pale green serp-talc, mg, vague banding, wk magnesite?, BC @ 63		
37.30	52.50	Carb & U.M. Volc (VIB carb) grey, fg massive ultramafic Volc, mod-WK WAC, massive flow(s) locally bxd & disrupted & sealed with qtz &/ qtz-carb str & hds. - fol <sup>d</sup> @ 65 dca - 45 dca	mod- <u>WK</u> Fe-carb grad mess -tr chl-serp & talc thro	
		50.27-52.55: transition zone ACFC=65 - thickly banded/blanked. zone of volc & i/c seqs. - breccia flow top? grades into:		



GLOBEX

# GLOBEX MINING ENTERPRISES INC. DIAMOND DRILL HOLE RECORD

HOLE NO. TM-02

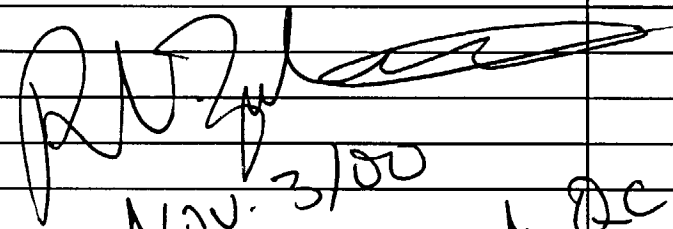
From	To	LITHOLOGY	ALTERATION	MINERALISATION
52.55	80.00	chloritic Qtz Pebble Conglomerate (Slatz) grey to green-grey, fg matrix thick bed, thinly laminated with 5-15% grey subangular to round Qtz pebbles & Qtz cobbles - matrix supported ≈ 10% subround to tabular sed. rip-up clasts thro	mod-wk Fe-carb grad near -wk green chlorite thro - minor seric &/sil <sup>2</sup>  - minor grey & opalescent grey-blue Qtz stris & qthds dev. sub ptf & occ. Xcutting thro	tr-1% py, po as fg diss grains commonly rimming Qtz clasts & as occ sulfide stringers dev. ptf.
		- avg. fol <sup>n</sup> @ 55 dca.		
		80.0 m EOH (Drillers rpt 80m)		
				
		Nov. 3/00		
		Rouyn-Noranda Q.C.		



GLOBEX

**GLOBEX MINING ENTERPRISES INC.  
DIAMOND DRILL HOLE SAMPLING RECORD**

HOLE NO. TM-02

From	To	Sample No.	Length	Visual Qtz %	Visual Fe-ox %	Visual Other Matrix %	Visual Tak %	Visual MgCO <sub>3</sub> %	Visual Serp %			Code	note:	
16.0	17.95		1.95	5	-	60	-	TR?	-			mod Fe-carb	Vcarb	
	20.0		2.05	TR	TR	-	10	<5?	60			wk-mod Fe-carb	SZ	
	23.0		3.0	<1/2	TR	-	+35	<5?	4			wk-mod "	TZ?	
	26.0		3.0	-	TR	-	30	TR	50			wk Fe-carb	SZ	
	27.52		1.52	-	TR	-	40	TR	50				SZ	
	28.23		0.71	<2	TR	40	TR	-	-				V13 carb	
	31.0		2.77	5	TR	60	TR	-	3				V13 carb	
	31.61		1.61	4	2-3	TR	40	-	50				SZ	
	34.0		2.39	12	1-2	40	20	-	5				V13, SZ	
	37.3		3.30	1	1-3	<5	30	<5?	50				SZ	
	39.0		1.70	10	1-2	-	<5	-	TR			wk	Fe-carb	V13
39.0	52.5	-	13.5	+10	1-2	55	TR	-	-			mod	Fe-carb	V13
	80.0	-	27.5	1-2	TR	+40	-	-	-			spotty wk	Fe-carb	Slight
NOTE:														
4.5	16.0	-	11.85	5	TR	20	-	-	-			mod	Fe-carb	IFPEV13]

**APPENDIX 'C'**

**Diamond Drill  
Cross Section  
6+00E**

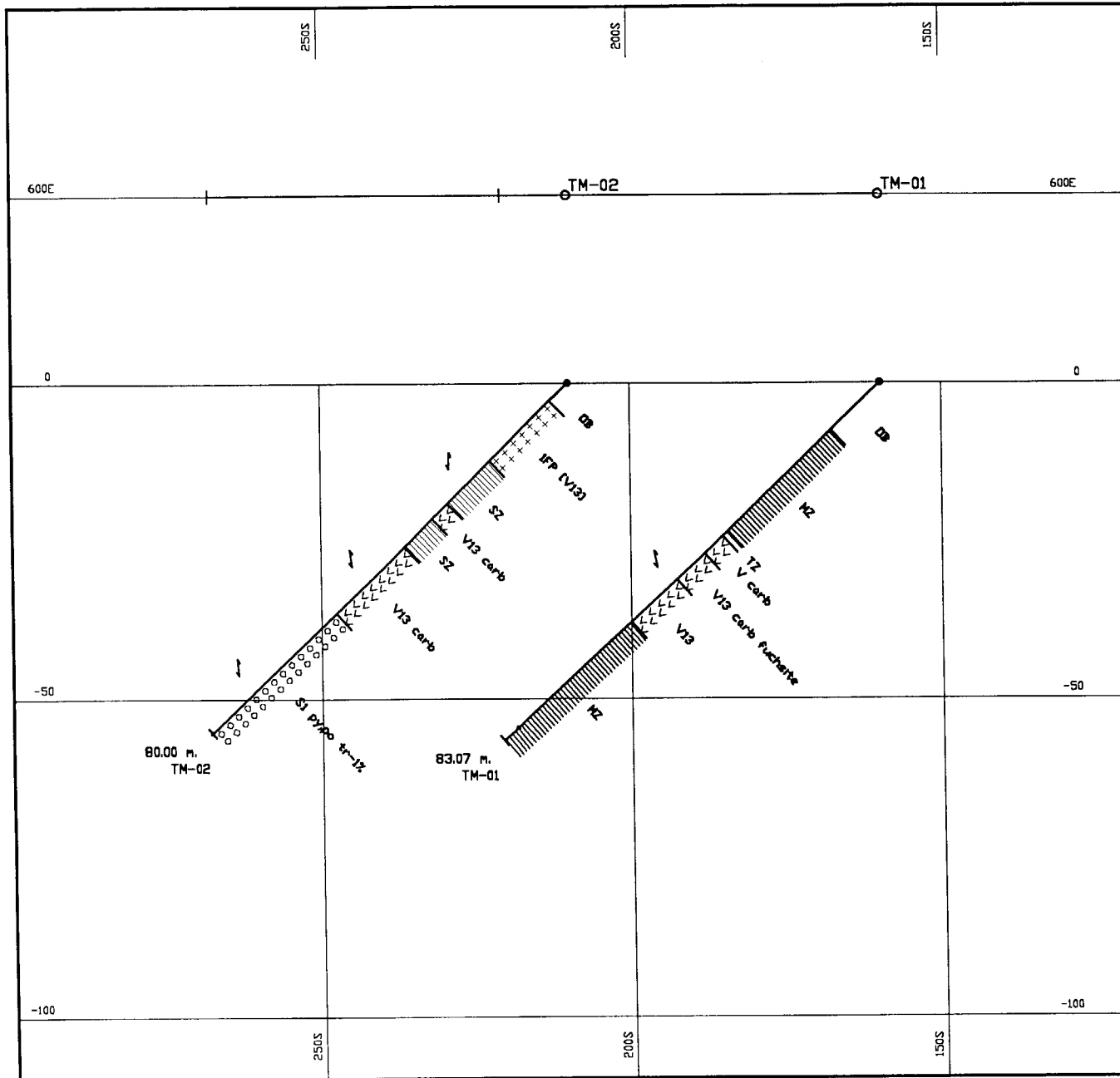

**Geological Legend:**

- Carbonate Alteration Zone**
  - (MZ) Magnesite-talc
  - (TZ) Talc-carbonate
  - (SZ) Serpentine-talc
- Intrusives**
  - (IFP) Feldspar Porphyry
- Sediments**
  - (S1) Conglomerate
- Volcanics**
  - (V) Volcanic (undif.)
  - (V13) Ultrabasic volc.
- Modifiers**
  - carb carbonitized
  - chl chloritized
  - py pyrite
  - po pyrrhotite
  - cp chalcopyrite

Globex Mining Enterprises Inc.

Timmins Magnesite Project

SECTION 6+00E

Deloro Tp., DNT NTS: 42A/06

Grid North = North (ast)

DATE: 09/12/14

SCALE: 1/1000



Declaration of Assessment Work Performed on Mining Land

Mining Act, Subsection 65(2) and 66(3), R.S.O. 1990

Transaction Number (office use) W. 0060.00495 Assessment Files Research Imaging

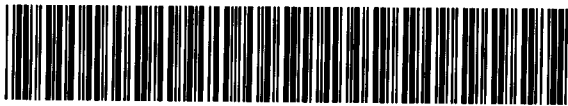

42A06SW2011 2.20791 DELORO

900

2.20791

of subsections 65(2) and 66(3) of the Mining Act. Under section 8 of the ... review the assessment work and correspond with the mining land holder. ... Recorder, Ministry of Northern Development and Mines, 6th Floor,

Instructions: - For work performed on Crown Lands before recording a claim, use form 0240. - Please type or print in ink.

1. Recorded holder(s) (Attach a list if necessary)

Form with fields for Name, Address, Client Number, Telephone Number, Fax Number. Handwritten: Globex Mining Enterprises Inc., 146, 14e rue Rouyn-Noranda, Qc J9X 2J3, Client Number 302226, Telephone Number 819-797-5242, Fax Number 819-797-1470.

2. Type of work performed: Check (✓) and report on only ONE of the following groups for this declaration.

Geotechnical: prospecting, surveys, assays and work under section 18 (regs) [ ] Physical: drilling, stripping, trenching and associated assays [✓] Rehabilitation [ ]

Form with fields for Work Type, Office Use, Dates Work Performed, Global Positioning System Data, Township/Area, Mining Division, Resident Geologist District. Handwritten: diamond drilling, diamond, 1 to 4 Nov 2000, Deloro, Percipine, Turminis.

Please remember to: - obtain a work permit from the Ministry of Natural Resources as required; - provide proper notice to surface rights holders before starting work; - complete and attach a Statement of Costs, form 0212; - provide a map showing contiguous mining lands that are linked for assigning work; - include two copies of your technical report.

3. Person or companies who prepared the technical report (Attach a list if necessary)

Form with fields for Name, Address, Telephone Number, Fax Number. Handwritten: R.V. Zalnierinnas, (as above), 819-797-5242, 819-797-1470. Includes RECEIVED stamp: DEC 18 2000, GEOSCIENCE ASSESSMENT.

4. Certification by Recorded Holder or Agent

I, R.V. Zalnierinnas, do hereby certify that I have personal knowledge of the facts set forth in this Declaration of Assessment Work having caused the work to be performed or witnessed the same during or after its completion and, to the best of my knowledge, the annexed report is true.

Form with fields for Signature of Recorded Holder or Agent, Date, Agent's Address, Telephone Number, Fax Number. Handwritten: Signature, Dec. 14 / 00, 146, 14e rue, Rouyn-Noranda Qc, 797-5242, 797-1470.



5. **Work to be recorded and distributed.** Work can only be assigned to claims that are contiguous (adjoining) to the mining land where work was performed, at the time work was performed. A map showing the contiguous link must accompany this form.

W.0060.00495

eg	Mining Claim Number. Or if work was done on other eligible mining land, show in this column the location number indicated on the claim map.	Number of Claim Units. For other mining land, list hectares.	Value of work performed on this claim or other mining land.	Value of work applied to this claim.	Value of work assigned to other mining claims.	Bank. Value of work to be distributed at a future date.
eg	TB 7827	16 ha	\$26, 825	N/A	\$24,000	\$2,825
eg	1234567	12	0	\$24,000	0	0
eg	1234568	2	\$ 8, 892	\$ 4,000	0	\$4,892
1	P 850094	1	\$9,056	\$ 800	\$ 8,000	\$ 256
2	P 725183	1		400		
3	P 725184	1		400		
4	P 781232	1		400		
5	P 849849	1		400		
6	P 849850	1		400		
7	P 849851	1		400		
8	P 850090	1		400		
9	P 850092	1		400		
10	P 850093	1		400		
11	P 850095	1		800		
12	P 878 736	1		400		
13	P 1207799	3		1200		
14	P 1212628	1		400		
15	P 1219705	4		1600		
Column Totals			\$ 9,056	\$ 8,800	\$ 8,000	\$ 256

I, R. V. Zalmerinas (Print Full Name), do hereby certify that the above work credits are eligible under subsection 7 (1) of the Assessment Work Regulation 6/96 for assignment to contiguous claims or for application to the claim where the work was done.

Signature of Recorder, Holder or Agent Authorized in Writing: R. V. Zalmerinas

Date: Dec. 14/00

6. **Instructions for cutting back credits that are not approved.**

Some of the credits claimed in this declaration may be cut back. Please check (✓) in the boxes below to show how you wish to prioritize the deletion of credits:

- 1. Credits are to be cut back from the Bank first, followed by option 2 or 3 or 4 as indicated.
- 2. Credits are to be cut back starting with the claims listed last, working backwards; or
- 3. Credits are to be cut back equally over all claims listed in this declaration; or
- 4. Credits are to be cut back as prioritized on the attached appendix or as follows (describe):

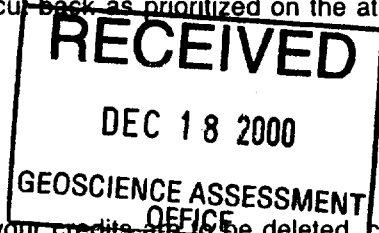

Note: If you have not indicated how your credits are to be deleted, credits will be cut back from the Bank first, followed by option number 2 if necessary.

**For Office Use Only**

Received Stamp	Deemed Approved Date	Date Notification Sent
	Date Approved	Total Value of Credit Approved
Approved for Recording by Mining Recorder (Signature)		



Ministry of Northern Development and Mines

Statement of Costs for Assessment Credit

Transaction Number (office use)  
W.0060.00495

Personal information collected on this form is obtained under the authority of subsection 6(1) of the Assessment Work Regulation 6/96. Under section 8 of the Mining Act, the information is a public record. This information will be used to review the assessment work and correspond with the mining land holder. Questions about this collection should be directed to the Chief Mining Recorder, Ministry of Northern Development and Mines, 6th Floor, 933 Ramsey Lake Road, Sudbury, Ontario, P3E 6B5.

Work Type	Units of Work <small>Depending on the type of work, list the number of hours/days worked, metres of drilling, kilometres of grid line, number of samples, etc.</small>	Cost Per Unit	Total Cost
Diamond drilling	163.07m	\$49.09/m	<del>8,566.4</del> 8,006.00
Associated Costs (e.g. supplies, mobilization and demobilization).			
Geologist (supervision, logging drafting & report writing) 3 1/2 days		\$300/d	1,050.00
Transportation Costs			
Food and Lodging Costs			
<b>Total Value of Assessment Work</b>			<b>9056.00</b>

Calculations of Filing Discounts:

1. Work filed within two years of performance is claimed at 100% of the above Total Value of Assessment Work.
2. If work is filed after two years and up to five years after performance, it can only be claimed at 50% of the Total Value of Assessment Work. If this situation applies to your claims, use the calculation below:

TOTAL VALUE OF ASSESSMENT WORK x 0.50 = 100% Total \$ value of worked claimed.

Note:  
 - Work older than 5 years is not eligible for credit.  
 - A recorded holder may be required to verify expenditures claimed in this statement of costs within 45 days of a request for verification and/or correction/clarification. If verification and/or correction/clarification is not made, the Minister may reject all or part of the assessment work submitted.

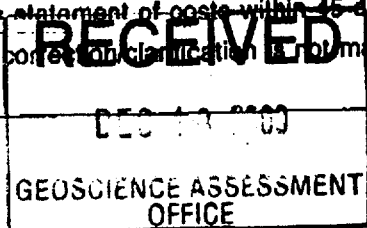

Certification verifying costs:

I, R.V. Zalmierinas (please print full name), do hereby certify, that the amounts shown are as accurate as may reasonably be determined and the costs were incurred while conducting assessment work on the lands indicated on the accompanying Declaration of Work form as agent & chief geologist (recorded holder, agent, or state company position with signing authority) I am authorized to make this certification.

Signature: R.V. Zalmierinas Date: Dec. 14/00

Geoscience Assessment Office  
933 Ramsey Lake Road  
6th Floor  
Sudbury, Ontario  
P3E 6B5

January 18, 2001

R.V. Zalnierunas  
GLOBEX MINING ENTERPRISES INC.  
146, 14E RUE  
ROUYN=NORANDA, QUEBEC  
J9X-2J3

Telephone: (888) 415-9845  
Fax: (877) 670-1555

Visit our website at:  
[www.gov.on.ca/MNDM/MINES/LANDS/mlsmnpgc.htm](http://www.gov.on.ca/MNDM/MINES/LANDS/mlsmnpgc.htm)

Dear Sir or Madam:

**Submission Number:** 2.20791

**Status**

**Subject: Transaction Number(s):** W0060.00495 Approval

---

We have reviewed your Assessment Work submission with the above noted Transaction Number(s). The attached summary page(s) indicate the results of the review. **WE RECOMMEND YOU READ THIS SUMMARY FOR THE DETAILS PERTAINING TO YOUR ASSESSMENT WORK.**

If the status for a transaction is a 45 Day Notice, the summary will outline the reasons for the notice, and any steps you can take to remedy deficiencies. The 90-day deemed approval provision, subsection 6(7) of the Assessment Work Regulation, will no longer be in effect for assessment work which has received a 45 Day Notice. Allowable changes to your credit distribution can be made by contacting the Geoscience Assessment Office within this 45 Day period, otherwise assessment credit will be cut back and distributed as outlined in Section #6 of the Declaration of Assessment work form.

Please note any revisions must be submitted in **DUPLICATE** to the Geoscience Assessment Office, by the response date on the summary.

If you have any questions regarding this correspondence, please contact **JIM MCAULEY** by e-mail at [james.mcauley@ndm.gov.on.ca](mailto:james.mcauley@ndm.gov.on.ca) or by telephone at (705) 670-5858.

Yours sincerely,



ORIGINAL SIGNED BY  
Lucille Jerome  
Acting Supervisor, Geoscience Assessment Office  
Mining Lands Section

# Work Report Assessment Results

---

**Submission Number:** 2.20791

**Date Correspondence Sent:** January 18, 2001

**Assessor:** JIM MCAULEY

---

<b>Transaction Number</b>	<b>First Claim Number</b>	<b>Township(s) / Area(s)</b>	<b>Status</b>	<b>Approval Date</b>
W0060.00495	850094	DELORO	Approval	January 15, 2001

**Section:**

16 Drilling PDRILL

At the discretion of the Ministry, the assessment work performed on the mining lands noted in this work report may be subject to inspection and/or investigation at any time.

**Correspondence to:**

Resident Geologist  
South Porcupine, ON

Assessment Files Library  
Sudbury, ON

**Recorded Holder(s) and/or Agent(s):**

R.V. Zalnieriunas  
GLOBEX MINING ENTERPRISES INC.  
ROUYN-NORANDA, QUEBEC

---

