



42A07NE0155 2.8711 BOND

2.8711

010

REPORT ON
AIRBORNE GEOPHYSICAL SURVEYS
IN
BOND AND SHERATON TOWNSHIPS
ONTARIO
FOR
SUMACH RESOURCES, INC.

BY
H. FERDERBER GEOPHYSICS

RECEIVED
DEC 09 1985
MINING LANDS SECTION

DECEMBER 4, 1985

FENTON SCOTT, P. ENG.

INTRODUCTION

An airborne geophysical survey was carried out over a claim group in Bond and Sheraton Townships, Cochrane District of Ontario, by H. Ferderber Geophysics.

Data was collected on VLF and magnetometer responses. The survey was flown from a base at Val d'Or, Quebec. The survey directly over the 60 Sumach claims was 45 miles.

PURPOSE OF SURVEY

The survey was designed to provide data which would:

1. Permit an interpretation of geological structures through recording variations in the magnetic mineral content of the formations underlying the survey area.
2. Identify potentially economic mineral concentrations which may have marked variations in accessory magnetic minerals.
3. Identify linear structures, such as major shear zones, which may result in current concentrations of VLF-signals. Such structures may contain economic minerals, notably precious metals.
4. Identify shallow, potentially valuable metallic sulfide deposits whose lower electrical resistances give resultant secondary VLF-Em fields.

SURVEY AREA

The survey covered a claim block in Bond and Sheraton Townships, Porcupine Mining Division, Ontario. The 60 unpatented mining claims included in the survey are shown on the map in an attached pocket.

EQUIPMENT

The aircraft used in this survey was a Cessna 172 owned and operated by H.Ferderber Geophysics. The sensors for geophysical data were mounted in modified wing tip installations.

Magnetometer The instrument used was a GEM GSM - 18 BA proton precession type. The sensitivity of the device was set at 2 gammas at a 1 second sampling rate. Analogue data was recorded on paper on-board.

VLF - EM System The instrument used was a Herz Totem 1 A. The total field and vertical resultant field was recorded on analogue tape. The transmitter station for this survey was Seattle, Washington, at a frequency of 24.8 kilohertz. The system was accurate to 1%.

SURVEY METHOD

The aircraft was flown at a terrain clearance of 250 feet. Navigation consisted of reference to an air mosaic, with manual fiducials recorded on the mosaic simultaneously with the geophysical tapes.

Line direction was North-South, and line spacing was 1/12 mile (440 feet).

DATA PRESENTATION

Flight lines, fiducial points, and geophysical responses are shown on air photo mosaics at a scale of 1/15, 840 (quarter mile). These mosaics also show the outlines of the claim group, together with enough claim numbers to permit identification.

Magnetic Contour Maps Correction of the aeromagnetic data for diurnal variation was by reference to a cross-line. The corrected profiles were then reduced to appropriate field strength intervals, and presented as contours at 20 gamma intervals.

VLF - EM Maps The axes of conductivity were selected on each analogue tape, and transferred to the mosaics with reference to fiducial points. These axes are further discriminated between those conductors showing a variation in total field strength, and those whose position only relates to "crossover" points on the resultant vertical field geometry.

SUMACH RESOURCES

MAGNETOMETER SURVEY

Two magnetic features were identified in the survey. One trends northeast with a maximum amplitude of 900 gammas and is probably magnetite in basic volcanics. The second appears to be caused by a north-striking diabase dyke cutting all of the older rock units.

VLF - EM SURVEY

A number of conductor axes were indicated in the survey. Those which appear to be related to bedrock features are numbered. This numbering has no implication of priority.

- (1) and (6) On north flank of magnetic trend possible overburden
- (2) and (4) On weak magnetic high
- (3) Isolated
- (5) Possibly overburden, follows bedrock magnetic trends
- (7) Apparently bedrock, interpreted by diabase dyke
- (8), (9), (10) Isolated



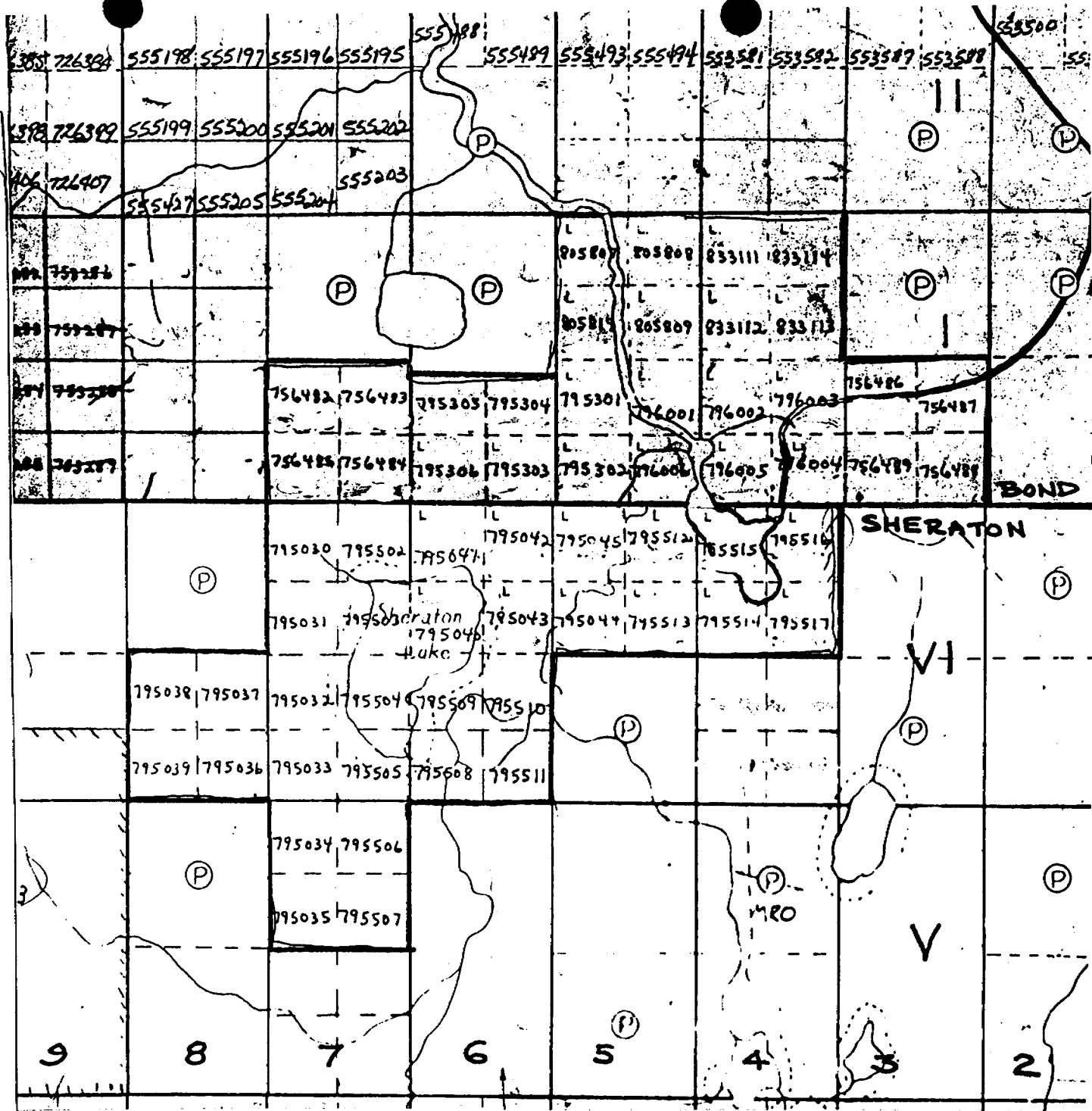



Mining Act

DO NOT use shaded areas below.

Type of Survey(s) AIRBORNE VLF-EM AND MAGNETOMETER	Township or Area DOND & SHERATON
Claim Holder(s) RANDAL SALO	Prospector's Licence No. M21107
Address GENERAL DELIVERY, CONNAUGHT, ONTARIO	
Survey Company H. FERDERBER GEOPHYSICS	Date of Survey (from & to) 5 10 85 5 10 85 Day Mo. Yr. Day Mo. Yr.
Name and Address of Author (of Geo-Technical report) FENTON SCOTT, 17 MALABAR PLACE, DON MILLS, ONTARIO M3B1A4	
Total Miles of line cut 12	

Credits Requested per Each Claim in Columns at right

Special Provisions	Geophysical	Days per Claim
For first survey: Enter 40 days. (This includes line cutting)	- Electromagnetic	
	- Magnetometer	
For each additional survey: using the same grid: Enter 20 days (for each)	- Radiometric	
	- Other	
	Geological	
	Geochemical	
Man Days Complete reverse side and enter to (s) of line	Geophysical	Days per Claim
	- Electromagnetic	
	- Magnetometer	
	- Radiometric	
	Geological	
	Geochemical	
Airborne Credits Note: Special provisions credits do not apply to Airborne Surveys.	VLF Electromagnetic	Days per Claim 30
	Magnetometer	30
	Radiometric	

Mining Claims Traversed (List in numerical sequence)

Mining Claim		Expend. Days Cr.	Mining Claim		Expend. Days Cr.
Prefix	Number		Prefix	Number	
P	795502				
	03				
	04				
	05				
	06				
	07				
	08				
	09				
	10				
	11				
	12				
	13				
	14				
	15				
	16				
	17				

Expenditures (excluding transportation)

Type of Work Performed

Performed on Claim(s)
OCT - 8 1985

Calculation of Expenditure Days Credits

Total Expenditures ÷ 15 = Total Days Credits

Instructions
Total Days Credits may be apportioned at the claim holder's choice. Enter number of days credits per claim selected in columns at right.

Total number of mining claims covered by this report of work. **16**

For Office Use Only

Total Days Cr. Recorded 960	Date Recorded Oct 8/85	Mining Record
	Date Approved as Recorded 86.1.6	Branch Inspector

Date **OCT 7/85** Recorder Holder or Agent (Signature) *[Signature]*

Certification Verifying Report of Work (AGENT)

I hereby certify that I have a personal and intimate knowledge of the facts set forth in the Report of Work annexed hereto, having performed the work or witnessed same during and/or after its completion and the annexed report is true.

Name and Postal Address of Person Certifying
FENTON SCOTT, 17 MALABAR PLACE DON MILLS, ONTARIO, M3B1A4

Date Certified **OCT 7/85** Certified by (Signature) *[Signature]*



Ministry of Natural Resources

Report of Work
(Geophysical, Geological, Geochemical and Expenditures)

366/85-

Instructions: - Please type or print.
- If number of mining claims traversed exceeds space on this form, attach a list.
Note: - Only days credits calculated in the "Expenditures" section may be entered in the "Expend. Days Cr." columns.
- Do not use shaded areas below.

NOV 27 1985

Mining Act

Type of Survey(s) AIRBORNE VLF-EM AND MAGNETOMETER		Township or Area BOND & SHERATON	
Claim Holder(s) DANIEL LACROIX		Prospector's Licence No. M20603	
Address % DUN MCKINNON, CINCINNATI, ONTARIO			
Survey Company H. FERDERBER GEOPHYSICS.		Date of Survey (from & to) Day Mo. Yr. Day Mo. Yr. 5 10 85 10 85	Total Miles of line 4.5
Name and Address of Author (of Geo-Technical report) FENTON SCOTT, 17 MALABAR PLACE, DUN MILLS, ONTARIO			

Credits Requested per Each Claim in Columns at right

Mining Claims Traversed (List in numerical sequence)

Special Provisions	Geophysical	Days per Claim
For first survey: Enter 40 days. (This includes line cutting)	- Electromagnetic	
	- Magnetometer	
For each additional survey using the same method: Enter 20 days (for each)	- Radiometric	
	- Other	
	Geological	
	Geochemical	
Man Days Complete reverse side and enter total(s) here	- Electromagnetic	
	- Magnetometer	
	- Radiometric	
	- Other	
	Geological	
Airborne Credits	VLF Electromagnetic	30
Note: Special provisions credits do not apply to Airborne Surveys.	Magnetometer	30
	Radiometric	

Mining Claim		Expend. Days Cr.	Mining Claim		Expend. Days Cr.
Prefix	Number		Prefix	Number	
P	795301				
	02				
	03				
	04				
	05				
	06				

Expenditures (excludes power stripping)

Type of Work performed
RECORDED

Performed on Claim(s)
OCT - 8 1985

Calculation of Expenditure Days Credits

Total Expenditures \$ ÷ 15 = Total Days Credits

Instructions
Total Days Credits may be apportioned at the claim holder's choice. Enter number of days credits per claim selected in columns at right.

RECORDED
OCT - 8 1985

Total number of mining claims covered by this report of work. **6**

For Office Use Only

Total Days Cr. Recorded **360**

Date Recorded **Oct 8/85**

Date Approved as Recorded **16.1.6**

Mining Recorder **[Signature]**

Branch Director **[Signature]**

Date **OCT 7/85**

Recorder, Holder or Agent (Signature) **[Signature]**

I hereby certify that I have a personal and intimate knowledge of the facts set forth in the Report of Work annexed hereto, having performed the work or witnessed same during and/or after its completion and the annexed report is true.

Name and Postal Address of Person Certifying
FENTON SCOTT, 17 MALABAR PLACE, DUN MILLS, ONTARIO

Date Certified **OCT 7/85**

Certified by (Signature) **[Signature]**

367/85 2.8711

Instructions: - Please type or print. - If number of mining claims traversed exceeds space on this form, attach a list. Note: - Only days credits calculated in the "Expenditures" section may be entered in the "Expend. Days Cr." columns. - Do not use shaded areas below.

No. 27

Mining Act

Type of Survey(s): **AIRBORNE VLF-EM AND MAGNETOMETER** Township or Area: **BOND & SHEKATON**

Claim Holder(s): **ERNEST SICARD** Prospector's Licence No.: **M-19643**

Address: **40 DUN MCKINNON, CUNNADOTT, ONTARIO**

Survey Company: **H. FERDERBER GEOPHYSICS** Date of Survey (from & to): **5 10 85 5 10 85** Total Miles of line Cut: **9**

Name and Address of Author (of Geo-Technical report): **FENTON SCOTT, 17 MALABAR PLACE, DON MILLS, ONTARIO M3B1A4**

Credits Requested per Each Claim in Columns at right

Special Provisions	Geophysical	Days per Claim
For first survey: Enter 40 days. (This includes line cutting)	- Electromagnetic	
	- Magnetometer	
For each additional survey: using the same grid: Enter 20 days (for each)	- Radiometric	
	- Other	
	Geological	
	Geochemical	

Man Days	Geophysical	Days per Claim
Complete reverse side and enter total	- Electromagnetic	
	- Magnetometer	
	- Radiometric	
	- Other	
	Geological	
	Geochemical	

Airborne Credits	Geophysical	Days per Claim
Note: Special provisions credits do not apply to Airborne Surveys.	VLF Electromagnetic	30
	Magnetometer	30
	Radiometric	

RECEIVED
OCT 15 1985
MINING LANDS SECTION

Mining Claims Traversed (List in numerical sequence)

Prefix	Mining Claim Number	Expend. Days Cr.
P	756482	
	3	
	4	
	5	
	6	
	7	
	8	
	9	
	833111	
	12	
	13	
	14	

RECORDED
OCT 08 1985
CJ

Expenditures (excludes power stripping)

Type of Work Performed: **RECORDED**

Performed on Claim(s): **OCT - R 1985**

Calculation of Expenditure Days Credits

Total Expenditures: \$ ÷ 15 = Total Days Credits

Instructions: Total Days Credits may be apportioned at the claim holder's choice. Enter number of days credits per claim selected in columns at right.

Total number of mining claims covered by this report of work. **12**

Date: **OCT 7/85** Record Holder or Agent (Signature): **Fenton Scott**
AGENT

For Office Use Only

Total Days Cr. Recorded: **720** Date Recorded: **Oct 8/85** Mining Recorder: **[Signature]**

Date Approved as Recorded: **86.1.6** Branch Director: **[Signature]**

Certification Verifying Report of Work

I hereby certify that I have a personal and intimate knowledge of the facts set forth in the Report of Work annexed hereto, having performed the work or witnessed same during and/or after its completion and the annexed report is true.

Name and Postal Address of Person Certifying: **FENTON SCOTT, 17 MALABAR PLACE, DON MILLS, ONTARIO.**

Date Certified: **OCT 7/85** Certified by (Signature): **Fenton Scott**

Nov. 27th



Report of Work
(Geophysical, Geological,
Geochemical and Expenditures)

368/85
28711

Instructions: - Please type or print.
- If number of mining claims traversed exceeds space on this form, attach a list.
Note: - Only days credits calculated in the "Expenditures" section may be entered in the "Expend. Days Cr." columns.
- Do not use shaded areas below.

Mining Act

Type of Survey(s) **AIRBORNE VLF-EM AND MAGNETOMETER** Township or Area **BUND & JNEKATON**

Claim Holder(s) **YVON GRONDIN** Prospector's Licence No. **M21611**

Address **1/2 DON MCKINNON, CONNAUGHT, ONTARIO**

Survey Company **H. FERDERBER GEOPHYSICS.** Date of Survey (from & to) **5 10 85 5 10 85** Total Miles of line ^{shown} **4.5**

Name and Address of Author (of Geo-Technical report) **FENTON SCOTT, 17 MALABAR PLACE, DON MILLS, ONTARIO**

Credits Requested per Each Claim in Columns at right

Mining Claims Traversed (List in numerical sequence)

Special Provisions	Geophysical	Days per Claim
For first survey: Enter 40 days. (This includes line cutting)	- Electromagnetic	
	- Magnetometer	
For each additional survey: using the same grid: Enter 20 days (for each)	- Radiometric	
	- Other	
	Geological	
	Geochemical	
Man Days Complete reverse side and enter total(s) here	Geophysical	Days per Claim
	- Electromagnetic	
	- Magnetometer	
	- Radiometric	
	Geological	
	Geochemical	
Airborne Credits Note: Special provisions credits do not apply to Airborne Surveys.	VLF Electromagnetic	30
	Magnetometer	30
	Radiometric	

Mining Claim			Mining Claim		
Prefix	Number	Expend. Days Cr.	Prefix	Number	Expend. Days Cr.
P	796001				
	02				
	03				
	04				
	05				
	06				

RECEIVED

OCT 15 1985

MINING LANDS SECTION

RECORDED

OCT 08 1985

RECORDED

OCT - 8 1985

Expenditures (excludes power stripping)

Type of Work Performed **RECORDED**

Performed on Claim(s) **OCT - 8 1985**

Calculation of Expenditure Days Credits

Total Expenditures \$ ÷ 15 =

Total Days Credits

Instructions
Total Days Credits may be apportioned at the claim holder's choice. Enter number of days credits per claim selected in columns at right.

Total number of mining claims covered by this report of work. **6**

For Office Use Only

Total Days Cr. Recorded **360** Date Recorded **Oct 8, 1985** Mining Recorder **[Signature]**

Date Approved as Recorded **1. 86. 1. 6** Branch Inspector **[Signature]**

Date **Oct 7/85** Recorded Holder or Agent (Signature) **[Signature]**

Certification Verifying Report of Work **AGENT**

I hereby certify that I have a personal and intimate knowledge of the facts set forth in the Report of Work annexed hereto, having performed the work or witnessed same during and/or after its completion and the annexed report is true.

Name and Postal Address of Person Certifying **FENTON SCOTT 17 MALABAR PLACE DON MILLS, ONT M3B1A2**

Date Certified **Oct 7/85** Certified by (Signature) **[Signature]**

Nov. 27



Report of Work (Geophysical, Geological, Geochemical and Expenditures)

369/85-28711

Instructions: - Please type or print. - If number of mining claims traversed exceeds space on this form, attach a list. Note: - Only days credits calculated in the "Expenditures" section may be entered in the "Expend. Days Cr." columns. - Do not use shaded areas below.

Mining Act

Form header containing: Type of Survey(s) AIRBORNE VLF-EM AND MAGNETOMETER, Township or Area BOND & SHELATORO, Claim Holder(s) EDWARD J. KORBA, Prospector's Licence No. M20807, Address % DON MCKINNIN, CONNAUGHT, ONTARIO, Survey Company H. FELDERBER GEOPHYSICS, Date of Survey (from & to) 5 10 85, Total Miles of line cut 3, Name and Address of Author (of Geo-Technical report) FENTON SCOTT, 17 MALABAR PLACE, DON MILLS, ONTARIO

Table with 3 columns: Special Provisions, Geophysical, Days per Claim. Includes rows for first survey (40 days), additional survey (20 days), Man Days (30), and Airborne Credits (30).

Table with 4 columns: Mining Claim Prefix, Mining Claim Number, Expend. Days Cr., and another Mining Claim column. Contains entries for claims 805808, 805809, and 805819.

RECORDED OCT 08 1985

Form section for Expenditures (excluding power stripping), Type of Work Performed, Performed on Claim(s) OCT - 8 1985, and Calculation of Expenditure Days Credits: \$ / 15 =

Total number of mining claims covered by this report of work. 4

Instructions: Total Days Credits may be apportioned at the claim holder's choice. Enter number of days credits per claim selected in columns at right.

For Office Use Only section containing: Total Days Cr. Recorded 240, Date Recorded Oct 8/85, Mining Records, Date Approved as Recorded 8.1.6, Branch Director signature.

Date Oct 7/85, Recorded Holder of Agent (Signature) Fenton Scott

Certification Verifying Report of Work. I hereby certify that I have a personal and intimate knowledge of the facts set forth in the Report of Work annexed hereto, having performed the work or witnessed same during and/or after its completion and the annexed report is true.

Name and Postal Address of Person Certifying: FENTON SCOTT, 17 MALABAR PLACE, DON MILLS, ONTARIO. Date Certified: Oct 7/85. Certified by (Signature): Fenton Scott

Nov 27th

364/85- 28711

Instructions: - Please type or print.
- If number of mining claims traversed exceeds space on this form, attach a list.
Note: - Only days credits calculated in the "Expenditures" section may be entered in the "Expend. Days Cr." columns.
- Do not use shaded areas below.



Report of Work
(Geophysical, Geological,
Geochemical and Expenditures)

Mining Act

Type of Survey(s) AIRBORNE VLF-EM AND MAGNETOMETER		Township or Area BOND & JHERATORA	
Claim Holder(s) LARRY JOHN SALO		Prospector's Licence No. M20010	
Address GENERAL DELIVERY, CONNAUGHT, ONTARIO			
Survey Company H. FERDERBER GEOPHYSICS.		Total Miles of line ^{FLOWN} 12	
Date of Survey (from & to) 5 10 85 - 5 10 85		Day Mo. Yr. Day Mo. Yr.	
Name and Address of Author (of Geo-Technical report) FENTON SCOTT, 17 MALABAR PLACE, DON MILLS, ONTARIO M3B1A4			

Credits Requested per Each Claim in Columns at right

Special Provisions	Geophysical	Days per Claim
For first survey: Enter 40 days. (This includes line cutting)	- Electromagnetic	
	- Magnetometer	
For each additional survey: using the same grid: Enter 20 days (for each)	- Radiometric	
	- Other	
	Geological	
	Geochemical	
Man Days Complete reverse side and enter total(s) here	Geophysical	Days per Claim
	- Electromagnetic	
	- Magnetometer	
	- Radiometric	
	- Other	
	Geological	
	Geochemical	
Airborne Credits	Geophysical	Days per Claim
Note: Special provisions credits do not apply to Airborne Surveys.	- Electromagnetic	30
	- Magnetometer	30
	- Radiometric	

RECEIVED
OCT 15 1985

MINING LANDS SECTION
VLF

Mining Claims Traversed (List in numerical sequence)

Mining Claim		Expend. Days Cr.	Mining Claim		Expend. Days Cr.
Prefix	Number		Prefix	Number	
P	795030				
	31				
	32				
	33				
	34				
	35				
	36				
	37				
	38				
	39				
	40				
	41				
	42				
	43				
	44				
	45				

RECORDED
OCT - 8 1985

Expenditures (excluding power striping)

Type of Work Performed

Performed on Claim(s)

OCT - 8 1985

Calculation of Expenditure Days Credits

Total Expenditure ÷ **15** = Total Days Credits

Total number of mining claims covered by this report of work. **16**

Instructions
Total Days Credits may be apportioned at the claim holder's choice. Enter number of days credits per claim selected in columns at right.

For Office Use Only

Total Days Cr. Recorded	Date Recorded	Miner's Name
960	Oct 8/85	<i>Chandler</i>
	Date Approved as Recorded	Branch Director
	86.1.6	<i>[Signature]</i>

Date **Oct. 7/85**

Recorded Holder or Agent (Signature)
Fenton Scott
(AGENT)

Certification Verifying Report of Work

I hereby certify that I have a personal and intimate knowledge of the facts set forth in the Report of Work annexed hereto, having performed the work or witnessed same during and/or after its completion and the annexed report is true.

Name and Postal Address of Person Certifying
FENTON SCOTT 17 MALABAR PLACE, DON MILLS, ONTARIO M3B1A4

Date Certified **7/10/85**

Certified by (Signature)
Fenton Scott

GEOPHYSICAL TECHNICAL DATA

GROUND SURVEYS - If more than one survey, specify data for each type of survey

Number of Stations _____ Number of Readings _____

Station interval _____ Line spacing _____

Profile scale _____

Contour interval _____

MAGNETIC

Instrument _____

Accuracy - Scale constant _____

Diurnal correction method _____

Base Station check-in interval (hours) _____

Base Station location and value _____

ELECTROMAGNETIC

Instrument _____

Coil configuration _____

Coil separation _____

Accuracy _____

Method: Fixed transmitter Shoot back In line Parallel line

Frequency _____
(specify V.L.F. station)

Parameters measured _____

GRAVITY

Instrument _____

Scale constant _____

Corrections made _____

Base station value and location _____

Elevation accuracy _____

INDUCED POLARIZATION RESISTIVITY

Instrument _____

Method Time Domain Frequency Domain

Parameters - On time _____ Frequency _____

- Off time _____ Range _____

- Delay time _____

- Integration time _____

Power _____

Electrode array _____

Electrode spacing _____

Type of electrode _____

SELF POTENTIAL

Instrument _____ Range _____

Survey Method _____

Corrections made _____

RADIOMETRIC

Instrument _____

Values measured _____

Energy windows (levels) _____

Height of instrument _____ Background Count _____

Size of detector _____

Overburden _____

(type, depth - include outcrop map)

OTHERS (SEISMIC, DRILL WELL LOGGING ETC.)

Type of survey _____

Instrument _____

Accuracy _____

Parameters measured _____

Additional information (for understanding results) _____

AIRBORNE SURVEYS

Type of survey(s) VLF-EM MAGNETOMETER

Instrument(s) TUTEM 1A GEN-GSM 10 BA

Accuracy 1% (specify for each type of survey) 2 GAMMA

Aircraft used CESSNA 172 (specify for each type of survey)

Sensor altitude 250'

Navigation and flight path recovery method VISUAL NAVIGATION, MANUAL

PROFILES ON AIR PHOTO MOSAICS

Aircraft altitude 250' Line Spacing 330'

Miles flown over total area 82 Over claims only 45-

GEOCHEMICAL SURVEY - PROCEDURE RECORD

Numbers of claims from which samples taken _____

Total Number of Samples _____

Type of Sample _____
(Nature of Material)

Average Sample Weight _____

Method of Collection _____

Soil Horizon Sampled _____

Horizon Development _____

Sample Depth _____

Terrain _____

Drainage Development _____

Estimated Range of Overburden Thickness _____

SAMPLE PREPARATION

(Includes drying, screening, crushing, ashing)

Mesh size of fraction used for analysis _____

General _____

ANALYTICAL METHODS

Values expressed in: per cent
p. p. m.
p. p. b.

Cu, Pb, Zn, Ni, Co, Ag, Mo, As, -(circle)

Others _____

Field Analysis (_____ tests)

Extraction Method _____

Analytical Method _____

Reagents Used _____

Field Laboratory Analysis

No. (_____ tests)

Extraction Method _____

Analytical Method _____

Reagents Used _____

Commercial Laboratory (_____ tests)

Name of Laboratory _____

Extraction Method _____

Analytical Method _____

Reagents Used _____

General _____

LIST OF MINING CLAIMS

SUMACH RESOURCES LTD.

P 756482 ✓
83.
84.
85.
86.
87.
88.
89.

P 795301 ✓
02.
03.
04.
05.
06.

P 796002 ✓
03.
04.
05.
06.

795030 ✓
31 ✓
32.
33.
34.
35.
36.
37.
38.
39.
40.
41 ✓
42.
43.
44.
45. ✓

P 795502 ✓
03.
04.
05.
06.
07.
08.
09.
10.
11.
12.
13.
14.
15.
16.
17.

P 805807 ✓
08.
09.

P 805819 ✓

P 833111 ✓
12.
13.
14.

TOTAL 60 CLAIMS

REGISTERED

November 27, 1985

Report Of Work #364

Larry John Salo
General Delivery
Connaught, Ontario
PON 1A0

Dear Sir:

RE: Mining Claims P 795030, et al,
in Bond & Sheraton Townships

I have not received the reports and maps (in duplicate)
for the Airborne (Electromagnetic & Magnetometer) Surveys
on the above-mentioned claims.

As the assessment "Report of Work" was recorded by the
Mining Recorder on October 8, 1985 the 60 day period
allowed by Section 77 of the Mining Act for the submission
of the technical reports and maps to this office will
expire on December 7, 1985.

If the material is not submitted to this office by December 7,
1985 I will have no alternative but to instruct the Mining
Recorder to delete the work credits from the claim record
sheets.

For further information, please contact Mr. Arthur Barr
at (416)965-4888.

Yours sincerely,

S.E. Yundt
Director
Land Management Branch

Whitney Block, Room 6643
Queen's Park
Toronto, Ontario
M7A 1W3
Phone:(416)965-4888

AB/mc

cc: Fenton Scott
17 Malabar Place
Don Mills, Ontario
M3B 1A4

Encl.

Mining Recorder
Timmins, Ontario

REGISTERED

November 27, 1985

Report Of Work #365

Randal Salo
General Delivery
Connaught, Ontario
PON 1A0

Dear Sir:

RE: Mining Claims P 795502, et al,
in Bond & Sheraton Townships

I have not received the reports and maps (in duplicate) for the Airborne (Electromagnetic & Magnetometer) Survey on the above-mentioned claims.

As the assessment "Report of Work" was recorded by the Mining Recorder on October 8, 1985 the 60 day period allowed by Section 77 of the Mining Act for the submission of the technical reports and maps to this office will expire on December 7, 1985.

If the material is not submitted to this office by December 7, 1985 I will have no alternative but to instruct the Mining Recorder to delete the work credits from the claim record sheets.

For further information, please contact Mr. Arthur Barr at (416)965-4888.

Yours sincerely,

S.E. Yundt
Director
Land Management Branch

Whitney Block, Room 6643
Queen's Park
Toronto, Ontario
M7A 1W3
Phone: (416)965-4888

AB/mc .

cc: Fenton Scott
17 Malabar Place
Don Mills, Ontario
M3B 1A4

Encl.

Mining Recorder
Timmins, Ontario

REGISTERED

November 27, 1985

Report Of Work #366

Daniel Lacroix
c/o Don McKinnon
Connaught, Ontario
PON 1A0

Dear Sir:

RE: Mining Claims P 795301, et al,
in Bond & Sheraton Townships

I have not received the reports and maps (in duplicate)
for the Airborne (Electromagnetic & Magnetometer) Surveys
on the above-mentioned claims.

As the assessment "Report of Work" was recorded by the
Mining Recorder on October 8, 1985 the 60 day period
allowed by Section 77 of the Mining Act for the submission
of the technical reports and maps to this office will
expire on December 7, 1985.

If the material is not submitted to this office by December 7,
1985 I will have no alternative but to instruct the Mining
Recorder to delete the work credits from the claim record
sheets.

For further information, please contact Mr. Arthur Barr
at (416)965-4888.

Yours sincerely,

S.E. Yundt
Director
Land Management Branch

Whitney Block, Room 6643
Queen's Park
Toronto, Ontario
M7A 1W3
Phone:(416)965-4888

AB/mc

cc: Fenton Scott
17 Malabar Place,
Don Mills, Ontario
M3B 1A4

Encl.

Mining Recorder
Timmins, Ontario

REGISTERED

November 27, 1985

Report Of Work #367

Ernest Sicard
c/o Don McKinnon
Connaught, Ontario
PON 1A0

Dear Sir:

RE: Mining Claims P 756482, et al,
in Bond & Sheraton Townships

I have not received the reports and maps (in duplicate)
for the Airborne (Electromagnetic & Magnetometer) Surveys
on the above-mentioned claims.

As the assessment "Report of Work" was recorded by the
Mining Recorder on October 8, 1985 the 60 day period
allowed by Section 77 of the Mining Act for the submission
of the technical reports and maps to this office will
expire on December 7, 1985.

If the material is not submitted to this office by December 7,
1985 I will have no alternative but to instruct the Mining
Recorder to delete the work credits from the claim record
sheets.

For further information, please contact Mr. Arthur Barr
at (416)965-4888.

Yours sincerely,

S.E. Yundt
Director
Land Management Branch

Whitney Block, Room 6643
Queen's Park
Toronto, Ontario
M7A 1W3
Phone:(416)965-4888

AB/mc

cc: Fenton Scott
17 Malabar Place
Don Mills, Ontario
M3B 1A4
Encl.

Mining Recorder
Timmins, Ontario

REGISTERED

November 27, 1985

Report Of Work #368

Yvon Grondin
c/o Don McKinnon
Connaught, Ontario
PON 1A0

Dear Sir:

RE: Mining Claims P 796001, et al,
in Bond & Sheraton Townships

I have not received the reports and maps (in duplicate)
for Airborne (Electromagnetic & Magntometer) Surveys on
the above-mentioned claims.

As the assessment "Report of Work" was recorded by the
Mining Recorder on October 8, 1985 the 60 day period
allowed by Section 77 of the Mining Act for the submission
of the technical reports and maps to this office will
expire on December 7, 1985.

If the material is not submitted to this office by December 7,
1985 I will have no alternative but to instruct the Mining
Recorder to delete the work credits from the claim record
sheets.

For further information, please contact Mr. Arthur Barr
at (416)965-4888.

Yours sincerely,

S.E. Yundt
Director
Land Management Branch

Whitney Block, Room 6643
Queen's Park
Toronto, Ontario
M7A 1W3
Phone:(416)965-4888

AB/mc

cc: Fenton Scott
17 Malabar Place
Don Mills, Ontario
M3B 1A4

Encl.

Mining Recorder
Timmins, Ontario

REGISTERED

November 27, 1985

Report Of Work #369

*Hold these till
Monday.*

Edward J. Korba
c/o Don McKinnon
Connaught, Ontario
PON 1A0

Dear Sir:

RE: Mining Claims P 805807, et al,
in Bond & Shearaton Townships

I have not received the reports and maps (in duplicate)
for Airborne (Electromagnetic & Magnetometer) Surveys
on the above-mentioned claims.

As the assessment "Report of Work" was recorded by the
Mining Recorder on October 8, 1985 the 60 day period
allowed by Section 77 of the Mining Act for the submission
of the technical reports and maps to this office will
expire on December 7, 1985.

If the material is not submitted to this office by December 7,
1985 I will have no alternative but to instruct the Mining
Recorder to delete the work credits from the claim record
sheets.

For further information, please contact Mr. Arthur Barr
at (416)965-4888.

Yours sincerely,

S.E. Yundt
Director
Land Management Branch

Whitney Block, Room 6643
Queen's Park
Toronto, Ontario
M7A 1W3
Phone: (416)965-4888

AB/mc

cc: Fenton Scott
17 Malabar Place
Don Mills, Ontario
M3B 1A4

Mining Recorder
Timmins, Ontario

Encl.

Mining Lands Section

File No 28711

Control Sheet

TYPE OF SURVEY

- GEOPHYSICAL
- GEOLOGICAL
- GEOCHEMICAL
- EXPENDITURE

MINING LANDS COMMENTS:

all claims covered.

H.S.
lgl

J. Hurst
Signature of Assessor

Jan 3/86
Date

BOND TOWNSHIP

ONTARIO
MINISTRY OF NATURAL RESOURCES
SURVEYS AND MAPPING BRANCH

PORCUPINE MINING DIVISION

DISTRICT OF COCHRANE

M.331

SCALE 40 CHAINS TO ONE INCH
STOCK TWP.

28711,2

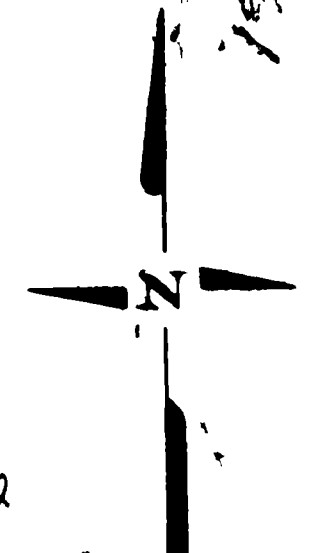

MACKLEM TWP.

VI

V

IV

III

II

CURRIE TWP.

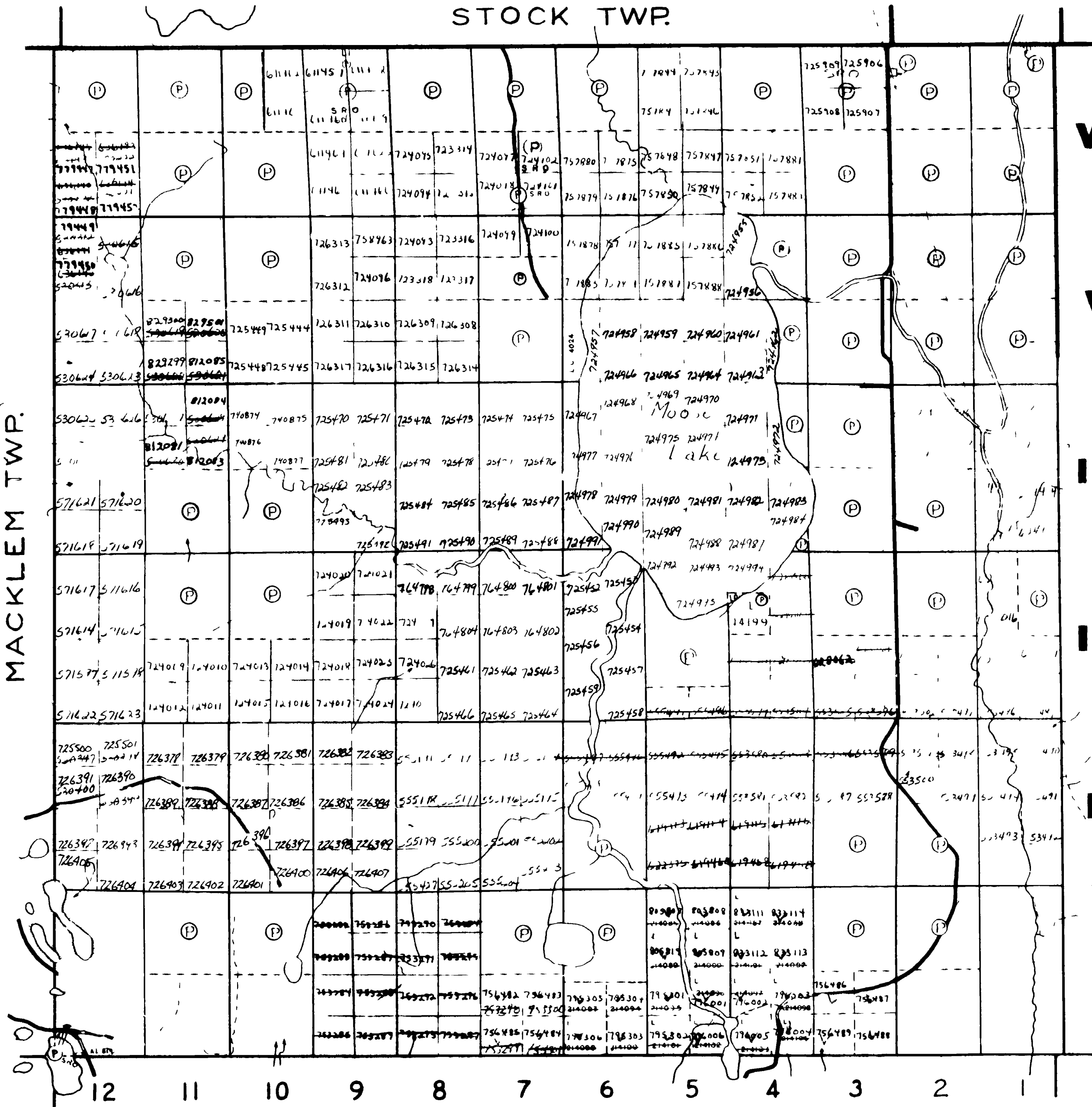

SHERATON TWP.

NOTE



200

Surface rights reservation around all roads & rivers

- GEND
- PATENTED LANDS
- CROWN LAND SALE
- LOCATED LANDS
- LICENSE OF OCCUPATION
- LEASE

- (P)
- (S) L S
- (L) ac
- (L) U
- (L) E A T A

SHERATON TOWNSHIP

ONTARIO

MINISTRY OF NATURAL RESOURCES PORCUPINE MINING DIVISION
SURVEYS AND MAPPING BRANCH

DISTRICT OF COCHRANE

M 386

SCALE 40 CHAINS TO ONE INCH

BOND TWP

287112'

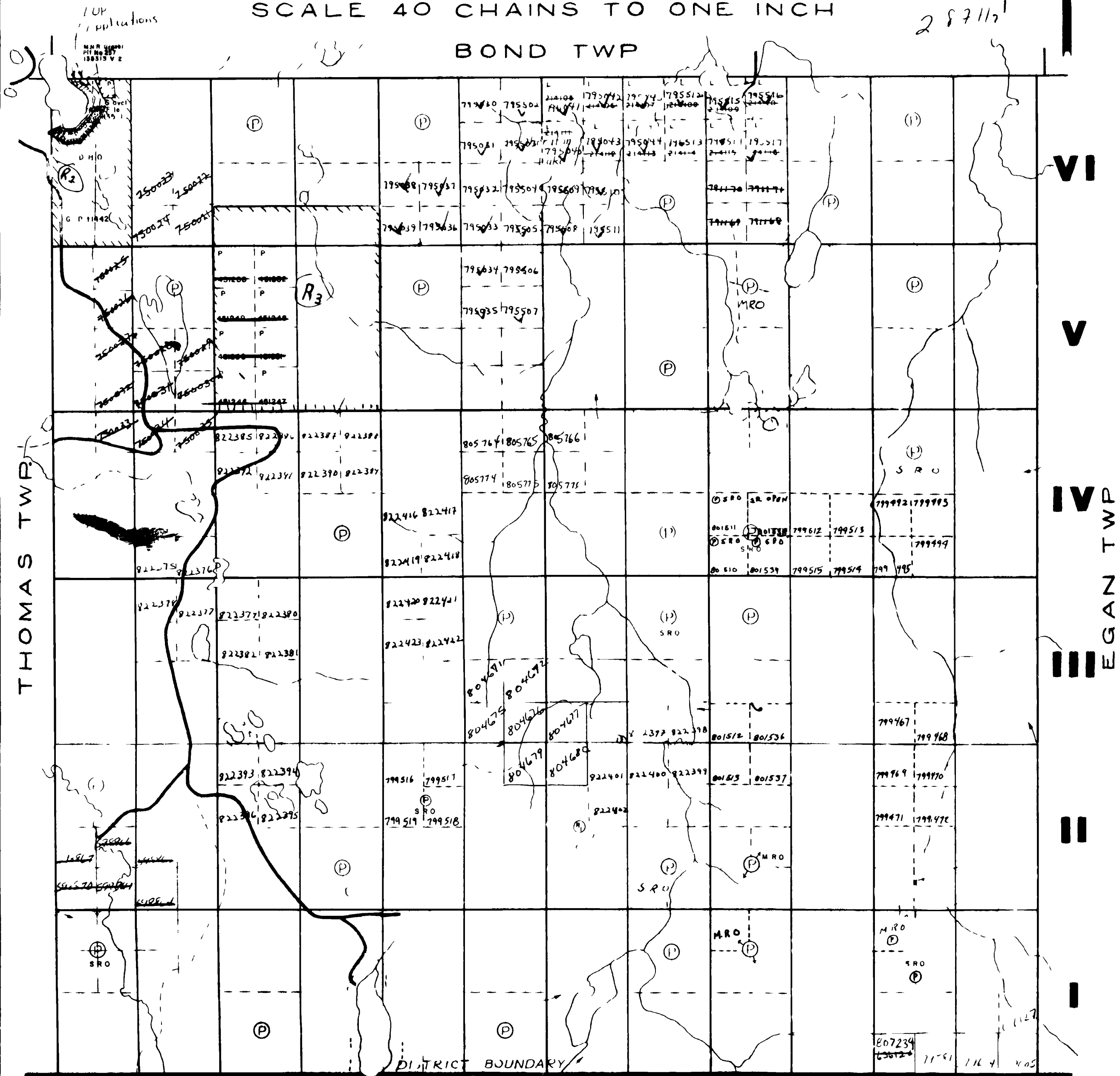
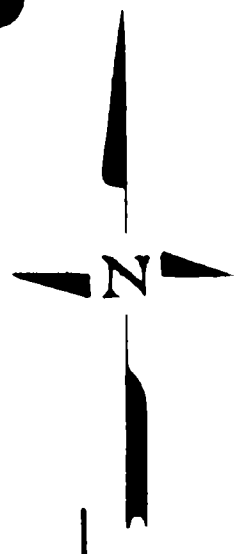

THOMAS TWP.

DISTRICT BOUNDARY

TIMMINS TWP.

VI

V

IV

EGAN TWP.



210 1004L 2R109L

LEGEND
PATENTED LANDS (P)
CROWN LAND SALES (C)

400' Surface rights reservation around all lakes and rivers
REGISTERED PLAN OF SUBDIVISION

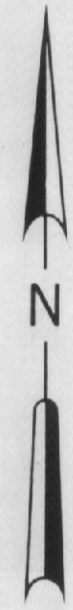

LEGEND

CONTOUR INTERVAL _____ 20 GAMMAS

500 GAMMA _____

100 GAMMA _____

20 GAMMA _____

MAGNETIC LOW _____

BASE VALUE _____ 58,000 GAMMAS

2.8711,3

F. Scott

H. FERDERBER GEOPHYSICS LTD.

BOND, SHERATON TWPS. - COCHRANE DISTRICT ONT.

SUMACH RESOURCES INC.

AIRBORNE MAGNETIC SURVEY

INTERPRETED BY: F. SCOTT	N.T.S. 42 A/7	DATE: DEC. 1985
SCALE: 1" = 1320'		PLATE 1M

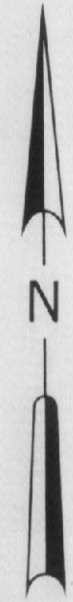
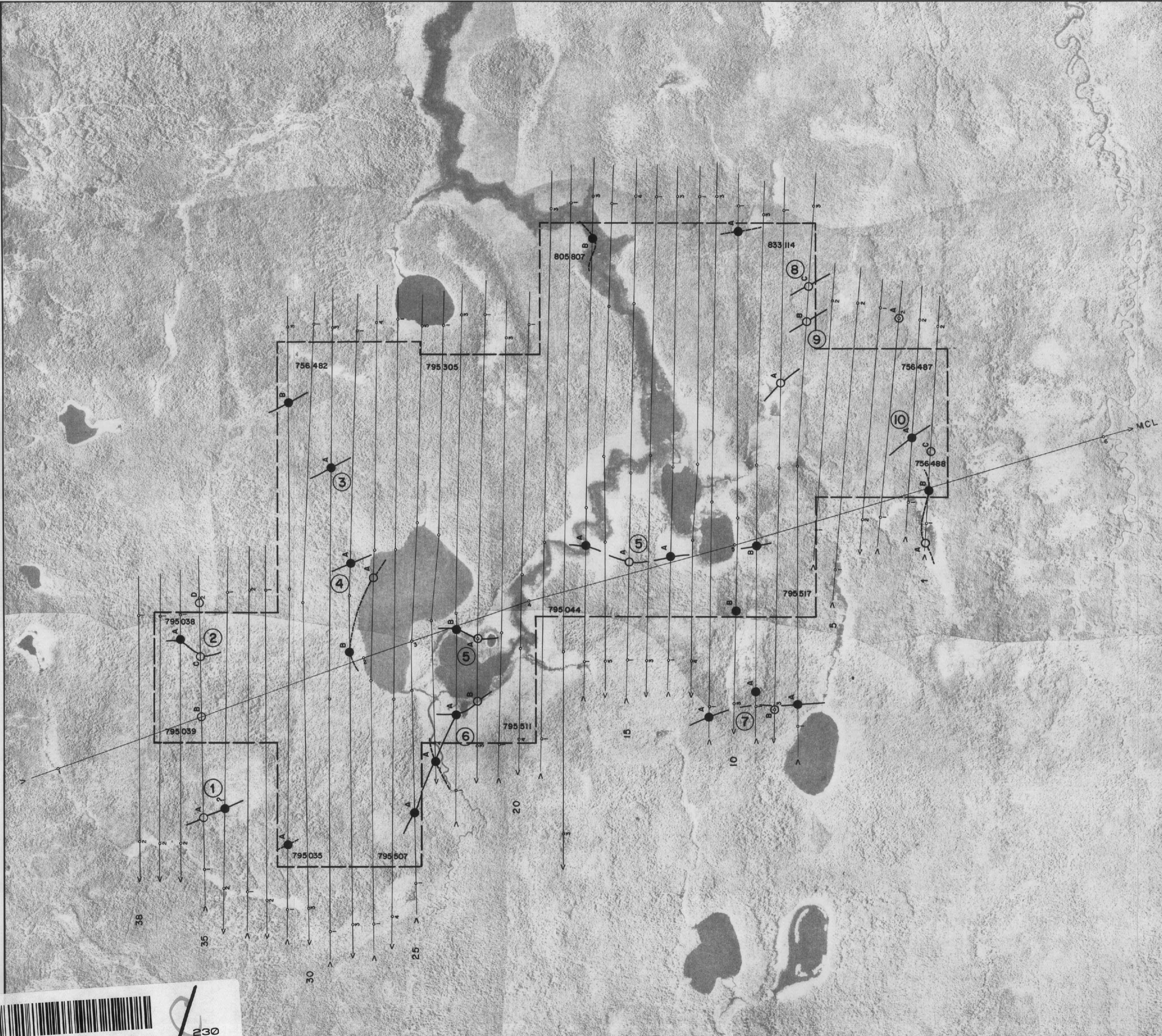

LEGEND

- CONDUCTOR AXIS
- CONDUCTOR AXIS WITH QUADRATURE FIELD

INTERPRETATION

- OVERBURDEN RESPONSE
- BEDROCK RESPONSE

2.8711,4

F. Scott

H. FERDERBER GEOPHYSICS LTD.

BOND, SHERATON TWPS. - COCHRANE DISTRICT ONT.

SUMACH RESOURCES INC.
AIRBORNE V.L.F.-EM SURVEY

INTERPRETED BY: F. SCOTT	N.T.S. 42 A/7	DATE: DEC. 1985
SCALE: 1" = 1320'		PLATE 1V

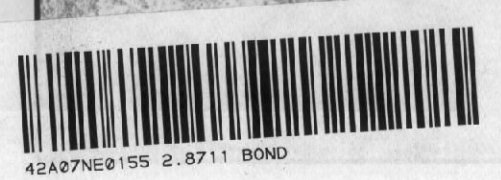

230