



42A07NE0204 63.5742 EGAN

010

SUMMARY REPORT
OF THE
**POWER STRIPPING \ WASHING \ MAPPING **
ASSAYING AND PROSPECTING
DEMARCHI EAST GROUP
AND
DEMARCHI WEST GROUP
SHERATON, EGAN AND TIMMINS TOWNSHIP
PORCUPINE AND LARDER LAKE MINING
DIVISIONS

JULY 18th, 1992

RICHARD F. KALTWASSER

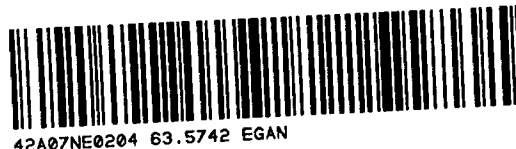

TABLE OF CONTENTS

	<u>PAGE</u>
DECLARATION	1
LETTER OF INTEREST	2
TRANSFER OF UNPATENTED CLAIMS	3
 <u>REPORT OF FIELD WORK SEASON 1992</u>	
INTRODUCTION - PROPERTY LOCATION	4
** LOCATION MAP ~ SCALE 1" = 4 MILES	5
** PROPERTY PLAN ~ SCALE 1" = 1/4 MILE	6
CLAIM LOCATION ~ EAST - WEST GROUPS	7
ACCESSIBILITY ~ TOPOGRAPHY	8
GENERAL GEOLOGY	8 - 10
** GEOLOGICAL PLAN ~ COLOURED 1:20,000	9
STRIPPING AND WASHING	10
ADDENDUM ~ STRIPPING TIMMINS TWP.	10a, b, c
GEOLOGY OF STRIPPED AREA: P-1156114	11, 13, 14
** GEOLOGY PLAN OF STRIPPED AREA	
~ SCALE 1" = 20'	12
SAMPLING AND ASSAYING	14
** PLAN ~ SAMPLE LOCATION OLD TRENCH	
~ SCALE 1" = 20'	15
** PLAN OF SAMPLE LOCATION OF STRIPPED	
AREA ~ SCALE 1: = 20'	16
SAMPLE LOCATIONS AND ASSAYS	17, 17a, 18, 18a
BIBLIOGRAPHY	19
APPENDIX I	20
APPENDIX II	21
ASSESSMENT BREAKDOWN	22

~~~~~

**MAPS AND PHOTOGRAPHS IN BACK POCKET**

- \*\*\* **GEOLOGY AND TOPOGRAPHIC PLAN**  
**DEMARCHI GROUP ~ TIMMINS, SHERATON,**  
**EGAN TOWNSHIPS, PROVINCE OF ONTARIO**  
**~SCALE 1" = 200' FEET UNCOLOURED**
- \*\*\* **DETAILED GEOLOGY OF STRIPPED AREAS**  
**~ SCALE 1" = 10' UNCOLOURED**

**Foot notes:**

- \*\* **Maps**
- \*\*\* **Maps and photographs in Back pockets**

## DECLARATION

**I Richard F. Kaltwasser of town of Matheson, Province of Ontario. Canada do state.**

- 1. I am a practising prospector, holder of Miners License No. K11569, Client No. 150541, since June 3rd, 1941.**
- 2. Studied geology by correspondence from McKinley-Roosevelt University, Chicago, Ill. U.S.A. enrollment number 940G prior to service in W.W. II.**
- 3. I was formerly with Wright-Hargreaves Mine, Kirkland Lake, Ontario in exploration. Previous to joining The Canadian John's Manville Company in 1949 and was senior fieldman, until recent closing of operations.**
- 4. That I have a 50% (percent) interest in the property.**
- 5. Dated this 13th of July 1992.**

  
**Richard F. Kaltwasser**

DAVID DEMARCHI  
BOX 1261  
SOUTH PORCUPINE, ONTARIO  
P0N 1H0

*July 6, 1992*

*To Whom It May Concern:*

*Re: Sheraton, Egan and Timmins Township Claim Group*

*Richard F. Kaltwasser and David DeMarahi both hold fifty percent (50%) interest in all the claim group in Sheraton, Egan and Timmins Township.*

*Sincerely Yours,*

*David DeMarahi*

*David DeMarahi*



# Transfer of Unpatented Mining Claim(s)

## Mining Act

Transaction No. **DOCUMENT No.**  
**19280-00061**

Personal information collected on this form is obtained under the authority of the Mining Act. This information will be used for serving notices. Question: about this collection should be directed to the Provincial Manager, Mining Lands, Ministry of Northern Development and Mines, Fourth Floor, 159 Cedar St., Sudbury, Ontario, P3E 6A5, telephone (705) 670-7264

I, DAVID E. DEMARCHI (client number CLN 125156) the recorded holder of 100 % interest, in consideration of \$ 100 dollars or other valuable consideration paid to me, hereby transfer 50% % interest in (Dist. #12) mining claim(s) numbered: L-1156116 - L-1156117 EGAN TWP.

(claim numbers must be listed separately; attach schedule if required)  
in TIMMINS, SHERATON, EGAN (specify township or area) to RICHARD F. KALTWASSER as transferee

|                                                              |                                                     |
|--------------------------------------------------------------|-----------------------------------------------------|
| Transferee's Address<br><u>BOX 34, MATHESON ONT. POKINGO</u> | Transferee's Telephone No.<br><u>(705) 273-2733</u> |
|                                                              | Transferee's Client Number<br><u>CLN 150541</u>     |

Dated at TIMMINS this 24<sup>th</sup> day of June 1992

|                                                   |                                                     |
|---------------------------------------------------|-----------------------------------------------------|
| Signature of Witness<br><u>Therese R. Binkley</u> | Signature of Transferor<br><u>David E. Demarchi</u> |
|---------------------------------------------------|-----------------------------------------------------|

Note: 1. The transfer must not be dated and executed before the date of recording of the mining claim.  
2. If the transferee is not a resident of Ontario, show here the name of the person who is a resident of Ontario upon whom service may be made.

|                            |           |
|----------------------------|-----------|
| Name                       | Telephone |
| Residence in Ontario       | ( )       |
| Mailing Address in Ontario |           |

### Affidavit of Subscribing Witness

I, T. BINKLEY, of the CITY of TIMMINS in the DISTRICT of COCHRANE make oath and say (or affirm):

- I was personally present and did see the attached instrument signed and executed by DAVID E. DEMARCHI one of the parties of the instrument.
- The attached instrument was executed at TIMMINS.
- I know the above-mentioned party.
- I am a subscribing witness to the attached instrument.

Sworn (or affirmed) before me at TIMMINS in the CITY of TIMMINS this 24<sup>th</sup> day of JUNE 1992.

|                                                   |                                                            |
|---------------------------------------------------|------------------------------------------------------------|
| Signature of Witness<br><u>Therese R. Binkley</u> | Commissioner/Notary Public<br><u>Louise Jeanne Monette</u> |
|---------------------------------------------------|------------------------------------------------------------|

Note: 1. The subscribing witness must be a person other than the transferee.  
2. The commissioner or notary public must be a person other than the transferee.  
3. The signature and affidavit of a subscribing witness is not required if the transferor is a corporation and the corporate seal is affixed over the signature of an officer of the corporation on the transfer document.

**LOUISE JEANNE MONETTE,**  
a Commissioner for taking affidavits in Northern Ontario while employed by the Ministry of Northern Development and Mines.

For Office Use Only

RECEIVED  
LARDER LAKE  
MINING DIVISION

JUL 8 1992

CHECK 20.00

TIME 10:21 AM

## **REPORT OF WORK FOR ASSESSMENT FOR FIELD SEASON 1992**

### **INTRODUCTION**

The following report describes the work program for the eleven (11) contiguous mining claims recorded in the name of David DeMarchi (Recorded holder), Located in Sheraton, Egan and Timmins Townships in the Porcupine and Larder Lake Mining Divisions.

An old known blasted trench in the north east corner of what is now claim P-1156114 was sampled in fall of 1990; across widths of 18" inches in a quartz fracture zone. Assays gave values of 0.149 to 3.22 oz. gold per ton.

It was impossible to trace the zone along west side of ridge due to overburden and sparse outcrops. A decision was made to apply for an OPAP Grant to help offset the cost of stripping. Grant number is 90-006, file number is OP92-013 was received in late May of 1992.

A work permit from Ministry of Natural Resources for Mechanical stripping was granted on 11th day of June 1992 and continued, until 31st of July 1992. Permit No. 527/92.

Data and Compilation of this report is the responsibility of the writer who holds an interest in the property. See attached letter.

### **PROPERTY AND LOCATION**

The property is comprised of (11) eleven unpatented contiguous mining claims situated in the Townships of Egan, Sheraton and Timmins for a total of approximately 440 acres.

For assessment purposes the claim block has been divided into two groups. The DeMarchi East Group consists of four (4) claims numbered P-1156114 - 115 situated in the north east quarter and the south east quarter, south half of Lot 1 Con 1. Sheraton Township. Claims L-1156116 - 117 are situated in the north west quarter and the south west quarter, south half of Lot 12 Con1. Egan Township. The dates of staking was July and August 1990; the assessment anniversary date is August 9th 1992.

The DeMarchi West Group consists of (7) seven unpatented mining claims adjoining the east group to the west. Six are in Sheraton Township in the south half of Lots 1 and 2 Con. 1. and One claim is in unsurveyed Timmins Township, along the north boundary adjoining patented claim 34453. The the work is still on going in this group.

Location Map of  
 Claim Group in  
 Egan - Sheraton - Timmins  
 Townships  
 Province of Ontario  
 Scale 1" inch = 4 miles

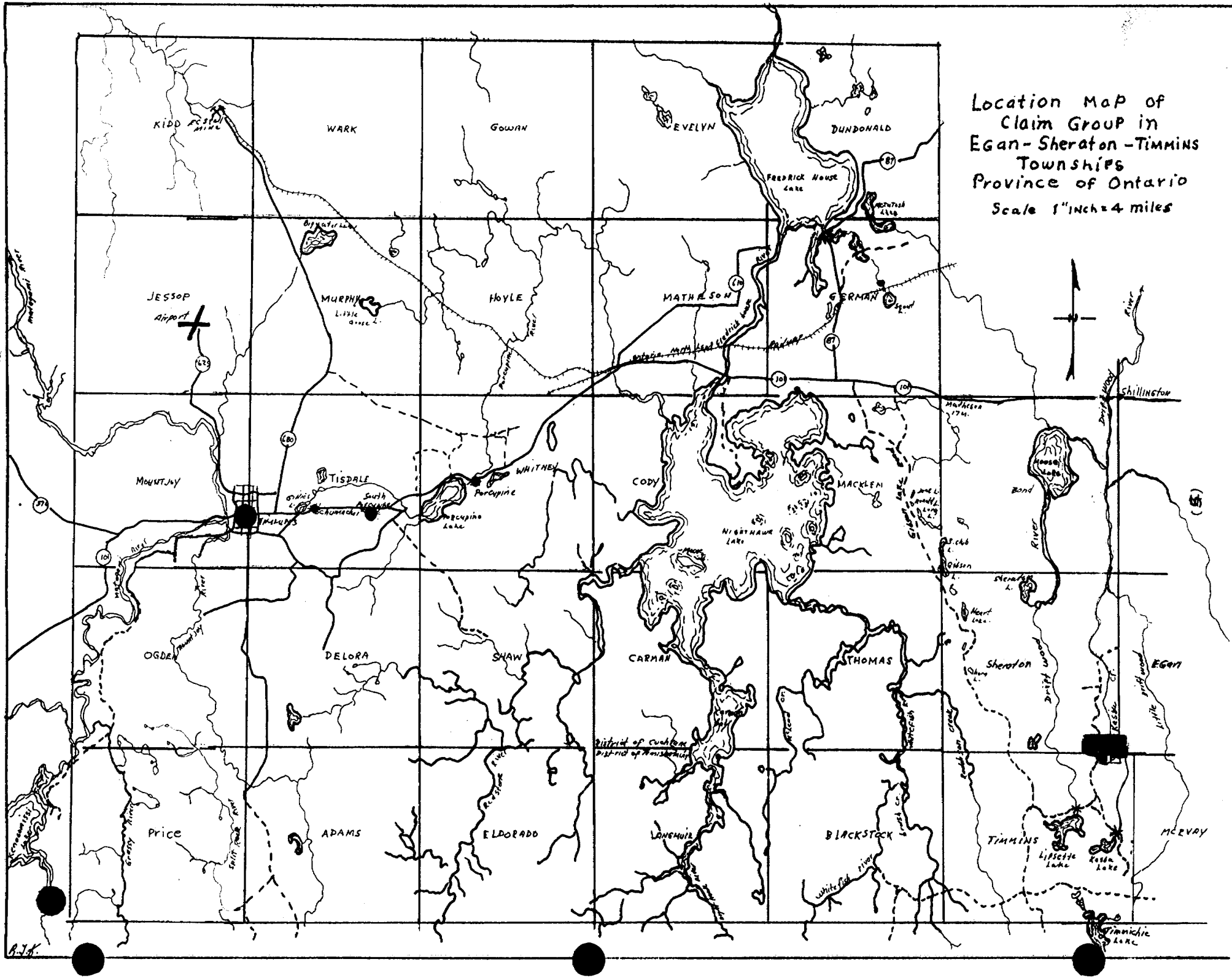

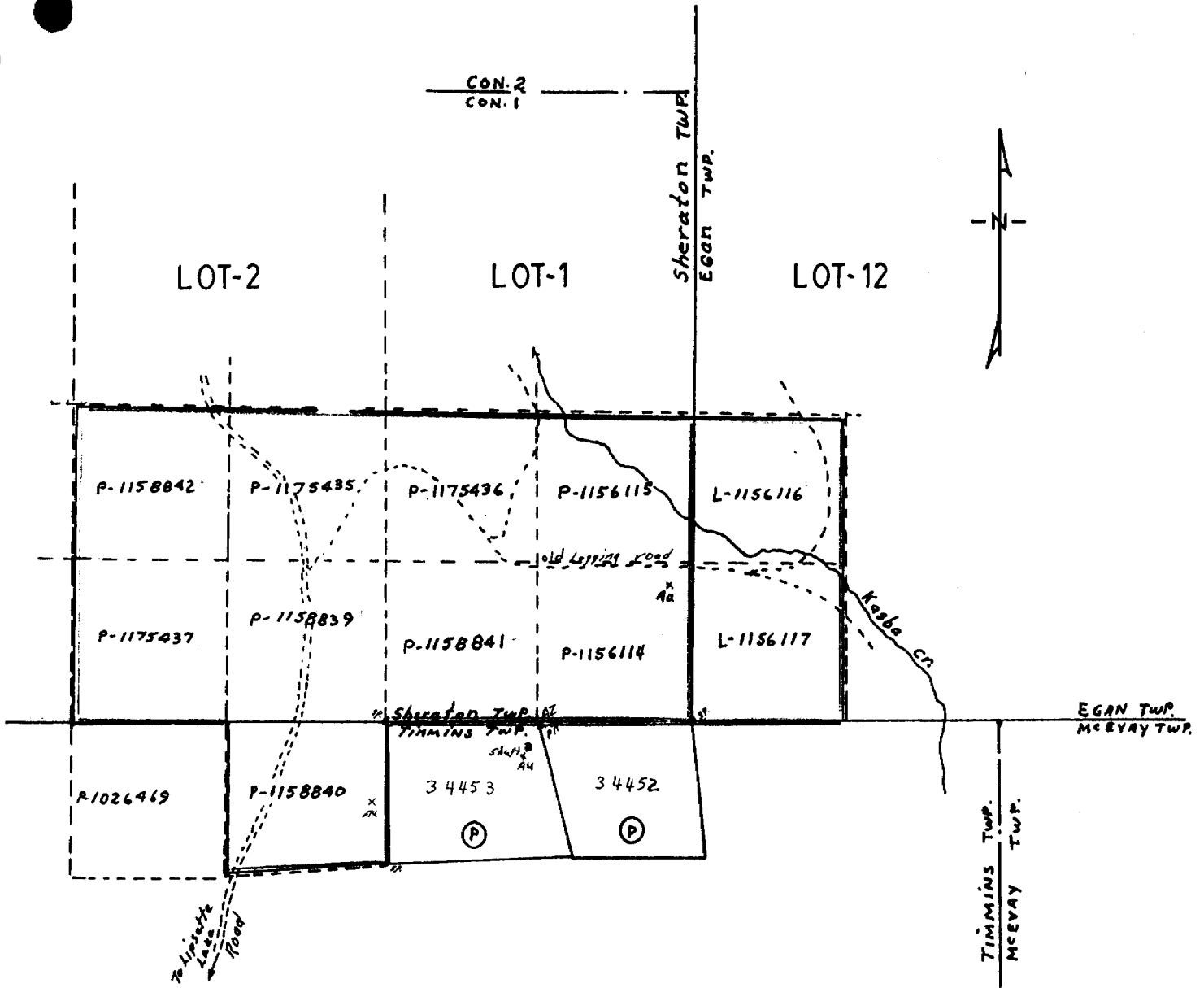

**PROPERTY PLAN**

Showing Claim Group  
 Egan - Sheraton - Timmins Twps.  
 Province of Ontario  
 Scale 1" = 1/4 Mi (1320')



## CLAIM LOCATIONS

### EAST GROUP (4CL)

| <u>CLAIM NO.</u> | <u>TOWNSHIP</u> | <u>LOCATION</u>                    | <u>STAKED</u> | <u>RECORDED</u> |
|------------------|-----------------|------------------------------------|---------------|-----------------|
| P-1156114        | Sheraton        | S.E. 1/4 S. 1/2<br>Lot 1, Con. 1   | July- Aug     | Aug 9, 1990     |
| P-1156115        | Sheraton        | N.E. 1/4 S. 1/2<br>Lot 1, Con. 1   |               | Aug 9, 1990     |
| L-1156116        | Egan            | N. W. 1/4 S. 1/2<br>Lot 12, Con. 1 |               | Aug 9, 1990     |
| L-1156117        | Egan            | S.W. 1/4 S. 1/2<br>Lot 12, Con. 1  |               | Aug 9, 1990     |

2 Claims in Egan Township are in Larder Lake Mining Division.  
2 Claims in Sheraton Township are in Porcupine Mining Division. All are contiguous claims.

### WEST GROUP (7 CL)

|           |          |                                  |  |            |
|-----------|----------|----------------------------------|--|------------|
| P-1158839 | Sheraton | S.E. 1/4 s. 1/2<br>Lot 2, Con.1  |  |            |
| P-1158840 | Timmins  | Unsurveyed                       |  | Dec. 31/92 |
| P-1158841 | Sheraton | S.W. 1/4 S. 1/2<br>Lot 1, Con.1  |  |            |
| P-1158842 | Sheraton | N.W 1/4 S. 1/2<br>Lot 2, Con. 1  |  |            |
| P-1175435 | Sheraton | N.E. 1/4 S.1/2<br>Lot 2, Con. 1  |  | Feb. 27/93 |
| P-1175436 | Sheraton | N.W. 1/4 S. 1/2<br>Lot 1, Con. 1 |  |            |
| P-1175437 | Sheraton | S.W. 1/4 S. 1/2<br>Lot 2, Con. 1 |  |            |

The recording dates of these seven (7) claims are as follows:

3- claims were staked on December 27th, 1990 and recorded December 31st, 1990.

4- claims were staked on February 12th, 1991 and recorded February 27th, 1991.

### **ACCESSIBILITY**

Access to the property is by a gravel road (Gibson Lake), which branches off to the south from highway 101 west approximately 19 miles west of Matheson. This road leads to Lipsette Lake a distance of 18 miles south from the highway. The property is approximately four miles north of Lipsette Lake and is reached by a sand road crossing the property.

The eastern portion of the claim group is accessible by an old over grown logging trail, which branches off the sand road eastward for approximately one mile to the stripped showing area on claim P - 1156114.

### **TOPOGRAPHY**

Generally the western portion of the claims form several north westerly trending sand and outcrop ridges broken by narrow swampy sections.

The central portion is mainly low and swampy, clay covered with a gradual rise eastward in elevation to approximately 30 to 50 feet above Kasba Creek. Soil is more of a sandy loam.

Western portion is covered mainly by jack pine, spruce and poplar, while swampy areas are mainly black spruce, balsam, cedar and alders.

Most of the area has been timbered, a few stands of Commercial forest are found on higher ground along the north boundary of Timmins - Sheraton Township Line.

Drainage throughout the property is poor with narrow run off streams flowing north into Kasba Creek.

### **GENERAL GEOLOGY**

#### **Volcanics: 2-2a-2a-1-2f.**







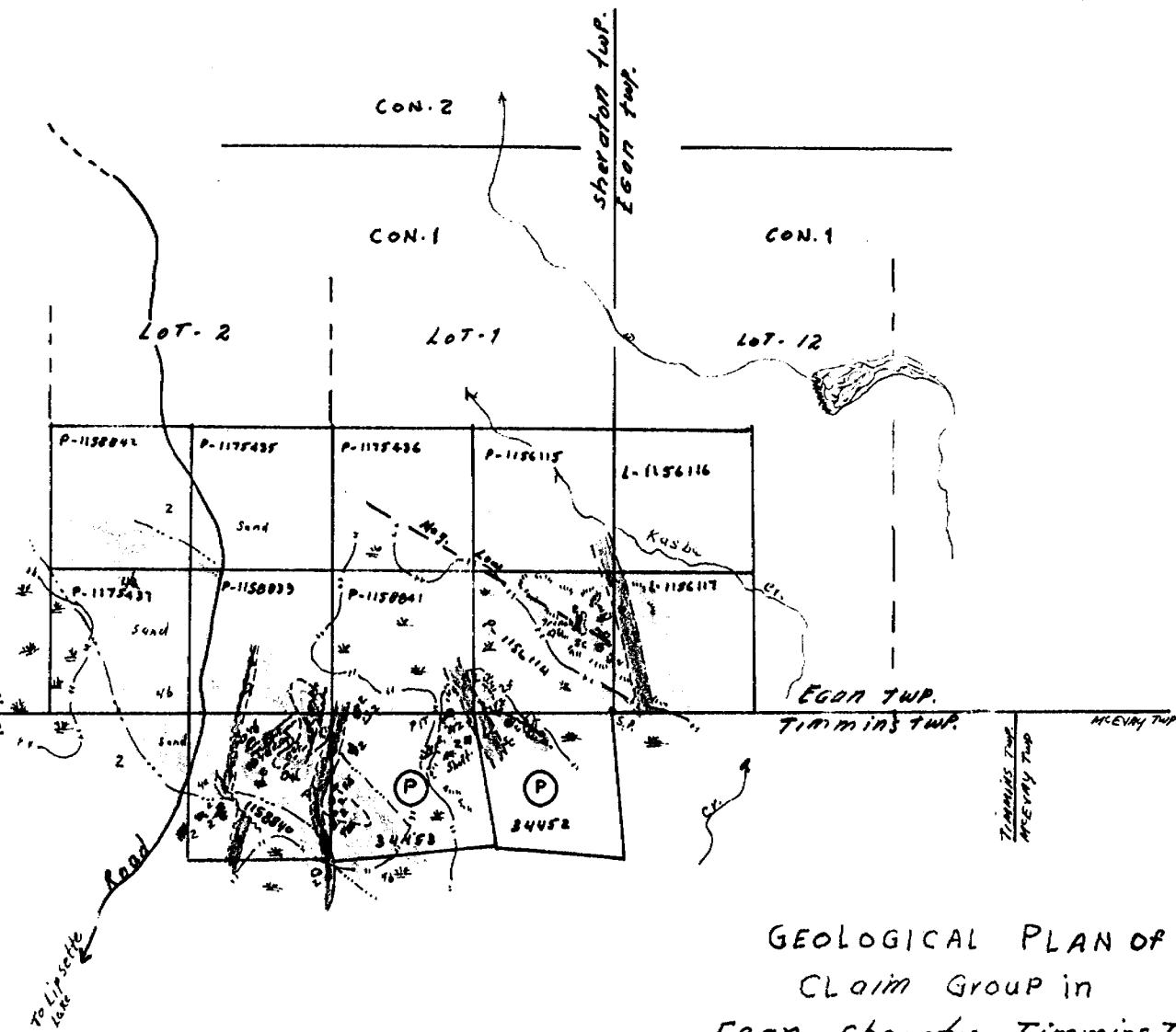
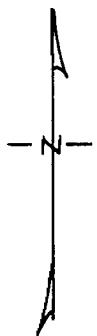

The intermediate to basic meta-volcanic, andesite and basalts strike generally north 30° west with dips of 70° - 75° to the southwest. Pronounced drag folding and shearing was observed in all outcrops of Volcanics. Rocks has been altered to chlorite and talc carbonate schists.  
3-3d intermediate Volcanics.

#### **Gabbro: 4a-4b-4c-4d**

Several outcrops of a gabbroic intrusive have been mapped. They have a rusty mottled appearance on the weathered surface, when broken into they are dark green to black, coarse grained



Legend

-  quartz diabase, diabase
-  Feldspar Porphyry
-  diorite, Gabbro etc
-  intermediate Volcanics, Tale-chlorite schist etc
-  Swamp
-  Contact
-  outcrop
-  Trench - shaft

GEOLOGICAL PLAN OF  
CLAIM GROUP in  
Egan, Sheraton, Timmins Twp.  
Prov. of Ontario  
Scale 1:20,000

with radiating hornblende crystals.

**Gabbro: continued**

The gabbroic rocks are composed of plagioclase feldspar, hornblende, magnetite, pyrite on fracture faces and disseminated sparsely throughout. Minor chalcopyrite was also noted, with occasionally blue quartz "eyes".

These rocks have been outlined by both aerial and ground surveys striking northwest conforming to the regional geology.

**Feldspar and Quartz Porphyries: 5b-5c**

Feldspar and quartz porphyries as narrow dikes intrude the meta-volcanics and gabbroic rocks. They are cut by quartz fractures often filled with fine cubic pyrite, sheared and oxidized. Along east boundary of claim P-1158840 occurs a oxidized zone with gold and silver values.

**Diabase: 6**

Matachewan Diabase dikes ranging up to 100' or more in width occur on the claim group, forming north south ridges in Egan - Sheraton Townships. Contacts with the meta-volcanic and gabbroic intrusive are sharp with minor pyrite locally along contacts.

A few minor shear zones and faults displace the dikes. Most of the dikes have intruded along old faults throughout the area.

**STRIPPING AND WASHING**

The stripping area is located in Sheraton Township on claim P-11564114, along the south side of ridge. The actual location is 400' feet south of the number one (1) post and 60 feet west of the Sheraton - Egan township boundary. The area was stripped from the picket line 82 feet west of the township line and 8+60' to 10+30' feet north. The total length is 170 feet and average width is 45' feet. The average depth of the overburden removed was from one to six feet from the crest to base of ridge. The overburden was spread over the swampy area and not left in piles. ( See attached photographs of stripped area). The program was under the direction of Richard F. Kaltwasser and assisted by David DeMarchi.

The contract was let Larchex Inc. Mining Exploration of Timmins, Ontario. Mailing address: 74 Robin Avenue, Box 1394, Timmins, Ontario P4N 7N2.

## **ADDENDUM**

### **STRIPPING ~ TRENCHING TIMMINS TOWNSHIP:**

Stripping of the gold showing on claim P-1158840 Timmins Township was completed on June 26th, 1992 by Agi Nissan, 62 Kent Avenue, Timmins, Ontario, using the 690B Excavator and is part of the cost breakdown ( included in invoice number 082 Larchex Inc. )

Property is currently being cleaned by hand, no water is available for washing. Mapping will be on a scale of 1" = 10' ( feet ), data will accompany assessment report for 7 ( seven) contiguous claims, known as ( DeMarchi West Group ), which is part of the 11 ( eleven ) claim block in Sheraton , Egan and Timmins Townships. The anniversary dates are December 1992 and February 1993.

## ADDENDUM

### STRIPPING ~ TRENCHING TIMMINS TOWNSHIP: continued.

#### **Trench:**

##### No. 1

**Location: along east boundary of claim P-1158840 in Timmins Township. 7+20' ( feet ) south of the No. 1 post. Dimension of stripping 60' x 40' x 5' ( feet ).**

**A grab sample of quartz and pyrite along the contact of talc chlorite schist and quartz feldspar porphyry gave low gold value of .023 oz. /T.**

**Stripping of the zone proved the vein was a small quartz lens within a fault contact and not traceable for any distance.**

**The outcrop is mainly of talc chlorite schists, sheared and folded cut by and east west quartz feldspar porphyry dike with narrow barren quartz veins up to 4" ( inches ) in width cutting, the dike in a northerly direction and terminating at the schist contact. Two grab samples taken.**

**A north trending quartz diabase dike along the west side of the trench cuts, the quartz feldspar porphyry and the schists.**

##### No. 2

**Location: 6 + 20' ( feet ) south of No. 1 post claim P-1158840 and 0 + 63' ( feet ) west to trench dimensions 30' x 8' x 1' ( feet ) exposing the quartz diabase dike cutting gabbro.**

**Geology and stripping area shown on a map 1" = 10' ( feet ).**

##### No. 3

**Location: 3 + 40' ( feet ) south of No. 1 post claim P-1158840 and 2 + 51' ( feet ) west to the stripped area. Dimension is 45' x 50' x 2' ( feet ).**

**The exposure is mainly a coarse grained massive gabbro with magnetite and pyrite. A sheared folded chloritic schists cuts the gabbro in a north westerly direction. A light gray felsic dike with north trending quartz fractures occasionally mineralize with pyrite and chalcopyrite. Striking north 40° east cuts, the gabbro and schist complex. Jointing within the felsic dike north 20° east, dipping 55° northwest. See detailed map scale 1" = 10' ( feet ).**

**TRENCH: continued**

**No.4**

**Location: 4 + 63' ( feet ) west of No. 1 post claim P-1158840 along the Timmins ~ Sheraton Township Line and 2 + 00' ( feet ) south to trench. Dimensions 75' x 15' x 5' ( feet ) mapped on a scale 1" = 10' ( feet ).**

**The north part of the trench is a sheared rusty talc chlorite schist with white quartz 4" ( inch ) veins and coarse pyrite. Veins appear as lenses within the fault zone striking north 70° east dips at 90°. A north south shear within the Chlorite schists strikes north 50° east and dips 75° northwest and appears to terminate at the fault. Two grab samples were taken.**

**The southern half of the trench is a coarse massive gabbro with magnetite and bluish quartz eyes. A previous sample was taken from this area assayed for PT-PD gave value < 10. The gold assay of the quartz vein gave a trace of .004 oz. / T.**

**Equipment:**

**1 - 690 B Excavator**

**1 - S1 Muskeg Backhoe**

**1 - Wajax Pump with 600 feet of hose**

**1 - Chain Saw**

**Operators:**

**Aagi Nissan - operator of excavator - Timmins, Ontario**

**Dave Larche - muskeg Backhoe operator - Timmins, Ontario**

**Jack Roberts - Pumpman Washing - Timmins, Ontario**

**Float Mobilization and Demobilization:**

**Monday, Thursday and Friday**

**(See attached invoice #082 from Larchex Inc).**

**Washing:**

**Washing was done by a wajax pump operated by Jack Robert for a total two days including traveling time. David DeMarchi assisted in the washing and clean up of the stripped area.**

**GEOLOGY OF STRIPPED AREA: CLAIM P-1156114 SHERATON TOWNSHIP**

**2a-2a1: Volcanics east of the stripped area along the township line are basic basaltic flows. Fine grained, massive, dark black in appearance with minor disseminated pyrite and magnetite, weathering to a dark brown surface.**

**The andesites are medium to fine grained, rusty fractures of quartz with fine pyrite. Weathered surface is a light brown to buff on the fresh surface the rocks are dark green and are offset by cross faults in a block fashion, in contact with quartz fracture zone.**

**2e: A host of one to two inch cherty dikes appear in the west central portion of the stripped area. Striking near east west; dipping north at 60 and terminate along the contact of the diabase dike. The weathered surface is light gray and the fresh rock is a darker gray.**

**2f: Chlorite schist appear west of the diabase are dark**



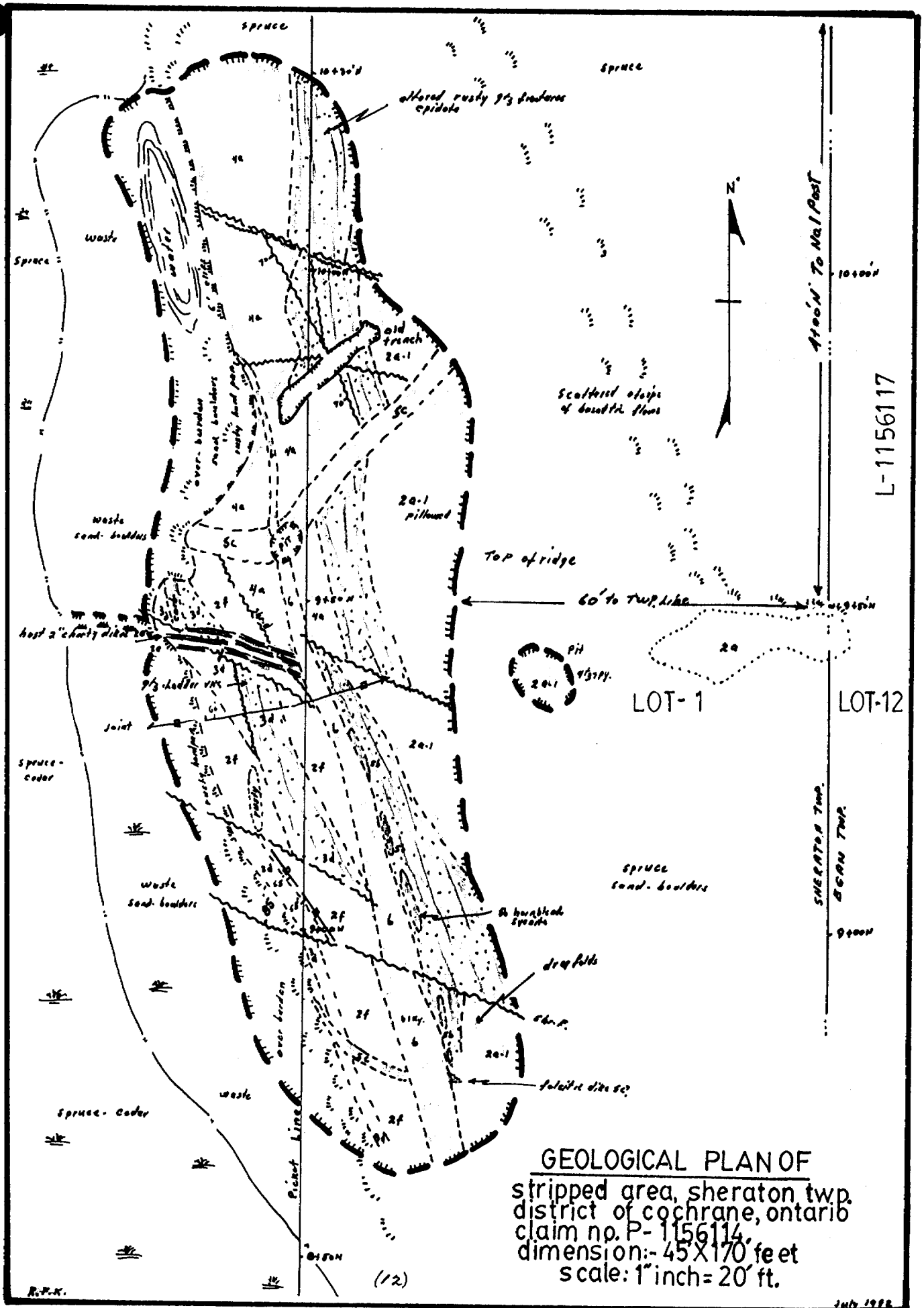

**GEOLOGICAL PLAN OF**  
 stripped area, sheraton twp.  
 district of cochrane, ontario  
 claim no. P- 1156114  
 dimension:- 45 X 170 feet  
 scale: 1" inch = 20' ft.

L-1156117

green, crenulated drag folds, moderately carbonated and block faulted. The weathered surface is medium green.

**3:** Striking north along the contact of the diabase and andesites is a siliceous quartz fracture zone, dipping  $70^{\circ}$  -  $75^{\circ}$  west south west. Rusty quartz veins, fractures with carbonate material and coarse pyrite is found along the outer walls of the veins. The surface weathers to a rusty appearance. This zone is sheared, blocked faulted; traced for a length of 165 feet, width from 5 to 10 feet in the stripped area and open at both ends.

**3d:** A white to light grey tuff horizon with rusty quartz fractures and narrow quartz veins with cubic pyrite occur within the tuff horizon. Small fragments appear as ash in the felsic ground mass? The weathering is a light grey to white.

**4a:** A wedge of medium coarse grain diorite appears to the west of fracture zone in contact with andesites. Rusty fracture fillings in the diorite carry low gold values. They may be a coarse phase of andesites?

**5b:** Hornblende syenite appear as elongated pods intruding the siliceous quartz fracture zone near the east side diabase contact.

**5c:** Narrow feldspar porphyry dikes cut the volcanic suite from west to east and dip at  $80^{\circ}$  north north west. Weathering is a light grey and medium grained. Fine pyrite quartz fractures in the porphyries often carry low gold values.

**6:** A north trending narrow fine grained diabase dike in contact with siliceous quartz fracture zone cuts through the volcanic and porphyry dikes and dips  $70^{\circ}$  west.

#### Carb:

Narrow rusty carbonate zones are found along the shears in the west central portion of the stripped area and appear as small lenses in the chlorite schists.

#### Quartz Vines:

Quartz vines occur as narrow parallel rusty stringers and fractures, with coarse cubic pyrite along the outer edges of the vines. The strikes are generally north south and dipping west at  $70^{\circ}$  -  $80^{\circ}$ . They occur within andesites and schists horizons.

#### Faulting and Shearing:

Steeply narrow shear zones strike north northwest cutting across the formation and dip from  $85^{\circ}$  northeast to vertical.

### **Faulting and Shearing: continued**

Cross faults cut the formation at near right angles and dip generally from 70° southwest to vertical and appear to terminate at the contact of the diabase, with an exception of a shear fault in the south part of the stripped area. Which offset the diabase for several feet from east to west dip is 85° northeast.

### **Jointing:**

One set of joints strike easterly and dip 60° north; another set of joints strike 35° to 40° northwest and dips 65° southwest forming a trapezoid pattern. (See attached geological plan in back pocket. Scale 1:10 feet, uncoloured. A geological map of stripping on scale 1:20 feet, coloured, accompanies this report.

## **SAMPLING AND ASSAYING**

Sampling of the showing in the stripped area on claim P-1156114, Sheraton Township was conducted by Richard F. Kaltwasser, David DeMarchi and assisted by Dennis DeMarchi both reside in South Porcupine.

A total of 23 chip samples and three grab samples were taken at intervals along the exposed strike length of showing, tied into a north south picket line and locations plotted, numbered from 1 to 26 shown on plan of sampling at 1" (inch) = 20' (feet) to accompany this report. Cost invoices also attached .

## **MAPPING:**

A geological map of property on scale 1: 200 feet was drafted by the writer. Part of this map is taken from previous mapping by the writer for another company ( see assessment file T-1856).

Showing geology and location of four (4) claims in Egan and Sheraton Townships for assessment.

Detailed map of the stripped area is on scale 1: 10 feet uncoloured . Mapping was done by the writer Richard F. Kaltwasser and reduced to 1: 20 feet coloured; also a plan of 1:20 feet showing sample locations of the stripped area. Declination is 11° 38' minutes west, magnetic north all mapping is based on astronomic north.

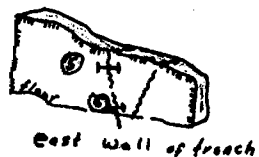
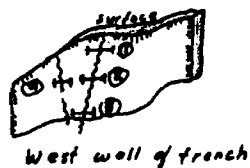

| Gold Assays |          |      |        |                           |
|-------------|----------|------|--------|---------------------------|
| #           | Book No. | chip | oz./t. | Location                  |
| ①           | 3453     | 24"  | 0.384  | west wall of trench       |
| ②           | 3454     | 24"  | 0.138  | west wall of trench       |
| ③           | 3455     | 24"  | 0.070  | west wall of trench       |
| ④           | 3458     | 24"  | 0.052  | west wall, 15" south edge |
| ⑤           | 3456     | 24"  | 0.270  | East wall                 |
| ⑥           | 3457     | 12"  | 0.624  | East wall near floor      |
| ⑦           | 3459     | 6rob | 0.476  | 0'30" east of trench      |
| ⑧           | 3460     | 24"  | 0.280  | 0'06" east of trench      |
| ⑨           |          | 6rob | 0.430  | 0'15" west of trench      |

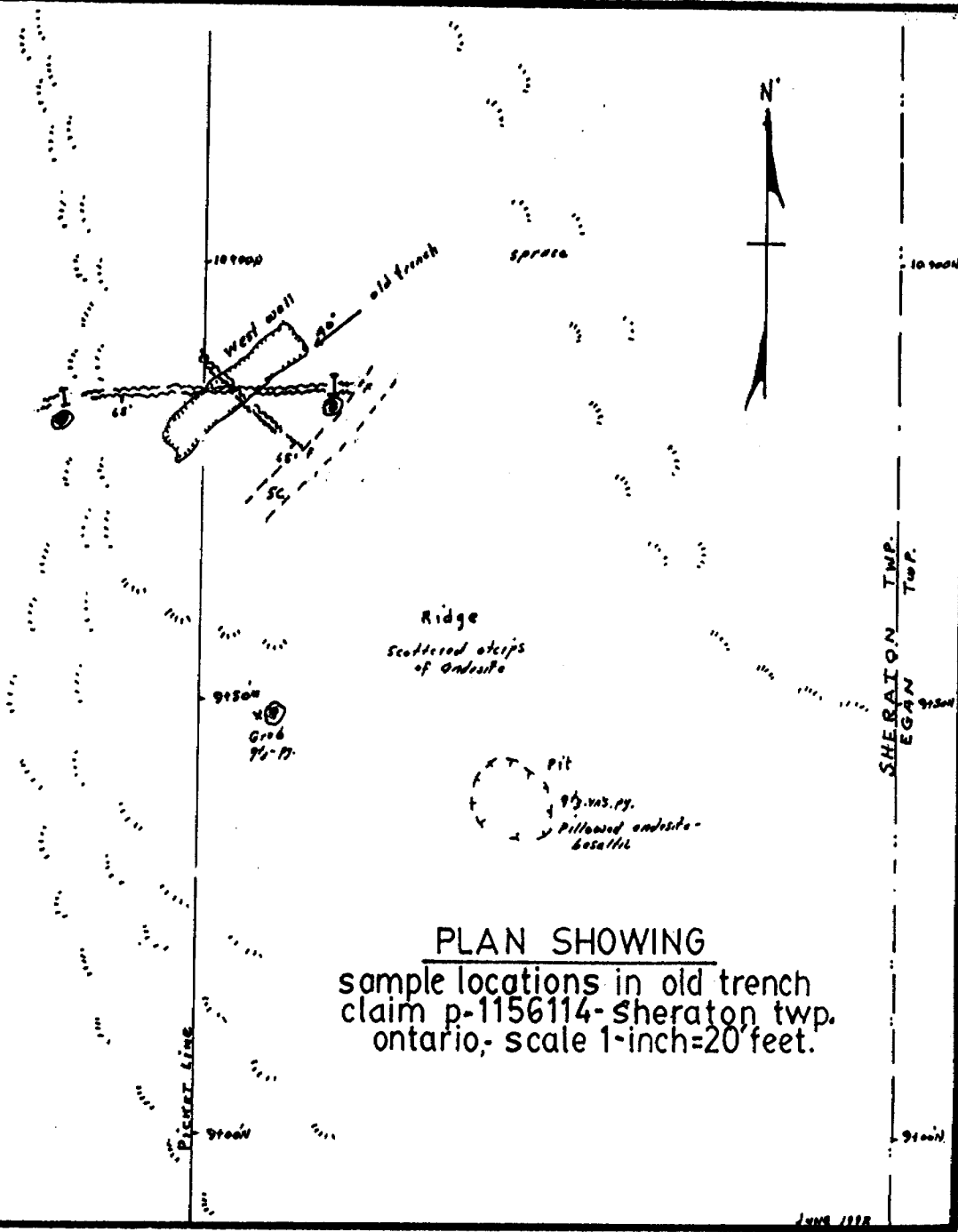

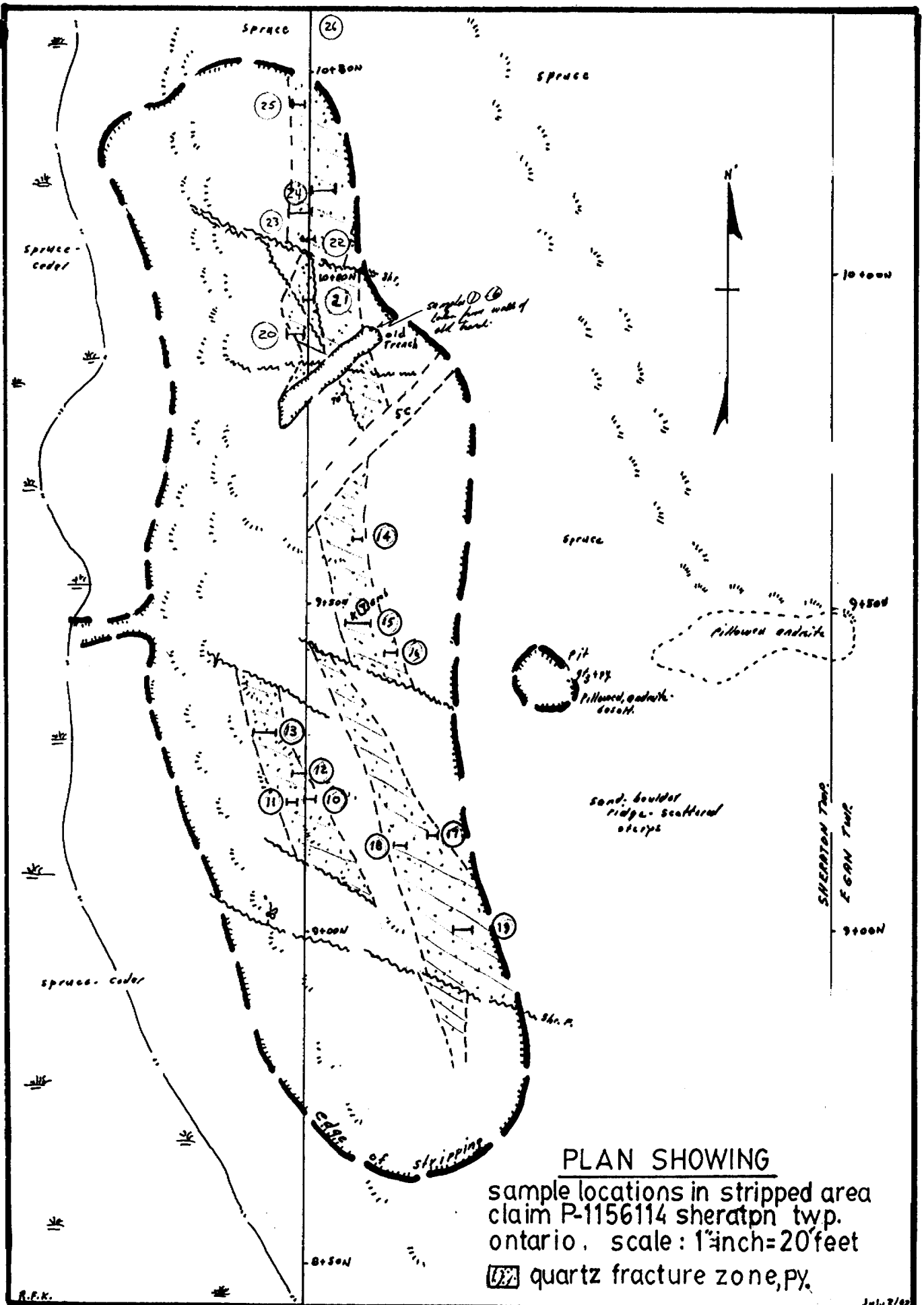

**PLAN SHOWING**  
 sample locations in stripped area  
 claim P-1156114 sheratpn twp.  
 ontario. scale: 1 inch = 20 feet  
 [hatched box] quartz fracture zone, py.

## SAMPLE LOCATIONS

| Map No.                      | Book Sample Series X1X | Chip Sample Inches | Location - Sheraton Twp. (CL- 1156114)                                                                                                        | Gold oz./per Ton |
|------------------------------|------------------------|--------------------|-----------------------------------------------------------------------------------------------------------------------------------------------|------------------|
| (1)                          | 3453                   | 24                 | old trench west wall, fracture zone pyrite                                                                                                    | 0.384            |
| (2)                          | 3454                   | 24                 | old trench west wall fracture zone pyrite                                                                                                     | 0.138            |
| (3)                          | 3455                   | 24                 | old trench west wall fracture zone at floor                                                                                                   | 0.070            |
| (4)                          | 3458                   | 24                 | 15" south of No. 2 sample (3454) west wall                                                                                                    | 0.052            |
| (5)                          | 3456                   | 24                 | old trench east wall, quartz fracture zone pyrite                                                                                             | 0.270            |
| (6)                          | 3457                   | 12                 | east wall at floor of trench                                                                                                                  | 0.624            |
| (7)                          | 3459                   | grab               | 0 + 30 feet south east of trench                                                                                                              | 0.476            |
| (8)                          | 3460                   | 24                 | 0 + 08 feet east of trench on surface near porphyry dike                                                                                      | 0.280            |
| (9)                          | ---                    | grab               | 0 + 15 feet west of old trench (assayed at Placer Dome) all samples (1-9) incl. taken June 22, 1992. Sent to Swastika Lab for fire assays (1) | 0.384            |
| <b>Sampled June 30, 1992</b> |                        |                    |                                                                                                                                               |                  |
| <b>F. Series</b>             |                        |                    |                                                                                                                                               |                  |
| (10)                         | 13851                  | 18                 | 9+20 feet north on picket line<br>stripped area                                                                                               | 0.178            |
| (11)                         | 13852                  | 20                 | @ 9+20 feet north on picket line<br>0+01 foot west of sample No. 10                                                                           | 0.062            |
| (12)                         | 13853                  | 22                 | 9+24 feet north on picket line                                                                                                                | 0.204            |

|      |       |      |                                                                                                             |       |
|------|-------|------|-------------------------------------------------------------------------------------------------------------|-------|
| (13) | 13854 | 48   | 9+30 feet north on picket line<br>0+05 feet west of picket line                                             | 0.668 |
| (14) | 13855 | 12   | Sampled July 1, 1992<br>9+60 feet north on picket line<br>0+07 feet east of picket line                     | 0.078 |
| (15) | 13856 | 48   | 9+47 feet north on picket<br>line 0+06 feet east                                                            | 0.192 |
| (16) | 13857 | 18   | 9+43 feet north to 0+12 feet<br>east of picket line                                                         | 0.046 |
| (17) | 13858 | 18   | 9+15 feet north on picket line<br>0+19 feet east                                                            | 0.062 |
| (18) | 13859 | 24   | 9+14 feet north - 0+16 feet<br>east of picket line                                                          | 0.192 |
| (19) | 13860 | 36   | 9+00 feet north - 0+23 feet<br>east of picket line                                                          | 0.020 |
| (20) | 13861 | 48   | Sampled July 5, 1992<br>9+92 feet north on picket line -<br>0+01 feet west of line (north of old<br>trench) | 0.214 |
| (21) | 13862 | 24   | 9+98 feet north of picket line                                                                              | 0.240 |
| (22) | 13863 | 18   | 10+08 feet north of picket line                                                                             | 0.094 |
| (23) | 13864 | 36   | 10+10 feet north on picket line<br>west of line                                                             | 0.124 |
| (24) | 13865 | 36   | 10+14 feet north on picket line<br>east side of line                                                        | 0.046 |
| (25) | 13866 | 20   | 10+28 feet north on picket line<br>- 0+03 feet west of line                                                 | 0.440 |
| (26) | 13867 | grab | 10+81 feet north on picket line<br>0+15 feet east rusty quartz<br>fractured                                 | 0.022 |



Established 1928

# Swastika Laboratories

A Division of Assayers Corporation Ltd.

Assaying - Consulting - Representation

## Assay Certificate

2W-0620-RA1

Company: **R. KALTWASSER**

Date: JUN-24-92

Project:

Copy 1. BOX 34, MATHESON, ONT POK IMO

Attn:

We hereby certify the following Assay of 8 ROCK samples submitted JUN-23-92 by .

| Sample Number | Au oz/ton | au check oz/ton |
|---------------|-----------|-----------------|
| 3453          | 0.384     | 0.382           |
| 3454          | 0.138     |                 |
| 3455          | 0.070     |                 |
| 3456          | 0.270     | 0.256           |
| 3457          | 0.624     |                 |
| 3458          | 0.052     |                 |
| 3459          | 0.476     |                 |
| 3460          | 0.280     |                 |

Certified by Donna Gardner

(17a)





Established 1928

# Swastika Laboratories

A Division of Assayers Corporation Ltd.

Assaying - Consulting - Representation

## Assay Certificate

2W-0664-RA1

Company: **R. KALTWASSER**

Project:

Date: JUL-13-92

Attn:

Copy 1. BOX 34, MATHESON POK INO

We hereby certify the following Assay of 17 ROCK samples submitted JUL-06-92 by .

| Sample Number | Au oz/ton | Au check oz/ton | Au 2nd oz/ton |
|---------------|-----------|-----------------|---------------|
| 13851         | 0.178     |                 |               |
| 13852         | 0.062     |                 |               |
| 13853         | 0.204     |                 |               |
| 13854         | 0.668     | 0.552           | 0.635         |
| 13855         | 0.078     |                 |               |
| 13856         | 0.192     |                 |               |
| 13857         | 0.046     |                 |               |
| 13858         | 0.062     |                 |               |
| 13859         | 0.192     |                 |               |
| 13860         | 0.020     |                 |               |
| 13861         | 0.214     |                 |               |
| 13862         | 0.240     | 0.280           |               |
| 13863         | 0.094     |                 |               |
| 13864         | 0.124     |                 |               |
| 13865         | 0.046     |                 |               |
| 13866         | 0.440     | 0.520           |               |
| 13867         | 0.022     |                 |               |

Certified by Donna Gardner

(18a)

## **BIBLIOGRAPHY**

### **ASSESSMENT:**

**Office Ministry of Northern Development and Mines, Timmins Branch**

**File No. T-277 Blanchette Porcupine Gold Mines 1936**

**File No. T- 1754 Morin- Laroche Group 1975**

**File No. T-1856 Blanchette Group Manville Canada 1984**

**File No. T-3309 Kinex Resource**

**File No. T-3230 T. McAllaster Property 1988**

### **REPORTS ONTARIO BUREAU OF MINES**

**Porcupine Gold Area- Twentieth Annual Report  
Part II A. G. Burrows 1911**

**Night Hawk Gold Area Twenty Third Annual Report  
Part III 1924**

**Geology of Langmuir- Sheraton Area Fourty ninth  
Annual Report Part IV L. G. Berry 1940**





**ASSESSMENT BREAKDOWN**  
**FOR 11 CONTIGUOUS CLAIMS**  
**EGAN - SHERATON - TIMMINS TOWNSHIPS**

|                                                                                        |             |
|----------------------------------------------------------------------------------------|-------------|
| Total Expenditure                                                                      | \$ 11,303.  |
| <br>                                                                                   |             |
| <b><u>EGAN:</u></b>                                                                    |             |
| ( 2 CL. ) No. I.- 1156116 - 117                                                        | ( 1,600. )  |
|                                                                                        | -----       |
| Sub Total                                                                              | 9,703.      |
| <br>                                                                                   |             |
| <b><u>SHERATON:</u></b>                                                                |             |
| ( 2 CL. ) No. P-1156114 - 115                                                          | ( 2,400. )  |
|                                                                                        | -----       |
| Sub Total                                                                              | 7,303.      |
| <br>                                                                                   |             |
| ( 6 CL. ) No. P-1158839 - P- 1158841<br>P-1158842 - P-1175435<br>P-1175436 - P-1175437 | ( 6,000. )  |
|                                                                                        | -----       |
| Sub Total                                                                              | 1,303.      |
| <br>                                                                                   |             |
| <b><u>TIMMINS:</u></b>                                                                 |             |
| ( 1 CL. ) No. P-1158840 ( Unsurveyed )                                                 | ( 1,000. )  |
|                                                                                        | -----       |
| <br><b>TOTAL BALANCE</b>                                                               | <br>\$ 303. |
|                                                                                        | =====       |

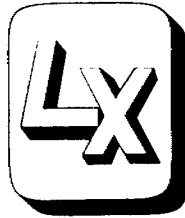

**LARCHEX Inc.**  
**MINING EXPLORATION**  
 PHONE 268-7793 FAX 268-6225

Office: 74 Roblin Ave.  
 Mailing: P.O. Box 1394  
 Timmins, Ontario P4N 7N2

082

R.Kaltwasser & D.Demarki ..... DATE OF INVOICE: July 2 1992  
 11 Bruce Street, South Porcupine, Ont. CUSTOMER NO.: .....  
 ..... (June 22 to June 26) .....

|                                                      |                       |           |            |
|------------------------------------------------------|-----------------------|-----------|------------|
| RE: Sheraton Timmins Property stripping and washing. |                       |           |            |
| 690 B EXCAVATOR at \$90.00 per hour                  | ✓ 16hrs               | \$1440.00 |            |
| S1 MUSKEG BACKHOE at \$50.00 per hour                | ✓ 8hrs                | \$400.00  |            |
| WAJAX PUMP at \$80.00 per day                        | 2 days                | \$160.00  |            |
| CHAIN SAW at \$20.00 per day                         | 1 day                 | \$20.00   |            |
| <u>OPERATORS</u>                                     |                       |           |            |
| Jack Robert at \$26.00 per hour                      | 23hrs                 | \$598.00  |            |
| Dave Larche at \$26.00 per hour                      | 14hrs                 | \$364.00  |            |
| Aagi Nissan at \$26.00/hour (32hrs-16hrs EXC.)       | 16hrs                 | \$416.00  |            |
| <u>FLOAT MOBE &amp; DEMOBILIZATION</u>               |                       |           |            |
| MONDAY                                               | 4hrs                  |           |            |
| THURSDAY                                             | 5hrs                  |           |            |
| FRIDAY                                               | 5hrs                  |           |            |
|                                                      | \$60.00 x TOTAL hours | 14hrs     | \$840.00   |
|                                                      | SUB-TOTAL             |           | \$4,238.00 |
|                                                      | G.S.T.                |           | \$296.66   |
|                                                      | TOTAL                 |           | \$4,534.66 |
| THANK YOU, David P. Larche                           |                       |           |            |

**PAID**  
 [ JUL 06 1992 ]

Swastika Laboratories  
P.O. Box 10  
Swastika, Ontario  
P0K 1T0

# INVOICE

NO: 27389

DATE: 06-24-92

PAGE: 1 of 1

SOLD TO:

R. Kaltwasser  
Box 34  
Matheson, Ontario  
P0K1N0

SHIP TO:

Same

GST Number: R132062640

| ITEM NO. | QUANTITY | UNIT   | DESCRIPTION      | G | P | UNIT PRICE | AMOUNT |
|----------|----------|--------|------------------|---|---|------------|--------|
|          | 0        | Code 1 | AU Assays        | 3 |   | 8.750      | 70.00  |
|          | 8        | Code 4 | Sample Handling  | 3 |   | 3.000      | 24.00  |
|          |          |        | Cert#2W-0620-RA1 |   |   |            |        |
|          |          |        | 3-GST @ 7 %      |   |   |            | 6.58   |

**PAID**  
[ JUN 29 1992 ]

COMMENTS:

Net 30 Days

**TOTAL** ↗

100.58

MINING RECORDER  
KIRKLAND LAKE DNL.  
BST# R124668666

07-07-92 #0

#1156116

|          |       |   |
|----------|-------|---|
| 2X       | 10.00 | 5 |
| TRANSFER | 20.00 |   |
| TOTAL    | 20.00 |   |
| CHECK    | 20.00 |   |
| CHANGE   | 0.00  |   |

ITEM 2

4CL 0.00 12:23:15





# The Write Shoppe

Stationery • Office Supplies • Carlton Cards

G.S.T. #R 129-256-061

Box 546 - 173 Third Ave.

Timmins, ONT. P4N 7E7

Telephone (705) 268-6131

Fax (705) 268-6196

|              |
|--------------|
| 5970         |
| INVOICE NO.  |
| DATE         |
| 25 JUNE 1992 |

FRIDIANNE ENTERPRISES

Box 34

448 EIGHTH AVE

TIMMINS, ONT. P4N 7E7

| ORDER NO         | YOUR ORDER NO | VIA                   | TERMS | 2% 15<br>Net 30 Days | P.S.T. NO | SALESMAN NO |        |
|------------------|---------------|-----------------------|-------|----------------------|-----------|-------------|--------|
|                  |               |                       |       |                      |           | BE 11       |        |
| QTY B O          | QTY SHIPPED   | DESCRIPTION           |       |                      | U M       | PRICE       | AMOUNT |
|                  | 4             | PLASTIC 040 RINGS NET |       |                      |           | 1.77        | 7.08   |
|                  | 1             | RED PAPER RINGS       |       |                      |           |             | 1.19   |
|                  | 1             | TUBE RINGS            |       |                      |           |             | 2.20   |
|                  | 1             | TUBE RINGS            |       |                      |           |             | 1.39   |
|                  |               |                       |       |                      |           |             | 11.86  |
| Items on account |               |                       |       |                      |           |             |        |
| SUB-TOTAL        |               |                       |       |                      |           |             |        |
| G.S.T.           |               |                       |       |                      |           |             | 83     |
| P.S.T.           |               |                       |       |                      |           |             | 95     |
| NET TOTAL        |               |                       |       |                      |           |             | 13.64  |

DISCREPANCY WITHIN 2  
DAYS RETURN TO OUR INVOICE

PLEASE PAY BY INVOICE - NO STATEMENT WILL BE ISSUED

2% PER MONTH CHARGED ON OVERDUE ACCOUNTS  
MINIMUM CHARGE SALE ALLOWABLE \$5.00

PLEASE BE WITHIN 30 DAYS IN  
RETURNING TO OUR INVOICE

PACKAGING CHARGE ON RETURNED GOODS

White - Customer    Canary - Office    Pink - Packing Slip

Porcupine Advance Printers Ltd., Timmins - E-1228

## STATEMENT

ARDIANNE ENTERPRISES  
 MANUAL & COMPUTERIZED ACCOUNTING  
 448 8TH AVENUE  
 BOX 34  
 MATHESON, ONT. POK 1N0  
 (705) 273-3066 3066

DATE JULY 16 1992RICHARD KALTWASSERDAVID DEMARCHIBOX 34, MATHESON, ONTARIO POKIND

| DATE       | DETAILS                      | DEBIT  | CREDIT | BALANCE |
|------------|------------------------------|--------|--------|---------|
|            | COMPUTER PROCESSING          |        |        |         |
|            | REPORT TYPING                |        |        |         |
|            | 16 HRS @ \$25. <sup>00</sup> |        |        |         |
| July 13/92 | 8 HRS                        |        |        |         |
| 16/92      | 8 HRS                        |        |        |         |
| TOTAL      | 16 HRS                       | 400 00 |        | 400 00  |
|            | TRAVELLING TIME              |        |        |         |
|            | 2 HRS @ \$20. <sup>00</sup>  |        |        |         |
|            | to SWASKIA LAB               |        |        |         |
| JUNE 23/92 | 1 HR                         |        |        |         |
| July 6/92  | 1 HR                         |        |        |         |
| TOTAL      | 2 HRS                        | 40 00  |        | 40 00   |
|            | BALANCE                      |        |        | 440 00  |
|            | THANK YOU!                   |        |        |         |

Swastika Laboratories  
P.O. Box 10  
Swastika, Ontario  
P0K 1T0

# INVOICE

NO: 27443

DATE: 07-13-92

PAGE: 1 of 1

SOLD TO:

R. Kaltwasser  
Box 34  
Matheson, Ontario  
P0K1N0

SHIP TO:

Same

GST Number: R132862640

| ITEM NO     | QUANTITY | UNIT   | DESCRIPTION      | G | P | UNIT PRICE | AMOUNT |
|-------------|----------|--------|------------------|---|---|------------|--------|
| 17          |          | Code 1 | Au Assays        |   |   | 8.750      | 148.75 |
| 17          |          | Code 4 | Sample Handling  |   |   | 0.000      | 51.00  |
|             |          |        | Cert#2W-0664-RA1 |   |   |            |        |
|             |          |        | 3-GST @ 7 %      |   |   |            | 13.98  |
| COMMENTS    |          |        |                  |   |   | TOTAL      | 213.73 |
| Net 30 Days |          |        |                  |   |   |            |        |

CREDIT CARD STATEMENT

RELEVÉ DE COMPTE DE CARTE DE CRÉDIT

You're on your way  
with Esso.



Partez en grand  
avec Esso.

FOR CUSTOMER SERVICE CALL 1-800-268-6287 NUMÉRO SANS FRAIS, SERVICE À LA CLIENTÈLE

PAGE 01 OF 01 STATEMENT DATE 92 06 15 PAYMENT DUE BY 92 07 06 ACCT. NO. 2510183375

| PURCHASE DATE M/D<br>DATE D'ACHAT M/J | CARD NO.<br>N° DE CARTE | INVOICE NO.<br>N° DE FACTURE | DETAILS/DETAILS              | AMOUNT<br>MONTANT |
|---------------------------------------|-------------------------|------------------------------|------------------------------|-------------------|
| 06 01                                 | 000                     | 6796626                      | HIGHWAY 11 NORTH MATHESON ON | 26.00             |
|                                       |                         |                              | SUB-TOTAL 000                | 26.00             |

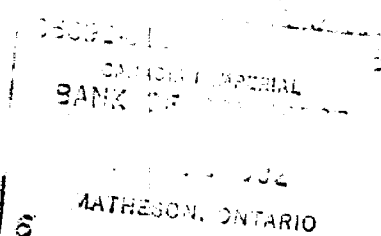

**BEFORE YOUR NEXT-FILLUP... 05092-010**  
**ALL GRADES OF ESSO GASOLINE CONTAIN IVC-400, AN ADVANCED DETERGENT ADDITIVE EXCLUSIVE TO ESSO. BY MINIMIZING INTAKE VALVE DEPOSITS, IVC-400 HELPS CLEAN YOUR ENGINE WHILE YOU DRIVE. IVC-400 -- JUST ONE MORE REASON WHY YOU'RE ON YOUR WAY WITH ESSO.**

|                                           |                                               |                                            |                                        |                                            |                                          |
|-------------------------------------------|-----------------------------------------------|--------------------------------------------|----------------------------------------|--------------------------------------------|------------------------------------------|
| PREVIOUS BALANCE<br>0.00<br>SOLDE REPORTE | PAYMENTS/CREDITS<br>0.00<br>PAIEMENTS/CREDITS | DEBIT ADJUSTMENTS<br>0.00<br>REDRESSEMENTS | UNPAID BALANCE<br>0.00<br>SOLDE IMPAYE | PURCHASES/CHARGES<br>26.00<br>ACHATS/FRAIS | CREDIT CHARGE<br>0.00<br>FRAIS DE CREDIT |
|-------------------------------------------|-----------------------------------------------|--------------------------------------------|----------------------------------------|--------------------------------------------|------------------------------------------|

See reverse side for payment terms

Voir les conditions de paiement au verso

Include ACCOUNT NUMBER and INVOICE NUMBER on all inquiries

Indiquer le NUMÉRO DE COMPTE et le NUMÉRO DE FACTURE sur toute correspondance

RETAIN this portion for your records

CONSERVEZ cette partie pour vos dossiers

|                                              |                                       |
|----------------------------------------------|---------------------------------------|
| 26.00<br>MINIMUM PAYMENT<br>PAIEMENT MINIMUM | 26.00<br>NEW BALANCE<br>NOUVEAU SOLDE |
|----------------------------------------------|---------------------------------------|

You may pay either new balance or minimum payment

Régler le nouveau solde ou le paiement minimum

Sold to / Vendu à: [Redacted] 337 001 12500  
 Amount of purchase / Montant de l'achat: 12500

Assigned to / À être cédé aux: Imperial Oil  
 Esso Petroleum Canada  
 Esso Canada, L'Impériale

Sold by / Vendu par: [Redacted] MM DE YA  
 Account / Compte: 192  
 Esso Petroleum Canada  
 Esso Canada, L'Impériale

Station: 5207  
 Highway 1  
 Theson  
 Rio

SONS  
 RTM

Retain this copy / Conservez cette copie  
 This financing is subject to the terms and conditions set out in the contract.  
 Ce financement est assujéti aux conditions énoncées dans votre contrat de carte de crédit.

| Product / Produit                                                                | Qty | Unit Price | Amount |
|----------------------------------------------------------------------------------|-----|------------|--------|
| Motor oil / Huile moteur                                                         | 42  |            | 75.00  |
| Fuel amount includes PST where applicable / Carburant TVP incluse, s'il y a lieu |     |            |        |
| Total                                                                            |     |            | 75.00  |

Sold to / Vendu à: [Redacted] 33 001 01500  
 Amount of purchase / Montant de l'achat: 01500

Assigned to / À être cédé aux: Imperial Oil  
 Esso Petroleum Canada  
 Esso Canada, L'Impériale

Sold by / Vendu par: [Redacted] MM DE YA  
 Account / Compte: 192  
 Esso Petroleum Canada  
 Esso Canada, L'Impériale

Station: 5207  
 Highway 1  
 Theson  
 Rio

SONS  
 RTM

Retain this copy / Conservez cette copie  
 This financing is subject to the terms and conditions set out in the contract.  
 Ce financement est assujéti aux conditions énoncées dans votre contrat de carte de crédit.

| Product / Produit                                                                | Qty  | Unit Price | Amount |
|----------------------------------------------------------------------------------|------|------------|--------|
| Motor oil / Huile moteur                                                         | 25.5 |            | 15.00  |
| Fuel amount includes PST where applicable / Carburant TVP incluse, s'il y a lieu |      |            |        |
| Total                                                                            |      |            | 15.00  |

Sold to / Vendu à: [Redacted] 33 001 02400  
 Amount of purchase / Montant de l'achat: 02400

Assigned to / À être cédé aux: Imperial Oil  
 Esso Petroleum Canada  
 Esso Canada, L'Impériale

Sold by / Vendu par: [Redacted] MM DE YA  
 Account / Compte: 192  
 Esso Petroleum Canada  
 Esso Canada, L'Impériale

Station: 5207  
 Highway 1  
 Theson  
 Rio

SONS  
 RTM

Retain this copy / Conservez cette copie  
 This financing is subject to the terms and conditions set out in the contract.  
 Ce financement est assujéti aux conditions énoncées dans votre contrat de carte de crédit.

| Product / Produit                                                                | Qty | Unit Price | Amount |
|----------------------------------------------------------------------------------|-----|------------|--------|
| Motor oil / Huile moteur                                                         | 40  |            | 29.00  |
| Fuel amount includes PST where applicable / Carburant TVP incluse, s'il y a lieu |     |            |        |
| Total                                                                            |     |            | 29.00  |

Sold to / Vendu à: [Redacted] 33 001 01200  
 Amount of purchase / Montant de l'achat: 01200

Assigned to / À être cédé aux: Imperial Oil  
 Esso Petroleum Canada  
 Esso Canada, L'Impériale

Sold by / Vendu par: [Redacted] MM DE YA  
 Account / Compte: 192  
 Esso Petroleum Canada  
 Esso Canada, L'Impériale

Station: 5207  
 Highway 1  
 Theson  
 Rio

SONS  
 RTM

Retain this copy / Conservez cette copie  
 This financing is subject to the terms and conditions set out in the contract.  
 Ce financement est assujéti aux conditions énoncées dans votre contrat de carte de crédit.

| Product / Produit                                                                | Qty  | Unit Price | Amount |
|----------------------------------------------------------------------------------|------|------------|--------|
| Motor oil / Huile moteur                                                         | 20.7 |            | 12.00  |
| Fuel amount includes PST where applicable / Carburant TVP incluse, s'il y a lieu |      |            |        |
| Total                                                                            |      |            | 12.00  |

*Supplies  
Assessed under  
Sheraton Eggs 1992*



Ministry of  
Northern Dev.  
and Mines

OFFICE OF THE  
MINING RECORDER  
TIMMINS ONTARIO

MINING RECORDER  
KIRKLAND LAKE ONT.  
GST# R124668666

07-06-92 #0  
1X 1.00 @  
WHITE PR 1.00 T  
TAX1 0.08  
TAX2 0.07  
TOTAL 1.15  
CATEND 20.00  
CHANGE 18.85

06-18-92 #0  
1X 5.00 @  
MISC.PUB 5.00 T  
GST 0.35  
TOTAL 5.35  
CATDND 10.35  
CHANGE 5.00

1CL 5582 11:25TM

ITEM 4CL 0278 11:12TM

MATHESON AUTO PARTS  
P.O. BOX 550 HWY #11  
MATHESON  
237-2777 FX 273-2850

June 20 1992 08:35:45

| Item #      | Name              | Price  | Total  |
|-------------|-------------------|--------|--------|
| 24          | SPARKPLUG 24-27 N |        |        |
| 1           |                   | \$2.71 | \$2.71 |
| Sub - Total |                   |        | \$2.71 |
| GST 7 %     |                   |        | \$0.19 |
| PST 8 %     |                   |        | \$0.22 |
| Total Price |                   |        | \$3.12 |

Saleslip# 23719 Clerk:RON  
Cheque \$3.12  
Name of buyer dianne Kaltwasser  
Address \_\_\_\_\_  
Town \_\_\_\_\_  
Phone \_\_\_\_\_  
THANK YOU-CALL AGAIN  
GST#r111666376

*fly type*  
07-02-92  
1Tx 6.99  
1Tx 5.99  
12.98 ST  
1.04 TX  
0.91 TX  
14.93 CK  
2\*  
1000 0023  
12-11

*fly type*  
06-02-92  
1Tx 19.99  
19.99 ST  
1.60 TX  
1.40 TX  
22.99 TL  
23.00 CA  
0.01 CD  
1\*  
1000 0051  
14-15

*fly type*  
07-03-92  
03 \*599  
02 \*1019  
05 \*899  
\*1697  
1 \*128  
2 \*119  
\*1844  
\*1244  
0000

23.98  
35  
Pricing film

Sold to / Vendu à



Amount of purchase / Montant de l'achat

*Open Account Limited*

Account may be assigned to: / Ce compte peut être cédé aux:

Imperial Oil

Esso Petroleum Canada  
A Division of Imperial Oil  
Pétroles Esso Canada,  
Division de la Pétrolière Impériale



L'Impériale

Sold by / Vendu par

M/M D/J Y/A

26797125

Retain this copy / Conserver cette copie  
This financing is subject to the terms and conditions applicable to your card.  
Financement sous réserve des conditions stipulées dans votre contrat de carte de crédit.

| Product / Produit                                                                  | Qty / Qté | Price / Prix | GST / TPS | Amount / Montant |
|------------------------------------------------------------------------------------|-----------|--------------|-----------|------------------|
| Supreme Diesel                                                                     | 54.579    |              |           | 20.00            |
| Motor oil / Huile moteur                                                           |           |              |           |                  |
| Fuel amount includes PST where applicable. / Carburant TVP incluse, s'il y a lieu. |           |              |           | PST - TVP        |
|                                                                                    |           |              |           | 20.00            |

License no. / N° de plaque: \_\_\_\_\_ Prov. State / État: \_\_\_\_\_

Authorization no. / N° d'autorisation: \_\_\_\_\_

Customer's Signature / Signature du client: *[Signature]*

Odometer Reading / Lecture de l'odomètre: \_\_\_\_\_

Sold to / Vendu à



Amount of purchase / Montant de l'achat

*Open Account Limited*

Account may be assigned to: / Ce compte peut être cédé aux:

Imperial Oil

Esso Petroleum Canada  
A Division of Imperial Oil  
Pétroles Esso Canada,  
Division de la Pétrolière Impériale



L'Impériale

Sold by / Vendu par

M/M D/J Y/A

26797127

Retain this copy / Conserver cette copie  
This financing is subject to the terms and conditions applicable to your card.  
Financement sous réserve des conditions stipulées dans votre contrat de carte de crédit.

| Product / Produit                                                                  | Qty / Qté | Price / Prix | GST / TPS | Amount / Montant |
|------------------------------------------------------------------------------------|-----------|--------------|-----------|------------------|
| Supreme Diesel                                                                     | 7.60      |              |           | 7.60             |
| Motor oil / Huile moteur                                                           | 4.10      |              |           | 4.10             |
| Fuel amount includes PST where applicable. / Carburant TVP incluse, s'il y a lieu. |           |              |           | PST - TVP        |
|                                                                                    |           |              |           | 82               |
|                                                                                    |           |              |           | 94               |
|                                                                                    |           |              |           | Total 13.40      |

License no. / N° de plaque: \_\_\_\_\_ Prov. State / État: \_\_\_\_\_

Authorization no. / N° d'autorisation: \_\_\_\_\_

Customer's Signature / Signature du client: *[Signature]*

Odometer Reading / Lecture de l'odomètre: \_\_\_\_\_

MAIL POSTE

Canada Post Corporation / Société canadienne des postes

Receipt Reçu

Customer Name / Nom du client: \_\_\_\_\_

CPC Registration No. / N° d'enregistrement de la TPS: 119321495

Office Date Stamp / Timbre à date du bureau: *[Stamp: MATHESON PM ONT 16 VII 92 POK INC]*

Received in payment for Postage Supplies / Reçu en paiement d'articles d'affranchissement

|              |               |    |     |
|--------------|---------------|----|-----|
| Sub Total    | Sous-total    | \$ | 48  |
| GST          | TPS           | \$ | .03 |
| Total Amount | Montant Total | \$ | .51 |

Signature

*[Signature]*

41-016-020 (90-09)



July 17

19 92

*M*

Ministry of Agriculture and Food,

Box 608, Matheson, Ont. POK 1N0

*In account with* Mr. Richard F. Kaltwasser,

Box 34, Matheson, Ont. POK 1N0

Photocopying 168 copies @ .50¢

\$84.00

July 2 - 6 copies  
" 3 - 18 copies  
" 6 - 6 copies  
" 8 - 24 copies  
" 13 - 32 copies  
" 15 - 38 copies  
" 16 - 44 copies

168 copies

*R. F. Kaltwasser*

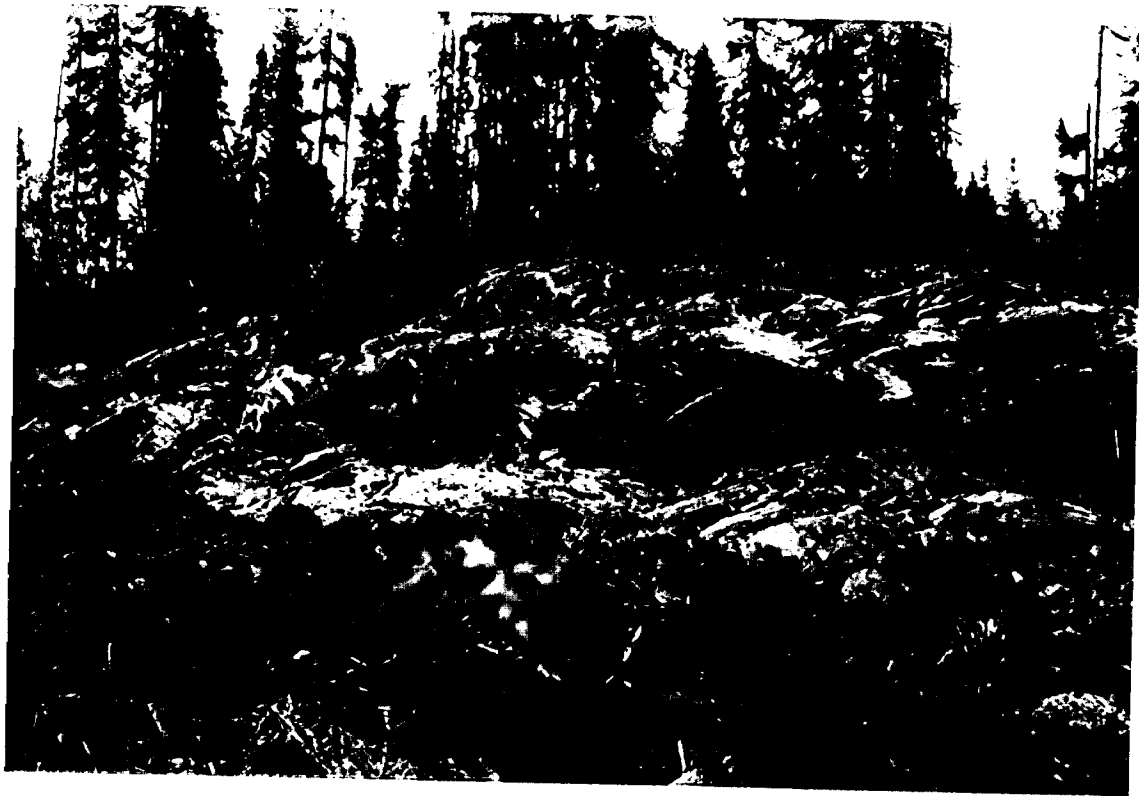

Looking N.E. across north part of stripping, from bottom of ridge  
 For ground is silicious quartz fracture zone, west of diabase dike. Central part  
 of picture. S.E. 1/4 - 5 1/2 lot 1, con. Sheraton Twp. Note: - RFR Sampling north edge  
 of photo.



Showing diabase dike cutting Feldspar porphyry dike  
 Sheraton Twp. S.E. 1/4 5 1/2 lot 1, con. 1



Looking Southeast into Egan Twp. (background)  
 Left side of photo Silicious Fracture Zone. David  
 pointing to contact with chlorite schist. 80' at  
 west of Twp. line. SE 1/4 - S<sub>2</sub> Lot 1 com. Sheraton Twp.



Looking east at host of cherty dikes at 4740' N  
 on P.L. claim P-1156114 - S<sub>1</sub> 1/4 - S<sub>2</sub> Lot 1, com 1  
 Sheraton Twp.

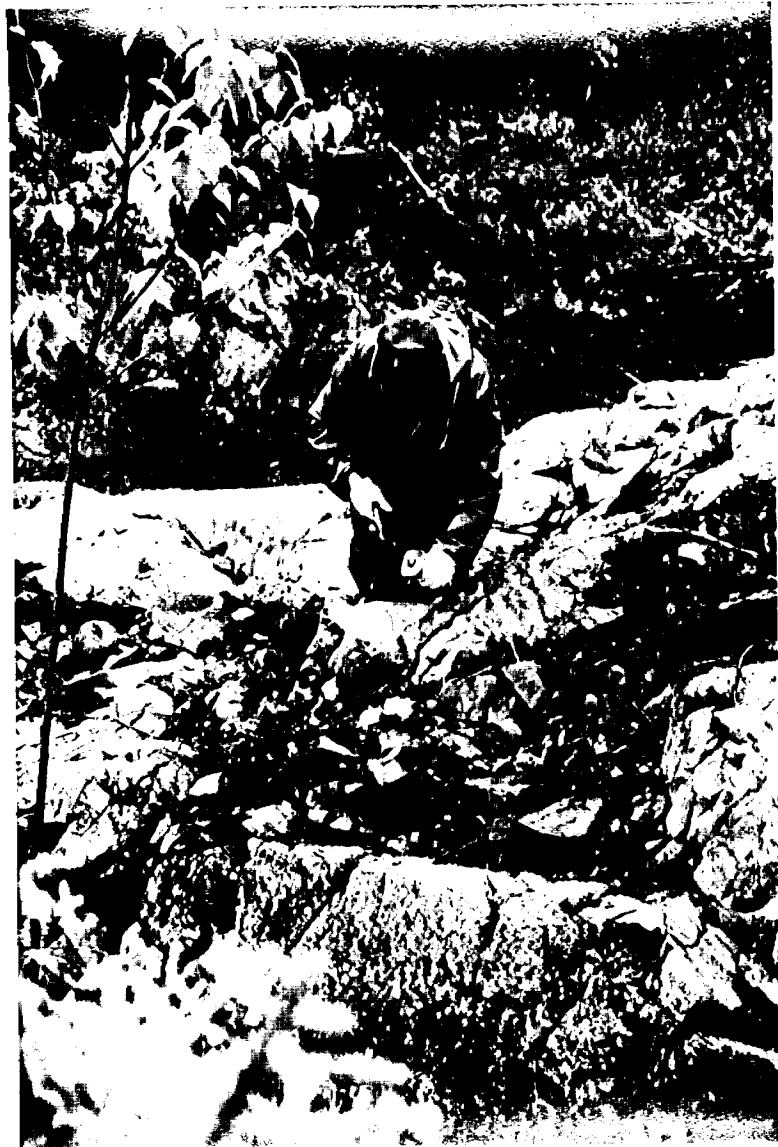

R.F.K. cutting samples



Looking North along fracture <sup>zone</sup> Red marks  
sample locations Sheraton twp. Stripped area.

400000  
2000



Looking South, from 10400'N. Stanton Twp. Lot 1, con. 5 1/2  
sample no. 23 by hammer. R.F.K. standing 10100'N, facing North.



Note: - rusty silicious ground zone in foreground with  
90° fractures to left. Showing contact with chloritic  
schists. Looking South s.w. 1/4 - 5 1/2 - Lot 1 - con.  
Stanton Twp. Near Twp. line with Ryan.



*Looking east at host of cherty dikes Dip 60° N. NW  
stepped area*



*Looking south along diabase dike, cutting fld. porphyry dike. Note g.v.v.  
in contact with diabase. David standing on dike, pointing to g.v.v.  
(Eson Top. background) SW 1/4 3 1/2 - LOT 1 - cont. Sheraton Twp.*

Report of Work After Recording

Mining Act



42A07NE0204 63.5742 EGAN

63.5742

900

W9260.00088

Personal information collected on this form is obtained under the authority of the this collection should be directed to the Provincial Manager, Mining Lands, N Sudbury, Ontario, P3E 6A5, telephone (705) 670-7264.

- Instructions:**
- Please type or print and submit in duplicate.
  - Refer to the Mining Act and Regulations for requirements of filing assessment work or consult the Mining Recorder.
  - A separate copy of this form must be completed for each Work Group.
  - Technical reports and maps must accompany this form in duplicate.
  - A sketch, showing the claims the work is assigned to, must accompany this form.

|                                                             |                                          |                                      |
|-------------------------------------------------------------|------------------------------------------|--------------------------------------|
| Recorded Holder(s)<br><i>David DEMARCHI</i>                 |                                          | Client No.<br><i>125156</i>          |
| Address<br><i>11 BRUCE AVE. SOUTH PORCUPINE ONT P4N1H0</i>  |                                          | Telephone No.<br><i>235-3888</i>     |
| Mining Division<br><i>PORCUPINE</i>                         | Township/Area<br><i>SHERATON-TIMMINS</i> | M or G Plan No.                      |
| Dates Work Performed From: <i>JUNE 14<sup>th</sup> / 92</i> |                                          | To: <i>JULY 10<sup>th</sup> 1992</i> |

Work Performed (Check One Work Group Only)

| Work Group                        | Type                                                      |
|-----------------------------------|-----------------------------------------------------------|
| Geotechnical Survey               |                                                           |
| Physical Work, Including Drilling | <i>Manual, P. stripping - washing, assaying - mapping</i> |
| Rehabilitation                    |                                                           |
| Other Authorized Work             |                                                           |
| Assays                            |                                                           |
| Assignment from Reserve           |                                                           |

ONTARIO GEOLOGICAL SURVEY  
GIS - ASSESSMENT FILES  
AUG 17 1992  
RECEIVED

RECORDED  
JUL 20 1992  
Receipt \_\_\_\_\_

Total Assessment Work Claimed on the Attached Statement of Costs \$ *9,703.00*

**Note:** The Minister may reject for assessment work credit all or part of the assessment work submitted if the recorded holder cannot verify expenditures claimed in the statement of costs within 30 days of a request for verification.

Persons and Survey Company Who Performed the Work (Give Name and Address of Author of Report)

| Name                             | Address                                                 |
|----------------------------------|---------------------------------------------------------|
| <i>RICHARD F. KALTWASSER</i>     | <i>8<sup>th</sup> AVE. BOX 34, MATHESON ONT. POKING</i> |
| <i>Larchex INC. MINING EXPL.</i> | <i>BOX 1394 TIMMINS ONT. P4N 7H2</i>                    |

(attach a schedule if necessary)

Certification of Beneficial Interest \* See Note No. 1 on reverse side

|                                                                                                                                                                                                          |      |                                      |
|----------------------------------------------------------------------------------------------------------------------------------------------------------------------------------------------------------|------|--------------------------------------|
| I certify that at the time the work was performed, the claims covered in this work report were recorded in the current holder's name or held under a beneficial interest by the current recorded holder. | Date | Recorded Holder or Agent (Signature) |
|----------------------------------------------------------------------------------------------------------------------------------------------------------------------------------------------------------|------|--------------------------------------|

Certification of Work Report

|                                                                                                                                                                                                   |                               |                                                          |
|---------------------------------------------------------------------------------------------------------------------------------------------------------------------------------------------------|-------------------------------|----------------------------------------------------------|
| I certify that I have a personal knowledge of the facts set forth in this Work report, having performed the work or witnessed same during and/or after its completion and annexed report is true. |                               |                                                          |
| Name and Address of Person Certifying<br><i>RICHARD F. KALTWASSER BOX 34, MATHESON ONT. POKING</i>                                                                                                |                               |                                                          |
| Telephone No.<br><i>273-2733</i>                                                                                                                                                                  | Date<br><i>JULY 20 / 1992</i> | Certified By (Signature)<br><i>Richard F. Kaltwasser</i> |

For Office Use Only

|                                                         |                                                          |                                    |                                                                     |
|---------------------------------------------------------|----------------------------------------------------------|------------------------------------|---------------------------------------------------------------------|
| Total Value Cr. Recorded<br><i>89,103.<sup>00</sup></i> | Date Recorded<br><i>JULY 20<sup>th</sup> / 92</i>        | Mining Recorder<br><i>St White</i> | Received<br><b>RECEIVED</b><br>JUL 20 1992<br><i>@-2045 p.m. 92</i> |
|                                                         | Deemed Approval Date<br><i>OCT. 18<sup>th</sup> / 92</i> | Date Approved                      |                                                                     |
|                                                         | Date Notice for Amendments Sent                          |                                    |                                                                     |





Statement of Costs  
for Assessment Credit

État des coûts aux fins  
du crédit d'évaluation

Mining Act/Loi sur les mines

Transaction No./N° de transaction  
W9260.00088

Personal information collected on this form is obtained under the authority of the Mining Act. This information will be used to maintain a record and ongoing status of the mining claim(s). Questions about this collection should be directed to the Provincial Manager, Minings Lands, Ministry of Northern Development and Mines, 4th Floor, 159 Cedar Street, Sudbury, Ontario P3E 6A5, telephone (705) 670-7264.

Les renseignements personnels contenus dans la présente formule sont recueillis en vertu de la Loi sur les mines et serviront à tenir à jour un registre des concessions minières. Adresser toute question sur la collecte de ces renseignements au chef provincial des terrains miniers, ministère du Développement du Nord et des Mines, 159, rue Cedar, 4<sup>e</sup> étage, Sudbury (Ontario) P3E 6A5, téléphone (705) 670-7264.

1. Direct Costs/Coûts directs

| Type                                                                                                  | Description                                                      | Amount<br>Montant | Totals<br>Total global |
|-------------------------------------------------------------------------------------------------------|------------------------------------------------------------------|-------------------|------------------------|
| Wages<br>Salaires                                                                                     | Labour<br>Main-d'oeuvre                                          | 1736.-            |                        |
|                                                                                                       | Field Supervision<br>Supervision sur le terrain                  | 1800.-            | 3536                   |
| Contractor's<br>and Consultant's<br>Fees<br>Droits de<br>l'entrepreneur<br>et de l'expert-<br>conseil | Type <i>Contractor<br/>consulting</i>                            | 2875.-            |                        |
|                                                                                                       |                                                                  |                   | 2875.-                 |
| Supplies Used<br>Fournitures<br>utilisées                                                             | Type                                                             |                   |                        |
|                                                                                                       | <i>fly tape - spray paint<br/>fuel - photo copies<br/>assess</i> | 641.-             |                        |
|                                                                                                       |                                                                  |                   | 641.-                  |
| Equipment<br>Rental<br>Location de<br>matériel                                                        | Type                                                             |                   |                        |
|                                                                                                       | <i>Excavator 690B</i>                                            | 1161.-            |                        |
|                                                                                                       |                                                                  |                   |                        |
|                                                                                                       | <i>Truck rental 4wh.<br/>Tilden</i>                              | 350.-             | 1511.-                 |
| Total Direct Costs<br>Total des coûts directs                                                         |                                                                  |                   | 8563.-                 |

2. Indirect Costs/Coûts indirects

\*\* Note: When claiming Rehabilitation work Indirect costs are not allowable as assessment work.  
Pour le remboursement des travaux de réhabilitation, les coûts indirects ne sont pas admissibles en tant que travaux d'évaluation.

| Type                                                                                                                  | Description                                 | Amount<br>Montant | Totals<br>Total global |
|-----------------------------------------------------------------------------------------------------------------------|---------------------------------------------|-------------------|------------------------|
| Transportation<br>Transport                                                                                           | Type                                        |                   |                        |
|                                                                                                                       | <i>Travel<br/>to and from job<br/>site</i>  | 241.-             | 241.-                  |
|                                                                                                                       |                                             |                   |                        |
|                                                                                                                       |                                             |                   | 241.-                  |
| Food and<br>Lodging<br>Nourriture et<br>hébergement                                                                   |                                             |                   |                        |
| Mobilization and<br>Demobilization<br>Mobilisation et<br>démobilisation                                               | <i>Excavator 690B<br/>S-1 Musky backhoe</i> | 899.-             | 899.-                  |
| Sub Total of Indirect Costs<br>Total partiel des coûts indirects                                                      |                                             |                   | 1140.-                 |
| Amount Allowable (not greater than 20% of Direct Costs)<br>Montant admissible (n'excédant pas 20 % des coûts directs) |                                             |                   |                        |
| Total Value of Assessment Credit<br>(Total of Direct and Allowable<br>indirect costs)                                 |                                             |                   | 9703.-                 |
| Valeur totale du crédit<br>d'évaluation<br>(Total des coûts directs<br>et indirects admissibles)                      |                                             |                   |                        |

Note: The recorded holder will be required to verify expenditures claimed in this statement of costs within 30 days of the date of verification. If verification is not made, the Minister may reject to assessment work all or part of the assessment work submitted.

Note : Le titulaire enregistré sera tenu de vérifier les dépenses demandées dans le présent état des coûts dans les 30 jours suivant une demande à cet effet. Si la vérification n'est pas effectuée, le ministre peut rejeter tout ou une partie des travaux d'évaluation présentés.

Filing Discounts

1. Work filed within two years of completion is claimed at 100% of the above Total Value of Assessment Credit.
2. Work filed three, four or five years after completion is claimed at 50% of the above Total Value of Assessment Credit. See calculations below:

|                                  |                          |
|----------------------------------|--------------------------|
| Total Value of Assessment Credit | Total Assessment Claimed |
|                                  | × 0.50 =                 |

Remises pour dépôt

1. Les travaux déposés dans les deux ans suivant leur achèvement sont remboursés à 100 % de la valeur totale susmentionnée du crédit d'évaluation.
2. Les travaux déposés trois, quatre ou cinq ans après leur achèvement sont remboursés à 50 % de la valeur totale du crédit d'évaluation susmentionné. Voir les calculs ci-dessous.

|                                      |                            |
|--------------------------------------|----------------------------|
| Valeur totale du crédit d'évaluation | Evaluation totale demandée |
|                                      | × 0,50 =                   |

Certification Verifying Statement of Costs

I hereby certify:  
that the amounts shown are as accurate as possible and these costs were incurred while conducting assessment work on the lands shown on the accompanying Report of Work form.

that as \_\_\_\_\_ I am authorized  
(Recorded Holder, Agent, Position in Company)

to make this certification

Attestation de l'état des coûts

J'atteste par la présente :  
que les montants indiqués sont le plus exact possible et que ces dépenses ont été engagées pour effectuer les travaux d'évaluation sur les terrains indiqués dans la formule de rapport de travail ci-joint.

Et qu'à titre de \_\_\_\_\_ je suis autorisé  
(titulaire enregistré, représentant, poste occupé dans la compagnie)

à faire cette attestation.

Signature \_\_\_\_\_ Date \_\_\_\_\_

413.M

LIMIT 21M

314

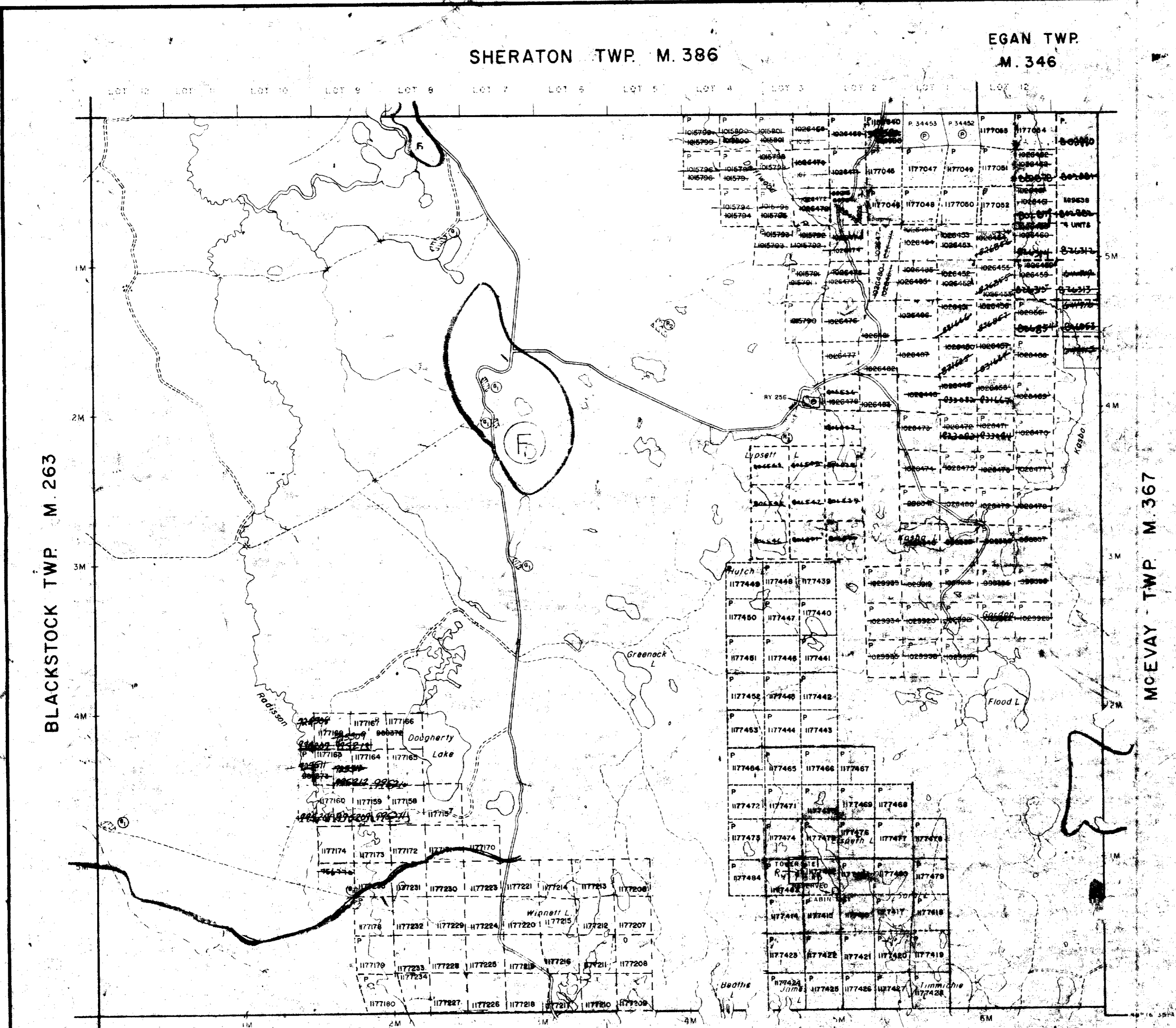

TRIM LINE

413.M

LIMIT 21M

413

NOTES

400' surface rights reservation along the shores of all lakes and rivers.

Areas withdrawn from staking under Section 43 of the Mining Act, R.S.O. 1970.

| Order No. | File   | Date     | Disposition |
|-----------|--------|----------|-------------|
| W. 67/77  | 192164 | 28/6/77  | S.R.O.      |
| W. 86/77  | 188543 | 27/10/77 | S.R.O.      |
| W. 19/78  | 188543 | 10/10/78 | S.R.O.      |
| W. 34/85  | 188543 | 10/1/85  | S.A.M.R.    |

SAND and GRAVEL

Quarry Permit

THIS TWP. SUBJECT TO FOREST ACTIVITY IN 1992/93 FURTHER INFORMATION ON FILE.

THIS TWP. IS SUBJECT TO FOREST ACTIVITIES IN 1991/92 FURTHER INFORMATION AVAILABLE ON FILE.

LEGEND

- PATENTED LAND (P) or (C)
- PATENTED FOR SURFACE RIGHTS ONLY (P)
- LEAST (L)
- LICENSE OF OCCUPATION (L.O.)
- CROWN LAND SALES (C.S.)
- LOCATED LAND (L.C.)
- CANCELLED (C)
- MINING RIGHTS ONLY (M.R.O.)
- SURFACE RIGHTS (S.R.O.)
- HIGHWAY & ROUTE (H)
- ROADS (R)
- TRAILS (T)
- RAILWAYS (R)
- POWER LINES (P)
- MARSH OR MUSKEG (M)
- MINES (M)

RECEIVED JUL 23 1992

63.5742 TOWNSHIP OF

TIMMINS

DISTRICT OF COCHRANE

PORCUPINE MINING DIVISION

SCALE: 1 INCH = 40 CHAINS (1/2 MILE)

PLAN NO. M.314

ONTARIO MINISTRY OF NATURAL RESOURCES SURVEYS AND MAPPING BRANCH

THE INFORMATION THAT APPEARS ON THIS MAP HAS BEEN COMPILED FROM VARIOUS SOURCES, AND ACCURACY IS NOT GUARANTEED. THOSE WISHING TO STAKE MINING CLAIMS SHOULD CONSULT WITH THE MINING RECORDER, MINISTRY OF NORTHERN DEVELOPMENT AND MINES, FOR ADDITIONAL INFORMATION ON THE STATUS OF THE LANDS SHOWN HEREON.



42A07NE084 63.5742 EGAN

200

MICHIE TWP. M. 301

**AREAS WITHDRAWN FROM DISPOSITION**

| Description                      | Order No. | Date      | Disposition | File   |
|----------------------------------|-----------|-----------|-------------|--------|
| M.R.O. - MINING RIGHTS ONLY      |           |           |             |        |
| S.R.O. - SURFACE RIGHTS ONLY     |           |           |             |        |
| M+S. - MINING AND SURFACE RIGHTS |           |           |             |        |
| W. 55/77                         | 4/6/77    | S.A.O.    |             | 177198 |
| NWR 16/82                        | 18/1/82   | S.A.O. MR |             |        |
| NWR 41/83                        | 22/04/83  | S.A.O. MR |             |        |

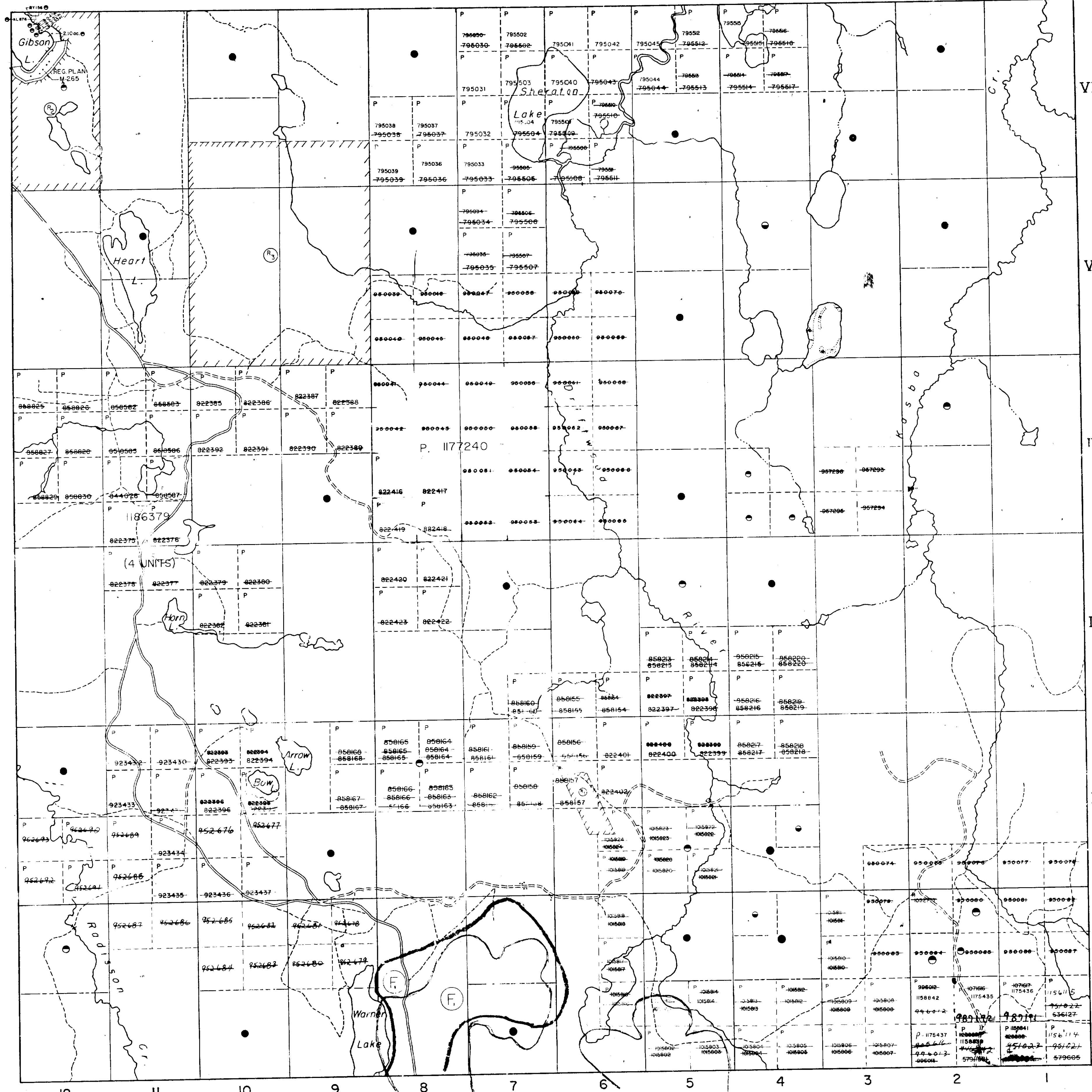

BOND TOWNSHIP

THOMAS TOWNSHIP

VI

V

IV

III

II

I

TIMMINS TOWNSHIP

**LEGEND**

- HIGHWAY AND ROUTE No.
- OTHER ROADS
- TRAILS
- SURVEYED LINES
- OWNSHIPS, BASE LINES, ETC.
- LOTS, MINING CLAIMS, PARCELS, ETC.
- UNSURVEYED LINES
- LOT LINES
- PARCEL BOUNDARY
- MINING CLAIMS ETC.
- RAILWAY AND RIGHT OF WAY
- UTILITY LINES
- NON PERENNIAL STREAM
- FLOODING OR FLOODING RIGHTS
- SUB DIVISION OR COMPOSITE PLAN
- RESERVATIONS
- ORIGINAL SHORELINE
- MARSH OR MUSKEG
- MINES
- TRAVERSE MONUMENT

**DISPOSITION OF CROWN LANDS**

| TYPE OF DOCUMENT                | SYMBOL |
|---------------------------------|--------|
| PATENT, SURFACE & MINING RIGHTS | ●      |
| " SURFACE RIGHTS ONLY           | ○      |
| " MINING RIGHTS ONLY            | ○      |
| LEASE, SURFACE & MINING RIGHTS  | □      |
| " SURFACE RIGHTS ONLY           | □      |
| " MINING RIGHTS ONLY            | □      |
| LICENCE OF OCCUPATION           | ○      |
| ORDER IN COUNCIL                | OC     |
| RESERVATION                     | ○      |
| CANCELLED                       | ○      |
| SAND & GRAVEL                   | ○      |

NOTE: MINING RIGHTS IN PARCELS PATENTED PRIOR TO MAY 6 1913 VESTED IN ORIGINAL PATENTEE BY THE PUBLIC LANDS ACT R.S.O. 1910, CAP. 281, S. 63, SUBSEC. 1.

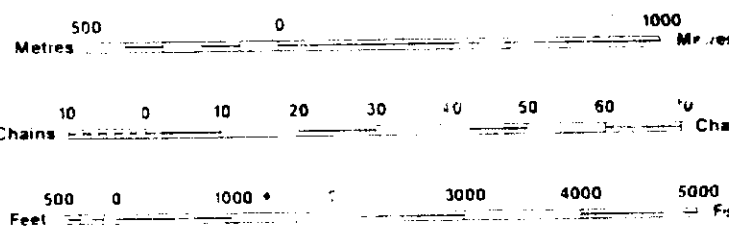

SCALE 1:20 000

**NOTES**

- THIS TWP. IS SUBJECT TO FOREST ACTIVITIES IN 1991/92 FURTHER INFORMATION AVAILABLE ON FILE.
- THIS TWP. SUBJECT TO FOREST ACTIVITY IN 1992/93 FURTHER INFORMATION ON FILE.

TOWNSHIP **63.5742**  
**SHERATON**  
 M.N.R. ADMINISTRATIVE DISTRICT  
 TIMMINS  
 MINING DIVISION  
 PORCUPINE  
 LAND TITLES / REGISTRY DIVISION  
**COCHRANE**

Ministry of Natural Resources Ontario  
 Ministry of Northern Development and Mines

Date: OCTOBER 1986  
 Drawn By: R. Oct 28/86  
 88  
**G-3971**

THE INFORMATION THAT APPEARS ON THIS MAP HAS BEEN COMPILED FROM VARIOUS SOURCES, AND ACCURACY IS NOT GUARANTEED. THOSE WISHING TO STAKE MINING CLAIMS SHOULD CONSULT WITH THE MINING RECORDER, MINISTRY OF NORTHERN DEVELOPMENT AND MINES, FOR ADDITIONAL INFORMATION ON THE STATUS OF THE LANDS SHOWN HEREON.

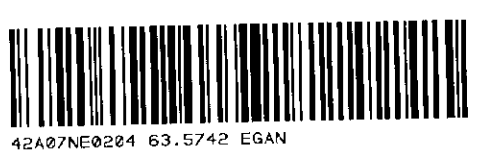



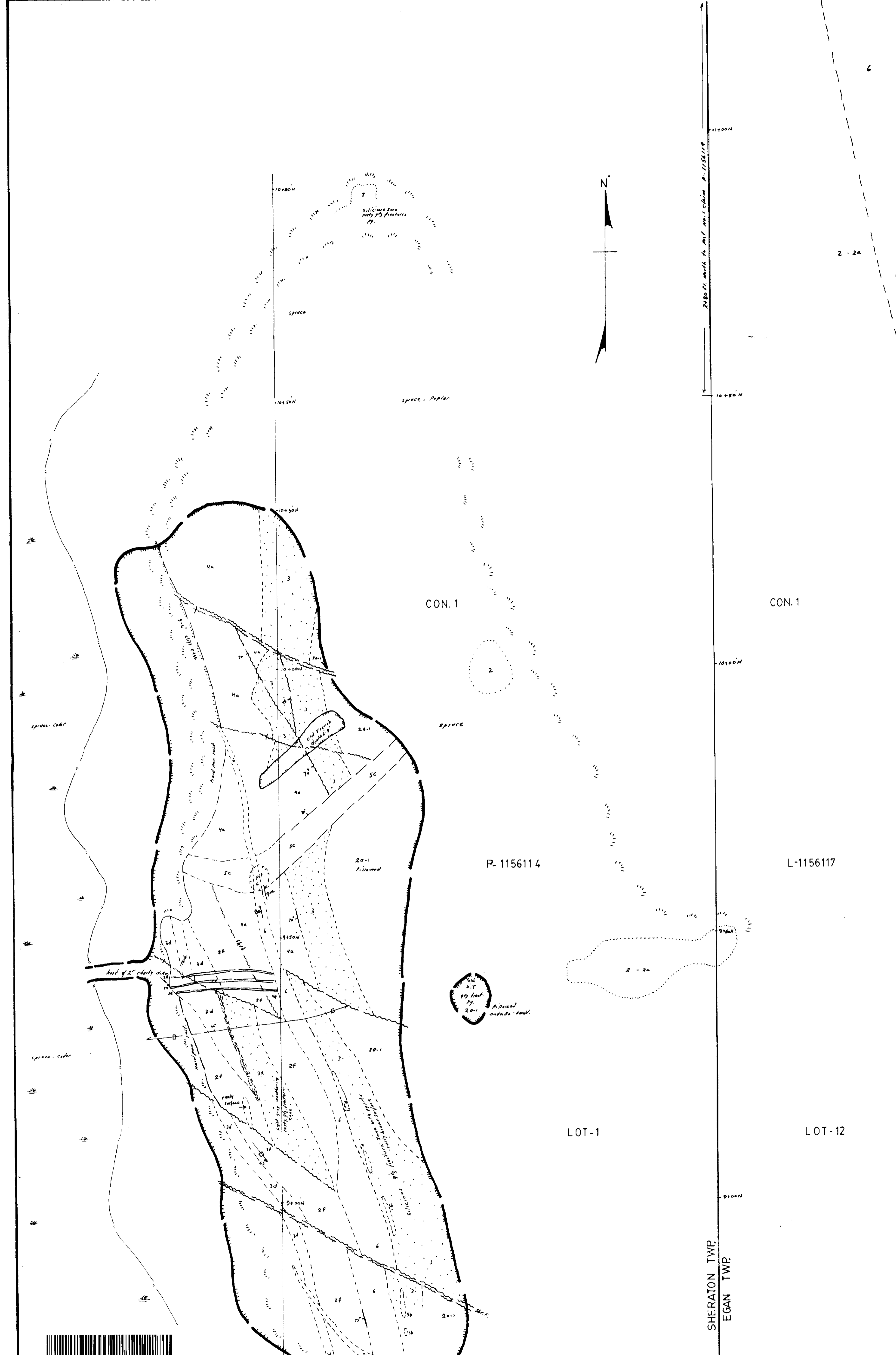

230

**GEOLOGICAL LEGEND**

- 6 quartz diorite, diorite
- 5 Hornblende syenite (S); Feldspar porphyry (SC); quartz Feldspar porphyry (SD); Lamprophyre (SP)
- 4 chlorite to. Gneiss (G); Peridotite (P); pyroxenite (PY)
- 3 rhyolite (undifferentiated); rhyolite (R); andesite (A); andesite (AN); andesite (AS); andesite (AD)
- 2 rhyolite (undifferentiated); rhyolite (R); andesite (A); andesite (AN); andesite (AS); andesite (AD)
- 1 rhyolite (undifferentiated); rhyolite (R); andesite (A); andesite (AN); andesite (AS); andesite (AD)
- 0.5 quartz veins, quartz fracture zone, pegmatite

**key map**

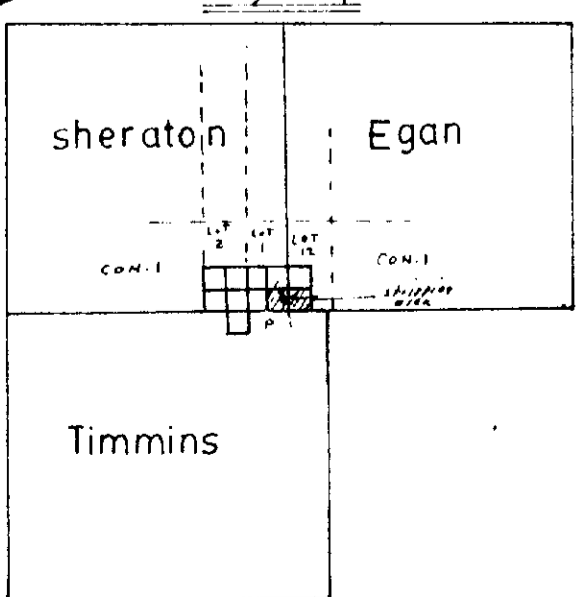

SHOWING AREA  
DEMARCHI EAST GROUP  
SHERATON & EGAN TWP.

STRIPPING AND GEOLOGICAL PLAN  
scale: 1" inch = 10' feet

63.5742  
OPAP PROGRAM - 1992

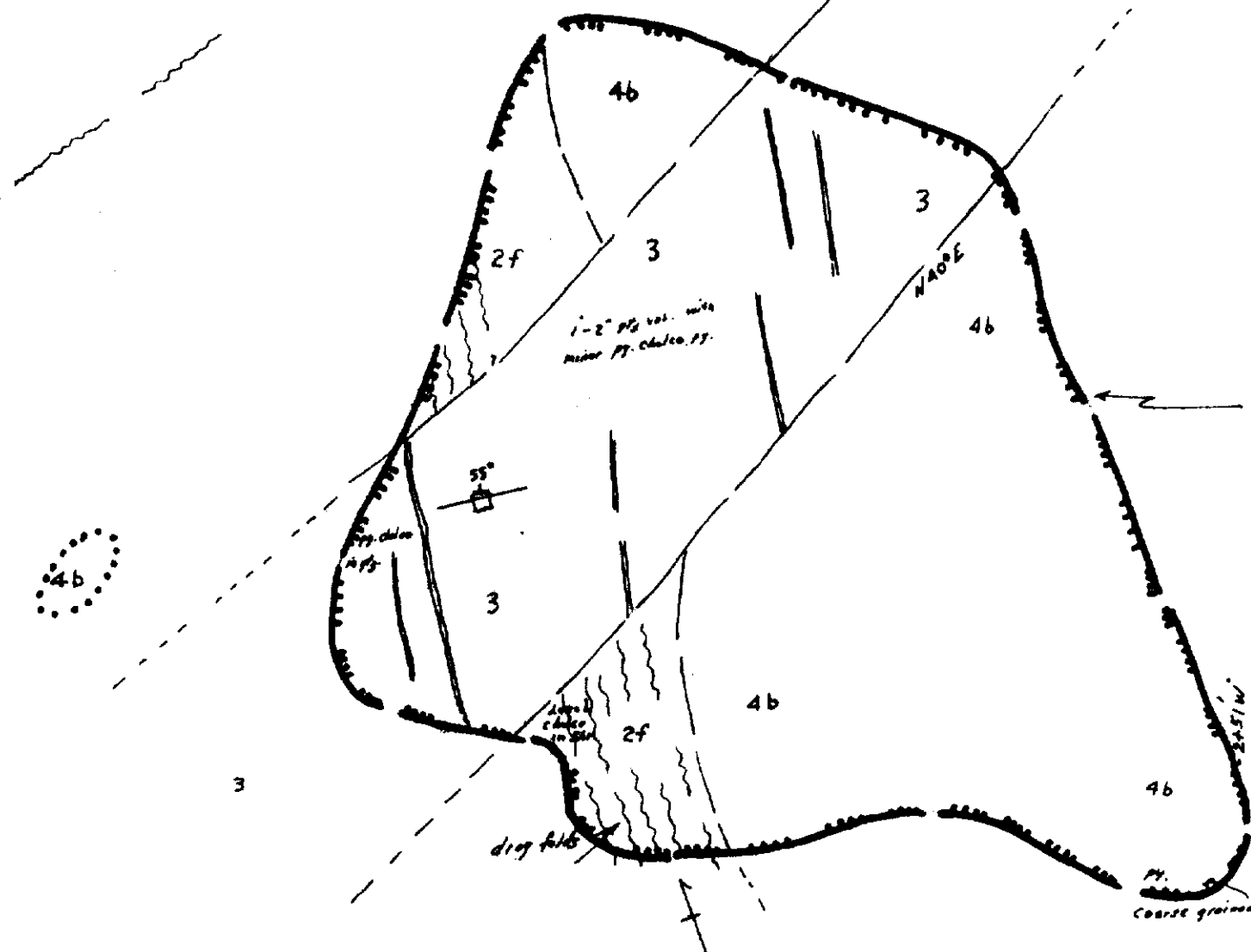
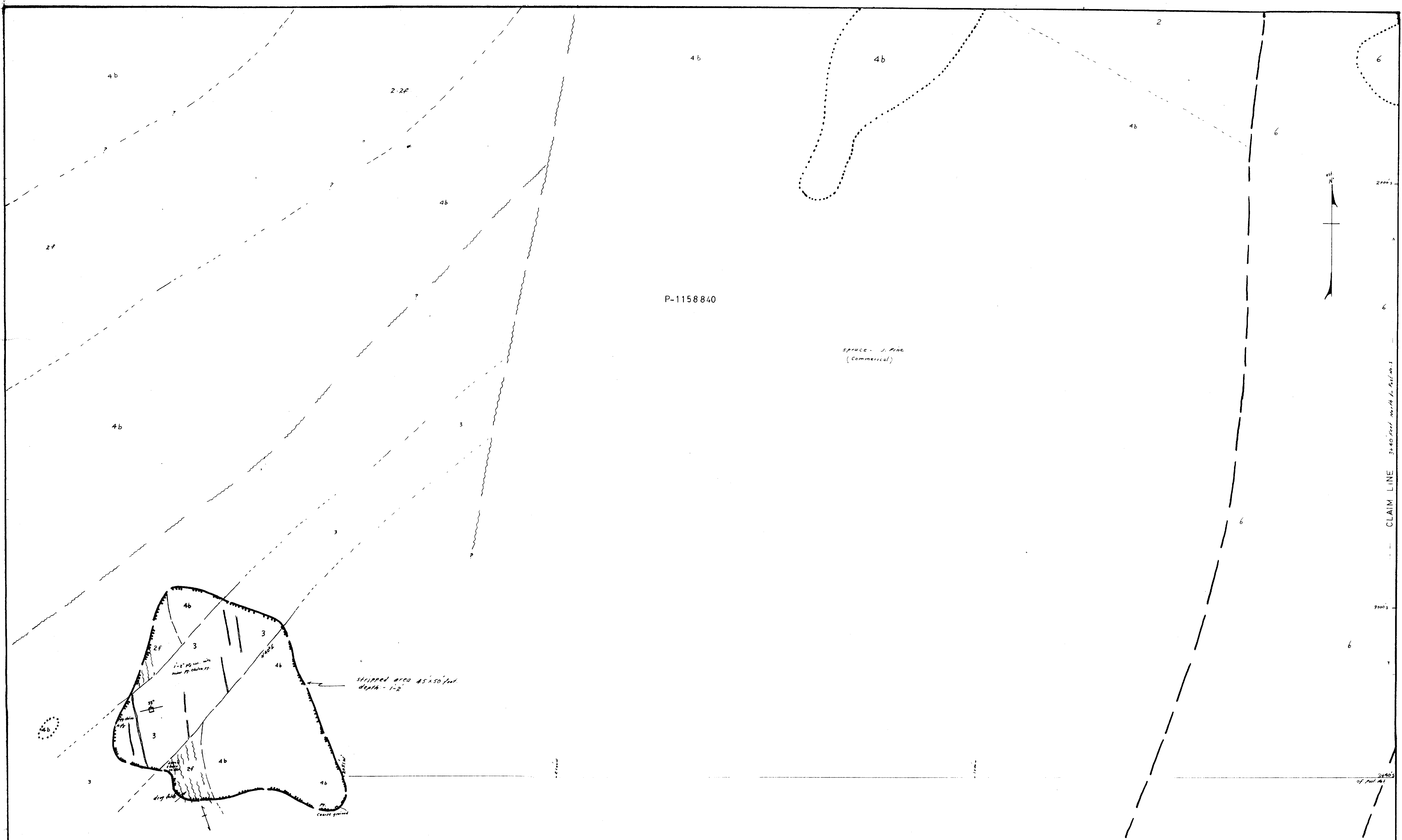

**GEOLOGICAL LEGEND**

- 6 quartz diorite, diorite
- 5 hornblende gneiss, feldspar gneiss, biotite gneiss, garnet gneiss, amphibole gneiss, quartzite, calcareous quartzite, gneiss, etc.
- 4 quartzite, calcareous quartzite, gneiss, etc.
- 3 felsic gneiss (undifferentiated), amphibole gneiss, feldspar gneiss, quartzite, etc.
- 2 igneous rocks, felsic gneiss (undifferentiated), amphibole gneiss, feldspar gneiss, quartzite, etc.
- c-6 diorite, quartzite, calcareous quartzite, etc.
- quartzite

**key map**

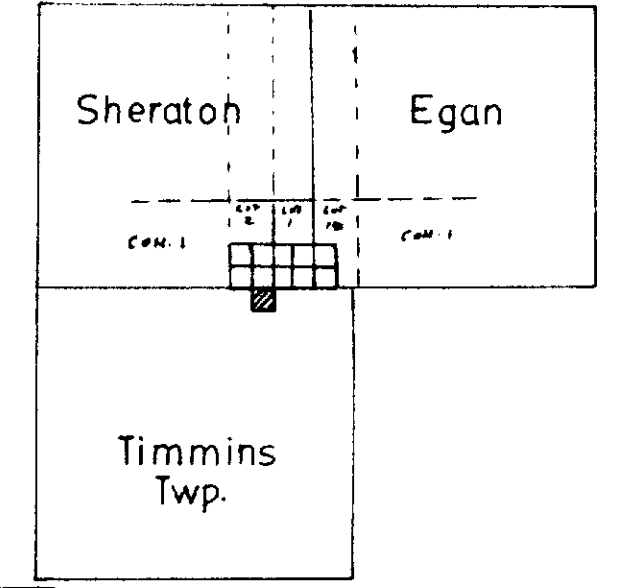

240

DEMARCHI WEST GROUP  
TIMMINS TWP.  
ONT.  
STRIPPING AND GEOLOGICAL PLAN  
scale 1" inch = 10' feet.

63.5742  
OPAP PROGRAM - 1992

CLAIM LINE 37-40 feet north of 21st St.

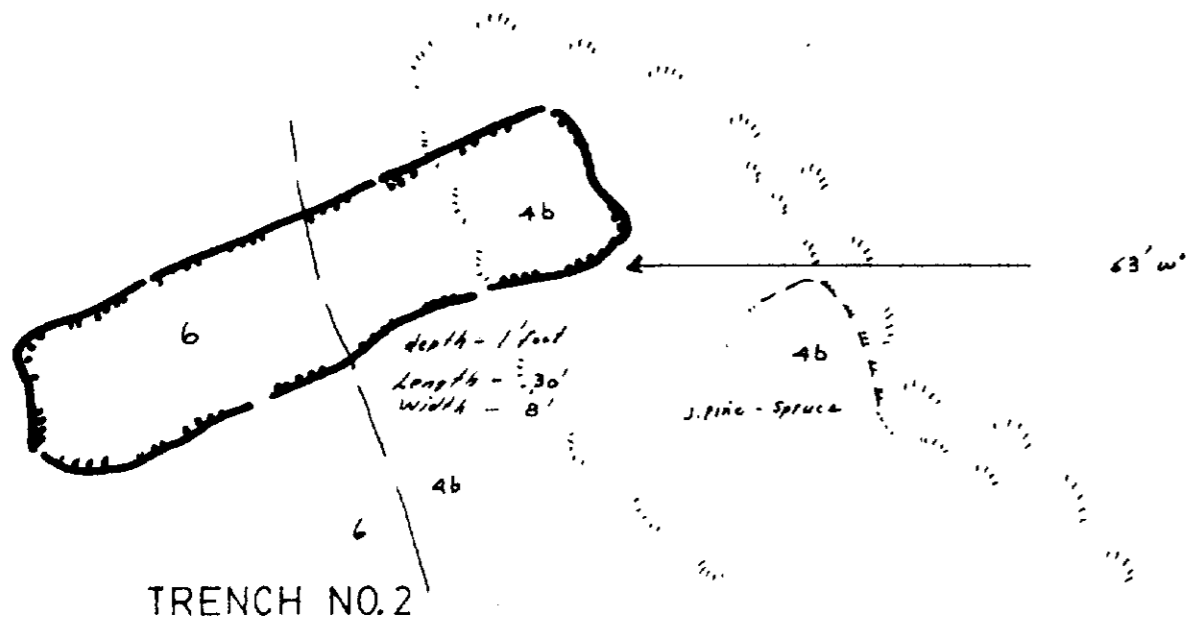

TRENCH NO.2

J. pine - Spruce  
Commercial

P-1158840

Sand - boulders

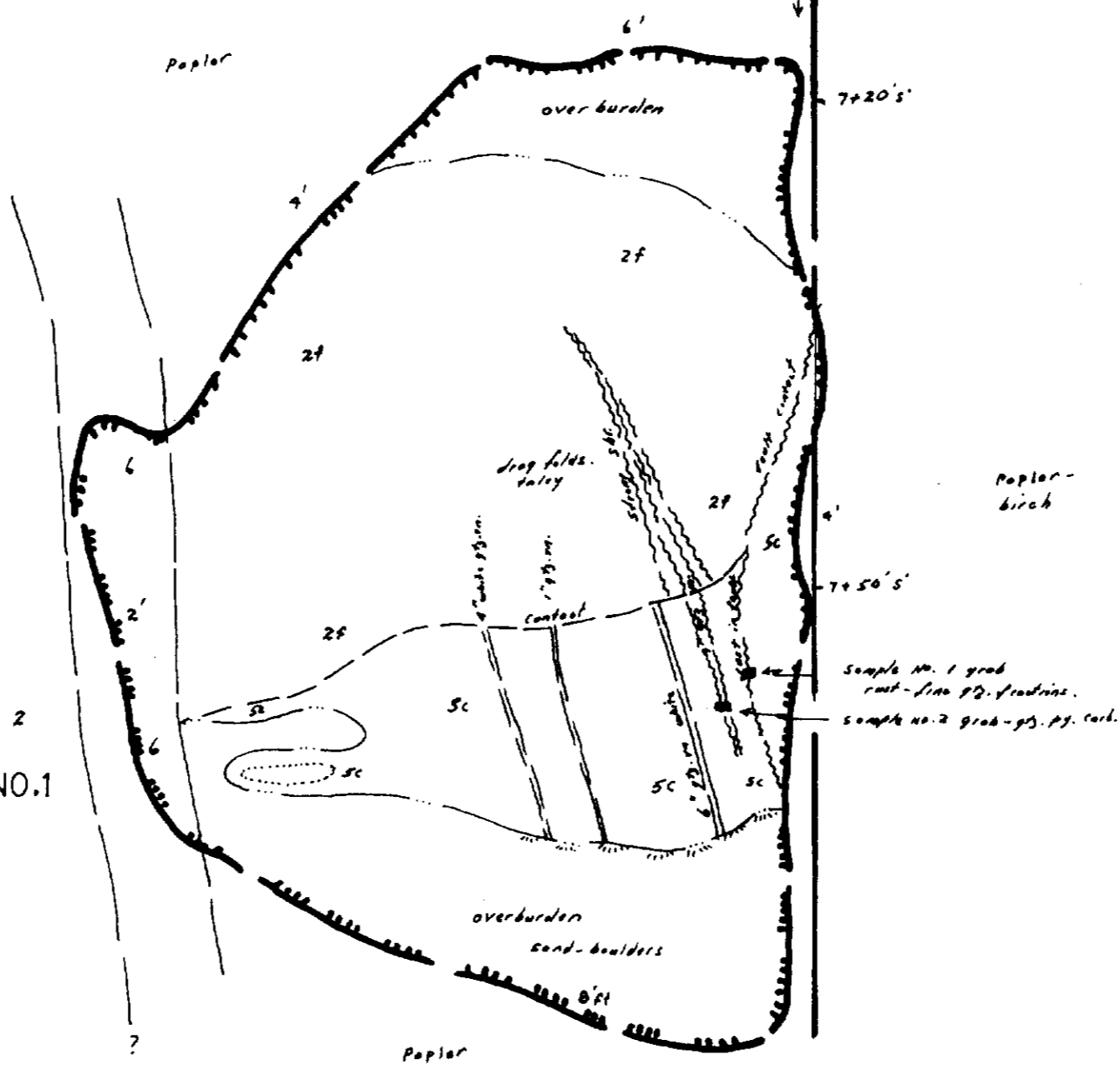

TRENCH NO.1

GEOLOGICAL LEGEND

- 6 quartz dike; diabase
- 5 Norwalkite spathite ss; Feldspar porphyry ss; quartz feldspar porphyry ss; lamp rock ss
- 4 diorite ss; basalt ss; peridotite ss; pyroxenite ss
- 3 Kilauea volcanics (undifferentiated) spathite ss; diorite ss; pyroxenite ss; sandy tuff ss
- 2 intermediate to basaltic volcanics (undifferentiated) pillow lava ss; andesite ss; basalt ss; diorite ss; subvolcanic ss; Tuff. clast ss; carbonate ss
- 6b quartz var.



250

key map

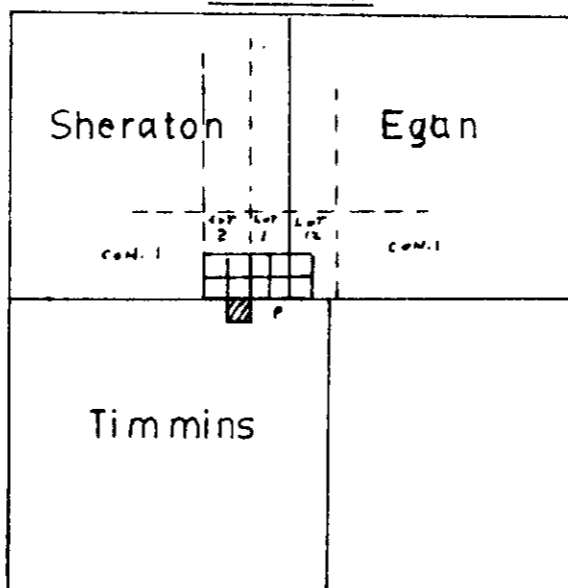

STRIPPING AND GEOLOGICAL PLAN

DEMARCHI WEST GROUP  
TIMMINS TWP  
ONTARIO

scale: 1" inch = 10' feet

Dimension: - 60' x 40' x 5' ft.  
Trench no. 1

63.5742

OPAP PROGRAM - 1992

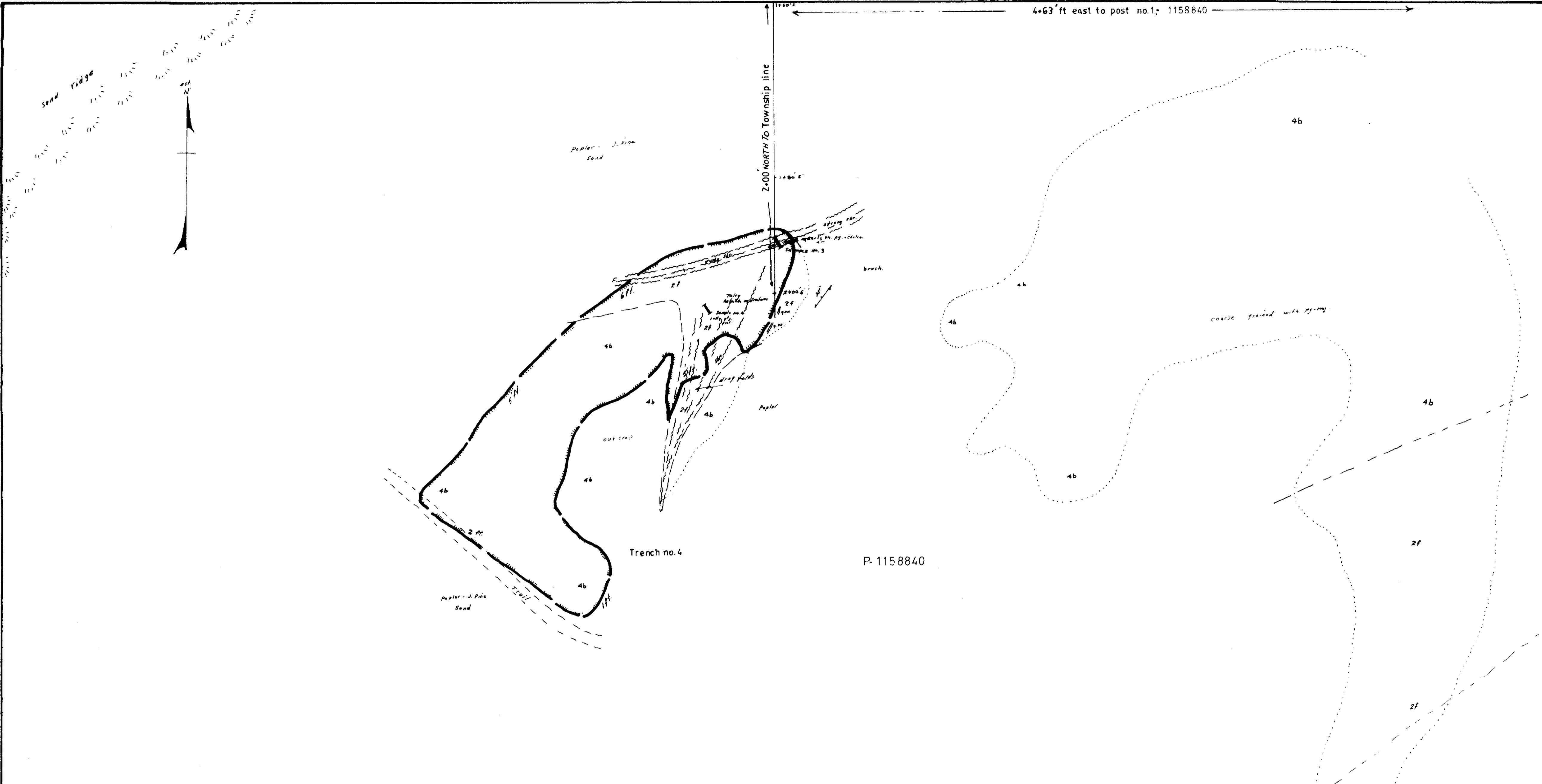

**GEOLOGICAL LEGEND**

- 6 quartz diabase, diabase
- 5 Hornblende syenite 5b; Feldspar porphyry 5c; quartz feldspar porphyry 5d; Long rapids 5f
- 4 diorite 4a; Gabbro 4b; peridotite 4c; Pyroxenite 4d
- 3 Alvin volcanics (undifferentiated); Alvinite 3a; dacite 3b; frag. mafic dms 3c; cherty tuff 3d
- 2 inter-mediate to basic volcanics (undifferentiated); Alvin dom 2a; quartzite 2a-1; basalt 2a-2; diorite 2a-3; spheroidal lambs; Tuff chert 2a; carbonate rock
- quartz veins

**KEY MAP**

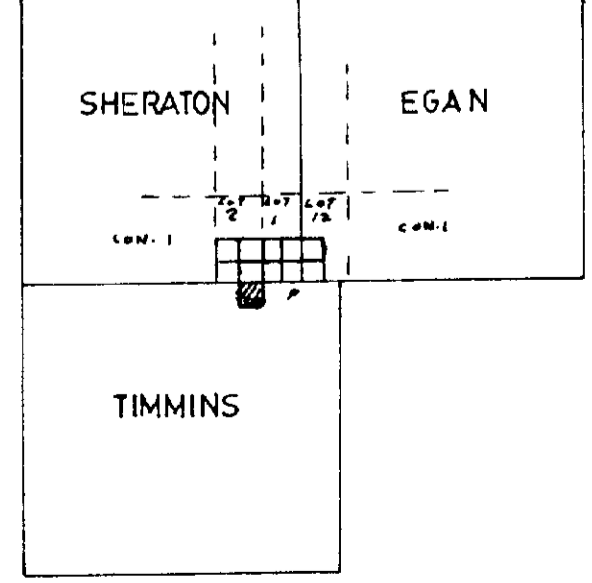

**STRIPPING AND GEOLOGICAL PLAN**

DEMARCHI WEST GROUP  
TIMMINS TWP.  
ONTARIO

SCALE 1" INCH = 10' FEET

DIMENSION: - 75' x 15' x 5' ±  
TRENCH NO. 4

635742

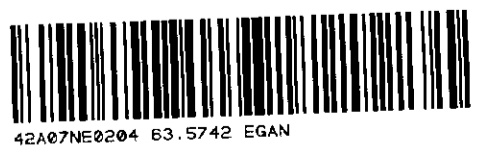

635742 July 27/92