



42A07SE0002 2.15515 SHERATON

010

**SUMMARY REPORT**

**OF THE**

**MAGNETOMETER SURVEY**

**MAPPING**

**AND**

**PROSPECTING**

**SHERATON TOWNSHIP**

**PARTS OF LOTS 1, 2 AND 3, CON 1**

**PORCUPINE MINING DIVISION**

2.15515

**JUNE 30, 1994**

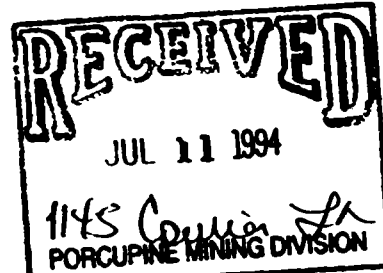

**RICHARD F. KALTWASSER**

*Richard F. Kaltwasser*



42A07SE0002 2.15515 SHERATON

010C

**TABLE OF CONTENTS**

	<b><u>PAGE</u></b>
<b>PROSPECTORS LICENCE</b>	<b>1</b>
<b>LETTER OF INTEREST</b>	<b>2</b>
<b>LOCATION MAP 1" = 4 MILES</b>	<b>3</b>
<b>PROPERTY PLAN SCALE 1 = 20,000</b>	<b>4</b>
<b><u>REPORT OF FIELD WORK 1993</u></b>	
<b>INTRODUCTION, PROPERTY , AND ACCESS</b>	<b>5</b>
<b>DETAILS OF SURVEY</b>	<b>5 - 6</b>
<b>RESULTS</b>	<b>6</b>
<b>MAPPING</b>	<b>7</b>
<b>CONCLUSIONS</b>	<b>7</b>
<b>BIBLIOGRAPHY</b>	<b>8</b>
<b>ASSESSMENT FOR 1994 WORK PROGRAM</b>	<b>9 - 10</b>
<b>ASSESSMENT BREAKDOWN</b>	<b>11</b>
<b>APPENDIX: INVOICES</b>	<b>12 - 23</b>
<b>*** GEOLOGY MAP OF SHERATON CLAIM GROUP 1 = 25,000 UNCOLOURED</b>	
<b>*** MAGNETOMETER SURVEY OF SEVEN CLAIMS SHERATON TOWNSHIP 1 = 25,000 UNCOLOURED</b>	



Ministry of  
Northern Development  
and Mines

Ministère du  
Développement du Nord  
et des Mines



Recognizing more than 25 years of contribution  
En reconnaissance de plus de 25 ans de service

*Richard F. Kalthwasser*  
Signature

(Not valid unless signed - non valide sans la signature)

1. No person shall prospect on Crown Lands or state land, renew or apply to renew the holding of a mining claim unless a holder of a prospector's licence issued under the Mining Act.
2. Licencee to notify Mining Registrar of any change in address.
3. Applications and payment for renewal must be made 60 days before licence's expiry date.

1. Il est interdit à une personne qui n'est pas titulaire d'un permis de prospecteur délivré en vertu de la Loi sur les mines de prospecter des terres de la Couronne, de planifier et d'entretenir un claim et de présenter une demande d'arrangement de paiement d'un claim.
2. Le titulaire du permis doit aviser le registraire de claim de tout changement d'adresse.
3. Les demandes et les droits de renouvellement doivent être envoyés 60 jours avant la date d'expiration du permis.

Under the Mining Act and the regulations and subject to the limitations thereof, this Prospector's Licence is issued. En vertu de la Loi sur les mines et des règlements adjoints, et sous réserve des restrictions qui s'y appliquent, le présent permis de prospecteur est délivré au titulaire.

DAVID DEMARCHI  
BOX 1261  
SOUTH PORCUPINE, ONTARIO  
P0N 1H0

*July 6, 1992*

*To Whom It May Concern:*

*Re: Sheraton, Egan and Timmins Township Claim Group*

*Richard F. Kaltwasser and David DeMarchi both hold fifty percent (50%) interest in all the claim group in Sheraton, Egan and Timmins Township.*

*Sincerely Yours,*

*David DeMarchi*

*David DeMarchi*

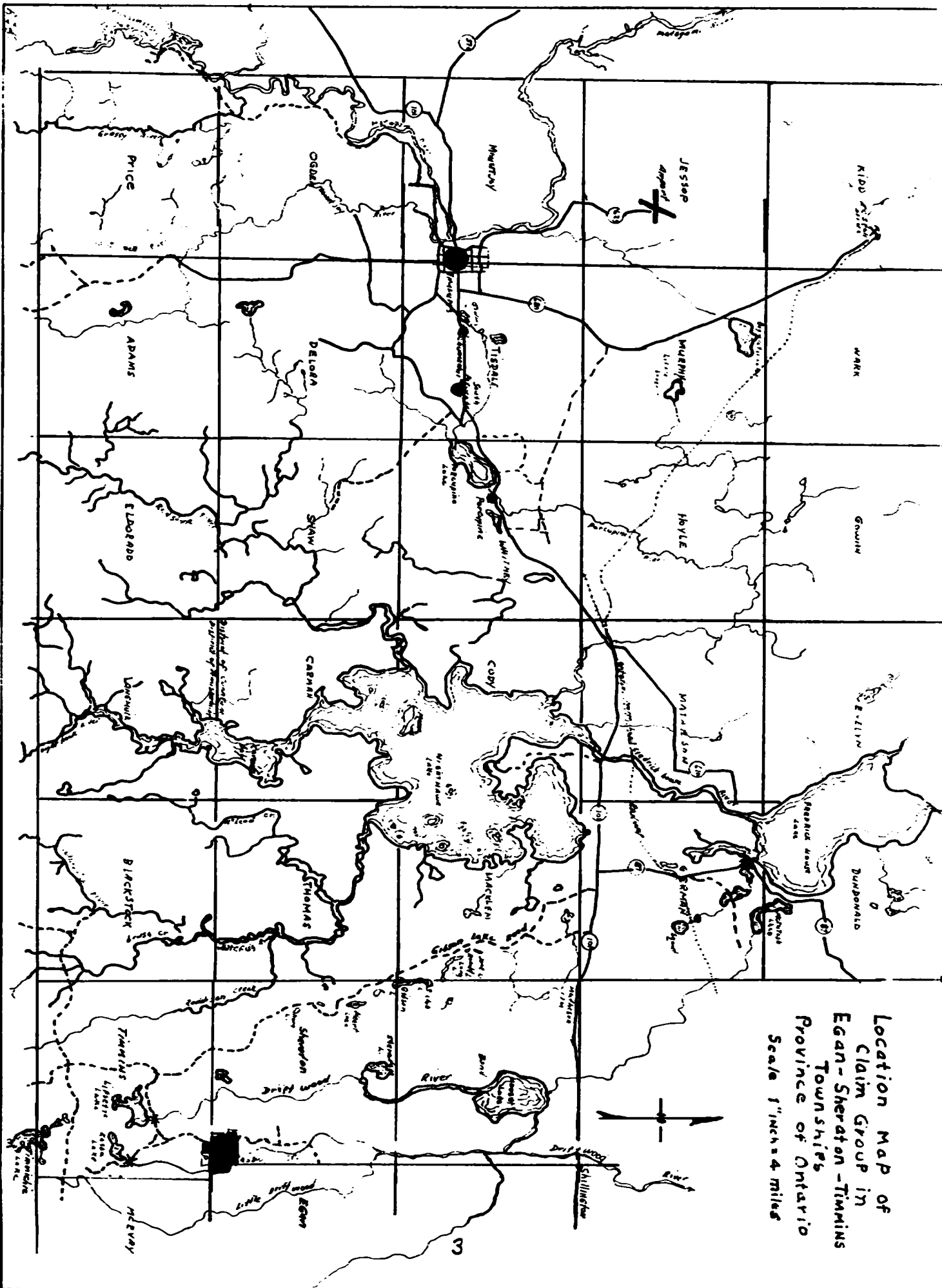

Location Map of  
 Claim Group in  
 Egan-Sheraton-Timmins  
 Townships  
 Province of Ontario  
 Scale 1"=4 miles

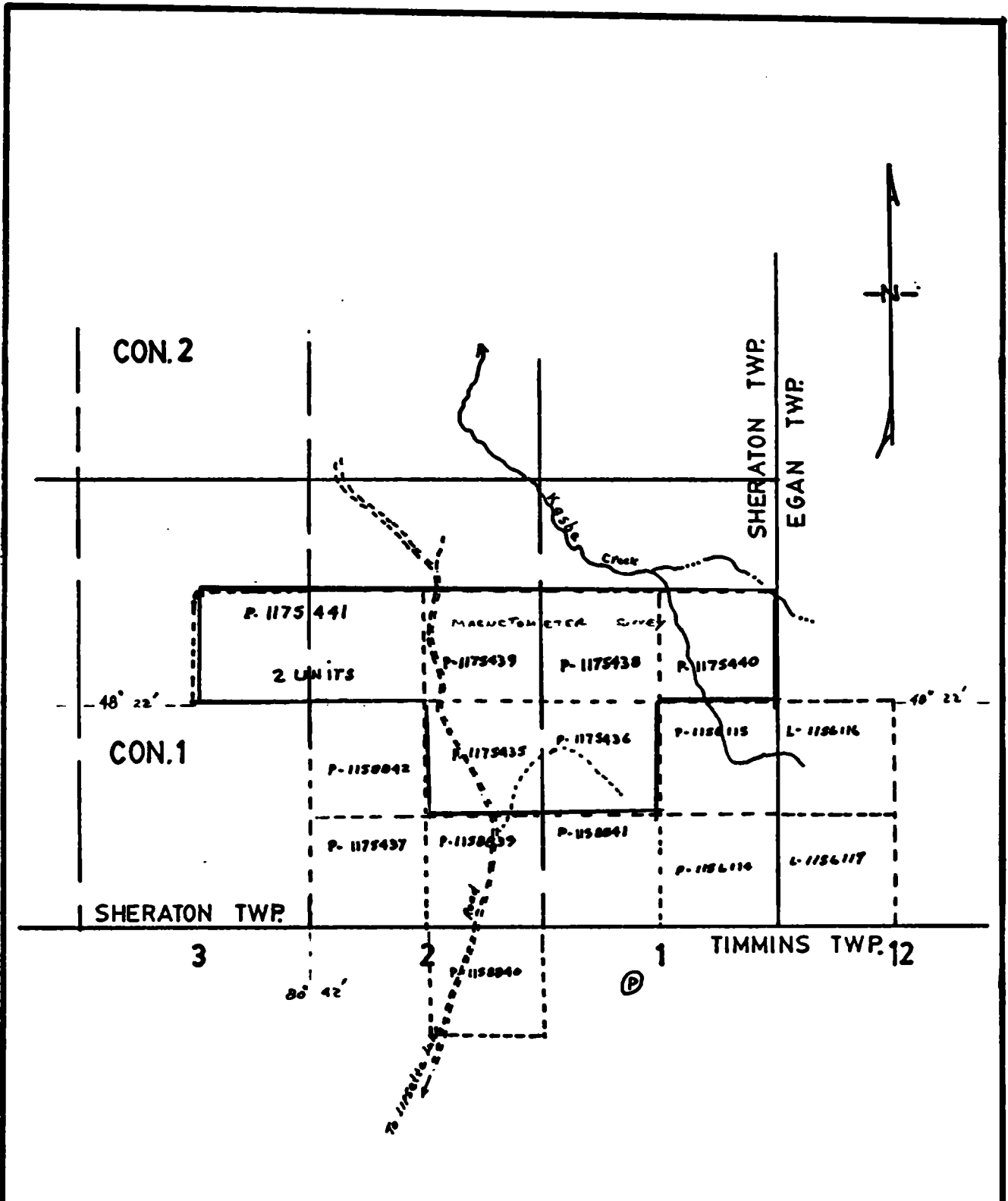

**PROPERTY PLAN**  
 SHOWING CLAIM GROUP  
 EGAN-SHERATON-TIMMINS TWPS.  
 PROVINCE OF ONTARIO  
 SCALE: 1:20,000

March 1996 *ATK*

# **REPORT OF WORK FOR ASSESSMENT FOR FIELD SEASON 1993**

## **INTRODUCTION**

The following report describes the assessment work completed on seven claims, during the field season of 1993. Work is due on July 31st, 1994 on claims number P-1175438 - 39 and also work due August 24 th, 1994 on claims number P-1175440 and two units P-1175441. The survey was extended to cover two claims south of the for mentioned group being P-1175435 and P-1175436.

This block was acquired to cover the possible strike of the known gold showing in the south east portion of Sheraton Township.

A ground magnetic survey and geological mapping was conducted as a follow-up to possibly outline further target zones.

## **PROPERTY**

Formally the group consisted of eleven (11) unpatented contiguous mining claims for a total of approximately 440 acres. In 1992 three (3) single units on one (1) two unit claims was staked increasing the acreage to 640 acres.

The claim group is situated in the south east corner of Sheraton Township in Lots 1-2-3, Con 1 Porcupine Mining Division.

Two (2) claims in Egan Township are situated in south west corner of Lot 12, Con 1. Larder Lake Mining Division.

## **ACCESS**

The property is reached by a gravel road (Gibson Lake), which branches off to the south from Highway 101 West approximately 18 miles from Matheson, Ontario.

This road leads south to Lipsette Lake road a distance of 19 miles from the highway, branching off to the east for two miles to Lipsette Lake, and continues east and north for another three miles to the property. Total distance from Matheson to property 42 miles.

## **DETAILS OF SURVEY**

The required grid was cut by the writer over seven (7) claims of the group being claim numbers P-1175435-36-38-39 - 1175440 and 2 unites P-1175441.

The lines were oriented geographic north - south, cut chained and picketed. Line spacing was every 100 meters apart and picketed at 30 meter intervals along lines. A base line was cut east west for total of 1850 meters. Total meters of picket line cut and

## DETAILS OF SURVEY(continued)

chained 10,505 meters.

Two base stations were set one at L- 0+00 and L- 5+00E using station at 0+00 for control of survey, B. C. S. #1 986 gammas. Base stations were checked out several times during each day, diurnal variations were plotted from field notes on a graph at completion of survey for possible  $\pm$  variations. A total of 734 readings were taken.

The magnetic survey of this grid was completed with a McPhar M-700 Magnetometer Vertical field fluxgate Serial Number 6604.

The magnetic survey was conducted by operator David Rice of Holtyre, Ontario and assisted by Kevin Daigle of Matheson, Ontario a student hired for the summer field season of 1993. Station readout every 15 meters and 7.5 meters over magnetic highs. Results were plotted on a map with scale of 1:25,000 and contoured at 100 gamma intervals.

## RESULTS

The magnetic response covers a wide range of values for a small area and offers much information about the sub-surface.

Interpretation of the magnetometer survey shows possibly five lithological units by the various magnetic responses and linear nature from outcrop observations.

Several high angle faults were observed with a NW-SE trend, these are shown on the map by a (T), magnetic interpreted faults are shown by a (M). Several east west shears were observed and mineralization occurs near the intersection of NW high angle faults.

The claim group is underlain by undifferentiated meta - volcanics and cut by a swarm of North - South trending Matachewan diabase dikes.

Two target areas A - B on geological map deserve further attention for favourable potential mineralization.

Target A is cut by two NW-SE trending faults, and east west shears show alternation and mineralized with pyrite, minor chalo-pyrite with quartz fractures. Several magnetic highs and lows are situated in this area.

Target B is situated in the north east corner of the group and lies between two diabase dikes. Volcanics are sheared and intruded by syenite dikes and generally strike north south.

The volcanics are altered with minor fine pyrite and magnetite occurs along flanks of the diabase dike.



## MAPPING

Detail mapping of the claims was completed and plotted on a scale of 1:25,000 assisted by Kevin Daigle and David Rice.

Unit 2 is mainly basic to ultra basic rocks, dark, fine grained and moderately magnetic local weak iron formations are associated with this unit.

Unit 3 Represents the intermediate volcanic sub group and mainly light coloured felsic tuffs and dacite flows and generally altered with a low magnetic response. Pyrite and chalcopyrite along with quartz veining is associated in this horizon and should be checked out for favorable mineralization.

Unit 5? is interpreted as possibly a granitic plug as magnetics are low, although no outcrops were seen.

Unit 6 is a swarm of Matachewan diabase dikes trending N - S across the claim group and probably represent old crustal weakness within the area.

## CONCLUSIONS

From the magnetic results a target area of alteration lies between lines 1 W to 3 E and should be checked for possible mineralized zones. Gold occurrence are known to be associated with this type of mineralization found on claim P-1156114 Sheraton Township south east corner.

A Geo-chemical survey ( soils ) will be conducted over this area, along with mechanical trenching in the target area, during 1994 field season.

Submitted by:



Richard F. Kaltwasser

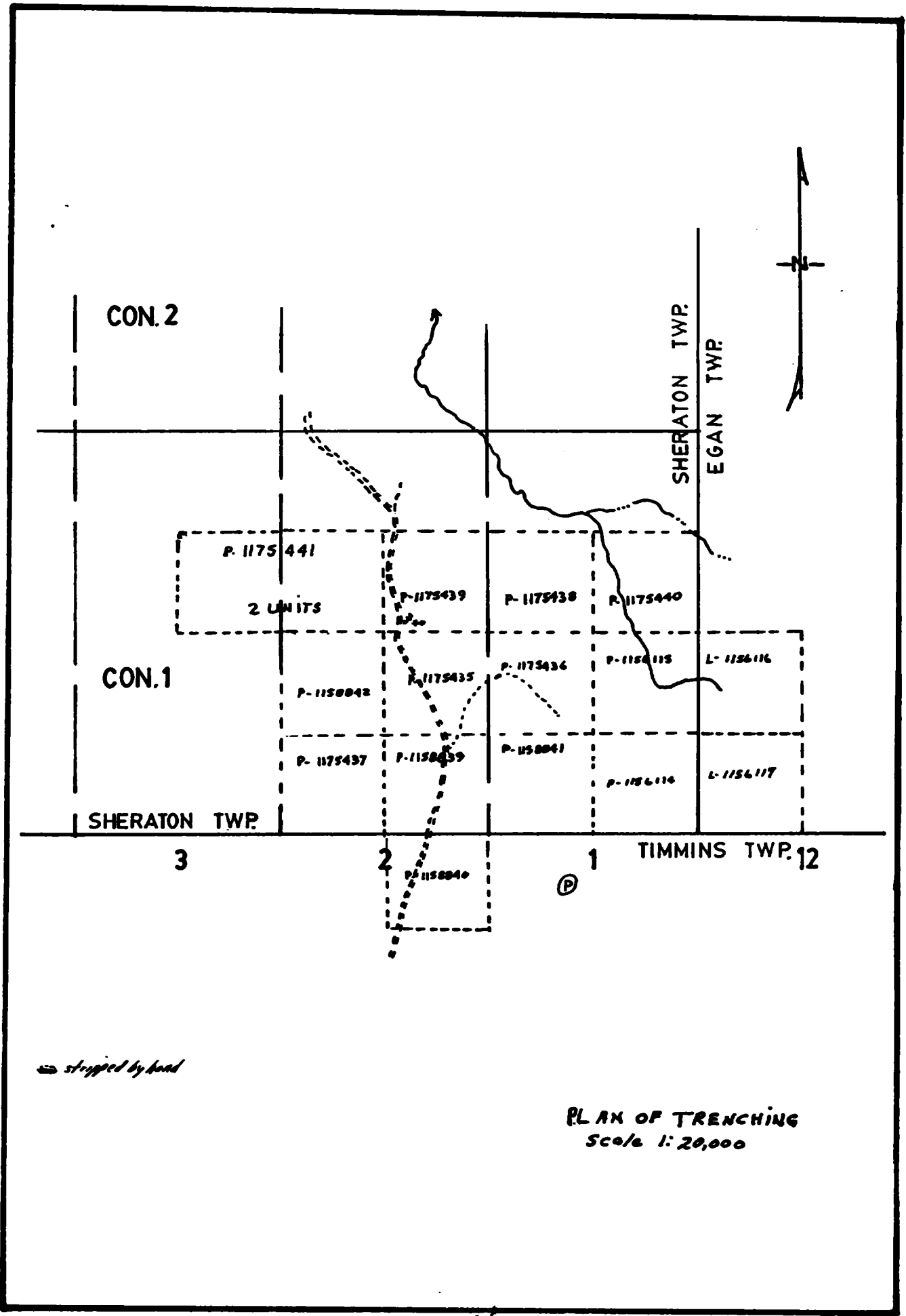

## **BIBLIOGRAPHY**

### **ASSESSMENT:**

**Office Ministry of Northern Development and Mines, Timmins Branch**

**File No. T-277 Blanchette Porcupine Gold Mines 1936**

**File No. T- 1754 Morin- Laroche Group 1975**

**File No. T-1856 Blanchette Group Manville Canada 1984**

**File No. T-3309 Kinex Resource**

**File No. T-3230 T. McAllaster Property 1988**

### **REPORTS ONTARIO BUREAU OF MINES**

**Porcupine Gold Area- Twentieth Annual Report  
Part II A. G. Burrows 1911**

**Night Hawk Gold Area Twenty Third Annual Report  
Part III 1924**

**Geology of Langmuir- Sheraton Area Fourty ninth  
Annual Report Part IV L. G. Berry 1940**

**ASSESSMENT FOR 1994**  
**(WORK PROGRAM OF 1993 SEASON)**

**WORK SCHEDULE AND DATES:**

**Prospecting and Supervision:**

**Direct Costs:**

All work is based on 7 hour days.

June 1st to August 30th, 1993.

Richard Kaltwasser:

448 8th Avenue, Matheson, Ontario. P0K 1N0

supervision and report	15 days x \$ 87.50 =	\$1,312.50	
line cutting	126 hours x 12.50 =	1,575.00	
prospecting	56 hours x 12.50 =	700.00	
mapping	42 hours x 12.50 =	<u>525.00</u>	\$4,112.50

**David Rice:**

General Delivery, Holtyre, Ontario. P0K 1C0

Hired under Futures Program with Northern College,  
 South Porcupine Campus.

magnetometer operator	70 hours x 6.35 =	444.50	
chaining	126 hours x 6.35 =	800.10	
labour	91 hours x 6.35 =	577.85	
drafting	42 hours x 6.35 =	<u>266.70</u>	2,089.15

**Kevin Daigle**

315 4th Avenue, Matheson, Ontario. P0K 1N0

Hired under NorTop Grant as an assistant helper.

chaining	126 hours x 6.35 =	800.10	
magnetometer assistant	70 hours x 6.35 =	444.50	
labour	49 hours x 6.35 =	311.15	
drafting	19 hours x 6.35 =	120.65	
vacation pay		<u>67.00</u>	<u>1,743.40</u>

<b>Total Prospecting and Supervision</b>			<b>7,945.05</b>
--	--	--	-----------------

**CONTRACTORS:**

**Ardianne Enterprises, 448 - 8th Avenue, Matheson, Ontario  
P0K 1N0**

**word processing and photocopies 100.00**

**INDIRECT COSTS:**

<b>Invoice No.:</b>	<b>Company:</b>	<b>Amount:</b>
<b>42688</b>	<b>Radio Shack</b>	<b>\$ 39.24</b>
<b>7691</b>	<b>Ginn-McLean Hardware Ltd.</b>	<b>63.83</b>
<b>10833</b>	<b>Write Shoppe</b>	<b>7.08</b>
<b>10956</b>	<b>Write Shoppe</b>	<b>6.98</b>
<b>9353</b>	<b>Ginn-McLean Hardware Ltd.</b>	<b>168.35</b>
<b>12643</b>	<b>Porcupine Canvas Inc.</b>	<b>25.30</b>
<b>4645</b>	<b>Mallory Auto Service &amp; Repair</b>	<b>869.99</b>
<b>P5F 4100</b>	<b>Esso Statement</b>	<b>25.00</b>
<b>P5F List</b>	<b>Esso Statement</b>	<b>56.00</b>
<b>P5F List</b>	<b>Esso Statement</b>	<b>203.56</b>
<b>P5F List</b>	<b>Esso Statement</b>	<b><u>140.85</u></b>
<b>Total Indirect Costs</b>		<b>\$1,606.18</b>
<b>Total Direct Costs</b>		<b>8,045.05</b>
<b>Less Reimbursement NorTop</b>		<b><u>( 871.72)</u></b>
<b>Total Direct and Indirect Costs</b>		<b>\$8,779.51</b>
		<b>-----</b>
<b>Rounded to Nearest Dollar</b>		<b>\$8,780.00</b>
		<b>-----</b>

**ASSESSMENT BREAKDOWN**

**SHERATON TOWNSHIP**

**TOTAL EXPENDITURE: \$8,780.**  
**-----**

**SHERATON:**

( 7 CL. ) No. P-1175435	P-1175436
P-1175438	P-1175439
P-1175440	
(2 Units)       P-1175441	

**Breakdown as follows:**

(2 CL.) No. P-1175435	P-1175436	1,883.
Banked.		

( 3CL.) No. P-1175438	P-1175439	
P-1175440		
Value assigned @ \$1,200 each		3,600.

(2 Units) No. P-1175441		
Value assigned		<u>2,000.</u>

Value applied to (5 claim units)		5,600.
----------------------------------	--	--------

Reserved banked		<u>1,297.</u>
-----------------	--	---------------

<b>Total Banked</b>		<b><u>\$3,180.</u></b>
		<b>-----</b>

ARDIANNE ENTERPRISES  
 MANUAL & COMPUTERIZED ACCOUNTING  
 446 8TH AVENUE  
 BOX 34  
 MATHESON, ONT. POK 1N0  
 705-273-3088

Statement  
 18694

DATE *JUNE 24, 1994*  
 TO  
 • *KALEX*  
 • *MATHESON, ONTARIO*  
*POKIND*

TAX REG. NO.

Please detach and return upper portion with your remittance.

\$

DATE	CHARGES AND CREDITS	BALANCE
<i>JUNE 23/94</i>	<i>TYPING, COMPUTER PRINTING</i>	<i>100.<sup>00</sup></i>

*part*  
*charge \$ 40*

BLUELINE 2 4113 50 Pkg. 0 5510 250 Pkg.

YOUR CHECK IS YOUR RECEIPT

1  
 DUP

# Radio Shack

DIVISION INTERMEDIARY CANADA LTD/LTEE  
 DOWNTOWN - 05-5326  
 36 PINE STREET SOUTH  
 TIMMINS, ON P4N 2J8  
 705-267-1677

SALES TRANSACTION  
 TRANSACTION DE VENTES

36842688

DATE: Apr 13/93 TIME: 2:39pm SALESMAN: G. BELL TRANSACTION TYPE/METHODE DE VENTE: AST NGR CASH  
 SOLD TO / VENDU A: DIANNE KALTWASSER  
 ARDIANNE ENTERPRISES  
 BOX 34  
 MATHESON, ON  
 P0K 1N0

SUCCESSOR / SUCCESSEUR: 5326842688

REFUND/CUSTOMER ACCOUNT NO. AUTHORIZATION NO. EXPIRY DATE METHOD SHIPPED PHONE NO. FAX NO. TELEPHONE NO.  
 842466 03/27/93 273-3066

QUANTITE	DESCRIPTION	UNIT PRICE	EXTENSION
Part(s) Sales			
B DEPOSIT	BATTERIES	-1	5.00
B CNB-276	9V BATTERIES	2	19.56
Purchased at Store 05-5326			39.12
Original Salesmaker: M. ROGERS			SALES

MERCHANDISE RETURNED FOR CREDIT REFUND OR EXCHANGE MUST BE IN NEW AND RE-SALEABLE CONDITION IN ORIGINAL CONTAINERS WITH ORIGINAL PACKAGING AND MUST BE RETURNED WITHIN 30 DAYS OF PURCHASE DATE. ALL RETURNS MUST BE ACCOMPANIED BY ORIGINAL RECEIPT AND ORIGINAL SALES TAX RECEIPT. MERCHANDISE RETURNED FOR CREDIT REFUND OR EXCHANGE MUST BE IN NEW AND RE-SALEABLE CONDITION IN ORIGINAL CONTAINERS WITH ORIGINAL PACKAGING AND MUST BE RETURNED WITHIN 30 DAYS OF PURCHASE DATE. ALL RETURNS MUST BE ACCOMPANIED BY ORIGINAL RECEIPT AND ORIGINAL SALES TAX RECEIPT.

SUB-TOTAL: 34.12  
 GST: 2.39  
 TOTAL AMOUNT / MONTANT TOTAL: 39.24

Security code: 30589  
 Tended: Cdn. \$ 50.24 CHANGE: \$ 11.00

GST #R102617521

MANAGER AUTHORIZATION / AUTHORISATION DU GERANT: \_\_\_\_\_  
 CUSTOMER SIGNATURE / SIGNATURE DU CLIENT: \_\_\_\_\_  
 Distribution: Top Copy - Store, Bottom Copy - Customer







# The Write Shoppe

Stationery • Office Supplies • Carlton Cards

G.S.T. #R 129-256-061

Box 546 - 173 Third Ave.  
Timmins, ONT. P4N 7E7  
Telephone (705) 268-6131  
Fax (705) 268-6196

10956 INVOICE NO
DATE MAY 7/93

MUNIE ENTERPRISES  
Box 34  
EIGHTH AVE  
TIMMINS ONT POK 1N0

S  
H  
I  
P  
T  
O

NO	YOUR ORDER NO	VIA	TERMS	PST NO	SALESMAN NO	
		REGULATOR	2% 15 Net 30 Days		VICTOR	
QTY SHIPPED	DESCRIPTION			U/M	PRICE	AMOUNT
1	SC LES DEAN PAPER BOOK			EA		6.75
	LES 1070					68
	<p>11/17/93 13/43 481</p>					
	SUB-TOTAL					6.07
	GST					42
	PST					49
	NET TOTAL					6.98

PLEASE PAY BY INVOICE - NO STATEMENT WILL BE ISSUED

2% PER MONTH CHARGED ON OVERDUE ACCOUNTS  
MINIMUM CHARGE SALE ALLOWABLE \$5.00

PAY WITHIN 2  
DAYS OF INVOICE  
30 DAYS IN

ON RETURNED GOODS White - Customer Canary - Office Pink - Packing Slip

Perdue-De Advance Printers Ltd. Timmins E 122





MAIL CO AUTO SERVICE & REPAIR  
 GST #R12345678  
 451 R. Highway Street  
 MATHESON, ONTARIO L0K 1N0  
 Bus (705) 273-2031 Res (705) 273-2771

4645

Aug 13/93

Falder  
 "brk."

AM

M. Matheson Ont FUK INO  
 74 chery 4 truck

273 - 2733  
 735 392  
 m.c.m.  
 97043.9

SERVICES REQUESTED / DESCRIPTION OF WORK

90 day warranty

re + re rear end  
 re + re shocks  
 re + re brake cables + bushes  
 4 wheel cyl.

4502 221 441 718

DO NOT WRITE ABOVE THIS LINE - NE REN ECRIRE AU-DESSUS DE CETTE LIGNE

DATE 01243

ALPHEE	TAKEN
RAYON	DELIVERED
CLERK	BY
COMMAN	RAYON

CUSTOMER COPY

DESCRIPTION	AMOUNT	AMOUNT
CAR REPAIRS	756.51	
TAX	52.96	
CDN CAN	60.52	
TOTAL	869.99	

*Technique Matheson*  
 MATHESON MATHESON MATHESON

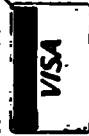

38.00

TOTAL LABOUR

QTY.	PART NUMBER	DESCRIPTION	CODE	UNIT	AMOUNT
1		weld rear end	U		350.00
2	NPN	wheel cyl	N	41.19	82.38
		SPONGE BEAR END (BOOTS)			48.40
2	NPN	shocks	N	36.00	72.00
2	NPN	brake cables	N	25.38	50.76
1	NPN	chold down kit	N	10.68	10.68
1	NPN	brake chock	N	28.29	28.29

TOTAL PARTS 649.51  
 TOTAL LABOUR 414.00  
 OUTSIDE REPAIRS  
 GAS, OIL & GREASE

SUBTOTAL 756.51  
 GST 52.96  
 PSI 60.52  
 TOTAL 869.99

TOTAL GAS, OIL & GREASE

1. This receipt is valid only for the repair work described on this receipt. It is not valid for any other work. An original receipt must be presented to the shop for the amount of the repair work to be covered. This receipt is not valid for any other work. The receipt is not valid for any other work. The receipt is not valid for any other work.

You're on your way with Esso.



Partez en grand avec Esso.

FOR CUSTOMER SERVICE CALL 1-800-268-6287

NUMÉRO SANS FRAIS, SERVICE À LA CLIENTÈLE

PAGE 01 OF 01

STATEMENT DATE 93 05 14

PAYMENT DUE BY 93 06 04

ACCOUNT NO. 2510183375

PURCHASE DATE M/D DATE D'ACHAT M./J.	CARD NO. N° DE CARTE	INVOICE NO. N° DE FACTURE	DETAILS/DÉTAILS	AMOUNT MONTANT
05 08	000	P5F 4100	HIGHWAY 11 NORTH MATHESON ON	25.00
			SUB-TOTAL	25.00

*Truck.*

*KAL EX*

OUR "STRIPES SHOPPING SERVICE" HAS THE "TOTAL SATISFACTION GUARANTEE": EVERY ITEM PURCHASED COMES WITH (1) A 30-DAY FREE HOME TRIAL, (2) A MINIMUM 1-YEAR WARRANTY AND (3) OUR PROMISE OF COMPETITIVE PRICING. FOR YOUR SUMMER 1993 "STRIPES" CATALOGUE, PLEASE CALL 1-800-563-0878 (IN TORONTO, CALL 510-2063). YOU'RE ON YOUR WAY WITH ESSO.

PREVIOUS BALANCE 0.00 S.O. DE REPORTÉ	PAYMENTS/CREDITS 0.00 PAIEMENTS/CRÉDITS	DEBIT ADJUSTMENTS 0.00 REDOUBLEMENTS	UNPAID BALANCE 0.00 SOLDE IMPAYÉ	PURCHASES/CHARGES 25.00 ACHATS/FRAIS	CREDIT CHARGE 0.00 FRAIS DE CRÉDIT
---	---	--	--	--	--

See reverse side for payment terms

Voir les conditions de paiement au verso

Include ACCOUNT NUMBER and INVOICE NUMBER on all inquiries

Indiquer le NUMÉRO DE COMPTE et le NUMÉRO DE FACTURE sur toute correspondance

RETAIN this portion for your records

CONSERVEZ cette partie pour vos dossiers

25.00 MINIMUM PAYMENT PAIEMENT MINIMUM	25.00 NEW BALANCE NOUVEAU SOLDE
--	---------------------------------------

You may pay either new balance or minimum payment

Régler le nouveau solde ou le paiement minimum

You're on your way  
with Esso.



Partez en grand  
avec Esso.

FOR CUSTOMER SERVICE CALL 1-800-268-6287 NUMERO SANS FRAIS, SERVICE A LA CLIENTELE

PAGE 01 OF 01

STATEMENT DATE 93 06 15

PAYMENT DUE BY 93 07 06

ACCT NO 2510183375

PURCHASE DATE M/D DATE D ACHAT M/J	CARD NO N° DE CARTE	INVOICE NO. N° DE FACTURE	DETAILS/DETAILS	AMOUNT MONTANT
05 31			PAYMENT RECEIVED THANK YOU	
05 27	000	P5F 4867	HIGHWAY 11 NORTH MATHESON	25.00CR
06 11	000	P5F 5461	HIGHWAY 11 NORTH MATHESON ON	23.00
06 14	000	P5F 5621	HIGHWAY 11 NORTH MATHESON ON	15.00
			SUB-TOTAL 000 56.00	18.00

*Truck  
Kaley*

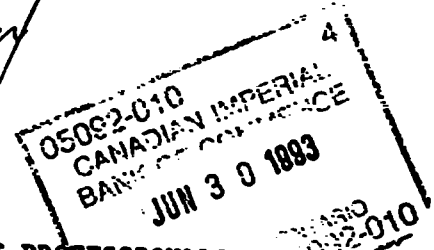

OUR DEDICATED STAFF OF CUSTOMER SERVICE PROFESSIONALS IS AVAILABLE TO HANDLE ALL YOUR INQUIRIES BETWEEN 8:00 A.M. TO 8:00 P.M., EDT, MONDAY THROUGH FRIDAY. JUST CALL TOLL FREE 1-800-268-6287. TO REPORT LOST OR STOLEN CARDS OR TO INFORM US OF ADDRESS CHANGES, YOU CAN CALL THE SAME NUMBER 24 HOURS A DAY, 7 DAYS A WEEK. YOU'RE ON YOUR WAY WITH ESSO.

PREVIOUS BALANCE 25.00 SOLDE REPORTÉ	PAYMENTS/CREDITS 25.00 PAIEMENTS/CRÉDITS	DEBIT ADJUSTMENTS 0.00 REDRESSEMENTS	UNPAID BALANCE 0.00 SOLDE IMPAYÉ	PURCHASES/CHARGES 56.00 ACHATS/FRAIS	CREDIT CHARGE 0.00 FRAIS DE CRÉDIT
--	--	--	--	--	--

See reverse side for payment terms

Voir les conditions de paiement au verso

Include ACCOUNT NUMBER and INVOICE NUMBER on all inquiries

Indiquer le NUMÉRO DE COMPTE et le NUMÉRO DE FACTURE sur toute correspondance

RETAIN this portion for your records

CONSERVEZ cette partie pour vos dossiers

56.00	56.00
MINIMUM PAYMENT PAIEMENT MINIMUM	NEW BALANCE NOUVEAU SOLDE
You may pay either new balance or minimum payment	Réglez le nouveau solde ou le paiement minimum



You're on your way  
with Esso.



Partez en grand  
avec Esso.

FOR CUSTOMER SERVICE CALL 1-800-268-6287

NUMERO SANS FRAIS, SERVICE À LA CLIENTÈLE

PAGE 01 OF 01

STATEMENT DATE 93 07 15

PAYMENT DUE BY 93 08 05

ACCT NO. 2510183375

PURCHASE DATE M/D DATE D'ACHAT M / J	CARD NO. N° DE CARTE	INVOICE NO. N° DE FACTURE	DETAILS/DETAILS	AMOUNT MONTANT
07 06			PAYMENT RECEIVED THANK YOU	56.02CR
06 16	000	P5F 5700	HIGHWAY 11 NORTH MATHESON	35.55
06 22	000	P5F 5932	HIGHWAY 11 NORTH MATHESON	27.00
06 24	000	P5F 6019	HIGHWAY 11 NORTH MATHESON	30.33
06 29	000	P5F 6229	HIGHWAY 11 NORTH MATHESON	32.85
07 07	000	P5F 6712	HIGHWAY 11 NORTH MATHESON	25.00
07 09	000	P5F 6793	HIGHWAY 11 NORTH MATHESON	28.85
07 13	000	P5F 6941	HIGHWAY 11 NORTH MATHESON	24.00
SUB-TOTAL			000 203.58	

TALK ABOUT A REWARD! THE AUGUST ESSO REWARDS OFFER IS A CANTEL PCT 8800 CELLULAR PHONE (RETAIL VALUE OF \$499) FOR JUST \$59.95 (PLUS TAXES AND \$99 DEPOSIT RETURNABLE AFTER ONE YEAR OF CELLULAR PHONE CONNECTION ON THE CANTEL PLAN). TO QUALIFY, ALL YOU HAVE TO DO IS PURCHASE \$80 OR MORE ON YOUR ESSO PERSONAL CARD IN THE 30 DAYS PRIOR TO YOUR AUGUST STATEMENT DATE.

*Chèque No 13  
July 30/83  
Kaley*

PREVIOUS BALANCE <b>56.00</b> SOLDE REPORTÉ	PAYMENTS/CREDITS <b>56.02</b> PAIEMENTS/CREDITS	DEBIT ADJUSTMENTS <b>0.00</b> REDOUBLEMENTS	UNPAID BALANCE <b>0.02CR</b> SOLDE IMPAYÉ	PURCHASES/CHARGES <b>203.58</b> ACHATS/FRAIS	CREDIT CHARGE <b>0.00</b> FRAIS DE CRÉDIT			
See reverse side for payment terms Voir les conditions de paiement au verso			<table border="1"> <tr> <td><b>203.56</b></td> <td><b>203.56</b></td> </tr> <tr> <td>MINIMUM PAYMENT PAIEMENT MINIMUM</td> <td>NEW BALANCE NOUVEAU SOLDE</td> </tr> </table>		<b>203.56</b>	<b>203.56</b>	MINIMUM PAYMENT PAIEMENT MINIMUM	NEW BALANCE NOUVEAU SOLDE
<b>203.56</b>	<b>203.56</b>							
MINIMUM PAYMENT PAIEMENT MINIMUM	NEW BALANCE NOUVEAU SOLDE							
Include ACCOUNT NUMBER and INVOICE NUMBER on all inquiries RETAIN this portion for your records		Indiquer le NUMERO DE COMPTE et le NUMERO DE FACTURE sur toute correspondance CONSERVEZ cette partie pour vos dossiers		You may pay either new balance or minimum payment Réglez le nouveau solde ou le paiement minimum				

You're on your way  
with Esso.



Partez en grand  
avec Esso.

FOR CUSTOMER SERVICE CALL 1-800-268-6287 NUMÉRO SANS FRAIS, SERVICE À LA CLIENTÈLE

PAGE 01 OF 01 STATEMENT DATE 93 08 16 PAYMENT DUE BY 93 09 06 ACCT NO. 2510183375  
DATE DU RELÈVE DATE DE RÉGLEMENT N° DE COMPTE

PURCHASE DATE M/D DATE D'ACHAT M / J	CARD NO. N° DE CARTE	INVOICE NO. N° DE FACTURE	DETAILS/DÉTAILS	AMOUNT MONTANT
07 30			PAYMENT RECEIVED THANK YOU	203.56CR
07 15	000	P5F 7067	HIGHWAY 11 NORTH MATHESON	24.00
07 17	000	P5F 7170	HIGHWAY 11 NORTH MATHESON	13.00
07 21	000	P5F 7382	HIGHWAY 11 NORTH MATHESON	30.00
07 26	000	P5F 7550	HIGHWAY 11 NORTH MATHESON	15.00
08 06	000	P5F 8264	HIGHWAY 11 NORTH MATHESON	28.00
08 12	000	P5F 8686	HIGHWAY 11 NORTH MATHESON	30.85
SUB-TOTAL			000 140.85	

CONGRATULATIONS! You've earned this month's fabulous ESSO REWARDS offer: a cantel cellular phone (retail value \$499) for just \$59.95 plus applicable taxes. Be sure not to misplace your offer certificate which is included in your statement this month.

Please be advised that our handling fee related to NSF cheques is \$20.00 for each returned cheque.

*paid cheque # 0020  
Kaley Aug 25/93  
Ryk.*

PREVIOUS BALANCE 203.56 SOLDE REPORTÉ	PAYMENTS/CREDITS 203.56 PAIEMENTS/CREDITS	DEBIT ADJUSTMENTS 0.00 RÈGLEMENTS	UNPAID BALANCE 0.00 SOLDE IMPAYÉ	PURCHASES/CHARGES 140.85 ACHATS/FRAIS	CREDIT CHARGE 0.00 FRAIS DE CRÉDIT
---	---	---	--	---	--

See reverse side for payment terms

Voir les conditions de paiement au verso

Include ACCOUNT NUMBER and INVOICE NUMBER on all inquiries

Indiquer le NUMÉRO DE COMPTE et le NUMÉRO DE FACTURE sur toute correspondance

RETAIN this portion for your records

CONSERVEZ cette partie pour vos dossiers

140.85 MINIMUM PAYMENT PAIEMENT MINIMUM	140.85 NEW BALANCE NOUVEAU SOLDE
---	--

You may pay either new balance or minimum payment

Réglez le nouveau solde ou le paiement minimum

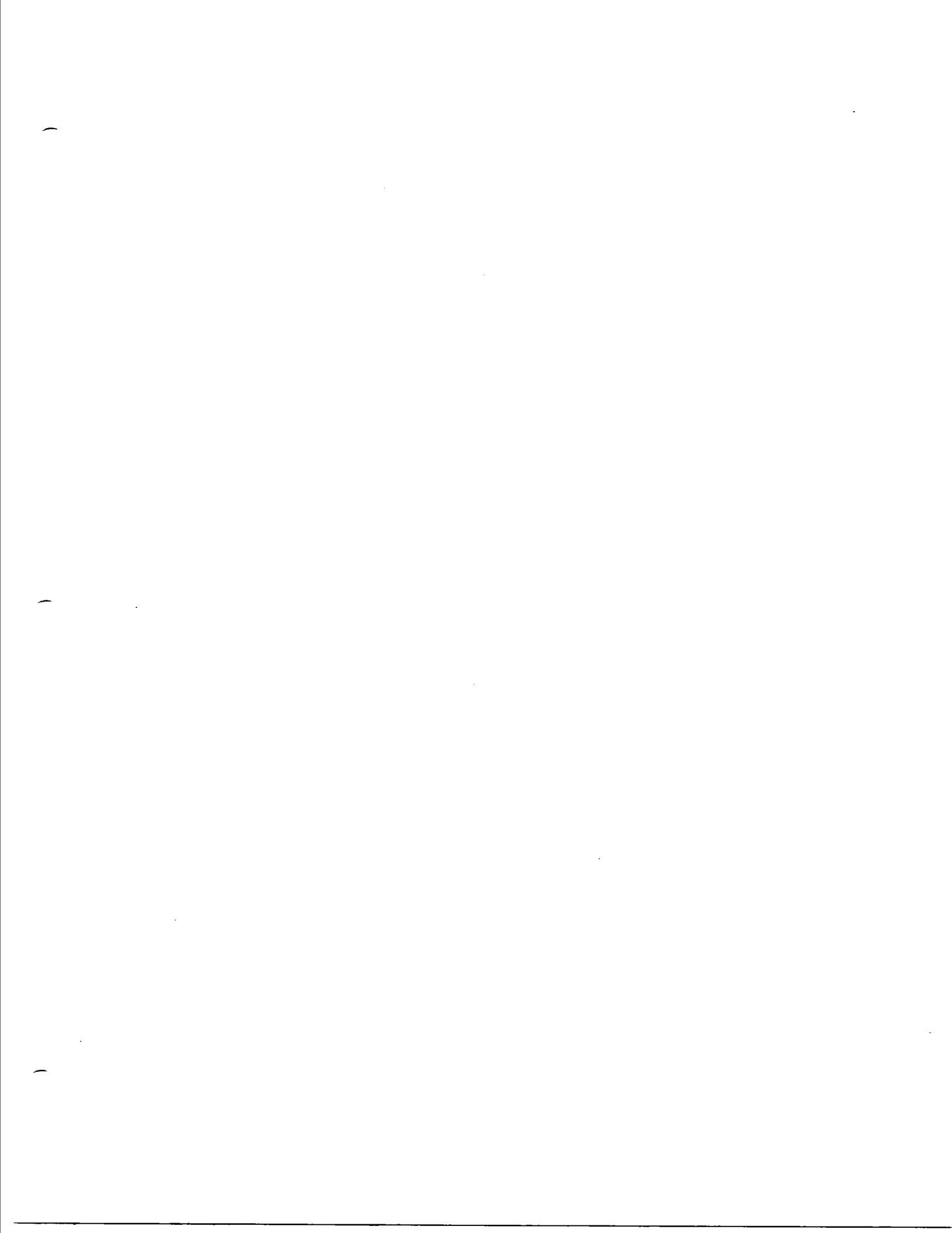

**RECEIVED .**  
OCT 24 1994  
MINING LANDS BRANCH

**ADDENDUM TO THE  
SUMMARY REPORT  
OF THE  
MAGNETOMETER SURVEY  
MAPPING  
AND  
PROSPECTING  
SHERATON TOWNSHIP  
PARTS OF LOTS 1, 2 AND 3, CON 1  
PORCUPINE MINING DIVISION**

**OCTOBER 15, 1994**

**RICHARD F. KALTWASSER**

## DECLARATION

I Richard F. Kaltwasser of town of Matheson, Province of Ontario.  
Canada do state.

1. I am a practicing prospector, holder of Miners License No. K11569, Client No. 150541, since June 3rd, 1941.
2. Studied geology by correspondence from McKinley-Roosevelt University, Chicago, Ill U.S.A. enrolment number 940G prior to service in W.W.II.
3. I was formerly with Wright-Hargreaves Mine, Kirkland Lake, Ontario in exploration. Previous to joining the Canadian John's Mansville Company in 1949 and was senior fieldman, until recent closing of operations.
4. That I have a 50% (percent) interest in the property.
5. Dated this 12th of October 1994.

  
Richard F. Kaltwasser

**REPORT OF WORK FOR ASSESSMENT  
FOR FIELD SEASON 1993**

**INTRODUCTION:**

The following report describes the assessment work completed on seven claims, during the field season of 1993. Work is due on July 31st, 1994 on claims numbered P-1175438 - 39 and also work due August 24th, 1994 on claims numbered P-1175440 and two units P-1175441. The survey was extended to cover two claims south of the mentioned groups being P-1175435 and P-1175436.

This block was acquired to cover the possible strike of the known gold showing in the south east portion of Sheraton Township.

A group magnetic survey and geological mapping was conducted as a follow-up to possibly outline further target zones.

**PROPERTY:**

Formally the group consisted of eleven (11) unpatented contiguous claims for a total of approximately 440 acres. In 1992 three (3) single units on one (1) two unit claims was staked increasing the acreage to 640 acres.

The claim group is situated in the south east corner of Sheraton Township in Lots 1-2-3-, Con 1 Porcupine Mining Division.

Two (2) claims in Egan Township are situated in south west corner of Lot 12, Con 1. Larder Lake Mining Division.

**ACCESS:**

The property is reached by a gravel road (Gibson Lake), which branches off to the south from Highway 101 West approximately 18 miles from Matheson, Ontario.

This road leads south to Lipsette Lake road a distance of 19 miles from the highway, branching off to the east for two miles to Lipsette Lake, and continues east and north for another three miles to the property. Total distance from Matheson to property 42 miles.

**REGIONAL GEOLOGY:**

All known rocks in the area are mafic volcanic rocks of Precambrian age, with minor felsic flows. These are mainly andesite, basalt, spherulitic lavas and chlorite schists with local interbedded iron formations, narrow intermediate felsic flows of rhyodacite tuff and fragmentals.

These units were subjected to regional deformation, which has in places imprinted a north west trending shearing, dips to the north east at 80°.

### REGIONAL GEOLOGY: (cont'd)

Intrusions of gabbro and peridotite were mapped in the south west part of the map sheet on scale 1:2,500. The peridotite was found in contact on the east side of the olivine diabase.

The sequence was later intruded by felsic rocks, granite (stocks) porphyry, syenite and lamprophyre dikes. Dikes generally striking north east and dip at west 70°. Quartz fractures are found associated with the feldspar porphyry and often contain low gold values.

A later swarm of quartz diabase dikes intrude all formations striking generally north south forming low hills and ridges, throughout the eastern half of Sheraton Township. The diabases have steep dips of 75° - 80°, vary in width a few meters to over a hundred meters. Most mafic volcanic exposures are found along the flanks of the ridges and low hills.

The claim group lays approximately 14 miles south of Destor Porcupine Fault, and adjacent to a strong north west trending lineament, which maybe part of the Buskegau River fault trending to the north west.

### GENERAL GEOLOGY:

"The occurrence is mapped as being within Archean mafic volcanic rocks adjacent to a felsic stock which lies in proximity to the south and to the east. North trending Matachewan diabase dikes are common throughout the area.

The claims are underlain mostly by mafic volcanic rocks with a northwest-trending gabbro intrusive located in the west. Numerous north-striking diabase dikes transect the property. Feldspar porphyry dikes occur intruding the mafic volcanic rocks and gabbro. Some are cut by fine, quartz-filled fractures containing fine cubic pyrite" by L.E. Luhta from Ontario Geological Survey Miscellaneous Paper #161 Report of Activities 1992 Resident Geologist.

#### ? Archean:

Mafic to intermediate volcanics in this group comprise most of the map area, in Sheraton Township. Extending south eastward into Egan Township and south into Timmins Township.

Most of the volcanic rocks in Sheraton consist of spherulitic lavas, basalts, poorly developed pillow lava and chlorite green schist facies. Weathered surface is generally buff, dark gray to dark green. All rocks are weak to moderately carbonated especially nearing fault structures.

Pillow structures are obscure and poorly developed. Spherulitic flows are well developed with large variolitic

### GENERAL GEOLOGY: (cont'd)

structures near the top of flows. Basalts are dark green to black on weathered surface, massive, hard and brittle. Associated minerals are pyrite, magnetite and epidote is also found in fractures.

#### 3 Intermediate Volcanics:

The more intermediate rocks in composition are probably andesite, rhyodacite and tuff. These rocks weather to light gray moderately carbonated with widely spaced white quartz veining with minor pyrite chalco-pyrite and specular hematite. Gold values occur in this horizon.

#### 4 Mafic Intrusive Rocks:

Several outcrops of gabbroic intrusive were mapped in south west portion of the map sheet. They have a rusty brown mottled appearance on the weathered surface, when brown into are dark green to black coarse grained with radiating hornblende crystals. The gabbroic rocks are composed of plagioclase feldspar, hornblende, magnetite and pyrite occur on fracture faces and sparsely disseminated, throughout the gabbro. Minor chalco-pyrite was also noted with occasional blue quartz eyes. These rocks have been outlined with both aerial and ground surveys striking north west and conforming to the regional geology.

#### 5 Felsic Intrusive Rocks:

The felsic intrusive rocks in the south eastern part of Sheraton Township occur as narrow dikes sills and irregular bodies. They range in composition from feldspar porphyry to quartz feldspar porphyry, syenite, lamprophyre dikes and small stocks of granite.

The porphyry in Sheraton Township in the south eastern part are light to dark pink in colour equigranular, milky white quartz veining with minor pyrite and chalco-pyrite and specular hematite observed near the road in south east corner of claim P-1175441 cutting the tuff in north easterly direction. They intrude the mafic felsic rocks in the area.

Dips are generally steep to the north west most of the dikes are narrow and probably do not exceed 10 - 15 meters in width?

A low magnetic response occurs in the north central portion of the group and has been interpreted possibly a small granitic stock?

#### 6 Mafic Intrusive Rocks:

Matachewan: A swarm of Matachewan diabase dikes ranging up to 100 meters or more occur on the claim group. Striking generally in a northerly direction, steeply dipping and intrude all known formations in Sheraton Township. Some of the dikes are porphyritic with large green feldspars



## General Geology:

The following "Table of Formations" has been taken from Page 7 of the Report on the Geology of the Night Hawk Lake area compiled by E.J. Leahy: -

### Table of Formations

#### Cenozoic:

Recent Lake, stream, and swamp deposits  
Pleistocene: Till, sand and gravel, varved clay.  
Unconformity

#### PRECAMBRIAN:

##### Proterozoic:

##### 6 Younger Mafic Intrusive Rocks (Keweenaw?)

Diabase  
Intrusive Contact

##### Mafic Intrusive Rocks (Matachewan?)

Diabase, porphyritic diabase.  
Intrusive Contact

##### Archean:

##### Extremely Altered Rocks

Chlorite-carbonate schist, talc-chlorite-carbonate schist, chlorite-sericite-quartz schist, serpentine schist, carbonate rock.  
Gradational and Fault Contacts

##### 5 Felsic Intrusive Rocks

Biotite granite, quartz-feldspar porphyry, feldspar porphyry, syenitic, aplitic, and felsitic dikes.  
Intrusive Contact

##### Younger Sedimentary Rocks

Greywacke, conglomerate, argillite, slate.  
Unconformable Contact

##### 4 Mafic and Ultramafic Intrusive Rocks

Serpentinized peridotite and dunite, diorite, carbonatized ultramafic rocks.  
Intrusive Contact

##### Metasediments and Tuffaceous Metasediments

Graphitic metasediments, argillite, slate, greywacke, conglomerate, tuffaceous rocks.  
Facies Change and Interfingering Contact

##### 3 Intermediate to Felsic Metavolcanics

Rhyolite, rhyodacitic rocks, agglomerate, tuff, iron formation.  
Conformable and Interfingering Contact

##### 2 Mafic to Intermediate Metavolcanics

Massive and pillowed lava flows, spherulitic and amygdaloidal lavas, porphyritic lavas, volcanic breccia, tuffs and agglomerate, iron formation.

## LEGEND

- 6 Quartz diabase
- 5 Granite 5a, Syenite 5b, Feldspar porphyry 5c, Quartz feldspar porphyry 5d, Felsite 5e, Lamprophyre 5f
- 4 Diorite 4a, Gabbro 4b,
- 4c Peridotite 4c
- 4d Pyroxenite 4d
- 3 Rhyolite, Fragmental Lava, Dacite, tuff, Chert, unifferentiated
- 2 Andesite, basalt, pillow lava, 2a, Spherulitic lava 2c, Chlorite schist 2f.
- Quartz veins

## SYMBOLS

- ⊙ Outcrop
- ⌞ Higher ground
- ┌ Scarp
- ⊘ Swamp
- ~ Creek
- ⋯ Road
- ↘ Strike and dip
- ↙ Strike and dip of schistosity
- Strike and face of flows
- ⋯ Faults M- magnetic  
T- topographic
- - - Assumed contact
- - - Edge of swamp

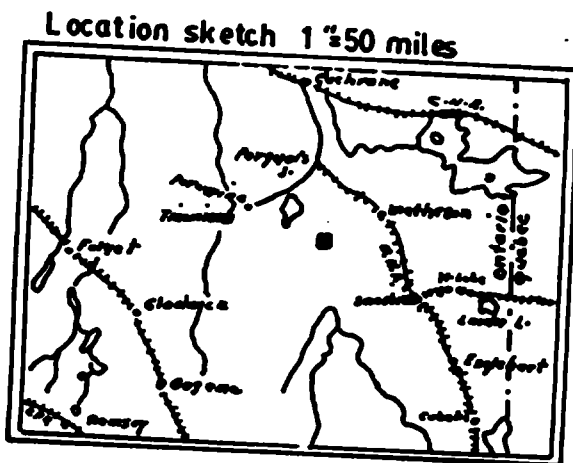

## GENERAL GEOLOGY: (cont'd)

### Mafic Intrusive Rocks:

up to 2 mm in size. They weather a dark brown and altered feldspars show up as cream coloured splotches.

The rocks form low hills and north south ridges, contacts with the mafic volcanics are distinct. Near the dikes they are generally hard and brittle, becoming much darker in appearance. Small iron rich occurrences are found near the diabase contacts. A few minor shear faults appear to displace the dikes in a northern part of the mapped area, but maybe parallel narrow dikes?

### GEOLOGICAL STRUCTURES:

In general the area is dominated by north east south west trending lineaments, which have been interpreted as faults or shears, and being younger somewhat displace the north south Matachewan diabase dikes. These lineaments have a steep dip north west.

Several north west south east trending faults were observed and are regarded as most favourable conditions for mineralization where intersect by east west shears and displace the mafic intermediate volcanics. The volcanic suite has been folded with many large drag folds. The rocks along these high angle faults, in places show sericite schist, chlorotic schist and carbonate alterations.

The western most high angle fault shown on the map of 1:2,500 is possibly the extension of the Cross Lake Fault and referred to as the Buskegau Fault. "The Buskegau River Fault, appears to be the northwest extension of the Cross Lake Fault. The Cross Lake Fault was interpreted to have its western side uplifted. The Cross Lake-Buskegau River Fault would, therefore, appear to be another "scissor-type" fault with the western side uplifted at the south end and downthrown in the northern part of the fault by R.S. Middleton, Gravity Survey-Timmins-Matheson Area, Geoscience Report 135, 1976."

### ECONOMICS:

Gold occurs in quartz stringers in the mafic volcanics associated with feldspar porphyry dikes in and near the diabase intrusions.

"A total of 25 chip samples were taken across the quartz stringers by the claim holders during the summer of 1992. Gold values of economic significance were obtained in the majority of these samples with the best assay being 0.668 ounces Au per ton over 4 feet. The writer with D. Korpela of the Timmins Mining Recorder's Office, took 12 selected grab samples of quartz and pyrite mineralization in various locations within the stripped area. Assays in ounces Au per ton obtained from these samples

**ECONOMICS:** (cont'd)

were: 0.151, 0.058, 0.004, 0.201, 0.127, 0.073, 0.111, 1.839, 0.179, 0.061, 0.255 and 0.758.

The Kaltwasser-DeMarchi occurrence contains narrow stringers which contain gold. Assays of economic significance were obtained by the claim holders and the writer. The whole area warrants further exploration since gold values were also obtained in other locations by previous workers." Report of Activities 1992 resident Geologist, L. E. Luhta, Paper #161.

**Zone A:**

Zone A is situated in the south east corner of claim P-1175441 and the south west corner of claim P-1175439 and extending into claim P-1175435 approximately 60 meters north of the claim post. Another quartz mineralized zone is found near the central part of claim P-1175439 between lines 1 and 2 east north of base line.

Zone A is possibly most favourable as it is cut by two north west striking lineaments and contains zones of alterations associated with westerly striking shears of chlorite schists with tuff, widely spaced white quartz narrow veins up to ten cm in width and appear as lenticular veins. Mineralization is minor pyrite and chalco-pyrite.

The western portion of this zone is intruded by a coarse pink feldspar porphyry, with large feldspar phenocryst (pegmatite dike). Cutting a stock work of white quartz quartz veins in a dacite tuff and up to fifteen cm in width and dipping 65° to the north, striking 285°.

The quartz is mineralized with pyrite minor chalco-pyrite and specular hematite. The zone is approximately 8 to 10 meters in width and in contact to the south with chlorite schist dipping at 65° to 70° north northeast and striking 110°.

Another zone of altered tuff with white quartz veining is in contact with chlorite schist in the south central portion of claim P-1175439. A lenticular quartz vein 1.5 meters wide occurs on the nose of the fold and becomes narrows towards the northwest.

The vein dips at 70° northeast, width of the zone is approximately five meters. Associated narrow quartz veins are up to five cm wide and found near the contact with chlorite schist. The veins are mineralized with coarse pyrite, chalco-pyrite and striking approximately 340°. Grab samples taken gave values of 0.073 oz/t. au.

## ECONOMICS: (cont'd)

### Zone A:

Located near the east side of the diabase at 150 meters north of line 1 east is another fifteen cm sugary white quartz vein in spherulitic lavas. Geodes occur in the vein with quartz crystal intergrowths. Minor chalco- pyrite is associated with the vein. Dipping north 70° east and strikes 330° the vein terminates at the contact with the diabase dike.

### Zone B:

This zone is situated at the intersection near east west oriented shears and major northwest southeast striking lineaments at the contact between mafic volcanics and felsite units 2 and 3 are intruded by diabase, which " Y " out forming an embayment of inter-fingered mafic and felsic rocks. Narrow syenite dikes intrude mafic volcanics and generally strike north. Fine pyrite occurs in a sheared mafic volcanic, on the east side of the diabase, a grab sample gave values of 134 ppb. gold.

## EXPLORATION AND DEVELOPMENT:

A previous EM V.L.F. survey was conducted by Excalibur International Consultants Limited for Placer Development Limited in 1987, on the north part of the group.

### Line Cutting:

A following is a summary of the field season 1993. A base line was cut east west with north south grid lines every 100 meters apart, with stations picketed every 30 meters along the grid lines. Old picket lines previously established north of the base line were heavily over grown.

These were brushed out and re-chained used for part of the survey. New lines were established to the south of base line number 1. The area covers seven claims of the group along the north boundary being claims P-1175435-36-38-39 and P-1175440 and one (two claim unit P-1175441). Total length of the base line chained is 1,850 meters total picket lines chained 10,505 meters.

### Magnetometer Survey:

Two base stations were set one at L-0+00 and L-5+00E using station at 0+00 for control of survey, (B.C.S. #1, 986 gammas). Base stations were checked out several times during each day, diurnal variations were plotted from field notes on a graph at completion of survey for possible ± variations. A total of 734 readings were taken.

The magnetic survey of this grid was completed with a McPhar M-700 Magnetometer Vertical Field fluxgate, Serial Number 6604.

**EXPLORATION AND DEVELOPMENT:** (cont'd)

**Magnetometer Survey:**

The magnetic survey was conducted by operator David Rice of Holtyre, Ontario and assisted by Kevin Daigle of Matheson, Ontario a student hired for the summer field season of 1993. Station readout every 15 meters and 7.5 meters over magnetic highs. Results were plotted on a map with scale of 1:2,500 and contoured at 100 gamma intervals.

**Mapping:**

Detailed mapping was conducted by compass traverse, pacing, and tied into stations along the picket lines assisted by David Rice and Kevin Daigle.

The area mapped is generally flat, sandy loam, broken by low north-south trending ridges, with outcrops of diabase intruding the (mafic) volcanics in a northerly direction. The mafic volcanics have been subjected to much folding and faulting, all mapping was plotted on scale 1:2,500.

A quartz stock work of veins occur in the southeast corner of claim P-1175441 approximately 60 meters north of number two post and traced to the west for 20 meters, before dipping under the overburden. The veins are sparsely mineralized with pyrite, minor chalco-pyrite, and specular hematite, dip at 65° north and strike 285°.

The zone was trenched by hand where possible for a width of five meters. Further to the southeast on claim P-1175435 white quartz fractures are widely spaced and possibly the same zone, they vary in width from 5 to 10 centimetres and appear as lenticular sinuous veins?

Between lines 1E-2E north of base line number 1, on claim P-1175439 a zone of white quartz veining occurs in dacite tuff in contact with chlorite schist. The veins are lenticular up to 1.5 meters wide, sinuous, dip 75° northeast and strike at 310°. The veins are mineralized with chalco-pyrite and pyrite with low gold values of 0.073 au/t.

**CONCLUSIONS:**

From the magnetic results a target area of alternation lies between lines 1 W to 3 E and should be checked for possible mineralized zones. Gold occurrence are known to be associated with this type of mineralization found on claim P-1156114.

A Geo-chemical survey (soils) will be conducted over this area, along with mechanical trenching in the target area, during 1994 field season.

This should be followed by a diamond drilling program, in the future if warranted by geochem results.

Submitted by:

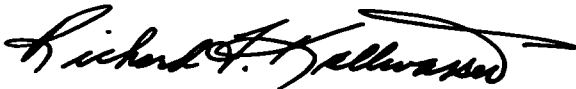
A handwritten signature in cursive script, reading "Richard F. Kaltwasser". The signature is written in dark ink and is positioned below the "Submitted by:" text.

Richard F. Kaltwasser



# Report of Work Conducted After Recording Claim

Mining Act

Transaction Number  
**W9460.00160**

Personal information collected on this form is obtained under the authority of the  
this collection should be directed to the Provincial Manager, Mining Lands,  
Sudbury, Ontario, P3E 6A5, telephone (706) 670-7284.

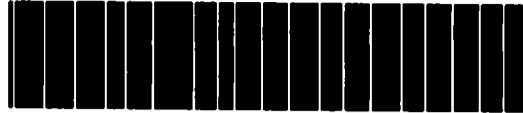

42A07SE0002 2.15515 SHERATON

900

- Instructions:**
- Please type or print and submit in duplicate.
  - Refer to the Mining Act and Regulations for requirements of filing assessment work or consult the Mining Recorder.
  - A separate copy of this form must be completed for each Work Group.
  - Technical reports and maps must accompany this form in duplicate.
  - A sketch, showing the claims the work is assigned to, must accompany this form.

Recorded Holder(s) <b>DAVID DEMARCHI (R. KALTWASSER) (15054/dk)</b>		Client No. <b>125156</b>
Address <b>11 BRUCE AVE. South Porcupine ONT. POKINO</b>		Telephone No. <b>235-3888</b>
Mining Division <b>Porcupine</b>	Township/Area <b>Sheraton</b>	U or G Plan No.
Dates Work Performed From: <b>JUNE 1<sup>st</sup> 1993</b>		To: <b>Sept 3<sup>rd</sup> 1993</b>

**Work Performed (Check One Work Group Only)**

Work Group	Type
Geotechnical Survey	<input checked="" type="checkbox"/>
Physical Work, including Drilling	<input checked="" type="checkbox"/>
Rehabilitation	<input type="checkbox"/>
Other Authorized Work	<input type="checkbox"/>
Assays	<input type="checkbox"/>
Assignment from Reserve	<input type="checkbox"/>

*Handwritten notes: Prospecting, magnetic stripping - mapping magnetometer survey - line outlining*

**RECEIVED**  
JUL 28 1994  
MINING LANDS BRANCH

**RECORDED**  
JUL 11 1994  
Receipt \_\_\_\_\_

Total Assessment Work Claimed on the Attached Statement of Costs \$ 8,780.-

**Note:** The Minister may reject for assessment work credit all or part of the assessment work submitted if the recorded holder cannot verify expenditures claimed in the statement of costs within 30 days of a request for verification.

**Persons and Survey Company Who Performed the Work (Give Name and Address of Author of Report)**

Name	Address
<i>Supervisor - Report</i> <b>RICHARD F. KALTWASSER</b>	<b>Box 34, 448-5<sup>th</sup> AVE. MATHESON ONT. POKINO</b>
<b>DAVID RICE magnetometer operator</b>	<b>General Delivery, MORTYRE ONT. POKINO</b>
<b>KEVIN DAIGLE magnetometer assist.</b>	<b>315-4<sup>th</sup> AVE. MATHESON, ONT. POKINO</b>

(attach a schedule if necessary)

**Certification of Beneficial Interest \* See Note No. 1 on reverse side**

I certify that at the time the work was performed, the claims covered in this work report were recorded in the current holder's name or held under a beneficial interest by the current recorded holder.	Date	Recorded Holder or Agent (Signature)
--	------	--------------------------------------

**Certification of Work Report**

I certify that I have a personal knowledge of the facts set forth in this Work report, having performed the work or witnessed same during and/or after its completion and annexed report is true.		
Name and Address of Person Certifying <b>RICHARD F. KALTWASSER Box 34 MATHESON ONT. POKINO</b>		
Telephone No. <b>273-2733 Home</b> <b>273-3066 Bus.</b>	Date <b>July 7<sup>th</sup> 1994</b>	Certified By (Signature) <i>Richard F. Kaltwasser</i>

**For Office Use Only**

Total Value Cr. Recorded <b>\$8,780</b>	Date Recorded	Mining Recorder
	Deemed Approval Date <b>Oct. 9, 1994</b>	Date Approved
	Date Notice for Amendments Sent	

**RECEIVED**  
JUL 11 1994  
1145  
PORCUPINE MINING DIVISION



Work Report Number for Applying Reserve	Claim Number (see Note 2)	Number of Claim Units
	P-1175435	1
	P-1175436	1
	P-1175438	1
	P-1175439	1
	P-1175440	1
	P-1175441	2
Total Number of Claims		7

Value of Assessment Work Done on the Claim	Value Applied to the Claim
942. --	200. --
941. --	200. --
1,254. --	1,200. --
1,881. --	1,200. --
1,254. --	1,200. --
2,508. --	2,000. --
Total Value Work Done	
8,780. --	6,000. --

Value Assigned from the Claim	Reserve: Work to be Claimed at a Future Date
	942.00
	941.00
	54. --
	681. --
	54. --
	508. --
Total Assigned from	
5,600	2,780. --

Credits you are claiming in this report may be cut back. In order to minimize the adverse effects of such deletions, please indicate from which claims you wish to prioritize the deletion of credits. Please mark (✓) one of the following:

- Credits are to be cut back starting with the claim listed last, working backwards.
- Credits are to be cut back equally over all claims contained in this report of work.
- Credits are to be cut back as prioritized on the attached appendix.

In the event that you have not specified your choice of priority, option one will be implemented.

Note 1: Examples of beneficial interest are unrecorded transfers, option agreements, memorandum of agreements, etc., with respect to the mining claims.

Note 2: If work has been performed on patented or leased land, please complete the following:

I certify that the recorded holder had a beneficial interest in the patented or leased land at the time the work was performed.	Signature <i>Richard F. Kellerman</i>	Date July 7 <sup>th</sup> / 94
---	--	-----------------------------------



Statement of Costs  
for Assessment Credit

État des coûts aux fins  
du crédit d'évaluation

Mining Act/Loi sur les mines

Transaction No./N° de transaction

W9460.00160

Personal information collected on this form is obtained under the authority of the Mining Act. This information will be used to maintain a record and ongoing status of the mining claim(s). Questions about this collection should be directed to the Provincial Manager, Minings Lands, Ministry of Northern Development and Mines, 4th Floor, 159 Cedar Street, Sudbury, Ontario P3E 6A5, telephone (705) 670-7264.

Les renseignements personnels contenus dans la présente formule sont recueillis en vertu de la Loi sur les mines et serviront à tenir à jour un registre des concessions minières. Adresser toute question sur la collecte de ces renseignements au chef provincial des terrains miniers, ministère du Développement du Nord et des Mines, 159, rue Cedar, 4<sup>e</sup> étage, Sudbury (Ontario) P3E 6A5, téléphone (705) 670-7264.

1. Direct Costs/Coûts directs

Type	Description	Amount Montant	Totals Total global
Wages Salaires	Labour Main-d'oeuvre	3,833.	
	Field Supervision Supervision sur le terrain	4,112.	7,945.
Contractor's and Consultant's Fees Droits de l'entrepreneur et de l'expert- conseil	Type		
	ARLINGTON Enterprises typing computer parts copies	100.	100.-
Supplies Used Fournitures utilisées	Type		
	batteries, pen ink - staple - desk pad Acid pens etc.	311.-	
Equipment Rental Location de matériel	Type		
Total Direct Costs Total des coûts directs			8,356.

2. Indirect Costs/Coûts indirects

\*\* Note: When claiming Rehabilitation work indirect costs are not allowable as assessment work.  
Pour le remboursement des travaux de réhabilitation, les coûts indirects ne sont pas admissibles en tant que travaux d'évaluation.

Type	Description	Amount Montant	Totals Total global
Transportation Transport	Type Travel to from job site	426.-	
	Repairs to truck	870.-	
			1296.
Food and Lodging Nourriture et hébergement			
Mobilization and Demobilization Mobilisation et démobilisation			
Sub Total of Indirect Costs Total partiel des coûts indirects			1296.
Amount Allowable (not greater than 20% of Direct Costs) Montant admissible (n'excedant pas 20 % des coûts directs)			1672.
Total Value of Assessment Credit (Total of Direct and Allowable indirect costs)			10,028.
Value total du crédit d'évaluation (Total des coûts directs et indirects admissibles)			10,028.

Note: The recorded holder will be required to verify expenditures claimed in this statement of costs within 30 days of a request for verification. If verification is not made, the Minister may reject for assessment work all or part of the assessment work submitted.

Note : Le titulaire enregistré sera tenu de vérifier les dépenses demandées dans le présent état des coûts dans les 30 jours suivant une demande à cet effet. Si la vérification n'est pas effectuée, le ministre peut rejeter tout ou une partie des travaux d'évaluation présentés.

Filing Discounts

1. Work filed within two years of completion is claimed at 100% of the above Total Value of Assessment Credit.
2. Work filed three, four or five years after completion is claimed at 50% of the above Total Value of Assessment Credit. See calculations below:

Total Value of Assessment Credit	Total Assessment Claimed
	x 0.50 =

Remises pour dépôt

1. Les travaux déposés dans les deux ans suivant leur achèvement sont remboursés à 100 % de la valeur totale susmentionnée du crédit d'évaluation.
2. Les travaux déposés trois, quatre ou cinq ans après leur achèvement sont remboursés à 50 % de la valeur totale du crédit d'évaluation susmentionné. Voir les calculs ci-dessous.

Valeur totale du crédit d'évaluation	Evaluation totale demandée
	x 0,50 =

Certification Verifying Statement of Costs

I hereby certify:  
that the amounts shown are as accurate as possible and these costs were incurred while conducting assessment work on the lands shown on the accompanying Report of Work form.

that as Hold 50% Interest I am authorized  
(Recorded Holder, Agent, Position in Company)

to make this certification

Attestation de l'état des

J'atteste par la présente :  
que les montants indiqués sont le plus exact possible et que ces dépenses ont été engagées pour effectuer les travaux d'évaluation sur les terrains indiqués dans la formule de rapport susmentionnée joint.

Et qu'à titre de \_\_\_\_\_ je suis autorisé  
(titulaire enregistré, représentant, poste occupé dans la compagnie)

à faire cette attestation.

Signature: Richard J. Halverson Date: July 7<sup>th</sup> / 94

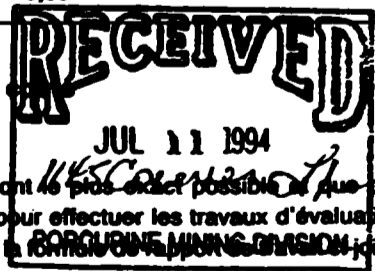

Richard F. Kaltwasser  
448- 8th Avenue, Box 34  
Matheson, Ontario  
POK 1N0



October 15, 1994

Ministry of Northern Development and Mines  
Geoscience Approvals Office  
933 Ramsey Lake Road  
6th Floor  
Sudbury, Ontario  
P3E 6B5

Re: File No. 2.15515  
Transaction #W8460.00160

Subject: Notice of Deficiency, Subsection 6 (2) Mining Act  
Regulations.

Dear Sir/Madam:

Please find the following required revisions to the former submission of Summary Report from Richard F. Kaltwasser dated June 30, 1994, Assessment Work Report in Sheraton Township Porcupine Mining Division.

Revisions:

- i) Exploration Development Work Performed.
- ii) Statement of qualifications.
- iii) Bar scale on maps from 1:2,500 corrected.
- iv) Table of Rocks added by outlining the rock formations on the property.
- v) Regional geology.
- vi) Descriptions of geological structures.
- vii) The attitudes and dimensions of quartz veins, mineralization and alteration found during the survey have been identified.

If you have any questions regarding this correspondence, please contact Richard F. Kaltwasser at (705) 273-3066.

A handwritten signature in cursive script that reads "Richard F. Kaltwasser".

Richard F. Kaltwasser  
RFK/dak

Enclosures:



Ontario

Ministry of  
Northern Development  
and Mines

Ministère du  
Développement du Nord  
et des Mines

Geoscience Approvals Office  
933 Ramsey Lake Road  
6th Floor  
Sudbury, Ontario  
P3E 6B5

November 7, 1994

Our File: 2.15515  
Transaction #: W9460.00160

Telephone: (705) 670-5853  
Fax: (705) 670-5863

Mining Recorder  
Ministry of Northern Development  
and Mines  
60 Wilson Avenue  
1st Floor  
Timmins, Ontario  
P4N 2S7

Dear Sir/Madam:

**Subject: APPROVAL OF ASSESSMENT WORK CREDITS ON MINING CLAIMS  
P.1175435 ET AL IN SHERATON TOWNSHIP**

The deficiencies in the original submission have been rectified.

Assessment work credits have been approved as outlined on the original report of work form for the submission. The credits have been approved under Section 12, Geology and Section 14, Geophysics (Mag), Mining Act Regulations.

The approval date is November 2, 1994.

If you have any questions regarding this correspondence, please contact Lucille Jerome at (705) 670-5861.

ORIGINAL SIGNED BY:

Ron C. Gashinski  
Senior Manager, Mining Lands Section  
Mining and Land Management Branch  
Mines and Minerals Division

LJ/lj  
Enclosures:

cc: Resident Geologist  
Timmins, Ontario

Assessment Files Library  
Sudbury, Ontario





**GEOL. LEGEND**

- 6 Quartz diabase, olivine diabase
- 5 Granite 5a, Syenite 5b, Feldspar porphyry 5c, Quartz feldspar porphyry 5d, Felsite 5e, Lamprophyre 5f
- 4 Diorite 4a, Gabbro 4b, Breccia 4c
- 4c Pyroxenite 4c (serpentinized)
- 4d Pyroxenite 4d
- 3 Rhyolite, fragmental lava, Tuff-chert undifferentiated
- 2 Andesite basalt, pillow lava 2a, Diabasic lava 2b, Spherulitic lava 2c, Chlorite schist
- 2c Carbonate rock
- Quartz veins

**LEGEND**

- CLAIM LINE POST
- PATENT SURFACE RIGHTS ONLY
- SWAMP
- BEAVER POND
- CREEK
- ROAD
- B.C.S.
- outcrop
- HIGH GROUND
- G - Geological
- M - Magnetic
- T - Topographic
- Flow Top
- Strike-Dip
- Assumed contacts
- Swamp outline

**KEY MAP**

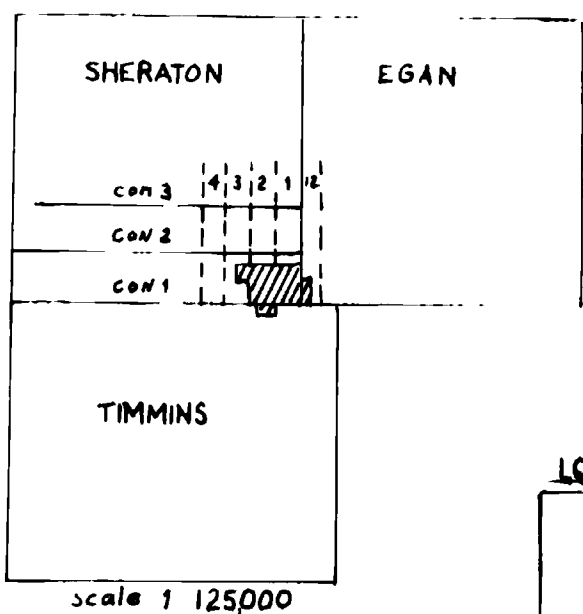

**LOCATION SKETCH - 1/25 MILES**

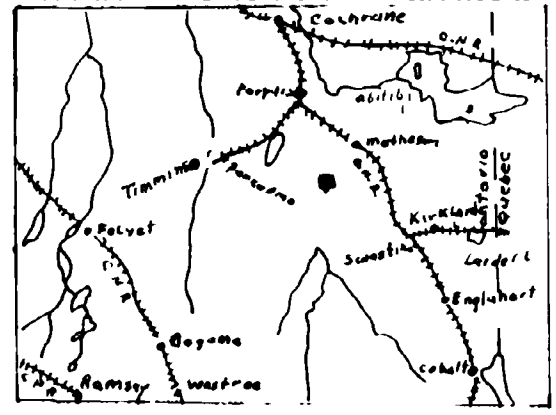

RECEIVED  
OCT 24 1994  
LITHIUM LANDS BRANCH

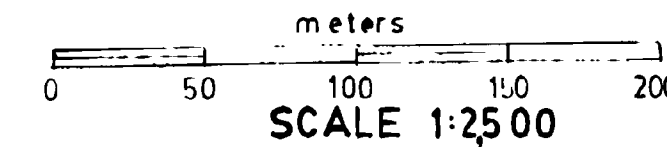



- GEOLOGICAL LEGEND**
- 6 Quartz diorase, olivine diabase
  - 5 Granite 5a, Syenite 5b, Feldspar Porphyry 5c, Quartz Feldspar Porphyry 5d, Felsite 5e, Lamprophyre 5f
  - 4 Diorite 4a, Gabbro 4b,
  - 4c Peridotite & Dunite (serpentinized) 4c
  - 4d Pyroxenite
  - 3 Rhyolite, Fragmental lava, Tuff-Chert undifferentiated
  - 2 Andesite, Basalt, Pillow Lava 2a, Diabasic Lava 2b, Spherulitic lava 2c, Chlorite schist 2f.

- LEGEND**
- CLAIM LINE - POST PATENT SURFACE RIGHTS ONLY
  - SWAMP
  - ☪ BEAVER POND
  - ~ CREEK
  - ROAD
  - - - - - Assumed Contacts
- Instrument used: MIPRO M-700, Serial 6604  
 Base station: L 7000/01000  
 Rod out: 15 meters minimum  
 Line spacing: 100 meters  
 Contour interval: 100 gamma  
 Operator: David L. ...  
 Assistant: ...  
 Total work: ...

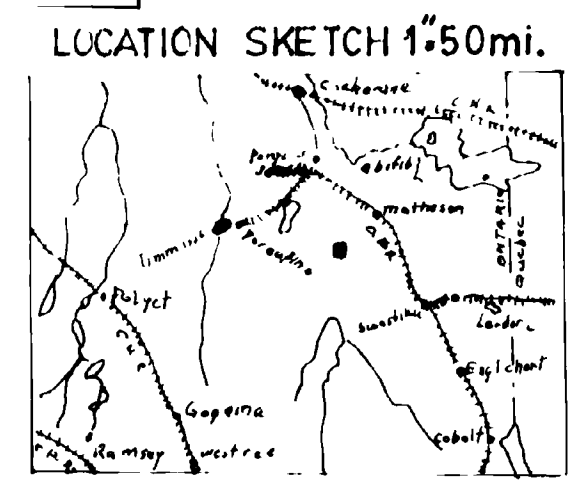
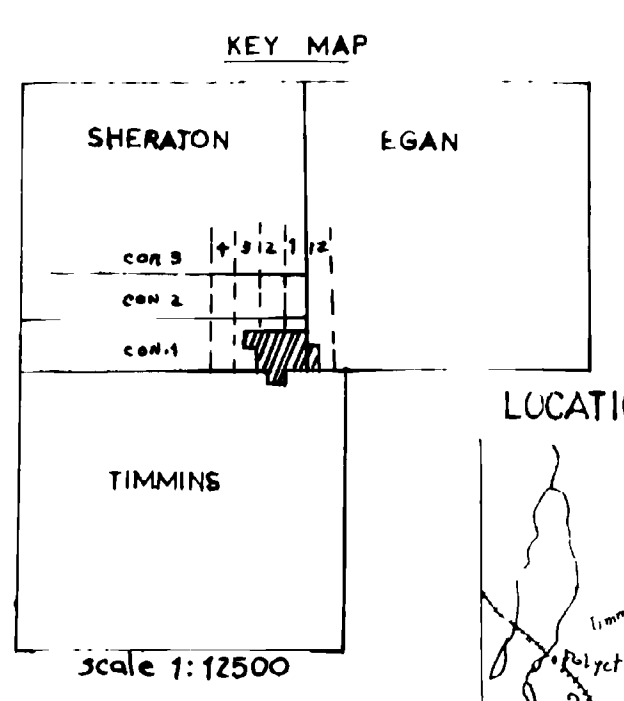

RECEIVED  
 OCT 24 1984  
 MINING LANDS BRANCH

