



42A07SW0062 13 LANGMUIR

010

## Diamond Drilling

Township of LANGMUIR

Report No: 13

Work performed by: Canadian Superior Exploration Limited

Claim No	Hole No	Footage	Date	Note
P 76878	391'	L-65-1	Jan/65	

Notes:

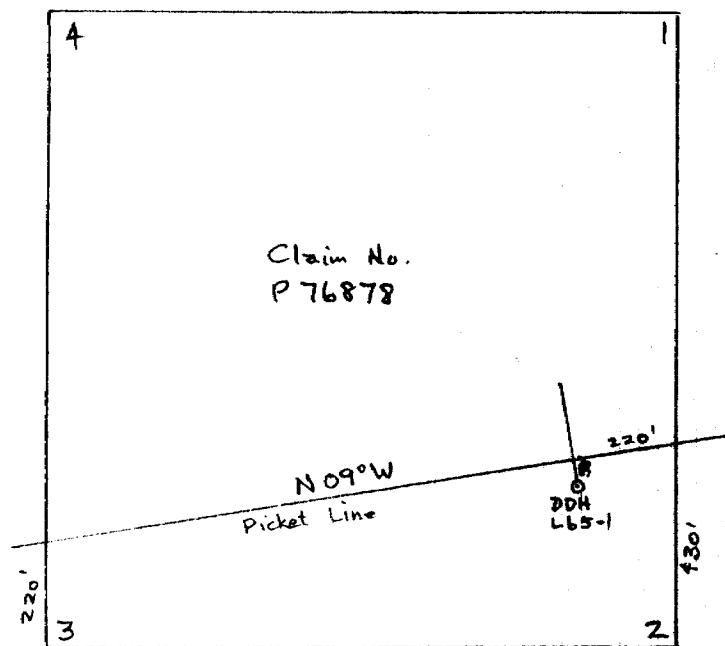

TN

Scale 1" to 400'

Canadian Superior Exploration Ltd.

Location of Drill Hole L-65-1

Langmuir Twp., Ont.

W.K. 5/10/65

**CANADIAN SUPERIOR EXPLORATION LIMITED**  
DIAMOND DRILL RECORD

LOCATION: **0 + 50 S**  
**4 + 00 W**  
AZIMUTH: **360° (mag)**

HOLE NO: **L-65-1**

PROPERTY: **Southern Group**  
**Langmuir Twp., Ontario**

DIP: **-45°**      LENGTH: **391'**      ELEVATION:      CLAIM NO: **D-76878**

STARTED: **January 26, 1965**      CORE SIZE: **AXT**      DATE LOGGED:      SECTION:

COMPLETED: **February 4, 1965**      DIP TESTS: **200' - 42° (corrected)**      LOGGED BY: **D.J.W., W.K.**  
**390' - 43°**      **William Kene**

PURPOSE:

FOOTAGE from	FOOTAGE to	DESCRIPTION	SAMPLE No:	FOOTAGE		LENGTH	Cu.	Ni.
				from	to			
0	88	Casing						
88	218	Peridotite - massive, uniform, medium to fine grained, equigranular, grey-dark green-black, some sections are fairly fresh and hard, others have been altered and are lighter in color and softer than unaltered sections. Minor shearing at 35° to core axis, minor to rare pyrite-pyrrhotite, possibly some serpentinite, some of the altered sections may be diorite	806 803	180 200	185 205	5' 5'	0.01 0.01	0.11 0.15
218	233	Peridotite - massive, uniform, fine grained, dark green to black, hard, fine sulphides up to 2% in places	804	220	225	5'	0.01	0.25
233	258	Graphitic shear zone - shearing and fracturing at average 50° to core axis, very chloritic in parts, up to 2% pyrrhotite-pyrite and rare chalcopyrite	805	235	240	5'	0.03	0.15
258	END	Peridotite - as at 88, moderately sheared in places at 45° to core axis						
	391	END OF HOLE						