



42A08NE0305 11 BARNET

010

Diamond Drilling

Township of BARNET

Report NO: 11

Work performed by: Dominion Gulf Company

Claim NO	Hole NO	Footage	Date	Note
L 55197	1	504.0'	Oct/50	
L 55197	2	213.0'	Nov/50	
L 55200	3	620.0'	Nov/50	
L 55198	4	683.0'	Nov/50	

Notes:

ROPEWAY Barnet-Thackeray, Grp. II

HOLE NUMBER 1

SHEET NUMBER 1

SECTION FROM

3-3-61

BARNET
TOP

255197

DIAMOND DRILL RECORD

LOCATION: 2 + 43 N
18 + 40 W

DEVIATION: 110° E

DIP:

DIRECTION: South
40°

STARTED: October 28, 1950

COMPLETED: November 7, 1950

ULTIMATE DEPTH: 504'

PROPOSED DEPTH: 500'

DEPTH	FORMATION	SAMPLE NO.	WASH	TEST	REMARKS
0 - 9'	Because of topography datum for measuring depth is 9' above collar.				
9'	Casing.				
14'	Amphibolite - grey black, sooty black on broken faces. Conspicuous acicular crystals (probably amphibole) show on surface. In mapping this rock was called anesite to distinguish it from coarse basalt. Will hereafter be designated Asic. Amph.				
22'	Lost core.				
24'	Asic. Amph.				
30'	Lost core.				
31'	Asic. Amph.				
33'	Lost core.				
34'	Asic. Amph.				
37½'	Dusty seams in Asic. Amph. Some coarse pyrite. Seams - 6" at 42', 4" at 46', 4" at 47'.				
52'	More altered. Epidote and quartz stringers. Fractures and some brecciation. Oxidation along fractures.				

DIAMOND DRILL RECORD

141. 2 + 43N
18 + 40 W

ELEVATION OF GROUND
SURFACE

DIP OF DRILL FACE South
40°

STARTED October 28, 1950

COMPLETED November 7, 1950

ULTIMATE DEPTH 504'

PROPOSED DEPTH 500'

DEPTH	FORMATION	SAMPLE NO.	WIDTH OF SAMPLE	LOG NO.	REMARKS
	6" Seam (Oxidized) at 57'				
	24" seam at 61'				
	Increased oxidation to:				
76'	Massive Asic. Amph.				
77'	Lost core.				
78'	Massive Asic. Amph. with many fine quartz veinlets, random orientation.				
81'	Oxidized zone.				
83'	Massive Asic. Amph. many fine quartz stringers.				
86'	Lost core.				
87½'	As previous.	626	6" from 92.0'		
	Seams and lost core 92' - 94' and at 96' and 99'.	629	4" from 93.0'		
122½'	Seams and sheared material. More than 50% lost core space filled with ferruginous gossan which washed out. Not recovered in sludge samples.				
	Remaining core represents less oxidized portions - show strong hydrothermal				

DIAMOND DRILL RECORD

LOCALITY 2 + 43 N
13 + 40 W

STARTED October 28, 1950

DIAMETER OF COLLAR
(AUX)

COMPLETED November 7, 1950

DIRECTION OF TILT South
40°

ULTIMATE DEPTH 504'

PROPOSED DEPTH 500'

DEPTH	FORMATION	SAMPLE NO.	ANALYSIS	REMARKS
	alteration. All disseminated minerals oxidized out.			
131'	Syenitized and silicified. The rock is still recognizable as Asic. Amph. but is highly altered.			
139'	Massive Asic. Amph. less altered.			
141'	Altered and fractured 1/3 of core lost.			
153½'	Massive band.			
155½'	Greenish fine-grained rock with disseminated pyrite. May be basic sill or only highly altered phase of Asic. Amph. Locally brecciated and oxidized with quartz veins up to 2". Random orientation. 1½' Lost core at 166½'.	627 628	1' .5 from 135.0' 1' .0 from 190.5'	
171'	Massive Asic. Amph. with seams and quartz stringers.	624	1' from 182.5'	
191½'	Porphyritic syenite dike or sill angle to core 40° (approximately). Apparently horizontal member.	625	6" from 126.0'	
194'	Massive Asic. Amph. brecciated with quartz filling.			
199½'	Syenite, porphyritic.			

DIAMOND DRILL RECORD

LOCATION: LAT. 2 + 43 N
LONG. 18 + 40 WSTARTED October 28, 1950

ELEVATION OF COLLAR

COMPLETED November 7, 1950

DATUM

ULTIMATE DEPTH 504'DIRECTION AT START BEARING South
40°PROPOSED DEPTH 500'

DEPTH FEET	FORMATION	SAMPLE NO	WHEN OF STUDY	REMARKS	REMARKS
200 $\frac{1}{2}$ '	Mass. Asic. Amph. with narrow quartz stringers. Quartz veins 6" at 201 $\frac{1}{2}$ ' 2" at 211'.				
223'	Highly altered zone with oxidized seams. 50% lost core.				
237'	Mass. Asic. Amph. with quartz stringers.	630	3" from 242.0'		
255'	Porphyritic syenite.				
257'	Mass. Asic. Amph. 6" syenite dike at 258'. Increasing quartz stringers with carbonate.				
288'	Breccia - numerous quartz. stringers offset by later movement.	631	10" from 303.5'		
328'	Massive, Non Asicular, very fine-grained amphibolite.	632	4" from 411.0'		
504'	End of hole. (There is no noticeable change from 328' to 504' where the hole was stopped).				

DIAMOND DRILL RECORD

HOLE NO. 13 + 43 N
 13 + 40 N
 LOCATION Same as Hole No. 1
 DIRECTION Same as Hole No. 1
 DIP 70°

STARTED November 7, 1950
 COMPLETED November 11, 1950
 ULTIMATE DEPTH 213' incl. casing.
 PROPOSED DEPTH

DEPTH	FORMATION	SAMPLE NO.	ANALYSIS	REMARKS
from 0'	Casing.			
to 10'	Asicular amphibolite - 50% lost core.			
23'	Massive asic. amph. some very fine quartz stringers, random orientation, blocky and fractured.			
75'	Fine-grained, altered developing spotted appearance. Fractured with seams of rusty material and pyrite. 6.5 of lost core (cumulative). Blebs of pyrite increasing approaching:	633	4" at 92.0	.005
119'	Pyrox. fragments of asic. amph. in greenish matrix, fractures sealed with pyrite.	634	2' 0 from 122'	Nil
133'	Uttered contact of asic. amph. with carbonated or silicified, very fine-grained material.	620	Grab at 140'	.005
		635	6" at 127.5	Nil
		636	2' 0 from 138'.5	Nil
141'	1' Rusty seam.			
142'	Silicified (and carbonated?) zone with some widely scattered galena and chalcopryite. Well mineralized with pyrite.	621	Grab at 146'	Nil
		637	2' 0 from 142'.5	.005
		638	3" at 144.5	Nil
		639	3' 0 from 145'.0	Nil
		640	3' 0 from 147'.0	Nil
150'	Pink granite dike 2" wide, with galena, bordering rusty seam 1 1/2' wide.	641	1.5 from 150'.0	Nil

DIAMOND DRILL RECORD

2 + 43 N

18 + 40 N

STARTED November 7, 1950.

COMPLETED November 11, 1950

ULTIMATE DEPTH 213' incl. casing.

Same as Hole No. 1

70°

PROPOSED DEPTH

DEPTH	FORMATION	SAMPLE NO.	REMARKS	REMARKS
151½	Altered breccia or agglomerate small quartz veins - disseminated pyrite.			
160	4' .5 mud seam - No core	623	Caved material,	Nil
164½	Altered breccia, or agglomerate, some pyrite.			
168	Mud seam.			
170	Highly altered and replaced breccia (?) well mineralized.	642	2' .5 from 170.0	Nil
172½	Mud seam, some highly altered material recovered.	643	1.0 from 173.0	Nil
176	Highly altered agglomeritic (?) material with pyrite.	622	Grab 176.0	Nil
		644	4' .0 from 176.0	Nil
		645	1' .5 from 180.0	Nil
		646	2' .0 from 181.5	Nil
189	Massive, very fine-grained andesite (?), with some disseminated pyrite and narrow quartz veins. Narrow bands of altered material.			
213	End of hole (including casing).			

PROPERTY Barnet-Thackeray, Group II

L56912
Barnet Com A
SE 1/4 of 1/2 Sec 12

HOLE NUMBER 3
 SHEET NUMBER 1
 SECTION FROM ● TO ●

3-3-61

DIAMOND DRILL RECORD

LOCATION: LAT. 28 + 80 W
 DEP. 0 + 00 N
 ELEVATION OF COLLAR
 DATUM
 DIRECTION AT START: BEARING S 45° W
 DIP 2 45°

STARTED November 13, 1950
 COMPLETED November 23, 1950
 ULTIMATE DEPTH 620
 PROPOSED DEPTH ?

DEPTH FEET	FORMATION	SAMPLE NO.	WIDTH OF SAMPLE	GOLD \$	PLACER GOLD \$
0	Casing.				
- 19.5	Rhyolite - pseudo rhyolite - due to soaking of country rock with siliceous material. Extremely fine-grained, occasionally banded.				
- 20.5	Waxy - medium-grained rock intrusive into rhyolite. Seems to be highly altered and not recognizable in hand specimen.				
- 23.5	Rhyolite.	414	2 1/2" @ 25.0	0.17	
- 27.5	Breccia - greenish fragments in matrix of rhyolite.	415	2 1/2" @ 27.5	1.05	
		416	2 1/2" @ 30.0	0.35	
- 32.5	Breccia - injected with syenite and brecciated.				
- 37.5	Dalmatianite (?)				
- 38.5	Rhyolite, fractured.				
- 54.0	Fine-grained, highly altered basic lava with sulphide stringers.	418	2 1/2" @ 61.5	Nil	
- 64.0	Basic lava injected, with rhyolite in fine bands and later syenite.	419	2 1/2" @ 75.0	0.70	
- 81.0	Syenite dike with greyish mineral, magnetite or specular hematite, some pyrite and minor chalcopyrite.	420	1" @ 83.0	Nil	
- 85.0	Altered basic lava.	421	4 1/2" @ 85.0	Nil	
		422	1 1/2" @ 94.5	Nil	

NORTHERN MINER PRESS LIMITED, TORONTO - STOCK FORM NO. 501 REV. 5-54

DRILLED BY Heath & Sherwood

SIGNED R. W. Johns

PROPERTY Barnet-Thackeray, Group IIHOLE NUMBER 3SHEET NUMBER 2SECTION FROM TO

DIAMOND DRILL RECORD

LOCATION: LAT. 28 + 80 W
 DEP. 0 + 00 N
 ELEVATION OF COLLAR
 DATUM
 DIRECTION AT START: BEARING S 45° W
 DIP 45°

STARTED November 13, 1950COMPLETED November 23, 1950ULTIMATE DEPTH 620PROPOSED DEPTH ?

DEPTH FEET	FORMATION	SAMPLE NO	WIDTH OF SAMPLE	GOLD \$	SLUDGE GOLD \$
- 98.0	Increasing syenite injection and syenitization.				
- 124.5	Syenite, with narrow bands of included basic material.				
- 140.5	Altered very fine-grained basic lava, or dike.				
- 153.0	Syenite dike with 1½ foot syenitized band on either side.				
- 155.0	Altered very fine-grained lava or basic dike - very dense.				
- 162.5	Syenite and syenite breccia,				
- 177.0	Syenite.	423	1' 0" @ 180.5	0.70	
- 193.0	Rhyolite very dense, somewhat brecciated. Porphyritic bands, rare glassy quartz stringers.				
- 287	Syenite.				
- 293.5	Altered basic lava.	424	8" @ 293.5	N11	
- 297	Pink syenite grading to greyish syenite or granodiorite.				
- 311	Syenitized breccia.				
- 314.5	Syenite (pink? and syenitized).	425	2' 6" @ 345	N11	
		426	2' 0" @ 341.5	N11	
		427	2' 6" @ 371.5	N11	
		428	4' 5" @ 373.5	N11	
		429	2' 6" @ 377.5	N11	
- 371.5	Altered and syenitized basic lava	430	2' 6" @ 390.0	N11	

3-3-61

PROPERTY Barnet-Thacker

BARNET TWP

DIAMOND DRILL RECORD

HOLE NUMBER #4

SHEET NUMBER 1

SECTION FROM

TO

LOCATION: LAT. 6 + 40 W L 55198
 DEP. 7 + 50 N
 ELEVATION OF COLLAR (Approx. same as holes 1, 2 and 3)
 DATUM
 DIRECTION AT START: BEARING 105°
 DIP 45°

STARTED November 25, 1950.COMPLETED December 5, 1950ULTIMATE DEPTH 683

PROPOSED DEPTH

DEPTH FEET	FORMATION	SAMPLE NO.	WIDTH OF SAMPLE	GOLD #	EDGE GOLD #
0-10.0	Casing (see Smith re this).				
10.0-25.0	Grey lava, some narrow carbonate strgs, sparse pyrite.				
25.0-50.0	Ditto, blocky ground.				
50.0-75.0	Ditto, 6" lost core @ 73'.3" - 73'.9".				
75.0-100.0	Ditto, lost core @ 76'.6" - 77'.0" also 77'.10" - 72'.0". 81.7-82.10 ground very blocky but little evidence of open seams or leaching.				
100.0-125.0	Ditto, lost core @ 103.5 - 104.0 and 105.0-105.6, 109.0-110.0.				
125.0-150.0	Massive light grey lava, some narrow carbonate strgs.				
150.0-175.0	Ditto.				
175.0-200.0	Ditto, blocky again, lost core 191.0-192.0 - more alteration and silicification some pyrite becoming amphibolitic.				
200.0-225.0	Massive grey lava. Some narrow carbonate strgs. no mineral.				
225.0-250.0	Ditto.				
250.0-275.0	Ditto.				
275.0-300.0	Amphibolitic lava, more broken ground in this box.				
300.0-325.0	Ditto becoming very massive.				
			Dip at	300'-54°	

NORTHERN MINER PRESS LIMITED TORONTO, CANADA

DRILLED BY

Heath & Sherwood Ltd.

SIGNED

D. Sirala

PROPERTY Barnet-Thacker 44HOLE NUMBER #4SHEET NUMBER 2

DIAMOND DRILL RECORD

SECTION FROM TO

LOCATION: LAT. 6 + 40 W
 DEP. 7 + 50 N
 ELEVATION OF COLLAR (Approx. same as holes 1, 2 and 3)
 DATUM
 DIRECTION AT START: BEARING 105°
 DIP 45°

STARTED November 25, 1950
 COMPLETED December 5, 1950
 ULTIMATE DEPTH 683
 PROPOSED DEPTH

DEPTH FEET	FORMATION	SAMPLE NO	WIDTH OF SAMPLE	GOLD g	SLUDGE GOLD g
325.0-350.0	Massive lava - 1" quartz stringer @ 349.0" some scattered pyrite.				
350.0-357.4	Evidence of more silicification and carbonatization more pyrite, some light shearing @ 45° to core.				
357.4-360.0	5% quartz well min. with pyrite.	440	2'.8"		
360.0-375.0	Silicified and mineralized with pyrite.				
375.0-393.5	Medium grey, fine-grained massive lava.				
393.5-394.3	Well mineralized with fine pyrite, one 1/4" quartz strg.	441	10"		
394.3-398.2	Lava.				
398.2-399.5	Some pyrite associated with epidote.	442	1'.3"		
399.5-400.00	Lava.				
400.00-415.0	Massive grey fine-grained lava, with some narrow carbonate stringers leached in places, some epidote sparse pyrite.				
415.0-418.2	Much more epidote some pyrite at 417.0. 1/2" quartz stringers @ 417.0.	443	1'.4"	416.10-	418.2
418.2-419.0	Same as above a little more quartz.	444	10"		
419.07-425.0	Massive lava.				
425.0-450.0	Massive grey lava, some scattered carbonate strgs. some epidote, very little pyrite.				



NORTHERN MINER PRESS LIMITED TORONTO STOCK FORM NO. 201 REV. 12 44

DRILLED BY Heath & Sherwood Ltd.SIGNED D. Sirola

Lat. 28+80W
Dep. 0+00N
Bearing: 5-45°W
Dip: 45°

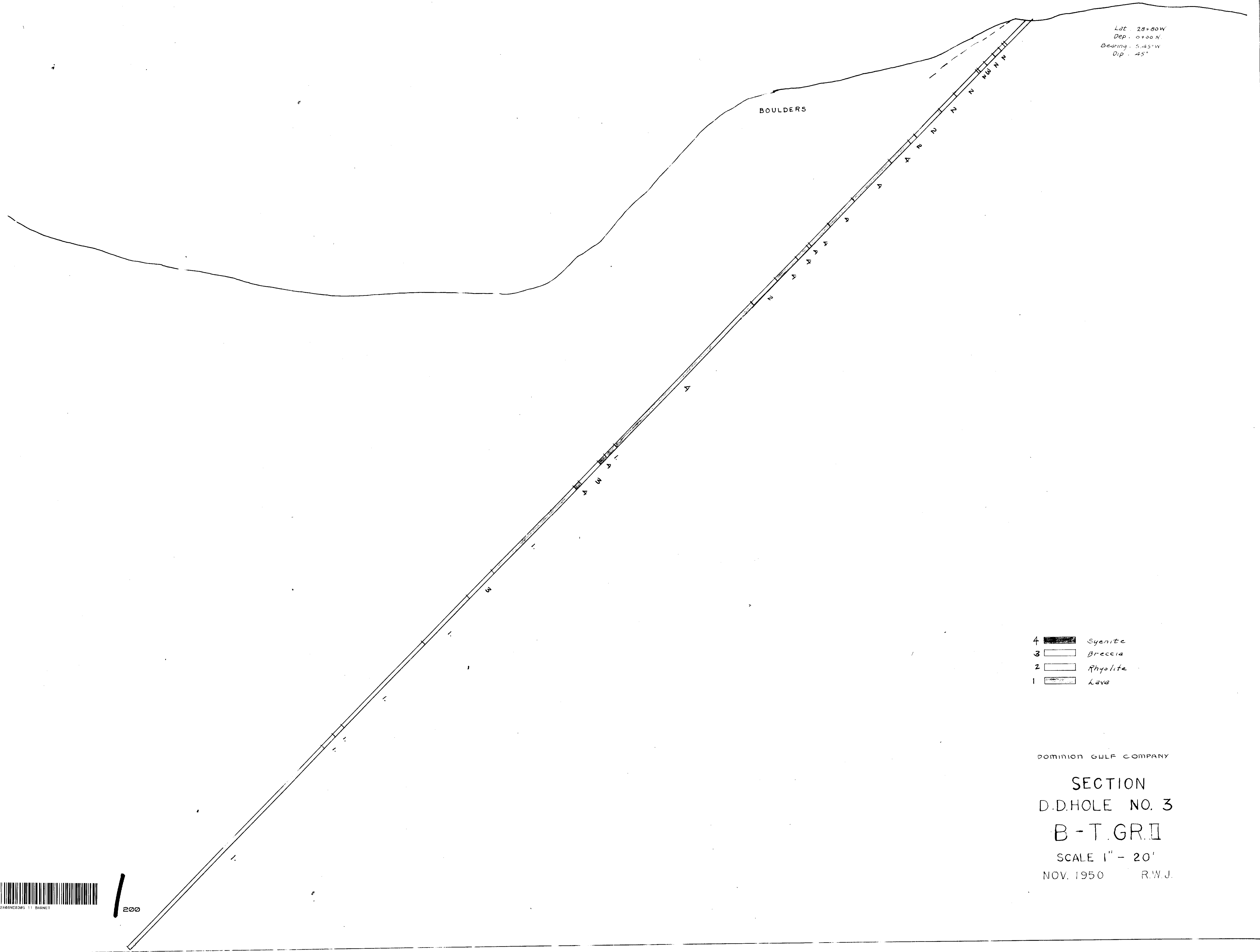
BOULDERS

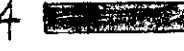
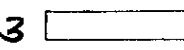
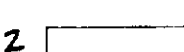

- 4  Syenite
- 3  Breccia
- 2  Rhyolite
- 1  Lava

DOMINION GULF COMPANY
SECTION
D.D.HOLE NO. 3
B-T.GR.II
SCALE 1" = 20'
NOV. 1950 R.W.J.



1
200

Lat. 6+40W
Dep. 7+50N
Bearing 105°
Dip. 45°

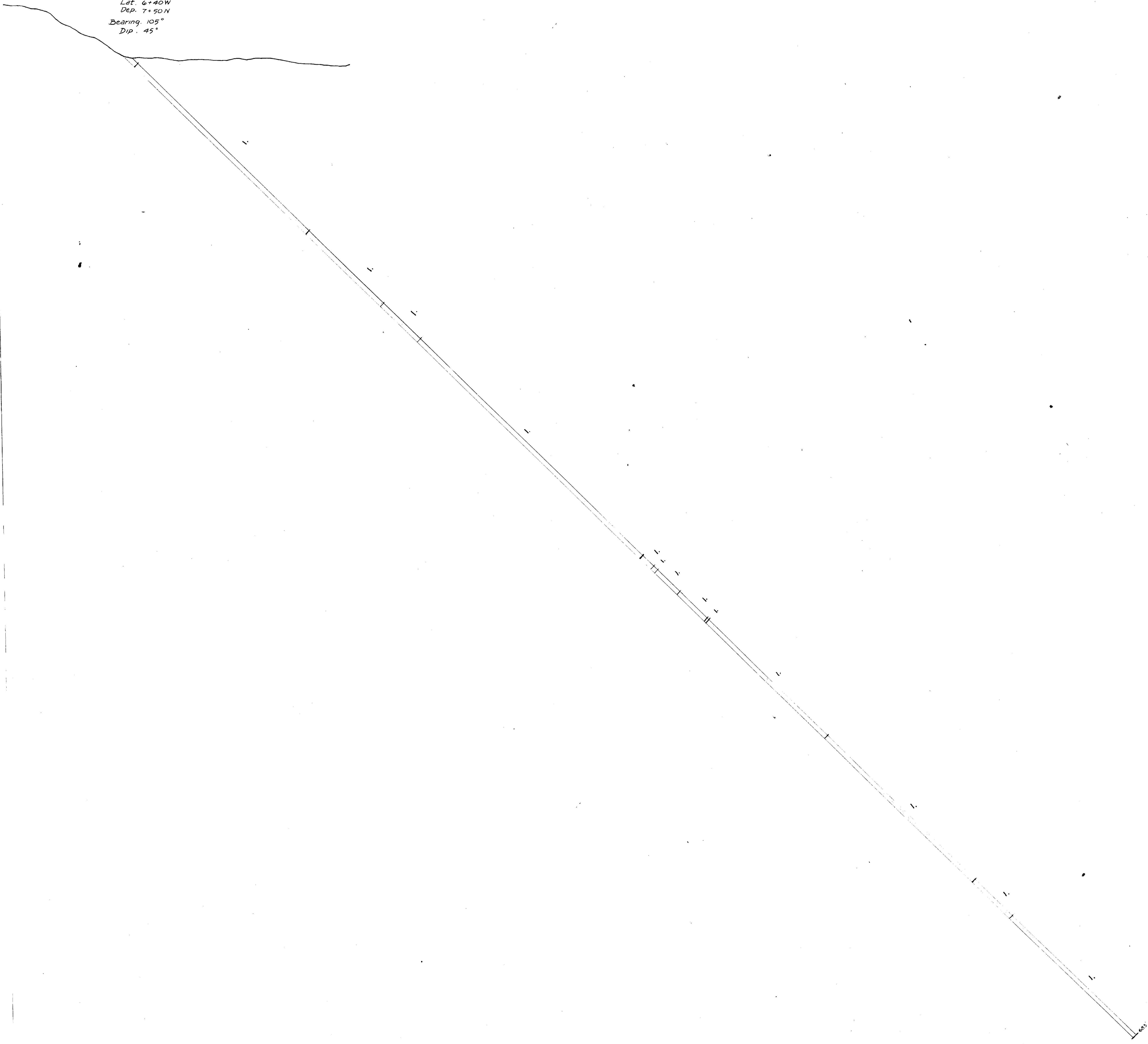

DOMINION GULF COMPANY

SECTION
D.D.HOLE NO. 4
B-T.GR.II
SCALE 1" = 20'
DEC. 1950 R.W.J.

L.  Lava.



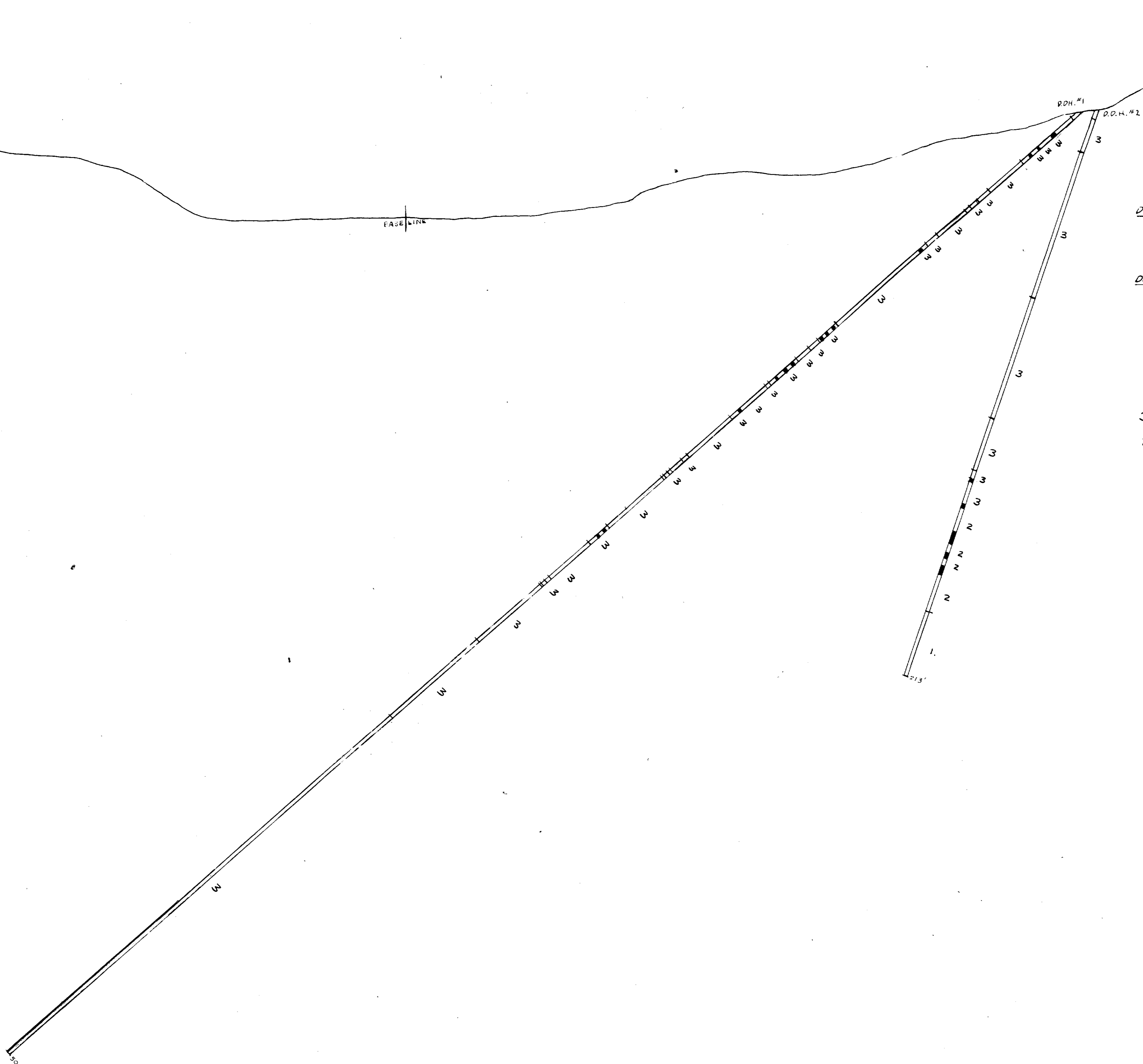

D.D.H. #1
 Lat. 2+43N
 Dep. 18+40W
 Bearing. South.

D.D.H. #2
 Lat. 2+43N
 Dep. 18+40W
 Bearing South.

- 3 Asicular amphibolite
- 2 Breccia
- 1. Andesite

DOMINION GULF COMPANY
SECTION
 D.D.HOLES 1 & 2
 B-T.GR.□
 SCALE 1" - 20'
 NOV. 1950 R.W.J.

