



42A08NW0227 63.3154 PLAYFAIR

010

11701

REPORT ON
GEOLOGIC AND MAGNETIC SURVEYS
PLAYFAIR TOWNSHIP
CLAIM GROUP
SHERWIN MINERALS LIMITED

December 1, 1973

Report on
Geologic and Magnetic Surveys
Playfair Township
Claim Group
Sherwin Minerals Limited

SUMMARY

Sherwin Minerals Limited holds 14 contiguous unpatented mining claims in lots 12 and 13, concession IV Playfair and lot 1, range IV McCann Townships. Earlier work for gold in this property has been reported. During October and November 1973 magnetic and geologic surveys were carried out. The location of the gold exploration in the 1930's was established.

It is considered best for this current program to test new possibilities on the property and not the old area of exploration. Two magnetic lows considered possible syenite intrusives and should be tested by diamond drilling. The budget for 1000 feet of diamond drilling would be \$10,000.

T. Gledhill



Report on
Geologic and Magnetic Surveys
Playfair Township
Claim Group
Sherwin Minerals Limited

I. INTRODUCTION

The company holds a group of 14 contiguous unpatented mining claims in Playfair and McCann Townships. The area was very active in 1930 with gold exploration. With renewed interest in gold, the company's property was mapped geologically and magnetically in order to select drill holes.

II. PROPERTY, LOCATION AND ACCESS

The property comprises 14 contiguous unpatented mining claims in Playfair and McCann Townships as follows:

L 373218 - 31 inclusive (14 claims)

560 acres approximately

being	N 1/2 lot 12)	
	NW 1/4 of S 1/2 lot 12)	Concession IV Playfair Twp.
	N 1/2 lot 13)	
	N 1/2 of S 1/2 lot 13)	
	NE 1/2 of S 1/2 lot 1)	Concession IV McCann Twp.
	N 1/2 of lot 1)	

The property is located four miles west of Ramore on Highway #11 and the Ontario Northland Railroad. It is reached by travelling one mile south of Ramore on Highway #11 and then west along a concession road three miles to Wildgoose River and then through the centre of the property by travelling up Wildgoose River.

III. GENERAL GEOLOGY

The rocks of the area are Keewatin greenstone intruded younger granites, porphyries and diabase dykes. The trend of the volcanics is east-west. An airborne magnetic high occurs over the claim group. The property is over half overburden covered. The magnetic survey was carried out to assist in interpreting the geology.

IV. ECONOMIC GEOLOGY

Gold is the only metal of economic interest in the area. It occurs as native gold, or with sulphides in or around granite intrusives, porphyry and syenite bodies. Exploration is carried out by mapping and surface trenching and sampling followed by diamond drilling. E.S. Moore's report (ODM Vol. XLV Part VI, 1936) indicated that the area was explored by Noranda Mines Limited in the 1930's but gave no details.

1.6
2.4
6.4

V. MAGNETIC SURVEY

A description of the procedure for the magnetic survey is attached.

Discussion of Results

The magnetic survey when contoured produced a map that is typical of Keewatin greenstones. The strike of the magnetics conforms to the volcanics. Some of the north-south trending Matachewan diabases dykes are evident from the magnetics. Magnetic lows exist in the northeast corner and likely reflect the hornblende syenite or granite intrusives. There does not seem to be an explanation within the outcrops of the low across the property at 10+00S. There is a low in the southwest corner where the property is mainly overburdened and flooded. The only rocks that outcrop are diabase. The balance of the rock is possibly granite or syenite. The conclusion that is drawn from the magnetic survey is that the acid intrusives occupy the overburdened areas while the massive basic volcanics form exposed in high resistant ridges.

VI. GEOLOGIC SURVEY

The geologic mapping was completed a few days before the snow covered the ground. The geologic mapping produced no surprises and the geology is as identical to the

to the ODM map 45d.

The syenite and granite was not observed to any great extent so it is necessary to depend on E.S. Moore's descriptions.

The volcanics are mainly massive basic flows that form resistance east-west striking ridges. These have been intruded by syenite and diabase dykes.

In the area between lines 24W and 32W about 12+00S east-west striking syenite dykes have been extensively explored in the 1930's. Many trenches and several drill holes were located.

Moore describes this area as "Much trenching was done, and a number of diamond-drill holes, from which the casing has been pulled, were sunk on an irregular quartz zone lying along the east side of a large hill of porphyritic Keewatin lavas. The trenches extend along the hill for a distance of about 400 feet. There is no definite vein, but numerous stringers of quartz make up a zone that in one section has been channel sampled across a width of 15 feet. - - - - In some places the zone is well mineralized and in others it is practically barren of sulphide. Irregular dikes of syenite are associated with the quartz."

At the present time no work is planned in the area described by Moore. The area that is to be tested is the overburdened area on the northeast portion of the property.

VII. CONCLUSIONS AND RECOMMENDATIONS

The property is much as it has been described in government literature. The area of previous activity to the south end of the property will not be worked on at this present time. Attention is focused to testing the overburdened area in the northeast portion of the property which is thought to be underlain by syenite or granite intrusives.

It is recommended that the lows at 10N line 16W and 1+00S line 20W be tested with one drill hole each.

A budget for this work would be:

1000 feet at an all inclusive cost of \$10/foot \$10,000.00

Respectfully submitted,



Tom Gledhill, B.A., P.Eng.

December 1, 1973.



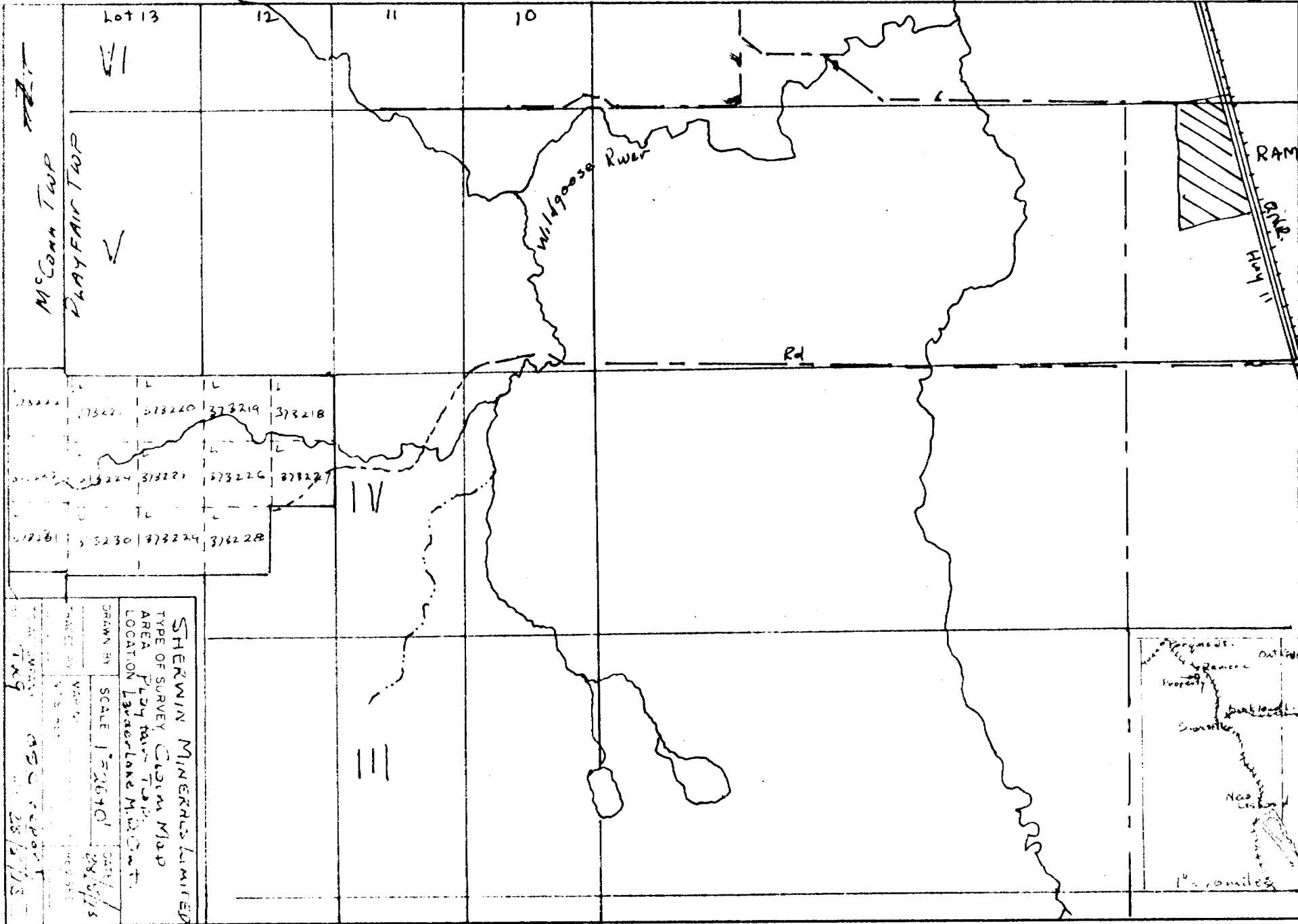

Lot 13

12

11

10

VI

V

IV

III

Wildgoose River

Rd

RAMORE

Hwy 11

373224	373225	373226	373227	373228
373229	373230	373231	373232	373233
373234	373235	373236	373237	373238

SHERWIN MINERALS LIMITED
 TYPE OF SURVEY: CLAIM MAP
 AREA: PLAY FAIR TWP
 LOCATION: BRUCELAND M.D. ON T.
 DRAWN BY: [Signature]
 SCALE: 1" = 2690'
 DATE: 28/5/73
 PROJECT NO: 28/5/73

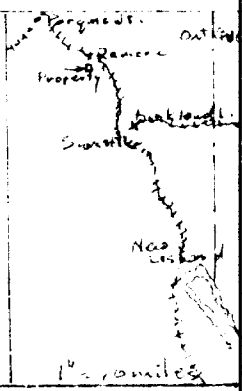

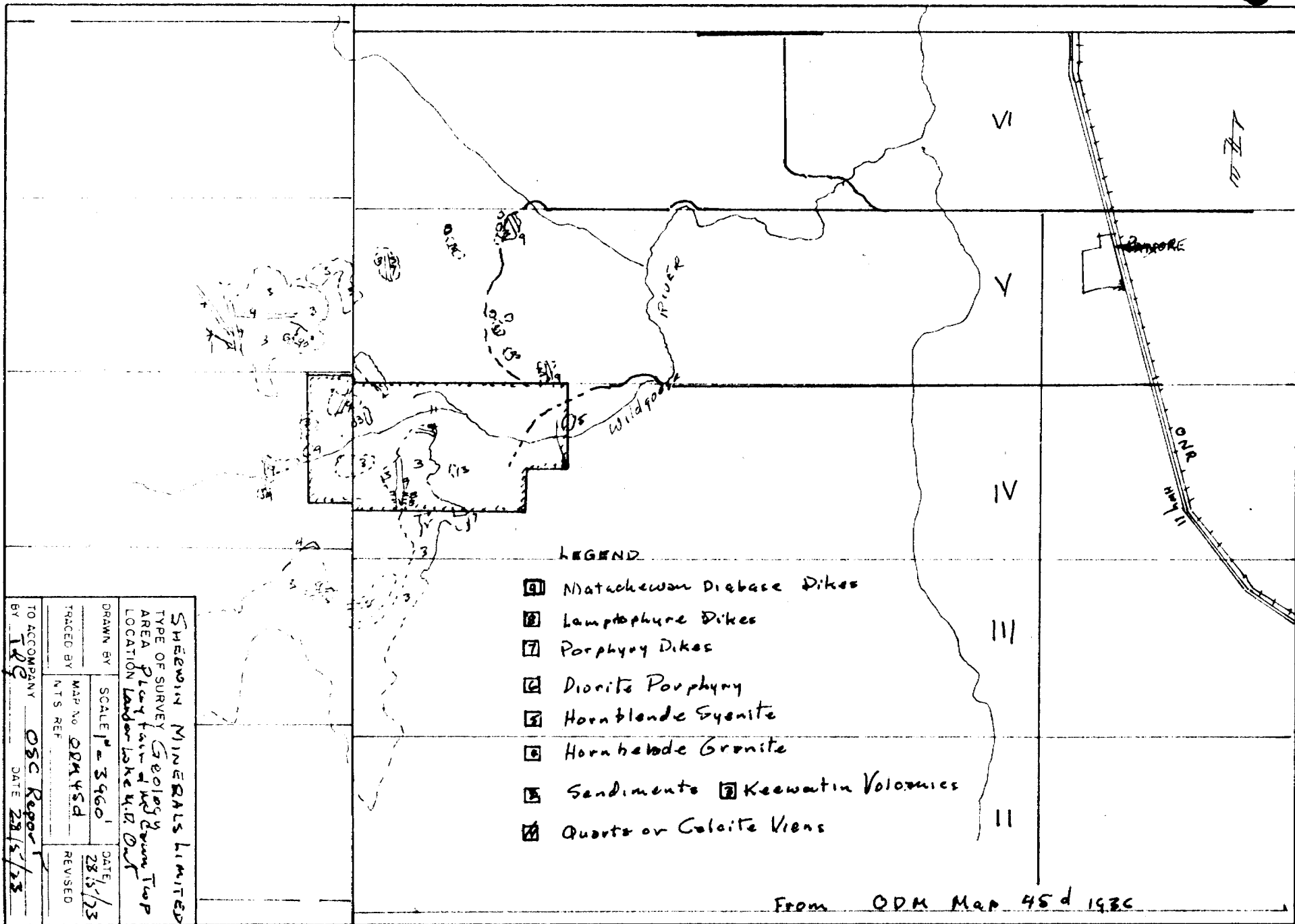

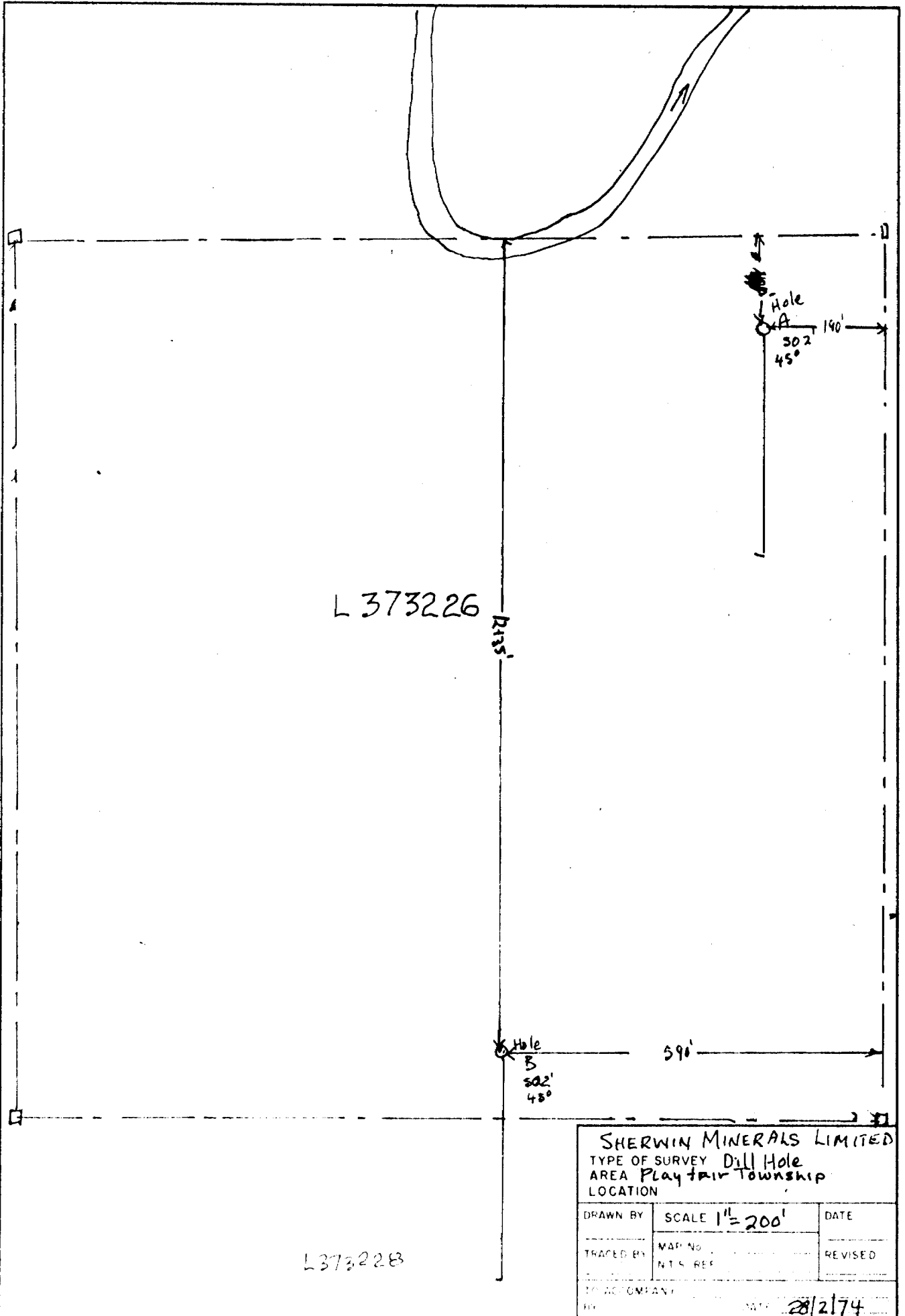

L 373226

1135'

Hole A
190'
302'
45°

Hole B
590'
302'
45°

SHERWIN MINERALS LIMITED
TYPE OF SURVEY Dill Hole
AREA Playfair Township
LOCATION

DRAWN BY	SCALE 1" = 200'	DATE
TRACED BY	MAP No. NTS REF	REVISED
TO ACCOMPANY		BY 28/2/74

L373228

Drill Core Log

Property Sherwin Minerals Limited

Hole No. A

Latitude 12+00N Bearing Grid South Page 1 of 1

Departure 16+00W Dip 45° @ Collar

Location Claim L 373226 Length 502.0' Core Size AXT
Flaggair Twp. Ont.

Elevation 0.00 arbitrary Started Feb 14/74 Completed Feb 18/74

FROM	TO	FORMATION	SAMPLE NO.	LENGTH FT.	au	Cu
0	22	Casing				
<u>22</u>	<u>33.8</u>	Volcanics - basic, massive dark nematite + epidote alteration				
<u>33.8</u>	<u>502</u>	Granite Diorite - grey - massive				
27.0	27.4	Sample - 2% pyrite, epidote alteration	A 2085	0.4'	TF	

99 % CORE RECOVERY

*Core entered at MORISSETTE P.D. LTD
 Haileybury, Ont.*

Drilled by MORISSETTE P.D. LTD

Logged by Tom Bidwell PERG

Drill Core Log

Property Sherwin Minerals Limited

Hole No. B

Latitude 11°00'N Bearing Grid South Page 1 of 1

Departure L 20+00W Dip 45° @ Collar

Location Claim L373226 Length 502.0' Core Size AXT

Elevation 0.00 arbitrary Started Feb 21/74 Completed Feb 23/74

FROM	TO	FORMATION	SAMPLE NO.	LENGTH FT.	Al ₂ O ₃ /Ton	SiO ₂ /Ton
0	14	Casing				
14.0	21.7	Volcanic - acid, dark, badly fractured				
21.7	44.0	Granite Porphyry, massive				
40.0	44.0	sample	A2082	4.0'	Tr	
44.0	264	Volcanic - acid dark - epidote				
44.0	167	massive, dark red hematite filled fractures				
167	264	- light, contorted epidote & hematite				
198.2	198.7	Sample	A2083	0.5'	Tr	0.08%
257	264	- badly broken				
264	298	Volcanic - intermediate, dark massive				
298	311	Volcanic Fracture Zone, quartz, hematite, chlorite				
311	477	Volcanic - intermediate - dark fracture, quartz & hematite				
477	502	Granite - grey, fine grained hematite fractures				
481.2	481.7	sample	A2084	0.5'	Tr	

Core stored at Morrisette P.P. Ltd.
Burlington Ont

99 % CORE RECOVERY

Drilled by _____ Logged by _____

X-RAY ASSAY LABORATORIES

LIMITED

45 LESMILL ROAD

DON MILLS ONTARIO M3B 2T8

445-5755

Certificate of Analysis

NO. 10765 PAGE 1 of 1

TO: T. Gledhill,
21 Sandalwood Place,
DON MILLS, Ontario.
M3B 1L5.

RECEIVED March 1, 1974

INVOICE NO. 10765

SAMPLE(S) OF 3 W. Core + 1 S. Core SUBMITTED TO US SHOW RESULTS AS FOLLOWS:

<u>Sample No.</u>	<u>% Cu</u>	<u>Au oz./ton</u>
A-2082		Trace
83	0.08	Trace
84		Trace
85		Trace

X-RAY ASSAY LABORATORIES LIMITED

DATE March 4, 1974

CERTIFIED BY 

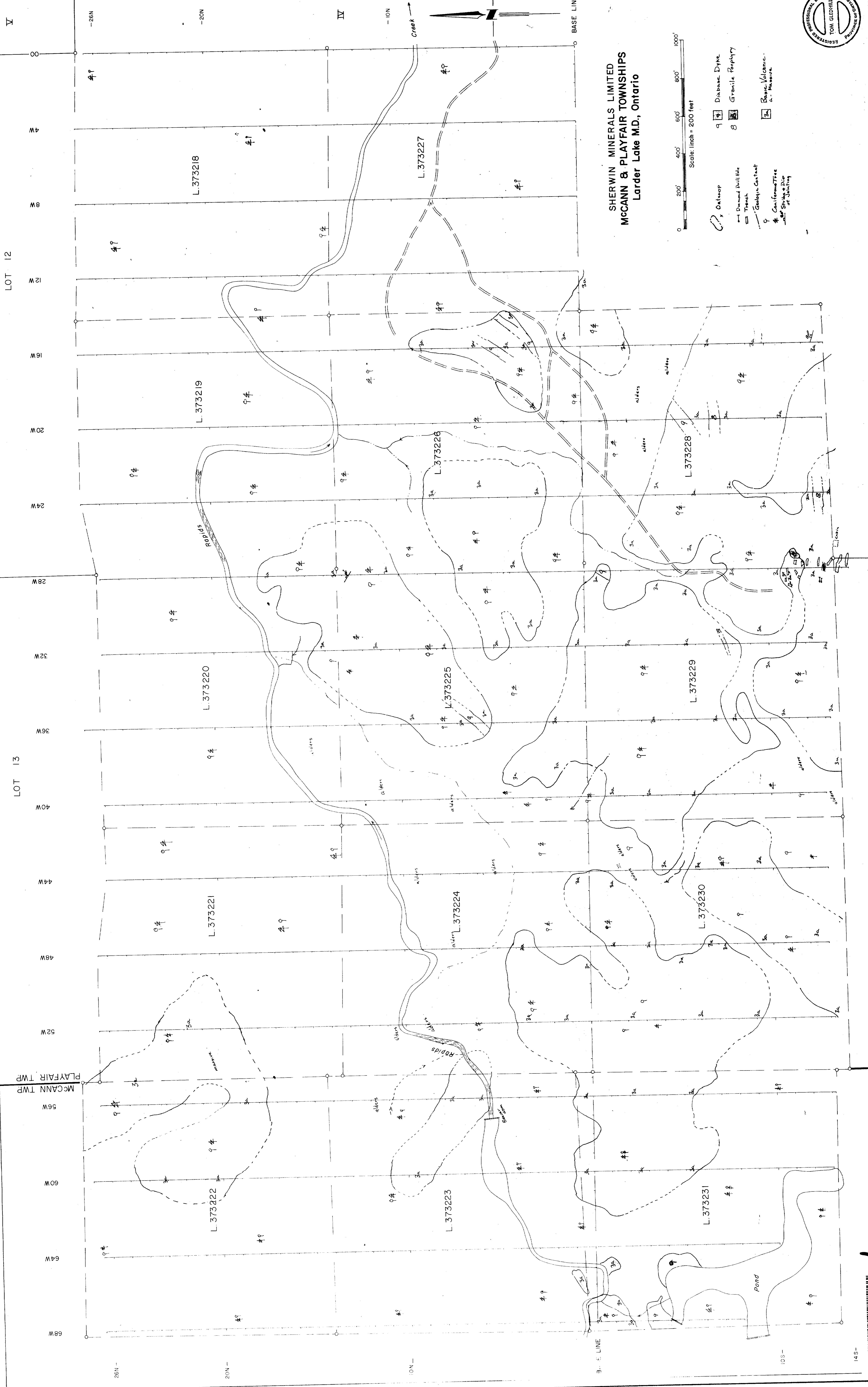

SHERWIN MINERALS LIMITED
 MCCANN & PLAYFAIR TOWNSHIPS
 Larder Lake M.D., Ontario

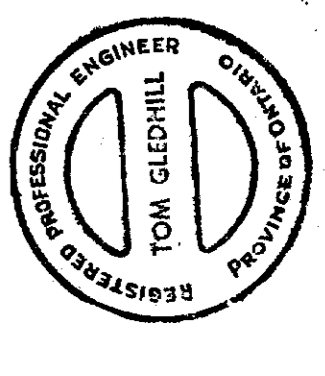
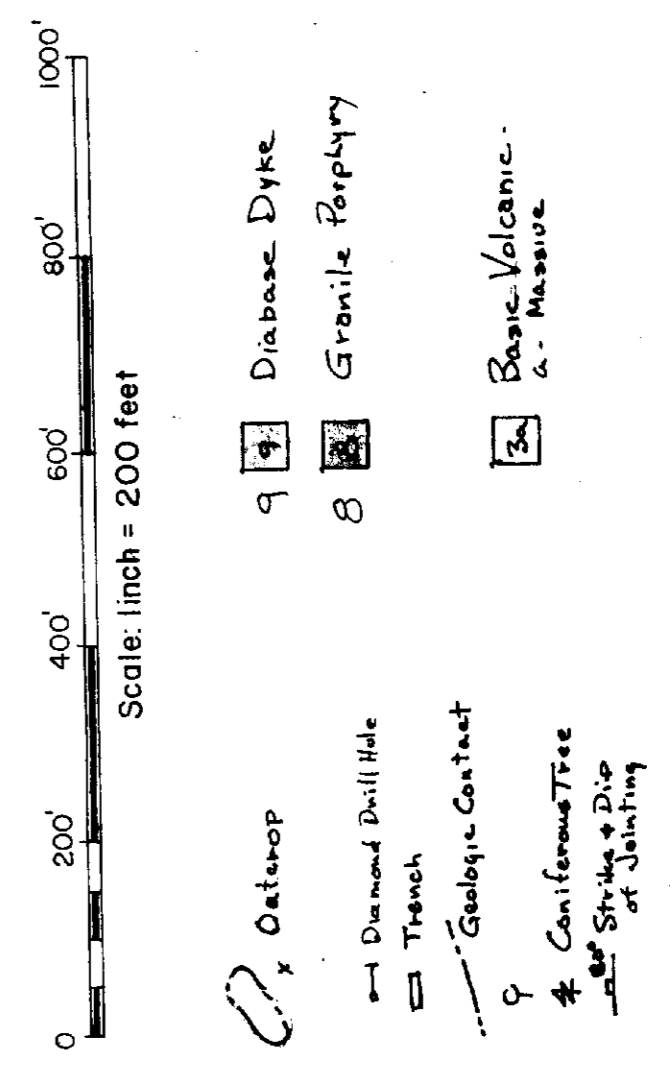

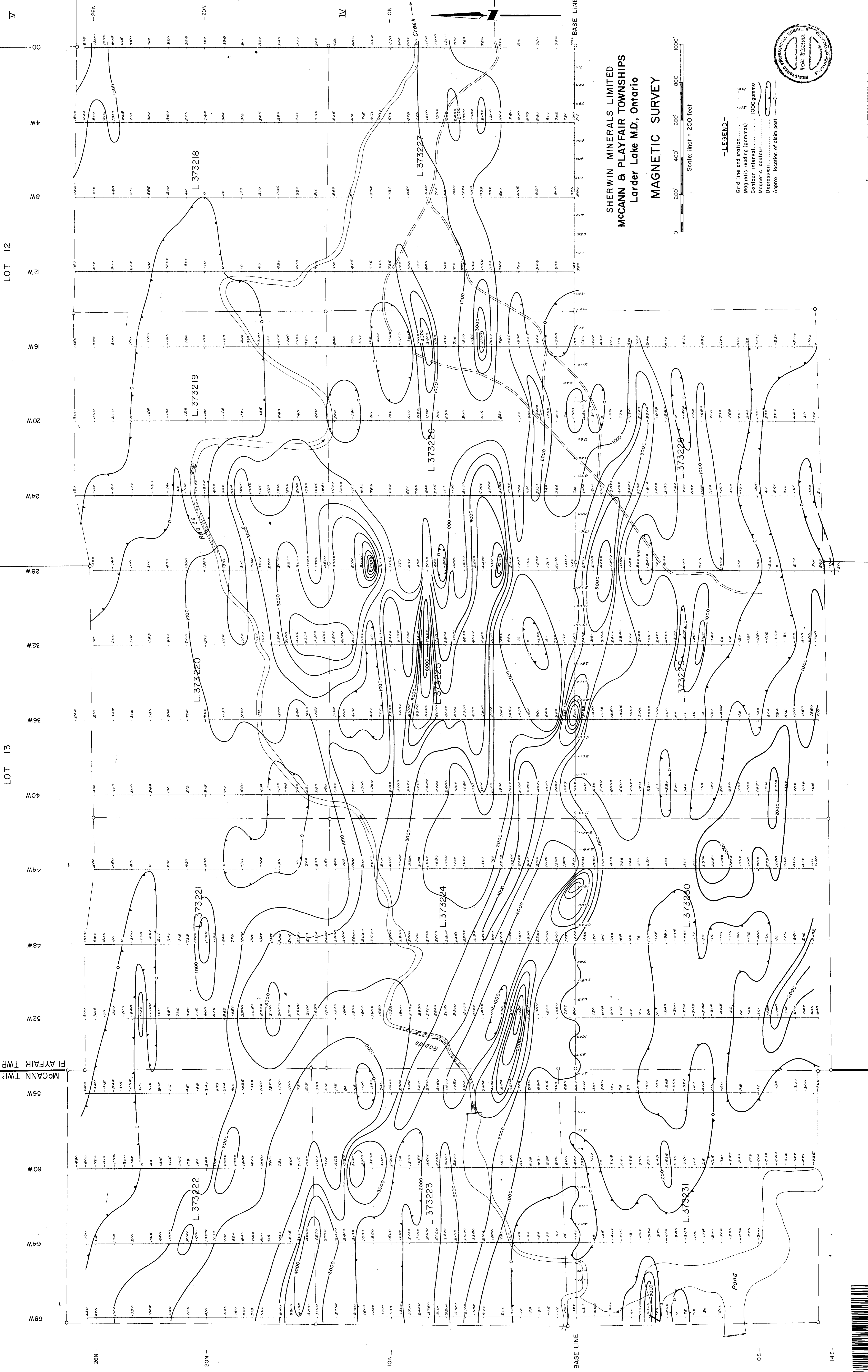

SHERWIN MINERALS LIMITED
MCCANN & PLAYFAIR TOWNSHIPS
 Larder Lake M.D., Ontario
MAGNETIC SURVEY

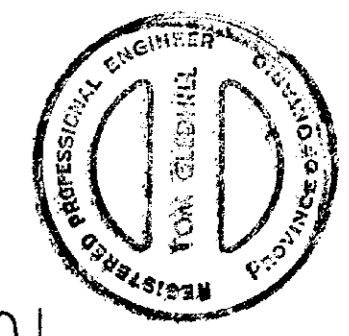

-LEGEND-
 Grid line and station
 Magnetic reading (gamma)
 Contour interval: 1000 gamma
 Magnetic contour
 Depression
 Approx. location of claim post

Scale: 1 inch = 200 feet
 0 200 400 600 800 1000

