



42A08NW0228 12 PLAYFAIR

010

Diamond Drilling

Township OF PLAYFAIR

Report NO: 12

Work performed by: C. M. HAMES (SHERWIN MINERALS LTD.)

Claim NO	Hole NO	Footage	Date	Note
L.373226	A	502'	Feb/74	(1)
	B	502'	Feb/74	(1)

Notes:

(1) 64/74 - also filed in 63.3154 as part of Mineral Exploration Assistance
Contract #KL-39

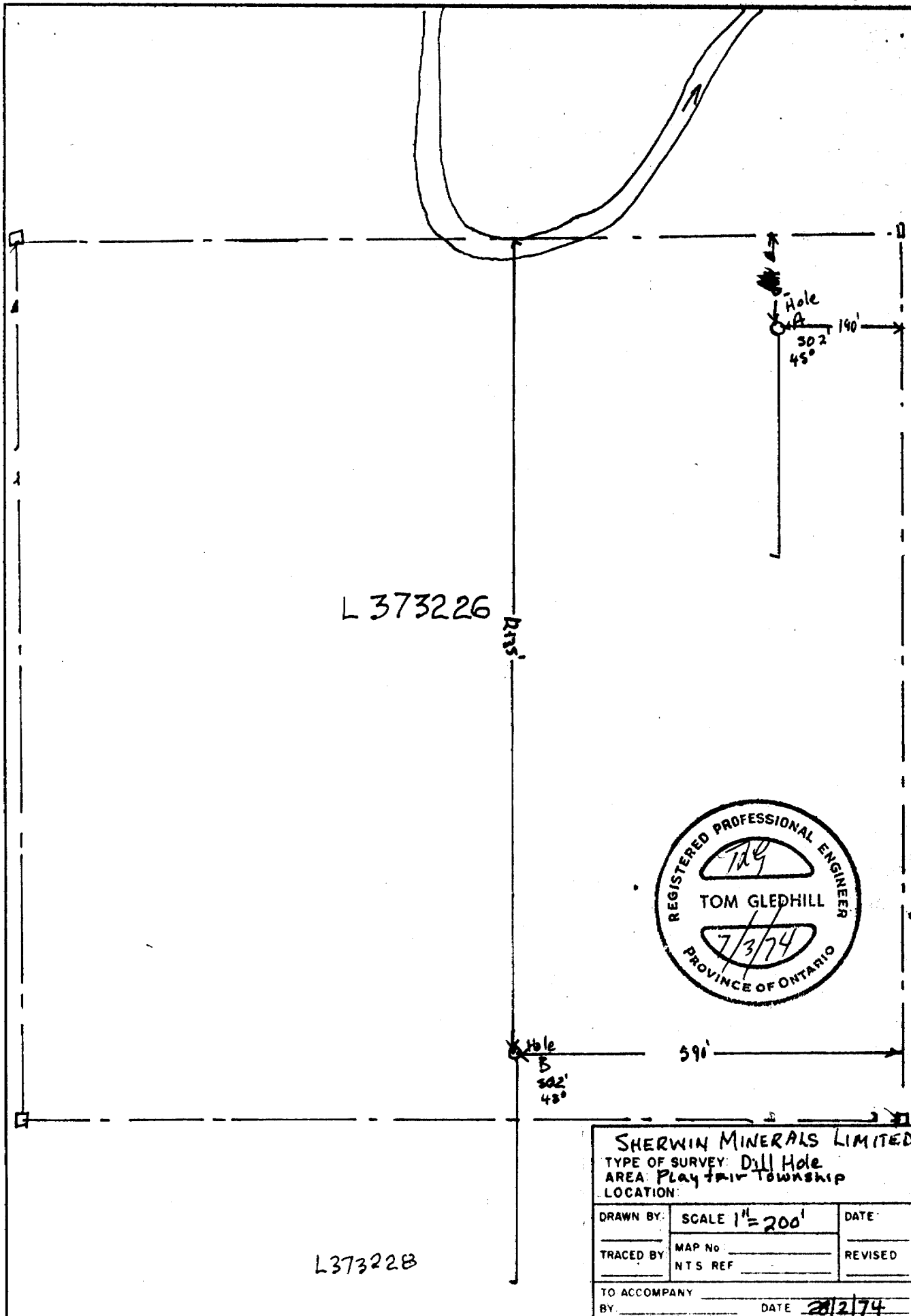

L 373226

195'



Hole B
302'
48°

590'

L 373228

SHERWIN MINERALS LIMITED		
TYPE OF SURVEY: Dill Hole		
AREA: Playfair Township		
LOCATION:		
DRAWN BY:	SCALE 1" = 200'	DATE:
TRACED BY:	MAP No. _____	REVISED
	NTS REF _____	
TO ACCOMPANY		DATE 28/2/74
BY:		

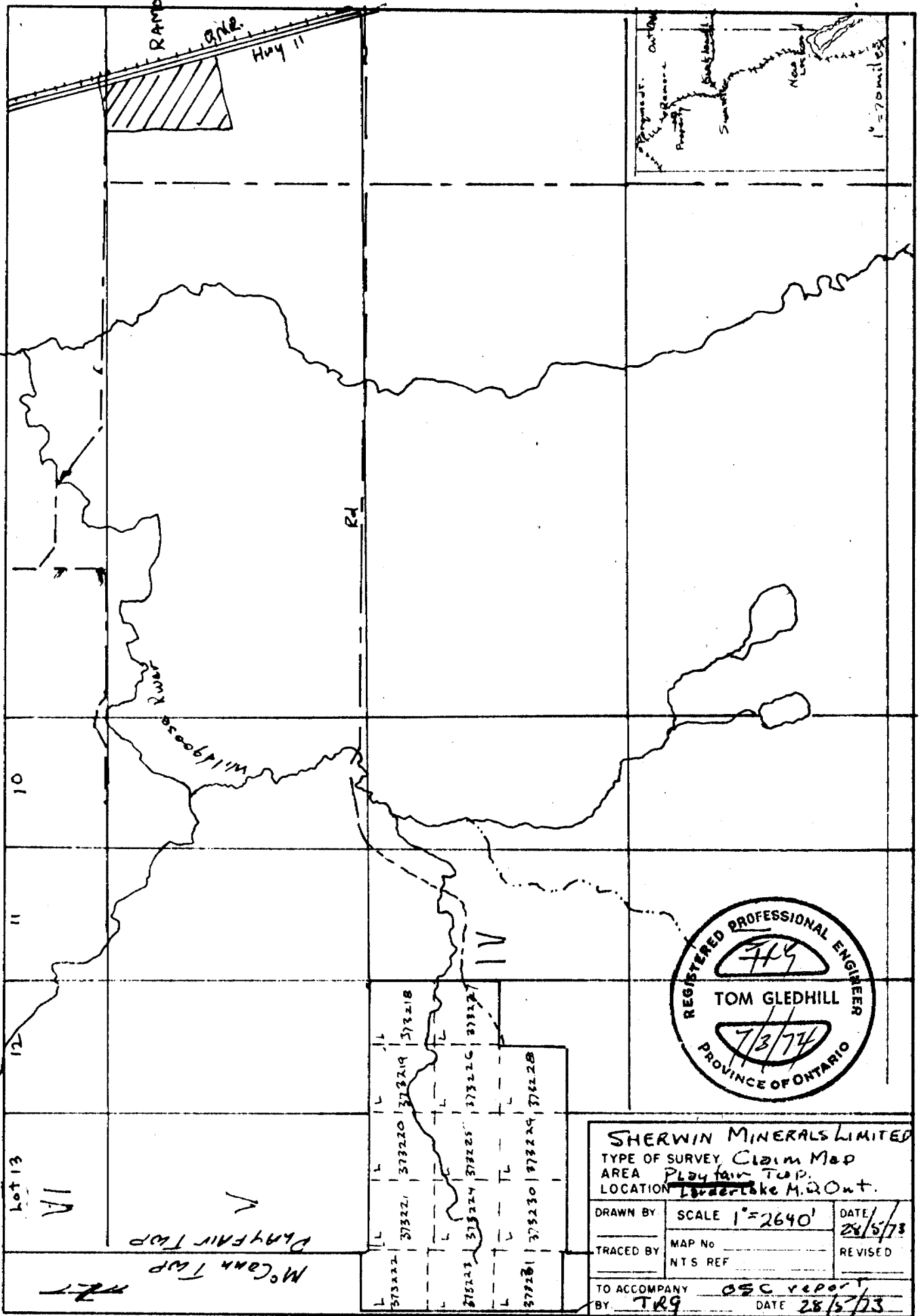

SHERWIN MINERALS LIMITED

TYPE OF SURVEY *Claim Map*
 AREA *Playfair Twp.*
 LOCATION *Lordsburg M. 20. Out.*

DRAWN BY	SCALE 1" = 2640'	DATE 8/5/73
TRACED BY	MAP No	REVISED
	NTS REF	

TO ACCOMPANY *OSC report*
 BY *TRG* DATE *28/5/73*

McCann Twp
 Playfair Twp
 Lot 13
 VI
 12
 11
 10

373222 373221 373220 373219 373218
 373223 373224 373225 373226 373227
 373228 373229 373230

Drill Core Log

Property Sherwin Minerals Limited

Hole No. A

Latitude 12+00N Bearing Grid South Page 1 of 1

Departure 16+00W Dip 45° @ Collar

Location Claim L 373226 Length 502.0' Core Size AXT
Playfair Twp. Ont.

Elevation 0.00 arbitrary Started Feb 14/74 Completed Feb 19/74

FROM	TO	FORMATION	SAMPLE NO.	LENGTH FT.	au	cu
0	22	Casing				
<u>22</u>	<u>33.8</u>	<u>Volcanics</u> - basic, massive dark hematite epidote alteration				
<u>33.8</u>	<u>502</u>	<u>Granite Diorite</u> - grey - massive				
27.0	27.4	Sample - 2% pyrite, epidote alteration	A 2085	0.4'	Tr	

Tom Gledhill

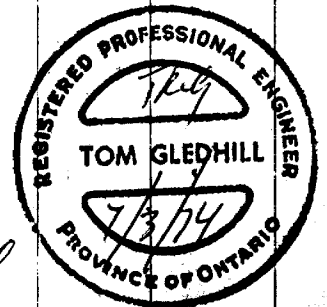

Core Stored at MORISSETTE P. D. LTD
 Halesbury, Ont.

99 % CORE RECOVERY

Drilled by MORISSETTE P. D. LTD

Logged by Tom Gledhill P. Eng

Drill Core Log

Property Sherwin Minerals Limited

Hole No. B

Latitude 11-00N Bearing Grid South Page 1 of 1

Departure L 20+00W Dip 45° @ Collar

Location Claim L373226 Length 502.0' Core Size AXT

Elevation 0.00 arbitrary Started Feb 21/74 Completed Feb 23/74

FROM	TO	FORMATION	SAMPLE NO.	LENGTH FT.	Al ₂ O ₃ %	Cu %
0	14	Casing				
14.0	21.7	Volcanic - acid, dark, badly fractured				
21.7	44.0	Granite Porphyry, massive				
40.0	44.0	sample	A2082	4.0'	Tr	
44.0	264	Volcanic - acid dark - epidote				
44.0	167	Massive, dark red hematite filled fractures				
167	264	- light, contorted epidote & hematite				
198.2	198.7	Sample	A2083	0.5'	Tr	0.08%
252	264	- badly broken				
264	298	Volcanic - intermediate, dark massive				
298	311	Volcanic Fracture Zone, quartz, hematite, chlorite				
311	477	Volcanic - intermediate - dark fracture, quartz & hematite				
477	502	Granite - grey, fine grained hematite fractures				
481.2	481.7	sample	A2084	0.5'	Tr	

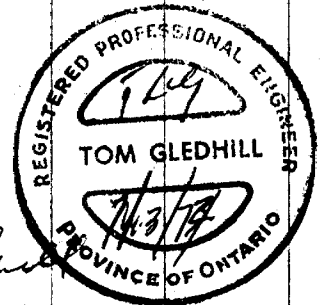

Tom Gledhill

Core Stored at Morissette D.P. Ltd.

99 % CORE RECOVERY

Drilled by

Logged by