



REPORT
ON
BLUE MOUNTAIN PROPERTY

IN
BERNHARDT AND MAISONVILLE TOWNSHIPS

OF THE
LARDER LAKE MINING DIVISION

IN THE
DISTRICT OF TIMISKAMING
ONTARIO

FOR
LONGBOW LAKE EXPLORATION SYNDICATE

RECEIVED

APR 28 1986

MINING LANDS SECTION

February 23, 1986

W. MacRAE

Qual.
2.3027



TABLE OF CONTENTS

	<u>Page</u>
Work Summary	(ii)
Introduction	1
Topography and Vegetation	4
Property	4
History	6
General Geology	11
Property Geology	11
Basal Till Sampling Program	12
Summary	13
Conclusions	14
Recommendations	15
Cost Estimates for Recommended Programs	15
Certificate	17
Bibliography	18
Appendix I - Sample Descriptions and Results	
Appendix II - Invoices	

LIST OF FIGURES

- Figure 1. Location map, Maisenville and Bernhardt Townships
- Figure 2. Claim location map, Maisenville and Bernhardt Townships (Scale 1" = 1/2 mile)
- Figure 3. "Cabin" vein shaft sample plan
- Figure 4. Consolidated Beaumont Resources Ltd. drill hole locations and assays

LIST OF TABLES

- Table 1. Claim Status (as of February 17, 1986)
- Table 2. Summary of Diamond Drill Results
- Table 3. Bedrock Sample Descriptions

LIST OF MAPS

- Map 1. Basal Till Hole Locations (in back pocket)

WORK SUMMARY

Overburden Sampling	\$ 9,241.90
Assaying	416.25
Supervision and Report	<u>\$ 5,322.50</u>
Total Expenditures	\$14,980.65
Man days credits available @ \$15/man days	998.71
Man days requested	998.71

INTRODUCTION

The Blue Mountain property consists of twenty-four (24) contiguous unpatented mining claims in northwestern Bernhardt Township and northeastern Maisonville Township. This report discusses the exploration history of the property and the work completed in the past year.

The property was first explored in the early 1920's with two shallow shafts sunk over a strike length of 7300 feet. In 1974, ground geophysical surveys were carried out and limited follow-up diamond drilling. From 1979 to 1981, geophysical surveys were completed with follow-up backhoe trenching.

In the past year bulldozer stripping and backhoe trenching in the southeastern area of the property was completed. In addition, a two phase basal till sampling program has been completed.

This report is an attempt to assimilate all of the known data on the property and generate a comprehensive exploration program for the future.

LOCATION AND ACCESS

The property is located 10 air miles northwest of the town of Kirkland Lake and 57 air miles east-southeast from the City of Timmins (Figure 1). The property consists of 19 mining claims in northwestern Bernhardt Township and 5 mining claims in northeastern Maisonville Township (Figure 2).

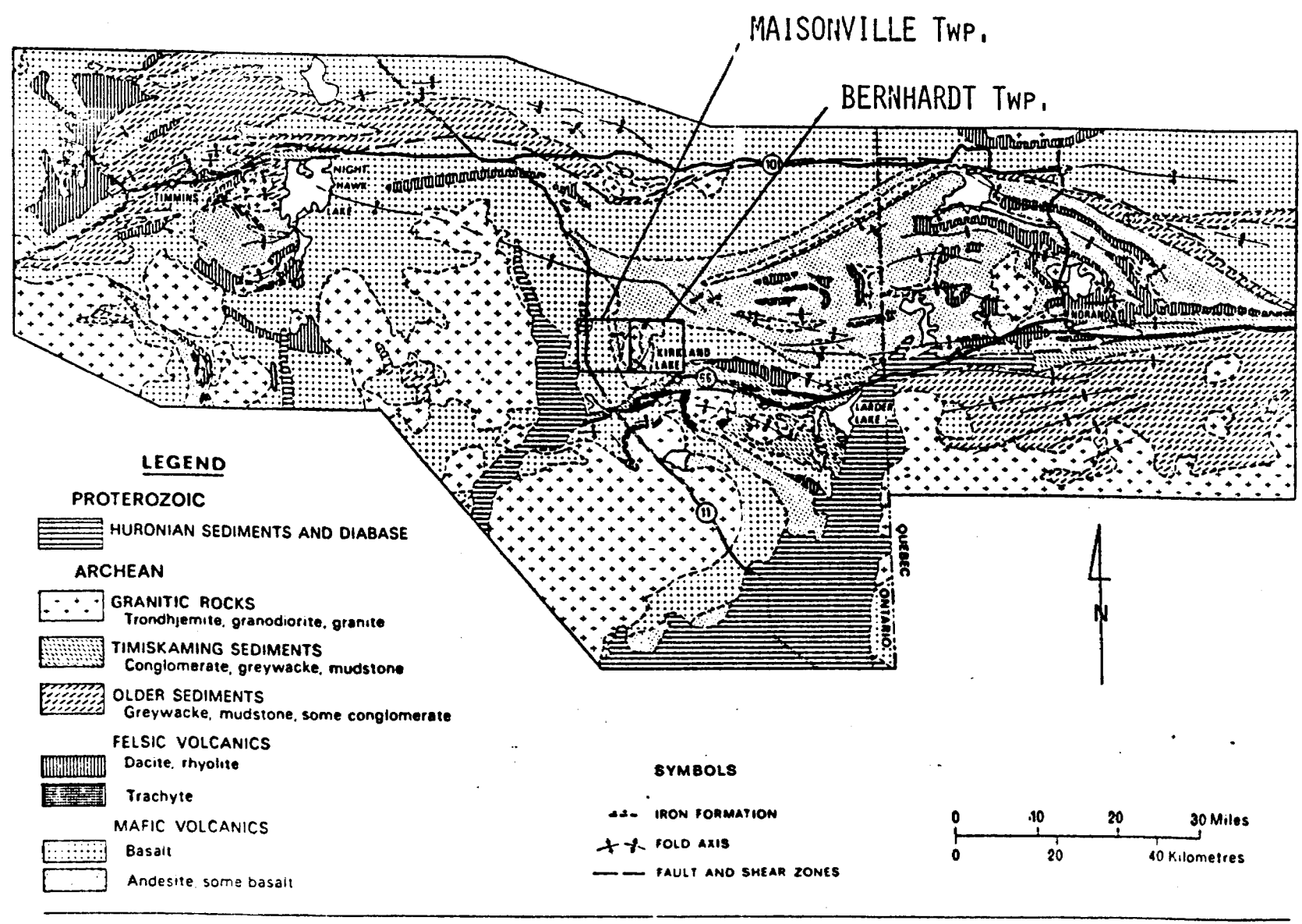

Figure 1. Location map, Maisonville and Bernhardt townships.

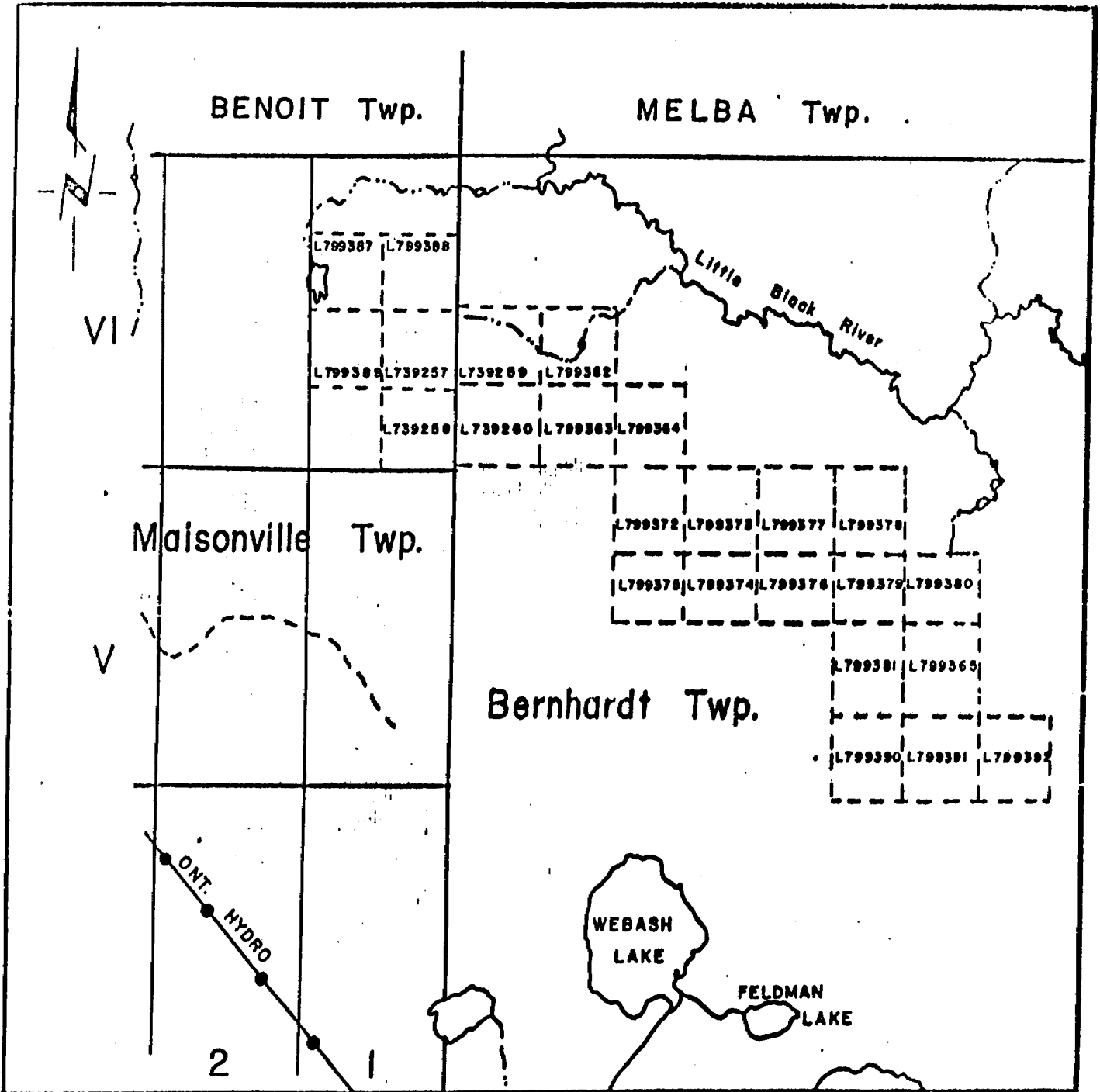

Figure 2. Claim location map, Maisonville and Bernhardt Townships (Scale 1" = 1/2 mile).

Access to the property is by way of Trans Canada Highway (Highway 11), 14 miles north, from Kenogami Lake to the turn-off to Bourkes. A gravel road leads due east from Highway 11 passing through Bourkes Station, on the Ontario Northland Railway, for approximately three miles. A sometimes travelable bush road leads east and south from this point to the property.

TOPOGRAPHY AND VEGETATION

The property can be described as low rolling hills and bedrock exposures separated by swamp. The most prominent topographic feature in the area is Blue Mountain attaining an elevation of 1500 feet above sea level and is located to the southeast of the property.

The vegetation consists of birch, spruce, jack pine and poplar in the dryer areas and tag alder, cedar, spruce, willow, balsam fir and poplar in the swamp areas.

PROPERTY

The Blue Mountain property consists of 24 contiguous unpatented mining claims in Bernhardt and Maisonville Townships, Larder Lake Mining Division, District of Timiskaming. The claims are registered in the name of Carl P. Forbes as of February 17, 1986.

Table 1 below outlines the present status of the claims comprising this property.

TABLE 1

CLAIM STATUS (as of February 17, 1986)

<u>CLAIM #</u>	<u>RECORDING DATE</u>	<u>ASSESSMENT WORK FILED</u>	<u>DATE WORK DUE</u>	<u>AMOUNT</u>
L739257	March 27, 1984	60 days	March 27, 1987	40 days
L739258	March 27, 1984	60 days	March 27, 1987	40 days
L739259	March 27, 1984	60 days	March 27, 1987	40 days
L739260	March 27, 1984	60 days	March 27, 1987	40 days
L799362	April 4, 1984	60 days	April 4, 1987	40 days
L799363	April 4, 1984	60 days	April 4, 1987	40 days
L799364	April 4, 1984	60 days	April 4, 1987	40 days
L799365	April 4, 1984	60 days	April 4, 1987	40 days
L799372	April 4, 1984	60 days	April 4, 1987	40 days
L799373	April 4, 1984	60.4 days	April 4, 1987	39.6 days
L799374	April 4, 1984	60 days	April 4, 1987	40 days
L799375	April 4, 1984	60 days	April 4, 1987	40 days
L799376	April 4, 1984	64 days	April 4, 1987	36 days
L799377	April 4, 1984	64 days	April 4, 1987	36 days
L799378	April 4, 1984	60.4 days	April 4, 1987	39.6 days
L799379	April 4, 1984	71.92 days	April 4, 1987	28.08 days
L799380	April 4, 1984	60 days	April 4, 1987	40 days
L799381	April 4, 1984	60 days	April 4, 1987	40 days
L799387	April 4, 1984	60 days	April 4, 1987	40 days
L399388	April 4, 1984	60 days	April 4, 1987	40 days
L799389	April 4, 1984	73.37 days	April 4, 1987	26.63 days
L799390	April 4, 1984	43 days	April 4, 1986	17 days
L799391	April 4, 1984	44.3 days	April 4, 1986	15.7 days
L799392	April 4, 1984	70.43 days	April 4, 1987	29.57 days

HISTORY

The Ontario Bureau of Mines first reported on this area in 1914, in a report by A. G. Burrows and P. E. Hopkins entitled Maisonville, Grenfell and Eby Townships and in 1916, Bernhardt Township was covered by the same authors in a report entitled Goodfish Lake Gold Area. A report in 1921 by D. G. H. Wright entitled Black River Area also covered the geology of Bernhardt and Maisonville Townships. In 1923, the Ontario Department of Mines included Bernhardt Township in a report on the Kirkland Lake Gold area by A. G. Burrows and P. E. Hopkins. In more recent times, Bernhardt Township was mapped by R. J. Rupert and H. L. Lovell in 1967 with an open file report (5022) released in 1968 and a final report (84) released in 1970. Maisonville Township was mapped in 1965 and 1966 by H. L. Lovell with an open file report (5036) released in 1969 and the final report (92) released in 1971. Data series maps were published for Bernhardt (P-893) and Maisonville (P-876) Townships in 1978 and 1979 respectively. In 1979, airborne electromagnetic and magnetic surveys were published by the Ontario Geological Survey for Maisonville and Bernhardt Townships.

The first reported exploration work on the property was by Challenger and Height of Land Properties of Cobalt in 1922. A report by J. H. Rattray described two showings; the "Jumbo" vein described as a contact zone between diabase and massive greenstone with assays varied from 0.01 to 0.17 oz./ton Au over narrow widths; and the "Cabin" vein situated in greenstone and assaying from 0.01 to 0.41 oz./ton Au over narrow widths. Further work was recommended by Rattray.

In September 1937, R. F. Taylor reports for Kinika Gold Mines Limited, have taken over the property from Ontario Gold Mines Ltd.. Sometime between 1922 and 1937, shafts were sunk on the "Cabin" and "Jumbo" veins. On the "Jumbo" vein a shaft was sunk to 50 feet with no reported assays. On the "Cabin" vein a shaft was sunk to 55 feet with 45 feet of lateral work completed on the 50 foot level. The "Cabin" vein shaft intersected a siliceous zone that averaged 0.16 oz./ton Au (cut to 1 oz./ton) over 15 feet. It is reported that coarse visible gold was obtained from the east wall, but on close inspection no further visible gold was found. Six additional samples were taken and averaged (Figure 3).

No further work was reported for the property until the early 1970's. Ajax Minerals Ltd. completed limited trenching in 1972 around the "Cabin" vein.

In May 1974, Consolidated Beaumont Resources Ltd. reported working on the property. Consolidated Beaumont completed magnetometer and EM surveys with 2860 feet of diamond drilling in eight holes as follow-up. The results of the diamond drilling were very spotty, but highly anomalous values are within the silicified horizon that returned 0.16 oz./ton over 15 feet from underground (Figure 4). A summary of the drilling results is as follows:

Table 2 - Summary of Diamond Drill Results

<u>Hole No.</u>	<u>Intersection Ft.</u>	<u>Length Ft</u>	<u>Assay (Oz. Gold/Ton)</u>
74-1	40.5 - 53.0	12.5	Not Available
74-1	71.1 - 86.6	15.5	" "
74-2	84.1 - 84.4	0.3	0.105
74-2	145.0 - 148.2	3.2	0.24
74-2	210.0 - 215.0	5.0	0.03

<u>Hole No.</u>	<u>Intersection Ft.</u>	<u>Length Ft.</u>	<u>Assay (Oz. Gold/Ton)</u>
74-3	98.0 - 102.5	4.5	0.30
74-4	334.0 - 362.0	28.0	Nil
74-5			No Sampling
74-6	334.0 - 340.0	6.0	0.02
74-7	192.2 - 198.4	6.2	0.145
74-7	318.5 - 325.0	6.5	0.04
74-8	236.8 - 242.2	5.4	0.08

In late 1980, Cedar Ridge Explorations Ltd. optioned the property from Helene Bonhomme and completed magnetometer and VLF-EM surveys over 73 claims, which encompass the present property, from April to June 1981. Numerous VLF-EM anomalies were located with a limited program of backhoe trenching as follow-up. The results of the backhoe trenching was not reported.

The property was restaked for Carl Forbes in the spring of 1984. Reconnaissance proton magnetometer surveying was carried out over parts of the property in August and September 1985. Also in August and September 1985, Premier Explorations Inc. completed bulldozer stripping, backhoe trenching, sampling and mapping. Four areas were worked on; the "Knoll" vein, the "South Boundary" vein, the "Toast" vein and the "Jumbo" vein. A report by Carl Forbes dated October 25, 1985, reports on 66 samples being taken in the stripped areas with assay values ranging from nil to 0.19 oz./ton Au. The best assays were from narrow width samples from the "Toast" vein.

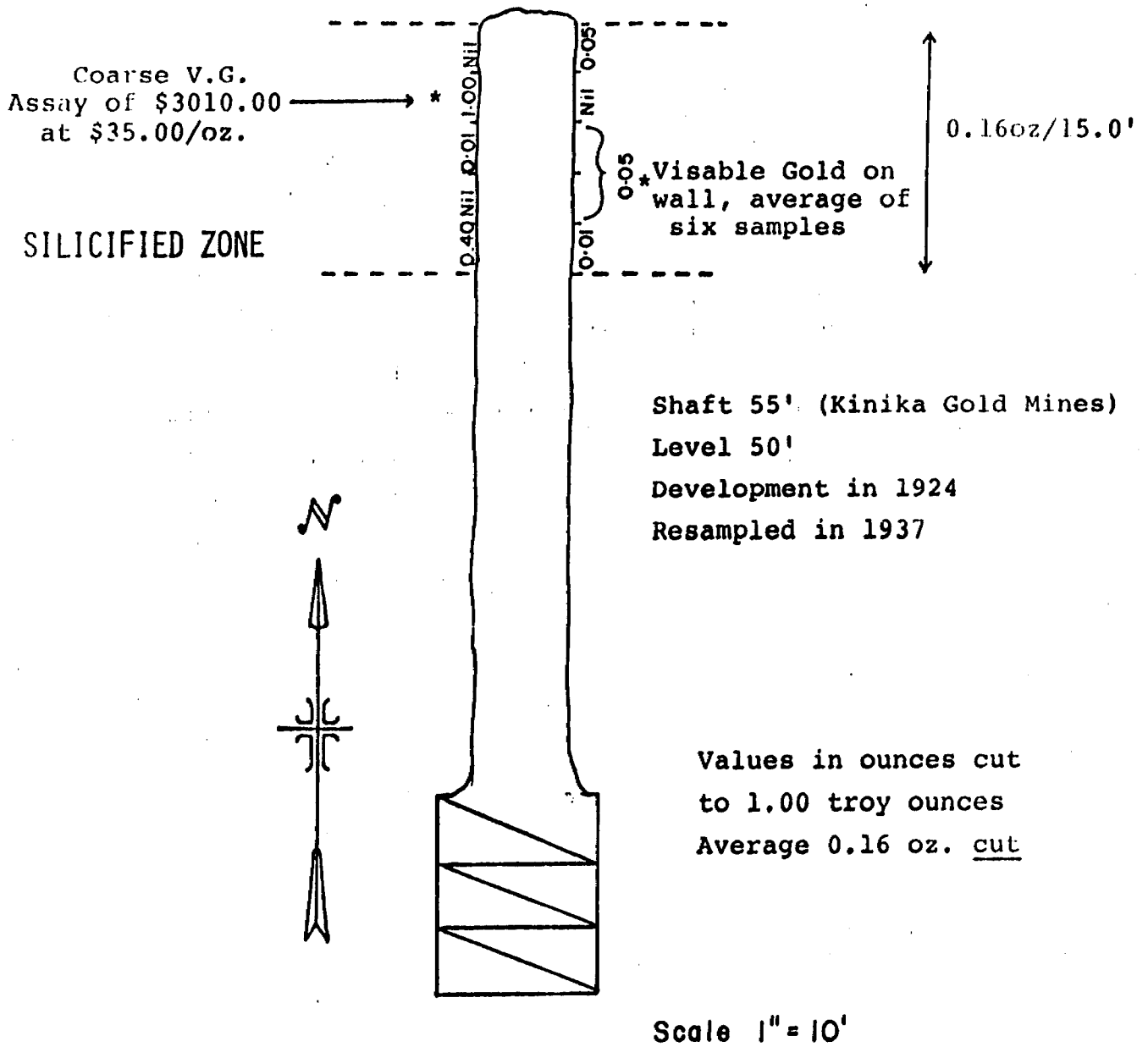
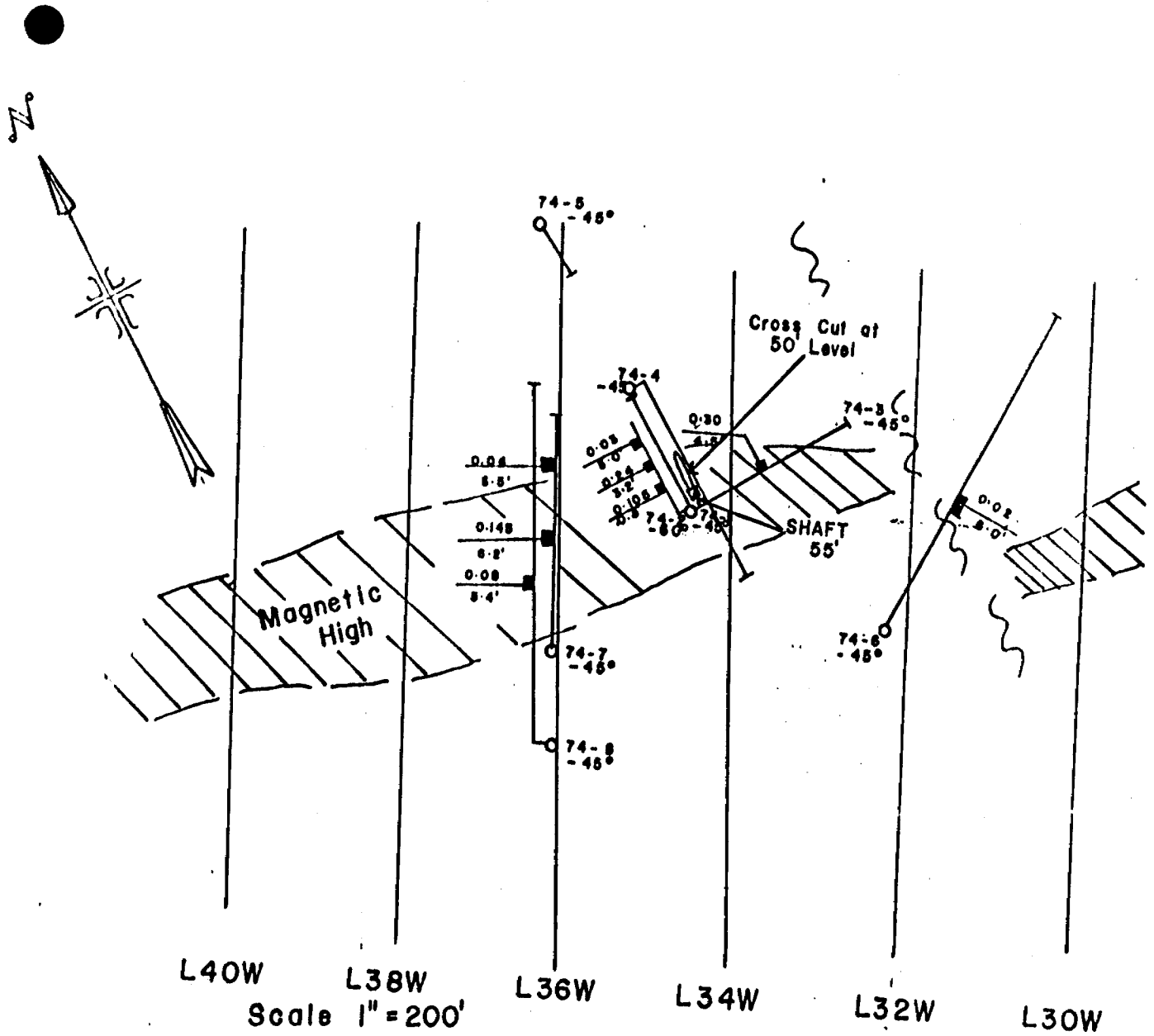

Figure 3. "Cabin" vein shaft sample plan.



LEGEND



-  Hole No. and collar location
-  Kinika Shaft

Figure 4. Consolidated Beaumont Resources Ltd. drill hole locations and assays.

GENERAL GEOLOGY

The regional geology was mapped by H. Lovell in 1966-67 and is presently being synoptically mapped by L. Jensen. The property is located near the top of the Kinojevis Group of rocks near the contact with the Blake River Group of the Abitibi Greenstone Belt. The Kinojevis Group consists of alternating formations of several flows composed of Mg-rich and Fe-rich tholeiitic basalt. Minor tholeiitic andesite, dacite and rhyolite occur. The Blake River Group conformably to disconformably overlies the Kinojevis Group and consists of calc-alkalic basalt, andesite dacite and rhyolite flows and pyroclastic rocks.

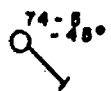
Structurally the region is folded by numerous anticlines and synclines with steeply dipping limbs. The claims are near the nose of a major east-west trending synclinorium. Faulting in the region varies from northeast to north to northwest with north and northwest trending faults predominant in the area of the property.

PROPERTY GEOLOGY

Within the claim block there is a series of Archean age volcanic rocks trending northwest and dipping northeast from 70° to 80°. The flows are an intercalated sequence of massive granular basalt/andesite and pillowed basalt/andesite. Flow top breccias can be significant enough to appear as units, particularly in the area of the "Cabin" vein. The flow top breccia is silicified and in places carbonatized with minor sulphides.

Mafic intrusives, particularly diabase, cuts the volcanic rocks and trend north-south. A small intrusion of diorite is reported near the southeastern corner of the claim group.

The gold mineralization is reported to be in the form of native gold as irregular patches and finely disseminated grains within gash quartz veins in the flow top breccia. The flow top breccias are reported to contain sulphide mineralization that extends into the country rock.

The property lies on the north limb of a west north-west trending anticline with the units dipping 70° to 80° to the north northeast. A north-south trending left lateral fault occurs near the southeastern part of the claim block. Abundant localized shearing is reported on the property by D. Bell in a report for Cedar Ridge Exploration Ltd., 1980.

BASAL TILL SAMPLING PROGRAM

The basal till sampling program was designed to test some of the area between the two showings on the property at a reconnaissance level and to check some of the VLF-EM anomalies indicated in the Cedar Ridge Exploration survey.

Fifty-four samples were taken at fifty-three sample sites (Map 1). The sample site locations are summarized in Table 1, Appendix I. Sampling was carried out by Northland Exploration Services of Timmins in December 1985 and February 1986. The crew consisted of three men to operate the equipment

and was supervised in the field by the author of this report. The equipment consisted of a gas powered "Wacker" impactor driving down a drill stem of 1 1/2" diameter. On the lower end of the drill stem was an 18" flow through, side ejection sampler. The drill stem is driven down until bedrock is reached and then retracted. The sample remaining in the sampler is the last material penetrated going down. At some sites bedrock chips were present in the end of the sampler.

At 1+00 south on Line 36E, two samples were taken with the deeper sample being taken as basal till.

The assay results and sample descriptions are summarized in Table 1 and 2, Appendix I. Analytically the samples were completely pulverized and assayed using a fire assay method and an atomic absorption finish. The analyses were carried out at Swastika Laboratories Ltd. of Swastika, Ontario.

SUMMARY

The backhoe trenching and stripping completed in the late summer of 1985 indicated that anomalous mineralization occurs over 2000 feet in strike length. Mineralization is in sheared and altered zones assaying up to 0.19 oz./ton Au over narrow widths. The writer visited the property in November 1985 and took five samples which are summarized below:

Table 3 - Bedrock Sample Description

<u>Sample</u>	<u>Location</u>	<u>Description</u>	<u>Assay Au (oz/t)</u>
1	small pit near Cabin vein shaft	sulphide-rich flow top breccia	0.005
2	dump at Cabin vein shaft	cherty interflow breccia	0.035

<u>Sample</u>	<u>Location</u>	<u>Description</u>	<u>Assay Au(oz/t)</u>
3	SE end of Jumbo vein stripping	sheared graphitic & pyritic material	0.002
4	N-S shear near SE end of Jumbo vein	siliceous with 10% pyrite	0.08
5	Toast vein in area of 0.19 oz/ton	highly sheared agglomerate (across 36")	0.002

The basal till program returned several anomalous samples between the two shaft areas using nil as the background value. The series of holes drilled on or near the Cabin vein, which underground averages 0.16 oz/ton Au over 15 feet, returned all nil except one sample near the shaft returning 5 ppb Au.

CONCLUSIONS

There are two mineralized zones that appear to be conformable to stratigraphy separated by 7000 feet of which most is thinly drift covered. At this point geophysics has not been able to define the mineralized zones.

Several workers on the property have noted that the mineralization is almost exclusively visible gold. This is an extremely difficult type of mineralization to explore for and evaluate. The basal till program indicated that such a survey is not suitable for evaluating this property. The standard geophysical surveys do not work, but maybe others will. As indicated from the basal till survey, overburden is very shallow in places thus stripping and trenching could be the most effective form of exploration on this property.

RECOMMENDATIONS

The writer would recommend the following phases to further evaluate this property:

- Phase 1 Linecutting
 Gradient magnetometer survey
 Detailed geological mapping
- Phase 2 Stripping and trenching in the Cabin vein area
 Dewatering the Cabin vein shaft and sampling
 Bulk sampling of the Cabin vein from underground
 or surface if exposed
- Phase 3 Diamond drilling if warranted

COST ESTIMATES FOR RECOMMENDED PROGRAMS

Phase 1.	Linecutting 50 miles @ \$300/line mile	\$15,000.00
	Gradient magnetometer survey 50 miles @ \$150/line mile	7,500.00
	Detailed geological mapping	7,500.00
	Reports for above	3,500.00
	Sub Total	\$33,500.00
	Contingencies 10%	3,350.00
		\$36,850.00
Phase 2.	Stripping and trenching	15,000.00
	Dewatering shaft and sampling	10,000.00
	Bulk sampling of Cabin vein	10,000.00
	Sub Total	\$35,000.00
	Contingencies 10%	3,500.00
		\$38,500.00
Phase 3.	Diamond drilling 5000 feet @ \$25/ft.	125,000.00
	Contingencies 10%	12,500.00
		\$137,500.00
	Total of the above Phases	\$212,850.00

Phases 1 and 2 are necessary, but phase 3 is dependent on obtaining favorable results from the preceding work.

Respectfully submitted,

A handwritten signature in cursive script, appearing to read 'W. MacRae', written in dark ink.

W. MacRae

CERTIFICATE

With reference to my report on the Bernhardt and
Maisonville Townships Claim Group dated February 23, 1986;

I, William E. MacRae, of the City of Timmins,
Ontario do hereby certify and state that:

- (1) I have graduated from Lakehead University with the degree of Bachelor of Science (Honours) in 1975 and have obtained the degree of Masters of Science from McMaster University in 1982;
- (2) I have practiced my profession continuously for the past eight years;
- (3) I am a fellow of the Geological Association of Canada, a member of the Canadian Institute of Mining and Metallurgy, and a member of the Prospectors and Developers Association (President of the Porcupine Branch);
- (4) I have no interest direct or indirect in the mining claims comprising the Property described in this report nor do I expect to receive any; and
- (5) This report is based upon direct personal supervision of the described program from November 1985 to February 1986 and previous geological experience in the area.

Dated this 23rd day of February, 1986.
Timmins, Ontario

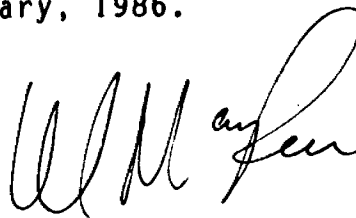

W. MacRae, M.Sc.
Consulting Geologist

BIBLIOGRAPHY

- Bayne, A. S., Consolidated Beaumont Resources Limited, re-Pathfinder Option, Diamond Drill Logs, Bernhardt Township. Unpublished report, June 1, 1974 to September 30, 1974.
- Bell, D. R., Report on the property of Cedar Ridge Explorations Ltd., Bernhardt and Maisenville Townships, District of Timiskaming, Larder Lake Mining Division, Ontario, Unpublished report, November 19, 1980.
- Forbes, C. P., Summary report on the Blue Mountain Property, Bernhardt and Maisenville Townships, Larder Lake Mining Division, unpublished report, October 25, 1985.
- Lovell, H. L., Geology of the Bourkes Area, District of Timiskaming, Geological Report 92, Ontario Department of Mines and Northern Affairs, 1971.
- Lovell, H. L. and Rupert, R. J., Geology of Bernhardt and Morrisette Townships, Geological Report 84, Ontario Department of Mines, 1970.
- Rattray, J. H., Report on Challenger and Height of Land Project, Bernhardt Township, Larder Lake Mining Division, Ontario. Unpublished report, July 29, 1922.
- Szetu, S. S., Consolidated Beaumont Resources Limited, Bernhardt Township, Geophysical Report, Larder Lake Mining Division, Ontario. Unpublished report, May 24, 1971.
- Taylor, R. F., Kinika Gold Mines Limited, Benoit, Melba, Maisenville and Bernhardt Townships, Larder Lake Mining Division, Ontario. Unpublished report, September 13, 1937.

APPENDIX I

SAMPLE DESCRIPTIONS AND RESULTS

TABLE 1. SAMPLE SITE LOCATIONS

<u>Sample</u>	<u>Grid Co-ordinates</u>	<u>Bedrock Depth</u>
1	L8W/BL	15'
2	L4W/BL	9'
3	L0/BL	6'
4	L0/5N	4'
5	L2E/BL	6'
6	L2E/6N	11'
7	L4E/6N	5'
8	L6E/BL	16'
9	L6E/5+50N	0'
10	L8E/BL	39'
11	L8E/5N	30'
12	L12E/BL	72'
13	L12E/1N	69'
14	L14E/BL	42'
15	L14E/1N	32'
16	L16E/BL	10'
17	L16E/1N	28'
18	L18E/BL	3'
19	L18E/1N	39'
20	L20E/BL	22'
21	L22E/BL	32'
22	L22E/1S	35'
23	L24E/BL	30'
24	L24E/1S	32'
25	L26E/BL	38'
26	L26E/1S	40'
27	L28E/BL	42'
28	L28E/1S	32'
29	L30E/BL	11'
30	L30E/1S	12'
31	L32E/BL	22'
32	L32E/1S	12'
33	33E/BL	12'
34	33E/1S	15'
35	L34E/BL	12'
36	L34E/1S	10'
37	L36E/BL	32'
38	L36E/1S	9'
39	L36E/1S	32'
40	L38E/BL	12'
41	L38E/1S	11'

<u>Sample</u>	<u>Grid Co-ordinates</u>	<u>Bedrock Depth</u>
42	L40E/BL	11'
43	L40E/1S	11'
44	L42E/BL	8'
45	L42E/1S	12'
46	L44E/BL	5'
47	L46E/BL	11'
48	L48E/BL	36'
49	L50E/BL	35'
50	L52E/BL	22'
51	L54E/BL	19'
52	L56E/BL	28'
53	L58E/BL	45'
54	L60E/BL	61'

TABLE 2.

ASSAY RESULTS AND SAMPLE DESCRIPTIONS

<u>Sample</u>	<u>Assay (Au ppb)</u>	<u>Description</u>
1	Nil	sandy till
2	Nil	sandy till
3	Nil	sandy till
4	Nil	oxidized sandy till
5	Nil	sandy till
6	Nil	oxidized sandy till
7	5	sandy till with minor clay
8	Nil	pebble till
9	Nil	bedrock chips
10	Nil	clay till with pebbles
11	Nil	clay till with pebbles
12	100	sandy clay till
13	Nil	sandy till
14	Nil	sandy clay till
15	Nil	sandy till
16	Nil	sandy till with clay
17	Nil	clay with minor fragment
18	Nil	sandy till
19	Nil	sandy till
20	Nil	pebble till
21	Nil	Clayey sandy till
22	Nil	coarse sandy till
23	Nil	sandy till
24	Nil	sandy till
25	30	sandy till
26	Nil	coarse sandy till
27	Nil	sandy till
28	Nil	coarse sandy till
29	Nil	sandy till
30	Nil	pebble till
31	Nil	sandy till
32	Nil	pebble till
33	Nil	sandy till
34	Nil	sandy till
35	Nil	sandy till
36	Nil	sandy till
37	Nil	sandy till
38	Nil	sandy till
39	Nil	Clay rich till
40	Nil	sandy till
41	Nil	sandy till
42	40	sandy pebble till

<u>Sample</u>	<u>Assay (Au ppb)</u>	<u>Description</u>
43	10	sandy till
44	Nil	sandy till
45	Nil	coarse sandy till
46	Nil	pebble till
47	Nil	sandy till
48	Nil	sandy till
49	20	sandy till
50	Nil	sandy till
51	Nil	sandy till
52	Nil	clay
53	Nil	clay rich till
54	Nil	sandy till



SWASTIKA LABORATORIES LIMITED

P.O. BOX 10, SWASTIKA, ONTARIO P0K 1T0

TELEPHONE: (705) 642-3244

ANALYTICAL CHEMISTS • ASSAYERS • CONSULTANTS

Certificate of Analysis

Certificate No. 61849 Date: Dec. 4, 1985

Received Nov. 26, 1985 5 Samples of ore

Submitted by Longbow Lake Exploration Syndicate, c/o W. MacRae, Timmins, Ontario

SAMPLE NO.	GOLD Oz./ton
98337	0.005
98338	0.035
98339	0.002
98340	0.080
	0.080
second pulp	0.070
	0.070
98341	0.002

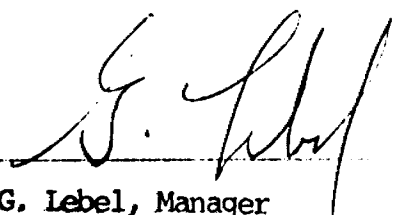
Per 
G. Lebel, Manager





SWASTIKA LABORATORIES LIMITED

P.O. BOX 10, SWASTIKA, ONTARIO P0K 1T0

TELEPHONE: (705) 642-3244

ANALYTICAL CHEMISTS • ASSAYERS • CONSULTANTS

Certificate of Analysis

Certificate No. 62125

Date: Jan. 10, 1986

Received Jan. 8, 1985 32 Samples of till samples

Submitted by Longbow Lake Exploration Syndicate, c/o W. MacRae, Timmins, Ontario

SAMPLE NO.	GOLD PPB	SAMPLE NO.	GOLD PPB
98342	Nil	98360	Nil
98343	Nil	98361	Nil
98344	Nil	98362	Nil
98345	Nil	98363	40
98346	Nil	98364	Nil
98347	Nil	98365	Nil
98348	100 100	98366	Nil
98349	Nil	98367	Nil
98350	Nil	98368	20 20
98351	Nil	98369	Nil
98352	Nil	98370	Nil
98353	Nil	98371	Nil
98354	Nil	98372	Nil
98355	30 30	98373	Nil
98356	Nil		
98357	Nil		
98358	Nil		
98359	Nil		

NOTE: The above samples were completely pulverized.

Per G. Lebel
G. Lebel, Manager

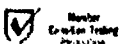

ESTABLISHED 1928



SWASTIKA LABORATORIES LIMITED

P.O. BOX 10, SWASTIKA, ONTARIO P0K 1T0

TELEPHONE: (705) 642-3244

ANALYTICAL CHEMISTS • ASSAYERS • CONSULTANTS

Certificate of Analysis

Certificate No. 62433

Date: Feb. 25, 1986

Received Feb. 17, 1986 22 Samples of till

Submitted by Longbow Lake Exploration Syndicate, c/o Wm. MacRae, Timmins, Ontario

SAMPLE NO.	GOLD
C-98384	PPB Nil
98385	10 Nil
98386	Nil
98387	Nil
98388	Nil
98389	Nil
98390	Nil
98391	Nil
98392	Nil
98393	Nil
98394	Nil
98395	Nil
98396	Nil
98397	Nil
98398	Nil
98399	Nil
98400	Nil
98401	Nil
98402	Nil Nil
98403	10
98404	Nil
L-0.5+00N 4ft	Nil

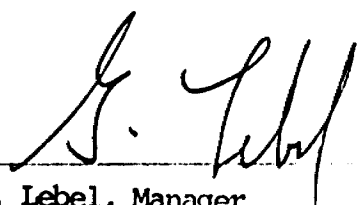
Per 

G. Lebel, Manager



APPENDIX II

INVOICES

NORTHLAND
EXPLORATION LTD.

36 Emerald St., off Highway 101 West, P.O. Box 1368
TIMMINS, ONTARIO P4N 7N2

Telephone (705) 264-9889
(705) 267-4242

February 14, 1986

Long Bow Exploration Syndicate,

Dear Sir: Re: Overburden Drilling
Bernhardt Twp.

December 7, 1985 to February 13, 1986	
13 Days Overburden Drilling 3 Man Crew @ \$710.92	<u>\$9,241.90</u>
Total Cost	<u>\$9,241.90</u>

Yours truly,

Robert G. Smith /cb.

ROBERT G. SMITH

RGS/cb

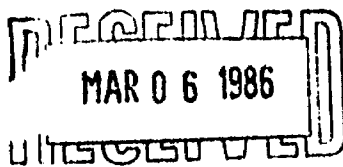

*Paid in full
Ch # 10
C. Blakemore*



William E. MacRae Geological Services

P.O. Box 417, Timmins, Ontario. P4N 7E3 [705] 268-0111

INVOICE

86-05

February 19, 1986

CLIENT: Longbow Lake Exploration Syndicate

PROPERTY: Blue Mountain, Bernhardt and Maisonville Twps.

RE: Basal Till Sampling Program.

CHARGES: Field supervision and expenses	\$3075.00
Assaying	\$247.50
Report	\$2000.00
	<hr/>
AMOUNT DUE	\$5322.50

Payment to:

William E. MACRAE Geological Services

P.O. Box 417

Timmins, Ontario

P4N 7E3

Respectfully submitted

W. MACRAE

PAID
MAR 07 1986
Paid in full
W. Macrae



12540

SWASTIKA LABORATORIES LIMITED

P.O. BOX 10, SWASTIKA, ONTARIO P0K 1T0 TELEPHONE: (705) 642-3244

SOLD TO

Longbow Lake Exploration Syndicate
c/o Mr. W. MacRae
Box 417
Timmins, Ontario
P4N 7E3

S
H
I
P
T
O

1.5% late charge over 30 days
annual rate 18%

DATE	SHIPPED VIA	FED LICENCE NO	PROV LICENCE NO	YOUR ORDER NO	OUR ORDER NO	TERMS	SALESMAN
Jan. 17/86							
QUANTITY	DESCRIPTION				UNIT PRICE	TOTAL	
32	Au Assays				\$ 8.50	\$ 272.00	
32	Sample handling Cert. No, 62125 Jan. 10/86				2.75	88.00	
					Total PER	\$ 360.00	

SWASTIKA LABORATORIES LTD.

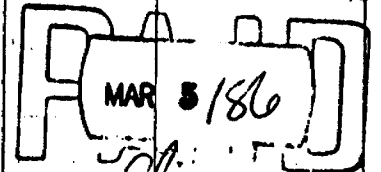

WITH THANKS

Total PER \$ 360.00

ONE BUSINESS FORMS 3 7060E

FACTURE / INVOICE

ANALYTICAL CHEMISTS • ASSAYERS • CONSULTANTS
ESTABLISHED 1928



12369



SWASTIKA LABORATORIES LIMITED

P.O. BOX 10, SWASTIKA, ONTARIO P0K 1T0 TELEPHONE: (705) 642-3244

80LB70

Lungbow Lake Exploration Syndicate
c/o Mr. W. MacRae
Box 417
Timmins, Ontario
P4N 7L3

S
H
I
P
T
O

1.5% late charge over 30 days
(annual rate 18%)

DATE	DESCRIPTION	AMOUNT	TOTAL
Dec. 15/85			
SUBSCRIPTION			
5	Au Assays	\$ 8.50	\$ 42.50
5	Sample handling Cert. No. 61849 Dec. 4/85	2.75	13.75
		Total	56.25

SWASTIKA LABORATORIES LTD.

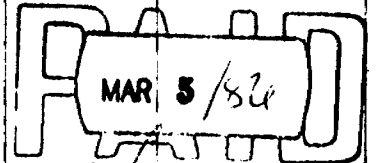

WITH THANKS

Total PER 56.25

DORE BUSINESS FORMS 3-1001

ANALYTICAL CHEMISTS • ASSAYERS • CONSULTANTS

FACTURE / INVOICE

ESTABLISHED 1928





Type of Survey(s) **Expenditures** BERNHARDT & MAISONVILLE TOWNSHIPS
 Claim Holder(s) **CARL P. FORBES** Prospector's Licence No. **K18293**
 Address **33 PREMIER AVE. WEST KIRKLAND LAKE ONT. P4N 2S7**
 Survey Company **Northland Exploration Ltd** Date of Survey (from & to) **01 12 85** to **20 02 86** Total Miles of line Cut
 Name and Address of Author (of Geo-Technical report) **W. MACRAE, P.O. Box 417, Timmins, Ont. P4N 7E3**

Credits Requested for Each Claim in Columns at right

Special Provisions	Geophysical	Days per Claim
For first survey: Enter 40 days. (This includes line cutting)	- Electromagnetic	
	- Magnetometer	
For each additional survey: using the same grid: Enter 20 days (for each)	- Radiometric	
	- Other	
	Geological	
	Geochemical	
Man Days	Geophysical	Days per Claim
Complete reverse side and enter total(s) here	- Electromagnetic	
	- Magnetometer	
	- Radiometric	
	- Other	
	Geological	
	Geochemical	
Airborne Credits	Geophysical	Days per Claim
Note: Special provisions credits do not apply to Airborne Surveys.	Electromagnetic	
	Magnetometer	
	Radiometric	

Mining Claims Traversed (List in numerical sequence)

Prefix	Mining Claim Number	Expend. Days Cr.
L	739257	51
-	739258	51
-	739259	53.71
-	739260	51
-	799362	40
-	799363	40
-	799364	40
-	799365	40
-	799372	40
-	799373	40
-	799374	40
-	799375	40
-	799376	36
-	799377	36
-	799378	40
-	799379	30
-	799380	40
-	799381	40
-	799387	40
-	799388	40
-	799389	27
-	799390	57
-	799391	56

RECEIVED
 APR 28 1986
 MINING LANDS SECTION
RECEIVED
 APR 4 1986
 LARDER LAKE MINING DIVISION

Expenditures (excludes power stripping)

Type of Work Performed **Basal Till Sampling (Sec. 77-19)**
 Performed on Claim(s) **L-739258, L-739260, L-799363, L-799372, & L-799373.**

Calculation of Expenditure Days Credits
 Total Expenditures **\$ 14,980.65** ÷ **15** = **998.71** Total Days Credits

Instructions
 Total Days Credits may be apportioned at the claim holder's choice. Enter number of days credits per claim selected in columns at right.

Date **April 4 186** Recorded Holder or Agent (Signature) **Carl P. Forbes**

For Office Use Only
 Total Days Cr. Recorded **998.71** Date Recorded **APR 4 - 1986** Mining Recorder **[Signature]**
 Date Approved as Recorded **[Signature]** Branch Director

Certification Verifying Report of Work
 I hereby certify that I have a personal and intimate knowledge of the facts set forth in the Report of Work annexed hereto, having performed the work or witnessed same during and/or after its completion and the annexed report is true.

Name and Postal Address of Person Certifying **W. Macrae, P.O. Box 417, Timmins, Ont P4N 7E3**
 Date Certified **2/04/86** Certified by (Signature) **[Signature]**



Recorded Holder	CARL P. FORBES
Township or Area	BERNHARDT & MAISONVILLE TOWNSHIPS

Type of survey and number of Assessment days credit per claim	Mining Claims Assessed
Geophysical Electromagnetic _____ days Magnetometer _____ days Radiometric _____ days Induced polarization _____ days Other _____ days Section 77 (19) See "Mining Claims Assessed" column Geological _____ days Geochemical _____ days Man days <input type="checkbox"/> Airborne <input type="checkbox"/> Special provision <input type="checkbox"/> Ground <input type="checkbox"/> <input type="checkbox"/> Credits have been reduced because of partial coverage of claims. <input type="checkbox"/> Credits have been reduced because of corrections to work dates and figures of applicant.	<p>\$14,980.65 SPENT ON OVERBURDEN DRILLING AND ASSAYING SAMPLES TAKEN FROM MINING CLAIMS:</p> <p>L 739258-60-63-64-72-73-77- 799363-64-72-73-77</p> <p>998.71 DAYS CREDIT ALLOWED WHICH MAY BE GROUPED IN ACCORDANCE WITH SECTION 76(6) OF THE MINING ACT R.S.O. 1980.</p> <p><u>FOR MINING RECORDER'S USE:</u></p> <p>The work assignemnt for each of the above listed 7 claims is 142.6 days per claim.</p>

Special credits under section 77 (16) for the following mining claims

No credits have been allowed for the following mining claims

not sufficiently covered by the survey insufficient technical data filed

The Mining Recorder may reduce the above credits if necessary in order that the total number of approved assessment days recorded on each claim does not exceed the maximum allowed as follows: Geophysical - 80; Geologocal - 40; Geochemical - 40; Section 77(19) - 60.

June 4, 1986

Your File: 144/86

Our File: 2.9061

Mining Recorder
Ministry of Northern Development and Mines
4 Government Road East
Kirkland Lake, Ontario
P2N 1A2

Dear Madam:

RE: Assaying submitted under Section 77(19)
of the Mining Act R.S.O. 1980, on Mining
Claims L 739258, et al, in Bernhardt and
Maisonville Townships

The enclosed statement of assessment work credits for
assaying expenditures has been approved as of the above
date.

Please inform the recorded holder of this mining claim
and so indicate on your records.

Yours sincerely,

J.C. Smith, Supervisor
Mining Lands Section

Whitney Block, 6th Floor
Queen's Park
Toronto, Ontario
M7A 1W3

Telephone: (416) 965-4888

SH/mc

cc: Carl P. Forbes
33 Premier Avenue West
Kirkland Lake, Ontario
P2N 2S7

W. MacRae
P.O. Box 417
Timmins, Ontario
P4N 7E3

Resident Geologist
Kirkland Lake, Ontario

Encl.

May 2, 1986

File: 2.9061

Mr. C.P. Forbes
33 Premier Avenue West
Kirkland Lake, Ontario
P2N 2S7

Dear Sir:

RE: Basal Till Sampling submitted on
Mining Claims L 739257, et al, in
the Townships of Bernhardt & Maissonville

This will acknowledge receipt of the above-described survey on April 28, 1986. Enclosed are the plans (in duplicate) for this survey. In order to complete your submission, please show all claim lines and claim numbers on the plans and return them to this office quoting file 2.9061.

For further information, please contact (Mrs.) Susan Hurst at (416) 965-4888.

Yours sincerely,

J.C. Smith, Supervisor
Mining Lands Section

Whitney Block, 6th Floor
Queen's Park
Toronto, Ontario
M7A 1W3

Telephone: (416) 965-4888

SH/mc

cc: William MacRae
P.O. Box 417
Timmins, Ontario
P4N 7E3

Mining Recorder
Kirkland Lake, Ontario
#144/86

Encl.

Mining Lands Section

File No 2.9061

Control Sheet

TYPE OF SURVEY GEOPHYSICAL
 GEOLOGICAL
 GEOCHEMICAL
 EXPENDITURE

MINING LANDS COMMENTS:

J. Hurst

Signature of Assessor

May 26/86

Date

lpt
CS.

June 12, 1986

Your File: #144/86
Our File: 2.9061

Mining Recorder
Ministry of Northern Development and Mines
4 Government Road East
Kirkland Lake, Ontario
P2N 1A2

Dear Madam:

RE: Assaying submitted under Section 77(19)
of the Mining Act R.S.O. 1980, on Mining
Claims L 739528, et al, in Bernhardt and
Maisonville Townships

Please disregard our letter of June 4, 1986 as the attached
statement of assessment work credits was incorrect. Enclosed
is a corrected statement.

Please inform the recorded holder of these mining claims and
so indicate on your records.

Yours sincerely,

J.C. Smith, Supervisor
Mining Lands Section

Whitney Block, 6th Floor
Queen's Park
Toronto, Ontario
M7A 1W3

Telephone: (416)965-4888

SH/mc
cc: Carl P. Forbes
33 Premier Avenue West
Kirkland Lake, Ontario
P2N 2S7

W. MacRae
P.O. Box 417
Timmins, Ontario
P4N 7E3

Resident Geologist
Kirkland Lake, Ontario

Encl.



Recorded Holder
CARL P. FORBES

Township or Area
BERNHARDT & MAISONVILLE TOWNSHIPS

Type of survey and number of Assessment days credit per claim	Mining Claims Assessed
Geophysical Electromagnetic _____ days Magnetometer _____ days Radiometric _____ days Induced polarization _____ days Other _____ days Section 77 (19) See "Mining Claims Assessed" column Geological _____ days Geochemical _____ days Man days <input type="checkbox"/> Airborne <input type="checkbox"/> Special provision <input type="checkbox"/> Ground <input type="checkbox"/> <input type="checkbox"/> Credits have been reduced because of partial coverage of claims. <input type="checkbox"/> Credits have been reduced because of corrections to work dates and figures of applicant.	<p>\$14,980.65 SPENT ON OVERBURDEN DRILLING AND ASSAYING SAMPLES TAKEN FROM MINING CLAIMS:</p> <p>L 739258 - 60 799363-64-72-73-77</p> <p>998.71 DAYS CREDIT ALLOWED WHICH MAY BE GROUPED IN ACCORDANCE WITH SECTION 76(6) OF THE MINING ACT R.S.O. 1980.</p> <p><u>FOR MINING RECORDER'S USE:</u></p> <p>THE WORK ASSIGNMENT FOR EACH OF THE ABOVE LISTED 7 CLAIMS IS 142.6 DAYS PER CLAIM.</p>

Special credits under section 77 (16) for the following mining claims

No credits have been allowed for the following mining claims

not sufficiently covered by the survey insufficient technical data filed

The Mining Recorder may reduce the above credits if necessary in order that the total number of approved assessment days recorded on each claim does not exceed the maximum allowed as follows: Geophysical - 80; Geological - 40; Geochemical - 40; Section 77(19) - 60.

REFERENCES

AREAS WITHDRAWN FROM DISPOSITION

- M.R.O. -- MINING RIGHTS ONLY
- S.R.O. -- SURFACE RIGHTS ONLY
- M.+S. -- MINING AND SURFACE RIGHTS

Description Order No. Date Disposition File

SAND and GRAVEL

M.N.R. GRAVEL RESERVE FILE 184522

MELBA TWP.

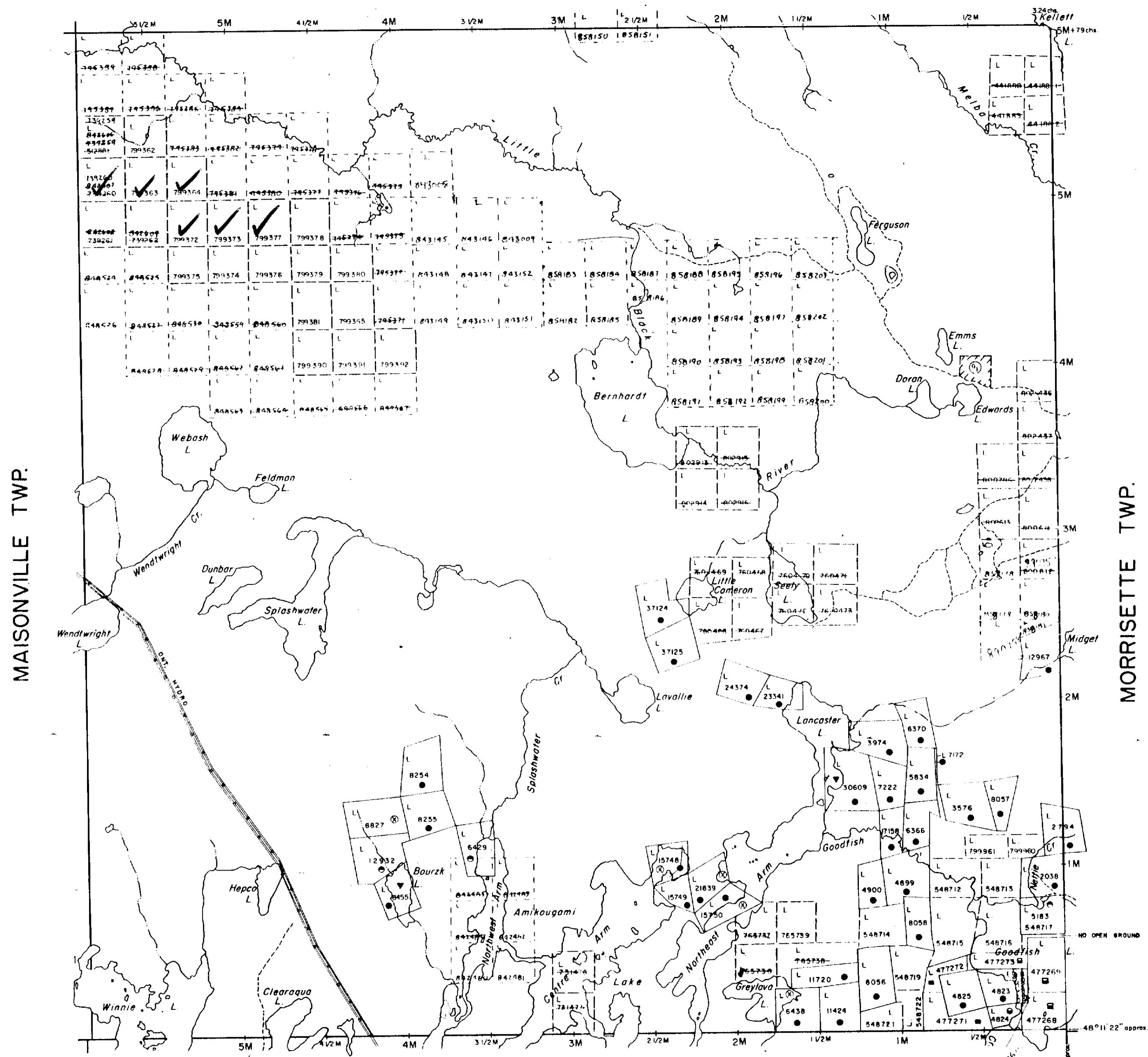

MAISONVILLE TWP.

MORRISETTE TWP.

TECK TWP.

LEGEND

- HIGHWAY AND ROUTE No.
- OTHER ROADS
- TRAILS
- SURVEYED LINES:
 - TOWNSHIPS, BASE LINES, ETC.
 - LOTS, MINING CLAIMS, PARCELS, ETC.
- UNSURVEYED LINES:
 - LOT LINES
 - PARCEL BOUNDARY
 - MINING CLAIMS ETC.
- RAILWAY AND RIGHT OF WAY
- UTILITY LINES
- NON-PERENNIAL STREAM
- FLOODING OR FLOODING RIGHTS
- SUBDIVISION OR COMPOSITE PLAN
- RESERVATIONS
- ORIGINAL SHORELINE
- MARSH OR MUSKEG
- MINES
- TRAVERSE MONUMENT

DISPOSITION OF CROWN LANDS

TYPE OF DOCUMENT	SYMBOL
PATENT, SURFACE & MINING RIGHTS	●
" SURFACE RIGHTS ONLY	○
" MINING RIGHTS ONLY	◐
LEASE, SURFACE & MINING RIGHTS	■
" SURFACE RIGHTS ONLY	□
" MINING RIGHTS ONLY	◼
LICENCE OF OCCUPATION	▼
ORDER-IN-COUNCIL	OC
RESERVATION	⊙
CANCELLED	⊗
SAND & GRAVEL	⊙

NOTE: MINING RIGHTS IN PARCELS PATENTED PRIOR TO MAY 8, 1913, VESTED IN ORIGINAL PATENTEE BY THE PUBLIC LANDS ACT, R.S.O. 1970, CHAP. 380, SEC. 63, SUBSEC. 1.

SCALE: 1 INCH = 40 CHAINS

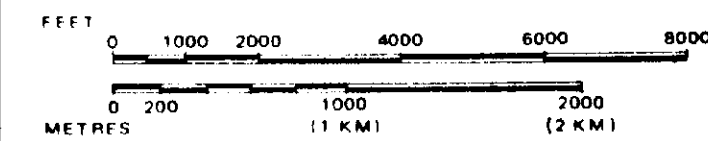

TOWNSHIP
BERNHARDT
 M.N.R. ADMINISTRATIVE DISTRICT
 KIRKLAND LAKE
 MINING DIVISION
 LARDER LAKE
 LAND TITLES / REGISTRY DIVISION
 TIMISKAMING

Ministry of Natural Resources
 Land Management Branch
 Ontario

Date JANUARY 1985
 Number **G-3207**

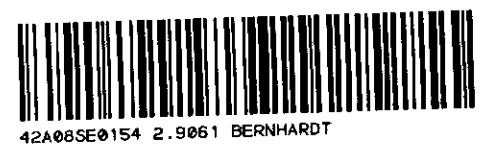

BENOIT TWP. - M.326

THE TOWNSHIP OF
OF
MAISONVILLE

DISTRICT OF
TIMISKAMING

LARDER LAKE
MINING DIVISION

SCALE: 1-INCH 40 CHAINS

LEE TWP. - M.360

BERNHARDT TWP. - M.327

LEGEND

PATENTED LAND	● or (P)
CROWN LAND SALE	C.S
LEASES	(L)
LOCATED LAND	Loc
LICENSE OF OCCUPATION	L.O.
MINING RIGHTS ONLY	M.R.O
SURFACE RIGHTS ONLY	S.R.O
ROADS	—
IMPROVED ROADS	—
KING'S HIGHWAYS	—
RAILWAYS	—
POWER LINES	—
MARSH OR MUSKEG	—
MINES	X
CANCELLED	C
PATENTED S.R.O	○

NOTES

400' surface rights reservation along the shores of all lakes and rivers.

Areas withdrawn from staking under Section 43 of the Mining Act, R.S.O 1970 (Sec.42, R.S.O '60)			
Order No.	File	Date	Disposition
(R)	22032	11/8/70	S.R.O
(R) NRW 5/81	22032	23/1/81	S.R.O
(R) w. 8/No	sec 43/40	20/1/86	m+s

All islands in Sesekinika Lake are withdrawn from staking by Order-in-Council dated Dec.7,1921

Withdrawn from staking, see 31 (a) pending application under Public Lands Act.

FEB 19 1986

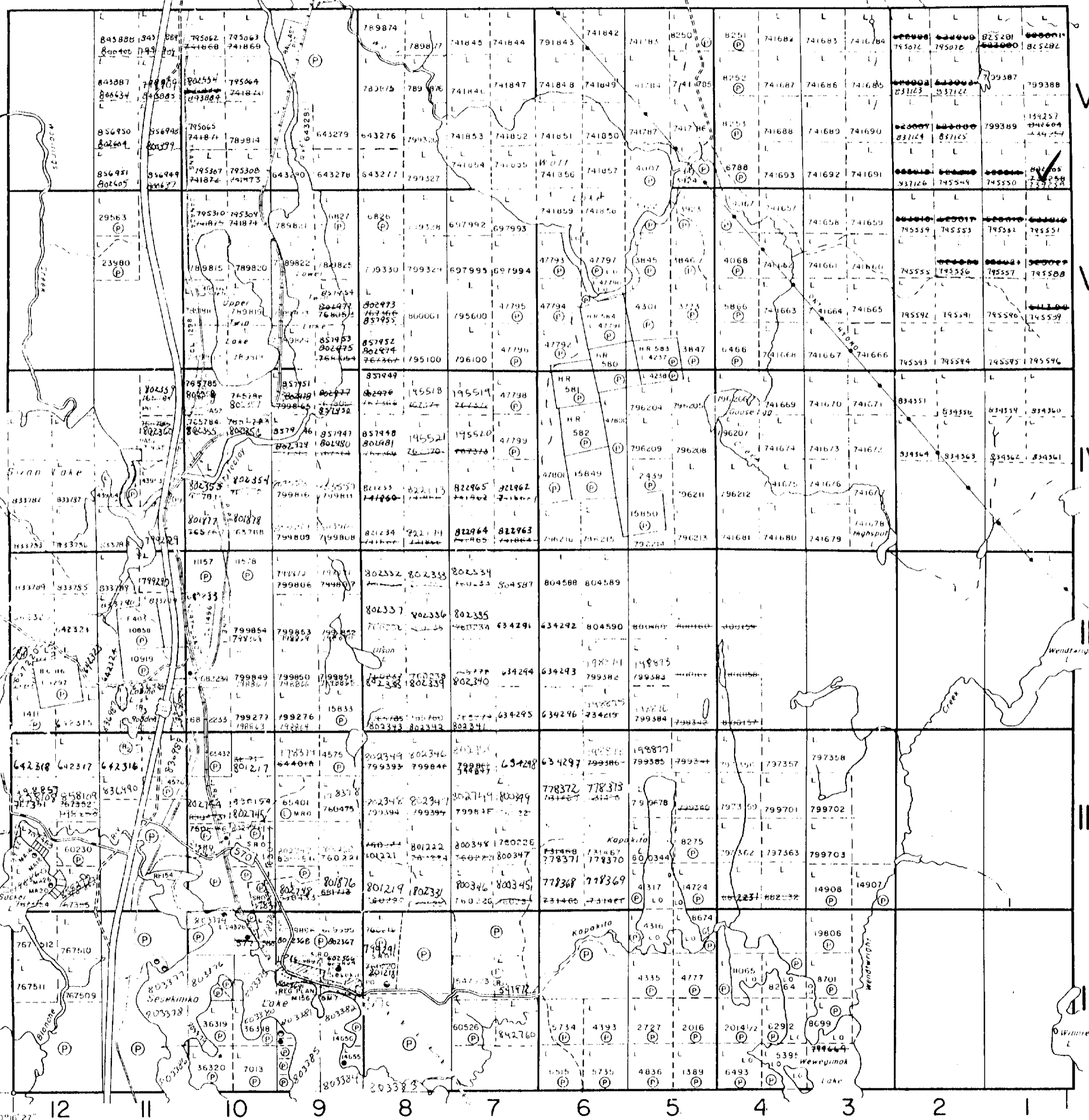

GRENFELL TWP. - M.351

PLAN NO. **M.361**
ONTARIO
MINISTRY OF NATURAL RESOURCES
SURVEYS AND MAPPING BRANCH



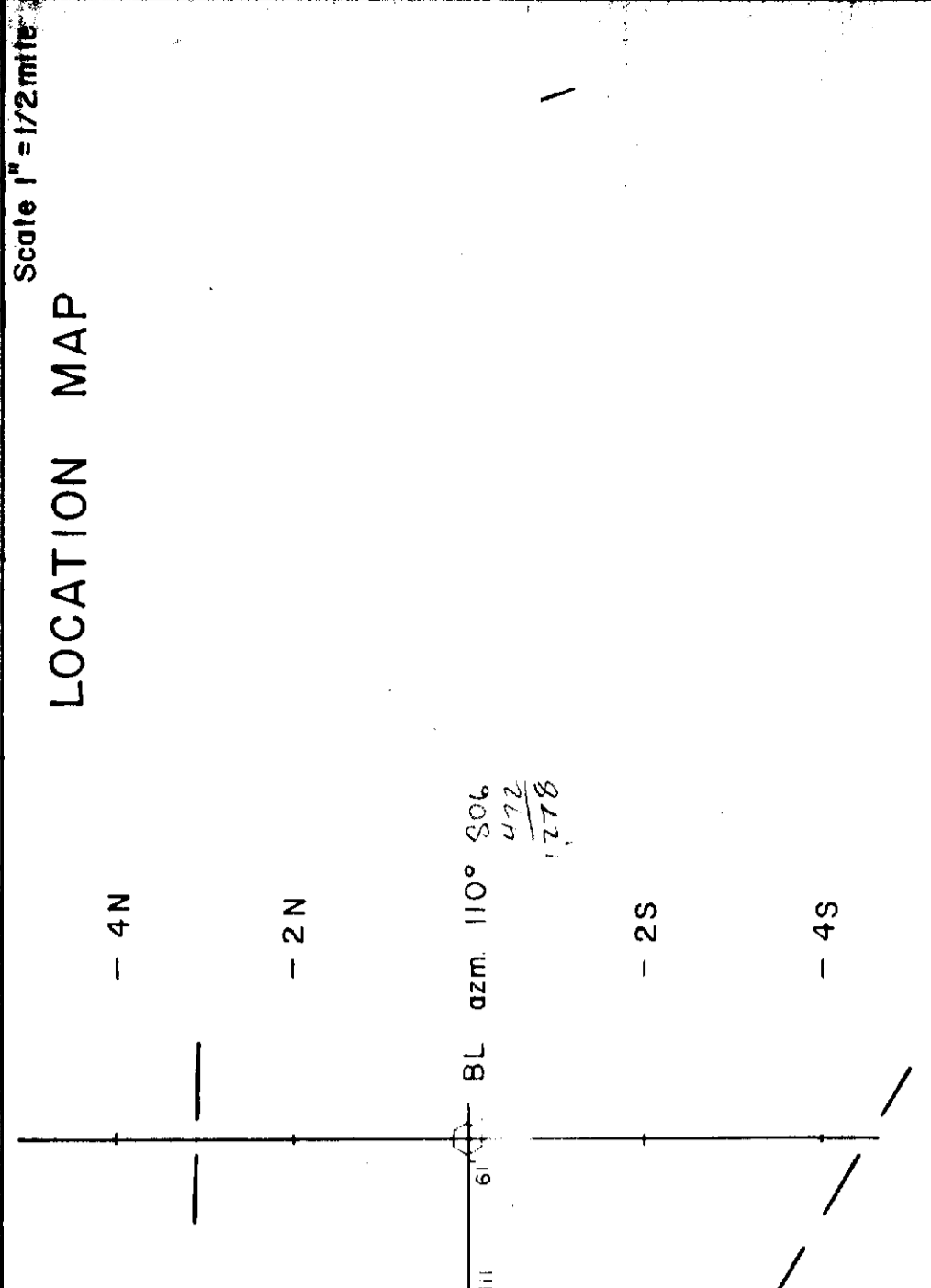
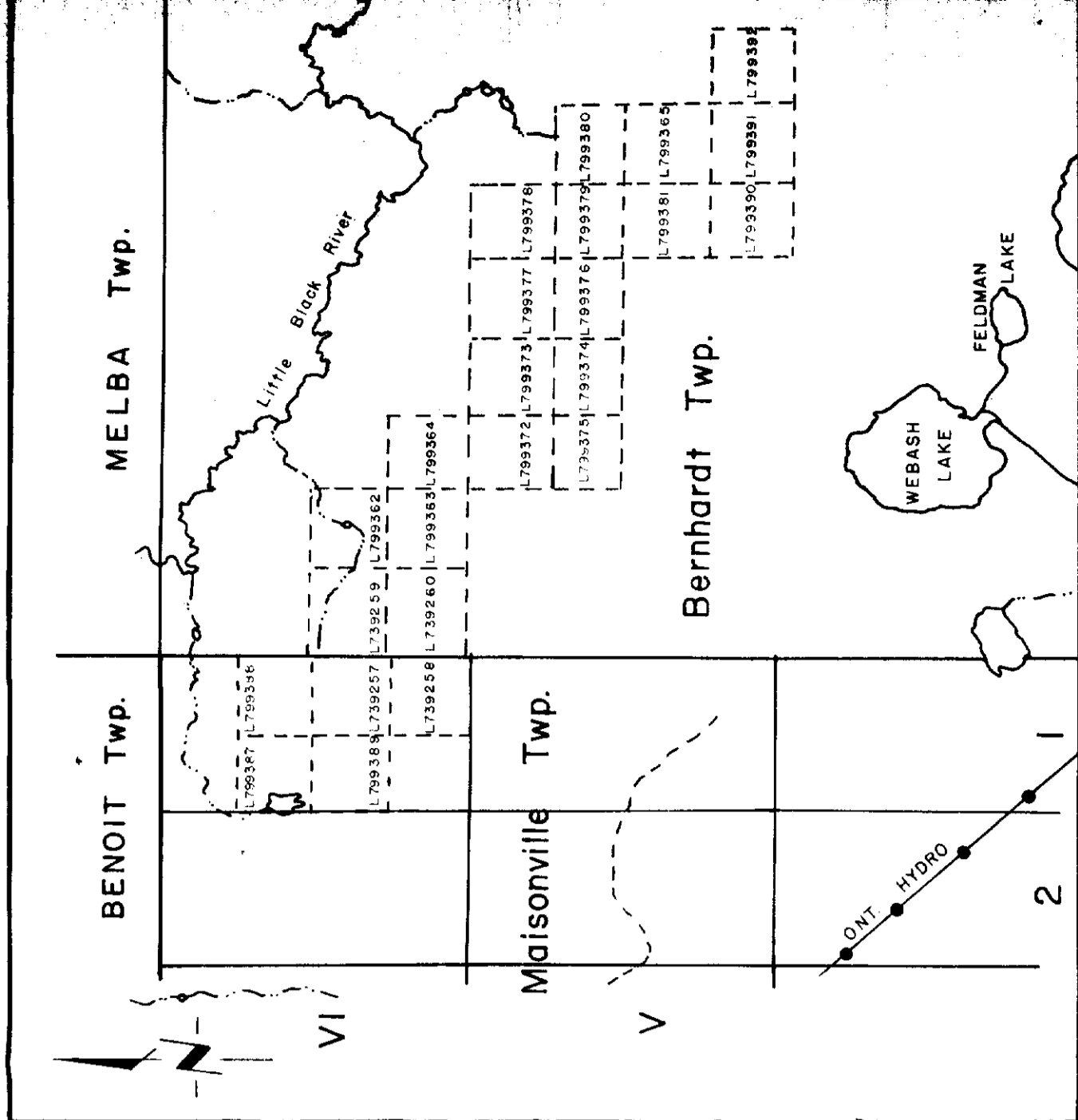

Scale 1" = 1/2 mile

Scale 1" = 200'

2.9061 duplicate 0M85-6-P-112

LONGBOW LAKE EXPL.

Basal Till Hole Locations

Township: Bernhardt & Maisonville NTS: 42 A/B

Mining Division: Larder Lake

Drawn By: W. MacRae

Date: 23/02/86

Scale: 1" = 200'

Map I

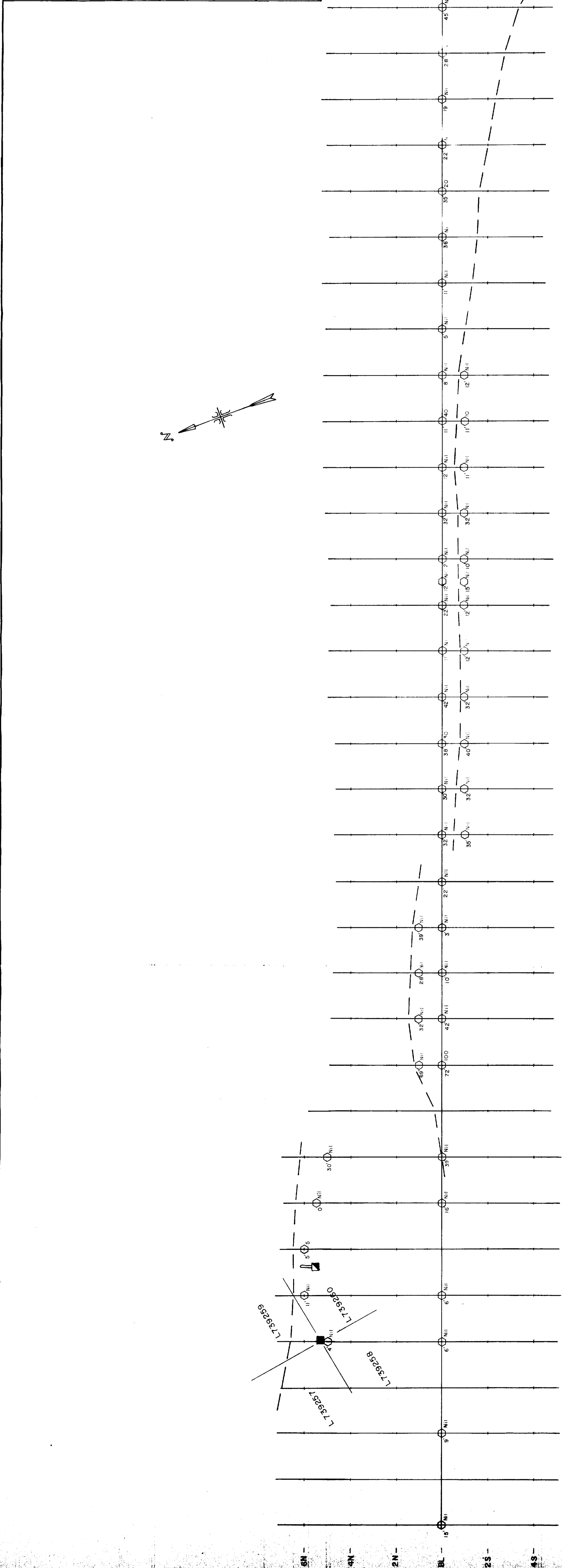

BL azm 110° GOL
0.72
1.778

4N
2N
BL
2S
4S

L6W L4W L2W L0 L2E L4E L6E L8E L10E L12E L14E L16E L18E L20E L22E L24E L26E L28E L30E L32E L34E L36E L38E L40E L42E L44E L46E L48E L50E L52E L54E L56E L58E L60E

Legend

- Basal fill hole location
- Claim post
- Shaft
- VLF-EM anomaly axis

9200

WEN William E. MacRae Geological Services