

W7408-252



010

THE MINING ACT REPORT OF WORK

type of work to be recorded.

To the Recorder of LARDER-LAKE Mining Division

I, WILFRED COOPER K 18068  
name of Recorded Holder Prospector's Licence

39 RIVER VIEW BLVD ST CATHARINES  
Post Office Address

do hereby report the performance of 1032 HRS days of MANUAL LABOUR  
type of work

not before reported to be applied on the following contiguous claims

Claim No.	Days	Claim No.	Days	Claim No.	Days
<u>1366 593</u>	<u>28.8</u>			<u>Micha trap</u>	
<u>594</u>	<u>28.8</u>				
<u>595</u>	<u>28.8</u>				
<u>596</u>	<u>28.8</u>				
<u>597</u>	<u>28.8</u>				
<u>598</u>	<u>28.8</u>				

Geological Branch ODM  
ASSESSMENT FILES  
RESEARCH OFFICE  
OCT 17 1974  
RECEIVED

All the work was performed on Mining Claim (s) 1366 597, 1366 596  
(In the case of geological and/or geophysical survey (s) where more than 18 claims are involved attach a schedule)

READ CAREFULLY: THE FOLLOWING INFORMATION IS REQUIRED BY THE MINING RECORDER.

- For Manual Work, Stripping or Opening up of Mines, Sinking Shafts or Other Actual Mining Operations - Names and addresses of the men who performed the work and the dates and hours of their employment.
- For Diamond and other Core Drilling - Footage, No. and angle of holes and diameter of core. Name and address of owner or operator of drill. Dates when drilling was done. Signed core log and sketch in duplicate.
- For Compressed Air or Other Power Driven or Mechanical Equipment  
Type of drill or equipment. Names and addresses of men engaged in operating equipment and the dates and hours of their employment.
- For Power Stripping - Type of equipment. Name and address of owner or operator. Amount expended. Dates on which work was done. Proof of actual cost must be submitted within 30 days of recording.
- With each of the above types of work sketches are required to show the location and extent of the work in relation to the nearest claim post. In the case of diamond or other core drilling the sketch must be submitted in duplicate.
- For Geophysical, Geological, Geochemical Surveys and Expenditure Credits - the name of author of report. Covering dates of survey (linecutting & office). Type of instrument used. Total amount of expenditure. Technical reports, maps, expenditure breakdown, receipts must be filed in duplicate with the Minister within 60 days of recording.
- For Land Survey - the name and address of Ontario Land surveyor.

The Required Information is as Follows: (Attach a list if this space is insufficient)

CREDIT  
 $\frac{1017}{6} = 172.8 \text{ DAYS}$   
 $172.8 \div 6 = 28.8 \text{ PER CLAIM}$

RECEIVED  
SEP 27 1974  
AM 7 18 19 10 11 12 1 12 3 4 5 PM

Date SEPT 23 - 74

Wilfred Cooper  
Signature of Recorded Holder or Agent

The Mining Act  
Certificate Verifying Report of Work

I, WILFRED COOPER  
39 RIVER VIEW BLVD ST CATHARINES  
(Post Office Address)

hereby certify:

- That I have a personal and intimate knowledge of the facts set forth in the report of work annexed hereto, having performed the work or witnessed same during and/or after its completion.
- That the annexed report is true.

Dated SEPT 23 19 74

Wilfred Cooper  
Signature

File # 366593

RECORDED OCT - 9 1974  
REC. No.

THE PENALTY FOR MAKING A FALSE STATEMENT IN THIS REPORT AND/OR CERTIFICATE IS \$500. OR SIX MONTHS IMPRISONMENT OR BOTH



42A08SE5094 W7408-00252 MELBA

900

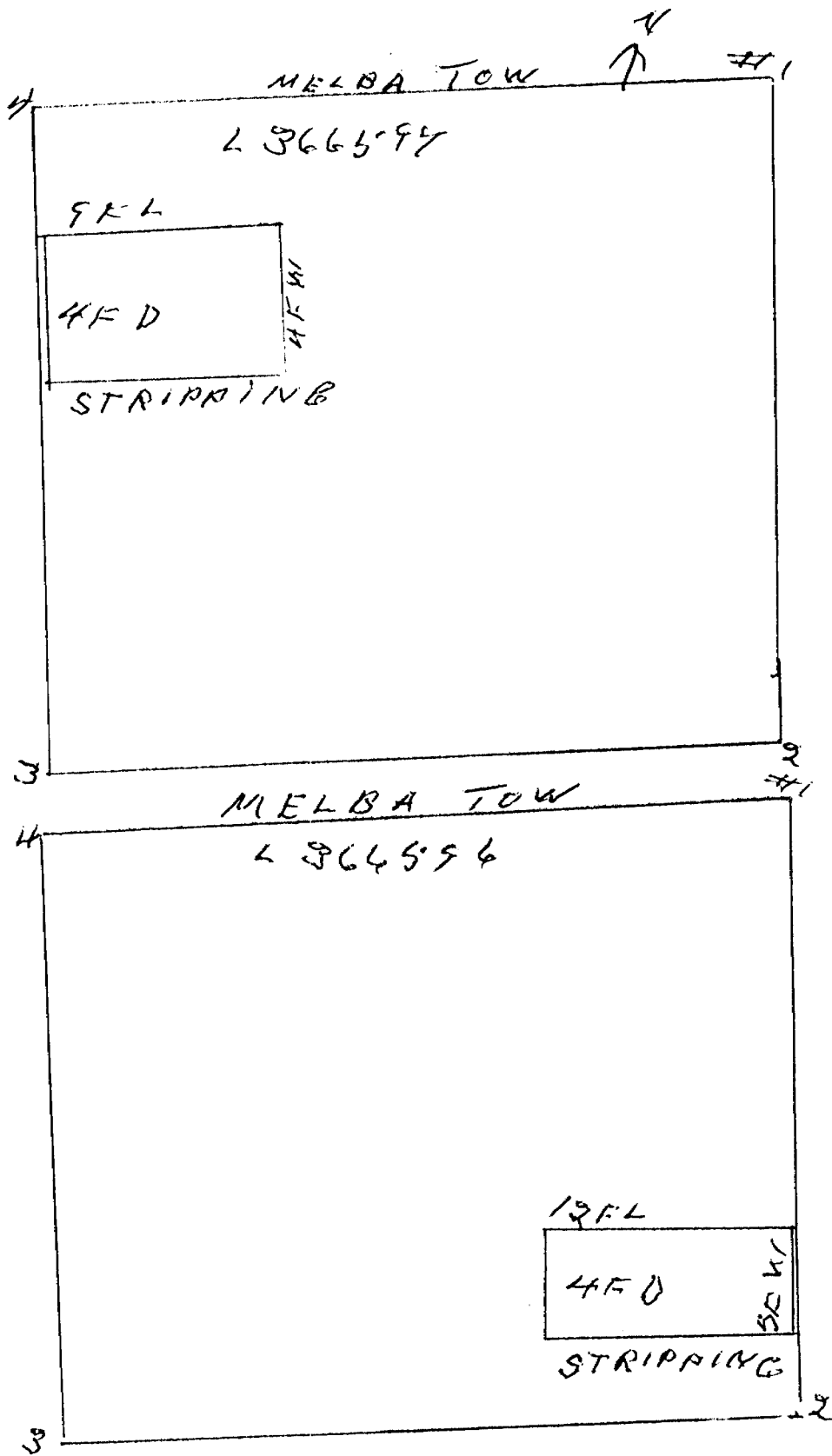

	6	7	8	9	10	11	12	13	14	15	16	17	18	19	20	21	22	23	24	25	26	27	28	18	20				
BRIAN COOPER	5			4						6			3	2			6			4	4							34	
WM. SULLIVAN	4		5									6	3			4			6	3				6	4			41	
TOM SULLIVAN			3			5				2		4				2		5			2	2			5			30	
DEAN SULLIVAN	5				6					5																		16	
JOHN SULLIVAN	2	2	2	2	2	2	2			4	2	2	2	2				2	2	2	2	4			2	2			42
KEITH COOPER				6						5	5			5	4	2			6	5	4	3	4			3			48
WILF COOPER	4			5						5			6					4			6				4			<del>34</del> 24	

	5	10	10	10	6	10	10			4	10	10	7	8			4	10	10	10	6	10	6	3	5	
BRIAN COOPER	5	10	10	10	6	10	10			4	10	10	7	8			4	10	10	10	6	10	6			156
WM SULLIVAN	10	6	10	5	10	10	10			10	10	4	7	10			6	10	11	4	2	10	10	3	5	117
TOM SULLIVAN	10	10	7	10	10	5	10			8	10	10	6	10			8	10	5	10	10	8	8	10	4	179
DEAN SULLIVAN	5	10	10	10	4	10	5																			54
JOHN SULLIVAN	8	8	8	8	8	8	8			6	8	8	8	8			10	8	8	8	8	4	10	8	7	165
KEITH COOPER	10	10	4	10	10	5	5			10	5	6	10	8			10	4	5	6	7	10	6			141
WILF COOPER	10	6	10	5	10	10	10			10	5	10	10	4			10	6	10	10	10	4	10	5	10	175

Chairs  
MELBA

$$\frac{83}{6} = 13 \frac{5}{6} \text{ DAYS}$$

$$\frac{254}{6} = 42 \text{ DAYS PER CLAIM}$$

1777  
18 20  
34  
41  
30  
16  
42  
48  
34  
24  
156  
171  
165  
141  
175  
1047