

42A095W0029 42 BEATTY

010

DIAMOND DRILLING

TOWNSHIP: BEATTY TWP.

REPORT NO: 42

WORK PERFORMED FOR: Maude Lake Gold Mines Ltd.

RECORDED HOLDER: Same as Above [xx]  
: Other [ ]

<u>Claim No.</u>	<u>Hole No.</u>	<u>Footage</u>	<u>Date</u>	<u>Note</u>
L 772555	MX84-02	457'	Aug/84	(1)
	MX84-03	447'	Aug/84	(1)
L 772557	SX84-04	518'	Sept/84	(1)
L 642579	SX84-05	450'	Sept-Oct/84	(1)

NOTES: (1) W8908-142, date filed June/89

**D-OR:** 44+00E, 44+50N **AZ:** 180 **DIP:** 45S **ELEV:** SURFACE **LOGGER NB**  
**TWP:** BEATTY **CLAIM:** L.772555 **START:** 08/11/84 **FINISH:** 08/20/84  
**DIP TESTS:** @ 8 FT - -45 ; @ 225 FT--45; @ 450 FT--44 degrees  
**DRILLED BY:** McKnight Drilling **CORE:** AQ **COMMENTS:** MAIN GROUP

FTAGE	DESCRIPTION	SAMPLE NUMBER	FTAGE from / to	LGTH ft	ASSAY opt
0	collar				
8	casing - bedrock at 8 ft				
63	BASALT - dark to light grey, well pillowed. cut by a white qtz vein. Pyrite, pyrrhotite & qtz-carb found in pillow margins.				
81.6	PORPHYRY - dark grey feldspar porphyry. Cts gradational with upper ct over 1', lower ct over 4".				
182	BASALT - fg, dark green to grey, pillowed lava with occasional chlorite clots. Some Py and Po along pillow margins.				
189.6	BASALT - fg, massive, with minor qtz-carb veinlets, and chl atln.				
244.5	BASALT - pillowed as above, with minor chloritic alteration. cut by several white qtz vns at 55 and a section of well developed breccia.				
245.2	LAMPROPHYRE - dyke, cutting pillowed basalt, with blebs of chlorite and Py.				
307.2	BASALT - pillowed, as above, with few qtz veins at 45 to 55 degrees.				
315.6	PORPHYRY - dark grey feldspar porphyry. UC @42, LC @40.				
323	BASALT - light green, weakly altered pillowed basalt.				
379.4	BASALT - fg to mg, massive, cut by minor qtz veinlets. Occasional pillows and chlorite clots. Pyrite.				
457	BASALT - light green, weakly altered pillowed basalt as above. Some Po and Py along pillow margins.				

FOOT OF HOLE

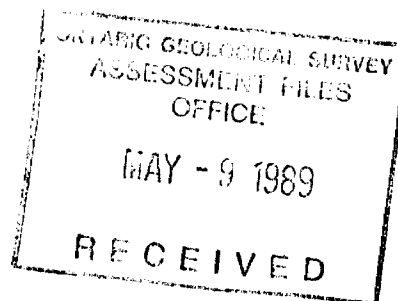

MAIN GROUP

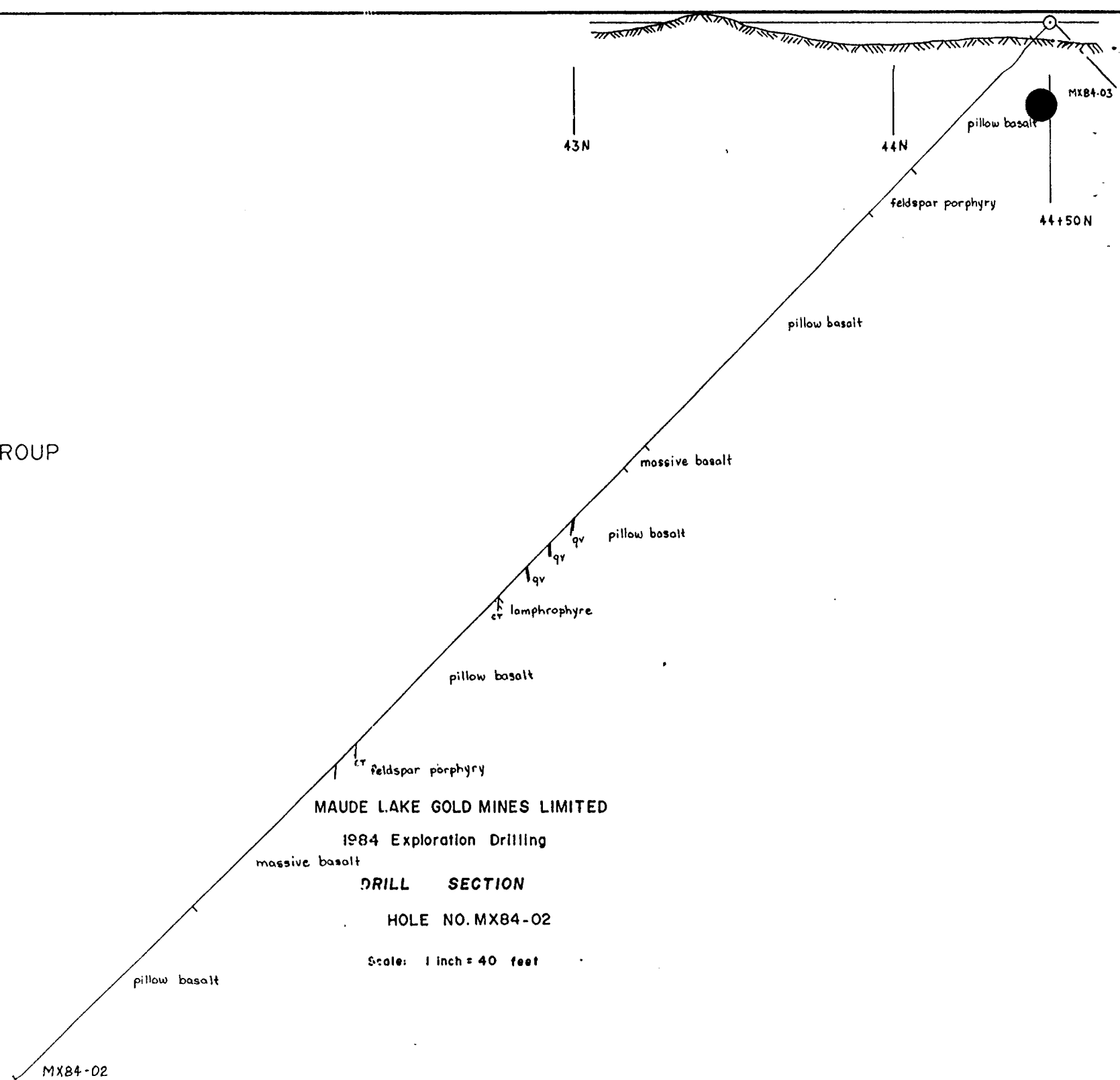

MAUDE LAKE GOLD MINES LIMITED

1984 Exploration Drilling

DRILL SECTION

HOLE NO. MX84-02

Scale: 1 inch = 40 feet

MX84-02

**MAUDE LAKE GOLD MINES LTD.**

**BORHOLE LOG**

**HOLE# MX84-03**

**OR: 44+00E, 44+50N AZ:360 DIP:45N ELEV: SURFACE LOGGER NB**

**TWP: BEATTY CLAIM: L.772555 START:08/21/84 FINISH:08/31/84**

**DIP TESTS: @220 ft--43; @447 ft-42 degrees.**

**DRILLED BY: McKnight Drilling CORE: AQ COMMENTS: MAIN GROUP**

FTAGE	DESCRIPTION	SAMPLE NUMBER	FTAGE from / to	LGTH ft	ASSAY opt
0	collar				
7	casing, bedrock at 7'				
56.6	BASALT - fg, dark grey, pillowed, with fine qtz veinlets. Interpillow breccia, abundant Po, Py and qtz-carb along pillow margins.				
69.4	BASALT - fg, massive basalt with few minor qtz-carb veinlets.				
131.5	BASALT - fg, dark grey, pillowed basalt as above, with light green altn near pillow margins. Abundant Py and Po pillow margins.				
145	BASALT - fine to medium grained, grey-green massive basalt.				
225.8	BASALT - pillow basalt as above, cut by a white qtz vn, ct @ 45. Interpillow qtz-carb brecciation with minor Py and Po.				
413.8	BASALT - f to mg, grey-green massive, with black chl specks throughout. Few pillows, disc py & po assoc with margins. Minor alteration as above. Grades into a cg, light grey dioritic lava down hole. Minor qtz-vns at 40 degrees.				
447	BASALT - fg, dark green, pillowed basalt. Disseminated po and py along pillow margins. Locally heavy Py and Po in Pillow margins.				

FOOT OF HOLE

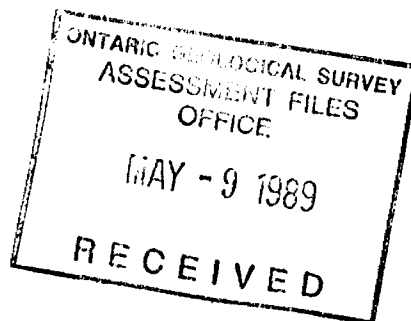

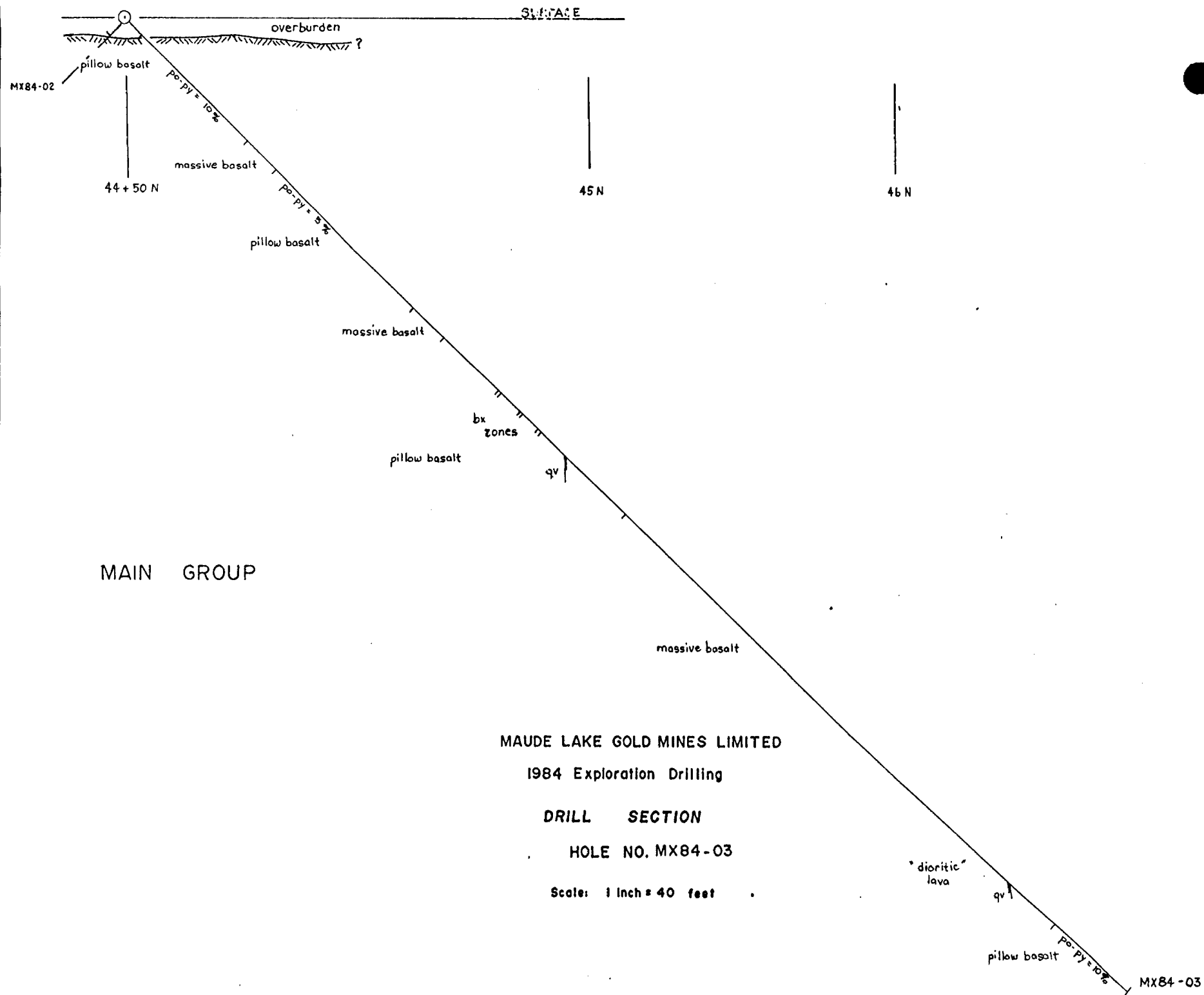

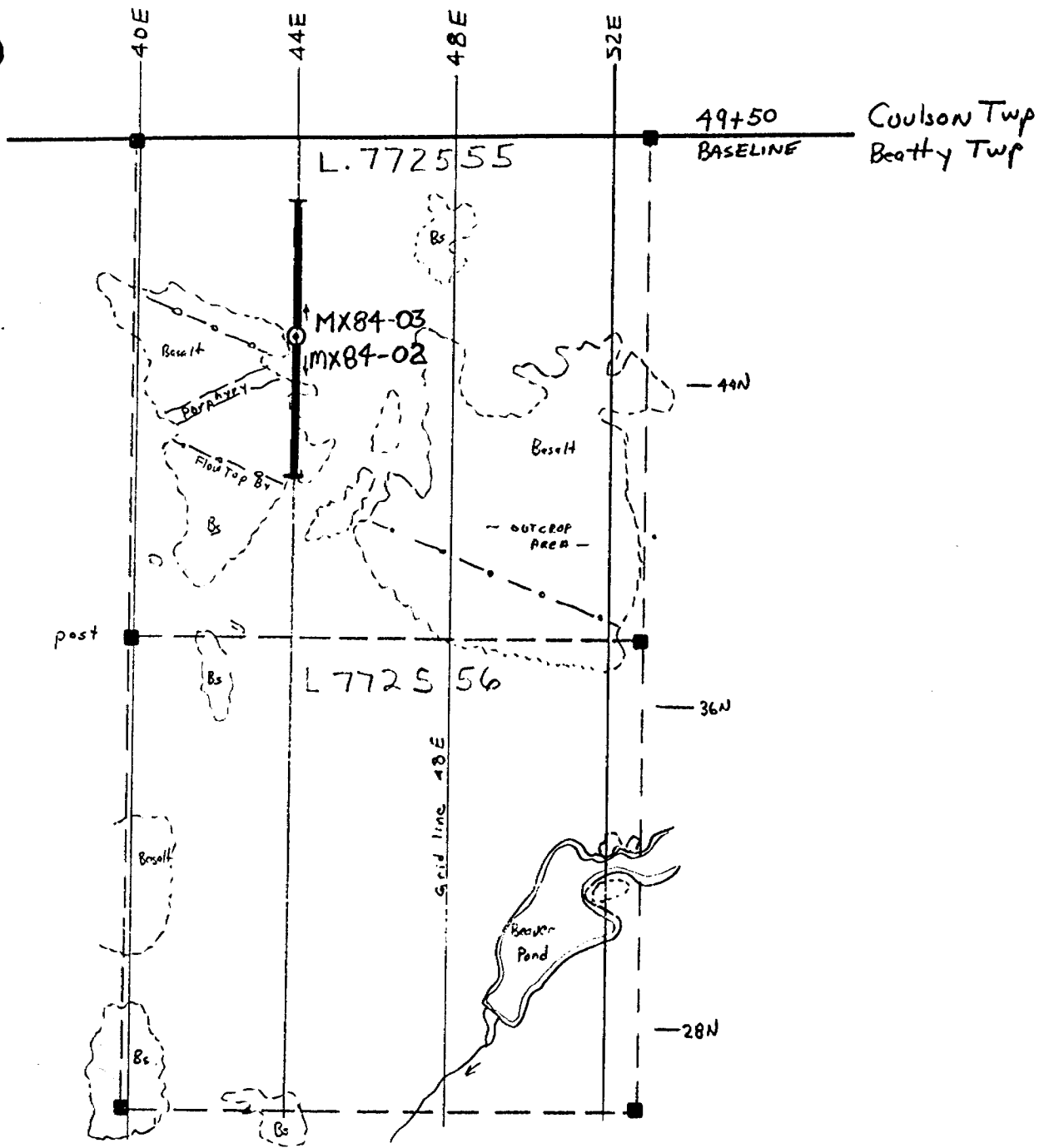

Lot 10  
Lot 9

MAUDE LAKE GOLD MINES LTD

"MAIN GROUP" - NE. Corner

BOREHOLES MX84-02, MX84-03

LOCATION PLAN

Scale: 1" = 400'

OCT 1984

**MAUDE LAKE GOLD MINES LTD.**

**BORHOLE LOG**

**HOLE# SX84-04**

**CO-OR:** 77E, 1S    **AZ:** 20    **DIP:** 40    **ELEV:** SURFACE    **LGTH:** 518 ft    **LOGGER:** RAB  
**TWP:** BEATTY    **CLAIM:** L772557    **START:** 09/6/84    **FINISH:** 09/25/84  
**DIP TESTS:** @300 FT - 39 DEGREES, @518 FT - 37 DEGREES  
**DRILLED BY:** McKNIGHT DRILLING    **CORE:**AQ    **COMMENTS:** SALVE GROUP

FTAGE	DESCRIPTION	SAMPLE	FTAGE	ASSAY
0	collar			
10	casing. 3 feet overburden			
32	RHYOLITE TUFF, f-mg, grey, rounded qtz grains & anhedral feldspar; several white Rhy fragments, flow banded matrix @50 deg. Fine dissem py & few narrow qtz-carb fracture-fillings @ 40 deg.			
35	RHYOLITE TUFF as above but altd-buff colour			
56.5	RHY. TUFF as @ 32', 2" qv at 43.5' @ 35 deg.			
62.6	RHY. TUFF becoming more dacitic and 're-worked' or laharic. Bedding/banding contacts at 50 deg.			
86.3	RHY. TUFF as @ 32 ft with 1' white qtz veins at 76 ft @50 deg and 81 ft @40 deg. Sharp LC @ 65.			
117.4	DACITIC TUFF- LAHAR pale, grey-buff, well banded at 50 deg (Tops N), occasional rhy. pyroclast. Black, graphitic material; few narrow qtz vnlt. 1% pyrite throughout. A 2" graphite bed at 112 ft @ 60 deg - CONDUCTOR. Sharp lower ct with 40% graphite in basaltic flow top breccia.			
138.0	BASALT-ANDESITE lg, pale green, rather massive, mafic lava. Few calcite vnlt @ 60 deg.			
155.0	BASALT altered, buff-green coloured with abundant carbonate-filled fractures (resmbles autobx).			
166.0	BASALT as @ 138 ft with marked flow top breccia at lower ct. 3" lamp dyke at 158.5 ft @ 80 deg.			
192.0	VARIOLITIC BASALT f-cg varioles(20-60% of rock) in basaltic matrix. 178-181 ft has graphitic matrix to varioles. At 190 ft - .3' qtz vein + cpy and cpy fracture fill. Lower ct is chlorite mud @ 45 deg.			
200.6	BASALT non-variolitic, locally brecciated.			
250.8	VARIOLITC BASALT as before, quite massive, dark green, sharp LC @ 45 deg. Few talcose			

ONTARIO GEOLOGICAL SURVEY  
 ASSESSMENT FILES  
 OFFICE  
 MAY - 9 1989  
 RECEIVED

shear zones.

- 309.0      **BASALT-KOMATIITE** fg-mg, chl-talc rich, mottled. At 286-288 ft - 1% pyrite and minor cpy.
  
- 323.0      **VARIOLITIC BASALT** as at 250.8 ft.
  
- 367.5      **BASALT-KOMATIITE(?)** as at 309 ft.
  
- 397.0      **BASALT-ANDESITE** massive, green, fg. At 385-388ft - white carb + qtz vein @ 23 deg. Several narrow carb fracture-fills @ 30-40 deg. Sharp lower contact at 40 degrees.
  
- 420.1      **VARIOLITIC BASALT** 60% varioles oriented @ 45.
  
- 435.2      **PILLOW BASALT** fg, green, massive .
  
- 482.9      **VARIOLITIC BASALT** as before, grnl cts.
  
- 493        **BASALT** green, massive flow.
  
- 518        **VARILOITC BASALT** as before. Oriented @ 35 deg.

**FOOT OF HOLE**



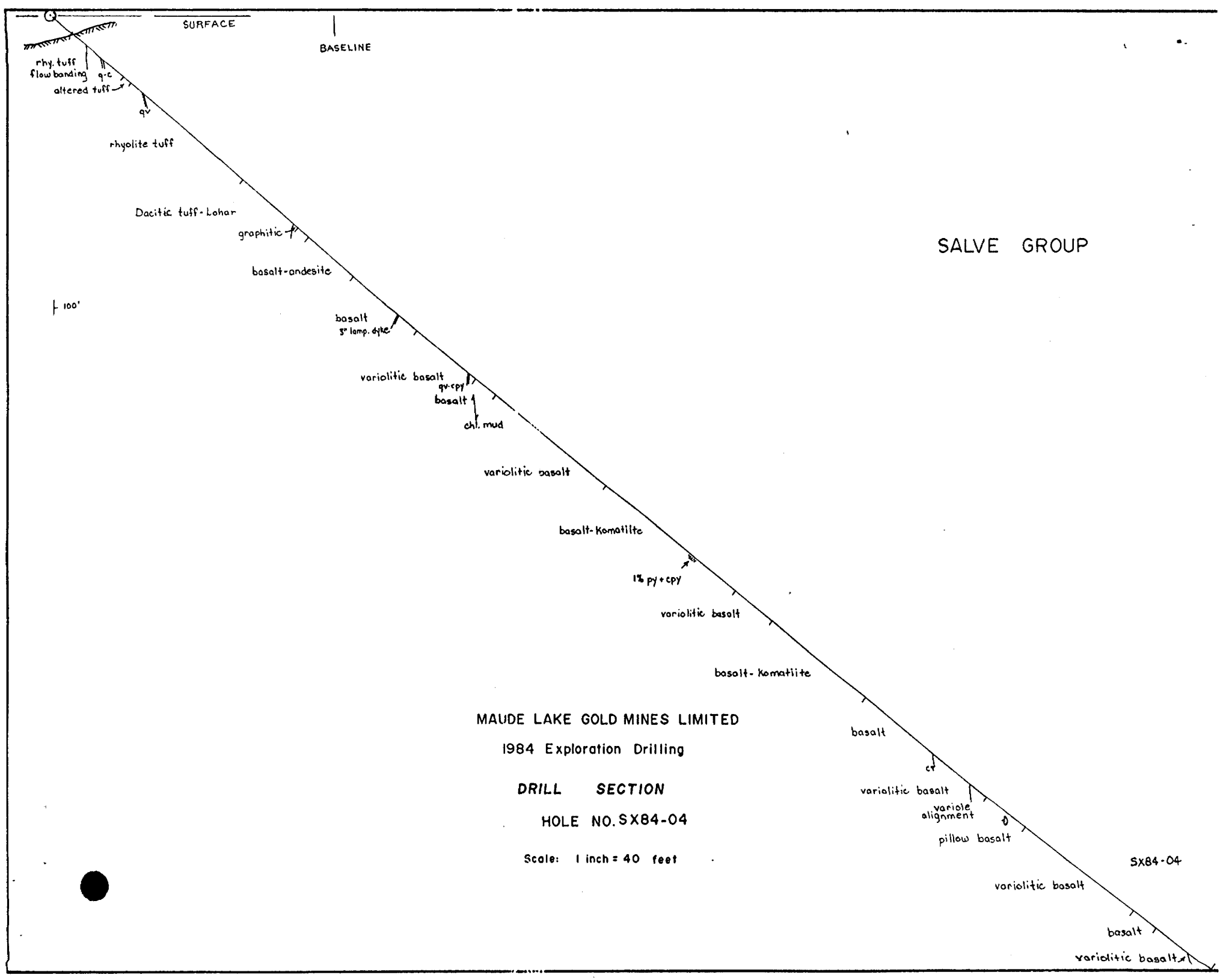

SALVE GROUP

MAUDE LAKE GOLD MINES LIMITED  
 1984 Exploration Drilling  
**DRILL SECTION**  
 HOLE NO. SX84-04

Scale: 1 inch = 40 feet

SX84-04

100'

SURFACE

BASELINE

rhy. tuff  
 flow banding q-c  
 altered tuff

rhyolite tuff

Dacitic tuff-Lohar

graphitic

basalt-andesite

basalt  
 5' lamp. dyke

variolitic basalt  
 qv+cpy

basalt  
 chl. mud

variolitic basalt

basalt-Komatiite

1% py+cpy

variolitic basalt

basalt-Komatiite

basalt

variolitic basalt

varic alignment

pillow basalt

variolitic basalt

basalt

variolitic basalt

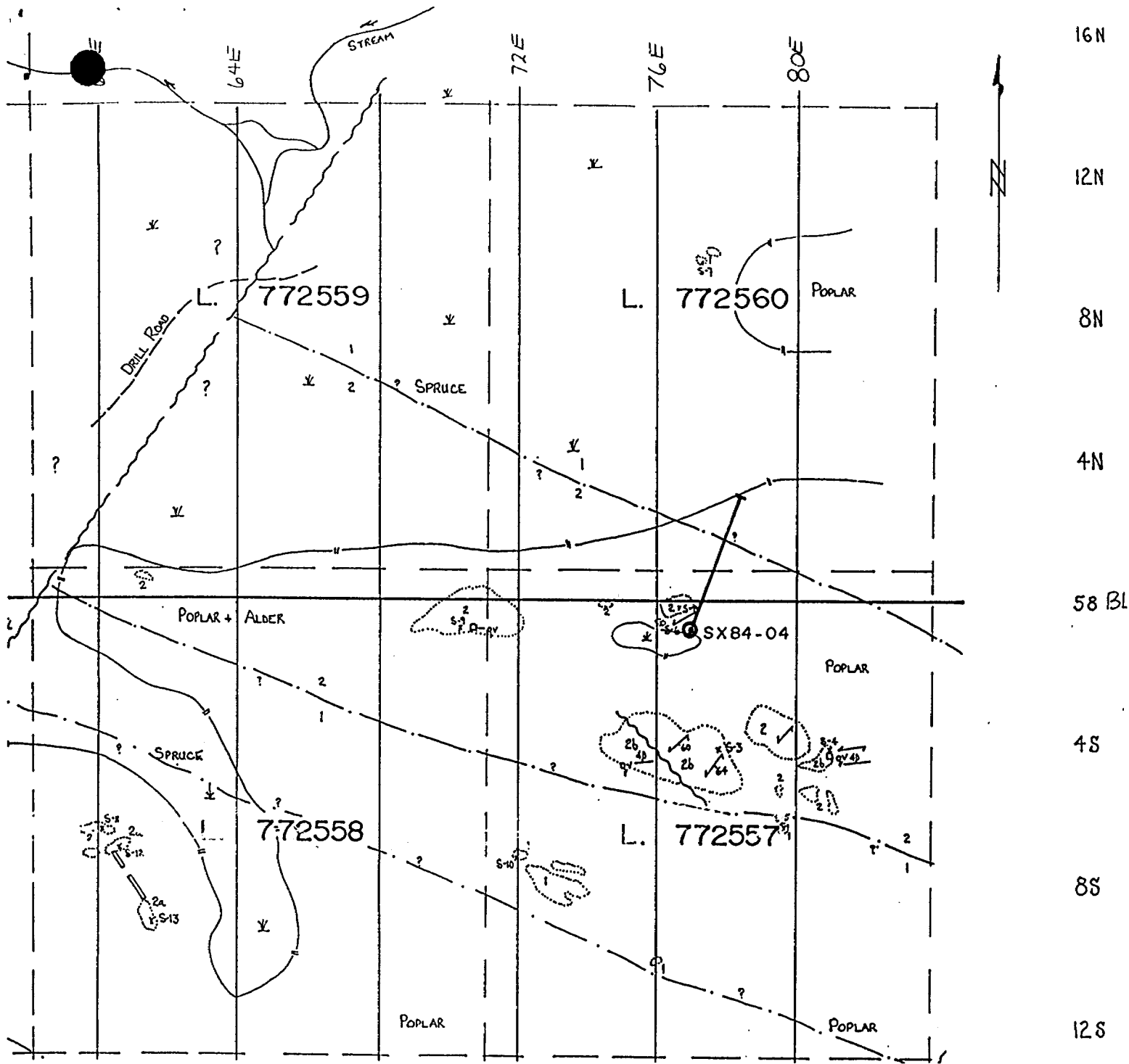

LOCATION PLAN

MAUDE LAKE GOLD MINES LTD

SALVE GROUP

Beatty Township

Borehole SX84-04

1" = 400ft

Jan 85

**MAUDE LAKE GOLD MINES LTD.**

**BOREHOLE LOG**

**HOLE# SX84-05**

**CO-OR:** 48E, 1S    **AZ:** 180    **DIP:** 45    **ELEV:** SURFACE    **LGTH:** 450FT    **LOGGER:** RAB  
**TWP:** BEATTY    **CLAIM:** L642579    **START:** 09/26/84    **FINISH:** 10/13/84  
**DIP TESTS:** @ 10 FT - 45 DEGREES, @ 200 FT - 43 DEGREES, @ 450 ft - 41 DEGREES  
**DRILLED BY:** McKNIGHT DRILLING    **CORE:**AQ    **COMMENTS:** SALVE GROUP

FTAGE	DESCRIPTION	SAMPLE NUMBER	FTAGE from/to	ASSAY opt Au
0	collar			
14	casing, 10 feet of overburden.			
23.8	DACITE TUFF vfg, grey, weakly carbonatized, with occasional clasts to 1/2 inch. Few chl slips @ 49 deg and chl. spots(amygdules?), scarce speck of pyrite.			
52.8	DACITE flow - f-mg, grey-buff, rather massive to locally brecciated with occ. chl amygd. LC @ 34 deg.			
59.8	ANDESITE-BASALT f-mg, green-grey, massive flow with sub-diabasic texture. Sharp LC @ 50 degrees.			
69.7	RHYOLITE aphanitic to vfg, buff colour, masive, occ. qtz-carb vnl @ 40-70 deg; locally spherulitic. Sharp lower ct @ 47 degrees.			
77.7	ANDESITE-BASALT as at 59.8 ft. Few chl slips at 20 degrees. Contact altn zones gradational.			
102.0	RHYODACITE Flow aphanitic to fg, grey, massive with occasional white qtz vnl @ 30 deg, some chl spots, gradational LC to buff coloured.			
147.6	RHYOLITE TUFF vfg, grey-buff, with rounded qtz eyes & angular feldspar grains, few angular rhy. clasts, several 1/16 inch qtz vnls @ 40-60. LC-46.			
150.8	RHYOLITE TUFF as above but medium to coarse grained phase. Contacts @ 35 degrees.			
161.0	RHYOLITE TUFF as at 147.6 ft. LC at 57 degrees.			
182.7	ANDESITE BRECCIA - possibly silicified basalt (due to rhy), grey to dark grey, chlorite slips and foliation at 32 deg. Breccia matrix is black graphitic cherty material. There are a few pillow rindes preserved.			

ONTARIO GEOLOGICAL SURVEY  
 ASSESSMENT FILES  
 OFFICE  
 MAY - 9 1989  
 RECEIVED

- 188.7 QUARTZ VEIN barren white qtz with up to 30% chlorite as fracture-fill. Cts @ 70 deg.
- 237.4 BASALT PILLOW LAVA fg, green, massive, few chl fractures @ 30-50 deg and qtz-carb vnlts @ 40-50 degrees. Few specks pyrite.
- 245.0 ANDESITE BRECCIA as at 182.7 ft. Sharp lower contact at 65 degrees.
- 247.0 GRAPHITE black, vfg, hard, graphitic chert bed - CONDUCTOR.
- 287.1 RHYODACITE BRECCIA fg-mg, grey, qtz and feldspar grains (may be a tuff), with mafic matrix containing up to 4% disseminated pyrite. Becomes more massive down hole.
- 306.0 RHYODACITE FLOW . As above but massive.
- 444.6 FLOW BANDED RHYOLITE f-mg, grey, very hard and siliceous. good flow bands at 5 to 85 degrees (mostly @ 50-70 deg). several brecciated to laharc-looking sections at 309-311 ft, 314-322 ft, 326-328 ft, and 351-54.6 ft. Occasional disseminated py and blebs of pyrite. Several 1-2" qtz veins @ 374', 442', 443', 444'.
- 445.5 QUARTZ VEIN barren, milky-white vein with chlorite fracture fill. Contacts a 75.
- 450 FLOW BANDED RHYOLITE as above. 1 inch qtz vein at 446.2 ft @ 70 deg.

FOOT OF HOLE

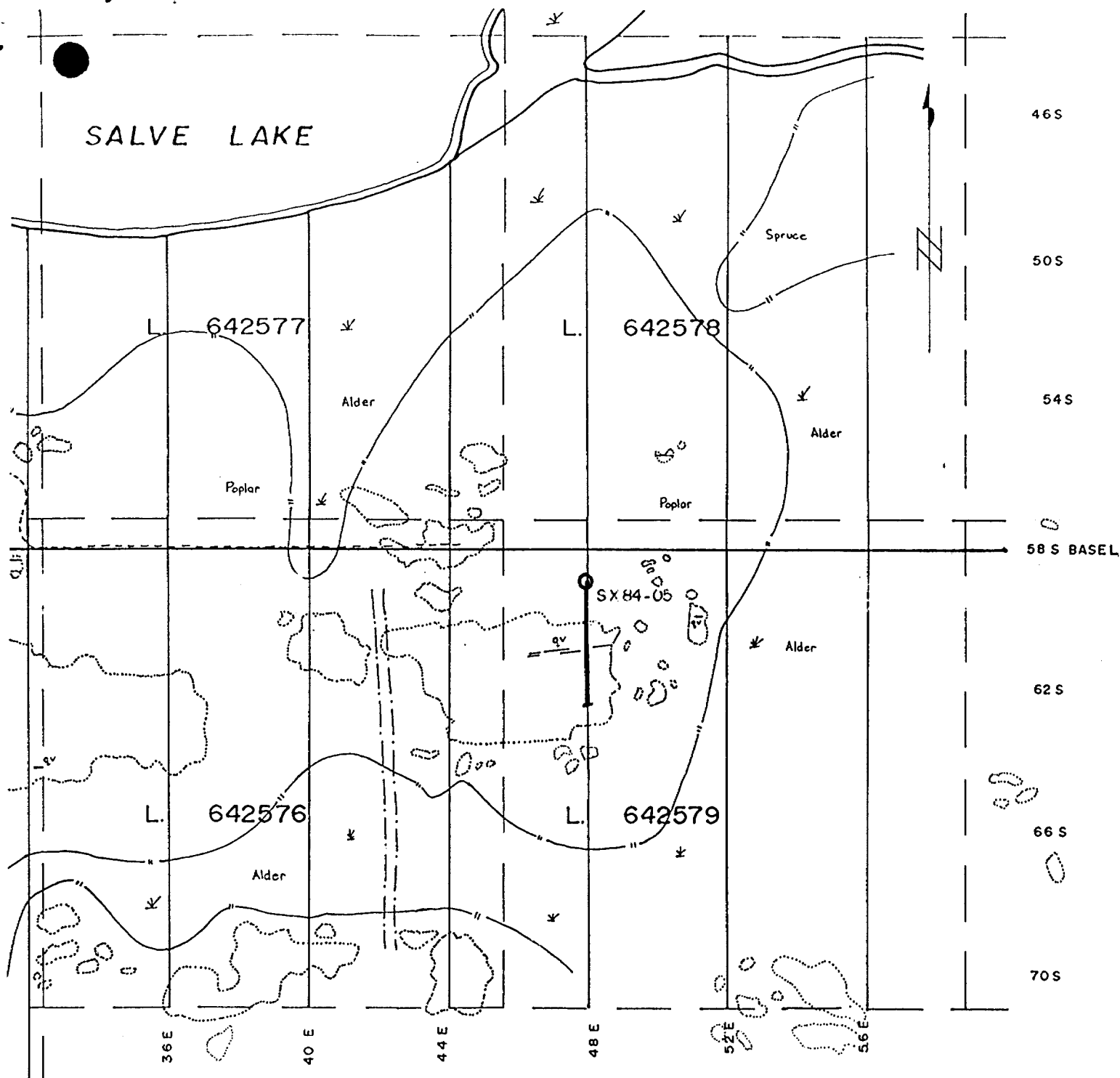

LOCATION PLAN

MAUDE LAKE GOLD MINES LTD

SALVE GROUP

Beatty Township

Borehole SX84-05

1" = 400ft

Jan 85

SALVE GROUP

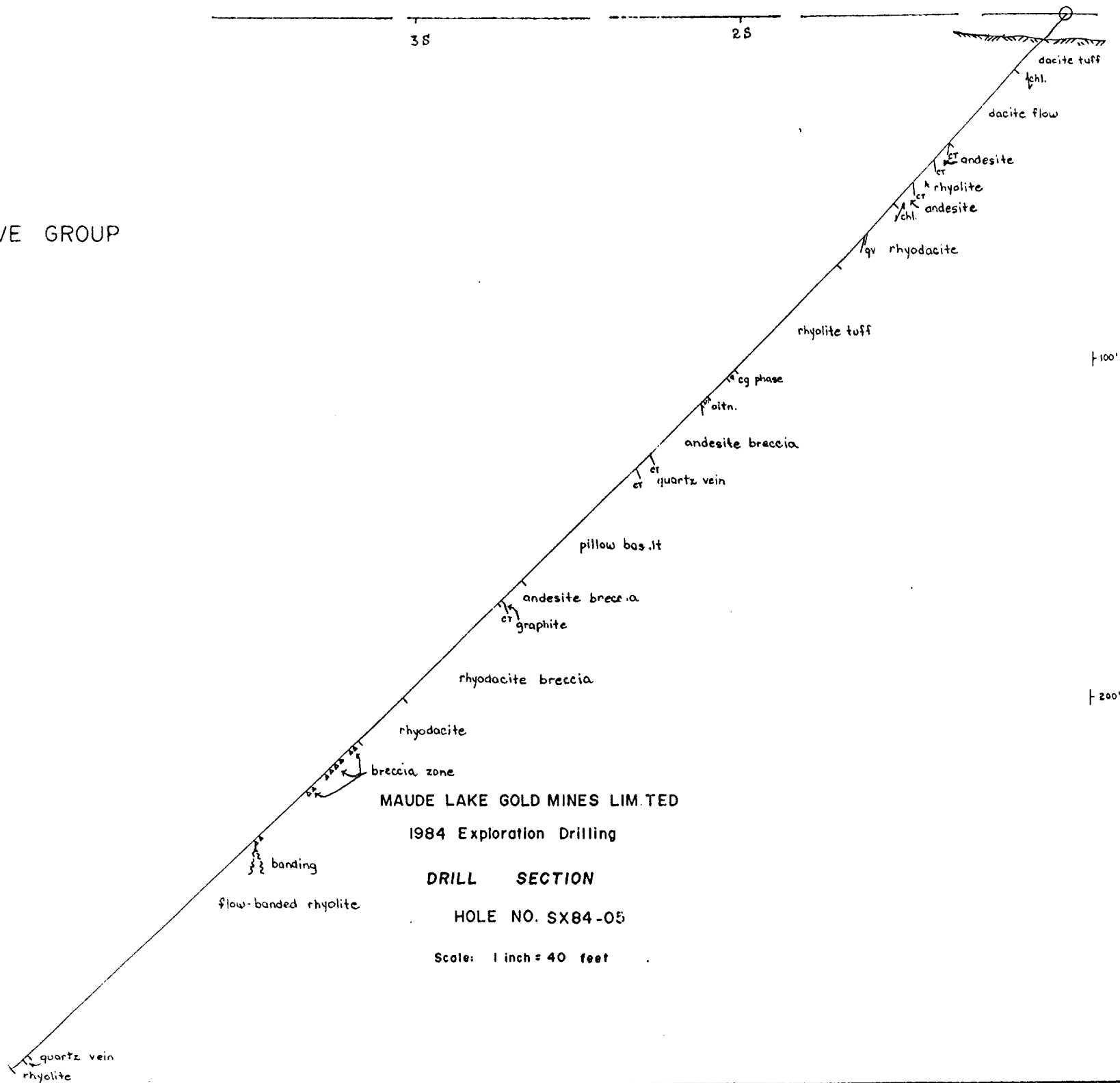

38

25

dacite tuff

chl.

dacite flow

cr andesite

cr rhyolite

chl. andesite

lqv rhyodacite

rhyolite tuff

cg phase

oltn.

andesite breccia

cr quartz vein

pillow basalt

andesite breccia

cr graphite

rhyodacite breccia

rhyodacite

breccia zone

banding

flow-banded rhyolite

MAUDE LAKE GOLD MINES LIMITED

1984 Exploration Drilling

DRILL SECTION

HOLE NO. SX84-05

Scale: 1 inch = 40 feet

100'

200'

SX84-05

quartz vein  
rhyolite

DRILL CORE LIBRARY  
 LARDER LAKE MINING DIVISION  
 DIAMOND DRILL CORE DONATION FORM

ONTARIO GEOLOGICAL SURVEY  
 ASSESSMENT FILES  
 OFFICE  
 MAY - 9 1989  
 RECEIVED

Core Received From : Company: MAUOE LAKE GOLD MINES LTD  
 Representative: R.A. Bennett  
 Address: Box 159  
Matheson, Ont, P0K1W0  
 Telephone: (705) 273-2764  
 # of Boxes Received: 4

HOLE #	# OF BOXES	FEET/ METERS <i># of Samples</i>	TOWNSHIP	LOGS/ LOC'N
<u>MX 84-02</u>	<u>1</u>	<u>46</u>	<u>Beatty</u>	
<u>MX 84-03</u>	<u>1</u>	<u>45</u>	<u>Beatty</u>	
<u>SX 84-04</u>	<u>1</u>	<u>52</u>	<u>Beatty</u>	
<u>SX 8405</u>	<u>1</u>	<u>44</u>	<u>Beatty</u>	

Donated by (Signature): [Signature] Date: Apr 13/89  
 Received by (Signature): [Signature] Date: Apr 13/89

ATTENTION; Core donated becomes the property of the Ontario Ministry of Natural Resources.

Wilke  
Twp  
M.318

Coulson  
M.340

Betty  
M.324

Carr  
G.361B

LUP.

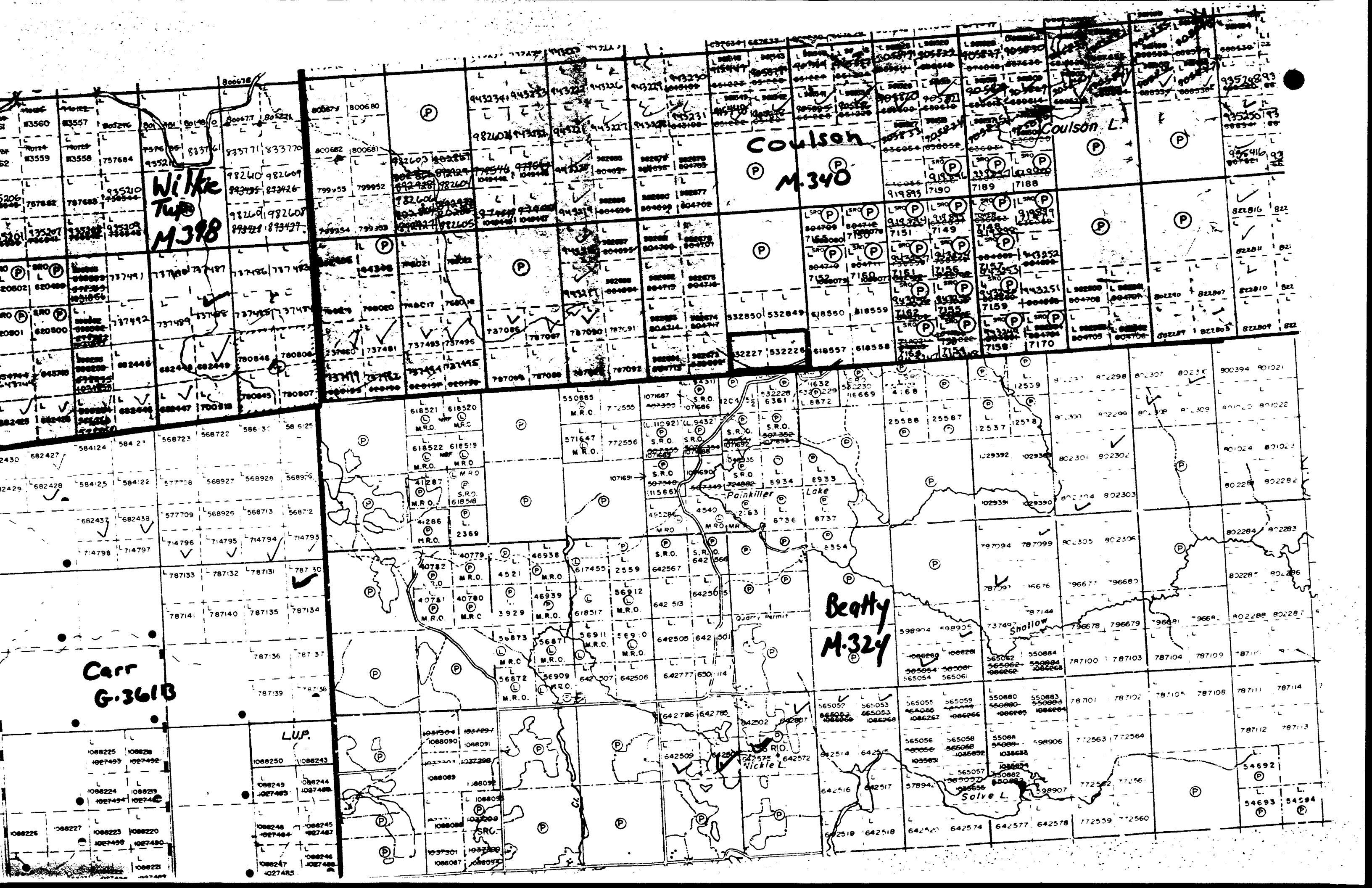





42A09SW0029 42 BEATTY

900

Name and Postal Address of Recorded Holder  
*Beatty, Carr & Wilkie Inc*

**MAUDE LAKE GOLD MINES LTD**  
**300 ELM ST. W., SUDBURY, ONT. P3C1U4**

Summary of Work Performance and Distribution of Credits

Total Work Days Cr. claimed	Mining Claim		Work Days Cr.	Mining Claim		Work Days Cr.	Mining Claim		Work Days Cr.
	Prefix	Number		Prefix	Number		Prefix	Number	
<b>74</b>	L	642508	20						
		642573	20						
		787130	14						
		737488	20						

- For Performance of the following work. (Check one only)
- Manual Work
  - Shaft Sinking Drifting or other Lateral Work.
  - Compressed Air, other Power driven or mechanical equip.
  - Power Stripping
  - Diamond or other Core drilling
  - Land Survey

**RECEIVED**  
13 1989  
PM  
**RECORDED**  
APR 13 1989

All the work was performed on Mining Claim(s): **L. 772555, L. 772557, L. 642579**

Required Information eg: type of equipment, Names, Addresses, etc. (See Table Below)

Drilled by: **McKnight Diamond Drilling, Haibybury, Ont.**  
Equipment: **Longyear "24" Wireline-type Diamond Drill**  
Core Size: **AQ**

ONTARIO GEOLOGICAL SURVEY  
ASSESSMENT FILES OFFICE  
MAY - 9 1989  
**RECEIVED**

	Length
84-02 = 870' W, 500' S of #1 Post of L. 772555	(457')
84-03 = 870' W, 500' S of #1 Post of L. 772555	(447')
84-04 = 695' W, 160' S of #1 Post of L. 772557	(518')
84-05 = 1085' W, 175' S of #1 Post of L. 642579	(450')
<b>TOTAL = 1872'</b>	

Assessment Credits =  $25 \sqrt{1872} = 74.88 \text{ DAYS}$

Core specimens = every 10 feet.

Date of Report: **April 13/89**  
Recorded Holder or Agent (Signature): *[Signature]*

Certification Verifying Report of Work

I hereby certify that I have a personal and intimate knowledge of the facts set forth in the Report of Work annexed hereto, having performed the work or witnessed same during and/or after its completion and the annexed report is true.

Name and Postal Address of Person Certifying  
**R.A. Bennett, RR4, SITE 37 BOX 1 SUDBURY ONTARIO**  
**P3E4M9**  
Date Certified: **Apr 13/89**  
Certified by (Signature): *[Signature]*

Table of Information/Attachments Required by the Mining Recorder

Type of Work	Specific information per type	Other Information (Common to 2 or more types)	Attachments
Manual Work	Nil	Names and addresses of men who performed manual work /operated equipment, together with dates and hours of employment.	Work Sketch: these are required to show the location and extent of work in relation to the nearest claim post.
Shaft Sinking, Drifting or other Lateral Work			
Compressed air, other power driven or mechanical equip.	Type of equipment	Names and addresses of owner or operator together with dates when drilling/stripping done.	
Power Stripping	Type of equipment and amount expended. Note: Proof of actual cost must be submitted within 30 days of recording.		
Diamond or other core drilling	Signed core log showing; footage, diameter of core, number and angles of holes.	Nil	Work Sketch (as above) in duplicate
Land Survey	Name and address of Ontario land surveyer.		Nil

W 8908.142