



BELL - WHITE ANALYTICAL LABORATORIES LTD.

P.O. BOX 187 HAILEYBURY, ONTARIO TEL: (705) 672-3107
POJ 1KO



42A09SW0050 2.8860 BEATTY

010

December 2, 1985

Maude Lake Gold Mines Ltd.,
577 Pearson Street,
R. R. #4, Site 37, Box 1,
Sudbury, Ontario.
P3E 4M9

TOTAL INVOICE AMOUNTS BILLED: \$1028.00

PAID IN FULL.

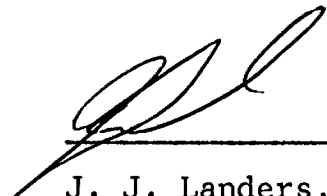

J. J. Landers,
Manager



BELL - WHITE ANALYTICAL LABORATORIES LTD.

P.O. BOX 187 HAILEYBURY, ONTARIO TEL: (705) 672-3107
POJ 1KO

Maude Lake Gold Mines Ltd.
P. O. Box 159
MATHESON, Ontario
POK 1N0

INVOICE N^o 19075

ORDER NO.

DATE September 12, 1985

CERTIFICATE NO.	DATE	DESCRIPTION	AMOUNT
17306	Sept.12/85	85-18 & 19 69 Au @ \$8.50 69 sample preparations @ \$2.50	\$ 586.50 172.50 <hr/> \$ 759.00



BELL - WHITE ANALYTICAL LABORATORIES LTD.

P.O. BOX 187,

HAILEYBURY, ONTARIO

TEL: 672-3107

Certificate of Analysis

NO. 17306

DATE: September 12, 1985

SAMPLE(S) OF: Core (69)

RECEIVED: September, 1985

SAMPLE(S) FROM: Mr. R. A. Bennett
Maude Lake Gold Mines Ltd.

<u>Sample No.</u>	<u>Gold oz.</u>	<u>Sample No.</u>	<u>Gold oz.</u>
G82219	Trace	G82253	0.002*
G82220	0.004	4	Trace
1	Trace	5	Trace
2	0.002*	6	Trace
3	0.002*	7	Trace
4	Trace	8	0.002*
5	0.002*	9	0.002*
6	Trace	G82260	Trace
7	Trace	1	Trace
8	0.004	2	Trace
9	0.002*	3	Trace
G82230	Trace	4	Trace
1	Trace	5	Trace
2	Trace	6	Trace
3	Trace	7	0.002*
4	Trace	8	Trace
5	0.002*	9	Trace
6	Trace	G82270	Trace
7	Trace	1	Trace
8	0.002*	2	Trace
9	Trace	3	Trace
G82240	0.002*	4	Trace
1	0.002*	5	Trace
2	Trace	6	0.002*
3	Trace	7	Trace
4	Trace	8	Trace
5	Trace	9	Trace
6	Trace	G82280	Trace
7	Trace	1	Trace
8	Trace	2	Trace
9	0.002*	3	Trace
G82250	Trace	4	Trace
1	Trace	5	Trace
2	Trace	6	Trace
		7	Trace

↑ 85-18
↓ 85-19

* Estimate

IN ACCORDANCE WITH LONG-ESTABLISHED NORTH AMERICAN CUSTOM, UNLESS IT IS SPECIFICALLY STATED OTHERWISE GOLD AND SILVER VALUES REPORTED ON THESE SHEETS HAVE NOT BEEN ADJUSTED TO COMPENSATE FOR LOSSES AND GAINS INHERENT IN THE FIRE ASSAY PROCESS.

BELL-WHITE ANALYTICAL LABORATORIES LTD.

PER



BELL - WHITE ANALYTICAL LABORATORIES LTD.

P.O. BOX 187 HAILEYBURY, ONTARIO TEL: (705) 672-3107
POJ 1KO

Maude Lake Gold Mines Ltd.
P. O. Box 159
MATHESON, Ontario
POK 1N0

INVOICE N^o 19117

ORDER NO.

DATE September 19, 1985

CERTIFICATE NO.	DATE	DESCRIPTION	AMOUNT
18015	"	63 Au @ \$8.50 2 Au @ \$2.25 63 sample preparations @ \$2.50	\$ 535.50 8.50 157.50 <hr/> \$ 701.50
		29 Au + Prep @ 11.00	<hr/> \$ 319.00



BELL - WHITE ANALYTICAL LABORATORIES LTD.

P.O. BOX 187,

HAILEYBURY, ONTARIO

TEL: 672-3107

Certificate of Analysis

NO. 18015

DATE: September 19, 1985

SAMPLE(S) OF: Core (63)

RECEIVED: September, 1985

SAMPLE(S) FROM: Mr. R. A. Bennett
Maude Lake Gold Mines Ltd.

85-19

<u>Sample No.</u>	<u>Gold oz.</u>
G82288	Trace
9	0.002*
G82290	Trace
1	0.032
2	Trace
3	Trace
4	Trace
5	Trace
6	Trace
7	Trace
8	Trace
9	Trace
G82300	Trace
1	Trace
2	Trace
3	Trace
4	Trace
5	Trace
6	Trace
7	Trace
8	Trace
9	Trace
G82310	0.006
1	Trace
2	Trace
3	Trace
4	Trace
5	Trace
6	Trace
7	Trace
8	Trace

* Estimate

IN ACCORDANCE WITH LONG-ESTABLISHED NORTH AMERICAN CUSTOM, UNLESS IT IS SPECIFICALLY STATED OTHERWISE GOLD AND SILVER VALUES REPORTED ON THESE SHEETS HAVE NOT BEEN ADJUSTED TO COMPENSATE FOR LOSSES AND GAINS INHERENT IN THE FIRE ASSAY PROCESS.

BELL-WHITE ANALYTICAL LABORATORIES LTD.

PER 

MAUDE LAKE GOLD MINES LIMITED

1985 BOREHOLE SUMMARY 85-19 SALVE

HOLE # 85-19 CO-OR 71-30W/2-40S DIP -58N LENGTH 866 ft.

FOOTAGE ft	GEOLOGY	CA	SAMPLE #	ASSAY troy opt	GRADE opt	Other
0-120	Overburden, Start of Core					DIP TESTS
120-146	Basalt-grn, pillowed, amygd. cv	35				135'-59
146-148.5	Quartz vn + carb, barren	20	82268	tr		200'-58
148.5-191	Basalt- pillowed + few q-c vnls					400'-58
191-193	Basalt; q-c rich vn	10	82269	tr		600'-57
193-196	Basalt- as before					800'-58
196-199	Basalt; q-c rich vn	20	82270	tr		
199-201.8	Basalt- as above		82271	tr		
201.8-258	Basalt- pill'wd + few q-c vnls					
258-263	Basalt-gy, silicified & altd with several q-c vnls @35	35	82272	tr		
263-266	Quartz Vein - white + minor carb & angular silic'd bsit clasts	60	82273	tr		
266-269	Quartz Vein- as above	60	82274	tr		
269-272	Quartz Vein- as above	60	82275	tr		
272-275	Quartz Vein with py, cpy	60	82276	0.002	Chalcopyrite	
275-292	Basalt- grn, mass, few q-c vnls	50				
292-296.5	Basalt-silif. & altd; q-c vns	40	82277	tr		
296.5-305	Basalt- pill'wd, as before					
305-306.2	Quartz Vein - minor py	60	82278	tr		
306.2-316	Basalt- pill'wd, few carb vns					
316-318	Quartz Vein - minor py; LC @	78	82279	tr		
318-322	Feldspar Porphyry Dyke, mass.	78				
322-326	Basalt-pill'wd; silif'd due to dyke		82280	tr		
326-346	Basalt- grn, pill'wd, few calc vns					
346-353	Basalt- grey, carb altd, foln @	60	82281	tr		
353-358	Basalt- as above		82282	tr		
358-382	Basalt- green, fresh, pillowed					
382-385	Basalt- as above + q-c vnls		82283	tr		
385-394.5	Basalt- fresh, pill'wd					
394.5-396	Basalt- as above + q-c vnls	40	82284	tr		
396-448	Basalt- as before					
448-450	Basalt- as above + q-c vnls		82285	tr		
450-479	Basalt- fresh, pillowed; LC @	42				
479-557	Basalt- green, mass, occ calcite- filled fractures					
557-558.5	Basalt- as above + fol'd + q-c	32	82286	tr		
558.5-600	Basalt- as before					
600-685	Basalt- green, mass, calcic					
685-686	Basalt- as above + 4" qtz vn + tourm		82287	tr	Tourmaline	
686-726	Basalt-as before, gradational lower ct					
726-736	Basalt-wkly altd & re-xlized, Calcic					

BOREHOLE 85-19 ..continued Page 2.

736-743	Basalt-hgly altd, re-xilized, foln- 40	82288	tr
743-747	Basalt- as above	82289	0.002
747-752	Basalt- as above	82290	tr
752-756	Basalt-as above	82291	0.032
756-760	Basalt- as above; LC 62	82292	tr
760-764	Aplite Dyke -aphanitic, gy, mass, with several q-c vnits & frac fills	82293	tr
764-767.5	Aplite Dyke Sharp lower ct @ 50	82301	tr
767.5-769	Quartz Veins - 2-2" blue qtz & few white q-c vnits, sheared	82294	tr
769-773	Basalt- Buff-grey, moderately fractured & altd + several calcite fracture fills. Strong foln @ 30	82295	tr
773-777	Basalt- as above	82296	tr
777-783	Basalt- as above	82297	tr
783-786	Basalt-as above + q-c vn, py 25	82298	tr
786-791	Basalt-as above	82299	tr
791-795	Basalt-as above + 3-2" q-c vnits 25	82300	tr
795-799	Basalt-as above + 1' vn, py 21	82302	tr
799-804	Basalt-as before; less altd	82303	tr
804-809	Basalt-as above	82304	tr
809-811	Basalt-as above	82305	tr
811-816	Basalt- green, close-packed pillows with several q-c fract. fillings @ 30	82306	tr
816-821	Basalt- as above	82307	tr
821-826	Basalt- as above	82308	tr
826-831	Basalt- as above	82309	tr
831-836	Basalt- as above + q-c vnit	82310	0.006
836-841	Basalt- as above	82311	tr
841-846	Basalt- as above	82312	tr
846-851	Basalt- as above	82313	tr
851-856	Basalt- as above	82314	tr
856-861	Basalt- as above	82315	tr
861-866	Basalt- as above	82316	tr

866 - FOOT OF HOLE

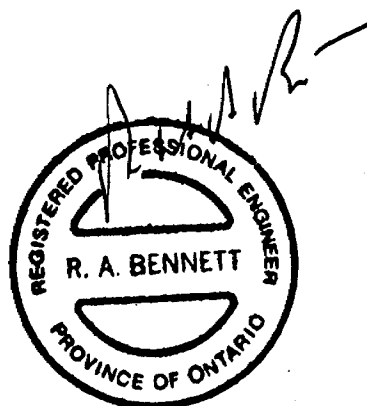

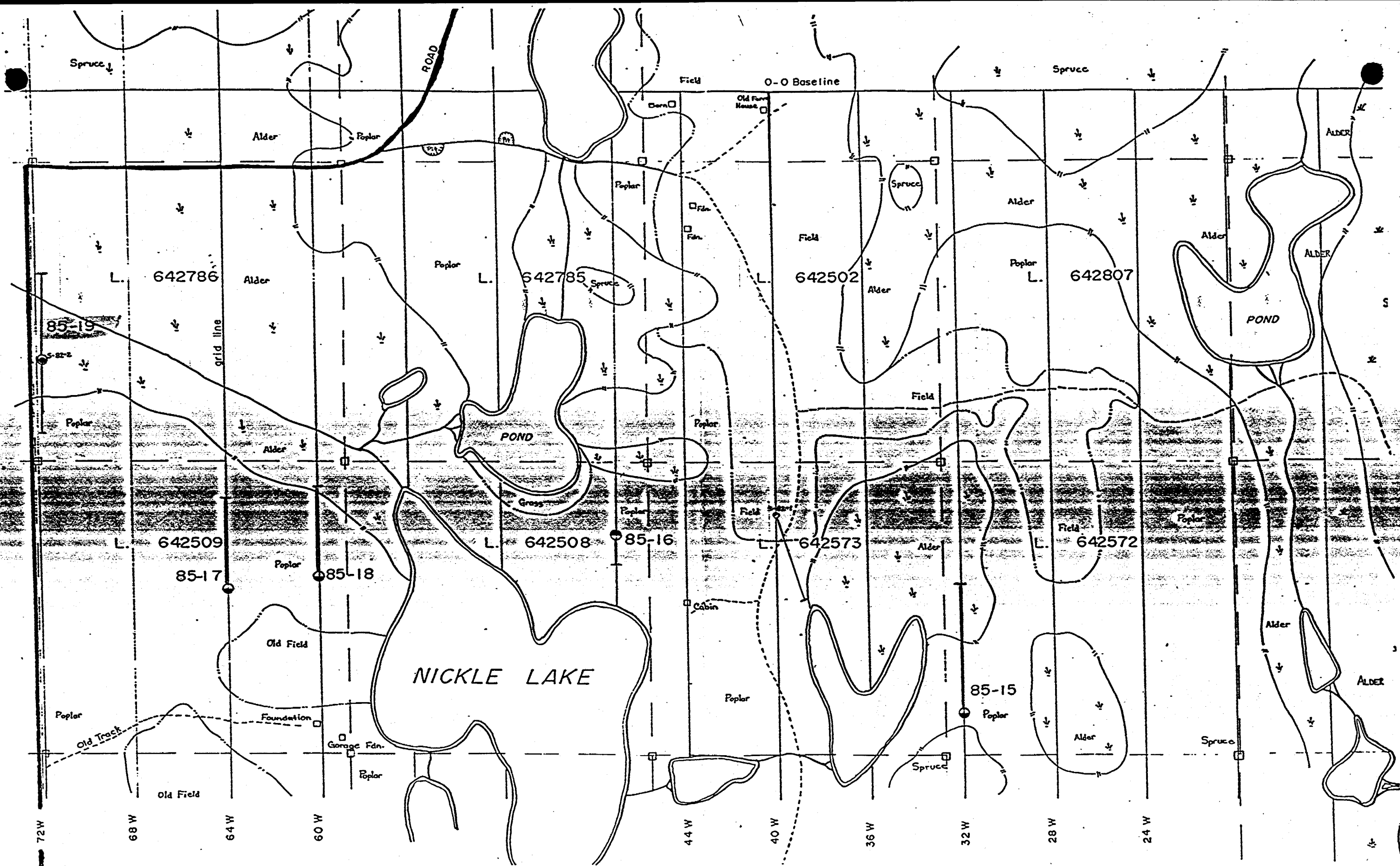

MAUDE LAKE GOLD MINES LTD.

Salve Group - Beatty Twp.

1985 BOREHOLE LOCATION PLAN

1" = 400ft.

MAUDE LAKE GOLD MINES LIMITED

1985 BOREHOLE SUMMARY 85-18 SALVE

HOLE # 85-18 CO-OR 60+00W, 22+00S DIP -58N LENGTH 694 ft.

FOOTAGE ft	GEOLOGY	CA	SAMPLE #	ASSAY troy opt	GRADE opt	Other
0-109	Overburden, Start of Core					DIP TESTS
109-119	Basalt- gy-grn, calcic, pillowed	30				110'-58
119-128	Basalt- gy, amygd, fract'd					200'-56
128-132	Basalt- buff-grn, calcic, foln e altd, several narrow q-c vnits	45				400'-51 696'-51
132-137	Basalt- as above		82219	tr		
137-141	Basalt- oxidization near fract	42	82220	0.004		
141-146	Basalt- as before		82221	tr		
146-151	Basalt- as above		82222	0.002		
151-156	Basalt- as above		82223	0.002		
156-161	Basalt- as above		82224	tr		
161-166	Basalt- as above		82225	0.002		
166-171	Basalt- as above		82226	tr		
171-176	Basalt- as above		82227	tr		
176-181	Basalt- as above		82228	0.004		
181-186	Basalt- as above		82229	0.002		
186-191	Basalt- as above		82230	tr		
191-196	Basalt- as above		82231	tr		
196-201	Basalt- as above		82232	tr		
201-206	Basalt- becomes gy, silicified fract'd, & mottled; still see amygd occasional q-c vnit, few pillows	45	82233	tr		
206-211	Basalt- as above		82234	tr		
211-216	Basalt- as above		82235	0.002		
216-221	Basalt- as above		82236	tr		
221-226	Basalt- as above		82237	tr		
226-231	Basalt- as above		82238	0.002		
231-236	Basalt- as above		82239	tr		
236-241	Basalt- as above		82240	0.002		
241-246	Basalt- Buff coloured, Fe-carb'd pillowed, few qtz vnits & oxid'n		82241	0.002		
246-251	Basalt- Buff as above		82242	tr		
251-256	Basalt- Buff as above		82243	tr		
256-261	Basalt- Buff as above		82244	tr		
261-266	Basalt- Buff + 1.5' qtz vn	63	82245	tr		
266-271	Basalt- more massive, Buff altn		82246	tr		
271-276	Basalt- massive		82247	tr		
276-282	Basalt- massive		82248	tr		
282-287.3	Basalt- massive + 6" mud zone		82249	0.002		
287.3-300.8	Basalt- pillowed, green, calcic					
300.8-303.6	Dyke - felds porphyritic	85				

BOREHOLE 85-18 ..continued Page 2.

303.6-456	Basalt-green, rather fresh, pillowed & amygd'l, calcic			
456-461	Basalt-Buff coloured, stgly altd but 'dry'. Few qtz vnits, foln @ 60	82250		tr
461-466	Basalt- as above	82251		tr
466-471	Basalt- as above	82252		tr
471-476	Basalt- as above	82253		0.002
476-481	Basalt- as above	82254		tr
481-486	Basalt- as above	82255		tr
486-491	Basalt- as above	82256		tr
491-496	Basalt- as above	82257		tr
496-501	Basalt- as above	82258		0.002
501-506	Basalt- as above	82259		0.002
506-511	Basalt- as above	82260		tr
511-516	Basalt- as above	82261		tr
516-521.4	Basalt- as above	82262		tr
521.4-577	Basalt-grades to fresh, green pillow lava + few q-c vnits. Calcic.			
577-579	Basalt-as above + qtz-calc vn 75	82263		tr
579-646	Basalt- as before			
646-670	Basalt- massive, green, med. grained			
670-671	Basalt- as above + q-c foln. 50	82264		tr
671-678	Basalt- as before			
678-679	Basalt- mass + q-c vns 80	82265		tr
679-687	Basalt- massive			
687-689	Basalt- as above + q-c vn-bx 50	82266		tr
689-693	Basalt- massive			
693-694	Basalt- as above + q-c vnlt 30	82267		0.002

694 - FOOT OF HOLE



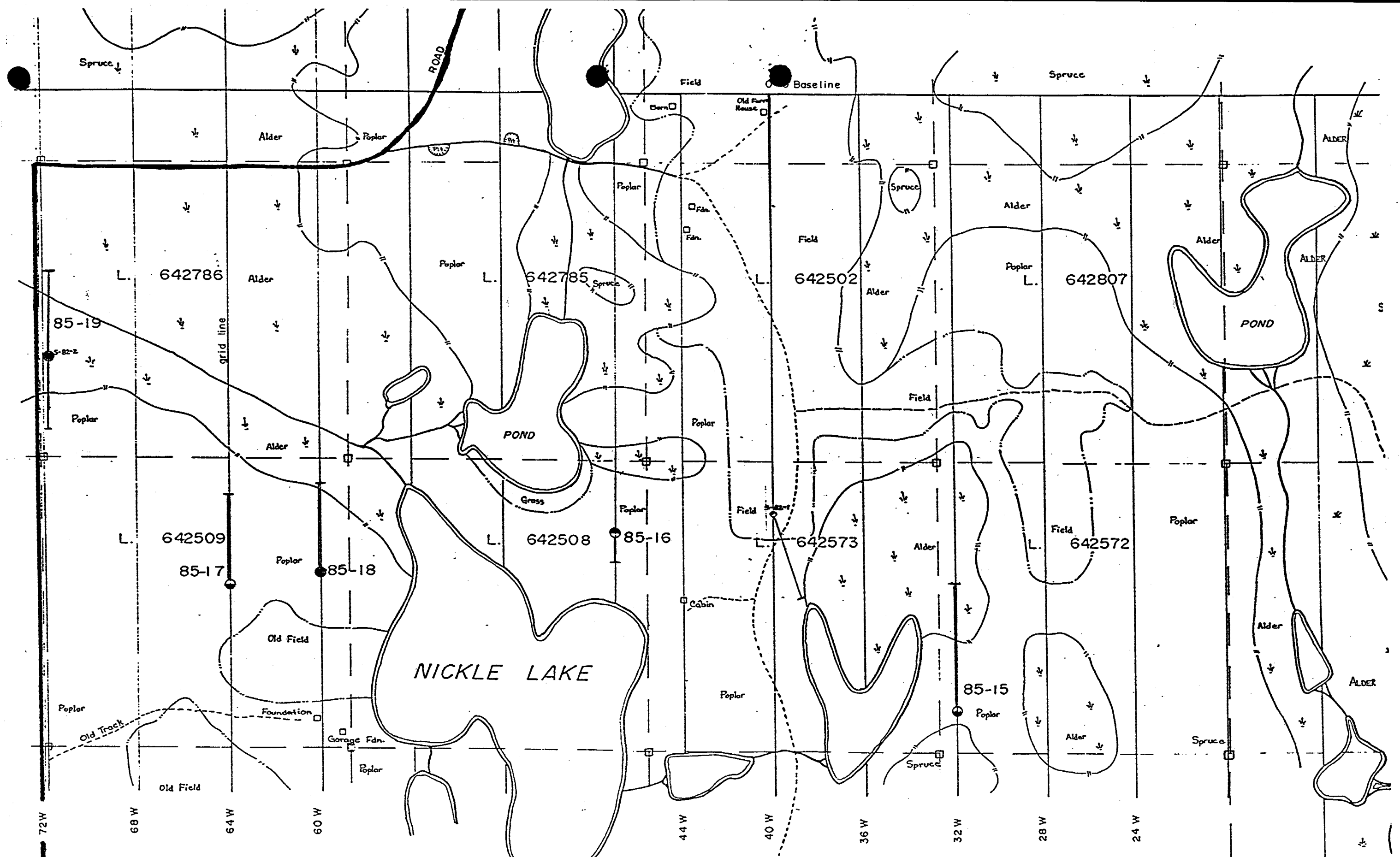

Salve Group - Beatty Twp.

1985 BOREHOLE LOCATION PLAN

1" = 400ft.

MAUDE LAKE GOLD MINES LTD.

Coulson Twp. (M.340)

NOTES

400' Surface Rights Reservation along the shores of all lakes and rivers.

Carr Twp. (M.335)

Munro Twp. (M.376)

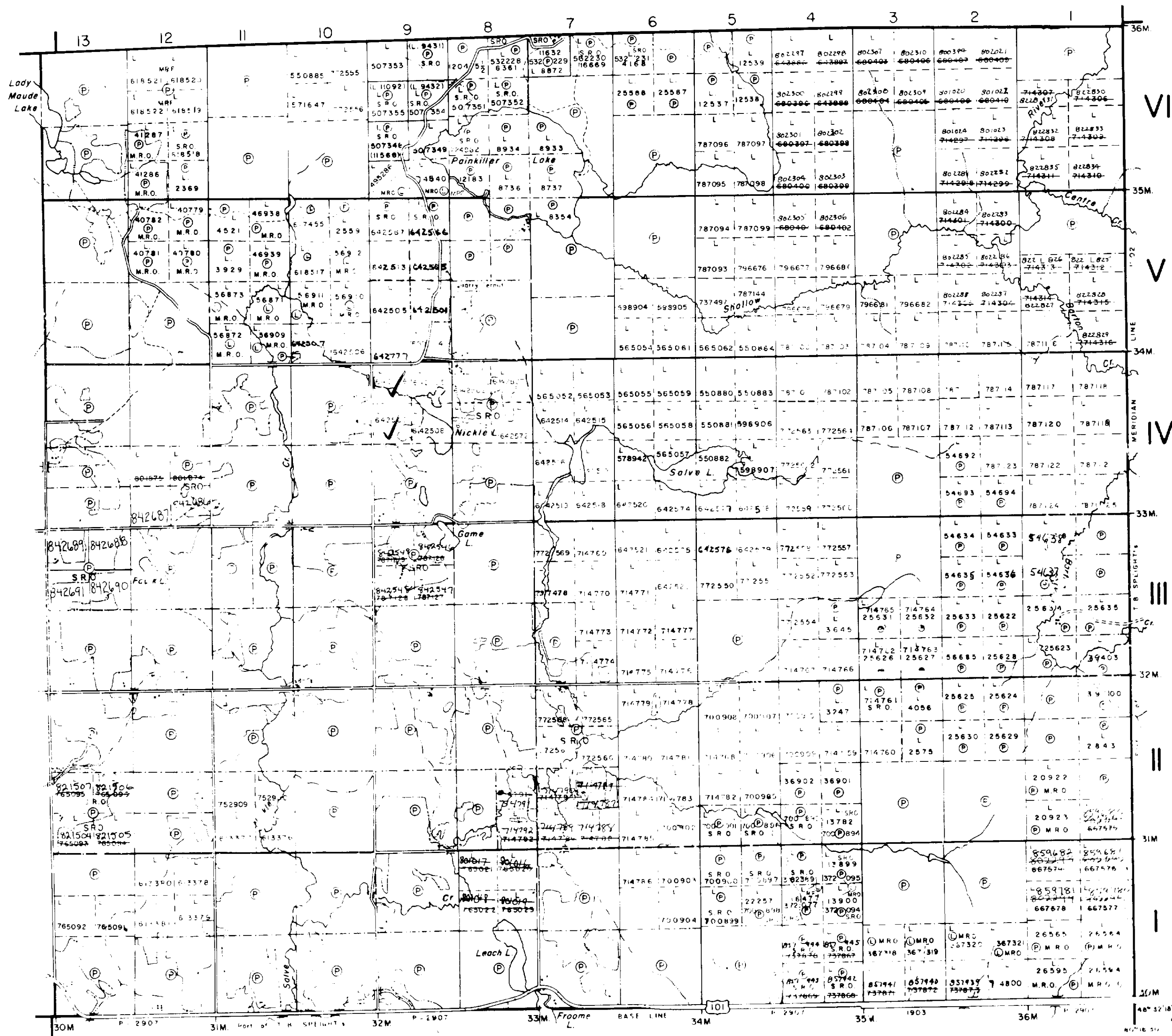

LEGEND

- PATENTED LAND
- PATENTED FOR SURFACE RIGHTS ONLY
- LEASE
- IN OCCUPATION
- CROWN LAND SALE
- PATENTED LAND
- CANCELLED
- MINING RIGHTS ONLY
- SURFACE RIGHTS ONLY
- HIGHWAY & ROUTE No.
- ROADS
- TRAILS
- RAILWAYS
- POWER LINES
- MARSH OR MUSKEG
- MINES

* used only with summit resort locations or when space is limited

TOWNSHIP OF *Jan. 7/80*

BEATTY

DISTRICT OF COCHRANE

LARDER LAKE MINING DIVISION

SCALE 1 INCH = 40 CHAINS (1/2 MILE)

DR *kk* PLAN No. **M.324**

DATE *Oct 7/81* ONTARIO

MINISTRY OF NATURAL RESOURCES

Hislop Twp. (M.355)

