

DIAMOND DRILL



42A09SW0075 28 BEATTY

010

TOWNSHIP: Beatty

REPORT No.: 28

WORK PERFORMED BY: Maude Lake Gold Mines Ltd.

<u>CLAIM No.</u>	<u>HOLE No.</u>	<u>FOOTAGE</u>	<u>DATE</u>	<u>NOTE</u>
L 772557	SX84-04	518	Sept/84	(1)
L 642579	SX84-05	450	Sept/84	(1)

NOTES: (1) #13-85

MAUDE LAKE GOLD MINES LTD.

BOREHOLE LOG

HOLE# SX84-04

SURF

CO-OR: 77E, 1S AZ: 20 DIP: 40 ELEV: SURFACE LGTH: 518 ft LOGGER: RAB

TWP: BEATTY CLAIM: L772557 START: 09/6/84 FINISH: 09/25/84

DIP TESTS: e300 FT - 39 DEGREES, e518 FT - 37 DEGREES

DRILLED BY: McKNIGHT DRILLING CORE:AQ COMMENTS: SALVE GROUP

FTAGE	DESCRIPTION	SAMPLE	FTAGE	ASSAY
0	collar			
10	casing. 3 feet overburden			
32	RHYOLITE TUFF, f-mg, grey, rounded qtz grains & anhedral feldspar; several white Rhy fragments, flow banded matrix e50 deg. Fine dissem py & few narrow qtz-carb fracture-fillings e 40 deg.			
35	RHYOLITE TUFF as above but altd-buff colour			
56.5	RHY. TUFF as e 32', 2" qv at 43.5' e 35 deg.			
62.6	RHY. TUFF becoming more dacitic and 're-worked' or laharc. Bedding/banding contacts at 50 deg.			
86.3	RHY. TUFF as e 32 ft with 1' white qtz veins at 76 ft e50 deg and 81 ft e40 deg. Sharp LC e 65.			
117.4	DACITIC TUFF- LAHAR pale, grey-buff, well banded at 50 deg (Tops N), occasional rhy. pyroclast. Black, graphitic material; few narrow qtz vnits, 1% pyrite throughout. A 2" graphite bed at 112 ft e 60 deg - CONDUCTOR. Sharp lower ct with 40% graphite in basaltic flow top breccia.			
138.0	BASALT-ANDESITE lg, pale green, rather massive, mafic lava. Few calcite vnits e 60 deg.			
155.0	BASALT altered, buff-green coloured with abundant carbonate-filled fractures (resmbles autobx).			
166.0	BASALT as e 138 ft with marked flow top breccia at lower ct. 3" lamp dyke at 158.5 ft e 80 deg.			
192.0	VARIOLITIC BASALT f-cg varioles(20-60% of rock) in basaltic matrix. 178-181 ft has graphitic matrix to varioles. At 190 ft - .3' qtz vein + cpy and cpy fracture fill. Lower ct is chlorite mud e 45 deg.			
200.6	BASALT non-variolitic, locally brecciated.			
250.8	VARIOLITC BASALT as before, quite massive, dark green, sharp LC e 45 deg. Few talcose			

P. N. R.

shear zones.

- 309.0 BASALT-KOMATIITE fg-mg, chl-talc rich, mottled. At 286-288 ft - 1% pyrite and minor cpy.
- 325.0 VARIOLITIC BASALT as at 250.8 ft.
- 367.5 BASALT-KOMATIITE(?) as at 309 ft.
- 397.0 BASALT-ANDESITE massive, green, fg. At 385-388ft - white carb + qtz vein @ 23 deg. Several narrow carb fracture-fills @ 30-40 deg. Sharp lower contact at 40 degrees.
- 420.1 VARIOLITIC BASALT 60% varioles oriented @ 45.
- 435.2 PILLOW BASALT fg, green, massive .
- 482.9 VARIOLITIC BASALT as before, grnl cts.
- 493 BASALT green, massive flow.
- 518 VARILOITC BASALT as before. Oriented @ 35 deg.

FOOT OF HOLE

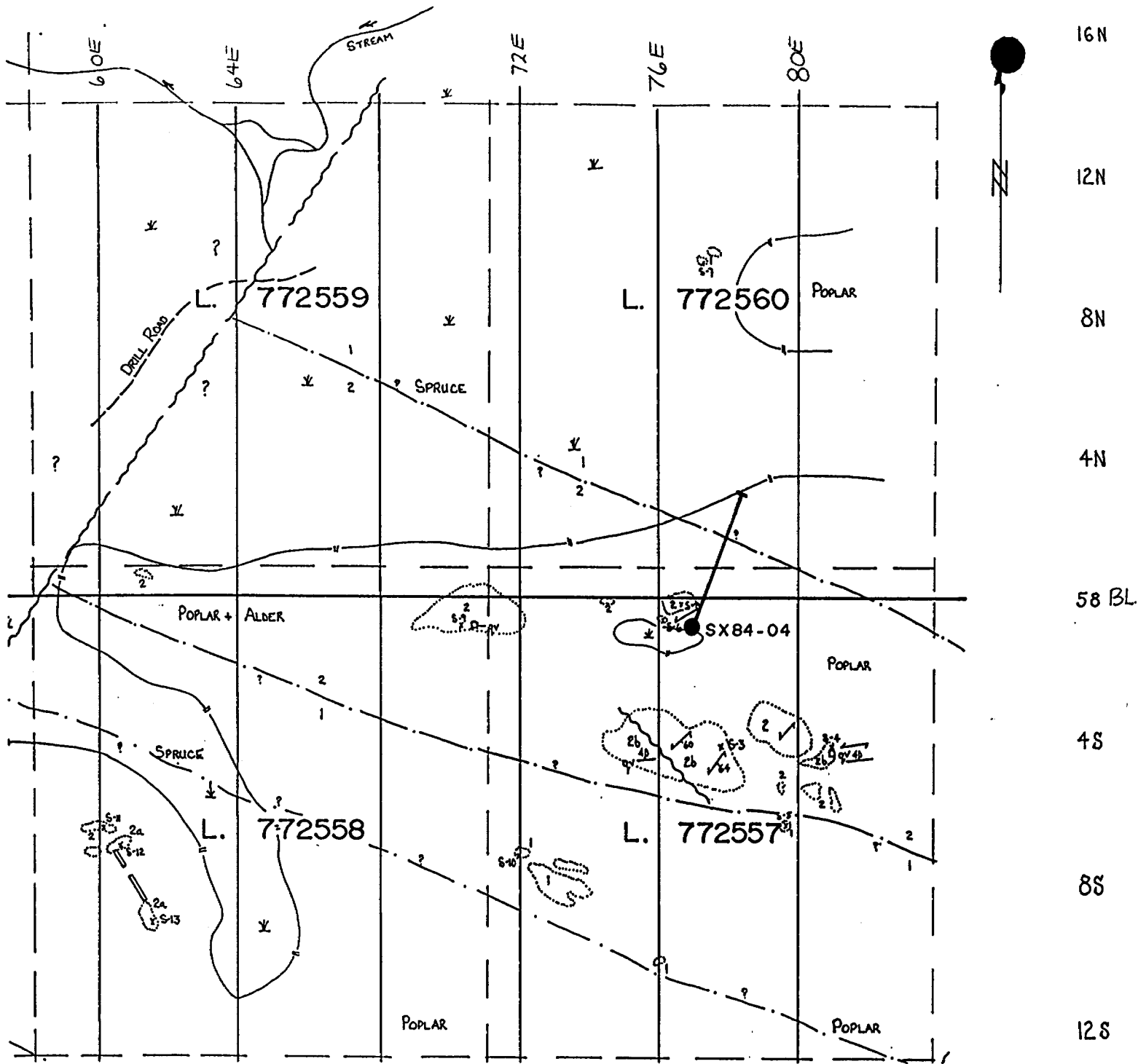

LOCATION PLAN

2 AR

MAUDE LAKE GOLD MINES LTD

SALVE GROUP

Beatty Township

Borehole SX84-04

1" = 400ft

Jan 85

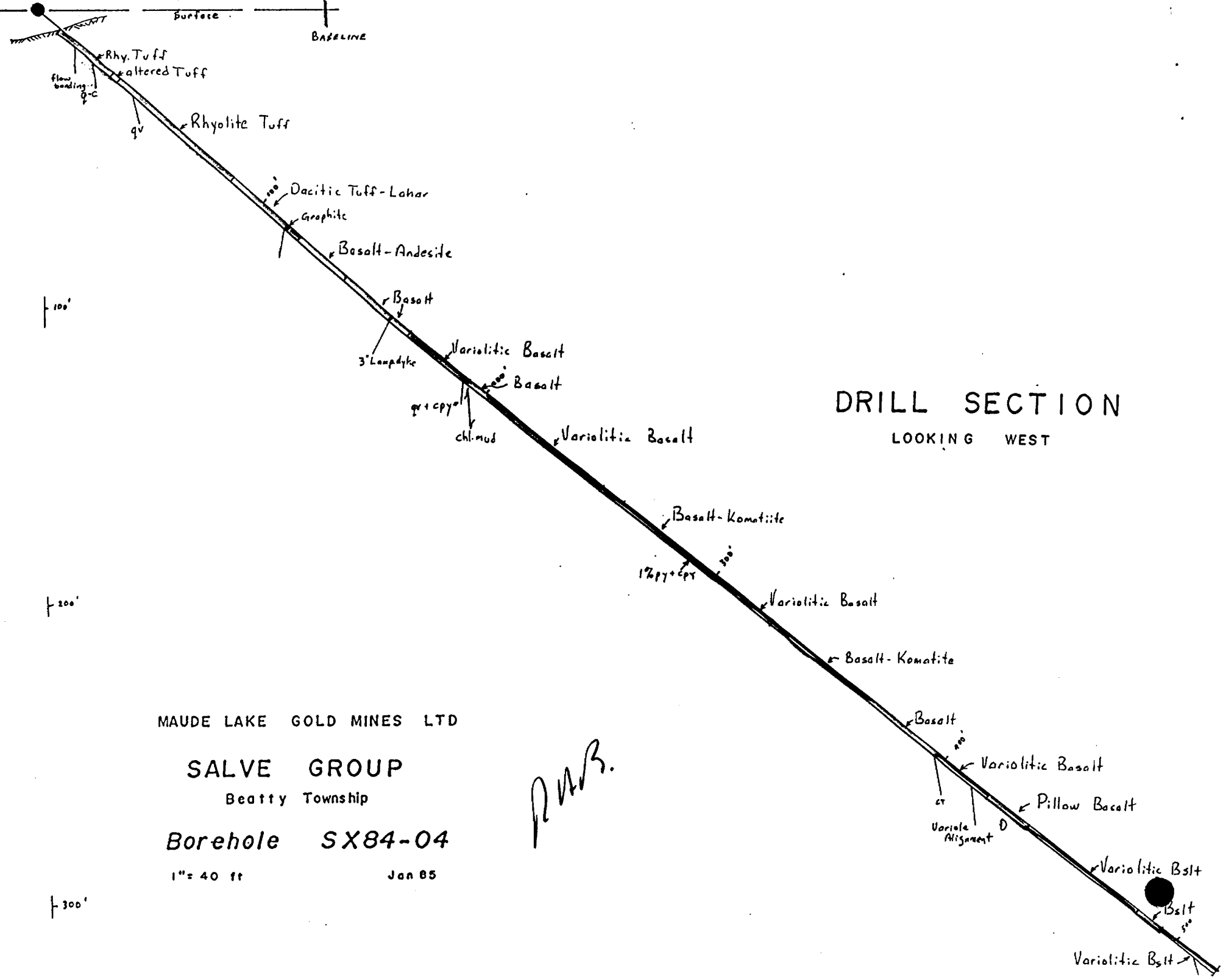

DRILL SECTION
LOOKING WEST

MAUDE LAKE GOLD MINES LTD

SALVE GROUP

Beatty Township

Borehole SX84-04

1" = 40 ft

Jan 85

P.A.B.

MAUDE LAKE GOLD MINES LTD.

BOREHOLE LOG

HOLE# SX84-05

CO-OR: 48E, 1S AZ: 180 DIP: 45 ELEV: SURFACE LGTH: 450FT LOGGER: RAB
 TWP: BEATTY CLAIM: L642579 START: 09/26/84 FINISH: 10/13/84
 DIP TESTS: @ 10 FT - 45 DEGREES, @ 200 FT - 43 DEGREES, @ 450 ft - 41 DEGREES
 DRILLED BY: McKNIGHT DRILLING CORE: AQ COMMENTS: SALVE GROUP

FTAGE	DESCRIPTION	SAMPLE NUMBER	FTAGE from/to	ASSAY opt Au
0	collar			
14	casing, 10 feet of overburden.			
23.8	DACITE TUFF vfg, grey, weakly carbonatized, with occasional clasts to 1/2 inch. Few chl slips @ 49 deg and chl. spots(amygdules?), scarce speck of pyrite.			
52.8	DACITE flow - f-mg, grey-buff, rather massive to locally brecciated with occ. chl amygd. LC @ 34 deg.			
59.8	ANDESITE-BASALT f-mg, green-grey, massive flow with sub-diabasic texture. Sharp LC @ 50 degrees.			
69.7	RHYOLITE aphanitic to vfg, buff colour, masive, occ. qtz-carb vnit @ 40-70 deg; locally spherulitic. Sharp lower ct @ 47 degrees.			
77.7	ANDESITE-BASALT as at 59.8 ft. Few chl slips at 20 degrees. Contact altn zones gradational.			
102.0	RHYODACITE Flow aphanitic to fg, grey, massive with occasional white qtz vnit @ 30 deg, some chl spots, gradational LC to buff coloured.			
147.6	RHYOLITE TUFF vfg, grey-buff, with rounded qtz eyes & angular feldspar grains, few angular rhy. clasts, several 1/16 inch qtz vnits @ 40-60. LC-46.			
150.8	RHYOLITE TUFF as above but medium to coarse grained phase. Contacts @ 35 degrees.			
161.0	RHYOLITE TUFF as at 147.6 ft. LC at 57 degrees.			
182.7	ANDESITE BRECCIA - possibly silicified basalt (due to rhy), grey to dark grey, chlorite slips and foliation at 32 deg. Breccia matrix is black graphitic cherty material. There are a few pillow rindes preserved.			

RAB

- 188.7 QUARTZ VEIN barren white qtz with up to 30% chlorite as fracture-fill. Cts @ 70 deg.
- 237.4 BASALT PILLOW LAVA fg, green, massive, few chl fractures @ 30-50 deg and qtz-carb vnits @ 40-50 degrees. Few specks pyrite.
- 245.0 ANDESITE BRECCIA as at 182.7 ft. Sharp lower contact at 65 degrees.
- 247.0 GRAPHITE black, vfg, hard, graphitic chert bed - CONDUCTOR.
- 287.1 RHYODACITE BRECCIA fg-mg, grey, qtz and feldspar grains (may be a tuff), with mafic matrix containing up to 4% disseminated pyrite. Becomes more massive down hole.
- 306.0 RHYODACITE FLOW . As above but massive.
- 444.6 FLOW BANDED RHYOLITE f-mg, grey, very hard and siliceous, good flow bands at 5 to 85 degrees (mostly @ 50-70 deg), several brecciated to laharic-looking sections at 309-311 ft, 314-322 ft, 326-328 ft, and 351-54.6 ft. Occasional disseminated py and blebs of pyrite. Several 1-2" qtz veins @ 374', 442', 443', 444'.
- 445.5 QUARTZ VEIN barren, milky-white vein with chlorite fracture fill. Contacts a 75.
- 450 FLOW BANDED RHYOLITE as above. 1 inch qtz vein at 446.2 ft @ 70 deg.

Handwritten signature/initials

FOOT OF HOLE

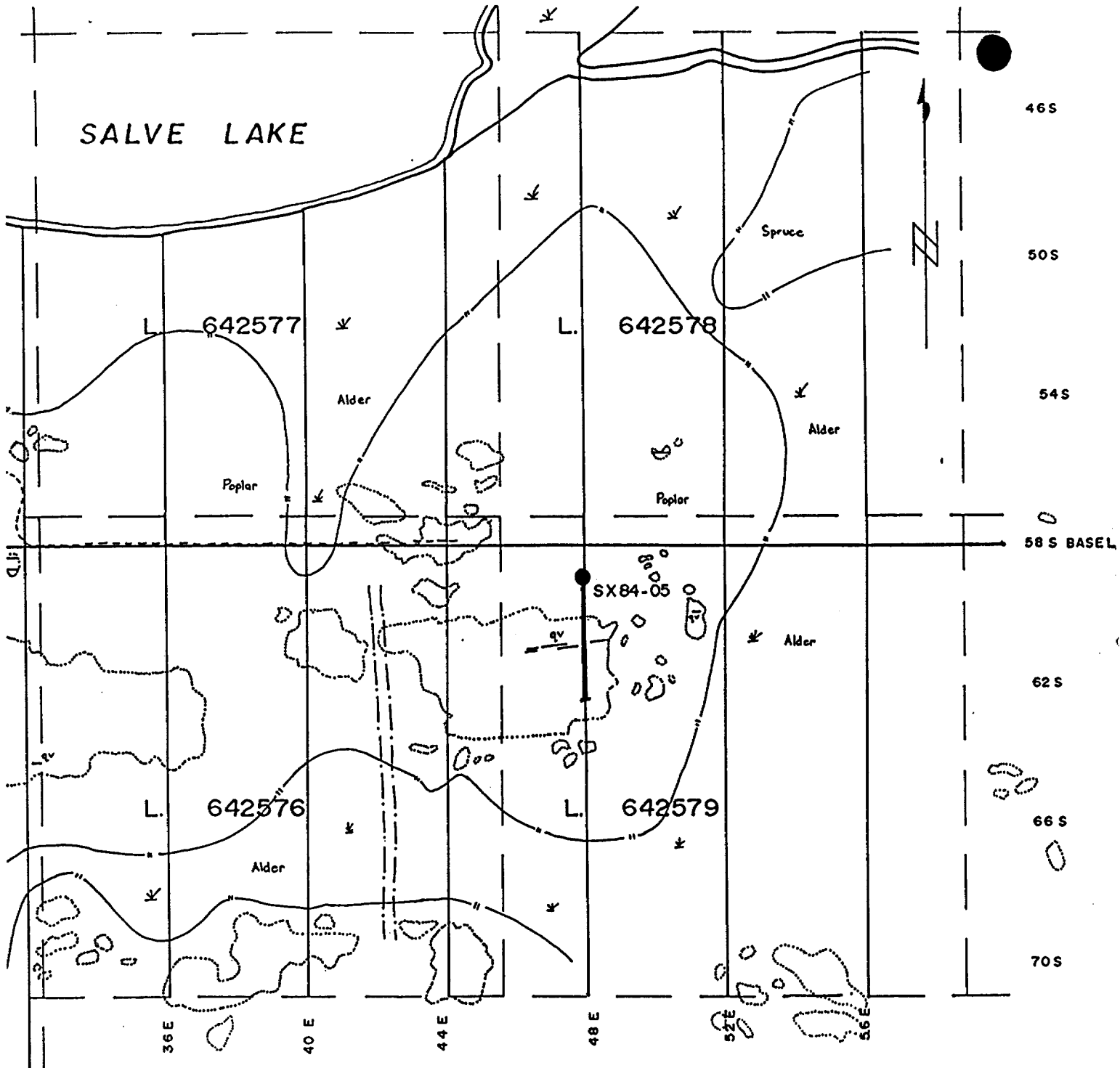

LOCATION PLAN

MAUDE LAKE GOLD MINES LTD

SALVE GROUP

Beatty Township

Borehole SX84-05

1" = 400ft

Jan 85

DRILL SECTION

LOOKING WEST

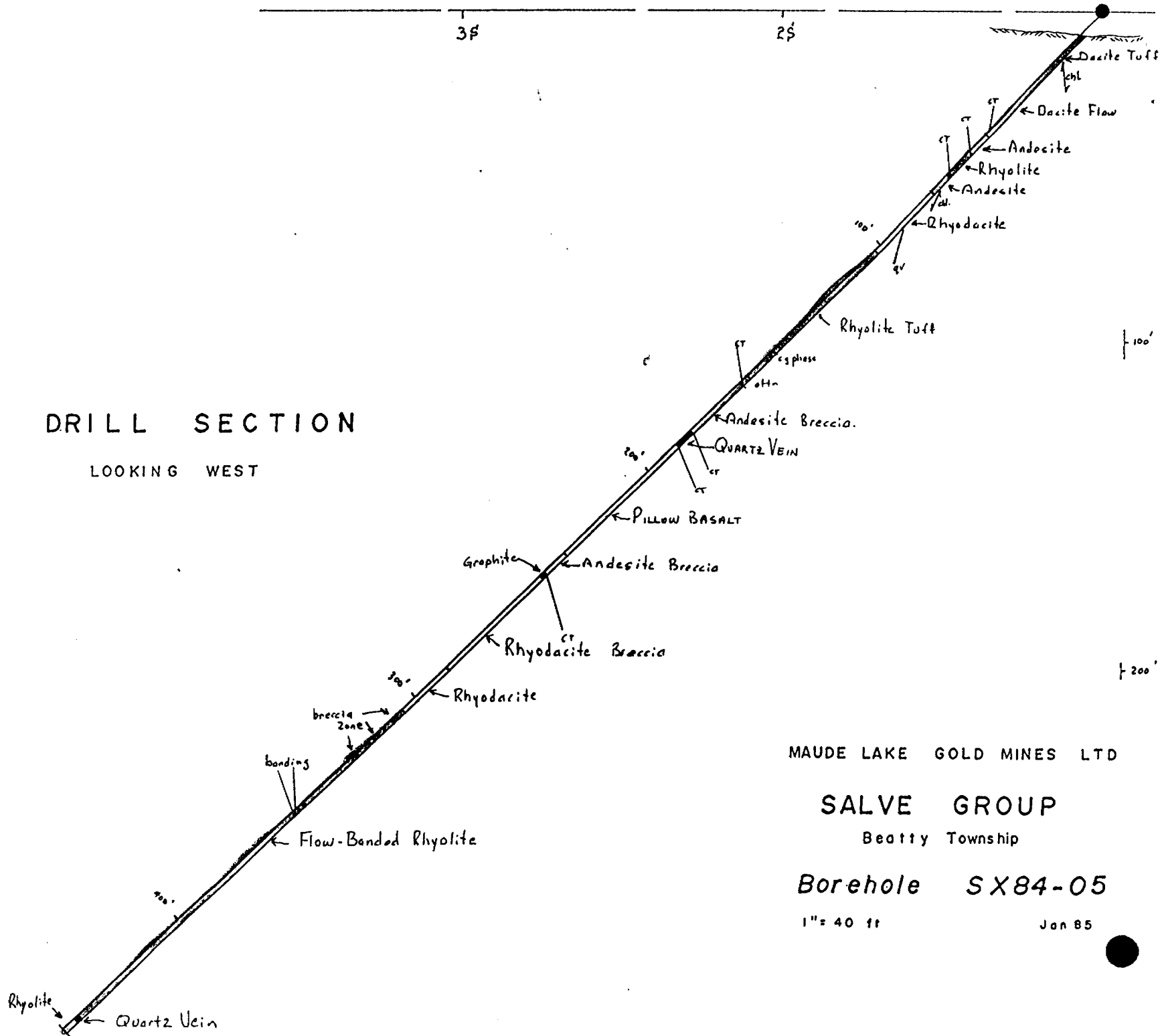

MAUDE LAKE GOLD MINES LTD

SALVE GROUP

Beatty Township

Borehole SX84-05

1" = 40 ft

Jan 85

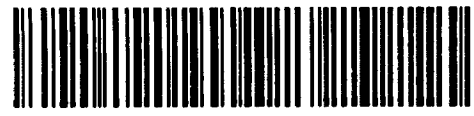

#13

Name and Postal Address of Recorded Holder
MAUDE LAKE GOLD MINES LIMIT.

42A09SW0075 28 BEATTY

900

300 Elm Street West, Sudbury, Ontario, P3C1V4

Summary of Work Performance and Distribution of Credits

Total Work Days Cr. claimed 968	Mining Claim			Mining Claim			Mining Claim		
	Prefix	Number	Work Days Cr.	Prefix	Number	Work Days Cr.	Prefix	Number	Work Days Cr.
for Performance of the following work. (Check one only) <input type="checkbox"/> Manual Work <input type="checkbox"/> Shaft Sinking Drifting or other Lateral Work. <input type="checkbox"/> Compressed Air, other Power driven or mechanical equip. <input type="checkbox"/> Power Stripping <input checked="" type="checkbox"/> Diamond or other Core drilling <input type="checkbox"/> Land Survey	L	550880	40	L	565059	40	L	772562	20
		550881	40		565061	40		772563	20
		550882	50		565062	40		772564	20
		550883	40		-578942	40		772564	20
		550884	40		598904	40			
		565052	40		598905	33			
		565053	40		598906	40			
		565054	40		598907	45			
		565055	40		642574	20		128 1995	
		565056	40		642577	20			
		565057	50		642578	35			
		565058	40		772561	20			

ONTARIO GEOLOGICAL SURVEY
ASSESSMENT FILES
RESEARCH OFFICE
128 1995
RECEIVED

All the work was performed on Mining Claim(s): L.642579, L.772557

Required Information eg: type of equipment, Names, Addresses, etc. (See Table Below)

Drilled by: McKnight Diamond Drilling, Haileybury, Ontario, POJ 1K0
 Equipment: Longyear "Super 24" Wireline-type diamond drill
 Core Size: AQ (1 & 1/16th inches in diameter)-
 BOREHOLE SX84-04 drilled -40° at 20° Az at 77E, 1S in Claim L.772557
 BOREHOLE SX84-05' drilled -45° South at 48E, 1S in claim L.642579.
 Both holes drilled on Maude Lake Gold Mines' "SALVE GROUP" of claims.
 A claim map is attached.
 LOCATION PLAN, BOREHOLE LOG, and DRILL SECTION attached for each drill hole

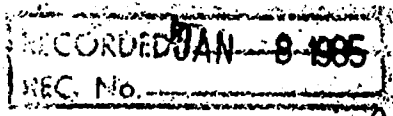
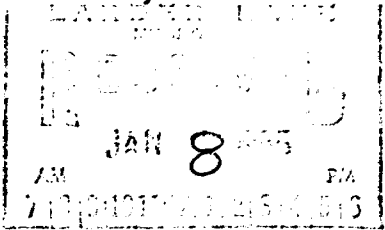

Date of Report: Jan 8, 1985
 Recorded Holder or Agent (Signature): [Signature]

Certification Verifying Report of Work

I hereby certify that I have a personal and intimate knowledge of the facts set forth in the Report of Work annexed hereto, having performed the work or witnessed same during and/or after its completion and the annexed report is true.

Name and Postal Address of Person Certifying
Robert A. Bennett, MSc., PEng. Consulting Geologist, RR 4, Site 37, Box 1,
Sudbury, Ontario, P3E 4M9

Date Certified: Jan 8, 1985
 Certified by (Signature): [Signature]

Table of Information/Attachments Required by the Mining Recorder

Type of Work	Specific information per type	Other information (Common to 2 or more types)	Attachments
Manual Work	Nil	Names and addresses of men who performed manual work/operated equipment, together with dates and hours of employment.	Work Sketch: these are required to show the location and extent of work in relation to the nearest claim post.
Shaft Sinking, Drifting or other Lateral Work			
Compressed air, other power driven or mechanical equip.			
Power Stripping	Type of equipment and amount expended. Note: Proof of actual cost must be submitted within 30 days of recording.	Names and addresses of owner or operator together with dates when drilling/stripping done.	Work Sketch (as above) in duplicate
Diamond or other core drilling	Signed core log showing; footage, diameter, of core, number and angles of holes.		
Land Survey	Name and address of Ontario land surveyor.	Nil	Nil

