

42A09SW0138 63.5819 CARR

010

DIAMOND DRILLING REPORT

CARR TWP PROJECTD.D.H. 90-2

63.5819

Location: Claim L979580; NW 1/4 S 1/2 Lot 5 - Con II Carr Twp;
11+50N on line 14W or 24+80N of Con I - Con II line
and 1400 ft west of Lot 4 - Lot 5 line

Bearing: Due North

Dip: @ Collar 80° Length 685 ft

Started: 23 Aug 1990 Completed Aug 1990

Drilled by Heath & Sherwood, Logged by J. E. Parsons

0-67 ft Overburden

clay except for last 1 1/2 feet of silt and fine sand under water pressure.

67-324 1/2 Andesite massive good coring type; for most part tends to be blotchy with seams of epidote-bearing material and possibly pillow selvages

73-89, 142-150 with fine amygdaloids

218-232 more feldspathic

@ 72 ft 1" white qtz-carb. vein @ 75° to core

102-103.5 section starts on a slip at 15° and ends with 1" qtz-carb @ 60°; fine interlocking fractures between above structures with patches plus a little chalcocopyrite

110-113.5 ft 70% white qtz-carb. veining at 30° to 50° to core; trace of pyrite local rock unaltered

117-117.5 qtz-carb

@ 125 " slip @ 15°

130-130.5 bluish tinged qtz-carb

132-132.6 vein crushed and brecciated qtz-carb @ 80° to core; some fine seams of dark pyrite

@ 141 2" of light bluish qtz-carb @ 60° ±; some co. pyrite

@ 141.5 " " " " " " " "

160-161 bluish grey carb with 20% white carb., 40° to core

218-232 locally finely feldspathic

@ 236 thin mud slip @ 30°

DP90-185

D.D.H. 90-2 cont'd

242.5-243 a light lavender colour silicified section plus qtz, carb & pyrite; 60° to core; offset in core by a 15° slip

243-244.5 same qtz and pyrite

Sample No B13 242.0-244.5 0.003% of Au per ton / 2.5 ft

248.5-249.4, 249.7-250, 250.4-251 qtz and qtz-carb veining @ 45° to core; @ 251 a 3/4" wide section bounded by slips @ 35° 50% pyrite

Sample No B14 248.5-251 0.01% of Au per ton / 2.5 ft

261-263.5 ft, first foot light greyish qtz-carb; 262-263 mostly a light lavender coloured altered rock; last 6" fractured with some alteration; all with pyrite (1%)

Sample No B15 261.0-263.5 0.018% of Au per ton / 2.5 ft

267-268 same qtz-carb and pyrite veining about along the core

295-296 light grey qtz-carb; some brecciation; slips @ 25°

304.5 some fine disseminated pyrite

292-334.5 generally a lighter grey colour with scattered carb-filled fractures

307-310 slips 20° to 40° to core; local alteration zones with fine pyrite; pyrite seams on chlorite slips; fractures and blebs of qtz-carb. Sample # B16 0.001% of Au per ton / 3 ft

310-312 ft blebs and fragments of dark blue quartz, plus frags and lenses of a hard crushed dark (brownish) altered rock with abundant very fine pyrite in a light blue siliceous matrix; @ 312 a very strong black chloritic zone 2" wide at 20°; ^{mineralization} unique to core

Sample # B17 0.004% of Au per ton / 2 ft

312-315 light grey carb; partly brecciated; wisps of dark green and black chlorite, trace of pyrite

Sample # B18 0.001% of Au per ton / 3 ft.

CARR TWP PROJECT

D.D.H. 90-2 cont'd

- 327.5-334.5 grey gtz carb plus inclusions of unaltered wallrock; trace of pyrite; 35° to core
- 334.5-341 Diorite Porphyry fine white feldspar in a fine grained dark matrix; contacts rather indefinite; hard
- 341-387 Andesite clotty, evidence of yellow schwaes, locally amygs.
- 384.5-385 light bluish grey carb 40° to core, few seams of pyrite
- 387-393 Diorite Porphyry fine white feldspar however only locally discernible; hard
- 393-402 Andesite
- 402-404 Diorite Porphyry as above
- 404-517.7 Andesite grey green; locally narrow carbonate zones, few epidote-rich clots
- 442-459 50% of core with feldspathic sections
- 459-500 10% " " "
- 500-517 hair-line fractures filled with white carbonate increasing down hole
- 517.7-662.5 Destor-Porcupine Fault Zone
- 517.7-522 white gtz with 20% inclusions of unaltered greenstone; core in part as gravel; a foot ± lost.
- 522-527 as 517.7-522; core mostly broken and partly as gravel; a foot ± lost
- @ 522 2" of mud fault gouge with few small gtz frags; bounding slips @ 65° to core
- 527-528 white gtz; 30% silicified light coloured wallrock; gtz fractured; trace of pyrite; core broken
- 528-530 as above only wallrock frags only slightly altd

Sample No 819 527-530 ft 0.005 oz Au/Ton

D.D.H 90-2 cont'd

- 530-532 white gtz with 40% wallrock frags
minor alteration; foliation 60°
- 532-534.5 Sample No 820 ~~0:00~~ ^{0:00} of Au perlon
white gtz with 50% wallrock frags, of these
50% altered to a dull tan colour; all fractured;
some strong slips 40° to 60° , trace of pyrite
- 534.5-537 white gtz and foliated soft altered light
olive green schist 50:50; foliation @ 55°
- 537-539 Sample No 821 ~~0:00~~ ^{0:00} of Au perlon
1ft of greyish fractured gtz; 3" of gtz & schist;
8" tan to pinkish fractured wallrock cemented
with gtz @ 538.7 strong slip @ 70° followed
by reddened wallrock fractured and
cemented by blue gtz for $1\frac{1}{2}$ "; 1% pyrite
- 539-550.5ft light yellowish green foliated schist
with local build-ups of white gtz
- 550.5-560 a milky white gtz cementing patches
of light blue gtz; massive; hard; trace pyrite
- 550.5-556 Sample 822 ~~0:00~~ ^{0:00} of Au / 5.5ft
- 560-595.5 "Schist" light olive green; thin uniformly
foliated; with 50% milky gtz along foliation;
solid except for last 10ft which is more
friable; foliation 50° to core
- 569.5-570.5
at 550.5-560
- 595.5-662.5 Serpentine Zone Carbonate Zone
after peridotite; black, very soft; mostly
foliated and shd; locally massive with fine
carb crystals; first 25ft 15% white gtz & carb.
first contact sharp @ 85° ; core badly broken through out
@ 597 2" mud followed by 4" of friable schist
@ 600.5 6" friable schist
- 576.5-577.2Db
greyish green dome
hard with
large amyg
- 609-610.5 approaching a friable schist
- 618-634 relatively abundant small rounded
frags of white gtz in the black matrix
(a breccia).

620-622 fine silt to mud
 624.5-627 " " to mud with qtz frags

662.5-685 Sediments

End well bedded at 50° to 60° to core; no
 distortion of bedding; first contact @ 662.5
 is on a slip @ 50° which parallels the
 bedding; dominantly a medium grey
 colour however with generally thin
 blackish slate beds; fine grained.

28 Aug 90
 G. C. Parnes

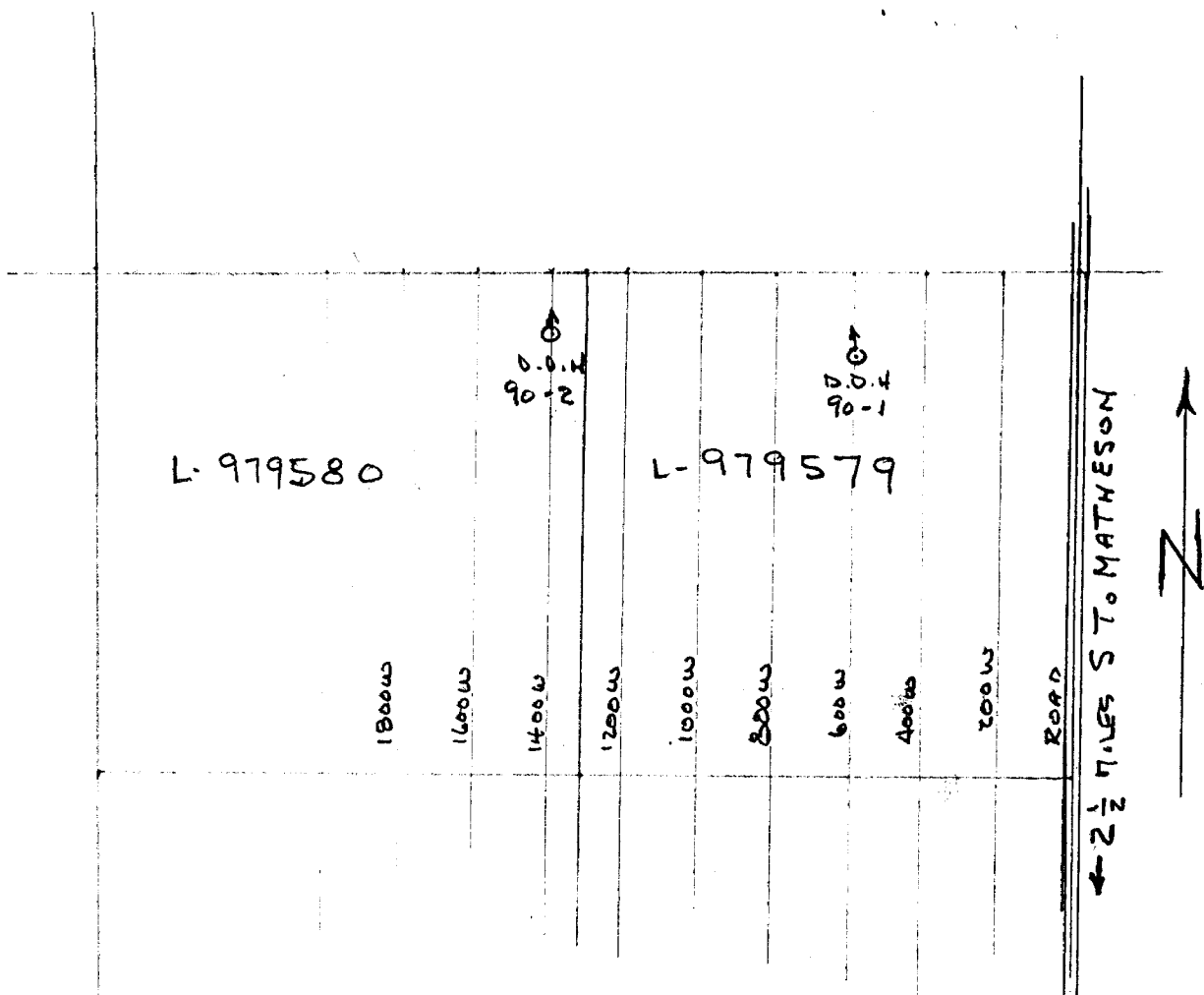

L-979580

L-979579

1800W

1600W

1400W

1200W

1000W

800W

600W

400W

200W

ROAD

← 2 1/2 MILES S TO MATHESON



SKETCH SHOWING

DRILL LOCATIONS - CARR TWP

SEPT-1990

SCALE 1" = 500'