

010

DIAMOND DRILLING

TOWNSHIP: CARR TWP.

REPORT NO: 16

WORK PERFORMED FOR: Lac Minerals Ltd.

RECORDED HOLDER: Same as above [xx]
: Other []

<u>Claim No.</u>	<u>Hole No.</u>	<u>Footage</u>	<u>Date</u>	<u>Note</u>
L 892908	C-4-87	666'	Aug/87	(1)

NOTES: (1)#366-87, filed in Mar/88

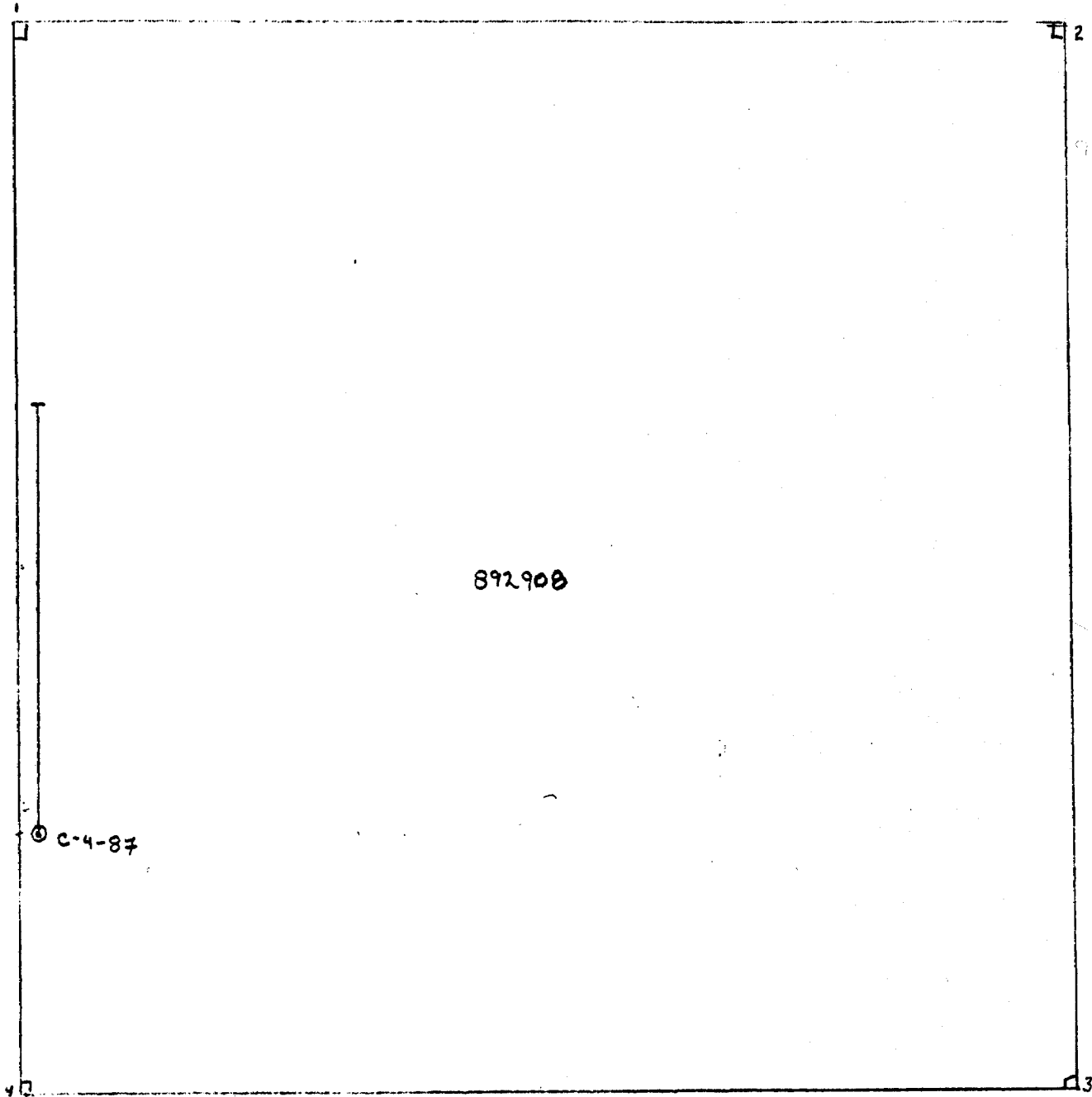

892900

⊙ C-4-87

BAH
Luc Minerals Ltd
Drill Hole Location Plan
Carr Twp.
Claim # 892900
Hole # C-4-87
Sept 3 1987
Scale. 1" = 200'

LAC MINERALS LTD.
91 DUNCAN AVENUE
KIRKLAND LAKE, ONTARIO
P2N 1Y2

GENERAL INFORMATION

HOLE NUMBER: C-4-87
PAGE NUMBER: 1
LOGGED BY: G.A.MOTZOK
DATE: AUGUST 18, 1987

PROJECT: CARR - CARR TOWNSHIP

Type of Hole: DDH

LOCATION: L16+18E , 5+00N
COLLAR: LATITUDE:
DEPARTURE:
LENGTH: 666 FEET
PURPOSE: TEST WEAK IP. ANOMALLY
DATE STARTED: 12/08/87

AZIMUTH: 0 DEG. DIP: -55 DEG.
ELEVATION: COLLAR:
BOTTOM:
RECOVERY: 99% CORE SIZE: 80
DATE ENDED: 14/8/87

SURVEY DATA

LOCATION	AZIMUTH	DIP	METHOD	REMARKS
0	360	-55		COLLAR
200		-52	A	
400		-52	A	
600		-51	A	

LAC MINERALS LTD.
GEOLOGICAL AND ASSAY DATA

DRILL HOLE: C-4-87 PROPERTY: CARR TOWNSHIP TARGET: Test "Weak" IP Anomaly

FROM FEET	TO	REMARKS	SAMPLE NUMBER	FROM	TO	FEET/ METERS	AU ASSAY (CORE)				SLUDGE		MAGNETICS									
							1st pulp ppb	2nd pulp ppb	oz/ ton	FROM	TO	AU ppb	FROM	TO	MGT.							
0	84	CASING																				
84	666	<p>ARKOSIC GREYWACKE</p> <p>-medium greenish grey colour; fairly massive medium grained; not well bedded</p> <p>-contains approximately 1% disseminated pyrite, medium grained well formed crystals with a few large irregular shaped grains (up to 1/3" size) which show rare crystal faces</p> <p>-greYWacke constitutes approximately 80% of the rock unit and is interbedded with approximately 20% Argillite</p> <p>ARGILLITE</p> <p>-Fine grained; dark grey to black colour; well banded and bedded; minor visible pyrite, some graded bedding and soft sediment deformation (slumping, folding & faulting: bedding is approximately 085 DEG. to 090 DEG. to core</p> <p>CONTAINS</p> <p>-95 to 101 approximately 40% quartz veins - 6 veins up to 1.5 ft. wide, 1.5 ft. wide one is barren of sulfides but others contain pyrite as crystals and rarely as sheets along fractures</p> <p>-minor quartz (+ carbonate) veins < 1/2" wide occur throughout.</p> <p>-209.3' to 272' zone of veining, brecciation and creamy green coloured alteration; approximately 1% medium grained disseminated pyrite crystals; minor carbonate</p> <p>about 300' to end of hole pyrite content decreases to 0.5%</p> <p>654 to 657 pyrite approximately 1%</p>	7207	95	101	6.0'	7208	101	106	5.0'	7209	251	256	5.0'	7210	269.3	272	2.7'	7211	652	657	5.0'

Alex M. [Signature]

Work permit issued for operations, expiry date

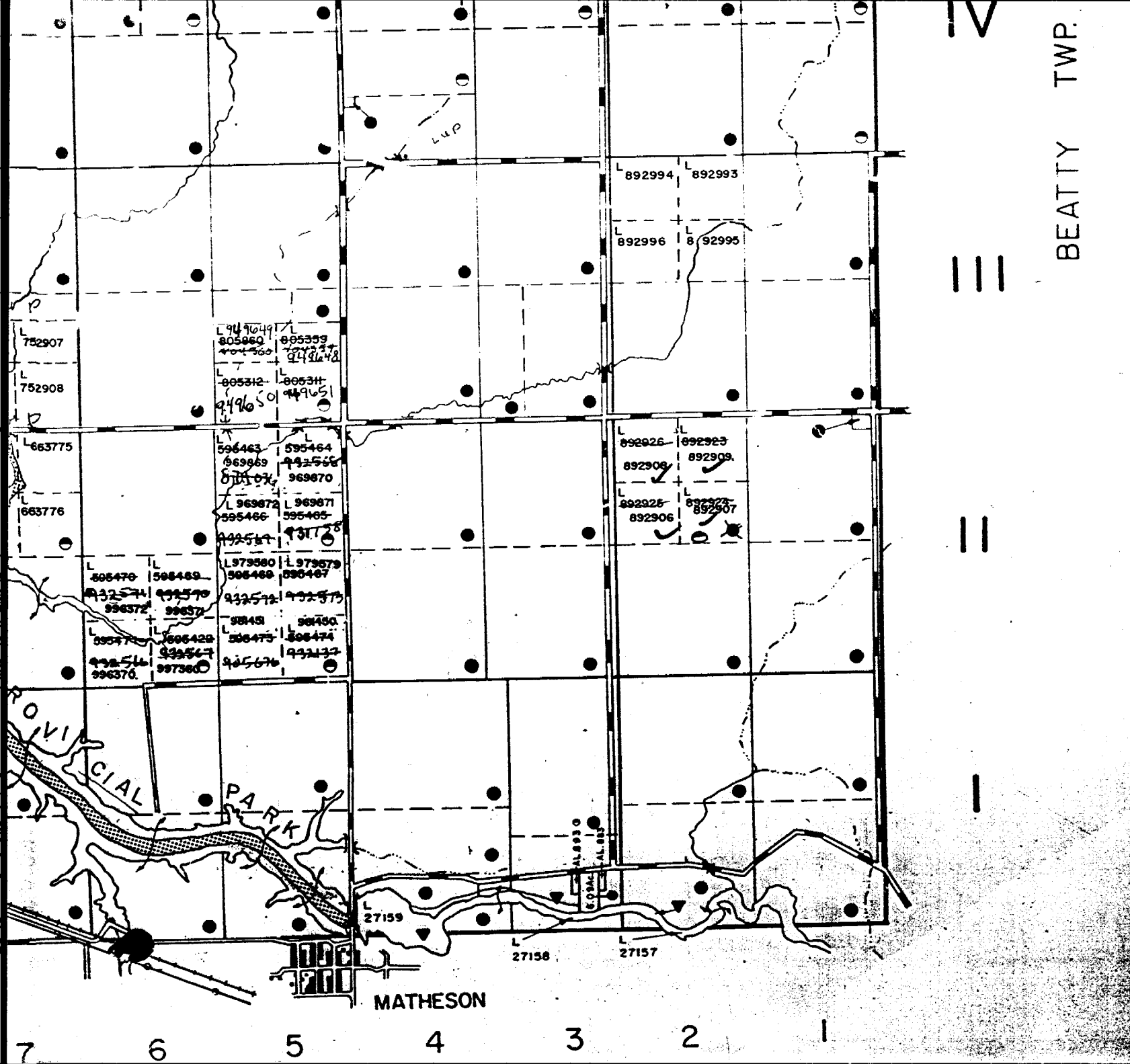

BEATTY TWP.

III

II

I

SCALE: 1 INCH = 40 CHAINS

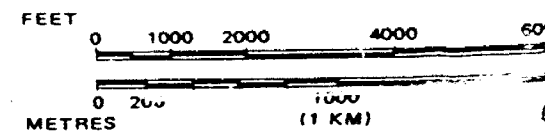

ACRES HECTARES

40

16

TOWNSHIP OF
CARR
 G.3613
 DISTRICT
 COCHRANE
 MINING DIVISION
 LARDER LAKE



Ministry of Natural Resources
 Ministry of Northern and Mines



42A095W0147 16 CARR

Mining Ac

Name and Address of Recorded Holder
LAC Minerals Ltd., 91 Duncan Ave., for Wayne F. Clark (T-664) K 21432
KIRKLAND LAKE, Ontario.

Summary of Work Performance and Distribution of Credits

Total Work Days Cr. claimed 666	Mining Claim		Work Days Cr.	Mining Claim		Work Days Cr.	Mining Claim		Work Days Cr.
	Prefix	Number		Prefix	Number		Prefix	Number	
for Performance of the following work. (Check one only)	L	892906	167						
	<input type="checkbox"/> Manual Work								
	<input type="checkbox"/> Shaft Sinking Drifting or other Lateral Work.								
	<input type="checkbox"/> Compressed Air, other Power driven or mechanical equip.								
	<input type="checkbox"/> Power Stripping								
<input checked="" type="checkbox"/> Diamond or other Core drilling									
<input type="checkbox"/> Land Survey									

All the work was performed on Mining Claim(s): **L 892908**

Required Information eg: type of equipment, Names, Addresses, etc. (See Table Below)

Standard Boyles Diamond Drill Machine

Drill Contractor

Philippon Diamond Drilling
 829 Chemin Granada,
 C.P. 788,
 ROUYN, Quebec.
 J9X 5C7

OCT 7 1987
RECEIVED

LARDER LAKE MINING DIV.
RECEIVED
SEP 15 1987
AM 7 | 8 | 9 | 10 | 11 | 12 | 1 | 2 | 3 | 4 | 5 | 6 PM
10:25 a.m.

RECORDED
SEP 15 1987
Receipt # _____

Date of Report: **Aug. 19, 1987**
 Recorded Holder or Agent (Signature): *Wayne F. Clark*
LAC Minerals Ltd.

Certification Verifying Report of Work

I hereby certify that I have a personal and intimate knowledge of the facts set forth in the Report of Work annexed hereto, having performed the work or witnessed same during and/or after its completion and the annexed report is true.

Name and Postal Address of Person Certifying
Alex Motzok 11 Tyndall Ave., TORONTO, Ontario M6K 2E8

Date Certified: **Aug. 19, 1987**
 Certified by (Signature): *Alex Motzok*

Table of Information/Attachments Required by the Mining Recorder

Type of Work	Specific information per type	Other information (Common to 2 or more types)	Attachments
Manual Work	Nil	Names and addresses of men who performed manual work/operated equipment, together with dates and hours of employment.	Work Sketch: these are required to show the location and extent of work in relation to the nearest claim post.
Shaft Sinking, Drifting or other Lateral Work			
Compressed air, other power driven or mechanical equip.	Type of equipment	Names and addresses of owner or operator together with dates when drilling/stripping done.	Work Sketch (as above) in duplicate
Power Stripping	Type of equipment and amount expended. Note: Proof of actual cost must be submitted within 30 days of recording.		
Diamond or other core drilling	Signed core log showing; footage, diameter of core, number and angles of holes.	Nil	Nil
Land Survey	Name and address of Ontario land surveyor.		