



42A10NE0057 2.4771 WALKER

010

REPORT ON A GEOLOGICAL SURVEY

WALKER-1

PROJECT 1131-09

NTS: 42-A-10

RECEIVED

MAY 10 1982

MINING LANDS SECTION

AMAX MINERALS EXPLORATION

Timmins, Ontario
August, 1981

John Walmsley
Geological Engineering Technician



T A B L E O F C O N T E N T S

	<u>Page</u>
SUMMARY	1
INTRODUCTION	1
LOCATION AND ACCESS	1
TOPOGRAPHY AND RESOURCES	2
PREVIOUS WORK	2
SURVEY METHOD	3
REGIONAL GEOLOGY	3
PROPERTY GEOLOGY	4
CONCLUSIONS AND RECOMMENDATIONS	4
LIST OF REFERENCES	5

LIST OF FIGURES

FIGURE 1	LOCATION SKETCH	After Page 1
FIGURE 2	CLAIM SKETCH	After Page 1

LIST OF TABLES

TABLE 1	TABLE OF FORMATIONS	After Page 2
---------	---------------------------	--------------

LIST OF APPENDICES

APPENDIX A	SCHEDULE OF CLAIMS	After Page 5
------------	--------------------------	--------------

LIST OF MAPS

MAP 1	GEOLOGICAL SURVEY MAP	Back Pocket
-------	-----------------------------	-------------

SUMMARY

A group of eight (8) claims were staked in early September, 1980, to cover two conductors detected by an A.E.M. survey conducted over Walker township.

In June of 1981, a geological mapping-prospecting survey was undertaken to locate geophysical grids, claim posts, lines, outcrop and to search for any evidence of previous activity on the property. An old claim post was discovered at the north end and an old grid line from a claim group to the south crossed part of the southeast claim.

INTRODUCTION

On June 5, 1981, a geological mapping-prospecting survey was conducted on a group of eight (8) claims staked on September 6, 1980, in the name of Amax of Canada Limited.

The claims were staked to cover two anomalies detected by an A.E.M. survey flown for Amax by Questor Surveys Limited.

This report describes the method and results of the geological survey.

LOCATION AND ACCESS

The claim group consists of eight (8) claims

FIGURE 1

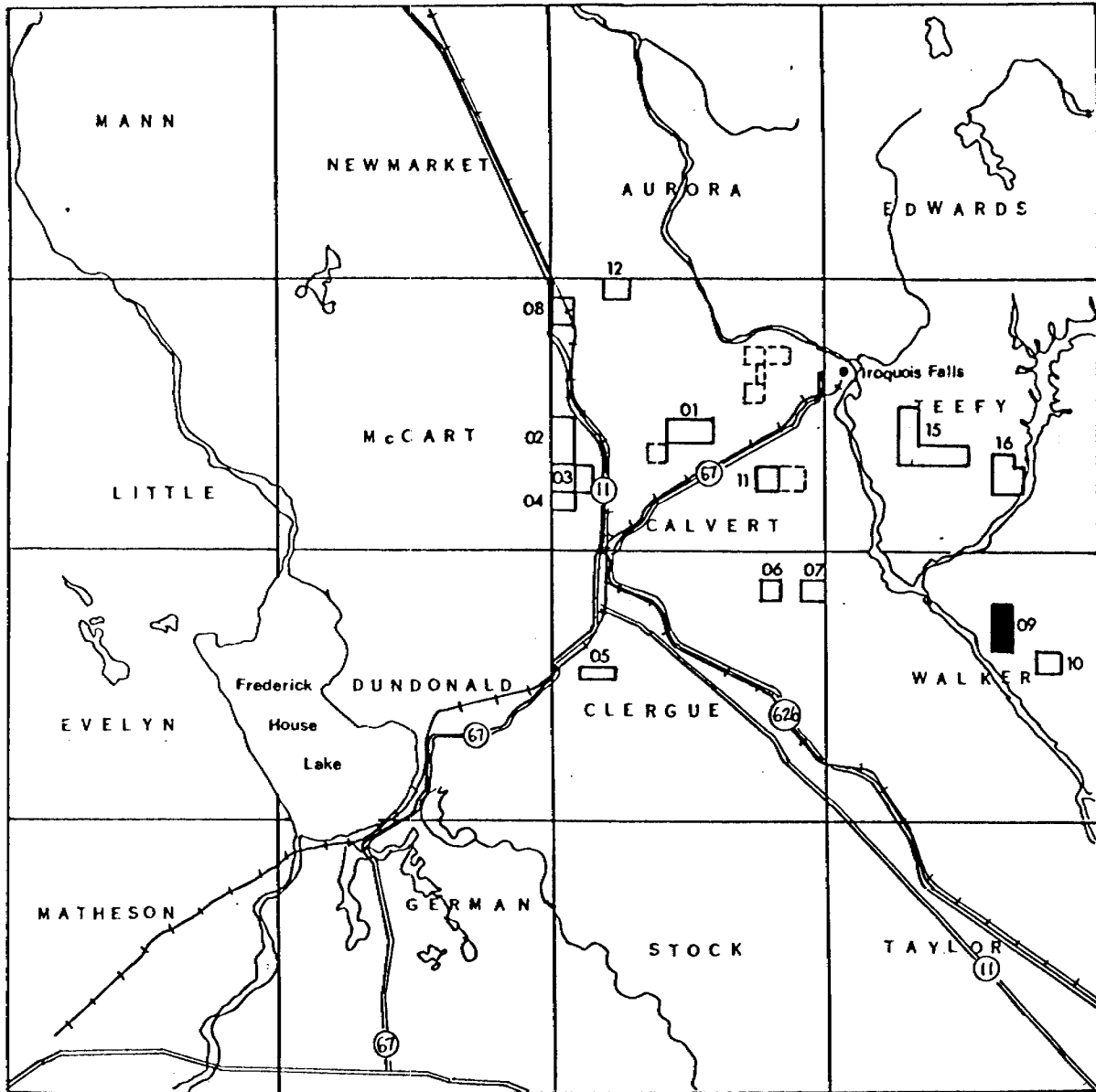

SCALE: 1" = 4 miles

LOCATION SKETCH

Project 1131-09, Iroquois Falls

WALKER TOWNSHIP

NTS: 42/A/10

Lot 5



L583762	L583763
L 583761	L583764
L 583760	L583765
L583759	L583766

Con V

CLAIM MAP
Project 1131-09
WALKER-1
Walker Township
1"=¼ mile

taking up Lot 5, Concession V, Walker township, north-eastern Ontario. It is approximately 6.5 kilometres south and 5.5 kilometres east of the town of Iroquois Falls.

Access is by boat taken from a landing approximately 2.5 kilometres east of highway 577, along Black River road, 5 kilometres south of Iroquois Falls. The Black River is followed east for 0.25 kilometres then southeast, keeping to the east channel, for about 2.5 kilometres to a tributary on the east side. The tributary is then followed for approximately 0.25 kilometres.

TOPOGRAPHY AND RESOURCES

The topography of the area is quite rough along side the river, flattening out into swamps to the north and south. Most of the property is on the rough part, being cut by many small streams. The north claims are on flatter ground and swamps.

Most of the group is covered with poplar and mixed vegetation making for easy walking. Some alder swamps occur through the central portion, and the northern claims are in spruce swamp.

PREVIOUS WORK

One old claim post, #1, L-83984 was found

TABLE OF FORMATIONS

CENOZOIC

Recent: Swamp and stream deposits
Pleistocene: Glacial drift, gravel, sand and clay

-----Unconformity-----

PRECAMBRIAN

Proterozoic: Diabase dykes - 2 generations

-----Intrusive Contact-----

Lamprophyre dykes

-----Intrusive contact-----

Archean: Discordant gabbro bodies

-----Intrusive contact-----

: Layered gabbro-peridotite sills

-----Intrusive contact-----

: Volcanics - Rhyolite, rhyolite agglomerate
and tuff, and associated chert
- Andesite, basalt; as pillowed and
massive flows, individual flows
separated by flow breccia
- Ultramafic flows - showing
spinifex texture

-----Faulted contact-----

: Sediments - Greywacke, argillite, arkose,
conglomerate

on the northeastern claim. A grid line from the claim below Amax's was found extending north to the river. An old road was found traversing east-west along the top boundary. No evidence of what the road was for was found.

SURVEY METHOD

Traverses were made by J. Walmsley, P. Bateman and M. Villeneuve in a north-south direction from the north and south group boundaries at 125 metre intervals.

All claim posts, lines, grid lines and physical features were located and tied in.

A 1:5000 blow-up of an Ontario Government 1:15000 air photo, number 2.71-4828-24, 129, was used for control while mapping.

REGIONAL GEOLOGY

Most of the township is underlain by intermediate and mafic metavolcanics. A band of meta-sediments strikes east-west across the bottom and a small unit of felsic intrusives occurs in the south-east corner. Through the centre of the township, a fault traverse strikes northwest-southeast. A thin

unit of felsic metavolcanics strikes east through the central part of the region, east of the fault.

PROPERTY GEOLOGY

The claim group is covered by swamp and clay overburden, allowing no bedrock to be exposed. It is therefore assumed that the property is underlain by intermediate and mafic volcanics. The fault mentioned above cuts across the northeast corner of the property.

CONCLUSIONS AND RECOMMENDATIONS

Due to the lack of outcrop, the nature of the conductors was not observed. It is therefore recommended that the northern conductor be drilled to determine its cause and if possible, further geophysical work be done to the east of the southern claims to determine more accurately the value of that conductor.

Respectfully submitted,

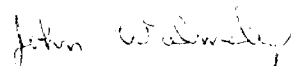

Timmins, Ontario
August, 1981

John Walmsley
Geological Engineering Technician

LIST OF REFERENCES

References: Geological Compilation Series Map
 Timmins-Kirkland Lake
 D.R. Pyke, L.D. Ayres and D.G. Innes
 1970,71

APPENDIX A

SCHEDULE OF CLAIMS

PROJECT 1131-09; Walker-1

Claim Group	Township	Number	Claim Numbers	Recording Date
1131-09 Walker-1	Walker	8	L-583759	September 10/80
			L-583760	September 10/80
			L-583761	September 10/80
			L-583762	September 10/80
			L-583763	September 10/80
			L-583764	September 10/80
			L-583765	September 10/80
			L-583766	September 10/80

STATEMENT OF QUALIFICATION

I, John R. Walmsley, residing at 164 Hugill St. Sault Ste. Marie, Ontario, employed as a Geological Engineering Technician by Amax of Canada Limited, to hereby certify that:

I attended Sault College of Applied Arts and Technology in Sault Ste. Marie, Ontario and graduated as a Geological Engineering Technician in 1980.

I have been employed as a Geological Engineering Technician for the 1980 and 1981 field seasons in all phases of mining exploration.

I was personally present on the property and did supervise the survey as reported.

.....*John R. Walmsley*.....

J. R. Walmsley



Ministry of
Natural
Resources

Ontario

Report of Work
(Geophysical, Geological,
Geochemical and Expenditures)



42A10NE0057 2.4771 WALKER

900

11-09

(file L583759)

The Mining Act

2.4771

Do not use shaded areas below.

Type of Survey(s) Geological Survey	Township or Area Walker
Claim Holder(s) Amax of Canada Limited	Prospector's Licence No. A-38495
Survey Company Amax Minerals Exploration	Survey Dates (linecutting to office) 05 06 81 Day Mo. Yr. Day Mo. Yr.
Name and Address of Author (of Geo-Technical report) John Walmsley, 255 Algonquin Blvd. West, Timmins, Ontario. P4N 2R8	

Special Provisions Credits Requested

Instructions	Geophysical	Days per Claim
For first survey: Enter 40 days. (This includes line cutting)	- Electromagnetic	
	- Magnetometer	
For each additional survey: using the same grid:	- Radiometric	
Enter 20 days (for each)	- Other	
	Geological	20
	Geochemical	

Mining Claims Traversed (List in numerical sequence)

Mining Claim			Mining Claim		
Prefix	Number	Expend. Days Cr.	Prefix	Number	Expend. Days Cr.
L	583759	20			
	583760	20			
	583761	20			
	583762	20			
	583763	20			
	583764	20			
	583765	20			
	583766	20			

RECEIVED

MAY 25 1982

MINING LANDS SECTION

Man Days

Instructions	Geophysical	Days per Claim
Complete reverse side and enter total(s) here	- Electromagnetic	
	- Magnetometer	
	- Radiometric	
	- Other	
	Geological	
	Geochemical	

Airborne Credits

Note: Special provisions credits do not apply to Airborne Surveys.		Days per Claim
	Electromagnetic	
	Magnetometer	
	Radiometric	

Expenditures (excludes power stripping)

Type of Work Performed

Performed on Claim(s)

Calculation of Expenditure Days Credits

Total Expenditures \$ + 15 = Total Days Credits

Instructions

Total Days Credits may be apportioned at the claim holder's choice. Enter number of days credits per claim selected in columns at right.

Report Completed

Date of Report April 27, 1982

Recorded Holder or Agent (Signature) *Rosemary Ditty*

Certification Verifying Report of Work

I hereby certify that I have a personal and intimate knowledge of the facts set forth in the Report of Work annexed hereto, having performed the work or witnessed same during and/or after its completion and the annexed report is true.

Name and Postal Address of Person Certifying

R. J. Roussain
255 Algonquin Blvd. West, Timmins, Ont. P4N 2R8

Date Certified

April 27/82

Certified by (Signature)

R. J. Roussain

ARDE
RECEIVED
MAY - 4 1982
AM 7 8 9 10 11 12 1 2 3 4 5 6 PM

For Office Use Only

Total Days Cr. Recorded 160

Date Recorded MAY 4 1982

Date Approved as Recorded 82.02.89

Total number of mining claims covered by this report of work. 8

Mining Recorder *[Signature]*

Engineer/Branch Director *[Signature]*

GEOPHYSICAL TECHNICAL DATA

GROUND SURVEYS - If more than one survey, specify data for each type of survey

Number of Stations _____ Number of Readings _____

Station interval _____ Line spacing _____

Profile scale _____

Contour interval _____

MAGNETIC

Instrument _____

Accuracy - Scale constant _____

Diurnal correction method _____

Base Station check-in interval (hours) _____

Base Station location and value _____

ELECTROMAGNETIC

Instrument _____

Coil configuration _____

Coil separation _____

Accuracy _____

Method: Fixed transmitter Shoot back In line Parallel line

Frequency _____
(specify V.L.F. station)

Parameters measured _____

GRAVITY

Instrument _____

Scale constant _____

Corrections made _____

Base station value and location _____

Elevation accuracy _____

INDUCED POLARIZATION
RESISTIVITY

Instrument _____

Method Time Domain Frequency Domain

Parameters - On time _____ Frequency _____

- Off time _____ Range _____

- Delay time _____

- Integration time _____

Power _____

Electrode array _____

Electrode spacing _____

Type of electrode _____

SELF POTENTIAL

Instrument _____ Range _____

Survey Method _____

Corrections made _____

RADIOMETRIC

Instrument _____

Values measured _____

Energy windows (levels) _____

Height of instrument _____ Background Count _____

Size of detector _____

Overburden _____

(type, depth - include outcrop map)

OTHERS (SEISMIC, DRILL WELL LOGGING ETC.)

Type of survey _____

Instrument _____

Accuracy _____

Parameters measured _____

Additional information (for understanding results) _____

AIRBORNE SURVEYS

Type of survey(s) _____

Instrument(s) _____

(specify for each type of survey)

Accuracy _____

(specify for each type of survey)

Aircraft used _____

Sensor altitude _____

Navigation and flight path recovery method _____

Aircraft altitude _____ Line Spacing _____

Miles flown over total area _____ Over claims only _____

GEOCHEMICAL SURVEY - PROCEDURE RECORD

Numbers of claims from which samples taken _____

Total Number of Samples _____

Type of Sample _____
(Nature of Material)

Average Sample Weight _____

Method of Collection _____

Soil Horizon Sampled _____

Horizon Development _____

Sample Depth _____

Terrain _____

Drainage Development _____

Estimated Range of Overburden Thickness _____

SAMPLE PREPARATION

(Includes drying, screening, crushing, ashing)

Mesh size of fraction used for analysis _____

General _____

ANALYTICAL METHODS

Values expressed in: per cent
p. p. m.
p. p. b.

Cu, Pb, Zn, Ni, Co, Ag, Mo, As, -(circle)

Others _____

Field Analysis (_____ tests)

Extraction Method _____

Analytical Method _____

Reagents Used _____

Field Laboratory Analysis

No. (_____ tests)

Extraction Method _____

Analytical Method _____

Reagents Used _____

Commercial Laboratory (_____ tests)

Name of Laboratory _____

Extraction Method _____

Analytical Method _____

Reagents Used _____

General _____



MINERALS EXPLORATION
(A Division of AMAX OF CANADA LIMITED)

255 Algonquin Blvd. West
Timmins, Ontario
P4N 2R8

2.4771

Telephone: (705) 264-5247

Our File: 034-09

February 2, 1983

Mr. E. F. Anderson,
Director, Land Management Branch,
Ontario Ministry of Natural Resources,
Whitney Block, Room 6450,
Queen's Park,
Toronto, Ontario.
M7A 1W3

RECEIVED

FEB - 8 1983

MINING LANDS SECTION

Dear Sir:

Re: Your File 2.4771

Enclosed herewith is the map in duplicate for the Geological Survey report submitted on Mining Claims L.583759 et al., in the township of Walker in the Larder Lake Mining Division.

The traverse lines have been added onto the maps.

Yours truly,
AMAX OF CANADA LIMITED

Rosemary Tittley (Mrs.)
Land Recorder

Encs. 2

c.c. G. Koleszar, Mining Recorder, Kirkland Lake

1983 02 01

2.4771

Amax of Canada Limited
255 Algonquin Blvd West
Timmins, Ontario
P4N 2R8

Attention: Mr. John Walmsley.

Dear Sirs:

RE: Geological Survey submitted on Mining Claims
L 583759 et al in the Township of Walker.

Enclosed is the map in duplicate for the above mentioned survey. Please show all traverse lines and return the maps to this office.

For further information, please contact Mr. F.W. Matthews at 416/965-1380.

Yours very truly,

E.F. Anderson
Director
Land Management Branch

Whitney Block, Room 6450
Queen's Park
Toronto, Ontario
M7A 1W3
Phone: 416/965-1380

A. Barr:sc

Encls:

cc: Mining Recorder
Kirkland Lake, Ontario

1982 05 21

2.4771

Mining Recorder
Ministry of Natural Resources
4 Government Road East
P.O. Box 984
Kirkland Lake, Ontario
P2N 1A2

Dear Sir:

We have received reports and maps for a Geological Survey submitted under Special Provisions (credit for Performance and Coverage) on Mining Claims 1. 583759 et al in the Township of Walker.

This material will be examined and assessed and a statement of assessment work credits will be issued.

Yours very truly,

E.F. Anderson
Director
Land Management Branch

Whitney Block, Room 6450
Queen's Park
Toronto, Ontario
M7A 1W3
Phone: 416/965-1316

J. Skura/amc

cc: Amax of Canada Limited
Timmins, Ontario
Attn: Mrs. Rosemary Tittley/
Mr. John Walmsley



MINERALS EXPLORATION
(A Division of AMAX OF CANADA LIMITED)

255 Algonquin Blvd. West
Timmins, Ontario
P4N 2R8

Telephone: (705) 264-5247

Our File: 1131-09

May 7, 1982

Mr. F. W. Matthews,
Ontario Ministry of Natural Resources,
W1617, Whitney Block,
Queen's Park,
Toronto, Ontario.
M7A 1W3

Dear Sir:

Enclosed herewith please find two (2) copies of a report by Mr. John Walmsley who was employed by Amax during the 1981 summer field season, concerning a geological survey which was performed over the below listed contiguous mining claims located in Walker township, along with the survey plans.

L-583759	L-583760	L-583761	L-583762
L-583763	L-583764	L-583765	L-583766

A "Report of Work" concerning this survey has been filed with Mr. George Koleszar, Mining Recorder for the Larder Lake Mining Division.

Thank you.

Yours truly,
AMAX OF CANADA LIMITED

Rosemary Tittley (Mrs.)
Land Recorder

Encs. 2

c.c. K. Clemis/E. Barclay, Toronto

RECEIVED

MAY 10 1982

MINING LANDS SECTION

Teefy Twp.

Clergue Twp.

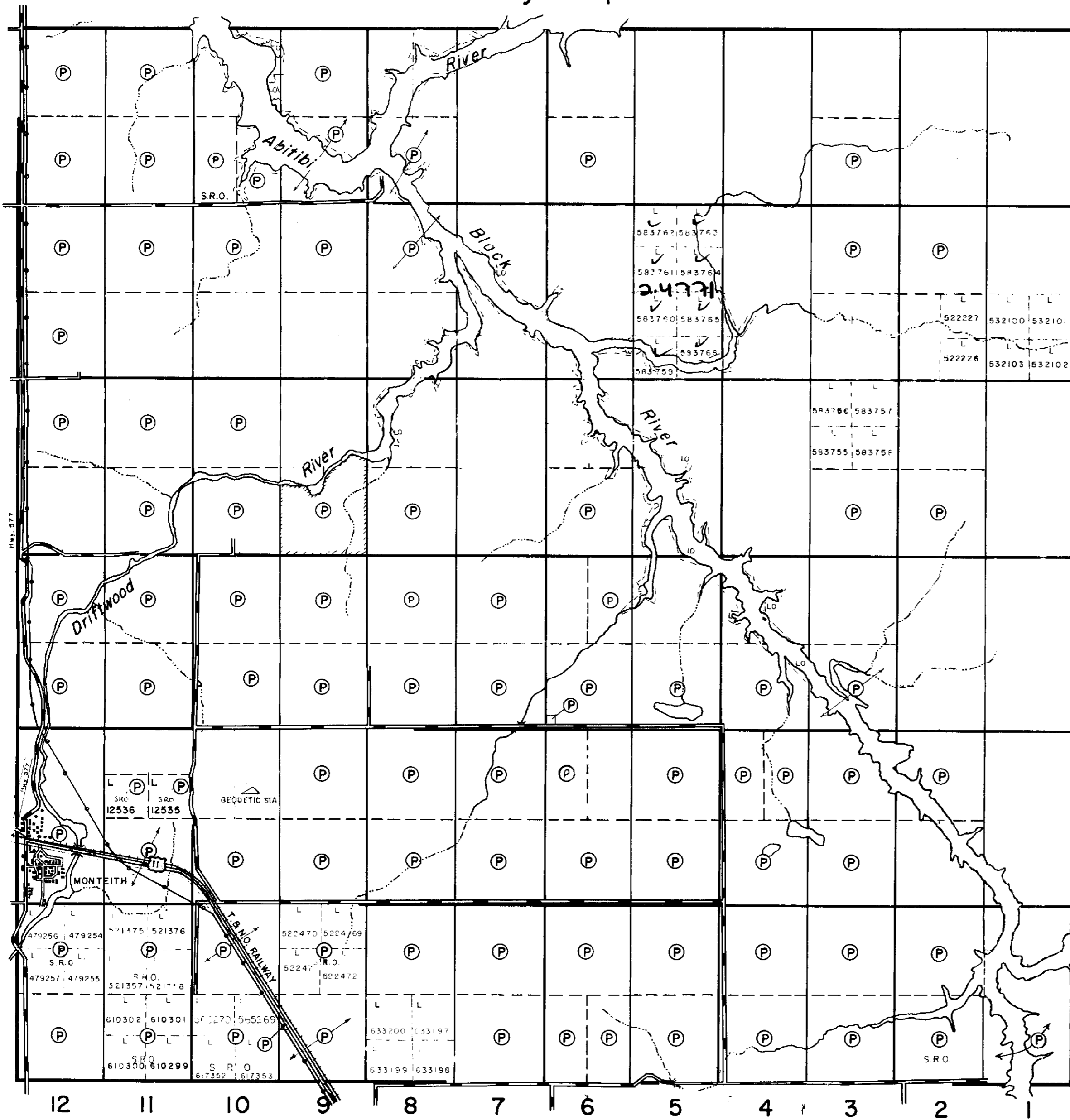

VI

V

IV

III

II

Wikie Twp.

THE TOWNSHIP OF

WALKER

DISTRICT OF COCHRANE

LARDER LAKE MINING DIVISION

SCALE: 1-INCH= 40 CHAINS

LEGEND

PATENTED LAND	(P)
CROWN LAND SALE LEASES	(S) or (C.S.)
LOCATED LAND	Loc.
LICENSE OF OCCUPATION	L.O.
MINING RIGHTS ONLY	M.R.O.
SURFACE RIGHTS ONLY	S.R.O.
ROADS	—
IMPROVED ROADS	—
KING'S HIGHWAYS	—
RAILWAYS	—
POWER LINES	—
MARSH OR MUSKEG	—
MINES	—

NOTES

400' Surface rights reservation around all lakes and vers.

L.O. 8672 issued for flooding rights along the shores of Abitibi, Black and Driftwood Rivers.

DATE OF ISSUE

JAN - 5 1983

Ministry of Natural Resources
TORONTO

PLAN NO.- M-396

ONTARIO
MINISTRY OF NATURAL RESOURCES

SURVEY AND MAPS DIVISION

Taylor Twp.



42A10NE0057 2.4771 WALKER

200

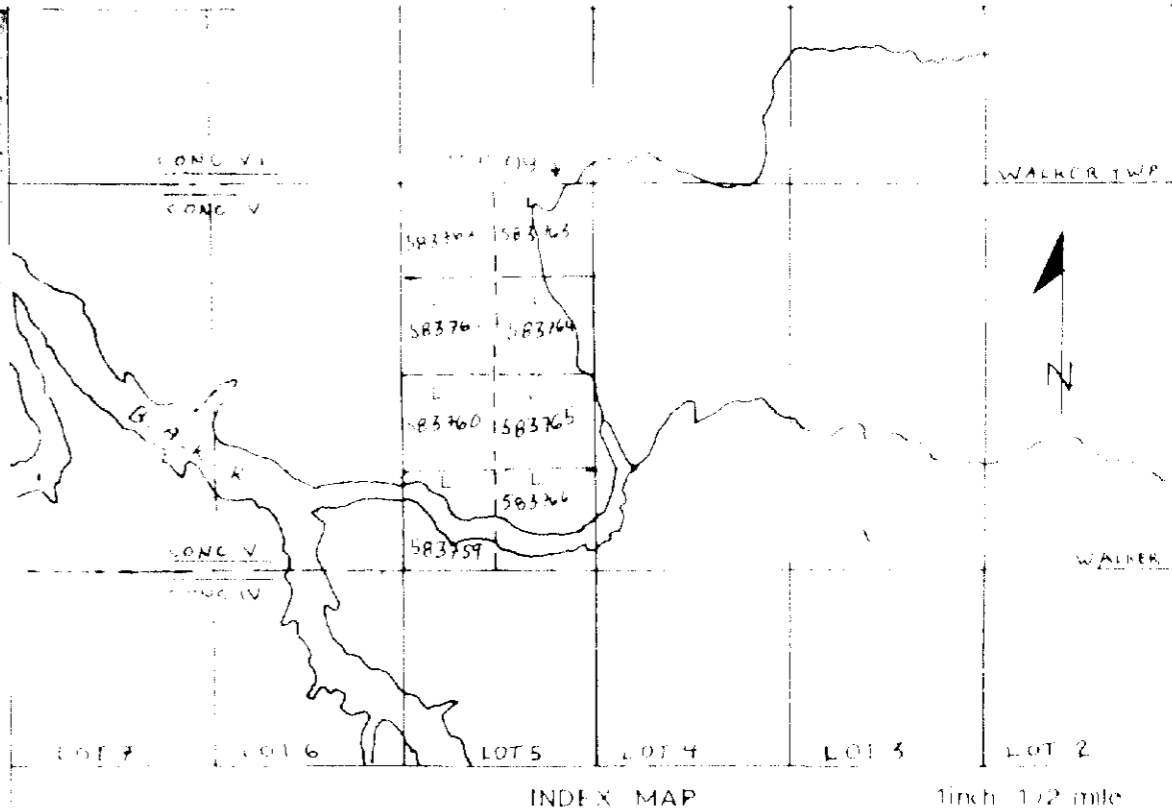
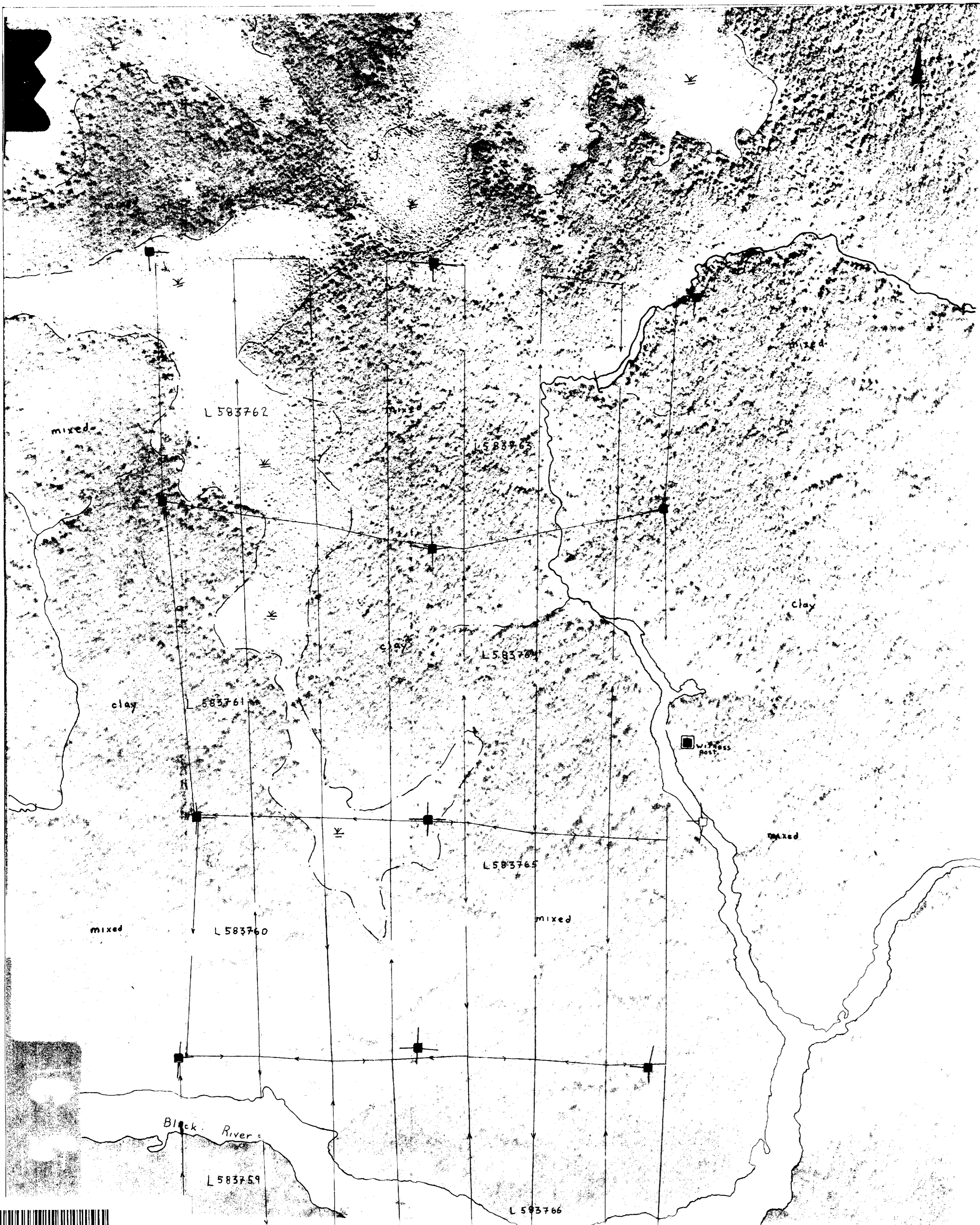

- Legend
- Claim post located
 - () Claim post (location assumed)
 - Dike
 - ∇ Swamp
 - ~ Stream
 - Traverse Line

NOTE: NO GEOLOGY LOCATED.

Atlas Minerals Exploration
 OF COLOR SURVEY
 WALKER TOWNSHIP, T13S09
 Irons Falls, Ont.

SCALE: 1" = 1/2 MI.
 DATE: 1981
 NTS: 42-A-10
 JUNE 1981



42A10N09S7 2.4771 WALKER