



42A10NE2004 2.18542 WALKER

010

R525

REPORT ON RECONNAISSANCE GRAVITY SURVEY

WALKER TOWNSHIP AREA

ONTARIO

FOR

Merle Cosby

13 Windermere Rd., St. Catherines, Ontario

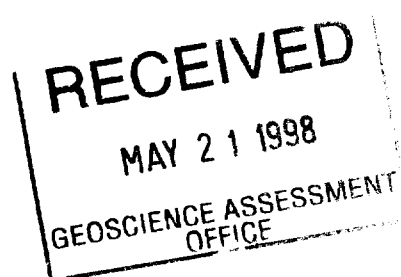

by

ALLAN SPECTOR AND ASSOCIATES LIMITED
TORONTO CANADA

May, 1998

1. INTRODUCTION

This work was initiated in response to a request from Merle Cosby to conduct a gravity survey of a property area that includes the following mining exploration claims; 1200339, 1200338, 1140851, 1140850, 1140854 and 1140855.

The project area is about 20 km NW of the village of Matheson and is centred at about 48°15'N, 80°36'W.

Primary objective of the gravity survey is geological mapping; to locate rock units exhibiting anomalously high density. These rocks are considered prospective for massive sulfide and gold exploration.

2. The gravity survey & data reduction

The survey was conducted by this author and amounted to 130 measurements taken on foot, at 100' (30m) spacing on 7 cut lines, in the period May 8-9, 1998. The lines 0w to 24w run south from a logging road.

A thermostatically controlled Sodin gravimeter mounted on a 0.7m high tripod, was used to make the gravity measurements. This instrument has a sensitivity of 0.01 mgal. A barometric system was used to determine elevation. The system involves a fixed base monitor as well as a "rover" unit. Accuracy of this procedure is about ±1 meter or ±0.2 mgal. All gravity and barometric measurements began and ended at a base "B" located at point 0+00N on line 4w. Observed gravity at this point is assumed to be 0.00 mgal. Elevation of this point was set at 46' (14m).

Navigation and positioning was done using a Garmin 89 GPS receiver. After a northerly correction of -100m, the GPS positioning was found to conform to published 1:50,000 topo map UTM locations to better than 100m accuracy.

A Bouguer density of 2.65 was adopted in the reduction of the data to Bouguer gravity. A latitude correction of -0.8055 mgal/km. was used. A digital file "gmat.dat" recorded in ASCII format onto a 3.5" diskette, includes the principal facts data collected in the survey. Each data record consists of a station number, elevation in feet above sea level, UTM east and north coordinates in kilometers and Bouguer gravity in milligals. A print out of this file accompanies this report. No terrain corrections were applied to the data and thus the reduced data may be referred to as Simple Bouguer gravity data.

3. Results

Figure 1 is a Simple Bouguer gravity map of the project area at 1:5,000 scale. It shows the location of all gravity measurements. Contour interval is 0.1 mgal.

3.1 Mafic/Felsic Contact

Principal feature expressed in the data is south to north decrease in gravity. A northwest-trending geological contact that separates less dense (f = felsic) rocks to the north from denser (m = mafic) rocks to the south is interpreted from this gradient. The change in gravity is about 1 to 2 mgal. A 500m thick layer of felsic rocks having a density contrast of -0.1 gm/cc could be attributed to this negative effect.

An analysis of the gravity data in profile form (Figure 2) indicates that the depth to the contact is about 100m below ground.

3.2 Anomaly A

A +0.5 mgal gravity anomaly appears to be located on this contact. The 600m x

COSBY CLAIM GROUP, WALKER Twp. BOUGUER GRAVITY

scale 1:5,000

c.i. = 0.1 mgal.

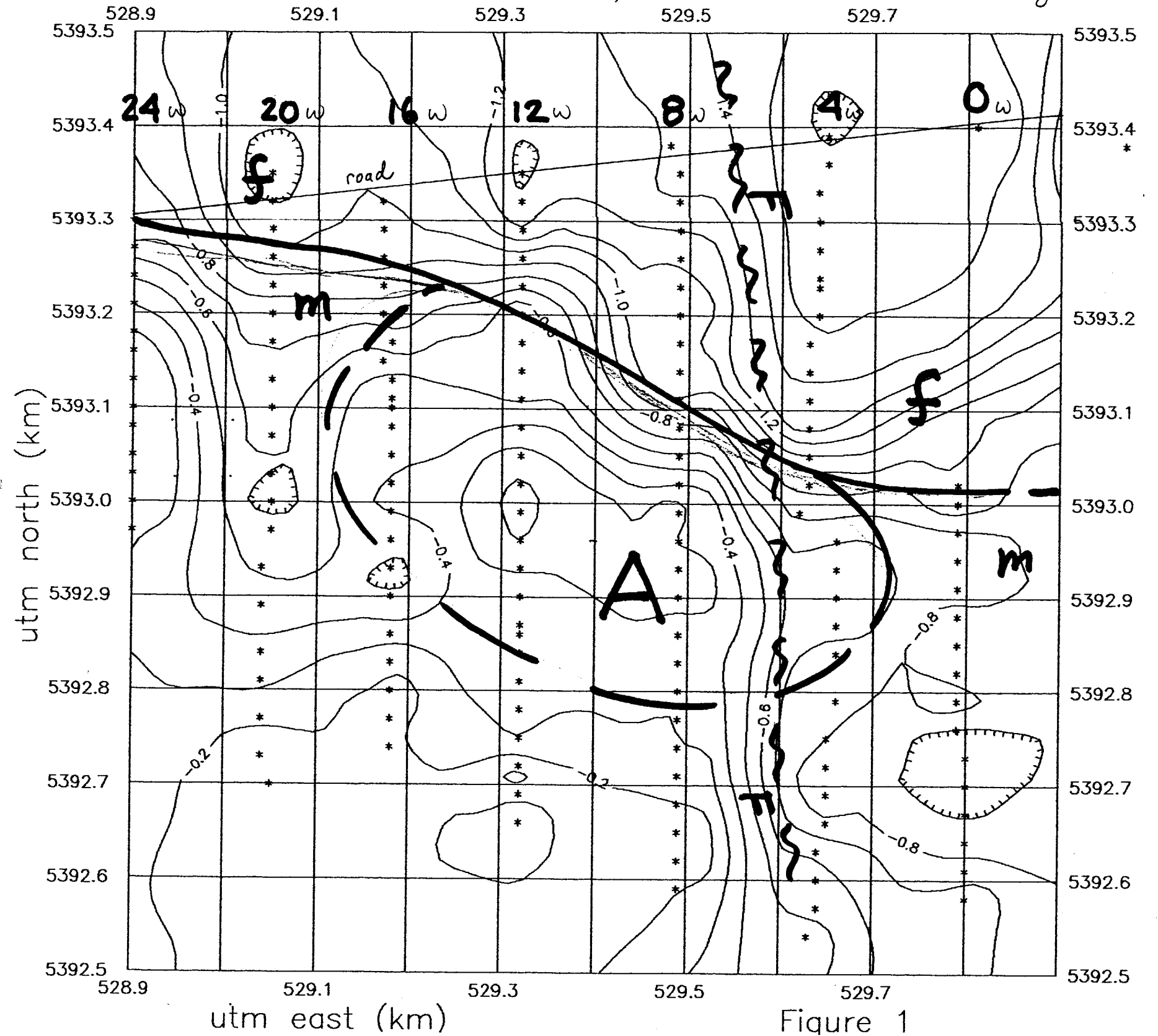
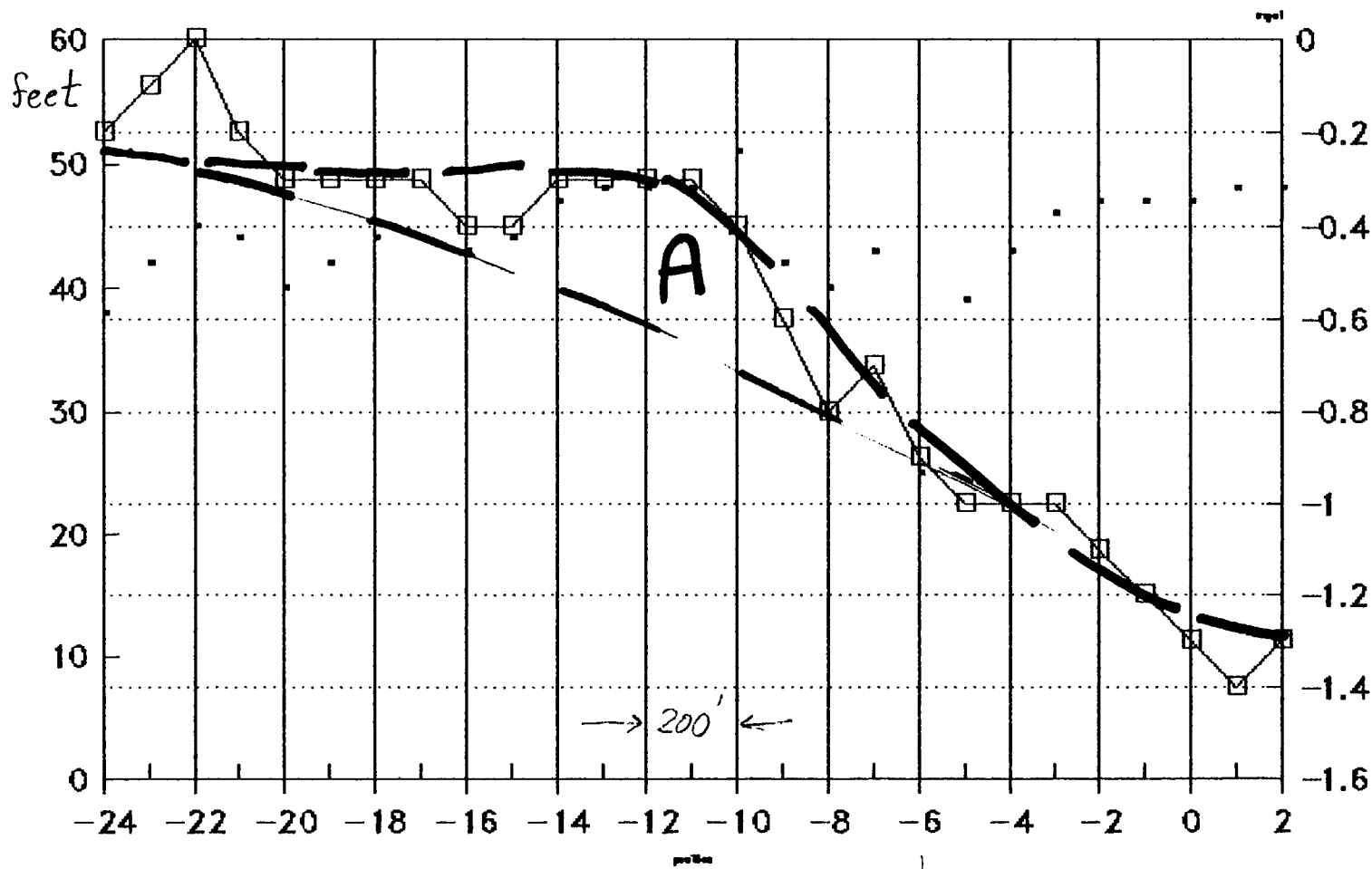

Figure 1

Bauguer gravity profile Line Bw



• elevation □ gravity

Figure 2

4100-

300m high density zone is centred between lines 8w and 12w about 400m south of the road. Estimated depth to the zone is about 100m.

3.3 Fault

A west to east drop off in gravity suggests that a NNW-trending fault (F) is located between lines 4w and 8w.

4. Recommendations

Anomaly A is prospective for either base metals (massive sulfides deposit) or gold exploration. It is recommended that it be tested by drilling. Recommended drill hole locations are

- (a) the centre of the anomaly at line 12w, 350m south of the logging road
- (b) the north contact of the zone to test for gold mineralization in this contact or transition zone.

Respectfully submitted,

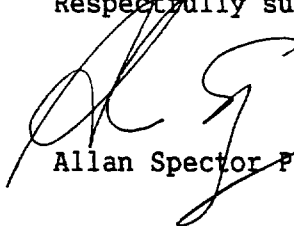

Allan Spector Ph.D.

May 10, 1998

GRAVITY SURVEY PRINCIPAL FACTS

| stn | elevation | east | north | gravity | |
|-----|-----------|--------|---------|---------|-----|
| 0 | 50. | 529.32 | 5393.35 | -1.4 | 12W |
| -1 | 48. | 529.32 | 5393.32 | -1.3 | |
| -2 | 49. | 529.32 | 5393.29 | -1.2 | |
| -3 | 51. | 529.32 | 5393.26 | -.9 | |
| -4 | 46. | 529.32 | 5393.23 | -.7 | |
| -5 | 52. | 529.32 | 5393.20 | -.5 | |
| -6 | 51. | 529.32 | 5393.17 | -.5 | |
| -7 | 50. | 529.32 | 5393.14 | -.6 | |
| -8 | 47. | 529.32 | 5393.11 | -.6 | |
| -9 | 48. | 529.32 | 5393.08 | -.4 | |
| -10 | 50. | 529.32 | 5393.05 | -.2 | |
| -11 | 48. | 529.32 | 5393.02 | -.3 | |
| -12 | 49. | 529.32 | 5392.99 | -.1 | |
| -13 | 45. | 529.32 | 5392.96 | -.2 | |
| -14 | 44. | 529.32 | 5392.93 | -.3 | |
| -15 | 42. | 529.32 | 5392.90 | -.4 | |
| -16 | 41. | 529.32 | 5392.87 | -.3 | |
| -17 | 40. | 529.32 | 5392.86 | -.3 | |
| -18 | 38. | 529.32 | 5392.84 | -.4 | |
| -19 | 36. | 529.32 | 5392.81 | -.5 | |
| -20 | 39. | 529.32 | 5392.78 | -.3 | |
| -21 | 40. | 529.32 | 5392.75 | -.3 | |
| -22 | 41. | 529.32 | 5392.72 | .0 | |
| -23 | 41. | 529.32 | 5392.69 | -.1 | |
| -24 | 35. | 529.32 | 5392.66 | -.3 | |
| -24 | 38. | 529.49 | 5392.59 | -.2 | 8W |
| -23 | 42. | 529.49 | 5392.62 | -.1 | |
| -22 | 45. | 529.49 | 5392.65 | .0 | |
| -21 | 44. | 529.49 | 5392.68 | -.2 | |
| -20 | 40. | 529.49 | 5392.71 | -.3 | |
| -19 | 42. | 529.49 | 5392.74 | -.3 | |
| -18 | 44. | 529.49 | 5392.77 | -.3 | |
| -17 | 44. | 529.49 | 5392.80 | -.3 | |
| -16 | 43. | 529.49 | 5392.83 | -.4 | |
| -15 | 44. | 529.49 | 5392.86 | -.4 | |
| -14 | 47. | 529.49 | 5392.90 | -.1 | |
| -13 | 48. | 529.49 | 5392.93 | -.3 | |
| -12 | 48. | 529.49 | 5392.96 | -.3 | |
| -11 | 48. | 529.49 | 5392.99 | -.3 | |
| -10 | 51. | 529.49 | 5393.02 | -.1 | |
| -9 | 42. | 529.49 | 5393.05 | -.6 | |
| -8 | 40. | 529.49 | 5393.08 | -.8 | |
| -7 | 43. | 529.49 | 5393.11 | -.7 | |
| -6 | 25. | 529.49 | 5393.14 | -1.6 | |
| -5 | 39. | 529.49 | 5393.17 | -1.0 | |
| -4 | 43. | 529.49 | 5393.20 | -1.0 | |
| -3 | 46. | 529.49 | 5393.23 | -1.0 | |
| -2 | 47. | 529.49 | 5393.26 | -1.1 | |
| -1 | 47. | 529.49 | 5393.29 | -1.2 | |
| 0 | 47. | 529.49 | 5393.32 | -1.3 | |
| 1 | 48. | 529.49 | 5393.35 | -1.4 | |

| | | | | | |
|-----|-----|--------|---------|------|-----|
| 2 | 48. | 529.48 | 5393.38 | -1.3 | |
| 0 | 46. | 529.65 | 5393.39 | -1.7 | 4W |
| -1 | 35. | 529.65 | 5393.36 | -1.5 | |
| -2 | 41. | 529.64 | 5393.33 | -1.6 | |
| -3 | 41. | 529.64 | 5393.30 | -1.5 | |
| -4 | 41. | 529.64 | 5393.27 | -1.5 | |
| -5 | 38. | 529.64 | 5393.24 | -1.6 | |
| -6 | 38. | 529.64 | 5393.23 | -1.4 | |
| -7 | 35. | 529.64 | 5393.20 | -1.6 | |
| -8 | 21. | 529.63 | 5393.17 | -1.5 | |
| -9 | -5. | 529.63 | 5393.14 | -1.3 | |
| -10 | 22. | 529.63 | 5393.11 | -1.5 | |
| -11 | 33. | 529.63 | 5393.08 | -1.4 | |
| -12 | 38. | 529.63 | 5393.05 | -1.0 | |
| -13 | 40. | 529.63 | 5393.02 | -.9 | |
| -14 | 41. | 529.62 | 5392.99 | -.8 | |
| -15 | 42. | 529.66 | 5392.96 | -.7 | |
| -16 | 44. | 529.66 | 5392.93 | -.6 | |
| -17 | 43. | 529.66 | 5392.90 | -.6 | |
| -18 | 42. | 529.66 | 5392.87 | -.6 | |
| -19 | 37. | 529.66 | 5392.84 | -.8 | |
| -20 | 29. | 529.66 | 5392.79 | -.8 | |
| -21 | 32. | 529.65 | 5392.75 | -.8 | |
| -22 | 31. | 529.65 | 5392.72 | -.9 | |
| -23 | 33. | 529.65 | 5392.69 | -.9 | |
| -24 | 36. | 529.65 | 5392.66 | -.8 | |
| -25 | 39. | 529.64 | 5392.63 | -.6 | |
| -26 | 38. | 529.64 | 5392.60 | -.5 | |
| -27 | 36. | 529.64 | 5392.57 | -.6 | |
| -28 | 39. | 529.63 | 5392.54 | -.4 | |
| -28 | 39. | 529.80 | 5392.58 | -.6 | OW |
| -27 | 37. | 529.80 | 5392.61 | -.7 | |
| -26 | 36. | 529.80 | 5392.64 | -.9 | |
| -25 | 36. | 529.80 | 5392.67 | -.9 | |
| -24 | 35. | 529.80 | 5392.70 | -1.0 | |
| -23 | 35. | 529.80 | 5392.73 | -1.0 | |
| -22 | 32. | 529.79 | 5392.76 | -1.0 | |
| -21 | 7. | 529.79 | 5392.79 | -.6 | |
| -20 | 28. | 529.79 | 5392.82 | -.9 | |
| -19 | 34. | 529.79 | 5392.85 | -.9 | |
| -18 | 37. | 529.79 | 5392.88 | -.9 | |
| -17 | 39. | 529.79 | 5392.91 | -.7 | |
| -16 | 40. | 529.79 | 5392.94 | -.6 | |
| -15 | 40. | 529.79 | 5392.97 | -.7 | |
| -14 | 36. | 529.79 | 5393.00 | -1.0 | |
| -13 | 36. | 529.79 | 5393.02 | -1.1 | |
| 100 | 57. | 529.97 | 5393.38 | -.9 | |
| 0 | 43. | 529.81 | 5393.40 | -1.6 | |
| 0 | 52. | 529.17 | 5393.32 | -1.0 | 16W |
| -1 | 49. | 529.17 | 5393.29 | -1.0 | |
| -2 | 47. | 529.17 | 5393.26 | -1.0 | |
| -3 | 50. | 529.17 | 5393.23 | -.8 | |
| -4 | 50. | 529.17 | 5393.20 | -.8 | |
| -5 | 48. | 529.18 | 5393.17 | -.7 | |

| | | | | | |
|-----|-----|--------|---------|------|-----|
| -6 | 50. | 529.17 | 5393.15 | -.5 | |
| -7 | 51. | 529.18 | 5393.13 | -.4 | |
| -8 | 49. | 529.18 | 5393.11 | -.4 | |
| -9 | 46. | 529.18 | 5393.10 | -.6 | |
| -10 | 45. | 529.18 | 5393.08 | -.4 | |
| -11 | 43. | 529.18 | 5393.05 | -.4 | |
| -12 | 43. | 529.18 | 5393.02 | -.4 | |
| -13 | 43. | 529.18 | 5392.99 | -.3 | |
| -14 | 40. | 529.18 | 5392.96 | -.5 | |
| -15 | 38. | 529.18 | 5392.93 | -.6 | |
| -16 | 36. | 529.18 | 5392.90 | -.5 | |
| -17 | 35. | 529.18 | 5392.86 | -.4 | |
| -18 | 39. | 529.18 | 5392.83 | -.2 | |
| -19 | 40. | 529.18 | 5392.80 | -.1 | |
| -20 | 38. | 529.18 | 5392.77 | -.2 | |
| -21 | 39. | 529.18 | 5392.74 | -.2 | |
| -21 | 37. | 529.05 | 5392.70 | -.1 | 20W |
| -20 | 37. | 529.04 | 5392.73 | -.1 | |
| -19 | 36. | 529.04 | 5392.77 | -.2 | |
| -18 | 36. | 529.04 | 5392.81 | -.4 | |
| -17 | 36. | 529.04 | 5392.84 | -.3 | |
| -16 | 34. | 529.04 | 5392.89 | -.5 | |
| -15 | 29. | 529.04 | 5392.93 | -.5 | |
| -14 | 36. | 529.05 | 5392.97 | -.5 | |
| -13 | 35. | 529.05 | 5393.00 | -.7 | |
| -12 | 39. | 529.05 | 5393.03 | -.6 | |
| -11 | 40. | 529.05 | 5393.07 | -.6 | |
| -10 | 42. | 529.05 | 5393.10 | -.6 | |
| -9 | 42. | 529.05 | 5393.13 | -.7 | |
| -8 | 44. | 529.05 | 5393.17 | -.7 | |
| -7 | 45. | 529.05 | 5393.20 | -.7 | |
| -6 | 46. | 529.05 | 5393.23 | -.8 | |
| -5 | 45. | 529.05 | 5393.26 | -1.0 | |
| -4 | 44. | 529.05 | 5393.29 | -1.1 | |
| -3 | 47. | 529.05 | 5393.32 | -1.1 | |
| -2 | 46. | 529.05 | 5393.35 | -1.2 | |
| 0 | 50. | 528.90 | 5393.30 | -.8 | 24W |
| -1 | 50. | 528.90 | 5393.27 | -.8 | |
| -2 | 53. | 528.90 | 5393.24 | -.5 | |
| -3 | 50. | 528.90 | 5393.21 | -.4 | |
| -4 | 47. | 528.90 | 5393.18 | -.4 | |
| -5 | 46. | 528.90 | 5393.16 | -.2 | |
| -6 | 43. | 528.90 | 5393.13 | -.2 | |
| -7 | 41. | 528.90 | 5393.10 | -.3 | |
| -8 | 44. | 528.90 | 5393.08 | -.3 | |
| -9 | 44. | 528.90 | 5393.05 | -.2 | |
| -10 | 42. | 528.90 | 5393.03 | -.2 | |
| -11 | 40. | 528.90 | 5393.00 | -.2 | |
| -12 | 37. | 528.90 | 5392.97 | -.3 | |

2. 18542

RECEIVED
SEP - 3 1998
GEOSCIENCE ASSESSMENT
OFFICE

① — GRAVITY SURVEY —

COSBY CLAIMS

TRANSACTION NUMBER W9880.00917

FIRST CLAIMS NUMBER 1260339

- 1 CLAIMS MAPS
- 1 MAPS ACCESS ROUTE
- 1 KEY MAPS LAND SURVED
- 1 SUMMARY OF EXPLORATION & DEVELOPMENT

COSBY CLAIMS

GRAVITY SURVEY —
make Cosby



III - LOCATION & ACCESSIBILITY:

9. 18542

The claim group is located in the northern part of Walker Twp., Ontario, i.e. on parts of lots 5 and 6, concession V, Larder Lake Mining Division.

The property lies at an approximate distance of 9 kilometers southeast of the town of Iroquois Falls, 5 kilometers east of highway 577 and 8 kilometers northeast of trans-Canada highway 11.

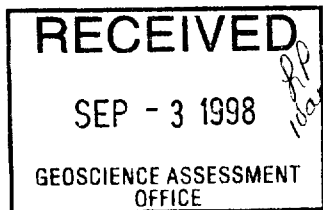

A range road (V-VI) leads eastward from the town of Iroquois Falls to the shores of the Black River. The claim group may be reached by following, by boat,

SERVICES EXPLORATION ENRG.

- 2 -

the river in a southeasterly direction for an approximate distance of one half mile.

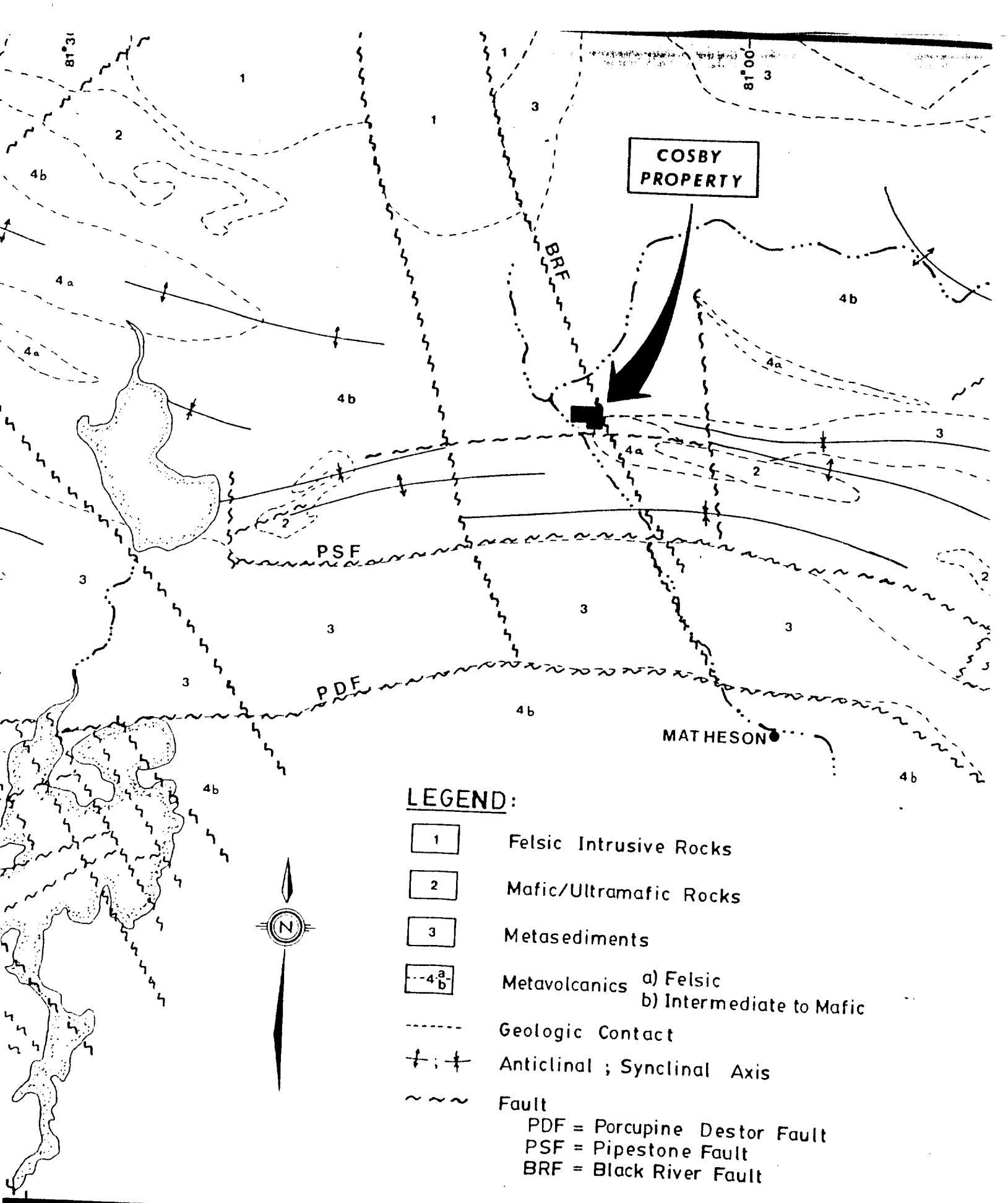

LEGEND:

- 1 Felsic Intrusive Rocks
- 2 Mafic/Ultramafic Rocks
- 3 Metasediments
- 4^a Metavolcanics a) Felsic
- 4^b b) Intermediate to Mafic
- Geologic Contact
- + ; + Anticlinal ; Synclinal Axis
- ~~~~~ Fault
- PDF = Porcupine Destor Fault
- PSF = Pipestone Fault
- BRF = Black River Fault

Knox
346.9 m

29 m/s

FALLS

WILKIE

COLESON

BOST
ROAD

CARR

BENITY

Matheson

BOWMAN

HISLOP

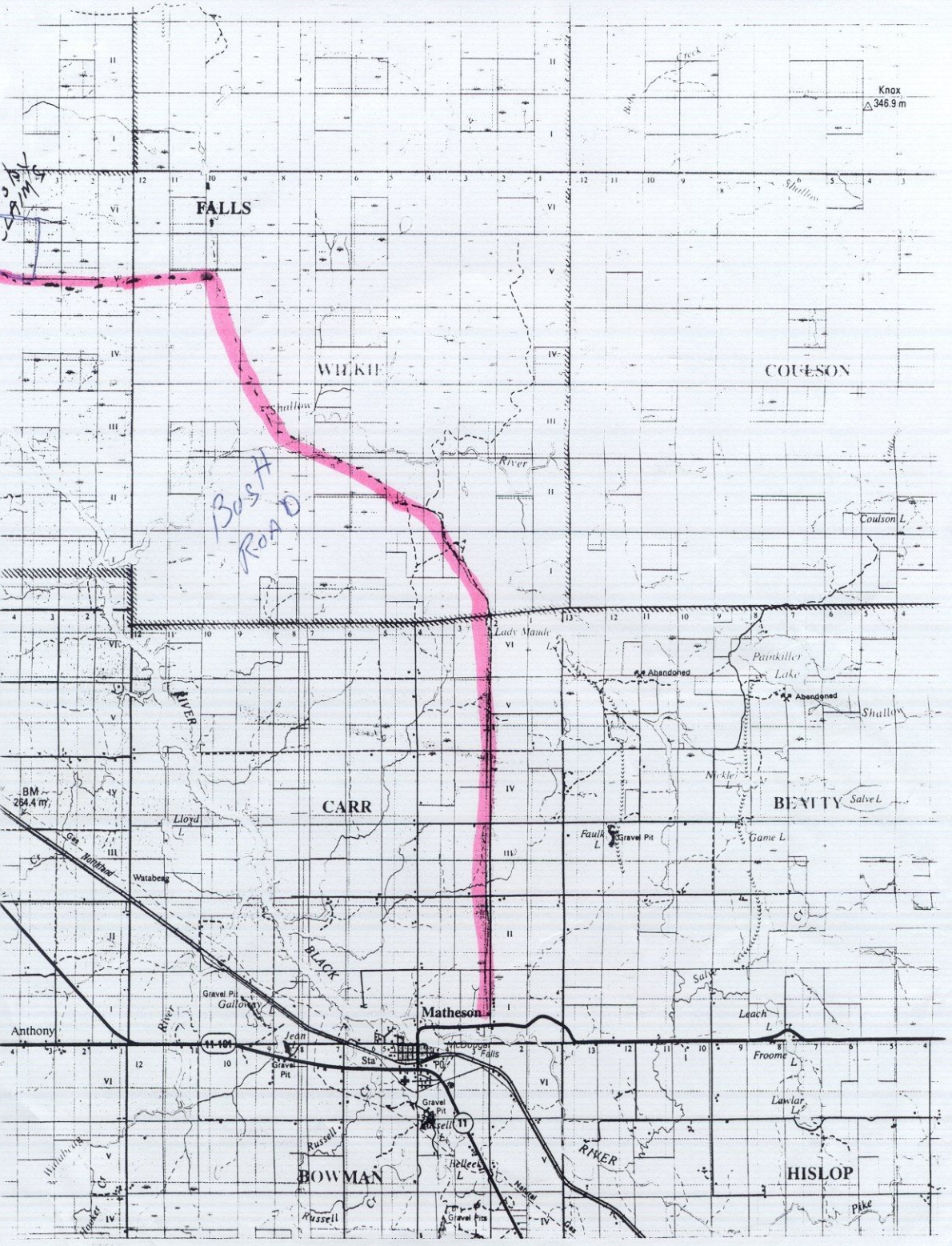

Claim No: L 1140855
 Status: Active

Due Date: 1998-SEP-17 | Recorded: 1990-SEP-17
 Work Required: 303 | Staked: 1990-SEP-05 16:20

| | | |
|--------------------------|-------|-------------------------------|
| Total Work: | 2,497 | Description of Claim: |
| Total Reserve: | 0 | WALKER (M-0396) |
| Present Work Assignment: | 0 | NE 1/4 OF S 1/2 LOT 5 CONC. 5 |
| Claim Bank: | 0 | Claim Units: 1 |
| | | Multiple Township: N |

Claim Ownership

| | | |
|------------|---------|---------------------|
| Percentage | Client# | Recorded Holder(s) |
| 100.00 | 121174 | COSBY MERLE STEWART |

| Type | Date | Dollars | Description | |
|--------|-------------|---------|--|-------------|
| STAKER | 1990-SEP-17 | | RECORDED BY BUTLER PETER FRANCIS (A50620) FILE NUMBER: R900800628 | R9080.03678 |
| TRAN | 1990-NOV-13 | | PETER FRANCIS BUTLER (A50620) TRANSFERS 100.00 % TO MERLE STEWART COSBY (K15600) FILE NUMBER: T900800640 | T9080.02718 |
| MISC | 1991-JUN-03 | | 0.00 DAYS CONVERTED TO DOLLARS | X9180.01075 |
| MISC | 1991-JUN-03 | | \$0 CONVERTED WORK APPLIED TO THIS CLAIM | X9180.01747 |
| OTHER | 1992-AUG-05 | | GEOTECHNICAL WORK PERFORMED: 400 APPROVED: 1992-NOV-18 | Q9280.00182 |
| WORK | 1992-AUG-05 | 400 | GEOTECHNICAL WORK APPLIED APPROVED: 1992-NOV-18 | W9280.00182 |
| ORDER | 1993-AUG-24 | | RECORDER EXTENDS TIME UNTIL AND INCLUDING 1994-MAY-31 FOR WORK AND FILING THEREOF. | D9380.00098 |
| OTHER | 1994-MAY-26 | | GEOTECHNICAL WORK PERFORMED: 1457 APPROVED: 1994-OCT-11 | Q9480.00326 |
| WORK | 1994-MAY-26 | 1,457 | GEOTECHNICAL WORK APPLIED APPROVED: 1994-OCT-11 | W9480.00326 |
| OTHER | 1995-NOV-03 | | GEOTECHNICAL WORK PERFORMED: 693 APPROVED: 1996-APR-02 (Previously: 826) | Q9580.00747 |
| WORK | 1995-NOV-03 | 640 | GEOTECHNICAL WORK APPLIED APPROVED: 1996-APR-02 (Previously: 826) | W9580.00747 |

Status of claim is based on information currently on record.

Claim No: L 1140855
Status: Active

| Type | Date | Dollars | Description |
|------|-------------|---------|---------------------|
| WORK | 1998-MAY-21 | | WORK REPORT PENDING |

W9880.00317

-
- Reservation :
- 01 400' surface rights reservation around all lakes and rivers
 - 02 Sand and gravel reserved
 - 03 Peat reserved
 - 04 Other reservations under the Mining Act may apply
 - 05 Including land under water

*** End of Abstract ***

Claim No: L 1140854
Status: Active

Due Date: 1998-SEP-17
Work Required: 302
Recorded: 1990-SEP-17
Staked: 1990-SEP-05 14:15

Total Work: 2,498
Total Reserve: 0
Present Work Assignment: 0
Claim Bank: 0
Description of Claim:
WALKER (M-0396)
NW 1/4 OF S 1/2 LOT 5 CONC. 5
Claim Units: 1
Multiple Township: N

Claim Ownership

| Percentage | Client# | Recorded Holder(s) |
|------------|---------|---------------------|
| 100.00 | 121174 | COSBY MERLE STEWART |

| Type | Date | Dollars | Description | |
|--------|-------------|---------|---|-------------|
| STAKER | 1990-SEP-17 | | RECORDED BY BUTLER PETER FRANCIS (A50620) FILE NUMBER: R900800628 | R9080.03678 |
| TRAN | 1990-NOV-13 | | PETER FRANCIS BUTLER (A50620) TRANSFERS 100.00 % TO MERLE STEWART COSBY (K15600) FILE NUMBER: T900800640 | T9080.02718 |
| MISC | 1991-JUN-03 | | 0.00 DAYS CONVERTED TO DOLLARS | X9180.01075 |
| MISC | 1991-JUN-03 | | \$0 CONVERTED WORK APPLIED TO THIS CLAIM | X9180.01747 |
| OTHER | 1992-AUG-05 | | GEOTECHNICAL WORK PERFORMED: 400 APPROVED: 1992-NOV-18 | Q9280.00182 |
| WORK | 1992-AUG-05 | 400 | GEOTECHNICAL WORK APPLIED APPROVED: 1992-NOV-18 | W9280.00182 |
| ORDER | 1993-AUG-24 | | RECORDER EXTENDS TIME UNTIL AND INCLUDING 1994-MAY-31 FOR WORK AND FILING THEREOF. | D9380.00098 |
| OTHER | 1994-MAY-26 | | GEOTECHNICAL WORK PERFORMED: 1458 APPROVED: 1994-OCT-11 | Q9480.00326 |
| WORK | 1994-MAY-26 | 1,458 | GEOTECHNICAL WORK APPLIED APPROVED: 1994-OCT-11 | W9480.00326 |
| OTHER | 1995-NOV-03 | | GEOTECHNICAL WORK PERFORMED: 694 APPROVED: 1996-APR-02 (Previously: 829) | Q9580.00747 |
| WORK | 1995-NOV-03 | 640 | GEOTECHNICAL WORK APPLIED APPROVED: 1996-APR-02 (Previously: 829) | W9580.00747 |

Status of claim is based on information currently on record.

Claim No: L 1140854
Status: Active

| Type | Date | Dollars | Description |
|------|-------------|---------|---------------------|
| WORK | 1998-MAY-21 | | WORK REPORT PENDING |

W9880.00317

Reservation :

01 400' surface rights reservation around all lakes and rivers
02 Sand and gravel reserved
03 Peat reserved
04 Other reservations under the Mining Act may apply

*** End of Abstract ***

Status of claim is based on information currently on record.

Claim No: L 1140851
 Status: Active

Due Date: 1998-SEP-17
 Work Required: 302

Recorded: 1990-SEP-17
 Staked: 1990-SEP-05 07:20

Total Work: 2,498
 Total Reserve: 0
 Present Work Assignment: 0
 Claim Bank: 0

Description of Claim:
 WALKER (M-0396)
 SW 1/4 OF N 1/2 LOT 5 CONC. 5
 Claim Units: 1
 Multiple Township: N

 Claim Ownership

| Percentage | Client# | Recorded Holder(s) |
|------------|---------|---------------------|
| 100.00 | 121174 | COSBY MERLE STEWART |

| Type | Date | Dollars | Description | |
|--------|-------------|---------|--|-------------|
| STAKER | 1990-SEP-17 | | RECORDED BY BUTLER PETER FRANCIS (A50620) FILE NUMBER: R900800628 | R9080.03678 |
| TRAN | 1990-NOV-13 | | PETER FRANCIS BUTLER (A50620) TRANSFERS 100.00 % TO MERLE STEWART COSBY (K15600) FILE NUMBER: T900800640 | T9080.02718 |
| MISC | 1991-JUN-03 | | \$0 CONVERTED WORK APPLIED TO THIS CLAIM | X9180.01747 |
| MISC | 1991-JUN-03 | | 0.00 DAYS CONVERTED TO DOLLARS | X9180.01075 |
| OTHER | 1992-AUG-05 | | GEOTECHNICAL WORK PERFORMED: 400 APPROVED: 1992-NOV-18 | Q9280.00182 |
| WORK | 1992-AUG-05 | 400 | GEOTECHNICAL WORK APPLIED APPROVED: 1992-NOV-18 | W9280.00182 |
| ORDER | 1993-AUG-24 | | RECORDER EXTENDS TIME UNTIL AND INCLUDING 1994-MAY-31 FOR WORK AND FILING THEREOF. | D9380.00098 |
| OTHER | 1994-MAY-26 | | GEOTECHNICAL WORK PERFORMED: 1458 APPROVED: 1994-OCT-11 | Q9480.00326 |
| WORK | 1994-MAY-26 | 1,458 | GEOTECHNICAL WORK APPLIED APPROVED: 1994-OCT-11 | W9480.00326 |
| OTHER | 1995-NOV-03 | | GEOTECHNICAL WORK PERFORMED: 694 APPROVED: 1996-APR-02 (Previously: 829) | Q9580.00747 |
| WORK | 1995-NOV-03 | 640 | GEOTECHNICAL WORK APPLIED APPROVED: 1996-APR-02 (Previously: 829) | W9580.00747 |

Status of claim is based on information currently on record.

LARDER LAKE
CLAIM ABSTRACT

Claim No: L 1140851
Status: Active

| Type | Date | Dollars | Description |
|------|-------------|---------|---------------------|
| WORK | 1998-MAY-21 | | WORK REPORT PENDING |

W9880.00317

Reservation :

01 400' surface rights reservation around all lakes and rivers
02 Sand and gravel reserved
03 Peat reserved
04 Other reservations under the Mining Act may apply

*** End of Abstract ***

Status of claim is based on information currently on record.

Claim No: L 1140855
Status: Active

Due Date: 1998-SEP-17
Work Required: 303

Recorded: 1990-SEP-17
Staked: 1990-SEP-05 16:20

Total Work: 2,497
Total Reserve: 0
Present Work Assignment: 0
Claim Bank: 0

Description of Claim:
WALKER (M-0396)
NE 1/4 OF S 1/2 LOT 5 CONC. 5
Claim Units: 1
Multiple Township: N

Claim Ownership

| Percentage | Client# | Recorded Holder(s) |
|------------|---------|---------------------|
| 100.00 | 121174 | COSBY MERLE STEWART |

| Type | Date | Dollars | Description | |
|--------|-------------|---------|---|-------------|
| STAKER | 1990-SEP-17 | | RECORDED BY BUTLER PETER FRANCIS (A50620) FILE NUMBER: R900800628 | R9080.03678 |
| TRAN | 1990-NOV-13 | | PETER FRANCIS BUTLER (A50620) TRANSFERS 100.00 % TO MERLE STEWART COSBY (K15600) FILE NUMBER: T900800640 | T9080.02718 |
| MISC | 1991-JUN-03 | 0.00 | DAYS CONVERTED TO DOLLARS | X9180.01075 |
| MISC | 1991-JUN-03 | | \$0 CONVERTED WORK APPLIED TO THIS CLAIM | X9180.01747 |
| OTHER | 1992-AUG-05 | | GEOTECHNICAL WORK PERFORMED: 400 APPROVED: 1992-NOV-18 | Q9280.00182 |
| WORK | 1992-AUG-05 | 400 | GEOTECHNICAL WORK APPLIED APPROVED: 1992-NOV-18 | W9280.00182 |
| ORDER | 1993-AUG-24 | | RECORDER EXTENDS TIME UNTIL AND INCLUDING 1994-MAY-31 FOR WORK AND FILING THEREOF. | D9380.00098 |
| OTHER | 1994-MAY-26 | | GEOTECHNICAL WORK PERFORMED: 1457 APPROVED: 1994-OCT-11 | Q9480.00326 |
| WORK | 1994-MAY-26 | 1,457 | GEOTECHNICAL WORK APPLIED APPROVED: 1994-OCT-11 | W9480.00326 |
| OTHER | 1995-NOV-03 | | GEOTECHNICAL WORK PERFORMED: 693 APPROVED: 1996-APR-02 (Previously: 826) | Q9580.00747 |
| WORK | 1995-NOV-03 | 640 | GEOTECHNICAL WORK APPLIED APPROVED: 1996-APR-02 (Previously: 826) | W9580.00747 |

Status of claim is based on information currently on record.

Claim No: L 1140855
Status: Active

| Type | Date | Dollars | Description |
|------|-------------|---------|---------------------|
| WORK | 1998-MAY-21 | | WORK REPORT PENDING |

W9880.00317

-
- Reservation :
- 01 400' surface rights reservation around all lakes and rivers
 - 02 Sand and gravel reserved
 - 03 Peat reserved
 - 04 Other reservations under the Mining Act may apply
 - 05 Including land under water

*** End of Abstract ***

Claim No: L 1200338
Status: Active

Due Date: 1998-JUL-31 E
Work Required: 800

Recorded: 1993-NOV-05
Staked: 1993-OCT-13 11:00

Total Work: 800
Total Reserve: 0
Present Work Assignment: 0
Claim Bank: 0

Description of Claim:
WALKER (M-0396)
NE1/4 OF N1/2 LOT 5 CON 5
Claim Units: 1
Multiple Township: N

Claim Ownership

| Percentage | Client# | Recorded Holder(s) |
|------------|---------|---------------------|
| 100.00 | 121174 | COSBY MERLE STEWART |

| Type | Date | Dollars | Description | |
|--------|-------------|---------|--|-------------|
| STAKER | 1993-NOV-05 | | RECORDED BY COSBY MERLE STEWART (K15600) | R9380.00879 |
| ORDER | 1995-OCT-19 | | RECORDER EXTENDS TIME UNTIL AND INCLUDING 1996-JAN-05 FOR WORK AND FILING THEREOF. | D9580.00250 |
| OTHER | 1995-NOV-03 | | GEOTECHNICAL WORK PERFORMED: 694 APPROVED: 1996-APR-02 (Previously: 829) | Q9580.00747 |
| WORK | 1995-NOV-03 | 800 | GEOTECHNICAL WORK APPLIED APPROVED: 1996-APR-02 (Previously: 829) | W9580.00747 |
| ORDER | 1997-OCT-03 | | RECORDER EXTENDS TIME UNTIL AND INCLUDING 1998-JUL-31 FOR WORK AND FILING THEREOF. | D9780.00105 |
| WORK | 1998-MAY-21 | | WORK REPORT PENDING | W9880.00317 |

Reservation :

01 400' surface rights reservation around all lakes and rivers
02 Sand and gravel reserved
03 Peat reserved
04 Other reservations under the Mining Act may apply

*** End of Abstract ***

Status of claim is based on information currently on record.

Claim No: L 1200338
Status: Active

Due Date: 1998-JUL-31 E | Recorded: 1993-NOV-05
Work Required: 800 | Staked: 1993-OCT-13 11:00

Total Work: 800 | Description of Claim:
Total Reserve: 0 | WALKER (M-0396)
Present Work Assignment: 0 | NE1/4 OF N1/2 LOT 5 CON 5
Claim Bank: 0 | Claim Units: 1
Multiple Township: N

Claim Ownership

Percentage Client# Recorded Holder(s)
100.00 121174 COSBY MERLE STEWART

| Type | Date | Dollars | Description | |
|--------|-------------|---------|--|-------------|
| STAKER | 1993-NOV-05 | | RECORDED BY COSBY MERLE STEWART (K15600) | R9380.00879 |
| ORDER | 1995-OCT-19 | | RECORDER EXTENDS TIME UNTIL AND INCLUDING 1996-JAN-05 FOR WORK AND FILING THEREOF. | D9580.00250 |
| OTHER | 1995-NOV-03 | | GEOTECHNICAL WORK PERFORMED: 694 APPROVED: 1996-APR-02 (Previously: 829) | Q9580.00747 |
| WORK | 1995-NOV-03 | 800 | GEOTECHNICAL WORK APPLIED APPROVED: 1996-APR-02 (Previously: 829) | W9580.00747 |
| ORDER | 1997-OCT-03 | | RECORDER EXTENDS TIME UNTIL AND INCLUDING 1998-JUL-31 FOR WORK AND FILING THEREOF. | D9780.00105 |
| WORK | 1998-MAY-21 | | WORK REPORT PENDING | W9880.00317 |

Reservation :

01 400' surface rights reservation around all lakes and rivers
02 Sand and gravel reserved
03 Peat reserved
04 Other reservations under the Mining Act may apply

*** End of Abstract ***

Status of claim is based on information currently on record.

Report of Work Conducted After Recording Claim

Transaction Number
W9880.00317

Mining Act



of the Mining Act. This information will be used for correspondence. Questions about is, Ministry of Northern Development and Mines, Fourth Floor, 159 Cedar Street,

42A10NE2004 2.18542 WALKER

900 te.

2.18542

- Refer to the Mining Act and Regulations for requirements of filing assessment work or consult the Mining Recorder.
- A separate copy of this form must be completed for each Work Group.
- Technical reports and maps must accompany this form in duplicate.
- A sketch, showing the claims the work is assigned to, must accompany this form.

| | | |
|---|------------------------------------|-------------------------------------|
| Recorded Holder(s) MERLE S COSBY | | Client No. |
| Address 13 WINDERMERE RD. ST. CATHARINES ONT L2T3W1 | | Telephone No. 905.6847953 |
| Mining Division LARDER LAKE | Township/Area WALKER TWP | M or G Plan No. |
| Dates Work Performed From: MAY 6/98 | | To: MAY 10/98 |

Work Performed (Check One Work Group Only)

| Work Group | Type |
|--|-----------------------|
| <input checked="" type="checkbox"/> Geotechnical Survey | GRAVITY SURVEY |
| <input type="checkbox"/> Physical Work, Including Drilling | |
| <input type="checkbox"/> Rehabilitation | |
| <input type="checkbox"/> Other Authorized Work | |
| <input type="checkbox"/> Assays | |
| <input type="checkbox"/> Assignment from Reserve | |

Total Assessment Work Claimed on the Attached Statement of Costs \$ **16,607** / **15,607 LP.**

Note: The Minister may reject for assessment work credit all or part of the assessment work submitted if the recorded holder cannot verify expenditures claimed in the statement of costs within 30 days of a request for verification.

Persons and Survey Company Who Performed the Work (Give Name and Address of Author of Report)

| Name | Address |
|---|---|
| ALLAN SPECTOR AND ASSOCIATES LTD | TORONTO CANADA M5N 2S7 |
| RON BASEMENT | NIAGARA FALLS |
| RICHARD COSBY | 6 CHETWOOD ST ST. CATHARINES ONT |
| MERLE S COSBY | 13 WINDERMERE RD ST. CATHARINES ONT L2T3W1 |

(attach a schedule if necessary)

Certification of Beneficial Interest * See Note No. 1 on reverse side

| | | |
|--|--------------------------|--|
| I certify that at the time the work was performed, the claims covered in this work report were recorded in the current holder's name or held under a beneficial interest by the current recorded holder. | Date MAY 14/98 | Recorded Holder or Agent (Signature) Merle S Cosby |
|--|--------------------------|--|

Certification of Work Report

| | | |
|---|--------------------------|--|
| I certify that I have a personal knowledge of the facts set forth in this Work report, having performed the work or witnessed same during and/or after its completion and annexed report is true. | | |
| Name and Address of Person Certifying MERLE S COSBY 13 WINDERMERE RD ST. CATHARINES ONT L2T3W1 | | |
| Telephone No. 905.6847953 | Date MAY 14/98 | Certified By (Signature) Merle S Cosby |

For Office Use Only

| | | | |
|---------------------------------|---------------|-------------------------------------|---|
| Total Value Cr. Recorded | Date Recorded | Mining Recorder | Received Stamp |
| | | | RECEIVED LARDER LAKE MINING DIVISION |
| Deemed Approval Date | Date Approved | | MAY 19 1998 |
| | | 10:03 AM GCS | 7:45 LP |
| Date Notice for Amendments Sent | | GEOSCIENCE ASSESSMENT OFFICE | Required by mail |

Received by mail

| Work Report Number for Applying Reserve | Claim Number (see Note 2) | Number of Claim Units |
|---|---------------------------|-----------------------|
| | 1260339 | 1 |
| | 1260338 | 1 |
| | 1140851 | 1 |
| | 1140850 | 1 |
| | 1140854 | 1 |
| | 1140855 | 1 |
| Total Number of Claims | | 6 |

Amendments

| Value of Assessment Work Done on this Claim | Value Applied to this Claim |
|---|-----------------------------|
| 24000mc | 2406mc |
| 24000mc | 2400mc |
| 1902 | 19021 |
| 1906 | 19001 |
| 1902 | 19021 |
| 1905 | 19031 |
| Total Value Work Done | |
| Total Value Work Applied | |

RECEIVED
 JUN 01 1998
 9:4768
 GEOSCIENCE ASSESSMENT OFFICE

| Value Assigned from this Claim | Reserve: Work to be Claimed at a Future Date |
|--------------------------------|--|
| | 1660mc |
| | 1600mc |
| Total Assigned From | |
| Total Reserve | |

RECEIVED
 MAY 21 1998
 GEOSCIENCE ASSESSMENT OFFICE

Credits you are claiming in this report may be cut back. In order to minimize the adverse effects of such deletions, please indicate from which claims you wish to prioritize the deletion of credits. Please mark (✓) one of the following:

- Credits are to be cut back starting with the claim listed last, working backwards.
- Credits are to be cut back equally over all claims contained in this report of work.
- Credits are to be cut back as prioritized on the attached appendix.

In the event that you have not specified your choice of priority, option one will be implemented.

Note 1: Examples of beneficial interest are unrecorded transfers, option agreements, memorandum of agreements, etc., with respect to the mining claims.

Note 2: If work has been performed on patented or leased land, please complete the following:

| | | |
|---|-----------|------|
| I certify that the recorded holder had a beneficial interest in the patented or leased land at the time the work was performed. | Signature | Date |
|---|-----------|------|

MAY 98

Cosby CLAIMS WALKER TWP
COST FOR LINE CUTTING & CHAINING

MERLE Cosby ROW BASEMENT RICHARD Cosby

8 LINE 2600' LONG = 20800'
3 MEN CUT & CHAIN COST PER MAN \$5546.66
EACH
AT A COST OF \$80 PER FOOT = \$5546.66
3 MEN = \$16640.00

ALLAN SPECTOR AND ASSOCIATES LTD
TORONTO MAY 98 CANADA
COST OF GRAVITY SURVEY \$2675 ÷ 6
= \$445.83 PER CLAIM

MERLE Cosby PROJECT MANAGER
COST \$600.00 ÷ 6 = \$100 PER CLAIM

COST OF Cosby PROJECT \$16672.75

ASSESSMENT CREDIT APPLY TO CLAIMS

- CLAIM # 1200339 \$4000
- 1200338 \$4000
- 1140850 \$1900
- 1140851 \$1902
- 1140854 \$1902
- 1140855 \$1903

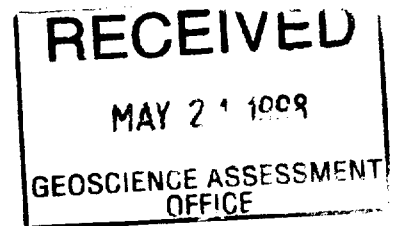

Merle & Cosby

② Cosby CLAIMS

W9880.00317.

MAY 1998

EXPENSIVES 1998 WALKER TWP Cosby CLAIMS
COST FOR GRAVITY SURVEY ON Cosby PROPERTY
IN WALKER TWP CLAIMS # 1200338- 1200339
1140850- 1140851- 1140854 - 1140855 COCHRANE
MINING DIVISION LARDER LAKE

MOTEL 479.58

MEALS \$ 356.09

GAS FOR TRIP ST. CATHARINES TOMATHESON
TO PROPERTY WALKER TWP \$ 155.94

COST FOR LABOR \$ 16.607

M. Cosby COST MANAGER OF SURVEY \$ 600.00

MOTEL 479.58

MEALS 356.09

GAS 155.94

\$ 991.61

PLEASE BANK THIS

M. Cosby

④

W9880.00317

Cosby CLAIMS WALKER TWP MAY 1998

| | | |
|---------|---------|----------------|
| CLAIM # | 1200339 | \$ 4000 |
| # | 1200338 | \$ 4000 |
| | 1140850 | \$ 1900 |
| | 1140851 | \$ 1902 |
| | 1140854 | \$ 1902 |
| | 1140855 | <u>\$ 1903</u> |

\$ 16.607 = \$ 80 PER FOOT

LINE CUTTING & CHAINING \$ 80 PER FOOT
PER MAN 6546.66 EACH

Muel Posley



Geoscience Assessment Office
933 Ramsey Lake Road
6th Floor
Sudbury, Ontario
P3E 6B5

Telephone: (888) 415-9846
Fax: (877) 670-1555

October 13, 1998

MERLE STEWART COSBY
13 Wildermere Road
St. Catharines, Ontario
L2T-3W1

Visit our website at:
www.gov.on.ca/MNDM/MINES/LANDS/mlsmnpge.htm

Dear Sir or Madam:

Submission Number: 2.18542

Status

Subject: Transaction Number(s): W9880.00317 Approval After Notice

We have reviewed your Assessment Work submission with the above noted Transaction Number(s). The attached summary page(s) indicate the results of the review. WE RECOMMEND YOU READ THIS SUMMARY FOR THE DETAILS PERTAINING TO YOUR ASSESSMENT WORK.

If the status for a transaction is a 45 Day Notice, the summary will outline the reasons for the notice, and any steps you can take to remedy deficiencies. The 90-day deemed approval provision, subsection 6(7) of the Assessment Work Regulation, will no longer be in effect for assessment work which has received a 45 Day Notice. Allowable changes to your credit distribution can be made by contacting the Geoscience Assessment Office within this 45 Day period, otherwise assessment credit will be cut back and distributed as outlined in Section #6 of the Declaration of Assessment work form.

Please note any revisions must be submitted in DUPLICATE to the Geoscience Assessment Office, by the response date on the summary.

If you have any questions regarding this correspondence, please contact Steve Beneteau by e-mail at benetest@epo.gov.on.ca or by telephone at (705) 670-5855.

Yours sincerely,

A handwritten signature in black ink, appearing to read "Blair Kite".

ORIGINAL SIGNED BY
Blair Kite
Supervisor, Geoscience Assessment Office
Mining Lands Section

Work Report Assessment Results

Submission Number: 2.18542

Date Correspondence Sent: October 13, 1998

Assessor: Steve Beneteau

| Transaction Number | First Claim Number | Township(s) / Area(s) | Status | Approval Date |
|---------------------------|---------------------------|------------------------------|-----------------------|----------------------|
| W9880.00317 | 1200339 | WALKER | Approval After Notice | September 26, 1998 |

Section:
14 Geophysical GRAV

Thank you for the prompt response to the 45 Day Notice dated August 12, 1998. The submitted material has corrected all deficiencies associated with this submission.

Credit for line-cutting is eligible only on the portion of cut-line used for the gravity survey. Accordingly, as outlined in the 45 Day Notice dated August 12, 1998 and verified on your submitted maps at a scale of 1:2,400, the gravity survey covered 6.4km of cut line. Accordingly, assessment credit can only be given for 6.4km of line-cutting. Therefore, this file has been approved at \$6,142.00. The approved assessment credit has been distributed as outlined on the attached Distribution of Assessment Work Credit form.

Correspondence to:

Resident Geologist
Kirkland Lake, ON

Recorded Holder(s) and/or Agent(s):

MERLE STEWART COSBY
St. Catharines, Ontario

Assessment Files Library
Sudbury, ON

Distribution of Assessment Work Credit

The following credit distribution reflects the value of assessment work performed on the mining land(s).

Date: October 13, 1998

Submission Number: 2.18542

Transaction Number: W9880.00317

| <u>Claim Number</u> | <u>Value Of Work Performed</u> |
|---------------------|--------------------------------|
| 1140851 | 1,536.00 |
| 1140850 | 1,675.00 |
| 1140854 | 698.00 |
| 1140855 | 2,233.00 |
| 1200339 | 0.00 |
| 1200338 | 0.00 |
| Total: \$ | 6,142.00 |

REFERENCES

LANDS WITHDRAWN FROM DISPOSITION

| | |
|--------|---------------------------|
| M.R.O. | MINING RIGHTS ONLY |
| S.R.O. | SURFACE RIGHTS ONLY |
| M.+S. | MINING AND SURFACE RIGHTS |
| Option | Order No |
| | Date |
| | Disposition |
| | File |

NOTE

RESERVATION AROUND ALL LAKES AND RIVERS FOR FLOODING RIGHTS ALONG THE SHORES OF ABITIBI, BLACK RIVER AND DRIFTWOOD RIVER

PENDING SURFACE RIGHTS APPLICATION

ABITIBI DE TROYES PROVINCIAL PARK

THE INFORMATION THAT APPEARS ON THIS MAP HAS BEEN COMPILED FROM VARIOUS SOURCES, AND ACCURACY IS NOT GUARANTEED. THOSE WISHING TO STAKE MINING CLAIMS SHOULD CONSULT WITH THE MINING RECORDER, MINISTRY OF NORTHERN DEVELOPMENT AND MINES, FOR ADDITIONAL INFORMATION ON THE STATUS OF THE LANDS SHOWN HEREON.

NOTICE OF FORESTRY ACTIVITY

THIS TOWNSHIP / AREA FALLS WITHIN THE TABEAG MANAGEMENT UNIT.

IT MAY BE SUBJECT TO FORESTRY OPERATIONS. CONTACT THE MNR UNIT FORESTER FOR THIS AREA CAN BE CONTACTED AT: PO. BOX 129, SWASTIKA, ONT. POK ITO, 705-642-3222

Surface Rights Withdrawn under Sec. 36. The Mines Act: R.S.O. 1980, ORDER NO. W-01/91/ONT (Trans Canada Pipeline Right of Way and Buffer Zone particularly 40.25 meters or 132 ft. on either side of centre line of right of way)

TEEFY TWP

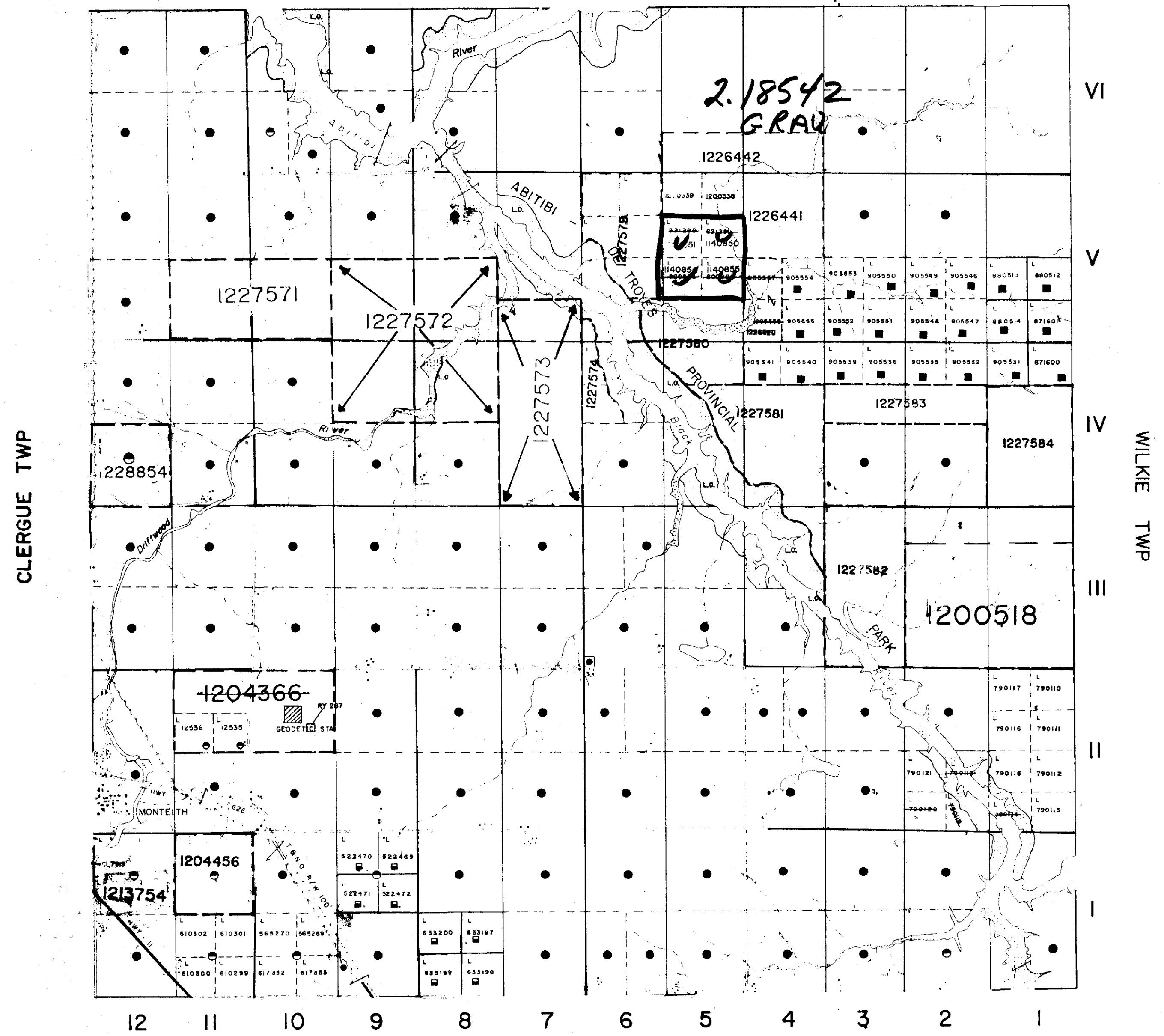

TAYLOR TWP.

COPY OF THIS G-PLAN WAS ARCHIVED ON MAY 17/93 ARCHIVED JUNE 3/96

LEGEND

| | |
|--|--|
| HIGHWAY AND ROUTE No | |
| OTHER ROADS | |
| TRAILS | |
| SURVEYED LINES | |
| TOWNSHIPS, BASE LINES, ETC. | |
| LOTS, MINING CLAIMS, PARCELS, ETC. | |
| UNSURVEYED LINES | |
| LOT LINES | |
| PARCEL BOUNDARY | |
| MINING CLAIMS ETC. | |
| RAILWAY AND RIGHT OF WAY | |
| UTILITY LINES | |
| NON-PERENNIAL STREAM | |
| FLOODING OR FLOODING RIGHTS | |
| SUBDIVISION OR COMPOSITE PLAN RESERVATIONS | |
| ORIGINAL SHORELINE | |
| MARSH OR MUSKEG | |
| MINES | |
| TRAVERSE MONUMENT | |

DISPOSITION OF CROWN LANDS

| TYPE OF DOCUMENT | SYMBOL |
|---------------------------------|--------|
| PATENT, SURFACE & MINING RIGHTS | |
| " SURFACE RIGHTS ONLY | |
| " MINING RIGHTS ONLY | |
| LEASE, SURFACE & MINING RIGHTS | |
| " SURFACE RIGHTS ONLY | |
| " MINING RIGHTS ONLY | |
| LICENCE OF OCCUPATION | |
| ORDER IN COUNCIL | |
| RESERVATION | |
| CANCELLED | |
| SAND & GRAVEL | |

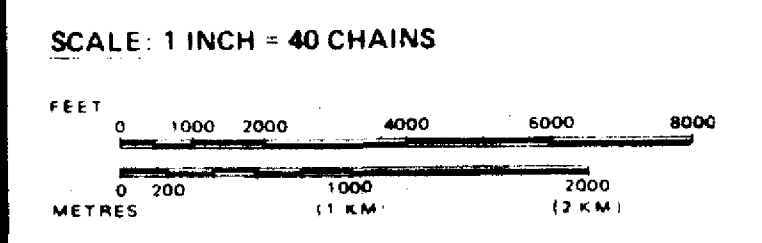

CIRCULATED FEB. 26, 1990

DATE OF ISSUE

TOWNSHIP 3, OCT 14 1998

PROVINCIAL RECORDING OFFICE - SUDBURY

WALKER

M.N.R. ADMINISTRATIVE DISTRICT

COCHRANE

MINING DIVISION

LARDER LAKE

LAND TITLES / REGISTRY DIVISION

COCHRANE

Ministry of Natural Resources Ontario

Ministry of Northern Development and Mines

Date: DECEMBER 1989

G-3584



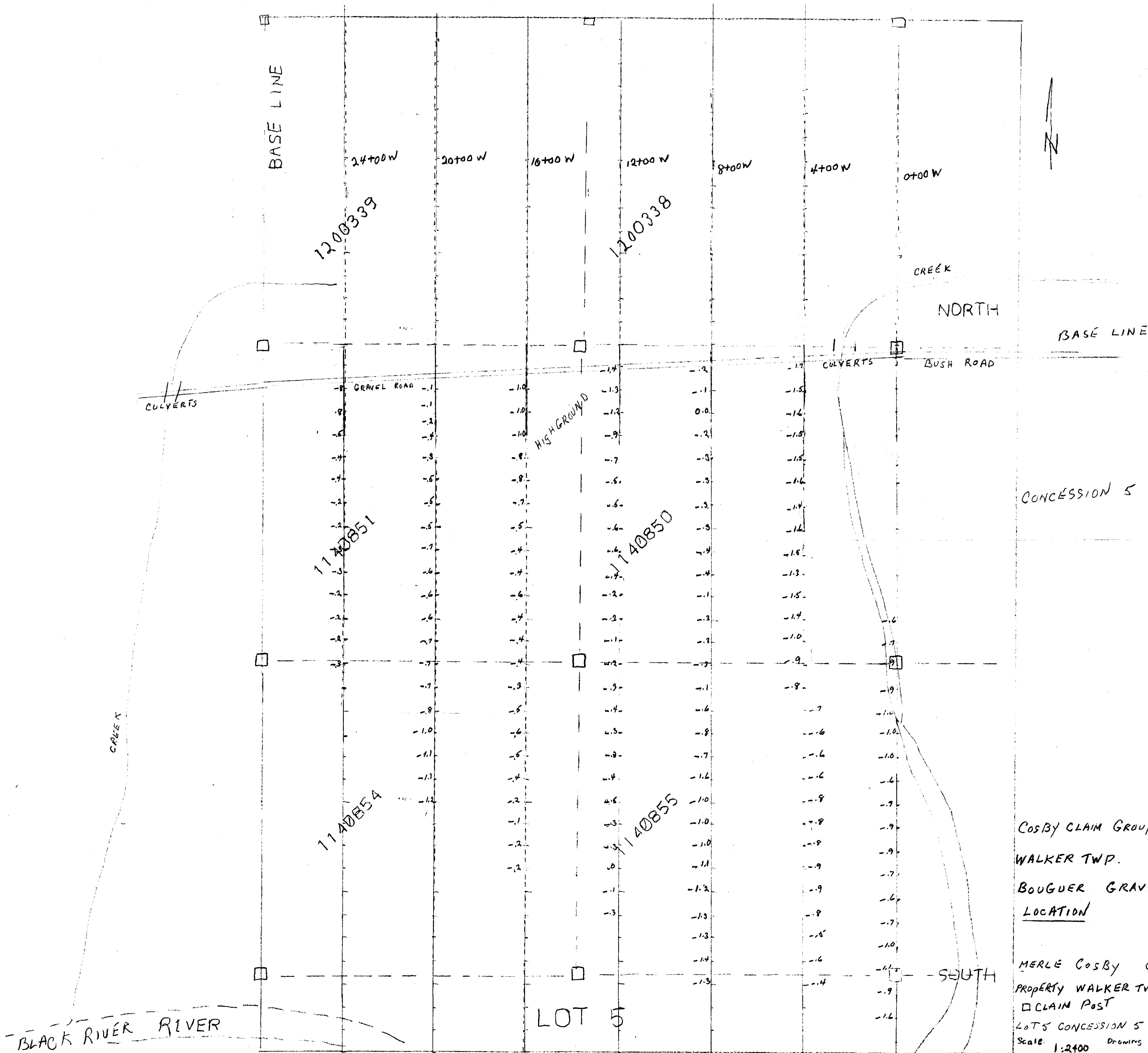

COSBY CLAIM GROUP,
 WALKER TWP.
 BOUGUER GRAVITY SURVEY
 LOCATION

MERLE COSBY CLAIMS
 PROPERTY WALKER TWP
 □ CLAIM POST
 LOTS CONCESSION 5
 Scale: 1:2400 Drawings M. COSBY

6

