



42A10SE0151 25 BOND

010

DIAMOND DRILLING

TOWNSHIP: BOND

REPORT NO:25

WORK PERFORMED FOR: Unigold Resources Ltd.

RECORDED HOLDER: Same as Above [xx]  
: Other [ ]

<u>Claim No.</u>	<u>Hole No.</u>	<u>Footage</u>	<u>Date</u>	<u>Note</u>
P 795302	UB-87-1-2	261m	Mar-Apr/87	(1) (2)
P 795303	UB-87-4	166m	May/87	(1) (2)

NOTES: (1) #274-87, filed in April/88.

(2) Similar diamond drilling logs and cross-sections added to this report Sept/89 from OMEP # OMB7-5-C-010.

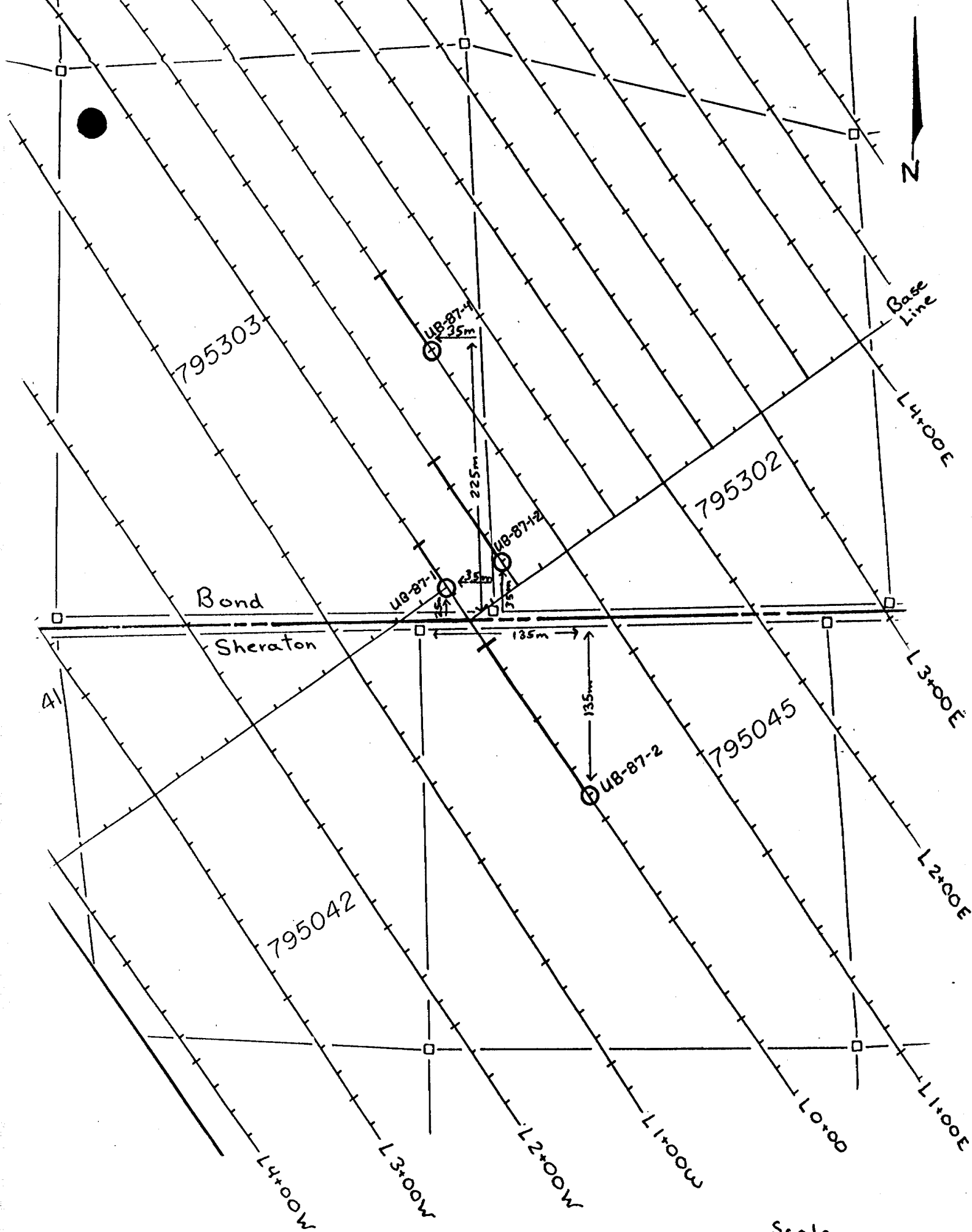

Drill Hole Location Map

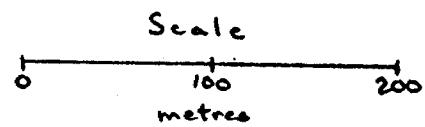

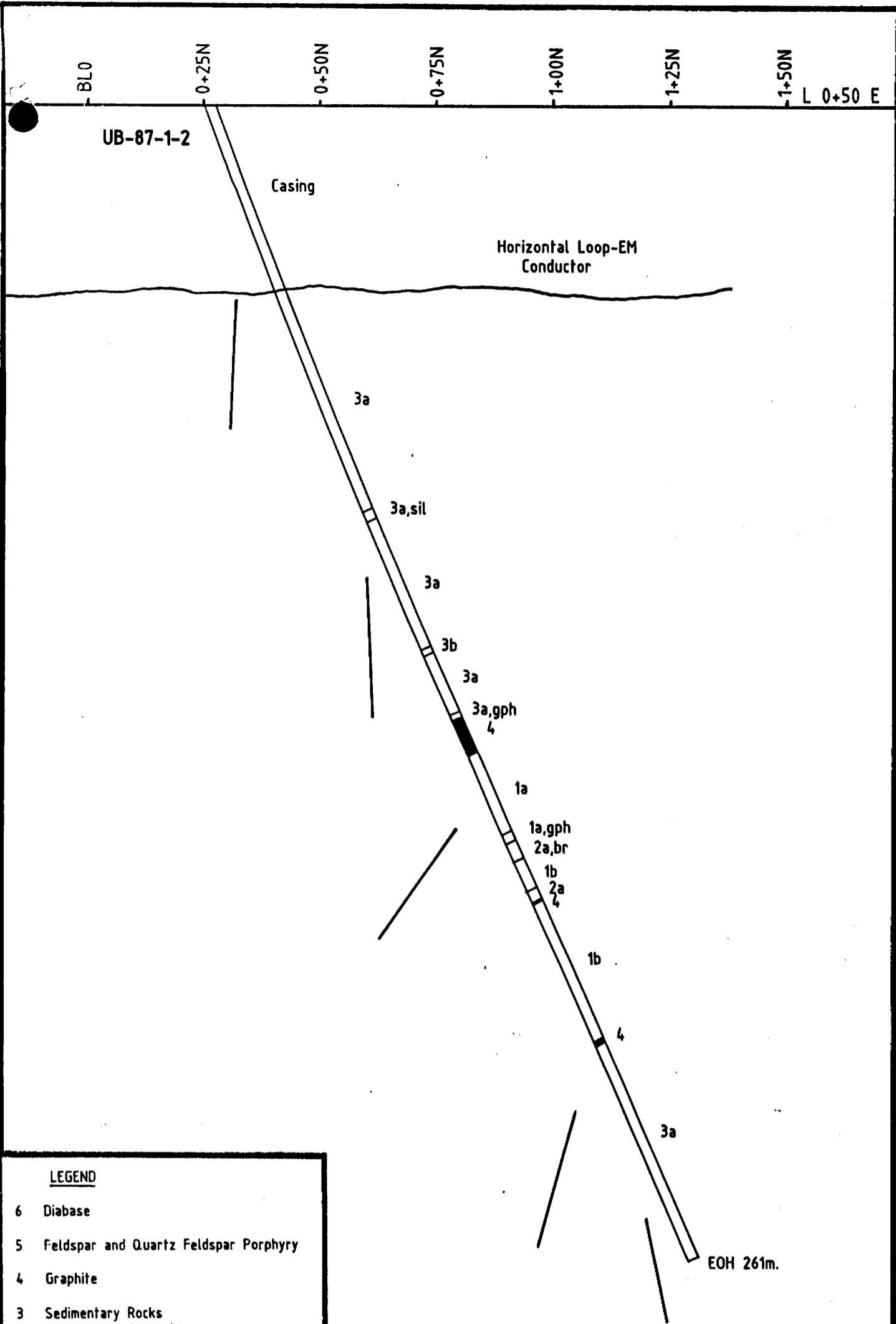

**LEGEND**

- 6 Diabase
- 5 Feldspar and Quartz Feldspar Porphyry
- 4 Graphite
- 3 Sedimentary Rocks
  - 3a Argillaceous Greywacke
  - 3b Arenite
- 2 Felsic-Intermediate Volcanic Rocks
  - 2a Ash, Crystal, Lapilli Tuff, Agglomerate
  - 2b Sericite Schist
  - 2c Quartz-Sericite Schist
- 1 Mafic-Intermediate Volcanic Rocks
  - 1a Pyroclastic Rocks
  - 1b Flows

**SYMBOLS**

- ser sericitic
- sil silicified
- br breccia
- gph graphitic
- carb carbonatized

<i>REVISIONS</i>	DURHAM GEOLOGICAL SERVICES INC.		
	For: UNIGOLD RESOURCES LTD.		
	Title: SHERATON-BOND TWPS.		
	UB-87-1-2		
	L 0+50 E		
	Date: Sept 1987	Drawn: C.G.	Scale: 1:1000
	NTS:	Approved:	Fig:

DURHAM GEOLOGICAL SERVICES INC.

DIAMOND DRILL HOLE LOG

PROJECT:	D-19	HOLE NUMBER:	UB-87-1-2
AREA:	Sheraton-Bond Twps	LOCATION:	LO + 50E, 0 + 25N
CLAIM NUMBER:	795302	AZIMUTH:	330°
CORE SIZE:	BQ	DIP:	70°
DRILLED BY:	St.Lambert Drilling Co.	DATE:	March 29 - April 13, 1987
LOGGED BY:	Henry P. Hutteri	CASING:	42.1 m
CORE STORED AT:		LENGTH:	261 m
OBJECTIVE:	Test a Horizontal Loop-EM Conductor	ACID TEST:	@ 125 m 66° @ 250 m 66°















2+00N 2+25N 2+50N 2+75N 3+00N 3+25N 3+50N L 1+00 E

UB-87-4

Casing

Pulse EM Anomaly

2a,ser 6

2a,ser

2c

6

2c

2a,ser

2c

2a,ser

2a

1a

2a,ser

EOH 166m.

**LEGEND**

- 6 Diabase
- 5 Feldspar and Quartz Feldspar Porphyry
- 4 Graphite
- 3 Sedimentary Rocks
  - 3a Argillaceous Greywacke
  - 3b Arenite
- 2 Felsic-Intermediate Volcanic Rocks
  - 2a Ash, Crystal, Lapilli Tuff, Agglomerate
  - 2b Sericite Schist
  - 2c Quartz-Sericite Schist
- 1 Mafic-Intermediate Volcanic Rocks
  - 1a Pyroclastic Rocks
  - 1b Flows

**SYMBOLS**

- ser sericitic
- sil silicified
- br breccia
- gph graphitic
- carb carbonatized

<i>REVISIONS</i>	DURHAM GEOLOGICAL SERVICES INC.		
	For: UNIGOLD RESOURCES LTD.		
	Title: SHERATON-BOND TWPS.		
	UB-87-4		
	L 1+00 E		
	Date: Sept 1987	Drawn: C.G.	Scale: 1:1000
	NTS:	Approved:	Fig:

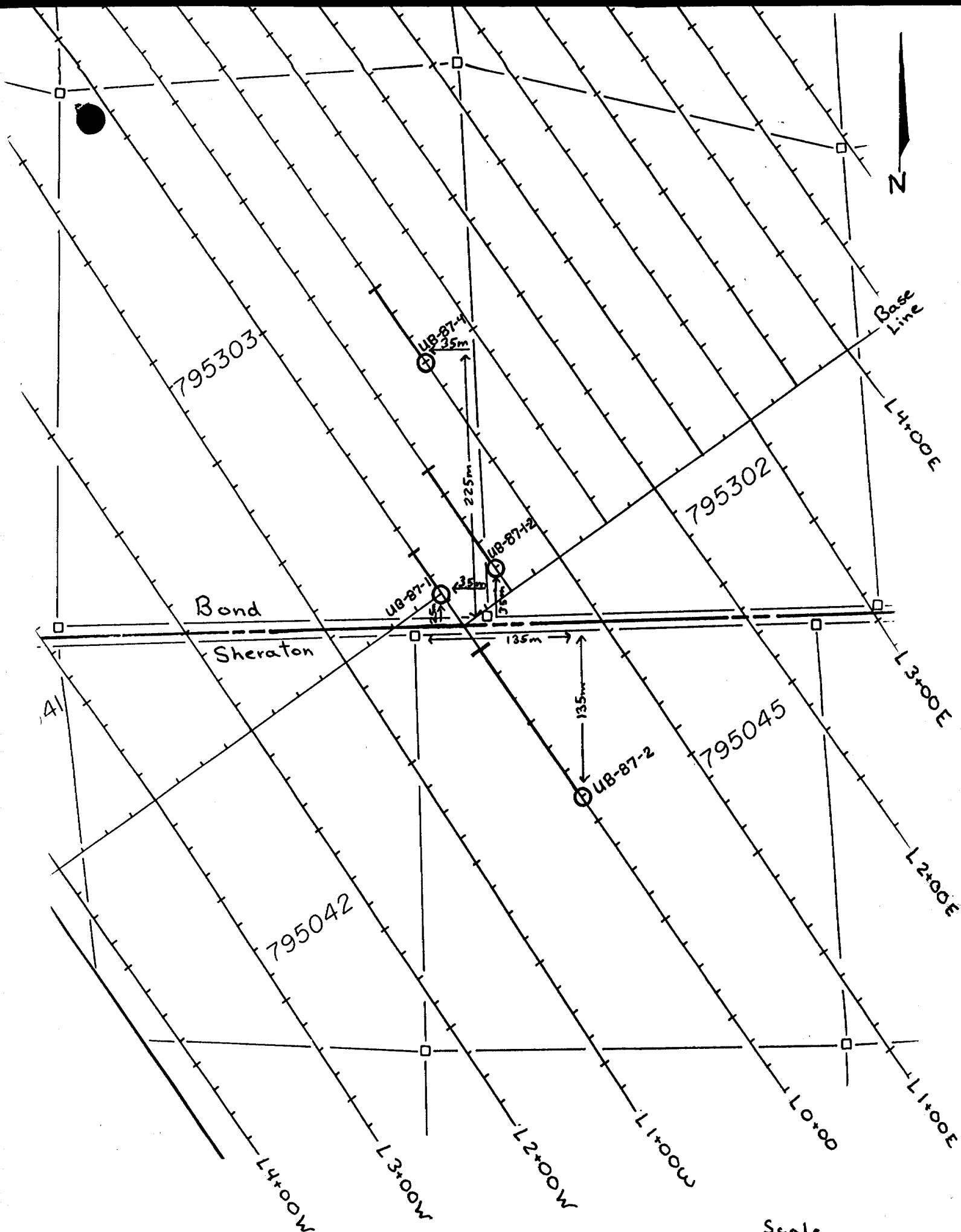

Drill Hole Location Map

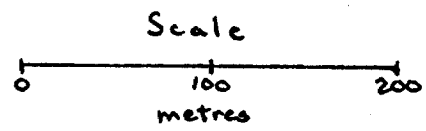

DURHAM GEOLOGICAL SERVICES INC.

DIAMOND DRILL HOLE LOG

PROJECT: D-19

HOLE NUMBER: UB-87-4

AREA: Sheraton-Bond Twps

LOCATION: L1 + 00E, 2 + 20N

CLAIM NUMBER: 795303

AZIMUTH: 330°

CORE SIZE: BQ

DIP: 60°

DRILLED BY: St. Lambert

DATE: May 8 - 14, 1987

LOGGED BY: Henry P. Hutteri

CASING: 50.1 m

CORE STORED AT: Timmins

LENGTH: 166 m

OBJECTIVE: Test a strong Pulse EM Anomaly

ACID TEST: @ 96m - 53°  
@ 166m - 39°

Footage		ROCK TYPE AND DESCRIPTION	Core Angle to Axis	% Sulphides	SAMPLE			Analytical Result	
From	To				Number	From	To	Length (feet)	Au ppb
0.0	50.1								
50.1	52.5	SERICITIC AGGLOMERATE							
		- moderately sericitic with numerous 3-20cm clasts which are very stretched and sericitic	30°						
		- clasts consist mainly of porphyritic rhyolite and possibly mafic volcanics							
		- 1-2% pyrite overall							
52.5	54.0	INTERMEDIATE INTRUSIVE							
		- medium grey-green, medium grained, equigranular							
		- intrusive contacts, sharp-bottom contact 45° to CA							
		- strong and pervasive calcite alteration throughout with 5-10% disseminated pyrite		5-10% PY	5073	52.5	54.0	1.5	1 8
54.0	70.4	SERICITIC AGGLOMERATE							
		- moderately strong sericite alteration, very banded in appearance, fairly siliceous	35°						
		- trace cpv as 1-2mm blebs in irregular <2mm calcite stringers							
		- 1% pyrite overall							







Footage		ROCK TYPE AND DESCRIPTION	Core Angle to Axis	% Sulphides	SAMPLE				Analytical Result	
From	To				Number	From	To	Length (feet)		
		- several <5mm cross-cutting quartz-calcite stringers								
		containing trace pyrite								
		- generally <1% pyrite, trace cpy								
154.9	159.0	CRYSTAL TUFF								
		- medium grey-green, fine grained matrix with subhedral white feldspar crystals								
		- slightly sericitic with some bedding evident								
		- <1% pyrite overall								
159.0	162.0	MAFIC-INTERMEDIATE ASH TUFF								
		- very weakly sericitic, medium-dark grey-green with much chlorite, fairly siliceous								
		- fragments generally <1mm								
		- <1% fine disseminated pyrite								
162.0	166.0	SERICITIC LAPILLI TUFF								
		- weak to moderately sericitic, narrow banded appearance up to 3cm maximum width								
		- stretched, sericitic clasts evident								
		- foliation 52° to CA, medium-dark grey-green in less	52°							



DURHAM GEOLOGICAL SERVICES INC.

DIAMOND DRILL HOLE LOG

PROJECT:	D-19	HOLE NUMBER:	UB-87-1-2
AREA:	Sheraton-Bond Twps	LOCATION:	LO + 50E, O + 25N
CLAIM NUMBER:	795302	AZIMUTH:	330°
CORE SIZE:	BQ	DIP:	70°
DRILLED BY:	St.Lambert Drilling Co.	DATE:	March 29 - April 13, 1987
LOGGED BY:	Henry P. Hutteri	CASING:	42.1 m
CORE STORED AT:		LENGTH:	261 m
OBJECTIVE:	Test a Horizontal Loop-EM Conductor	ACID TEST:	@ 125 m 66° @ 250 m 66°

0487-5-C-010



Meterage		ROCK TYPE AND DESCRIPTION	Core Angle to Axis	% Sulphides	SAMPLE			Analytical Result					
From	To				Number	From	To	Length (m)	Au ppb	As ppm	Pb ppm	Zn ppm	Cu ppm
		- bedding - 25° to CA @ 42m, 30° to CA @ 75m, 20° to CA @ 114m											
122.6	123.7	ARENITE - coarse grained, equigranular, grey and silicious - pervasive calcite alteration with 5% pyrite cubes disseminated throughout											
123.7	137.3	ARGILLACEOUS GREYWACKE - as at 42.1-122.6 with bedding at 15° to CA - several <1mm quartz and quartz-calcite seams along bedding planes containing pyrite - minor sph and lesser gn and cpy in section mainly as fine cross-cutting seams - broken up core @ 129.5-132.2	15°		5012	132.6	134.0	1.4	1	21	1000	2850	82
137.3	138.7	GRAPHITIC ARGILLACEOUS GREYWACKE - grey-black with some bedding evident - conductive, 5% bedded and disseminated pyrite - 1-2% sph in irregular, cross-cutting calcite stringers	23°	5% py 1-2% sph	5013	137.3	138.7	1.4	3	53	785	5450	











DURHAM GEOLOGICAL SERVICES INC.

DIAMOND DRILL HOLE LOG

PROJECT: D-19

HOLE NUMBER: UB-87-4

AREA: Sheraton-Bond Twps

LOCATION: L1 + 00E, 2 + 20N

CLAIM NUMBER: 795303

AZIMUTH: 330°

CORE SIZE: BQ

DIP: 60°

DRILLED BY: St. Lambert

DATE: May 8 - 14, 1987

LOGGED BY: Henry P. Hutteri

CASING: 50.1 m

CORE STORED AT: Timmins

LENGTH: 166 m

OBJECTIVE: Test a strong Pulse EM Anomaly

ACID TEST: @ 96m - 53°  
@ 166m - 39°

OM87-5-C-010

Footage		ROCK TYPE AND DESCRIPTION	Core Angle to Axis	% Sulphides	SAMPLE			Analytical Result	
From	To				Number	From	To	Length (feet)	Au ppb
0.0	50.1								
50.1	52.5	SERICITIC AGGLOMERATE							
		- moderately sericitic with numerous 3-20cm clasts which	30°						
		are very stretched and sericitic							
		- clasts consist mainly of porphyritic rhyolite and							
		possibly mafic volcanics							
		- 1-2% pyrite overall							
52.5	54.0	INTERMEDIATE INTRUSIVE							
		- medium grey-green, medium grained, equigranular							
		- intrusive contacts, sharp-bottom contact 45° to CA							
		- strong and pervasive calcite alteration throughout		5-10%	5073	52.5	54.0	1.5	1 8
		with 5-10% disseminated pyrite		py					
54.0	70.4	SERICITIC AGGLOMERATE							
		- moderately strong sericite alteration, very banded in	35°						
		appearance, fairly siliceous							
		- trace cpy as 1-2mm blebs in irregular <2mm calcite							
		stringers							
		- 1% pyrite overall							

Footage		ROCK TYPE AND DESCRIPTION	Core Angle to Axis	% Sul-phides	SAMPLE				Analytical Result		
From	To				Number	From	To	Length (feet)	Au ppb	Pb ppm	Zn ppm
70.4	105.4	QUARTZ-SERICITE SCHIST									
		- composed mainly of ash sized quartz clasts in a moderate- strongly sericitic matrix	35°								
		- quartz clasts are generally very stretched									
		- very light green colour with lesser slightly darker sections reflecting an increase in chlorite									
		- generally <1% pyrite									
		- 89.1 - 89.6 - 2-3% sph occurring as a mass of very fine stringers which are generally concordant		tr. Py 2-3% sph	5075	89.1	89.6	0.5	4	31	8200
		- @ 89.4 - a 6cm section contains 80% of the sph in sample 5075									
105.4	106.4	MAFIC INTRUSIVE									
		- dark green, massive, strong pervasive calcite alteration, sharp contacts, no sericite or pyrite									
106.4	130.8	QUARTZ-SERICITE SCHIST	40°								
		- similar to unit @ 70.4, very light green to grey with darker sections reflecting slight increases in chlorite content		1% py	5076	114.0	114.8	0.8	2	90	.46
		- a few <1cm quartz-calcite stringers cut section which are concordant and generally barren		1% py	5077	125.4	126.2	0.8	1	142	49







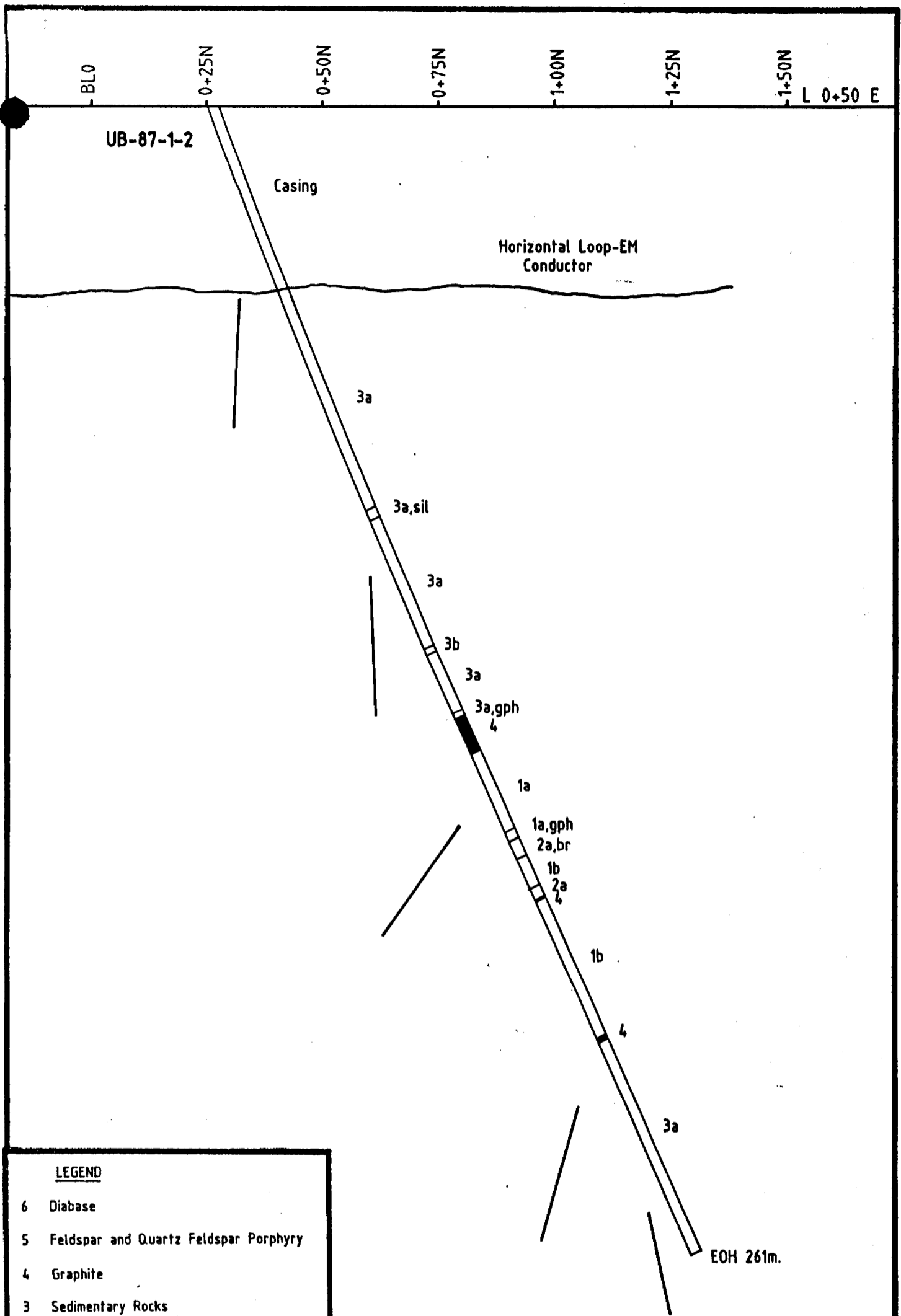

**LEGEND**

- 6 Diabase
- 5 Feldspar and Quartz Feldspar Porphyry
- 4 Graphite
- 3 Sedimentary Rocks
  - 3a Argillaceous Greywacke
  - 3b Arenite
- 2 Felsic-Intermediate Volcanic Rocks
  - 2a Ash, Crystal, Lapilli Tuff, Agglomerate
  - 2b Sericite Schist
  - 2c Quartz-Sericite Schist
- 1 Mafic-Intermediate Volcanic Rocks
  - 1a Pyroclastic Rocks
  - 1b Flows

**SYMBOLS**

- ser sericitic
- sil silicified
- br breccia
- gph graphitic
- carb carbonatized

RÉVISIONS	DURHAM GEOLOGICAL SERVICES INC.		
	For: UNIGOLD RESOURCES LTD.		
	Title: SHERATON-BOND TWPS.		
	UB-87-1-2 L 0+50 E		
	Date: Sept 1987	Drawn: C.G.	Scale: 1:1000
	NTS:	Approved:	Fig:



-2+00N      -2+25N      -2+50N      -2+75N      -3+00N      -3+25N      -3+50N      L 1+00 E

UB-87-4

Casing

Pulse EM Anomaly



2a.ser

2c

6

2c

2a.ser

2c

2a.ser

2a

1a

2a.ser

EOH 166m.

**LEGEND**

- 6 Diabase
- 5 Feldspar and Quartz Feldspar Porphyry
- 4 Graphite
- 3 Sedimentary Rocks
  - 3a Argillaceous Greywacke
  - 3b Arenite
- 2 Felsic-Intermediate Volcanic Rocks
  - 2a Ash, Crystal, Lapilli Tuff, Agglomerate
  - 2b Sericite Schist
  - 2c Quartz-Sericite Schist
- 1 Mafic-Intermediate Volcanic Rocks
  - 1a Pyroclastic Rocks
  - 1b Flows

**SYMBOLS**

- ser sericitic
- sil silicified
- br breccia
- gph graphitic
- carb carbonatized

<i>REVISIONS</i>	DURHAM GEOLOGICAL SERVICES INC.		
	For: UNIGOLD RESOURCES LTD.		
	Title: SHERATON-BOND TWPS.		
	UB-87-4		
	L 1+00 E		
	Date: Sept 1987	Drawn: C.G.	Scale: 1:1000
NTS:	Approved:	Fig:	



Name and Postal Address of Recorded Holder  
**Unigold Resources Ltd.**  
 1404-141 Adelaide St. West, Toronto, Ont. M5H 3M7

Summary of Work Performance and Distribution of Credits

Total Work Days Cr. claimed 200	Mining Claim			Mining Claim			Mining Claim		
	Prefix	Number	Work Days Cr.	Prefix	Number	Work Days Cr.	Prefix	Number	Work Days Cr.
for Performance of the following work. (Check one only) <input type="checkbox"/> Manual Work <input type="checkbox"/> Shaft Sinking Drifting or other Lateral Work. <input type="checkbox"/> Compressed Air, other Power driven or mechanical equip. <input type="checkbox"/> Power Stripping <input type="checkbox"/> Diamond or other Core drilling <input type="checkbox"/> Land Survey	P	795041	40						
		795042	40						
		795045	40						
		795303	40						
		796006	40						

ONTARIO GEOLOGICAL SURVEY  
 ASSESSMENT FILES  
 OFFICE  
 OCT 13 1989  
 RECEIVED

All the work was performed on Mining Claim(s): 795302, 795045, 795042, 795303, 795504, 795041

Required Information eg: type of equipment, Names, Addresses, etc. (See Table Below)

Core specimens donated to Core Library

Hole	FOOTAGE	DAYS CREDIT
UB-87-1-2	856'	34
UB-87-2	1584'	63
UB-87-3	728'	29
UB-87-4	544'	21
UB-87-5	590'	23
UB-87-6	954'	38

RECORDED  
 JUL 19 1989

PORCUPINE MINING DIVISION  
 RECEIVED  
 JUL 19 1989  
 3:00 PM RB

208 days

Date of Report: July 18/89  
 Recorded Holder or Agent (Signature): *Henry Hutteri*

Certification Verifying Report of Work

I hereby certify that I have a personal and intimate knowledge of the facts set forth in the Report of Work annexed hereto, having performed the work or witnessed same during and/or after its completion and the annexed report is true.

Name and Postal Address of Person Certifying: **Henry Hutteri**  
 Box 1330, Timmins, Ont. P4N 7J8  
 Date Certified: July 18/89  
 Certified by (Signature): *Henry Hutteri*

Table of Information/Attachments Required by the Mining Recorder

Type of Work	Specific information per type	Other Information (Common to 2 or more types)	Attachments
Manual Work	Nil	Names and addresses of men who performed manual work /operated equipment, together with dates and hours of employment.	Work Sketch: these are required to show the location and extent of work in relation to the nearest claim post.
Shaft Sinking, Drifting or other Lateral Work			
Compressed air, other power driven or mechanical equip.	Type of equipment	Names and addresses of owner or operator together with dates when drilling/stripping done.	Work Sketch (as above) in duplicate
Power Stripping	Type of equipment and amount expended. Note: Proof of actual cost must be submitted within 30 days of recording.		
Diamond or other core	Signed core log showing: footage, diameter of core, number and angles of holes.		



Ministère du Développement du Nord et des Mines

donated to: Porcupine Mining Division  
 Drill Core Library  
 896 Riverside Drive  
 Timmins, Ontario, P4N 3W2  
 (705) 267-1401

Material Received From :

Company: Durham Geological Services Inc.

Representative: A. Hutteri

Address: Aunor Minesite, Timmins, Ont.  
P4N 7J8

Telephone: ( 705 ) 268 - 6644 Ext. \_\_\_\_\_

Type of Samples Received: Core Specimens

# of ~~Bore~~/Samples Received: 227

Material Confidential Until: \_\_\_\_\_  
 (maximum of one (1) year)

HOLE #	# OF <del>BORES</del> /SAMP'S	<del>FEET</del> /METERS	TOWNSHIP	LOGS/LOCATION RECEIVED
UB-87-1-2	42	44-254.6	Bond	Y/Y
UB-87-2	76	53.5-480	Sheraton	Y/Y.
UB-87-3	31	59-222	Sheraton	Y/Y
UB-87-4	19	50.5-164	Bond	Y/Y
UB-87-5	23	33.5-177	Sheraton	Y/Y
UB-87-6	36	65.5-288	Sheraton	Y/Y
/	/	/	/	/
/	/	/	/	/
/	/	/	/	/
/	/	/	/	/
/	/	/	/	/
/	/	/	/	/
/	/	/	/	/
/	/	/	/	/
/	/	/	/	/
/	/	/	/	/
/	/	/	/	/
/	/	/	/	/
/	/	/	/	/
/	/	/	/	/
/	/	/	/	/
/	/	/	/	/
/	/	/	/	/
/	/	/	/	/
/	/	/	/	/

I HAVE READ AND HEREBY AGREE TO THE ABOVE AND THE TERMS AND CONDITIONS ON THE REVERSE OF THIS AGREEMENT AND UNDERSTAND THAT I AM BOUND BY THOSE TERMS.

X *A. Hutteri*  
 (Company Representative)

Authorizing Signature of Core Library Personnel: *[Signature]*

Date: 89/07/19

# BOND TOWNSHIP

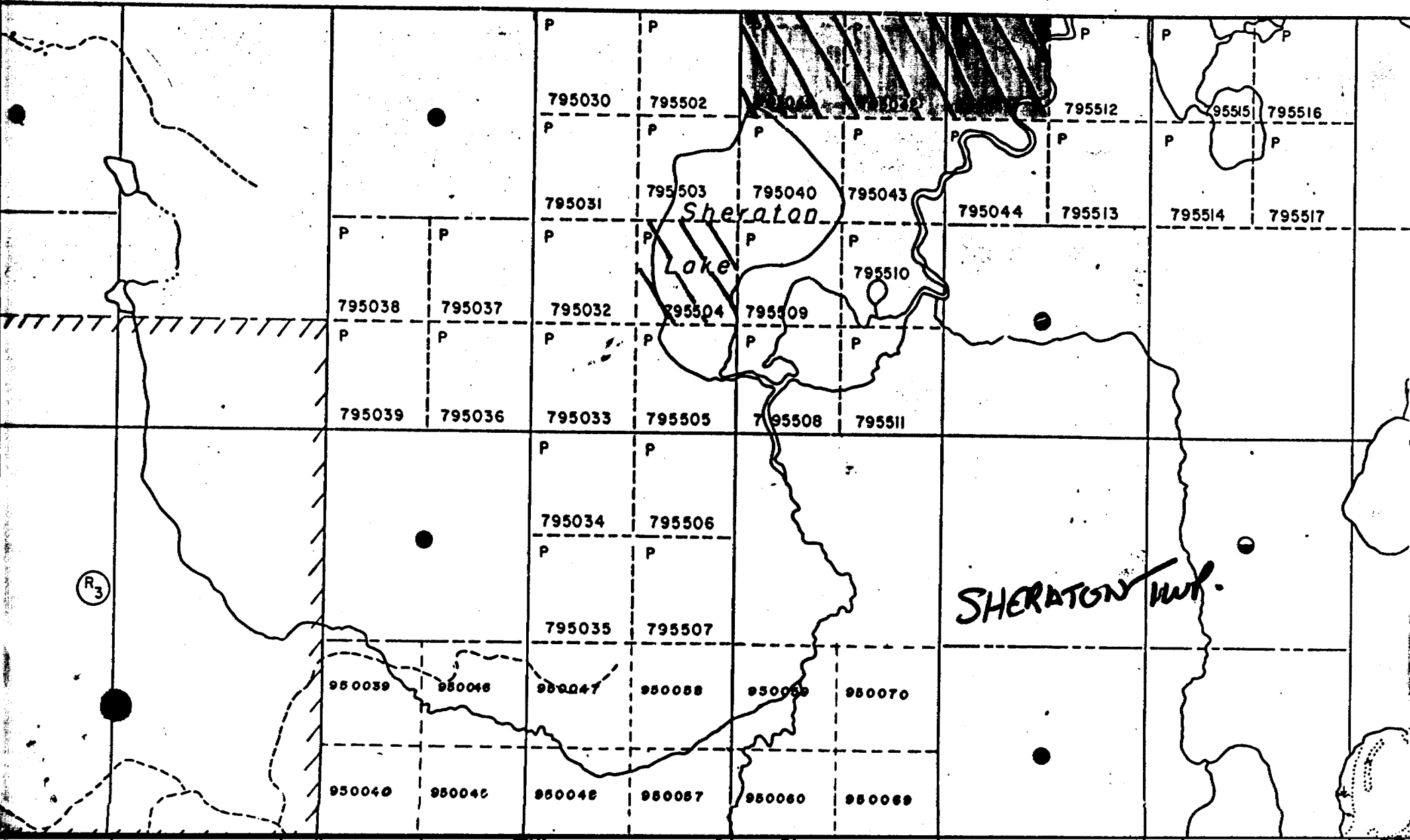

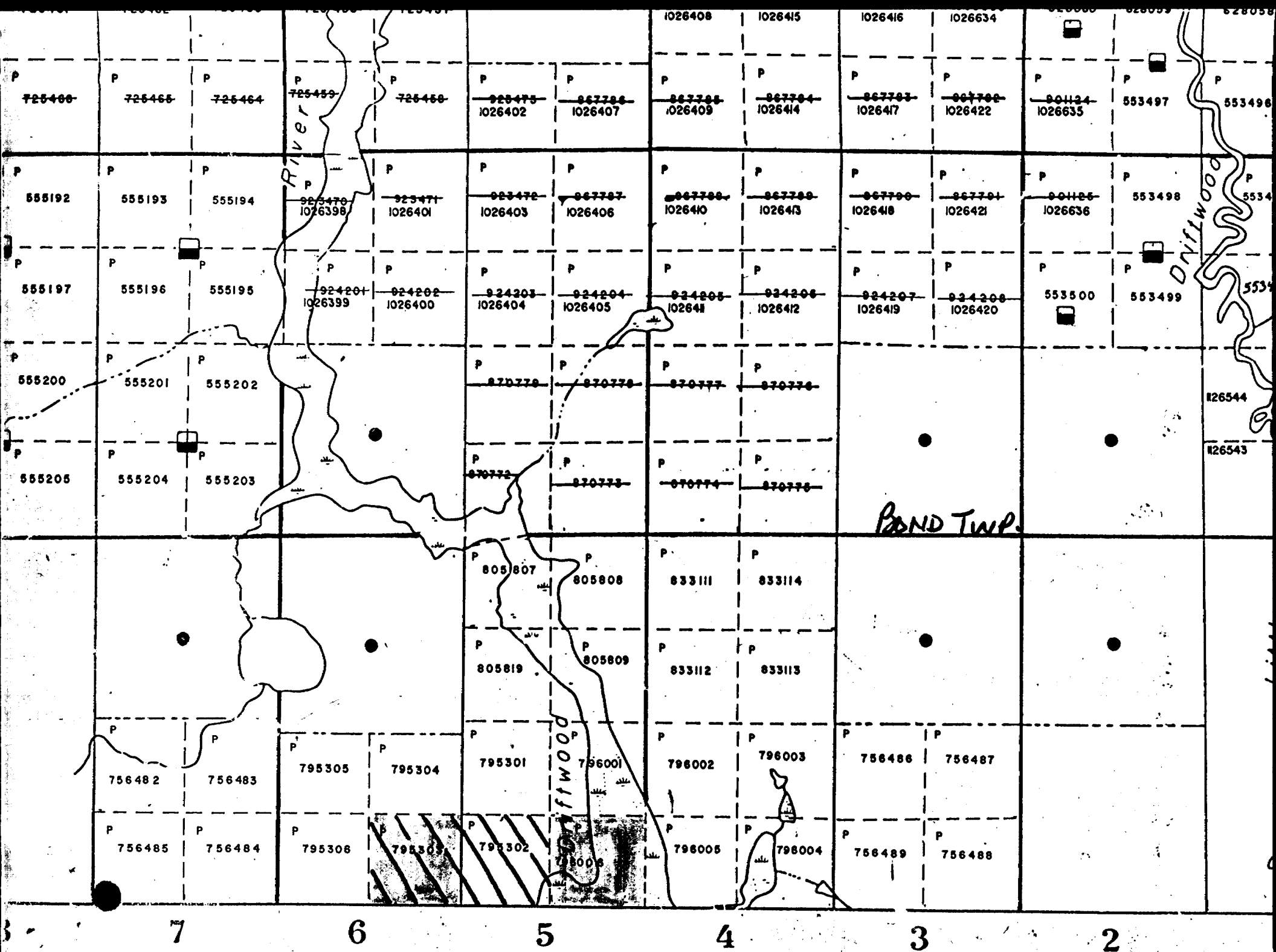



#274/87  
Mining Act

Instructions - Supply required data on a separate form for each type of work to be recorded (see table below).  
- For Geo-technical work use form no. 1362 "Report of Work (Geological, Geophysical, Geochemical and Expenditures)".

Name and Postal Address of Recorded Holder: **Unigold Resources Ltd, 1404-141 Adelaide St. West**  
**Toronto, Ontario, M5H 3M7**

Prospector's Licence No.: **T 46 33**

Summary of Work Performance and Distribution of Credits

Total Work Days Cr. claimed <b>5389.5257</b>	Mining Claim			Work Days Cr.			Mining Claim			Work Days Cr.		
	Prefix	Number	Work Days Cr.	Prefix	Number	Work Days Cr.	Prefix	Number	Work Days Cr.	Prefix	Number	Work Days Cr.
for Performance of the following work. (Check one only)												
<input type="checkbox"/> Manual Work <input type="checkbox"/> Shaft Sinking Drifting or other Lateral Work. <input type="checkbox"/> Compressed Air, other Power driven or mechanical equip. <input type="checkbox"/> Power Stripping <input checked="" type="checkbox"/> Diamond or other Core drilling <input type="checkbox"/> Land Survey												

All the work was performed on Mining Claim(s): **795302, 795303, 795041, 795042, 795045, 795504**

Required Information eg: type of equipment, Names, Addresses, etc. (See Table Below)

St. Lambert Drilling Co. Ltd.  
 P.O. Box 473  
 Valleyfield, Quebec  
 J6S 4V7

Unigold Resources Ltd  
 1404-141 Adelaide St. West  
 Toronto, Ontario  
 M5H 3M7

Diamond Drill-Acker

List of Holes

List of Holes	Depth
UB-87-1	40m - lost in overburden
UB-87-1-2	261m
UB-87-2	483m
UB-87-3	222m
UB-87-4	166m
UB-87-5	180m
UB-87-6	291m
<b>7,643m x 3.28 = 5389.5257</b>	
<b>1603m x 3.28 = 5257.84</b>	

28572989 to be applied at a later date.

RECEIVED  
 OCT 7 1987

RECORDED  
 OCT 07 1987

Date of Report: **June 17/87**  
 Recorded Holder or Agent (Signature): **Randy Hoase**  
 FOR HENRY HUTTERI

I hereby certify that I have a personal and intimate knowledge of the facts set forth in the Report of Work annexed hereto, having performed the work or witnessed same during and/or after its completion and the annexed report is true.

Name and Postal Address of Person Certifying: **Henry P. Hutteri, Box 1256, South Parcupine, Ontario.**  
**POW 1H0**

Date Certified: **June 17/87**  
 Certified by (Signature): **Henry P. Hutteri**

Table of Information/Attachments Required by the Mining Recorder

Type of Work	Specific information per type	Other Information (Common to 2 or more types)	Attachments
Manual Work	Nil	Names and addresses of men who performed manual work/operated equipment, together with dates and hours of employment.	Work Sketch: these are required to show the location and extent of work in relation to the nearest claim post.
Shaft Sinking, Drifting or other Lateral Work			
Compressed air, other power driven or mechanical equip.	Type of equipment	Names and addresses of owner or operator together with dates when drilling/stripping done.	
Power Stripping	Type of equipment and amount expended. Note: Proof of actual cost must be submitted within 30 days of recording.		

## BOND TOWNSHIP (28 claims)

## SHERATON TOWNSHIP (32 claims)

CLAIM NO. Workdays credit

805807	40
805808	40
805809	40
805819	40
833111	40
833112	40
833113	40
833114	40
756482	40
756483	40
756484	40
756485	40
795301	40
795302	40
795303	40
795304	40
795305	40
795306	40
796001	40
796002	40
796003	40
796004	40
796005	40
796006	40
756486	40
756487	40
756488	40
756489	40

795030	40
795031	40
795032	40
795033	40
795034	40
795035	40
795036	40
795037	40
795038	40
795039	40
795502	40
795503	40
795504	40
795505	40
795506	40
795507	40
795040	40
795041	40
795042	40
795043	40
795044	40
795045	40
795508	40
795509	40
795510	40
795511	40
795512	40
795513	40
795514	40
795515	40
795516	40
795517	40



Ontario

Ministry of  
Northern Development  
and Mines

Ministère du  
Développement du Nord  
et des Mines

November 17, 1987

Our File: 274/87

Unigold Resources Ltd.  
1404 - 141 Adelaide Street West  
Toronto, Ontario  
M5H 3M7

**RE: Report of Work for Diamond Drilling, Mining Claim  
P-975302 et al., Bond and Sheraton Townships,  
Porcupine Mining Division.**

I have amended your Report of Work to indicate a total of 5257 days credit for diamond drilling.

The number of days credit claimed for drill hole UB-87-1 cannot be recorded due to the fact that the drill hole did not intersect bedrock.

You may obtain credit for the drill hole by resubmitting a work report under mechanical equipment, claiming time operators were employed during the drilling of this hole.

As a result of the change in total days credit, you may assign 2857 days credit at some future date to keep the mining claims in good standing.

Sincerely,

Gary White  
Mining Recorder  
Porcupine Mining Division  
60 Wilson Avenue  
Timmins, Ontario  
P4N 2S7

BB  
BB/ca

Enclosure

cc: Lorne Luhta, Resident Geologist  
Porcupine Mining Division

✓ P. Joseph  
The Assessment Files Research Office  
77 Grenville Street - Room 802  
Toronto, Ontario  
M5S 1B3