



42A10SE0159 2.5123 BOND

010

REPORT ON OVERBURDEN DRILLING 1982

BOND TOWNSHIP
42-A-7, Ontario

RECEIVED
OCT 26 1982
MINING LANDS SECTION

October, 1982

D.J. Robinson
Westmin Resources Limited



42A10SE0159 2.5123 BOND

010C

LIST OF CONTENTS

Introduction	1
Location, Access and Property Status	2
Table 1 ; Property Status	3
Figure 1 ; Location Map	4
Figure 2 ; Claim Map	5
Mosse Group Drill Holes	8
Driftwood Group Drill Holes	10

LIST OF APPENDICES

Appendix I : Description of Overburden and and Bedrock Drilling and Sampling	11
Appendix II: Expenditure Breakdown	15
Appendix III: Overburden Drill Logs	17
Appendix IV : Geochemical Results	35
Appendix V : Invoices	44

Introduction:

Twenty-nine reverse circulation overburden drill holes were completed on three priority target areas (Moose, Grindstone and Driftwood) in Bond township, to partially define anomalous Au concentrations in glacial dispersion trains. Two diamond drill holes were also completed on the Moose and Grindstone areas to test weak H.E.M. conductors coincident with anomalous Au concentrations in H.M.C.* in till.

The reverse circulation drilling program was carried out in 3 separate campaigns by Bradley Bros. for W.R.L. from March 17 to 26, Aug. 3 to 11 and Aug. 31 to Sept. 5, 1982. A total of 623.9 metres were drilled, with an average depth of overburden of 41.6 m. A minimum depth of 36.0 m was encountered in BO-82-21, on the Driftwood group, and a maximum depth of 73.2 m in hole BO-82-17 on the Moose group (figures 3-5 and Appendix III). One hundred and sixty-six samples of till and/or gravel were taken at approximately 2 m intervals and shipped to Overburden Management Ltd. for heavy mineral concentration on a Wilfrey shaking table. Samples containing visible gold were also selectively panned by O.M.L. personnel. Heavy mineral concentrates were subsequently shipped to Bondar-Clegg Assayers for geochemical analyses for Cu-Zn-Ni-Ag-Au by atomic absorption methods. Bedrock chips were collected in each hole when possible and analyzed for the above base and precious metals. A few bedrock samples were also analyzed for major and trace elements by X-Ray Assay in Toronto.

Location, Access and Property Status

The Bond-Grindstone project is situated in Bond township and is located approximately 45 kilometres east of Timmins, Ontario (figure 1). The property is centred within $48^{\circ}28'30''$ latitude and $80^{\circ}43'00''$ longitude and consists of 86 contiguous mining claims (Table 1). Access to the property is facilitated by the Bond-Currie Boundary Road which reaches the Grindstone River on the Gibson Lake Road; both of which extend from Highway 101.

Bond-Grindstone: Property Status

Equity: Westmin Resources Limited 100%

Location: Bond and Currie Townships, Porcupine and
Larder Lake Mining Division, Ontario.

Property: 86 Mining Claims

Total work filed as per September 15, 1982.

<u>Claim No.</u>	<u>Total Work Filed (days)</u>	<u>Work Due</u>	<u>Excess Credit</u>
P.553489-502 incl.	120/each	March 5, 1984	20/each
P.553579-589 incl.	120/each	March 5, 1984	20/each
P.553596	120	March 5, 1984	20
P.555191-205 incl.	120/each	Feb. 27, 1984	20/each
P.555427	120	March 5, 1984	20
P.555487-496 incl.	120/each	March 5, 1984	20/each
P.597116-121 incl.	60/each	Jan. 30, 1984	Nil
L.597122-123 incl.	60/each	Feb. 2, 1984	Nil
P.619113-116 incl.	60/each	Sept. 1, 1984	Nil
P.619458-460 incl.	60/each	Sept. 1, 1984	Nil
P.622375	60	Sept. 1, 1984	Nil
P.624423-426 incl.	60/each	Sept.14, 1984	Nil
P.628015-016 incl.	60/each	Sept.14, 1984	Nil
P.628057-066 incl.	60/each	Sept.14, 1984	Nil
P.628219-220 incl.	60/each	Sept.14, 1984	Nil

TABLE 1

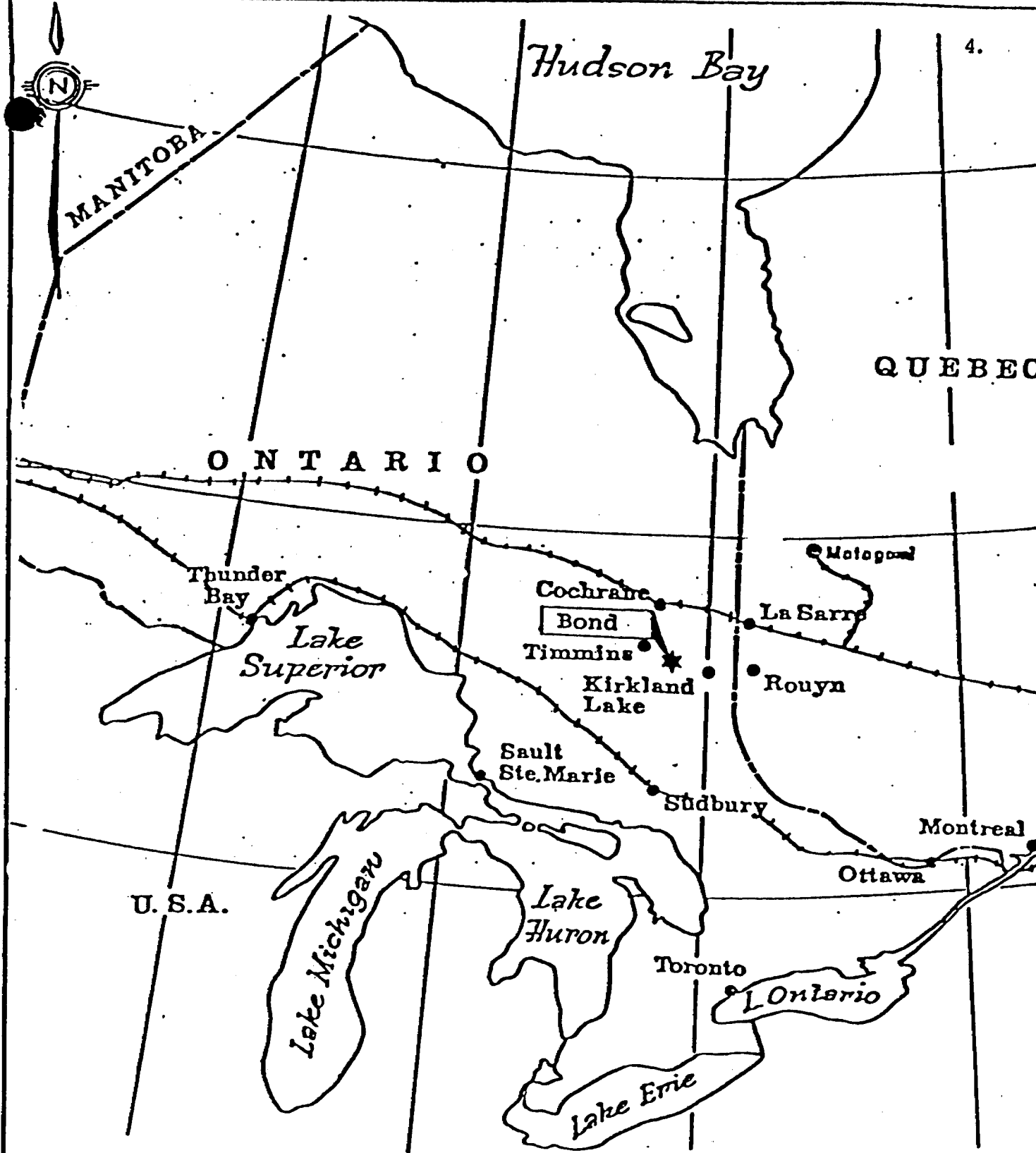

 Westmin Resources Limited EASTERN CANADA MINING DIVISION	
<i>Bond Project</i> <i>Location Map</i>	
Work by	<i>D. J. R.</i>
Date	<i>Oct. 1982</i>
Scale	NTS 42 A/16

FIGURE 1



Grindstone

MOOSE
LAKE

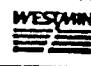
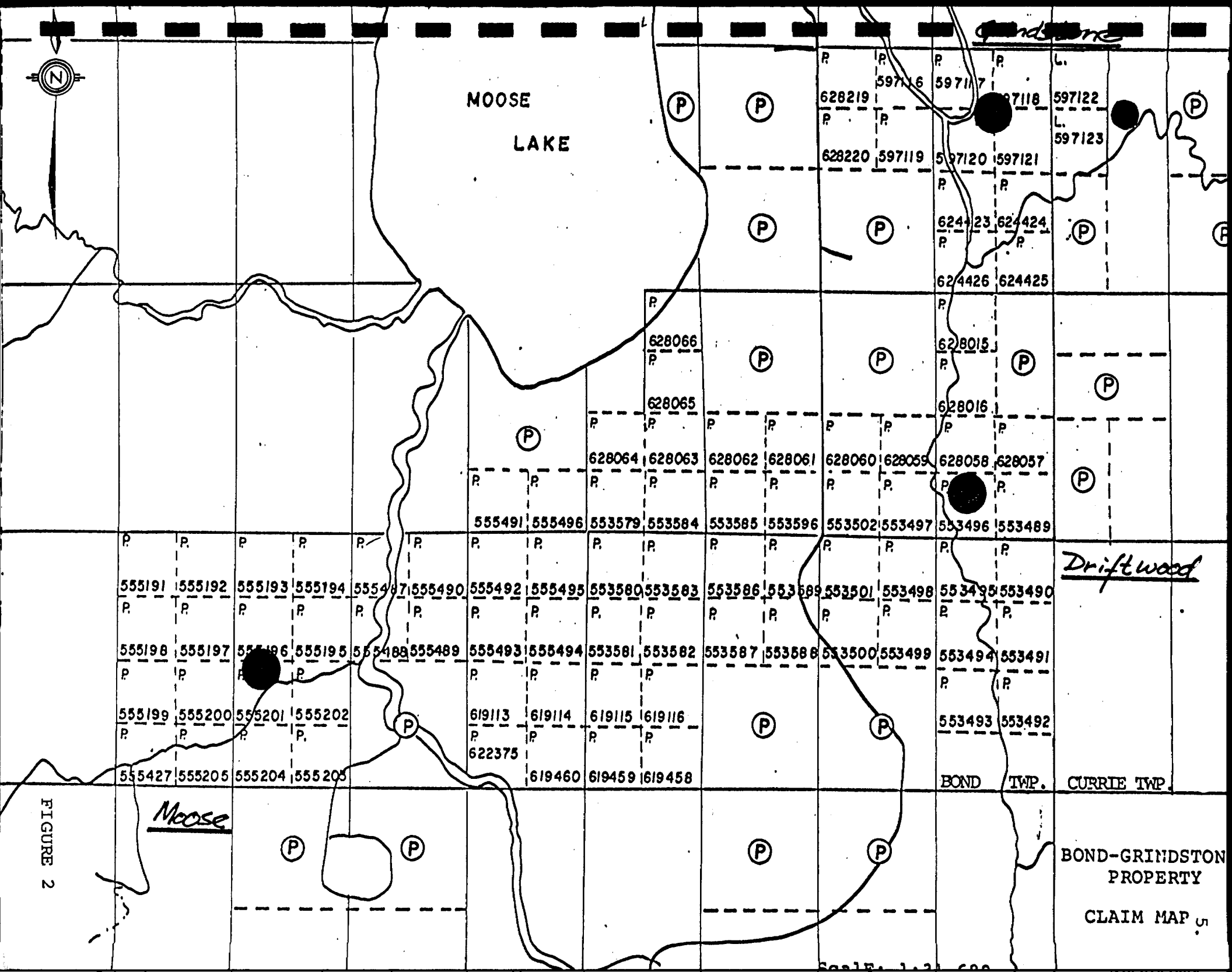
Driftwood

Moose

BOND TWP. CURRIE TWP.

BOND-GRINDSTON
PROPERTY

CLAIM MAP

Scale: 1:25,000

FIGURE 2



(P)

(P)

(P)

(P)

(P)

(P)

(P)

(P)

(P)

(P)

(P)

(P)

(P)

(P)

(P)

(P)

628219 597116 597117 597118 597122
 628220 597119 597120 597121 597123
 624423 624424
 624426 624425
 628066 628015
 628065 628016
 628064 628063 628062 628061 628060 628059 628058 628057
 555491 555496 555579 555584 555585 555596 555502 555497 555496 555489
 555191 555192 555193 555194 555487 555490 555492 555495 555580 555583 555586 555589 555501 555498 555495 555490
 555198 555197 555196 555195 555488 555489 555493 555494 555581 555582 555587 555588 555500 555499 555494 555491
 555199 555200 555201 555202 619113 619114 619115 619116 555493 555492
 622375 619460 619459 619458

Assessment Credit:

<u>Drill Hole</u>	<u>Claim</u>	<u>Depth (metres)</u>
BO-82-17	555196	73.2
BO-82-18	555195	43.3
BO-82-19	555196	39
BO-82-20	555201	42.4
BO-82-21	553489	36
BO-82-22	553496	46.3
BO-82-23	553495	54.9
BO-82-24	553495	52.4
BO-82-25	553496	44
BO-82-25A	553496	52.4
BO-82-26	553496	41.2
BO-82-26A	553496	54.6
BO-82-27	553496	44.2
		623.9 m

The work is being filed under Section 86-18 of the Mining Act.
 An assessment credit of 2,942 days (\$15/day, max. 60 days/cl.)
 is submitted against these claims (Appendix II).

Expenditures: \$44,131.24

Total cost against assessment	\$44,131.24
Total drilled 623.9 metres	
Total days credit as per Section 86-18 (\$15.00/day, max. 60 days)	2,560.00

Credit is being applied against the following claims:

	<u>No. of Days</u>
P.628219-220 2 cls. x 40 days/each	80
P.553489-502 14 cls. x 20 days/each	280
P.553579-589 11 cls. x 20 days/each	220
P.553596 1 cl. x 20 days	20
P.555487-496 10 cls. x 20 days/each	200
P.555191-205 15 cls. x 20 days/each	300
P.555427 1 cl. x 20 days	20
P.619113-116 4 cls. x 60 days/each	240
P.619458-460 3 cls. x 60 days/each	180
P.622375 1 cl. x 60 days	60
P.624423-426 4 cls. x 60 days/each	240
P.628015-016 2 cls. x 60 days/each	120
P.628057-066 10 cls. x 60 days/each	600

Total: 2,560 days

MOOSE GROUP

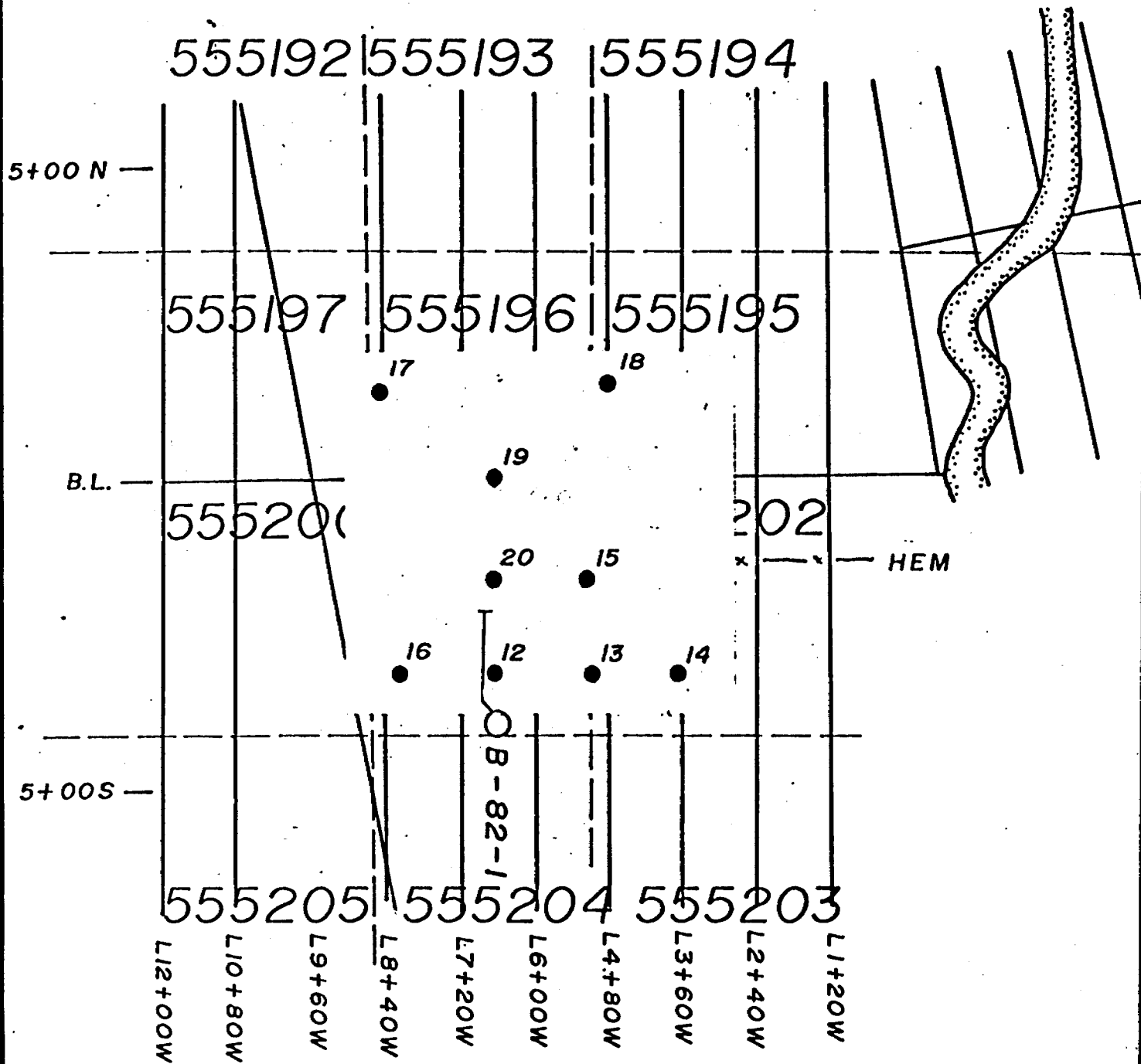

hole number
 ○¹²

 Westmin Resources Limited EASTERN CANADA MINING DIVISION	
Overburden Drill Hole Location Map	
Work by D.J.R.	Scale 1:10,000
Date Sept. 1982	NTS 42 A/7

FIGURE 3

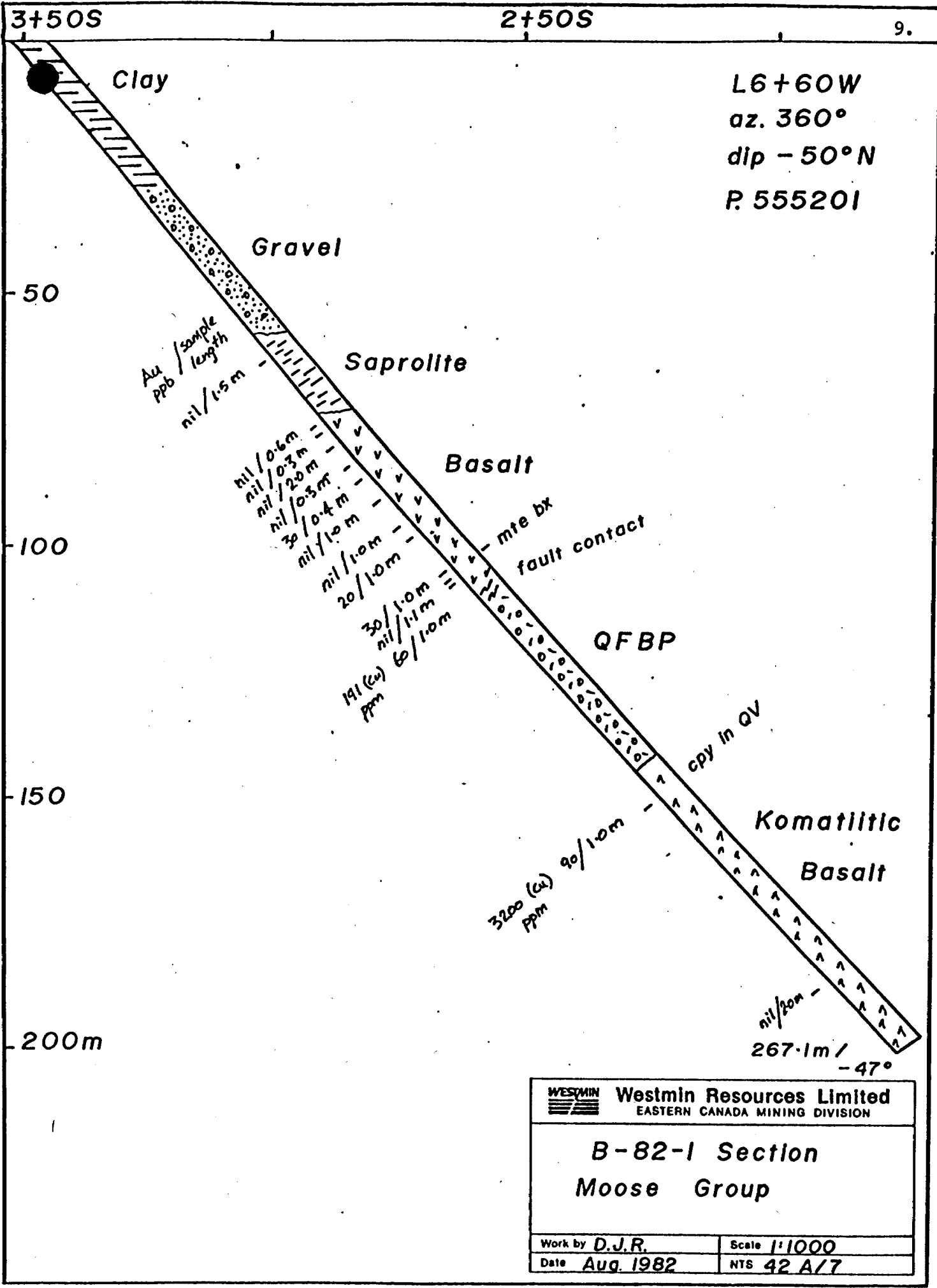
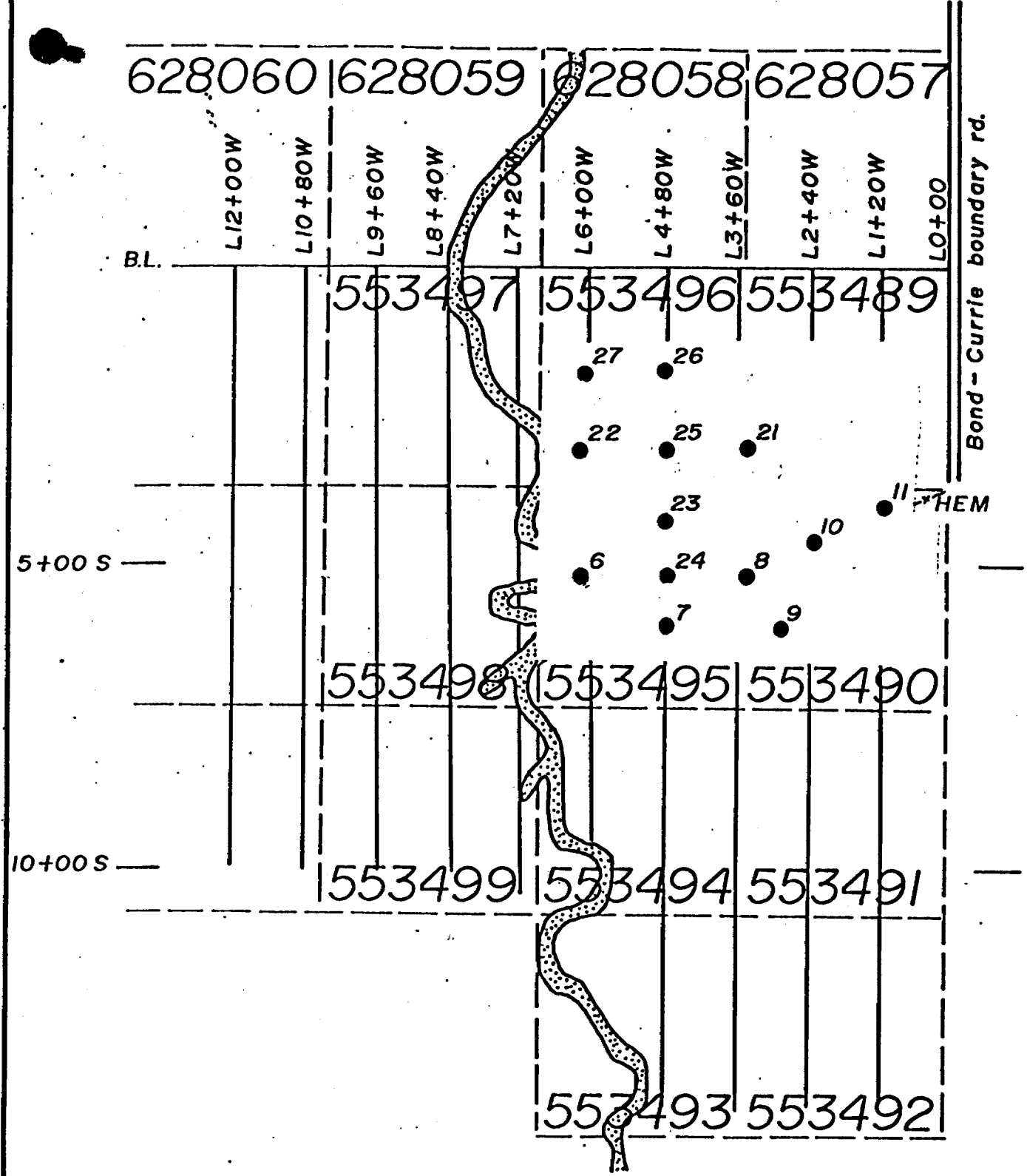

FIGURE 4

DRIFTWOOD GROUP



○ hole number
12

 Westmin Resources Limited EASTERN CANADA MINING DIVISION	
Overburden Drill Hole Location Map	
Work by D.J.R.	Scale 1:10,000
Date Sept. 1982	NTS 42 A/7

FIGURE 5

Appendix I

DESCRIPTION OF OVERBURDEN AND
BIT ROCK DRILLING AND SAMPLING:

The equipment was a Longyear drill converted to dual tube reverse circulation. It is mounted on a Nodwell FN-160 carrier. Power for the drill is taken from the drill engine with aid of hydraulics. The drilling string comprised 9 foot sectional dual-tube rods of 2 15/16" size and a standard tricone 15/16 bit. Rapid and reliable penetration and recovery of glacial overburden is achieved with a combination of air and water and a 20 foot continuous feed.

Water is pumped down between the outer and inner tubes to exit near the bit cone. The resultant mixture of water and sediment is returned up the centre tube of the drill string and discharges through a 1 foot diameter steel funnel (cyclone) into a \pm 300 gallon water recovery tank, thus allowing for recycling of drill water.

Silt, sand and gravel are collected below the discharge cyclone in 5 gallon plastic pails which rest upon a steel grate lying on the top of the recovery tank. The clay size fraction is allowed to overflow the pail into the tank. Figure 5 which is reproduced from G.S.C. Open File #116, 1972, is a schematic version of this sampling system.

A 10 mesh Tyler screen is placed over the bucket to allow the geologist to continuously log the nature of the coarser drift particles, i.e. sand, gravel and till chunks, and a portion of the

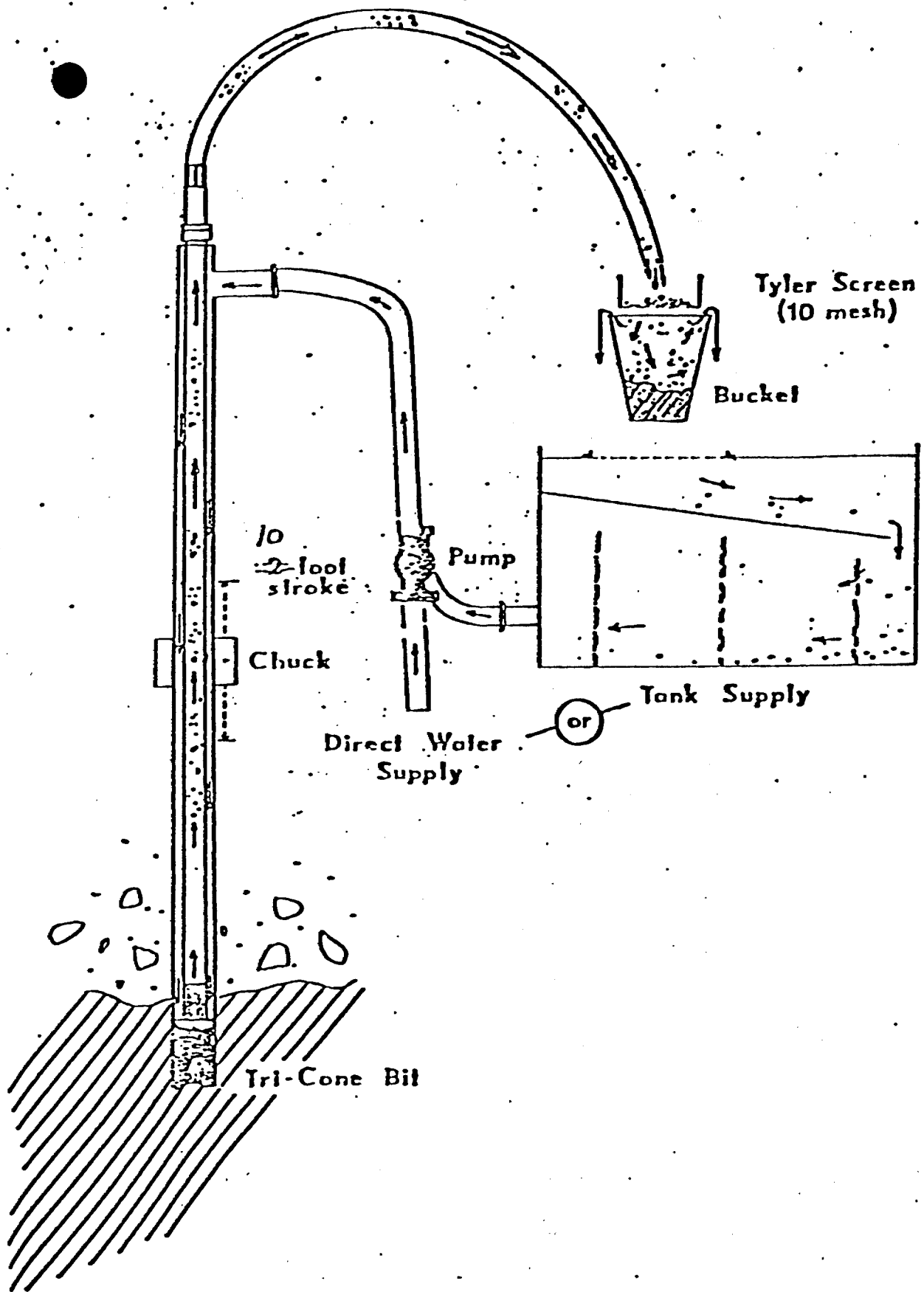

FIGURE 5 Schematic Section of Dual Tube Drilling System

+10 mesh fraction may be temporarily retained for field geological examination. In normal practice, however, the +10 mesh fraction is dumped into the bucket at the end of each run so that all sediment, exclusive of clay fines, are available for laboratory investigation. Samples are bagged from each run at periodic intervals and transported to a central laboratory.

Drilling continues below the glacial drift section into bedrock for depths of 1 ft. to 5 ft. The +10 mesh bedrock chips, which are up to 1/2" in diameter, are collected on the Tyler screen during drilling and kept separately from -10 mesh bedrock fines which pass into the sample bucket.

LABORATORY TEST WORK:

The samples, as received from the drill, are sent to the Overburden Management Ltd., in Ottawa, for heavy metal separation. The samples are passed through a 10 mesh screen and the -10 mesh part (most of the sample) is passed over a shaking table and the heavys and lights are separated. The heavy fraction is dried, mixed with a solution of methylene iodide of 3.35G and the heavy part of the heavys are collected. A 3/4 split of the heavy segment is then sent to Bondar-Clegg Laboratory for analysis of copper, zinc, lead, nickel, silver, and gold.

Bedrock chips from each hole are also collected, examined and analysed.

Appendix II

EXPENDITURE BREAKDOWN

Appendix II

Phase II

Overburden Drilling
BO-82-17 - BO-82-27Cost Summary

A.	<u>Bradley Bros.</u>		
	1. Drilling time	\$218.00 hr. x 95 hrs.	\$ 20,710.00
	2. Mechanical time	\$175.00 hr. x 0 hrs.	
	3. Button bits	\$725.00 each x 5	3,625.00
	4. Drill rods/Adapter	\$570.00 each x 2	1,140.00
	5. Mobilization and demobilization		1,200.00
		Plus 15% materials	<u>714.75</u>
			\$ 27,389.75
B.	<u>Salaries</u>		
	1. Project Geologist - 2 months		\$ 7,638.00
	2. Geological Consultant \$100.00/day x 13		1,300.00
			<u>8,938.00</u>
C.	<u>Meals and Accommodation</u>		
	1. Meals		\$ 767.74
	2. Motel		760.00
			<u>1,527.74</u>
D.	<u>Transportation</u>		
	1. Truck rental		\$ 2,000.00
			<u>2,000.00</u>
E.	<u>Sample Preparation</u>		
	1. Overburden Management Ltd. 88 samples x \$30.00 sample		\$ 2,640.00
	2. Sample bags, buckets, sieves, etc.		470.00
	3. Bondar-Clegg and Co. geochem.		1,165.75
			<u>4,275.75</u>
			<u>\$ 44,131.24</u>
		Total:	

Appendix III

Overburden Drill Logs - Holes BO-82-17

to BO-82-27, Bond Township,

Ontario

SCHEDULE "A"

OVERBURDEN DRILLING 1982 - BOND TOWNSHIP

<u>Claims</u>	<u>Days</u>	<u>Claims</u>	<u>Days</u>
1) P.553489	20	40) P.555204	20
2) P.553490	20	41) P.555205	20
3) P.553491	20	42) P.555427	20
4) P.553492	20	43) P.555487	20
5) P.553493	20	44) P.555488	20
6) P.553494	20	45) P.555489	20
7) P.553495	20	46) P.555490	20
8) P.553496	20	47) P.555491	20
9) P.553497	20	48) P.555492	20
10) P.553498	20	49) P.555493	20
11) P.553499	20	50) P.555494	20
12) P.553500	20	51) P.555495	20
13) P.553501	20	52) P.555496	20
14) P.553502	20	53) P.619113	60
15) P.553579	20	54) P.619114	60
16) P.553580	20	55) P.619115	60
17) P.553581	20	56) P.619116	60
18) P.553582	20	57) P.619458	60
19) P.553583	20	58) P.619459	60
20) P.553584	20	59) P.619460	60
21) P.553585	20	60) P.622375	60
22) P.553586	20	61) P.624423	60
23) P.553587	20	62) P.624424	60
24) P.553588	20	63) P.624425	60
25) P.553589	20	64) P.624426	60
26) P.553596	20	65) P.628015	60
27) P.555191	20	66) P.628016	60
28) P.555192	20	67) P.628057	60
29) P.555193	20	68) P.628058	60
30) P.555194	20	69) P.628059	60
31) P.555195	20	70) P.628060	60
32) P.555196	20	71) P.628061	60
33) P.555197	20	72) P.628062	60
34) P.555198	20	73) P.628063	60
35) P.555199	20	74) P.628064	60
36) P.555200	20	75) P.628065	60
37) P.555201	20	76) P.628066	60
38) P.555202	20	77) P.628219	40
39) P.555203	20	78) P.628220	40

Total of 2,560 days

APPENDIX IV.

GEOCHEMICAL RESULTS

Bondar-Clegg & Company Ltd.
 764 Belfast Road
 Ottawa, Ontario
 Canada K1G 0Z5
 Phone: (613) 237-
 Telex: 053-4455

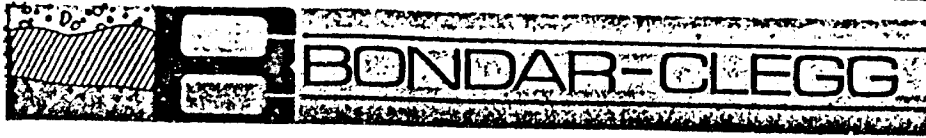

Geochemical
 Lab Report

REPORT: 112-1425 PROJECT:

PAGE 1

SAMPLE NUMBER	ELEMENT UNITS	Cu PPM	Zn PPM	Ni PPM	As PPM	Au PPB	wt/Au GM	NOTES
80-82-17-01		70	35	42	0.2	70		
80-82-17-02		73	34	54	0.1	875		
80-82-17-03		62	25	48	<0.1	30		
80-82-17-04		15	15	15	15	1065	7.80	
80-82-17-05		1320	58	149	0.2	100		
80-82-17-06		65	33	40	<0.1	26		
80-82-17-06A		260	155	156	0.5	1630		
80-82-17-07		15	15	15	15	70	4.80	
80-82-17-08		15	15	15	15	160	6.40	
80-82-17-09		15	15	15	15	190	8.10	
80-82-17-10		15	15	15	15	100	8.80	
80-82-17-11		15	15	15	15	25	3.20	
80-82-17-12		15	15	15	15	<40	1.90	
80-82-18-01		132	36	56	0.3	965		
80-82-18-02		66	40	42	0.1	45		
80-82-18-03		50	38	30	<0.1	140		
80-82-18-04		1380	37	990	0.6	200		

Bondar-Clegg & Company Ltd.
 764 Belfast Road
 Ottawa, Ontario
 Canada K1G 0Z3
 Phone: (613) 237-3110
 Telex: 053-445



REPORT: 112-1336 PROJECT:

PAGE 1

SAMPLE NUMBER	ELEMENT UNITS	Cu PPM	Zn PPM	Ni PPM	As PPM	Au PPM	wt/Au GR	NOTES
BO-82-19-01		204	52	55	0.3			
BO-82-20-01		61	39	51	0.1	40		
BO-82-20-02		131	80	161	0.1	415		
BO-82-20-02A		150	89	156	1.5	445		
BO-82-23-01		70	64	43	0.6	105		
BO-82-23-02		52	32	24	<0.1			
BO-82-23-03		68	33	24	0.2	20		
BO-82-23-04		78	140	37	0.1	135		
BO-82-23-05		137	34	55	0.1			
BO-82-23-06		67	23	28	1.2	1620		

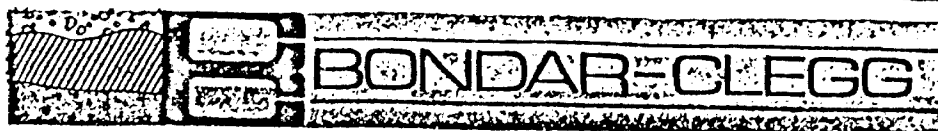

REPORT: 112-1396 PROJECT:

PAGE 1

SAMPLE NUMBER	ELEMENT UNITS	Cu PPM	Zn PPM	Ni PPM	As PPM	Au PPB	wt/Au Gm	NOTES
BO-82-23-07		107	29	40	0.2	2000		
BO-82-23-08		152	54	56	0.2	500		
BO-82-23-09		102	88	79	0.1	30		
BO-82-23-10		158	201	114	0.5	535	9.05	
BO-82-23-11		144	94	87	2.4		9.90	
BO-82-24-01		82	33	29	1.3			
BO-82-24-02		257	54	29	0.9	180		
BO-82-24-03		82	55	50	0.2	1475		
BO-82-24-04		306	97	367	3.6	7410		
BO-82-21-01		58	46	25	0.1	15		
BO-82-21-02		59	39	27	0.1	60		
BO-82-22-01		83	51	27	0.1	105		
BO-82-22-02		52	30	18	0.1	80		
BO-82-22-03		46	28	22	0.2	2180		
BO-82-22-04		51	25	29	0.1	30		
BO-82-22-05		53	27	29	0.1	30		
BO-82-22-06		54	30	23	0.1	400		
BO-82-22-07		59	35	27	0.7	370		
BO-82-22-08		72	32	20	0.3	400		
BO-82-22-09		50	29	18	0.2	30		
BO-82-22-10		54	23	31	0.2	170		

2915
 = 194.3

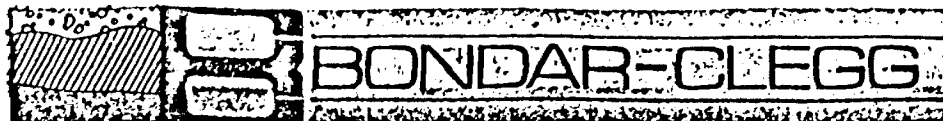

REPORT: 112-1608 PROJECT:

PAGE 1

SAMPLE NUMBER	ELEMENT UNITS	Cu PPM	Zn PPM	Ni PPM	Ag PPM	Au PPB	wt/Au GK	NOTES
BO-82-25-01		54	33	90	0.3	10		
BO-82-25-02		48	29	18	0.1	10		
BO-82-25-03		124	46	27	0.3	20		
BO-82-25-04		119	156	37	0.5	75		
BO-82-25-05		67	57	35	0.3	610		
BO-82-25-06		120	45	45	0.5	440		
BO-82-25A-01		52	35	21	0.1	10		
BO-82-25A-02		52	38	18	<0.1	5		
BO-82-25A-03		80	41	41	0.5			
BO-82-25A-04		87	45	39	0.3	190		
BO-82-25A-05		74	45	26	0.3	40		
BO-82-25A-06		161	51	43	1.1	2675		
BO-82-25A-07		75	119	70	0.2	570		
BO-82-26-01		66	38	27	1.8	390		
BO-82-26-02		54	29	28	0.2	165		
BO-82-26-03		320	27	36	0.3	465		
BO-82-26-04		83	90	16	0.2	2630		
BO-82-26-05		45	36	23	0.2	25		
BO-82-26-06		40	24	22	0.1	195		
BO-82-26-07		50	35	23	0.3	480		
BO-82-26-08		280	53	33	0.4	70		
BO-82-26-09		183	60	76	0.6	35		
BO-82-26-10		91	52	24	0.2	40	4.85	
BO-82-26-11		94	60	53	0.3	45	5.00	
BO-82-26-12		187	48	62	0.3	105		
BO-82-26-13		152	34	56	0.3			
BO-82-26-14		83	19	56	0.3	75		
BO-82-26-15		63	33	33	1.0			
BO-82-26-16		48	111	112	<0.1	20		
BO-82-27-01		49	38	23	0.1	35		
BO-82-27-02		49	36	25	0.1	15		
BO-82-27-03		53	50	32	0.1	210		
BO-82-27-04		99	37	28	<0.1	15	8.00	
BO-82-27-05		44	42	26	0.1	150		
BO-82-27-06		52	41	24	0.3	220		
BO-82-27-07		105	44	30	0.3	95		
BO-82-27-08		77	45	27	0.2	65		
BO-82-27-09		68	28	22	0.3	1150		
BO-82-27-10		460	42	31	0.5	1290		
BO-82-27-11		85	59	32	0.3	260	2.10	

5155 = 156.2
 23



REPORT: 112-1424 PROJECT:

PAGE 1

SAMPLE NUMBER	ELEMENT UNITS	Cu PPM	Zn PPM	Ni PPM	As PPM	Au PPB	w/Au GM	NOTES
BO-82-17-13 B		34	75	178	<0.1	<5		
BO-82-18-05 B		7	45	20	0.2	<5		

Bondar-Clegg & Company Ltd.
764 Belfast Road
Ottawa, Ontario
Canada K1G 0Z5
Phone: (613) 233-
Telex: 053-4455

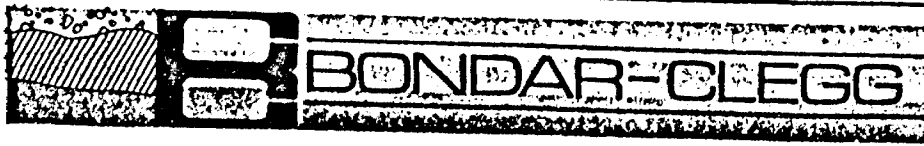

41.
Geochemical
Lab Report

REPORT: 112-1335 PROJECT:

PAGE 1

SAMPLE NUMBER	ELEMENT UNITS	Cu PPM	Zn PPM	Ni PPM	As PPM	Au PPM	wt/Au	NOTES
80-82-19-02-B		31	29	134	<0.1	20		
80-82-20-03-B		2	20	7	0.1	10		
80-82-24-05-B		32	80	161	0.2	10		



REPRT: 112-1395 PROJECT:

PAGE 1

SAMPLE NUMBER	ELEMENT UNITS	Cu PPM	Zn PPM	Ni PPM	As PPM	Au PPB	wt/Au GM	NOTES
B0-82-21-03 B		6	32	16	<0.1	<5		
B0-82-22-11 B		5	43	28	<0.1	<5		



REPORT: 112-1609 PROJECT:

PAGE 1

SAMPLE NUMBER	ELEMENT UNITS	Cu PPM	Zn PPM	Ni PPM	As PPM	Au PPR	wt/Au GN	NOTES
---------------	---------------	--------	--------	--------	--------	--------	----------	-------

BD-82-25A-08B

14 35 25 <0.1 <5

BD-82-27-12B

5 34 27 0.1 <5

APPENDIX V.

INVOICES



Westmin Resources Limited
Toronto, Ontario

CONTROL NO. 0494

TO THE BANK OF MONTREAL
MAIN BRANCH
VANCOUVER, B.C.

WESTMIN
RESOURCES LTD. \$10,335 and 00/100ths

DATE October 15, 1982

PAY
TO THE
ORDER OF

BRADLEY BROS. LIMITED
98, 14th Street
P.O. Box 367
NORANDA, Quebec
J9X 5A9

AMOUNT: 10,335.00
Westmin Resources Limited

R.D. McMillan

NOT NEGOTIABLE

REMITTANCE VOUCHER - DETACH BEFORE DEPOSITING CHEQUE

0494

EXPLANATION	BALANCE
1a Invoice dated Sept.15, 1982 to cover diamond drilling for Sept. 2 to 5, 1982	<i>overburden sh</i> \$ 9,263.00 ✓
1b Invoice dated Sept.15, 1982 to cover diamond drilling for Sept. 7, 1982	<i>overburden sh</i> <u>1,072.00</u> ✓
	<u>\$10,335.00</u> m <i>CB167</i>



Westmin Resources Limited
Toronto, Ontario

0

**BRADLEY
BROS.
LIMITED**

September 15, 1982

COPY

CONTRACT DIAMOND DRILLING

Westmin Resources Limited
Eastern Canada Exploration Office,
Suite 1414 - 390 Bay Street,
Toronto, Ontario M5H 2Y2

HOLE No.

TO COVER DIAMOND DRILLING FOR

Sept. 7

FROM

TO

FOOTAGE COMPLETED

Bond Township

Cost to move out:

36 man hours

@

\$22.00

\$792 00

8 muskeg hours

@

35.00

280 00

\$1,072 00

(12)



Westmin Resources Limited
Toronto, Ontario

CONTROL NO. 0439

TO THE BANK OF MONTREAL
MAIN BRANCH
VANCOUVER, B.C.

WESTMIN RESOURCES LTD. \$23,460 and 00cts

DATE Sept. 15, 1982

AMOUNT \$ 23,460.00
Westmin Resources Limited

R.G. McMillan
B. Lewis

PAY
TO THE
ORDER OF

BRADLEY BROS. LIMITED
98, 14th Street
P.O. Box 367
NORANDA, Quebec
J9X 5A9

0000400001

10911131

0002346000

FOR DEPOSIT ONLY
TO THE CREDIT OF
BRADLEY BROS. LIMITED

SEP 15 1982
9 25 47

SEP 20 1982

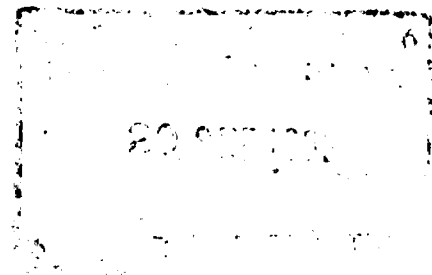

(2)



Westmin Resources Limited
Toronto, Ontario

CONTROL NO. 0439

TO THE BANK OF MONTREAL
MAIN BRANCH
VANCOUVER, B.C.

WESTMIN RESOURCES LTD. \$23,460 and 00 Cts

DATE: Sept. 15, 1982

AMOUNT: 23,460.00
Westmin Resources Limited

PAY TO THE ORDER OF

BRADLEY BROS. LIMITED
98, 14th Street
P.O. Box 367
NORANDA, Quebec
J9X 5A9

R.G. [Signature]
NOT NEGOTIABLE

PERMITTANCE VOUCHER - DETACH BEFORE DEPOSITING CHEQUE

0439

EXPLANATION	BALANCE
2a Inv. dated Aug. 15, 1982 - Aug. 1 to 15, 1982	\$ 6,752.00
2b " " Aug. 15, 1982 - Aug. 3 to 12, 1982	17,093.00
2b Debit Memo No. 27 dated Aug. 30, 1982	<u>(385.00)</u>
	<u>\$23,460.00</u> <i>CB165</i>



Westmin Resources Limited
Toronto, Ontario

(2)

BRADLEY BROS. LIMITED

August 15, 1982

CONTRACT DIAMOND DRILLING

Westmin Resources Limited
Eastern Canada Exploration Office,
Suite 1414 - 390 Bay Street,
Toronto, Ontario M5H 2Y2

HOLE No.

TO COVER DIAMOND DRILLING FOR

Aug. 3 to 12, 1982

FROM

TO

FOOTAGE COMPLETED

Bond Township

Mobilization -
40 miles

@ \$5.00

\$200 00

82-17

0' 240' 240'

18 0' 142' 142'

19 0' 128' 128'

20 0' 139' 139'

21 0' 118' 118'

22 0' 152' 152'

23 0' 180' 180'

24 0' 172' 172'

Equipment rental:
65 hours

@ 218.00

14,170 00

Down the hole consumables:

2 Tricone bits @ \$725.00 - \$1450.00

1 Adaptor @ 570.00 - 570.00

\$2020.00

Plus 15% 303.00

2,323 00

Move from Bond Township to
Currie Twp -
40 miles

@ 5.00

200 00

Demobilization -
40 miles

@ 5.00

200 00

\$17,093 00

2a



Westmin Resources Limited
Suite 1414, 390 Bay Street
Toronto, Ontario, Canada
M5H 2Y2
416 364-8116 Telex: 06-22072

August 30, 1982

Bradley Bros. Limited
98, 14th Street
P.O. Box 367
Noranda, Quebec
J9X 5A9

DEBIT MEMO 27

Debit Memo to adjust your Invoice dated Aug. 15, 1982 covering diamond drilling for August 1 to 15, 1982 as follows:

Invoice reads:	100B Core trays @ \$5.50	=	\$550.00
Invoice should read:	30 " " @ \$5.50	=	<u>165.00</u>
	Debit to Adjust		<u>\$385.00</u>

PER:

Don Robinson
D. Robinson
Project Geologist

PRECIOUS METALS	
DESCRIPTION	AMOUNT
BOND 216	(385.00)
P127	(385.00) 20



Westmin Resources Limited
Toronto, Ontario

CONTROL NO. 0475

TO THE BANK OF MONTREAL
MAIN BRANCH
VANCOUVER, B.C.

WESTMIN RESOURCES LTD. \$1,915 and 06cts

DATE September 28, 1982

PAY TO THE ORDER OF

OVERBURDEN DRILLING MANAGEMENT LTD.
3 Cleopatra Drive
NEPEAN, Ontario
K2G 3M9

AMOUNT \$ 1,915.06
Westmin Resources Limited

R.H. Campbell

B. Lewis

⑆00040⑆00⑆⑆

1091⑆113⑆

⑆0000191506⑆

WESTMIN RESOURCES LTD. \$1,915 and 06cts

SEP 29 1982
COMMERCIAL BANK OF CANADA
VANCOUVER BRANCH

126 786 824

⑆1030836⑆

②



OVERBURDEN DRILLING MANAGEMENT LIMITED

3 CLEOPATRA DRIVE, NEPEAN, ONTARIO K2G 3M9 (613) 226-1774

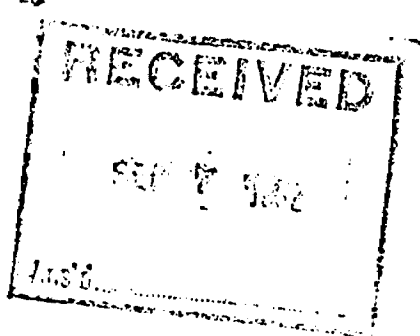

September 02, 1982

To: Westmin Resources Limited
Ste. 1414 -390 Bay Street
Toronto, Ontario
M5H 2Y2

RE: Invoice

Laboratory Services:

prepare heavy mineral concentrates plus
gold count plus gold panning

48 overburden samples @ 30.00 1440.00 ✓

7 bedrock samples @ 2.50 17.50 ✓

1457.50

Field Supplies:

as per attached lists

#1 32.78 ✓

#2 87.40 ✓

#3 32.78 ✓

152.96

Expenses: as per attached summary and receipts

304.60

INVOICE TOTAL:

\$1,915.06 ✓

N. Averill
General Manager

BOND

J.R.



OVERBURDEN DRILLING MANAGEMENT LIMITED

3 CLEOPATRA DRIVE, NEPEAN, ONTARIO K2G 3M9 (613) 226-1774

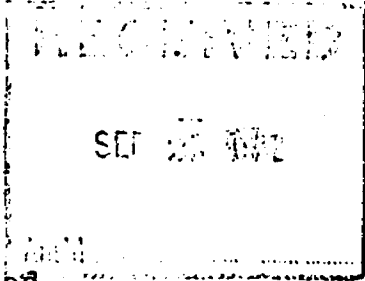

September 21, 1982

To: Westmin Resources Limited
Ste. 1414 - 390 Bay Street
Toronto, Ontario
M5H 2Y2

Re: Final Invoice

Laboratory Services:

40 overburden samples
prepare heavy mineral concentrates plus gold counts
plus panning @ 30.00

1,200.00

Expenses:

as per attached summary and receipts

170.00

\$1,370.00

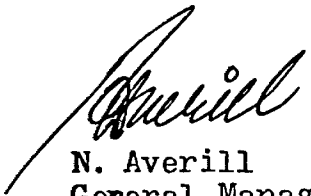
N. Averill
General Manager

PRECIOUS METALS

BOND 335

1,370.00

TR

1,370.00

④

WESTMIN

Westmin Resources Limited

Toronto, Ontario

CONTROL NO. **0468**

TO THE BANK OF MONTREAL
MAIN BRANCH
VANCOUVER, B.C.

WESTMIN RESOURCES LTD. \$160 and 55cts

DATE **September 28, 1982**

PAY
TO THE
ORDER OF

BONDAR-CLEGG & COMPANY LTD.
764 Belfast Road
OTTAWA, Ontario
K1G 0Z5

AMOUNT \$ **160.55**
Westmin Resources Limited

R.H. Small
NOT NEGOTIABLE

EMITTANCE VOUCHER - DETACH BEFORE DEPOSITING CHEQUE

0468

EXPLANATION

BALANCE

5a
5b

Invoice No. 100713 dated August 30, 1982
" 100714 " August 30, 1982

\$ 37.05 ✓
123.50 ✓

\$160.55

CB 166



Westmin Resources Limited
Toronto, Ontario

(5)



BONDAR-CLEGG & COMPANY. LTD.

764 BELFAST ROAD, OTTAWA, ONTARIO, K1G 0Z5 PHONE: 237-3110 TELEX: 053-4455

WESTMIN RESOURCES LIMITED
C. ROCKINGHAM
SUITE 1414- 390 BAY ST.
TORONTO, ONTARIO
M5H 2Y2

Invoice: 100713

Date: August 30, 1982

Report No: 112-1335

3 Analyses of Silver	at	1.90	5.70	
3 Analyses of Copper	at	0.90	2.70	
3 Analyses of Nickel	at	0.90	2.70	
3 Analyses of Zinc	at	0.90	2.70	
Subtotal			13.80	13.80
3 Analyses of Gold - Fire Assay	at	6.00	18.00	
Subtotal			18.00	18.00
Sample Preparation				
3 Samples of PULVERIZE -200	at	1.75	5.25	
Subtotal			5.25	5.25
Invoice Total				\$37.05

Wa
THIS IS A PROFESSIONAL SERVICE
ACCOUNTS DUE WHEN RENDERED

5a



BONDAR-CLEGG & COMPANY LTD.

764 BELFAST ROAD, OTTAWA, ONTARIO, K1G 0Z5 PHONE: 237-3110 TELEX: 053-4455

WESTMIN RESOURCES LIMITED
C. ROCKINGHAM
SUITE 1414- 390 BAY ST.
TORONTO, ONTARIO
M5H 2Y2

Invoice: 100714

Date: August 30, 1982

Report No: 112-1336

10 Analyses of Silver	at	1.90	19.00	
10 Analyses of Copper	at	0.90	9.00	
10 Analyses of Nickel	at	0.90	9.00	
10 Analyses of Zinc	at	0.90	9.00	
Subtotal			46.00	46.00
10 Analyses of Gold - Fire Assay	at	6.00	60.00	
Subtotal			60.00	60.00
Sample Preparation				
10 Samples of PULVERIZE -200	at	1.75	17.50	
Subtotal			17.50	17.50
Invoice Total				\$123.50

Am
THIS IS A PROFESSIONAL SERVICE
ACCOUNTS DUE WHEN RENDERED

56



Westmin Resources Limited
Toronto, Ontario

CONTROL NO. **0493**

TO THE **BANK OF MONTREAL**
MAIN BRANCH
VANCOUVER, B.C.

WESTMIN
RESOURCES LTD. \$486 and 50cts

DATE **October 15, 1982**

AMOUNT: **486.50**
Westmin Resources Limited

R.H. McMillan

NOT NEGOTIABLE

PAY
TO THE
ORDER OF

BONDAR-CLEGG & COMPANY LTD.
764 Belfast Road
OTTAWA, Ontario
K1G 0Z5

EMITTANCE VOUCHER - DETACH BEFORE DEPOSITING CHEQUE

0493

EXPLANATION

BALANCE

6a	Invoice No.	100785	dated	Sept. 3, 1982
6b	"	100784	"	Sept. 3, 1982
6c	"	100903	"	Sept. 15, 1982
6d	"	100904	"	Sept. 15, 1982

\$ 24.70	✓
259.35	✓
24.70	✓
<u>177.75</u>	✓

\$486.50

CB167



Westmin Resources Limited
Toronto, Ontario

6



BONDAR-CLEGG & COMPANY LTD.

764 BELFAST ROAD, OTTAWA, ONTARIO, K1G 0Z5 PHONE: 237-3110 TELEX: 053-4455

WESTMIN RESOURCES LIMITED
D.J. ROBINSON
1414-390 BAY STREET
TORONTO, ONTARIO
M5H 2Y2

Invoice: 100785

Date: September 03, 1982

Report No: 112-1395

6a	2 Analyses of Silver	at	1.90	3.80	
	2 Analyses of Copper	at	0.90	1.80	
	2 Analyses of Nickel	at	0.90	1.80	
	2 Analyses of Zinc	at	0.90	1.80	
	Subtotal			9.20	9.20
	2 Analyses of Gold - Fire Assay	at	6.00	12.00	
	Subtotal			12.00	12.00
	Sample Preparation				
	2 Samples of PULVERIZE -200	at	1.75	3.50	
	Subtotal			3.50	3.50
	Invoice Total				\$24.70

Wm
THIS IS A PROFESSIONAL SERVICE
ACCOUNTS DUE WHEN RENDERED

6a



BONDAR-CLEGG & COMPANY LTD.

164 BELFAST ROAD, OTTAWA, ONTARIO, K1G 0Z5 PHONE: 237-3110 TELEX: 053-4455

WESTMIN RESOURCES LIMITED
D.J. ROBINSON
1414-390 BAY STREET
TORONTO, ONTARIO
M5H 2Y2

Invoice: 100784

Date: September 03, 1982

Report No: 112-1396

21 Analyses of Silver	at	1.90	39.90	
21 Analyses of Copper	at	0.90	18.90	
21 Analyses of Nickel	at	0.90	18.90	
21 Analyses of Zinc	at	0.90	18.90	
Subtotal			96.60	96.60
21 Analyses of Gold - Fire Assay	at	6.00	126.00	
Subtotal			126.00	126.00
Sample Preparation				
21 Samples of PULVERIZE -200	at	1.75	36.75	
Subtotal			36.75	36.75
Invoice Total				6259.35

Wm
THIS IS A PROFESSIONAL SERVICE
ACCOUNTS DUE WHEN RENDERED

68



BONDAR-CLEGG & COMPANY LTD.

4 BELFAST ROAD, OTTAWA, ONTARIO, K1G 0Z5 PHONE: 237-3110 TELEX: 053-4455

WESTMIN RESOURCES LIMITED
D.J. ROBINSON
1414-390 BAY STREET
TORONTO, ONTARIO
MSH 2Y2

Invoice: 100903

Date: September 15, 1982

Report No: 112-1424

2 Analyses of Silver	at	1.90	3.80	
2 Analyses of Copper	at	0.90	1.80	
2 Analyses of Nickel	at	0.90	1.80	
2 Analyses of Zinc	at	0.90	1.80	
Subtotal			9.20	9.20
2 Analyses of Gold - Fire Assay	at	6.00	12.00	
Subtotal			12.00	12.00
Sample Preparation				
2 Samples of PULVERIZE -200	at	1.75	3.50	
Subtotal			3.50	3.50
Invoice Total				\$24.70

Wm
THIS IS A PROFESSIONAL SERVICE
ACCOUNTS DUE WHEN RENDERED

6c



BONDAR-CLEGG & COMPANY LTD.

764 BELFAST ROAD, OTTAWA, ONTARIO, K1G 0Z5 PHONE: 237-3110 TELEX: 053-4455

WESTMIN RESOURCES LIMITED
D.J. ROBINSON
1414-390 BAY STREET
TORONTO, ONTARIO
M5H 2Y2

Invoice: 100904

Date: September 15, 1982

Report No: 112-1425

10 Analyses of Silver	at	1.90	19.00	
10 Analyses of Copper	at	0.90	9.00	
10 Analyses of Nickel	at	0.90	9.00	
10 Analyses of Zinc	at	0.90	9.00	
Subtotal			46.00	46.00
17 Analyses of Gold - Fire Assay	at	6.00	102.00	
Subtotal			102.00	102.00
Sample Preparation				
17 Samples of PULVERIZE -200	at	1.75	29.75	
Subtotal			29.75	29.75
Invoice Total				\$177.75

Wm
THIS IS A PROFESSIONAL SERVICE
ACCOUNTS DUE WHEN RENDERED

6 d

END OF INVOICE PRINTING **BONDAR-CLEGG & COMPANY LTD.**

764 BELFAST ROAD, OTTAWA, ONTARIO, K1G 0Z5 PHONE: 237-3110 TELEX: 053-4455

WESTMIN RESOURCES LIMITED
D.J. ROBINSON
1414-390 BAY STREET
TORONTO, ONTARIO
M5H 2Y2

Invoice: 101124
Date: October 04, 1982
Report No: 112-1609

2 Analyses of Silver	at	1.90	3.80	
2 Analyses of Copper	at	0.90	1.80	
2 Analyses of Nickel	at	0.90	1.80	
2 Analyses of Zinc	at	0.90	1.80	
Subtotal			9.20	9.20
2 Analyses of Gold - Fire Assay	at	6.00	12.00	
Subtotal			12.00	12.00
Sample Preparation				
2 Samples of PULVERIZE -200	at	1.75	3.50	
Subtotal			3.50	3.50
Invoice Total				\$24.70

THIS IS A PROFESSIONAL SERVICE
ACCOUNTS DUE WHEN RENDERED

7a



BONDAR-CLEGG & COMPANY LTD.

64 BELFAST ROAD, OTTAWA, ONTARIO, K1G 0Z5 PHONE: 237-3110 TELEX: 053-4455

WESTMIN RESOURCES LIMITED
D.J. ROBINSON
1414-390 BAY STREET
TORONTO, ONTARIO
M5H 2Y2

Invoice: 101123

Date: October 04, 1982

Report No: 112-1608

40 Analyses of Silver	at	1.90	76.00	
40 Analyses of Copper	at	0.90	36.00	
40 Analyses of Nickel	at	0.90	36.00	
40 Analyses of Zinc	at	0.90	36.00	
Subtotal			184.00	184.00
40 Analyses of Gold - Fire Assay	at	6.00	240.00	
Subtotal			240.00	240.00
Sample Preparation				
40 Samples of PULVERIZE -200	at	1.75	70.00	
Subtotal			70.00	70.00
Invoice Total				\$494.00

THIS IS A PROFESSIONAL SERVICE
ACCOUNTS DUE WHEN RENDERED

76

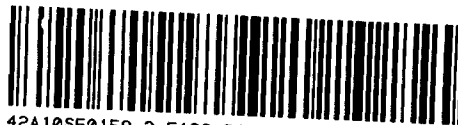

900

1983 05 27

2.5123

Mr. William L. Good
Mining Recorder
Ministry of Natural Resources
60 Wilson Avenue
Timmins, Ontario
P4N 2S7

Dear Sir:

Westmin Resources Limited recorded overburden drilling assessment work credits on each of mining claims P553489 to 502 inclusive, P553579 to 89 inclusive, P553596, P555191 to 205 inclusive, P555427, P555487 to 96 inclusive, P628219-20 P597116 to 21 inclusive on June 25, 1982.

The survey reports and maps were not submitted to the Minister within the time prescribed by Section 77 of the Mining Act.

You are hereby authorized to delete the work credits recorded on June 25, 1982, from each of the claim record sheets. Please inform the recorded holder accordingly.

Yours very truly,

E.F. Anderson
Director
Land Management Branch

Whitney Block, Room 6450
Queen's Park
Toronto, Ontario
M7A 1W3
Phone: 416/965-1380

A. Barr:mc

cc: Westmin Resources Limited
390 Bay Street
Suite 1414
Toronto, Ontario
M5H 2Y2

1983 05 27

2.5123

Mr. William L. Good
Mining Recorder
Ministry of Natural Resources
60 Wilson Avenue
Timmins, Ontario
P4N 2S7

Dear Sir:

RE: Assaying On Mining Claims P 553498 et al in the
Township of Bond

The data for assaying as shown on the attached statement
have been approved as of the above date.

Please inform the recorded holder of these mining claims
and so indicate on your records.

Yours very truly,

E.F. Anderson
Director
Land Management Branch

Whitney Block, Room 6450
Queen's Park
Toronto, Ontario
M7A 1W3
Phone: 416/965-1380

A. Barrimc

Encls:

cc: Westmin Resources Limited
390 Bay Street
Suite 1414
Toronto, Ontario
M5H 2Y2

cc: Resident Geologist
Timmins, Ontario



Ontario

553489

Ministry of
Natural
Resources

Notification of recording
of assessment work credits

RECEIVED

JUL 7 1982

MINING LANDS SECTION

Lands Administration Branch
Mining Lands Section
Ministry of Natural Resources
Room 1617, Whitney Block
Queen's Park, Toronto
M7A 1W3

Date of recording of work: June 25, 1982

Recorded holder: Westmin Resources Limited

Address: 390 Bay Street, Suite 1414,
Toronto, Ontario M5H 2Y2

Township or Area: BOND TOWNSHIP

Type of survey and number of Assessment days credit per claim	Mining claims
Geophysical	40 days on each: P-553489 to 502 incl. ✓ P-553579 to 589 incl. ✓ P-553596 ✓ P-555191 to 205 incl. ✓ P-555427 ✓ P-555487 to 496 incl. ✓
Electromagnetic _____ days	20 days on each: P-628219 to 220 incl. ✓
Magnetometer _____ days	60 days on each: P-597116 to 121 incl. ✓
Radiometric _____ days	
Induced polarization _____ days	
Section ^{77 19} (8) <u>Overburden Drilling</u> days	
Geological _____ days	
Geochemical _____ days	
Man days <input type="checkbox"/>	Airborne <input type="checkbox"/>
Special provision <input type="checkbox"/>	Ground <input type="checkbox"/>

Notice to recorded holder:

Survey reports and maps in duplicate be submitted to the Lands Administration Branch, Toronto within 60 days from the date of recording of this work.

Reports and maps are being forwarded to the Lands Administration Branch with this letter.

Mining recorder
Regional Mining Recorder
c.c. Westmin Resources Limited



Ontario

553489

Ministry of
Natural
Resources

Notification of recording
of assessment work credits

RECEIVED

OCT 18 1982

MINING LANDS SECTION

Lands Administration Branch
Mining Lands Section
Ministry of Natural Resources
Room 1617, Whitney Block
Queen's Park, Toronto
M7A 1W3

Date of recording of work: Sept. 22/82
Recorded holder: Westmin Resources Limited
390 Bay Street
Address: Suite 1414
Toronto, Ontario M5H 2Y2
Township or Area: BOND TOWNSHIP

Type of survey and number of Assessment days credit per claim	Mining claims
Geophysical	
Electromagnetic _____ days	
Magnetometer _____ days	
Radiometric _____ days	
Induced polarization _____ days	
77 19 Overburden Drilling Section 25 (13) See attached list. days	
Geological _____ days	
Geochemical _____ days	
Man days <input type="checkbox"/> Airborne <input type="checkbox"/>	
Special provision <input type="checkbox"/> Ground <input type="checkbox"/>	

Notice to recorded holder:

Survey reports and maps in duplicate be submitted to the Lands Administration Branch, Toronto within 60 days from the date of recording of this work.

Reports and maps are being forwarded to the Lands Administration Branch with this letter.

Regional Mining Recorder
Mining recorder

c.c.

Westmin Resources Limited

SCHEDULE "A"

BOND-OVERBURDEN DRILLING

<u>Claim No.</u>	<u>Days</u>	<u>Claim No.</u>	<u>Days</u>
✓ 1. P.553489	20	23. P.624426	60
2. P.553490	20	✓ 24. P.628015	60
3. P.553491	20	25. P.628016	60
4. P.553492	20	26. P.628057	60
5. P.553493	20	27. P.628058	60
6. P.553494	20	28. P.628059	60
7. P.553495	20	29. P.628060	60
8. P.553496	20	30. P.628061	60
9. P.553497	20	31. P.628062	60
10. P.553498	20	32. P.628063	60
11. P.553499	20	33. P.628064	60
12. P.553500	20	34. P.628065	60
13. P.553501	20	35. P.628066	60
14. P.553502	20	36. P.619113	40
15. P.553586	9	37. P.619114	40
16. P.553587	20	38. P.619115	40
17. P.553588	20	39. P.619116	40
✓ 18. P.553589	20	40. P.619458	40
✓ 19. P.553596	20	41. P.619459	23
✓ 20. P.624423	60	42. P.628219	40
21. P.624424	60	43. P.628220	40
22. P.624425	60		

1,632 days

553489

90

91

92

93

94

95

96

97

98

99

500

1

2/

553586

87

88

89/

553596

624428

24

25

26/

628018

16/

628057

58

59

60

61

62

63

64

65

66

619113

14

15

16/

619458

59/

628219

20

555191

92

93

94

95

96

97

98

99

200

1

2

3

4

5/

555427,

555487

88

89

90

91

92

93

94

95

96

619460

622375

553579

80

81

82

83

84

85

597116

~~17~~ x 60

~~18~~

~~19~~

~~20~~

~~21~~

~~84 claims. 78 claims~~

~~40,359.41~~

~~2691 days~~

~~32 days per claim~~

78 claims

\$44,131.24

2742 days



Ontario

P-553579

Ministry of
Natural
Resources

Notification of recording
of assessment work credits

Lands Administration Branch
Mining Lands Section
Ministry of Natural Resources
Room 1617, Whitney Block
Queen's Park, Toronto
M7A 1W3

Date of recording of work: September 1, 1982

Recorded holder: Westmin Resources Limited

390 Bay Street, Suite 1414,

Address: Toronto, Ontario

Township or Area: BOND TOWNSHIP

Type of survey and number of Assessment days credit per claim	Mining claims
Geophysical	(See attached list.)
Electromagnetic _____ days	
Magnetometer _____ days	
Radiometric _____ days	
Induced polarization _____ days	
Section ^{22 19} 25 (24) Overburden Drilling _____ days	
Geological _____ days	
Geochemical _____ days	
Man days <input type="checkbox"/>	Airborne <input type="checkbox"/>
Special provision <input type="checkbox"/>	Ground <input type="checkbox"/>

Notice to recorded holder:

Survey reports and maps in duplicate be submitted to the Lands Administration Branch, Toronto within 60 days from the date of recording of this work.

Reports and maps are being forwarded to the Lands Administration Branch with this letter.

Mining recorder
Regional Mining Recorder
c.c. Westmin Resources Limited

SCHEDULE "A"

Overburden Drilling , Bond Township

<u>Claim No.</u>	<u>Days</u>	<u>Claim No.</u>	<u>Days</u>
1) P.555191	20	27) P.619113	20 40
2) P.555192	20	28) P.619114	20 40
3) P.555193	20	29) P.619115	20 40
4) P.555194	20	30) P.619116	20 40
5) P.555195	20	31) P.619458	20 40
6) P.555196	20	32) P.619459	20 40
7) P.555197	20	33) P.619460	20
8) P.555198	20	34) P.622375	20
9) P.555199	20	35) P.553579	20
10) P.555200	20	36) P.553580	20
11) P.555201	20	37) P.553581	20
12) P.555202	20	38) P.553582	20
13) P.555203	20	39) P.553583	20
14) P.555204	20	40) P.553584	20
15) P.555205	20	41) P.553585	20
16) P.555427	20	42) P.553586	11
17) P.555487	20		
18) P.555488	20		
19) P.555489	20		
20) P.555490	20		
21) P.555491	20		
22) P.555492	20		
23) P.555493	20		
24) P.555494	20		
25) P.555495	20		
26) P.555496	20		

700-days

Jan 25/83

Mining Lands Comments

To: Geophysics

Comments

Approved Wish to see again with corrections

Date

Signature

To: Geology - Expenditures

MR Kustra

Comments

Approved Wish to see again with corrections

Date

Signature

March 15/83 Kustra

To: Geochemistry

Comments

Approved Wish to see again with corrections

Date

Signature

[Signature]

To: Mining Lands Section, Room 6462, Whitney Block.

(Tel: 5-1380)

P

1982 11 02

2.5123

Mining Recorder
Ministry of Natural Resources
60 Wilson Avenue
Timmins, Ontario
P4N 2S7

Dear Sir:

We have received data for Assaying submitted under Section 77(19) of the Mining Act R.S.O. 1980 submitted on Mining Claims P 553498 et al in the Township of Bond.

This material will be examined and assessed and a statement of assessment work credits will be issued.

Yours very truly,

E.F. Anderson
Director
Land Management Branch

Whitney Block, Room 6450
Queen's Park
Toronto, Ontario
M7A 1W3
Phone: 416/965-1380

DW:sc

cc: Westmen Resources Limited
Toronto, Ontario



Westmin Resources Limited
Suite 1414, 390 Bay Street
Toronto, Ontario, Canada
M5H 2Y2
416 364-8116 Telex: 06-22072

RECEIVED

DEC 20 1982

MINING LANDS SECTION

December 17, 1982.

Ministry of Natural Resources,
Land Admin. Branch,
Whitney Block, Room 6450,
Queen's Park,
Toronto, Ontario.
M7A 1W3.

Dear Sir:

Your File: 2.5123

Re: Overburden Drilling Report, Bond Twp.

As you were advised in my letter of October 22, 1982, please find enclosed the copies of cancelled cheques which should accompany the above mentioned report.

Also is enclosed for your file a Certificate of Education of Mr. D. Robinson, who is the author of this report.

I hope you will find everything in order.

Yours truly,

WESTMIN RESOURCES LIMITED

A handwritten signature in cursive script, appearing to read "S. Kuprejanov".

(Mrs.) S. Kuprejanov,
Administrative Geologist.

SK/hmc
Encls.

Certification

I, D. J. Robinson, of 110 Rosedale Hts. Dr.,
Toronto, Ontario, M4T 1C6, certify:

- 1) I hold a B.Sc. (1977) degree from the
University of Western Ontario.
- 2) I hold a Ph.D. (1982) degree from the
University of Western Ontario.
- 3) Am a member of the Geological Association
of Canada and the Prospectors and Developers
Association.
- 4) Am employed as a Project Geologist with
Westmin Resources Limited since 1980.

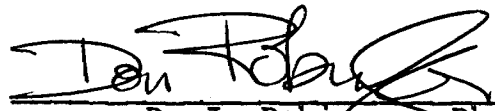

D. J. Robinson, Ph.D.

December 17, 1982.

5



Westmin Resources Limited
Toronto, Ontario

WESTMIN
MILES LTD. \$350 and 35cts

CONTROL NO. 0136

TO THE BANK OF MONTREAL
MAIN BRANCH
VANCOUVER, B.C.

DATE March 26, 1982

AMOUNT: 350.35
Westmin Resources Limited

PAY
TO THE
ORDER OF

OVERBURDEN DRILLING MANAGEMENT LTD.
192 Powell Avenue
OTTAWA, Ontario
K1S 2A5

R.A. M... ..

NOT NEGOTIABLE

REMITTANCE VOUCHER - DETACH BEFORE DEPOSITING CHEQUE

0136

EXPLANATION	BALANCE
Invoice dated March 1, 1982 re Overburden Drilling Program	<u>\$350.35</u> CB152



Westmin Resources Limited
Toronto, Ontario



Westmin Resources Limited
Toronto, Ontario

CONTROL NO. 0217

TO THE BANK OF MONTREAL
MAIN BRANCH
VANCOUVER, B.C.

WESTMIN RESOURCES LTD. \$2,512 and 45cts

DATE May 17, 1982

AMOUNT \$ 2,512.45
Westmin Resources Limited

PAY TO THE ORDER OF

OVERBURDEN DRILLING MANAGEMENT LTD.
3 Cleopatra Drive
NEPEAN, Ontario
K2G 3M9

R. H. McMill

B. Lewis

⑆00040⑆00⑆⑆⑆

109⑆⑆⑆113⑆⑆

⑆0000251245⑆

WESTMIN RESOURCES LTD. 021 2333033R

52002

00225-003
THE ROYAL BANK OF CANADA
THE ROYAL BANK OF CANADA
BANK & HERON BRANCH
OTTAWA, ONTARIO
00226-003

MAY 27 1982

⑆28017105

⑆90063371

⑆1019782⑆

WESTMIN

Westmin Resources Limited

Toronto, Ontario

CONTROL NO. **0217**

TO THE BANK OF MONTREAL
MAIN BRANCH
VANCOUVER, B.C.

WESTMIN RESOURCES LTD. \$2,512 and 45cts

DATE **May 17, 1982**

AMOUNT \$ **2,512.45**
Westmin Resources Limited

PAY
TO THE
ORDER OF

**OVERBURDEN DRILLING MANAGEMENT LTD.
3 Cleopatra Drive
NEPEAN, Ontario
K2G 3M9**

R. H. McMillan
NOT NEGOTIABLE

REMITTANCE VOUCHER - DETACH BEFORE DEPOSITING CHEQUE

0217

EXPLANATION	BALANCE
Invoice dated April 6, 1982 " " April 13, 1982	\$1,760.45 ✓ <u>752.00</u> ✓ <u>\$2,512.45</u> <i>CB155</i>



Westmin Resources Limited
Toronto, Ontario



OVERBURDEN DRILLING MANAGEMENT LIMITED

3 CLEOPATRA DRIVE, NEPEAN, ONTARIO K2G 3M9 (613) 226-1774

April 13, 1982

Westmin Resources Limited
Ste. 1414-390 Bay St.
Toronto, Ont.
M5H 2Y2

Re: BO Service Sample processing-Final Invoice

31 overburden samples
prepare heavy mineral
concentrates plus Au
count @24.00/sample = \$744.00 ✓

Expenses: as per
attached receipt
(Speedy to Bondar Clegg) 8.00 ✓

\$752.00 ✓

Yours truly,

Nancy Averill
Nancy Averill
General Manager
NA/he

PRECIOUS METALS

Bond 335 752.00

P116 DR. R 752.00



Westmin Resources Limited
Toronto, Ontario

CONTROL NO. 0234

TO THE BANK OF MONTREAL
MAIN BRANCH
VANCOUVER, B.C.

WESTMIN
RESOURCES LTD. \$1,139 and 50cts

DATE: May 28, 1982

AMOUNT \$ 1,139.50
Westmin Resources Limited

PAY
TO THE
ORDER OF

BONDAR-CLEGG & COMPANY LTD.
764 Belfast Road
OTTAWA, Ontario
K1G 0Z5

R.H. McMillan
S. Lewis

⑆00040⑆00⑆⑆

⑆09⑆⑆⑆⑆⑆⑆⑆

⑆0000⑆⑆⑆⑆⑆⑆⑆

FOR DEPOSIT ONLY
TO THE CREDIT OF
BONDAR - CLEGG & CO. LIMITED
106-637-2

⑆0000⑆⑆⑆⑆⑆⑆⑆

⑆0000⑆⑆⑆⑆⑆⑆⑆

JE 02 24 1982
BANK OF MONTREAL
VANCOUVER BRANCH



Westmin Resources Limited
Toronto, Ontario

CONTROL NO. **0234**

TO THE BANK OF MONTREAL
MAIN BRANCH
VANCOUVER, B.C.

WESTMIN RESOURCES LTD. \$1,139 and 50cts

DATE **May 28, 1982**

AMOUNT **\$ 1,139.50**
Westmin Resources Limited

PAY
TO THE
ORDER OF

BONDAR-CLEGG & COMPANY LTD.
764 Belfast Road
OTTAWA, Ontario
K1G 0Z5

[Signature]
NOT NEGOTIABLE

REMITTANCE VOUCHER - DETACH BEFORE DEPOSITING CHEQUE

0234

EXPLANATION	BALANCE
Invoice No. F03078 dated Apr. 20, 1982 " F03080 " Apr. 20, 1982	\$ 940.75 <u>198.75</u> <u>\$1,139.50</u>
	<i>CB156</i>



Westmin Resources Limited
Toronto, Ontario



BONDAR-CLEGG & COMPANY LTD.

764 BELFAST ROAD, OTTAWA, ONTARIO, K1G 0Z5 PHONE: 237-3110 TELEX: 053-4455

Westmin Resources Limited
1414-390 Bay Street
Toronto, Ontario
M5H 2Y2
Attention: D. Robinson

INVOICE: **F 03080**

DATE: April 20, 1982

REPORT NO: 112-0370

PROJECT:

15	Analyses of Copper	@\$1.90	\$28.50
15	Analyses of Lead	@ .90	13.50
15	Analyses of Zinc	@ .90	13.50
15	Analyses of Nickel	@ .90	13.50
15	Analyses of Silver	@ .90	13.50
15	Analyses of Gold	@ 6.00	90.00
15	Sample Preparations	@ 1.75	26.25
		TOTAL	\$198.75 ✓

PRECIOUS METALS

<i>BOND</i>	<i>335</i>	<i>198</i>	<i>75</i>
<i>P117</i>	<i>DR.</i>	<i>198</i>	<i>75</i>

mk

Wm

**THIS IS A PROFESSIONAL SERVICE
ACCOUNTS DUE WHEN RENDERED**



BONDAR-CLEGG & COMPANY LTD.

64 BELFAST ROAD, OTTAWA, ONTARIO, K1G 0Z5 PHONE: 237-3110 TELEX: 053-4455

INVOICE: **F 03078**

Westmin Resources Limited
1414-390 Bay Street
Toronto, Ontario
M5H 2Y2
Attention: D. Robinson

DATE: April 20, 1982

REPORT NO: 112-0369

PROJECT:

71	Analyses of Copper	@ \$1.90	\$134.90
71	Analyses of Lead	@ .90	63.90
71	Analyses of Zinc	@ .90	63.90
71	Analyses of Nickel	@ .90	63.90
71	Analyses of Silver	@ .90	63.90
71	Analyses of Gold	@ 6.00	426.00
71	Sample Preparations	@ 1.75	124.25
		TOTAL	<u>\$940.75</u> ✓

PRECIOUS METALS

BOND 335 940 75

P117 DR. R 940 75

Wm

THIS IS A PROFESSIONAL SERVICE
ACCOUNTS DUE WHEN RENDERED



Westmin Resources Limited
 Suite 1414, 390 Bay Street
 Toronto, Ontario, Canada
 M5H 2Y2
 416 364-8116 Telex: 06-22072

RECEIVED	
Land Management Branch	
<input type="checkbox"/> CIRCULATE	<input type="checkbox"/>
<input type="checkbox"/> COMMENTS PLEASE	<input type="checkbox"/>
BY	
OCT 26 1982	
E. F. ANDERSON	<input type="checkbox"/>
J. R. MORTON	<input type="checkbox"/>
J. C. SMITH	<input checked="" type="checkbox"/>
G. SHERMAN	<input type="checkbox"/>
	<input type="checkbox"/>
	<input type="checkbox"/>
	<input type="checkbox"/>

REGISTERED MAIL

October 22, 1982.

Ministry of Natural Resources,
 Lands Admin. Branch,
 Room 6450, Whitney Block,
 Queen's Park,
 Toronto, Ontario.
 M7A 1X1.

Dear Sir:

Please find enclosed in duplicate the Overburden Report, Bond Township. The form "Report on Work" has been submitted to the Mining Recorder Office in Timmins.

Please be advised that as at today, we do not have back all cancelled cheques and in some cases we have enclosed the invoice or cheque with which the payment was made. As soon as we have the cancelled cheques we shall forward copies to you.

Thank you and I hope you will find everything in order.

Yours truly,

WESTMIN RESOURCES LIMITED

(Mrs.) S. Kuprejanov,
 Administrative Geologist.

SK/hmc

GEOLOGIST: D.J. Robinson

DATE: Aug 3/82

HOLE # B0-82-17

SAMPLER: T. Hughes

CLAIM GROUP: BOND

PROV.: ONT.

CONTRACTOR/
DRILLER: Bradley Bros.

FIELD
LOCATION: L28W 4100N MOOSE
ANOMALY

BIT NO.: B64491 NTS: 42A/7, A/10

13 1/2 hrs. drilling time, hole complete 2:00 PM Aug. 5/82

Log (inches)	Sample No.	Overburden Description	Notes & Analyses
0		<u>HUMUS</u>	
0-1		Brown leached <u>CLAY.</u>	
1-5		Grey <u>CLAY</u> - Barlow - Ojibway	
5-20			
20-25		Fine <u>SAND</u>	
25-25.9		- no clay component - intercalated clay lenses	
25.9-30		- Petrified wood @ 25.9.	
30-40			
40-45		- pebble layer	
45-48		- pebble layer	
48-50		- clay layer	
50	B0-82-17-1		

GEOLOGIST: D.J. Robinson DATE: Aug 3/82 HOLE # Bo-82-17
 SAMPLER: T. Hughes CLAIM GROUP: BOND PROV.: GNT.
 CONTRACTOR/ DRILLER: Bradley Bros FIELD LOCATION: L28 W 4100N, MOOSE ANOMALY
 BIT NO.: B64491 NTS: 42 A/7, A/10

Log (inches)	Sample No.	Overburden Description	Cu, Zn, Ni, Ag, Au				
			Notes & Analyses				
50	Bo-82-17-1	GRAVEL - polymictic	70	35	42	0.2	70
	2	- coarse sandy matrix	73	34	54	0.1	875
	3	60% volcanic pebbles	62	25	48	<0.1	30
55	4	40% sediments + granite.	-	-	-	-	1065
	5	- pebble provenance more local down	1320	58	149	0.2	100
60	6	section, 75% UM &	65	33	40	<0.1	26
	7	MV < 25% Seds. & Gran. ^{GA}	260	155	156	0.5	1630
	8	- scattered cobbles					70
65	9	- numerous serpentized peridotite pebbles.					160
	10	- sand matrix.					190
	11	- no clay component					100
70	12						25
	13	SERPENTINIZED BEDROCK: PERIDOTITE (FLOW?) - v.f.g., msv., dark grn.					<40
75		73.17 metres T.D.	34	75	178	<0.1	<5
			J	N	Z	Ag	Au
			} ppm				ppb

Don Robinson

GEOLOGIST: D.J. Robinson DATE: Aug. 5/82 HOLE # 80-82-18
 SAMPLER: T. Hughes CLAIM GROUP: BOND PROV.: ONT
 CONTRACTOR/DRILLER: Bradley Bros. FIELD LOCATION: L16W 4400N, MOOSE ANOMALY
 BIT NO.: B64491 NTS: 42 A/7, A/10

3 hrs. drilling time. , hole complete 9:20 am Aug. 6/82

Log (inches)	Sample No.	Overburden Description	Notes & Analyses							
0 - 1		<u>HUMUS</u>								
1 - 2		<u>Brown CLAY</u>								
2 - 4		<u>Grey CLAY - Barlow - Ojibway</u>								
4 - 6		<u>Fine SAND</u>								
6 - 8		- clay layer								
8 - 10		- petrified wood chips								
10 - 12		- clay layer								
12 - 14										
14 - 16										
16 - 18										
18 - 20										
20 - 22										
22 - 24										
24 - 26										
26 - 28										
28 - 30										
30 - 32										
32 - 34	80-82-18-1	<u>Pebbly Till - CTB's</u>								
34 - 36	2	<u>GRAVEL - polyhedral sand matrix</u>	132	36	56	0.3	965			
36 - 38	3	<u>SAND</u> - v. few pebbles poor sampling medium	66	40	42	0.1	45			
38 - 40	4	<u>GRAVEL - polyhedral</u> 60% volc - coarse sand 40% sdst + gran.	50	38	30	<0.1	140			
40 - 42	5	<u>BEDROCK - FELSIC VOLCANIC</u>	1380	37	990	0.6	200			
42 - 44		T.D. 43.29 metres.	7	45	20	0.2	<5			
44 - 46		- Fv. - mov, vfg., chl. a.Hn. 5% diss. pyrite.								
46 - 48										
48 - 50										

Don Robinson

2.5123

GEOLOGIST: D.J. Robinson DATE: Aug. 6/82 HOLE # B0-82-19
 SAMPLER: T. Hughes CLAIM GROUP: BOND PROV.: ONT.
 CONTRACTOR/DRILLER: Bradley Bros. FIELD LOCATION: L22 W B.L., MOOSE ANOMALY
 BIT NO.: B64491 NTS: 42 A/9, A/10

1 1/2 hrs. drilling time., hole complete 11:30am Aug. 6/82

Log (inches)	Sample No.	Overburden Description	Notes & Analyses															
0		<u>HUMUS</u>																
0-5		<u>CLAY</u> - brown, leached - grey, ropey																
5-10		<u>SAND</u> - fine. - clay lenses																
10-35																		
35-40	B0-82-19-1	<u>CLAY-PEBBLE TILL</u> - <TB's, local vole pebbles sandy clay matrix	<table border="1"> <thead> <tr> <th>Cu</th> <th>Zn</th> <th>Ni</th> <th>Ag</th> <th>Au</th> </tr> </thead> <tbody> <tr> <td>204</td> <td>52</td> <td>55</td> <td>0.3</td> <td>3770</td> </tr> <tr> <td>31</td> <td>29</td> <td>134</td> <td><0.1</td> <td>20</td> </tr> </tbody> </table>	Cu	Zn	Ni	Ag	Au	204	52	55	0.3	3770	31	29	134	<0.1	20
Cu	Zn	Ni	Ag	Au														
204	52	55	0.3	3770														
31	29	134	<0.1	20														
40-45	2	<u>BEDROCK</u> - SERPENTINIZED PERIDOTITE - chl + talc aHh																
45-50		T.D. - 39.02 metres 19-01 3VG's																

Don Robinson

Hole No.	Page No.
B0-82-19	1 of 1

2.5183

GEOLOGIST: D.J. Robinson DATE: Aug. 6/82 HOLE # BO-82-20

SAMPLER: T. Hughes CLAIM GROUP: BOND PROV.: ONT.

CONTRACTOR/DRILLER: Bradley Bros. FIELD LOCATION: L22W, 4+50S; MCGEE ANOMALY

BIT NO: B64491 NTS: 42A/7, A/10

3 1/2 hrs. drilling time, hole complete 3:00pm Aug 6/82

Log (inches)	Sample No.	Overburden Description	Notes & Analyses										
0 - 5		<u>HUMUS</u> <u>CLAY</u> - brown, leached - gray											
5 - 35		<u>SAND</u> - very fine - scattered clay lenses.											
35 - 40	Bo-82-20-1	<u>PEBBLE</u> - <u>CLAY TILL</u> - CTG's - sandy-clay matrix - poly metric 60% volc 40% sed.	<table border="1"> <thead> <tr> <th>Cu</th> <th>Zn</th> <th>Ni</th> <th>Ag</th> <th>Au</th> </tr> </thead> <tbody> <tr> <td>61</td> <td>39</td> <td>51</td> <td>0.1</td> <td>40</td> </tr> </tbody> </table>	Cu	Zn	Ni	Ag	Au	61	39	51	0.1	40
Cu	Zn	Ni	Ag	Au									
61	39	51	0.1	40									
40 - 42	2 & 2A	- felsic volc. bldr. in pebbly-clay till - sandy matrix	<table border="1"> <tbody> <tr> <td>131</td> <td>80</td> <td>161</td> <td>0.1</td> <td>415</td> </tr> <tr> <td>150</td> <td>89</td> <td>156</td> <td>1.5</td> <td>445</td> </tr> </tbody> </table>	131	80	161	0.1	415	150	89	156	1.5	445
131	80	161	0.1	415									
150	89	156	1.5	445									
42 - 45	3	<u>BEDROCK</u> - <u>VOLCANIC?</u> - bright green & white coarse quartz chips & mica - grn. matrix, v. soft. chl?	<table border="1"> <tbody> <tr> <td>2</td> <td>20</td> <td>7</td> <td>0.1</td> <td>10</td> </tr> </tbody> </table>	2	20	7	0.1	10					
2	20	7	0.1	10									
45 - 50		T.D. - 48.38 metres Same as. Bo-82-16. 42.37											

Don Robinson

GEOLOGIST: D.J. Robinson DATE: Aug 9/82 HOLE # B0-82-21
 SAMPLER: T. Hughes CLAIM GROUP: Bond PROV.: Ont.
 CONTRACTOR/DRILLER: Bradley Bros. FIELD LOCATION: L12W, 9400S; Driftwood Gp.
 BIT NO.: B64491 NTS: 42A/7, A/10

3hrs 25min. drilling time, hole complete 4:10 pm. Aug 9/82.

Log (inches)	Sample No.	Overburden Description	Notes & Analyses				
0		<u>HUMUS</u>					
5		<u>CLAY</u> - brown, leached upper layer - grey					
10							
15							
20							
25		<u>CLAY & SAND</u>					
30	B0-82-21-1	<u>CLAY-PEBBLE TILL</u> - clay tillballs - clay coated pebbles, polymitic UM, MV, SEDS; clay-sand matrix	Cu	Zn	Ni	Ag	Au
	2	<u>SANDY-GRAVEL</u> - no clay, sand matrix	58	46	25	0.1	15
	3	<u>BEDROCK</u> - ANDESITIC TUFF - pale gry-grn - v.f.g., foliated	59	39	27	0.1	60
35			6	32	16	<0.1	<5
40		T.D. - 35.97 metres					
45							
50							

Don Robinson

2.5123

GEOLOGIST: D.J. Robinson DATE: Aug 10/82 HOLE # 80-82-22
 SAMPLER: T. Hughes CLAIM GROUP: Bond PROV.: Ont
 CONTRACTOR/DRILLER: Bradley Bros. FIELD LOCATION: L20W, 9400S; Driftwood Gp.
 BIT NO.: B64488 NTS: 42A/7, A/10
 6hrs drilling time, hole complete 2:30 pm Aug. 10/82

Log (inches)	Sample No.	Overburden Description	Notes & Analyses				
0		<u>HUMUS</u>					
0-5		<u>CLAY</u> - brown, leached upper horizon.					
25		<u>SANDY-GRAVEL</u>	Cu	Zn	Ni	Ag	Au
25-30	80-82-22-1	- polymeric - sandy matrix	83	51	27	0.1	105
30-35	2	- 4mm, MV, GRAN, SED. pebbles	52	30	18	0.1	80
35-40	3		46	28	22	0.2	2180
40-45	4	- 80% coarse sand, 20% pebbles	51	25	29	0.1	30
45-50	5	- minor clay till & gravels.	53	27	29	0.1	30
50-55	6		54	30	23	0.1	400
55-60	7		59	35	27	0.7	370
60-65	8		72	32	20	0.3	400
65-70	9		50	29	18	0.2	30
70-75	10		54	23	31	0.2	170
75-80	11	<u>BEDROCK</u> - MAFIC TUFF - dark green - v.f.g., tuffaceous	5	43	28	<0.1	<5
		T.D. - 46.34 m					

Don Robinson

Hole No.	Page No.
80-82-22	1 of 1

GEOLOGIST: D.J. Robinson DATE: Aug 9, 10/82 HOLE # Bo-82-23

SAMPLER: T. Hughes CLAIM GROUP: Bond PROV.: Ont.

CONTRACTOR/ DRILLER: Bradley Bros. FIELD LOCATION: L 16 W, 12400 S; Driftwood Gp.

BIT NO.: B64488 NTS: 42A/7, A/10

6 1/2 hrs drilling time, bit worn out., hole terminated 1:00 pm Aug 10/82.

Log (inches)	Sample No.	Overburden Description	Notes & Analyses 10/82.					
0 - 40		<u>HUMUS</u> <u>CLAY</u>						
40 - 42	Bo-82-23-1	<u>SAND & GRAVEL</u> - polyminetic - coarse sand matrix	Cu	Zn	Ni	Ag	Au	
42 - 44	2	- minor till - clay layer	70	64	43	0.6	105	
44 - 46	3	<u>SANDY-CLAY TILL</u> - minor clay till balls	52	32	24	50.1		
46 - 48	4	<u>SANDY GRAVEL</u> - local volc. pebbles	68	33	24	0.2	20	
48 - 50	5	- gravelly till, clay till balls.	78	140	37	0.1	135	
	6		137	34	55	0.1	3365	
	7		67	23	28	1.2	1620	
			107	29	40	0.2	2000	

25123

GEOLOGIST: D.J. Robinson DATE: Aug 10/82 HOLE # Bo-82-23
 SAMPLER: T. Hughes CLAIM GROUP: Bond PROV.: Ont.
 CONTRACTOR/DRILLER: Bradley Bros FIELD LOCATION: L16W, 12+00S; Driftwood Gp
 BIT NO.: B64488 NTS: 42A/7, A/10

Log (inches)	Sample No.	Overburden Description	Notes & Analyses							
			152	54	56	0.2	500			
50	8	SANDY-GRAVEL - polymictic								
	9	- coarse sand matrix	102	88	79	0.1	30			
	10		158	201	114	0.5	535			
55	11	BEDROCK? - MAFIC-UMAFIC VOLCANIC RX. - dark grn - v.f.g., massive	144	94	87	2.4				
60		T.D. - 54.88 m - bit worn out								
65		- drilling terminated at 1.00 pm.								

Jon Robinson

25123

GEOLOGIST: D.J. Robinson DATE: Aug 11/82 HOLE # B0-82-24
 SAMPLER: T. Hughes CLAIM GROUP: Bond PROV.: Orl.
 CONTRACTOR/DRILLER: Bradley Bros. FIELD LOCATION: L16W, 16400S; Driftwood Gp.
 BIT NO.: B64487 NTS: 42A/7, A/10

3 hrs drilling time, hole complete 4:45pm Aug. 11/82

Log (inches)	Sample No.	Overburden Description	Notes & Analyses				
0 - 4		<u>HUMUS</u>					
4 - 38		<u>CLAY</u>					
38 - 42		<u>SAND & CLAY</u>					
42 - 44							
44 - 46	B0-82-24-1	<u>SANDY-GRAVEL</u> - coarse sand matrix - polymictic pebble assortment	Cu	Zn	Ni	Ag	Au
46 - 48	2	<u>CLAY-PEBBLE TILL</u> - clay till balls	82	33	29	1.3	
48 - 50	3	- very minor sand matrix	257	54	29	0.9	160
50 - 52	4	<u>GRAVELLY TILL</u>	82	55	50	0.2	1475
52 - 54	5	<u>BEDROCK - FELSIC TUFF</u> - paly grey. - v.f.g., foliated. - quartz eyes & veins.	306	97	367	3.6	410
54 - 60		T.D. - 52.44m	32	80	161	0.2	10

Don Robinson

Hole No.	Page No.
B0-82-24	1 of 1

DATE SEPT 1/82 HOLE No. BO-82-25 GEOLOGIST D.R. DRILLER G.G.
 HOLE LOCATION L4 + 80 W, 3+20S; Driftwood anomaly
 BIT No. B64519 FOOTAGE ON BIT new
 HOURS MOVE 1hr 30min. HOURS DRILL 2hrs. 30min. OTHER Burnt bit,
blocked adapter, drilling suspended at 47 m.

DEPTH	GRAPHIC LOG	SAMPLE No.	DESCRIPTIVE LOG	ANALYSES					
0			<u>MUSKEG</u> <u>CLAY</u>						
5									
10									
15									
20									
25									
30									
35		1	<u>CLAY TILL</u> - clay + sand matrix						
40		2	<u>PEBBLE - CLAY TILL</u> - gritty clay matrix - 80% clay, 20% pebbles						
40		3	<u>CLAY</u> <u>CLAY - PEBBLE TILL</u>						
40		4	<u>GRAVEL</u> - polymetric pebble assortment						
45		5	<u>GRAVEL</u> <u>CLAY PEB. TILL</u>						
45		6	- few small bldrs. , - clay + sand matrix						
50			ABANDONED. @ 44 m blocked bit & adapter						

NO SAMPLES

Don Robinson

DATE SEPT. 2/82 HOLE NO. BO-82-25A GEOLOGIST D.R. DRILLER GG

HOLE LOCATION L4+80W, 3+20S; Driftwood Group

BIT No. B65518 FOOTAGE ON BIT new

HOURS MOVE — HOURS DRILL 5hrs. OTHER BO-82-25

drilling suspended - blocked & burnt bit @ 47m.

DEPTH	GRAPHIC LOG	SAMPLE No.	DESCRIPTIVE LOG	ANALYSES					
0			<u>MUSKEG</u>						
			<u>CLAY</u>						
5									
10									
15									
20									
25									
30									
35		1	<u>CLAY - PEBBLE - SANDY TILL</u>						
		2	<u>CLAY TILL</u>						
		No SAMPLE	<u>SAND</u> <u>CLAY</u>						
40		3	<u>PEBBLE - CLAY TILL</u>						
		4	<u>GRAVELLY TILL</u>						
45		5	" "	- minor gritty clay					
		6	" "	- clast dominant					
		7	" "	- matrix poor.					
50			<u>GRAVEL</u>						
			- no clay, matrix poor						

NO SAMPLES

DATE SEPT. 4/82 HOLE No. BO-82-26A GEOLOGIST D.R. DRILLER G.G.

HOLE LOCATION LA+80 W, 2toos; Driftwood Group.

BIT No. B64517 FOOTAGE ON BIT new
B64516

HOURS MOVE 30min HOURS DRILL 7hrs 15min OTHER Broken bit
adapter, & faulty rod, must redrill hole after 42m on first attempt.

DEPTH	GRAPHIC LOG	SAMPLE No.	DESCRIPTIVE LOG	ANALYSES					
0			<u>MUSKEG</u>						
			<u>CLAY</u>						
5									
10									
15									
20									
			<u>SANDY GRAVEL</u>						
		1	- coarse sand matrix - polymictic peb. assortment						
25		2	<u>SAND & COARSE GRAVEL</u>						
		3	<u>GRAVEL</u>						
		4	<u>SANDY GRAVEL</u>						
		5	" " - poor return - matrix dominant						
		6	<u>SAND.</u>						
		7	<u>SAND & GRAVEL</u> - narrow clay till layer.						
40		8	<u>GRAVEL</u> - coarse sand matrix						
		9	" " - gran. bldr.						
		10	<u>CLAY TILL</u> 80% gritty clay 20% pebbles						
45		11	<u>SAND & GRAVEL</u>						
		12	<u>GRAVEL</u> - cobbles, pebbles, in sand matrix						
50		13	" "						

2.5133

DATE SEPT 5/82 HOLE No. BD-82-27 GEOLOGIST D.R. DRILLER G.G.
 HOLE LOCATION L 6400W, 2400 S; Driftwood Group.
 BIT No. B600067 FOOTAGE ON BIT new
 HOURS MOVE 30 min. HOURS DRILL 3 hrs. 15 min. OTHER Acker drill

DEPTH	GRAPHIC LOG	SAMPLE No.	DESCRIPTIVE LOG	ANALYSES					
0		NON SAMPLES	<u>MUSKEG</u>						
5			<u>CLAY</u> - grey, ropey, soft						
10									
15									
20					<u>SANDY-GRAVEL</u>				
				1	- very coarse matrix, polymictic pebble conc. volc-gran-seals				
				2	<u>SAND</u> & pebbles				
25				3	<u>SANDY-GRAVEL</u>				
					- porphyritic maf. volc. bldr.				
				4	<u>SAND & GRAVEL</u>				
					- coarse to fine sand matrix				
30				5	<u>SAND</u>				
			- fine sand matrix						
35		6	<u>SAND</u> & pebbles & minor clay matrix						
			- volc bldr.						
		7	<u>SANDY-GRAVEL</u>						
			- gran. bldr.						
35		8	<u>CLAY TILL</u> 80% gritty clay						
			20% pebbles (volc.) < 1/2 cm size						
		9	<u>GRAVELLY TILL</u> maf. volc bldr.						
			- clay till balls						
			- matrix-poor						
40		10	<u>SANDY GRAVEL</u>						
			- kom. perid. bldr & po						
		11	<u>CLAY-PEBBLE TILL</u> - basal clay till						
		12	<u>BEDROCK</u>						
45			- Mafic volc. rx (tuff?)						
			- dark green, very fine grained						
			- schistose						
50			T.D. 44.2 m						
			Don Robinson						

BOND TOWNSHIP

DATE OF ISSUE
 APR 22 1963
 Ministry of Natural Resources
 TORONTO

ONTARIO
 MINISTRY OF NATURAL RESOURCES
 SURVEYS AND MAPPING BRANCH

PORCUPINE MINING DIVISION

DISTRICT OF COCHRANE

M.331

SCALE 40 CHAINS TO ONE INCH
 STOCK TWP.

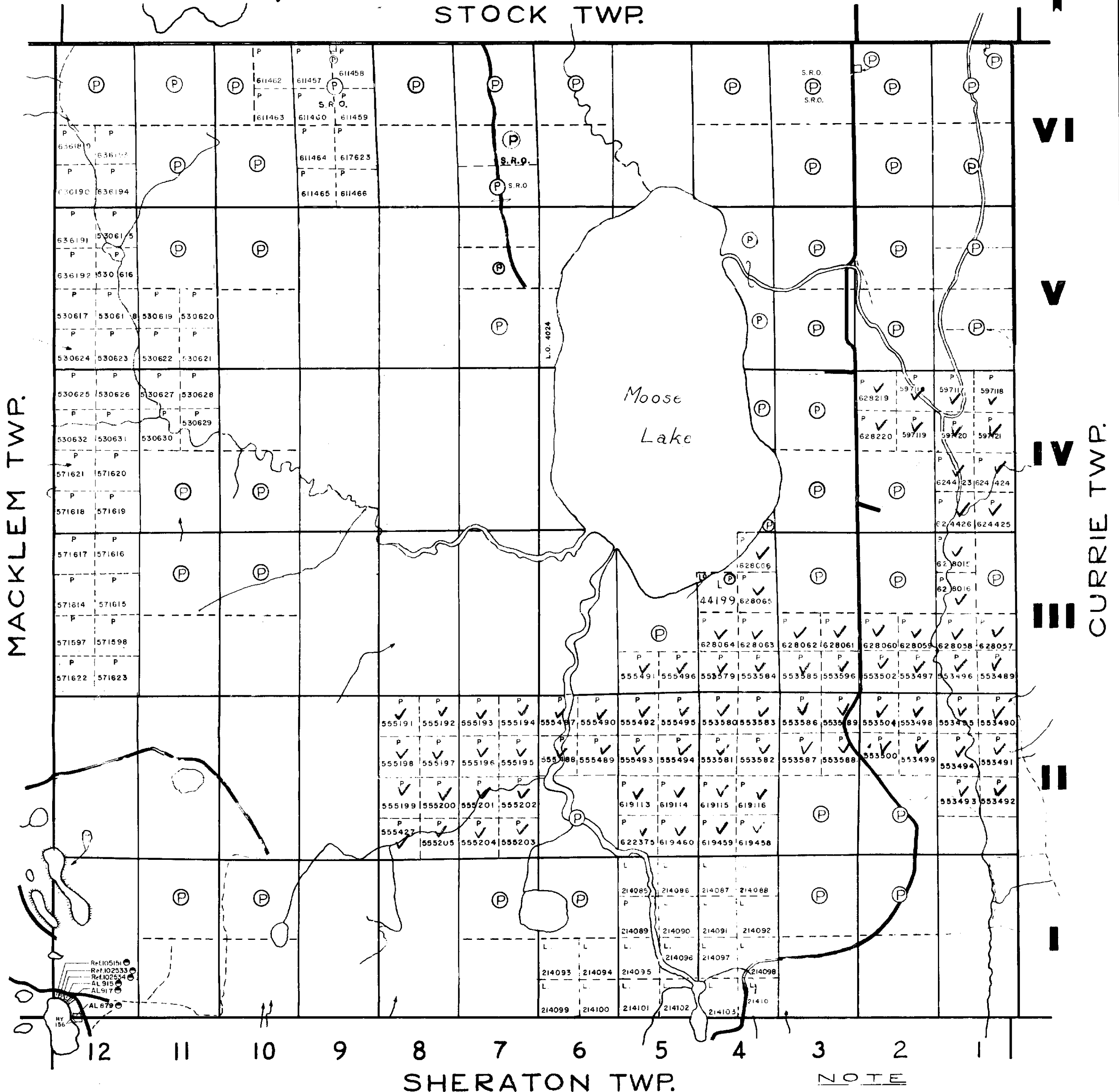

MACKLEM TWP.

CURRIE TWP.

SHERATON TWP.

NOTE

LEGEND

- IMPROVED ROADS
- PATENTED LANDS (P)
- CROWN LAND SALES (S) or C.S.
- ⊙ LOCATED LANDS L.O.
- LICENSE OF OCCUPATION.. L.O.
- LEASES (L)

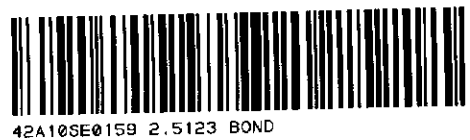

42A105E0159 2-5123 BOND