



42A10SW0198 17 MACKLEM

010

MACKLEM TOWNSHIP REPORT NO. 17

This file contains work performed by Gaspé Park Mines Ltd.
on Claims:

P. 85583	Hole # G-1	March, 1967
P. 85582	Hole # G-2	April, 1967
P. 85577	Hole # G-3	April, 1967

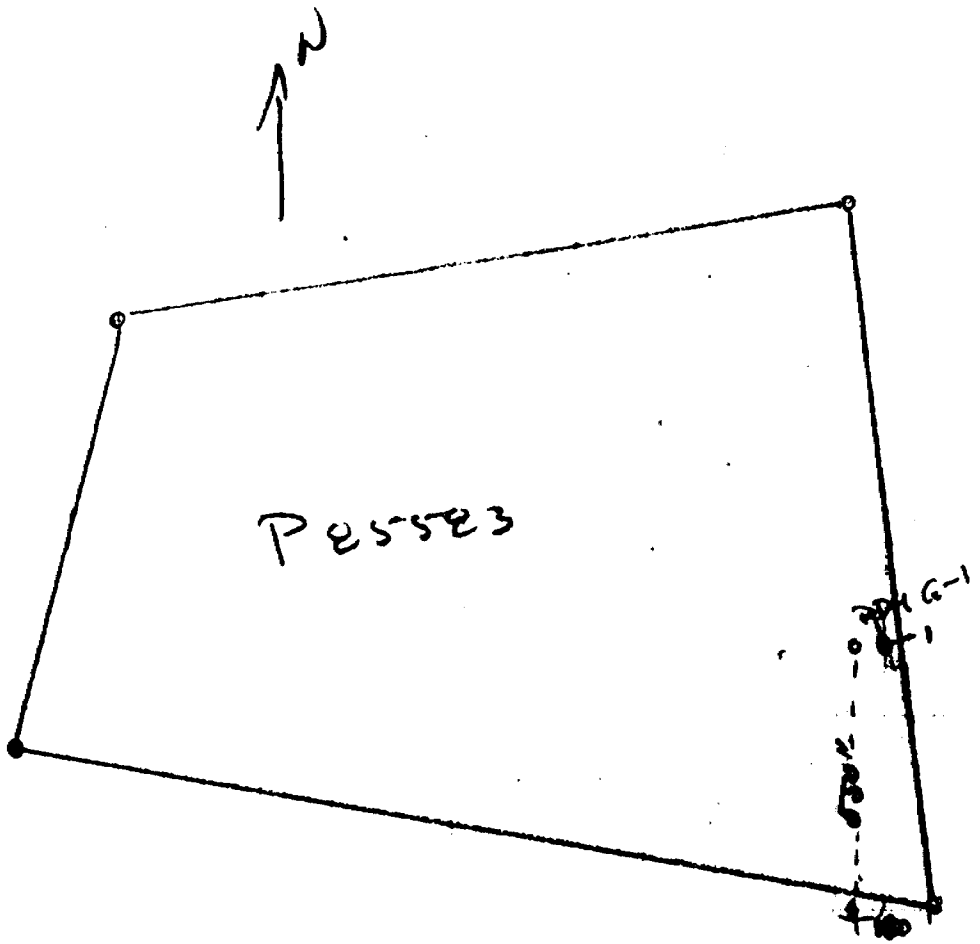

P-85575
Hacklem

SASPE PARK MINES LIMITED

MACKLEN PROPERTY

DIAMOND DRILL HOLE #1

Location: Line 5V - 500 South

Direction: N 14°W

Dip: Coliar 55°, 490' 61°

Depth: 496'

0 - 236	Casing
236 - 251	Dark Rhyelite, chloritized, trace pyrite, minor quartz and epidote stringers.
251 - 265	coarse lamprophyre
265 - 277	Rhyelite, as above,
277 - 302	Coarse lamprophyre (?) as above
302 - 408.1	Andesite, dark green, chloritized, taseose, carbonated, serpentized. Trace pyrite, from 403
408.1- 409.5	Aplite, crystalline pyrite
409.5-496	Serpentized andesite, as above, trace pyrite to 416

Leutenant
P. Gray

MOREAU, WOODWARD & COMPANY LTD.
General Exploration Services

BASES PARK MINES LIMITED

MARSH PROPERTY

WELL NO. 28

Collar: Line 22N - 225E

Depth: 437 feet

Dip: 55° (collar) 59° (180') 52° (435')

Drilled: April 1 - 5, 1967.

*28576
F. Macklin*

0 - 170	Sasing in overburden
170 - 259	Carbonated, serpentinized Andesite 195 - 220 traces pyrite.
259 - 304	Carbonated Gabbro, granular texture.
304 - 318	Carbonated serpentine
318 - 332	Green serpentine
332 - 361	Carbonated serpentine
361 - 364	Peridotite
364 - 378	Carbonated serpentine
378 - 381	Peridotite
381 - 437	Carbonated serpentine, thin lenses peridotite.

MOREAU, WOODARD & COMPANY LTD.
MINERAL EXPLORATION SERVICES

GASPE PARK MINES LIMITED

MACKLEM PROPERTY

DRILL HOLE 93

Collar: Line 24N - Baseline

Depth: 405 feet

Dip: 55° (collar) 55° (220') 67° (400')

Drilled: April 5 - 16, 1967.

0 - 220	Casing in overburden
220 - 405	Light coloured Khyalite, Spherulitic in sections.
223	- 1" quartz
259.5-261.5	- Quartz vein
307 - 311	- Quartz vein
399	- 1" quartz - carbonate vein
364	- 1" quartz - carbonate vein
390.5 - 392	- Quartz-carbonate vein with Pyrite
401	- 6" mineralized Flow Top.
405 -	End of Hole.

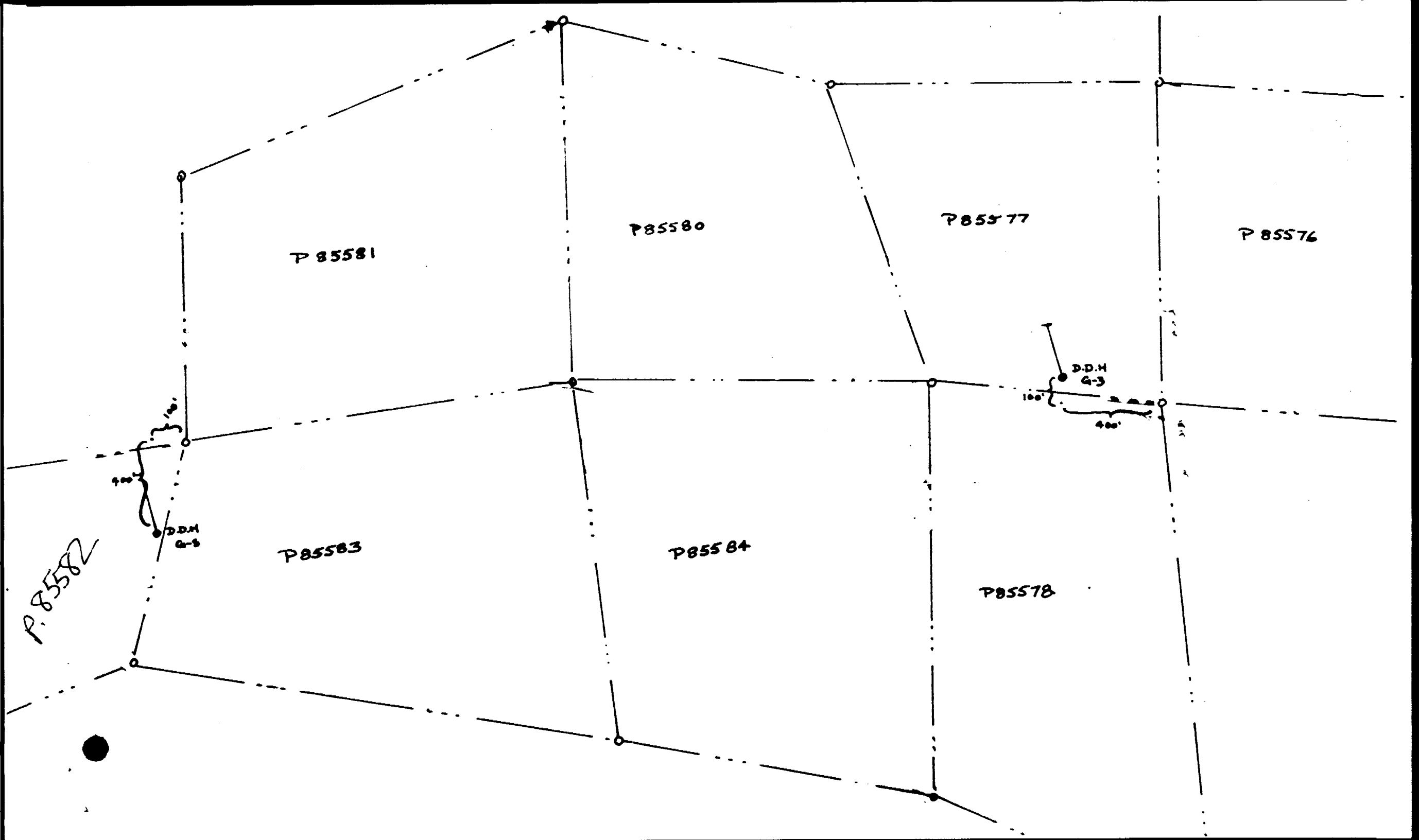

P 85581

P 85580

P 85577

P 85576

P 85583

P 85584

P 85578

P. 85582

D.D.H.
G-1

D.D.H.
G-3

100'

400'