



42A10SW0254 63.1558 MACKLEM

010

BROULAN REEF MINES LIMITED  
MAGNETOMETER SURVEY  
NIGHTHAWK LAKE AREA  
PORCUPINE MINING DIVISION OF ONTARIO

By: C. F. Desson

May 14, 1965

LOCATION AND ACCESSIBILITY

The area surveyed lies entirely over the waters of Nighthawk Lake and is located in the north-east quadrant of Cody Twp., and the north-west quadrant of Macklem, Twp., in the Porcupine Mining Division of Ontario.

The property is reached in winter via highway 101 east from a point 3 miles east of Nighthawk Center for 4½ miles south-west along winter road to camp on the East Peninsula. Best summer access is by road for 1 mile south from Nighthawk Center to Nighthawk Lake or 4 miles by poor gravel road, south on the North Peninsula from a point just east of the Nighthawk River bridge on highway 101 east.

PROPERTY OWNER

Property is owned by Broulan Reef Mines Limited  
7th Floor,  
105 Adelaide St. W.,  
TORONTO 1, Ontario.

The work was conducted by personnel employed by Broulan Reef Mines Limited, Pamour, Ontario under the direct supervision of Mr. C. F. Desson, Exploration Geologist for the Company.

CLAIMS SURVEYED

The area surveyed covers 44 contiguous claims numbered as follows.

P 53644 ✓	P 53645 ✓	P 53646 ✓	P 53647 ✓
P 53648 ✓	P 55056 ✓	P 57712 ✓	P 57713 ✓
P 57715 ✓	P 57716 ✓	P 57717 ✓	P 57718 ✓
P 58467 ✓	P 58468 ✓	P 58469 ✓	P 58470 ✓
P 58471 ✓	P 58472 ✓	P 58473 ✓	P 58474 ✓
P 58475 ✓	P 58476 ✓	P 58477 ✓	P 58478 ✓
P 58479 ✓	P 58480 ✓	P 58481 ✓	P 58482 ✓
P 58510 ✓	P 58511 ✓	P 58512 ✓	P 58513 ✓
P 62418 ✓	P 62419 ✓	P 62420 ✓	P 62421 ✓
P 62423 ✓	P 62439 ✓	P 62441 ✓	P 62443 ✓
P 62444 ✓	P 62445 ✓	P 62446 ✓	P 62447 ✓

SURVEY DATES

The survey, including line preparation technical, draughting etc., was conducted from March 1st - April 23rd, 1965.

RESUME OF PERSONNEL EMPLOYED ON SURVEY AND REPORTS

The personnel employed in conducting the field and office work related to the survey are listed on appendix "B" attached which is a copy of the Assessment Work Breakdown filed with the Mining Recorder in Timmins for this survey.

Respectfully Submitted,

BROULAN REEF MINES LIMITED.

*C. F. Desson*

C. F. Desson,  
Exploration Geologist.

CFD/jd

c.c. H. F. Brownbill  
W. H. Maedel  
W. F. Atkins

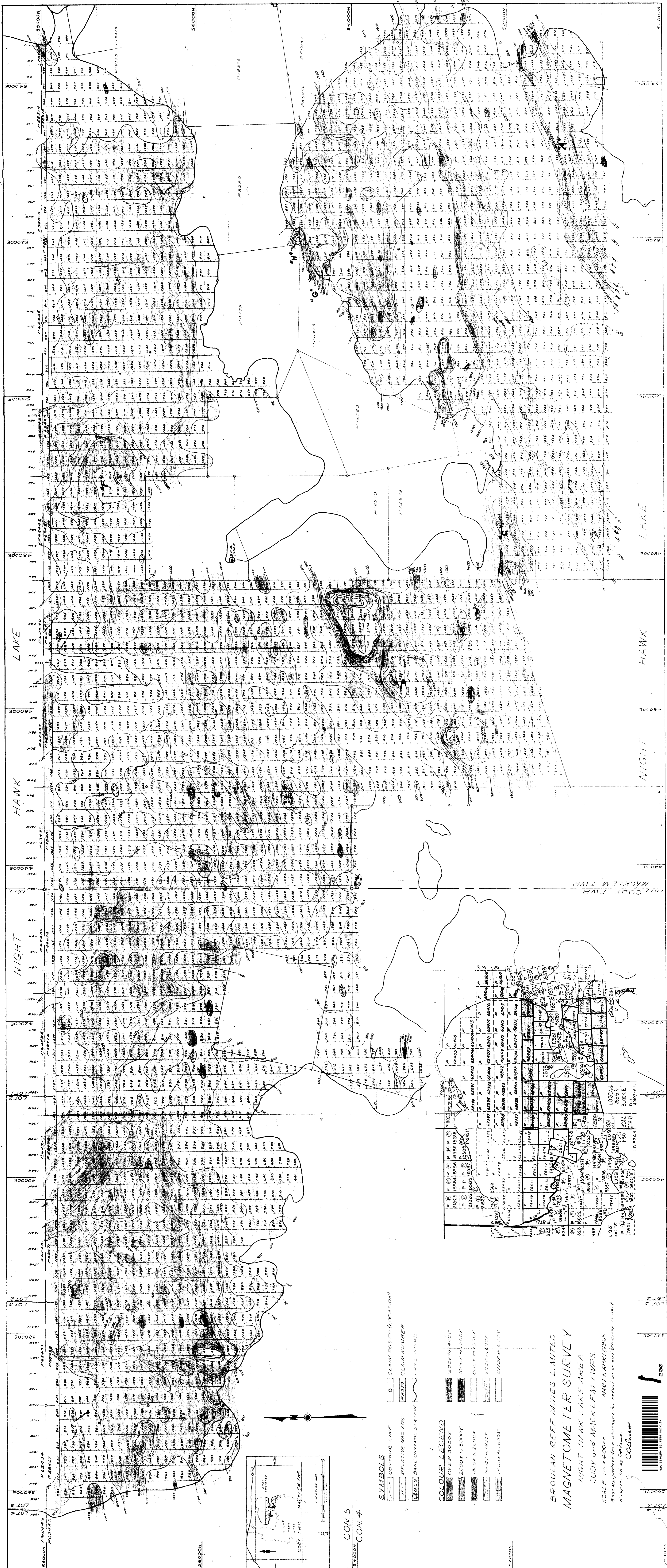

CON 5  
CON 4

- SYMBOLS**
- CLAIM POSTS (LOCATION)
  - RELATIVE MAG LOW
  - BASE CONTROL STATION

- COLOUR LEGEND**
- 1200 FT. 3000 FT.
  - 1000 FT. 2000 FT.
  - 800 FT. 1000 FT.
  - 600 FT. 800 FT.
  - 400 FT. 600 FT.

BROULAN REEF MINES LIMITED  
MAGNETOMETER SURVEY  
NIGHT HAWK LAKE AREA  
CODY AND MACKLEM TOWNS.

SCALE 1:2500  
MARI 18 APR 1965

Base Magnetometer from 1954-55. Reduction on 1:2500 scale. 1965.

Prepared by *Collinson*



1500

1500

1500

1500

1500

1500

1500

1500

1500

1500

1500

1500

1500

1500

1500

1500

1500

1500

1500

1500

1500

1500

1500

1500

1500

1500

1500

1500

1500

1500

1500

1500

1500

1500

1500