



42A10SW0269 2.8662 MACKLEM

010



TABLE OF CONTENTS

	Page
SUMMARY OF WORK	1
INTRODUCTION	2
LOCATION AND ACCESS	2
DRILLING EQUIPMENT	3
SAMPLING PROCEDURE	3
PLEISTOCENE GEOLOGY	4
CONCLUSIONS	4
CERTIFICATE	
APPENDIX I Invoices	
APPENDIX II Drill Logs	

LIST OF FIGURES

- FIGURE 1 Location Map, Macklem Townships
- FIGURE 2 Claim Location Map

RECEIVED

MAY 21 1985

MINING LANDS SECTION

LIST OF MAPS

- DRILL HOLE LOCATION MAP (in back pocket)
- DRILL HOLE SECTIONS L30W & L33W "
- DRILL HOLE SECTIONS L36W & L39W "

SUMMARY OF WORK

TOTAL FOOTAGE DRILLED	3039
NUMBER OF HOLES	20
OPERATING DAYS	10
TOTAL COST OF DRILLING	\$20,440.00
CREDITS EARNED AT \$15.00/DAY	1,362.67
CREDITS REQUESTED IN THIS REPORT	1,080.00

* * * * *

INTRODUCTION

During March, 1985, Dominik Drilling Ltd. of Timmins was contracted to carry out a reverse circulation overburden drilling program. From March 25 to April 4, 1985, nine days of work was required to drill 20 holes with a total footage of 3039 feet on claims P663240 and P663241. The property consists of 18 unpatented mining claims in the southeast corner of Macklem Township, Porcupine Mining Division, District of Cochrane, Ontario (Figures 1 and 2).

<u>Claim Number</u>	<u>Recording Date</u>
P663236	October 4, 1982
P663237	October 4, 1982
P663238	October 4, 1982
P663239	October 4, 1982
P663240	October 4, 1982
P663241	October 4, 1982
P663242	October 4, 1982
P663243	October 4, 1982
P663244	October 4, 1982
P663245	October 4, 1982
P663254	October 4, 1982
P663263	October 4, 1982
P663264	October 4, 1982
P663273	October 4, 1982
P805784	February 18, 1985
P805785	February 18, 1985
P805786	February 18, 1985
P805787	February 18, 1985

LOCATION AND ACCESS

The property is located approximately twenty-three (23) miles east - southeast of Timmins (Figure 1) in the southeast portion of Macklem Township (Figure 2). Access is via the Gibson Lake Road south from Highway 101, just east of the Highway 67 intersection.

DRILLING EQUIPMENT

The equipment consisted of a Longyear 38 drill mounted on skids and moved by a bombardier (J-5) and a skidder. Water was obtained from Long Lake and transported in a 5000 gallon tank on skids.

SAMPLING PROCEDURE

Depths were determined with the aid of the known length of the drill rods used. The samples were collected in five (5) gallon pails with the sampling interval determined by the supervisor logging the stratigraphy. The samples were collected from a cone into which the return water, containing the sample, was discharged. The samples were constantly monitored to determine the nature of the horizon being drilled. Horizons normally encountered are organic matter, clay, varved clays, sandy clay, sand, gravel, basal till, boulders or bedrock.

The sample pail is changed as new horizons are encountered or a sample length has been chosen. If the horizon is not sampled then the sample is discarded; if it is to be sampled, the material is transferred to a heavy plastic bag and saved. A portion of the sample was assayed at the lab while the remainder was sent to Overburden Drill Management for analysis. The sample interval varies from five (5) to ten (10) feet, depending on the change in the stratigraphy. Bedrock was penetrated approximately three (3) feet and the resulting chips were saved, of which a portion was assayed.

PLEISTOCENE GEOLOGY

The Night Hawk Lake area was covered by a continental ice sheet in the Pleistocene period. The last ice movement in the area was just east of south. A large part of Macklem Township is covered by well sorted sands and gravels. Glacial Lake Barlow-Ojibway formed as the glacier retreated, the lake depositing varved clays over most of the bedrock and flanks of the large sand and gravel deposits.

On the Long Lake Claim Group generally a thin layer of clay underlays an organic layer and is underlain by thick sand units. These sand units are part of the outwash sands and gravels to the east.

In the twenty reverse circulation drill holes drilled in this phase of the program, the overburden varied from 87 feet to 213 feet. Till was obtained in all but one hole (LL-85-26) and bedrock was reached in all but one hole (LL-85-19). The basal till varied from nothing to 46 feet in hole LL-85-25. An upper gravel/till was encountered in holes LL-85-8, 9, 14 and 21.

The drill logs for holes LL-85-9 to LL-85-28 inclusive are in Appendix II. Location and sections for the holes are in the back map pocket.

CONCLUSIONS

Underlying the surface organic layer is a thin clay layer, 10 to 20 feet, which is underlain by sands and gravels with minor clay beds. The basal till is generally present and well developed.

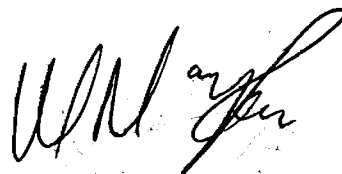

CERTIFICATE

I, William Edgar MacRae, of the City of Timmins, in the District of Cochrane and the Province of Ontario, hereby certify that:

- 1) I am a geologist residing at Kamiskotia Lake, P.O. Box 417, Timmins, Ontario;
- 2) I have graduated from Lakehead University with the degree of Bachelor of Science (Honours) in 1975 and have obtained the degree of Master of Science from McMaster University in 1982;
- 3) I have worked as a geologist for both the federal and provincial governments and several exploration companies;
- 4) I have, not now or in the past, had any interest, directly or indirectly, in the mineral claims reported on in the preceding pages or in the shares of the company which holds the said claims;
- 5) I personally supervised the work reported here from March 25, 1985 to April 10, 1985.

Timmins, Ontario

W. MacRae

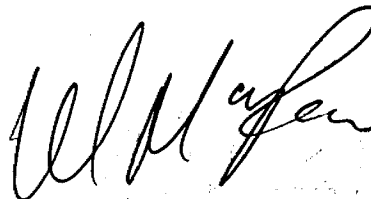

APPENDIX I

INVOICES



INVOICE - FACTURE

FORAGE DOMINIK (1981) INC. Case Postale 247, Val d'Or, P.Q. J9P 4
DOMINIK DRILLING (1981) INC. P.O. Box 247, Val d'Or, P.Q. J9P 4

Téléphone: (819) 824-6839 Téléc: 057-45523

UNITED KINGDOM ENERGY
SUITE 14, HOLLINGER BUILDING
P. O. BOX 417
TIMMINS, ONTARIO P4N 7E3

Invoice No. No. de facture: 0959
Date ~~APRIL 30~~ MAY 15, 1985
Terms - Net 15 Days Terms - Net 15 Jours

REVERSE CIRCULATION - MACKLEM TOWNSHIP - APRIL 1-15, 1985

HOLE NO. 85-20	:	FROM	0'	to	140'	=	140'	REV. CIRC.
HOLE NO. 85-21	:	FROM	0'	to	180'	=	180'	REV. CIRC.
HOLE NO. 85-22	:	FROM	0'	to	211'	=	211'	REV. CIRC.
HOLE NO. 85-23	:	FROM	0'	to	161'	=	161'	REV. CIRC.
HOLE NO. 85-24	:	FROM	0'	to	163'	=	163'	REV. CIRC.
HOLE NO. 85-25	:	FROM	0'	to	215'	=	215'	REV. CIRC.
HOLE NO. 85-26	:	FROM	0'	to	117'	=	117'	REV. CIRC.
HOLE NO. 85-27	:	FROM	0'	to	107'	=	107'	REV. CIRC.
HOLE NO. 85-28	:	FROM	0'	to	96'	=	96'	REV. CIRC.

CONTRACT COST:

APRIL 01, 1985	:	10	CONTRACT HOURS		
APRIL 02, 1985	:	10	CONTRACT HOURS		
APRIL 03, 1985	:	10	CONTRACT HOURS		
APRIL 04, 1985	:	8	CONTRACT HOURS		
				38 CONTRACT GHOURS X \$ 165.00 =	\$ 6,270.00

MATERIAL USED:

1 only TRICONE 2 15/16	X \$ 867.50 =	\$ 867.50
1 only TRICONE 2 15/16	X \$ 867.50 =	\$ 867.50
1 only SUB 2 15/16	X \$ 450.00 =	\$ 450.00
		\$ 2,185.00

DEMOBILIZATION COST: 2 HOURS X \$ 165.00 = \$ 330.00

TOTAL \$ 8,785.00

121-879
CONTRACT ~~3579~~
DRILLED 1390'

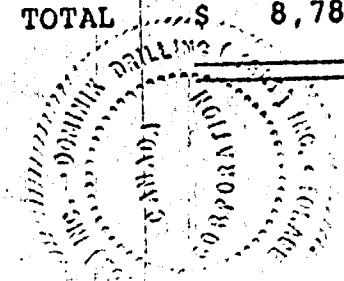



INVOICE - FACTURE

FORAGE DOMINIK (1981) INC. Case Postale 247, Val d'Or, P.Q. J9P 4
DOMINIK DRILLING (1981) INC. P.O. Box 247, Val d'Or, P.Q. J9P 4

Téléphone: (819) 824-6839 Téléc: 057-45523

UNITED KINGDOM ENERGY INC.
SUITE 14, HOLLINGER BUILDING
P. O. BOX 417
TIMMINS, ONTARIO P4N 7E3

Invoice No. No. de facture: 0921

Date MARCH 31, 1985

Terms - Net 15 Days Terms - Net 15 Jours

REVERSE CIRCULATION - MACKLEM TOWNSHIP - MARCH 16-31, 1985

HOLE NO. 85-9 :	FROM 0' to 101' = 101' REV. CIRC.
HOLE NO. 85-10:	FROM 0' to 157' = 157' REV. CIRC.
HOLE NO. 85-11:	FROM 0' to 117' = 117' REV. CIRC.
HOLE NO. 85-12:	FROM 0' to 105' = 105' REV. CIRC.
HOLE NO. 85-13:	FROM 0' to 125' = 125' REV. CIRC.
HOLE NO. 85-14:	FROM 0' to 151' = 151' REV. CIRC.
HOLE NO. 85-15:	FROM 0' to 179' = 179' REV. CIRC.
HOLE NO. 85-16:	FROM 0' to 188' = 188' REV. CIRC.
HOLE NO. 85-17:	FROM 0' to 189' = 189' REV. CIRC.
HOLE NO. 85-18:	FROM 0' to 151' = 151' REV. CIRC.
HOLE NO. 85-19:	FROM 0' to 185' = 185' REV. CIRC.

CONTRACT COST:

TRAVELING TIME = 7 DAYS X \$ 50.00 per day = \$ 350.00

MARCH 25/85	:	9	CONTRACT HOURS
MARCH 26/85	:	6	CONTRACT HOURS
MARCH 27/85	:	9	CONTRACT HOURS
MARCH 28/85	:	9	CONTRACT HOURS
MARCH 29/85	:	10	CONTRACT HOURS
MARCH 30/85	:	8	CONTRACT HOURS

51 CONTRACT HOURS X \$ 165.00 =

MATERIAL LEFT IN HOLE OR USED:

1 ONLY TRICONE BIT AT 100% X \$ 867.50
1 ONLY TRICONE BIT AT 100% X \$ 867.50

MOBILIZATION COST: as per contract agreement

7 HOURS X \$ 165.00 = \$ 1,155.00

CONTRACT 3-579
DRILLED 1648'

TOTAL \$ 11,655.00

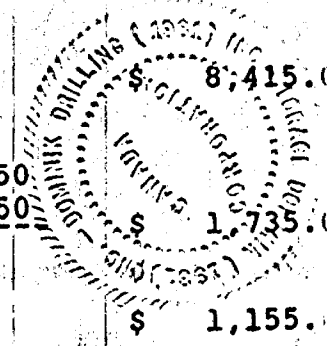

APPENDIX II

DRILL LOGS

LOCATION: L30W/1+00S
DATE: 26/03/85
TRICONE #: G000271
LOGGED BY: W. MacRae

HOLE #: LL-85-9
START TIME: 12:30 PM
FINISH TIME: 2:35 PM
TOTAL DEPTH: 100 Feet

0' - 3' Organic material
3' - 12' Gray clay with minor pebbles
12' - 16' Gray clay
16' - 22' Sand with minor clay layers
22' - 62' Sand with minor clay layers and pebbles
62' - 84' Sand with minor pebbles
84' - 90' Till with - 20% mafic volcanic pebbles
- 40% ultramafic volcanic pebbles
- 30% granitic pebbles
- 5% quartz pebbles
90' - 92' Sand
92' - 96' Sand with minor till
96' - 100' Bedrock - carbonatized ultramafic rocks
- 50% carbonate veining
- light apple green in colour
100' END OF HOLE

<u>SAMPLES</u>	<u>FOOTAGE</u>	<u>DESCRIPTION</u>
9A	84' - 90'	Till
9B	92' - 96'	Sand
9C	96' - 100'	Bedrock

LOCATION: L30W/1+00N
 DATE: 26/03/85
 TRICONE #: G000271
 LOGGED BY: W. MacRae

HOLE #: LL-85-10
 START TIME: 3:10 PM
 FINISH TIME: 5:10 PM
 TOTAL DEPTH: 157 Feet

0' - 2' Organic material
 2' - 10' Gray clay with 10% pebbles
 10' - 13' Sand with minor clay layers
 13' - 23' Sand with minor clay layers and pebbles
 23' - 53' Sand
 53' - 63' Sand with minor pebbles
 63' - 93' Sand
 93' - 103' Sand with minor pebbles
 103' - 121' Sand with 20% clay layers and 10% pebbles
 121' - 133' Till with - 40% mafic pebbles
 - 25% ultramafic pebbles
 - 20% granitic pebbles
 - 10% quartz pebbles
 133' - 136' Till with higher sand content and
 - 40% mafic pebbles
 - 25% ultramafic pebbles
 - 20% granitic pebbles
 - 10% quartz pebbles
 136' - 143' Till with - 18" border at 136' of ultramafic with 1-2% pyrite
 - 40% ultramafic pebbles
 - 20% mafic pebbles
 - 20% granitic pebbles
 - 15% quartz pebbles
 143' - 154' Till with - 50% ultramafic pebbles
 - 20% mafic pebbles
 - 10% granitic pebbles
 - 15% quartz pebbles
 154' - 157' Bedrock - highly weathered talc chloritic schist
 - rusty brown in colour
 - very soft

157'		
END OF HOLE		
<u>SAMPLES</u>	<u>FOOTAGE</u>	<u>DESCRIPTION</u>
10A	121'-133'	Till
10B	133'-143'	Till
10C	143'-154'	Till
10D	154'-157'	Bedrock

LOCATION: L36W/1+00S
DATE: 27/03/85
TRICONE #: G000271
LOGGED BY: W. MacRae

HOLE #: LL-85-11
START TIME: 10:20 AM
FINISH TIME: 11:38 AM
TOTAL DEPTH: 117 Feet

0' - 2' Organic material
2' - 17' Gray clay
17' - 22' Sand
22' - 27' Gray clay with minor sand layers
27' - 30' Gray clay
30' - 43' Sand with a one foot gray clay layer at 39'
43' - 73' Sand with minor pebbles
73' - 83' Sand with minor clay layers
83' - 98' Sand with minor pebbles
98' - 110' Sandy Till with - 75% altered ultramafic pebbles
- 10% mafic pebbles
- 5% granitic pebbles
110' - 113' Sand with minor clay layers
113' - 117' Bedrock - partially altered ultramafics
- 20% carbonate veining
- medium to light green in colour
117' END OF HOLE

<u>SAMPLES</u>	<u>FOOTAGE</u>	<u>DESCRIPTION</u>
11A	103'-110'	Till
11B	113'-117'	Bedrock

LOCATION: L36W/1+00N
DATE: 27/03/85
TRICONE #: G000271
LOGGED BY: W. MacRae

HOLE #: LL-85-12
START TIME: 12:10 PM
FINISH TIME: 1:30 PM
TOTAL DEPTH: 105 Feet

0' - 2' Organic material
2' - 10' Gray clay
10' - 13' Gray clay with minor sand layers
13' - 43' Sand with minor clay layers and pebbles
43' - 93' Sand with minor pebbles and 1' gray clay layer at 70'
93' - 103' Till with - 40% altered ultramafic pebbles
- 25% mafic pebbles
- 15% granitic pebbles
- 15% quartz pebbles
- poor water return from 91' to 93'
103' - 105' Bedrock - slightly altered ultramafics
- 15% carbonate veining
105' END OF HOLE

<u>SAMPLES</u>	<u>FOOTAGE</u>	<u>DESCRIPTION</u>
12A	93'-103'	T111
12B	103'-105'	Bedrock

LOCATION: L39W/1+00N
DATE: 27/03/85
TRICONE #: K000427
LOGGED BY: W. MacRae

HOLE #: LL-85-13
START TIME: 2:28 PM
FINISH TIME: 4:00 PM
TOTAL DEPTH: 125 Feet

0' - 2' Organic material
2' - 17' Gray clay
17' - 55' Gray clay with minor sand layers
55' - 112' Sand with minor pebbles
112' - 121.5' Till with - 20% altered ultramafic pebbles
- 30% mafic pebbles
- 10% felsic pebbles
- 15% granitic pebbles
- 20% quartz pebbles
121.5'-125' Bedrock - dark green ultramafic
- up to 10% carbonate veining
125.0' END OF HOLE

<u>SAMPLES</u>	<u>FOOTAGE</u>	<u>DESCRIPTION</u>
13A	112'-121.5'	Till
13B	121.5'-125'	Bedrock

LOCATION: L39W/2+00S
DATE: 28/03/85
TRICONE #: K000427
LOGGED BY: W. MacRae

HOLE #: LL-85-14
START TIME: 9:15 AM
FINISH TIME: 11:30 AM
TOTAL DEPTH: 151 Feet

0' - 2' Organic material
2' - 9' Gray clay
9' - 23' Gray clay with minor sand layers
23' - 43' Sand with minor clay layers and pebbles with a one foot clay bed at 31'
43' - 63' Sand
63' - 93' Sand with minor pebbles
93' - 106' Sand
106' - 111' Till with - 40% mafic pebbles
 - 30% ultramafic pebbles
 - 20% granitic pebbles
 - 10% quartz pebbles
111' - 113' Sand with minor clay layers
113' - 133' Sand with 5% pebbles
133' - 142.5' Till with - 50% altered ultramafic pebbles
 - 20% mafic pebbles
 - 15% granitic pebbles
 - 10% quartz-carbonate pebbles
142.5' - 148' Till with - 60% ultramafic pebbles
 - 10% mafic pebbles
 - 20% granitic pebbles
 - 10% quartz pebbles
 - 2.5' boulders from 142.5' to 145'
148' - 151' Bedrock - highly weathered talc chlorite schist
 - 10% quartz veining
 - very soft and rusty brown

151' END OF HOLE

<u>SAMPLES</u>	<u>FOOTAGE</u>	<u>DESCRIPTION</u>
14A	106'-111'	Till
14B	133'-142.5'	Till
14C	142.5'-148'	Till
14D	148'-151'	Bedrock

LOCATION: L39W/4+00S
DATE: 28/03/85
TRICONE #: K000427
LOGGED BY: W. MacRae

HOLE #: LL-85-15
START TIME: 12:35 PM
FINISH TIME: 3:14 PM
TOTAL DEPTH: 179 Feet

0' - 2' Organic material
2' - 5' Gray clay
5' - 53' Sand with minor clay layers
53' - 63' Sand
63' - 83' Sand with minor pebbles
83' - 133' Sand
133' - 154.5' Sand with minor pebbles
154.5' - 171' Till with - 40% altered ultramafic pebbles
- 25% mafic pebbles
- 20% granitic pebbles
- 15% quartz pebbles
171' - 175' Till with 30% clay and - 40% altered ultramafic pebbles
- 25% mafic pebbles
- 20% granitic pebbles
- 15% quartz pebbles
175' - 179' Bedrock - highly altered ultramafic
- rusty brown talc chloritic schist
- 1% quartz veining
179' END OF HOLE

<u>SAMPLES</u>	<u>FOOTAGE</u>	<u>DESCRIPTION</u>
15A	154.5'-163'	Till
15B	163'-171'	Till
15C	171'-175'	Till
15D	175'-179'	Bedrock

LOCATION: L39W/6+00S
DATE: 29/03/85
TRICONE #: K000427
LOGGED BY: W. MacRae

HOLE #: LL-85-16
START TIME: 9:10 AM
FINISH TIME: 11:30 AM
TOTAL DEPTH: 188 Feet.

0' - 2'	Organic material
2' - 10'	Brown clay with minor sand layers
10' - 31'	Gray clay with minor sand layers
31' - 33'	Sand
33' - 43'	Sand with minor clay layers and a one foot clay bed at 41'
43' - 93'	Sand
93' - 123'	Sand with minor clay layers
123' - 152'	Sand
152' - 163'	Till with - 20% mafic pebbles - 50% altered ultramafic pebbles - 15% granitic pebbles - 10% quartz pebbles
163' - 173'	Till with - 45% altered ultramafic pebbles - 30% mafic pebbles - 15% granitic pebbles - 10% quartz pebbles
173' - 184.5'	Till with minor clay and - 45% altered ultramafic pebbles - 30% mafic pebbles - 15% granitic pebbles - 10% quartz pebbles
184.5' - 188'	Bedrock - brown weathering talc chloritic schist - very soft
188'	END OF HOLE

<u>SAMPLES</u>	<u>FOOTAGE</u>	<u>DESCRIPTION</u>
16A	152'-163'	Till
16B	163'-173'	Till
16C	173'-183'	Till
16D	183'-184.5'	Till
16E	184.5'-188'	Bedrock

LOCATION: L39W/8+00S
DATE: 29/03/85
TRICONE #: K000426
LOGGED BY: W. MacRae

HOLE #: LL-85-17
START TIME: 12:22 PM
FINISH TIME: 2:30 PM
TOTAL DEPTH: 189 Feet

0' - 2' Organic material
2' - 10' Gray clay
10' - 23' Gray clay with minor sandy layers
23' - 43' Sand with minor clay layers
43' - 63' Sand
63' - 73' Sand with minor pebbles
73' - 103' Sand
103' - 151' Sand with minor pebbles
151' - 157' Till with - 35% granitic pebbles
- 35% altered ultramafic pebbles
- 10% mafic pebbles
- 15% quartz pebbles
157' - 173' Till with - 30% granitic pebbles
- 40% altered ultramafic pebbles
- 10% mafic pebbles
- 15% quartz pebbles
173' - 183' Till with - 40% altered ultramafic pebbles
- 30% granitic pebbles
- 10% mafic pebbles
- 10% quartz pebbles
- 5% clay
183' - 185' Till with - 65% altered ultramafic pebbles
- 35% granitic pebbles
185' - 189' Bedrock - Talc chloritic schist
- very soft
- light to dark green in colour

189' END OF HOLE

<u>SAMPLES</u>	<u>FOOTAGE</u>	<u>DESCRIPTION</u>
17A	151'-157'	Till
17B	157'-163'	Till
17C	163'-168'	Till
17D	168'-173'	Till
17E	173'-183'	Till
17F	183'-185'	Till
17G	185'-189'	Bedrock

LOCATION: L36W/10+00S
DATE: 30/03/85
TRICONE #: K000426
LOGGED BY: W. MacRae

HOLE #: LL-85-18
START TIME: 9:00 AM
FINISH TIME: 10:22 AM
TOTAL DEPTH: 151 Feet

0' - 2' Organic material
2' - 33' Sand with minor clay layers
33' - 43' Sand with minor clay layers and pebbles
43' - 73' Sand with minor pebbles
73' - 83' Sand with minor clay layers and pebbles
83' - 93' Sand
93' - 138' Sand with minor pebbles
138' - 146' Till with - 50% altered ultramafic pebbles
- 10% mafic pebbles
- 20% granitic pebbles
- 10% quartz pebbles
- no water return from 142' to 146'
146' - 151' Bedrock - slightly altered ultramafics
- 5% reddish carbonate veining
151' END OF HOLE

<u>SAMPLES</u>	<u>FOOTAGE</u>	<u>DESCRIPTION</u>
18A	138'-146'	Till
18B	146'-149'	Bedrock

LOCATION: L36W/8+00S
DATE: 30/03/85
TRICONE #: K000411
LOGGED BY: W. MacRae

HOLE #: LL-85-19
START TIME: 12:10 PM
FINISH TIME: 2:15 PM
TOTAL DEPTH: 185 Feet

0' - 2' Organic material
2' - 10' Brown clay
10' - 23' Gray clay
23' - 33' Gray clay with minor sand layers and 20% pebbles from 27' to 30'
33' - 63' Sand with minor clay layers
63' - 73' Sand
73' - 83' Sand with minor clay layers
83' - 103' Sand
103' - 113' Sand with minor clay layers
113' - 158' Sand
158' - 168' Till with - 40% altered ultramafic pebbles
- 20% mafic pebbles
- 20% granitic pebbles
- 15% quartz pebbles
168' - 178' Till with - 20% altered ultramafic pebbles
- 10% mafic pebbles
- 30% granitic pebbles
- 30% quartz pebbles
178' - 183' Till with large boulders up to 1' thick of altered and unaltered ultramafics
- 50% ultramafic pebbles
- 20% granitic pebbles
- 20% quartz pebbles
183' - 185' Till with large boulders of rusty brown weathering talc chloritic schist
- rods jamming
185' END OF HOLE

<u>SAMPLES</u>	<u>FOOTAGE</u>	<u>DESCRIPTION</u>
19A	158'-168'	Till
19B	168'-178'	Till
19C	178'-181'	Till
19D	181'-185'	Till

LOCATION: L36W/12+00S
DATE: 1/04/85
TRICONE #: K000411
LOGGED BY: W. MacRae

HOLE #: LL-85-20
START TIME: 9:25 PM
FINISH TIME: 10:48 PM
TOTAL DEPTH: 140 Feet

0' - 2' Organic material
2' - 10' Brown clay
10' - 13' Gray clay
13' - 33' Sand with minor clay layers
33' - 63' Sand
63' - 73' Sand with minor clay layers
73' - 93' Sand
93' - 113' Sand with minor pebbles
113' - 125' Sand with minor clay layers
125' - 133' Till with - 80% ultramafic pebbles
- 10% granitic pebbles
- 5% quartz pebbles
133' - 140' Bedrock - variably altered talc chloritic schist
- light to dark green in colour
- 10% quartz veining
140' END OF HOLE

<u>SAMPLES</u>	<u>FOOTAGE</u>	<u>DESCRIPTION</u>
20A	125'-133'	Till
20B	133'-140'	Bedrock

LOCATION: L30W/10+00S
DATE: 1/04/85
TRICONE #: K000411
LOGGED BY: W. MacRae

HOLE #: LL-85-21
START TIME: 11:28 AM
FINISH TIME: 1:04 PM
TOTAL DEPTH: 181 Feet

0' - 2' Organic material
2' - 10' Brown clay
10' - 14' Gray clay
14' - 33' Sand with minor clay layers
33' - 71' Sand
71' - 80' Till (gravel) with - 70% ultramafic pebbles
- 10% granitic pebbles
- quartz pebbles
80' - 173' Sand with minor pebbles
173' - 178' Till with - 70% ultramafic pebbles
- 10% granitic pebbles
- 15% quartz pebbles
178' - 181' Bedrock - altered ultramafics
- light to medium green in colour
- 70% quartz-carbonate veining
181' END OF HOLE

<u>SAMPLES</u>	<u>FOOTAGE</u>	<u>DESCRIPTION</u>
21A	71'- 80'	Till
21B	173'-178'	Till
21C	178'-181'	Bedrock

LOCATION: L33W/7+50S
DATE: 1/04/85
TRICONE #: K000411
LOGGED BY: W. MacRae

HOLE #: LL-85-22
START TIME: 1:58 PM
FINISH TIME: 4:51 PM
TOTAL DEPTH: 211 Feet

0' - 2' Organic material
2' - 8' Gray clay
8' - 73' Sand with minor clay layers
73' - 175' Sand
175' - 183' Till with - 60% altered ultramafic pebbles
- 10% unaltered ultramafic pebbles
- 15% granitic pebbles
- 15% quartz pebbles
183' - 193' Till with - 50% altered ultramafic pebbles
- 20% granitic pebbles
- 15% quartz pebbles
- 10% mafic pebbles
193' - 203' Till with - 50% altered ultramafic pebbles
- 10% felsic pebbles
- 10% mafic pebbles
- 15% granitic pebbles
- 10% quartz pebbles
203' - 209' Till with - 70% brown weathering talc chloritic schist
- 10% granitic pebbles
- 10% mafic pebbles
- 10% quartz pebbles
209' - 211' Bedrock - rusty brown weathering talc chloritic schist
- very soft
211' END OF HOLE

<u>SAMPLES</u>	<u>FOOTAGE</u>	<u>DESCRIPTION</u>
22A	175'-183'	T111
22B	183'-193'	T111
22C	193'-203'	T111
22D	203'-209'	T111
22E	209'-211'	Bedrock

LOCATION: L30W/6+00S
DATE: 2/04/85
TRICONE #: K000411
LOGGED BY: W. MacRae

HOLE #: LL-85-23
START TIME: 9:34 AM
FINISH TIME: 11:40 AM
TOTAL DEPTH: 161 Feet

0' - 2' Organic material
2' - 8' Brown clay
8' - 13' Gray clay
13' - 33' Sand with minor clay layers
33' - 73' Sand
73' - 83' Sand with minor clay layers
83' - 113' Sand
113' - 121' Sand with minor pebbles
121' - 136' Till with - 40% altered ultramafic pebbles
- 20% granitic pebbles
- 15% quartz pebbles
136' - 158' Till with - 70% altered ultramafic pebbles
- 15% granitic pebbles
- 10% quartz pebbles
- some altered ultramafic pebbles containing sulphides
158' - 161' Bedrock - very soft talc chlorite schist
- medium to dark green in colour
161' END OF HOLE

<u>SAMPLES</u>	<u>FOOTAGE</u>	<u>DESCRIPTION</u>	
23A	121'-129'	T111	
23B	129'-136'	T111	
23C	136'-143'	T111	150
23D	143'-153'	T111	
23E	153'-158'	T111	41
23F	158'-161'	Bedrock	41

LOCATION: L33W/5+00S
DATE: 2/04/85
TRICONE #: B663358
LOGGED BY: W. MacRae

HOLE #: LL-85-24
START TIME: 12:50 PM
FINISH TIME: 2:33 PM
TOTAL DEPTH: 163 Feet

0' - 2' Organic material
2' - 9' Brown clay
9' - 13' Gray clay
13' - 23' Gray clay with minor sand layers
23' - 63' Sand with minor clay layers
63' - 83' Sand
83' - 103' Sand with minor clay layers
103' - 133' Sand
133' - 148' Sand with minor pebbles
148' - 156' Sandy gravel
156' - 159' Till with - 60% altered ultramafic pebbles
 - 20% granitic pebbles
 - 15% quartz pebbles
159' - 163' Bedrock - light to medium green talc chlorite schist
 - 20% carbonate veining
163' END OF HOLE

<u>SAMPLES</u>	<u>FOOTAGE</u>	<u>DESCRIPTION</u>
24A	156'-159'	T111
24B	159'-163'	Bedrock

LOCATION: L36W/6+00S
DATE: 3/04/85
TRICONE #: B66358
LOGGED BY: W. MacRae

HOLE #: LL-85-25
START TIME: 8:50 AM
FINISH TIME: 12:20 PM
TOTAL DEPTH: 215 Feet

0' - 2' Organic material
2' - 9' Brown clay
9' - 13' Gray clay
13' - 43' Sand with minor clay layers
43' - 53' Sand
53' - 63' Sand with minor clay layers
63' - 73' Sand
73' - 93' Sand with minor clay layers and pebbles
93' - 143' Sand
14' - 167' Sand with minor pebbles
167' - 181' Till with - 50% altered ultramafic pebbles
- 20% granitic pebbles
- 15% quartz pebbles
- 10% mafic pebbles
181' - 193' Till with - 40% altered ultramafic pebbles
- 20% mafic pebbles
- 20% granitic pebbles
- 10% quartz pebbles
193' - 213' Till - very little water return with very small sample
- 60% rusty brown talc chlorite schist
- 20% granitic pebbles
- 15% quartz pebbles
213' - 215' Bedrock - rusty brown talc chlorite schist
- very soft
215' END OF HOLE

<u>SAMPLES</u>	<u>FOOTAGE</u>	<u>DESCRIPTION</u>
25A	167'-181'	Till
25B	181'-183'	Till
25C	183'-193'	Till
25D	193'-213'	Till
25E	213'-215'	Bedrock

LOCATION: L33W/3+00S
DATE: 3/04/85
TRICONE #: B66358
LOGGED BY: W. MacRae

HOLE #: LL-85-26
START TIME: 1:12 PM
FINISH TIME: 2:30 PM
TOTAL DEPTH: 117 Feet.

0' - 2' Organic material
2' - 13' Gray clay
13' - 33' Sand with minor clay layers
33' - 43' Sand
43' - 53' Sand with minor clay layers and pebbles
53' - 73' Sand
73' - 93' Sand with minor clay layers
93' - 114' Sand
114' - 117' Bedrock - medium to light green altered ultramafics
- 20% quartz carbonate veining
117' END OF HOLE

<u>SAMPLES</u>	<u>FOOTAGE</u>	<u>DESCRIPTION</u>
26A	114'-117'	Bedrock

LOCATION: L33W/1+00S
DATE: 3/04/85
TRICONE #: B66358
LOGGED BY: W. MacRae

HOLE #: LL-85-27
START TIME: 2:54 PM
FINISH TIME: 4:19 PM
TOTAL DEPTH: 107 Feet

0' - 2' Organic material
2' - 13' Gray clay
13' - 43' Sand with minor clay layers
43' - 73' Sand
73' - 83' Sand with minor clay layers
83' - 95' Sand
95' - 103' Till with - 60% altered ultramafic pebbles
- 20% granitic pebbles
- 10% quartz pebbles
- very poor water return from 99' to 103'
103' - 107' Bedrock - medium to dark green slightly altered ultramafics
- 10% carbonate veining
107' END OF HOLE

<u>SAMPLES</u>	<u>FOOTAGE</u>	<u>DESCRIPTION</u>
27A	95'-103'	T111
27B	103'-107'	Bedrock

LOCATION: L33W/1+00N
DATE: 4/04/85
TRICONE #: B66158
LOGGED BY: W. MacRae

HOLE #: LL-85-28
START TIME: 9:00 AM
FINISH TIME: 10:24 AM
TOTAL DEPTH: 96 Feet

0' - 2' Organic material
2' - 13' Gray clay
13' - 33' Sand with minor clay layers
33' - 53' Sand with minor clay layers and pebbles
53' - 81' Sand
81' - 85' Sand with 5% pebbles
85' - 87' Till with less than 10% water return
87' - 96' Bedrock - light green altered ultramafics
- 10% quartz-carbonate veining
- poor water return from 87' to 93'
96' END OF HOLE

<u>SAMPLES</u>	<u>FOOTAGE</u>	<u>DESCRIPTION</u>
28A	85'-87'	T111
28B	87'-96'	Bedrock



42A10SW0269 2.8662 MACKLEM

900

Mining Lands Section

File No 2.8662

Control Sheet

TYPE OF SURVEY GEOPHYSICAL
 GEOLOGICAL
 GEOCHEMICAL
 ✓ EXPENDITURE

MINING LANDS COMMENTS:

*log.
L.D.*

D. Aurst

Signature of Assessor

Dec 31/85

Date



Ministry of
Natural
Resources

Report of Work
(Geophysical, Geological,
Geochemical and Expenditures)

28662
#338/85

Instructions: - Please type or print.
- If number of mining claims traversed exceeds space on this form, attach a list.
Note: - Only days credits calculated in the "Expenditures" section may be entered in the "Expend. Days Cr." columns.
- Do not use shaded areas below.

No. 167

The Mining Act

Type of Survey(s) EXPENDITURES		Township or Area MACKLEM
Claim Holder(s) UNITED KINGDOM ENERGY INC.		Prospector's Licence No. T-1339
Address Suite 808 - 409 Granville Street, Vancouver, B.C. V6C 1T2		
Survey Company DOMINIK DRILLING(1981) INC.	Date of Survey (from & to) 25 03 85 4 04 85 Day Mo. Yr. Day Mo. Yr.	Total Miles of line Cut
Name and Address of Author (of Geo-Technical report) W. MACRAE, P.O. BOX 417, Timmins, Ont. P4N 7E3		

Credits Requested per Each Claim in Columns at right

Mining Claims Traversed (List in numerical sequence)

Special Provisions	Geophysical	Days per Claim
For first survey: Enter 40 days. (This includes line cutting)	- Electromagnetic	
	- Magnetometer	
	- Radiometric	
	- Other	
For each additional survey: using the same grid: Enter 20 days (for each)	Geological	
	Geochemical	
Man Days Complete reverse side and enter total(s) here	Geophysical	Days per Claim
	- Electromagnetic	
	- Magnetometer	
	- Radiometric	
	- Other	
Airborne Credits MINING LANDS SECTION	Geophysical	Days per Claim
	Electromagnetic	
	Magnetometer	
Note: Special provisions credits do not apply to Airborne Surveys.	Radiometric	

Prefix	Mining Claim Number	Expend. Days Cr.	Prefix	Mining Claim Number	Expend. Days Cr.
P	663236	60			
	663237	60			
	663238	60			
	663239	60			
	663240	60			
	663241	60			
	663242	60			
	663243	60			
	663244	60			
	663245	60			
	663254	60			
	663263	60			
	663264	60			
	663273	60			
	805784	60			
	805785	60			
	805786	60			
	805787	60			

RECEIVED
OCT 15 1985

RECORDED
SEP 27 1985

PROSPERINE MINING DIVISION
RECEIVED
SEP 27 1985

Expenditures (excludes power stripping)

Type of Work Performed *(Sect 77-19)*
Reverse Circulation Drilling

Performed on Claim(s)
P663240 & P663241

Calculation of Expenditure Days Credits

Total Expenditures	÷	15	=	Total Days Credits
\$ 20,440.00				1362.67

Instructions
Total Days Credits may be apportioned at the claim holder's choice. Enter number of days credits per claim selected in columns at right.

For Office Use Only

Total Days Cr. Recorded	Date Recorded	Mining Recorder
1,080	Sept 27/85	<i>[Signature]</i>
	Date Approved as Recorded	Branch Director
	8.6.1.6	<i>[Signature]</i>

Total number of mining claims covered by this report of work. **18**

Date
27/09/85

Recorded Holder or Agent (Signature)
[Signature]

Certification Verifying Report of Work

I hereby certify that I have a personal and intimate knowledge of the facts set forth in the Report of Work annexed hereto, having performed the work or witnessed same during and/or after its completion and the annexed report is true.

Name and Postal Address of Person Certifying
W. MACRAE, P.O. BOX 417, Timmins, ONT. P4N 7E3

Date Certified
27/09/85

Certified by (Signature)
[Signature]



William E. MacRae Geological Services

P.O. Box 417, Timmins, Ontario. P4N 7E3

[705] 268-0111

17/12/85

Dear Sir,
Re: File 2.8662
Enclosed are revised copies of the
drill hole location maps for the
United Kingdom Energy report. I hope
this is satisfactory.

Yours Truly

W MacRae

RECEIVED

DEC 30 1985

MINING LANDS SECTION

RECEIVED	
LAND MANAGEMENT BRANCH	
DEC 30 1985	
PREFERENCE REPLY	<input type="checkbox"/>
COMMENTS PLEASE	<input type="checkbox"/>
BY	
S. E. YUNDT	<input checked="" type="checkbox"/>
J. R. MORTON	
J. C. SMITH	
W. P. BROOK	
M. J. HOGAN	
D. W. SCOTT	
S. KEEN	
Return To: R.6643	

United Kingdom Energy Inc.

SUITE 808 - 409 GRANVILLE STREET, VANCOUVER, B.C. V6C 1T2

TELEPHONE 689-7347

RECEIVED

DEC 1 8 1985

MINING LANDS SECTION

December 16 1985

Ministry of Natural Resources,
Land Management Branch,
Whitney Block, Room 6643,
Toronto, Ontario.

RECEIVED	
LAND MANAGEMENT BRANCH	
DEC 1 8 '85	
PREPARE REPLY	<input type="checkbox"/>
COMMENTS PLEASE BY	<input type="checkbox"/>
S. E. YUNDT	
J. R. MORTON	
J. C. SMITH	
W. P. BROOK	
M. J. HOGAN	
D. W. SCOTT	
S. KEEN	
Return To: R.6643	

File 2.8662.

Dear Sir:

Further to your letter dated Dec 6/85, and noting its contents.

Please find enclosed copies in duplicate, of our payments to "Dominik Drelling" in cheque form, totaling \$20,440.00.

Your second request for maps, re claim lines and numbers, is being completed by Mr. William E. MacRae of Timmins, Ontario, who will directly send them on from his office.

Yours Truly

B. Shelton

Compliments of the Season

advance payment to drilling contract.

UNITED KINGDOM ENERGY INC.
SUITE 808 - 409 GRANVILLE STREET
VANCOUVER, B.C. V6C 1T2

No 293

March 1 1985

PAY TO THE ORDER OF

Dominik Drilling Inc.

\$5000.00

five thousand

00 DOLLARS
100

THE BANK OF NOVA SCOTIA

GRANVILLE & PENDER ST. BR.
700 WEST PENDER STREET
VANCOUVER, B.C. V6C 1G8

UNITED KINGDOM ENERGY INC.

B. A. Helton

Albert J. Moss

⑈000293⑈ ⑆80440⑈002⑆ 00272⑈19⑈

⑈0000500000⑈

⑆ CUSTOM CHEQUES OF CANADA /IA

Invoice 0921.

UNITED KINGDOM ENERGY INC.
SUITE 808 - 409 GRANVILLE STREET
VANCOUVER, B.C. V6C 1T2

No 310

April 29 1985

PAY TO THE ORDER OF

Dominik Drilling (1981) Inc.

\$6655.00

six thousand six hundred & fifty five

00 DOLLARS
100

THE BANK OF NOVA SCOTIA

GRANVILLE & PENDER ST. BR.
700 WEST PENDER STREET
VANCOUVER, B.C. V6C 1G8

UNITED KINGDOM ENERGY INC.

B. A. Helton

Albert J. Moss

⑈000310⑈ ⑆80440⑈002⑆ 00272⑈19⑈

⑈0000665500⑈

⑆ CUSTOM CHEQUES OF CANADA /IA

Invoice 0959.

UNITED KINGDOM ENERGY INC.
SUITE 808 - 409 GRANVILLE STREET
VANCOUVER, B.C. V6C 1T2

No 331

June 5 1985

PAY TO THE ORDER OF

Dominik Drilling (1981) Inc.

\$8785.00

eight thousand seven hundred & eighty five

00 DOLLARS
100

THE BANK OF NOVA SCOTIA

GRANVILLE & PENDER ST. BR.
700 WEST PENDER STREET
VANCOUVER, B.C. V6C 1G8

UNITED KINGDOM ENERGY INC.

B. A. Helton

Albert J. Moss

⑈000331⑈ ⑆80440⑈002⑆ 00272⑈19⑈

⑈0000878500⑈

*overbank billing
Lair, Macklem
Tremblay, Timmins
(in advance)*

MR '85 20 1
SCOTIABANK
DATA CENTRE
VANCOUVER

0885 14 003
LA BANQUE
DE NOUVELLE-ECOSSE
DE CALCUL
MONTREAL
85 07 1
7 5

ROYAL BANK
QUEBEC

DEPOT FORAGE - 55
DOMINIK (1981) 55
8 5

13 7 8 1 8 1

13 7 8 1 8 1

NY '85 07
SCOTIABANK
DATA CENTRE
VANCOUVER

0885 14 003
LA BANQUE
DE NOUVELLE-ECOSSE
DE CALCUL
MONTREAL
85 06 1
8 9

NY '85 06
ROYAL BANK
QUEBEC

DEPOT FORAGE - 55
DOMINIK (1981) 55
8 5

13 7 8 1 8 1

13 7 8 1 8 1

IDENTIFICATION
5810118 55

JE '85 12 1
SCOTIABANK

0885 14 003
LA BANQUE
DE NOUVELLE-ECOSSE
DE CALCUL
MONTREAL
85 11 1

DEPOT FORAGE - 55
DOMINIK (1981) 55
8 5

ROYAL BANK
QUEBEC

13 7 8 1 8 1

8508

8508

8508

December 6, 1985

File: 2.8662

United Kingdom Energy Inc.
Suite 808
409 Granville Street
Vancouver, B.C.
V6C 1T2

Dear Sirs:

RE: Data for Reverse Circulation Drilling
submitted on Mining Claims P 663236,
et al, in Macklem Township

Returned herein is the Drill Hole Location plan (in duplicate). Please show the claim lines and numbers on each copy. Also please forward (in duplicate) receipts or cancelled cheques as proof of payment for the \$20,440.00 expenditure credits claimed.

When submitting this information, please quote file 2.8662.

For further information, please contact Susan Hurst at (416)965-4888.

Yours sincerely,

S.E. Yundt
Director
Land Management Branch

Whitney Block, Room 6643
Queen's Park
Toronto, Ontario
M7A 1W3
Phone: (416)965-4888

SH/mc

cc: Mining Recorder
Timmins, Ontario
#338/85

W. MacRae
P.O. Box 417
Timmins, Ontario
P4N 7E3

Encl.

November 18, 1985

Report of Work: #338

REGISTERED

United Kingdom Energy Inc.
Suite 808
409 Granville Street
Vancouver, B.C.
V6C 1T2

Dear Sirs:

RE: Mining Claims P 663236 et al in the
Township of Macklem

I have not received the reports and maps (in duplicate) for the Reverse Circulation Drilling on the above-mentioned claims.

As the assessment "Report of Work" was recorded by the Mining Recorder on September 27, 1985 the 60 day period allowed by Section 77 of the Mining Act for the submission of the technical reports and maps to this office will expire on November 26, 1985.

If the material is not submitted to this office by November 26, 1985 I will have no alternative but to instruct the Mining Recorder to delete the work credits from the claim record sheets.

For further information, please contact Mr. A. Barr at 416/965-4888.

Yours sincerely

S.E. Yundt
Director
Land Management Branch

Whitney Block, Room 6643
Queen's Park, Toronto
M7A 1W3
Telephone: 416/965-4888

AB:sc

cc: W. MacRae
P.O. Box 417
Timmins, Ontario
P4N 7E3

cc: Mining Recorder
Timmins, Ontario

MAP SYMBOLOLOGY

Aerial Cowlway	Pipeline (above ground)
Boundary	Railroad
International	Single Track
District, Township Indian Reserve	Double Track
Approximate	Abandoned
Lot, Concession	Road
Approximate	Highway County
Post Boundary	Township
Bridge	Access Road of doubtful
Road, Railroad	or existence of
Building	High-Traffic Roadway
Chimney	Tram, Back Road (single line)
Cliff, Pit, Pile	Rapids
Contours	Double line river
Interpretation	with multiple rapids
Approximate	Double line river
Depression	with multiple rapids
Control Points	Reservoir
Horizontal	River, Stream, Canal
Vertical	Approximate
Culvert	Location of Dam
Falls	Rock
Double line river	Vertical
Fence, Hedge, Wall	Spot Elevation
Feature Outline	Tower
(Construction Features, etc.)	Transmission Line
Flooded Land	Pole
Lock	Palms
Marsh or Swamp	Tunnel
Mast	Utility Poles
Mine Head Frame	Wharf, Dock, Pier
Outcrop	Wooded Area

AREAS WITHDRAWN FROM DISPOSITION

- M.R.O. - MINING RIGHTS ONLY
- S.R.O. - SURFACE RIGHTS ONLY
- M.+S. - MINING AND SURFACE RIGHTS

Description	Order No.	Date	Disposition	File
Site Preparation	05/02/83			77034 V.6

SAND and GRAVEL

- GRAVEL FILE 105381
- M.T.C. PIT 1121
- QUARRY PERMIT

GERMAN TWP.

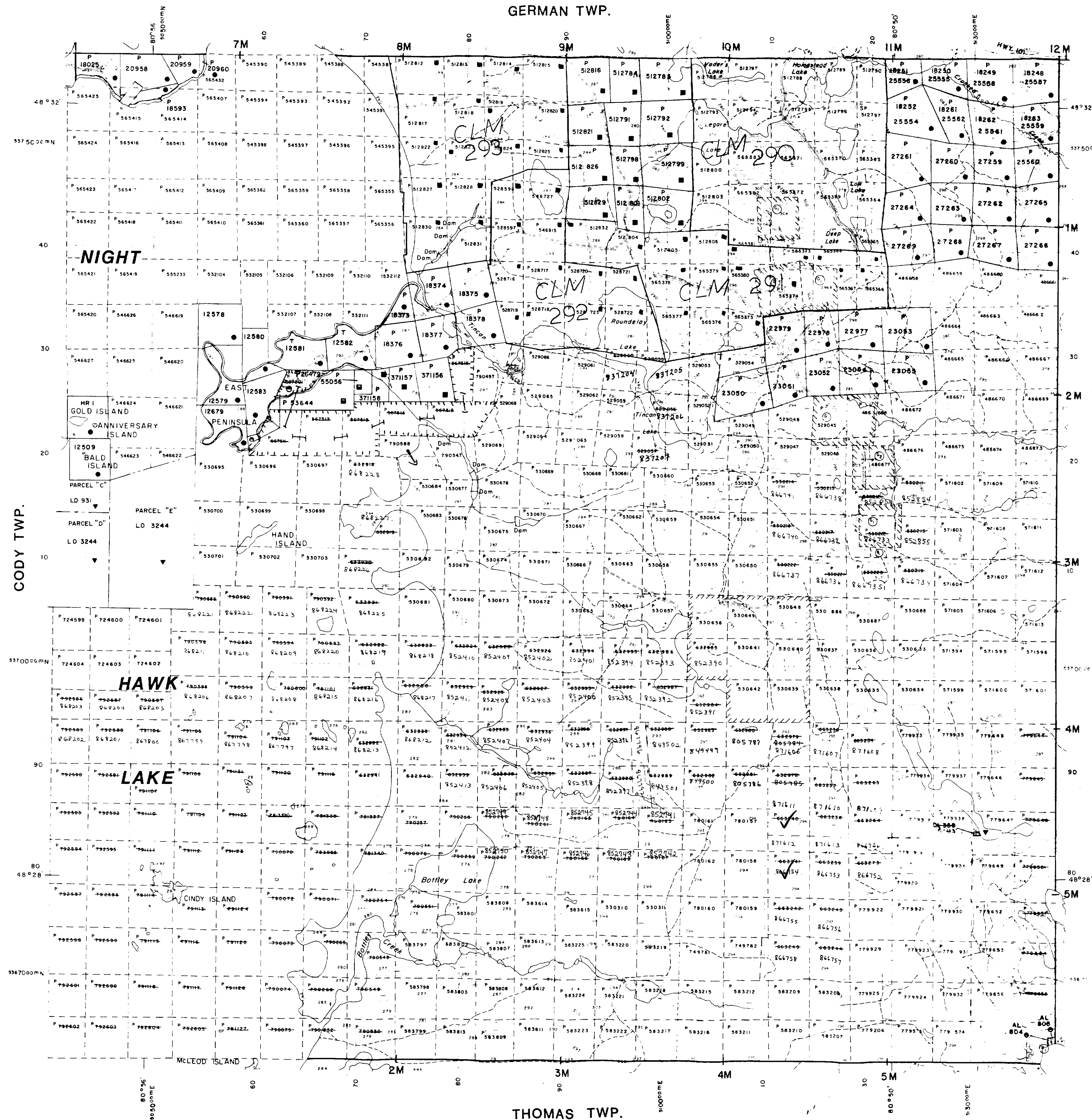

LEGEND

HIGHWAY AND ROUTE No	
OTHER ROADS	
TRAILS	
SURVEYED LINES	
TOWNSHIPS, BASE LINES, ETC	
LOTS, MINING CLAIMS, PARCELS, ETC	
UNSURVEYED LINES	
LOT LINES	
PARCEL BOUNDARY	
MINING CLAIMS ETC	
RAILWAY AND RIGHT OF WAY	
UTILITY LINES	
NON-PERENNIAL STREAM	
FLOODING or FLOODING RIGHTS	
SUBDIVISION or COMPOSITE PLAN	
RESERVATIONS	
ORIGINAL SHORELINE	
MARSH or MUSKIEG	
MINES	
TRAVERSE MONUMENT	

DISPOSITION OF CROWN LANDS

TYPE OF DOCUMENT	SYMBOL
PATENT, SURFACE & MINING RIGHTS	
" SURFACE RIGHTS ONLY	
" MINING RIGHTS ONLY	
LEASE, SURFACE & MINING RIGHTS	
" SURFACE RIGHTS ONLY	
" MINING RIGHTS ONLY	
LICENCE OF OCCUPATION	
ORDER IN COUNCIL	
RESERVATION	
CANCELLED	
SAND & GRAVEL	

NOTE: MINING RIGHTS IN PARCELS PATENTED PRIOR TO MAY 6 1913 VESTED IN ORIGINAL PATENTEE BY THE PUBLIC LANDS ACT, R.S.O. 1970 CHAP. 300, SEC. 63, SUBSEC. 1

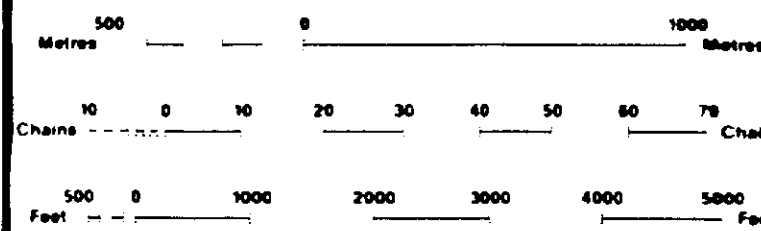

SCALE 1:20 000
GRID ZONE 17

Reserve flooding rights on Night Hawk Lake to Ontario Hydro to elevation 903.5', T.B.M. No. 101um

Area withdrawn NR+SR from Staking & Section 36 Mining Act. R.S.O. 1980 See NR W 10/85

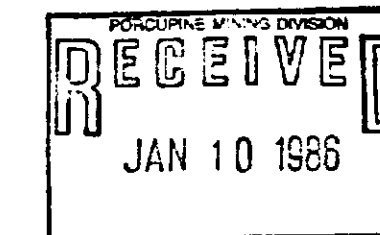

TOWNSHIP
MACKLEM
M.N.R. ADMINISTRATIVE DISTRICT
TIMMINS
MINING DIVISION
PORCUPINE
LAND TITLES / REGISTRY DIVISION
COCHRANE

Ministry of Natural Resources
Land Management Branch
Ontario

ORIGINAL COMPILATION JULY 1984
REVISED
G-3997

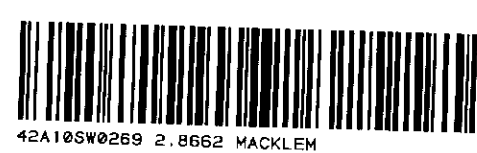

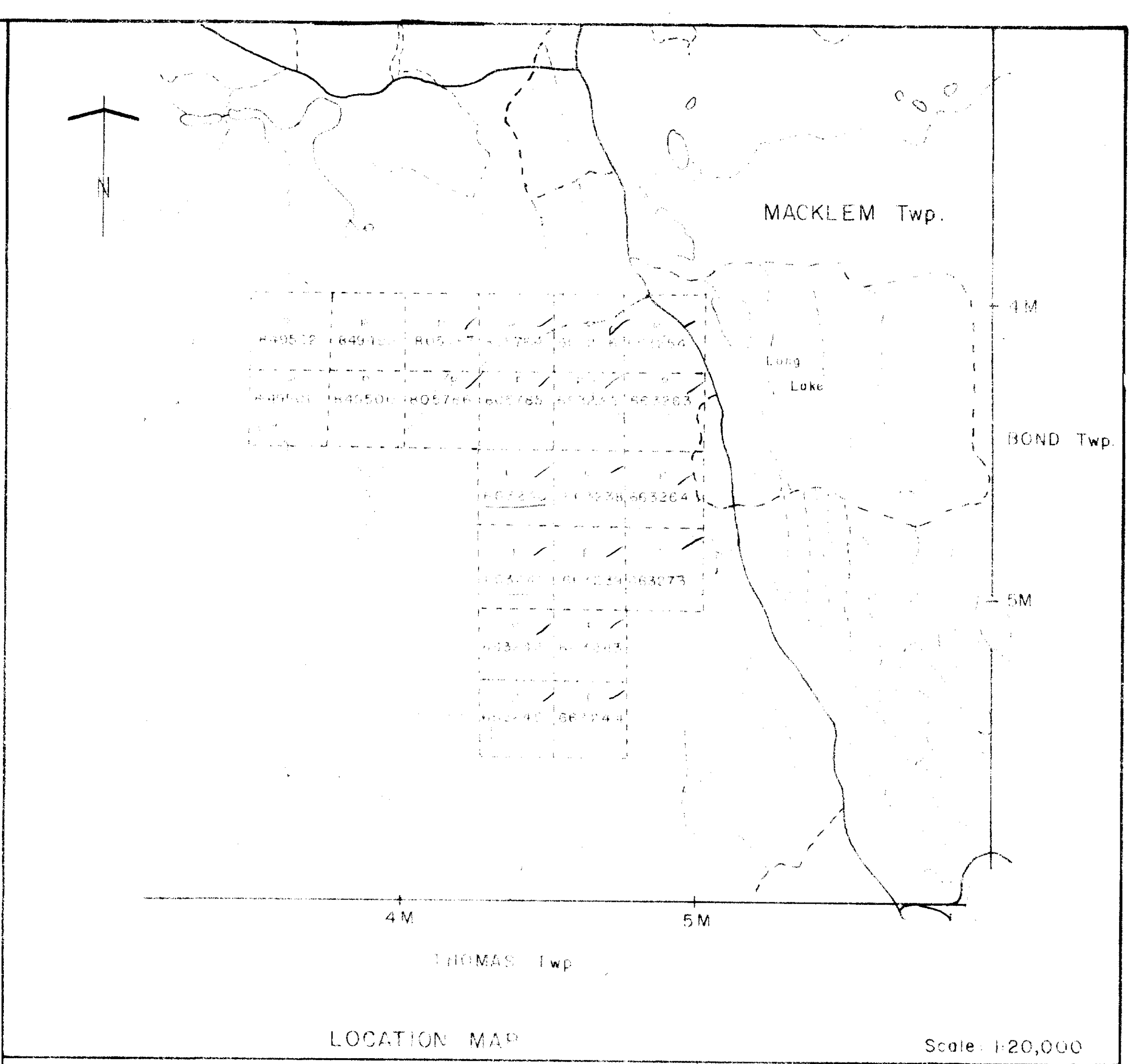
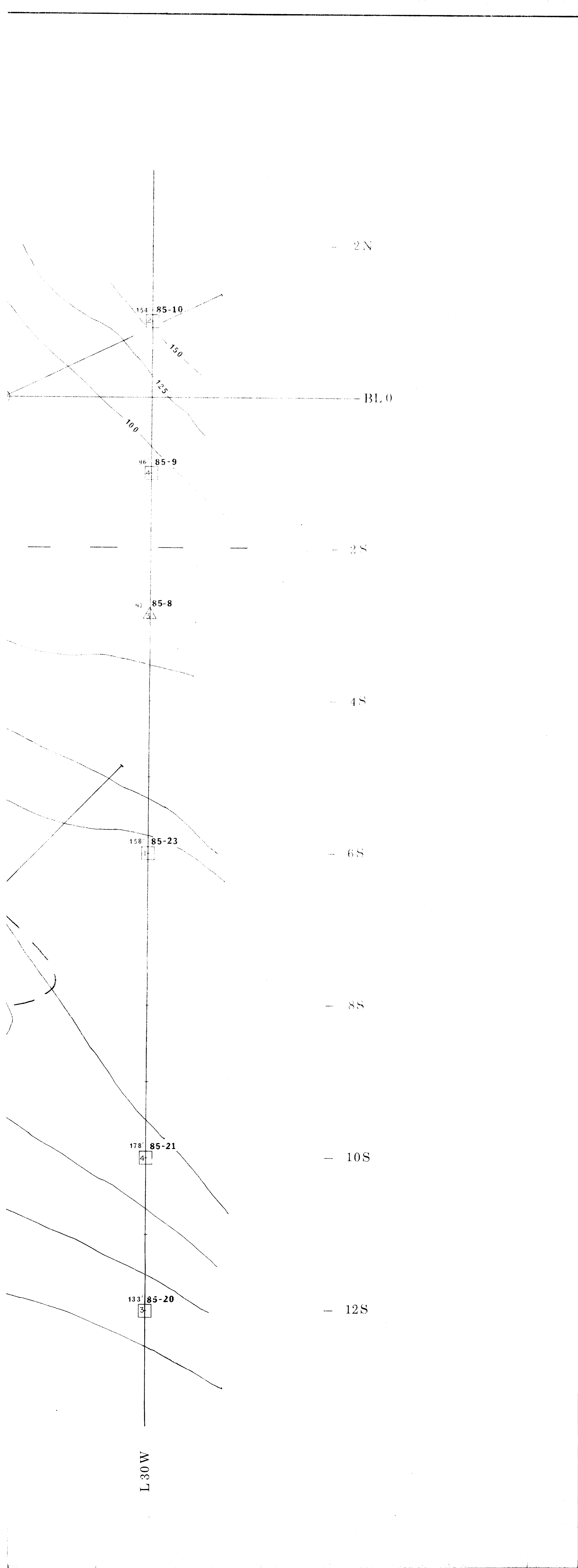

LOCATION MAP Scale: 1:20,000

LEGEND

- PHASE 1 DRILLING
 - PHASE 2 DRILLING
 - Bedrock Depth: 37 85 28 Hole Number
 - Overburden Depth (contour interval: 25')
 - Proposed Diamond Drill Hole
- BEDROCK TYPE**
- Talc Chlorite Schist
 - Rusty Brown Talc Chlorite Schist
 - Partially Altered Ultramafic
 - Carbonitized Ultramafic

Map 1

UNITED KINGDOM ENERGY Inc.	
DRILL HOLE LOCATIONS	
Property: Long Lake Claim Group	
Mining Division: Porcupine	
Twp: Macklem	NTS: 42 A/7
Drawn by: W. MacRae	Date: 21/05/85
Scale: 1"=50'	

W MacRae

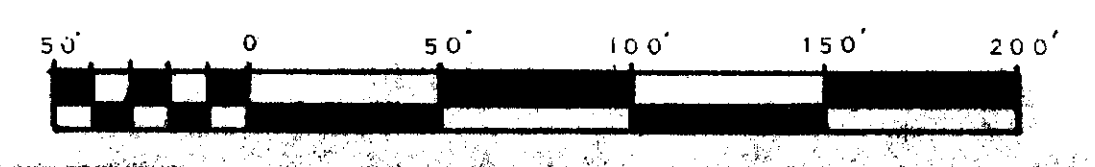

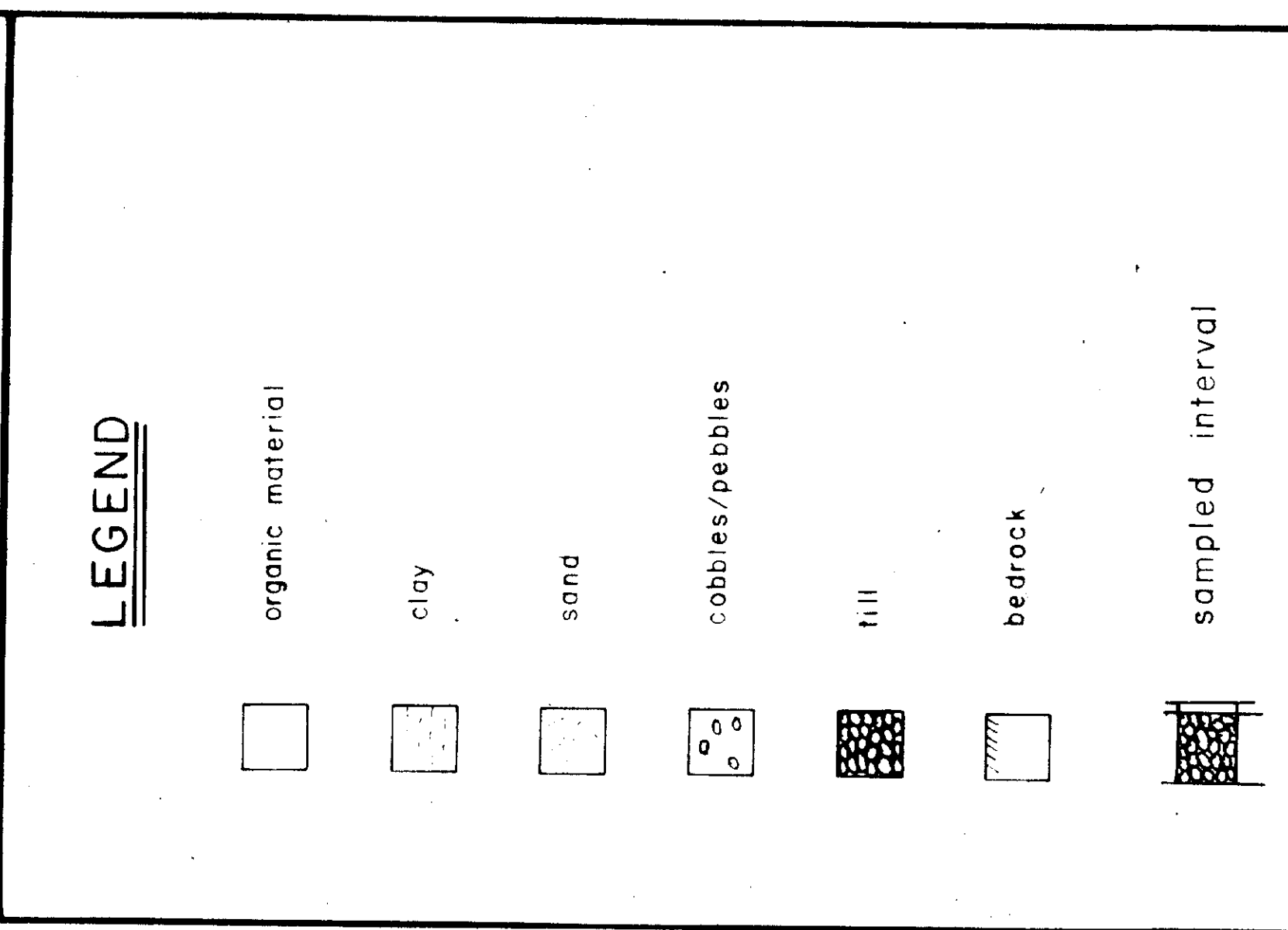
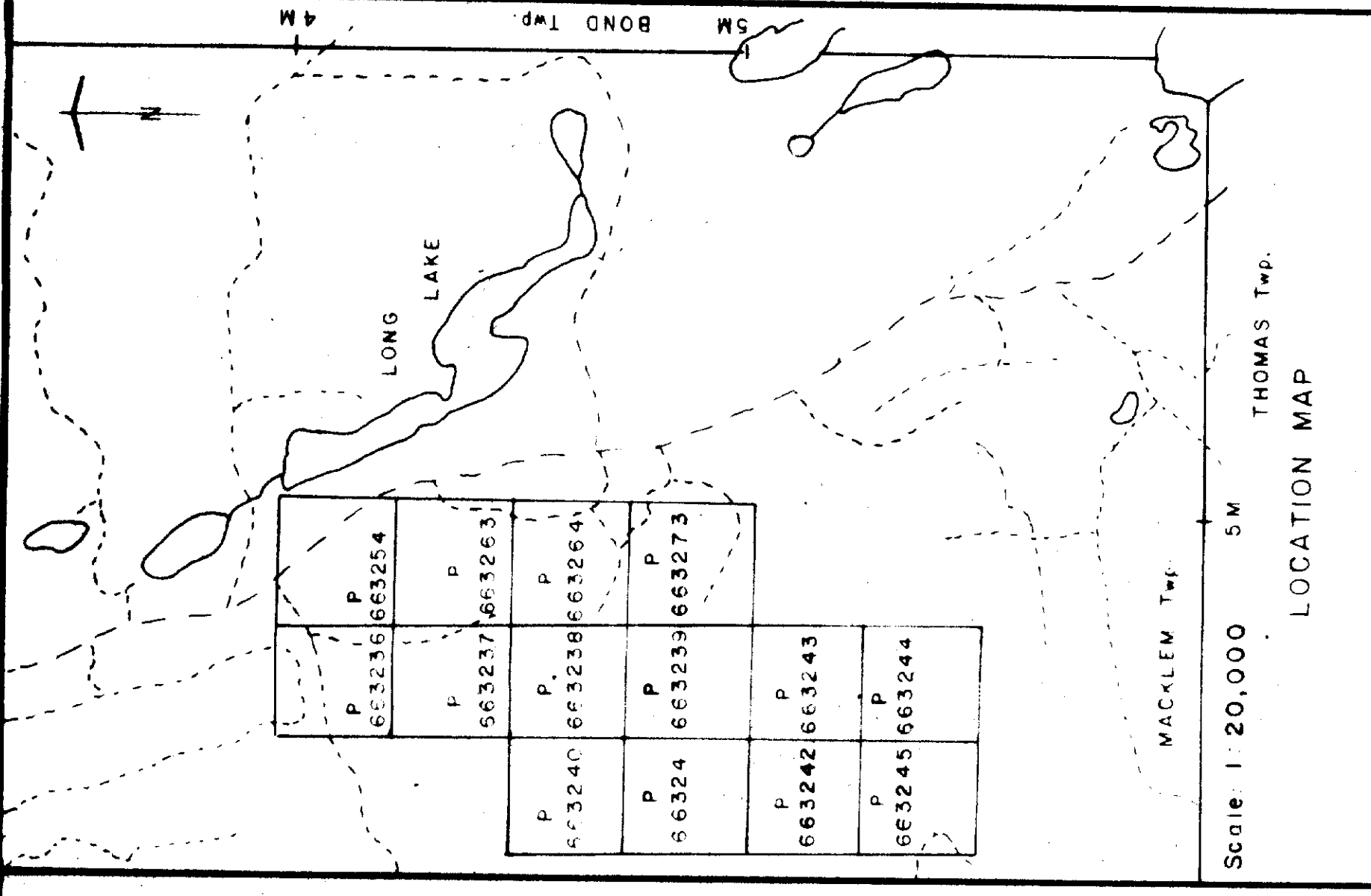

W. J. ...

UNITED KINGDOM ENERGY

OVERBURDEN DRILL SECTIONS
L30W & L33W
2842

Property: Long Lake Claim Group
Mining Division: Porcupine
Town: Macleam
N.T.S. 46 47

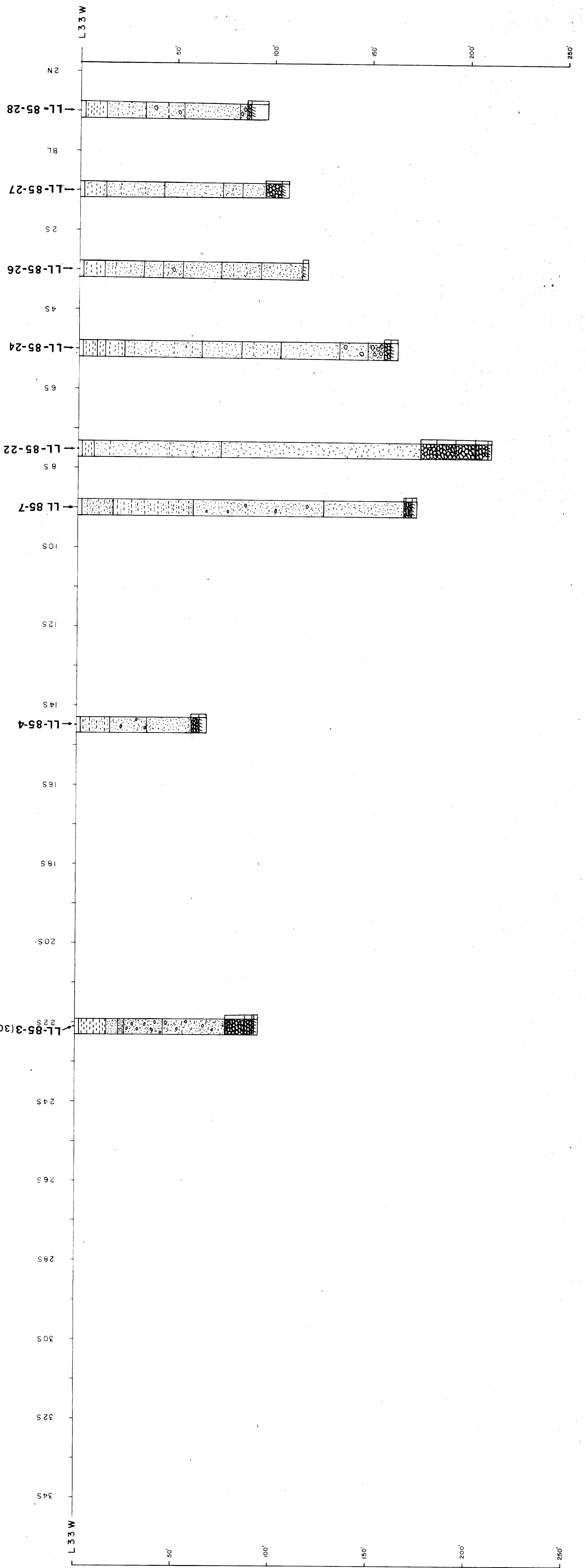
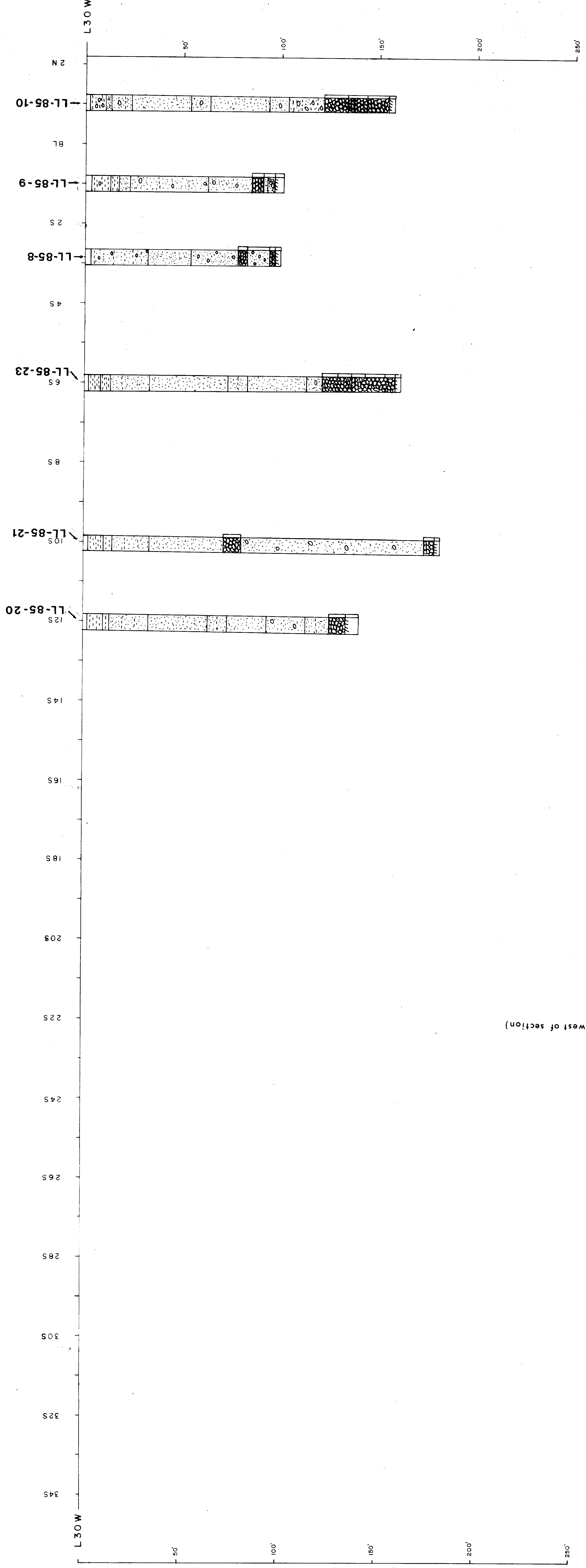

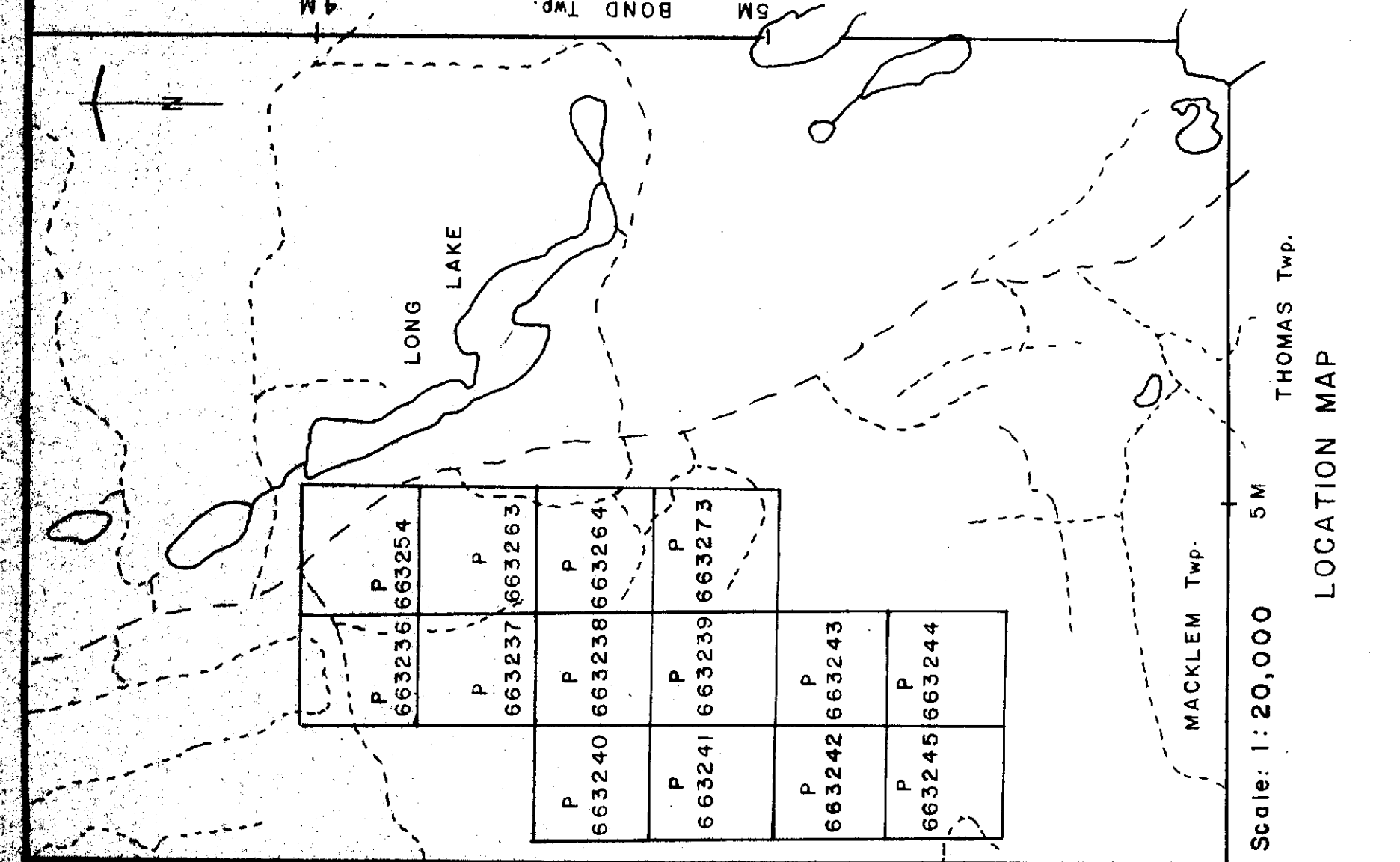

LEGEND

- organic material
- clay
- sand
- cobbles/pebbles
- till
- bedrock
- sampled interval

UNITED KINGDOM ENERGY
 OVERBURDEN DRILL SECTIONS
 L 36W & L 39W 28662
 Property: Long Lake Claim Group
 Mining Division: Porcupine
 Twp: Macklem N.T.S 42 A/7
 Drawn by: W. MacRAE Date: 31/05/85
 Scale: Horizontal 1"=100'/Vertical 1"=20'

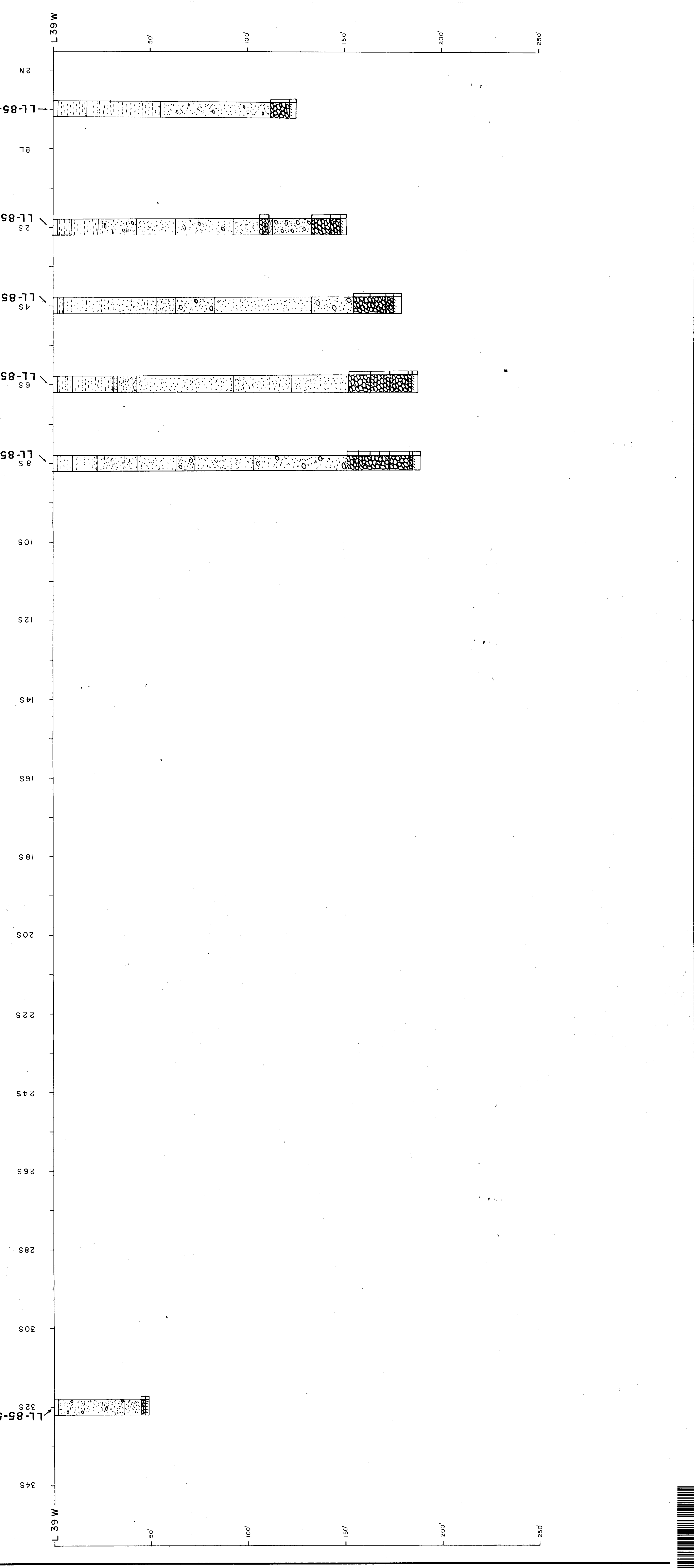
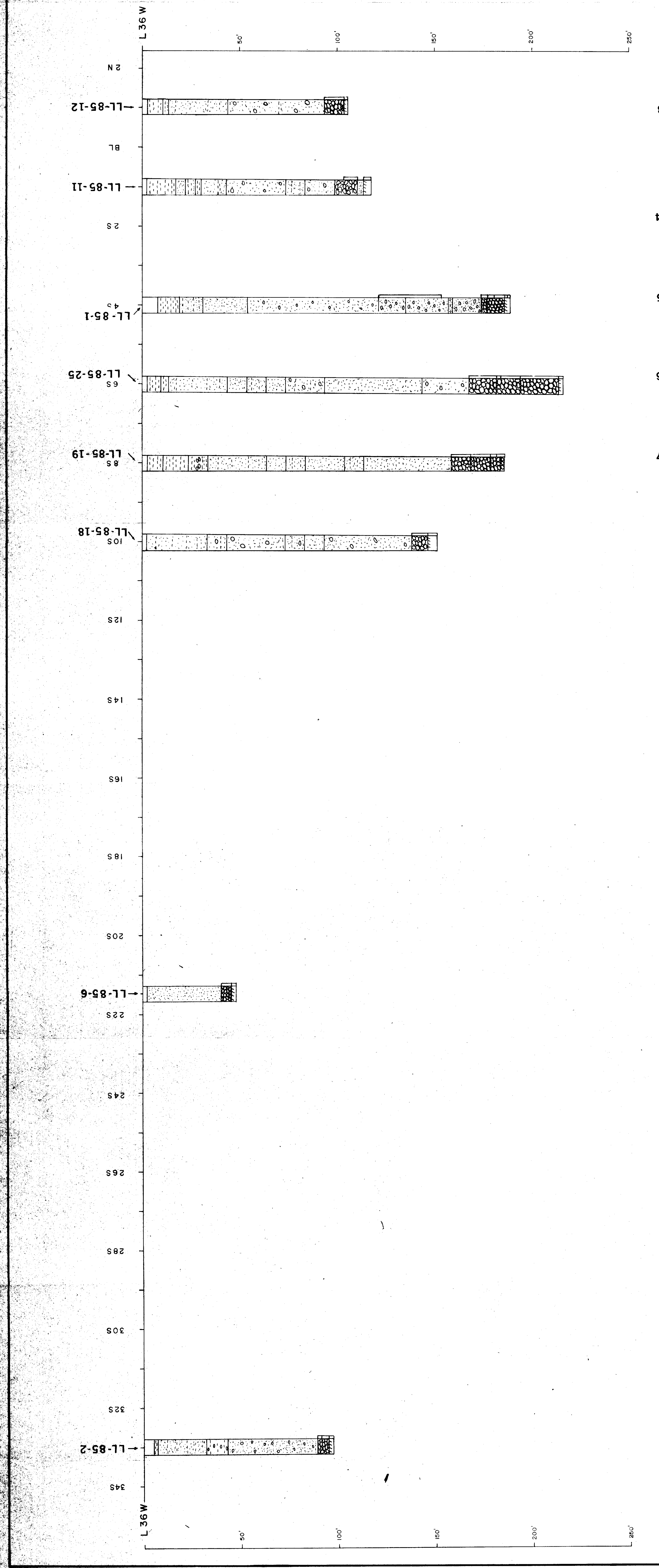

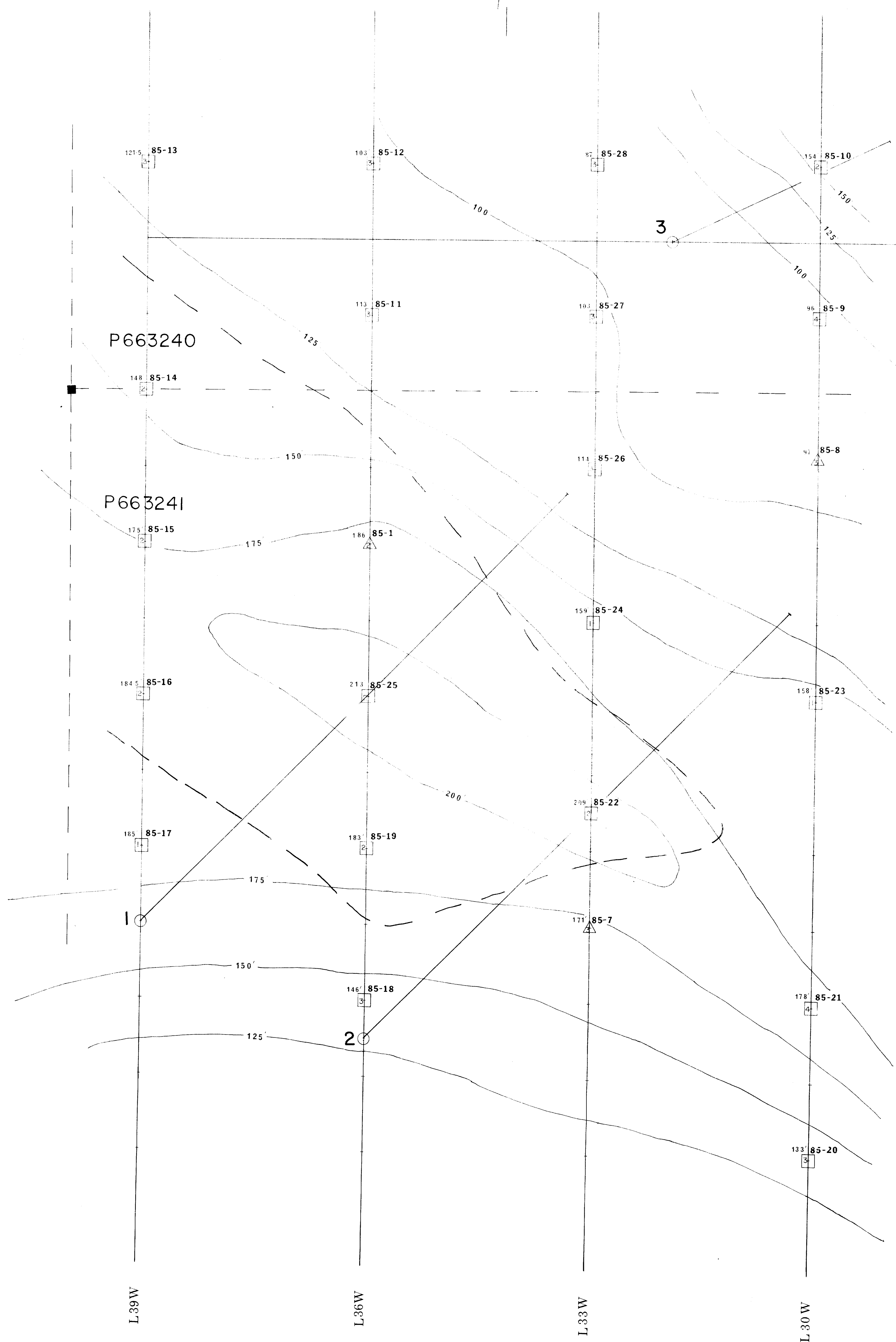

P663240

P663241

L39W

L36W

L33W

L30W

