



42A10SW0333 34 CODY

010

DIAMOND DRILLING

Township: Cody

Report No: 34

WORK PERFORMED FOR: J.P. Sheridan

RECORDED HOLDER: SAME AS ABOVE [x]

: OTHER []

<u>CLAIM NO.</u>	<u>HOLE NO.</u>	<u>FOOTAGE</u>	<u>DATE</u>	<u>NOTE</u>
P 55828	87CE-1	602'	Mar/87	(1)

NOTES: (1) #67-87(filed in July/87)

DIAMOND DRILL RECORD

NAME OF PROPERTY Evans Option
 HOLE NO. 87CE-1 LENGTH 602' (still drilling)
 LOCATION Claim 555828 Cody Tp. (Below High Water Mark) Lake 10' below normal
 LATITUDE 274905 (Grid) DEPARTURE 31+10E (Grid)
 ELEVATION High Water -3' AZIMUTH 10° DIP -45°
 STARTED Mar 23/87 FINISHED Mar 31/87 - still drilling

FOOTAGE	DIP	AZIMUTH	FOOTAGE	DIP	AZIMUTH
0	-45	10°			
250	-43				
500	-42				

HOLE NO. 87CE-1 SHEET NO. 1 of 3
 REMARKS Hole still being drilled - slated for 1000 feet.

LOGGED BY CF Dession

FOOTAGE		DESCRIPTION	SAMPLE			ASSAYS					
FROM	TO		NO.	% SULPHIDES	FOOTAGE FROM	FOOTAGE TO	FOOTAGE TOTAL	%	%	OZ/TON	OZ/TON
0	8.0	CASING									
8.0	55.0	Talc Chlorite Qtz-Albite Schist. Abundant white ferro-carb. Med. grey, slightly ptic. 25% Qtz-albite in irreg. seams and stringers. Sparse blebs coarse pyrite to 3mm. CA 45-50°									
55.0	85.5	Chloritic Qtz-albite alteration zone. Med. grey with very faint yellowish cast. Slightly porphyritic.									
85.5	132.0	Talcose Volcanic. Fine grained, med grey, slightly ptic, chloritic, alt'd. Mod. fractured. Local scattered patches ferro-carb. Minor albite silic'n in irreg. seams.									
132.0	169.5	Porphyritic Alt'd Volcanic. Fine grained, ^{talcose} Med. grey with ^{slightly ptic.} faint yellowish cast similar to 55-85.5. Sheared in local areas with 20% albite Qtz in seams and irregular blebs and stringers. CA 25-50°									
		139.1-140.0: white milky Qtz									
		At 157: 7" grey albite-Qtz mix with thin seam fuschite									
		160.0-161.0: abundant ferro-carb in blebs up to 3mm									
169.5	231.3	Talc Chlorite Shear ^{zone.} Grad. from above. Highly sheared 50% whitish grey albite Qtz in irreg. seams and blebs sparse fine disseid pyr. CA 45°									

ONTARIO GEOLOGICAL SURVEY
 ASSESSMENT FILES
 RESEARCH OFFICE
 APR 10 1987
 RECEIVED

ORCUPINE MINING DIVISION
 RECEIVED
 MAR 21 1987
 3

DIAMOND DRILL RECORD

NAME OF PROPERTY Evans Option
 HOLE NO. 87CE-1 SHEET NO. 2 of 3

FOOTAGE		DESCRIPTION	SAMPLE			ASSAYS					
FROM	TO		NO.	% SULPHIDES	FOOTAGE			%	%	OZ. TON	OZ. TON
					FROM	TO	TOTAL				
231.3	455.5	Serpentinite. Dark grey to blackish grey. Minorly whitish grey albitic silic. Very scant ^{disseminated} magnetite in small clusters and widely dispersed. Very sparse disseminated pyrite. CA 50°-70° 222.0-224.0: talc schist 360.2-370.0: core ground and lost 400.0-421.0: f. grained fairly uniform, massive. non-magnetic. 421.0-437.3: highly brecc'd, blackish grey with albitic grt in irreg blebs to 1/2". Sparse diss'd pyrite 440.0-441.3: as above 441.3-455.5: euhedral pyrite in grains up to 2mm increasing plus scant patches up to 5mm of fine pyrite									
455.5	526.0	Serpentinite: dark greenish grey with local blackish grey areas. 25% albitic grt with chlorite in small irregular blebs. Very sparse diss'd pyrite up to 2mm. Core weakly magnetic. CA 35°-40° irregular 460.0-463.2: muddied schist 505.0-515.6: muddied and badly broken 515.6-526.0: ^{paler} grey, brecc'd 1/4" rept'd. Sparse albitic grt. Sparse pyrite									

LANGRIDGES - TORONTO - 366-1168

DIAMOND DRILL RECORD

NAME OF PROPERTY Evans Option
 HOLE NO. 87CE-1 SHEET NO. 3 of 3

FOOTAGE		DESCRIPTION	SAMPLE			ASSAYS				
FROM	TO		NO.	% SULPHIDES	FOOTAGE		%	%	OZ/TON	OZ TON
					FROM	TO				
526.0	575.0	<p>Serpentine: gradational from above. Bit harder non magnetic. Fine grained, med. grey, brecc'd. Slightly pty in local small areas. 5% albite silicification. Minor white gtz blebs to 1cm. Very sparse specks pyrite.</p> <p>526.2-530.0: core grain & and lost</p> <p>540-575: pale grey blotchy appearance. Very scant fine pyrite.</p> <p>At 573.5: 5" white milky gtz with 1% green chlorite</p>								
575.0	602.0	<p>Borderline Talcose Volcanic - Serpentinized. Fine grained med grey. Sparse pyrite disseminated and along thin fractures.</p> <p>602 Log to March 31/87</p> <p>Hole still being drilled</p> <p>Core Size ADBEM 1.2" diameter</p> <p>C. Ulesso</p>								

ONTARIO GEOLOGICAL SURVEY
 ASSESSMENT FILES
 RESEARCH OFFICE
 APR 10 1987
 RECEIVED

NORTHEAST BAY
NIGHTHAWK LAKE

P555827

P555828

P555829

High Water (Normal)
Shore Line.

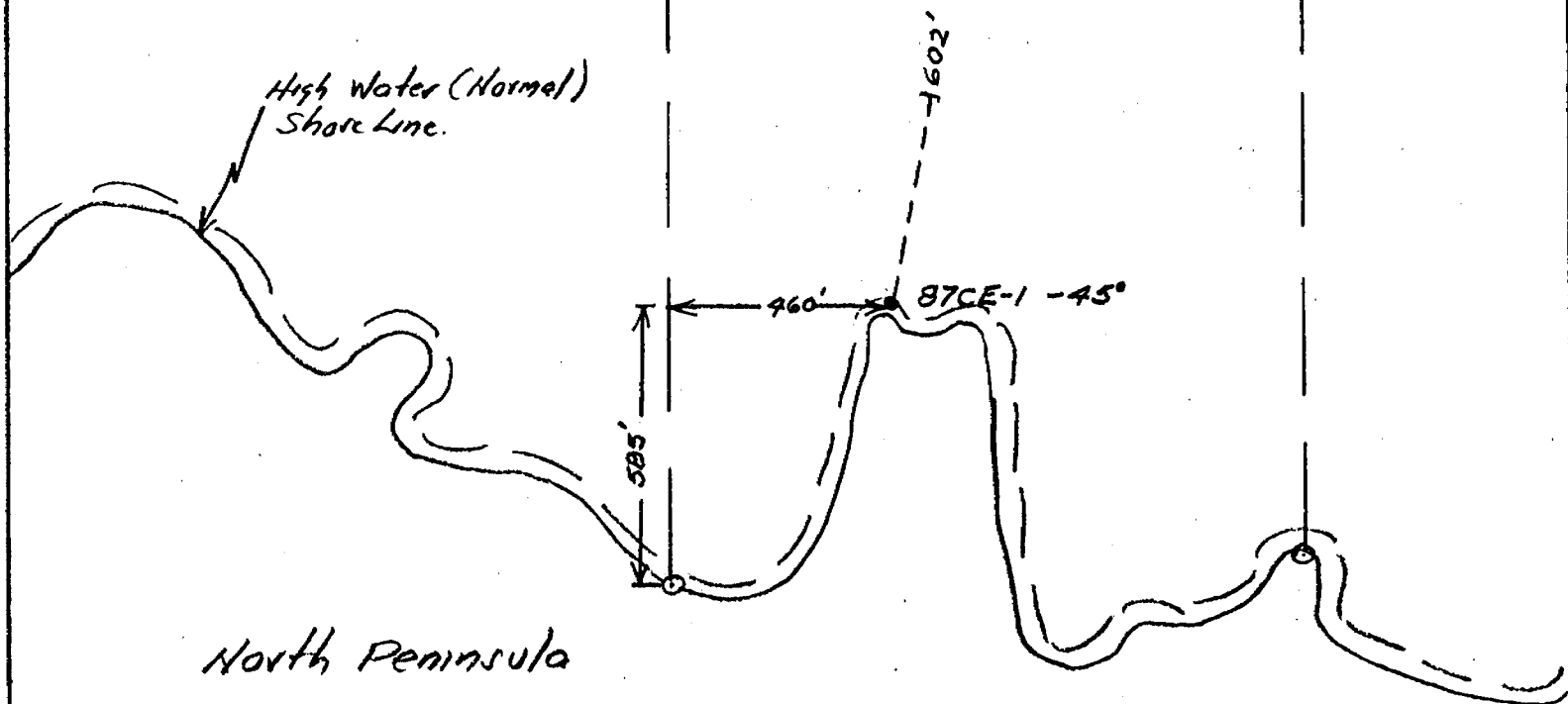

SYMBOLS

- Drill hole plan
- ⊙--- Claim Post, Line

EVANS OPTION

DDH 87CE-1

HOLE LOCATION PLAN

SCALE: 1/4" = 400 FT 31-03-87

Chalson



67/8
Minin



42A10SW0333 34 CODY

900

Name and Postal Address of Recorded Holder
Mr. J. P. Sheridan
150 York St Ste. 1814, Toronto, Ontario
M5H 3S5

Summary of Work Performance and Distribution of Credits

Total Work Days Cr. claimed	Mining Claim			Work Days Cr.	Mining Claim			Work Days Cr.	Mining Claim			Work Days Cr.
	Prefix	Number	Work Days Cr.		Prefix	Number	Work Days Cr.		Prefix	Number	Work Days Cr.	
602	P	552605	14	P	552613	14	P	552621	14			
		552606	14		552614	14		555236	14			
		552607	14		552615	14		555237	14			
		552608	14		552616	14		555238	14			
		552609	14		552617	14		555239	14			
		552610	14		552618	14		555240	14			
		552611	14		552619	14		555241	14			
		552612	14		552620	14		See Attached List				

All the work was performed on Mining Claim(s): *P 555828*

Required Information eg: type of equipment, Names, Addresses, etc. (See Table Below)

Drill Model JKS-300
Core Size ADBEM 1.2" diameter
Drilling dates Mar 23/87 to Mar 31/87 - still drilling
Drill Contractor:
Preston Electrical & Mechanical
Drilling Division
Box 1392
Timmins, Ontario P4N 7N2

ASSESSMENT FILES RESEARCH OFFICE
 APR 10 1987
 RECEIVED

RECORDED
 MAR 31 1987

RECEIVED
 MAR 31 1987

Date of Report: *March 31/87*
 Recorded Holder (Agent) (Signature): *Chlessor*

Certification Verifying Report of Work
 I hereby certify that I have a personal and intimate knowledge of the facts set forth in the Report of Work annexed hereto, having performed the work or witnessed same during and/or after its completion and the annexed report is true.

Name and Postal Address of Person Certifying
Mr. C F Desson Box 2217 Timmins Ontario P4N 8E7
 Date Certified: *Mar 31/87*
 Certified by (Signature): *Chlessor*

Table of Information/Attachments Required by the Mining Recorder

Type of Work	Specific information per type	Other information (Common to 2 or more types)	Attachments
Manual Work	Nil	Names and addresses of men who performed manual work/operated equipment, together with dates and hours of employment.	Work Sketch: these are required to show the location and extent of work in relation to the nearest claim post.
Shaft Sinking, Drifting or other Lateral Work			
Compressed air, other power driven or mechanical equip.	Type of equipment	Names and addresses of owner or operator together with dates when drilling/stripping done.	Work Sketch (as above) in duplicate
Power Stripping	Type of equipment and amount expended. Note: Proof of actual cost must be submitted within 30 days of recording.		
Diamond or other core drilling	Signed core log showing; footage, diameter of core, number and angles of holes.	Nil	Nil
Land Survey	Name and address of Ontario land surveyor.		

- 2 -

Report of Work

Mar

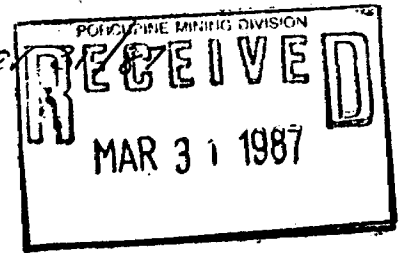

Ministry of
Northern Development
and Mines

Claims List (continued)

Prefix	MINING CLAIM		Work Days cr.	MINING CLAIM		Work Days Credit
	Number	Work		Prefix	Number	
P	555 242	14	P	555 834	14	
	555 818	14		555 835	14	
	555 819	14		555 836	14	
	555 820	14				
	555 821	14				
	555 822	14				
	555 823	14				
	555 824	14				
	555 825	14				
	555 826	14				
	555 827	14				
	555 828	14				
	555 829	14				
	555 830	14				
	555 831	14				
	555 832	14				
	555 833	14				

