



42A106W1303 2.4721 CODY

010

OVERBURDEN DRILLING REPORT

FOR

KARPOVICH CLAIMS, NIGHT HAWK LAKE

PORCUPINE MINING DIVISION

DISTRICT OF COCHRANE, ONTARIO

BY

PAMOUR PORCUPINE MINES LIMITED

EXPLORATION DEPARTMENT

ED VAN HEES

APRIL, 1982

RECEIVED

APR 26 1982

MINING LANDS SECTION

SUMMARY OF WORK

Total footage drilled	237.8
Number of holes	6
Operating days* March 7, 8, 1982	1.75 days
Total Cost of drilling	4,928.70
Cost of supervision plus sampler \$220/day x 1.75 days	<u>388.50</u>
Total Cost	5,317.20
Cost per foot	22.36
Credit earned at \$15 per day	= 354.5 days

* The program took longer than expected here because 4-5 hours were spent pulling the drill out of slush on March 8, 1982.

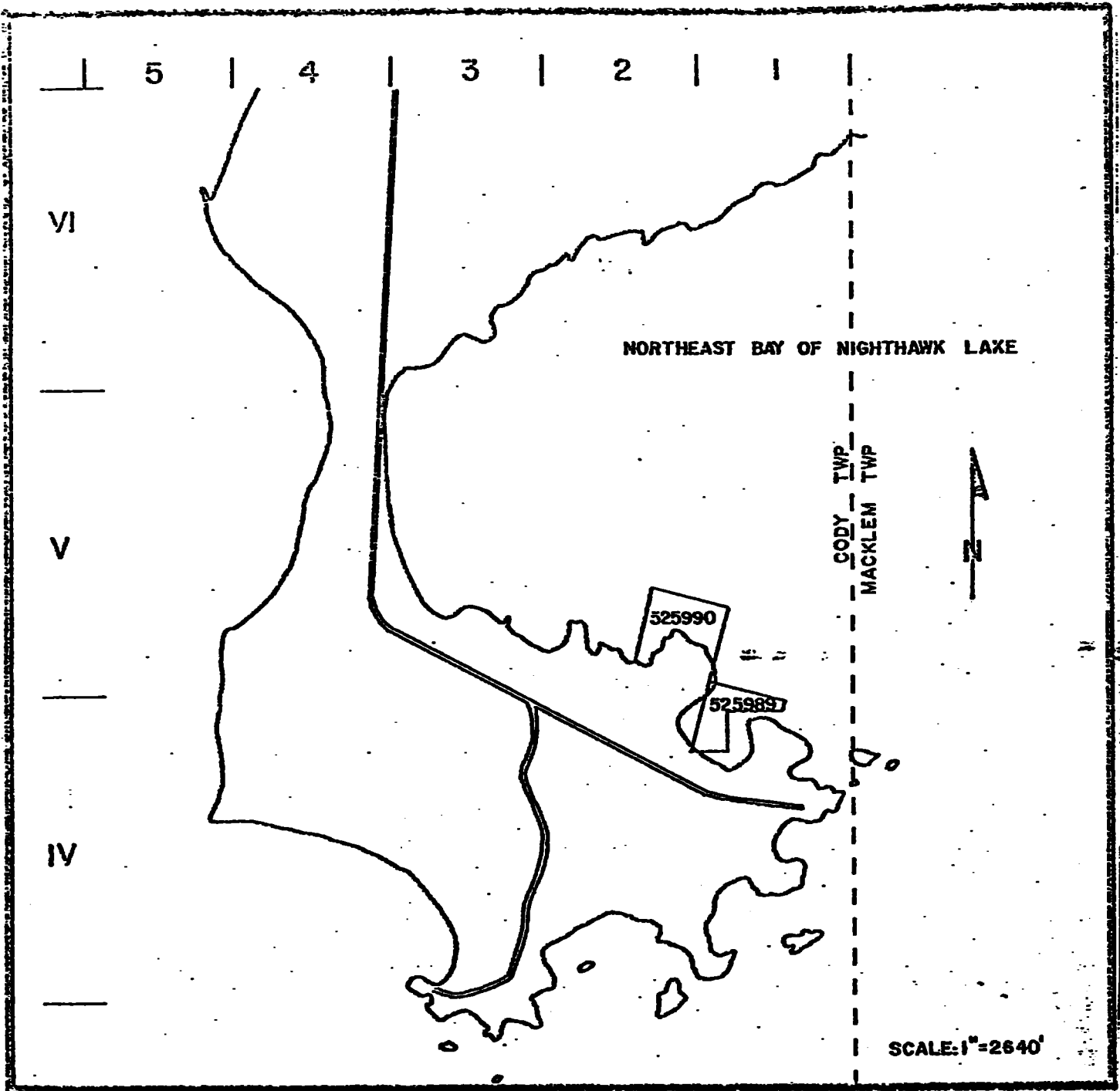

5 | 4 | 3 | 2 | 1

VI

V

IV

NORTHEAST BAY OF NIGHTHAWK LAKE

CODY TWP
MACKLEM TWP

525990

525989



SCALE: 1" = 2640'

REPORT ON OVERBURDEN SAMPLING PROCEDURE

General Statement

During the winter of 1982, Bradley Brothers Limited was contracted to carry out a reverse circulation overburden drilling program. During the contract period of March 1 to 10th, they drilled for 1 day on claim 525990 and three quarters of a day on claim 525989.

The equipment consists of a Longyear 38 drill mounted on a skid which was towed from drill site to drill site by a JD 440 tractor and a J-5 bombardier. Water was supplied by a pump and waterline for these sites where water was not immediately available.

The water is pumped down the outer tube of the drill rods and returns up the inner tube with the sample. The samples are collected in five gallon pails. Sampling intervals are determined by the supervisor logging the stratigraphy.

Depth Measuring Procedure

A hole is started using two ten foot rods coupled together and a tri-cone bit at the advancing end of the rods. When the bit is resting on the ice and the hydraulic chuck is down, 13 feet of rods remain between the chuck and the water swivel. The chuck is released and raised to its maximum extent of 2 feet. The rod is advanced 2 feet at a time and 10 foot rods are added as needed. This continues till 5 feet of bedrock has been drilled.

Sample Collecting Procedure

A five gallon pail is placed under the cone into which the return water and sample are dumped by a hose. The returning sample is screened by both a 10 mesh and $\frac{1}{4}$ " wire mesh screens. The return is constantly examined to determine the nature of the return. Those normally encountered are organic, clay, varved clay, sandy clay, sand, gravel, basal-till, boulder, or bedrock.

As each horizon is reached the sample bucket is changed and the sample is either discarded if it is part of the varved layer or placed in heavy plastic bags for treatment in the laboratory. Sample interval is decided by the supervisor on the drill and is usually 5 to 10 feet unless there is a stratigraphic change.

Pleistocene Geology

The northeast bay of Night Hawk Lake in which these claims lie is characterized by a varved clay sequence directly overlying bedrock where it outcrops on surface. Only in one location is the lower or Fredrick House basal till evident (Leahy, 1971).

All overburden drill holes encountered clays immediately below the lake bottom debris. This clay was a medium grey green in color with significant patches of beige and is therefore considered to be a varved clay sequence. Thickness of this unit ranged from 2 to 71.1 feet.

Beneath the clay a sequence of sand, gravel and minor sandy clay units exist in the deepest hole (#DNH-17). The other holes all have the clay covering a layer of basal till or partially reworked basal till of 0.5 to 7.6 feet thick.

The bedrock surface is fairly shallow and even except near hole PNH-17 where the sudden increase in depth would indicate a significant break between this hole and PNH-16 and PNH-18.

Conclusions

The immediate sub-surface material is a clay deposited by glacial Lake Barlow-Ojibway. This is underlain in most places by a thin basal till layer of sufficient thickness to provide a good sample.

Bedrock Analyses

HOLE #	OUNCES PER TON AU.	TON Ag.	NI	PERCENT CU	ZN	Pb
PNH -16	TR	.04	.05	.003	.002	.001
-17	TR	.02	.04	.007	.002	.001
-18	TR	.03	.05	.003	.004	.002
-19	TR	.04	.07	.009	.005	.002
-20	TR	.04	.06	.005	.005	.002
-21	TR	.02	.009	.005	.001	TR

*ed Van Has per
Kian Afan*



42A165W1303 2.4721 CODY

900

1982 10 25

2.4721

**Pamour Porcupine Mines Limited
P.O. Bag 2010
Timmins, Ontario
P4W 7X7**

Attn: Mr. K. Jensen

Dear Sirs:

**RE: Data received on an overburden drilling
survey submitted on Mining Claims # 525989
et al in the Township of Cody**

**In order to complete your submission for the above
mentioned survey, we require copies of receipts or
cancelled cheques (in duplicate) to verify your
expenditures of \$3,981.25.**

**For further information, please contact Mr. F.W. Matthews
at 416-965-1380.**

Yours very truly

**E.F. Anderson
Director
Land Management Branch**

**Whitney Block, Room 6450
Queen's Park
Toronto, Ontario
M7A 1W3
Phone: 416/965-1380**

A. Barr:sc

**cc: Mining Recorder
Timmins, Ontario**

**Mining Recorder
Ministry of Natural Resources
60 Wilson Avenue
Timmins, Ontario
P4N 2S7**

2.4721

Dear Sir:

**We have received reports and maps for an Overbuden
Drilling Survey submitted under Special Provisions
(credit for Performance and Coverage) on Mining
Claims P 525989 et al in the Township of Cody.**

**This material will be examined and assessed and a
statement of assessment work credits will be issued.**

Yours very truly,

**E.F. Anderson
Director
Land Management Branch**

**Whitney Block, Room 6450
Queen's Park
Toronto, Ontario
M7A 1W3
Phone: 416/965-1316**

J. Skura/amc

**cc: Pamour Porcupine Mines, Limited
Timmins, Ontario**

**cc: Mr. E. Van Hees
Timmins, Ontario**

Pamour Porcupine Mines, Limited
Administration Building
P.O. Bag 2010
Timmins, Ontario, Canada P4N 7X7

pamour

April 20, 1982

From
Mr. E. F. Anderson,
Director,
Land Management Branch,
Whitney Block, Room 6450,
Queen's Park,
TORONTO, Ontario.
M7A 1W3

Re: Overburden Drilling on Mining Claims P.525989 and
P.525990, Cody Township, Porcupine Mining Division,
District of Cochrane, Ontario.

Dear Mr. Anderson:

Please find enclosed two copies of the overburden report
and maps for the above claims.

Since Mr. Ed van Hees, the supervisor for this project,
is on holidays, I have signed the reports and accompanying
maps. Hoping this is satisfactory.

Yours truly,

Kian A. Jensen

KAJ/kg
Enclosure

Kian A. Jensen, B.Sc.,
Exploration Geophysicist-
Geologist.

RECEIVED

APR 26 1982

MINING LANDS SECTION



Mining Lands Comments

To: Geophysics

Comments		
<input type="checkbox"/> Approved	<input type="checkbox"/> Wish to see again with corrections	Date
		Signature

To: Geology - Expenditures *Mr. Kustra*

Comments		
<i>receipts required</i>		
<input checked="" type="checkbox"/> Approved	<input type="checkbox"/> Wish to see again with corrections	Date
		<i>Oct 19/82</i>
		Signature
		<i>Kustra</i>

To: Geochemistry

Comments		
<i>(D)</i>		
<input type="checkbox"/> Approved	<input type="checkbox"/> Wish to see again with corrections	Date
		Signature

DLEY
 J.S.
 M.F.E.D.

CONTRACT DIAMOND DRILLING

Poplar Porcupine Mines Limited
 Administration Building
 P.O. Bag 2010,
 Chelms, Ontario
 P3R 7X7.

HOLE NO.	TO COVER DIAMOND DRILLING FOR		March 1 to 9, 1982		FOOTAGE COMPLETED	
	FROM	TO				
	Down the hole consumables:					
			5 Tricone bits @ \$725.00	-	\$3625.00	
			1 Adapter	570.00	-	570.00
					<u>\$4195.00</u>	
			Plus 15%		<u>629.25</u>	\$4,824.25
	Demobilization:					
			30 miles	@	\$5.00	150 00
			2 Tyler screen	@	106.15	212 30
			1 Scoop			10 05
			700 sample bags	@	=.25	175 00
						<u>\$25,347 60</u>

Only part of this applies to
 work on clo 585989+90
 \$4928.70

March 15, 1982

REFERENCE MEMORANDUM

Date Mar. 29, 1982

The attached are referred

TO: Ed
 BY: Dino Martin

Please reply direct _____ Please handle _____

Please see me re. this _____ Your comments _____

For your information _____ For approval

For signature _____ Please return

CONTRACT DIAMOND DRILLING

Limited

27

1 to 9, - 1982

FOOTAGE COMPLETED

DN-32-1
 2
 3
 4
 5
 6
 7
 8
 9
 10
 11
 12
 13
 14
 15
 16
 17
 18
 19
 20
 21
 22
 23
 24
 25
 26

0'
 0'
 0'
 0'
 0'
 0'
 0'
 0'
 0'
 0'
 0'
 0'
 0'
 0'
 0'
 0'
 0'
 0'
 0'
 0'
 0'
 0'
 0'
 0'
 0'
 0'
 0'

155'
 159'
 210'
 173'
 200'
 36'
 39'
 30'
 123'
 110'
 20'
 80'
 64'
 32'
 83'
 35'
 105'
 09'
 13'
 33'
 41'
 29'
 47'
 52'
 18'
 29'

153'
 159'
 210'
 173'
 200'
 36'
 39'
 30'
 123'
 110'
 20'
 80'
 64'
 32'
 83'
 35'
 105'
 09'
 13'
 33'
 41'
 29'
 47'
 52'
 18'
 29'

525987

525990

72.15' / hole

1876'

Equipment rental:
 90 hours

e \$218.00 \$19,620 00

Breakdown:
 2 hours

e 173.00 356 00

FORWARD

\$ 13.51 / foot

2.4721

PAMOUR

Pamour Porcupine Mines, Limited
P.O. Bag 2010
Timmins, Ontario, Canada P4N 7X7

0046054

DATE
30 04 1982

AMOUNT
\$ ***25,347.60

BRADLEY MANUFACTURING LTD
98-14TH STREET BX 367
MORANDA QUEBEC
J9X 5A9

TO
BANK OF NEW SCOTIA
TIMMINS, ONT.

[Handwritten Signature]

PAMOUR PORCUPINE MINES, LIMITED

[Handwritten Signature]
AUTHORIZED SIGNATURE

⑆ 11072-0000 0040-13⑆

⑆0002534760⑆

Bradley W. M. Manufacturing Co.

FOR DEPOSIT ONLY
TO THE CREDIT OF
BRADLEY BROS. MANUFACTURING CO.

177
174
100010710

MAY 1 1982

100010710
18.82
COMMERCIAL
COMMERCE
21

MATHESON TWP. M.297

THE TOWNSHIP OF

CODY

DISTRICT OF COCHRANE

PORCUPINE MINING DIVISION

SCALE: 1-INCH 40 CHAINS

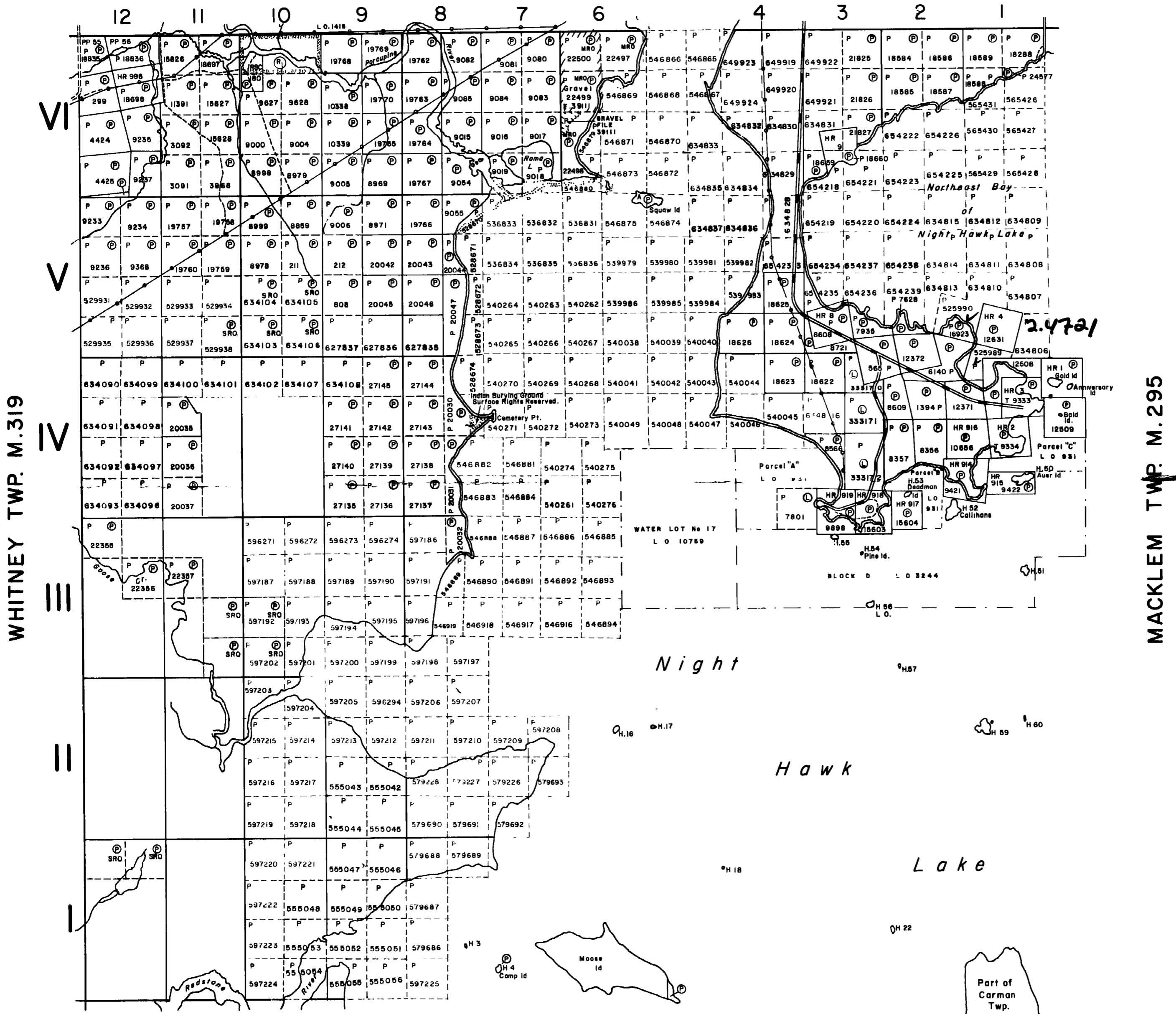

LEGEND

- PATENTED LAND (P)
- CROWN LAND SAIE (C.S.)
- LEASES (L)
- LOCATED LAND (Loc.)
- LICENSE OF OCCUPATION (L.O.)
- MINING RIGHTS ONLY (M.R.O.)
- SURFACE RIGHTS ONLY (S.R.O.)
- ROADS
- IMPROVED ROADS
- KING'S HIGHWAYS
- RAILWAYS
- POWER LINES
- MARSH OR MUSKEG
- MINES
- CANCELLED

NOTES

400' surface rights reservation along the shores of all lakes and rivers.

The whole of Moose Island is attached to the Township of Cody. File 23642.

This Township lies within the Municipality of The City of Timmins

Reserve flooding rights to Ont Hydro to elevation 903.5' T & N O Railway datum on Night Hawk Lake and that portion of the river between Night Hawk Lake and Frederick House Lake

Areas withdrawn from staking under Section 43 of the Mining Act (R.S.O. 1970).

C.L. No.	File	Date	Disposition
W 53/76	16539	10/9/76	SRO

DATE OF ISSUE
DEC 20 1982
Ministry of Natural Resources
TORONTO

PLAN NO. M.270

ONTARIO
MINISTRY OF NATURAL RESOURCES
SURVEYS AND MAPPING BRANCH

CARMAN TWP. M.266



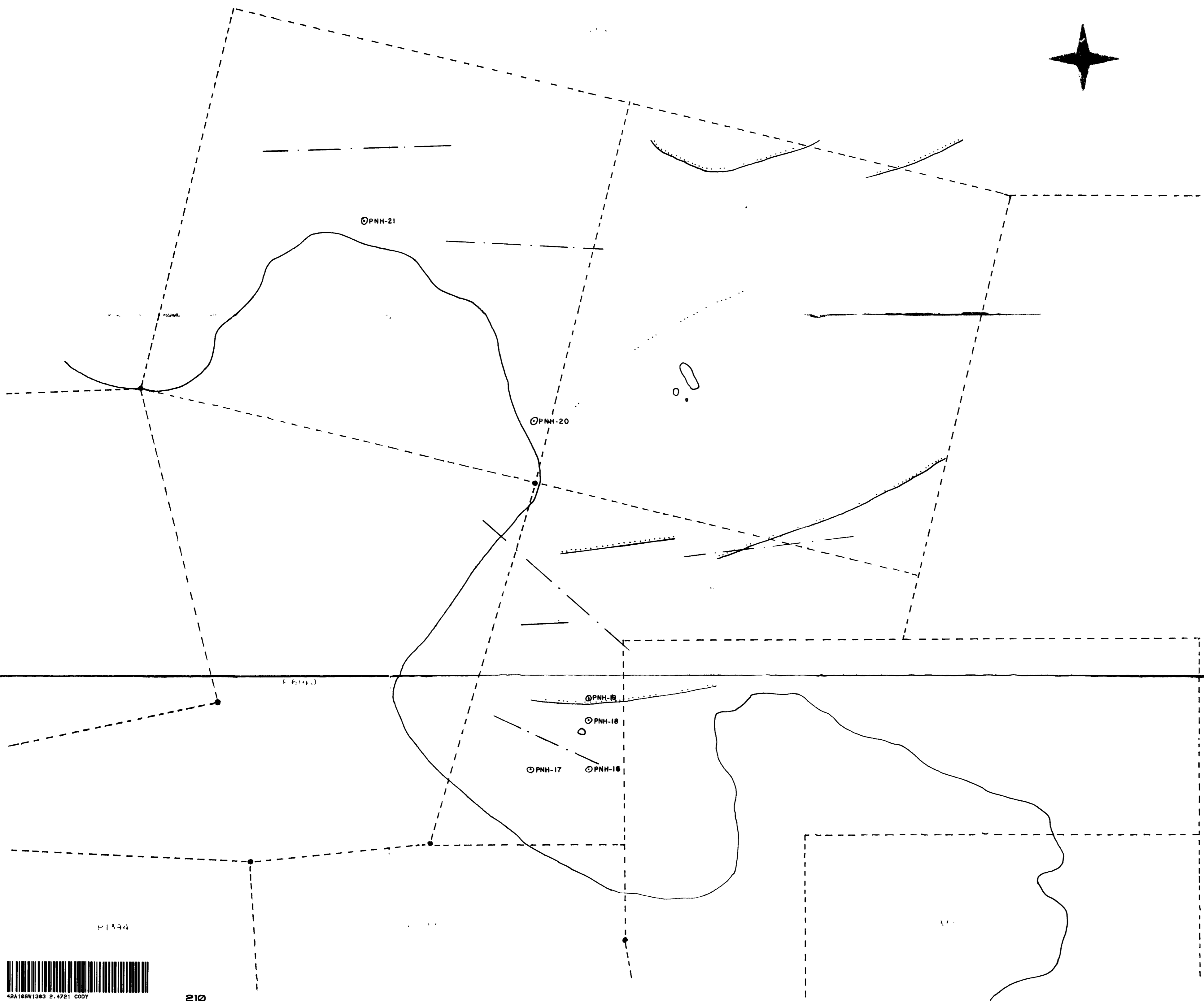

——— AXIS OF MAGNETIC HIGH
 - - - - - AXIS OF MAGNETIC LOW
 - - - - - AXIS OF VLF ANOMALY
 ○ PNH-16 OVERBURDEN DRILLHOLE

PAMOUR EXPLORATION

NIGHTHAWK LAKE-KARPOVICH DEPOSIT

CLAIM NUMBERS: P. 525989 - 525990

COUNTY OF TOWN OF
 FOR OPINE MINING

OVERBURDEN DRILLING

DRAWN BY: K.A.J.
 DATE: DEC 15, 1981

APPROVED BY:
 DATE:

Ed Van Hoo per K.A.J.
April 19/82



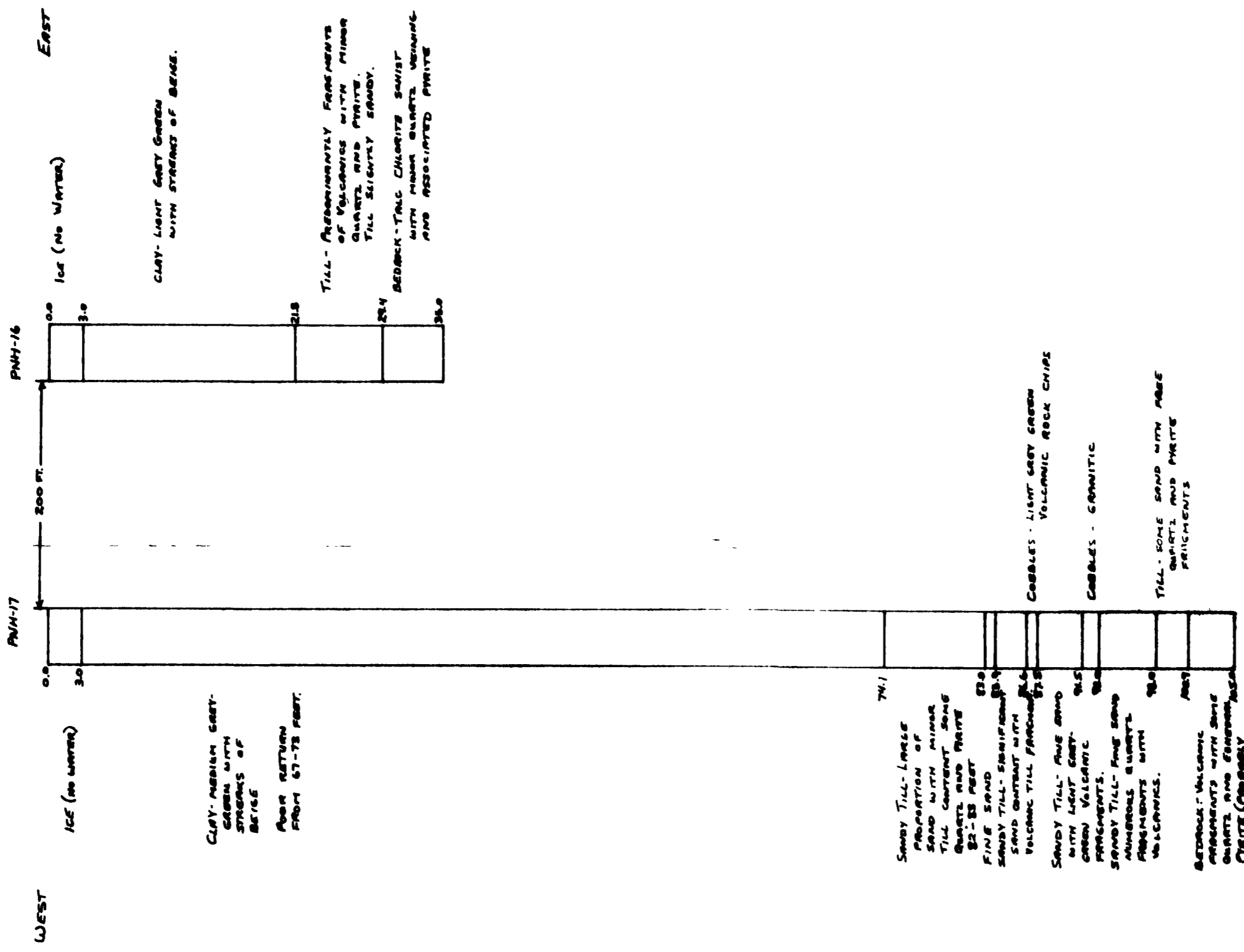

REVISIONS	No.	MADE BY	CK. BY	DATE	DESCRIPTION	DRAWN BY	DATE
1						K. JENSEN	APRIL 19/82
2						TRACED BY	
3						CHECKED BY	
4						O K.	
						APPROVED	

PAMOUR PORCUPINE MINES LIMITED		PAMOUR, ONTARIO
KARPOVICH OPTION - NIGHT HAWK LAKE - CODY TWP.		SCALE - 1/4" = 100 FT
OVERBURDEN DRILLING HOLES PNH-16 AND PNH-17		D-

Ed van der Meer per Ken Jensen
 April 19/82



42A105W1303 2 4721 CODY

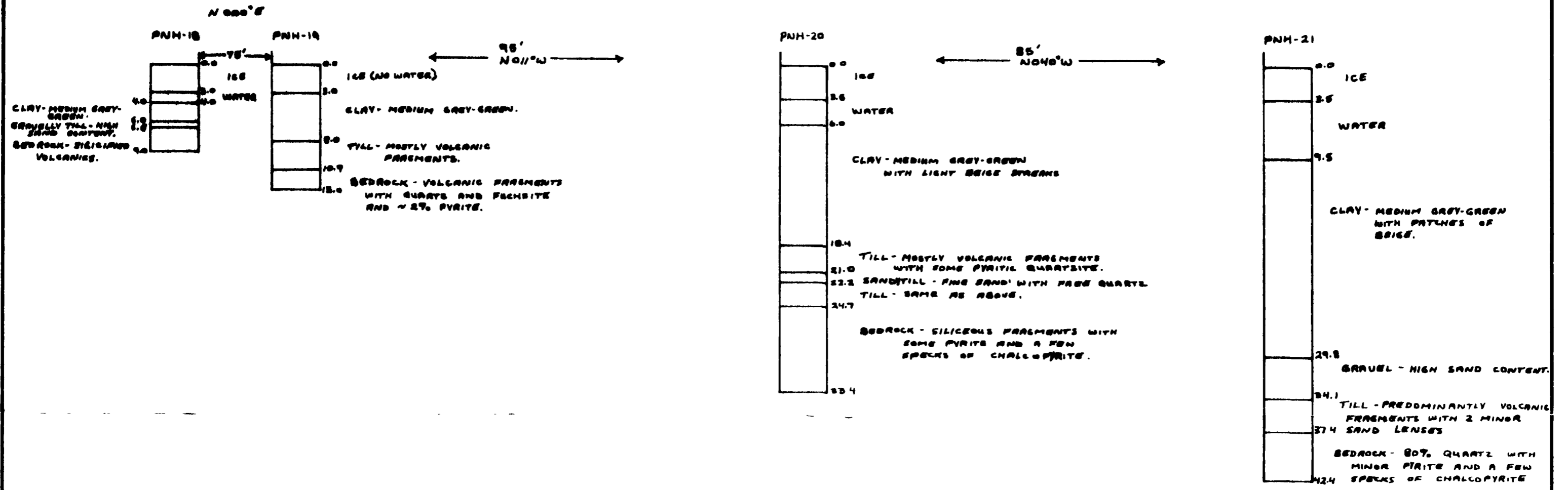

REVISIONS	No	MADE BY	CHK. BY	DATE	DESCRIPTION	DRAWN BY <i>K. Jensen</i>	APRIL 19/82	PAMOUR PORCUPINE MINES LIMITED PAMOUR, ONTARIO	
	1					TRACED BY		KARPOVICH OPTION - NIGHT HAWK LAKE - CODY TWP.	
	2					CHECKED BY		SCALE - 1 INCH = 10.0 FEET	
	3					O. K.		OVERBURDEN DRILLING - HOLES PNH-18, 19, 20, 21	
4					APPROVED				

Elvan Hoo
April 19/82

