



42A11NE0005 63.5378 CARNEGIE

010

INTEX Mining Company Limited  
Whidden Road  
Carnegie, Prosser and Tully Townships  
Porcupine Mining Division of Ontario

Introduction

The company intends to mine two separate ore zones on their property in Tully Township, Ontario.

An all weather gravel road which was started in 1988 for service and ore transportation is in its final stages of construction.

The road right of way with a width of 100 feet is cleared. Most of the culverts are installed, most of the ditching is completed and the swamp areas are completed with sand base ready for gravel topping.

A total of 11 culverts are installed to date.

One six foot culvert is installed in Prosser Creek and two six foot culverts are installed in the West Branch of the Buskegau River.

The first 5.58 km of the road is totally operational.

Total length of the road is 12.6 km from the roadhead to the west end of the Texmont ore zone. The road might have to be extended east to the Frankfield Zone an additional distance of 1 km or so.

Location

The road heads off Hwy 655 in Carnegie Township at a point 33.4 km north of the junction of Hwy's 655 and 101 in Timmins. The road trends easterly across Prosser Township and into Tully Township to the west ore zone (Texmont Zone).

At 3.55 km the road crosses a power transmission tower line and service road. At 5.80 km the road crosses Prosser Creek with a 6 foot culvert.

At 10.8 km the road crosses the west branch of the Buskegau River with two 6 foot culverts.

## Type of Construction

The road right of way is cleared of all vegetation cut fairly flush to ground level. This leaves the stump and root mat undisturbed.

In areas of thin organics ( less than 2 feet ) the clay removed in ditching is piled on top of the stump - root mat to a depth of 2 to 3 feet, allowed to dry, graded and surfaced with 2-3 feet of sand and topped with 8" to 12" pit run gravel.

In areas of deeper muskeg the cut trees are laid down tight together, butts out at right angles to the road to form a "brush mat".

Ditched clay is laid on top of the brush mat to a depth of 2 to 3 feet followed by 2 to 3 feet of sand and topped with 8" to 12" pit run gravel.

In two areas of deep muskeg ( up to 12 feet deep ) a film of Geo Textile Fabric was laid on top of the brush mat on a 1200 foot stretch and a 600 foot stretch of road. The fabric film was covered with 3 feet of sand 2 feet of pit run gravel one foot of sand and one foot of gravel.

The Prosser Creek 6 foot culvert was laid on a thin sand base on top of the creek bed clay followed by 5 feet of sand. A log crib was installed to retain the sand fill. The road is topped by 12" of gravel.

The Buskegau River 6 foot culverts were placed 7 feet apart on a layer of sand on top of the clay creek bottom, the sides and space between the culverts were filled with sand and covered to a depth of 5 feet and topped with 12" of gravel. A log crib was installed to retain the sand fill.

Respectfully Submitted,

*C. F. Desson*

C.F. Desson P. Eng.

Figure "A" Road location plan showing the power line and service road, Prosser Creek, the West Branch of the Buskegau River and the two ore zones.

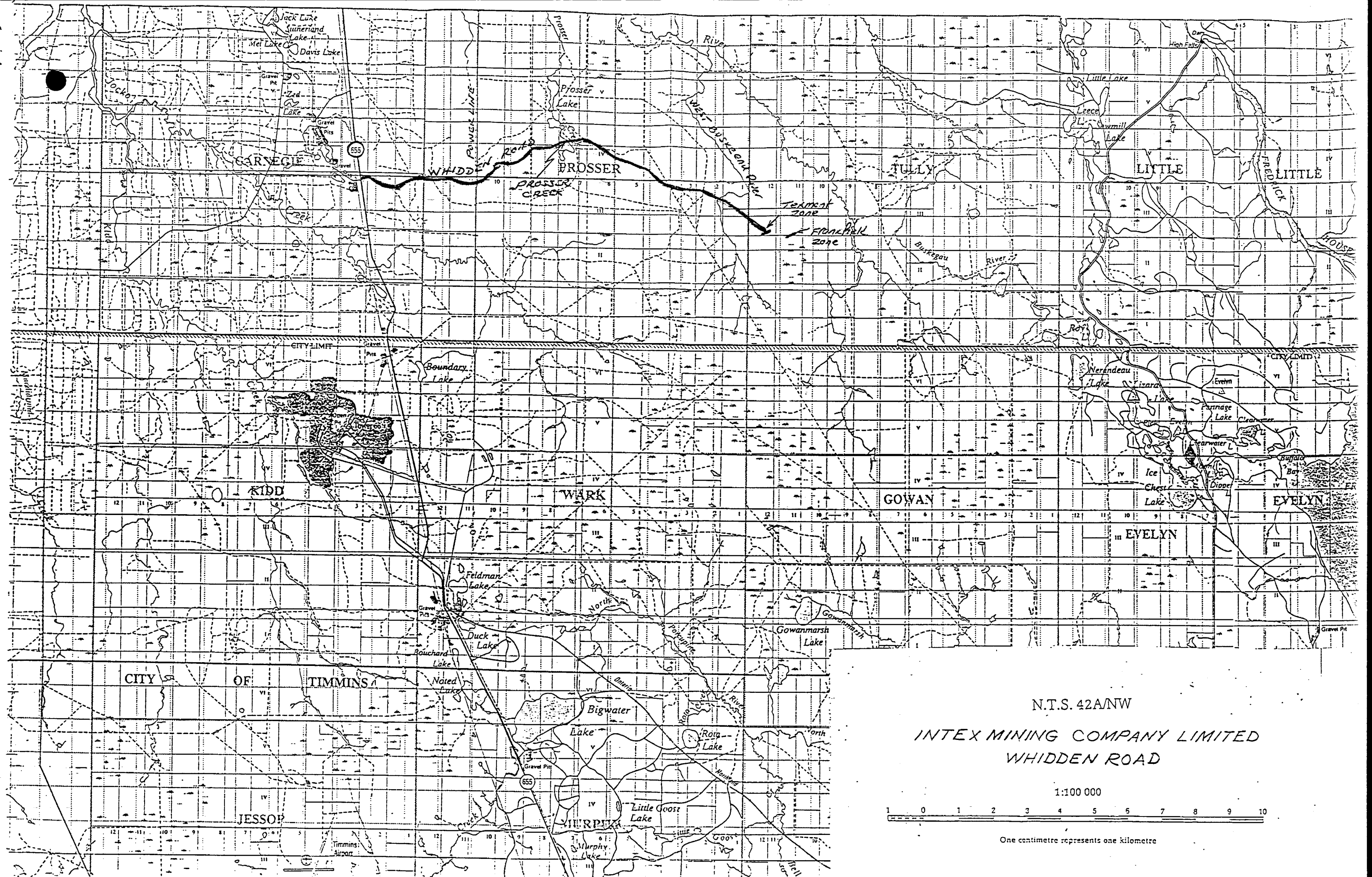

N.T.S. 42ANW

INTEX MINING COMPANY LIMITED  
WHIDDEN ROAD

1:100 000



One centimetre represents one kilometre