

0 ME 1281-5 E-77

63-4099

INTEX MINING COMPANY LIMITED

TELEPHONE 363-4477
363-3933



42A11NE0015 63.4099 TULLY

010

SUITE 1500
4 KING STREET WEST
TORONTO, ONTARIO
M5H 1B6

INTEX MINING COMPANY LIMITED

FRANKFIELD EXPLORATIONS LIMITED

Stripping, Bulldozing, Rock Trenching
and Sampling Programme - 1981

Tully Township Property

PORCUPINE MINING DIVISION, ONTARIO

In 1981, a programme of geophysics, diamond drilling, stripping, bulldozing, washing, rock trenching and sampling was conducted over the Tully Township property by Intex Mining Company Limited.

The 22-claim group is located in Tully Township, approximately 25 miles north-northeast of Timmins and is comprised of the following claims: 97938 to 97949 inclusive; 99286 to 99289 inclusive; and 100437 to 100442 inclusive.

The group was staked originally to cover a series of airborne electromagnetic anomalies associated with a band of volcanic flows and tuffs (ranging from rhyolite, andesite and basalt to ultramafics) which extend from the vicinity of the Kidd Creek copper deposit through Prosser Township and into Tully Township.

Originally, the group was staked as a base-metal prospect; but subsequently, diamond drilling of the electromagnetic conductors outlined three gold deposits: the Texmont and Frankfield zones on the Intex property, and a similar deposit on the Nickel Offsets property which adjoins to the south.

... continued ...

All three deposits are associated with graphitic sediments, basaltic and andesitic flows, in close proximity to ultramafic flows (serpentinite, peridotite) and are located within tuffaceous andesite horizons which host the veins. The veining is associated with a competent, brittle tuffaceous horizon which contacts an incompetent serpentinite. This association is indicated to be through-going as to strike and depth continuity; and further occurrence of gold values could be reasonably expected along strike and at depth anywhere along the zone.

The gold concentrations appear to be localized by north-south faulting; and a south-trending fault in southwest Tully Township may genetically relate these deposits to the Pamour gold producing area 15 miles to the south.

Each of the deposits was discovered as a result of drilling a conductive zone. Heavily disseminated pyrite and arsenopyrite, along with graphitic horizons, account for the conductors.

HISTORY

In 1968-9, Intex Mining Company Limited outlined by diamond drilling, a gold deposit 500 feet long and 10 feet wide, averaging 0.22 ozs. gold per ton (the Texmont Zone).

Subsequently, McIntyre Porcupine Mines outlined a deposit of 835,000 tons on the Nickel Offsets property, one mile to the south. Overburden, in excess of 100 feet on the McIntyre property, apparently deterred underground exploration of their deposit.

Diamond drilling what appeared to be the faulted extension of the Texmont Zone conductor, during 1974-5-6, Intex and Frankfield outlined the Frankfield Zone, 4,000 feet east of the Texmont Zone.

... continued ...

Along a 600-foot length, the Frankfield Zone averaged 0.23 ozs. gold per ton over an average core width of 15.5 feet. Significant gold values (0.15 ozs. gold per ton) were intersected on the conductor 600 feet east of the zone outlined by drilling. Overburden on the Frankfield Zone averaged 45 feet.

BULLDOZING, TRENCHING AND STRIPPING PROGRAMME

During the period March to July 198¹/₂, sixteen holes (4,708 feet) were diamond drilled on the Tully Township property.

On claims P-97940 and P-97941, holes 81H-3, 81H-4, 81H-5, 81H-7 and 81H-8, were bored to check the upward extension of the Texmont Zone indicated by previous diamond drill programmes. 81H-3 intersected 4 sections with values ranging from 0.22 to 0.39 ozs. gold per ton over 5 foot widths. 81H-4 had 4 intersections ranging from 0.12 ozs. gold per ton over 4 feet to 0.25 ozs. gold per ton over 7 feet.

81H-5 intersected 0.09 ozs. gold per ton over 5 feet, and 0.13 ozs. gold per ton over 6 feet.

81H-7 had 0.07 ozs. gold per ton over 6 feet; and 81H-8 had 0.12 ozs. gold per ton over 7 feet.

Diamond drilling on this Texmont Zone has indicated 114,000 tons averaging 0.22 ozs. gold per ton across 10.0 feet, along a strike length of 500 feet.

In order to investigate the surface expression of this deposit, a programme of stripping, bulldozing, rock trenching, washing and sampling was conducted in an area straddling the mutual boundary of claims P-97940 and P-97941.

... continued ...

The stripping and bulldozing was carried out by Super City Contracting of Timmins, Ontario, under the direction of Mr. Rene Lapointe. The mapping, rock-trenching and sampling was conducted by Intex employees, Philippe Roby and Paul Perreault both of Senneterre, Quebec, and by Michael Pelangio of South Porcupine, Ontario.

Initially, in stripping to an average depth of 12 feet, the contractor employed a CAT225 backhoe and a CATD7 bulldozer. An M7 Bombardier was used for daily access to the site.

When it was discovered that the overburden exceeded the estimated maximum of 15 feet and at one point reached a depth of 34 feet, a "wide pad" D6 Caterpillar and a 921 Liebherr backhoe were used to perform the work.

The initial work was conducted during October, 1981, with the deeper excavations completed during the period November 16th to December 22nd, 1981.

The east-west extent of the trench is approximately 480 feet and the width (north-south) varies from 130 to 180 feet.

Four rock trenches, Nos. 1, 2, 3 and 4, were blasted and sampled. Trenches 5 and 6 were bulldozed, and were also sampled.

The outcrop exposed by the stripping was, for the most part agglomeratic andesite. A narrow band of sheared tuff, 5-15 feet wide, traverses the south sector of the trench in an east-west direction. The values in 81H-3 are in quartz veins within this tuff horizon.

In all, 27 samples were taken; and significant values were obtained in only trenches 2 and 6, as follow:

... continued ...

<u>Trench</u>	<u>Width (feet)</u>	<u>Ozs. Gold per ton</u>
2	3	0.24
	4	0.26
	4	0.30
	grab	0.26
6	5	0.04
	4	0.08

The values in Trench 2 correspond to the drill hole intersections in hole 81H-3.

No surface expression of the values in hole 81H-4 could be identified in the stripped area.

Further rock trenching and sampling is recommended in this area.

CONCLUSIONS:

The stripping and trenching exposed the upward extension of the Texmont Zone intersected in hole 81H-3.

The north lens of the Texmont Zone as indicated in drill hole 81H-4 has not been identified on surface to date; and its upward extension should be outlined by a number of short holes bored with a light drill (e.g. Winkie drill). Further rock trenching in this sector is warranted.

Respectfully submitted,
INTEX MINING COMPANY LIMITED

H. A. Pearson

H. A. Pearson, P.Eng



HAP/mmj
November 1982

PROSSER Tp. M. 571

P 576722	P 576719	P 501085	P 501088	P 539245	P 501092	P 101258	P 101259	P 101260	P 101951	P 101950	P 299633
P 576721	P 576720	P 501086	P 501087	P 501091	P 452508	P 452507	P 101262	P 101261	P 101952		P 299638
P 576980	P 922205	P 501051	P 501054	<i>Regau</i>				P 452506	P 452503	P 255751	P 102012
P 566529	P 566528	P 501052	P 501053	<i>Patented</i>				P 452505	P 452504	P 102014	P 102013
P 508390	P 508389	<i>460 TI</i>		<i>Patented</i>		P 501058	P 501061	P 501063	P 52603	P 62608	P 62605
P 97938	P 97939	P 508395	P 508398	P 508399	P 508401	P 501057	P 501060	P 501064	P 62609		
P 97941	P 97940	P 508396	P 508397	P 508400	P 508402	P 501059	P 501059	P 501065	P 62610		
P 97942	P 99286	P 99289	P 100440	P 100441	P 100442	P 512687	P 512690	P 512691	P 512694	P 522477	P 522267
P 97943	P 99287	P 99288	P 100437	P 100438	P 100439	P 512688	P 512689	P 512692	P 512693	P 522468	P 522467
P 97944	P 97947	P 97948	P 97949	P 01372	P 101373			P 522455	P 522456	P 522457	P 522458
P 97945	P 97946	P 57464	P 57463	P 101375	P 101374			P 522454	P 522453	P 522452	P 522451
		P 57468	P 57467	P 57476	P 57475			P 522435	P 522436		
		P 57486	P 57485	P 57473	P 57474			P 522434	P 522433		
P 97874	P 97875	P 57479	P 57480	P 57471	P 57472	P 522409	P 522410	P 522411	P 522412	P 522413	P 522414
P 97876	P 97877	P 97878	P 97879	P 102250	P 102251	P 522408	P 522407	P 522406	P 522405	P 522404	P 522403

12

11

10

9

8

7

TULLY TWP

GOWAN T

© M.E.P. 815-C-77

Handwritten signature

97938		97939			
97941		97940		EXCAVATION	
CONC. 3					
97942	99286	99289	100440	100441	100442
97943	99287	99288	100437	100438	100439
TWE LINE PROSER				SCALE: 1" = 1/4 MILE	
97944	97947	97948	97949	TULLY TWP CLAIM PLAN	
CONC. 2					
97945	97946				

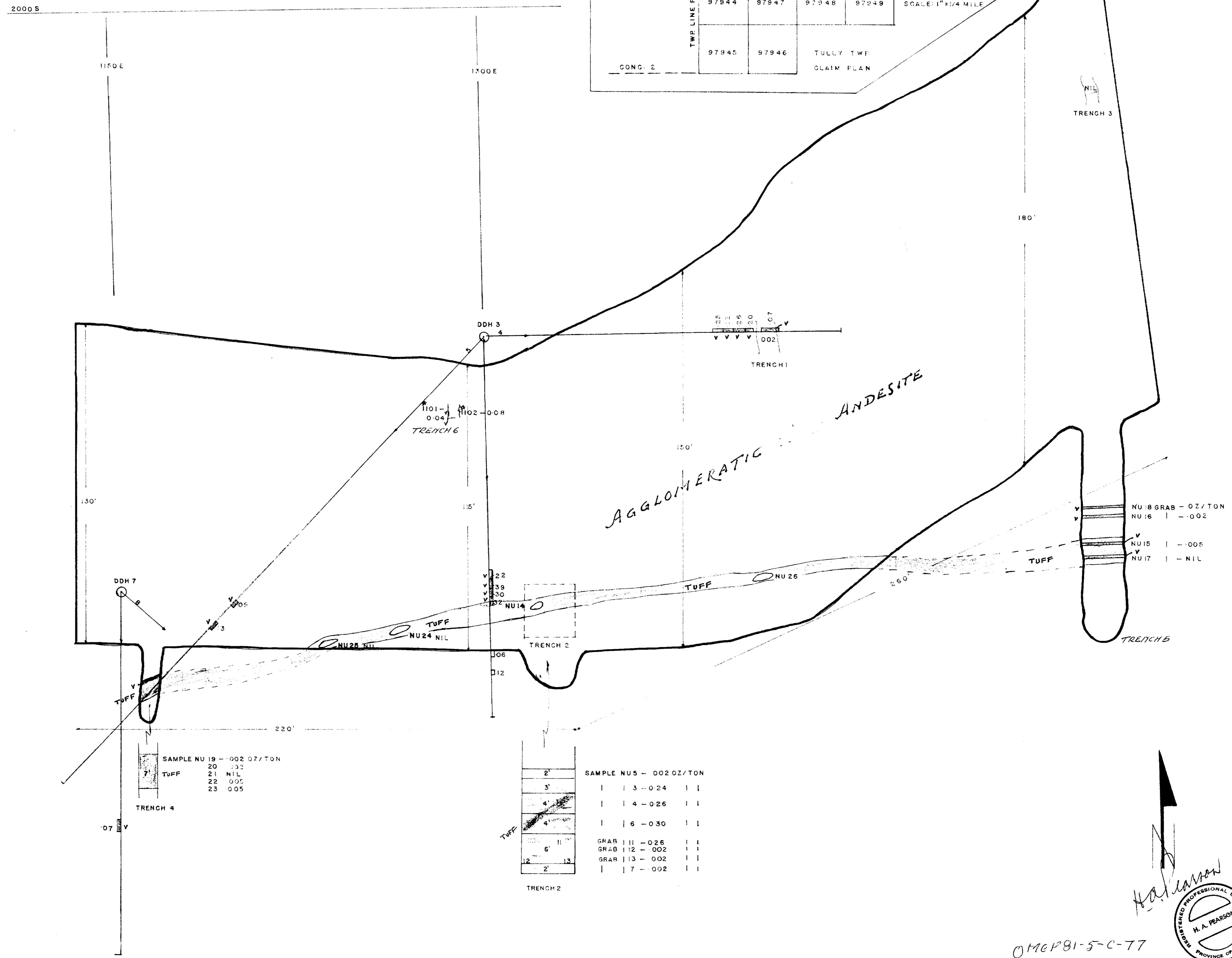

VEIN

SCHISTED TUFF

PLAN OF EXCAVATION
TUXMONT ZONE

H. A. Pearson
REGISTERED PROFESSIONAL ENGINEER
H. A. PEARSON
PROVINCE OF ONTARIO

0MCP81-5-C-77

INTEX MINING LTD.
TULLY - T.W.P. 63-4099

SAMPLE PROGRAM
SCALE: 1" = 20'
DATE: OCT. 1981