

Diamond Drill Record

BATTLE MOUNTAIN CANADA LTD.

Property: Arvo Salo-Evelyn	Grid	Survey
Project No:	east 0+00	depth
Hole No: E-1-97	north 0+00	azim.
Length: 524.5m	UTM E	inclin.
Overburden: 110.0m	UTM N	
Core Size: BQ	azim. 180	
Township Evelyn	incli. -55	
Drill Company: Turbo Drilling	elev.	
Date Started: Sept. 21, 1997	grid az.	
Completed: Sept. 30, 1997	claim #. P121331 EVELYN	
Logged By: J. Londry, B. MacLachlan	Lot #. Lot 8 Con 6	
Date Logged: October 02, 1997	1213358 MATHESON	
Core Storage: Finn Rd.-MacIntosh Springs		
Signature: <i>J. Londry</i>		

From	To	Rock Type	Description
0.0	110.0		Overburden
110.0	524.5	Greywacke	Grey in color, fine to medium grained, minor quartz-calcite veinlets and stringers, fragments locally.
			110.0-122.6: Weathered greywacke, light colored weakly fractured
			215.0-216.0: Glossy white quartz vein contact at 45 degrees to c.a.
			269.3-271.2: Narrow pyrite stringer 1mm in width at 90 degrees to c.a.
			300.4-302.3: 40% quartz veining, trace pyrite contact at 45 degrees to c.a.
			370.2-377.7: 20% vuggy quartz veining, glossy white-yellow quartz, trace pyrite.
			390.4-391.7: Numerous quartz-calcite stringers at 70 degrees to c.a.
			404.0-406.1: Quartz vein, glassy white, contact at 20 degrees to c.a.
			465.5-466.3: Quartz vein, glassy white, 0 degrees to c.a.
			470.5-485.4: Numerous fragments up to 2cm in size. Cherty appearance.
			472.2-496.6: Alteration zone, 30-40% quartz veining, trace to 1% pyrite, sericitic, weakly sheared.
			520.4-521.0: Glassy white-grey quartz vein.

010



42A11NE0096 2.17926 EVELYN

Pg \_\_\_\_\_

2.17926

**RECEIVED**  
OCT 07 1997  
GEOSCIENCE ASSESSMENT  
OFFICE

**Diamond Drill Record**

**BATTLE MOUNTAIN CANADA LTD.**

			Bedding angles to the core axis:  246.0' - 60 degrees  474.8' - 70 degrees  Graded bedding:  408.8' to top of hole  438.1' to top of hole.
524.5			END OF HOLE
			The core was provided by Mr. Arvo Salo. The loggers did not visit the drill site.
			Location: 165 feet west, 145 feet north.

Z<sub>0</sub>

S  
180°

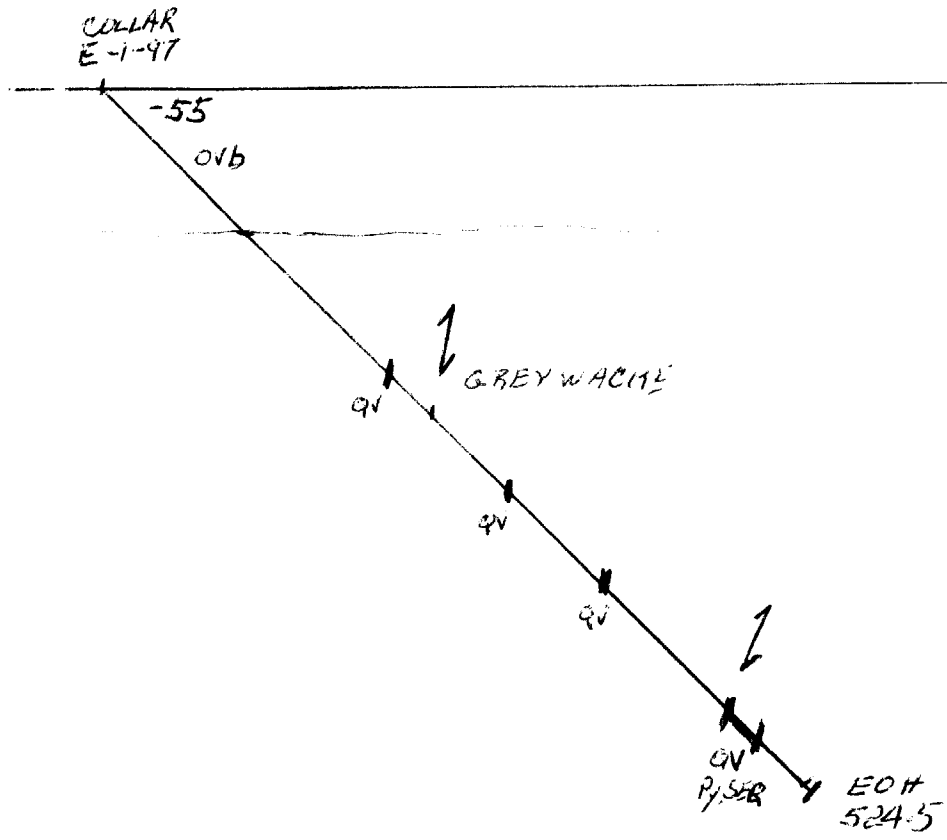

OVB - OVER BURDEN  
 QV - QUARTZ VEINING  
 Py - PYRITE  
 SER - SERICITE

SCALE 1" = 100'

E-1-97  
 DRILL HOLE SECTION  
 FIELY N TOWNSHIP  
 LOT 8, CONC. 6  
 SEPT. 21-30, 1997

*[Handwritten Signature]*

RECEIVED  
 OCT 17 1997  
 REGIONAL CLASSIFICATION OFFICE

SALO <sup>DRILL HOLE</sup> MATHESON-EVELYN PROPERTY

AZ - 180°

DIP - 55°

TOTAL LENGTH - 525'

BQ CORE

CLAIM - P-1213331 (8 units)

DRILLING DATES - 9-21-97 - 9-30-97 (INCL)

CORE STORED AT  
BATTLE MOUNTAIN GOLD  
60 SHIRLEY ST  
TIMMINS, ONT

DDH E-1-97

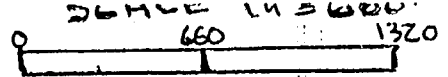

*Salo*  
10-1-97

CLAIM - P-1213331 (8 units)

CONC.

RECEIVED  
OCT 07 1997  
GEOSCIENCE ASSESSMENT  
OFFICE

PATENT

OLD CLAIM POSTS:  
POST 3 - P. 624600  
POST 2 - P. 624601

E-1-97

EVELYN TWP  
MATHESON TWP

165'

LOT-9

LOT 8

CL-P-1213358  
(2 units)

PATENT

LOT 7  
CL-P-1213357  
(2 units)

CONC.

CLAIM

P-1220040

CREEK

Pump

CREEK

# DRILL HOLE SECTION

A. SALO

LOOKING NORTH

DDH - E - 1 - 97

A2 - 1800

DIP - -55°

BQ CORE - P624000

POST 3 - P624601  
POST 2 - P624601  
OLD POSTS

EVELYN  
TWP  
MATHESON  
TWP

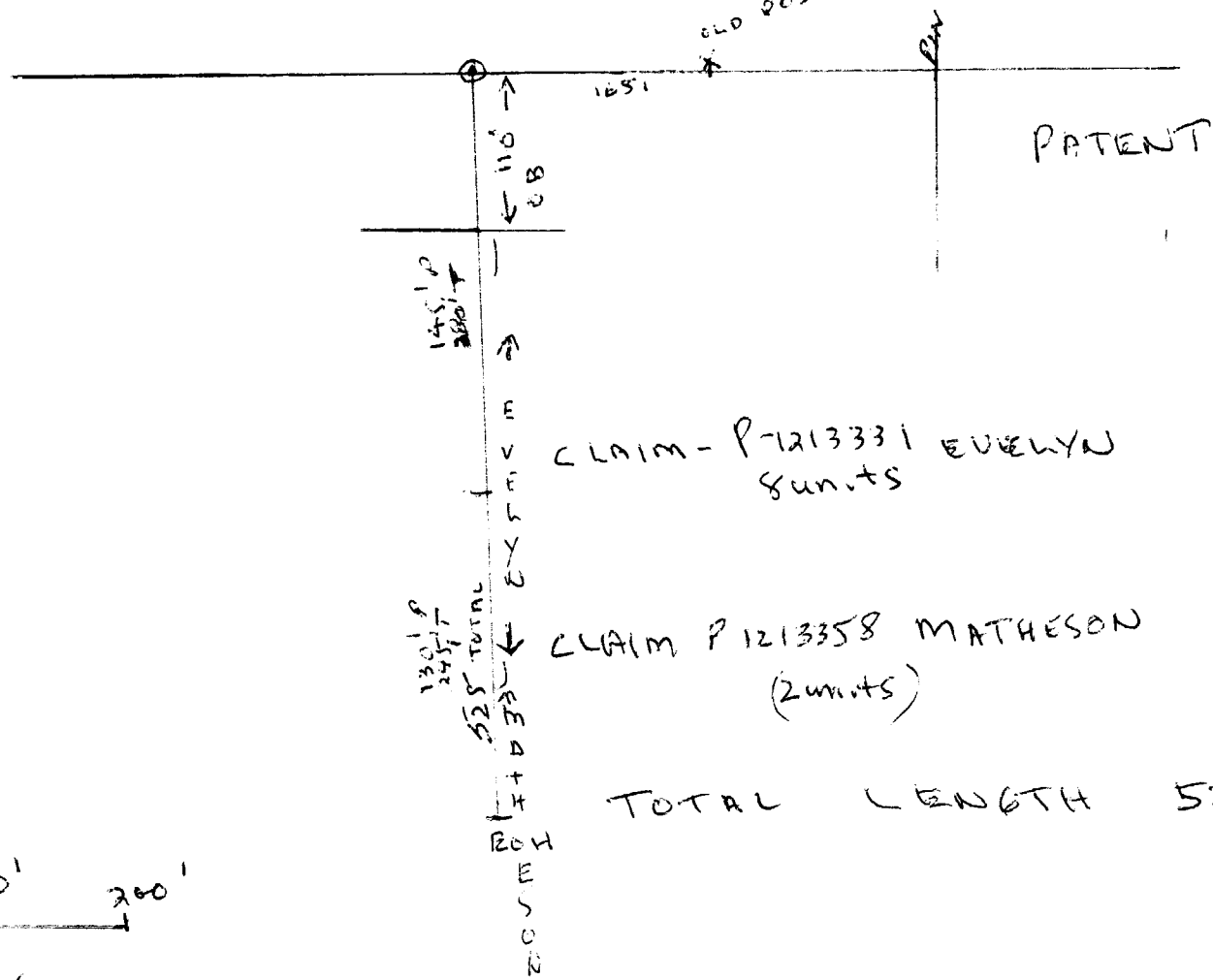

**RECEIVED**  
 OCT 07 1997  
 GEOSCIENCE ASSESSMENT  
 OFFICE

CLAIM - P-1213331 EVELYN  
8 units

CLAIM P1213358 MATHESON  
(2 units)

TOTAL LENGTH 525'

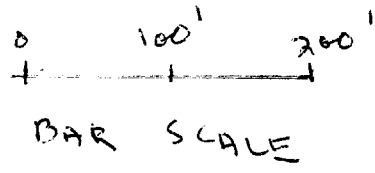

2. 12926

GOWAN TWP

A. SALO - DDH E-1-97  
CONTIGUOUS CLAIMS

HOYLE TWP

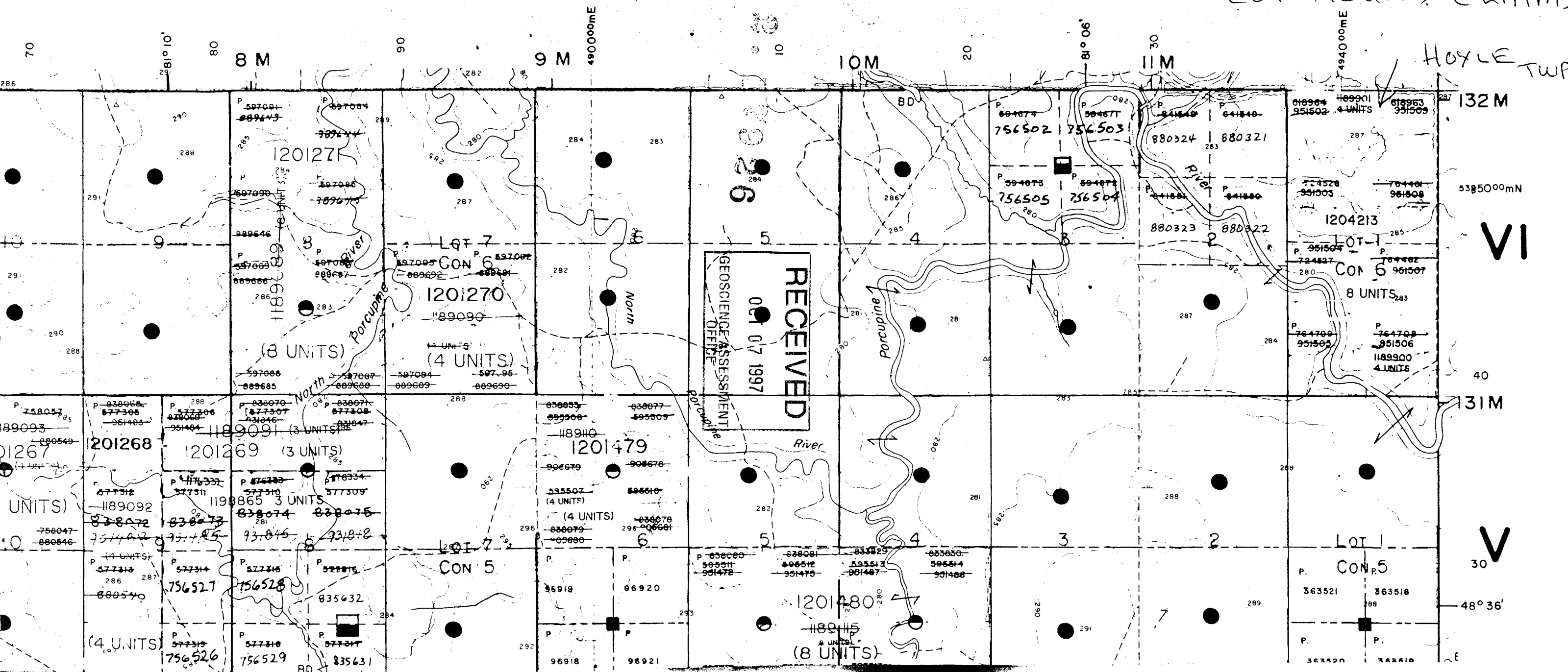

RECEIVED  
01/07/1997  
GEOSCIENCE ASSESSMENT  
OFFICE

VI

V

70 80 90 100 110 120 130 M

286 287 288 289 290 291 292

8 M 9 M 10 M 11 M 12 M

120127 (8 UNITS)

1201270 (4 UNITS)

1201268 (4 UNITS)

1201269 (3 UNITS)

1201479 (4 UNITS)

1201480 (8 UNITS)

1204213 (8 UNITS)

LOT 7 CON 6

LOT 7 CON 5

LOT 1 CON 6

LOT 1 CON 5

Porcupine River

North

BD

48° 36'

5385000mN

490000mE

194000mE

MATHESSON

TOWNSHIP

FORGIVEN MINING DIVISION

AUG 07 1937

A. SALO - DDH - E - 1 - 97  
CONTIGUOUS CLAIMS EVELYN TWP.  
MATHESSON TWP E - 1 - 97

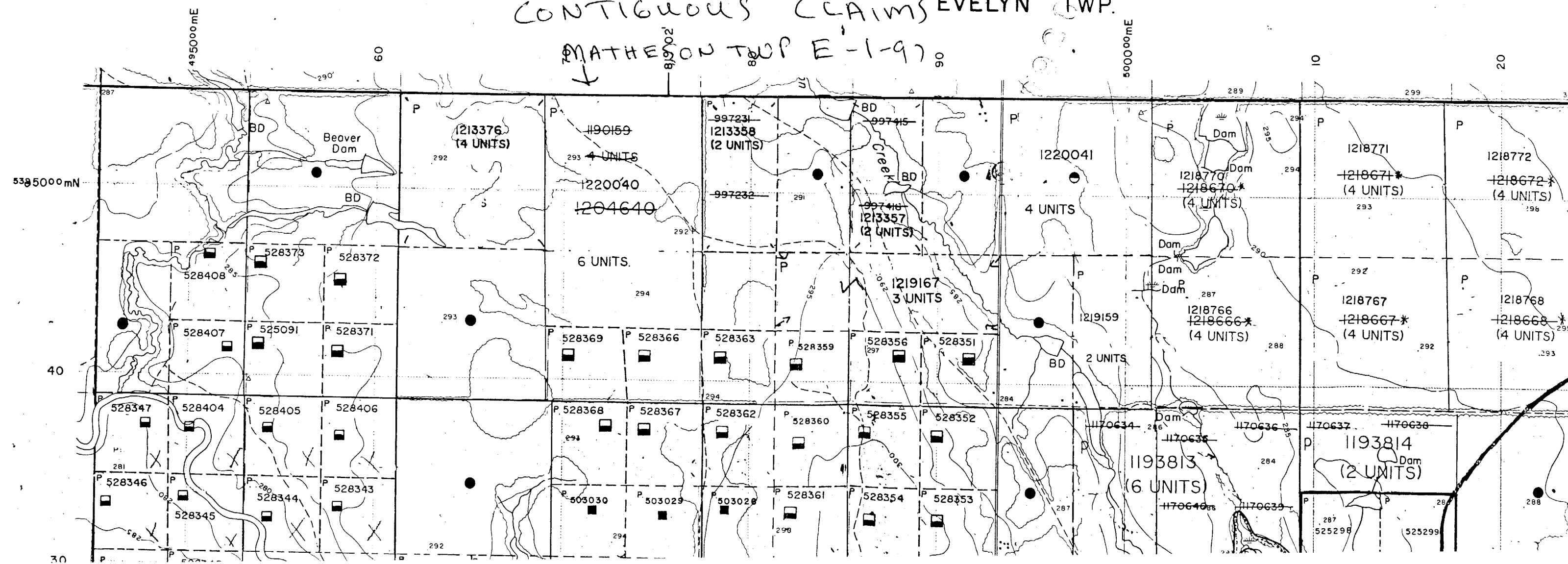

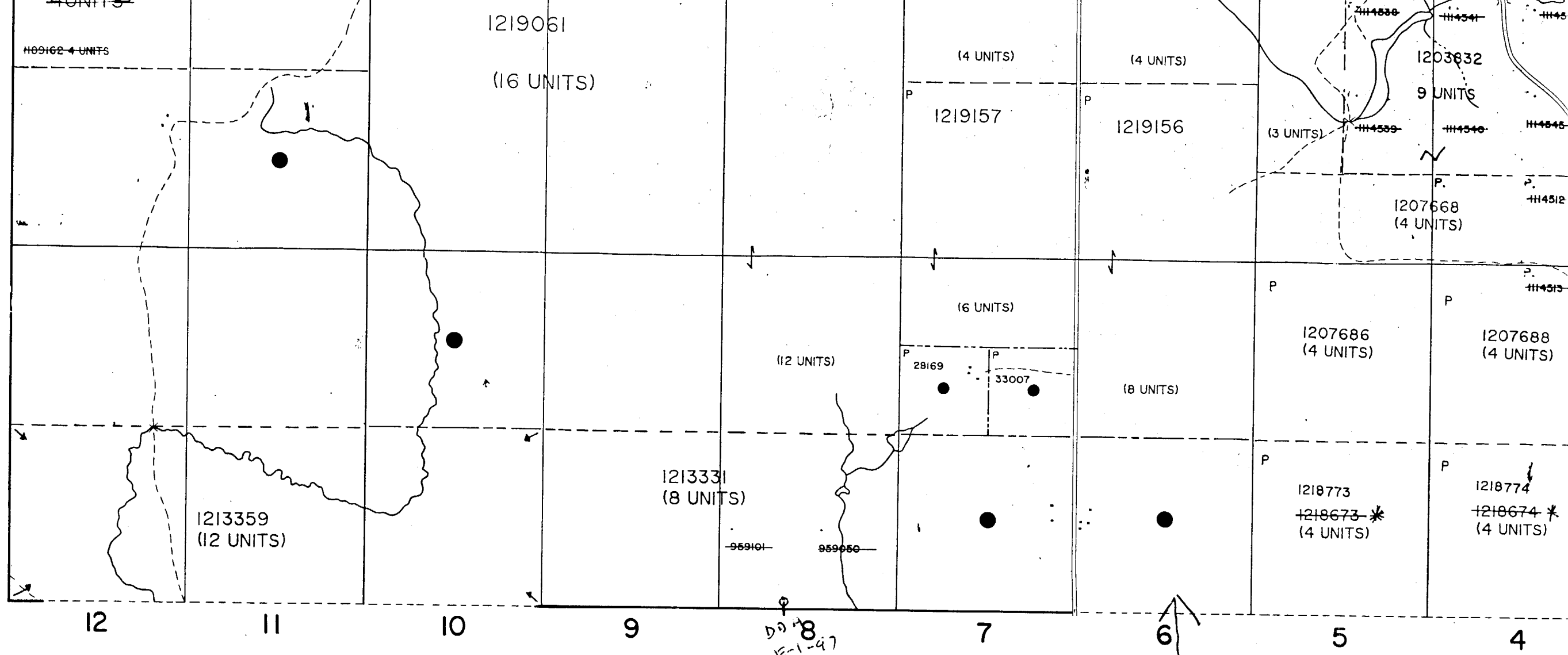

" A. SALO  
 DDH E-1-97 - CONTIGUOUS CLAIMS - EVELYN TWP

MATHESON TOWNSHIP

MINING AND SURFACE RIGHTS WITHDRAWN FROM PROSPECTING, STAKING OUT, SALE OR LEASE UNDER SECTION 35 OF THE MINING ACT, R.S.O. 1990 ORDER NO. W-P 15/94 NER, DATED MARCH 4, 1994. (SEED ORCHARD)

R6



Declaration of Assessment Work Performed on Mining Land

Mining Act, Subsection 65(2) and ...

Transaction Number (office use) W9765.00414 Assessment Files Research Imaging

Personal information collected on this form is obtained under the Access to Information Act, the information is a public document. For questions about this collection contact the Ministry of Northern Development and Mines, 6th Floor, 3 Ramsey Lake Road, Sudb...



900

THE FINAL REVISION STAPLED TO THIS CORRESPOND WITH THE MINING LAND HOLDER. ORIGINAL

Instructions: - For work performed on mining land, use form 0240. - Please type in ink.

Recorded holder(s) (Attach a list if necessary) Name: ARVO SALO, Address: BOX 276, 5 COLVILLE ST, VIRGINIATOWN, ONT POKIXO, Client Number: 191038, Telephone Number: NONE, Fax Number: NONE

2.17926

2. Type of work performed: Check (✓) and report on only ONE of the following groups for this declaration.

Geotechnical: prospecting, surveys, assays and work under section 18 (regs) [ ] Physical: drilling, stripping, trenching and associated assays [✓] Rehabilitation [ ]

Work Type: DIAMOND DRILLING, Dates Work Performed: From 21 9 97 To 30 9 97, Township/Area: EVELYN + MATHESON, M or G-Plan Number: E-6-3940 M-(3482)

Please remember to: - obtain a work permit from the Ministry of Natural Resources as required; - provide proper notice to surface rights holders before starting work; - complete and attach a Statement of Costs, form 0212; - provide a map showing contiguous mining lands that are linked for assigning work; - include two copies of your technical report.

3. Person or companies who prepared the technical report (Attach a list if necessary)

Name: JOHN LONDREY - PROJECT GEOLOGIST, Address: 40 BATTLE MOUNTAIN GOLD, 60 SHIRLEY ST TIMMINS, ONT P4N7J5, Telephone Number: 705-268-9600, Fax Number: 705-268-9572

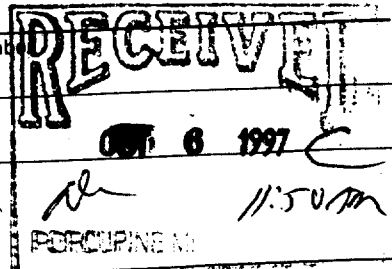
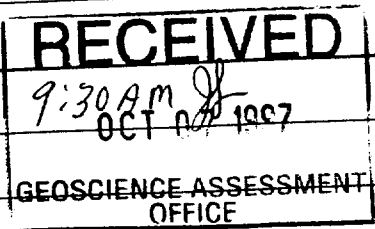

4. Certification by Recorded Holder or Agent

I, ARVO SALO, do hereby certify that I have personal knowledge of the facts set forth in this Declaration of Assessment Work having caused the work to be performed or witnessed the same during or after its completion and, to the best of my knowledge, the annexed report is true.

Signature of Recorded Holder or Agent: [Signature], Date: 10-8-97, Agent's Address: [Address], Telephone Number: NONE, Fax Number: NONE

Mining Claim Number. Or if work was done on other eligible mining land, show in this column the location number indicated on the claim map.	Number of Claim Units. For other mining land, list hectares.	Value of work performed on this claim or other mining land.	Value of work applied to this claim.	Value of work assigned to other mining claims.	Bank Value of work to be distributed at a future date.
neg TB 7827	16 ha	\$26,825	N/A	\$24,000	\$2,825
eg 1234567	12	0	\$24,000	0	0
eg 1234568	2	\$8,892	\$4,000	0	\$4,892
1 P-1213331(E)	8	10582	3200	7382	✓
2 P-1213338(M)	2	2000	800	1200	✓
3 P-1213339(E)	12	0	4800	0	✓
4 P-1213335(M)	2	0	800	0	✓
5 P-1213376(M)	4	0	1600	0	✓
6 P-880323(H)	1	0	400	0	✓
7 P-880324(H)	1	0	400	0	✓
8 P-880322(H)	1	0	400	0	✓
9 P-880321(H)	1	0	182	0	✓
10					
11					
12					
13					
14					
15					
Column Totals		12582	12582	8582	0

P-1213357  
MATHESON TWP

I, ARVO SALO (Print Full Name), do hereby certify that the above work credits are eligible under subsection 7 (1) of the Assessment Work Regulation 6/96 for assignment to contiguous claims or for application to the claim where the work was done.

Signature of Recorded Holder or Agent Authorized in Writing: [Signature] Date: 10-3-97

6. Instructions for cutting back credits that are not approved.

Some of the credits claimed in this declaration may be cut back. Please check (✓) in the boxes below to show how you wish to prioritize the deletion of credits:

- 1. Credits are to be cut back from the Bank first, followed by option 2 or 3 or 4 as indicated.
- 2. Credits are to be cut back starting with the claims listed last, working back to the Bank.
- 3. Credits are to be cut back equally over all claims listed in this declaration; or
- 4. Credits are to be cut back as prioritized on the attached appendix or as follows (describe):

TO JIM MCCAULEY  
GEOSCIENCE ASSESSMENT  
FAX 705-670-5887

**RECEIVED**  
3:15  
GEOSCIENCE ASSESSMENT OFFICE

Note: If you have not indicated how your credits are to be deleted, credits will be cut back from the Bank first, followed by option number 2 if necessary.

For Office Use Only

Received Stamp	Deemed Approved Date	Date Notification Sent
	Date Approved	Total Value of Credit Approved
	Approved for Recording by Mining Recorder (Signature)	

GEOSCIENCE ASSESSMENT OFFICE

11:50 AM  
PORCUPINE MI

Certification by Recorded Holder or Agent

I, ARVO SALO (Print Name), do hereby certify that I have personal knowledge of the facts set in this Declaration of Assessment Work having caused the work to be performed or witnessed the same during its completion and, to the best of my knowledge, the annexed report is true.

Recorded Holder or Agent: <u>[Signature]</u>	Date: <u>Jan. 04/98</u>	Date: <u>10-3-97</u>
Address: <u>[Illegible]</u>	Telephone Number: <u>NONE</u>	Fax Number: <u>NONE</u>



February 20, 1998

ARVO JOHN SALO  
BOX 276  
5 COLVILLE ST  
VIRGINIATOWN, ONTARIO  
P0K-1X0

Geoscience Assessment Office  
933 Ramsey Lake Road  
6th Floor  
Sudbury, Ontario  
P3E 6B5

Telephone: (888) 415-9846  
Fax: (705) 670-5881

Dear Sir or Madam:

**Submission Number:** 2.17926

**Status**

**Subject: Transaction Number(s):** W9760.00414 Approval After Notice

---

We have reviewed your Assessment Work submission with the above noted Transaction Number(s). The attached summary page(s) indicate the results of the review. **WE RECOMMEND YOU READ THIS SUMMARY FOR THE DETAILS PERTAINING TO YOUR ASSESSMENT WORK.**

If the status for a transaction is a 45 Day Notice, the summary will outline the reasons for the notice, and any steps you can take to remedy deficiencies. The 90-day deemed approval provision, subsection 6(7) of the Assessment Work Regulation, will no longer be in effect for assessment work which has received a 45 Day Notice.

Please note any revisions must be submitted in DUPLICATE to the Geoscience Assessment Office, by the response date on the summary.

If you have any questions regarding this correspondence, please contact Bruce Gates by e-mail at [gatesb2@epo.gov.on.ca](mailto:gatesb2@epo.gov.on.ca) or by telephone at (705) 670-5856.

Yours sincerely,



ORIGINAL SIGNED BY  
Blair Kite  
Supervisor, Geoscience Assessment Office  
Mining Lands Section

# Work Report Assessment Results

---

**Submission Number:** 2.17926

**Date Correspondence Sent:** February 20, 1998

**Assessor:** Bruce Gates

---

<b>Transaction Number</b>	<b>First Claim Number</b>	<b>Township(s) / Area(s)</b>	<b>Status</b>	<b>Approval Date</b>
W9760.00414	1213331	EVELYN, MATHESON	Approval After Notice	February 14, 1998

**Section:**  
16 Drilling PDRILL

**Correspondence to:**

Resident Geologist  
South Porcupine, ON

**Recorded Holder(s) and/or Agent(s):**

ARVO JOHN SALO  
VIRGINIATOWN, ONTARIO

Assessment Files Library  
Sudbury, ON

---

**AREAS WITHDRAWN FROM DISPOSITION**

M.R.O. - MINING RIGHTS ONLY  
 S.R.O. - SURFACE RIGHTS ONLY  
 M.+S. - MINING AND SURFACE RIGHTS

Description	Order No.	Date	Disposition	File
(N)	W28/75	04/06/75	S.R.O.	134839
(N)	W19/78	10/04/78	S.R.O.	188543
(N)	NRW 41/85		S.R.O.	

(NS) PENDING DISPOSITION UNDER THE PUBLIC LANDS ACT. NOTICE RECEIVED 92-M.V. (CAMP WATERFALLS)

(RE) MINING AND SURFACE RIGHTS WITHDRAWN FROM PROSPECTING, STAKING OUT, SALE OR LEASE UNDER SECTION 35 OF THE MINING ACT, R.S.O. 1990 ORDER NO. W.P. 15/94 NER, DATED MARCH 4, 1994. (SEED ORCHARD)

THE INFORMATION THAT APPEARS ON THIS MAP HAS BEEN COMPILED FROM VARIOUS SOURCES AND ACCURACY IS NOT GUARANTEED. THOSE WISHING TO STAKE MINING CLAIMS SHOULD CONSULT WITH THE MINING RECORDER, MINISTRY OF NORTHERN DEVELOPMENT AND MINES, FOR ADDITIONAL INFORMATION ON THE STATUS OF THE LANDS SHOWN HEREON.

**LITTLE TOWNSHIP**

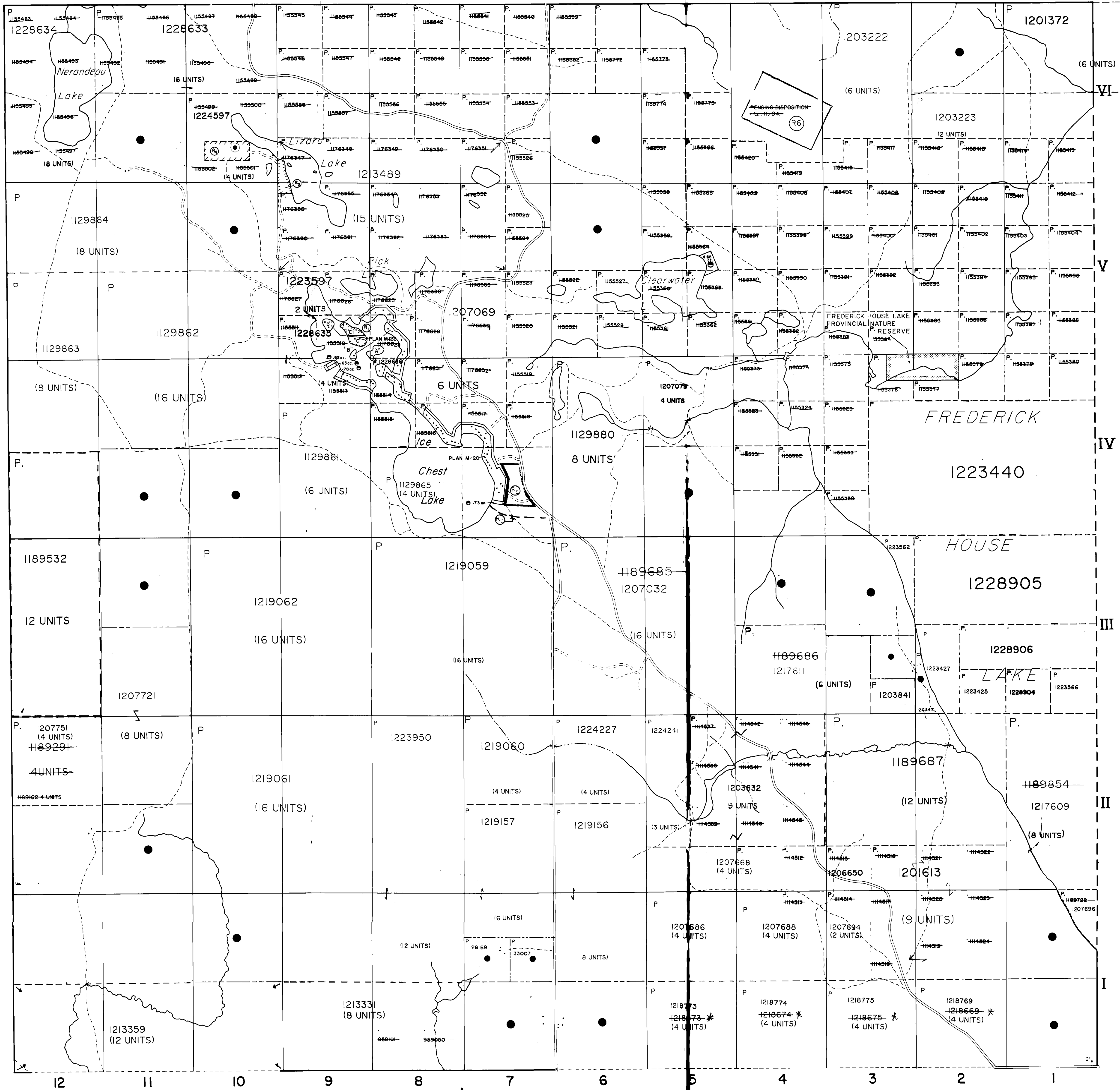

2.17926  
 DRILL

**MATHESON TOWNSHIP**

**LEGEND**

- HIGHWAY AND ROUTE No.
- OTHER ROADS
- TRAILS
- SURVEYED LINES
- TOWNSHIPS, BASE LINES, ETC.
- LOTS, MINING CLAIMS, PARCELS, ETC.
- UNSURVEYED LINES
- LOT LINES
- PARCEL BOUNDARY
- MINING CLAIMS ETC.
- RAILWAY AND RIGHT OF WAY
- UTILITY LINES
- NON PERENNIAL STREAM
- FLOODING OR FLOODING RIGHTS
- SUBDIVISION OR COMPOSITE PLAN
- RESERVATIONS
- ORIGINAL SHORELINE
- MARSH OR MUSKEG
- MINES
- TRAVERSE MONUMENT

**DISPOSITION OF CROWN LANDS**

TYPE OF DOCUMENT	SYMBOL
PATENT, SURFACE & MINING RIGHTS	
" SURFACE RIGHTS ONLY	
" MINING RIGHTS ONLY	
LEASE, SURFACE & MINING RIGHTS	
" SURFACE RIGHTS ONLY	
" MINING RIGHTS ONLY	
LICENCE OF OCCUPATION	
ORDER IN COUNCIL	
RESERVATION	
CANCELLED	
SAND & GRAVEL	

NOTE: MINING RIGHTS IN PARCELS PATENTED PRIOR TO MAY 6, 1913, VESTED IN ORIGINAL PATENTEE BY THE PUBLIC LANDS ACT, R.S.O. 1970, CHAP. 380, SEC. 63, SUBSEC. 1.

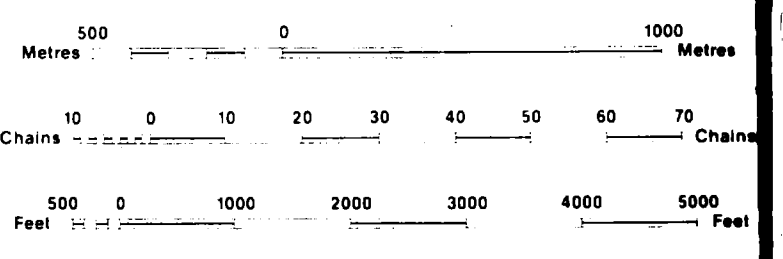

SCALE 1:20 000

(1) THIS TWP. IS SUBJECT TO FOREST ACTIVITY IN 1992/93. FURTHER INFORMATION AVAILABLE ON FILE.  
 (2) THIS TWP. IS SUBJECT TO FOREST ACTIVITY IN 994/95. FURTHER INFORMATION ON FILE.  
 \* - APPLICATION TO RECORD AMENDED

**DATE OF ISSUE**  
 OCT 06 1997  
 PROVINCIAL RECORDING  
 OFFICE - GULDFORD

TOWNSHIP  
**EVELYN**  
 M.N.R. ADMINISTRATIVE DISTRICT  
**TIMMINS**  
 MINING DIVISION  
**PORCUPINE**  
 LAND TITLES / REGISTRY DIVISION  
**COCHRANE**

Ministry of Natural Resources Ontario  
 Ministry of Northern Development and Mines

Date: OCTOBER/1986  
 Number: **G-3940**





MAP SYMBOLOGY

Aerial Cableway	Pipeline (above ground)
Boundary	Railroad
International	Single Track
Interprovincial	Double Track
District, Township Indian Reserve	Abandoned
Approximate	Variable
Lot, Concession	Road
Approximate	Highway, County Township
Park Boundary	Access (road of doubtful maintenance or significance)
Bridge	Trail, Bush Road (bearing atop)
Road, Railroad	Double line river with multiple rapids
Building	Double line river with multiple rapids
Chimney	Rapids
Cliff, Pit, Pile	Double line river with multiple rapids
Contours	Reservoir
Intersected	River, Stream, Canal
Approximate	Approximate
Depression	Approximate
Control Points	Approximate
Horizontal	Direction of Flow
Vertical	Rock
Culvert	Spot Elevation (like elevations) -300.0
Falls	Tower
Double line river	Transmission Line
Fence, Hedge, Wall	Power
Feature Outline (Construction features, etc.)	Tunnel
Flooded Land	Utility Poles
Lock	Wharf, Dock, Pier
Marsh or Swamp	Wooded Area
Mast	
Mine Head Frame	
Outcrop	

AREAS WITHDRAWN FROM DISPOSITION

- M.R.O. - MINING RIGHTS ONLY
- S.R.O. - SURFACE RIGHTS ONLY
- M.+S. - MINING AND SURFACE RIGHTS

Description	Order No.	Date	Disposition	File

THE INFORMATION THAT APPEARS ON THIS MAP HAS BEEN COMPILED FROM VARIOUS SOURCES, AND ACCURACY IS NOT GUARANTEED. THOSE WISHING TO STAKE MINING CLAIMS SHOULD CONSULT WITH THE MINING RECORDER, MINISTRY OF NORTHERN DEVELOPMENT AND MINES, FOR ADDITIONAL INFORMATION ON THE STATUS OF THE LANDS SHOWN HEREON.

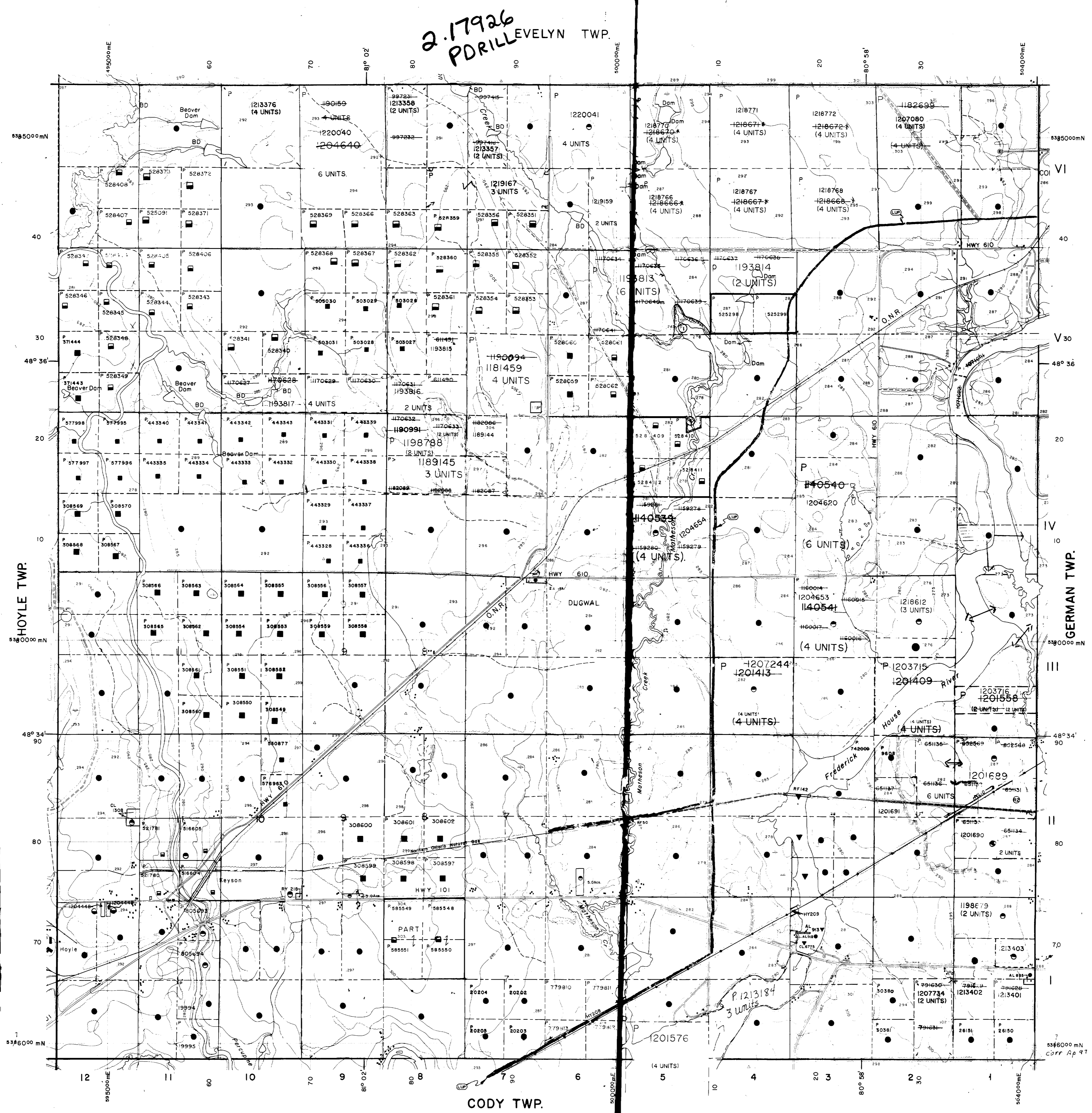

LEGEND

HIGHWAY AND ROUTE No	
OTHER ROADS	
TRAILS	
SURVEYED LINES	
TOWNSHIPS, BASE LINES, ETC.	
LOTS, MINING CLAIMS, PARCELS, ETC.	
UNSURVEYED LINES	
LOT LINES	
PARCEL BOUNDARY	
MINING CLAIMS ETC	
RAILWAY AND RIGHT OF WAY	
UTILITY LINES	
NON-PERENNIAL STREAM	
FLOODING OR FLOODING RIGHTS	
SUBDIVISION OR COMPOSITE PLAN	
RESERVATIONS	
ORIGINAL SHORELINE	
MARSH OR MUSKEG	
MINES	
TRAVERSE MONUMENT	

DISPOSITION OF CROWN LANDS

TYPE OF DOCUMENT	SYMBOL
PATENT, SURFACE & MINING RIGHTS	
" SURFACE RIGHTS ONLY	
" MINING RIGHTS ONLY	
LEASE, SURFACE & MINING RIGHTS	
" SURFACE RIGHTS ONLY	
" MINING RIGHTS ONLY	
LICENCE OF OCCUPATION	
ORDER-IN-COUNCIL	
RESERVATION	
CANCELLED	
SAND & GRAVEL	

NOTE: MINING RIGHTS IN PARCELS PATENTED PRIOR TO MAY 8, 1913, VESTED IN ORIGINAL PATENTEES BY THE PUBLIC LANDS ACT, R.S.O. 1970, CHAP. 380, SEC. 63, SUBSEC. 1.

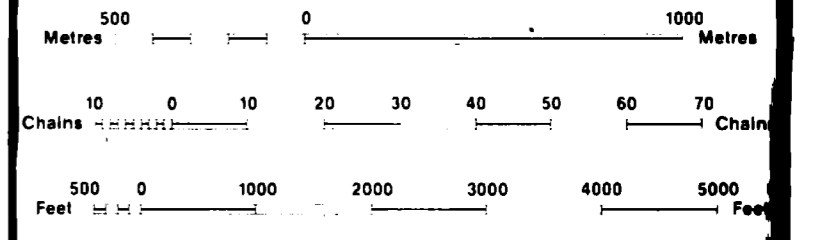

SCALE 1:20 000  
GRID ZONE: 17

NOTES

- FLOODING RIGHTS ON THE FREDERICK HOUSE RIVER TO 303' CONTOUR RESERVED TO H.E.P.C.
- FLOODING RIGHTS RESERVED TO DUCKS UNLIMITED (FILE #A8900007) OCTOBER 31, 1988
- THIS TWP IS SUBJECT TO FOREST ACTIVITY IN 1994/95 - FURTHER INFORMATION AVAILABLE ON FILE.
- PENDING LAND USE PERMIT - MAR 18/92
- PENDING APPLICATION UNDER THE PUBLIC LANDS ACT NOTICE RECEIVED 92-NOV-17 (AGRICULTURAL)
- APPLICATION PENDING UNDER PUBLIC LANDS ACT NOTICE RECEIVED 93-MAR-30 (SNOWMOBILE TRAIL)
- APPLICATION TO RECORD AMF...

DATE OF ISSUE

OCT 06 1997

PROVINCIAL RECORDING OFFICE - SUDBURY

2.17926

TOWNSHIP  
**MATHESON**  
M.N.R. ADMINISTRATIVE DISTRICT  
**TIMMINS**  
MINING DIVISION  
**PORCUPINE**  
LAND TITLES / REGISTRY DIVISION  
**COCHRANE**

Ministry of Natural Resources  
Land Management Branch  
Ontario

ORIGINAL COMPILATION JULY 1984  
ACTIVATED JULY 1997  
REVISED  
Number  
**G-3982**

