



42A11NE0309 2.4692 MATHESON

010

KIDD CREEK MINES LTD.  
REPORT ON REVERSE CIRCULATION  
OVERBURDEN STRIPPING  
IN  
MATHESON TOWNSHIP  
NTS 42A/10

MARCH 22, 1982.

C.C. McLEOD

**RECEIVED**

APR 14 1982

**MINING LANDS SECTION**



42A11NE0309 2.4692 MATHESON

010C

Table of Contents

Summary of Work	1
Location Map	2
Report on Overburden Stripping Procedure	3
"	4
Cheque Re: Stripping	5
Logs of Stripping	
Map Showing Locations of Stripping	

SUMMARY OF WORK

Total footage stripped during invoice period

September 1 to September 14, 1981                      240 feet

Total cost of stripping as per invoices -

September 1 to September 14, 1981                      \$6,253.75

Cost per foot - September 1 to September 14, 1981      \$26.06/foot

Total Footage submitted -

September 1 to September 14, 1981                      240 feet

Cost of Supervisor plus sampler                              \$200.00/day

1) Cost of Reverse Circulation Stripping Claimed

240 ft. X 26.06 per ft.                                      \$6,253.75

2) Cost of Supervisor and Sampler

for 3 days @ \$200.00 per day                              \$600.00

September 1 to 3, 1981 inclusive.

Total Claim:      \$6,853.75

Days claimed @ \$15.00per day - 456 days.

# Evelyn Twp.

# Hoyle Twp.

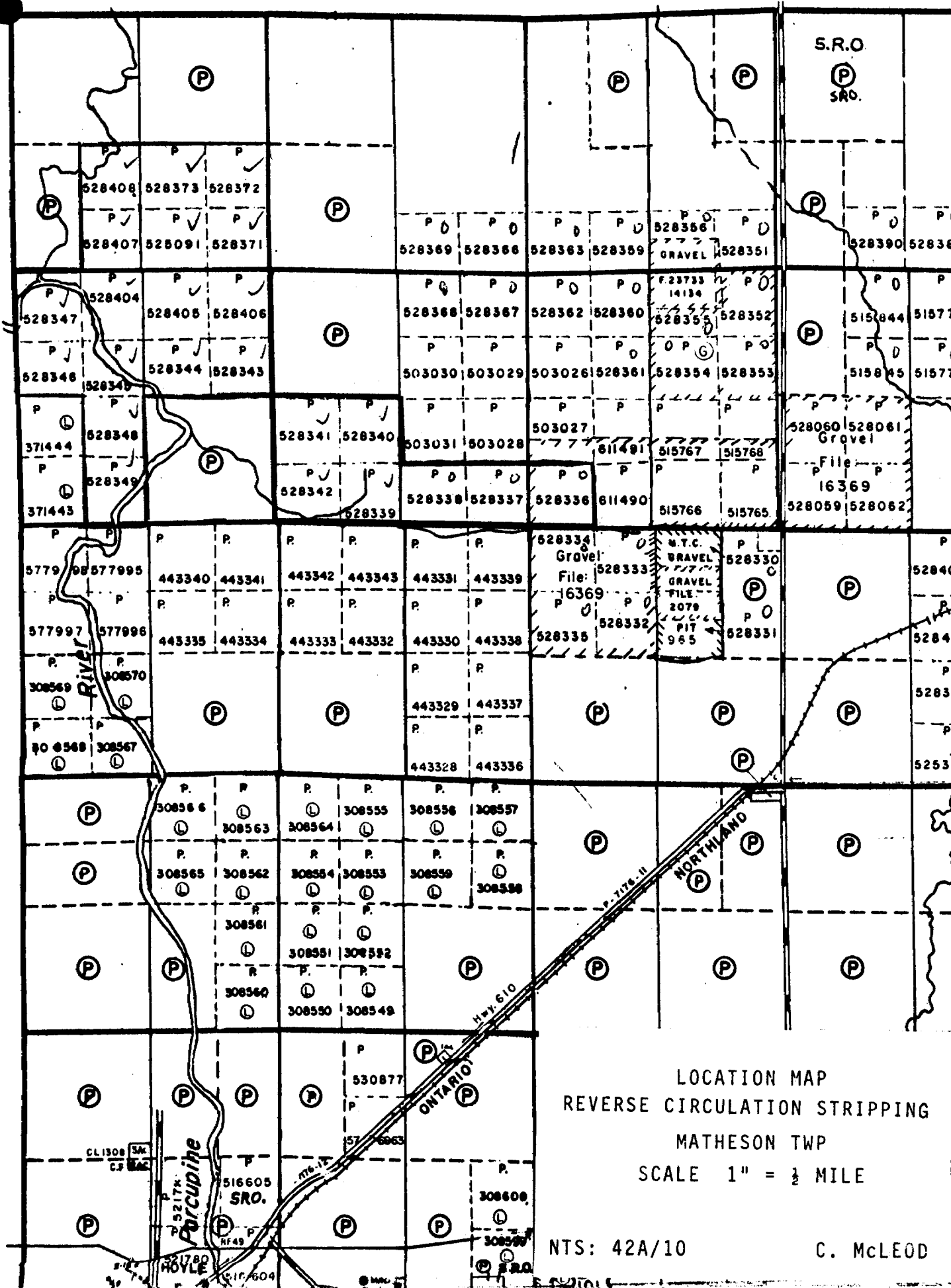

LOCATION MAP  
 REVERSE CIRCULATION STRIPPING  
 MATHESON TWP  
 SCALE 1" = 1/2 MILE

NTS: 42A/10

C. McLEOD

## REPORT ON OVERBURDEN STRIPPING

### GENERAL STATEMENT:

During the summer of 1981, Bradley Bros. Limited, was contracted to carry out Reverse Circulation Overburden Stripping. During the contract period of September 1 to September 14, 1981 and specifically on September 1 to 3, 1981 inclusive they carried out reverse circulation stripping at 2 locations in Matheson Township. The locations are number H-81-109 and H-81-110.

The equipment consists of a Longyear 38 drill mounted on a Flextrac FN160 with a three hundred gallon water storage tank and a 125 cubic foot/minute compressor.

The water or a mixture of water and air is pumped down the outer tube of the drill rods and returns up the inner tube with the sample. The samples are collected in five gallon pails. The sample interval is determined by the supervisor logging the stratigraphy.

### DEPTH MEASURING PROCEDURE:

A hole is started by piecing together a 30 foot length of

drill rod, which when in place has the tri-cone bit resting on the ground surface and the top, where the swivel is attached, is at the top of the tower. When this first length of rods is drilled into the ground to it's full extent, 10 feet of rod is still above ground and 20 feet of rod is measured in the ground. This procedure is continued until 5 feet of bedrock has been drilled. As the rods pass through the different stratigraphic horizons the footage is noted. The footage is easily noted by counting the number of 20 foot sections added and by noting the position of the rods on the tower which has footage markers every two feet.

SAMPLE COLLECTING PROCEDURE:

A five gallon pail is placed under the return hose with a 4-mesh screen on top. The return is constantly examined to determine the type of material, organic, clay, varved clay, silty clay, sand, gravel, basal-till, boulder, or bedrock.

As each horizon is reached the sample bucket is changed and depending on the type of sample it is either discarded or placed in a heavy plastic bag for treatment in the laboratory. Sample interval is decided by the supervisor on the drill and is usually at 5 to 10 foot intervals when in the same material or at odd intervals when there is a stratigraphic change.

*Gay D. Head*

asgulf

Ltd. A Subsidiary of Texasgulf Inc.

No C 6419

Commerce Court Toronto, Ontario

DATE

November 10, 1981

AMOUNT



\$40,421.95

PAY TO THE ORDER OF

Bradley Bros. Limited  
98, 14th Street, P.O. Box 367  
Noranda, Quebec  
J9X 5A9

Texasgulf Canada Ltd.

TORONTO OFFICE ACCOUNT

Bank of Commerce  
19 Street West  
Toronto, Ontario

*M. J. [Signature]*  
**NOT NEGOTIABLE**

DETACH BEFORE DEPOSITING

Texasgulf Canada Ltd. Commerce Court Toronto, Ontario

ITEMS	AMOUNT	BALANCE
Invoices September 30, 1981		\$40,421.95

C 6419

*OK*

AUDITED

*AS*

APPROVED FOR PAYMENT

*[Signature]*

51	0	0	0	0	0	0	0	0	0
52	0	0	0	0	0	0	0	0	0
53	0	0	0	0	0	0	0	0	0
54	0	0	0	0	0	0	0	0	0
55	0	0	0	0	0	0	0	0	0
56	0	0	0	0	0	0	0	0	0
57	0	0	0	0	0	0	0	0	0
58	0	0	0	0	0	0	0	0	0
59	0	0	0	0	0	0	0	0	0
60	0	0	0	0	0	0	0	0	0

Account code

Amount

*C*  
40,421.95

Voucher total

68	0	0	0	0	0	0	0	0	0
69	0	0	0	0	0	0	0	0	0
70	0	0	0	0	0	0	0	0	0
71	0	0	0	0	0	0	0	0	0
72	0	0	0	0	0	0	0	0	0
73	0	0	0	0	0	0	0	0	0
74	0	0	0	0	0	0	0	0	0
75	0	0	0	0	0	0	0	0	0
76	0	0	0	0	0	0	0	0	0
77	0	0	0	0	0	0	0	0	0
78	0	0	0	0	0	0	0	0	0
79	0	0	0	0	0	0	0	0	0
80	0	0	0	0	0	0	0	0	0

Amount	Discount
17	
18	
19	
20	
21	
22	
23	
24	
25	
26	
27	
28	
29	
30	
31	
32	
33	
34	
35	
36	
37	
38	
39	
40	
41	
42	
43	
44	
45	
46	
47	
48	
49	
50	
51	
52	
53	
54	
55	
56	
57	
58	
59	
60	
61	
62	
63	
64	
65	
66	
67	
68	
69	
70	
71	
72	
73	
74	
75	
76	
77	
78	
79	
80	

Prepared By *SS* Date *11/19/81*  
Audited By *AS* Date *11/10/81*

Disposition of cheque:



Enclose Attachments  
With Cheque

Special Instructions

# BRADLEY BROS. LIMITED

September 15, 1981

CONTRACT DIAMOND DRILLING

Texasgulf Canada Limited  
P.O. Box 1140  
Tissims, Ontario

HOLE NO.	TO COVER DIAMOND DRILLING FOR					
	FROM	TO	FOOTAGE COMPLETED			
	<b>Sept. 1 to 14, 1981</b>					
	<u>Materson Township</u>					
881-109	0'	97'	97'			
110	0'	143'	143'			
	Equipment rental:					
	32½ hours			0	\$150.00	\$4,875 00
	Breakdown:					
	4 hours			0	120.00	480 00
	Down the hole consumables:					
	1 Tricone bit	0	\$625.00			
	Plus 15%		<u>93.75</u>			718 75
	Demobilisation:					
	40 miles			0	4.50	180 00
						<u>\$6,253 75</u>

*Page 82*



PROJECT \_\_\_\_\_ DATE Sept. 1/81  
 TOWNSHIP Matheson LOT 9 CON v SAMPLER Jamie W.

Graphic Log	Sample No.	REMARKS
		Humus
		Clay
	H-81-109A	Sand
	H-81-109E	Sand and some clay
	H-81-109C	Sand and some clay
	H-81-109D	Sand - gravel at 49'
	H-81-109E	Sand and gravel
	H-81-109F	Sand and gravel
	H-81-109G	Sand and gravel and some boulder
	H-81-109H	Sand and gravel
	H-81-109I	Sand and gravel
	H-81-109J	Sand and gravel
	H-81-109K	Sand and gravel
	H-81-109L	Sand and gravel
		Bedrock

H-81-109  
 Matheson  
 Lot 9  
 Conc: V

Analysis (H.M.)

OVERBURDEN DRILL LOG NO. H-81-110 "A"

PROJECT \_\_\_\_\_ DATE September 2, 1981  
 TOWNSHIP Matheson LOT 9 CON v SAMPLER Jamie W.  
 Baseline 20E

Graphic Log	Sample No.	REMARKS
		HUMUS
		Brown Clay
		Varved Clay
2.6	H-81-110A	Sand
9.1	H-81-110B	Till
16.6	H-81-110C	Till - clay at 34'
	H-81-110D	Grey clay and sand
13.7	H-81-110E	Till - sand and gravel at 48'
15.2	H-81-110F	Sand and gravel
16.7	H-81-110G	Sand and gravel - grey clay at 56' - 2 bags
15.7	H-81-110H	Grey clay and minor sand
17.8	H-81-110I	Sand and grey clay
21.3	H-81-110J	Grey clay
22.7	H-81-110K	Grey clay
24.3	H-81-110L	Grey clay
16.8	H-81-110M	Sand and grey clay
27.4	H-81-110N	Sand and grey interbedded clay 99' sand and grey clay
30.4	H-81-110O	Sand and clay at 94' - 4 bags
35.0	H-81-110P	Sand - sand and gravel at 108'
33.5	H-81-110Q	Sand and gravel
35.0	H-81-110R	Sand and gravel
36.5	H-81-110S	Sand and gravel - at 124' minor clay and 124' boulder
39.1	H-81-110T	Sand and gravel - boulders at 128-130' - minor mass. py
39.6	H-81-110U	Sand and gravel
41.1		

Analysis (H.M.)

Wt. Remarks

PROJECT \_\_\_\_\_ DATE September 2, 1981  
 TOWNSHIP Matheson LOT 9 CON v SAMPLER Jamie W.

Graphic Log	Sample No.	REMARKS
411 408 405	H-81-110V	Sand and gravel Bedrock - foliated rock - light green series in dark green matrix

H-81-110 "B"  
 Lot 9  
 Con: V  
 Matheson

Analysis (H.M.)

KIDD CREEK MINES LTD.

MINERALS EXPLORATION

TORONTO, ONTARIO

**HOLE LOCATION  
REVERSE CIRCULATION  
STRIPPING  
MATHESON TWP.**

Scale: 1"=1/4m. Data:

Drafter: J.K.

Date: 22/3/1982

Lot

12

Lot

11

Lot

10

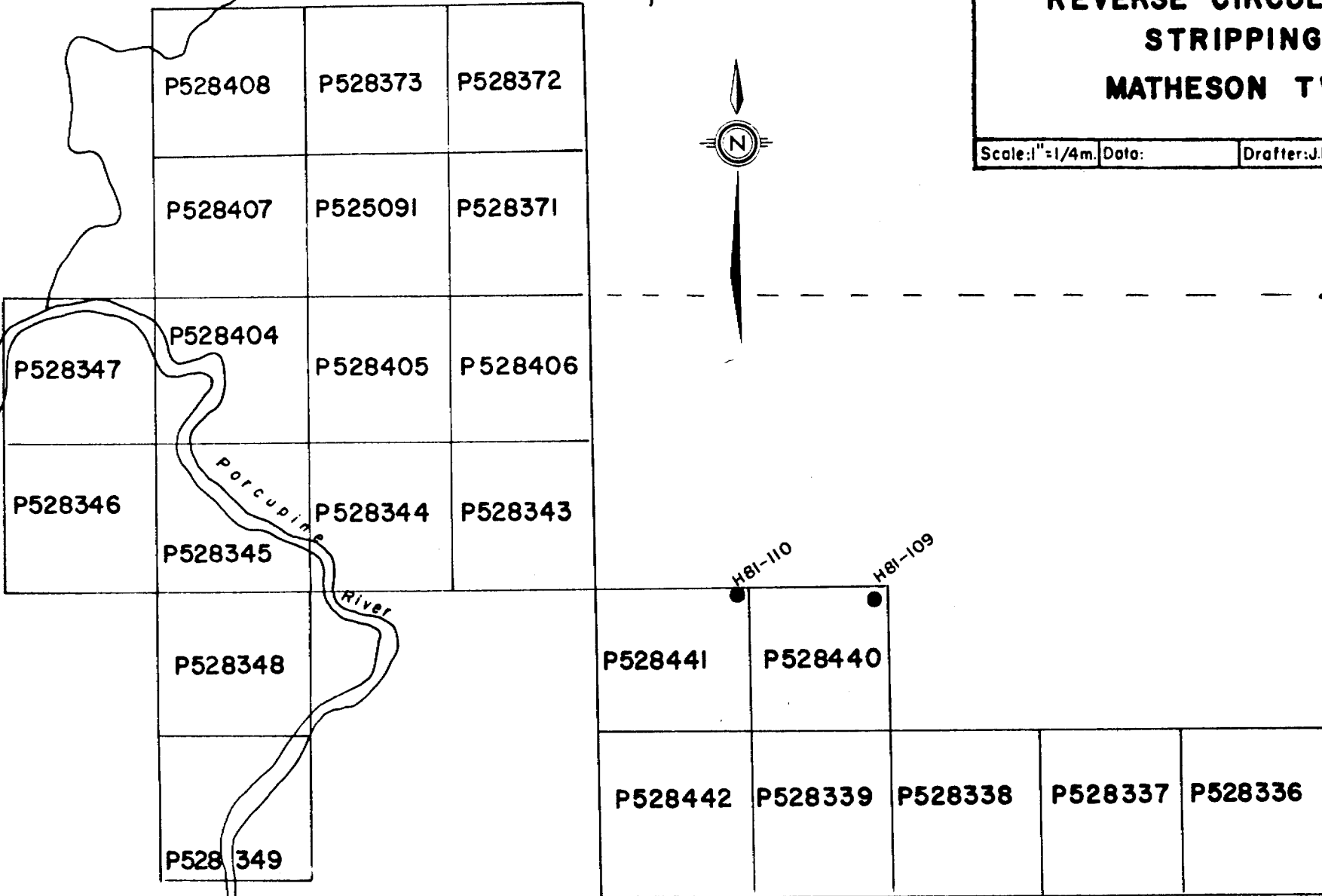

CONC VI

CONC V

Lot 9

Lot 8



42A11NE0309 2.4692 MATHESON

900

1983 02 28

2.4692

Mining Recorder  
Ministry of Natural Resources  
60 Wilson Avenue  
Timmins, Ontario  
P4N 2S7

Dear Sir:

RE: Reverse Circulation Overburden Drilling on  
Mining Claims P 528336 et al, in the Township  
of Matheson

---

The Reverse Circulation Overburden Drilling  
Survey assessment work credits as shown on the  
attached statement have been approved as of the  
above date.

Please inform the recorded holder of these mining  
claims and so indicate on your records.

Yours very truly,

E.F. Anderson  
Director  
Land Management Branch

Whitney Block, Room 6450  
Queen's Park  
Toronto, Ontario  
M7A 1W3

Phone 416/965-1380

A. Barr:jh

Encls.

cc: Kidd Creek Mines Ltd.  
Toronto

Kidd Creek Mines Ltd.  
Timmins, Ontario

Resident Geologist  
Timmins, Ontario

1983 02 28

Recorded Holder	Kidd Creek Mines Ltd.
Township or Area	Matheson Twp.

Type of survey and number of Assessment days credit per claim	Mining Claims Assessed
<b>Geophysical</b> Electromagnetic _____ days Magnetometer _____ days Radiometric _____ days Induced polarization _____ days Section <del>86(18)</del> <sup>77(19)</sup> See across _____ days <b>Geological</b> _____ days <b>Geochemical</b> _____ days Man days <input type="checkbox"/> Airborne <input type="checkbox"/> Special provision <input type="checkbox"/> Ground <input checked="" type="checkbox"/> <input type="checkbox"/> Credits have been reduced because of partial coverage of claims. <input type="checkbox"/> Credits have been reduced because of corrections to work dates and figures of applicant.	\$6,253.75 spent on reverse circulation overburden drilling on mining claims P 528440-41.  417 assessment work days are allowed which may be grouped in accordance with Sec. 76 (6) of the Mining Act R.S.O. 1980.  For Mining Recorder's use:  The work assignment for each of the above listed 2 claims is: 208.5 days per claim.

Special credits under section 86 (15a) for the following mining claims

No credits have been allowed for the following mining claims

not sufficiently covered by the survey       Insufficient technical data filed

The Mining Recorder may reduce the above credits if necessary in order that the total number of approved assessment days recorded on each claim does not exceed the maximum allowed as follows: Geophysical — 80; Geological — 40; Geochemical — 40; Section 86(18)-60:



Mining Lands Comments

Large empty rectangular box for Mining Lands Comments.

To: Geophysics

Comments

---

---

---

---

---

---

Approved     Wish to see again with corrections

Date \_\_\_\_\_ Signature \_\_\_\_\_

To: Geology - Expenditures

*Mr. Kushta*

Comments

---

---

---

---

---

---

Approved     Wish to see again with corrections

Date \_\_\_\_\_ Signature \_\_\_\_\_

To: Geochemistry

Comments

*§ This work should be REVERSE CIRCULATION  
OVERBURDEN "DRILLING"  
NOT "STRIPPING"?*

*J.D.*

Approved     Wish to see again with corrections

Date *December 14<sup>th</sup> 1982*    Signature *J.H. C. [unclear]*

1982 04 19

234692

Mining Recorder  
Ministry of Natural Resources  
60 Wilson Avenue  
Timmins, Ontario  
P4N 2S7

Dear Sir:

We have received reports and maps for Reverse Circulation  
Overburden ~~Sampling~~ <sup>8/11/82</sup> on Mining Claims P 528336 et al, in  
the Township of Matheson.

This material will be examined and assessed and a state-  
ment of assessment work credits will be issued.

Yours very truly,

E.F. Anderson  
Director  
Land Management Branch

Whitney Block, Room 6450  
Queen's Park  
Toronto, Ontario  
M7A 1W3  
Phone: 416/965-1316

J Skura/amc

cc: Kidd Creek Mines Ltd.  
Toronto, Ontario

cc: Kidd Creek Mines Ltd.  
Timmins, Ontario





Ontario

D-528340

2.4692

Ministry of Natural Resources

Notification of recording of assessment work credits

Lands Administration Branch Mining Lands Section Ministry of Natural Resources Room 1617, Whitney Block Queen's Park, Toronto M7A 1W3

RECEIVED

APR 20 1982

MINING LANDS SECTION

Date of recording of work: March 31, 1982
Recorded holder: Kidd Creek Mines Ltd.
Address: # 300-357 Bay Street, Toronto, Ontario M5H 2T7
Township or Area: Matheson Township

Table with 2 columns: Type of survey and number of Assessment days credit per claim, Mining claims. Includes rows for Geophysical (Electromagnetic, Magnetometer, Radiometric, Induced polarization), Geological, Geochemical, and checkboxes for Man days, Airborne, Special provision, Ground.

Notice to recorded holder:

- Survey reports and maps in duplicate be submitted to the Lands Administration Branch, Toronto within 60 days from the date of recording of this work.
Reports and maps are being forwarded to the Lands Administration Branch with this letter.

Handwritten signature

Regional Mining Recorder Mining recorder

c.c. Kidd Creek Mines Ltd. # 300-357 Bay Street, Toronto, Ontario M5H 2T7

CLAIM NUMBER

DAYS

P525091	20
P528336	<i>Maximum already on record</i> <del>20</del>
P528337	" " " <del>20</del>
P528338	" " " <del>20</del>
P528339	<del>40</del> <del>20</del>
P528340	16
P528341	<del>40</del> <del>20</del>
P528342	<del>40</del> <del>20</del>
P528343	20
P528344	20
P528345	20
P528346	20
P528347	20
P528348	20
P528349	20
P528371	20
P528372	20
P528373	20
P528404	20
P528405	20
P528406	20
P528407	20
P528408	20