



42A11NE0600 25 MURPHY

DIAMOND DR.-----

010

TOWNSHIP:   murphy

REPORT No.: ~~758815~~ 25

WORK PERFORMED BY:   Carlo Rizzo

<u>CLAIM No.</u>	<u>HOLE No.</u>	<u>FOOTAGE</u>	<u>DATE</u>	<u>NOTE</u>
P 758815	C-84-1	105	Aug/84	(1)
	C-84-2	160	Aug/84	(1)
	C-84-3	50	Aug/84	(1)

NOTES:   #546-84

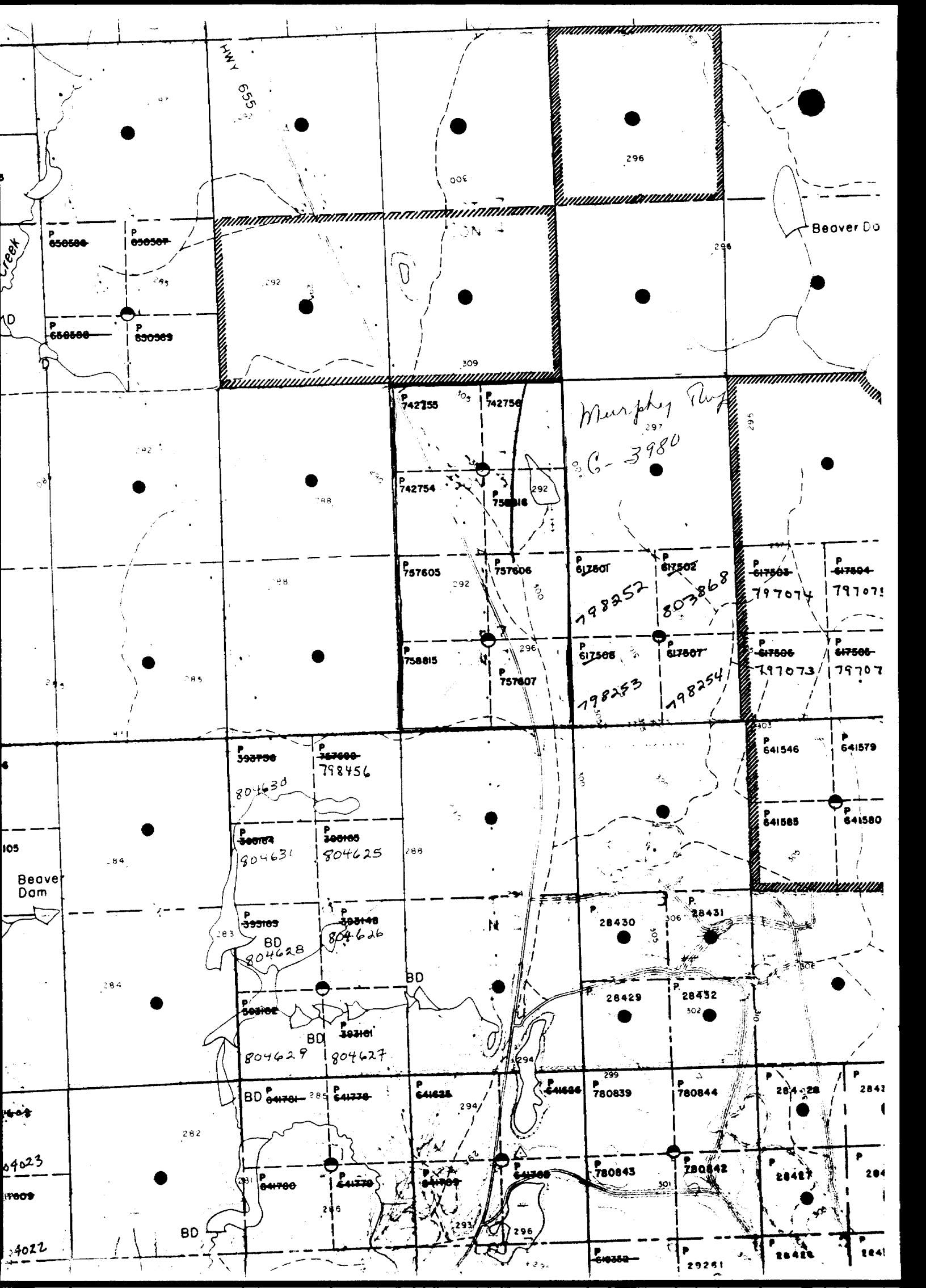

HWY  
655

Creek

Beaver Do

Beaver Dam

Murphy Prop

G-3980

798252

803868

798253

798254

P 399700

P 767000

804630

798456

P 399704

P 399705

804631

804625

P 399703

P 399704

BD  
804628

804626

P 399702

P 399701

BD  
804629

804627

BD P 641701

P 641778

P 641625

P 641686

P 780839

P 780844

P 284028

P 2841

P 641700

P 641770

P 641709

P 641708

P 780845

P 780842

P 284027

P 284

BD

P 641682

P 29261

P 284026

P 2841

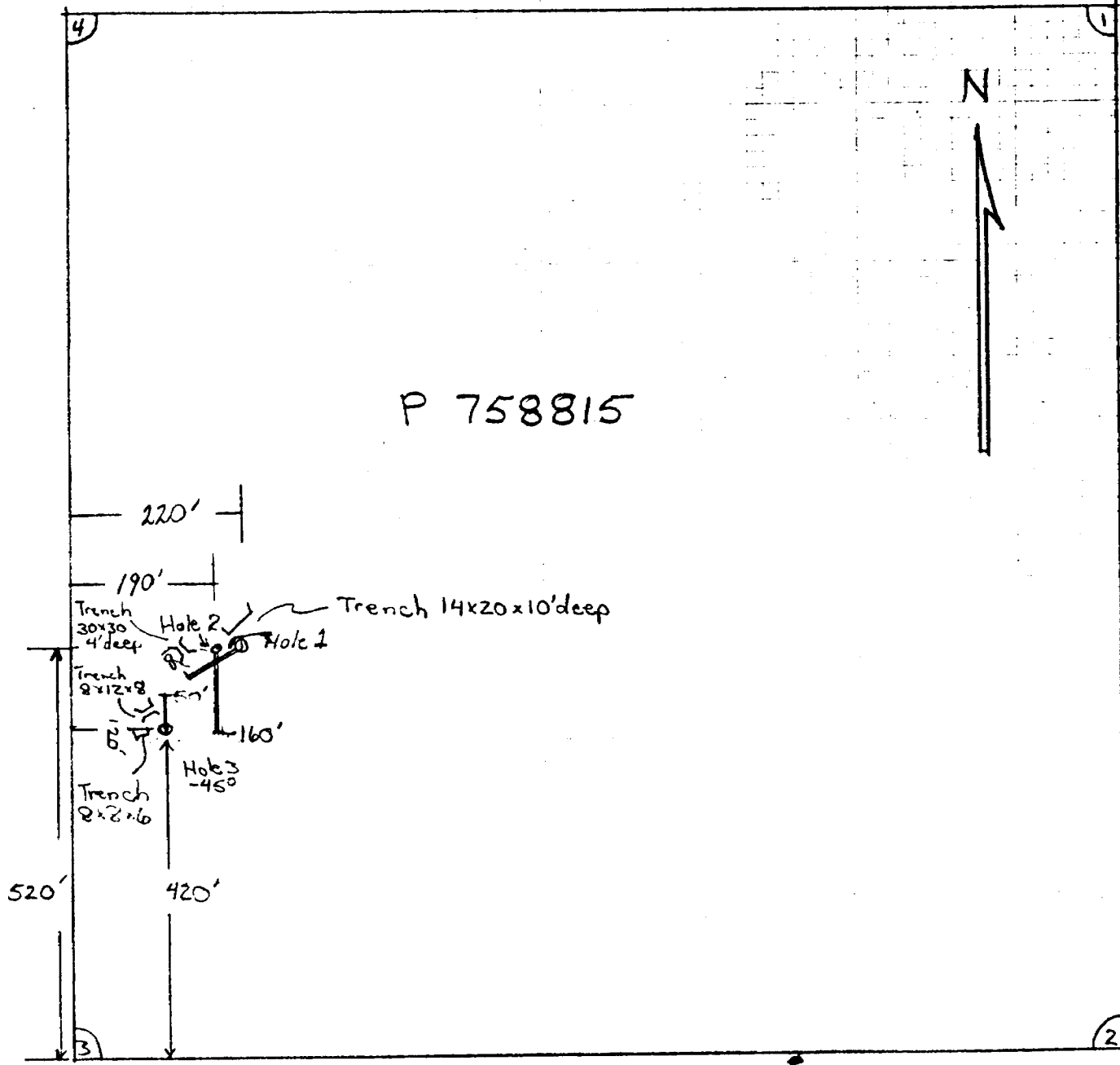

C Rizzo Property  
 Murphy Twp.  
 SW  $\frac{1}{4}$  S  $\frac{1}{2}$  Lot 7 Cor. III  
 1" = 200'

ROBERT S. MIDDLETON EXPLORATION SERVICES INC.

DIAMOND DRILL HOLE LOG

PROJECT:	Carlo Rizzo	HOLE NUMBER:	C - 84 - 1
AREA:	Murphy Township	LOCATION:	560' north of and 220' east of Post 3 of 758815
CLAIM NUMBER:	P 758815	AZIMUTH:	230°
CORE SIZE:	BQ	DIP:	-45°
DRILLED BY:	E.O. Neil, Timmins, Ontario	DATE:	December 7, 1984
LOGGED BY:	Nadia Caira	CASING:	---
CORE STORED AT:	Kirby Street Warehouse	LENGTH:	105'
OBJECTIVE:		ACID TESTS:	None

Footage		ROCK TYPE AND DESCRIPTION	Core Angle to Axis	% Sulphides	SAMPLE			Analytical Result	
From	To				Number	From	To	Length (feet)	Au ppb
0	105	<p><u>RHYODACITE FLOW BRECCIA</u> Debris size varies from .2" to 3". The rhyodacite material consists of fine grained grey-cream bleached looking dacitic to rhyolitic material with 5-15% black aphanitic matrix material containing trace to 3% pyrite and pyrrhotite.</p>							
		<p><u>Note</u> The core has been poorly cared for and poorly marked.</p>							

*Robert Middleton*

ROBERT S. MIDDLETON EXPLORATION SERVICES INC.

DIAMOND DRILL HOLE LOG

PROJECT:	Carlo Rizzo	HOLE NUMBER:	C - 84 - 2
AREA:	Murphy Township	LOCATION:	560' north of and 190' east of Post 3 of 758815
CLAIM NUMBER:	P 758815	AZIMUTH:	180°
CORE SIZE:	BQ	DIP:	-45°
DRILLED BY:	574395 Ontario Inc.	DATE:	December 7, 1984
LOGGED BY:	Nadia Caira	CASING:	---
CORE STORED AT:	Kirby Street Warehouse	LENGTH:	163'
OBJECTIVE:		ACID TESTS:	None

Footage		ROCK TYPE AND DESCRIPTION	Core Angle to Axis	% Sul-phides	SAMPLE				Analytical Result	
From	To				Number	From	To	Length (feet)	Au ppb	Au oz/t
0	10	CASING								
10	12.4	<u>MASSIVE RHYODACITIC FLOW</u> Massive; light grey; aphanitic; with pyrite and pyrrhotite along fractures; as disseminations up to 5-7%.		5-7% pyrite	67516	10	13	3		
12.4	84	<u>RHYODACITIC FLOW BRECCIA</u> -fragment supported; ratio is 70:30 fragments; matrix. -fragments are angular to subangular; up to 6" with a fine black, magnetic, in part sedimentary matrix.  -46-50' fragments are small 2mm to 1/2" with a large bomb shaped 5" fragment occassionally.  -occasional pyrrhotite and pyrite fragment.  -from 60' downhole fragments are large and dominate; matrix decreases rapidly.		tr.py. tr.po						
84	86.4	<u>MASSIVE RHYODACITIC FLOW</u> -strongly fractured with black seams of previous matrix of breccia; looks somewhat tuffaceous.								
86.4	104	<u>RHYODACITIC FLOW BRECCIA</u> -as 12.4 to 84								
104	107	<u>MASSIVE RHYODACITIC FLOW</u> -same as 10 - 12.4.								
107	123	<u>RHYODACITIC FLOW BRECCIA</u> -same as 12.4 to 84.								
123	125	<u>MASSIVE RHYODACITIC FLOW</u> -as 84 - 86.4; fragments of this bed occur at 122.7' they are coarser grained than the aphanitic rhyolite fragments. -occasional section with aphanitic fragments of								

DIAMOND DRILL HOLE LOG

Footage		ROCK TYPE AND DESCRIPTION	Core Angle to Axis	% Sulphides	SAMPLE			Analytical Result	
From	To				Number	From	To	Length (feet)	Au ppb
		rhyolite. -looks somewhat pasty textured, recrystallized.							
125	132	<u>FLOW BRECCIA</u> -same as 12.4 - 84.							
132	163	<u>MASSIVE RHYODACITIC FLOW</u> -same as 10'-12.4' the occasional brecciated portion.							
	163	END OF HOLE							

*Robert Middleton*



ROBERT S. MIDDLETON EXPLORATION SERVICES INC.

DIAMOND DRILL HOLE LOG

PROJECT:	Carlo Rizzo	HOLE NUMBER:	C - 84 - 3
AREA:	Murphy Township SW 1/4, S 1/2 Lot 7 Con.III	LOCATION:	420' north of and 120' east of Post 3 of P758815
CLAIM NUMBER:	P 758815	AZIMUTH:	0°
CORE SIZE:	BQ	DIP:	-45°
DRILLED BY:	574395 Ontario Inc.	DATE:	December 7, 1984
LOGGED BY:	Nadia Caira	CASING:	---
CORE STORED AT:	Kirby Street Warehouse	LENGTH:	50'
OBJECTIVE:		ACID TESTS:	None

DIAMOND DRILL HOLE LOG

Footage		ROCK TYPE AND DESCRIPTION	Core Angle to Axis	% Sulphides	SAMPLE			Analytical Result	
From	To				Number	From	To	Length (feet)	Au ppb
0	7	CASING							
7	50	<p><u>RHYODACITIC FLOW BRECCIA</u></p> <p>-from 7 -11.4 matrix is moderately sericitic; pale green colour; trace disseminated pyrite as cubes; fragments are pale green felsic to inter volcanic; aphanitic; from 1/4" to 2"; trace pyrrhotite as matrix sulphides at 11.0 .</p> <p>-fragments are all same kind; angular to subangular from 11.4 to 32 matrix is less sericitic; aphanitic dark grey to black magnetic; trace to 2% pyrrhotite as wisps, fine blebs.</p> <p>-occasional black sediment? fragment; pyrrhotite inclusions within light green rhyolitic fragments.</p> <p>-at 32 fragments are intensely micro fractured; increase in average size to 4" up to 6".</p> <p>-at 40 -46 white calcite in matrix with 1/2" clear quartz veins at 050° to CA; 1-2% pyrrhotite wisps parallel to foliation.</p>							
	50	END OF HOLE	050°	tr.-2% pyrite	67513	7	11.4	4.4	
					67514	44	46	2	
					67515	48.7	50	1.3	



Ministry of Natural Resources

Report of Work



42A11NE0600 25 MURPHY

729. Separate form for each 1 (see table below). Form no. 1362 "Report of Work", Geological and

Ontario # 546/84

900

No.

Name and Postal Address of Recorded Holder

Carlo Rizzo

M-21128

129 Cayuga Dr. TIMMINS ONT.

Summary of Work Performance and Distribution of Credits

Total Work Days Cr. claimed	Mining Claim			Mining Claim			Mining Claim		
	Prefix	Number	Work Days Cr.	Prefix	Number	Work Days Cr.	Prefix	Number	Work Days Cr.
289.5	P	742754	20						
		742755	20						
		742756	20						
		757605	60						
		757606	60						
		757607	29.5						
		758815	60						
		758816	20						

ONTARIO GEOLOGICAL SURVEY ASSESSMENT FILES RESEARCH OFFICE JAN 9 1985 RECEIVED

All the work was performed on Mining Claim(s): P 758815.

Required Information eg: type of equipment, Names, Addresses, etc. (See Table Below)

Hole 1 Depth 105' Az 230° Dip -45° Credits Hole 1 105<sup>2</sup>

Hole 2 Depth 160' Az 180 Dip -45° Hole 2 160

Hole 3 Depth 50' Az 0 Dip -45° Hole 3 12.5

Hole 4 Drilling performed by E. O'Neil TIMMINS. Core Specimens H1 6  
24  
32  
289.5

Dates Aug 3 - 12 / 84

Hole 2, 3 Drilling performed by: 574395 ONTARIO INC. 167 Lakeshore Lane Timmins Ont. P4N 7A1

Dates Oct 16 - 21 / 84

RECORDED DEC 1 1984

Date of Report 12-12-1984 Recorded Holder or Agent (Signature) Carlo Rizzo

Certification Verifying Report of Work

I hereby certify that I have a personal and intimate knowledge of the facts set forth in the Report of Work annexed hereto, having performed the work or witnessed same during and/or after its completion and the annexed report is true.

Name and Postal Address of Person Certifying CARLO RIZZO 129 CAYUGA DR. TIMMINS ONT.

Date Certified 12-12-1984 Certified by (Signature) Carlo Rizzo

Table of Information/Attachments Required by the Mining Recorder

Type of Work	Specific information per type	Other information (Common to 2 or more types)	Attachments
Manual Work	Nil		Work Sketch: these are required to show the location and extent of work in relation to the nearest claim post.
Shaft Sinking, Drifting or other Lateral Work			
Compressed air, other power driven or mechanical equip.	Type of equipment	Names and addresses of owner or operator together with dates when drilling/stripping done.	Work Sketch (as above) in duplicate
Power Stripping	Type of equipment and amount expended. Note: Proof of actual cost must be submitted within 30 days of recording.		
Diamond or other core drilling	Signed core log showing; footage, diameter of core, number and angles of holes.	Nil	Nil
Land Survey	Name and address of Ontario land surveyor.		