

DIAMOND DRILLING



42A11NW0017 28 CARNEGIE

010

TOWNSHIP: Carnegie

REPORT No.: 28

WORK PERFORMED BY: Rosario Resources Ltd.

<u>CLAIM No.</u>	<u>HOLE No.</u>	<u>FOOTAGE</u>	<u>DATE</u>	<u>NOTE</u>
P 528615-6	C80-1 h	1014.0	Dec/80	(1) (2)
P 525973	C80-2 i	700.0	Jan/81	(1) (2)
P 517070	C80-3 j	805.0	Jan/81	(1)

*3124*

*.2519'*

NOTES: (1) #38-41, 1981

(2) Hole X-sections added to file (Jan./89) from material donated by Abitibi-Price Inc.

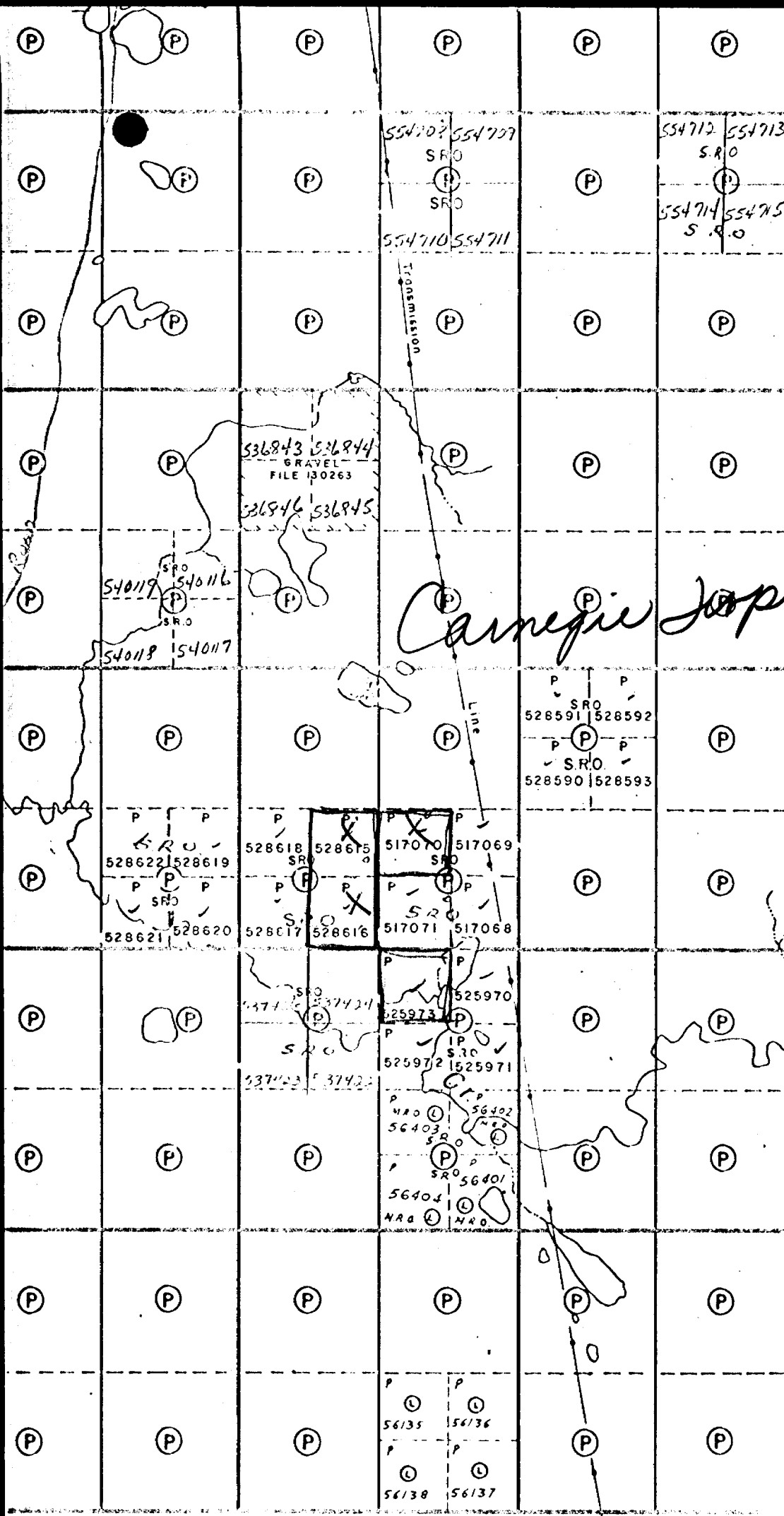

SCA

PATE  
CROV  
LEAS  
LOGA  
LICE  
ROAD  
IMPR  
RAILY  
POW  
MARS



# 38 to 41 - 81



Prosser Twp.

L.O. I  
400' S  
rivers

6 5 4 3 2 1



THE MINING ACT - DEPARTMENT OF MINES  
**DIAMOND DRILLING LOG**

Start a new page for every new hole, but fill in top portion of form only on first page for each hole.

FILL IN ON EVERY PAGE

HOLE NO. C80-1  
PAGE NO. 1  
CLAIM NO.

DRILLING COMPANY <b>Norex Drilling</b>		COLLAR ELEVATION	BEARING OF HOLE FROM TRUE NORTH 180°	TOTAL FOOTAGE 1014	DIP OF HOLE AT collar   -50	LOCATION OF HOLE IN RELATION TO A FIXED POINT ON THE CLAIM  24 + 60S, L32W	MAP REFERENCE NO.
DATE HOLE STARTED December 9, 1980	DATE COMPLETED December 19, 1980	DATE LOGGED Jan. 25, 26/31	LOGGED BY R.S. Middleton	200 ft   -52.5	LOCATION (Tp., Lot, Con. OR Lat. and Long.) Carnegie Con III Lot 4, S½, SE ¼ and Con II N½, NE ¼		
EXPLORATION CO., OWNER OR OPTIONEE Rosario Resources Canada Ltd.		DATE SUBMITTED	SUBMITTED BY (Signature) <i>R.S. Middleton</i>	400 ft   -52			
				500 ft   -44			
				800 ft   -46		PROPERTY NAME Abitibi-Price	

FOOTAGE FROM TO		ROCK TYPE	DESCRIPTION Colour, grain size, texture, minerals, alteration, etc.	PLANAR FEATURE ANGLE *	CORE SPECIMEN FOOTAGE †	YOUR SAMPLE NUMBER	SAMPLE FOOTAGE FROM TO		SAMPLE LENGTH	ASSAYS +	
										Au	ppb
0	210	overburden	mainly gravel-sand and boulders								
210	305.5	basalt- "andesite" Probably numerous thin flows	Medium green fine-grained with many hairline calcitic sutures that may mark flow lines and pillow concentric rings. These fizz with HCL. Slight bleaching extends away from these hairline fractures. Shear 221-224' brecciated-hyaloclastite  Small seams of pyrrhotite @ 221' scattered over 5". 2" qtz-cb vein @ 235' @ 45°.  Flow breccia 235-236'. Flow breccia 243.5-244.8'. 249-249.5' + 2% pyrite  Qtz-veining 251.5 2". Bleaching of rock to pale green-white zoning starts at 252-253.5'. Po seam @ 253.1'. Bleaching occurs occasionally thereafter. Flow contact 262.1' @ 3" qtz vein @ 263' @ 45°.  Vesicles 265-266'. Gash-suturing with dark grey black calcite starts @ 272. 1" sugary carbonate @ 275' @ 45°. Bleaching begins 276' to pale green grey and white to tan zoning. Bleaching along fractures. Flow breccia 284-285'. Tan colouration intensifies 295-305.5'.	45°							

\* For features such as foliation, bedding, schistosity, measured from the long axis of the core.



THE MINING ACT - DEPARTMENT OF MINES  
DIAMOND DRILLING LOG

Start a new page for every new hole, but fill in top portion of form only on first page for each hole.

FILL IN ON EVERY PAGE

HOLE NO. C30-1  
PAGE NO. 2  
CLAIM NO.

DRILLING COMPANY		COLLAR ELEVATION	BEARING OF HOLE FROM TRUE NORTH	TOTAL FOOTAGE	DIP OF HOLE AT collar	LOCATION OF HOLE IN RELATION TO A FIXED POINT ON THE CLAIM	MAP REFERENCE NO.	LOCATION (Tp., Lot, Con. OR Lat. and Long.)
DATE HOLE STARTED	DATE COMPLETED	DATE LOGGED	LOGGED BY	ft				
EXPLORATION CO., OWNER OR OPTIONEE		DATE SUBMITTED	SUBMITTED BY (Signature)	ft				
				ft				
								PROPERTY NAME

FOOTAGE FROM	TO	ROCK TYPE	DESCRIPTION Colour, grain size, texture, minerals, alteration, etc.	PLANAR FEATURE ANGLE	CORE SPECIMEN FOOTAGE +	YOUR SAMPLE NUMBER	SAMPLE FOOTAGE		SAMPLE LENGTH	ASSAYS +	
							FROM	TO		Au	Pb
210	305.5	con't	Large zoned rounded fragments up to 3" @ 239'-294' with white 1/8-1/4" veins. These fragments are bleb shaped elliptical and dumbell shaped. Rock then becomes massive tan coloured. @ 302' 1/2" qtz vein Lower contact	65°							
305.5	312.1	breccia	Tan coloured fragments of various sizes angular to sub angular in black graphitic looking matrix. Fragments make up 60-70% of unit. Rock becomes greyer. Cubic Pyrite 10% @ 309' over 1". 1" qtz @ 310.2 45° to C.A. Pyrite in seams 311-312' 3%.			6613	309	312	2	5	
312.1	336.8	basalt	Grey massive volcanic -slightly carbonated. Pyritic cubes developed near quartz veins. Milky Quartz 314.6-317' slight grinding of vein. Quartz 323-324.5' with pv cubes up to 6" either side. 1/4" qtz 328.3' wormy. Fresh surfaces display graphitic looking content.			6614	314.5	318.5	4	5	
						6615	322	325	3	5	
336.8	459	basalt carbonated	Bleached basalt- tan, fine grained 2' qtz -carbonate vein at contact @336.3'. Carbonate alteration causes bleaching but silicification possible as well. Becomes intense with white cream irregular stripes and zones and spotting. @ 350-363' with quartz eye development in most intense bleached stripes. Pyrite content overall is nil, but 2% 346-349' in seams.			6616	336.8	339	2.2	4	
						6617	339		.2		Total Rock
						6618	346	349	3	3	

\* For features such as foliation, bedding, schistosity, measured from the long axis of the core.



THE MINING ACT - DEPARTMENT OF MINES  
**DIAMOND DRILLING LOG**

Start a new page for every new hole, but fill in top portion of form only on first page for each hole.

FILL IN ON EVERY PAGE

HOLE NO. C80-1  
PAGE NO. 3  
CLAIM NO.

DRILLING COMPANY		COLLAR ELEVATION	BEARING OF HOLE FROM TRUE NORTH	TOTAL FOOTAGE	DIP OF HOLE AT collar	LOCATION OF HOLE IN RELATION TO A FIXED POINT ON THE CLAIM	MAP REFERENCE NO.	PROPERTY NAME
DATE HOLE STARTED	DATE COMPLETED	DATE LOGGED	LOGGED BY		ft		LOCATION (Tp., Lot, Con. OR Lat. and Long.)	
EXPLORATION CO., OWNER OR OPTIONEE		DATE SUBMITTED	SUBMITTED BY (Signature)		ft			
					ft			

FOOTAGE FROM	TO	ROCK TYPE	DESCRIPTION Colour, grain size, texture, minerals, alteration, etc.	PLANAR FEATURE ANGLE *	CORE SPECIMEN FOOTAGE †	YOUR SAMPLE NUMBER	SAMPLE FOOTAGE		SAMPLE LENGTH	ASSAYS +	
							FROM	TO		Au	ppb
236.8	459	con't	Smooth hard surface gives way to more granular @ 370', suggesting more intense carbonate alteration. Pyrite 2% + Qtz veins 45% 373-376'. Rock is massive overall.			6619	373	376	3	4	
			387-389' 15% Qtz @ 30° + 3% py cubes			6620	386.8	387	.2		Total Rock
			399-401' 50% milky quartz			6621	387	389	2	10	
						6622	399	401.5	2.5	8	
			Bleaching phases out 398' and rock becomes grey with occasional brecciated zones @ 402', 403' and interflow graphite ie. 406.8' and this phenomena lasts to 412'. But rock becomes tan and bleached after 410 and granular surface gives way to hard smooth surface @ 412'. Rock may have been mg-fg basalt -possibly mg thoeiliite			6623	424	424.2	.2		Total Rock
			1" Qtz 422.5' @ 70°.								
			1" Qtz 428' @ 45°.								
			Rock is bleached tan to light green 430-459'. Possible flow bottom @ 457-459'.								
			1" vein Qtz @ 430.5'								
			1" vein Qtz @ 432'								
			1/2" vein Qtz @ 445'								
			1" vein Qtz @ 446'								
			1" vein Qtz @ 451.5' @ 45°								
			Graphite ingested up to 3' from contact, tops south?								
459	475	graphitic tuffs	Black graphitic tuff with stretched fragments of tan carbonated volcanic.								

\* For features such as foliation, bedding, schistosity, measured from the long axis of the core.

† Additional credit available. See Assessment Work Regulations.



THE MINING ACT - DEPARTMENT OF MINES  
**DIAMOND DRILLING LOG**

Start a new page for every new hole, but fill in top portion of form only on first page for each hole.

FILL IN ON EVERY PAGE

HOLE NO. C80-1  
PAGE NO. 4  
CLAIM NO.

DRILLING COMPANY		COLLAR ELEVATION	BEARING OF HOLE FROM TRUE NORTH	TOTAL FOOTAGE	DIP OF HOLE AT collar	LOCATION OF HOLE IN RELATION TO A FIXED POINT ON THE CLAIM	MAP REFERENCE NO.	PROPERTY NAME
DATE HOLE STARTED	DATE COMPLETED	DATE LOGGED	LOGGED BY	ft	ft		LOCATION (Tp., Lot, Con. OR Lat. and Long.)	
EXPLORATION CO., OWNER OR OPTIONEE		DATE SUBMITTED	SUBMITTED BY (Signature)	ft	ft			
				ft				

FOOTAGE FROM	TO	ROCK TYPE	DESCRIPTION Colour, grain size, texture, minerals, alteration, etc.	PLANAR FEATURE ANGLE *	CORE SPECIMEN FOOTAGE +	YOUR SAMPLE NUMBER	SAMPLE FOOTAGE		SAMPLE LENGTH	ASSAYS +	
							FROM	TO		Au	ob
459	475	con't	Contact is sharp @ 45°.								
			366.3-366.6' .3' 30% cubes			6624	459	461	2	10	
			469-470' tan carb band 40° to C.A.			6625	466	468	2	12	
			471' 1" qtz			6626	469	471	2	14	
			471-475' graphite + 3% py @ 475' 1" qtz + py vein			6627	471	475	4	33	
475	478.5	carbonated volcanic	Tan carbonated volcanic with 10% graphite streaks @ 5% pyrite.			6628	475	478.5	3.5	7	
						6629	478.5	479.5	1.3	34	
478.5	479.8	graphite	Black dense 55°C.A. shear, calcite veinlets								
479.8	519.6	Basalt carbonated + leucoxene basalt	Tan carbonated with grey black calcite veining to 487. Pyrite 2% 479.8-480'. 1" qtz 491'. White spotting - leucoxene begins 491.5', and tan colouration changes to dark green @ 492-500' area. 1" qtz @ 509.1'			6630	479.5	482	2.2	3	
519.6	527.5	basalt	Grey green, granular with coarse grey clots and streaks that maybe alteration. Flow contact sharp chlorite streak with fg dark green flow above. Grey flecks fizz with HCL so carbonate replacement of former phenocrysts suspected.								
527.5	539.5	basalt	1" quartz vein on flow contact @ 55° dark grey brown colouration-unit is pyritized to 529'. Zebra strip quartz on down hole size of qtz vein and seam of pyrite runs along contact. This maybe interflow material.			6631	527.5	529	1.5	4	

\* For features such as foliation, bedding, schistosity, measured from the long axis of the core.



THE MINING ACT - DEPARTMENT OF MINES  
**DIAMOND DRILLING LOG**

Start a new page for every new hole, but fill in top portion of form only on first page for each hole.

FILL IN ON EVERY PAGE

HOLE NO. C80-1  
PAGE NO. 5  
CLAIM NO.

DRILLING COMPANY		COLLAR ELEVATION	BEARING OF HOLE FROM TRUE NORTH	TOTAL FOOTAGE	DIP OF HOLE AT collar	LOCATION OF HOLE IN RELATION TO A FIXED POINT ON THE CLAIM	MAP REFERENCE NO.	LOCATION (Tp., Lot, Con. OR Lat. and Long.)
DATE HOLE STARTED	DATE COMPLETED	DATE LOGGED	LOGGED BY	ft				
EXPLORATION CO., OWNER OR OPTIONEE		DATE SUBMITTED	SUBMITTED BY (Signature)	ft				
				ft				
				ft			PROPERTY NAME	

FOOTAGE FROM	TO	ROCK TYPE	DESCRIPTION Colour, grain size, texture, minerals, alteration, etc.	PLANAR FEATURE ANGLE	CORE SPECIMEN FOOTAGE +	YOUR SAMPLE NUMBER	SAMPLE FOOTAGE		SAMPLE LENGTH	ASSAYS +	
							FROM	TO		Au	ppb
527.5	539.5	con't	Qtz 1/2" @ 523 @ 45°. Coarse grey clot phase starts 534-536'. Pyrite is 3% overall.			6632	529	534	5	3	
			539-539.5' Qtz-carb with black carbonate on down hole side -interflow unit?			6633	534	537	3	8	
						6634	537	539.5	2.5	7	
539.5	617	Basalt leucoxene	Medium- fg green with ting of tan very small leucoxene specs, mildly carbonated. 1/2%-1% pyrite content. Qtz 546.7-547.2' - interflow? 1/2" Qtz py @ 548.2'. 1" Qtz calcite @ 557'. Bleaching to tan 563-564'. 3% pyrite cubes start @ 565' and leucoxene becomes coarser and rock turns dark brown. Qtz 6" 566-566.5'. 5% pyrite cubes and fine pyrite in tan-dark brown carbonated volcanic to 575 then 2% pyrite and leucoxene specs. 1" grey ankerite vein @ 572'. Starts becoming darker green after 591', calcite flecs 599'.			6635	546.5	548.2	1.7	4	
						6636	563	564	1	8	
						6637	565	567	2	7	
						6638	567	571	4	7	
						6639	571	576	5	3	
						6640	576	581	5	3	
						6641	581	586	5	3	
618	619	Breccia Flow	Fine grained green interflow breccia sutured stretched fragments 1" size.								
619	737	Basalt	Dark green leucoxene basalt. Occasional gash black graphite infill 626-634'. Flow contact 630.5' 48°.	48							
			Bleached tan section 653.5- 656 then grading into dark green basalt. 2" Qtz carb @ 653.5 + other gashes of Qtz.			6642	653.5	656	2.5	1	



THE MINING ACT - DEPARTMENT OF MINES  
DIAMOND DRILLING LOG

Start a new page for every new hole, but fill in top portion of form only on first page for each hole.

FILL IN ON EVERY PAGE

HOLE NO.	PAGE NO.
C80-1	6
CLAIM NO.	

DRILLING COMPANY		COLLAR ELEVATION	BEARING OF HOLE FROM TRUE NORTH	TOTAL FOOTAGE	DIP OF HOLE AT collar	LOCATION OF HOLE IN RELATION TO A FIXED POINT ON THE CLAIM	MAP REFERENCE NO.	LOCATION (Tp., Lot, Con. OR Lot. and Long.)
DATE HOLE STARTED	DATE COMPLETED	DATE LOGGED	LOGGED BY	ft	ft		PROPERTY NAME	
EXPLORATION CO., OWNER OR OPTIONEE		DATE SUBMITTED	SUBMITTED BY (Signature)	ft	ft			
				ft	ft			

FOOTAGE FROM	TO	ROCK TYPE	DESCRIPTION Colour, grain size, texture, minerals, alteration, etc.	PLANAR FEATURE ANGLE	CORE SPECIMEN FOOTAGE +	YOUR SAMPLE NUMBER	SAMPLE FOOTAGE		SAMPLE LENGTH	ASSAYS + ppm				
							FROM	TO		Au ppb	Ag ppm	Cu	Zn	
619	737	con't Leucoxene Basalt with carbonate sections.	Pyrite developes 660-665' up to 3%. Brown tan colour returns 666-672'. 667.1 3" qtz then back to dark green, 667-671'. 3% py @ 670' with spec sphalerite.  Black chlorite infilling starts 672'. Bleaching to tan brown colour starts at 691 to 737'. 1/2" qtz 703.5'. Qtz 705.2-706'. Qtz 712-714' + 3% py and grey ankerite Black sutures and fractures of carbonate and qtz throughout this tan coloured section. 724.5-725.2 dark chloritic flow top.			6643	661	665	4	4				
			Sharp contact @ 724.5 where as brecciated @ 725.2' so top maybe up hole? irregular qtz 726.5-727.5'. qtz-cb 728.2-728.4'.	60°		6647	726.5	728.5	2	15				
			Py cubes 3% Brecciation 734.5-737' with graphite infilling and qtz veining. 1/2" qtz @ 732.4' 65° +py. 1/2" qtz 732.7'.			6648	734.5	737	2.5	1				
737	767	Graphitic tuff	Black dense graphite, beds 70°. graphite 737-739 5% py.			6649	737	739	2	34	0.6	62	1956	
			Tan carbonate rock 739-740.5' 1" argillite band 740.5' tops down hole			6650	739	740.5	1.5	8	0.6	176	612	

\* For footages...





THE MINING ACT - DEPARTMENT OF MINES  
DIAMOND DRILLING LOG

Start a new page for every new hole, but fill in top portion of form only on first page for each hole.

FILL IN ON EVERY PAGE

HOLE NO. C80-1  
PAGE NO. 7  
CLAIM NO.

DRILLING COMPANY		COLLAR ELEVATION	BEARING OF HOLE FROM TRUE NORTH	TOTAL FOOTAGE	DIP OF HOLE AT collar	LOCATION OF HOLE IN RELATION TO A FIXED POINT ON THE CLAIM	MAP REFERENCE NO.	LOCATION (T <sub>p</sub> ., Lot, Con. OR Lat. and Long.)
DATE HOLE STARTED	DATE COMPLETED	DATE LOGGED	LOGGED BY	ft	ft			
EXPLORATION CO., OWNER OR OPTIONEE		DATE SUBMITTED	SUBMITTED BY (Signature)	ft	ft			
				ft				
PROPERTY NAME								

FOOTAGE		ROCK TYPE	DESCRIPTION Colour, grain size, texture, minerals, alteration, etc.	PLANAR FEATURE ANGLE	CORE SPECIMEN FOOTAGE ±	YOUR SAMPLE NUMBER	SAMPLE FOOTAGE		SAMPLE LENGTH	ASSAYS + DDM		
FROM	TO						FROM	TO		Auopb	Ag ppm	Cu Zn
737	767	con't Graphitic tuff	@ 740.5' - 5" massive py then tuffaceous with 40% white fragments 20% .			6531	740.5	747	6.5	23	0.4	28 97
			Massive pyrite 747.5-749' then mix of carb rock and graphite with disseminated pyrite to 760'.			6532	747	749.5	2.5	19	0.6	23 216
						6533	749.5	752	2.5	3	0.2	42 112
						6534	752	757	5	8	0.6	186 856
			Massive pyrite 760.2-760.7' then 20% coarse clots and nodules + 20% disseminated py to 767'.			6535	757	762	5	48	0.8	116 264
						6536	762	767	5	49	1.2	53 2256
767	863	Tan carbonated Basalt	Tan fg basalt with fracture fillings of black calcite, graphite. 2% pyrite cubes to 786'.			6537	772	777	5	3		
			786-787 brecciated with qtz, py, gf			6538	786	787	1	14		
			788.5-789.4' qtz, cb, breccia			6539	787	789.5	2.5	8		
			801-3" qtz + 801-802' 20% qtz infill + 3% py.			6540	800	803	3	5		
			804.2 2" qtz carb.									
			810-810.5' dark flow contact									
			817-819' qtz down core axis + 5% py cubes			6541	817	819	2	8		
			821-824' 1.5' ground									
			837.7-Black gf contact 1" then.									
			gf filling of fractures begins									
			833.5-834.5 qtz sweets 40%.			6542	833.5	834.5	1	4		
			@ 836' 2" gf + py flow contact									
			shear @ 50, contact @ 70°									
			Rock remains tan coloured and infilled with graphite to 863'. no pyrite.									

\* For features such as fractures, bedding, etc., refer to the log sheet.



**DIAMOND DRILLING LOG**

Start a new page for every new hole, but fill in top portion of form only on first page for each hole.

FILL IN ON EVERY PAGE

HOLE NO. C30-1  
PAGE NO. 3  
CLAIM NO.

DRILLING COMPANY		COLLAR ELEVATION	BEARING OF HOLE FROM TRUE NORTH	TOTAL FOOTAGE	DIP OF HOLE AT collar	LOCATION OF HOLE IN RELATION TO A FIXED POINT ON THE CLAIM	MAP REFERENCE NO.	LOCATION (Tp., Lot, Con. OR Lot. and Long.)	PROPERTY NAME
DATE HOLE STARTED	DATE COMPLETED	DATE LOGGED	LOGGED BY	ft	ft				
EXPLORATION CO., OWNER OR OPTIONEE		DATE SUBMITTED	SUBMITTED BY (Signature)	ft	ft				
				ft					

FOOTAGE FROM TO		ROCK TYPE	DESCRIPTION Colour, grain size, texture, minerals, alteration, etc.	PLANAR FEATURE ANGLE	CORE SPECIMEN FOOTAGE +	YOUR SAMPLE NUMBER	SAMPLE FOOTAGE FROM TO		SAMPLE LENGTH	ASSAYS + Au ppb	
863	867	Graphitic tuff	Fragments of tan carbonate and grey rounded fragments up to 1/4". Pyrite 863-864' 5%.								
867	868.5	Tan carbonated basalt	Tan fg carbonated, no pyrite.								
868.5	877	Rhyolite tuff or highlevel porphyry	Sericitized grey tuff? relic 1/4" fragments. Rock is fg and massive 868.5-870', then becomes more tuffaceous with graphite lenses up to 1/2" then black cherty fragmental over 3" at lower contact. Contacts 85°	85°							
877	896.5	Tan carbonate Basalt	Tan, fizzy with HCL, granular, white calcite spots (filling of vesicles), grades into tan-brown leucoxene basalt.								
896.5	915.7	Rhyolite tuff	Grey tuff fg with numerous tuff bands. Yellow sericitization.	85°							
			Breccia 807-809.5 with 2% pyrite + dark grey colouration due to gf?			6543	807	809.5	2.5	4	
915.7	922	Tan carbonated Basalt	Tan, granular, white calcite filling of vesicles then gradational colour change 920- becomes greener @ 922 and			6544	924		.3		Total Rock
922	960	Basalt	eventually dark green and becomes massive fg-mg basalt beyond 932 with 1/2% py. 960-962' calcite brecciation.								
962	981.5	Basalt	After 962 rock becomes greener and finer grained perhaps reflecting epidote.			6545	963		.2		Total Rock



Line 8+181'W

GN 61264

Carnegie Trip.  
C-80.1  
May 1980.

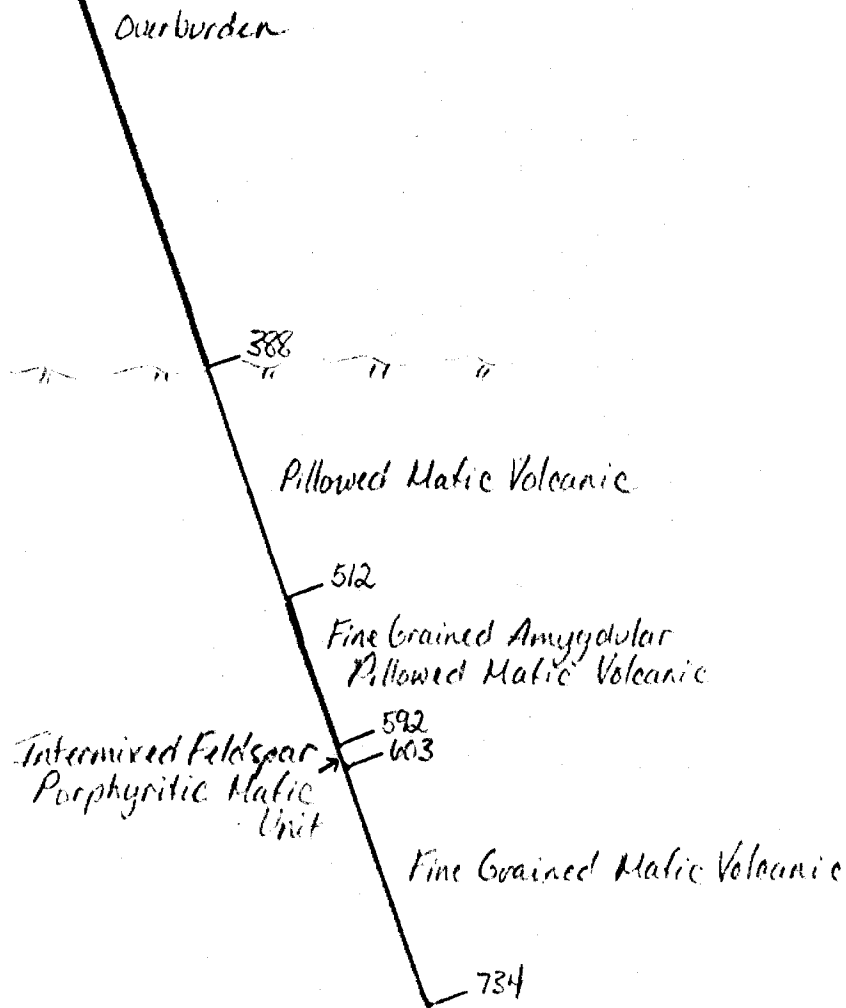



THE MINING ACT - DEPARTMENT OF MINES  
**DIAMOND DRILLING LOG**

Start a new page for every new hole, but fill in top portion of form only on first page for each hole.

FILL IN ON EVERY PAGE

HOLE NO. CSO-2 PAGE NO. 1

DRILLING COMPANY <b>Norex Drilling</b>		COLLAR ELEVATION	BEARING OF HOLE FROM TRUE NORTH 130°	TOTAL FOOTAGE 700	DIP OF HOLE AT collar   -50	LOCATION OF HOLE IN RELATION TO A FIXED POINT ON THE CLAIM  27 + 00S, 25 + 00W	MAP REFERENCE NO.	CLAIM NO. P. 525973
DATE HOLE STARTED January 5, 1981	DATE COMPLETED January 10, 1981	DATE LOGGED Jan. 31/31	LOGGED BY R.S. Middleton	300 ft   -51	LOCATION (Tp., Lot, Con. OR Lat. and Long.)  Carnegie Con II Lot 3 N $\frac{1}{2}$ NW $\frac{1}{4}$			
EXPLORATION CO., OWNER OR OPTIONEE Rosario Resources Canada Ltd.		DATE SUBMITTED	SUBMITTED BY (Signature) <i>R. Middleton</i>	500 ft   ?				
				700 ft   -39.5				
						PROPERTY NAME Allerston-Meurier		

FOOTAGE FROM TO		ROCK TYPE	DESCRIPTION Colour, grain size, texture, minerals, alteration, etc.	PLANAR FEATURE ANGLE	CORE SPECIMEN FOOTAGE	YOUR SAMPLE NUMBER	SAMPLE FOOTAGE FROM TO		SAMPLE LENGTH	ASSAYS + ppm Auppb Agppm Cu Zn			
0	257	Overburden	Mostly gravel and sand.										
257	362	Basalt Carbonated Flow + Flow Breccia Sequence	Tan to dark brown carbonated basalt with graphite infilling of fractures + 1-2" band of graphite. Rock is badly broken up. Some calcite veining. 50% of core loss 257-285'. Pyrite 1/2%-1% very small cubes min head size. Shearing 45-50°	43°									
			Badly broken gf sections with 10% py + ctz chips. More massive sections cut by 10% carbonate veining. ie. 293-303, 307-310' @ 326 breccia flowton				12051	289	295	6	130		
							12052	300	302	2	230		
			330-335 10% carbonate filling of breccia fragments + 3% py. Fault 338.7, 2" fault breccia filling by carbonate.	50°			12053	330	335	5	106		
			1/2" py seam @ 343' + 10° to C.A. carbonate.				12054	342	344	2	106		
			White grey carbonate infilling breccia fragments + 3% py as seams along carbonate filled cracks and as small cubes. Pyrite ashes 10% in tan carb intensifying toward. Graphitic breccia at 359.6-360.9'. Pyritized dark grey carbonated volcanic 10% cubes.				12055	347	352	5	128		
							12056	357	360	3	48		
							12057	360	362	2	56		
362	373	Graphite tuff	Black graphite tuff with 1"-2" lenses and franboids of pyrite 5% with grey fragments 1"-2" stretched and angular Shearing	46°			12058	362	366	4	244	2.0	200 568
							12059	366	371	5	266		
							12060	371	373	7	75		



THE MINING ACT - DEPARTMENT OF MINES  
**DIAMOND DRILLING LOG**

Start a new page for every new hole, but fill in top portion of form only on first page for each hole.

FILL IN ON EVERY PAGE

HOLE NO. C30-2  
PAGE NO. 2  
CLAIM NO.

DRILLING COMPANY		COLLAR ELEVATION	BEARING OF HOLE FROM TRUE NORTH	TOTAL FOOTAGE	DIP OF HOLE AT collar	LOCATION OF HOLE IN RELATION TO A FIXED POINT ON THE CLAIM	MAP REFERENCE NO.	PROPERTY NAME
DATE HOLE STARTED	DATE COMPLETED	DATE LOGGED	LOGGED BY		ft		LOCATION (Tp., Lot, Con. OR Lat. and Long.)	
EXPLORATION CO., OWNER OR OPTIONEE		DATE SUBMITTED	SUBMITTED BY (Signature)		ft			
					ft			

FOOTAGE FROM	TO	ROCK TYPE	DESCRIPTION Colour, grain size, texture, minerals, alteration, etc.	PLANAR FEATURE ANGLE *	CORE SPECIMEN FOOTAGE +	YOUR SAMPLE NUMBER	SAMPLE FOOTAGE		SAMPLE LENGTH	ASSAYS +	
							FROM	TO		Au	ppb
373	387	Basalt breccia	The above rock grades into phase where grey fragments become 90% with minor graphite infilling plus carbonate 10% in irregular voids and fragments become tan to green but graphite slaps persist.			12061	378	381	3	36	
						12062	381	386	5	27	
387	402	Grey wacke or Tuff	Grey tuffaceous horizon with grey lense like 1/8" fragments and occasional graphite fragment. Pyrite is 3% in cubes + lenses + calcite-graphite fracture filling, Graphite beds 6" @ 378, 4" @ 379'.			12063	387	391	4	85	
						12064	397	402	5	27	
402	403	Graphite	Black fine-grained with 10% pyrite nodules.			12065	402	403	1	32	
403	428	Basalt tuff or Coarse grey Wacke	Grey fg, graphite infilling 2% py cubes but small fragments start to appear @ 406'. Band of graphite 410-410.5'. 413-416' Broken gf beds or gf fragments			12066	403	406	3	123	
			Grey fragments become coarser 1/4" after 413'. Pyrite overall is 5% cubes and seams, 1/2" qtz vein @ 416.2'. Graphite beds-coarse argillite 422-422.5', then rock becomes finer grained grey with graphite beds and infilling.			12067	411	416	5	25	
						12068	416	421	5	15	
						12069	422	425	3	41	
			426.5-428' highly contorted with thin white carbonate + gf breccia fragments. 2% py			12070	426	428	2	18	
428	436	Basalt tuff	Grey fg basalt tuff mildly carbonated								

\* For features such as foliation, bedding, schistosity, measured from the long axis of the core.

+ Additional credit available. See Assessment Work Regulations.



THE MINING ACT - DEPARTMENT OF MINES  
**DIAMOND DRILLING LOG**

Start a new page for every new hole, but fill in top portion of form only on first page for each hole.

FILL IN ON EVERY PAGE

HOLE NO. C80-2	PAGE NO. 3
CLAIM NO.	

DRILLING COMPANY		COLLAR ELEVATION	BEARING OF HOLE FROM TRUE NORTH	TOTAL FOOTAGE	DIP OF HOLE AT collar	LOCATION OF HOLE IN RELATION TO A FIXED POINT ON THE CLAIM	MAP REFERENCE NO.
DATE HOLE STARTED	DATE COMPLETED	DATE LOGGED	LOGGED BY		ft		LOCATION (Tp., Lot, Con. OR Lat. and Long.)
EXPLORATION CO., OWNER OR OPTIONEE		DATE SUBMITTED	SUBMITTED BY (Signature)		ft		
					ft		
							PROPERTY NAME

FOOTAGE FROM	TO	ROCK TYPE	DESCRIPTION Colour, grain size, texture, minerals, alteration, etc.	PLANAR FEATURE ANGLE	CORE SPECIMEN FOOTAGE +	YOUR SAMPLE NUMBER	SAMPLE FOOTAGE		SAMPLE LENGTH	ASSAYS +		
							FROM	TO		Au	ppb	
436	444	Tuff	Coarse tuff with 1" tan to grey fragments stretched + pyrite lenses and blebs up to 10% 436-439, then mainly tuff + 1% py.			12071	436	440	4	27		
444	474.8	Grey Wacke	Grey wacke fg-mg, clasts 1/16" less than 1% pyrite. Beds + Shear	58°								
			Band black argillite @ 450-457'. Occasional white carbonate vein @ 55° to C.A., becomes coarser 471-474.8 with 1/8" fragments.									
474.8	486	Argillite	Bedded Grey 1" bands-beds Contact @ 35°	35°								
			Tops down hole @ 482. Beds @ 50. Lower contact 55° against contorted graphite.									
436	528	Graphite tuff	Black graphitic with grey fragments 1/2" some calcite veining, pyrite nodules up to 1" Overall pyrite content 5%. Some sections 6" long are solid graphite. Shears vary 20° to 55°.			12072	486	490	4	27	0.8	92 30
			510-511.5 50% white calcite in shears @	39°		12073	490	495	5	53	1.6	190 836
						12074	495	500	5	90	0.8	164 388
						12075	500	505	5	36	0.6	152 952
						12076	510	515	5	41	1.0	300 1712
			525-528' - 60% qtz - carbonate veining @			12077	520	524	4	41	1.6	760 7280
						12078	524	528	4	29	0.8	550 4400
528	530.5	Basalt breccia	Brecciated tan-grey basalt with graphite infilling and calcite veining 5% + pyrite 10% as fine clots and cubes.			12079	528	530.5	2.5	11		

\* For features such as foliation, bedding, schistosity, measured from the long axis of the core.

+ Additional credit available. See Assessment Work Regulations.



THE MINING ACT - DEPARTMENT OF MINES  
**DIAMOND DRILLING LOG**

Start a new page for every new hole, but fill in top portion of form only on first page for each hole.

FILL IN ON EVERY PAGE

HOLE NO. C80-2  
PAGE NO. 4  
CLAIM NO.

DRILLING COMPANY		COLLAR ELEVATION	BEARING OF HOLE FROM TRUE NORTH	TOTAL FOOTAGE	DIP OF HOLE AT collar	LOCATION OF HOLE IN RELATION TO A FIXED POINT ON THE CLAIM	MAP REFERENCE NO.
DATE HOLE STARTED	DATE COMPLETED	DATE LOGGED	LOGGED BY	ft			LOCATION (Tp., Lot, Con. OR Lat. and Long.)
EXPLORATION CO., OWNER OR OPTIONEE		DATE SUBMITTED	SUBMITTED BY (Signature)	ft			PROPERTY NAME
				ft			

FOOTAGE FROM	TO	ROCK TYPE	DESCRIPTION Colour, grain size, texture, minerals, alteration, etc.	PLANAR FEATURE ANGLE	CORE SPECIMEN FOOTAGE +	YOUR SAMPLE NUMBER	SAMPLE FOOTAGE		SAMPLE LENGTH	ASSAYS + ppm				
							FROM	TO		Au	ppb	As	ppm	Cu
530.5	546	Graphite	Blade dense graphite with 2" pyrite clots 5%. Veins Qtz- carbonate @ 530.5-532', then black graphite with 15% py for next 6'			12080	530.5	532	1.5	14				
						12081	532	538	6	69	1.2	Zn	5460	
546	617	Basalt breccia	Grades into grey brecciated rock with 20% graphite infilling in matrix. Pyrite cubes 3%-4% throughout. Broken ground 577-587'. Becomes much more graphitic 605 onward.			12082	544	549	5	45	0.6	Zn	752	
						12083	575	580	5	12				
						12084	537	590	3	7				
617	620	Graphite	all graphite 617-620'.			12085	597	600	3	8				
620-	630	Basalt tuff ?	Tan grey brecciated with graphite infill grades into grey wache @ 630'.			12086	615	620	5	15				
630	642	Grey Wacke	Granular, bedding appears, calcite infilling 640-642': broken ground 638-644'.			12087	625	630	5	10				
						12088	640	642	2	4				
642	676.5	Argillite	Grey wacke gives way to argillite-bedded with sections of brecciated grey wache or basalt. Quartz veining 663-664'. Quartz veining 2" 668.3' ground up. Fine pyrite in argillite and white carbonate veinlets parallel to bedding. Beds highly contorted 652-672 then more massive to 676.5'.			12089	662	665	3	11				
						12090	667	669	2	8				
						12091	669	672	3	8				

\* For features such as foliation, bedding, schistosity, measured from the long axis of the core.

+ Additional credit available. See Assessment Work Regulations.





L 204)

13N

Carnegie Top  
C-80-2. (South on Line)  
May 1980

Overburden

322

Pillowed Mafic Volcanic

416

Amygdalar Pillowed Mafic Volcanic

500

Fine Grained Mafic Volcanic

641

Intermixed Zone of Amygdalar Andesite and  
Fine Grained Mafic

696

Andesite

845









DIAMOND DRILLING LOG

Start a new page for every new hole, but fill in top portion of form only on first page for each hole.

FILL IN ON EVERY PAGE

HOLE NO. C80-3 PAGE NO. 4 CLAIM NO.

DRILLING COMPANY, COLLAR ELEVATION, BEARING OF HOLE FROM TRUE NORTH, TOTAL FOOTAGE, DIP OF HOLE AT collar, LOCATION OF HOLE IN RELATION TO A FIXED POINT ON THE CLAIM, MAP REFERENCE NO., DATE HOLE STARTED, DATE COMPLETED, DATE LOGGED, LOGGED BY, EXPLORATION CO., OWNER OR OPTIONEE, DATE SUBMITTED, SUBMITTED BY (Signature), LOCATION (Tp., Lot, Con. OR Lat. and Long.), PROPERTY NAME

Table with columns: FOOTAGE FROM TO, ROCK TYPE, DESCRIPTION, PLANAR FEATURE ANGLE, CORE SPECIMEN FOOTAGE, YOUR SAMPLE NUMBER, SAMPLE FOOTAGE FROM TO, SAMPLE LENGTH, ASSAYS Au ppb, Ag ppm. Contains detailed log entries for graphite-argillite and carbonated volcanic basalt.



THE MINING ACT - DEPARTMENT OF MINES  
DIAMOND DRILLING LOG

Start a new page for every new hole, but fill in top portion of form only on first page for each hole.

FILL IN ON EVERY PAGE

HOLE NO. C80-3	PAGE NO. 5
CLAIM NO.	

DRILLING COMPANY		COLLAR ELEVATION	BEARING OF HOLE FROM TRUE NORTH	TOTAL FOOTAGE	DIP OF HOLE AT collar	LOCATION OF HOLE IN RELATION TO A FIXED POINT ON THE CLAIM	MAP REFERENCE NO.
DATE HOLE STARTED	DATE COMPLETED	DATE LOGGED	LOGGED BY	ft	ft		LOCATION (Tp., Lot, Con. OR Lat. and Long.)
EXPLORATION CO., OWNER OR OPTIONEE		DATE SUBMITTED	SUBMITTED BY (Signature)	ft	ft		
				ft	ft		

FOOTAGE FROM	TO	ROCK TYPE	DESCRIPTION Colour, grain size, texture, minerals, alteration, etc.	PLANAR FEATURE ANGLE	CORE SPECIMEN FOOTAGE +	YOUR SAMPLE NUMBER	SAMPLE FOOTAGE		SAMPLE LENGTH	ASSAYS +	
							FROM	TO		Au ppb	Ag ppm
504.9	509.2	sediment graphitic	Grey hard banded sediment- cherty sediment to argillite with massive grey fine grained grey sections. Pyrite is in graphitic sections.			6566	504	509.2	5.2	4	0.2
509.2	514.5	carbonated volcanic	Tan to pale green fg volcanic- Breccia flow top @ 510.5-511.5. 512-514' 50-60% pyrite			6567	509.2	514.5	5.3	23	0.8
514.5	517	graphite	Black dense sutured with white calcite.			6568	514.5	517	2.5	5	0.4
517	519	carbonated volcanic	Flow top breccia @ 517, chilled flow bottom @ 519' so tops maybe up hole here. Contact at	30°		6569	517	519	2	3	0.8
519	520.5	graphite	Black dense graphite sutured with white carbonate and 10% pyrite in cubes.			6570	519	520.5	1.5	4	0.4
520.5	552	carbonated volcanic	Tan to light green volcanic with occasional qtz carbonate veins 1/2". Pyrite 2-3%. 525-527' breccia and hyaloclastite Occasional graphite suture infilling. Rock becomes greyer with tan @ 530'. 529.5' 2" quartz vein grained Fault @ 20° with breccia and white vesicles to 538.3'. 1/2" qtz vein @ 45° across schistosity. 541.5' 5% py + calcite	20°		6571	520.5	524	3.5	23	
						6572	541	542	1	8	

\* For further information...







**DIAMOND DRILLING LOG**

Start a new page for every new hole, but fill in top portion of form only on first page for each hole.

FILL IN ON EVERY PAGE

HOLE NO. C80-3 PAGE NO. 7

DRILLING COMPANY		COLLAR ELEVATION	BEARING OF HOLE FROM TRUE NORTH	TOTAL FOOTAGE	DIP OF HOLE AT collar	LOCATION OF HOLE IN RELATION TO A FIXED POINT ON THE CLAIM	MAP REFERENCE NO.	CLAIM NO.	
DATE HOLE STARTED	DATE COMPLETED	DATE LOGGED	LOGGED BY		ft		LOCATION (Tp., Lot, Con. OR Lat. and Long.)		
EXPLORATION CO., OWNER OR OPTIONEE		DATE SUBMITTED	SUBMITTED BY (Signature)		ft		PROPERTY NAME		
					ft				

FOOTAGE FROM	TO	ROCK TYPE	DESCRIPTION Colour, grain size, texture, minerals, alteration, etc.	PLANAR FEATURE ANGLE	CORE SPECIMEN FOOTAGE +	YOUR SAMPLE NUMBER	SAMPLE FOOTAGE		SAMPLE LENGTH	ASSAYS +	
							FROM	TO		Au ppb	Ag ppm
587.5	689.1	cont.	Talc veins 35°-45° to core axis.								
		Ultramafic intrusive?	50% white carbonate 643-644'. Rock totally lacks sulphide. 654-656' 1.8' core ground.			6579	643	644	1	7	
			@ 670' colour changes from olive brown to yellow green and ankerite veining becomes associated with minor pyrite (2%)			6580	653		.3		total rock
			Veining goes down core axis, veins are 1" wide grey to white and are broken and folded. Quartz is not obvious until 680.5'.			6581	669.5	674	4.5	5	
			674-676' 45% grey ankerite veining, 5% pyrite			6582	674	676	2	8	
			676-678' fg-mg- massive, sericite, 5% pyrite			6583	676	678	2	11	
			678-682' intense carbonate veining with 1" quartz vein cutting carbonate veins @ 680.5, py 2%			6584	678	682	4	5	
			Rock starts becoming finer grained with 3% pyrite and remains yellow brown to contact at 689.1.			6585	682	687	5	5	
			85° contact is sharp and marked by ankerite- white carbonate and fuchsite colouration on dark grey unit below. No physical evidence for flow seen.	85°		6586	687	689.1	2.1	4	
689	691	tuff-mafic	Fine grained dark green with tan bleaching and graphite zoning- infill, 2% pyrite in graphite	45°		6587	689.1	691	1.9	3	
691	693	graphitic sediment	Black, dense graphite with cherty-grey beds 691-691.5'-then massive black to 693 where high pyrite content begins and fragments start to appear-contact 50°	50°		6588	691	693	2	5	



THE MINING ACT - DEPARTMENT OF MINES  
**DIAMOND DRILLING LOG**

Start a new page for every new hole, but fill in top portion of form only on first page for each hole.

FILL IN ON EVERY PAGE  
HOLE NO. C80-3  
PAGE NO. 8  
CLAIM NO.

DRILLING COMPANY		COLLAR ELEVATION	BEARING OF HOLE FROM TRUE NORTH	TOTAL FOOTAGE	DIP OF HOLE AT collar	LOCATION OF HOLE IN RELATION TO A FIXED POINT ON THE CLAIM	MAP REFERENCE NO.	HOLE NO. C80-3	PAGE NO. 8
DATE HOLE STARTED	DATE COMPLETED	DATE LOGGED	LOGGED BY	ft			LOCATION (Tp., Lot, Con. OR Lat. and Long.)		
EXPLORATION CO., OWNER OR OPTIONEE		DATE SUBMITTED	SUBMITTED BY (Signature)	ft			PROPERTY NAME		
				ft					

FOOTAGE		ROCK TYPE	DESCRIPTION Colour, grain size, texture, minerals, alteration, etc.	PLANAR FEATURE ANGLE	CORE SPECIMEN FOOTAGE +	YOUR SAMPLE NUMBER	SAMPLE FOOTAGE		SAMPLE LENGTH	ASSAYS + ppm			
FROM	TO						FROM	TO		Au ppb	Ag ppm	Cu	Zn
693	756	vesicular fragmental tuff-felsic intermediate. Carbonated mafic? matrix with cherty fragments	Felsic-intermediate fragmental with graphitic slips. Grey colour. High pyrite content with zones of beds of 35% to 100% pyrite over 2' widths. Overall the unit runs 30% pyrite. Vesicular spots both rounded and in 1" long lenses composed of grey cherty zones surrounded by white carbonate occur throughout the unit and form augen-eye shapes. They maybe cordierite growths and form a lumpy surface on schistosity planes. Sub-angular fragments are cherty grey up to 1".			6589	693	695	2	25	0.8	34	63
						6590	695	699	4	5	0.8	34	43
						6591	699	701	2	7	0.8	98	43
						6592	701	706	5	4	0.6	52	83
						6593	706	711	5	4	0.6	28	32
						6594	711	715	4	4	0.8	24	67
			Massive sulphides are sometimes colloform with fractures filled with carbonate. Massive sulphide sections are:			6595	715	717	2	5	0.3	50	43
			693-695'			6596	717	720	3	5	0.4	32	47
			699.5-701'			6597	720	721.5	1.5	3	0.2	22	40
			716-717'			6598	721.5	724	2.5	5	0.6	50	44
			1" py @ 718'			6599	724	729	5	3	0.6	26	44
			50% py @ 719.6-720'										
			80% py 722-722.5'										
			100% py 723-723.3'										
			2" py @ 726'										
			80% py 729-730', hairline sphalerite 729.5' in carbonate. minor py -3% in grain bed, 5 @ 733'.			6600	729	730	1	18	0.8	98	25
			Shearing and fragments are alligned 50° to C.A.			6601	730	734	4	3	0.4	30	47

\* For features such as foliation, bedding, schistosity, measured from the long axis of the core



THE MINING ACT - DEPARTMENT OF MINES  
**DIAMOND DRILLING LOG**

Start a new page for every new hole, but fill in top portion of form only on first page for each hole.

FILL IN ON EVERY PAGE

HOLE NO. C80-3  
PAGE NO. 9  
CLAIM NO.

DRILLING COMPANY		COLLAR ELEVATION	BEARING OF HOLE FROM TRUE NORTH	TOTAL FOOTAGE	DIP OF HOLE AT collar	LOCATION OF HOLE IN RELATION TO A FIXED POINT ON THE CLAIM	MAP REFERENCE NO.	CLAIM NO.	
DATE HOLE STARTED	DATE COMPLETED	DATE LOGGED	LOGGED BY	ft			LOCATION (Tp., Lot, Con. OR Lot. and Long.)		
EXPLORATION CO., OWNER OR OPTIONEE		DATE SUBMITTED	SUBMITTED BY (Signature)	ft			PROPERTY NAME		
				ft					

FOOTAGE FROM	TO	ROCK TYPE	DESCRIPTION Colour, grain size, texture, minerals, alteration, etc.	PLANAR FEATURE ANGLE *	CORE SPECIMEN FOOTAGE †	YOUR SAMPLE NUMBER	SAMPLE FOOTAGE		SAMPLE LENGTH	ASSAYS + ppm		
							FROM	TO		Au ppb	Ag ppm	Cu Zn
693	756	con't fragmental	1" pyrite bed @ 737-6'			6602	734	739	5	3	0.4	34 42
			741.5'			6603	739	744	5	1	0.4	36 71
			45% pyrite 744-745'			6604	744	748	4	63	0.8	72.44
			3" pyrite 750.3 + 1" graphite bed 50°			6605	748	750	2	3	0.6	38 51
			Overall carbonate alteration gives some tan colouration .			6606	750	751	1	16	0.8	222 32
			1% py in fragmental.			6607	751	756	5	11	0.4	40 33
			Vesicular appearance persists.									
756	758	mafic volcanic	Fine grained tan green and grey rock, brecciated @ 756' over 3" - maybe flow top. Mild carbonate alteration .									
758	770	mafic volcanic	Granular tan-grey rock with 1" qtz veins at 763, 764' doesn't fizz.			6608	759		.3			Total Rock
			Fragmental zone @ 769'.			6609	761	764	3	3		
			4' core missing 761-778'.									
770	795	massive intrusive? ultramafic?	Massive grey with granular fresh surface- pyrite 1-2%. May contain sausseritized feldspar pin head size. Rock contains sericite flakes - maybe carbonated ultramafic phase.			6610	778		.3			Total Rock
			1" qtz @ 778.1 @ 45°; 780-781' 1/2" qtz 10° to C.A.			6611	773	775	2	7		
			Rock becomes more olive grey.			6612	773	781	3	5		
			End of hole 795' = 895' due to core loss above									

\* For features such as foliation, bedding, schistosity, measured from the long axis of the core.

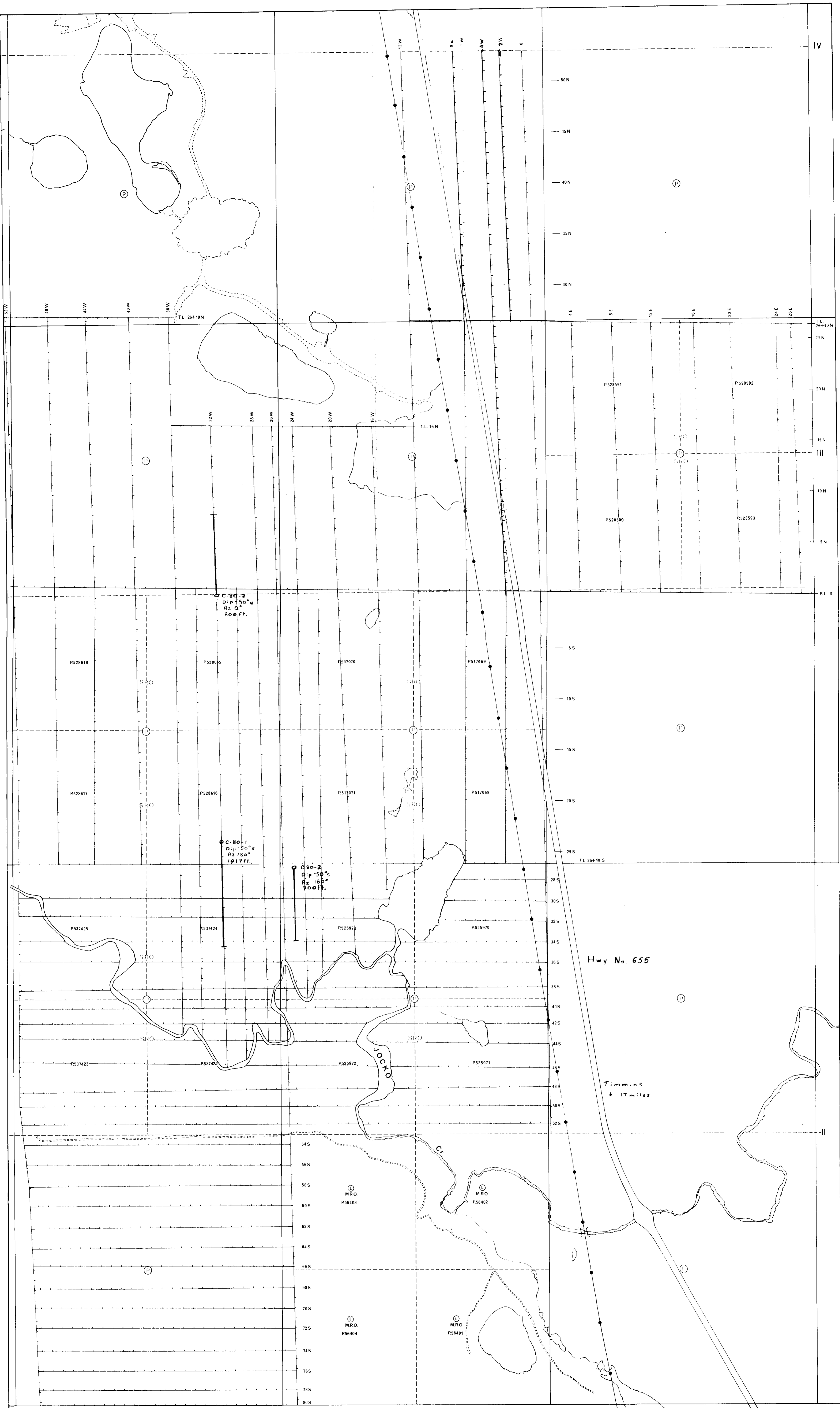

**LEGEND**

- Claim Post
- - - Claim Line
- ~ Creek
- Power Line
- ⊙ Patented Land
- ⊙ Leases
- I.B. Iron Bar
- ==== Road

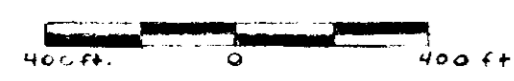

ROSARIO RESOURCES CANADA LTD.	
CARNEGIE TWP.	
DIAMOND DRILL HOLE LOCATION MAP	
OPER.	INST.
SCALE 1"=400'	DATE January 1981

