



42A11NW0065 20 REID

010

Diamond Drilling

Township of REID

Report NO: 20

Work performed by: Black Bay Uranium

| Claim NO | Ho | HO | Date | Note |
|-----------------------------|-----|--------|---------|------|
| ⁵⁹¹⁴² P 59137 | B-1 | 385.0' | Aug/64 | |
| P 59138 | B-2 | 298.0' | Aug/64 | |
| P 59142 | B-3 | 396.0' | Aug/64 | |
| P 59139 | B-4 | 503.0' | Sept/64 | |
| P 59143 | B-5 | 500.0' | Sept/64 | |
| | B-6 | 240.0' | Sept/64 | |
| 59137 59137 | B-7 | 246.0' | Sept/64 | |

Notes:

R. Bruce Graham & Associates Ltd.

Mining Consultants

Property BLACK BAY URANIUM

Hole No. B-1

Latitude 1420 S Bearing South Page 1

Departure 20 W Dip -55°

Location _____ Length 385' Core Size AX

Elevation Surface Started Aug. 14, 1964 Completed Aug. 17, 1964

| FROM | TO | FORMATION | SAMPLE NO. | LENGTH FT. | % CORE RECOVERY |
|-------|-------|---|------------|------------|-----------------|
| 0 | 16 | YELLOW CLAY | | | |
| 16 | 24 | ROCK REAMED | | | |
| 24 | 71 | RHYOLITE White-yellow color, fine-grained, massive with fine-medium grained quartz phenocrysts \pm 1/16" diameter, 60% yellow feldspar, 40% quartz with minor pyrite. 24-48 - rock carbonatized and is speckled with fine grained limonite 46-70 - a few tuffaceous horizons sericitic | | | |
| 71 | 93 | ANDESITE - May be a dyke Green, fine grained At 75-78.5 - rock is porphyritic with medium grained euhedral feldspar <u>CRYSTALS</u> At 88-93 - andesite stained with limonite | | | |
| 93 | 214 | RHYOLITE As from 24-71 Massive, speckled with limonite | | | |
| 214 | 239.4 | ANDESITE - May be a dyke. Fine grained, green; chilled edges - dyke? | | | |
| 239.4 | 385 | RHYOLITE As from 93-214 N.B. At 299' small speck of galena in blue quartz. From 298-385' minor blue streaking of quartz $\frac{1}{4}$ " wide. 385- end of hole | | | |

P-59137

certified true copy

R. Bruce Graham & Associates Ltd.

Mining Consultants

Property BLACK HAY URANIUM

Hole No. B-2

Latitude 12° 30' S Bearing South Page 1
 Departure 3 W Dip -55°
 Location _____ Length 2231' Core Size 3/8"
 Elevation Surface Started Aug. 12, 1964 Completed Aug. 23, 1964

FROM TO FORMATION SAMPLE NO. LENGTH FT.

0-100 Yellow Clay

100-176.6 - RHYOLITE

Fine-grained, white yellow color. Massive with radium quartz eyes generally laminated, sericitic throughout which may indicate the hole is following the rock-overburden profile. Minor pyrite observed.

176-198 - rhyolite is sericitic and quartzose with radiating, euhedral, black, coarse-grained along its length of tourmaline euhedral, very fine crystals of pyrite observed.

Note - minor galena observed at 188.7'

196.4-199.6 - as from 176-188'

Note - minor galena (2 specks) observed at 198.8

198.4-207.6 - rhyolite very laminitic, vuggy with water seen at 206'. Overburden filled up the hole 10 feet on pulling rods. Hole may be close to rock-overburden profile.

207.6 - 1/2" vein of euhedral pyrite in a quartz matrix. Vein is at 40-45° to core axis.

208-210.6 - rhyolite is pinkish in color due to pink quartz or feldspar replacement. Sericitic with minor disseminated cubes pyrite. Foliation up to core axis. Relict phenocrysts.

210.6-236.6 - as from 208-210.6'

236.6 - 236.6 - FACITE-AMIBSITE

Green to gray-green, fine grained. The upper and lower contacts are gradational between the rock and rhyolite. Rock is permeated by yellow-white quartz - feldspar grains. Fine-grained, euhedral crystals of tourmaline.

% CORE RECOVERY

R. Bruce Graham & Associates Ltd.

Mining Consultants

Property: BLACK BAY URANIUM

Hole No. B-2

Latitude

Bearing

Page 2

Departure

Dip

Location

Length

Core Size

Elevation

Started

Completed

| FROM | TO | FORMATION | SAMPLE NO. | LENGTH FT. |
|-------|-------|--|------------|------------|
| 236.6 | 254.6 | <p>RHYOLITE As from 28-230.6 236.6-250.7 - sericitic, foliation 45° to core axis. 250.7-253.4 - A medium gray colored rock. Rock is brecciated with fractures filled with sericite.</p> | | |
| 254.6 | 266.6 | <p>ANDESITE Green, fine grained with euhedral black, coarse-grained (along its axes) crystals of tourmaline-quartz-feldspar veins permeate the rock. Upper and lower contacts gradational with rhyolite.</p> | | |
| 266.6 | 298.0 | <p>RHYOLITE White to light gray-green with minor seams of rust and massive. This section is less altered than from 28-230.6 236.6-254.6. Water seam at 262'. Note: 272-273' minor galena observed in a pinkish quartz vein.</p> | | |
| | | 298 - end of hole | | |

% CORE RECOVERY

Drilled by

CONTINENTAL DIAMOND DRILL CO.

Logged by

PAUL LAFLEUR

Continental Diamond Drill Co.
R. Bruce Graham

R. Bruce Graham & Associates Ltd.

Mining Consultants

Property BLACK BAY URANIUM

Hole No. B-3

Latitude 1080 N

Bearing South

Page 1

Departure 4 W

Dip -55°

Location

Length 396'

Core Size Ax

Elevation Surface

Started Aug. 26, 1964

Completed Sept. 2, 1964

| FROM | TO | FORMATION | SAMPLE NO. | LENGTH FT. |
|------|-----|-----------|------------|------------|
| 0 | 121 | CASING | | |
| 121 | 396 | GABBRO | | |

Massive, dark green with 50% mafic minerals and 50% dark green feldspar, and very minor pyrite.

Fine grained, chilled gabbro becoming progressively coarser grained; medium grained by 170'; coarse grained by 192' to end of hole at 396'.

No defined foliation and no magnetite observed.

396' - END OF HOLE

W CORE RECOVERY

Property.....

RIED TOWNSHIP

Hole No. B-4

Latitude 21 + 00 N

Bearing South

Page 1

Departure 36 W

Dip -55°

Location.....

Length 503' Core Size Ax

Elevation Surface

Started Sept. 6, 1964 Completed Sept. 13, 1964

| FROM | TO | FORMATION | SAMPLE NO. | LENGTH FT. |
|------|------|--|------------|-----------------|
| 0 | 170 | CASING | | |
| 170 | 234 | <u>GABBRO</u> Dark green with 55% mafic, 40% feldspar and containing 5% leucoxene with minor pyrite and magnetite. Massive with no definite foliation direction Fine-grained Extremely wide chill zone, possibly indicating drill hole direction of acute angle to gabbro-andesite contact. Lower contact at 10° to core axis. | | |
| 234 | 450 | <u>ANDESITE</u> Very fine-grained Anhedral fine amygdaloids filled with calcite Amygdaloidal and brecciated flow tops Hematitic quartz-feldspar veins at 304.6 - 1/4" 309-309.6 1/4" 314-315 1/4" 340 - 1 1/2" 383 - 4" 388 - 1" 395 - 1" 417 - 1" 431 - 3" Generally from 10% of rock cut by hematitic quartz feldspar veins Shear zone at 428-429' sheared 30-40° to core axis with 5% pyrite Sericitic zone at 443.6-450' - yellow sericite | | |
| 450 | 460) | Shear zone in andesite - shearing 40-50° to core axis occurs | | |
| 460 | 464) | Shear zone in gabbro - at the contact between gabbro and andesite favouring somewhat the andesite Shear zone contains - 20% quartz/ 30% feldspar with 2-3% euhedral crystals of pyrite -(fine-grained pyrite) and 10% yellow sericite. | | |
| | | | | % CORE RECOVERY |

R. Bruce Graham & Associates Ltd.

Mining Consultants

BLACK BAY URANIUM LTD.

Property..... **RIED TOWNSHIP**

Hole No. **B-4**

Latitude..... Bearing..... Page **2**

Departure..... Dip.....

Location..... Length..... Core Size.....

Elevation..... Started..... Completed.....

| FROM | TO | FORMATION | SAMPLE NO. | LENGTH FT. | | | | | |
|------|-----|---|------------|------------|--|--|--|--|--|
| 464 | 503 | <p>GABBRO Fine-grained, green-gray with 10% leucoxene Appears fresh-looking except the following sections which are saturated with quartz and feldspar, i.e. granitized Granitized sections are: 460-474; 479-481.6; 491.6-495; 500-503 503 - END OF HOLE</p> | | | | | | | |

% CORE RECOVERY

Drilled by.....

Logged by..... *certified true copy*
R. Bruce Graham

Latitude **18 + 00 S** Bearing **North** Page **1**

Departure **24 W** Dip **50°**

Location..... Length **500'** Core Size **1x**

Elevation **Surface** Started **Sept. 13, 1964** Completed **Sept. 19, 1964**

| FROM | TO | FORMATION | SAMPLE NO. | LENGTH FT. | | | | |
|------|-----|---|------------|------------|--|--|--|--|
| 0 | 36 | CASING | | | | | | |
| 36 | 432 | <u>RYHOLITE</u> Light gray, fine grained, somewhat sericitic with 20% quartz eyes up to 1/32" in diameter Massive 36-67 - pitted with hematitic and limonitic staining probably due to weathering of ferruginous carbonate Faint foliation throughout Foliation at 68' - 60° to core axis; at 98' - 65° to core axis; at 130' - 65° to core axis; at 145' - 65° to core axis; at 166' - 55° to core axis; at 211' - 60° to core axis; at 236' - 65° to core axis 199.5-202.5 - light green, aphanitic diorite dyke cut by quartz-feldspar veinlets, with 2 speck chalco and 1 speck of galena. The lower contact of 1" is altered to limonite. Sections where 25% of rock has reddish rust at 141'; 159-161.6'; 176-183'; 205-208'; 209'; 226-232' Pin points of pyrite and chalco are very sparsely disseminated throughout section CHARACTER samples taken at 241.5'; 256.5' Blue quartz veinlets up to 1/8" wide with sparse pinpoint chalco and pyrite At 550' - 8" dyke with upper and lower contacts at 45° to core axis. Light green, fine-grained. | | | | | | |
| 432 | 451 | <u>DIORITE (GABBRO) DYKE</u> Upper contact 40° to core axis - has pyrite cubes at upper contact; lower contact ground Contacts appear to be chilled Light green, fine-grained | | | | | | |
| 451 | 500 | <u>RYHOLITE</u> - 20% quartz eyes up to 1/16" in diameter Note: From 369' to end of hole rock appears to be darker gray in colour (chloritized) and also there is an increase of fine-grained, chloritic material in matrix; and also an increase of feldspar in matrix (albitized?). Some quartz eyes appear smoky, i.e. darker in color. Foliation at 463'-40° to core axis; at 490'-55° to core axis Note: This section may be an alteration zone. | | | | | | |

% CORE RECOVERY
55° to core axis

500 - END OF HOLE

Drilled by **CONTINENTAL DIAMOND DRILLING CO.**

Logged by *Certified true copy*
GRAHAM, LAFLEUR
R. Bruce Graham

Property BLACK BAY URANIUM

Hole No. B-6

Latitude 16 + 00 S

Bearing -

Page 1

Departure 24 W

Dip Vertical

Location

Length 240'

Core Size 1x

Elevation Surface

Started Sept. 20, 1964

Completed Sept. 23, 1964

| FROM | TO | FORMATION | SAMPLE NO. | LENGTH FT. | | | | | |
|------|-----|---|------------|------------|--|--|--|--|--|
| 0 | 84 | OVERBURDEN | | | | | | | |
| 84 | 93 | <u>QUARTZ OR DIORITE DYKE</u> Light green, fine-grained Near surface transformation to a soft green rock of chlorite and clay Foliation 10° to core axis At 86-88' rock is limonitic in color Lower contact ground Notes: This rock similar to rock in Hole B-5 at 432-451 | | | | | | | |
| 93 | 240 | <u>AMYOLITE</u> Very hard made up of 50% light yellow beige feldspar and 40% quartz with 10% quartz eyes First 2' of section vuggy due to surface weathering - lack of ferruginous carbonate Local 1/8" thick blue quartz veins with subhedral, fine-grained pyrite crystals Sericitized 240 - END OF HOLE | | | | | | | |

% CORE RECOVERY

Drilled by CONTINENTAL DIAMOND DRILLING CO.

Logged by

Confidential
LAFLEUR
R. Bruce Graham

Property BLACK BAY URANIUM

Hole No. B-7

Latitude 2 + 00 S

Bearing -

Page 1

Departure 4 W

Dip Vertical

Location

Length 246' Core Size 1 1/2"

Elevation Surface

Started Sept. 25, 1964 Completed Sept. 27, 1964

| FROM | TO | FORMATION | SAMPLE NO. | LENGTH FT. | | | | | |
|-----------------|-----|--|------------|------------|--|--|--|--|--|
| 0 | 45 | CASING | | | | | | | |
| 45 | 140 | <u>RHYOLITE</u> Gray yellow, fine-grained with 10-15% quartz eyes Sericitized with minor pyrite distributed throughout 45-104.5 - 40% of rock rusty colored 61-66 white-gray, quartzose with ghost-like quartz eyes Foliation - 10-15° to core axis Local sections contain 30% quartz eyes e.g. 68.5-74.5 69.5-71.5 - 1-2% euhedral fine-medium-grained pyrite 102' - minor shear 15° to core axis | | | | | | | |
| 140 | 202 | <u>ANDESITE</u> Dark green, fine-grained Porphyritic with euhedral crystal of fine to medium-grained feldspar Gradational upper and lower contacts with rhyolite 186' - 1" quartz and tourmaline 174' - foliation 15° to core axis 140-140.5 - rusty limonitic stained | | | | | | | |
| 202 | 246 | <u>RHYOLITE</u> Gray-yellow with 10% quartz eyes Sericitic Minor pyrite throughout 208-213 - black-gray chloritic 226' - foliation 10-15° to core axis 211' - minor specks chalc seen 205-206 - tourmaline observed 246 - END OF HOLE | | | | | | | |
| % CORE RECOVERY | | | | | | | | | |

Drilled by CONTINENTAL DIAMOND DRILLING CO.

Logged by Paul Lafleur
Continental True copy
R. Bruce Graham

LOCATION:
T4E 20S 20W

conductor

B-1

50'

100'

150'

200'

250'

300'

350'

400'

385'

Rhyolite

Andesite or
Dyke?

Rhyolite

Andesite or
Dyke?

Rhyolite

BLACK BAY URANIUM LIMITED
REID TOWNSHIP
ONTARIO
SECTION DRILL HOLE B-1
(LOOKING WEST)

SCALE: 1" = 50'

DATE: August, 1964

LOCATION:
B.W. 131805

B-2

conductor

50'

100'

150'

200'

250'

300'

350'

400'

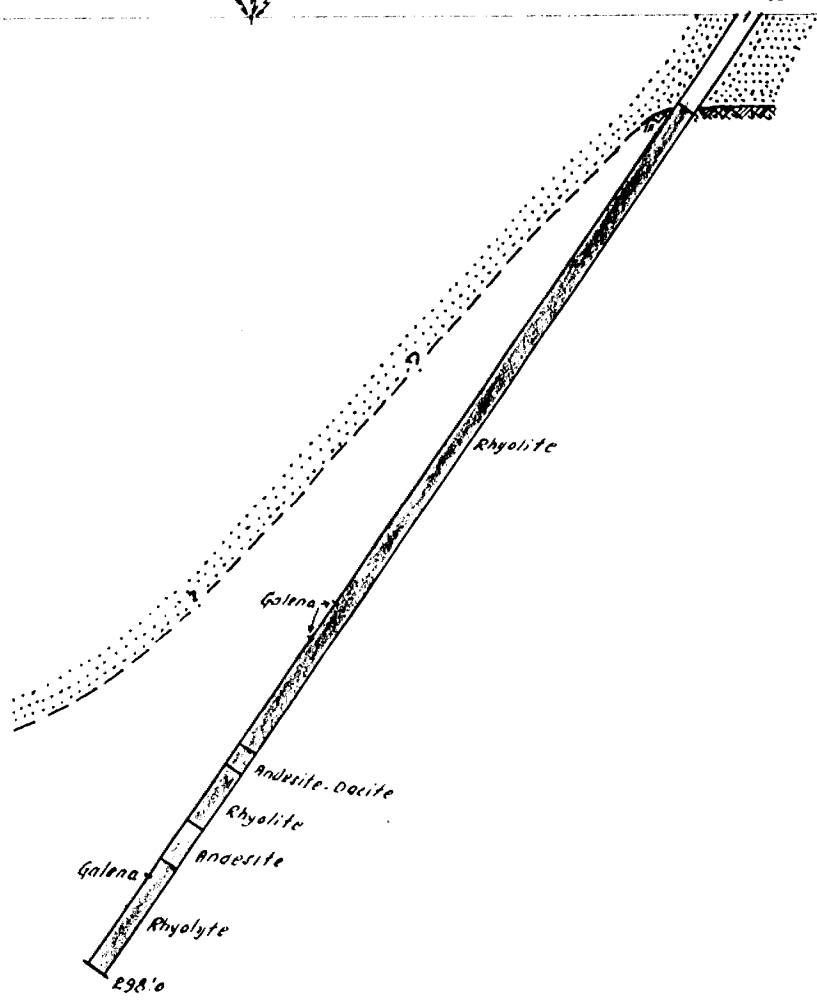

BLACK BAY URANIUM LIMITED
REID TOWNSHIP
ONTARIO
SECTION DRILL HOLE B-2
(LOOKING WEST)

SCALE: 1" = 50'

DATE: August, 1964.

LOCATION:
10+80N-4+00W

CONDUCTOR

B-3

50'

100'

150'

200'

250'

300'

350'

396'

Gabbro

BLACK BAY URANIUM LIMITED

REID TOWNSHIP
ONTARIO

SECTION DRILL HOLE B-3

(LOOKING WEST)

SCALE: 1" = 50'

DATE: Sept., 1964.

LOCATION:
21°00'N - 36°W

B-4

Conductor

N. Boundary

50'

100'

150'

200'

250'

300'

350'

400'

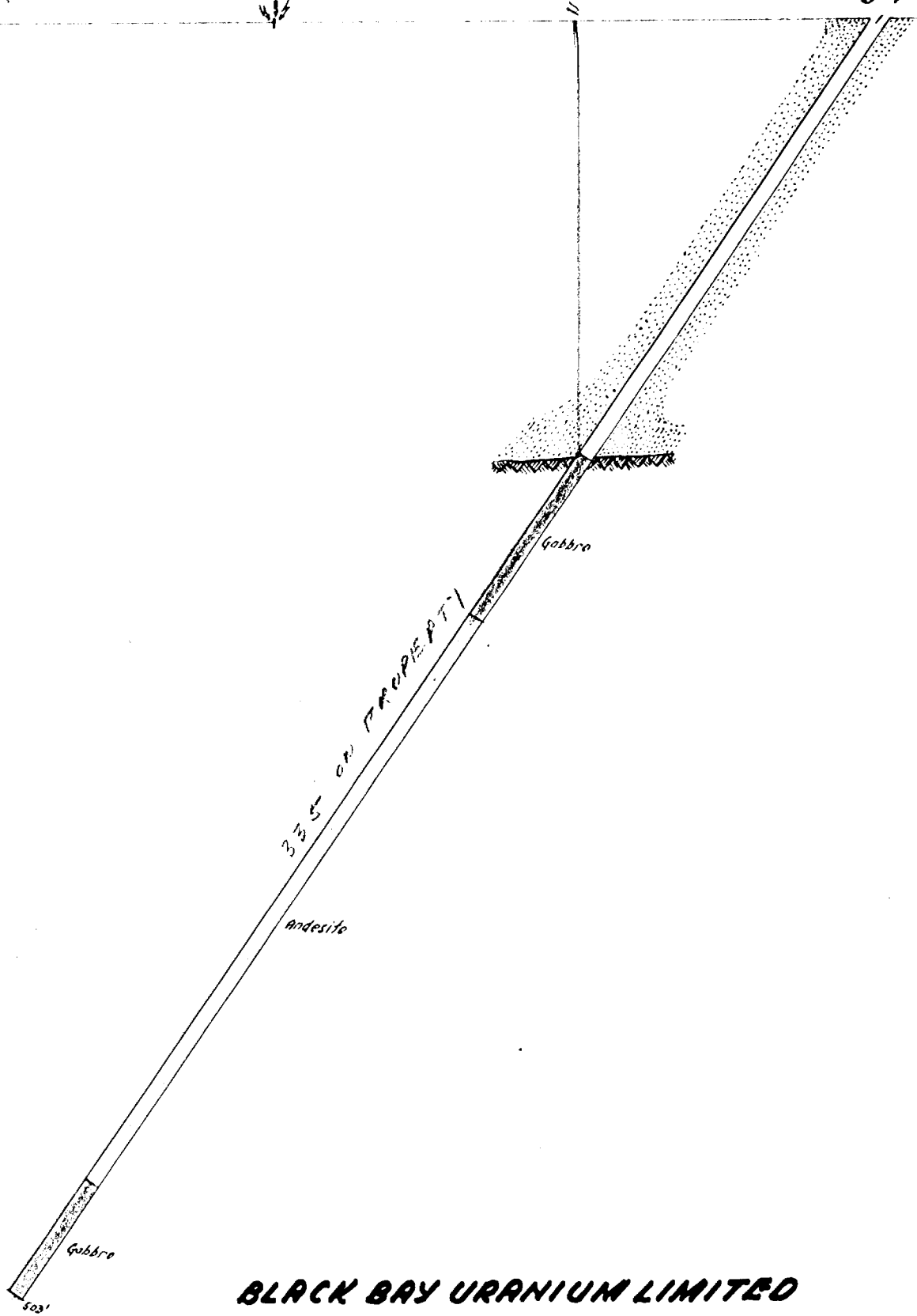

BLACK BAY URANIUM LIMITED
REID TOWNSHIP
ONTARIO

SECTION DRILL HOLE B-4
(LOOKING WEST)

SCALE: 1" = 50'

DATE: SEPT., 1964.

LOCATION: 18100S, 24W

LOCATION: 16100S, 24W

B-5

B-6

CONDUCTOR

50

100

150

200

250

300

350

400

Rhyolite

Rhyolite

Granite Dyke

140

500

BLACK BAY URANIUM LIMITED
REID TOWNSHIP
ONTARIO

SECTION DRILL HOLES B-5 & B-6
(LOOKING WEST)

SCALE 1"=50'

DATE: OCT, 1964

F. R. B. KENNEDY & ASSOCIATES

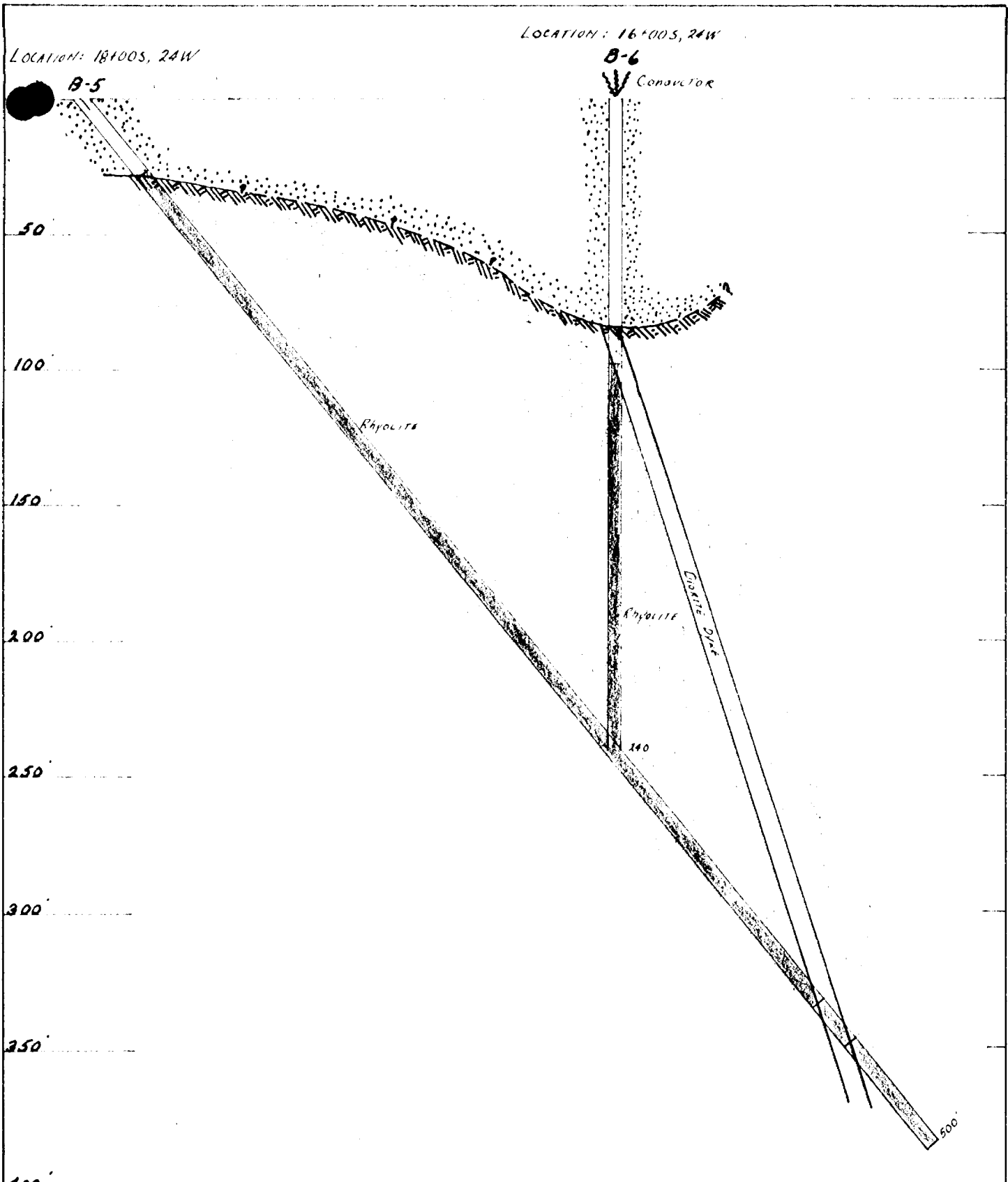

LOCATION: 2100S, 4W

B-7

CONDUCTOR

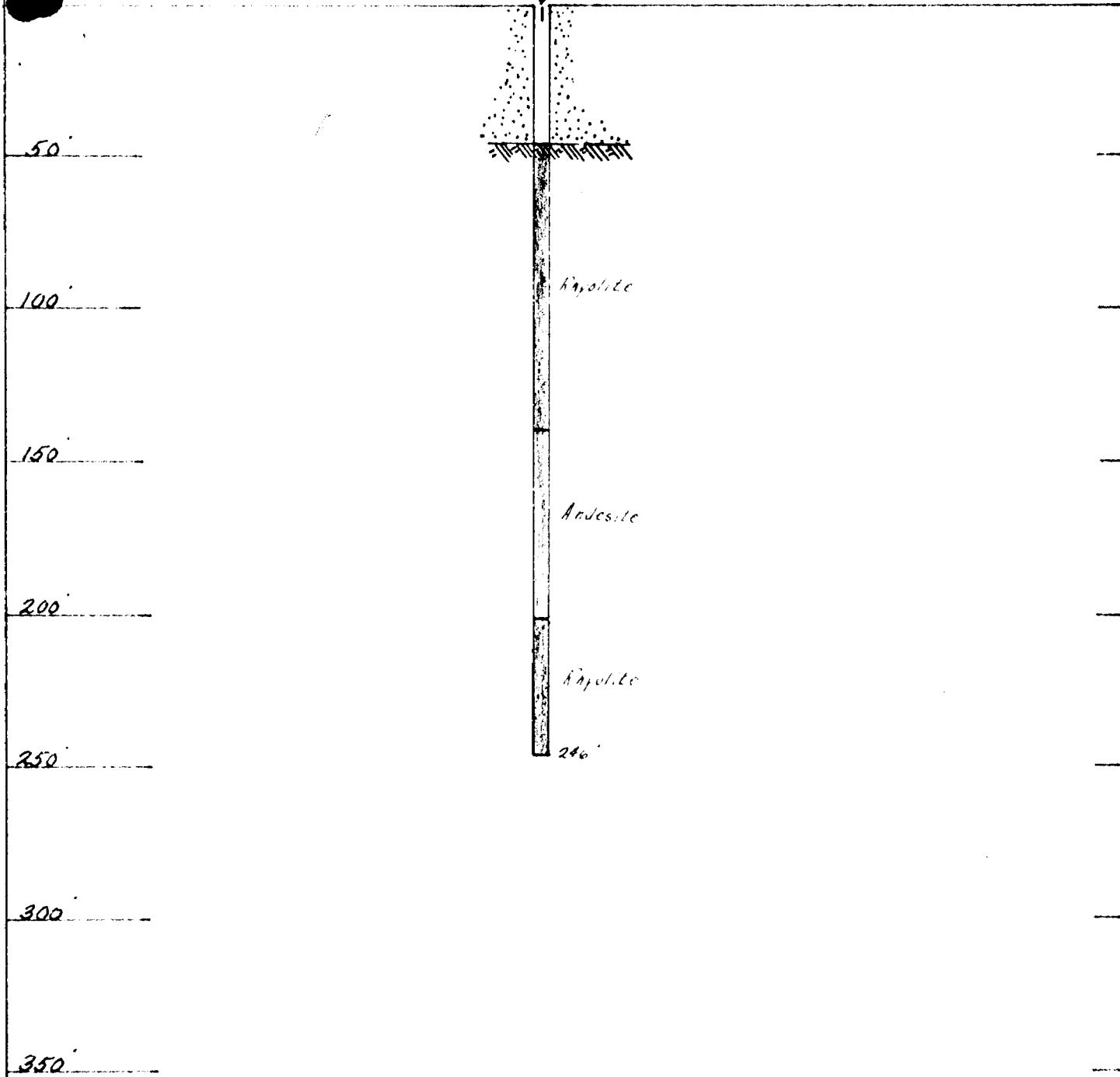

BLACK BAY URANIUM LIMITED
REID TOWNSHIP
ONTARIO
SECTION DRILL HOLE B-7
(LOOKING WEST)

SCALE 1"=50'

DATE: OCT, 1964

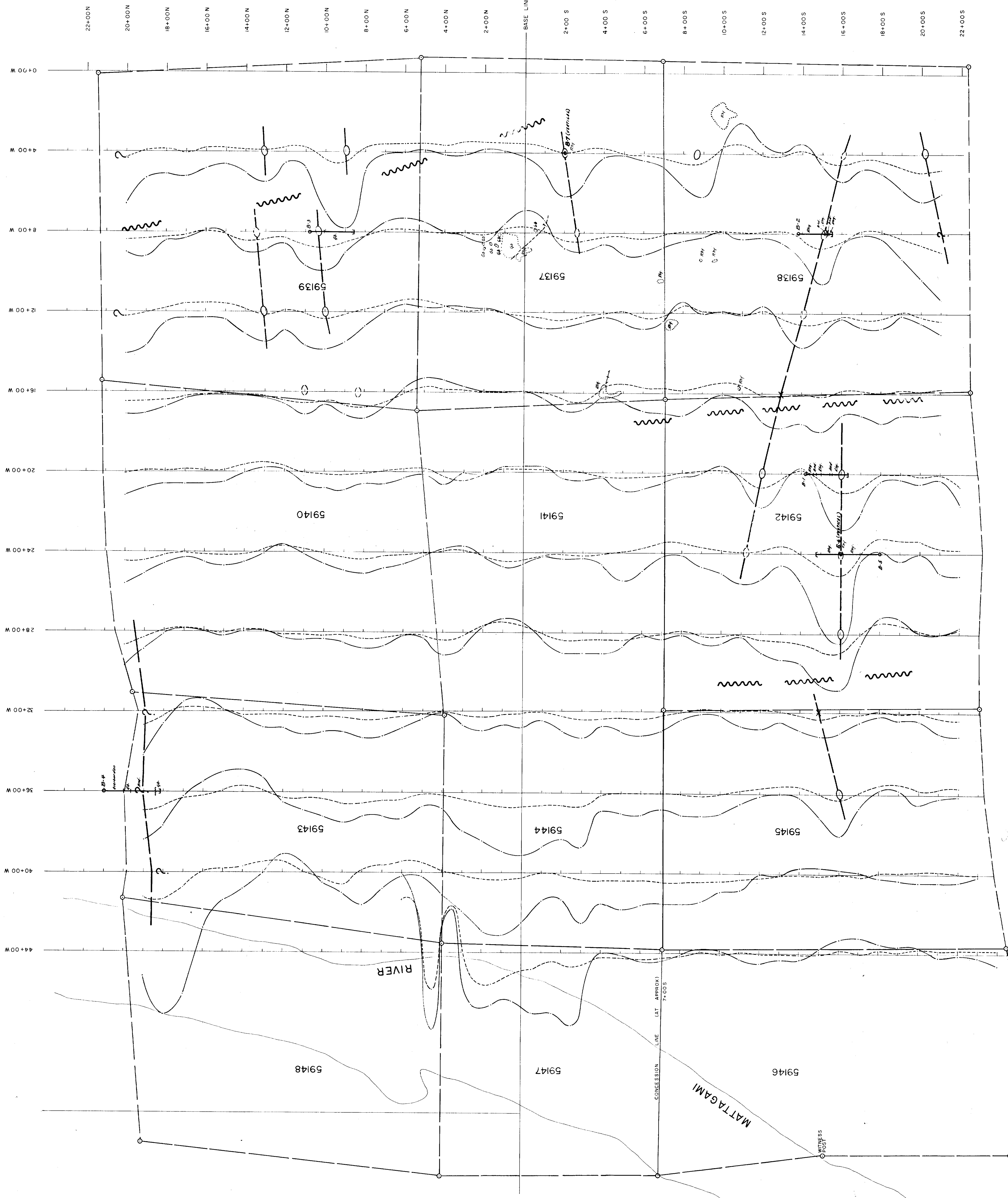

- LEGEND**
- Claim post (approx. location)
 - Medium to strong anomaly
 - Weak to medium anomaly
 - Weak anomaly possibly due to disseminated sulphides
 - Axis of major anomalous trend
 - Location of conducting zone uncertain
 - ? Possible fault zone
 - Diamond drill hole
 - Rhyolite
 - Anesite
 - gabbro

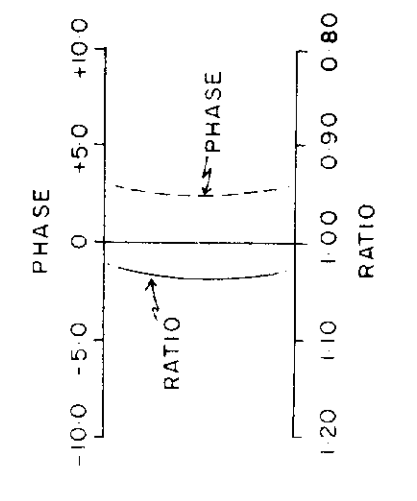

BLACK BAY URANIUM LIMITED
 TURAM ELECTROMAGNETIC SURVEY
 REID TOWNSHIP
 TIMMINS AREA, ONTARIO
 INTERPRETATION

SCALE 1:200 Feet
 HUNTEC LIMITED, TORONTO, CANADA - JULY 1984
 E. B. N. CHOW, Geophysicist

*Geology will have information Sept - Oct, 1984
 Advance Planning Administration*

REID TWT
 DD 20

