



42A11SE0029 17 MATHESON

010

Diamond Drilling

Township of MATHESON

Report NO: 17

Work performed by: J. V. Bonhomme

Claim NO	Hole NO	Footage	Date	Note
P 308568	76-1	568'	Jan/76	(1)
P 308565	76-2	552'	Feb/76	(1)
P 308554	76-3A	601'	Feb/76	(1)
	76-3	195'	Feb/76	(2)
P 308564	76-4	302'	Mar/76	(2)
P 308553	76-5	688'	Mar/76	(1)
<del>P 308557</del> 308559 ?	76-6	680'	Mar/76	(1)
P 308598	76-7	847'	Mar/76	(3)

Notes:

- (1) #51/76
- (2) #52/76
- (3) #56/76

# DIAMOND DRILL RECORD

P 308568

**PROPERTY** J. V. BONHOMME **HOLE NO.** 76-1  
**TOWNSHIP** Matheson Township **PAGE NO.** 1  
**LOCATION** Line 48+00 West **CORE LOCATION** 79 Pine St. S. - **STARTED** January 23, 1976  
9+00 N at tie line along **DATUM** basement **COMPLETED** January 28, 1976  
Conc. III-IV **BEARING** south **DEPTH** 568'  
**ELEVATION** \_\_\_\_\_ **DIP** 55°

DEPTH FEET	FORMATION	SAMPLE NO.	WIDTH OF SAMPLE			
0 - 86	Casing (overburden)					
86 - 271	Greywacke-slate: well defined bedding @ 45° to c.a., grey fine gr. greywacke alternates with minor carbonaceous slate bands, occ. vug.					
	109 erosional unconformity suggests tops down hole					
	171 5" barren fractured qtz-carb - fault ?					
	177 few qtz-carb str.					
	211 fractured qtz-carb str. - fault ?					
	239 erosional unconformity suggests tops down hole					
	262.5 minor pyrite; bedding @ 60° to c.a.					
	263-269 fractured, broken, vuggy, core; rust spots					
	269 .7' core ground					
	269-271 vuggy, silicified, pyritized, greywacke					
	263-271 Conductor					
271 - 296.5	Carbonatized Intermediate Volcanic: grey, buff, fine grained, white speckles, odd qtz str. & diss. pyrite.					
	270.5-275.5	1-1	5.0	Au		
	291-293 mod. pyrite in qtz. str. at 10° to c.a.	1-2	2.0	Au		

Drilled By Marisette Diamond Drilling

Signed *[Signature]*  
**SHIELD GEOPHYSICS LIMITED**

# DIAMOND DRILL RECORD

PROPERTY J. V. BONHOMME

HOLE NO. 76-1

TOWNSHIP Matheson Township

PAGE NO. 2

LOCATION \_\_\_\_\_

CORE LOCATION \_\_\_\_\_

STARTED \_\_\_\_\_

\_\_\_\_\_

DATUM \_\_\_\_\_

COMPLETED \_\_\_\_\_

ELEVATION \_\_\_\_\_

BEARING \_\_\_\_\_

DEPTH \_\_\_\_\_

DIP \_\_\_\_\_

DEPTH FEET	FORMATION	SAMPLE NO.	WIDTH OF SAMPLE				
296.5 - 369	Carbonate Rock: much carbonate, some mariposite-fuchsite micaceous mineral-sericite ?, odd qtz. str. & diss. pyrite.						
369 - 383	Carbonatized Agglomerate (?): fairly well defined rounded lapilli - 3/4" & up, bedding @ 45°, grey buff coloured, highly carbonatized with micaceous mineral.						
383 - 568	Carbonate Rock: grey-buff, fine grained, soft with micaceous mineral, occ. barren qtz. str., some mariposite generally with qtz. str., minor pyrite as 1/8" blebs, banding @ 45° to c.a.						
454	amygdules (?)						
470-478	exhibits tuffaceous & agglomeratic structures indicating tops down hole, bedding @ 60° to c.a.						
477.5	3" pinkish vuggy carbonate marking fault ?						
548	6" irregular barren qtz.						
560	8" irregular barren qtz.						
568	END.						

DIP TESTS  
200' - 45°  
568' - 29°

Drilled By Morissette Diamond Drilling

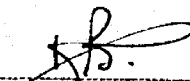
Signed 

HOYLE TWP.  
TWP. BERRY

MATHESON TWP.

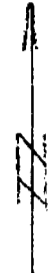
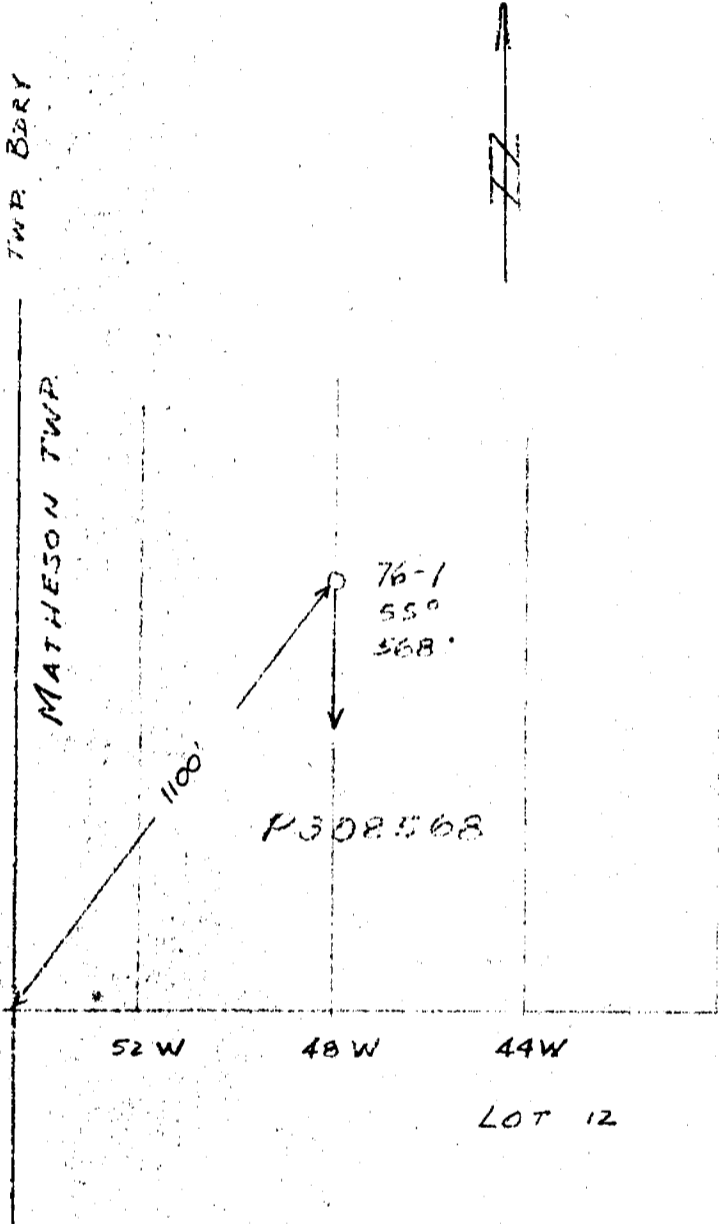

CONC. IV  
CONC. III B'atic line

LOT 12

LOCATION N  
DRILL HOLE 76-1  
1" = 400'

# DIAMOND DRILL RECORD

*P 308565*

PROPERTY J. V. BONHOMME HOLE NO. 76-2  
 TOWNSHIP Matheson Township PAGE NO. 1

LOCATION Line 16 West CORE LOCATION 79 Pine St. S. STARTED February 3, 1976.  
Station 14 North DATUM basement COMPLETED February 12, 1976  
North Matheson Twp. property BEARING south DEPTH 552'  
 ELEVATION \_\_\_\_\_ DIP 55°

DEPTH FEET	FORMATION	SAMPLE NO.	WIDTH OF SAMPLE			
0 - 124	Casing.					
124 - 184	Altered Intermediate Agglomerate (?): grey-buff v. f. gr. soft, with apparent large bombs & lapilli; carbonatized.					
	130.5-132 core lost.					
	136.5-137 core lost.					
	137.0-143 chloritic & vuggy					
	138.0-140 core lost					
	163.5 mud seam					
	161.0 vugs after pyrite, same rusty pyrite diss. as xstals					
184 - 247	Fault Breccia: light coloured fragments in black carbonaceous matrix, sli. diss. pyrite, some secondary carbonate seaming.					
	184.0 2" heavy crystalline pyrite					
	195.5-196.5 core lost					
	206.5-207.0 core lost					
	217.5 2" rust					
247 - 262	Altered Volcanic (?): light grey, soft, few fractures, vuggy, sli. pyrite.					

Drilled By Morissette Diamond Drilling

Signed *[Signature]*  
 SHIELD GEOPHYSICS LIMITED

# DIAMOND DRILL RECORD

PROPERTY J. V. BONHOMME HOLE NO. 76-2

TOWNSHIP Matheson Township PAGE NO. 2

CORE LOCATION \_\_\_\_\_ STARTED \_\_\_\_\_

DATUM \_\_\_\_\_ COMPLETED \_\_\_\_\_

BEARING \_\_\_\_\_ DEPTH \_\_\_\_\_

DIP \_\_\_\_\_

FORMATION	SAMPLE NO.	WIDTH OF SAMPLE			
Graphite: (Conductor), black, carbonaceous, laminated @ 70° to c.a., some pyrite.					
62-270 brecciated, vuggy, soft					
264-267 core ground					
270 heavy pyrite in seams					
271-277 core ground					
277 dense graphitic material with med. green mineral on slips (serpentine type ?)					
280-283 core ground					
284-287 core ground					
285-286 fractured siliceous zone					
288-291 core ground					
Carbonaceous Slate: thin carbonaceous bands					
in slate with greywacke, bedding @ 70°, occasional slate seams in fractures.					
297 core ground					
297 feldspar porphyry, grey & sericitized					
greywacke: generally, grey, fine grained, some bedding @ 75-80° to c.a., occ. qtz-carb str. with pyrite.					

Matheson Morissette Diamond Drilling

Signed \_\_\_\_\_

SHIELD GEOPHYSICS LIMITED

# DIAMOND DRILL RECORD

PROPERTY J. V. BONHOMME HOLE NO. 76-2  
 TOWNSHIP Matheson Township PAGE NO. 3

LOCATION \_\_\_\_\_ CORE LOCATION \_\_\_\_\_ STARTED \_\_\_\_\_  
 \_\_\_\_\_ DATUM \_\_\_\_\_ COMPLETED \_\_\_\_\_  
 \_\_\_\_\_ BEARING \_\_\_\_\_ DEPTH \_\_\_\_\_  
 ELEVATION \_\_\_\_\_ DIP \_\_\_\_\_

DEPTH FEET	FORMATION	SAMPLE NO.	WIDTH OF SAMPLE				
	413-415 some irreg. qtz.						
	479, 479.5 2" & 4" vuggy grey qtz.						
	481 2" purple qtz. str. with sli. py. @ 15° to c.a.						
491.5 - 552	Slate: black & grey layers bedded @ 75-80° to c.a.						
	507-508.8 feldspar porphyry, grey sericitized						
	508.8-511.2 irreg. white qtz. in porphyry						
	511.2-512 pink carb. fracture @ 5° to c.a.						
	531.7-532.7 few grey qtz. str. with some pyrite-pyrrhotite						
552	END.						
	Dip Test: 500' - 26°						

Drilled By Morissette Diamond Drilling

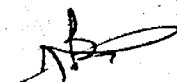
Signed  \_\_\_\_\_

MATHESON TWP.

CONG. III

LOT 11

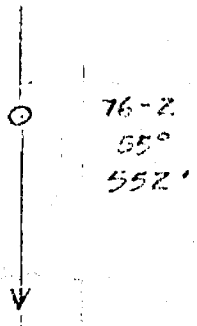

76-2  
55°  
552'

P 308565

Creek

PORCUPINE  
RIVER

20W

16W

12W

N 1/2 CONG. III

S 1/2 CONG. III

LOCATION  
DRILL HOLE 76-2  
1" = 400'



# DIAMOND DRILL RECORD

*P 304554*

**PROPERTY** J. V. BONHOMME **HOLE NO.** 76-3A  
**TOWNSHIP** Matheson Township **PAGE NO.** 1  
**LOCATION** Line 4 East **CORE LOCATION** 79 Pine St. S. - **STARTED** February 21, 1976  
 Station 10+25 North **DATUM** basement **COMPLETED** March 3, 1976  
 North Matheson Township property **BEARING** South **DEPTH** 601'  
**ELEVATION** **DIP** 58°

DEPTH FEET	FORMATION	SAMPLE NO.	WIDTH OF SAMPLE			
0 - 248	Overburden.					
248 - 381	Greywacke-Slate: grey to black, bedding @ 60° to c.a., tops appear down hole by grain gradation, odd quartz stringer.					
	260-266 core ground					
	272-273 core ground					
	310.5 - 3" carbonate + gouge & graphite with bedding					
	311.2-312.0 graphitic & broken					
	313.5-315.0 core ground					
	345 - 4" barren conformable qtz-sericite stringer					
	347.3 - 8" barren conformable qtz-sericite str.					
381 - 405	Fault Zone: in greywacke, broken, minor carb. & qtz. str.					
	381-382 carbonate filled breccia @ 25° to c.a.					
	383-384 broken with gouge @ 25° to c.a.					
	388.5-389.5 core lost					
405 - 601	Greywacke: grey v. f. to f. grained, bedding @ 70-75° to c.a., tops down hole from grain gradation.					
	450.7-452 30% irreg. qtz-sericite					

Drilled By Morissette Diamond Drilling

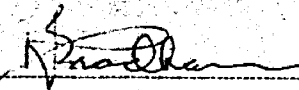
Signed   
 SHIELD GEOPHYSICS LIMITED

# DIAMOND DRILL RECORD

*P 304554*

**PROPERTY** J. V. BONHOMME **HOLE NO.** 76-3A  
**TOWNSHIP** Matheson Township **PAGE NO.** 1  
**LOCATION** Line 4 East **CORE LOCATION** 79 Pine St. S. - **STARTED** February 21, 1976  
 Station 10+25 North **DATUM** basement **COMPLETED** March 3, 1976  
 North Matheson Township property **BEARING** South **DEPTH** 601'  
**ELEVATION** **DIP** 58°

DEPTH FEET	FORMATION	SAMPLE NO.	WIDTH OF SAMPLE				
0 - 248	Overburden.						
248 - 381	Greywacke-Slate: grey to black, bedding @ 60° to c.a., tops appear down hole by grain gradation, odd quartz stringer.						
	260-266 core ground						
	272-273 core ground						
	310.5 - 3" carbonate + gouge & graphite with bedding						
	311.2-312.0 graphitic & broken						
	313.5-315.0 core ground						
	345 - 4" barren conformable qtz-sericite stringer						
	347.3 - 8" barren conformable qtz-sericite str.						
381 - 405	Fault Zone: in greywacke, broken, minor carb. & qtz. str.						
	381-382 carbonate filled breccia @ 25° to c.a.						
	383-384 broken with gouge @ 25° to c.a.						
	388.5-389.5 core lost						
405 - 601	Greywacke: grey v. f. to f. grained, bedding @ 70-75° to c.a., tops down hole from grain gradation.						
	450.7-452 30% irreg. qtz-sericite						

Drilled By Morissette Diamond Drilling

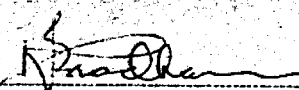
Signed   
SHIELD GEOPHYSICS LIMITED

# DIAMOND DRILL RECORD

PROPERTY \_\_\_\_\_ HOLE NO. 76-3A

TOWNSHIP \_\_\_\_\_ PAGE NO. 2

SECTION \_\_\_\_\_ CORE LOCATION \_\_\_\_\_ STARTED \_\_\_\_\_  
 DATUM \_\_\_\_\_ COMPLETED \_\_\_\_\_  
 BEARING \_\_\_\_\_ DEPTH \_\_\_\_\_  
 ELEVATION \_\_\_\_\_ DIP \_\_\_\_\_

DEPTH FEET	FORMATION	SAMPLE NO.	WIDTH OF SAMPLE	A <sub>2</sub> /z		
	486.3-487 qtz-sericite @ 60°					
	494.4-495 qtz-sericite @ 50°					
	501.5-503 80% qtz-sericite	3A-1	1.5	Tr		
	505.8 1" qtz. str.					
	511.4 2" irreg. qtz.					
	520.5 3" white qtz.					
	533 2" " " @ 45°					
	534.4 2" " " @ 50°					
	554.5 1.5" " " @ 40°					
	580 3" qtz-sericite str. @ 40°					
	588 1" qtz. str. @ 45°					
601	END.					
	<u>Dip Tests</u>					
	250' - 56° true angle					
	600' - 39° true angle					

Drilled By Morissette Diamond Drilling

Signed  \_\_\_\_\_  
 SHIELD GEOPHYSICS LIMITED

P 308564

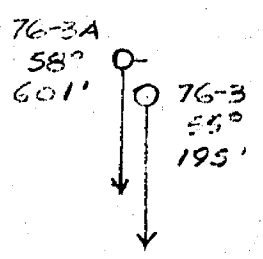
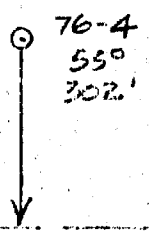

P 308554

MATHESON TWP.

L4E L8E

B

N 1/2 CONC. III  
S 1/2 CONC. III

LOT 11 LOT 10

LOCATION  
DRILL HOLES 76-3, 3A, 4  
1" = 400'

# DIAMOND DRILL RECORD

p. 30

PROPERTY J. V. BONHOMME HOLE NO. 76-5

TOWNSHIP Matheson Township PAGE NO. 1

LOCATION Line 12 East CORE LOCATION 79 Pine St. S. - STARTED March 15, 1976  
Station 0+75 North DATUM basement COMPLETED March 21, 1976  
North Matheson Township property BEARING south DEPTH 688'  
 ELEVATION \_\_\_\_\_ DIP 55°

DEPTH FEET	FORMATION	SAMPLE NO.	WIDTH OF SAMPLE	Au/oz			
0 - 132	Casing - overburden.						
132 - 233	Greywacke-Slate: broken, odd qtz. str. with pyrite, bedding @ 75° to c.a. shown by thin layers of black slate, large xstals of pyrite.						
	144-146 core lost						
	154-156 core lost						
	164-167 core lost						
	170.1 - 4" qtz. str. + pyrite @ 30°						
	182-185 whole core	5-2	3.0'				
	182 - 1" qtz. str. + pyrite @ 45°						
	183 - 1.2" qtz. with pyrite 45°						
	204.6 - 2 2" qtz. str. with pyrite						
	206 - 1" qtz. str. with pyrite						
	207.5 - 1" " " " "						
	210 - 2" " " " " @ 50° + sericite						
	213.5 - 1" " " " "						
	223.5 - 1" " " " "						
	225.0 - 5" " " " " @ 50° + "						
233 - 237.5	Fault zone in greywacke - shearing, carbonatization, carbonization, 2" gouge.						

Drilled By Morissette Diamond Drilling

Signed [Signature]

SHIELD GEOPHYSICS LIMITED

# DIAMOND DRILL RECORD

PROPERTY \_\_\_\_\_ HOLE NO. 76-5

ADDRESS \_\_\_\_\_ PAGE NO. 2

\_\_\_\_\_ CORE LOCATION \_\_\_\_\_ STARTED \_\_\_\_\_  
 \_\_\_\_\_ DATUM \_\_\_\_\_ COMPLETED \_\_\_\_\_  
 \_\_\_\_\_ BEARING \_\_\_\_\_ DEPTH \_\_\_\_\_  
 \_\_\_\_\_ DIP \_\_\_\_\_

FORMATION	SAMPLE NO.	WIDTH OF SAMPLE	Au/oz			
Greywacke: v. f. to fine grained, grey uniform, occasional bedding.						
Greywacke: carbonaceous layers were prominent at 75-80° to c.a.						
2.5" barren white qtz.						
Slate:						
orientation indicates tops down hole.						
occasional narrow, barren, irregular quartz stringers						
60% qtz. veining with chlorite,						
sericite, minor pyrite (half core)	5-1	10'				
carbonaceous, banded at 80°.						
Slate: occ. slate band at 80 to 90°						
shearing						
barren quartz						
str.						
uniform, fine to med. gr., shards of						
epiphyroblasts (lathes) of carbonaceous pyritic appearance.						

Signed 



MATHESON TWP.

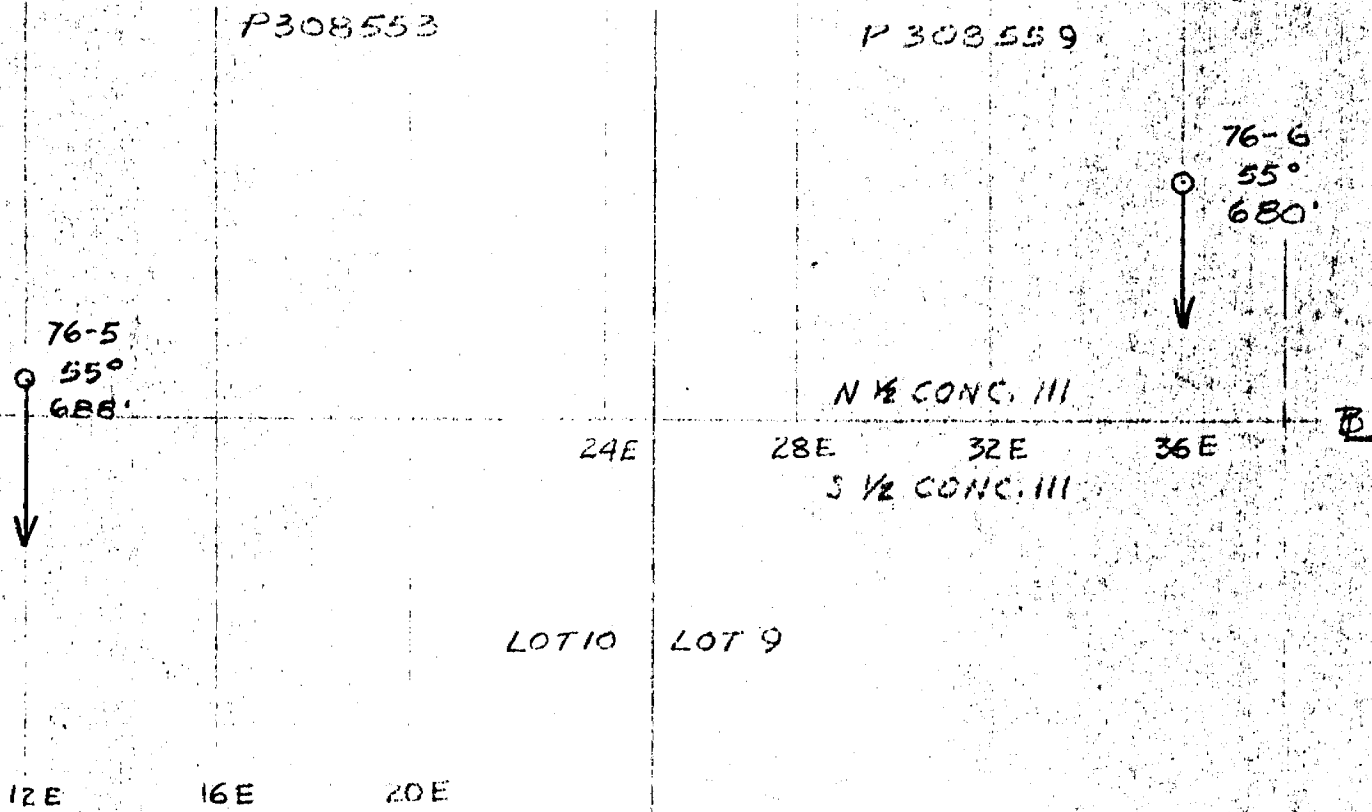

LOCATION II  
DRILL HOLES 76-5, 6  
1" = 400'



# DIAMOND DRILL RECORD

*P. 208557*

PROPERTY J. V. BONHOMME HOLE NO. 76-6  
 TOWNSHIP Matheson Township PAGE NO. 1  
 LOCATION Line 36 East CORE LOCATION 79 Pine St. S. - STARTED March 22, 1976  
Station 5+00 North DATUM basement COMPLETED March 25, 1976  
North Matheson Township property BEARING south DEPTH 680'  
 ELEVATION \_\_\_\_\_ DIP 55°

DEPTH FEET	FORMATION	SAMPLE NO.	WIDTH OF SAMPLE			
0 - 190	Casing - overburden.					
190 - 680	Greywacke - slate: v. f. to f. grained greywacke beds with thin slate banding @ 70° to c.a., porphyroblastic appearance from lenses of carb. diss. throughout to 250'. 192 - 2" qtz. str. @ 45° to c.a. with some sericite 236 - 2" qtz. str. 259.5 - 2" qtz. str. 271 - 4" qtz. str. @ 50° 295.3 - 2" " " 314.6 - 2" " " 372 - 6" qtz. str. 452 - 2" " " 454-455 qtz. str. with graphitic parting 500 - bedding @ 80-85° 538 - 6" qtz. stringer 650 - 6" qtz.-carbonate 655.5-656.5 60% qtz. carb. str. @ 85° to c.a. 662.2 - 4" qtz.-carb. @ 90°					

680 END Dip Tests: 600' - 32°

Drilled By Morissette Diamond Drilling

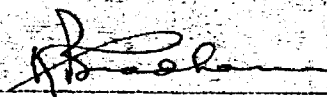
Signed   
SHIELD GEOPHYSICS LIMITED

#52/76

MATHESON TWP.

J. V. BONHOMME

MATHESON TWP.

P308584

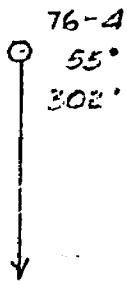

LOCATION  
DRILL HOLES 76-3 & 4  
1" = 400'

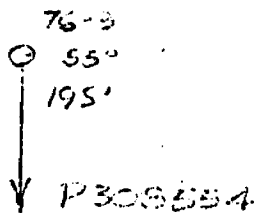

LOT 11

LOT 10

N 1/2 CONC III  
E  
S 1/2 CONC III

0

4E

8E

12E

16E

Re: Holes 76-3, 76-4

76-3 - 195'

	J. Cretes	M. Pelletier	W. Caron	M. Savoie	N. Laplante	L. Joly
Feb. 15	12 hr.	12 hr.	12 hr.	12 hr.	12 hr.	
17	9	9	8	9	8	9 hr.
18	11	11	12	12	12	11
19	12	12	12	12	12	12

76-4 - 302'

	J. Cretes	V. Menier	W. Caron	M. Savoie	N. Laplante	L. Cutts
Mar. 6	12 hr.	12 hr.	12 hr.	12 hr.	12 hr.	12 hr.
7	12	12	8	12	12	
8	12	12	12	12	12	
9	12	12	12	12	12	
10	12	12	12	12	12	
	—	—	—	—	—	—
Total	104	104	100	105	104	44

Total hours = 561 hours/3 = 187 days

Address of Men: Morissette Diamond Drilling Co.  
Halleybury, Ontario

# DIAMOND DRILL RECORD

PROPERTY J. V. BONHOMME HOLE NO. 76-3

TOWNSHIP Matheson Township PAGE NO. 1

LOCATION Line 4 East  
P308554 Station 9+50 North  
North Matheson Township property  
 ELEVATION \_\_\_\_\_

CORE LOCATION \_\_\_\_\_  
 DATUM \_\_\_\_\_  
 BEARING South  
 DIP 55°

STARTED February 16, 1976  
 COMPLETED February 20, 1976  
 DEPTH 195'

DEPTH FEET	FORMATION	SAMPLE NO.	WIDTH OF SAMPLE			
0 - 195	Overburden					
	Hole abandoned.					

Drilled By Morissette Diamond Drilling

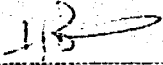
Signed   
**SHIELD GEOPHYSICS LIMITED**

# DIAMOND DRILL RECORD

PROPERTY J. V. BONHOMME HOLE NO. 76-4  
 TOWNSHIP Matheson Township PAGE NO. 1

LOCATION Line 8 East CORE LOCATION \_\_\_\_\_ STARTED March 5, 1976  
P308564 Station 18 North DATUM \_\_\_\_\_ COMPLETED March 11, 1976  
North Matheson Township property BEARING south DEPTH 302'  
 ELEVATION \_\_\_\_\_ DIP 55°

DEPTH FEET	FORMATION	SAMPLE NO.	WIDTH OF SAMPLE				
0 - 302	Casing: overburden, including clay and some boulders.						
	Hole abandoned						

Drilled By Morissette Diamond Drilling

Signed \_\_\_\_\_  
**SHIELD GEOPHYSICS LIMITED**

INVOICE

**N. MORISSETTE**  
**DIAMOND DRILLING LIMITED**  
 CONTRACT DIAMOND DRILLING  
 BOX 789 HAILEYBURY, ONT. TEL 672-3326

REMIT TO  
 BOX 789  
 HAILEYBURY, ONT.: POJ 1K0

INVOICE NO. No 6691 R

INVOICE DATE February 23, 1970

IN ACCOUNT WITH

J. V. Bonhomme Real Estate  
 c/o R. J. Bromshaw  
 Shield Geophysics Limited  
 26 Pine Street South  
 TIMMINS, Ontario

Dr.

150 Ft. Drilling through overburden	@ \$ 8.50 /Ft.	\$ 1,275.00
150 Ft. " " "	@ 11.50 /Ft.	1,725.00
254 Ft. " " "	@ as per attached	6,034.34
567 Ft. Rock Diamond Drilling	@ 8.50 /Ft.	4,819.50
52 Ft. " " "	@ 9.40 /Ft.	488.80
2 tests (0-500')	@ 17.00 each	34.00
Culling casing charges - as per attached		1,533.95
Moving charges - as per attached		2,881.45
Water line charges - as per attached		3,716.63
		<u>\$22,508.67</u>

Hole #	Overburden			Rock Drilling	
	to 50'	100'	Over	to 500'	1000'
76-2	50'	50'	22'	378'	52'
75-3	50'	50'	84'		
76-3A	50'	50'	148'	189'	
	<u>150'</u>	<u>150'</u>	<u>254'</u>	<u>567'</u>	<u>52'</u>

February - Surface A.N.T. - Timmins Area

456/76

MATHESON

TWP

Hoyle TWP

J.V. BONHOMME

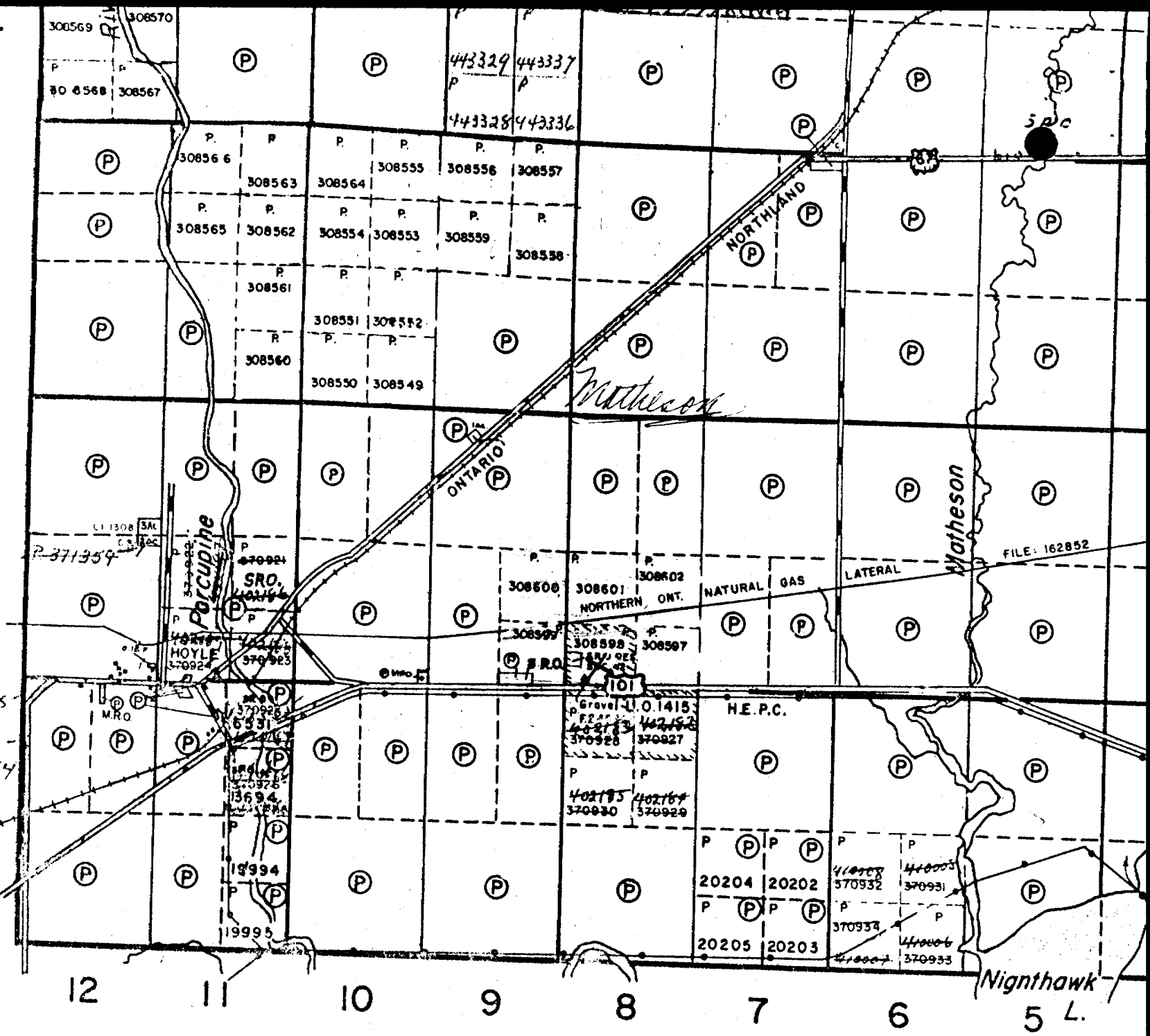

443505  
443506

443507  
443508

12 11 10 9 8 7 6 5 L.

Cody Twp

MATHESON TWP.

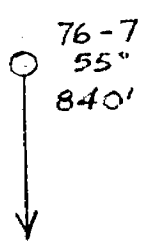

LOCATION  
DRILL HOLE 76-7  
1" = 200'

P 308 69 8

LOT 9 LOT 8

L 24W

L 20W

CONC II

CONC I

R

HWY 101



# DIAMOND DRILL RECORD

PROPERTY J. V. BONHOMME HOLE NO. 76-7  
 TOWNSHIP Matheson Township PAGE NO. 1  
 LOCATION Line 24 West CORE LOCATION 79 Pine St. S. - STARTED March 26, 1976.  
Station 11+00 North basement COMPLETED March 29, 1976.  
South Matheson Township property BEARING south DEPTH 847'  
 ELEVATION \_\_\_\_\_ DIP 55°

DEPTH FEET	FORMATION	SAMPLE NO.	WIDTH OF SAMPLE				
0 - 176	Casing.						
176 - 335	Altered Intermediate Volcanic: soft, light to medium green with carbonate filling fractures occasionally vuggy.						
	194-206 vugs appear to be after pyrite & chlorite in places, very soft						
	228-231 peculiar silicified zone with filigree-type pyrite dissemination						
	248-250 graphite with some pyrite						
	251 vuggy						
	252-335 bleached to buff colour						
	277.6-278.2 white qtz. with mariposite fuchsite						
	302 1" white qtz-carb + mariposite						
	310 2" " " " str.						
335 - 360	Altered Volcanics: carbonaceous & carbonatized, some pyrite.						
	352 2" graphite with pyrite						
	356-360 carbonaceous						

Drilled By Morissette Diamond Drilling

Signed [Signature]  
SHIELD GEOPHYSICS LIMITED

# DIAMOND DRILL RECORD

PROPERTY J. V. BONHOMME HOLE NO. 76-7  
 TOWNSHIP Matheson Township PAGE NO. 1  
 LOCATION Line 24 West CORE LOCATION 79 Pine St. S. - STARTED March 26, 1976  
Station 11+00 North basement COMPLETED March 29, 1976  
South Matheson Township property BEARING south DEPTH 840'  
 ELEVATION \_\_\_\_\_ DIP 55°

DEPTH FEET	FORMATION	SAMPLE NO.	WIDTH OF SAMPLE			
0 - 201	Overburden.					
201 - 840	Intermediate Volcanics: v. f. gr., light to med. green, uniform, with occasional seams of pyrite.					
840	END.					

Drilled By Morissette Diamond Drilling Signed [Signature]  
SHIELD GEOPHYSICS LIMITED

# DIAMOND DRILL RECORD

PROPERTY \_\_\_\_\_ HOLE NO. 76-7  
 TOWNSHIP \_\_\_\_\_ PAGE NO. 2

LOCATION \_\_\_\_\_ CORE LOCATION \_\_\_\_\_ STARTED \_\_\_\_\_  
 \_\_\_\_\_ DATUM \_\_\_\_\_ COMPLETED \_\_\_\_\_  
 \_\_\_\_\_ BEARING \_\_\_\_\_ DEPTH \_\_\_\_\_  
 ELEVATION \_\_\_\_\_ DIP \_\_\_\_\_

DEPTH FEET	FORMATION	SAMPLE NO.	WIDTH OF SAMPLE	Au/OZ			
360 - 602	Altered Intermediate Volcanics: uniform, buff coloured, v. f. grained, carbonatized, mariposite-fuchsite on parting planes. from 457 - grades to light to med. green colour						
	466 5" qtz. stringer						
	509 grades to grey colour from carbonate						
	554-562.5 buff colour with moderate pyrite diss.						
602 - 662	Altered Intermediate Agglomerate: buff to grey coloured, carbonatized, light coloured fragments at least 2" diameter with dark matrix, occ. disseminated pyrite. 602-612 disseminated pyrite & arsenopyrite						
	606-611 1/2 whole core	7-1	5.0				
662 - 847	Altered Intermediate Volcanic: uniform, carbonatized, light grey-green, slight pyrite diss. from 757 - becomes more coarsely crystalline carbonate						
847	END. Dip Test @ 700' - 47°						

Drilled By Morissette Diamond Drilling

Signed  \_\_\_\_\_  
 SHIELD GEOPHYSICS LIMITED

Hoyle Twp.

#5176 MATHESON TWP.  
J. V. BONHOMME

S.R.O.  
S.R.O.

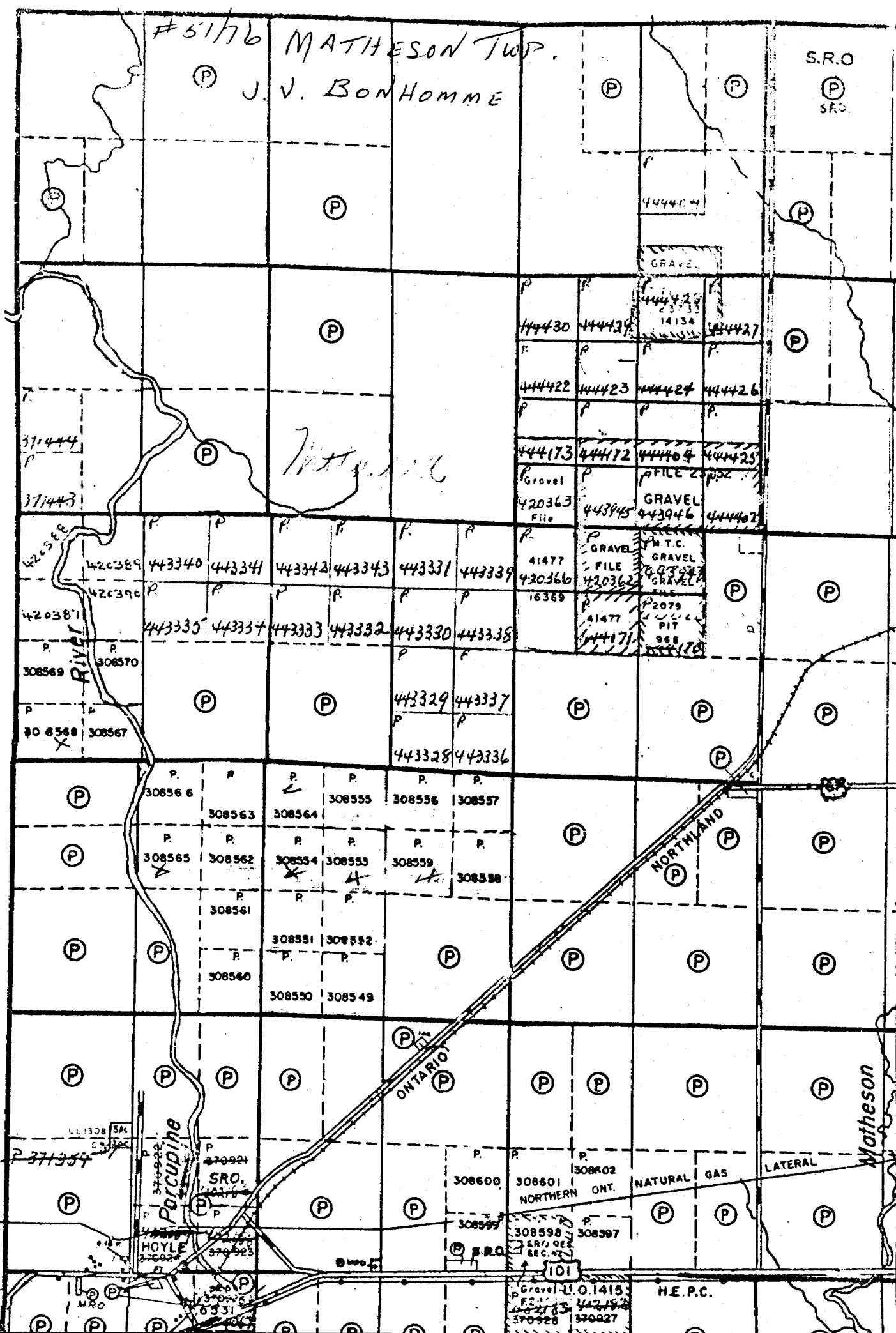

P44335's  
P44336's