



42A11SE0050 31 MATHESON

010

DIAMOND DRILLING

Township: Matheson

Report No: 31

WORK PERFORMED FOR: Kidd Creek Mines Ltd.

RECORDED HOLDER: SAME AS ABOVE [x]

: OTHER []

<u>CLAIM NO.</u>	<u>HOLE NO.</u>	<u>FOOTAGE</u>	<u>DATE</u>	<u>NOTE</u>
P 585548	M13-03	240'	Apr/85	(1)

NOTES: (1) #352--85

FROM - TO	DESCRIPTION	SAMPLE NO.	FROM — TO	SAMPLE LENGTH	ASSAYS			
0	46.93							
	CASING							
46.93	49.60							
	PILLOWED MAFICS							
	Light green and fine grained. Unit is pillowed with 30-60mm chloritic selvages. Concentric cooling cracks are common within the pillows. The unit is only weakly carbonated. The core carries 1-2% fine black needles and masses of black tourmaline. Weak schistosity at 65-70° to the core axis.							
49.60	59.05							
	ULTRAMAFICS (Basaltic Komatiite?)							
	Medium to dark green and medium grained. Unit is weakly carbonated and weakly talcose. Moderate schistosity at 65-70° to the core axis. Scattered dark brown to black tourmaline needles. Also carries minor thin carbonate stringers.							
	51.06-52.15 Light to medium green talcose core. Moderately sheared at 70° to the core axis.							
	57.87 - 59.05 Gradational contact into a massive granular mafic.							
59.05	74.0							
	MASSIVE MAFICS							
	Medium to dark green and fine to coarse grained. Unit is moderately to strongly chloritic and weakly to moderately carbonated. Weak schistosity at 70-75° to the core axis. Unit is leucoxene bearing with 1% fine white fibrous leucoxene crystals. Unit carries 1-3% fine black needles and masses of tourmaline.							

Lot 9

Lot 8

Lot 8

Lot 7

II

Con II

I

Con I

101

P 585549

P 585548

P 585551

P 585550

M13-03

68 m

105 m

L 3 E

L 4 E

L 5 E

BLO 000

J. Der Weduwen

LEGEND

 MAFIC VOLCANICS

 ULTRAMAFIC VOLCANICS



KIDD CREEK MINES LTD.

Exploration Division

Timmins, ONTARIO

MATHESON 13
MATHESON Twp.

DRILL PLAN

M 13 - 03

SCALE: 1:5000

Drawn: DerWeduwen

Drawn: DEL

Project N°: 82

Date: 23 / 09 / 85

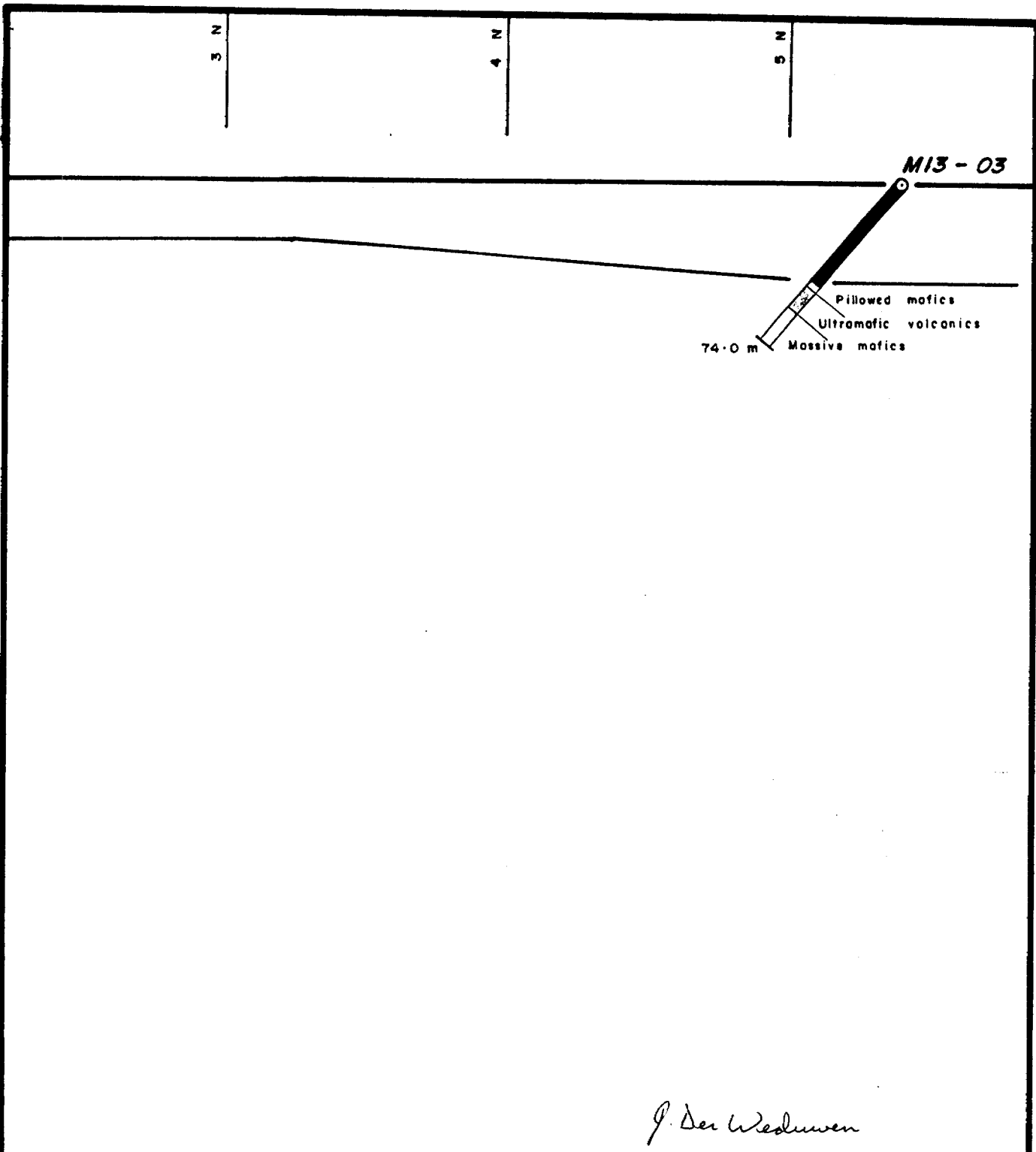

J. Der Weduwen

LEGEND

- MAFIC VOLCANICS
- ULTRAMAFIC VOLCANICS

KIDD CREEK MINES LTD.		
Exploration Division	Timmins, ONTARIO	
<p>MATHESON 13</p> <p>MATHESON Twp.</p> <p>SECTION</p> <p>L 5 E</p> <p>LOOKING WEST</p>		
SCALE: 1 : 2,000	Data: Der Weduwen	
Drawn: DEL	Project N ^o : 82	Date: 23 / 09 / 85



#352/85

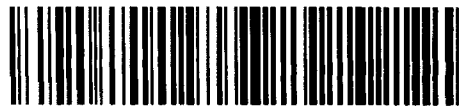

42A11SE0050 31 MATHESON

Mining

900

Name and Postal Address of Recorded Holder
KIDD CREEK MINES LTD. "Matheson Sup"
 571 Moneta Avenue, P. O. Box 1140, Timmins, Ontario P4N 7H9

Summary of Work Performance and Distribution of Credits

Total Work Days Cr. claimed 240	Mining Claim			Mining Claim			Mining Claim		
	Prefix	Number	Work Days Cr.	Prefix	Number	Work Days Cr.	Prefix	Number	Work Days Cr.
for the following work. (Check one only) <input type="checkbox"/> Manual Work <input type="checkbox"/> Shaft Sinking Drifting or other Lateral Work. <input type="checkbox"/> Compressed Air, other Power driven or mechanical equip. <input type="checkbox"/> Power Stripping <input checked="" type="checkbox"/> Diamond or other Core drilling <input type="checkbox"/> Land Survey	P	585548	60						
		585549	60						
		585550	60						
		585551	60						

ONTARIO GEOLOGICAL ASSESSMENT RESEARCH OFFICE

All the work was performed on Mining Claim(s): P-585548, MATHESON TOWNSHIP

Required Information eg: type of equipment, Names, Addresses, etc. (See Table Below) OCT 15 1985

Diamond Drilling by: Norex Diamond Drilling
P. O. Box 88
Porcupine, Ontario
PON 1C0

RECEIVED

Drilling conducted from April 23 to April 26, 1985.

RECORDED

SEP 24 1985

cf.

PORCUPINE MINING DIVISION
RECEIVED
SEP 24 1985

Date of Report Sept. 23, 1985	Recorded Holder or Agent (Signature) <i>J. Der Weduwen</i>
----------------------------------	---

Certification Verifying Report of Work

I hereby certify that I have a personal and intimate knowledge of the facts set forth in the Report of Work annexed hereto, having performed the work or witnessed same during and/or after its completion and the annexed report is true.

Name and Postal Address of Person Certifying
Jack M. Der Weduwen, P. O. Box 1140, 571 Moneta Avenue, Timmins, Ontario P4N 7H9

Date Certified Sept. 23, 1985	Certified by (Signature) <i>J. Der Weduwen</i>
----------------------------------	---

Table of Information/Attachments Required by the Mining Recorder

Type of Work	Specific information per type	Other information (Common to 2 or more types)	Attachments
Manual Work	Nil	Names and addresses of men who performed manual work/operated equipment, together with dates and hours of employment.	Work Sketch: these are required to show the location and extent of work in relation to the nearest claim post.
Shaft Sinking, Drifting or other Lateral Work			
Compressed air, other power driven or mechanical equip.	Type of equipment	Names and addresses of owner or operator together with dates when drilling/stripping done.	
Power Stripping	Type of equipment and amount expended. Note: Proof of actual cost must be submitted within 30 days of recording.		
Diamond or other core drilling	Signed core log showing; footage, diameter of core, number and angles of holes.	Nil	Work Sketch (as above) in duplicate
Land Survey	Name and address of Ontario land surveyor.		Nil

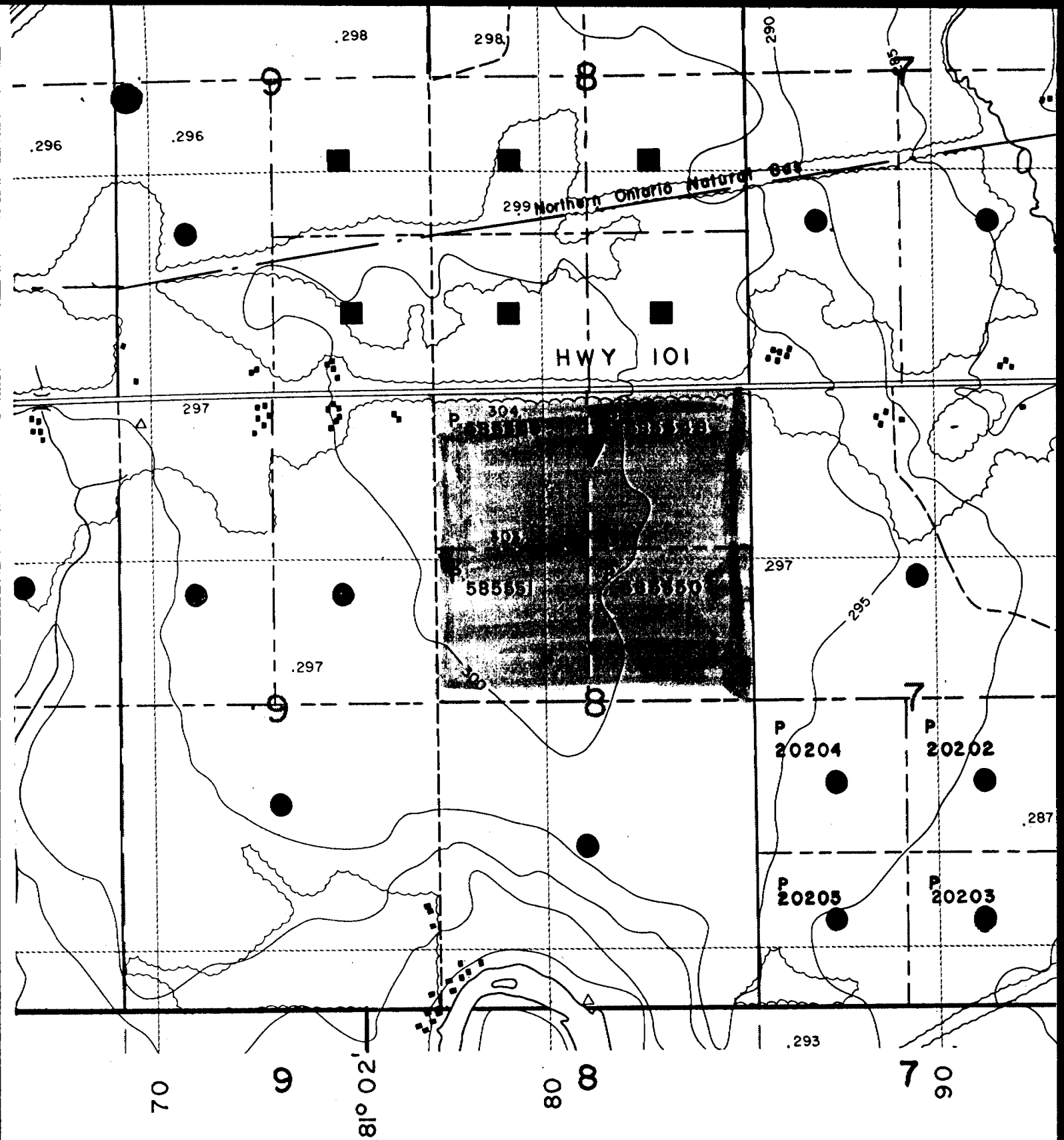

CODY TWP

Matheson Twp.